

CONSTRUCTION SUMMARY

Mountainview Heights 3 (G) - Russell Gardens Building Ltd.

PURCHASERS: Harpreet Singh BAL and Gurmeet BAL

TEL: RES.: 647-549-9311

LOT / PHASE 10 / 3	REG. PLAN # 62M-1266	HOUSE TYPE Mountainash Five (5 Bedroom) Elev 3		
-----------------------	-------------------------	---	--	--

CABINETRY ACCESSORIES

* Appliance Specs. Attached.

1 - KITCHEN CABINETRY BASE - COOKTOP CABINET WITH POT DRAWERS (2 DRAWERS) - STANDARD - 36" 15Dec20 Note:	
1 - KITCHEN CABINETRY - BUILT-IN MICROWAVE/OVEN COMBO - STANDARD 15Dec20 Note:	
1 - PANTRY UNIT UPGRADE - TO GO FROM 300MM TO 600MM DEEP - PRICE IS PER FOOT - STANDARD 15Dec20 Note:	
1 - KITCHEN CABINETRY UPPER - FULL DEPTH ABOVE FRIDGE - WITH GABLES - 600MM - PRICE IS EACH - STANDARD 15Dec20 Note:	

CERAMIC TILE

1 - DELETE ALL CERAMIC BATHROOM ACCESSORIES - DELETE TOWEL BAR, PAPER HOLDER & SOAP DISH THROUGHOUT 15Dec20 Note:	
1 - TILE - UPGRADE 4 FLOOR TILE - - POWDER ROOM 15Dec20 Note:	
1 - TILE - UPGRADE 4 FLOOR TILE - - MUD ROOM 15Dec20 Note:	
1 - TILE - UPGRADE 4 FLOOR TILE - - KITCHEN 15Dec20 Note:	
1 - TILE - UPGRADE 4 FLOOR TILE - - FOYER 15Dec20 Note:	

CONSTRUCTION

1 - BEDROOM 4/5 SHARED ENSUITE -- 5 FOOT SHOWER WITH SLIDING GLASS CHROME DOORS IN LIEU OF TUB 20Jul20 Note:	
1 - BASEMENT 8 FOOT 6 INCH CONCRETE POUR - MEASURED FROM TOP OF FOOTING TO TOP OF FOUNDATION WALL 20Jul20 Note: IF CONSTRUCTION PERMITS	

ELECTRICAL

1 - ABOVE KITCHEN ISLAND - ADD LIGHT AND SWITCH - NO FIXTURE INCLUDED 15Dec20 Note:	
1 - PLUG - ELECTRICAL PLUG - TO BE INSTALLED OVER FIREPLACE 15Dec20 Note:	
1 - LIGHT AND SWITCH - NO FIXTURE INCLUDED - LIVING ROOM 15Dec20 Note:	
1 - BUILT IN OVEN AND COOKTOP PROVISION - PROVISION ONLY - ELECTRICAL ONLY 15Dec20 Note:	

FIREPLACE AND ACCESSORIES

1 - GAS LINE ROUGH-IN FOR STOVE (INCLUDES ELECTRICAL OUTLET) - FIRST FLOOR 15Dec20 Note:	
---	--

RECEIVED

DEC 21 2020

CONSTRUCTION SUMMARY

Mountainview Heights 3 (G) - Russell Gardens Building Ltd.

PURCHASERS: Harpreet Singh BAL and Gurmeet BAL

TEL: RES.: 647-549-9311

LOT / PHASE 10 / 3	REG. PLAN # 62M-1266	HOUSE TYPE Mountainash Five (5 Bedroom) Elev 3		
-----------------------	-------------------------	---	--	--

HARDWOOD FLOORING

1 - HARDWOOD - GROUP A SERIES 5 INCH - IN LIEU OF 2 1/4 INCH NATURAL RED OAK - - LIVING AND DINING ROOM 15Dec20 Note:	
1 - HARDWOOD - GROUP A SERIES 5 INCH - IN LIEU OF 2 1/4 INCH NATURAL RED OAK - - LIBRARY/DEN 15Dec20 Note:	
1 - HARDWOOD - GROUP A SERIES 5 INCH - IN LIEU OF 2 1/4 INCH NATURAL RED OAK - - MAIN HALL 15Dec20 Note:	
1 - HARDWOOD - GROUP A SERIES 5 INCH - IN LIEU OF 2 1/4 INCH NATURAL RED OAK - - FAMILY ROOM 15Dec20 Note:	

PLUMBING

1 - WATER LINE FOR FRIDGE - ROUGH-IN ONLY 15Dec20 Note:	
3 - TOE TESTER - ADD TOE TESTER TO SHOWER - ALL SHOWERS 20Jul20 Note:	



PROMOTIONAL

1 - LESS CREDIT FROM PURCHASER EXTRA SHEET IN OFFER 20Jul20 Note:	
--	--

STAIRS AND RAILINGS

1 - STAIRCASE - V GROOVE HANDRAIL 15Dec20 Note:	
1 - STAIRCASE - EUROLINE 1 IRON PICKETS - BLACK 15Dec20 Note:	
1 - STAINED STAIRS – STANDARD STAIRCASE - PRICE IS PER SET 15Dec20 Note:	

EXTRAS AS PER OFFER

WALK OUT BASEMENT WITH DECK. Worksheet Note:	
INCREASE BASEMENT WINDOWS SIZES, SUBJECT TO ARCHITECTURAL AND ENGINEERING APPROVAL, AS PER SKETCH Worksheet Note:	
200 AMP SERVICE LABELLED WITH CIRCUIT BREAKER PANEL TO UTILITY AUTHORITY STANDARDS Worksheet Note:	
The Vendor agrees that notwithstanding any other term or provision in this Agreement included in the Purchase Price and in addition to those items detailed in Schedule GP to the Agreement of Purchase and Sale, the Purchaser is entitled to a credit of Sev Worksheet Note:	

Purchasers:

Harpreet Singh BAL & Gurmeet BAL

Telephone Res. / Bus:

(647) 549-9311 /

Decor Advisor:

Candace Forza

Lock Date:

15-Dec-20

Property: 10

Project: Russell Gardens Building Ltd.

Model and Elevation: Mountainash Five (5 Bedroom) Elev 3

Plan #: 62M-1266

Layout Changes:

☐ Yes ☒ No

Sketch Attached:

☒ Yes ☐ No

Exterior Colour Scheme:

1. Cabinetry

	Style and Colour	Hardware
Kitchen / Breakfast	DORAL W-500	446SA
Laundry Room	ELISSE	Standard
Powder Room	DORAL W-500	190SA
Master Ensuite Bathroom	MONACO 823 DRIFTWOOD	431SA
Ensuite Bath - Bedroom 2/3	MONACO 823 DRIFTWOOD	431SA
Ensuite Bath - Bedroom 4/5	MONACO 823 DRIFTWOOD	431SA
	N/A	N/A
	N/A	N/A
	N/A	N/A

Appliances:

Built In Appliances ☒ Yes ☐ No

Slide In Stove ☐ Yes ☒ No

Dishwasher Cabinet ☐ Closed ☒ Open

41" Upper Cabinets ☒ Yes ☐ No

Please NOTE: Standard Cabinet Height is 30"

Stove Opening

36" See Specs.

NOTE: If not specified, opening will be set to builder's standard opening of approximately 30" width

Fridge Opening

NOTE: If not specified, opening will be set to builder's standard opening of approximately 37" width x 74" height

** Refer to Construction Summary

2. Counters

	Counter	Edge
Kitchen / Breakfast	LAMINATE-CARRARA BIANCO 6696-46	
Laundry Room	N/A	
Powder Room	LAMINATE-WHITE CARRARA 4924-38	
Master Ensuite Bathroom	LAMINATE-PALOMA POLAR 6698-46	
Ensuite Bath - Bedroom 2/3	LAMINATE-PALOMA POLAR 6698-46	
Ensuite Bath - Bedroom 4/5	LAMINATE-PALOMA POLAR 6698-46	
	N/A	
	N/A	
	N/A	

** Refer to Construction Summary

Initials: he lk

Purchasers:

Harpreet Singh BAL & Gurmeet BAL

Telephone Res. / Bus:

(647) 549-9311 /

Decor Advisor:

Candace Forza

Lock Date:

15-Dec-20

Property: 10

Project: Russell Gardens Building Ltd.

Model and Elevation: Mountainash Five (5 Bedroom) Elev 3

Plan #: 62M-1266

3. Ceramic Flooring

Entrance Vestibule

TILE-CALACATTA POLISHED (CA6083P)-24X24

☐

metal strip where applicable

Main Hall

STRIP

☐

Kitchen / Breakfast

TILE-CALACATTA POLISHED (CA6083P)-24X24

☐

Laundry Room

TILE-ESSENZE GRIGIO-13X13

☐

Powder Room

TILE-CALACATTA POLISHED (CA6083P)-24X24

☐

Master Ensuite Bathroom

TILE-ESSENZE GRIGIO-13X13

☐

Ensuite Bath - Bedroom 2/3

TILE-ESSENZE GRIGIO-13X13

☐

Ensuite Bath - Bedroom 4/5

TILE-ESSENZE GRIGIO-13X13

☐

MUD ROOM

TILE-CALACATTA POLISHED (CA6083P)-24X24

☐

N/A

☐

N/A

☐

** Refer to Construction Summary

4. Ceramic Wall Tile

Master Ensuite Bathroom

Selection

Describe

Tub Deck Wall

N/A

Tub Deck

N/A

Tub Deck Skirt

N/A

Shower Stall

TILE-LUC BLANC GROENLANDIA-8X16

Bathtub Enclosure Walls

N/A

Ensuite Bath - Bedroom 2/3

TILE-LUC BLANC GROENLANDIA-8X16

Ensuite Bath - Bedroom 4/5

TILE-LUC BLANC GROENLANDIA-8X16

MUD ROOM

N/A

N/A

N/A

Kitchen Backsplash

N/A

** Refer to Construction Summary - STANDARD GROUT THROUGHOUT UNLESS SPECIFIED

5. Plumbing Fixtures

All Bathrooms

White

N/A

N/A

N/A

N/A

N/A

Whirlpool

N/A

☐ Yes

☒ No

Dishwasher Rough-In

☒ Yes

☐ No

Waterline for Fridge

☒ Yes

☐ No

** Refer to Construction Summary

6. Trim Carpentry

Interior Doors

CARRARA-SMOOTH

Interior Trim

As Per Construction Specifications

Door Handles

As Per Construction Specifications

Exterior Front Door Handle

As Per Construction Specifications

** Refer to Construction Summary

Initials: hs pk

Purchasers:

Telephone Res. / Bus:

Decor Advisor:

Lock Date:

Harpreet Singh BAL & Gurmeet BAL

(647) 549-9311 /

Candace Forza

15-Dec-20

Property: 10

Project: Russell Gardens Building Ltd.

Model and Elevation: Mountainash Five (5 Bedroom) Elev 3

Plan #: 62M-1266

7. Other Flooring

Main Hall	STRIP-VINTAGE-NOTHERN SOLID SAWN-CHARACTER-PEARL-RED OAK-PEWTER-5"	
Living Room	STRIP-VINTAGE-NOTHERN SOLID SAWN-CHARACTER-PEARL-RED OAK-PEWTER-5"	
Dining Room	STRIP-VINTAGE-NOTHERN SOLID SAWN-CHARACTER-PEARL-RED OAK-PEWTER-5"	
Family Room	STRIP-VINTAGE-NOTHERN SOLID SAWN-CHARACTER-PEARL-RED OAK-PEWTER-5"	
Den / Library / Study	STRIP-VINTAGE-NOTHERN SOLID SAWN-CHARACTER-PEARL-RED OAK-PEWTER-5"	
Basement Landing(If Applies)	N/A	
Lower Landing (If Applies)	STRIP-VINTAGE-NOTHERN SOLID SAWN-CHARACTER-PEARL-RED OAK-PEWTER-5"	
Upper Landing	STRIP-VINTAGE-NOTHERN SOLID SAWN-CHARACTER-PEARL-RED OAK-PEWTER-5"	
Upper Hall	LAMINATE-LEXINGTON-BEAUMONT OAK-TL-LW1313	
Master Bedroom	LAMINATE-LEXINGTON-BEAUMONT OAK-TL-LW1313	
Bedroom #2	LAMINATE-LEXINGTON-BEAUMONT OAK-TL-LW1313	
Bedroom #3	LAMINATE-LEXINGTON-BEAUMONT OAK-TL-LW1313	
Bedroom #4	LAMINATE-LEXINGTON-BEAUMONT OAK-TL-LW1313	
Bedroom #5	LAMINATE-LEXINGTON-BEAUMONT OAK-TL-LW1313	
	N/A	
	N/A	
	N/A	
Underpad	Type	Area
	N/A	N/A

** Refer to Construction Summary

8. Railings and Pickets

Railing Type	V-GROOVE	Colour	VINTAGE PEWTER RED OAK
Picket Type	EUROLINE 1	Colour	BLACK
Stringer / Riser	AS PER CONSTRUCTION SPECIFICATIO	Colour	VINTAGE PEWTER RED OAK
Treads	AS PER CONSTRUCTION SPECIFICATIO	Colour	VINTAGE PEWTER RED OAK
Red Oak Stairs with Semi Gloss Finish		<input checked="" type="radio"/> Yes <input type="radio"/> No	

** Refer to Construction Summary THE STAIN COLOURS OR FINISH AVAILABLE ON RISERS, TREADS, PICKETS AND RAILS (STAIRCASES), WILL NOT BE AN EXACT MATCH TO PREFINISHED HARDWOOD OR LAMINATE FLOORS.

9. Wall Paint Flat Finish

Main & Upper Hall	22 WARM GREY	Master Bedroom	22 WARM GREY
Living Room	22 WARM GREY	Bedroom #2	22 WARM GREY
Dining Room	22 WARM GREY	Bedroom #3	22 WARM GREY
Kitchen / Breakfast	22 WARM GREY	Bedroom #4	22 WARM GREY
Family Room	22 WARM GREY	Bedroom #5	22 WARM GREY
Powder Room	22 WARM GREY	Master Ensuite	22 WARM GREY
Laundry Room	22 WARM GREY	Ensuite Bath - Bedroom 2/3	22 WARM GREY
Den/Library	22 WARM GREY	Ensuite Bath - Bedroom 4/5	22 WARM GREY
Trim Paint-Semi Gloss	BIRCH WHITE	Mud Room	22 WARM GREY
	N/A		N/A
	N/A		N/A

Smooth Ceilings First Floor ☐ Yes ☒ No

** Refer to Construction Summary

Initials:

Purchasers:Harpreet Singh BAL & Gurmeet BAL

Telephone Res. / Bus: (647) 549-9311 /

Decor Advisor: Candace Forza

Lock Date: 15-Dec-20

Property: 10

Project: Russell Gardens Building Ltd.

Model and Elevation: Mountainash Five (5 Bedroom) Elev 3

Plan #: 62M-1266

10. Plaster Mouldings and Medallions

Entrance Vestibule	N/A	N/A	Kitchen/Breakfast	N/A	N/A
Main Hall	N/A	N/A	Den/Library	N/A	N/A
Living Room	N/A	N/A	Lower Landing	N/A	N/A
Dining Room	N/A	N/A		N/A	N/A
Family Room	N/A	N/A			

** Refer to Construction Summary

11. Fireplace

	Living Room			Family Room			Other Room - Specify		
	Purchased	As Per Plan	N/A	Purchased	As Per Plan	N/A	Purchased	As Per Plan	N/A
	<input type="radio"/>	<input type="radio"/>	<input checked="" type="radio"/>	<input type="radio"/>	<input checked="" type="radio"/>	<input type="radio"/>	<input type="radio"/>	<input type="radio"/>	<input type="radio"/>
Fireplace Type	N/A			FLAT ON WALL			N/A		
Mantle Type	N/A			MANTLE M2-STANDARD			N/A		
Colour / Stain	N/A			AS PER CONSTRUCTION SPECIFICATIONS			N/A		
Surround	N/A			BIANCO			N/A		
Hearth	N/A			NO			N/A		

** Refer to Construction Summary

12. Heating and Air Conditioning

Air Conditioning	NO	Gas Provisions Stove	YES
Gas Provisions Dryer	NO	Gas Provisions Barbecue	NO
Comment			

** Refer to Construction Summary

13. Electrical

Plugs and Switches	<input checked="" type="radio"/> White	DECOR	Above Kitchen Cabinet Light	<input type="radio"/> Yes <input checked="" type="radio"/> No
Hood Fan	STANDARD WHITE		Below Kitchen Cabinet Light	<input type="radio"/> Yes <input checked="" type="radio"/> No
Appliances	Built in Cooktop	Built in Oven	Gas Stove	Microwave
	<input checked="" type="radio"/> Yes <input type="radio"/> No	<input checked="" type="radio"/> Yes <input type="radio"/> No	<input checked="" type="radio"/> Yes <input type="radio"/> No	<input checked="" type="radio"/> Yes <input type="radio"/> No
Dishwasher Rough-in	Yes			

** Refer to Construction Summary

14. General Comments

** Refer to Construction Summary

Disclaimers and Notes

- 1) Colours of all materials are as close as possible to builder's selection, but not necessarily identical due to variances in manufacturing.

2) Any extras listed above are null and void unless accompanied by a separate invoice/amendment. Said invoice must be paid in full.

3) The Purchaser agrees that this colour selection is final and that no changes will be permitted, unless required by the Vendor.

4) The Purchaser acknowledges reading and accepting document which contains other miscellaneous disclaimers.

Signature: 

Date: Dec. 15/20

Signature: 

Date: Dec 14/20

NQ70M7770DS

SAMSUNG

30" Microwave Combination Wall Oven

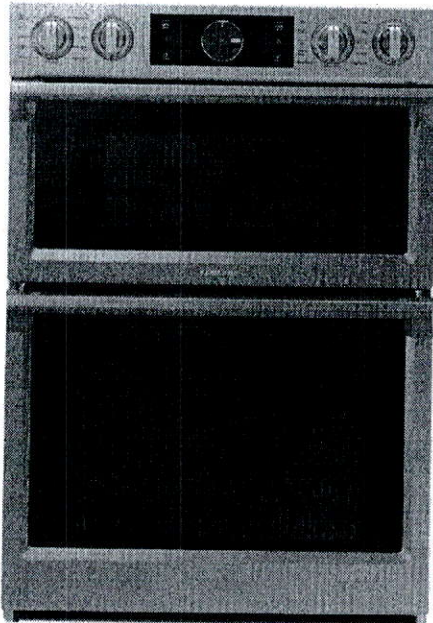

Signature Features

Steam Cook (Oven)

- Delivers moisture at precise times for a crisp, browned outside and tender inside.

Speed Cook (Microwave)

- Cook food faster and more evenly by using power convection.

Flex Duo™ (Oven)

- Cook two dishes at different temperatures simultaneously with the Smart Divider.

Available Colors



Stainless Steel (shown)



Black Stainless Steel

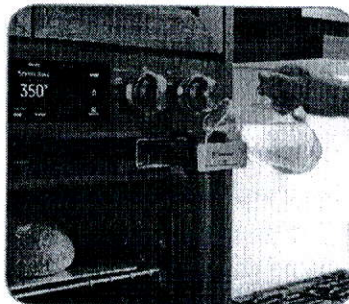

Steam Cook

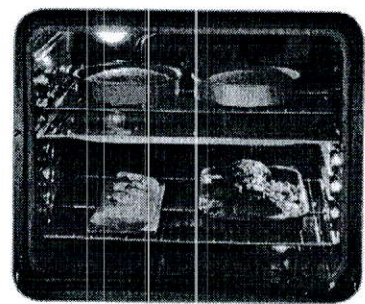

Flex Duo™

Features

- Digital-Analog Controls
- 1.9/5.1 cu. ft. Capacity
- Hybrid Clean and Self-Clean (Oven)
- Gourmet Cook (Oven)
- Dual Convection (Oven)
- Wi-Fi Connectivity
- Wi-Fi Enabled Temperature Probe (Oven)
- LED Spotlights (Oven)
- Easy View Window
- 3 Heavy-Duty Racks including a Gliding Rack (Oven)
- Soft-Close Door (Oven)
- Ceramic Plate (Microwave)
- Rapid Preheat (Oven)
- Auto Latch Microwave Door
- 6 Oven Modes including Steam Bake and Steam Roast
- Blue LED Illuminated Knobs
- Broil Element
- Smart Control Key (Oven)
- 6 Rack Positions (Oven)
- Drop-Down Door Design
- LCD Display

Convenience

- Hidden Heating Element (Oven)
- Sabbath Mode (Oven)
- Delay Start (Oven)
- Proofing (Oven)
- Warming Mode (Oven)
- Kitchen Timer
- Child Safety Lock
- Convection Conversion

NQ70M7770DS

SAMSUNG

30" Microwave Combination Wall Oven

Cabinet Dimensions

Combination Oven Installed in Cabinet

* Junction Box

** Allow a minimum of 22" for clearance to adjacent corners, drawers, walls, etc. when door is open.

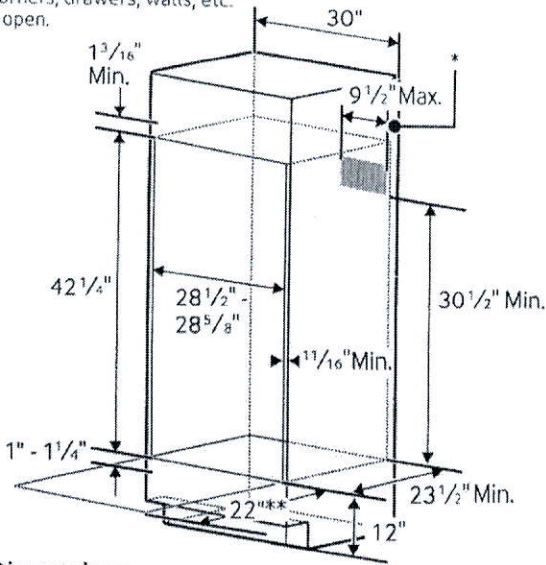

Product Dimensions

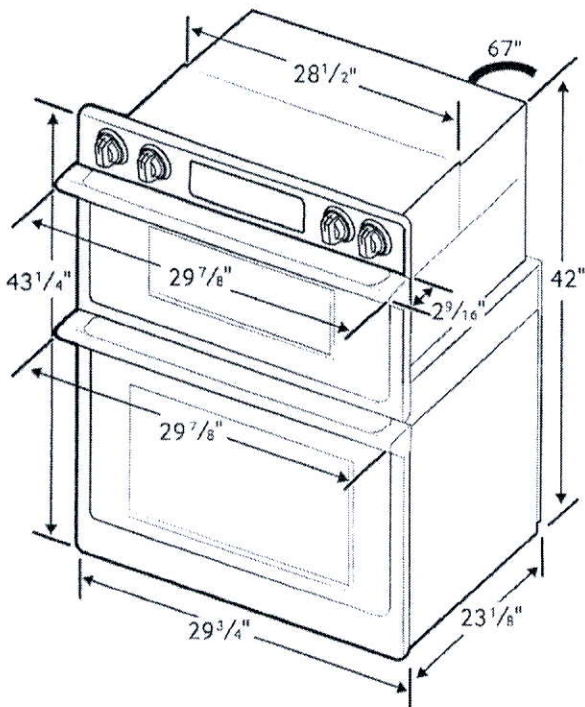

Total Capacity: 1.9/5.1 cu. ft.

- Microwave: 1.9 cu. ft.
- Wall Oven: 5.1 cu. ft. total, 2.8/2.2 cu. ft.
- Hidden Bake Element
- Bake: 175°F–550°F
- Convection Bake: 175°F–550°F
- Convection Roast: 175°F–550°F
- Broil: Low-High
- Steam Bake: 230°F–550°F
- Steam Roast: 230°F–550°F
- Proofing
- Sabbath Mode

Warranty

One (1) Year All Parts and Labor
Ten (10) Years Parts Warranty for Magnetron

Product Dimensions & Weight (WxHxD)

Outside (Max) Combination Oven Dimensions:
29 7/8" x 43 1/4" x 25 11/16"

Combination Oven Cut-Out Dimensions:
28 1/2" x 42 1/4" x 23 1/2"

Weight: 262.4 lbs.

Shipping Dimensions & Weight (WxHxD)

Dimensions:
33 5/8" x 48 3/16" x 29 51/64"

Weight: 291.1 lbs.

Color

Stainless Steel
Black Stainless Steel

Model

NQ70M7770DS
NQ70M7770DG

UPC Code

887276195186
887276195162

RATING	
240V	9.5 kW
208V	7.2 kW
BREAKER SIZE	
240V	40 Amps
208V	40 Amps

NA36N7755TS

36" Gas Cooktop

SAMSUNG

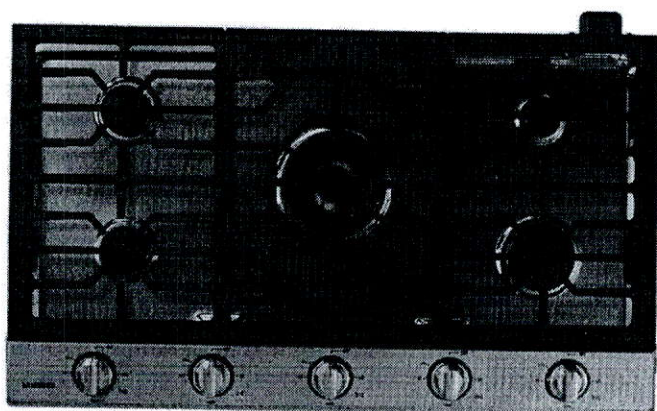

Signature Features

22K True Dual-Power Burner

- Two independent heating burners offer intense heat and precise control to quickly boil water or temper chocolate.

Analog Controls with Digital Wi-Fi and Bluetooth® Technology

- The ultimate combination of analog comfort and digital technology delivers exceptional cooking performance.

Cast Iron Griddle

- Cook breakfast, grill sandwiches, or sauté vegetables on the removable griddle.

Available Colors



Stainless Steel (shown)



Fingerprint Resistant
Black Stainless Steel



22K True Dual-Power Burner

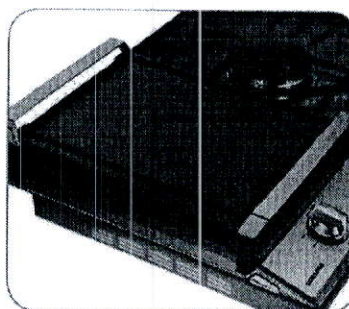

Cast Iron Griddle

Features

- Bluetooth® Connected to Hood
- Blue LED Lights
- Wi-Fi Connectivity
- Powerful Cooktop
 - Right Front: 13K BTU
 - Left Front: 9.5K BTU
 - Right Rear: 5K BTU
 - Left Rear: 9.5K BTU
 - Center: True Dual, 22K BTU (Brass)

- Cast Iron 3-Piece Grates
- Sealed Burners
- Burner On/Off Monitoring
- ADA Compliant

Convenience

- Wok Grate
- LP Conversion Kit



ADA Compliant

NA36N7755TS

36" Gas Cooktop

SAMSUNG

Installation Requirements

Countertop cut-out and minimum clearance dimensions:

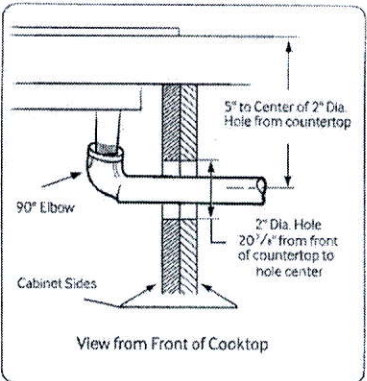
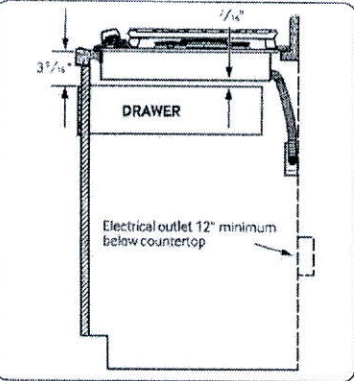
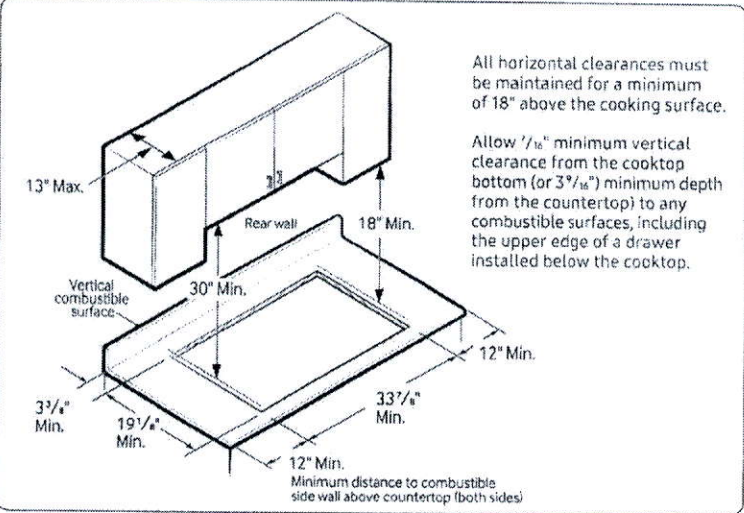

Total Power (BTU)
59K

Power Source
120V / 60 Hz / 1A

Gas Cooktop (BTU)
• Right Front: 13K
• Left Front: 9.5K
• Right Rear: 5K Simmer
• Left Rear: 9.5K
• Center: 22K (True Dual)

Warranty
One (1) Year All Parts and Labor

Product Dimensions & Weight (WxHxD)
Outside (Max) Cooktop Dimensions:
36" x 5 $\frac{41}{72}$ " x 22 $\frac{1}{3}$ "

Cooktop Cut-Out Dimensions:
33 $\frac{7}{8}$ " x 3 $\frac{3}{8}$ " x 19 $\frac{1}{8}$ "

Weight: 87.7 lbs. (88.4 lbs. Fingerprint Resistant Black Stainless Steel)

Shipping Dimensions & Weight (WxHxD)
Dimensions: 40 $\frac{9}{16}$ " x 10 $\frac{5}{8}$ " x 25 $\frac{5}{8}$ "
Weight: 95.9 lbs. (97.2 lbs. Fingerprint Resistant Black Stainless Steel)

Color	Model #	UPC Code
Stainless Steel	NA36N7755TS	887276281766
Fingerprint Resistant Black Stainless Steel	NA36N7755TG	887276281759

Installing Over a Single Oven

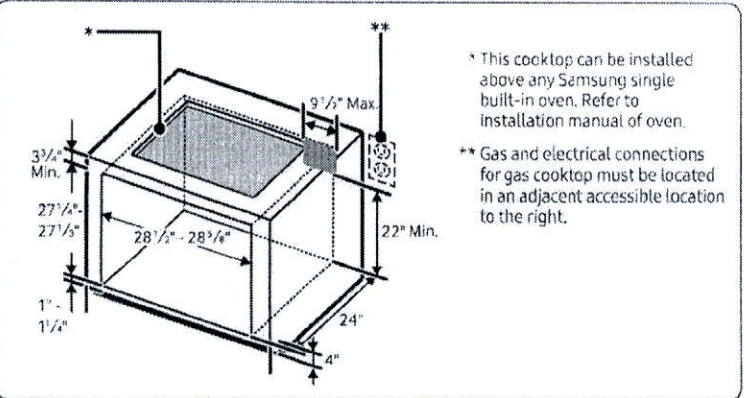

Cooktop Dimensions

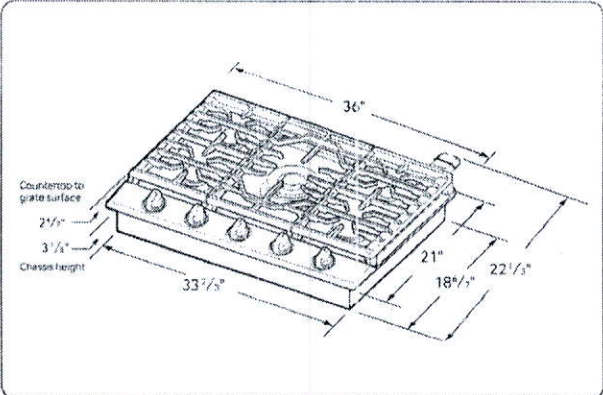

NK36K7000WS/A2

36" Range Hood

SAMSUNG

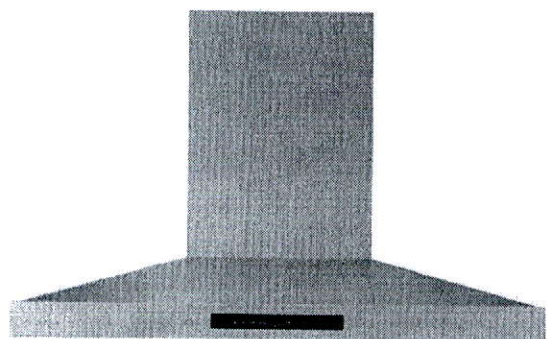

Signature Features

Bluetooth® Connected Hood

- Automatically sync the fans and the lights with the cooktop through Bluetooth.¹

¹Only on select Samsung cooktops.

Baffle Filter

- Dishwasher-safe metal filters help keep the air clean by drawing grease and odor through the hood.

Powerful 390 CFM² Ventilation

- Circulates air to remove odors quickly.

²600 CFM capable.

Available Colors



Stainless Steel (shown)



Black Stainless Steel

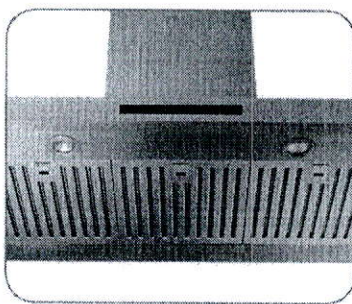

Baffle Filter

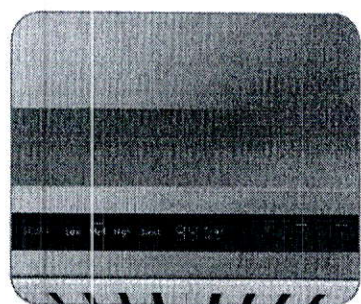

Wi-Fi Monitoring

Features

- Wi-Fi Monitoring
- ADA Compliant
- 4 Fan Speeds, Including Booster
- Wall-Mounted Chimney Style
- Digital Touch Control
- Exterior Venting & Recirculating Capabilities
- 74 dBA (10.8 sonnes) Noise Level
- Optional Recirculating Kit Available
- Optional Extension Kit Available

Convenience

- LED Lighting

DW80R9950

SAMSUNG

Samsung Linear Wash 39 dBA Dishwasher

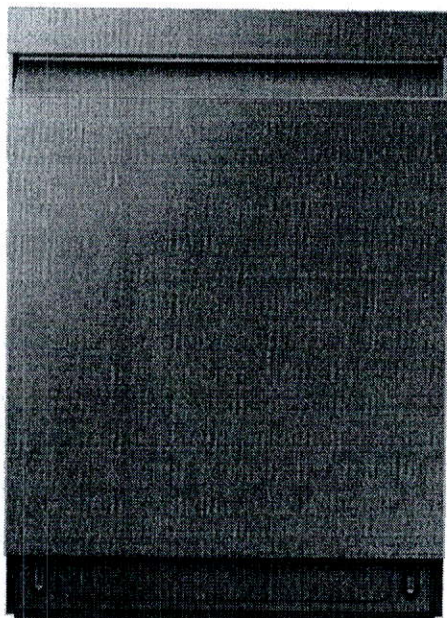

Signature Features

Linear Wash System

- AquaBlast™ jets provide corner to corner coverage for superior cleaning.

Whisper Quiet Cleaning

- Less noise and less disturbance with virtually silent wash cycles at 39 dBA.

AutoRelease™ Door

- At the end of a cycle, the door automatically opens to circulate air and improve drying performance.

Available Colors



Fingerprint Resistant
Stainless Steel (shown)



Fingerprint Resistant
Black Stainless Steel



Fingerprint Resistant
Tuscan Stainless Steel

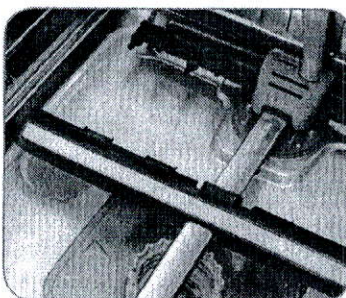

Linear Wash System

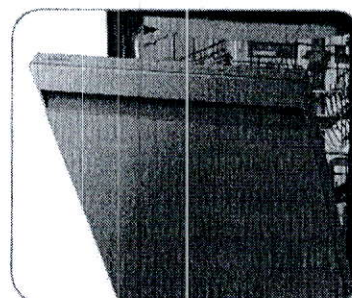

AutoRelease™ Door

Features

- Flexible 3rd Rack
- Fingerprint Resistant Stainless Finish
- Zone Booster™
- Touch Control
- Quiet Operation: 39 dBA
- Wi-Fi Connectivity
- 7 Wash Cycles
- 8 Options
- Half-Load Cycle
- Express Cycle: 60 Minutes
- One-Touch Adjustable Racking System
- Full Stainless Steel Interior
- 15 Place Settings
- 3 Spray Wash Arms (Upper, Middle, Lower)

Convenience

- LED Time Display
- Control Lock
- Delay Start
- Digital Leak Sensor

Rating

ENERGY STAR®-rated:
239 kWh/yr

DW80R9950

Samsung Linear Wash 39 dBA Dishwasher

SAMSUNG

Installation Specifications

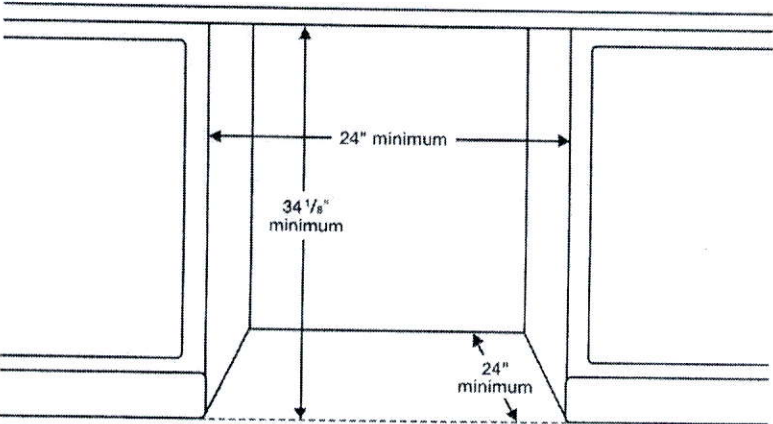

Features

- 7 Wash Cycles: Auto, Normal, Heavy, Delicate, Express 60, Rinse Only, Self Clean
- 8 Options: Half-Load Wash (Lower Rack), Zone Booster™ (Left), Speed Booster, Hi-Temp Wash, Sanitize (Anti-bacterial – NSF), Delay Start, Control Lock, Smart Control (Wi-Fi App)
- AutoRelease™ Door
- Hidden Heat Element
- Stainless Steel Interior Tub

Convenience

- Control Lock
- Digital Water Leakage Sensor
- Flexible Third Rack
- One-Touch Adjustable Racking System
- Silverware Basket
- Upper Rack: Foldable Cup Shelves, 2 Adjustable Tines
- Lower Rack: Fold-Down Tines

Warranty

One (1) Year All Parts and Labor
Five (5) Year Limited on Printed Circuit Board and Interior Nylon Racks

Product Dimensions & Weight (WxHxD)

Dimensions (height is adjustable):
23 7/8" x 33 7/8" – 35" x 25"

Weight: 95 lbs

Shipping Dimensions & Weight (WxHxD)

Dimensions:
26" x 34 3/4" x 29 3/4"

Weight: 101 lbs

Color	Model #	UPC Code
Fingerprint Resistant Stainless Steel	DW80R9950US	887276296647
Fingerprint Resistant Black Stainless Steel	DW80R9950UG	887276296623
Fingerprint Resistant Tuscan Stainless Steel	DW80R9950UT	887276320137

Dimensions

Side View

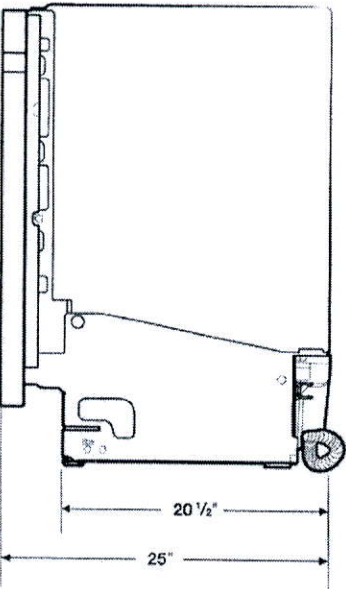

Rear View

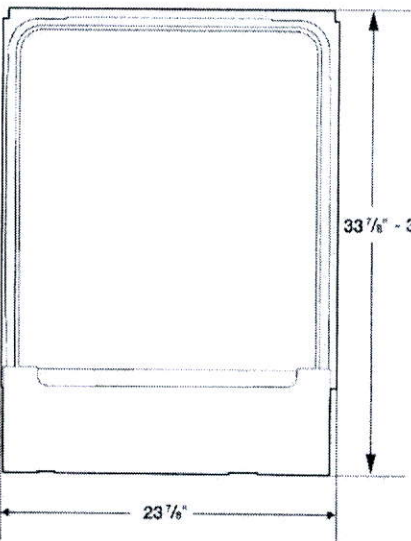

RF22M9581SR

SAMSUNG

Samsung Counter-Depth, 4-Door Flex™ with Family Hub™

22 cu. ft. Capacity

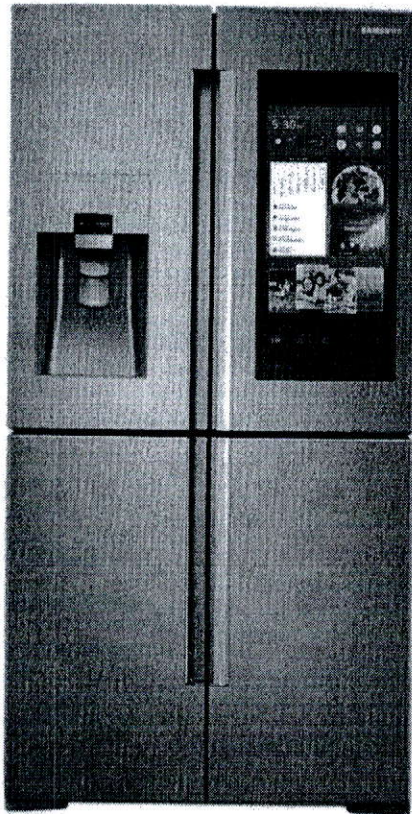

Signature Features

Food

- Use your voice to add items to your shopping lists.
- See inside from anywhere with 3 built-in cameras.

Family

- Sync calendars for all family activities and events.
- Remotely share photos, notes and memos.

Fun

- Stream music, mirror your Samsung TV or Samsung phone directly on your Family Hub™ screen.

Connect

- Simplify your life through the SmartThings app by controlling smart devices and appliances: set lights, adjust the thermostat or monitor your baby's room.

Available Colors



Stainless Steel (shown)



Black Stainless Steel

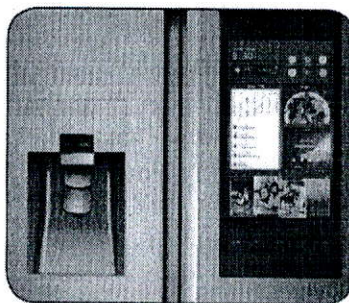

Family Hub™

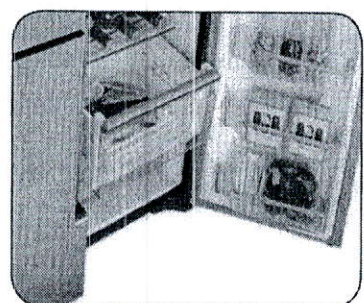

FlexZone™

Features

- Profile Base Communication Apps
- S-Voice – Integrated Voice-Activated Features
- One Family Hub™ Experience Integrated Mobile App
- FlexZone™
- Triple and Metal Cooling
- Large Capacity – 22 cu. ft.
- External Filtered Water and Ice Dispenser
- Ice Master Ice Maker in the Refrigerator
- High-Efficiency LED Lighting
- Wine Rack
- Fingerprint-Proof Coating
- ENERGY STAR® Compliant
- EZ Slide-Out Shelves in Freezer and FlexZone™
- Counter-Depth

Convenience

- Tempered Glass Spill-Proof Shelves
- Gallon Door Bins
- Flip-Up Shelf
- Door Alarm
- Water Filter Indicator

Rating



ENERGY STAR®-rated:
709 kWh/yr

RF22M9581SR

SAMSUNG

Samsung Counter-Depth, 4-Door Flex™ with Family Hub™

22 cu. ft. Capacity

Installation Specifications

1. Measure the height, width and depth of the opening, making sure to include baseboards, molding tile, countertop overhang, etc. Check to be sure there is enough room to open the door (consider walls, islands or other obstacles when measuring).
2. Refer to illustration below to determine dimensions.
3. Allow 2.5" of clearance on hinge side of refrigerator when installing next to a wall where handle may make contact.
4. Allow 1" minimum clearance at rear for proper air circulation and water/electrical connections. Allow a 3/8" minimum clearance at sides and top for ease of installation.
5. Ensure each door and entryway in the home is wide enough for the refrigerator to be moved through easily.

For optimal usage and to be able to open refrigerator doors completely, do not install next to a wall.

Please note: The following dimension and cutout information is for planning purposes only. For complete installation details, consult manual packed with product, or download manual online at samsung.com.

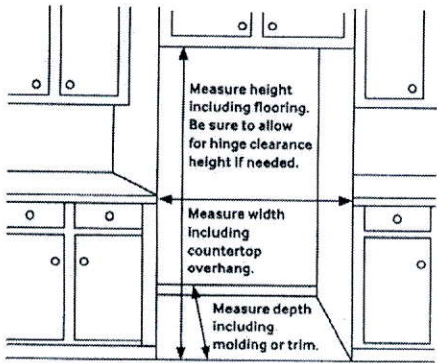

Dimensions

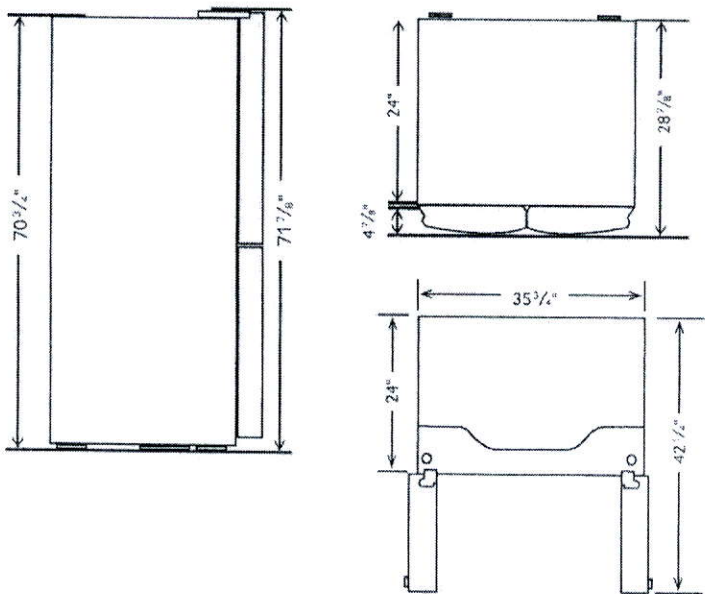

Total Capacity: 22 cu. ft.

Refrigerator: 13.2 cu. ft.

- Premium External Filtered Water and Ice Dispenser (Crushed or Cubed Ice)
- Ice Master Ice Maker
- 2 Humidity-Controlled Crispers
- Gallon Door Bins
- 5 Tempered Glass Spill-Proof Shelves
 - 1 Slide-In
 - 1 Flip-Up
 - 3 Fixed
- Wine Rack
- High-Efficiency LED Lighting

FlexZone™: 4.4 cu. ft.

- 1 EZ Slide-Out Shelf
- 2 Drawers
- 5 Temperature Zones:
 - 41°F
 - 35°F
 - 30°F
 - 23°F
 - -8°F – 5°F
- High-Efficiency LED Lighting

Freezer: 4.4 cu. ft.

- 1 EZ Slide-Out Shelf
- 2 Freezer Drawers
- High-Efficiency LED Lighting

Warranty

One (1) Year Parts and Labor on Refrigerator

Five (5) Years Parts and Labor on Sealed Refrigeration System Only*

Ten (10) Years Parts and Five (5) Years Labor on Digital Inverter Compressor

*Compressor, evaporator, condenser, drier and connecting tubing.

Product Dimensions & Weight

Dimensions (WxHxD with hinges, handles and doors): 35 3/4" x 71 7/8" x 28 7/8"

Dimensions (WxHxD without hinges and door): 35 3/4" x 70 3/4" x 24"

Dimensions (WxHxD with hinge and door, no handle): 35 3/4" x 71 7/8" x 28 7/8"

Weight: 350.5 lbs.

Shipping Dimensions & Weight (WxHxD)

Dimensions: 38 5/16" x 78" x 31 5/16"

Weight: 374.7 lbs.

Color	Model #	UPC Code
Stainless Steel	RF22M9581SR	887276197999
Black Stainless Steel	RF22M9581SG	887276197982

Actual color may vary. Design, specifications, and color availability are subject to change without notice. Non-metric weights and measurements are approximate.

©2018 Samsung Electronics America, Inc. 85 Challenger Road, Ridgefield Park, NJ 07660. Tel: 800-SAMSUNG. samsung.com. Samsung is a registered trademark of Samsung Electronics Co., Ltd.

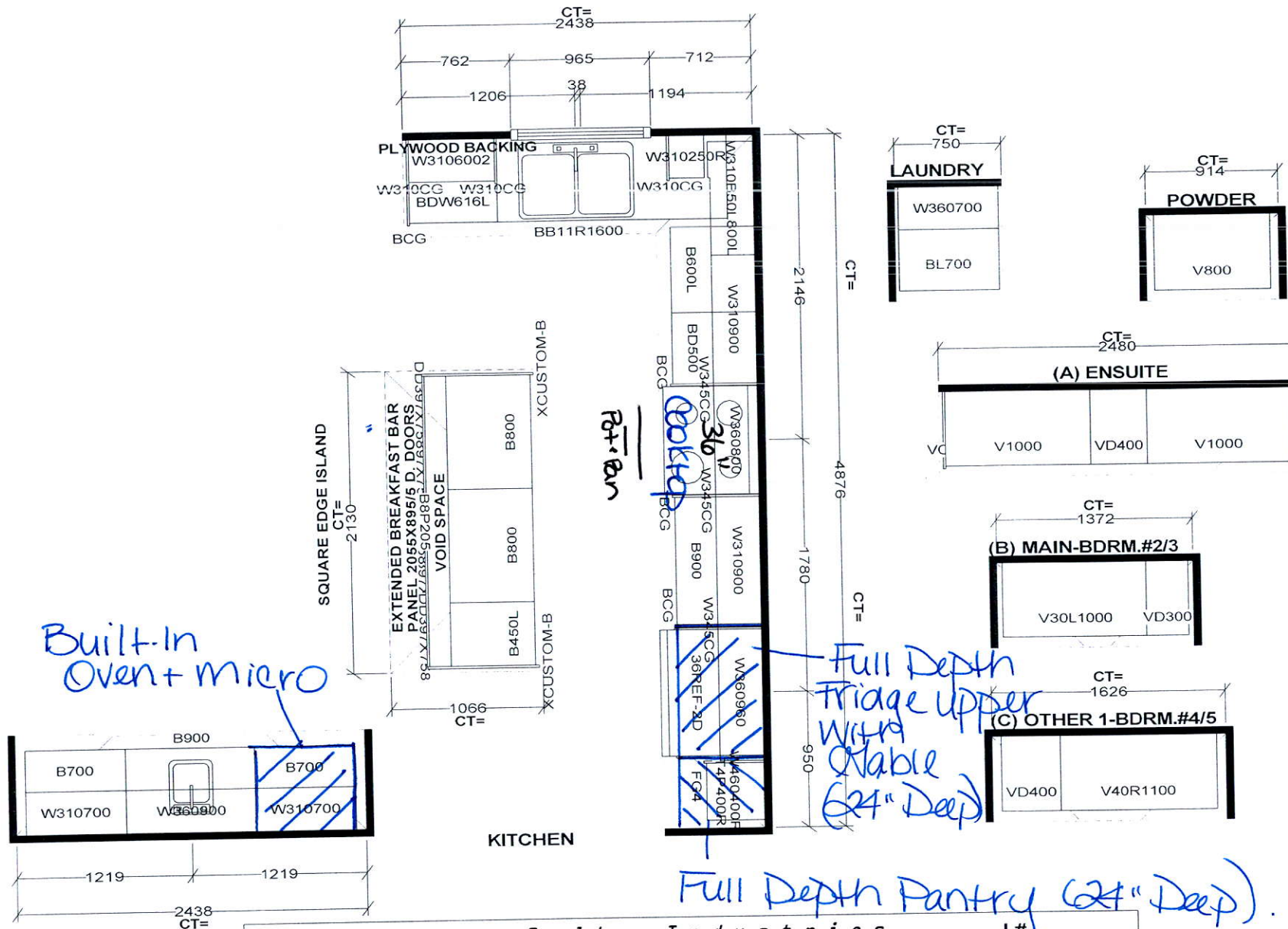

Selba Industries			J#
W WIDTH _____ W HGHT _____ W CNT _____ FLOOR HGHT _____ DOOR HGHT _____ ST. CENT _____ 2X4 _____ VENT BOX COVER _____			This drawing is the intellectual property of SELBA INDUSTRIES INC. and is an original design which must not be released or copied unless applicable fee has been paid or job order placed. DESIGNER: KS DATE: MAY 13 20
JOB NUMBER: _____ BUILDER: GREENPARK SITE: RUSSELL GARDENS PH.3 MODEL: MOUNTAINASH 5X OPT 5 BDRM EL 1,2,3 LOT #: _____			

LOT 10
RUSSELL GARDENS
PHASE 3
MOUNTAINVIEW HEIGHTS

MOUNTAINASH 5
ELEV. 3

REVISION:

1. REAR UPGRADE - ENLARGE FAMILY ROOM AND MASTER BEDROOM BY 1'0" AS PER SKETCH
2. MASTER ENSUITE - PROJECTED WINDOW AS PER SKETCH

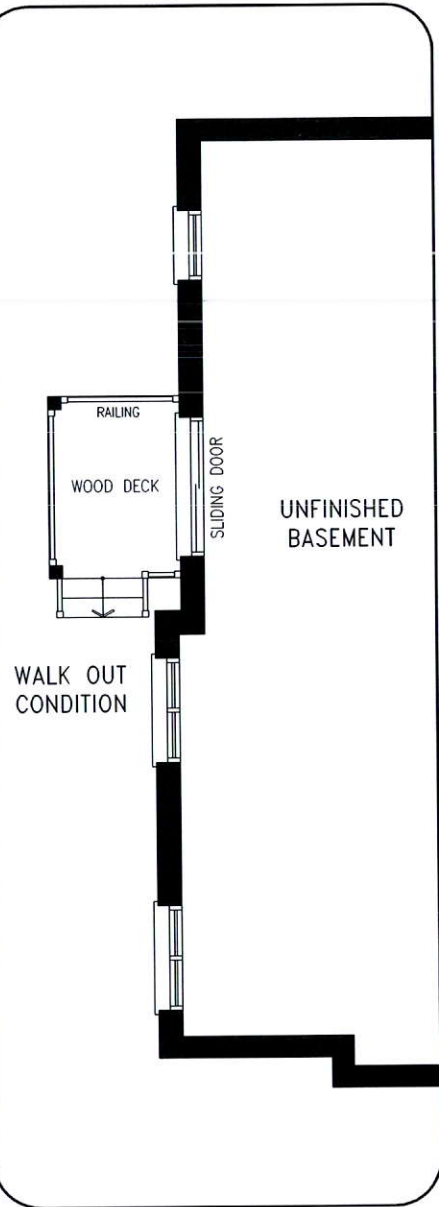

LOWER LEVEL

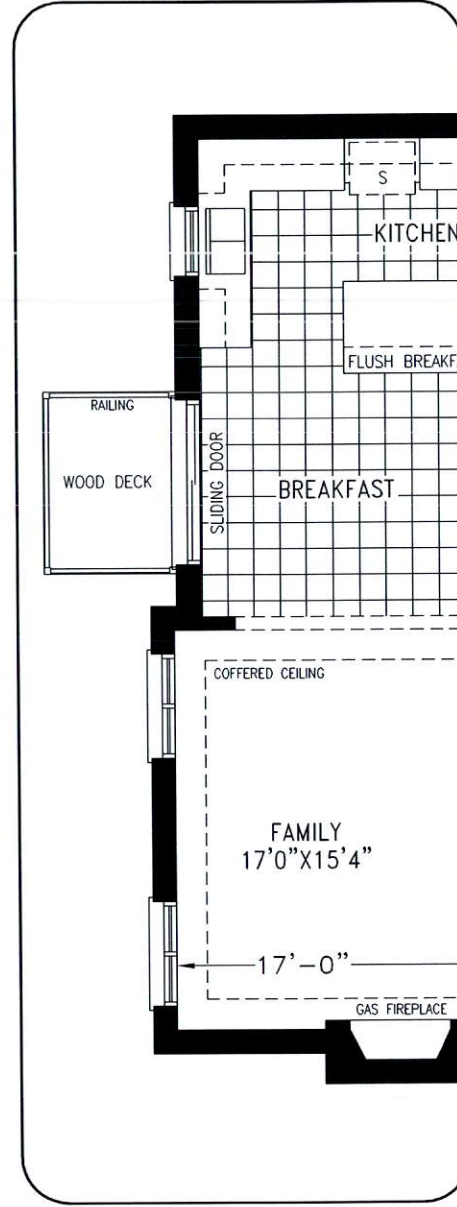

MAIN LEVEL

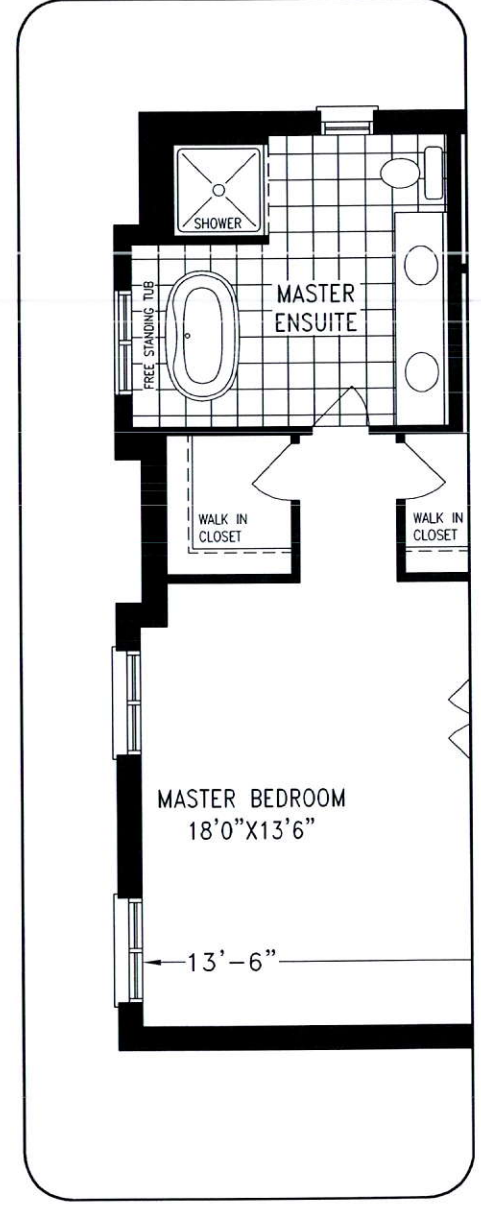

UPPER LEVEL

DISCLAIMERS: SKETCH NOT TO SCALE. DIMENSIONS, SPECIFICATIONS AND ARCHITECTURAL DETAILS SUBJECT TO MODIFICATION BY THE VENDOR. SKETCH IS ONLY FOR THE PURPOSE OF ILLUSTRATING REVISIONS REQUESTED BY THE PURCHASER AND ALL REVISIONS ARE SUBJECT TO VENDOR'S FINAL APPROVAL. ONLY REVISIONS ACCEPTED IN WRITING BY THE PURCHASER AND VENDOR ON A PURCHASER'S EXTRA SHEET WILL BE INCORPORATED INTO THE PLANS FILED WITH THE MUNICIPALITY. E. & O.E.

REGION
DESIGN
INC.

SCALE
BY
VG

N.T.S.
PAGE No.
1 OF 2

Greenpark™

LOT 10
RUSSELL GARDENS
PHASE 3
MOUNTAINVIEW HEIGHTS

MOUNTAINASH 5
ELEV. 3

REVISION:

1. REAR UPGRADE

LS *QK*



NOTE: ELEVATION SUBJECT TO FINAL ARCHITECTURAL APPROVALS
ACTUAL GRADE MAY VARY WITH THE GRADE SHOWN ON DRAWING

REAR ELEVATION

DISCLAIMERS: SKETCH NOT TO SCALE. DIMENSIONS, SPECIFICATIONS AND ARCHITECTURAL DETAILS SUBJECT TO MODIFICATION BY THE VENDOR. SKETCH IS ONLY FOR THE PURPOSE OF ILLUSTRATING REVISIONS REQUESTED BY THE PURCHASER AND ALL REVISIONS ARE SUBJECT TO VENDOR'S FINAL APPROVAL. ONLY REVISIONS ACCEPTED IN WRITING BY THE PURCHASER AND VENDOR ON A PURCHASER'S EXTRA SHEET WILL BE INCORPORATED INTO THE PLANS FILED WITH THE MUNICIPALITY. E. & O.E.

**REGION
DESIGN
INC.**

SCALE	
N.T.S.	
BY	PAGE No.
VG	2 OF 2

Greenpark™

Revised
See Sketch

Add Plug

Add Light
Above
Island

Walk-Out.
Enlarged Basement
Windows

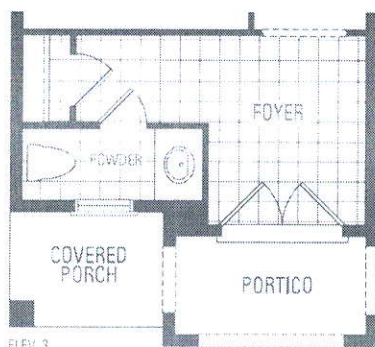
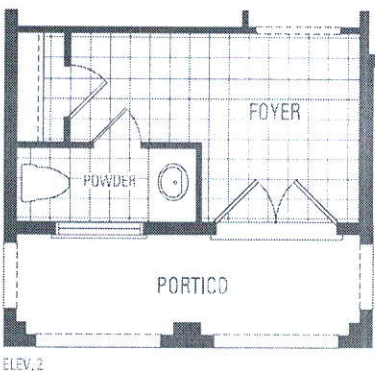
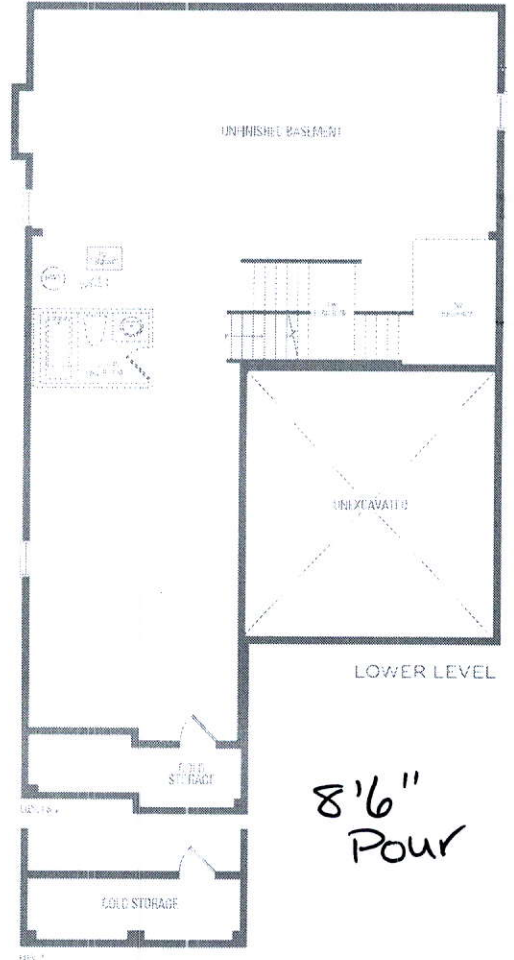
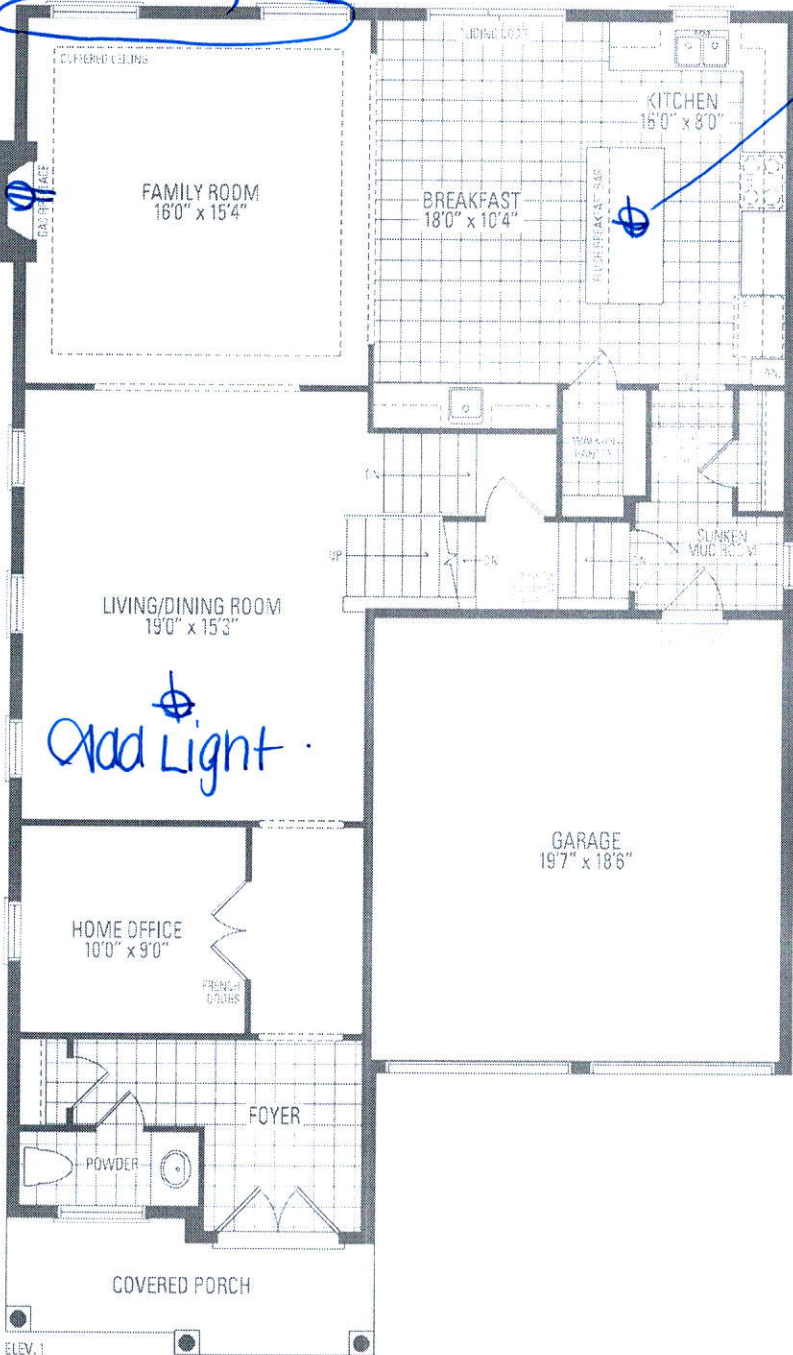

- 200 AMP

MOUNTAINASH FIVE ELEV. 1 • 3,288 sq.ft. | ELEV. 2 • 3,291 sq.ft.

Orientation of home may be reversed and purchaser agrees to accept the same. Steps and porches may vary at any exterior entrance ways the stated floor areas. All renderings are artist's concept. Dimensions, specifications and architectural detailing subject to modifications. Roofline

Handwritten signature/initials in a red circle.

Handwritten signature/initials in a red circle.

ELEV. 1 • 3,288 sq.ft. | ELEV. 2 • 3,291 sq.ft. | ELEV. 3 • 3,298 sq.ft.

Revised - see sketch



173

Cite