

CONSTRUCTION SUMMARY

Lotus Pointe 2 (G) - Lamberts Lane Home Corp.

PURCHASER: Gurkarm Sher DHINDSA

TEL:

LOT / PHASE	REG. PLAN #	HOUSE TYPE		
79 / 2	43M-2071	Barton Twelve Elev 1		

CARPET

1 - UNDERPAD UPGRADE 3 - ALL BEDROOMS 07Jan20 Note:	
1 - UPGRADE 1 CARPET IN BEDROOMS ONLY 07Jan20 Note:	

CERAMIC TILE

1 - TILE - UPGRADE 3 FLOOR TILE - - BATHROOM 4 - FLOOR 07Jan20 Note:	
1 - TILE - UPGRADE 3 FLOOR TILE - - BATHROOM 3 - FLOOR 07Jan20 Note:	
1 - TILE - UPGRADE 3 FLOOR TILE - - BATHROOM 2 - FLOOR 07Jan20 Note:	
1 - DELETE ALL CERAMIC BATHROOM ACCESSORIES - DELETE TOWEL BAR, PAPER HOLDER & SOAP DISH THROUGHOUT 07Jan20 Note:	
1 - TILE - UPGRADE 3 WALL TILE - - ENSUITE WALL TILE - SHOWER 07Jan20 Note:	
1 - TILE - UPGRADE 3 FLOOR TILE - - ENSUITE BATHROOM - FLOOR 07Jan20 Note:	
1 - TILE - UPGRADE 4 FLOOR TILE - FIRST FLOOR IN ALL TILED AREAS 07Jan20 Note:	

CONSTRUCTION

1 - SMOOTH CEILINGS ON FIRST FLOOR ONLY 07Jan20 Note:	
1 - PROVISION FOR SHAMPOO NICHE APPROX. 14" WIDE X 20" HIGH AS PER SKETCH - IF CONSTRUCTION PERMITS- MASTER ENSUITE SHOWER 12Nov19 Note:	

COUNTERTOP

1 - SHAMPOO NICHE 14" WIDE X 20" HIGH AS PER SKETCH - MARBLE, GRANITE OR QUARTZ-** INCLUDES SHOWER JAMS AS WELL*** - IF CONSTRUCTION PERMITS - REQUIRES PROVISION FROM CONSTRUCTION- MASTER ENSUITE SHOWER 12Nov19 Note:	
--	--

ELECTRICAL

1 - STANDARD PORCH LIGHT TO BE IN CEILING - SEE SKETCH 12Nov19 Note:	
1 - LIGHT - EXTERIOR WITH INTERIOR SWITCH- ADD 2ND PORCH LIGHT IN CEILING- SEE SKETCH 12Nov19 Note:	
2 - LIGHT AND SWITCH - NO FIXTURE INCLUDED- 2 WALL SCONCES IN DINING ROOM 12Nov19 Note:	
1 - STANDARD KITCHEN LIGHT TO BE CENTERED OVER ISLAND 12Nov19 Note:	
1 - PLUG - ELECTRICAL PLUG - TO BE INSTALLED OVER FIREPLACE 12Nov19 Note:	

FIREPLACE AND ACCESSORIES

RECEIVED

JAN 08 2020



CONSTRUCTION SUMMARY

Lotus Pointe 2 (G) - Lamberts Lane Home Corp.

PURCHASER: Gurkarm Sher DHINDSA

TEL:

LOT / PHASE	REG. PLAN #	HOUSE TYPE		
79 / 2	43M-2071	Barton Twelve Elev 1		

1 - MANTEL - CAST STONE - AEQUALITAS 1 STYLE MANTEL  
07Jan20 Note:

HARDWOOD FLOORING

1 - HARDWOOD - GROUP B SERIES 5 INCH - - UPPER HALL  
07Jan20 Note:

1 - HARDWOOD - GROUP B SERIES 5 INCH - IN LIEU OF 2 1/4 INCH NATURAL RED OAK- FIRST FLOOR COMPLETE  
07Jan20 Note:

MIRRORS AND GLASS

1 - MASTER ENSUITE- CUSTOM FRAMELESS GLASS SHOWER ENCLOSURE WITH CHROME KNOB- RELOCATE SHOWER DOOR TO SIDE OF SHOWER FACING TUB  
12Nov19 Note:

MISCELLANEOUS

1 - FURTHER VENDOR DISCOUNT  
07Jan20 Note:

PLUMBING

1 - TOILET UPGRADE- CAYLA 4782BOV/4781BOV- MASTER ENSUITE  
07Jan20 Note:

1 - MASTER ENSUITE- SHOWER- DRYDEN - DFKIT10-WS  
28Nov19 Note:

1 - 5 FOOT SHOWER WITH SLIDING GLASS CHROME DOORS IN LIEU OF TUB- BEDROOM 3 ENSUITE  
12Nov19 Note:

PROMOTIONAL

1 - LESS BALANCE OF CREDIT FROM PURCHASER EXTRA SHEET IN OFFER  
12Nov19 Note:

STAIRS AND RAILINGS

1 - V GROOVE HANDRAIL  
07Jan20 Note:

1 - STAINED HANDRAIL, TREADS, RISERS AND STRINGER EXCLUDING PICKETS (FOR IRON PICKETS) - STANDARD STAIRCASE  
- PRICE IS PER SET  
07Jan20 Note:

1 - EUROLINE 2 BLACK IRON PICKETS  
07Jan20 Note:

EXTRAS AS PER OFFER

The Purchaser acknowledges that the Purchase Price is inclusive of all credits and promotional packages available at the time of purchase.  
Worksheet Note:

(7,5) The Vendor agrees that notwithstanding any other term or provision in this Agreement included in the Purchase Price and in addition to those items detailed in Schedule GP to the Agreement of Purchase and Sale, the Purchaser is entitled to a credit  
Worksheet Note:

Purchaser: Gurkarm Sher DHINDSA  
Telephone Res. / Bus: /  
Decor Advisor: Natalie Mancuso  
Lock Date: 7-Jan-20

Property: 79  
Project: Lamberts Lane Home Corp.  
Model and Elevation: Barton Twelve Elev 1  
Plan #: 43M-2071

Layout Changes: ☒ Yes ☐ No      Sketch Attached: ☒ Yes ☐ No      Exterior Colour Scheme:

1. Cabinetry

	Style and Colour	Hardware
Kitchen / Breakfast	CONTINENTAL 823 DRIFTWOOD	431SA
Laundry Room	ELISSE	Standard
Powder Room	EVEREST WHITE	412SB
Master Ensuite Bathroom	EVEREST WHITE	431SA
Ensuite Bath - Bedroom 2	CONTINENTAL 823 DRIFTWOOD	412SB
Ensuite Bath - Bedroom 3	CONTINENTAL 823 DRIFTWOOD	412SB
Ensuite Bath - Bedroom 4	EVEREST WHITE	431SA

Appliances:      Built In Appliances ☐ Yes ☒ No      Slide In Stove ☐ Yes ☒ No  
Dishwasher Cabinet ☐ Closed ☒ Open      41" Upper Cabinets ☒ Yes ☐ No      Please NOTE: Standard Cabinet Height is 30"  
Stove Opening       NOTE: If not specified, opening will be set to builder's standard opening of approximately 30" width  
Fridge Opening       NOTE: If not specified, opening will be set to builder's standard opening of approximately 37" width x 74" height

\*\* Refer to Construction Summary

2. Counters

	Counter	Edge
Kitchen / Breakfast	LAMINATE-WHITE CARRARA 4924-38	
Laundry Room	N/A	
Powder Room	LAMINATE-CARRARA BIANCO 6696-46	
Master Ensuite Bathroom	LAMINATE-PORTICO MARBLE 7735-58	
Ensuite Bath - Bedroom 2	LAMINATE-PALOMA POLAR 6698-46	
Ensuite Bath - Bedroom 3	LAMINATE-WHITE CARRARA 4924-38	
Ensuite Bath - Bedroom 4	LAMINATE-ARGENTO ROMANO 6697-46	

MASTER ENSUITE SHOWER JAMS AND NICHE- FUSION WHITE-QUARTZITE



Purchaser: Gurkarm Sher DHINDSA  
Telephone Res. / Bus: /  
Decor Advisor: Natalie Mancuso  
Lock Date: 7-Jan-20 7-Jan-20

Property: 79  
Project: Lamberts Lane Home Corp.  
Model and Elevation: Barton Twelve Elev 1  
Plan #: 43M-2071

3. Ceramic Flooring

		At a 45	Threshold-If App.
Entrance Vestibule	TILE- CALACATTA CA6083P POLISHED 24X24	<input type="checkbox"/>	Metal Strip Where Applic.
Main Hall	HARDWOOD	<input type="checkbox"/>	
Kitchen / Breakfast	TILE- CALACATTA CA6083P POLISHED 24X24	<input type="checkbox"/>	
Laundry Room	TILE- CALACATTA CA6083P POLISHED 24X24	<input type="checkbox"/>	
Powder Room	TILE- CALACATTA CA6083P POLISHED 24X24	<input type="checkbox"/>	
Master Ensuite Bathroom	TILE- VARENNA CARRARA POLISHED 24X24	<input type="checkbox"/>	
Ensuite Bath - Bedroom 2	TILE- ALPI ARGENTO 12X24	<input type="checkbox"/>	
Ensuite Bath - Bedroom 3	TILE- LITIUM PEARL POLISHED 24X24	<input type="checkbox"/>	
Ensuite Bath - Bedroom 4	TILE- LITIUMSILVER POLISHED 24X24	<input type="checkbox"/>	
		<input type="checkbox"/>	
		<input type="checkbox"/>	
		<input type="checkbox"/>	

\*\* Refer to Construction Summary

4. Ceramic Wall Tile

Master Ensuite Bathroom	Selection	Describe
Tub Deck Wall		
Tub Deck		
Tub Deck Skirt		
Shower Stall	TILE- VARENNA CARRARA POLISHED 24X24	
Bathtub Enclosure Walls		
Ensuite Bath - Bedroom 2	TILE- LUC GROENLANDIA 8X16	
Ensuite Bath - Bedroom 3	TILE- LUC GROENLANDIA 8X16	
Ensuite Bath - Bedroom 4	TILE- LUC GROENLANDIA 8X16	
Kitchen Backsplash		

MASTER ENSUITE SHOWER JAMS AND NICHE- FUSION WHITE-QUARTZITE\*\* Refer to Construction Summary - STANDARD GROUT THROUGHOUT UNLESS SPECIFIED

5. Plumbing Fixtures

All Bathrooms	White	Whirlpool <input type="checkbox"/> Yes <input checked="" type="radio"/> No
		Dishwasher Rough-In <input checked="" type="radio"/> Yes <input type="radio"/> No
		Waterline for Fridge <input type="radio"/> Yes <input checked="" type="radio"/> No

\*\* Refer to Construction Summary

6. Trim Carpentry

Interior Doors	CARRARA-SMOOTH
Interior Trim	3" BB CASING WITH 5 1/4" BASEBOARD - COLONIAL
Door Handles	As Per Construction Specifications
Exterior Front Door Handle	As Per Construction Specifications

\*\* Refer to Construction Summary

Initial: 



Purchaser: Gurkarm Sher DHINDSA

Telephone Res. / Bus: /

Decor Advisor: Natalie Mancuso

Lock Date: 7-Jan-20

Property: 79

Project: Lamberts Lane Home Corp.

Model and Elevation: Barton Twelve Elev 1

7-Jan-20

Plan #: 43M-2071

7. Other Flooring

Main Hall	HARDWOOD- MIRAGE 5" RED OAK- HOPSCOTCH CHARACTER- CASHMERE
Living Room	HARDWOOD- MIRAGE 5" RED OAK- HOPSCOTCH CHARACTER- CASHMERE
Dining Room	HARDWOOD- MIRAGE 5" RED OAK- HOPSCOTCH CHARACTER- CASHMERE
Family Room	HARDWOOD- MIRAGE 5" RED OAK- HOPSCOTCH CHARACTER- CASHMERE
Den / Library / Study	HARDWOOD- MIRAGE 5" RED OAK- HOPSCOTCH CHARACTER- CASHMERE
Basement Landing(If Applies)	HARDWOOD- MIRAGE 5" RED OAK- HOPSCOTCH CHARACTER- CASHMERE
Lower Landing (If Applies)	TILE- CALACATTA CA6083P POLISHED 24X24
Upper Landing	HARDWOOD- MIRAGE 5" RED OAK- HOPSCOTCH CHARACTER- CASHMERE
Upper Hall	HARDWOOD- MIRAGE 5" RED OAK- HOPSCOTCH CHARACTER- CASHMERE
Master Bedroom	CARPET- SHAW- TRUST ME E0688- 106 FOSSIL
Bedroom #2	CARPET- SHAW- TRUST ME E0688- 106 FOSSIL
Bedroom #3	CARPET- SHAW- TRUST ME E0688- 106 FOSSIL
Bedroom #4	CARPET- SHAW- TRUST ME E0688- 106 FOSSIL
Bedroom #5	CARPET- SHAW- TRUST ME E0688- 106 FOSSIL

Underpad	Type	Area
	SPRING GOLD ELITE UNDERPAD	BEDROOMS

\*\* Refer to Construction Summary

8. Railings and Pickets

Railing Type	V-GROOVE	Colour	MIRAGE- HOPSCOTCH
Picket Type	EUROLINE 2	Colour	BLACK
Stringer / Riser	AS PER CONSTRUCTION SPECIFICATIO	Colour	MIRAGE- HOPSCOTCH
Treads	AS PER CONSTRUCTION SPECIFICATIO	Colour	MIRAGE- HOPSCOTCH
Red Oak Stairs with Semi Gloss Finish		<input checked="" type="radio"/> Yes <input type="radio"/> No	

\*\* Refer to Construction Summary THE STAIN COLOURS OR FINISH AVAILABLE ON RISERS, TREADS, PICKETS AND RAILS (STAIRCASES), WILL NOT BE AN EXACT MATCH TO PREFINISHED HARDWOOD OR LAMINATE FLOORS.

9. Wall Paint Flat Finish

Main & Upper Hall	22 WARM GREY	Master Bedroom	22 WARM GREY
Living Room	22 WARM GREY	Bedroom #2	22 WARM GREY
Dining Room	22 WARM GREY	Bedroom #3	22 WARM GREY
Kitchen / Breakfast	22 WARM GREY	Bedroom #4	22 WARM GREY
Family Room	22 WARM GREY	Bedroom #5	
Powder Room	22 WARM GREY	Master Ensuite	22 WARM GREY
Laundry Room	22 WARM GREY	Ensuite Bath - Bedroom 2	22 WARM GREY
Den/Library	22 WARM GREY	Ensuite Bath - Bedroom 3	22 WARM GREY
Trim Paint-Semi Gloss	BIRCH WHITE	Ensuite Bath - Bedroom 4	22 WARM GREY

Smooth Ceilings First Floor ☒ Yes ☐ No

\*\* Refer to Construction Summary

Initial: 



Purchaser: Gurkarm Sher DHINDSA

Telephone Res. / Bus: /

Decor Advisor: Natalie Mancuso

Lock Date: 7-Jan-20

Property: 79

Project: Lamberts Lane Home Corp.

Model and Elevation: Barton Twelve Elev 1

7-Jan-20

Plan #: 43M-2071

### 10. Plaster Mouldings and Medallions

Entrance Vestibule

Main Hall

Living Room

Dining Room

Family Room

Kitchen/Breakfast

Den/Library

Lower Landing

\*\* Refer to Construction Summary

### 11. Fireplace

Living Room

Purchased As Per Plan N/A

Family Room

Purchased As Per Plan N/A

Other Room - Specify

Purchased As Per Plan N/A

Fireplace Type

Mantle Type

Colour / Stain

Surround

Hearth

FLAT ON WALL

CASTONE-AEQUALITAS I

NATURAL IVORY

N/A

NO

\*\* Refer to Construction Summary

### 12. Heating and Air Conditioning

Air Conditioning

NO

Gas Provisions Dryer

NO

Comment

Gas Provisions Stove

NO

Gas Provisions Barbecue

NO

\*\* Refer to Construction Summary

### 13. Electrical

Plugs and Switches

White

DECOR

Hood Fan

STANDARD WHITE

Appliances

Built in Cooktop

Built in Oven

Above Kitchen Cabinet Light

Yes No

Below Kitchen Cabinet Light

Yes No

Gas Stove

Microwave

Yes No

Yes No

Yes No

Yes No

Dishwasher Rough-in Yes

\*\* Refer to Construction Summary

### 14. General Comments

\*\* Refer to Construction Summary

### Disclaimers and Notes

- Colours of all materials are as close as possible to builder's selection, but not necessarily identical due to variances in manufacturing.
- Any extras listed above are null and void unless accompanied by a separate invoice/amendment. Said invoice must be paid in full.
- The Purchaser agrees that this colour selection is final and that no changes will be permitted, unless required by the Vendor.
- The Purchaser acknowledges reading and accepting document which contains other miscellaneous disclaimers.

Signature:

*S. Dhindsa*

Date:

*Jan-7th 2020*

Shower Pans

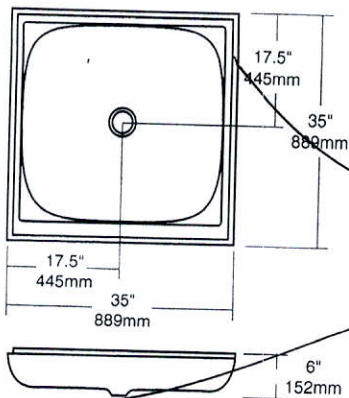

Model Number	Apx Weight	Description	List Price	Standard Colours	Des Col
3636D	45 lbs 18 kgs	Standard feature: Slip resistant bottom, polished chrome drain			

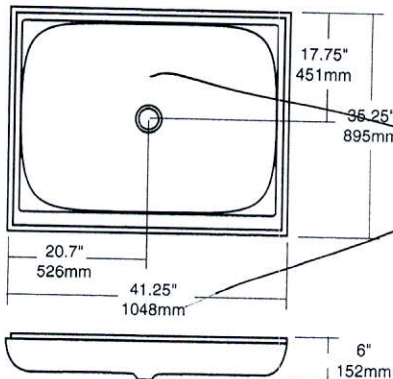
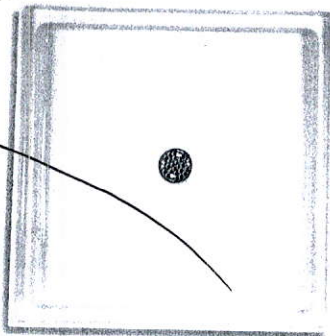

Model Number	Apx Weight	Description	List Price	Standard Colours	Des Col
3642D	50 lbs 19 kgs	Standard feature: Slip resistant bottom, polished chrome drain			

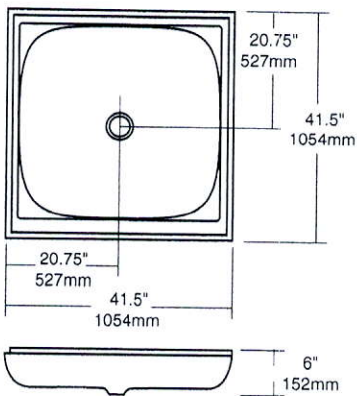
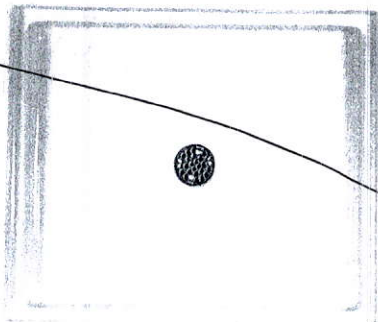

Model Number	Apx Weight	Description	List Price	Standard Colours	Des Col
4242DS	50 lbs 19 kgs	Standard feature: Slip resistant bottom, polished chrome drain			

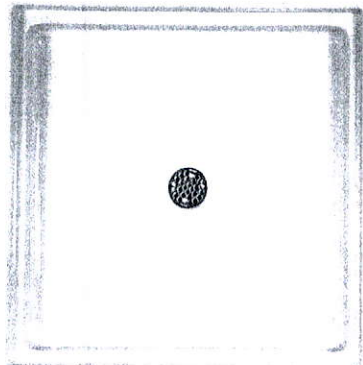

Master Ensuite  
shower Pan for  
custom Glass shower.





*Delta Dryden 14 Series P/B Kit  
Includes With Stops Rough &  
Ceiling Mount Arm & Wall Mount Arm  
Model DF-KIT10-WS*



see what Delta can do™

RECEIVED

NOV 28 2019

2.0 GPM

RECEIVED

E

RF



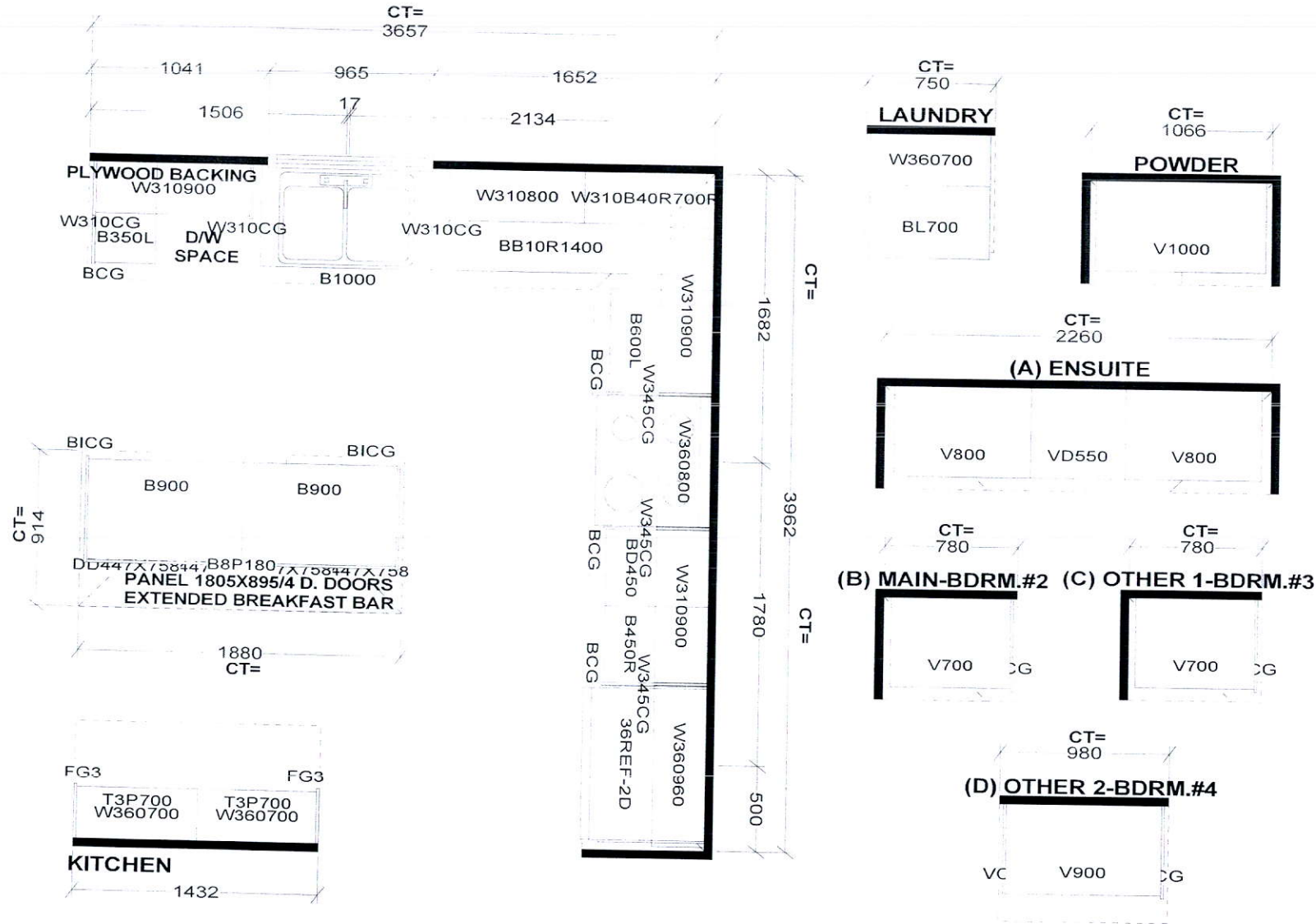

<b>Selba Industries</b>		J# _____
W WIDTH _____ W HGHT _____ W CNT _____ FLOOR HGHT _____ DOOR HGHT _____ ST. CENT _____ 2X4 _____ VENT BOX COVER _____		This drawing is the intellectual property of SELBA INDUSTRIES INC. and is an original design which must not be released or copied unless applicable fee has been paid or job order placed.
DESIGNER: KS DATE: MAR 12 19		JOB NUMBER: BUILDER: GREENPARK SITE: LAMBERTS LANE PH.2 MODEL: BARTON 12X EL 1,2 LOT #:

LOT 79  
LAMBERTS LANE  
PHASE 2

BARTON 12  
ELEVATION 1

REVISION:

REVISE MASTER SHOWER TO  
FRAMELESS GLASS ON THREE  
SIDES. DOOR TO OPEN ON  
TUB SIDE. ADD 14"X20"  
NICHE ON DOOR SIDE OF  
WALL.

(NICHE WIDTH SIZE MAY VARY DUE  
TO LIMITATIONS DUE TO PLUMBING  
IN WALL SPACE)

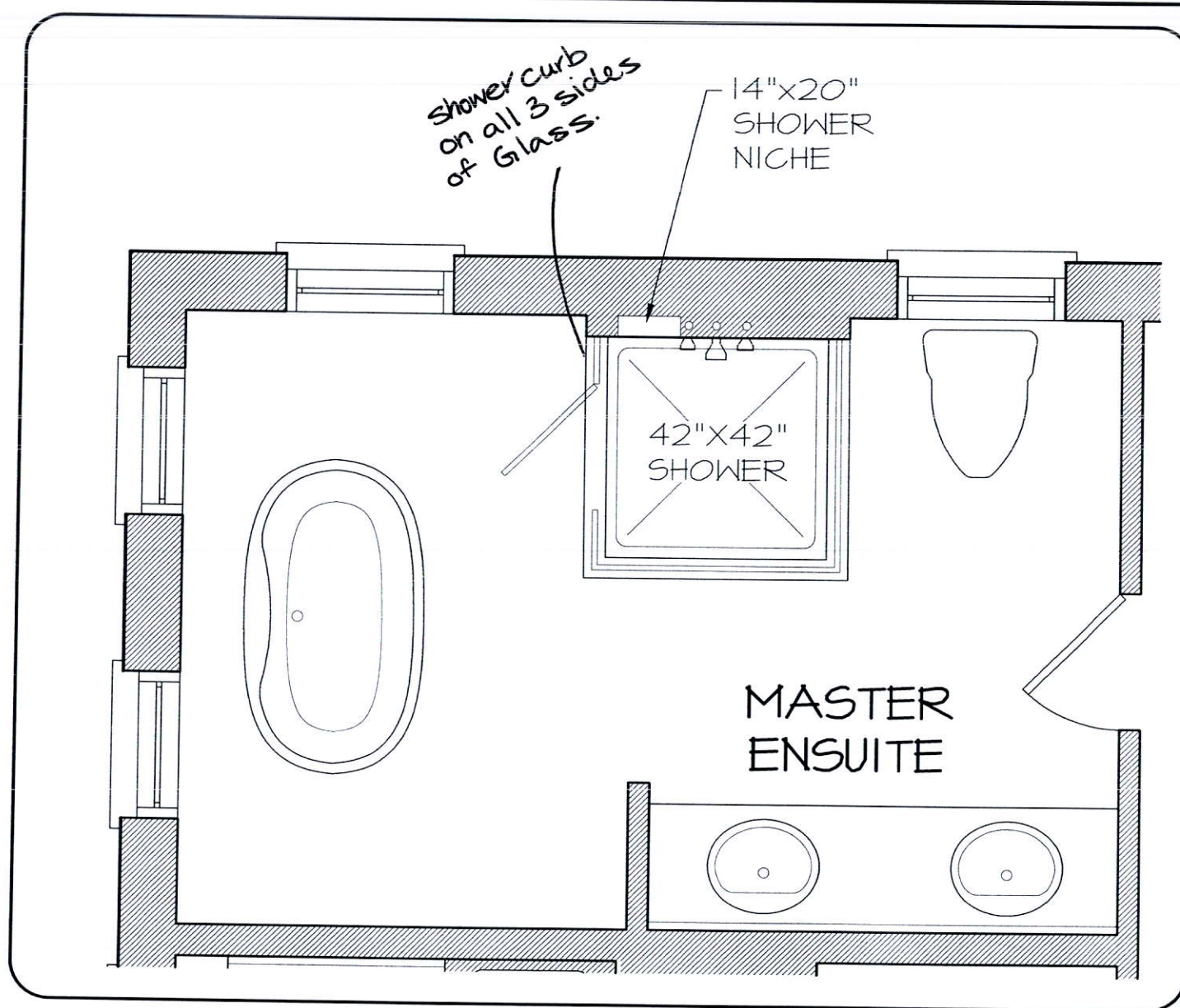

UPPER LEVEL

DISCLAIMERS: SKETCH NOT TO SCALE. DIMENSIONS, SPECIFICATIONS AND ARCHITECTURAL DETAILS SUBJECT TO MODIFICATION BY THE VENDOR. SKETCH IS ONLY FOR THE PURPOSE OF ILLUSTRATING REVISIONS REQUESTED BY THE PURCHASER AND ALL REVISIONS ARE SUBJECT TO VENDOR'S FINAL APPROVAL. ONLY REVISIONS ACCEPTED IN WRITING BY THE PURCHASER AND VENDOR ON A PURCHASER'S EXTRA SHEET WILL BE INCORPORATED INTO THE PLANS FILED WITH THE MUNICIPALITY. E. & O.E.

REGION  
DESIGN  
INC.

SCALE

N.T.S.

BY  
MB

PAGE No.  
1 OF 1





