

CONSTRUCTION SUMMARY

Lotus Pointe 2 (G) - Lamberts Lane Home Corp. DATE:

DEC 09 2019

PURCHASERS: Derick AGYEIHENE and Doreen Ofosu ADDO

TEL: RES.: 647-704-5462

| | | | | |
|----------------------|-------------------------|-----------------------------------|--|--|
| LOT / PHASE 6 / 2 | REG. PLAN # 43M-2071 | HOUSE TYPE Barton Eight Elev 2 | | |
|----------------------|-------------------------|-----------------------------------|--|--|

CABINETRY

| | |
|--|--|
| 1 - CABINETRY - KITCHEN - LIGHT VALENCE 21Aug19 Note: NO ELECTRICAL | |
| 1 - KITCHEN - DELETE CABINETS ABOVE STOVE - VENDOR WILL SUPPLY 6 INCH VENT AS PER CONSTRUCTION SPECIFICATIONS AND VENT MAY NOT BE IN THE APPROPRIATE LOCATION FOR INSTALLATION OF PURCHASER SUPPLIED VENT - PURCHASER TO SUPPLY OWN FAN AFTER CLOSING (TEMP. FAN MA 21Aug19 Note: Specs. Attached | |
| 1 - KITCHEN - DELETE HARDWARE NO HOLES DRILLED 21Aug19 Note: | |

CABINETRY ACCESSORIES

| | |
|---|--|
| 1 - FOR CONFIRMATION PURPOSES - KITCHEN - NO OVERHANG ON ISLAND 13Sep19 Note: | |
| 1 - ***INSERT - KITCHEN CABINETRY BASE - RECYCLE PULLOUT 1 BIN - PRICE IS EACH 13Sep19 Note: | |
| 1 - KITCHEN CABINETRY BASE - RECYCLE PULLOUT 2 BIN - PRICE IS EACH 13Sep19 Note: | |
| 1 - KITCHEN CABINETRY BASE - BANK OF DRAWERS - STANDARD 13Sep19 Note: | |
| 1 - KITCHEN - ISLAND - BASE CABINETRY TO BE PULLED OUT TO ACCOMMODATE FLUSH INSTALL OF BAR FRIDGE 12Sep19 Note: | |
| 1 - CABINETRY FEE FOR FLUSH CUTOUT ON WALL OVEN/MICROWAVE COMBO CABINET ONLY 10Sep19 Note: Specs. Attached | |
| 1 - KITCHEN CABINETRY - BUILT-IN FRIDGE CABINET - PRICE IS EACH 21Aug19 Note: Specs. Attached | |
| 3 - KITCHEN CABINETRY UPPER - UPPER CABINETS - FITS TALL UPPER CABINETS - PRICE IS PER FOOT - STANDARD 21Aug19 Note: | |
| 3 - KITCHEN CABINETRY BASE - BASE AND STANDARD COUNTER - PRICE IS PER FOOT - STANDARD 21Aug19 Note: | |
| 1 - KITCHEN CABINETRY BASE - RECYCLE PULLOUT 2 BIN - PRICE IS EACH 21Aug19 Note: | |
| 1 - KITCHEN CABINETRY BASE - PIE CUT CORNER CABINET - BASE CABINETRY - STANDARD 21Aug19 Note: | |
| 1 - KITCHEN CABINETRY UPPER - FULL DEPTH ABOVE FRIDGE - WITH GABLES - 600MM - PRICE IS EACH - STANDARD 21Aug19 Note: | |
| 1 - KITCHEN CABINETRY BASE - COOKTOP CABINET WITH POT DRAWERS (2 DRAWERS) - STANDARD 21Aug19 Note: Specs. Attached | |
| 1 - KITCHEN CABINETRY - BUILT-IN MICROWAVE/OVEN COMBO - STANDARD 21Aug19 Note: | |
| 1 - ENSUITE 3/4 BATHROOM - 36" HEGHT VANITY IN LIEU OF STANDARD HEIGHT 21Aug19 Note: | |
| 1 - ENSUITE 2 BATHROOM - 36" HEGHT VANITY IN LIEU OF STANDARD HEIGHT 21Aug19 Note: | |
| 1 - MASTER ENSUITE BATHROOM - 36" HEGHT VANITY IN LIEU OF STANDARD HEIGHT 21Aug19 Note: | |

CONSTRUCTION SUMMARY

Lotus Pointe 2 (G) - Lamberts Lane Home Corp.

PURCHASERS: Derick AGYEIHENE and Doreen Ofosu ADDO

TEL: RES.: 647-704-5462

| LOT / PHASE | REG. PLAN # | HOUSE TYPE | | |
|--|-------------|---------------------|--|--|
| 6 / 2 | 43M-2071 | Barton Eight Elev 2 | | |
| 1 - KITCHEN - ISLAND - CUT OUT FOR BUILT-IN WINE FRIDGE 21Aug19 Note: Specs. Attached | | | | |
| 1 - KITCHEN - ROTATE ISLAND 21Aug19 Note: | | | | |

CERAMIC TILE

| | |
|--|--|
| 1 - TILE - UPGRADE 6 FLOOR TILE - - LAUNDRY ROOM 21Aug19 Note: | |
| 1 - TILE - UPGRADE 6 FLOOR TILE - - POWDER ROOM 21Aug19 Note: | |
| 1 - TILE - UPGRADE 6 FLOOR TILE - - KITCHEN 21Aug19 Note: | |
| 1 - TILE - UPGRADE 6 FLOOR TILE - - FOYER 21Aug19 Note: | |
| 1 - TILE - UPGRADE 2 FLOOR TILE - - BATHROOM 2 - SHOWER 21Aug19 Note: | |
| 1 - TILE - UPGRADE 2 FLOOR TILE - - BATHROOM 2 - FLOOR 21Aug19 Note: | |
| 1 - TILE - UPGRADE 1 FLOOR TILE - - BATHROOM 3/4 - FLOOR 21Aug19 Note: | |
| 1 - TILE - UPGRADE 3 WALL TILE - - ENSUITE WALL TILE - SHOWER 21Aug19 Note: | |
| 1 - TILE - UPGRADE 3 FLOOR TILE - - ENSUITE BATHROOM - FLOOR 21Aug19 Note: | |
| 1 - DELETE ALL CERAMIC BATHROOM ACCESSORIES - DELETE TOWEL BAR, PAPER HOLDER & SOAP DISH THROUGHOUT 21Aug19 Note: | |

CONSTRUCTION

| | |
|---|--|
| 1 - SMOOTH CEILINGS ON FIRST FLOOR ONLY 21Aug19 Note: | |
| 1 - PLEASE NOTE THAT NO FURTHER STRUCTURAL CHANGES WILL BE PERMITTED. 03Jul19 Note: | |
| 1 - MASTER BEDROOM - DIVIDE STANDARD CLOSET TO CREATE HIS AND HERS CLOSETS - CENTER DOORS IN EACH CLOSET 03Jul19 Note: | |
| 1 - FAMILY ROOM - REMOVE HALFWALL AND ENLARGE OPENING 03Jul19 Note: | |
| 1 - BASEMENT 8 FOOT 6 INCH CONCRETE POUR - MEASURED FROM TOP OF FOOTING TO TOP OF FOUNDATION WALL 13May19 Note: | |
| 1 - FIRST FLOOR INCREASE CEILING HEIGHT FROM 9 FEET TO 10 FEET 13May19 Note: | |
| 1 - SECOND FLOOR INCREASE CEILING HEIGHT FROM 8 FEET TO 9 FEET 13May19 Note: | |

DOORS AND TRIM

| | | | |
|--|-----|-------------------------|--|
| 1 - INSERT- TRIM - UPGRADE 2- 7-¼" STEP-- BASEBOARD AND 3" CASING 09Dec19 Note: EXTRA COST- | New | RECEIVED DEC 09 2019 | |
|--|-----|-------------------------|--|

CONSTRUCTION SUMMARY

Lotus Pointe 2 (G) - Lamberts Lane Home Corp.

PURCHASERS: Derick AGYEIHENE and Doreen Ofori ADDO

TEL: RES.: 647-704-5462

| LOT / PHASE | REG. PLAN # | HOUSE TYPE | | |
|-------------|-------------|---------------------|--|--|
| 6 / 2 | 43M-2071 | Barton Eight Elev 2 | | |

| | |
|---|--|
| 1 - DELETE-----TRIM - UPGRADE 2- 7-1/4" BASEBOARD AND 3" CASING 09Dec19 Note: | |
| 1 - TRIM - UPGRADE 2- 7-1/4" BASEBOARD AND 3" CASING 21Aug19 Note: Delete. | |

ELECTRICAL

| | |
|---|--|
| 1 - BUILT IN OVEN AND COOKTOP PROVISION - PROVISION ONLY - ELECTRICAL ONLY 21Aug19 Note: | |
| 1 - MASTER BEDROOM - PLUG - ELECTRICAL PLUG - INSTALLED 5' FROM FLOOR 21Aug19 Note: | |
| 1 - PLUG - ELECTRICAL PLUG - ADD TO ISLAND FOR BUILT-IN WINE FRIDGE 21Aug19 Note: | |
| 1 - LIGHT AND SWITCH - NO FIXTURE INCLUDED - LIVING ROOM 21Aug19 Note: | |
| 1 - PLUG - ELECTRICAL PLUG - TO BE INSTALLED OVER FIREPLACE 21Aug19 Note: | |
| 1 - ABOVE KITCHEN ISLAND - ADD LIGHT AND SWITCH - NO FIXTURE INCLUDED 21Aug19 Note: | |

FIREPLACE AND ACCESSORIES

| | |
|---|--|
| 1 - GAS LINE ROUGH-IN FOR STOVE (INCLUDES ELECTRICAL OUTLET) - FIRST FLOOR 26Aug19 Note: | |
| 1 - GAS LINE ROUGH-IN FOR BARBECUE - FIRST FLOOR 21Aug19 Note: | |
| 1 - MANTEL - PAINTED - M6 - IN LIEU OF STANDARD MANTEL 21Aug19 Note: | |

HARDWOOD FLOORING

| | |
|--|--|
| 1 - LAMINATE -UPGRADE TO LEXINGTON SERIES IN LIEU OF STANDARD LAMINATE 21Aug19 Note: | |
| 1 - HARDWOOD – GROUP B SERIES 5 INCH - IN LIEU OF 2 1/4 INCH NATURAL RED OAK - - MAIN HALL 21Aug19 Note: | |
| 1 - HARDWOOD – GROUP B SERIES 5 INCH - IN LIEU OF 2 1/4 INCH NATURAL RED OAK - - LIVING AND DINING ROOM 21Aug19 Note: | |
| 1 - HARDWOOD – GROUP B SERIES 5 INCH - IN LIEU OF 2 1/4 INCH NATURAL RED OAK - - LIBRARY/DEN 21Aug19 Note: | |
| 1 - HARDWOOD – GROUP B SERIES 5 INCH - IN LIEU OF 2 1/4 INCH NATURAL RED OAK - - FAMILY ROOM 21Aug19 Note: | |

MIRRORS AND GLASS

| | |
|---|--|
| 1 - ENSUITE 2 BATHROOM - FRAMELESS GLASS SHOWER DOOR FOR 5 FOOT PAN - CHROME KNOB AND HINGES 21Aug19 Note: | |
| 1 - MASTER ENSUITE BATHROOM - SHOWER DOOR HANDLE - CHROME D-RING WITH TOWEL BAR 21Aug19 Note: | |
| 1 - MASTER ENSUITE BATHROOM - FRAMELESS GLASS SHOWER DOOR WITH HALF WALL OF GLASS ABOVE VANITY 21Aug19 Note: | |

CONSTRUCTION SUMMARY

Lotus Pointe 2 (G) - Lamberts Lane Home Corp.

PURCHASERS: Derick AGYEIHENE and Doreen Ofosu ADDO

TEL: RES.: 647-704-5462

| | | | | |
|----------------------|-------------------------|-----------------------------------|--|--|
| LOT / PHASE 6 / 2 | REG. PLAN # 43M-2071 | HOUSE TYPE Barton Eight Elev 2 | | |
|----------------------|-------------------------|-----------------------------------|--|--|

MISCELLANEOUS

| | |
|---|--|
| 1 - FURTHER DISCOUNT AS PER VENDOR 21Aug19 Note: | |
|---|--|

PLUMBING

| | |
|--|--|
| 1 - MASTER ENSUITE BATHROOM - FREESTANDING TUB - TUBCO CIRBUS SR 22 IN LIEU OF STANDARD FREE STANDARD TUB 21Aug19 Note: | |
|--|--|

PROMOTIONAL

| | |
|--|--|
| 1 - PARTIAL REDEMPTION OF PROMOTIONAL PACKAGE \$\$\$\$\$\$ BALANCE FORWARD TO BE USED AT A LATER DATE. ORIGINAL PROMOTIONAL PACKAGE OF \$\$\$\$\$ AS PER SCHEDULE PE DATED MMMDDYYYY. 13May19 Note: | |
|--|--|

STAIRS AND RAILINGS

| | |
|---|--|
| 1 - STAINED HANDRAIL, TREADS, RISERS AND STRINGER EXCLUDING PICKETS (FOR IRON PICKETS) - STANDARD STAIRCASE - PRICE IS PER SET 21Aug19 Note: | |
| 1 - STAIRCASE - V GROOVE HANDRAIL 21Aug19 Note: | |
| 1 - STAIRCASE - EUROLINE R6-3 IRON PICKETS - BLACK 21Aug19 Note: | |

EXTRAS AS PER OFFER

| | |
|--|--|
| (7,5) The Vendor agrees that notwithstanding any other term or provision in this Agreement included in the Purchase Price and in addition to those items detailed in Schedule GP to the Agreement of Purchase and Sale, the Purchaser is entitled to a credit Worksheet Note: | |
| The Purchaser acknowledges that the Purchase Price is inclusive of all credits and promotional packages available at the time of purchase. Worksheet Note: | |

This Document is Extremely Time Sensitive - Printed 9 Dec 19 at 14:50

Purchasers:

Derick AGYEIHENE & Doreen Ofosu ADDO

Property: 6

Telephone Res. / Bus:

(647) 704-5462 /

Project: Lamberts Lane Home Corp.

Decor Advisor:

Candace Forza

Model and Elevation: Barton Eight Elev 2

Lock Date:

21-Aug-19

21-Aug-19

Plan #: 43M-2071

Layout Changes: ☒ Yes ☐ No

Sketch Attached: ☒ Yes ☐ No

Exterior Colour Scheme:

1. Cabinetry

| | Style and Colour | Hardware |
|----------------------------|------------------|----------|
| Kitchen / Breakfast | EVEREST WHITE | N/A |
| Laundry Room | ELISSE | Standard |
| Powder Room | EVEREST WHITE | 431SA |
| Master Ensuite Bathroom | EVEREST WHITE | 431SA |
| Ensuite Bath - Bedroom 2 | EVEREST WHITE | 113SB |
| Ensuite Bath - Bedroom 3/4 | EVEREST WHITE | 113SB |
| | N/A | N/A |
| | N/A | N/A |
| | N/A | N/A |

Appliances:

Built In Appliances ☒ Yes ☐ No

Slide In Stove ☐ Yes ☒ No

Dishwasher Cabinet ☐ Closed ☒ Open

41" Upper Cabinets ☒ Yes ☐ No

Please NOTE: Standard Cabinet Height is 30"

Stove Opening

36"

NOTE: If not specified, opening will be set to builder's standard opening of approximately 30" width

Fridge Opening

NOTE: If not specified, opening will be set to builder's standard opening of approximately 37" width x 74" height

** Refer to Construction Summary

2. Counters

| | Counter | Edge |
|----------------------------|----------------------------------|------|
| Kitchen / Breakfast | LAMINATE-PEARL SOAPSTONE 4886-38 | |
| Laundry Room | N/A | |
| Powder Room | LAMINATE-INUK SHUK GREY P-344 LM | |
| Master Ensuite Bathroom | LAMINATE-CARRARA BIANCO 6696-46 | |
| Ensuite Bath - Bedroom 2 | LAMINATE-PEARL SOAPSTONE 4886-38 | |
| Ensuite Bath - Bedroom 3/4 | LAMINATE-ARGENTO ROMANO 6697-46 | |
| | N/A | |
| | N/A | |
| | N/A | |

** Refer to Construction Summary

Purchasers:Derick AGYEIHENE & Doreen Ofosu ADDO

Property: 6

Telephone Res. / Bus: (647) 704-5462 /

Project: Lamberts Lane Home Corp.

Decor Advisor: Anne Federico

Model and Elevation: Barton Eight Elev 2

Lock Date: 9-Dec-19

21-Aug-19

Plan #: 43M-2071

3. Ceramic Flooring

| | | At a 45 | Threshold-If App. |
|----------------------------|-----------------------------------|--------------------------|------------------------------|
| Entrance Vestibule | TILE-PURITY STATUARIO LUX-24X24 | <input type="checkbox"/> | metal strip where applicable |
| Main Hall | STRIP | <input type="checkbox"/> | |
| Kitchen / Breakfast | TILE-PURITY STATUARIO LUX-24X24 | <input type="checkbox"/> | |
| Laundry Room | TILE-PURITY STATUARIO LUX-24X24 | <input type="checkbox"/> | |
| Powder Room | TILE-PURITY STATUARIO LUX-24X24 | <input type="checkbox"/> | |
| Master Ensuite Bathroom | TILE-LITIUM SILVER POLISHED-24X24 | <input type="checkbox"/> | |
| Ensuite Bath - Bedroom 2 | TILE-PALLISANDRO WHITE-12X24 | <input type="checkbox"/> | |
| Ensuite Bath - Bedroom 3/4 | TILE-STONE LTE GREY-12 1/4X24 1/4 | <input type="checkbox"/> | |
| | N/A | <input type="checkbox"/> | |
| | N/A | <input type="checkbox"/> | |
| | N/A | <input type="checkbox"/> | |

** Refer to Construction Summary

4. Ceramic Wall Tile

| Master Ensuite Bathroom | Selection | Describe |
|----------------------------|-----------------------------------|----------|
| Tub Deck Wall | N/A | |
| Tub Deck | N/A | |
| Tub Deck Skirt | N/A | |
| Shower Stall | TILE-LITIUM SILVER POLISHED-24X24 | |
| Bathtub Enclosure Walls | N/A | |
| Ensuite Bath - Bedroom 2 | TILE-PALLISANDRO WHITE-12X24 | |
| Ensuite Bath - Bedroom 3/4 | TILE-LUC BLANC GROENLANDIA-8X16 | |
| | N/A | |
| | N/A | |
| | N/A | |
| Kitchen Backsplash | N/A | |

** Refer to Construction Summary - STANDARD GROUT THROUGHOUT UNLESS SPECIFIED

5. Plumbing Fixtures

All Bathrooms

White

N/A

N/A

N/A

N/A

N/A

Whirlpool

N/A

☐ Yes

☒ No

Dishwasher Rough-In

☒ Yes

☐ No

Waterline for Fridge

☐ Yes

☒ No

** Refer to Construction Summary

6. Trim Carpentry

| | |
|----------------------------|---|
| Interior Doors | CARRARA-SMOOTH |
| Interior Trim | 3" 1/4 BB CASING WITH 7 1/4" BASEBOARD - STEP |
| Door Handles | As Per Construction Specifications |
| Exterior Front Door Handle | As Per Construction Specifications |

** Refer to Construction Summary

RECEIVED
DEC 09 2019

Purchasers:Derick AGYEIHENE & Doreen Ofosu ADDO

Property: 6

Telephone Res. / Bus: (647) 704-5462 /

Project: Lamberts Lane Home Corp.

Decor Advisor: Candace Forza

Model and Elevation: Barton Eight Elev 2

Lock Date: 21-Aug-19

21-Aug-19

Plan #: 43M-2071

7. Other Flooring

| | |
|------------------------------|---|
| Main Hall | STRIP-MIRAGE-SWEET MEMORIES-CHARACTER-RED OAK-CASHMERE-HOPSCOTCH-5" |
| Living Room | STRIP-MIRAGE-SWEET MEMORIES-CHARACTER-RED OAK-CASHMERE-HOPSCOTCH-5" |
| Dining Room | STRIP-MIRAGE-SWEET MEMORIES-CHARACTER-RED OAK-CASHMERE-HOPSCOTCH-5" |
| Family Room | STRIP-MIRAGE-SWEET MEMORIES-CHARACTER-RED OAK-CASHMERE-HOPSCOTCH-5" |
| Den / Library / Study | STRIP-MIRAGE-SWEET MEMORIES-CHARACTER-RED OAK-CASHMERE-HOPSCOTCH-5" |
| Basement Landing(If Applies) | N/A |
| Lower Landing (If Applies) | STRIP-MIRAGE-SWEET MEMORIES-CHARACTER-RED OAK-CASHMERE-HOPSCOTCH-5" |
| Upper Landing | STRIP-MIRAGE-SWEET MEMORIES-CHARACTER-RED OAK-CASHMERE-HOPSCOTCH-5" |
| Upper Hall | LAMINATE-LEXINGTON - HAZELWOOD OAK TL-21016-M |
| Master Bedroom | LAMINATE-LEXINGTON - HAZELWOOD OAK TL-21016-M |
| Bedroom #2 | LAMINATE-LEXINGTON - HAZELWOOD OAK TL-21016-M |
| Bedroom #3 | LAMINATE-LEXINGTON - HAZELWOOD OAK TL-21016-M |
| Bedroom #4 | LAMINATE-LEXINGTON - HAZELWOOD OAK TL-21016-M |
| Bedroom #5 | N/A |
| | N/A |
| | N/A |
| | N/A |
| Underpad | TypeArea |
| | N/A |

** Refer to Construction Summary

8. Railings and Pickets

| | | | |
|---------------------------------------|----------------------------------|---|------------------|
| Railing Type | V-GROOVE | Colour | MIRAGE HOPSCOTCH |
| Picket Type | PICKETS R-6-3 | Colour | BLACK |
| Stringer / Riser | AS PER CONSTRUCTION SPECIFICATIO | Colour | MIRAGE HOPSCOTCH |
| Treads | AS PER CONSTRUCTION SPECIFICATIO | Colour | MIRAGE HOPSCOTCH |
| Red Oak Stairs with Semi Gloss Finish | | <input checked="" type="radio"/> Yes <input type="radio"/> No | |

** Refer to Construction Summary

9. Wall Paint Flat Finish

| | | | |
|-----------------------------|---|----------------------------|--------------|
| Main & Upper Hall | 22 WARM GREY | Master Bedroom | 22 WARM GREY |
| Living Room | 22 WARM GREY | Bedroom #2 | 22 WARM GREY |
| Dining Room | 22 WARM GREY | Bedroom #3 | 22 WARM GREY |
| Kitchen / Breakfast | 22 WARM GREY | Bedroom #4 | 22 WARM GREY |
| Family Room | 22 WARM GREY | Bedroom #5 | N/A |
| Powder Room | 22 WARM GREY | Master Ensuite | 22 WARM GREY |
| Laundry Room | 22 WARM GREY | Ensuite Bath - Bedroom 2 | 22 WARM GREY |
| Den/Library | 22 WARM GREY | Ensuite Bath - Bedroom 3/4 | 22 WARM GREY |
| Trim Paint-Semi Gloss | BIRCH WHITE | | N/A |
| | N/A | | N/A |
| | N/A | | N/A |
| Smooth Ceilings First Floor | <input checked="" type="radio"/> Yes <input type="radio"/> No | | |

** Refer to Construction Summary

Initials:

Purchasers: Derick AGYEIHENE & Doreen Ofosu ADDO

Property: 6

Telephone Res. / Bus: (647) 704-5462 /

Project: Lamberts Lane Home Corp.

Decor Advisor: Candace Forza

Model and Elevation: Barton Eight Elev 2

Lock Date: 26-Aug-19

21-Aug-19

Plan #: 43M-2071

10. Plaster Mouldings and Medallions

| | | | | | |
|--------------------|-----|-----|-------------------|-----|-----|
| Entrance Vestibule | N/A | N/A | Kitchen/Breakfast | N/A | N/A |
| Main Hall | N/A | N/A | Den/Library | N/A | N/A |
| Living Room | N/A | N/A | Lower Landing | N/A | N/A |
| Dining Room | N/A | N/A | | N/A | N/A |
| Family Room | N/A | N/A | | | |

** Refer to Construction Summary

11. Fireplace

| Living Room | | | Family Room | | | Other Room - Specify | | |
|-----------------------|-----------------------|----------------------------------|------------------------------------|----------------------------------|-----------------------|-----------------------|-----------------------|----------------------------------|
| Purchased | As Per Plan | N/A | Purchased | As Per Plan | N/A | Purchased | As Per Plan | N/A |
| <input type="radio"/> | <input type="radio"/> | <input checked="" type="radio"/> | <input type="radio"/> | <input checked="" type="radio"/> | <input type="radio"/> | <input type="radio"/> | <input type="radio"/> | <input checked="" type="radio"/> |
| Fireplace Type | N/A | | FLAT ON WALL | | | N/A | | |
| Mantle Type | N/A | | MANTLE M6 | | | N/A | | |
| Colour / Stain | N/A | | AS PER CONSTRUCTION SPECIFICATIONS | | | N/A | | |
| Surround | N/A | | GRIGIO CARNICO | | | N/A | | |
| Hearth | N/A | | NO | | | N/A | | |

** Refer to Construction Summary

12. Heating and Air Conditioning

Air Conditioning NO

Gas Provisions Dryer NO

Comment

Gas Provisions Stove YES

Gas Provisions Barbecue YES

** Refer to Construction Summary

13. Electrical

| | | | | | |
|---------------------|---|---|---|--------------------------------------|-------------------------------------|
| Plugs and Switches | <input checked="" type="radio"/> White | DECOR | Above Kitchen Cabinet Light | <input type="radio"/> Yes | <input checked="" type="radio"/> No |
| Hood Fan | STANDARD WHITE TEMP. | | Below Kitchen Cabinet Light | <input type="radio"/> Yes | <input checked="" type="radio"/> No |
| Appliances | Built in Cooktop | Built in Oven | Gas Stove | Microwave | |
| | <input checked="" type="radio"/> Yes <input type="radio"/> No | <input checked="" type="radio"/> Yes <input type="radio"/> No | <input checked="" type="radio"/> Yes <input type="radio"/> No | <input checked="" type="radio"/> Yes | <input type="radio"/> No |
| Dishwasher Rough-in | Yes | | | | |

** Refer to Construction Summary

14. General Comments

** Refer to Construction Summary

Disclaimers and Notes

- Colours of all materials are as close as possible to builder's selection, but not necessarily identical due to variances in manufacturing.
- Any extras listed above are null and void unless accompanied by a separate invoice/amendment. Said invoice must be paid in full.
- The Purchaser agrees that this colour selection is final and that no changes will be permitted, unless required by the Vendor.
- The Purchaser acknowledges reading and accepting document which contains other miscellaneous disclaimers.

Signature: 

Date: _____

Signature: _____

Date: _____

30" Steam Convection Combination Oven

Benchmark® Series – Stainless Steel HSLP751UC

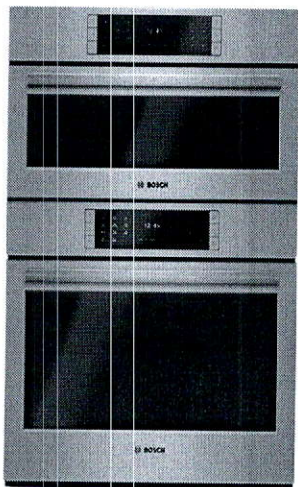

HSLP751UC
Stainless Steel

The steam convection combination oven allows for great results and features an oven with a QuietClose® door.

Features & Benefits

The steam oven cooks meats, vegetables, rice and fish to perfection.

Dampened hinges softly and quietly guide the QuietClose® door shut.

The color TFT control panel with SteelTouch® buttons is easy to use.

A full-extension telescopic rack offers safe access to the oven cavity.

The wall oven is designed to be installed flush with cabinetry.

General Properties

| | |
|--|--|
| Cooking modes – upper cavity | Steam, Steam Convection, European Convection, Reheat, Keep Warm, Defrost, Slow Cook, Proof, Dish Warming, 2 Chicken and 7 Vegetable Programs |
| Cooking modes – lower cavity | Bake, Variable Broil (hi & low), Roast, Warm, Sabbath, Proof Dough, Convection Bake, Convection Broil, Convection Roast, Pizza, Multi Rack Genuine European Convection, Convection Conversion, AutoProbe, Fast Preheat, EcoChef, Speed Convection (Frozen Foods) |
| Cleaning type – lower | Self Clean |
| Telescopic rack | 1 |
| Illumination type | Halogen (Upper and Lower) |
| Interior lights – upper / lower cavity | 1 / 2 |

Oven Performance

| | |
|--|-------------------|
| Bake / broil element wattages – upper cavity | 1,960 W** |
| Bake / broil element wattages – lower cavity | 2,400 / 3,800 W |
| Convection element wattages – lower cavity | 1,960 W / 2,000 W |

Technical Details

| | |
|---------------------------|---------------------------|
| Watts (W) | 8,325 W |
| Circuit breaker (A) | 40 A |
| Volts (V); Frequency (Hz) | 240 / 208 V; 60 Hz |
| Power cord length (in) | 50" |
| Plug type | Fixed Connection, No Plug |
| Energy source | Electric |
| Installation Type | Non-plumbed |



Dimensions & Weight

| | |
|---|------------------------------|
| Overall appliance dimensions (HxWxD)(in) | 49" x 29 3/4" x 24 1/2" |
| Required cutout size (HxWxD) (in) | 48 5/8" x 28 1/2" x 23 1/2" |
| Oven cavity size – upper | 1.4 cu. ft. |
| Oven cavity size – lower | 4.6 cu. ft. |
| Overall lower oven interior dimensions (HxWxD) (in) | 17 13/16" x 24 1/8" x 18" |
| Usable lower oven interior dimensions (HxWxD) (in) | 12 5/16" x 23 1/4" x 15 1/4" |
| Net weight (lbs) | 219 lbs |

Accessories—Included

Upper Oven: Wire rack, Perforated Cooking Pan – Full Size, Baking Tray, Perforated Cooking Pan – Half Size, Cooking Pan – Half Size Lower Oven: 1 Telescopic and 2 Standard Oven Racks, Temperature Probe, Broiler Pan

Accessories—Optional

| | |
|---|---|
|  HEZ36D453 Cooking pan – full size, 1 5/8" deep [not included with product] |  HEZ36D452 Baking tray – full size, 1 1/8" deep |
|  HEZ36D153G Perforated cooking pan – half size, 1 5/8" deep |  HEZ36D153 Cooking pan – half size, 1 5/8" deep |



*Wall oven only

**Element below water reservoir that generates steam

Accessories: To purchase Bosch accessories, cleaners & parts please visit www.bosch-home.com/us/store or call 1-800-944-2904 (Mon to Fri 5 am to 6 pm PST, Sat 6 am to 3 pm PST).
Notes: All height, width and depth dimensions are shown in inches. BSH reserves the absolute and unrestricted right to change product materials and specifications, at any time, without notice. Consult the product's installation instructions for final dimensional data and other details prior to making cutout.
Warranties: Please see Use & Care manual or Bosch website for statement of limited warranty.

For more information on our entire line of products, go to www.bosch-home.com/us or call 1-800-944-2904

© BSH Home Appliances Corporation. All rights reserved. Bosch is a registered trademark of Robert Bosch GmbH.

30" Steam Convection Combination Oven

Benchmark® Series – Stainless Steel HSLP751UC



Installation Details

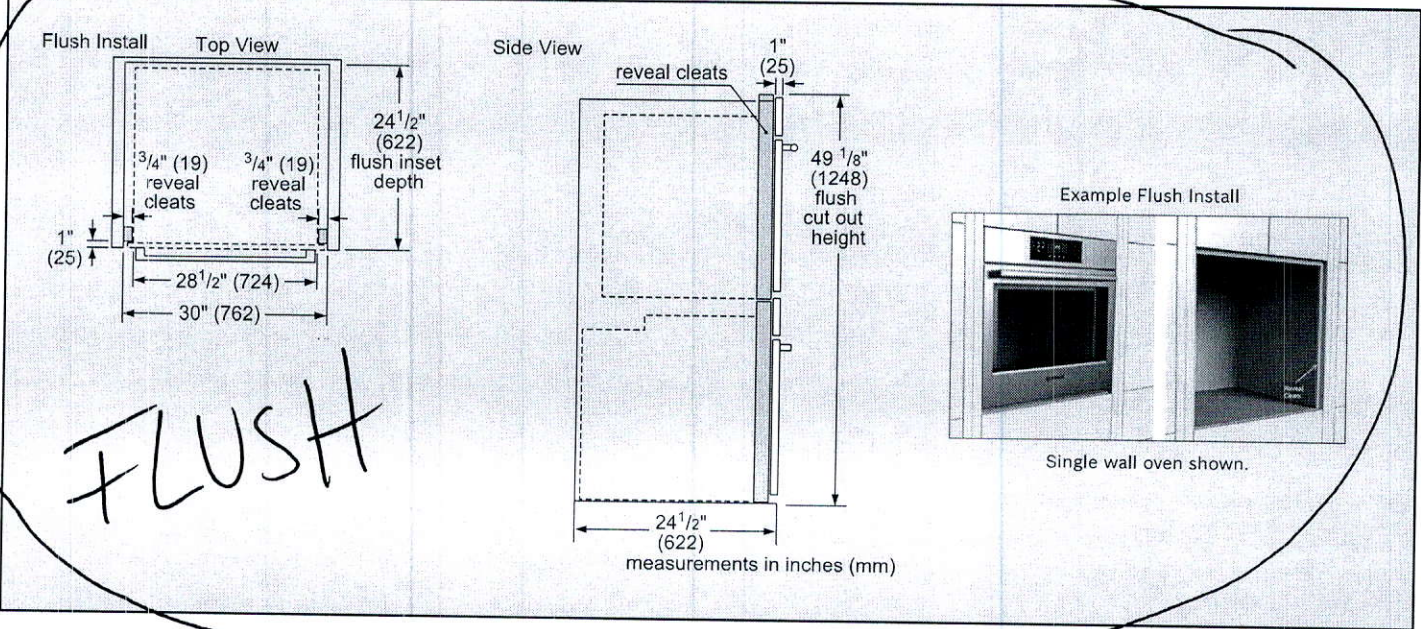
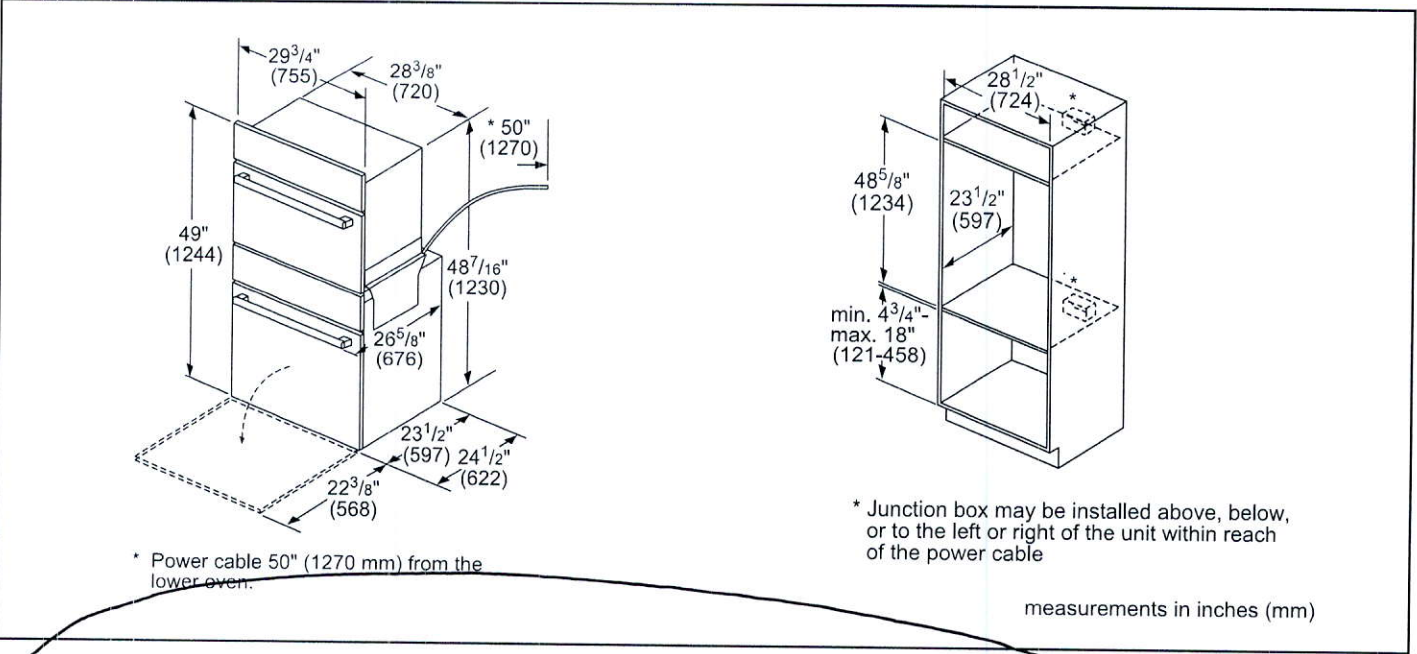

Accessories: To purchase Bosch accessories, cleaners & parts please visit www.bosch-home.com/us/store or call 1-800-944-2904 (Mon to Fri 5 am to 6 pm PST, Sat 6 am to 3 pm PST).

Notes: All height, width and depth dimensions are shown in inches. BSH reserves the absolute and unrestricted right to change product materials and specifications, at any time, without notice. Consult the product's installation instructions for final dimensional data and other details prior to making cutout.

Warranties: Please see Use & Care manual or Bosch website for statement of limited warranty.

For more information on our entire line of products, go to www.bosch-home.com/us or call 1-800-944-2904

© BSH Home Appliances Corporation. All rights reserved. Bosch is a registered trademark of Robert Bosch GmbH.

30" Steam Convection Combination Oven

Benchmark® Series – Stainless Steel HSLP751UC



Installation Details

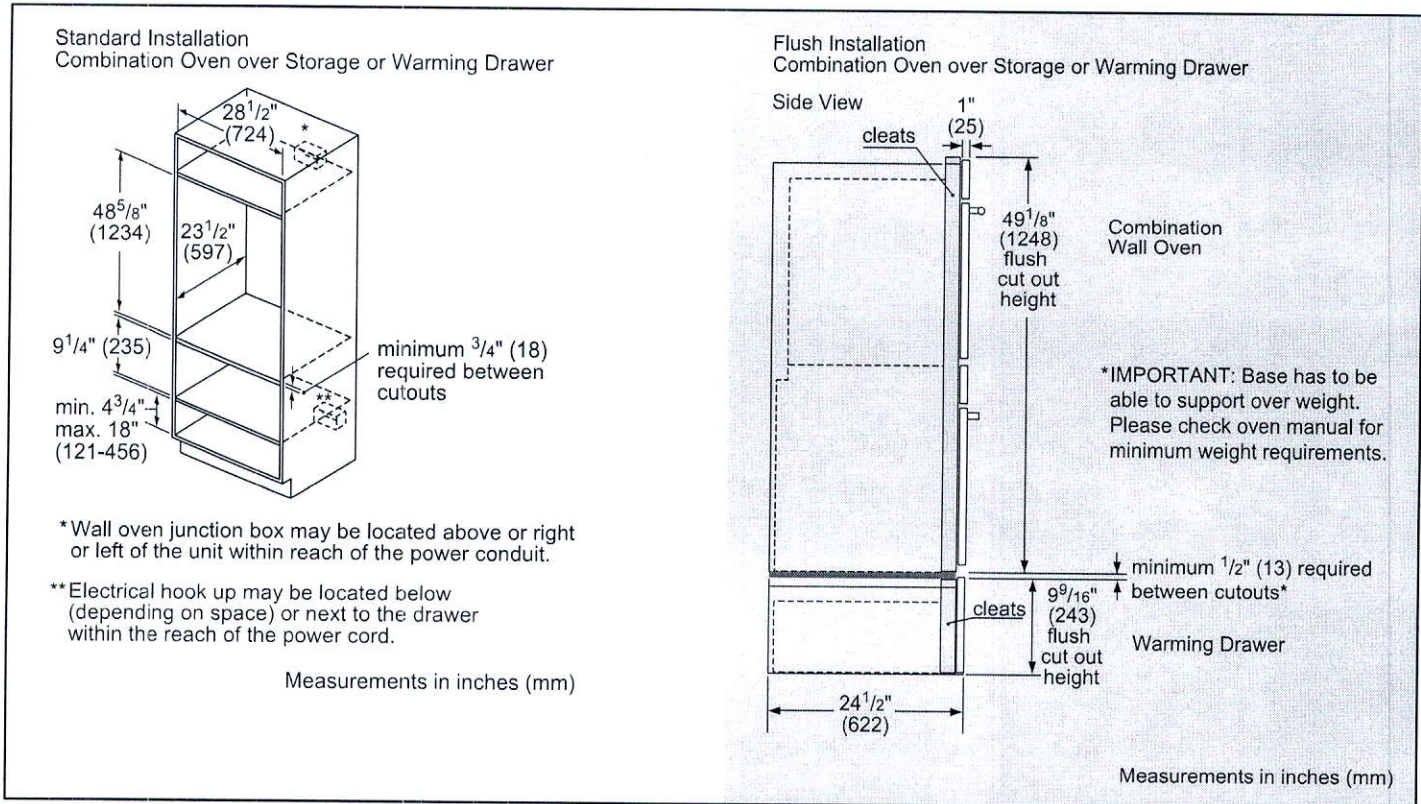

Accessories: To purchase Bosch accessories, cleaners & parts please visit www.bosch-home.com/us/store or call 1-800-944-2904 (Mon to Fri 5 am to 6 pm PST, Sat 6 am to 3 pm PST).

Notes: All height, width and depth dimensions are shown in inches. BSH reserves the absolute and unrestricted right to change product materials and specifications, at any time, without notice. Consult the product's installation instructions for final dimensional data and other details prior to making cutout.

Warranties: Please see Use & Care manual or Bosch website for statement of limited warranty.

For more information on our entire line of products, go to www.bosch-home.com/us or call 1-800-944-2904

© BSH Home Appliances Corporation. All rights reserved. Bosch is a registered trademark of Robert Bosch GmbH.

DIMENSIONS

JENNAIR® RANGETOPS

PRODUCT

| | 30" RANGETOP JGCP430H | 36" RANGETOP JGCP436H | 48" RANGETOP JGCP548H |
|---------------------------------------|--------------------------|--------------------------|--------------------------|
| Overall Width (A) | 29-3/4" (75.6 cm) | 35-3/4" (90.8 cm) | 47-7/8" (121.6 cm) |
| Grate Depth (B) | 22" (55.9 cm) | 22" (55.9 cm) | 22" (55.9 cm) |
| Depth without Control Panel (C) | 23-1/4" (59.1 cm) | 23-1/4" (59.1 cm) | 23-1/4" (59.1 cm) |
| Depth with Control Panel Overhang (D) | 27-1/2" (69.9 cm) | 27-1/2" (69.9 cm) | 27-1/2" (69.9 cm) |
| Depth with Knobs: RISE™ (E) | 29-1/8" (74 cm) | 29-1/8" (74 cm) | 29-1/8" (74 cm) |
| Depth with Knobs: NOIR™ (E) | 29" (73.7 cm) | 29" (73.7 cm) | 29" (73.7 cm) |

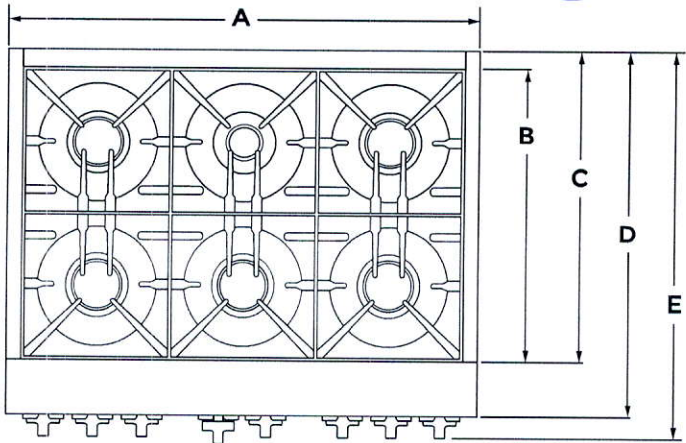

TOP VIEW

★ **IMPORTANT:** Dimensional specifications are provided for planning purposes only. Do not make any cutouts based on this information. Refer to the Installation Guide before selecting cabinetry, verifying electrical/gas connections, making cutouts or beginning installation. All JennAir® appliances are appropriately UL, CUL or CSA approved.

DIMENSIONS

JENNAIR® RANGETOPS

PRODUCT

| | 30" RANGETOP JGCP430H | 36" RANGETOP JGCP436H | 48" RANGETOP JGCP548H |
|-----------------------------|--------------------------|--------------------------|--------------------------|
| Grate Width (F)* | 27-7/16" (69.7 cm) | 33" (83.8 cm) | 44-3/8"* (112.7 cm) |
| Gas Inlet to Surface (G) | 10-3/4" (27.3 cm) | 10-3/4" (27.3 cm) | 10-3/4" (27.3 cm) |
| Center to Gas Inlet (H) | 11" (27.9 cm) | 14-1/8" (35.9 cm) | 19-5/8" (49.8 cm) |
| Recessed Rangetop Width (I) | 29-1/8" (74 cm) | 35" (88.9 cm) | 47-1/4" (120 cm) |

*Includes width of grates and griddle

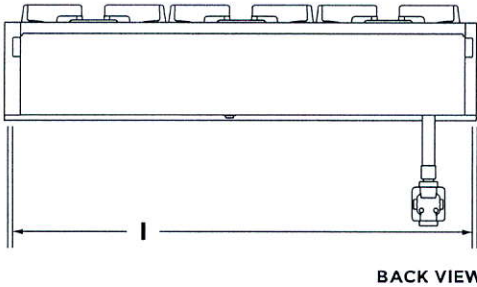
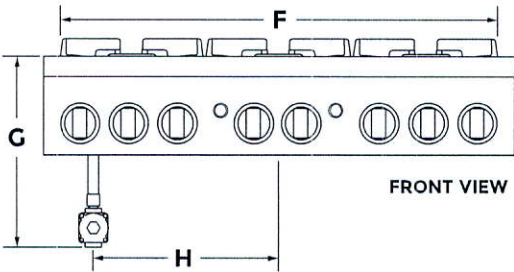

DIMENSIONS

JENNAIR® RANGETOPS

PRODUCT

| | 30" RANGETOP JGCP430H | 36" RANGETOP JGCP436H | 48" RANGETOP JGCP548H |
|------------------------------|--------------------------|--------------------------|--------------------------|
| Height with Grates (J) | 9" (22.9 cm) | 9" (22.9 cm) | 9" (22.9 cm) |
| Control Panel Height (K) | 7-13/16" (19.8 cm) | 7-13/16" (19.8 cm) | 7-13/16" (19.8 cm) |
| Recessed Rangetop Height (L) | 7" (17.8 cm) | 7" (17.8 cm) | 7" (17.8 cm) |
| Cooking Surface Height (M) | 7-7/16" (18.9 cm) | 7-7/16" (18.9 cm) | 7-7/16" (18.9 cm) |
| Recessed Rangetop Depth (N) | 21-7/8" (55.6 cm) | 21-7/8" (55.6 cm) | 21-7/8" (55.6 cm) |
| Depth with Control Panel (O) | 25-1/2" (64.8 cm) | 25-1/2" (64.8 cm) | 25-1/2" (64.8 cm) |

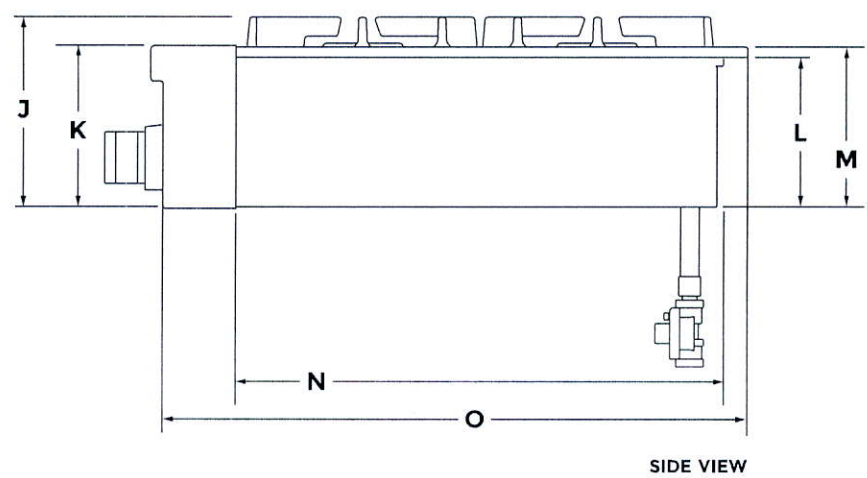

★ **IMPORTANT:** Supplied regulator does not come preattached and is pictured for reference purposes only.

DIMENSIONS

JENNAIR® RANGETOPS

OPENING AND CLEARANCE

| | 30" RANGETOP JGCP430H | 36" RANGETOP JGCP436H | 48" RANGETOP JGCP548H |
|--|--------------------------|--------------------------|--------------------------|
| Combustible Area Above Cooking Surface Width (A) | 30" (76.2 cm) min. | 36" (91.4 cm) min. | 48" (121.9 cm) min. |
| Bottom of Cabinet Height Above Cooking Surface (B)* | 42" (106.7 cm) min. | 58" (147.3 cm) min. | 58" (147.3 cm) min. |
| Bottom of Cabinet Height Above Countertop (C) | 18" (45.7 cm) min. | 18" (45.7 cm) min. | 18" (45.7 cm) min. |
| Distance to Fixed Wall or Combustible Material (D) | 12" (30.5 cm) min. | 12" (30.5 cm) min. | 12" (30.5 cm) min. |

*Dimension reduced by 6" (15.2 cm) when bottom of wood or metal cabinet is covered by at least 1/4" (0.6 cm) flame retardant millboard, which is in turn covered with at least No. 28 MSG sheet metal, 0.015" (0.4 mm) stainless steel, 0.024" (0.6 mm) aluminum or 0.020" (0.5 mm) copper. If installing a hood above the rangetop, follow the hood instructions for dimensional clearances above the cooking surface.

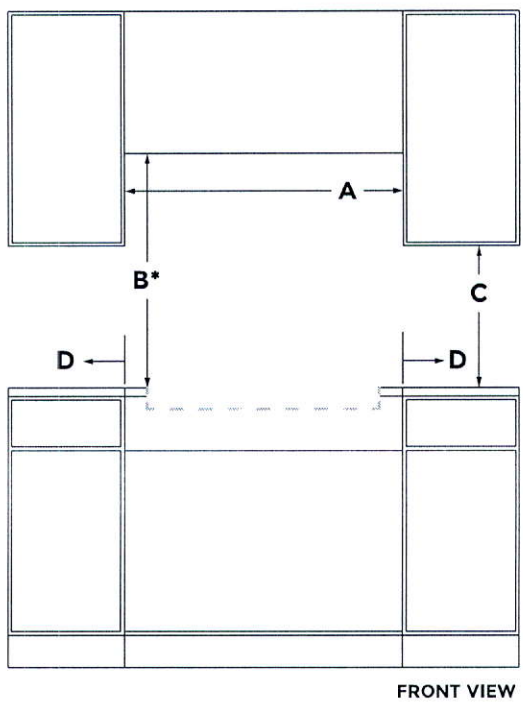

DIMENSIONS

JENNAIR® RANGETOPS

OPENING AND CLEARANCE

| | 30" RANGETOP JGCP430H | 36" RANGETOP JGCP436H | 48" RANGETOP JGCP548H |
|-------------------------------------|--------------------------|--------------------------|--------------------------|
| Recommended Upper Cabinet Depth (E) | 13" (33 cm) | 13" (33 cm) | 13" (33 cm) |
| Cutout to Wall Depth (F)* | 1-1/2" (3.8 cm) min. | 1-1/2" (3.8 cm) min. | 1-1/2" (3.8 cm) min. |
| Cabinet to Countertop Height (G) | 7-1/4" (18.4 cm) | 7-1/4" (18.4 cm) | 7-1/4" (18.4 cm) |
| Cabinet Depth (H) | 24" (61 cm) | 24" (61 cm) | 24" (61 cm) |

*If the back wall is constructed of a combustible material and a backsplash is not installed, a 7-1/2" (19.1 cm) minimum clearance is required from the cutout or 6" (15.2 cm) minimum clearance from the back edge of the rangetop.

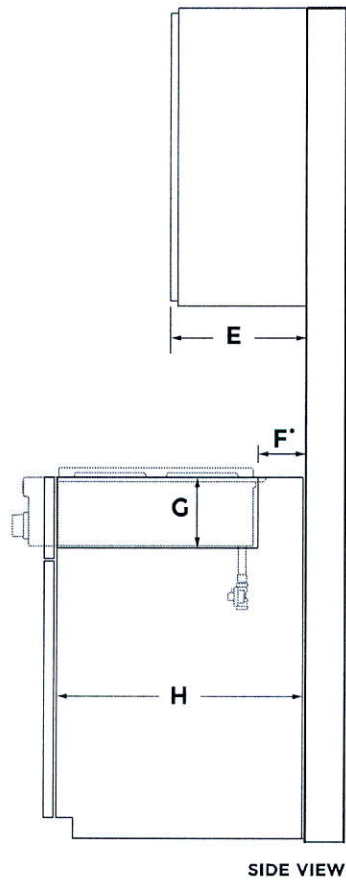

DIMENSIONS
JENNAIR® RANGETOPS
OPENING AND CLEARANCE

| | 30" RANGETOP JGCP430H | 36" RANGETOP JGCP436H | 48" RANGETOP JGCP548H |
|--|--------------------------|--------------------------|--------------------------|
| Countertop and Cabinet Cutout Width (I) | 29-1/4" (74.3 cm) | 35-1/4" (89.5 cm) | 47-3/8" (120.3 cm) |
| Countertop and Cutout Depth (J) | 22-1/4" (56.5 cm) | 22-1/4" (56.5 cm) | 22-1/4" (56.5 cm) |
| Notch Width (K) | 5/16" (0.8 cm) | 5/16" (0.8 cm) | 5/16" (0.8 cm) |
| Cutout Width (L) | 29-7/8" (75.9 cm) | 35-3/4" (90.8 cm) | 47-7/8" (121.6 cm) |

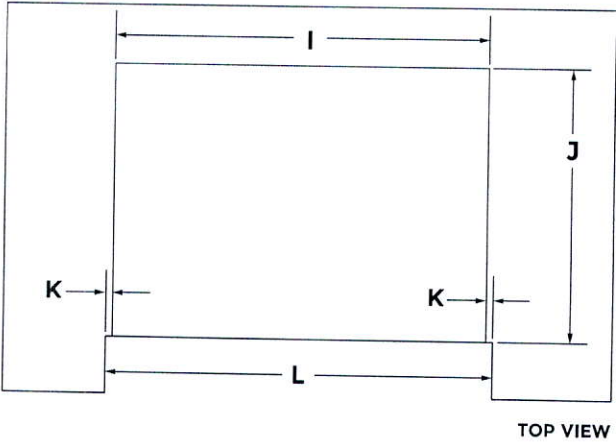

DIMENSIONS

JENNAIR® RANGETOPS

ELECTRICAL REQUIREMENTS

| ELECTRIC REQUIREMENTS CHECKLIST | |
|---------------------------------|---|
| <input type="checkbox"/> | A 120 volt, 60 Hz, AC only, 15-amp fused, electrical circuit is required. |
| <input type="checkbox"/> | A dedicated circuit is recommended. |

RECOMMENDED ELECTRICAL OUTLET ZONE

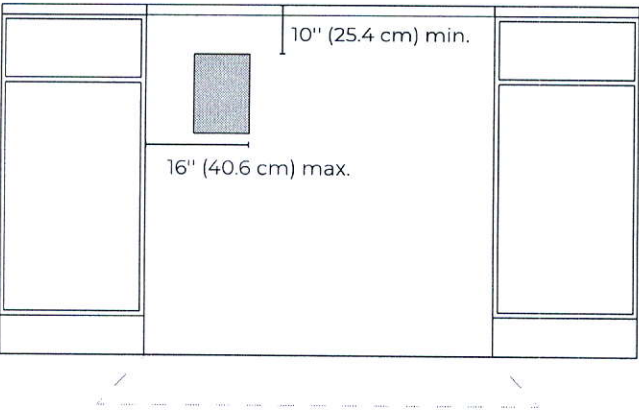

FRONT VIEW

? IF YOU HAVE QUESTIONS ABOUT YOUR ELECTRICAL SUPPLY, CALL A LICENSED, QUALIFIED ELECTRICIAN.

DIMENSIONS

JENNAIR® RANGETOPS

GAS REQUIREMENTS

RECOMMENDED GAS SUPPLY LOCATION

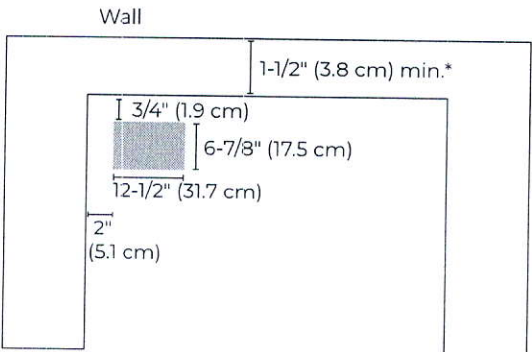

TOP VIEW

*If the back wall is constructed of a combustible material and a backsplash is not installed, a 7-1/2" (19.1 cm) minimum clearance is required from the cutout or 6" (15.2 cm) minimum clearance from the back edge of the rangetop.

GAS SUPPLY ZONE

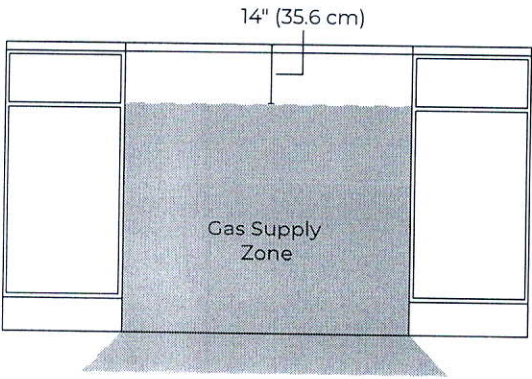

FRONT VIEW



IF YOU HAVE QUESTIONS ABOUT YOUR GAS SUPPLY,
CALL A LICENSED, QUALIFIED SERVICE TECHNICIAN.

Lot 6
Lambert's
Lane



46-Bottle Wine cellar | Dual zone
VPC46DS

MSRP: \$1,759.00

| Selected Model | |
|---|---|
| Model number | VPC46DS |
| Series | Avantgarde Collection |
| | Vinopazzo |
| | Exterior Appearance |
| Cabinet | Black |
| Color Appearance | Seamless Stainless Steel Door |
| Flush with cabinet | Yes |
| Glass Door | Tinted with Low E Argon |
| Handle Type | Curved |
| Installation Type | Freestanding or Built-in |
| Kick Plate | Stainless Steel |
| | Capacity |
| Total Capacity | 46 Bottles |
| | Features |
| Temperature zone(s) | 2 |
| Adjustable Temperature | 4°-18° C |
| Built-in | Yes |
| Configuration | Single Door |
| Control Type | Soft touch electronic control |
| Door opening orientation | Reversible |
| Interior lighting | White LED |
| Leveling legs | Yes |
| Shelves extension | Full Extension on Ball Bearings |
| Shelves type | Metal shelves Stainless steel frontage |
| | Electrical Requirements |
| Volts, Hertz, Amps | 120V / 60 Hz / 15 amp |
| | Dimensions |
| Width (in.) | 23 3/4" |
| Depth (in.) | 23 1/2" |
| Height (in.) | 34 1/2" |
| | Accessories (optional) |
| Square shape Stainless steel handle kit | DG14-1176 |
| | Warranty |
| 2 Year full Warranty | Entire appliance, parts and labour, in-home service |
| 3-year total warranty | Compressor only |

Back to summary

Technical file

User guide

Previous page

Send by Email

Add to my Selection

I Want to Compare

ELICA PRO SERIES
LEONE



Give a splash of Italian design to your professional kitchen with Leone's crisp lines, seamless welded corner craftsmanship, beveled rim and gleaming stainless steel.

Leone has the extra depth (24") and power (1200 CFM on 36", 42" & 48" widths) needed to support professional ranges and cooktops. No ear plugs required with Leone's HUSH sound suppression system, which enables you to comfortably talk and entertain, even when cooking up a storm. Available in 30", 36" and 42" widths, Leone features backlit hidden knob controls, which operate the 4-speed blower and LED lighting. Designed for standard ducted ventilation only.

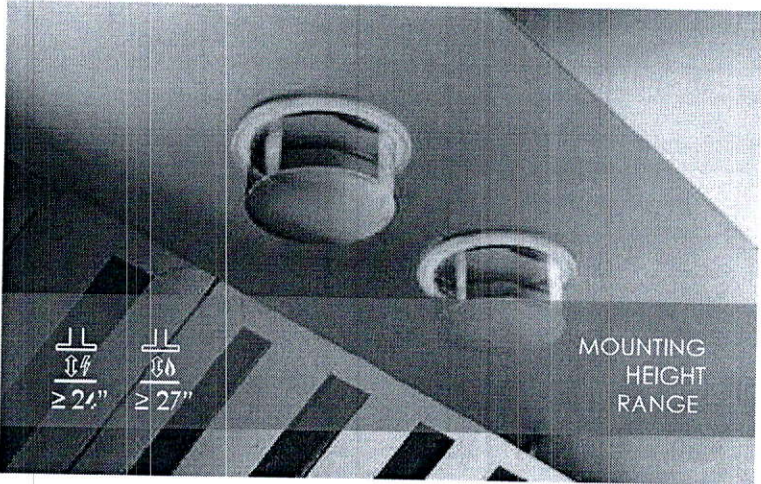
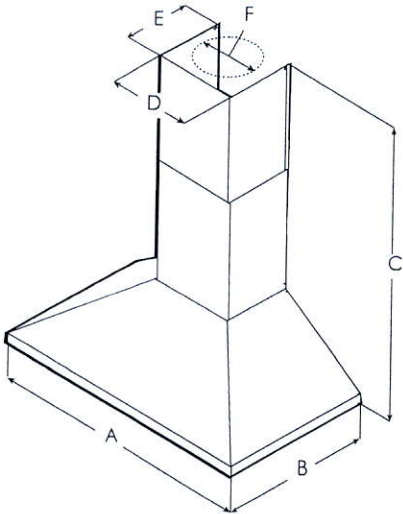

| | ELN630S1 ELN630S2 | ELN136S1 ELN136S2 | ELN142S1 ELN142S2 | ELN148SS |
|---|---|----------------------|----------------------|----------------|
| A | 30" (76.2 cm) | 36" (91.4 cm) | 42" (106.7 cm) | 48" (121.9 cm) |
| B | 24" (61 cm) | | | |
| C | Max: 47 5/8" (120.9 cm) Min: 30" (76.2 cm) | | | |
| D | 13 2/16" (33.2 cm) | | | |
| E | 10 5/8" (27 cm) | | | |
| F | 8" (20.3 cm) | | | |

ELICA PRO SERIES
LEONE





SPECIFICATIONS

| | 30" Unit | 36" Unit | 42" Unit | 48" Unit |
|---|---|------------------------|-------------------------|-------------------------|
| Model: | ELN630S1 ELN630S2 | ELN136S1 ELN136S2 | ELN142S1 ELN142S2 | ELN148SS |
| Dimensions: | 30"W x 24"D x 12 1/8"H | 36"W x 24"D x 12 1/8"H | 42"W x 24"D x 12 1/8 "H | 48"W x 24"D x 12 1/8 "H |
| Blower Type(internal): | 600 CFM(4-speed) | 1200 CFM(4-speed) | 1200 CFM(4-speed) | 1200 CFM(4-speed) |
| Blower Performance: | | | | |
| Speed 1 | 205 CFM | 375 CFM | 375 CFM | 375 CFM |
| Speed 2 | 350 CFM | 640 CFM | 640 CFM | 640 CFM |
| Speed 3 | 510 CFM | 940 CFM | 940 CFM | 940 CFM |
| Speed 4 | 600 CFM | 1200 CFM | 1200 CFM | 1200 CFM |
| Noise (sones): | | | | |
| Woking Speed | Min:2.01, Max:6 | Min:3.21, Max:7.7 | Min:3.21, Max:7.7 | Min:3.21, Max:7.7 |
| Finish: | Stainless Steel | | | |
| Controls: | Fully retractable rotating knobs with blue backlighting | | | |
| Illumination: | 2 LED, 7.5 Watts LED light | | | |
| (replaceable lamps 1 intensity) | | | | |
| Filter Type: | Dishwasher-Safe, Professional Stainless Steel, Angles baffled filters | | | |
| Angled Baffle Filters: | 1 | 2 | 2 | 3 |
| Duct Transition: | 8" Round with BackDraft Damper (top only) | | | |
| Installation Type: | Ducted Installation Only | | | |
| Electrical: | 120V - 60 Hz | | | |
| KITS: | | | | |
| Long Chimney Extension Kit: | KIT07285 | | | |
| CONSUMABLE PARTS: | | | | |
| Replacement Grease Filter (1): | GF09FA | GF09EA | GF09FA | |
| Replacement Light Bulb (1): | LMP0131098 | | | |
| *Consumable parts are sold in units of one (1). Order accordingly | | | | |
| INSTALL HEIGHTS: | | | | |
| Ranger Hood: | Min: 8", Max 10" | | | |
| Ranger Hood with extension duct covers: | Min: 9.9", Max 13" | | | |

PLUS FEATURES

- 

HUSH SYSTEM - An exclusive sound deadening technology that effectively reduces sound levels by over 35%
- 

LED CONSUMER REPLACEABLE BULB - High quality LED lighting usually requires a skilled technician to replace lamps. Avoid this expense with Elica's new LED lamps that enable homeowners to replace in seconds
- 

SEAMLESS CRAFTSMANSHIP - Heavy gauge stainless steel "Seamless" construction that delivers refined elegance.
- 

STAINLESS STEEL BAFFLE FILTERS WITH GREASE COLLECTORS - Designed for high airflow cooking, the "S" shape design traps high volumes of grease
- 

PROFESSIONAL PERFORMANCE - Special features and high performances for models with aspiration capacity between 600 and 1200 CFM's
- 

HEAT GUARD - Senses extreme temperatures (>158 degrees) and automatically adjusts the blower speed to HIGH



36-INCH FRENCH DOOR
BOTTOM FREEZER
PANEL-READY

DRF367500AP

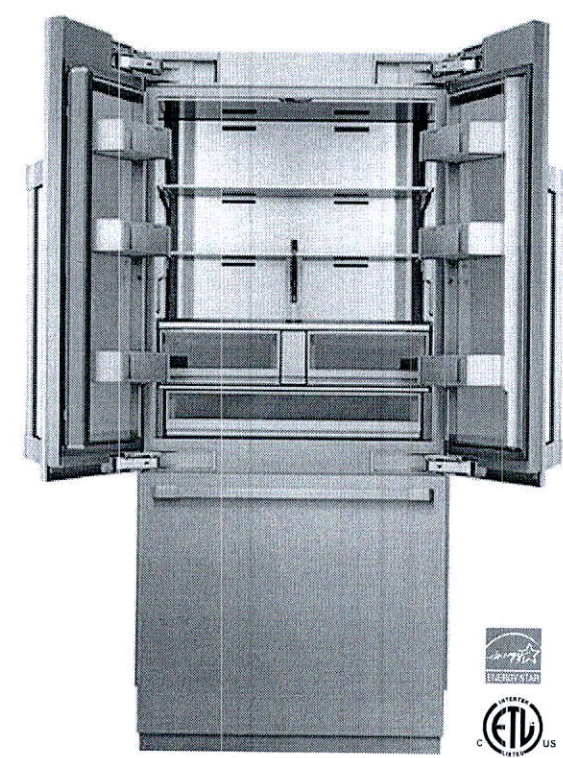

PRODUCT FEATURES

- Full height door with true flush cabinet integration without exposed venting grille
- SteelCool™ Interior illuminated by 3DLighting™
- FreshZone™ Drawer with three customizable temperatures for Meat/Fish, chilled drinks and dairy
- Internal Water Dispenser for easy access to clean, filtered water
- Dual Icemaker with Standard and Cocktail Ice™

DIMENSIONS & WEIGHT

| | |
|---|-------------------------------|
| APPLIANCE DIMENSIONS (H X W X D) (IN.) | 83 5/8" X 35 3/4" X 23 13/16" |
| REQUIRED CUTOUT SIZE (HXWXD) (IN.) | 84" X 36" X 25" |
| NET WEIGHT (LBS) | 562 LBS. |

GENERAL PROPERTIES

| | |
|--|--|
| PANEL READY | YES |
| INTERNAL WATER DISPENSER | YES |
| ICEMAKER | DUAL ICEMAKER FOR STANDARD AND COCKTAIL ICE™ |
| DEODORIZING FILTER | YES |
| LIGHTING | 3D LIGHTING™ |
| INTERIOR MATERIAL | STEELCOOL™ STAINLESS STEEL INTERIOR |
| FULL WIDTH SHELVES - REFRIGERATOR | 2 EA |
| ADJUSTABLE SHELVES - REFRIGERATOR | 2 EA |
| SHELF MATERIAL - REFRIGERATOR | TEMPERED GLASS SHELVES W/ METAL TRIM |
| FULL EXTENSION DRAWERS AT 90° DOOR OPENING ANGLE | YES |
| FRESHZONE™ DRAWER | YES - CHEESE (37°F) / COLD DRINKS (33°F) / MEAT (29°F) |
| CRISPER DRAWERS | 2 EA |
| DOOR BINS - REFRIGERATOR | 6 EA |
| FREEZER DRAWERS | 2 EA |
| DOOR OPEN ALARM | YES |
| SPECIAL MODES | SABBATH MODE |

CAPACITY

| | |
|---|--------------|
| TOTAL UNIT GROSS CAPACITY (CU.FT.) - AHAM | 21.3 CU. FT. |
| REFRIGERATOR GROSS CAPACITY (CU.FT.) | 14.5 CU. FT. |
| FREEZER GROSS CAPACITY (CU.FT.) | 6.8 CU. FT. |

PERFORMANCE

| | |
|--|------------|
| DOUBLE COOLING (2 EVAPORATORS, 1 COMPRESSOR) | YES |
| POWER COOL - REFRIGERATOR | YES |
| DEFROST PROCESS - FREEZER | YES |
| PRECISE COOLING | FROST-FREE |
| PRECISE COOLING | YES |

EFFICIENCY

| | |
|---------------------------|--------------|
| ENERGY STAR® QUALIFIED | YES |
| ANNUAL ENERGY CONSUMPTION | 549 KWH/YEAR |

TECHNICAL DETAILS

| | |
|-------------------------|----------------|
| CURRENT (A) | 6 |
| VOLTS (V) | 115 |
| FREQUENCY (HZ) | 60 |
| POWER CORD LENGTH (IN.) | 78 3/4" |
| PLUG TYPE | 120 V, 3 PRONG |

TEMPERATURE RANGES

| | |
|---------------------------|------------------------------|
| REFRIGERATOR | 34°(1°) TO 44°(7°) |
| REFRIGERATOR - POWER COOL | 34°(1°) |
| FRESHZONE™ DRAWER | 37°(3°) / 33°(1°) / 29°(-1°) |
| FREEZER | 5°(-15°) TO -8°(-23°) |
| FREEZER - POWER FREEZE | -8°(-23°) |



36-INCH FRENCH DOOR BOTTOM FREEZER PANEL-READY

| APPLIANCE DIMENSIONS | |
|----------------------|--------------------------|
| A (WIDTH) | 35 3/4" (908MM) |
| B (DEPTH) | 25" (635MM) |
| C (HEIGHT) | 83 3/8" (2118MM) - FRONT |
| D | 35 5/8" (905MM) |
| E | 44 7/8" (1140MM) |
| F | 20 9/16" (496MM) |
| G | 44" (1118MM) |

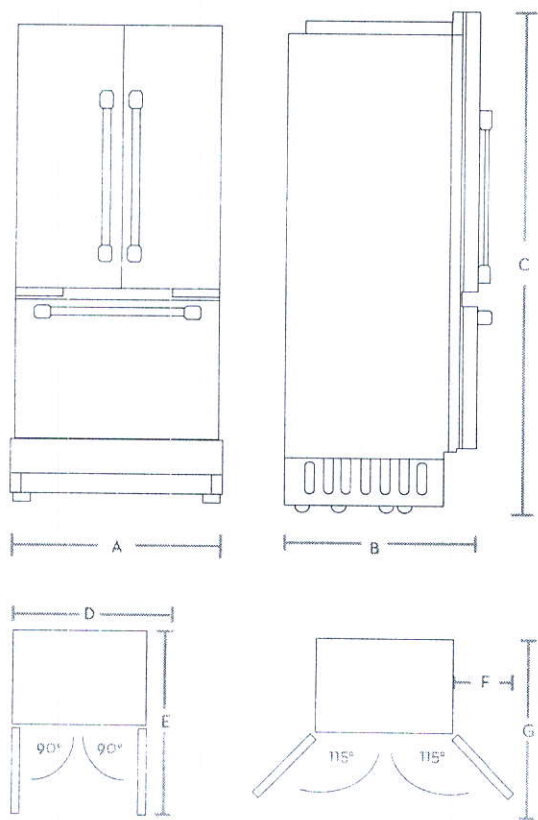

| INSTALLATION CUTOUT DIMENSIONS | |
|--------------------------------|--------------|
| A (WIDTH) | 36" (914MM) |
| B (DEPTH) | 25" (635MM) |
| C (HEIGHT) | 84" (2134MM) |
| D | 26" (660MM) |
| E | 80" (2032MM) |

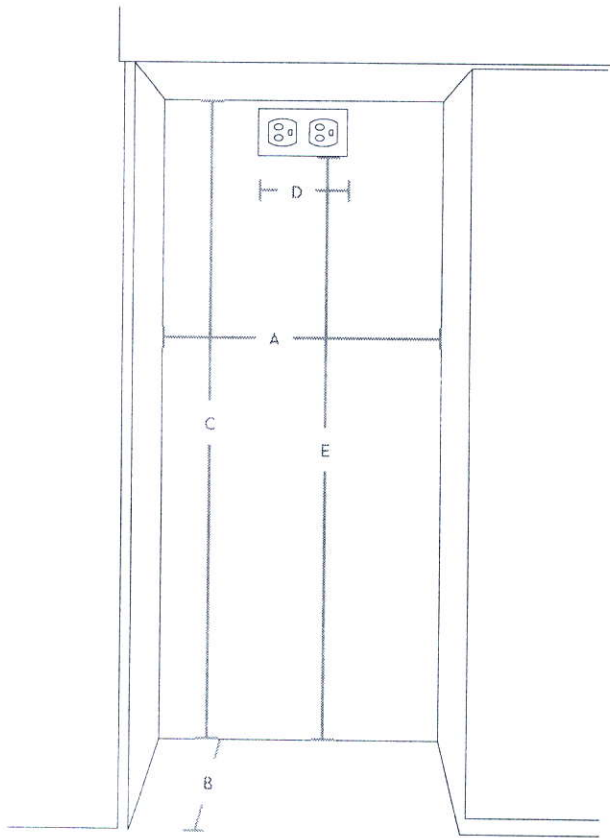

| ACCESSORIES | |
|--|-------------|
| SILVER STAINLESS STEEL - 36" FDR UPPER PANEL - LEFT | RAF36DPULSR |
| SILVER STAINLESS STEEL - 36" FDR UPPER PANEL - RIGHT | RAF36DPURSR |
| SILVER STAINLESS STEEL - 36" FDR BOTTOM PANEL | RAF36DPBDSR |
| SILVER STAINLESS STEEL - 36" KICK PLATE | RAC36TKBBSR |
| SILVER STAINLESS STEEL - MODERNIST HANDLE | RAC00MHAASR |
| SILVER STAINLESS STEEL - DACOR PRO HANDLE | RAC00PHAASR |
| WATER FILTER | RAC00WFAAAA |
| DEODORIZING FILTER | RAC00DFAAAA |

| WARRANTY | |
|---|-------------------|
| LIMITED ENTIRE APPLIANCE, PARTS AND LABOR ON ANY PART OF THE REFRIGERATOR | 2 YEAR |
| LIMITED WARRANTY FOR SEALED REFRIGERATION SYSTEM, PARTS AND LABOR | 3RD TO 6TH YEAR |
| LIMITED WARRANTY FOR SEALED REFRIGERATION SYSTEM, PARTS ONLY | 7TH TO 12TH YEAR |
| LIMITED WARRANTY FOR COMPRESSOR, PARTS ONLY | 13TH TO 15TH YEAR |

AUG 8 19 FB
SEPT 23 19 FB

LAMBERT LANE 6
PROTOTYPE FOR EXTRAS

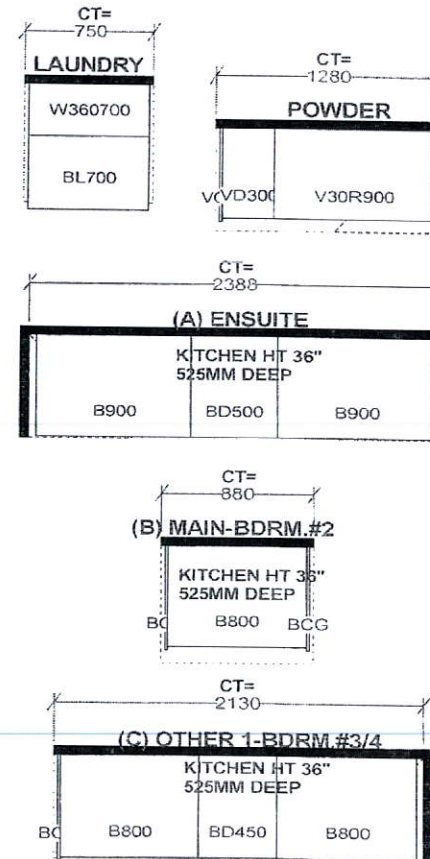

W W DTH _____ W H GHT _____ W C N T _____
F L O O R H G H T _____ D O O R H G H T _____
S T C E N T 2X4 V E N T B O X C O V E R

This drawing is the intellectual property of SELBA INDUSTRIES INC. and is an original design which must not be released or copied unless applicable fee has been paid or job order placed.



DESIGNER: KS
DATE: MAR 12 19

JOB NUMBER:
BUILDER: GREENPARK
SITE: LAMBERTS LANE PH.2
MODEL: BARTON 8X EL 1,2
LOT #: 6



This drawing is the intellectual property of SELBA INDUSTRIES INC. and is an artistic interpretation of the general appearance of the design. It is not meant to be an exact rendition.



Designed: 8/8/2019
Printed: 9/23/2019

LAMBERT LANE 6.kit

LAMBERT LANE 6.kit Drawing #: 1

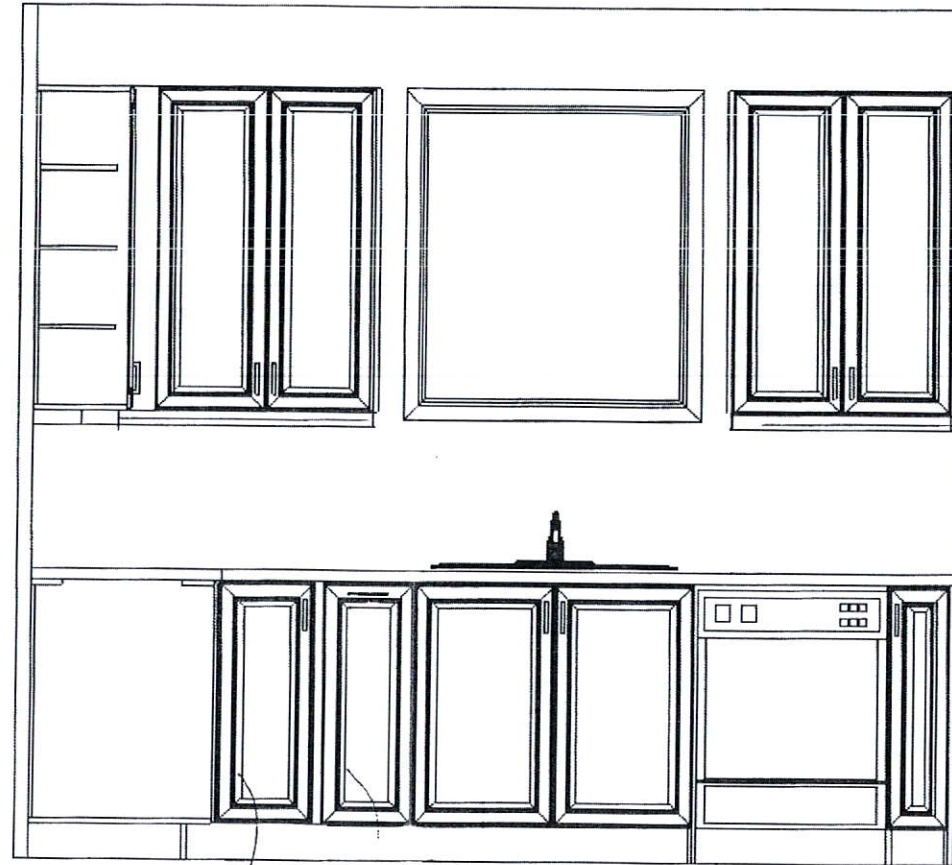

PICK UP
BASE

1 BIN
WASTE
PULL OUT

This drawing is the intellectual property of SELBA INDUSTRIES INC. and is an artistic interpretation of the general appearance of the design. It is not meant to be an exact rendition.

Selba
Kitchen + Bath Designs

Designed: 8/8/2019
Printed: 9/23/2019

LAMBERT LANE 6.kit

LAMBERT LANE 6.kit Drawing #: 1

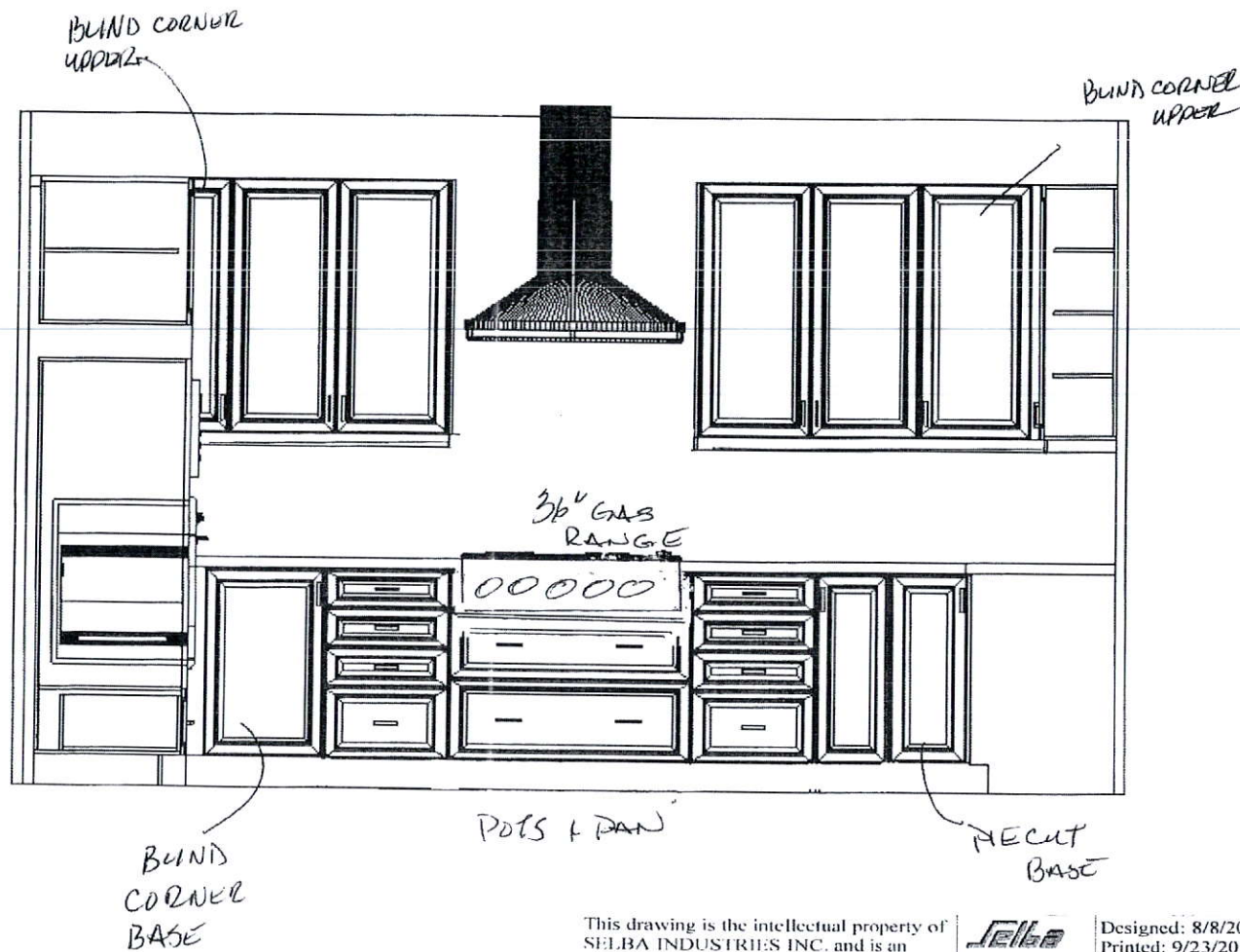

This drawing is the intellectual property of SELBA INDUSTRIES INC. and is an artistic interpretation of the general appearance of the design. It is not meant to be an exact rendition.



Designed: 8/8/2019
Printed: 9/23/2019

LAMBERT LANE 6.kit

LAMBERT LANE 6.kit Drawing #: 1

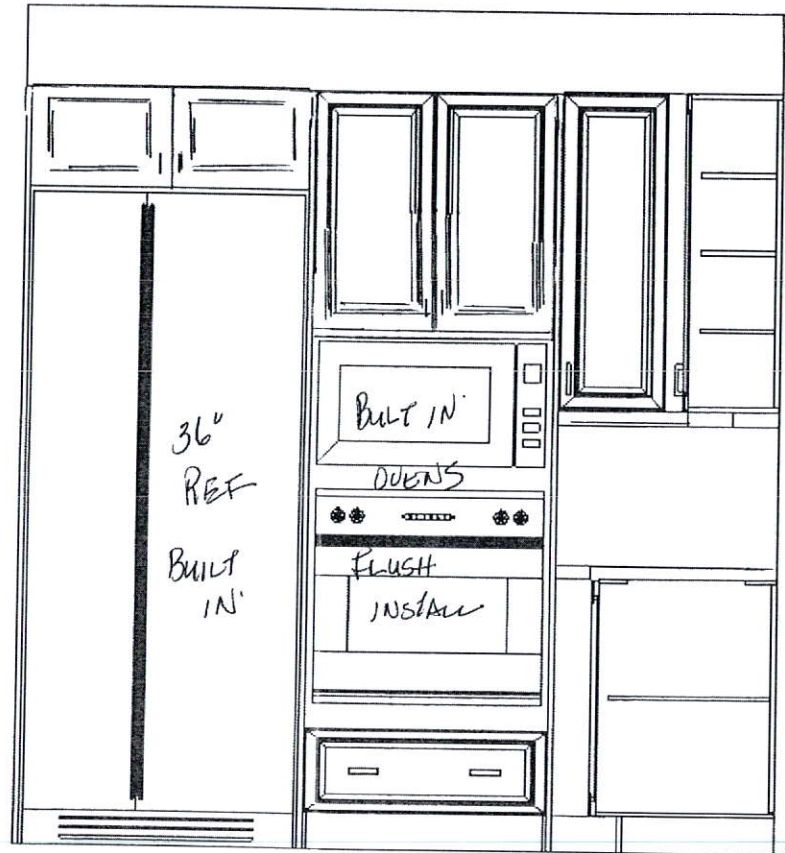

This drawing is the intellectual property of SELBA INDUSTRIES INC. and is an artistic interpretation of the general appearance of the design. It is not meant to be an exact rendition.



Designed: 8/8/2019
Printed: 9/23/2019

LAMBERT LANE 6.kit

LAMBERT LANE 6.kit Drawing #: 1

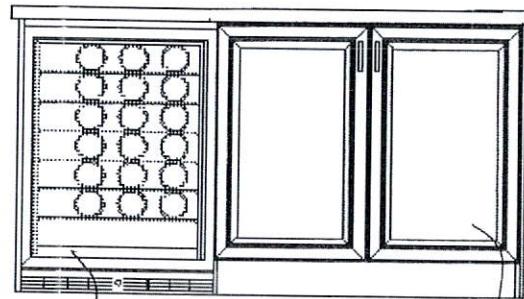
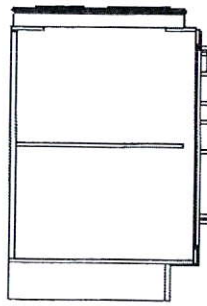
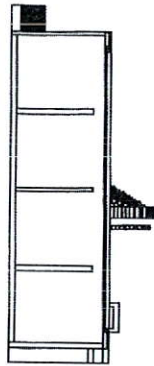

WINE 24"
RET

24" DEEP

ISLAND-FACING FRIDGE

This drawing is the intellectual property of SELBA INDUSTRIES INC. and is an artistic interpretation of the general appearance of the design. It is not meant to be an exact rendition.



Designed: 8/8/2019
Printed: 9/23/2019

LAMBERT LANE 6.kit

LAMBERT LANE 6.kit | Drawing #: 1

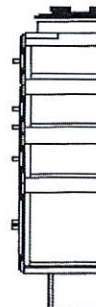
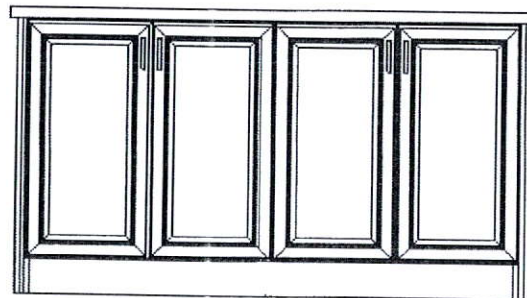

12" DEEP BASES

This drawing is the intellectual property of SELBA INDUSTRIES INC. and is an artistic interpretation of the general appearance of the design. It is not meant to be an exact rendition.



Designed: 8/8/2019
Printed: 9/23/2019

ISLAND- FACING SINK
LAMBERT LANE 6.kit

LAMBERT LANE 6.kit Drawing #: 1

Gas Line R.I for BBQ.

Add Plug Above Fireplace.

Frameless Shower
Glass wall above vanity.

Delete Half Wall
Enlarge Opening

Add Plug 5' from floor.

Revised-
See Kitchen
Layout.

Add Light
Above
Island.

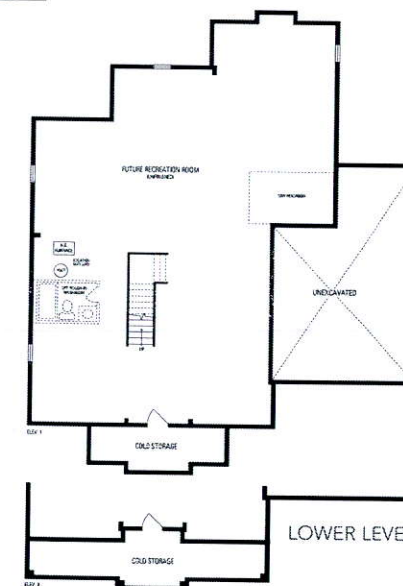
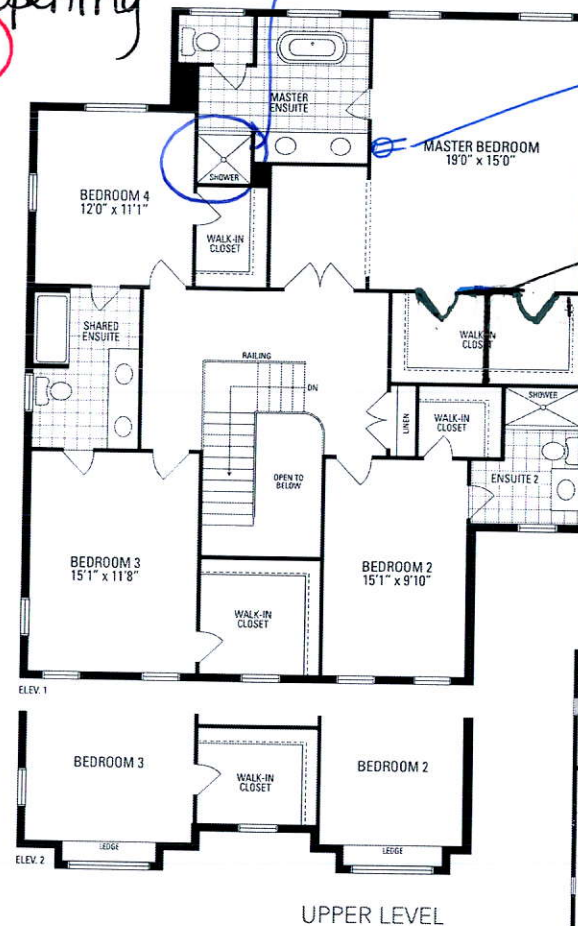
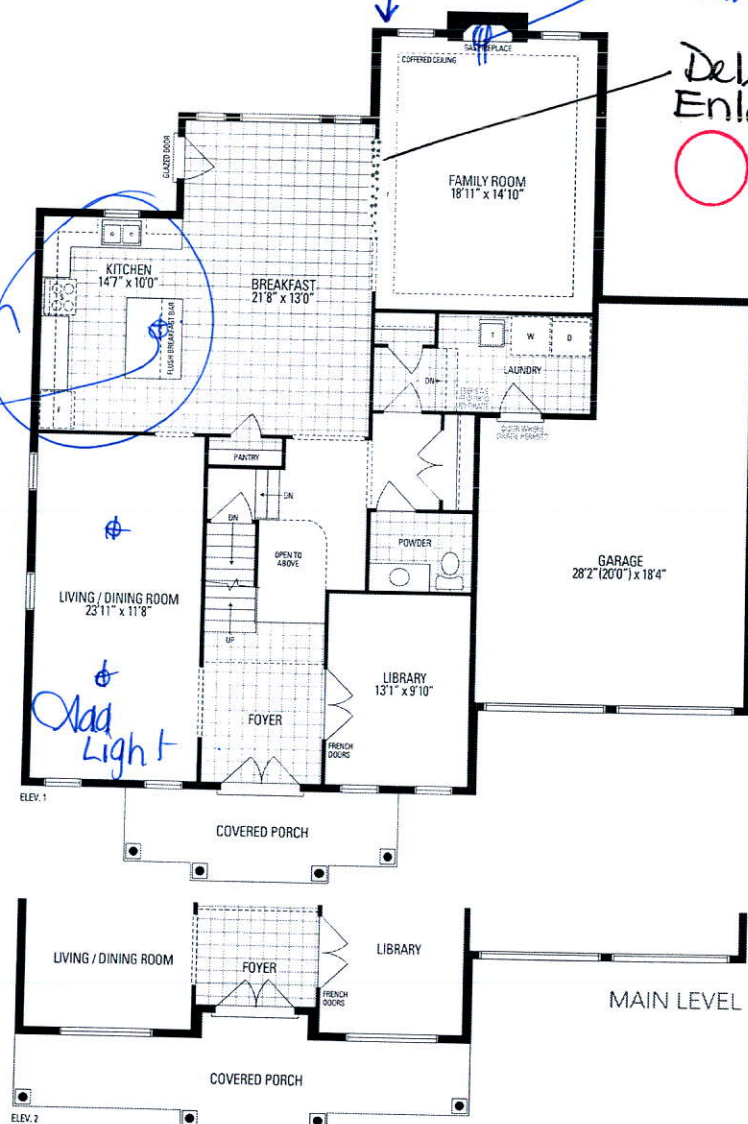

Boston
EIGHT

INCLUDES 50 SQ.FT. OF OPEN AREA

Orientation of home may be reversed and purchaser agrees to accept the same. Steps and porches may vary at any exterior entrance ways due to grading variance. Actual usable floor space may vary from the stated floor areas. All renderings are artists concept. Dimensions, specifications and architectural detailing subject to modifications. Roofline and adjoining model types may vary due to siting. Appliances, furniture and furnishings not included. E. & O. E. March 2019

RECEIVED

JUL 10 2019