

CONSTRUCTION SUMMARY

DATE: JUL 30 2019

Mountainview Heights (G) - Russell Gardens Building Ltd.

PURCHASERS: SYED TAUSEEF AHMED BANOORI and SHUMAILA KHAN

TEL:

LOT / PHASE Block 205 TH 1 / 2	REG. PLAN # 62M-1238	HOUSE TYPE Highgrove 5ES Elev 3		
-----------------------------------	-------------------------	------------------------------------	--	--

CABINETRY

1 - KITCHEN ISLAND- DECREASE BASES TO ALLOW FOR FLUSH BREAKFAST BAR 09Jul19 Note:	
--	--

CABINETRY ACCESSORIES

1 - KITCHEN CABINETRY BASE - RECYCLE PULLOUT 2 BIN - PRICE IS EACH 09Jul19 Note:	
1 - KITCHEN CABINETRY BASE - PIE CUT CORNER CABINET - BASE CABINETRY - STANDARD 09Jul19 Note:	
3 - PANTRY UNIT UPGRADE - TO GO FROM 300MM TO 600MM DEEP - PRICE IS PER FOOT - STANDARD 09Jul19 Note:	
1 - KITCHEN CABINETRY UPPER - FULL DEPTH ABOVE FRIDGE - WITH GABLES - 600MM - PRICE IS EACH - STANDARD 09Jul19 Note:	

CERAMIC TILE

1 - DELETE ALL CERAMIC BATHROOM ACCESSORIES - DELETE TOWEL BAR, PAPER HOLDER & SOAP DISH THROUGHOUT 30Jul19 Note:	
--	--

NEW RECEIVED  
JUL 30 2019

CONSTRUCTION

1 - SMOOTH CEILINGS ON FIRST FLOOR ONLY 09Jul19 Note:	
--	--

ELECTRICAL

1 - PLUG - ELECTRICAL PLUG WITH GFI- ADD EXTERIOR PLUG AT BACK OF HOUSE NEXT TO WALK OUT DOORS - STANDARD PLUG TO REMAIN AT WALKOUT FROM KITCHEN 09Jul19 Note:	
1 - PLUG - ELECTRICAL PLUG - TO BE INSTALLED OVER STOVE FOR FUTURE MICROWAVE/HOOD FAN 09Jul19 Note:	
1 - PLUG - ELECTRICAL PLUG- FAMILY ROOM - ADD PLUG 5FT FROM FLOOR FOR FUTURE TV 09Jul19 Note:	
1 - LIGHT AND SWITCH - NO FIXTURE INCLUDED - LIVING ROOM 09Jul19 Note:	
1 - 200 AMP ELECTRICAL SERVICE 09Jul19 Note:	

FIREPLACE AND ACCESSORIES

1 - GAS LINE ROUGH-IN FOR DRYER (INCLUDES ELECTRICAL PLUG) - SECOND FLOOR 09Jul19 Note:	
1 - GAS LINE ROUGH-IN FOR STOVE (INCLUDES ELECTRICAL OUTLET) - FIRST FLOOR 09Jul19 Note:	

PLUMBING

1 - WASHROOM - 3 PIECE ROUGH-IN IN BASEMENT 12Jun19 Note:	
--	--

PROMOTIONAL

1 - LESS BALANCE OF CREDIT FROM PURCHASER EXTRA SHEET IN OFFER 09Jul19 Note:	
---	--



CONSTRUCTION SUMMARY

Mountainview Heights (G) - Russell Gardens Building Ltd.

PURCHASERS: SYED TAUSEEF AHMED BANOORI and SHUMAILA KHAN

TEL:

LOT / PHASE Block 205 TH 1 / 2	REG. PLAN # 62M-1238	HOUSE TYPE Highgrove 5ES Elev 3		
-----------------------------------	-------------------------	------------------------------------	--	--

I - PARTIAL REDEMPTION OF PROMOTIONAL PACKAGE \$640 BALANCE FORWARD \$11,860 TO BE USED AT A LATER DATE. ORIGINAL PROMOTIONAL PACKAGE OF \$12,500 AS PER SCHEDULE PE 12Jun19    Note:	
---	--

STAIRS AND RAILINGS

I - EUROLINE I BLACK IRON PICKETS 09Jul19    Note:	
I - STAINED STAIRS, RAILING – STANDARD STAIRCASE - PRICE IS PER SET 09Jul19    Note:	

This Document is Extremely Time Sensitive - Printed 30 Jul 19 at 10:04

Purchasers:

SYED TAUSEEF AHMED BANOORI & SHUMAIL

Property:

Block 205 TH 1

Telephone Res. / Bus:

/

Project:

Russell Gardens Building Ltd.

Decor Advisor:

Natalie Mancuso

Model and Elevation:

Highgrove 5ES Elev 3

Lock Date:

9-Jul-19

9-Jul-19

Plan #:

62M-1238

Layout Changes: ☐ Yes ☒ No

Sketch Attached: ☒ Yes ☐ No

Exterior Colour Scheme:

1. Cabinetry

	Style and Colour	Hardware
Kitchen / Breakfast	CONTINENTAL 823 DRIFTWOOD	447SA
Laundry Room	ELISSE	Standard
Powder Room	HASTING CHOCOLATE	113SB
Master Ensuite Bathroom	HASTING CHOCOLATE	113SB
Main Bathroom	EVEREST WHITE	190SA

Appliances:

Built In Appliances ☐ Yes ☒ No

Slide In Stove ☐ Yes ☒ No

Dishwasher Cabinet

☐ Closed ☒ Open

41" Upper Cabinets ☒ Yes ☐ No

Please NOTE: Standard Cabinet Height is 30"

Stove Opening

NOTE: If not specified, opening will be set to builder's standard opening of approximately 30" width

Fridge Opening

NOTE: If not specified, opening will be set to builder's standard opening of approximately 37" width x 74" height

\*\* Refer to Construction Summary

2. Counters

	Counter	Edge
Kitchen / Breakfast	LAMINATE-PALOMA POLAR 6698-46	
Laundry Room	N/A	
Powder Room	LAMINATE-PALOMA POLAR 6698-46	
Master Ensuite Bathroom	LAMINATE-PALOMA POLAR 6698-46	
Main Bathroom	LAMINATE-PALOMA POLAR 6698-46	

\*\* Refer to Construction Summary

Purchasers:SYED TAUSEEF AHMED BANOORI & SHUMAIL

Property:Block 205 TH 1

Telephone Res. / Bus: /

Project:Russell Gardens Building Ltd.

Decor Advisor:Natalie Mancuso

Model and Elevation:Highgrove 5ES Elev 3

Lock Date:9-Jul-19

9-Jul-19

Plan #:62M-1238

3. Ceramic Flooring

At a 45 Threshold-If App.

Entrance Vestibule	TILE- ESSENZE GRIGIO 13X13	<input type="checkbox"/>	Metal Strip Where Applic.
Main Hall	LAMINATE	<input type="checkbox"/>	
Kitchen / Breakfast	TILE- ESSENZE GRIGIO 13X13	<input type="checkbox"/>	
Laundry Room	TILE- SN PASTELLO BIANCO 13X13	<input type="checkbox"/>	
Powder Room	TILE- ESSENZE GRIGIO 13X13	<input type="checkbox"/>	
Master Ensuite Bathroom	TILE- CEMENTI WHITE 12X12	<input type="checkbox"/>	
Main Bathroom	TILE- ESSENZE NERO 13X13	<input type="checkbox"/>	
GARAGE ENTRANCE	TILE- ESSENZE GRIGIO 13X13	<input type="checkbox"/>	
		<input type="checkbox"/>	
		<input type="checkbox"/>	
		<input type="checkbox"/>	

\*\* Refer to Construction Summary

4. Ceramic Wall Tile

Master Ensuite Bathroom	Selection	Describe
Tub Deck Wall	TILE- NATURALE GRIGIO 8X10	
Tub Deck		
Tub Deck Skirt		
Shower Stall	TILE- NATURALE GRIGIO 8X10	
Bathtub Enclosure Walls		
Main Bathroom	TILE- NATURALE NERO 8X10	
GARAGE ENTRANCE		
Kitchen Backsplash		

\*\* Refer to Construction Summary - STANDARD GROUT THROUGHOUT UNLESS SPECIFIED

5. Plumbing Fixtures

All Bathrooms

White

Whirlpool

☐ Yes ☒ No

Dishwasher Rough-In

☒ Yes ☐ No

Waterline for Fridge

☐ Yes ☒ No

\*\* Refer to Construction Summary

6. Trim Carpentry

Interior Doors	800 SERIES
Interior Trim	2 3/4" CASING WITH 4 1/4" BASEBOARD - COLONIAL
Door Handles	As Per Construction Specifications
Exterior Front Door Handle	As Per Construction Specifications

\*\* Refer to Construction Summary

Purchasers:SYED TAUSEEF AHMED BANOORI & SHUMAIL

Property:Block 205 TH 1

Telephone Res. / Bus: /

Project:Russell Gardens Building Ltd.

Decor Advisor:Natalie Mancuso

Model and Elevation:Highgrove 5ES Elev 3

Lock Date:9-Jul-19

9-Jul-19

Plan #:62M-1238

7. Other Flooring

Main Hall	LAMINATE-MANHATTAN - EARL GREY OAK TL-15012
Living Room	LAMINATE-MANHATTAN - EARL GREY OAK TL-15012
Dining Room	LAMINATE-MANHATTAN - EARL GREY OAK TL-15012
Family Room	LAMINATE-MANHATTAN - EARL GREY OAK TL-15012
Den / Library / Study	
Basement Landing(If Applies)	
Lower Landing (If Applies)	LAMINATE-MANHATTAN - EARL GREY OAK TL-15012
Upper Landing	LAMINATE-MANHATTAN - EARL GREY OAK TL-15012
Upper Hall	CARPET-BEAULIEU - A4447 WEBSTER SDN - MORNING CLOUD 13931
Master Bedroom	CARPET-BEAULIEU - A4447 WEBSTER SDN - MORNING CLOUD 13931
Bedroom #2	CARPET-BEAULIEU - A4447 WEBSTER SDN - MORNING CLOUD 13931
Bedroom #3	CARPET-BEAULIEU - A4447 WEBSTER SDN - MORNING CLOUD 13931
Bedroom #4	CARPET-BEAULIEU - A4447 WEBSTER SDN - MORNING CLOUD 13931
Bedroom #5	
Underpad	TypeArea
	STANDARD UNDERPADSECOND FLOOR

\*\* Refer to Construction Summary

8. Railings and Pickets

Railing Type	AS PER CONSTRUCTION SPECIFICATIONS	Colour	TORLYS- EARL GREY OAK
Picket Type	EUROLINE 1	Colour	BLACK
Stringer / Riser	AS PER CONSTRUCTION SPECIFICATIO	Colour	TORLYS- EARL GREY OAK
Treads	AS PER CONSTRUCTION SPECIFICATIO	Colour	TORLYS- EARL GREY OAK
Red Oak Stairs with Semi Gloss Finish		<input checked="" type="radio"/> Yes <input type="radio"/> No	

\*\* Refer to Construction Summary

9. Wall Paint Flat Finish

Main & Upper Hall	22 WARM GREY	Master Bedroom	22 WARM GREY
Living Room	22 WARM GREY	Bedroom #2	22 WARM GREY
Dining Room	22 WARM GREY	Bedroom #3	22 WARM GREY
Kitchen / Breakfast	22 WARM GREY	Bedroom #4	22 WARM GREY
Family Room	22 WARM GREY	Bedroom #5	
Powder Room	22 WARM GREY	Master Ensuite	22 WARM GREY
Laundry Room	22 WARM GREY	Main Bathroom	22 WARM GREY
Den/Library			
Trim Paint-Semi Gloss	BIRCH WHITE		

Smooth Ceilings First Floor ☒ Yes ☐ No

\*\* Refer to Construction Summary

Purchasers:

SYED TAUSEEF AHMED BANOORI & SHUMAIL

Property:

Block 205 TH 1

Telephone Res. / Bus:

/

Project:

Russell Gardens Building Ltd.

Decor Advisor:

Natalie Mancuso

Model and Elevation:

Highgrove 5ES Elev 3

Lock Date:

9-Jul-19

9-Jul-19

Plan #:

62M-1238

10. Plaster Mouldings and Medallions

Entrance Vestibule			Kitchen/Breakfast		
Main Hall			Den/Library		
Living Room			Lower Landing		
Dining Room					
Family Room					

\*\* Refer to Construction Summary

11. Fireplace

	Living Room			Family Room			Other Room - Specify		
	Purchased	As Per Plan	N/A	Purchased	As Per Plan	N/A	Purchased	As Per Plan	N/A
Fireplace Type	<input type="radio"/>	<input type="radio"/>	<input checked="" type="radio"/>	<input type="radio"/>	<input type="radio"/>	<input checked="" type="radio"/>	<input type="radio"/>	<input type="radio"/>	<input checked="" type="radio"/>
Mantle Type									
Colour / Stain									
Surround									
Hearth									

\*\* Refer to Construction Summary

12. Heating and Air Conditioning

Air Conditioning	NO	Gas Provisions Stove	YES
Gas Provisions Dryer	YES	Gas Provisions Barbecue	NO
Comment			

\*\* Refer to Construction Summary

13. Electrical

Plugs and Switches	<input checked="" type="radio"/> White	DECOR	Above Kitchen Cabinet Light	<input type="radio"/> Yes	<input checked="" type="radio"/> No
Hood Fan	STANDARD WHITE		Below Kitchen Cabinet Light	<input type="radio"/> Yes	<input checked="" type="radio"/> No
Appliances	Built in Cooktop	Built in Oven	Gas Stove	Microwave	
	<input type="radio"/> Yes <input checked="" type="radio"/> No	<input type="radio"/> Yes <input checked="" type="radio"/> No	<input checked="" type="radio"/> Yes <input type="radio"/> No	<input checked="" type="radio"/> Yes <input type="radio"/> No	
Dishwasher Rough-in	Yes				

\*\* Refer to Construction Summary

14. General Comments

\*\* Refer to Construction Summary

Disclaimers and Notes

- 1) Colours of all materials are as close as possible to builder's selection, but not necessarily identical due to variances in manufacturing.
- 2) Any extras listed above are null and void unless accompanied by a separate invoice/amendment. Said invoice must be paid in full.
- 3) The Purchaser agrees that this colour selection is final and that no changes will be permitted, unless required by the Vendor.
- 4) The Purchaser acknowledges reading and accepting document which contains other miscellaneous disclaimers.

Signature: \_\_\_\_\_ Date: \_\_\_\_\_

Signature:  Date: July 9/2019

Page 4 of 4

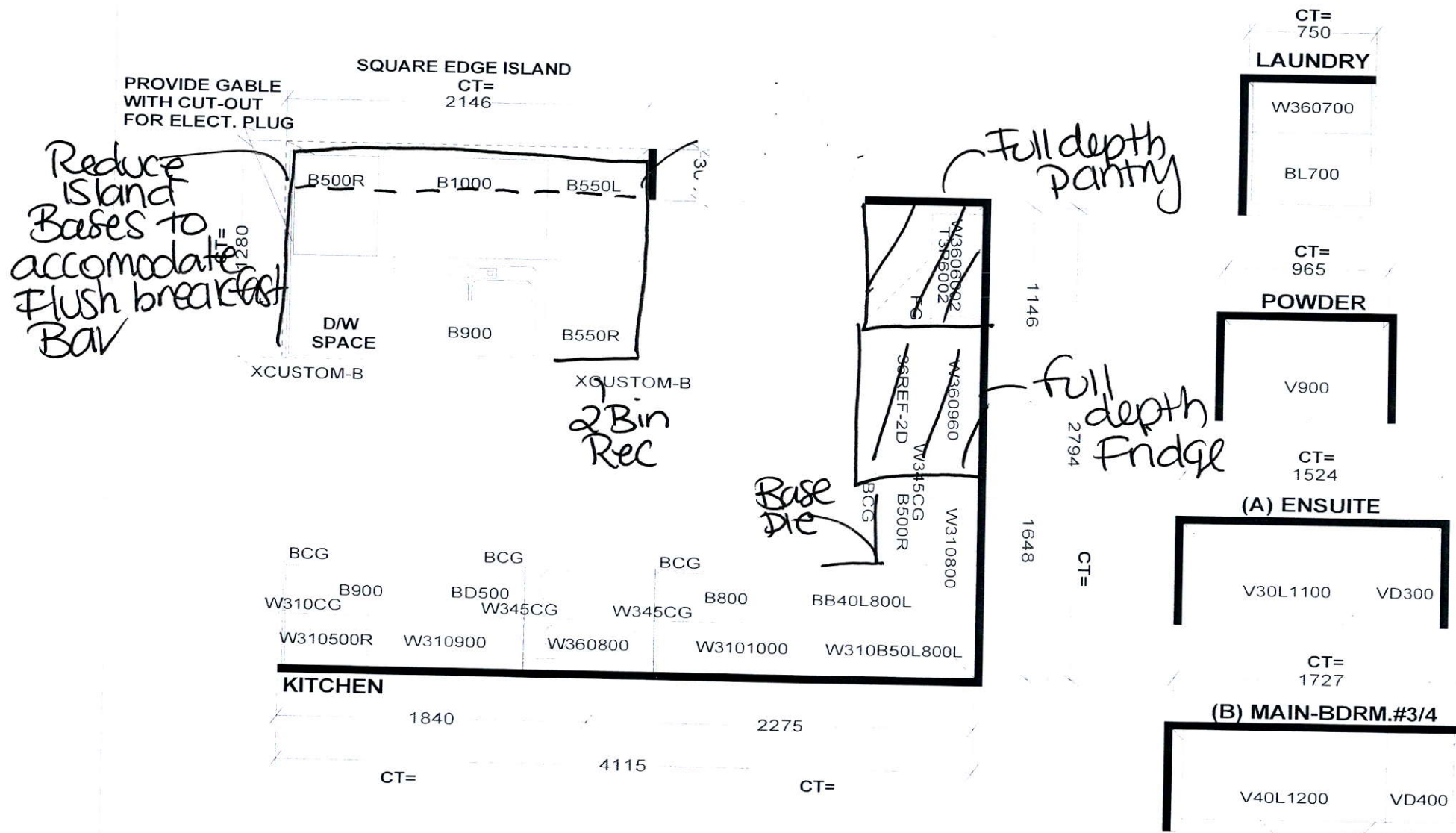

Selba Industries

W WIDTH W HGHT W CNT FL HGHT DWY H ST CENT 2X4 VENT BOX COVER

STANDARD FEATURES:

1040MM HIGH UPPERS (9' Ceiling-No D/C Box)  
DUMMY DOORS  
D/W SPACE  
LAMINATE KITCHEN & VANITY COUNTERTOPS

This drawing is the intellectual property of SELBA INDUSTRIES INC. and is an original design which must not be released or copied unless applicable fee has been paid or job order placed.



JOB NUMBER:  
BUILDER: GREENPARK  
SITE NAME: RUSSEL GARDENS  
MODEL: HIGHGROVE 5ESX ELEV 1,3  
LOT #:  
DESIGNER: KS  
DATE: SEPT 13 17

**HIGHGROVE 5ES** 2,264 SQ.FT.  
AVAILABLE IN BLOCK: 200 & 205

