



CONSTRUCTION SUMMARY

Saddle Ridge (G) - Lecco Ridge Developments Inc.

PURCHASER: INVENTORY HOME_B338_TH4

TEL:

LOT / PHASE Block 338 TH 4 / 1	REG. PLAN # 20M-1184	HOUSE TYPE Ivy 1 Elev 3		
-----------------------------------	-------------------------	----------------------------	--	--

CABINETRY ACCESSORIES

2 - PANTRY UNIT UPGRADE - TO GO FROM 300MM TO 600MM DEEP - PRICE IS PER FOOT - STANDARD 07Jun19 Note:	
1 - KITCHEN CABINETRY UPPER - FULL DEPTH ABOVE FRIDGE - WITH GABLES - 600MM - PRICE IS EACH - STANDARD 07Jun19 Note:	

CERAMIC TILE

1 - TILE - UPGRADE 1 FLOOR TILE - - POWDER ROOM 07Jun19 Note:	
1 - TILE - UPGRADE 1 FLOOR TILE - - KITCHEN 07Jun19 Note:	
1 - TILE - UPGRADE 1 FLOOR TILE - - FOYER 07Jun19 Note:	

HARDWOOD FLOORING

1 - LAMINATE -UPGRADE 1 SERIES IN LIEU OF STANDARD LAMINATE 07Jun19 Note:	
1 - LAMINATE - LEXINGTON SERIES - - SECOND FLOOR COMPLETE 07Jun19 Note:	

STAIRS AND RAILINGS

1 - STAINED STAIRS, RAILING AND PICKETS – STANDARD STAIRCASE - PRICE IS PER SET 07Jun19 Note:	
--	--

This Document is Extremely Time Sensitive - Printed 7 Jun 19 at 14:18

RECEIVED JUN 10 2019

Layout Changes: ☐ Yes ☒ No

Sketch Attached: ☒ Yes ☐ No

Exterior Colour Scheme:

1. Cabinetry

	Style and Colour	Hardware
Kitchen / Breakfast	CONTINENTAL 823 DRIFTWOOD	431SA
Laundry Room	N/A	N/A
Powder Room	CONTINENTAL 823 DRIFTWOOD	113SB
Master Ensuite Bathroom	EVEREST WHITE	113SB
Main Bathroom	EVEREST WHITE	113SB

Appliances:

Built In Appliances ☐ Yes ☒ No

Slide In Stove ☐ Yes ☒ No

Dishwasher Cabinet ☐ Closed ☒ Open

41" Upper Cabinets ☒ Yes ☐ No

Please NOTE: Standard Cabinet Height is 30"

Stove Opening

NOTE: If not specified, opening will be set to builder's standard opening of approximately 30" width

Fridge Opening

NOTE: If not specified, opening will be set to builder's standard opening of approximately 37" width x 74" height

** Refer to Construction Summary

2. Counters

	Counter	Edge
Kitchen / Breakfast	LAMINATE-WHITE CARRARA 4924-38	
Laundry Room	N/A	
Powder Room	LAMINATE-CALCUTTA MARBLE 4925K-07	
Master Ensuite Bathroom	LAMINATE-INUK SHUK GREY P-344 LM	
Main Bathroom	LAMINATE-CARRARA BIANCO 6696-46	

** Refer to Construction Summary

3. Ceramic Flooring

Entrance Vestibule	TILE- FM45GL001S GLOSSY WHITE 18X18		At a 45 Threshold-If App.
Main Hall	LAMINATE		Metal Strip Where Applic.
Kitchen / Breakfast	TILE- FM45GL001S GLOSSY WHITE 18X18		
Laundry Room	N/A		
Powder Room	TILE- FM45GL001S GLOSSY WHITE 18X18		
Master Ensuite Bathroom	TILE- ESSENZE GRIGIO 13X13		
Main Bathroom	TILE- ESSENZE GRIGIO 13X13		

** Refer to Construction Summary

4. Ceramic Wall Tile

Master Ensuite Bathroom	Selection	Describe
Tub Deck Wall	TILE- NATURALE GRIGIO 8X10	
Tub Deck		
Tub Deck Skirt		
Shower Stall	TILE- NATURALE GRIGIO 8X10	
Bathtub Enclosure Walls		
Main Bathroom	TILE- NATURALE GRIGIO 8X10	
Kitchen Backsplash		

** Refer to Construction Summary - STANDARD GROUT THROUGHOUT UNLESS SPECIFIED

5. Plumbing Fixtures

All Bathrooms

White

Whirlpool

☐ Yes ☒ No

Dishwasher Rough-In

☒ Yes ☐ No

Waterline for Fridge

☐ Yes ☒ No

** Refer to Construction Summary

6. Trim Carpentry

Interior Doors	800 SERIES
Interior Trim	2 3/4" CASING WITH 4 1/4" BASEBOARD - COLONIAL
Door Handles	As Per Construction Specifications
Exterior Front Door Handle	As Per Construction Specifications

** Refer to Construction Summary

Purchaser: INVENTORY HOME_B338_TH4

Property: Block 338 TH 4

Telephone Res. / Bus: /

Project: Lecco Ridge Developments Inc.

Decor Advisor: Natalie Mancuso

Model and Elevation: Ivy 1 Elev 3

Lock Date: 7-Jun-19

7-Jun-19

Plan #: 20M-1184

7. Other Flooring

Main Hall	LAMINATE- TORLYS- FJORD- NORD OAK- TL-NEUM05
Living Room	LAMINATE- TORLYS- FJORD- NORD OAK- TL-NEUM05
Dining Room	LAMINATE- TORLYS- FJORD- NORD OAK- TL-NEUM05
Family Room	N/A
Den / Library / Study	N/A
Basement Landing(If Applies)	
Lower Landing (If Applies)	N/A
Upper Landing	LAMINATE- TORLYS- FJORD- NORD OAK- TL-NEUM05
Upper Hall	LAMINATE- TORLYS- FJORD- NORD OAK- TL-NEUM05
Master Bedroom	LAMINATE- TORLYS- FJORD- NORD OAK- TL-NEUM05
Bedroom #2	LAMINATE- TORLYS- FJORD- NORD OAK- TL-NEUM05
Bedroom #3	LAMINATE- TORLYS- FJORD- NORD OAK- TL-NEUM05
Bedroom #4	
Bedroom #5	
Underpad	TypeArea

** Refer to Construction Summary

8. Railings and Pickets

Railing Type	AS PER CONSTRUCTION SPECIFICATIONS	Colour	TORLYS- NORD OAK
Picket Type	1 5/16 PICKETS SQUARE CHAMFERED	Colour	TORLYS- NORD OAK
Stringer / Riser	AS PER CONSTRUCTION SPECIFICATIO	Colour	TORLYS- NORD OAK
Treads	Standard	Colour	TORLYS- NORD OAK
Red Oak Stairs with Semi Gloss Finish		<input checked="" type="radio"/> Yes <input type="radio"/> No	

** Refer to Construction Summary

9. Wall Paint Flat Finish

Main & Upper Hall	22 WARM GREY	Master Bedroom	22 WARM GREY
Living Room	22 WARM GREY	Bedroom #2	22 WARM GREY
Dining Room	22 WARM GREY	Bedroom #3	22 WARM GREY
Kitchen / Breakfast	22 WARM GREY	Bedroom #4	
Family Room		Bedroom #5	
Powder Room	22 WARM GREY	Master Ensuite	22 WARM GREY
Laundry Room		Main Bathroom	22 WARM GREY
Den/Library			
Trim Paint-Semi Gloss	BIRCH WHITE		

Smooth Ceilings First Floor ☐ Yes ☒ No

** Refer to Construction Summary

Purchaser:INVENTORY HOME_B338_TH4

Property:Block 338 TH 4

Telephone Res. / Bus: /

Project:Lecco Ridge Developments Inc.

Decor Advisor:Natalie Mancuso

Model and Elevation:Ivy 1 Elev 3

Lock Date:7-Jun-19

7-Jun-19

Plan #:20M-1184

10. Plaster Mouldings and Medallions

Entrance Vestibule			Kitchen/Breakfast		
Main Hall			Den/Library		
Living Room			Lower Landing		
Dining Room					
Family Room					

** Refer to Construction Summary

11. Fireplace

	Living Room			Family Room			Other Room - Specify		
	Purchased	As Per Plan	N/A	Purchased	As Per Plan	N/A	Purchased	As Per Plan	N/A
Fireplace Type	<input type="radio"/>	<input type="radio"/>	<input checked="" type="radio"/>	<input type="radio"/>	<input type="radio"/>	<input checked="" type="radio"/>	<input type="radio"/>	<input type="radio"/>	<input checked="" type="radio"/>
Mantle Type									
Colour / Stain									
Surround									
Hearth									

** Refer to Construction Summary

12. Heating and Air Conditioning

Air Conditioning	NO	Gas Provisions Stove	NO
Gas Provisions Dryer	NO	Gas Provisions Barbecue	NO
Comment			

** Refer to Construction Summary

13. Electrical

Plugs and Switches	<input checked="" type="radio"/> White	DECOR	Above Kitchen Cabinet Light	<input type="radio"/> Yes	<input checked="" type="radio"/> No
Hood Fan	STANDARD WHITE		Below Kitchen Cabinet Light	<input type="radio"/> Yes	<input checked="" type="radio"/> No
Appliances	Built in Cooktop	Built in Oven	Gas Stove	Microwave	
	<input type="radio"/> Yes <input checked="" type="radio"/> No	<input type="radio"/> Yes <input checked="" type="radio"/> No	<input type="radio"/> Yes <input checked="" type="radio"/> No	<input type="radio"/> Yes	<input checked="" type="radio"/> No
Dishwasher Rough-in	Yes				

** Refer to Construction Summary

14. General Comments

** Refer to Construction Summary

Disclaimers and Notes

- 1) Colours of all materials are as close as possible to builder's selection, but not necessarily identical due to variances in manufacturing.
- 2) Any extras listed above are null and void unless accompanied by a separate invoice/amendment. Said invoice must be paid in full.
- 3) The Purchaser agrees that this colour selection is final and that no changes will be permitted, unless required by the Vendor.
- 4) The Purchaser acknowledges reading and accepting document which contains other miscellaneous disclaimers.

Signature: Date:

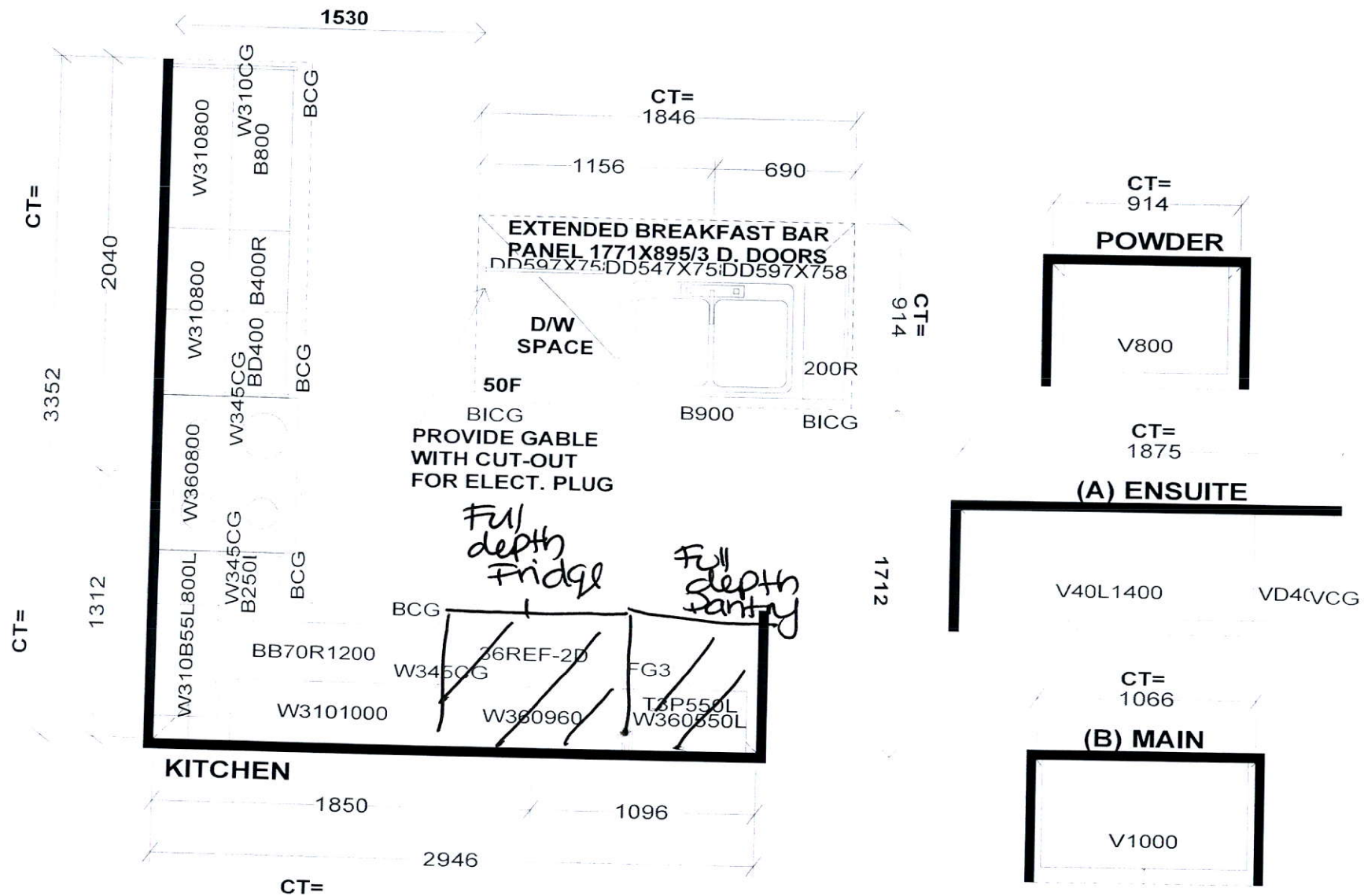

Selba Industries

STANDARD FEATURES:

9' CEILINGS WITH D/C BOX
 1040MM HIGH UPPER CABINETS
 DISHWASHER SPACE
 DUMMY DOORS ON EXPOSED BACKS
 LAMINATE KITCHEN & VANITY COUNTERTOPS

This drawing is the intellectual property of SELBA INDUSTRIES INC. and is an original design which must not be released or copied unless applicable fee has been paid or job order placed.



JOB NUMBER:
 BUILDER: GREENPARK HOMES
 SITE NAME: LECCO RIDGE, Milton
 MODEL: IVY 1X ELEV 1,2,3
 LOT #:
 DESIGNER: KS
 DATE: FEB 13 17

IVY 1

1,578 SQ.FT.

AVAILABLE IN BLOCK: 324, 327, 328, 329, 330, 332, 334, 335, 337, 338, 341, 342, 343, 344 & 345

