



CONSTRUCTION SUMMARY

Saddle Ridge (G) - Lecco Ridge Developments Inc. DATE: **MAR 14 2019**

PURCHASER: **THE CAPITAL INC.**

TEL:

LOT / PHASE Block 330 TH 1 / 1	REG. PLAN # 20M-1184	HOUSE TYPE Ivy 7E Elev 2		
-----------------------------------	-------------------------	-----------------------------	--	--

CABINETRY

1 - KITCHEN - MONACO CABINETRY WITH UPGRADE STAIN

06Sep17 Note:



CABINETRY ACCESSORIES

1 - PANTRY UNIT UPGRADE - TO GO FROM 300MM TO 600MM DEEP - PRICE IS PER FOOT - STANDARD

06Sep17 Note:



1 - KITCHEN CABINETRY UPPER - FULL DEPTH ABOVE FRIDGE - WITH GABLES - 600MM - PRICE IS EACH - STANDARD

06Sep17 Note:



HARDWOOD FLOORING

1 - LAMINATE - PARK LANE - Eligna SERIES - - UPPER HALL

06Sep17 Note:



MISCELLANEOUS

1 - VENDOR DISCOUNT

06Sep17 Note:



PLUMBING

1 - WASHROOM - 3 PIECE ROUGH-IN IN BASEMENT

25May17 Note:



PROMOTIONAL

1 - LESS BALANCE OF CREDIT FROM PURCHASER EXTRA SHEET IN OFFER

06Sep17 Note:

1 - PARTIAL REDEMPTION OF PROMOTIONAL PACKAGE \$\$\$\$\$\$ BALANCE FORWARD TO BE USED AT A LATER DATE.
ORIGINAL PROMOTIONAL PACKAGE OF \$\$\$\$ AS PER SCHEDULE PE DATED MMMDDYYYY.

25May17 Note: ORIGINAL PROMO PACKAGE - \$5000.00
BALANCE FORWARD - \$4360.00

STAIRS AND RAILINGS

1 - STAINED STAIRS, RAILING AND PICKETS - FIRST TO SECOND FLOOR - STANDARD STAIRCASE

06Sep17 Note:



EXTRAS AS PER OFFER

Five (5) White Appliances as per PE Appliances

Worksheet Note:

The Vendor agrees that notwithstanding any other term or provision in this Agreement included in the Purchase Price and in addition to those items detailed in Schedule GP to the Agreement of Purchase and Sale, the Purchaser is entitled to a credit of Fiv

Worksheet Note:

The Purchaser acknowledges that the Purchase Price is inclusive of all credits and promotional packages available at the time of purchase.

Worksheet Note:

COMPLETE CENTRAL AIR CONDITIONING

Worksheet Note:

This Document is Extremely Time Sensitive - Printed 6 Sep 17 at 15:06

RECEIVED SEP 08 2017

NEW
RECEIVED
MAR 14 2019

SCHEDULE "PE-2"
PURCHASER'S EXTRA

- Cons/Majestic/Selba/
Premier/Lancia
Frontier -

Lecco Ridge Developments Inc. c.o.b. Greenpark Homes Vendor		Jaspal Singh DHALIWAL Purchaser(s) Telephone Number: Res.: (647) 217-4747		
Lot Number Block 330 TH 1	House Type Ivy 7E Elev 2	Reg. Plan # 20M-1184	Phase	Date Ordered 12-Mar-2019

IN ACCORDANCE WITH THE PROVISIONS OF SCHEDULE "X" OF THE AGREEMENT OF PURCHASE AND SALE, THE PURCHASER HEREBY AGREES TO PURCHASE THE FOLLOWING EXTRA'S:

DESCRIPTION

Kitchen Counter-top to be supplied and installed - Torrone (Q) - Majestic/Selba
Kitchen Backsplash to be supplied and installed - Thassos White - Premier-Lancia
Kitchen Undermount Sink to be supplied and installed - Blanco Essential - U2 400008 - Dasa
Continue existing selected laminate (as per current colour chart) throughout 2nd floor in lieu of broadloom areas - Heritage Oak QS-U1386 - Frontier

All promotional items and incentives available at the time of purchase have been given to the Purchaser at the time of sale. No further credits available. Any unused portion of the credit will be forfeited by the Purchaser.

Where applicable: Purchaser acknowledges being advised that the stain of pre-finished wood flooring and the stain of the stairs, railings, spindles and stair landing may vary, despite both having the same descriptive name and or code.

Paid: Included in the purchase price

Purchaser: Jaspal Singh DHALIWAL

Vendor

Construction Scheduling Approval

Per: _____

Date: _____

Greenpark

☐

Metropark

☐

Purchaser

☐

Construction

☐

Site Office

☐

Purchaser's Lawyer

☐

Purchaser: [REDACTED]

Property: Block 330 TH 1

Telephone Res. / Bus: /

Project: Lecco Ridge Developments Inc.

Decor Advisor: Candace Forza

Model and Elevation: Ivy 7E Elev 2

Lock Date: 6-Sep-17

6-Sep-17

Plan #: 20M-1184

Layout Changes: ☐ Yes ☒ No

Sketch Attached: ☒ Yes ☐ No

Exterior Colour Scheme: [REDACTED]

1. Cabinetry

	Style and Colour	Hardware
Kitchen / Breakfast	MONACO W821XZ4	2002
Laundry Room	ELISSE	Standard
Powder Room	MONACO W350XZ4	2004
Master Ensuite Bathroom	MODENA ULTRA WHITE	2004
Main Bathroom	MODENA ULTRA WHITE	2004
	N/A	N/A
	N/A	N/A
	N/A	N/A
	N/A	N/A

Appliances:

Built In Appliances ☐ Yes ☒ No

Slide In Stove ☐ Yes ☒ No

Dishwasher Cabinet ☐ Closed ☒ Open

41" Upper Cabinets ☒ Yes ☐ No

Please NOTE: Standard Cabinet Height is 30"

Stove Opening

NOTE: If not specified, opening will be set to builder's standard opening of approximately 30" width

Fridge Opening

NOTE: If not specified, opening will be set to builder's standard opening of approximately 37" width x 74" height

** Refer to Construction Summary

RECEIVED

2. Counters

	Counter	Edge
Kitchen / Breakfast	LAMINATE-WHITE CARRARA 4924-38 Bianco Quartz-Stardust	#360 Pencil Edge
Laundry Room	N/A	
Powder Room	LAMINATE-CALCUTTA MARBLE-4925K-07	
Master Ensuite Bathroom	LAMINATE-CARRARA BIANCO-6696-46	
Main Bathroom	LAMINATE-INUKSHUK TAUPE-P-345-LM	
	N/A	
	N/A	
	N/A	
	N/A	

** Refer to Construction Summary

Initial: [Signature]

Purchaser: **UNIVERSITY OF**
 Telephone Res. / Bus: /
 Decor Advisor: Candace Forza
 Lock Date: 6-Sep-17

Property: Block 330 TH 1
 Project: Lecco Ridge Developments Inc.
 Model and Elevation: Ivy 7E Elev 2
 Plan #: 20M-1184

3. Ceramic Flooring

		At a 45° Threshold-If App.
Entrance Vestibule	TILE-RAINBOW WHITE-13X13	<input type="checkbox"/>
Main Hall	LAMINATE	<input type="checkbox"/>
Kitchen / Breakfast	TILE-RAINBOW WHITE-13X13	<input type="checkbox"/> METAL STRIP
Laundry Room	TILE-RAINBOW WHITE-13X13	<input type="checkbox"/> METAL STRIP
Powder Room	TILE-RAINBOW WHITE-13X13	<input type="checkbox"/> METAL STRIP
Master Ensuite Bathroom	TILE-RAINBOW LIGHT GREY-13X13	<input type="checkbox"/> METAL STRIP
Main Bathroom	TILE-SIENNA IVORY-13X13	<input type="checkbox"/> METAL STRIP
SIDE ENTRANCE	TILE-RAINBOW WHITE-13X13	<input type="checkbox"/>
	N/A	<input type="checkbox"/>
	N/A	<input type="checkbox"/>
	N/A	<input type="checkbox"/>

** Refer to Construction Summary

4. Ceramic Wall Tile

Master Ensuite Bathroom	Selection	Describe
Tub Deck Wall	TILE-GOLF GRIGIO-8X10	***LAID HORIZONTALLY***
Tub Deck	N/A	
Tub Deck Skirt	N/A	
Shower Stall	TILE-GOLF GRIGIO-8X10	***LAID HORIZONTALLY***
Bathtub Enclosure Walls	N/A	
	N/A	
Main Bathroom	TILE-MATTE WHITE-8X8	***LAID HORIZONTALLY***
	N/A	
	N/A	
	N/A	
Kitchen Backsplash	Tile - Thassos White (HB067B3-AP) Hex 2" 13x13	

** Refer to Construction Summary - STANDARD GROUT THROUGHOUT UNLESS SPECIFIED

RECEIVED
MAR 14 2019

5. Plumbing Fixtures

All Bathrooms	White	Whirlpool
	N/A	<input type="checkbox"/> N/A <input type="radio"/> Yes <input checked="" type="radio"/> No
	N/A	
	N/A	
	N/A	Dishwasher Rough-In <input checked="" type="radio"/> Yes <input type="radio"/> No
	N/A	Waterline for Fridge <input type="radio"/> Yes <input checked="" type="radio"/> No
	N/A	

** Refer to Construction Summary

6. Trim Carpentry

Interior Doors	CLERMONT
Interior Trim	As Per Construction Specifications
Door Handles	As Per Construction Specifications
Exterior Front Door Handle	As Per Construction Specifications

** Refer to Construction Summary

Initial: ML

Purchaser: [REDACTED]

Property: Block 330 TH 1

Telephone Res. / Bus: /

Project: Lecco Ridge Developments Inc.

Decor Advisor: Candace Forza

Model and Elevation: Ivy 7E Elev 2

Lock Date: 6-Sep-17

6-Sep-17

Plan #: 20M-1184

7. Other Flooring

Main Hall	Laminate - Park Lane - Heritage Oak QS-U1386
Living Room	Laminate - Park Lane - Heritage Oak QS-U1386
Dining Room	Laminate - Park Lane - Heritage Oak QS-U1386
Family Room	Laminate - Park Lane - Heritage Oak QS-U1386
Den / Library / Study	N/A
Basement Landing (If Applies)	N/A
Lower Landing (If Applies)	Laminate - Park Lane - Heritage Oak QS-U1386
Upper Landing	Laminate - Park Lane - Heritage Oak QS-U1386
Upper Hall	Laminate - Park Lane - Heritage Oak QS-U1386
Master Bedroom	CARPET SHAW NEWBERN CLASSIC MORNING FOG-00530 Laminate - Park Lane - Heritage Oak QS-U1386
Bedroom #2	CARPET SHAW NEWBERN CLASSIC MORNING FOG-00530 Laminate - Park Lane - Heritage Oak QS-U1386
Bedroom #3	CARPET SHAW NEWBERN CLASSIC MORNING FOG-00530 Laminate - Park Lane - Heritage Oak QS-U1386
Bedroom #4	CARPET SHAW NEWBERN CLASSIC MORNING FOG-00530 Laminate - Park Lane - Heritage Oak QS-U1386
Bedroom #5	N/A
	N/A
	N/A
	N/A
Underpad	Type Area
	STANDARD BEDROOMS ONLY

RECEIVED

MAR 14 2019

** Refer to Construction Summary

8. Railings and Pickets

Railing Type	As Per Construction Specifications	Colour	TORLYS HERITAGE OAK
Picket Type	As Per Construction Specifications	Colour	TORLYS HERITAGE OAK
Stringer / Riser	As Per Construction Specifications	Colour	TORLYS HERITAGE OAK
Treads	As Per Construction Specifications	Colour	TORLYS HERITAGE OAK
Red Oak Stairs with Semi Gloss Finish		<input checked="" type="radio"/> Yes <input type="radio"/> No	

** Refer to Construction Summary

9. Wall Paint Flat Finish

Main & Upper Hall	22 WARM GREY	Master Bedroom	22 WARM GREY
Living Room	22 WARM GREY	Bedroom #2	22 WARM GREY
Dining Room	22 WARM GREY	Bedroom #3	22 WARM GREY
Kitchen / Breakfast	22 WARM GREY	Bedroom #4	22 WARM GREY
Family Room	22 WARM GREY	Bedroom #5	N/A
Powder Room	22 WARM GREY	Master Ensuite	22 WARM GREY
Laundry Room	22 WARM GREY	Main Bathroom	22 WARM GREY
Den/Library	N/A		N/A
Trim Paint-Semi Gloss	BIRCH WHITE		N/A
	N/A		N/A
	N/A		N/A

Smooth Ceilings First Floor ☐ Yes ☒ No

** Refer to Construction Summary

Initial: [Signature]

Purchaser: [REDACTED]

Property: Block 330 TH 1

Telephone Res. / Bus: /

Project: Lecco Ridge Developments Inc.

Decor Advisor: Candace Forza

Model and Elevation: Ivy 7E Elev 2

Lock Date: 6-Sep-17

6-Sep-17

Plan #: 20M-1184

10. Plaster Mouldings and Medallions

Entrance Vestibule	N/A	N/A	Kitchen/Breakfast	N/A	N/A
Main Hall	N/A	N/A	Den/Library	N/A	N/A
Living Room	N/A	N/A	Lower Landing	N/A	N/A
Dining Room	N/A	N/A		N/A	N/A
Family Room	N/A	N/A			

** Refer to Construction Summary

11. Fireplace

	Living Room			Family Room			Other Room - Specify		
	Purchased	As Per Plan	N/A	Purchased	As Per Plan	N/A	Purchased	As Per Plan	N/A
Fireplace Type	<input type="radio"/>	<input type="radio"/>	<input checked="" type="radio"/>	<input type="radio"/>	<input type="radio"/>	<input checked="" type="radio"/>	<input type="radio"/>	<input type="radio"/>	<input checked="" type="radio"/>
Mantle Type	N/A			N/A			N/A		
Colour / Stain	N/A			N/A			N/A		
Surround	N/A			N/A			N/A		
Hearth	N/A			N/A			N/A		

** Refer to Construction Summary

12. Heating and Air Conditioning

Air Conditioning YES

Gas Provisions Dryer NO

Gas Provisions Stove NO

Gas Provisions Barbecue NO

Comment

** Refer to Construction Summary

13. Electrical

Plugs and Switches	<input checked="" type="radio"/> White	DECOR	Above Kitchen Cabinet Light	<input type="radio"/> Yes	<input checked="" type="radio"/> No
Hood Fan	STANDARD		Below Kitchen Cabinet Light	<input type="radio"/> Yes	<input checked="" type="radio"/> No
Appliances	Built in Cooktop	Built in Oven	Gas Stove	Microwave	
	<input type="radio"/> Yes <input checked="" type="radio"/> No	<input type="radio"/> Yes <input checked="" type="radio"/> No	<input type="radio"/> Yes <input checked="" type="radio"/> No	<input type="radio"/> Yes <input checked="" type="radio"/> No	
Dishwasher Rough-in	Yes				

** Refer to Construction Summary

14. General Comments

** Refer to Construction Summary

Disclaimers and Notes

- Colours of all materials are as close as possible to builder's selection, but not necessarily identical due to variances in manufacturing.
- Any extras listed above are null and void unless accompanied by a separate invoice/amendment. Said invoice must be paid in full.
- The Purchaser agrees that this colour selection is final and that no changes will be permitted, unless required by the Vendor.
- The Purchaser acknowledges reading and accepting document which contains other miscellaneous disclaimers.

Signature:  Date: _____

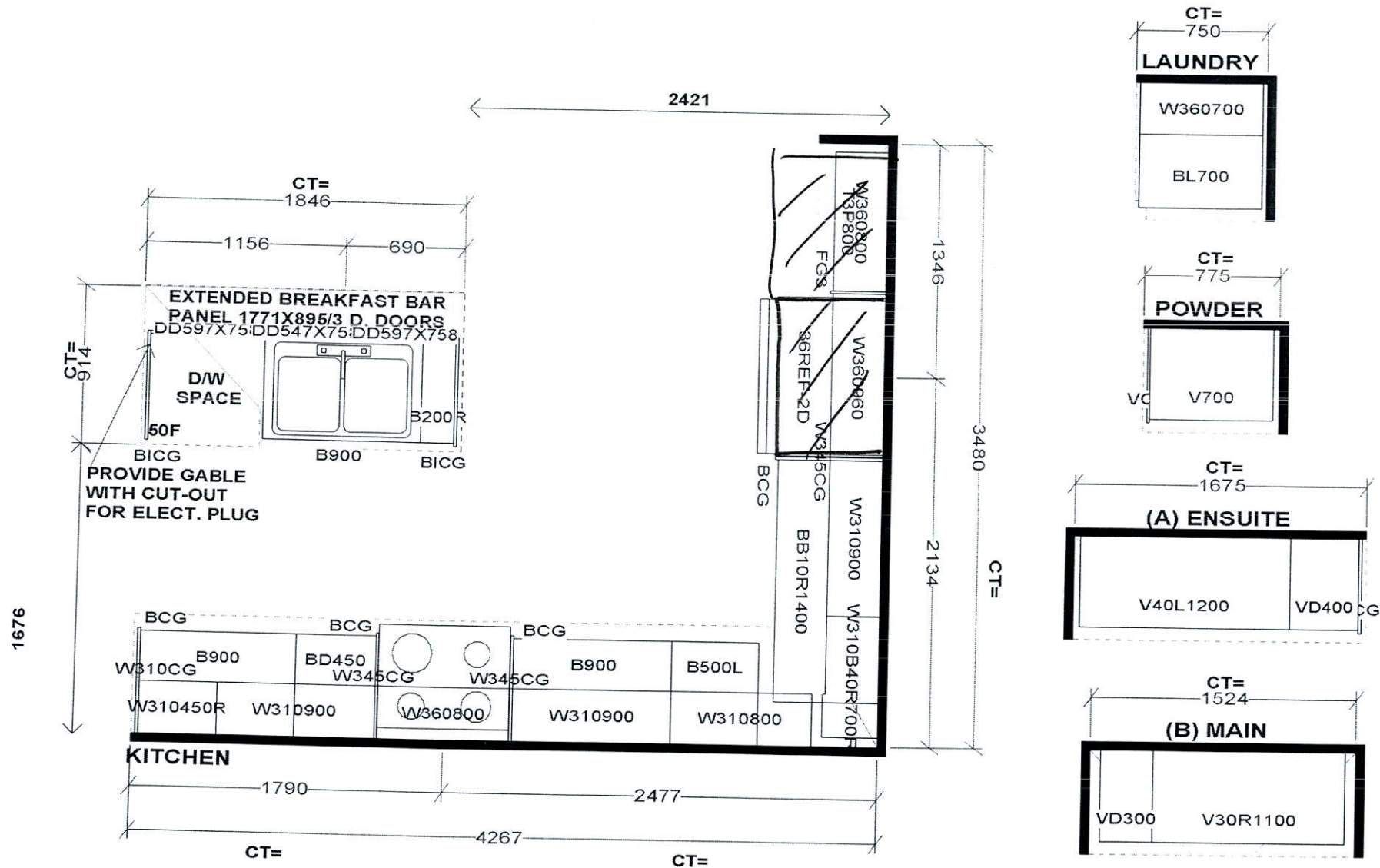

Selba Industries

STANDARD FEATURES:
 9' CEILINGS WITH D/C BOX
 1040MM HIGH UPPER CABINETS
 DISHWASHER SPACE
 DUMMY DOORS ON EXPOSED BACKS
 LAMINATE KITCHEN & VANITY COUNTERTOPS

This drawing is the intellectual property of SELBA INDUSTRIES INC. and is an original design which must not be released or copied unless applicable fee has been paid or job order placed.



JOB NUMBER:
 BUILDER: GREENPARK HOMES
 SITE NAME: LECCO RIDGE, Milton
 MODEL: IVY 7EX ELEV 1,2,3
 LOT #:
 DESIGNER: KS
 DATE: FEB 13 17

IVY 7E

2,284 SQ.FT.

AVAILABLE IN BLOCK: 325, 326, 327, 328, 329, 330
338, 339, 340, 345, 346, 347, 348 & 349

