

FEB 27 2019

CONSTRUCTION SUMMARY

DATE:

Saddle Ridge (G) - Lecco Ridge Developments Inc.

TEL:

PURCHASER: RIO CASINO BRILLANTES

LOT / PHASE Block 336 TH 6 / 1	REG. PLAN # 20M-1184	HOUSE TYPE Ivy 6E Elev 2		
-----------------------------------	-------------------------	-----------------------------	--	--

CABINETRY ACCESSORIES

1 - KITCHEN CABINETRY BASE - PIE CUT CORNER CABINET - BASE CABINETRY - STANDARD 20Mar18 Note:	
1 - KITCHEN CABINETRY UPPER - FULL DEPTH ABOVE FRIDGE - WITH GABLES - 600MM - PRICE IS EACH - STANDARD 20Mar18 Note:	

CERAMIC TILE

1 - KITCHEN - UPGRADE BACKSPLASH 11Feb19 Note: New	RECEIVED FEB 27 2019		
--	----------------------	---	--

HARDWOOD FLOORING

1 - LAMINATE - LEXINGTON SERIES - - UPPER HALL 20Mar18 Note:	
1 - LAMINATE -UPGRADE TO LEXINGTON SERIES IN LIEU OF STANDARD LAMINATE 20Mar18 Note:	

PLUMBING

1 - WATER LINE FOR FRIDGE - ROUGH-IN ONLY 20Mar18 Note:	
1 - WASHROOM - 3 PIECE ROUGH-IN IN BASEMENT 08May17 Note:	

PROMOTIONAL

1 - LESS BALANCE OF CREDIT FROM PURCHASER EXTRA SHEET IN OFFER 11Feb19 Note:	
1 - LESS BALANCE OF CREDIT FROM PURCHASER EXTRA SHEET IN OFFER 20Mar18 Note:	
1 - PARTIAL REDEMPTION OF PROMOTIONAL PACKAGE \$\$\$\$\$\$ BALANCE FORWARD TO BE USED AT A LATER DATE. ORIGINAL PROMOTIONAL PACKAGE OF \$\$\$\$ AS PER SCHEDULE PE DATED MMMDDYYYY. 08May17 Note:	

STAIRS AND RAILINGS

1 - STAINED STAIRS, RAILING AND PICKETS – STANDARD STAIRCASE - PRICE IS PER SET 20Mar18 Note:	
--	--

EXTRAS AS PER OFFER

Five (5) White Appliances as per PE Appliances Worksheet Note:	
The Vendor agrees that notwithstanding any other term or provision in this Agreement included in the Purchase Price and in addition to those items detailed in Schedule GP to the Agreement of Purchase and Sale, the Purchaser is entitled to a credit of Sev Worksheet Note:	
The Purchaser acknowledges that the Purchase Price is inclusive of all credits and promotional packages available at the time of purchase. Worksheet Note:	

This Document is Extremely Time Sensitive - Printed 21 Feb 19 at 11:51

Purchaser:

RIO CASINO BRILLANTES

Telephone Res. / Bus:

/

Decor Advisor:

Candace Forza

Lock Date:

20-Mar-18

Layout Changes:

☐ Yes ☒ No

Property:

Block 336 TH 6

Project:

Lecco Ridge Developments Inc.

Model and Elevation:

Ivy 6E Elev 2

Plan #:

20M-1184

Sketch Attached:

☒ Yes ☐ No

Exterior Colour Scheme:

20-Mar-18

20-Mar-18

1. Cabinetry		Hardware
	Style and Colour	
Kitchen / Breakfast	EVEREST WHITE	2002
Laundry Room	ELISSE	Standard
Powder Room	MODENA WHITE	2004
Master Ensuite Bathroom	MODENA WHITE	2004
Main Bathroom	MODENA WHITE	2004
	N/A	N/A
	N/A	N/A
	N/A	N/A
	N/A	N/A

Appliances:

Built In Appliances ☐ Yes ☒ No

Slide In Stove ☐ Yes ☒ No

Dishwasher Cabinet

☐ Closed ☒ Open

41" Upper Cabinets ☒ Yes ☐ No

Please NOTE: Standard Cabinet Height is 30"

Stove Opening

NOTE: If not specified, opening will be set to builder's standard opening of approximately 30" width

Fridge Opening

NOTE: If not specified, opening will be set to builder's standard opening of approximately 37" width x 74" height

** Refer to Construction Summary

2. Counters		Edge
	Counter	
Kitchen / Breakfast	LAMINATE-ARGENTO ROMANO 6697-46	
Laundry Room	N/A	
Powder Room	LAMINATE-CARRARA BIANCO 6696-46	
Master Ensuite Bathroom	LAMINATE-CARRARA BIANCO 6696-46	
Main Bathroom	LAMINATE-CARRARA BIANCO 6696-46	
	N/A	
	N/A	
	N/A	
	N/A	

** Refer to Construction Summary

Purchaser:RIO CASINO BRILLANTES

Telephone Res. / Bus: /

Decor Advisor:Candace Forza

Lock Date:20-Mar-18

7. Other Flooring

Property: Block 336 TH 6

Project: Lecco Ridge Developments Inc.

Model and Elevation: Ivy 6E Elev 2

Plan #: 20M-1184

Main Hall	LAMINATE-LEXINGTON - HAZELWOOD OAK TL21016 - M
Living Room	LAMINATE-LEXINGTON - HAZELWOOD OAK TL21016 - M
Dining Room	LAMINATE-LEXINGTON - HAZELWOOD OAK TL21016 - M
Family Room	LAMINATE-LEXINGTON - HAZELWOOD OAK TL21016 - M
Den / Library / Study	N/A
Basement Landing(If Applies)	N/A
Lower Landing (If Applies)	LAMINATE-LEXINGTON - HAZELWOOD OAK TL21016 - M
Upper Landing	LAMINATE-LEXINGTON - HAZELWOOD OAK TL21016 - M
Upper Hall	LAMINATE-LEXINGTON - HAZELWOOD OAK TL21016 - M
Master Bedroom	CARPET-SHAW - E0949 NEWBERN CLASSIC - TAUPE 55105
Bedroom #2	CARPET-SHAW - E0949 NEWBERN CLASSIC - TAUPE 55105
Bedroom #3	CARPET-SHAW - E0949 NEWBERN CLASSIC - TAUPE 55105
Bedroom #4	CARPET-SHAW - E0949 NEWBERN CLASSIC - TAUPE 55105
Bedroom #5	N/A
	N/A
	N/A
	N/A
Underpad	TypeArea
	STANDARDBEDROOMS ONLY

** Refer to Construction Summary

8. Railings and Pickets

Railing Type	As Per Construction Specifications	Colour	TORLYS HAZELWOOD OAK
Picket Type	As Per Construction Specifications	Colour	TORLYS HAZELWOOD OAK
Stringer / Riser	As Per Construction Specifications	Colour	TORLYS HAZELWOOD OAK
Treads	As Per Construction Specifications	Colour	TORLYS HAZELWOOD OAK
	Red Oak Stairs with Semi Gloss Finish		<input checked="" type="radio"/> Yes <input type="radio"/> No

** Refer to Construction Summary

9. Wall Paint Flat Finish

Main & Upper Hall	43 BIRCH WHITE	Master Bedroom	43 BIRCH WHITE
Living Room	43 BIRCH WHITE	Bedroom #2	43 BIRCH WHITE
Dining Room	43 BIRCH WHITE	Bedroom #3	43 BIRCH WHITE
Kitchen / Breakfast	43 BIRCH WHITE	Bedroom #4	43 BIRCH WHITE
Family Room	43 BIRCH WHITE	Bedroom #5	N/A
Powder Room	43 BIRCH WHITE	Master Ensuite	43 BIRCH WHITE
Laundry Room	43 BIRCH WHITE	Main Bathroom	43 BIRCH WHITE
Den/Library	N/A		N/A
Trim Paint-Semi Gloss	BIRCH WHITE		N/A
	N/A		N/A
	N/A		N/A

Smooth Ceilings First Floor ☒ Yes ☐ No

** Refer to Construction Summary

Purchaser:RIO CASINO BRILLANTES

Telephone Res. / Bus: /

Decor Advisor:Candace Forza

Lock Date:20-Mar-18

Property:Block 336 TH 6

Project:Lecco Ridge Developments Inc.

Model and Elevation:Ivy 6E Elev 2

Plan #:20M-1184

10. Plaster Mouldings and Medallions

Entrance Vestibule	N/A	N/A	Kitchen/Breakfast	N/A	N/A
Main Hall	N/A	N/A	Den/Library	N/A	N/A
Living Room	N/A	N/A	Lower Landing	N/A	N/A
Dining Room	N/A	N/A		N/A	N/A
Family Room	N/A	N/A			

** Refer to Construction Summary

11. Fireplace

Living Room			Family Room			Other Room - Specify		
Purchased	As Per Plan	N/A	Purchased	As Per Plan	N/A	Purchased	As Per Plan	N/A
<input type="radio"/>	<input type="radio"/>	<input checked="" type="radio"/>	<input type="radio"/>	<input type="radio"/>	<input checked="" type="radio"/>	<input type="radio"/>	<input type="radio"/>	<input checked="" type="radio"/>
Fireplace Type	N/A		N/A			N/A		
Mantle Type	N/A		N/A			N/A		
Colour / Stain	N/A		N/A			N/A		
Surround	N/A		N/A			N/A		
Hearth	N/A		N/A			N/A		

** Refer to Construction Summary

12. Heating and Air Conditioning

Air Conditioning	NO	Gas Provisions Stove	NO
Gas Provisions Dryer	NO	Gas Provisions Barbecue	NO
Comment			

** Refer to Construction Summary

13. Electrical

Plugs and Switches	<input checked="" type="radio"/> White	DECOR	Above Kitchen Cabinet Light	<input type="radio"/> Yes <input checked="" type="radio"/> No
Hood Fan	STANDARD WHITE		Below Kitchen Cabinet Light	<input type="radio"/> Yes <input checked="" type="radio"/> No
Appliances	Built in Cooktop	Built in Oven	Gas Stove	Microwave
	<input type="radio"/> Yes <input checked="" type="radio"/> No	<input type="radio"/> Yes <input checked="" type="radio"/> No	<input type="radio"/> Yes <input checked="" type="radio"/> No	<input type="radio"/> Yes <input checked="" type="radio"/> No
Dishwasher Rough-in	Yes			

** Refer to Construction Summary

14. General Comments

** Refer to Construction Summary

Disclaimers and Notes

1) Colours of all materials are as close as possible to builder's selection, but not necessarily identical due to variances in manufacturing.

2) Any extras listed above are null and void unless accompanied by a separate invoice/amendment. Said invoice must be paid in full.

3) The Purchaser agrees that this colour selection is final and that no changes will be permitted, unless required by the Vendor.

4) The Purchaser acknowledges reading and accepting document which contains other miscellaneous disclaimers.

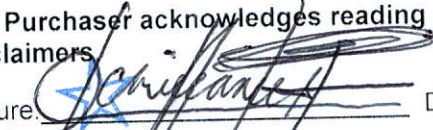
Signature:

Date:MARCA 20, 2018

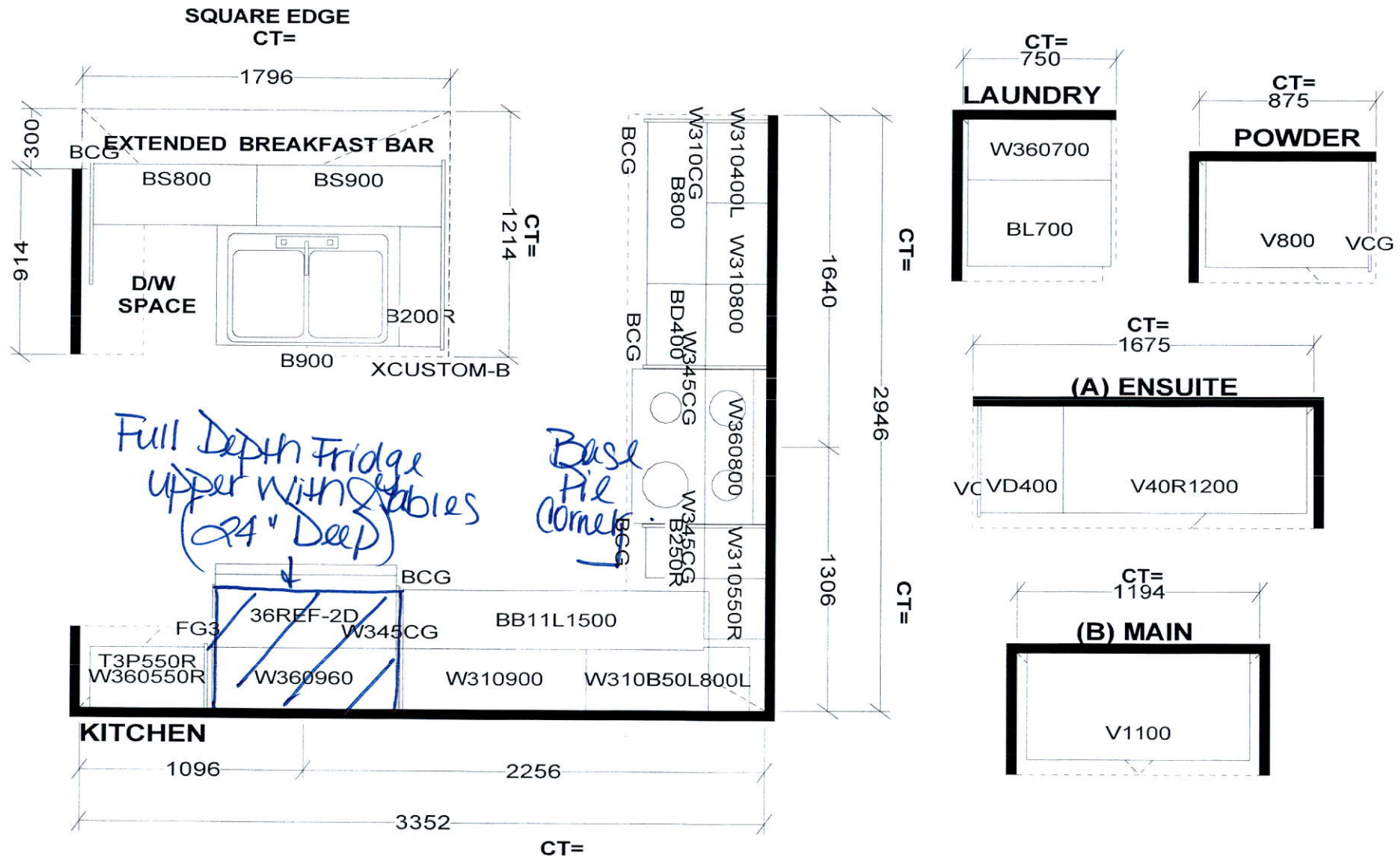

S e l b a I n d u s t r i e s

STANDARD FEATURES:

9' CEILINGS WITH D/C BOX
1040MM HIGH UPPER CABINETS
DISHWASHER SPACE
DUMMY DOORS ON EXPOSED BACKS
LAMINATE KITCHEN & VANITY COUNTERTOPS

This drawing is the intellectual property of SELBA INDUSTRIES INC. and is an original design which must not be released or copied unless applicable fee has been paid or job order placed.



JOB NUMBER:
BUILDER: GREENPARK HOMES
SITE NAME: LECCO RIDGE, Milton
MODEL: IVY 6EX ELEV 1,2,3
LOT #:
DESIGNER: KS
DATE: FEB 13 17

1416

IVY 6E

2,133 SQ.FT.

AVAILABLE IN BLOCK: 323, 332, 333, 334, 335, 336, 337
341, 342, 343 & 344

