

<div></div> <div>CONSTRUCTION SUMMARY</div> <div>Sharon Village 2 - Secondo Vales Estates Inc.</div>				
PURCHASERS: ANTHONY TOMASONE and ELIZABETH MARIA TOMASONE				TEL:
LOT / PHASE	REG. PLAN #	HOUSE TYPE		
Block 51 TH 1 / 2	65M-4626	Holland 14 Elev 1		

CERAMIC TILE

I - FIRST FLOOR - UPGRADE TILES- IN ALL TILED AREAS	
01Nov18 Note:	

ELECTRICAL

I - RELOCATE STANDARD KITCHEN LIGHT TO BE CENTERED OVER ISLAND	
01Nov18 Note:	
I - STANDARD DINING ROOM LIGHT TO BE CENTERED BETWEEN LIVING AND DINING ROOM	
01Nov18 Note:	

FIREPLACE AND ACCESSORIES

I - GAS LINE ROUGH-IN FOR BARBECUE - FIRST FLOOR	
01Nov18 Note:	

PLUMBING

I - SINK - DROP-IN SINK - CONTRAC LOLLAND #4480BST - POWDER ROOM ONLY	
01Nov18 Note:	
I - WATER LINE FOR FRIDGE - ROUGH-IN ONLY	
01Nov18 Note:	

PROMOTIONAL

I - LESS BALANCE OF CREDIT FROM PURCHASER EXTRA SHEET IN OFFER	
01Nov18 Note:	

STAIRS AND RAILINGS

I - STAINED STAIRS, RAILING AND PICKETS – STANDARD STAIRCASE - PRICE IS PER SET	
01Nov18 Note:	

EXTRAS AS PER OFFER

Five (5) White Appliances as per PE Appliances	
Worksheet Note:	
(5) The Vendor agrees that notwithstanding any other term or provision in this Agreement included in the Purchase Price and in addition to those items detailed in Schedule GP to the Agreement of Purchase and Sale, the Purchaser is entitled to a credit of	
Worksheet Note:	
The Purchaser acknowledges that the Purchase Price is inclusive of all credits and promotional packages available at the time of purchase.	
Worksheet Note:	

This Document is Extremely Time Sensitive - Printed 1 Nov 18 at 11:09

RECEIVED NOV 01 2018

Purchasers:

ANTHONY TOMASONE & ELIZABETH MARIA T

Telephone Res. / Bus:

/

Decor Advisor:

Natalie Mancuso

Lock Date:

1-Nov-18

Layout Changes:

☐ Yes ☒ No

Property:

Block 51 TH 1

Project:

Secondo Vales Estates Inc.

Model and Elevation:

Holland 14 Elev 1

1-Nov-18

Plan #:

65M-4626

Sketch Attached:

☒ Yes ☐ No

Exterior Colour Scheme:

1. Cabinetry

	Style and Colour	Hardware
Kitchen / Breakfast	MONACO W350XZ4	2002
Laundry Room	N/A	N/A
Powder Room	MODENA WHITE	2004
Master Ensuite Bathroom	MODENA WHITE	2004
Main Bathroom	MODENA WHITE	2004

Appliances:

Built In Appliances

☐ Yes ☒ No

Slide In Stove

☐ Yes ☒ No

Dishwasher Cabinet

☐ Closed ☒ Open

41" Upper Cabinets

☒ Yes ☐ No

Please NOTE:

Standard Cabinet Height is 30"

Stove Opening

NOTE: If not specified, opening will be set to builder's standard opening of approximately 30" width

Fridge Opening

NOTE: If not specified, opening will be set to builder's standard opening of approximately 37" width x 74" height

** Refer to Construction Summary

2. Counters

	Counter	Edge
Kitchen / Breakfast	LAMINATE-CARRARA BIANCO 6696-46	
Laundry Room	N/A	
Powder Room	LAMINATE-ELEMENTAL CONCRETE 8830-58	
Master Ensuite Bathroom	LAMINATE-ELEMENTAL CONCRETE 8830-58	
Main Bathroom	LAMINATE-ELEMENTAL CONCRETE 8830-58	

** Refer to Construction Summary

Initials:

Printed 11/1/2018 11:01:47

Page 1 of 4

Purchasers:	ANTHONY TOMASONE & ELIZABETH MARIA T		Property:	Block 51 TH 1
Telephone Res. / Bus:	/		Project:	Secondo Vales Estates Inc.
Decor Advisor:	Natalie Mancuso		Model and Elevation:	Holland 14 Elev 1
Lock Date:	1-Nov-18	1-Nov-18	Plan #:	65M-4626

3. Ceramic Flooring

At a 45 Threshold-If App.

Entrance Vestibule	TILE- MARMANI BIANCO 12X24	METAL STRIP THROUGHOUT
Main Hall	LAMINATE	
Kitchen / Breakfast	TILE- MARMANI BIANCO 12X24	
Laundry Room	N/A	
Powder Room	TILE- MARMANI BIANCO 12X24	
Master Ensuite Bathroom	TILE- RAINBOW LIGHT GREY 13X13	
Main Bathroom	TILE- RAINBOW WHITE 13X13	

** Refer to Construction Summary

4. Ceramic Wall Tile

Master Ensuite Bathroom		Selection	Describe
	Tub Deck Wall		
	Tub Deck		
	Tub Deck Skirt		
	Shower Stall	TILE- UNI GREY 8X10	
	Bathtub Enclosure Walls		
Main Bathroom		TILE- GOLF GRIGIO 8X10	
Kitchen Backsplash			

**** Refer to Construction Summary - STANDARD GROUT THROUGHOUT UNLESS SPECIFIED**

5. Plumbing Fixtures

All Bathrooms

White

Whirlpool ☐ Yes ☒ No

Dishwasher Rough-In ☒ Yes ☐ No

Waterline for Fridge ☒ Yes ☐ No

**** Refer to Construction Summary**

6. Trim Carpentry

Interior Doors	CARRARA-SMOOTH
Interior Trim	2 3/4" CASING WITH 4 1/4" BASEBOARD - COLONIAL
Door Handles	As Per Construction Specifications
Exterior Front Door Handle	As Per Construction Specifications

**** Refer to Construction Summary**

Initials:  

Purchasers:ANTHONY TOMASONE & ELIZABETH MARIA T

Telephone Res. / Bus: /

Decor Advisor:Natalie Mancuso

Lock Date:1-Nov-18

Property: Block 51 TH 1

Project: Secondo Vales Estates Inc.

Model and Elevation: Holland 14 Elev 1

Plan #: 65M-4626

7. Outer Flooring

Main Hall	LAMINATE-PARK LANE - HERITAGE OAK TL-U1386
Living Room	LAMINATE-PARK LANE - HERITAGE OAK TL-U1386
Dining Room	LAMINATE-PARK LANE - HERITAGE OAK TL-U1386
Family Room	
Den / Library / Study	
Basement Landing(If Applies)	
Lower Landing (If Applies)	TILE- MARMANI BIANCO 12X24
Upper Landing	LAMINATE-PARK LANE - HERITAGE OAK TL-U1386
Upper Hall	CARPET-BEULIEU - A4447 WEBSTER SDN - ATMOSPHERE GREY 87935
Master Bedroom	CARPET-BEULIEU - A4447 WEBSTER SDN - ATMOSPHERE GREY 87935
Bedroom #2	CARPET-BEULIEU - A4447 WEBSTER SDN - ATMOSPHERE GREY 87935
Bedroom #3	CARPET-BEULIEU - A4447 WEBSTER SDN - ATMOSPHERE GREY 87935
Bedroom #4	
Bedroom #5	
Underpad	TypeArea
	STANDARDSECOND FLOOR

** Refer to Construction Summary

8. Railings and Pickets

Railing Type	AS PER CONSTRUCTION SPECIFICATIONS	Colour	TORLYS- HERITAGE OAK
Picket Type	1 5/16 PICKETS SQUARE CHAMFERED	Colour	TORLYS- HERITAGE OAK
Stringer / Riser	AS PER CONSTRUCTION SPECIFICATIO	Colour	TORLYS- HERITAGE OAK
Treads	AS PER CONSTRUCTION SPECIFICATIO	Colour	TORLYS- HERITAGE OAK
	Red Oak Stairs with Semi Gloss Finish		<input checked="" type="radio"/> Yes <input type="radio"/> No

** Refer to Construction Summary

9. Wall Paint Flat Finish

Main & Upper Hall	22 WARM GREY	Master Bedroom	22 WARM GREY
Living Room	22 WARM GREY	Bedroom #2	22 WARM GREY
Dining Room	22 WARM GREY	Bedroom #3	22 WARM GREY
Kitchen / Breakfast	22 WARM GREY	Bedroom #4	
Family Room		Bedroom #5	
Powder Room	22 WARM GREY	Master Ensuite	22 WARM GREY
Laundry Room		Main Bathroom	22 WARM GREY
Den/Library			
Trim Paint-Semi Gloss	BIRCH WHITE		

Smooth Ceilings First Floor ☐ Yes ☒ No

** Refer to Construction Summary

Initials:  

Purchasers:ANTHONY TOMASONE & ELIZABETH MARIA T

Telephone Res. / Bus: /

Decor Advisor:Natalie Mancuso

Lock Date:1-Nov-18

Property: Block 51 TH 1

Project: Secondo Vales Estates Inc.

Model and Elevation: Holland 14 Elev 1

Plan #: 65M-4626

10. Plaster Mouldings and Medallions

Entrance Vestibule			Kitchen/Breakfast		
Main Hall			Den/Library		
Living Room			Lower Landing		
Dining Room					
Family Room					

** Refer to Construction Summary

11. Fireplace

Living Room			Family Room			Other Room - Specify		
Purchased	As Per Plan	N/A	Purchased	As Per Plan	N/A	Purchased	As Per Plan	N/A
<input type="radio"/>	<input type="radio"/>	<input checked="" type="radio"/>	<input type="radio"/>	<input type="radio"/>	<input checked="" type="radio"/>	<input type="radio"/>	<input type="radio"/>	<input checked="" type="radio"/>
Fireplace Type								
Mantle Type								
Colour / Stain								
Surround								
Hearth								

** Refer to Construction Summary

12. Heating and Air Conditioning

Air Conditioning	NO	Gas Provisions Stove	NO
Gas Provisions Dryer	NO	Gas Provisions Barbecue	YES
Comment			

** Refer to Construction Summary

13. Electrical

Plugs and Switches	<input checked="" type="radio"/> White	DECOR	Above Kitchen Cabinet Light	<input type="radio"/> Yes <input checked="" type="radio"/> No
Hood Fan	STANDARD WHITE		Below Kitchen Cabinet Light	<input type="radio"/> Yes <input checked="" type="radio"/> No
Appliances	Built in Cooktop	Built in Oven	Gas Stove	Microwave
	<input type="radio"/> Yes <input checked="" type="radio"/> No	<input type="radio"/> Yes <input checked="" type="radio"/> No	<input type="radio"/> Yes <input checked="" type="radio"/> No	<input type="radio"/> Yes <input checked="" type="radio"/> No
Dishwasher Rough-in	Yes			

** Refer to Construction Summary

14. General Comments

** Refer to Construction Summary

Disclaimers and Notes

- 1) Colours of all materials are as close as possible to builder's selection, but not necessarily identical due to variances in manufacturing.
- 2) Any extras listed above are null and void unless accompanied by a separate invoice/amendment. Said invoice must be paid in full.
- 3) The Purchaser agrees that this colour selection is final and that no changes will be permitted, unless required by the Vendor.
- 4) The Purchaser acknowledges reading and accepting document which contains other miscellaneous disclaimers.

Signature:  Date: Nov 1 2018

Signature:  Date: _____

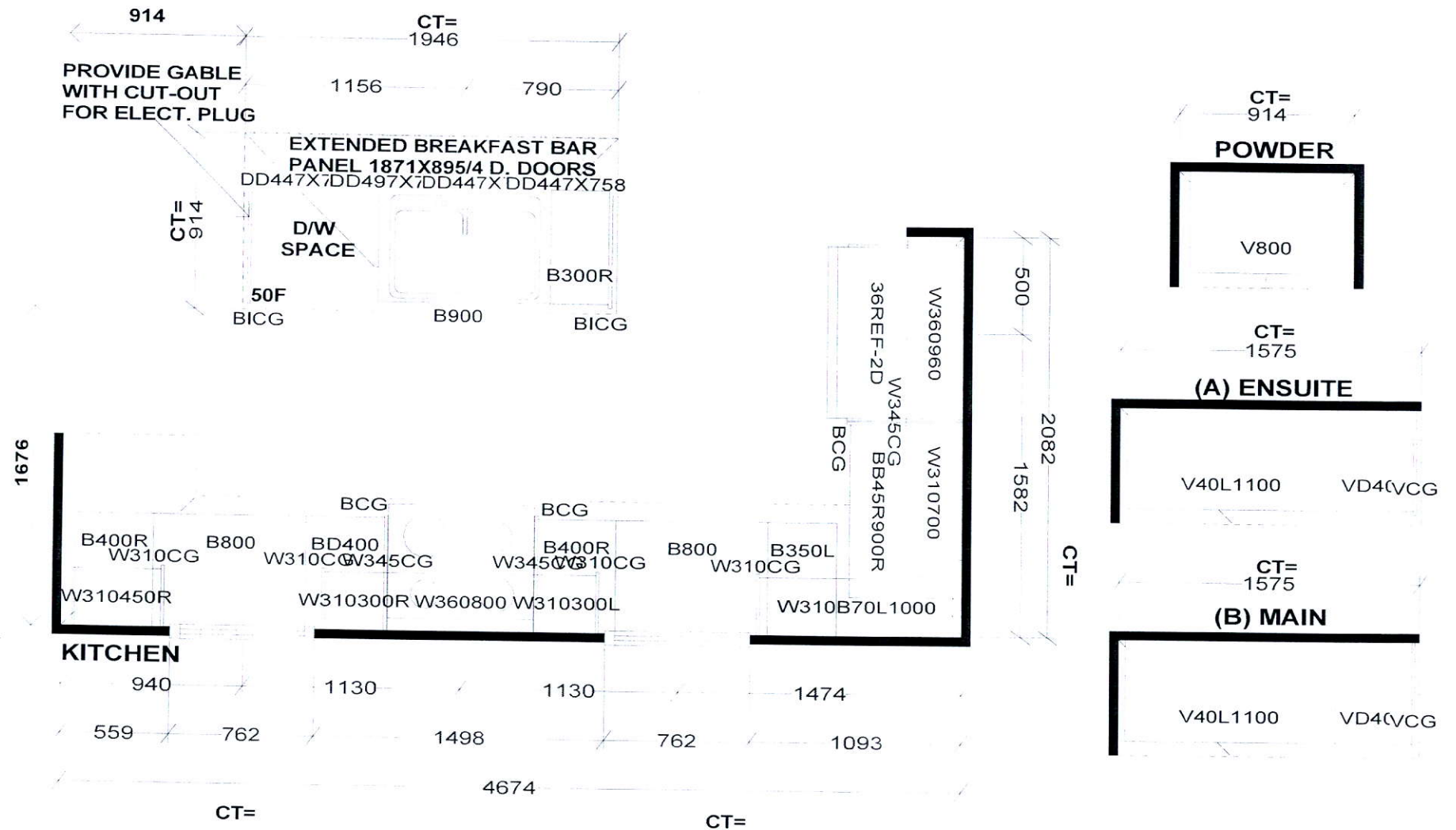

Selba Industries

W WIDTH _____ W HGHT _____ W CNT _____ FL HGHT _____ DWY H _____ ST CENT _____ 2X4 _____ VENT BOX COVER _____

STANDARD FEATURES:

1040MM HIGH UPPER CABINETS
LAMINATE KITCHEN & VANITY TOPS
DISHWASHER SPACE
DUMMY DOORS ON EXPOSED BACKS

This drawing is the intellectual property of SELBA INDUSTRIES INC. and is an original design which must not be released or copied unless applicable fee has been paid or job order placed.

G H A B
F E D C

JOB NUMBER:
BUILDER: GREENPARK
SITE NAME: SECONDO VALES
MODEL: HOLLAND 14X ELEV 1
LOT #:
DESIGNER: KS
DATE: MAR 22 18

BLK 51 Th 1

HOLLAND 14 | 1,437 SQ.FT.

