



CONSTRUCTION SUMMARY

Sharon Village 2 - Secondo Vales Estates Inc.

PURCHASERS: LAI MEI CHAN and CHEUK WING LAU

TEL:

LOT / PHASE Block 51 TH 3 / 2	REG. PLAN # 65M-4626	HOUSE TYPE Holland 3A Elev 1		
---	--------------------------------	--	--	--

CABINETRY

1 - KITCHEN - UPGRADE 1 CABINETRY

22Nov18 Note:

1 - KITCHEN - DELETE CABINETS ABOVE STOVE - VENDOR WILL SUPPLY 6 INCH VENT AS PER CONSTRUCTION SPECIFICATIONS AND VENT MAY NOT BE IN THE APPROPRIATE LOCATION FOR INSTALLATION OF PURCHASER SUPPLIED VENT - PURCHASER TO SUPPLY OWN FAN AFTER CLOSING (TEMP. FAN MA

22Nov18 Note:

CABINETRY ACCESSORIES

1 - KITCHEN CABINETRY BASE - RECYCLE PULLOUT 4 BIN - PRICE IS EACH

22Nov18 Note:

CERAMIC TILE

1 - FOYER, POWDER ROOM, KITCHEN & LOWER LANDING - UPGRADE 2 FLOOR TILES

22Nov18 Note:

1 - DELETE ALL CERAMIC BATHROOM ACCESSORIES - DELETE TOWEL BAR, PAPER HOLDER & SOAP DISH THROUGHOUT

22Nov18 Note:

ELECTRICAL

1 - STANDARD DINING ROOM LIGHT TO BE CENTERED BETWEEN LIVING AND DINING ROOM

22Nov18 Note:

HARDWOOD FLOORING

1 - LAMINATE -UPGRADE TO LEXINGTON SERIES IN LIEU OF STANDARD LAMINATE

22Nov18 Note:

MIRRORS AND GLASS

1 - FRAMELESS GLASS SHOWER DOOR FOR 5 FOOT PAN - Chrome knob

22Nov18 Note: Master Ensuite

PLUMBING

3 - MOEN BATHROOM ACCESSORIES - MASON CHROME - TOWEL RING #YB8086 - PRICE IS EACH

22Nov18 Note: ALL BATHROOMS

3 - MOEN BATHROOM ACCESSORIES - MASON CHROME - TOWEL BAR 24" #YB8094/YB8000 - PRICE IS EACH

22Nov18 Note: ALL BATHROOMS

3 - MOEN BATHROOM ACCESSORIES - MASON CHROME - PAPER HOLDER #YB8099/YB8000 - PRICE IS EACH

22Nov18 Note: ALL BATHROOMS

1 - WASHROOM - 3 PIECE ROUGH-IN IN BASEMENT

25Oct18 Note:

PROMOTIONAL

1 - LESS BALANCE OF CREDIT FROM PURCHASER EXTRA SHEET IN OFFER

22Nov18 Note:

1 - PARTIAL REDEMPTION OF PROMOTIONAL PACKAGE \$4360.00 BALANCE FORWARD TO BE USED AT A LATER DATE. ORIGINAL PROMOTIONAL PACKAGE OF \$5000.00 AS PER SCHEDULE PE

25Oct18 Note:

STAIRS AND RAILINGS

1 - STAINED HANDRAIL, TREADS, RISERS AND STRINGER EXCLUDING PICKETS (FOR IRON PICKETS) - STANDARD STAIRCASE

- PRICE IS PER SET

22Nov18 Note:

RECEIVED NOV 22 2018

CONSTRUCTION SUMMARY

Sharon Village 2 - Secondo Vales Estates Inc.

PURCHASERS: LAI MEI CHAN and CHEUK WING LAU

TEL:

LOT / PHASE Block 51 TH 3 / 2	REG. PLAN # 65M-4626	HOUSE TYPE Holland 3A Elev 1		
1 - STAIRCASE - EUROLINE 1 IRON PICKETS - BLACK 22Nov18 Note:				

EXTRAS AS PER OFFER

Five (5) White Appliances as per PE Appliances Worksheet Note:	
The Purchaser acknowledges that the Purchase Price is inclusive of all credits and promotional packages available at the time of purchase. Worksheet Note:	
(5) The Vendor agrees that notwithstanding any other term or provision in this Agreement included in the Purchase Price and in addition to those items detailed in Schedule GP to the Agreement of Purchase and Sale, the Purchaser is entitled to a credit of Worksheet Note:	

This Document is Extremely Time Sensitive - Printed 22 Nov 18 at 10:51

Purchasers: LAI MEI CHAN & CHEUK WING LAU

Property: Block 51 TH 3

Telephone Res. / Bus: /

Project: Secondo Vales Estates Inc.

Decor Advisor: Candace Forza

Model and Elevation: Holland 3A Elev 1

Lock Date: 22-Nov-18

22-Nov-18

Plan #: 65M-4626

Layout Changes: ☐ Yes ☒ NoSketch Attached: ☒ Yes ☐ NoExterior Colour Scheme:

1. Cabinetry

	Style and Colour	Hardware
Kitchen / Breakfast	RICHMOND W823XZ4	2004
Laundry Room	BASEMENT	N/A
Powder Room	SABRA CAROB 1045	1001
Master Ensuite Bathroom	MONACO W821XZ4	1001
Main Bathroom	MONACO W823XZ4	1001
	N/A	N/A
	N/A	N/A
	N/A	N/A
	N/A	N/A
	N/A	N/A

Appliances:

Built In Appliances ☐ Yes ☒ NoSlide In Stove ☐ Yes ☒ No

Dishwasher Cabinet

☐ Closed ☒ Open41" Upper Cabinets ☒ Yes ☐ No

Please NOTE: Standard Cabinet Height is 30"

Stove Opening

NOTE: If not specified, opening will be set to builder's standard opening of approximately 30" width

Fridge Opening

NOTE: If not specified, opening will be set to builder's standard opening of approximately 37" width x 74" height

** Refer to Construction Summary

2. Counters

	Counter	Edge
Kitchen / Breakfast	LAMINATE-CARRARA BIANCO 6696-46	
Laundry Room	N/A	
Powder Room	LAMINATE-WHITE TIGRIS 4783-60	
Master Ensuite Bathroom	LAMINATE-CALCUTTA MARBLE 4925K-07	
Main Bathroom	LAMINATE-INUK SHUK GREY P-344 LM	
	N/A	
	N/A	
	N/A	
	N/A	

** Refer to Construction Summary

Purchasers: LAI MEI CHAN & CHEUK WING LAU
Telephone Res. / Bus: /
Decor Advisor: Candace Forza
Lock Date: 22-Nov-18

Property: Block 51 TH 3
Project: Secondo Vales Estates Inc.
Model and Elevation: Holland 3A Elev 1
Plan #: 65M-4626

3. Ceramic Flooring

		At a 45	Threshold-If App.
Entrance Vestibule	TILE-PALLISANDRO LTE GREY-12X24	<input type="checkbox"/>	
Main Hall	N/A	<input type="checkbox"/>	
Kitchen / Breakfast	TILE-PALLISANDRO LTE GREY-12X24	<input type="checkbox"/>	METAL STRIP
Laundry Room	N/A	<input type="checkbox"/>	
Powder Room	TILE-PALLISANDRO LTE GREY-12X24	<input type="checkbox"/>	METAL STRIP
Master Ensuite Bathroom	TILE-SIENA GREY-13X13	<input type="checkbox"/>	METAL STRIP
Main Bathroom	TILE-BEACH LIGHT GREY-13X13	<input type="checkbox"/>	METAL STRIP
LOWER LANDING	TILE-PALLISANDRO LTE GREY-12X24	<input type="checkbox"/>	
	N/A	<input type="checkbox"/>	
	N/A	<input type="checkbox"/>	
	N/A	<input type="checkbox"/>	

** Refer to Construction Summary

4. Ceramic Wall Tile

Master Ensuite Bathroom	Selection	Describe
Tub Deck Wall	N/A	
Tub Deck	N/A	
Tub Deck Skirt	N/A	
Shower Stall	TILE-NATURALE GRIGIO-8X10	***LAID HORIZONTALLY***
Bathtub Enclosure Walls	N/A	
Main Bathroom	TILE-GOLF GRIGIO-8X10	***LAID HORIZONTALLY***
LOWER LANDING	N/A	
	N/A	
	N/A	
	N/A	
	N/A	
Kitchen Backsplash	N/A	

** Refer to Construction Summary - STANDARD GROUT THROUGHOUT UNLESS SPECIFIED

5. Plumbing Fixtures

All Bathrooms	White
	N/A
	N/A
	N/A
	N/A
	N/A

Whirlpool ☐ N/A ☐ Yes ☒ No

Dishwasher Rough-In ☒ Yes ☐ No

Waterline for Fridge ☐ Yes ☒ No

** Refer to Construction Summary

6. Trim Carpentry

Interior Doors	CARRARA-SMOOTH
Interior Trim	As Per Construction Specifications
Door Handles	As Per Construction Specifications
Exterior Front Door Handle	As Per Construction Specifications

** Refer to Construction Summary

Initials:

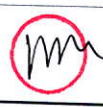
Purchasers: LAI MEI CHAN & CHEUK WING LAU

Property: Block 51 TH 3

Telephone Res. / Bus: /

Project: Secondo Vales Estates Inc.

Decor Advisor: Candace Forza

Model and Elevation: Holland 3A Elev 1

Lock Date: 22-Nov-18

22-Nov-18

Plan #: 65M-4626

7. Other Flooring

Main Hall	LAMINATE-LEXINGTON - HAZELWOOD OAK TL-21016-M	
Living Room	LAMINATE-LEXINGTON - HAZELWOOD OAK TL-21016-M	
Dining Room	LAMINATE-LEXINGTON - HAZELWOOD OAK TL-21016-M	
Family Room	LAMINATE-LEXINGTON - HAZELWOOD OAK TL-21016-M	
Den / Library / Study	N/A	
Basement Landing(If Applies)	N/A	
Lower Landing (If Applies)	TILE	
Upper Landing	LAMINATE-LEXINGTON - HAZELWOOD OAK TL-21016-M	
Upper Hall	CARPET-BEAULIEU - A4447 WEBSTER SDN - COMET GREY 86533	
Master Bedroom	CARPET-BEAULIEU - A4447 WEBSTER SDN - COMET GREY 86533	
Bedroom #2	CARPET-BEAULIEU - A4447 WEBSTER SDN - COMET GREY 86533	
Bedroom #3	CARPET-BEAULIEU - A4447 WEBSTER SDN - COMET GREY 86533	
Bedroom #4	N/A	
Bedroom #5	N/A	
	N/A	
	N/A	
	N/A	
	N/A	
	N/A	
Underpad	Type	Area
	STANDARD	SECOND FLOOR

** Refer to Construction Summary

8. Railings and Pickets

Railing Type	AS PER CONSTRUCTION SPECIFICATIONS	Colour	TORLYS HAZELWOOD OAK
Picket Type	EUROLINE 1	Colour	BLACK
Stringer / Riser	AS PER CONSTRUCTION SPECIFICATIO	Colour	TORLYS HAZELWOOD OAK
Treads	AS PER CONSTRUCTION SPECIFICATIO	Colour	TORLYS HAZELWOOD OAK
Red Oak Stairs with Semi Gloss Finish			<input checked="" type="radio"/> Yes <input type="radio"/> No

** Refer to Construction Summary

9. Wall Paint Flat Finish

Main & Upper Hall	22 WARM GREY	Master Bedroom	22 WARM GREY
Living Room	22 WARM GREY	Bedroom #2	22 WARM GREY
Dining Room	22 WARM GREY	Bedroom #3	22 WARM GREY
Kitchen / Breakfast	22 WARM GREY	Bedroom #4	N/A
Family Room	22 WARM GREY	Bedroom #5	N/A
Powder Room	22 WARM GREY	Master Ensuite	22 WARM GREY
Laundry Room	N/A	Main Bathroom	22 WARM GREY
Den/Library	N/A		N/A
Trim Paint-Semi Gloss	BIRCH WHITE		N/A
	N/A		N/A
	N/A		N/A
Smooth Ceilings First Floor	<input type="radio"/> Yes		N/A
	<input checked="" type="radio"/> No		

** Refer to Construction Summary

Initials:

Purchasers: LAI MEI CHAN & CHEUK WING LAU

Property: Block 51 TH 3

Telephone Res. / Bus: /

Project: Secondo Vales Estates Inc.

Decor Advisor: Candace Forza

Model and Elevation: Holland 3A Elev 1

Lock Date: 22-Nov-18

22-Nov-18

Plan #: 65M-4626

10. Plaster Mouldings and Medallions

Entrance Vestibule	N/A	N/A	Kitchen/Breakfast	N/A	N/A
Main Hall	N/A	N/A	Den/Library	N/A	N/A
Living Room	N/A	N/A	Lower Landing	N/A	N/A
Dining Room	N/A	N/A		N/A	N/A
Family Room	N/A	N/A		N/A	N/A

** Refer to Construction Summary

11. Fireplace

Living Room			Family Room			Other Room - Specify		
Purchased	As Per Plan	N/A	Purchased	As Per Plan	N/A	Purchased	As Per Plan	N/A
<input type="radio"/>	<input type="radio"/>	<input checked="" type="radio"/>	<input type="radio"/>	<input type="radio"/>	<input checked="" type="radio"/>	<input type="radio"/>	<input type="radio"/>	<input checked="" type="radio"/>
Fireplace Type	N/A		N/A	N/A		N/A	N/A	
Mantle Type	N/A		N/A	N/A		N/A	N/A	
Colour / Stain	N/A		N/A	N/A		N/A	N/A	
Surround	N/A		N/A	N/A		N/A	N/A	
Hearth	N/A		N/A	N/A		N/A	N/A	

** Refer to Construction Summary

12. Heating and Air Conditioning

Air Conditioning	NO	Gas Provisions Stove	NO
Gas Provisions Dryer	NO	Gas Provisions Barbecue	NO
Comment			

** Refer to Construction Summary

13. Electrical

Plugs and Switches	<input checked="" type="radio"/> White	DECOR	Above Kitchen Cabinet Light	<input type="radio"/> Yes <input checked="" type="radio"/> No
Hood Fan	STANDARD WHITE		Below Kitchen Cabinet Light	<input type="radio"/> Yes <input checked="" type="radio"/> No
Appliances	Built in Cooktop	Built in Oven	Gas Stove	Microwave
	<input type="radio"/> Yes <input checked="" type="radio"/> No	<input type="radio"/> Yes <input checked="" type="radio"/> No	<input type="radio"/> Yes <input checked="" type="radio"/> No	<input type="radio"/> Yes <input checked="" type="radio"/> No
Dishwasher Rough-in	Yes			

** Refer to Construction Summary

14. General Comments

** Refer to Construction Summary

Disclaimers and Notes

- Colours of all materials are as close as possible to builder's selection, but not necessarily identical due to variances in manufacturing.
- Any extras listed above are null and void unless accompanied by a separate invoice/amendment. Said invoice must be paid in full.
- The Purchaser agrees that this colour selection is final and that no changes will be permitted, unless required by the Vendor.
- The Purchaser acknowledges reading and accepting document which contains other miscellaneous disclaimers.

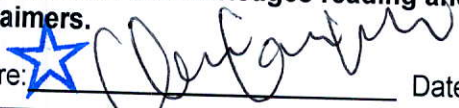
Signature: 

Date: Nov. 22, 2018

Signature: 

Date: Nov. 22, 2018

Kitchen
Hood Fan

Secondo
Th 3 BIK 51

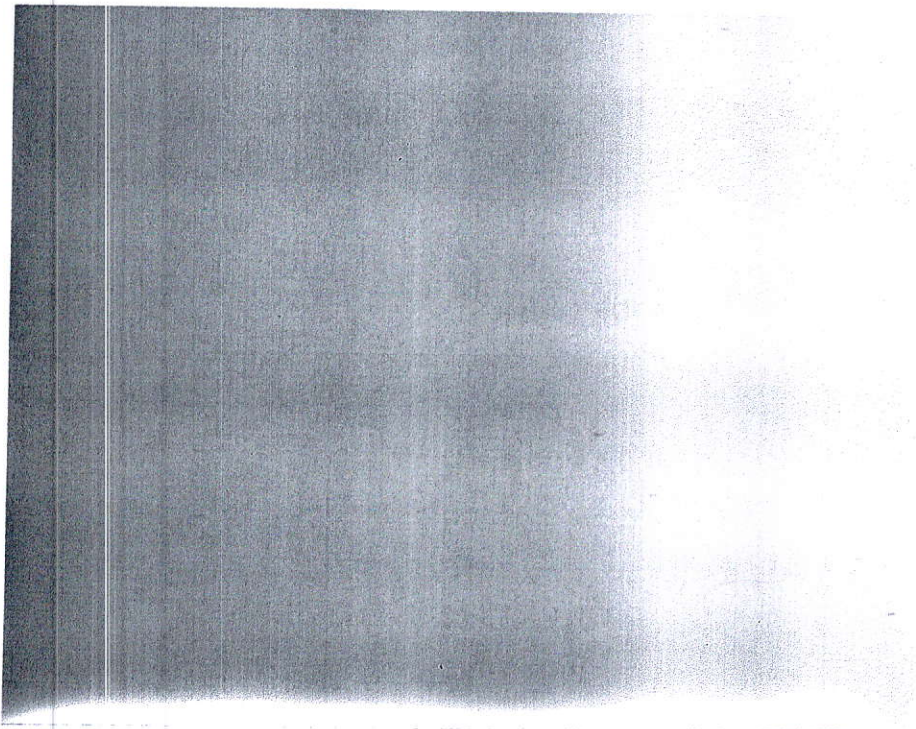

✓
EH13

RANGE HOOD

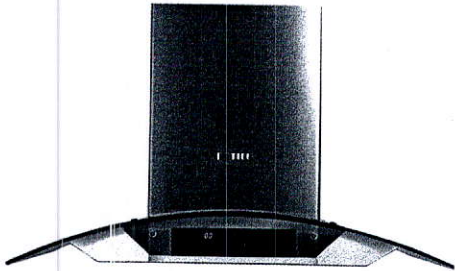

Features

- Built-in air inlet design for quick extraction
- Stainless Steel and Tempered Glass Surface
- Easy to clean filter
- Equipped with Gas & Heat Sensor that switches hood on automatically when gas or high temperature is detected.
- High definition fingertip touch display

6" Vent as per purchaser

Specification

Certification:	ETL
Product Size(in) W*D*H:	29 ⁹ / ₁₆ *20 ¹ / ₈ * (21 ¹ / ₁₆ -35 ⁵ / ₈)
Noise Level(dB(A)):	58



Delete Cabinetry
Above Stove

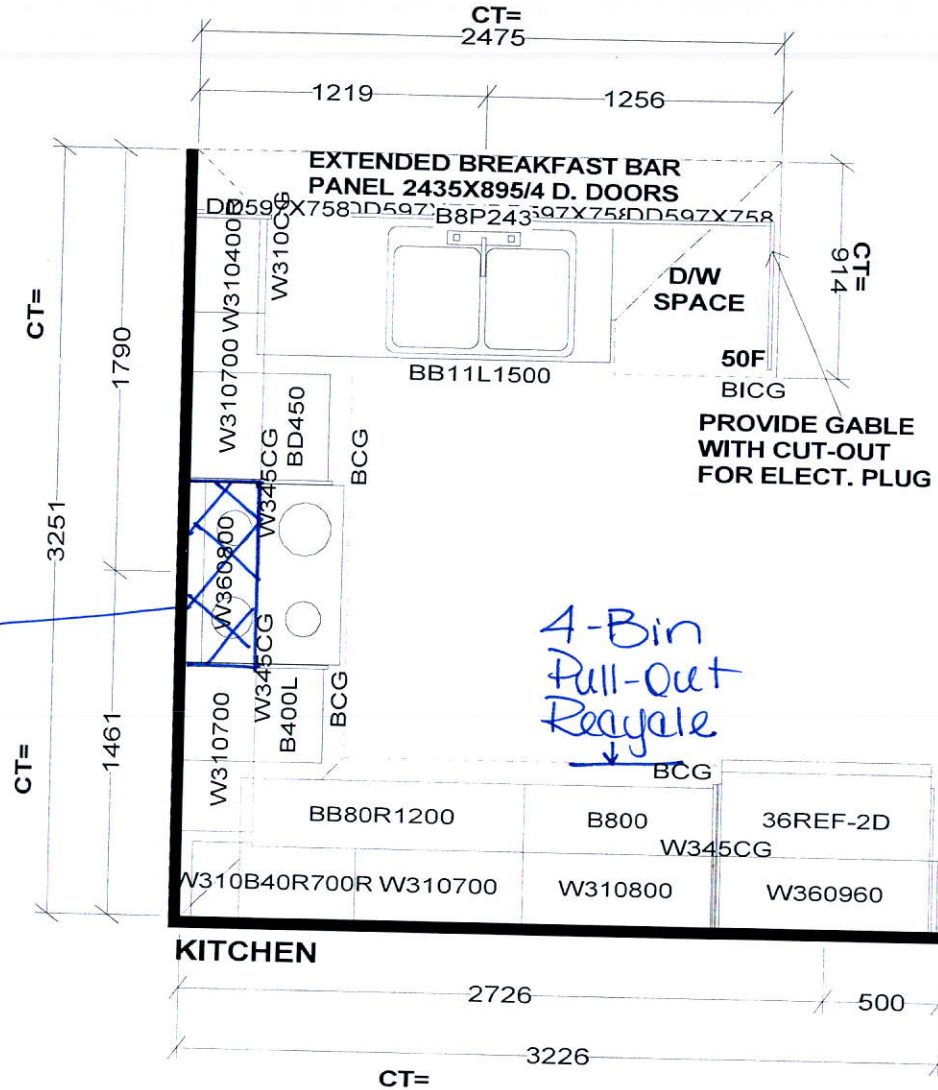

Selba Industries

W W DTH W H GHT W C N T F L H G H T D W Y H S T C E N T 2 X 4 V E N T B O X C O V E R

STANDARD FEATURES:

1040MM HIGH UPPER CABINETS
LAMINATE KITCHEN & VANITY TOPS
DISHWASHER SPACE
DUMMY DOORS ON EXPOSED BACKS

This drawing is the intellectual property of
SELBA INDUSTRIES INC. and is an
original design which must not be released
or copied unless applicable fee has been
paid or job order placed.



JOB NUMBER:
BUILDER: GREENPARK
SITE NAME: SECONDO VALES
MODEL: HOLLAND 3AX ELEV 1,1A,2
LOT #:
DESIGNER: KS
DATE: MAR 22 18

HOLLAND 3A | 1,826 SQ.FT.

