



CONSTRUCTION SUMMARY

Saddle Ridge (G) - Lecco Ridge Developments Inc.

PURCHASERS: PAUL ARTHUR OUELLETTE and TU QUYEN OUELLETTE

TEL:

LOT / PHASE 93 / 1	REG. PLAN # 20M-1184	HOUSE TYPE Juniper 7 Elev 1		
-----------------------	-------------------------	--------------------------------	--	--

CABINETRY

1 - LIGHT VALENCE - KITCHEN 31Jan18 Note:	
1 - VANITY - UPGRADE 2 - ENSUITE BATHROOM 31Jan18 Note: MASTER ENSUITE BATHROOM	
1 - CABINETRY - UPGRADE 2 - POWDER ROOM 31Jan18 Note:	

CABINETRY ACCESSORIES

1 - KITCHEN CABINETRY UPPER - ANGLED CORNER CABINET - FITS TALL UPPER CABINETS - PER UNIT - STANDARD 31Jan18 Note:	
2 - KITCHEN CABINETRY BASE - SPICE WIRE PULLOUT - PRICE IS EACH 31Jan18 Note: INSTALLED ON EITHER SIDE OF RANGE	
1 - PANTRY UNIT UPGRADE - TO GO FROM 300MM TO 600MM DEEP - PRICE IS PER FOOT - UPGRADE 5 31Jan18 Note:	
1 - KITCHEN CABINETRY UPPER - FULL DEPTH ABOVE FRIDGE - WITH GABLES - 600MM - PRICE IS EACH - UPGRADE 5 31Jan18 Note:	
1 - KITCHEN CABINETRY BASE - POT/PAN DRAWERS (CABINET) - UPGRADE 5 31Jan18 Note:	
1 - KITCHEN CABINETRY BASE - RECYCLE PULLOUT 4 BIN - PRICE IS EACH 31Jan18 Note:	

CONSTRUCTION

1 - PLEASE NOTE THAT NO FURTHER STRUCTURAL CHANGES WILL BE PERMITTED. 23Jan17 Note:	
1 - BASEMENT 8 FOOT 6 INCH CONCRETE POUR - MEASURED FROM TOP OF FOOTING TO TOP OF FOUNDATION WALL 23Jan17 Note:	
1 - FIRST FLOOR INCREASE CEILING HEIGHT FROM 9 FEET TO 10 FEET 23Jan17 Note: The ceiling height is measured from the top of the unfinished subfloor to underside of the unfinished ceiling above before finishes and excluding bulkheads and drop ceilings as per plan.	

COUNTER TOP

1 - HARD SURFACE COUNTERTOP - ENSUITE 31Jan18 Note: MASTER ENSUITE BATHROOM	
1 - HARD SURFACE COUNTERTOP - POWDER ROOM 31Jan18 Note:	
1 - HARD SURFACE COUNTERTOP - KITCHEN 31Jan18 Note:	

DOORS AND TRIM

1 - CS310 BB112 CASING & B5710 BASEBOARDS 31Jan18 Note:	
--	--

ELECTRICAL

1 - PLUG - ELECTRICAL PLUG 31Jan18 Note: KITCHEN	
2 - POT LIGHT - EXTERIOR - SOFFIT MOUNT - REGULAR VOLTAGE 31Jan18 Note:	

RECEIVED JAN 31 2018

CONSTRUCTION SUMMARY
Saddle Ridge (G) - Lecco Ridge Developments Inc.

PURCHASERS: PAUL ARTHUR OUELLETTE and TU QUYEN OUELLETTE

TEL:

LOT / PHASE	REG. PLAN #	HOUSE TYPE		
93 / 1	20M-1184	Juniper 7 Elev 1		
1 - PLUG - ELECTRICAL PLUG - TO BE INSTALLED OVER FIREPLACE 31Jan18 Note:				
1 - STANDARD DINING ROOM LIGHT TO BE CENTERED BETWEEN LIVING AND DINING ROOM 31Jan18 Note:				
1 - KITCHEN - VALANCE LIGHTING - LED LIGHTING 31Jan18 Note:				
1 - PLUG - ELECTRICAL PLUG 19Sep17 Note: ADD PLUG ON ISLAND				
1 - RELOCATE STANDARD KITCHEN LIGHT TO BE CENTERED OVER ISLAND 19Sep17 Note:				
1 - PLUG - ELECTRICAL PLUG WITH GFI AND SWITCH - FOR FESTIVE LIGHTING 19Sep17 Note:				
6 - POT LIGHT - EXTERIOR - SOFFIT MOUNT - REGULAR VOLTAGE 19Sep17 Note:				
2 - LIGHT AND SWITCH - NO FIXTURE INCLUDED 19Sep17 Note: ADD LIGHT IN BOTH FIRST FLOOR CLOSETS				
13 - POT LIGHT - LOW VOLTAGE LED - FIRST FLOOR INSTALLATION 19Sep17 Note:				

FIREPLACE AND ACCESSORIES

1 - GAS LINE ROUGH-IN FOR STOVE (INCLUDES ELECTRICAL OUTLET) - FIRST FLOOR 31Jan18 Note:	
1 - GAS LINE ROUGH-IN FOR DRYER (INCLUDES ELECTRICAL PLUG) - SECOND FLOOR 31Jan18 Note:	
1 - GAS LINE ROUGH-IN FOR BARBECUE - FIRST FLOOR 31Jan18 Note:	

HARDWOOD FLOORING

1 - KITCHEN - GROUP A SERIES 6 1/2 INCH STAINED HARDWOOD FLOORING - IN LIEU OF STANDARD TILE 31Jan18 Note:	
1 - HARDWOOD – GROUP A SERIES 6 1/2 INCH - IN LIEU OF 2 1/4 INCH NATURAL RED OAK - - FIRST FLOOR COMPLETE 31Jan18 Note:	
1 - LAMINATE -UPGRADE TO CLASSIC PLUS SERIES IN LIEU OF STANDARD LAMINATE 31Jan18 Note:	

PLUMBING

1 - WATER LINE FOR FRIDGE - ROUGH-IN ONLY 31Jan18 Note:	
3 - SINK - UNDERMOUNT SINK - CONTRAC COLLETTE #4220CIY 31Jan18 Note: MASTER BATHROOM & POWDER ROOM	
1 - SINK - UNDERMOUNT SINK - BLANCO PRECIS SILGRANIT U2 31Jan18 Note: KITCHEN - WHITE # 401705	

PROMOTIONAL

1 - LESS CREDIT FROM PURCHASER EXTRA SHEET IN OFFER 23Jan17 Note:	
--	--

CONSTRUCTION SUMMARY

Saddle Ridge (G) - Lecco Ridge Developments Inc.

PURCHASERS: PAUL ARTHUR OUELLETTE and TU QUYEN OUELLETTE

TEL:

LOT / PHASE 93 / 1	REG. PLAN # 20M-1184	HOUSE TYPE Juniper 7 Elev 1		
-----------------------	-------------------------	--------------------------------	--	--

STAIRS AND RAILINGS

1 - STAINED HANDRAIL, NOSING AND TREADS WITH PAINTED PICKETS, RISERS AND STRINGER WITH-STANDARD STAIRCASE - PRICE IS PER SET 31Jan18 Note:	
--	---

EXTRAS AS PER OFFER

The Vendor agrees that notwithstanding any other term or provision in this Agreement included in the Purchase Price and in addition to those items detailed in Schedule GP to the Agreement of Purchase and Sale, the Purchaser is entitled to a credit of Ten Worksheet Note:	
The Purchaser acknowledges that the Purchase Price is inclusive of all credits and promotional packages available at the time of purchase. Worksheet Note:	

This Document is Extremely Time Sensitive - Printed 31 Jan 18 at 16:26

Purchasers:PAUL ARTHUR OUELLETTE & TU QUYEN OUEProperty: 93

Telephone Res. / Bus: /Project: Lecco Ridge Developments Inc.

Decor Advisor: Candace ForzaModel and Elevation: Juniper 7 Elev 1

Lock Date: 31-Jan-1831-Jan-18Plan #: 20M-1184

Layout Changes: ☒ Yes ☐ NoSketch Attached: ☒ Yes ☐ NoExterior Colour Scheme:

1. Cabinetry

	Style and Colour	Hardware
Kitchen / Breakfast	EVEREST WHITE	1001
Laundry Room	ELISSE	Standard
Powder Room	HAMPTON W821XZ4	1001
Master Ensuite Bathroom	HAMPTON W821XZ4	1001
Ensuite Bath - Bedroom 2	MONACO W350XZ4	1001
Ensuite Bath - Bedroom 3/4	MONACO W350XZ4	1001
	N/A	N/A
	N/A	N/A
	N/A	N/A

Appliances:

Built In Appliances ☐ Yes ☒ No

Slide In Stove ☐ Yes ☒ No

Dishwasher Cabinet ☐ Closed ☒ Open

41" Upper Cabinets ☒ Yes ☐ No

Please NOTE: Standard Cabinet Height is 30"

Stove Opening

NOTE: If not specified, opening will be set to builder's standard opening of approximately 30" width

Fridge Opening

NOTE: If not specified, opening will be set to builder's standard opening of approximately 37" width x 74" height

** Refer to Construction Summary

2. Counters

	Counter	Edge
Kitchen / Breakfast	QUARTZ-MOUNTAIN GREY	#320 PENCIL ROUND EDGE
Laundry Room	N/A	
Powder Room	QUARTZ-CALACATTA MICHAELANGELO	#320 PENCIL ROUND EDGE
Master Ensuite Bathroom	QUARTZ-BIANCO STARDUST	#320 PENCIL ROUND EDGE
Ensuite Bath - Bedroom 2	LAMINATE-WHITE CARRARA 4924-38	
Ensuite Bath - Bedroom 3/4	LAMINATE-WHITE CARRARA 4924-38	
	N/A	
	N/A	
	N/A	

** Refer to Construction Summary

Purchasers:

PAUL ARTHUR OUELLETTE & TU QUYEN OUE

Property: 93

Telephone Res. / Bus:

/

Project: Lecco Ridge Developments Inc.

Decor Advisor:

Candace Forza

Model and Elevation: Juniper 7 Elev 1

Lock Date:

31-Jan-18

31-Jan-18

Plan #: 20M-1184

3. Ceramic Flooring

		At a 45	Threshold-If App.
Entrance Vestibule	TILE-RAINBOW LIGHT GREY-13X13	<input type="checkbox"/>	METAL STRIP
Main Hall	STRIP	<input type="checkbox"/>	
Kitchen / Breakfast	STRIP	<input type="checkbox"/>	
Laundry Room	TILE-RAINBOW LIGHT GREY-13X13	<input type="checkbox"/>	METAL STRIP
Powder Room	TILE-RAINBOW LIGHT GREY-13X13	<input type="checkbox"/>	
Master Ensuite Bathroom	TILE-RAINBOW WHITE-13X13	<input type="checkbox"/>	METAL STRIP
Ensuite Bath - Bedroom 2	TILE-RAINBOW LIGHT GREY-13X13	<input type="checkbox"/>	METAL STRIP
Ensuite Bath - Bedroom 3/4	TILE-RAINBOW LIGHT GREY-13X13	<input type="checkbox"/>	METAL STRIP
MUDROOM	TILE-RAINBOW LIGHT GREY-13X13	<input type="checkbox"/>	
	N/A	<input type="checkbox"/>	
	N/A	<input type="checkbox"/>	

** Refer to Construction Summary

4. Ceramic Wall Tile

Master Ensuite Bathroom	Selection	Describe
Tub Deck Wall	N/A	
Tub Deck	N/A	
Tub Deck Skirt	N/A	
Shower Stall	TILE-STARDUST GREY-8X16	***LAID VERTICALLY***
Bathtub Enclosure Walls	N/A	
	N/A	
Ensuite Bath - Bedroom 2	TILE-BIANCO MATTE-8X16	
Ensuite Bath - Bedroom 3/4	TILE-BIANCO MATTE-8X16	
	N/A	
	N/A	
Kitchen Backsplash	N/A	

** Refer to Construction Summary - STANDARD GROUT THROUGHOUT UNLESS SPECIFIED

5. Plumbing Fixtures

All Bathrooms

White

N/A

N/A

N/A

N/A

N/A

Whirlpool

N/A

☐ Yes

☒ No

Dishwasher Rough-In

☒ Yes

☐ No

Waterline for Fridge

☒ Yes

☐ No

** Refer to Construction Summary

6. Trim Carpentry

Interior Doors	CLASSIQUE
Interior Trim	CS310 BB112 CASING & B5710 BASEBOARDS
Door Handles	As Per Construction Specifications
Exterior Front Door Handle	As Per Construction Specifications

** Refer to Construction Summary

Purchasers:

PAUL ARTHUR OUELLETTE & TU QUYEN OUE

Property: 93

Telephone Res. / Bus: /

Project: Lecco Ridge Developments Inc.

Decor Advisor: Candace Forza

Model and Elevation: Juniper 7 Elev 1

Lock Date: 31-Jan-18

31-Jan-18

Plan #: 20M-1184

7. Other Flooring

Main Hall	STRIP-MIRAGE-RED OAK-CASHMERE-GRAPHITE-6 1/2"
Living Room	STRIP-MIRAGE-RED OAK-CASHMERE-GRAPHITE-6 1/2"
Dining Room	STRIP-MIRAGE-RED OAK-CASHMERE-GRAPHITE-6 1/2"
Family Room	STRIP-MIRAGE-RED OAK-CASHMERE-GRAPHITE-6 1/2"
Den / Library / Study	STRIP-MIRAGE-RED OAK-CASHMERE-GRAPHITE-6 1/2"
Basement Landing(If Applies)	N/A
Lower Landing (If Applies)	N/A
Upper Landing	STRIP-MIRAGE-RED OAK-CASHMERE-GRAPHITE-6 1/2"
Upper Hall	LAMINATE-CLASSIC PLUS - OLD OAK DARK QS-UM1383
Master Bedroom	LAMINATE-CLASSIC PLUS - OLD OAK DARK QS-UM1383
Bedroom #2	LAMINATE-CLASSIC PLUS - OLD OAK DARK QS-UM1383
Bedroom #3	LAMINATE-CLASSIC PLUS - OLD OAK DARK QS-UM1383
Bedroom #4	LAMINATE-CLASSIC PLUS - OLD OAK DARK QS-UM1383
Bedroom #5	N/A
KITCHEN	STRIP-MIRAGE-RED OAK-CASHMERE-GRAPHITE-6 1/2"
	N/A
	N/A
Underpad	Type Area
	N/A N/A

** Refer to Construction Summary

8. Railings and Pickets

Railing Type	As Per Construction Specifications	Colour	MIRAGE GRAPHITE
Picket Type	As Per Construction Specifications	Colour	Birch White
Stringer / Riser	As Per Construction Specifications	Colour	Birch White
Treads	As Per Construction Specifications	Colour	MIRAGE GRAPHITE
	Red Oak Stairs with Semi Gloss Finish		<input checked="" type="radio"/> Yes <input type="radio"/> No

** Refer to Construction Summary

RECEIVED NOV 15 2018

9. Wall Paint Flat Finish

Main & Upper Hall	43 BIRCH WHITE	Master Bedroom	43 BIRCH WHITE
Living Room	43 BIRCH WHITE	Bedroom #2	43 BIRCH WHITE
Dining Room	43 BIRCH WHITE	Bedroom #3	43 BIRCH WHITE
Kitchen / Breakfast	43 BIRCH WHITE	Bedroom #4	43 BIRCH WHITE
Family Room	43 BIRCH WHITE	Bedroom #5	N/A
Powder Room	43 BIRCH WHITE	Master Ensuite	43 BIRCH WHITE
Laundry Room	43 BIRCH WHITE	Ensuite Bath - Bedroom 2	43 BIRCH WHITE
Den/Library	43 BIRCH WHITE	Ensuite Bath - Bedroom 3/4	43 BIRCH WHITE
Trim Paint-Semi Gloss	BIRCH WHITE	MUDROOM	43 BIRCH WHITE
	N/A		N/A
	N/A		N/A
Smooth Ceilings First Floor	<input type="radio"/> Yes <input checked="" type="radio"/> No		

** Refer to Construction Summary

Purchasers: PAUL ARTHUR OUELLETTE & TU QUYEN OUEProperty: 93
Telephone Res. / Bus: / Project: Lecco Ridge Developments Inc.
Decor Advisor: Candace Forza Model and Elevation: Juniper 7 Elev 1
Lock Date: 31-Jan-18 31-Jan-18 Plan #: 20M-1184

10. Plaster Mouldings and Medallions

Entrance Vestibule	N/A	N/A	Kitchen/Breakfast	N/A	N/A
Main Hall	N/A	N/A	Den/Library	N/A	N/A
Living Room	N/A	N/A	Lower Landing	N/A	N/A
Dining Room	N/A	N/A		N/A	N/A
Family Room	N/A	N/A			

**** Refer to Construction Summary****11. Fireplace**

	Living Room			Family Room			Other Room - Specify		
	Purchased	As Per Plan	N/A	Purchased	As Per Plan	N/A	Purchased	As Per Plan	N/A
Fireplace Type	<input type="radio"/>	<input type="radio"/>	<input checked="" type="radio"/>	<input type="radio"/>	<input checked="" type="radio"/>	<input type="radio"/>	<input type="radio"/>	<input type="radio"/>	<input checked="" type="radio"/>
Mantle Type	N/A			FLAT ON WALL			N/A		
Colour / Stain	N/A			MANTLE M2-STANDARD			N/A		
Surround	N/A			AS PER CONSTRUCTION SPECIFICATIONS			N/A		
Hearth	N/A			GRIGIO CARNICO			N/A		
				NO			N/A		

**** Refer to Construction Summary****12. Heating and Air Conditioning**

Air Conditioning	NO	Gas Provisions Stove	YES
Gas Provisions Dryer	YES	Gas Provisions Barbecue	YES
Comment			

**** Refer to Construction Summary****13. Electrical**

Plugs and Switches	<input checked="" type="radio"/> White	DECOR	Above Kitchen Cabinet Light	<input type="radio"/> Yes	<input checked="" type="radio"/> No
Hood Fan	STANDARD WHITE		Below Kitchen Cabinet Light	<input checked="" type="radio"/> Yes	<input type="radio"/> No
Appliances	Built in Cooktop	Built in Oven	Gas Stove	Microwave	
	<input type="radio"/> Yes <input checked="" type="radio"/> No	<input type="radio"/> Yes <input checked="" type="radio"/> No	<input checked="" type="radio"/> Yes <input type="radio"/> No	<input type="radio"/> Yes <input checked="" type="radio"/> No	
Dishwasher Rough-in	Yes				

**** Refer to Construction Summary****14. General Comments****** Refer to Construction Summary****Disclaimers and Notes**

- Colours of all materials are as close as possible to builder's selection, but not necessarily identical due to variances in manufacturing.
- Any extras listed above are null and void unless accompanied by a separate invoice/amendment. Said invoice must be paid in full.
- The Purchaser agrees that this colour selection is final and that no changes will be permitted, unless required by the Vendor.
- The Purchaser acknowledges reading and accepting document which contains other miscellaneous disclaimers.

Signature:  Date: _____ Signature: _____ Date: _____

Gas Line for BBQ

Add Potlight

Add Plug

Relocate Std Light Above Island

Add Plug on Island

Add 6 Potlights

Add Light

Festive Plug

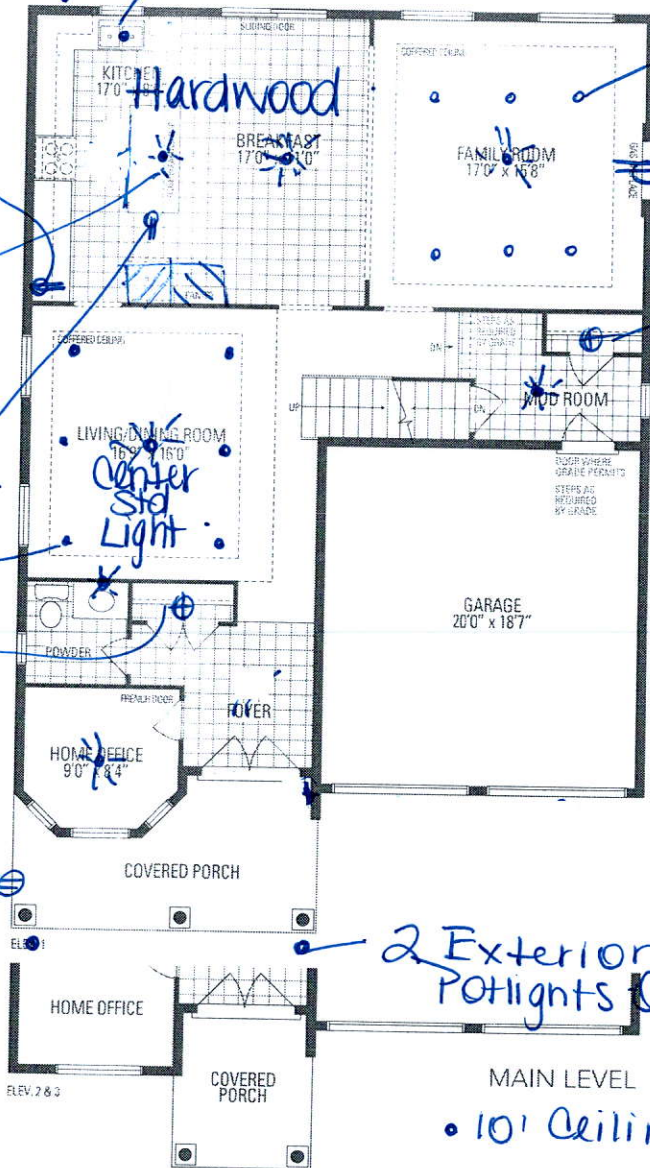

Add 6 Potlights

Add Plug Above Fireplace

Add Light

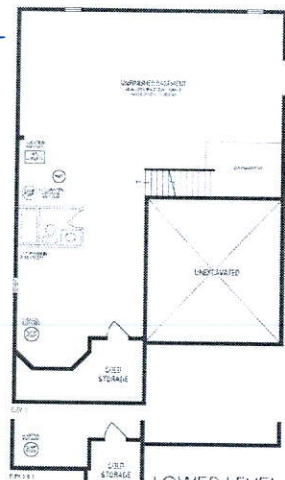

JUNIPER 7
3,093 sq.ft.

