

CONSTRUCTION SUMMARY



Mountainview Heights (G) - Russell Gardens Building Ltd.

PURCHASERS: RANJEET KAUR BAL and KARMJIT SINGH SMAGH

TEL: RES.: 416-602-0004

LOT / PHASE 134 / 2	REG. PLAN # 62M-1238	HOUSE TYPE Rosewood 6 Elev 3		
------------------------	-------------------------	---------------------------------	--	--

CABINETRY

1 - KITCHEN SOFT CLOSE CABINETS AND BLU MOTION DRAWERS - ALL CABINETS AND DRAWERS IN KITCHEN 22Aug18 Note:	
1 - VANITY - POWDER ROOM - UPGRADE 2 22Aug18 Note:	
1 - KITCHEN - DELETE CABINETS ABOVE STOVE - VENDOR WILL SUPPLY 6 INCH VENT AS PER CONSTRUCTION SPECIFICATIONS AND VENT MAY NOT BE IN THE APPROPRIATE LOCATION FOR INSTALLATION OF PURCHASER SUPPLIED VENT - PURCHASER TO SUPPLY OWN FAN AFTER CLOSING (TEMP. FAN MA 22Aug18 Note:	
1 - CABINETRY - KITCHEN - UPGRADE 2 22Aug18 Note:	

CABINETRY ACCESSORIES

1 - KITCHEN CABINETRY BASE - PULLOUT WIRE SPICE RACK - PRICE IS EACH 22Aug18 Note:	
1 - KITCHEN CABINETRY BASE - PIE CUT CORNER CABINET - BASE CABINETRY - UPGRADE 2 22Aug18 Note:	
1 - KITCHEN CABINETRY BASE - POT/PAN DRAWERS (CABINET) - UPGRADE 2 22Aug18 Note:	
1 - KITCHEN CABINETRY UPPER - GLASS DOOR - GROUP 2 GLASS - FINISHED INTERIOR - FITS TALL UPPER CABINETS - PRICE IS PER DOOR - UPGRADE 2 22Aug18 Note: Wire MESH	
1 - KITCHEN CABINETRY UPPER - ANGLED CORNER CABINET - FITS TALL UPPER CABINETS - PER UNIT - UPGRADE 2 22Aug18 Note:	
1 - KITCHEN CABINETRY - BUILT-IN MICROWAVE/OVEN COMBO - UPGRADE 2 22Aug18 Note: Specs. Attached	
1 - KITCHEN CABINETRY BASE - COOKTOP CABINET WITH POT DRAWERS (2 DRAWERS) - UPGRADE 2 - 36" Cooktop 22Aug18 Note: Specs. Attached	
3 - PANTRY UNIT UPGRADE - TO GO FROM 300MM TO 600MM DEEP - PRICE IS PER FOOT - UPGRADE 2 22Aug18 Note:	
1 - KITCHEN CABINETRY UPPER - FULL DEPTH ABOVE FRIDGE - WITH GABLES - 600MM - PRICE IS EACH - UPGRADE 2 22Aug18 Note:	
1 - KITCHEN CABINETRY - BUILT-IN FRIDGE CABINET - PRICE IS EACH - 42" Fridge 22Aug18 Note: Specs. Attached	

CERAMIC TILE

1 - KITCHEN, FOYER, POWDER ROOM TILES TO BE LAID ON A 45 DEGREE ANGLE 22Aug18 Note:	
1 - DELETE ALL CERAMIC BATHROOM ACCESSORIES - DELETE TOWEL BAR, PAPER HOLDER & SOAP DISH THROUGHOUT 22Aug18 Note:	
1 - TILE - UPGRADE 5 FLOOR TILE - - POWDER ROOM 22Aug18 Note:	
1 - TILE - UPGRADE 5 FLOOR TILE - - KITCHEN 22Aug18 Note:	
1 - TILE - UPGRADE 5 FLOOR TILE - - FOYER 22Aug18 Note:	



CONSTRUCTION SUMMARY

Mountainview Heights (G) - Russell Gardens Building Ltd.

PURCHASERS: RANJEET KAUR BAL and KARMJIT SINGH SMAGH

TEL: RES.: 416-602-0004

LOT / PHASE 134 / 2	REG. PLAN # 62M-1238	HOUSE TYPE Rosewood 6 Elev 3		
------------------------	-------------------------	---------------------------------	--	--

DOORS AND TRIM

20 - UPGRADE TO WINSTON SATIN NICKEL LEVERS THROUGHOUT 22Aug18 Note:	
---	--

ELECTRICAL

1 - BUILT IN OVEN AND COOKTOP PROVISION - PROVISION ONLY - ELECTRICAL ONLY 22Aug18 Note:	
1 - PLUG - ELECTRICAL PLUG - TO BE INSTALLED OVER FIREPLACE 17Jul18 Note:	
1 - 200 AMP ELECTRICAL SERVICE 17Jul18 Note:	

FIREPLACE AND ACCESSORIES

1 - GAS LINE ROUGH-IN FOR BARBECUE - FIRST FLOOR 22Aug18 Note:	
1 - GAS LINE ROUGH-IN FOR STOVE (INCLUDES ELECTRICAL OUTLET) - FIRST FLOOR 22Aug18 Note:	
1 - MANTEL - PAINTED - M6 - IN LIEU OF STANDARD MANTEL 22Aug18 Note:	

HARDWOOD FLOORING

1 - LAMINATE -UPGRADE TO LEXINGTON SERIES IN LIEU OF STANDARD LAMINATE 22Aug18 Note:	
1 - HARDWOOD – GROUP B SERIES 5 INCH - - UPPER HALL 22Aug18 Note:	
1 - HARDWOOD – GROUP B SERIES 5 INCH - IN LIEU OF 2 1/4 INCH NATURAL RED OAK - - FIRST FLOOR COMPLETE 22Aug18 Note:	

MIRRORS AND GLASS

1 - FRAMELESS GLASS SHOWER ENCLOSURE- MASTER ENSUITE WITH CHROME KNOB 17Jul18 Note:	
--	--

MISCELLANEOUS

1 - FURTHER VENDOR DISCOUNT 22Aug18 Note:	
--	--

PLUMBING

1 - WATER LINE FOR FRIDGE - ROUGH-IN ONLY 22Aug18 Note:	
--	--

PROMOTIONAL

1 - LESS CREDIT FROM PURCHASER EXTRA SHEET IN OFFER 22Aug18 Note:	
1 - PARTIAL REDEMPTION OF PROMOTIONAL PACKAGE \$4,040 BALANCE FORWARD \$5,960 TO BE USED AT A LATER DATE. ORIGINAL PROMOTIONAL PACKAGE OF \$10,000 AS PER SCHEDULE PE 17Jul18 Note:	

STAIRS AND RAILINGS

1 - EUROLINE R6-3- PEWTER 22Aug18 Note:	
--	--



CONSTRUCTION SUMMARY

Mountainview Heights (G) - Russell Gardens Building Ltd.

PURCHASERS: RANJEET KAUR BAL and KARMJIT SINGH SMAGH

TEL: RES.: 416-602-0004

LOT / PHASE 134 / 2	REG. PLAN # 62M-1238	HOUSE TYPE Rosewood 6 Elev 3		
------------------------	-------------------------	---------------------------------	--	--

I - V GROOVE HANDRAIL 22Aug18 Note:	
I - STAINED HANDRAIL, TREADS, RISERS AND STRINGER EXCLUDING PICKETS (FOR IRON PICKETS) - STANDARD STAIRCASE - PRICE IS PER SET 22Aug18 Note:	

EXTRAS AS PER OFFER

The Vendor agrees that notwithstanding any other term or provision in this Agreement included in the Purchase Price and in addition to those items detailed in Schedule GP to the Agreement of Purchase and Sale, the Purchaser is entitled to a credit of Ten Worksheet Note:	
The Purchaser acknowledges that the Purchase Price is inclusive of all credits and promotional packages available at the time of purchase. Worksheet Note:	

This Document is Extremely Time Sensitive - Printed 22 Aug 18 at 15:17



Purchasers: RANJEET KAUR BAL & KARMJIT SINGH SMAG

Property: 134

Telephone Res. / Bus: (416) 602-0004 /

Project: Russell Gardens Building Ltd.

Decor Advisor: Natalie Mancuso

Model and Elevation: Rosewood 6 Elev 3

Lock Date: 22-Aug-18

22-Aug-18

Plan #: 62M-1238

Layout Changes: ☐ Yes ☒ No

Sketch Attached: ☒ Yes ☐ No

Exterior Colour Scheme:

1. Cabinetry

	Style and Colour	Hardware
Kitchen / Breakfast	HAMPTON W823XZ4	1001
Laundry Room	ELISSE	Standard
Powder Room	HAMPTON W823XZ4	1001
Master Ensuite Bathroom	MONACO W350XZ4	1001
Ensuite Bath - Bedroom 2	MODENA WHITE	1001
Ensuite Bath - Bedroom 3	MONACO W350XZ4	1001
Ensuite Bath - Bedroom 4	MODENA WHITE	1001

Appliances:

Built In Appliances ☒ Yes ☐ No

Slide In Stove ☐ Yes ☒ No

Dishwasher Cabinet

☐ Closed ☒ Open

41" Upper Cabinets ☒ Yes ☐ No

Please NOTE: Standard Cabinet Height is 30"

Stove Opening

36"

NOTE: If not specified, opening will be set to builder's standard opening of approximately 30" width

Fridge Opening

42"

NOTE: If not specified, opening will be set to builder's standard opening of approximately 37" width x 74" height

\*\* Refer to Construction Summary

2. Counters

	Counter	Edge
Kitchen / Breakfast	LAMINATE-PALOMA POLAR 6698-46	
Laundry Room	N/A	
Powder Room	LAMINATE-PALOMA POLAR 6698-46	
Master Ensuite Bathroom	LAMINATE-PORTICO MARBLE 7735-58	
Ensuite Bath - Bedroom 2	LAMINATE-INUK SHUK GREY P-344 LM	
Ensuite Bath - Bedroom 3	LAMINATE-WHITE CARRARA 4924-38	
Ensuite Bath - Bedroom 4	LAMINATE-ELEMENTAL CONCRETE 8830-58	

\*\* Refer to Construction Summary

Initials:  

<b>Purchasers:</b>	RANJEET KAUR BAL & KARMJIT SINGH SMAG		<b>Property:</b> 134
<b>Telephone Res. / Bus:</b>	(416) 602-0004 /		<b>Project:</b> Russell Gardens Building Ltd.
<b>Decor Advisor:</b>	Natalie Mancuso	<b>Model and Elevation:</b>	Rosewood 6 Elev 3
<b>Lock Date:</b>	22-Aug-18	22-Aug-18	<b>Plan #:</b> 62M-1238

At a 45 Threshold-If App.

			At a 45° Threshold-If App.
Entrance Vestibule	TILE- GOTHAM DIAMOND LUX 24X24	@ 45°	✓
Main Hall	HARDWOOD		METAL STRIP THROUGHOUT
Kitchen / Breakfast	TILE- GOTHAM DIAMOND LUX 24X24	@ 45°	✓
Laundry Room	TILE- RAINBOW LIGHT GREY 13X13		
Powder Room	TILE- GOTHAM DIAMOND LUX 24X24	@ 45°	✓
Master Ensuite Bathroom	TILE- SIENA GREY 13X13		
Ensuite Bath - Bedroom 2	TILE- RAINBOW WHITE 13X13		
Ensuite Bath - Bedroom 3	TILE- RAINBOW LIGHT GREY 13X13		
Ensuite Bath - Bedroom 4	TILE- RAINBOW LIGHT GREY 13X13		

\*\* Refer to Construction Summary

Master Ensuite Bathroom	Selection	Describe
Tub Deck Wall		
Tub Deck		
Tub Deck Skirt		
Shower Stall	TILE- SAT CONCEPT NEVE 8X16	
Bathtub Enclosure Walls		
Ensuite Bath - Bedroom 2	TILE- LUC CONCEPT NEVE 8X16	
Ensuite Bath - Bedroom 3	TILE- SAT BLANC GROENLANDIA 8X16	
Ensuite Bath - Bedroom 4	TILE- SAT CONCEPT FERRO 8X16	

## Kitchen Backsplash

**\*\* Refer to Construction Summary - STANDARD GROUT THROUGHOUT UNLESS SPECIFIED**

**All Bathrooms**

**White**

**Whirlpool**

☐ Yes ☒ No

**Dishwasher Rough-In** ☒ Yes ☐ No

**Waterline for Fridge** ☒ Yes ☐ No

**\*\* Refer to Construction Summary**

Interior Doors	CLERMONT
Interior Trim	3" BB CASING WITH 5 1/4" BASEBOARD - COLONIAL
Door Handles	SATIN NICKEL LEVER
Exterior Front Door Handle	As Per Construction Specifications

**\*\* Refer to Construction Summary**

Initials:



Purchasers:

Telephone Res. / Bus:

Decor Advisor:

Lock Date:

RANJEET KAUR BAL & KARMJIT SINGH SMAG

(416) 602-0004 /

Natalie Mancuso

22-Aug-18

Property: 134

Project: Russell Gardens Building Ltd.

Model and Elevation: Rosewood 6 Elev 3

Plan #: 62M-1238

7. Other Flooring

Main Hall	HARDWOOD- MIRAGE 5" RED OAK - DRIFTWOOD- DURAMATT
Living Room	HARDWOOD- MIRAGE 5" RED OAK - DRIFTWOOD- DURAMATT
Dining Room	HARDWOOD- MIRAGE 5" RED OAK - DRIFTWOOD- DURAMATT
Family Room	HARDWOOD- MIRAGE 5" RED OAK - DRIFTWOOD- DURAMATT
Den / Library / Study	HARDWOOD- MIRAGE 5" RED OAK - DRIFTWOOD- DURAMATT
Basement Landing(If Applies)	
Lower Landing (If Applies)	TILE- RAINBOW LIGHT GREY 13X13
Upper Landing	HARDWOOD- MIRAGE 5" RED OAK - DRIFTWOOD- DURAMATT
Upper Hall	HARDWOOD- MIRAGE 5" RED OAK - DRIFTWOOD- DURAMATT
Master Bedroom	LAMINATE-LEXINGTON - HAZELWOOD OAK TL-21016-M
Bedroom #2	LAMINATE-LEXINGTON - HAZELWOOD OAK TL-21016-M
Bedroom #3	LAMINATE-LEXINGTON - HAZELWOOD OAK TL-21016-M
Bedroom #4	LAMINATE-LEXINGTON - HAZELWOOD OAK TL-21016-M
Bedroom #5	LAMINATE-LEXINGTON - HAZELWOOD OAK TL-21016-M

Underpad	Type	Area
----------	------	------

\*\* Refer to Construction Summary

8. Railings and Pickets

Railing Type	V-GROOVE	Colour	MIRAGE- DRIFTWOOD
Picket Type	EUROLINE R-6-3	Colour	PEWTER
Stringer / Riser	AS PER CONSTRUCTION SPECIFICATIO	Colour	MIRAGE- DRIFTWOOD
Treads	AS PER CONSTRUCTION SPECIFICATIO	Colour	MIRAGE- DRIFTWOOD
Red Oak Stairs with Semi Gloss Finish		<input checked="" type="radio"/> Yes	<input type="radio"/> No

\*\* Refer to Construction Summary

9. Wall Paint Flat Finish

Main & Upper Hall	22 WARM GREY	Master Bedroom	22 WARM GREY
Living Room	22 WARM GREY	Bedroom #2	22 WARM GREY
Dining Room	22 WARM GREY	Bedroom #3	22 WARM GREY
Kitchen / Breakfast	22 WARM GREY	Bedroom #4	22 WARM GREY
Family Room	22 WARM GREY	Bedroom #5	22 WARM GREY
Powder Room	22 WARM GREY	Master Ensuite	22 WARM GREY
Laundry Room	22 WARM GREY	Ensuite Bath - Bedroom 2	22 WARM GREY
Den/Library	22 WARM GREY	Ensuite Bath - Bedroom 3	22 WARM GREY
Trim Paint-Semi Gloss	BIRCH WHITE	Ensuite Bath - Bedroom 4	22 WARM GREY

Smooth Ceilings First Floor ☐ Yes

☒ No

\*\* Refer to Construction Summary

Initials:  

Purchasers: RANJEET KAUR BAL & KARMJIT SINGH SMAGProperty: 134  
Telephone Res. / Bus: (416) 602-0004 / Project: Russell Gardens Building Ltd.  
Decor Advisor: Natalie Mancuso Model and Elevation: Rosewood 6 Elev 3  
Lock Date: 22-Aug-18 22-Aug-18 Plan #: 62M-1238

**10. Plaster Mouldings and Medallions**

Entrance Vestibule		Kitchen/Breakfast	
Main Hall		Den/Library	
Living Room		Lower Landing	
Dining Room			
Family Room			

**\*\* Refer to Construction Summary****11. Fireplace**

Living Room	Family Room	Other Room - Specify
Purchased	Purchased	Purchased
As Per Plan	As Per Plan	As Per Plan
N/A	N/A	N/A
<input type="radio"/>	<input checked="" type="radio"/>	<input checked="" type="radio"/>
Fireplace Type	FLAT ON WALL	
Mantle Type	MANTLE M6	
Colour / Stain	AS PER CONSTRUCTION SPECIFICATIONS	
Surround	BIANCO	
Hearth	NO	

**\*\* Refer to Construction Summary****12. Heating and Air Conditioning**

Air Conditioning	NO	Gas Provisions Stove	YES
Gas Provisions Dryer	NO	Gas Provisions Barbecue	YES
Comment			

**\*\* Refer to Construction Summary****13. Electrical**

Plugs and Switches	<input checked="" type="radio"/> White	DECOR	Above Kitchen Cabinet Light	Yes <input checked="" type="radio"/> No <input type="radio"/>
Hood Fan	STANDARD WHITE		Below Kitchen Cabinet Light	Yes <input checked="" type="radio"/> No <input type="radio"/>
Appliances	Built in Cooktop	Built in Oven	Gas Stove	Microwave
	<input checked="" type="radio"/> Yes <input type="radio"/> No	<input checked="" type="radio"/> Yes <input type="radio"/> No	<input checked="" type="radio"/> Yes <input type="radio"/> No	<input checked="" type="radio"/> Yes <input type="radio"/> No
Dishwasher Rough-in	Yes			

**\*\* Refer to Construction Summary****14. General Comments****\*\* Refer to Construction Summary****Disclaimers and Notes**

- Colours of all materials are as close as possible to builder's selection, but not necessarily identical due to variances in manufacturing.
- Any extras listed above are null and void unless accompanied by a separate invoice/amendment. Said invoice must be paid in full.
- The Purchaser agrees that this colour selection is final and that no changes will be permitted, unless required by the Vendor.
- The Purchaser acknowledges reading and accepting document which contains other miscellaneous disclaimers.

Signature:  Date: Aug 22, 2018 Signature:  Date: \_\_\_\_\_



# INSTALLATION REQUIREMENTS

## Tools and Parts

Gather the required tools and parts before starting installation. Read and follow the instructions provided with any tools listed here.

### Tools Needed

- Level
- Drill with 1¼" (3.0 cm), ⅝" (9.5 mm), and ⅜" (7.9 mm) drill bits
- Pencil
- Wire stripper or utility knife
- Tape measure or ruler
- Pliers
- Caulking gun and weatherproof caulking compound
- Vent clamps
- Jigsaw or keyhole saw
- Flat-blade screwdriver
- Metal snips
- Phillips screwdriver

### Parts Needed

- Home power supply cable
- ½" (12.7 mm) UL listed or CSA approved strain relief
- UL listed wire connectors (3)

### For Vented Installations, You Will Also Need:

- 1 wall or roof cap
- Metal vent system

### For Non-Vented (Recirculating) Installations, You Will Also Need:

- Recirculation Kit Part Number W10692908 for non-vented (recirculating) installations only. See "Assistance or Service" section to order.
- 6" (15.2 cm) diameter round metal vent duct - length required is determined by ceiling height.

### Parts Supplied

Remove parts from packages. Check that all parts are included.

- Hood canopy assembly with ventilator and LED and halogen lights installed
- Vent transition with back draft dampers installed
- Metal grease filter(s)—depending on model and size
- Vent cover support bracket
- Mounting template
- 2-piece vent cover
- 4.2 x 8 screws (4)
- 5 x 45 mm mounting screws (6)
- D6.4 x 18 mm washers (2)
- 8 x 40 mm wall anchors (2)
- 10 x 60 mm wall anchors (4)
- 5.4 x 75 mm screws (for 10 x 60 mm wall anchors) (4)
- 3.5 x 9.5 mm sheet metal screws (2)
- T10 TORX®† adapter

†©TORX is a registered trademark of Acument Intellectual Properties, LLC.

## Location Requirements

**IMPORTANT:** Observe all governing codes and ordinances.

Have a qualified technician install the range hood. It is the installer's responsibility to comply with installation clearances specified on the model/serial/rating plate. The model/serial/rating plate is located behind the left filter on the rear wall of the vent hood.

Canopy hood location should be away from strong draft areas, such as windows, doors and strong heating vents.

Cabinet opening dimensions that are shown must be used. Given dimensions provide minimum clearance.

This range hood is recommended for use with cooktops with a maximum total rating of 65,000 BTUs or less.

Grounded electrical outlet is required. See "Electrical Requirements" section.

The canopy hood is factory-set for venting through the roof or wall. For non-vented (recirculating) installation see "For non-vented (recirculating) installation only" in the "Connect Vent System" section. Recirculation Kit Part Number W10692908 is available from your dealer or an authorized parts distributor.

All openings in ceiling and wall where canopy hood will be installed must be sealed.

### For Mobile Home Installations

The installation of this range hood must conform to the Manufactured Home Construction Safety Standards, Title 24 CFR, Part 328 (formerly the Federal Standard for Mobile Home Construction and Safety, Title 24, HUD, Part 280) or when such standard is not applicable, the standard for Manufactured Home Installation 1982 (Manufactured Home Sites, Communities and Setups) ANSI A225.1/NFPA 501A, or latest edition, or with local codes.

### Product Dimensions

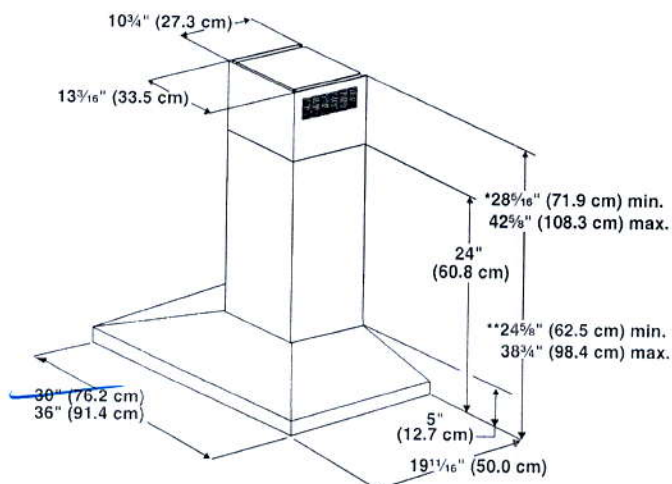

\*For non-vented (recirculating) installations

\*\*For vented installations

36"



### Cabinet Dimensions

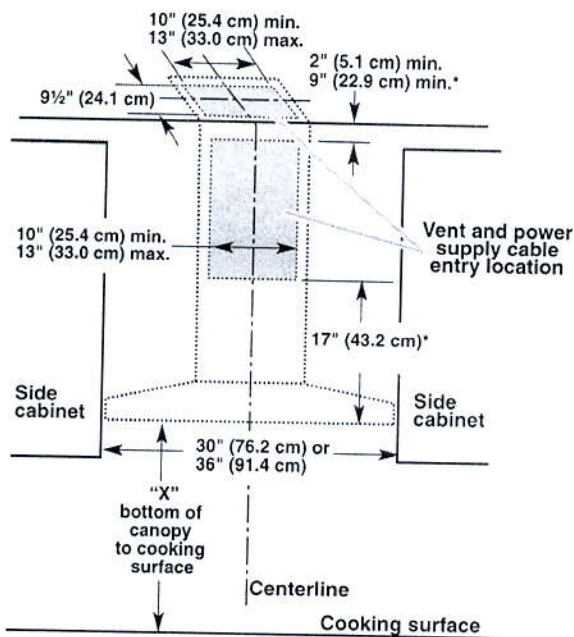

\*For non-vented (recirculating) installations

#### IMPORTANT:

Minimum distance "X": 24" (61.0 cm) from electric cooking surface.

Minimum distance "X": 27" (68.6 cm) from gas cooking surfaces.

Suggested maximum distance "X": 36" (91.4 cm)

The chimneys can be adjusted for different ceiling heights. See the following chart.

Vented Installations		
	Min. ceiling height	Max. ceiling height
Electric cooking surface	7' 1" (2.16 m)	9' 2" (2.79 m)
Gas cooking surface	7' 4" (2.23 m)	9' 2" (2.79 m)

Non-vented (recirculating) Installations		
	Min. ceiling height	Max. ceiling height
Electric cooking surface	7' 1" (2.16 m)	9' 6" (2.9 m)
Gas cooking surface	7' 4" (2.23 m)	9' 6" (2.9 m)

**NOTE:** The range hood chimneys are adjustable and designed to meet varying ceiling or soffit heights depending on the distance "X" between the bottom of the range hood and the cooking surface. For higher ceilings, a Chimney Extension Kit is available from your dealer or an authorized parts distributor. The chimney extension replaces the chimney shipped with the range hood. To order, see the "Assistance or Service" section.

### Venting Requirements (Vented Models Only)

- Vent system must terminate to the outdoors except for non-vented (recirculating) installations.
- Do not terminate the vent system in an attic or other enclosed area.
- Do not use 4" (10.2 cm) laundry-type wall caps.
- Use metal vent only. Rigid metal vent is recommended. Plastic or metal foil vent is not recommended.
- The length of vent system and number of elbows should be kept to a minimum to provide efficient performance.

#### For the Most Efficient and Quiet Operation:

- Use no more than three 90° elbows.
- Make sure there is a minimum of 24" (61.0 cm) of straight vent between the elbows if more than 1 elbow is used.
- Do not install 2 elbows together.
- Use clamps to seal all joints in the vent system.
- The vent system must have a damper. If the roof or wall cap has a damper, do not use the damper supplied with the range hood.
- Use caulking to seal exterior wall or roof opening around the cap.
- The size of the vent should be uniform.

#### Cold Weather Installations

An additional back draft damper should be installed to minimize backward cold air flow and a thermal break should be installed to minimize conduction of outside temperatures as part of the vent system. The damper should be on the cold air side of the thermal break.

The break should be as close as possible to where the vent system enters the heated portion of the house.

#### Makeup Air

Local building codes may require the use of makeup air systems when using ventilation systems greater than specified CFM of air movement. The specified CFM varies from locale to locale. Consult your HVAC professional for specific requirements in your area.

#### Venting Methods

This canopy range hood is factory set for venting through the roof or through the wall.

A 6" (15.2 cm) round vent system is needed for installation (not included). The hood exhaust opening is 6" (15.2 cm) round.

**NOTE:** Flexible vent is not recommended. Flexible vent creates back pressure and air turbulence that greatly reduce performance.

Vent system can terminate either through the roof or wall. To vent through a wall, a 90° elbow is needed.

#### Rear Discharge

A 90° elbow may be installed immediately above the hood.

## Product Dimensions

### KCGS550ESS and KCGS950ESS Models

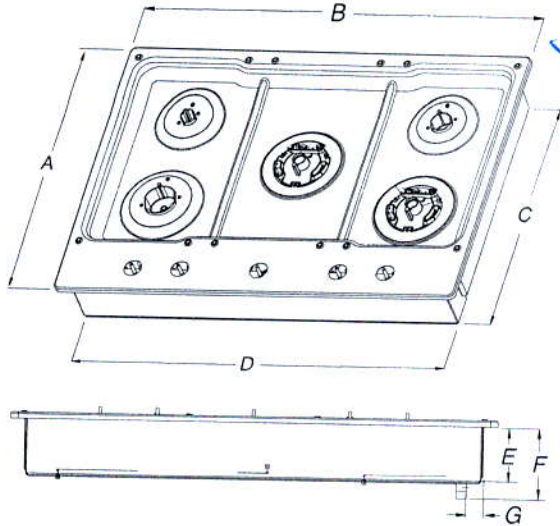

A. 21" (53.3 cm)  
B. 30" (76.2 cm)  
C. 19 $\frac{3}{8}$ " (49.2 cm)  
D. 28 $\frac{3}{8}$ " (72.1 cm)  
E. 3 $\frac{5}{8}$ " (9.2 cm)  
F. 4 $\frac{1}{16}$ " (11.6 cm)  
G. 1 $\frac{3}{8}$ " (3.4 cm)

### All Other 30" (76.2 cm) Models

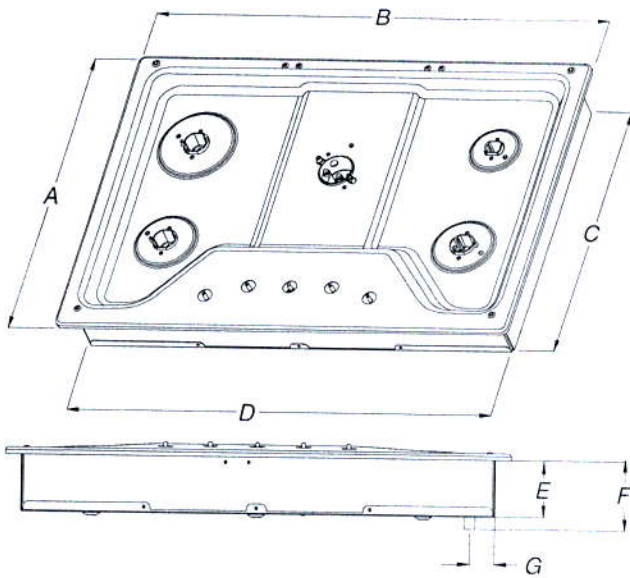

A. 21" (53.3 cm)  
B. 30" (76.2 cm)  
C. 18 $\frac{7}{8}$ " (48.0 cm)  
D. 28 $\frac{3}{8}$ " (72.1 cm)  
E. 3 $\frac{3}{8}$ " (8.6 cm)  
F. 4 $\frac{1}{8}$ " (10.5 cm)  
G. 1 $\frac{1}{2}$ " (3.8 cm)

### KCGS556ESS and KCGS956ESS Models

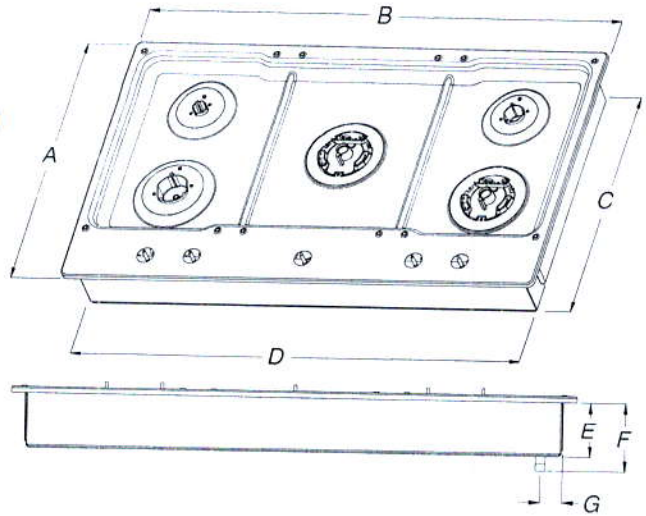

A. 21" (53.3 cm)  
B. 36 $\frac{1}{4}$ " (92.0 cm)  
C. 19 $\frac{3}{8}$ " (49.2 cm)  
D. 34 $\frac{3}{8}$ " (88.1 cm)  
E. 3 $\frac{5}{8}$ " (9.2 cm)  
F. 4 $\frac{1}{16}$ " (11.6 cm)  
G. 1 $\frac{1}{8}$ " (3.6 cm)

### All Other 36" (91.4 cm) Models

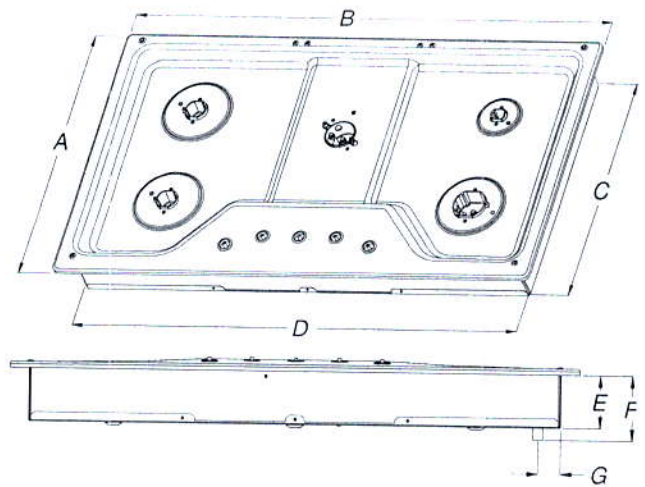

A. 21" (53.3 cm)  
B. 36" (91.4 cm)  
C. 18 $\frac{7}{8}$ " (48.0 cm)  
D. 33 $\frac{3}{4}$ " (85.7 cm)  
E. 3 $\frac{3}{8}$ " (8.6 cm)  
F. 4 $\frac{1}{8}$ " (10.5 cm)  
G. 1 $\frac{1}{2}$ " (3.8 cm)



## Cabinet Clearances

Side View

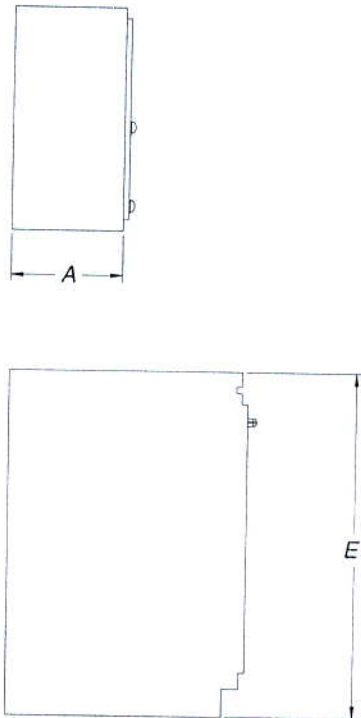

Front View

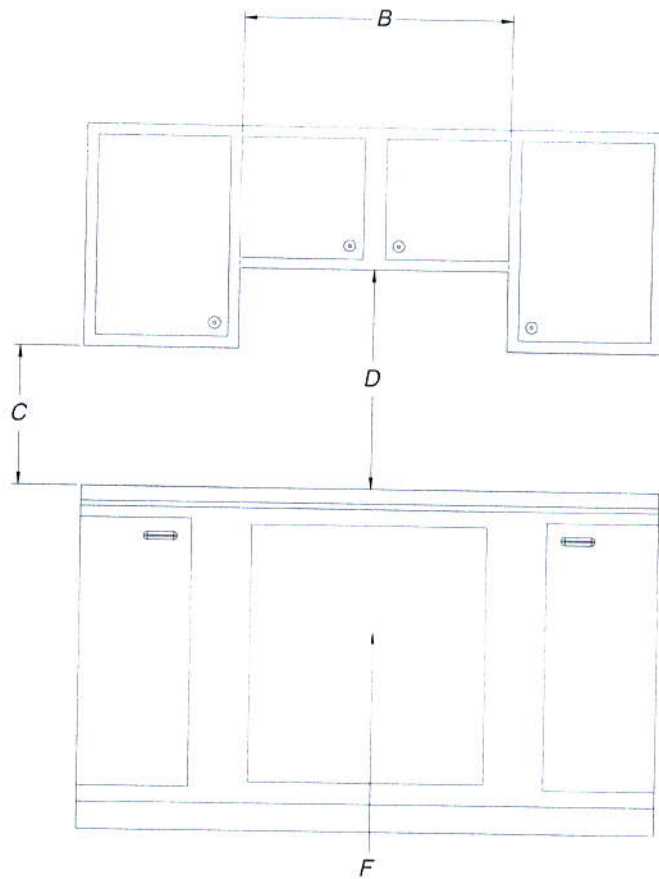

- A. 13" (33.0 cm) recommended upper cabinet depth.
- B. 30" (76.2 cm) for 30" models; 36" (91.4 cm) for 36" models.
- C. 18" (45.7 cm) minimum clearance from upper cabinet to countertop within minimum horizontal clearances to cooktop.
- D. 30" (76.2 cm) minimum clearance between top of cooktop platform and bottom of uncovered wood or metal cabinet.  
24" [61 cm] minimum clearance if bottom of wood or metal cabinet is covered by not less than 1/4" [0.6 cm] flame retardant millboard covered with not less than No. 28 MSG sheet steel, 0.015" [0.04 cm] stainless steel, or 0.024" [0.06 cm] aluminum or 0.020" [0.05 cm] copper.
- E. 36" (91.4 cm) top of countertop to floor.
- F. Gas line opening - Wall: anywhere 5" (12.7 cm) below underside of countertop. Cabinet floor: anywhere within 6" (15.2 cm) of rear wall is recommended.

Cutout Dimensions - Top View

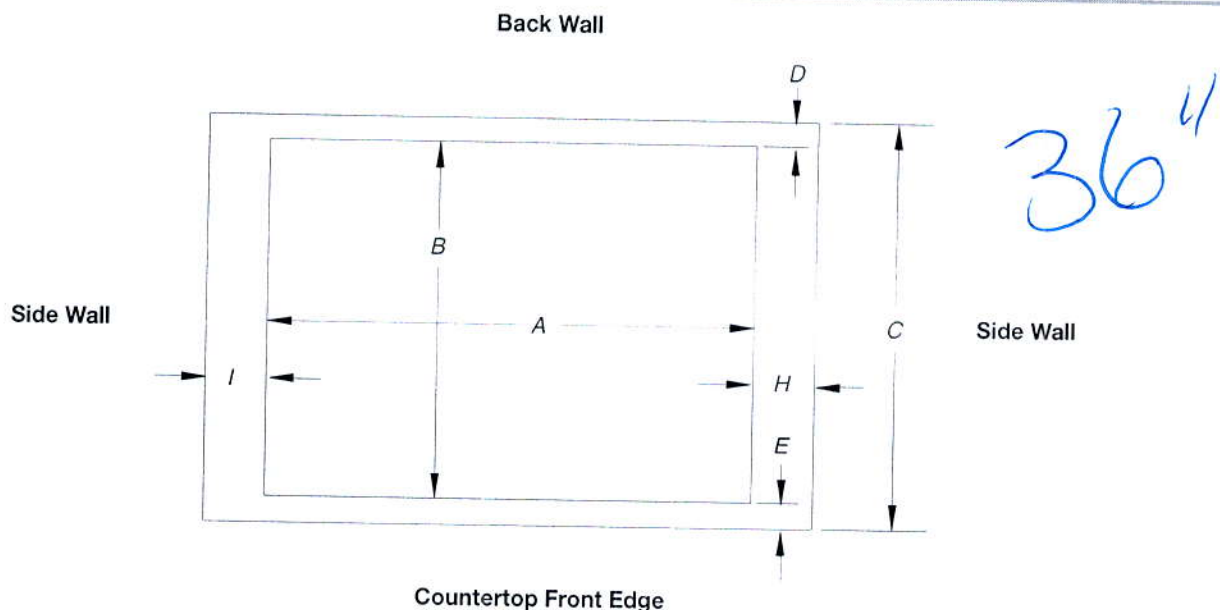

Cutout (Product Opening) Dimensions

Models	30" (76.2 cm) Models					
	A			B		
	Min	Recommended	Max	Min	Recommended	Max
KCGS550 and KCGS950 All Other 30" (76.2 cm) Models	28 1/2" (72.4 cm) 28 1/2" (72.4 cm)	28 7/8" (73.4 cm) 28 7/8" (73.4 cm)	29 3/16" (74.3 cm) 29 3/16" (74.3 cm)	19 1/2" (49.5 cm) 19" (48.3 cm)	19 13/16" (50.2 cm) 19 1/2" (49.5 cm)	20" (50.8 cm) 20" (50.8 cm)
Models	36" (91.4 cm) Models					
	34 7/8" (88.4 cm) 33 3/8" (86.0 cm)	35 3/16" (89.4 cm) 34 5/16" (87.0 cm)	35 5/8" (90.3 cm) 35 1/4" (89.5 cm)	19 1/2" (49.5 cm) 19" (48.3 cm)	19 13/16" (50.2 cm) 19 1/2" (49.5 cm)	20" (50.8 cm) 20" (50.8 cm)

Side Walls (Combustible Surfaces)

Models	H and I
KCGS5 and KCGS9	H and I added together must be at least 48" (122.0 cm), with each side individually being at least 8" (20.3 cm).
KCGS350, KCGS356, MGC9536, WCG97US0, WCG97US6	H and I added together must be at least 48" (122.0 cm), with each side individually being at least 12" (30.5 cm).
All Other Models	Both have to be 8" (20.3 cm) or more.

Back Wall and Countertop Front Dimensions

Models	C	D	E
KCGS550 and KCGS950	25" (63.5 cm)	2 7/8" (7.3 cm)	2 3/4" (6.9 cm)
All Other Models			3 1/8" (7.9 cm)

**NOTES:** After making the countertop cutout, some installations may require notching down the base cabinet side walls to clear the cooktop base. To avoid this modification, use a base cabinet with sidewalls wider than the cutout.

If cabinet has a drawer, a 4" (10.2 cm) depth clearance from the countertop to the top of the drawer (or other obstruction) in base cabinet is required. The drawer depth may need to be shortened to avoid interfering with the regulator.

**IMPORTANT:** If a built-in wall oven is to be installed below this cooktop, the grounded outlet and gas supply piping must be located in an adjacent cabinet.

This cooktop and its gas and electrical supply sources must be installed before the undercounter built-in wall oven is installed.



- Electrical supply junction box should be located 3" (7.6 cm) maximum below the support surface when the oven is installed in a wall cabinet. A 1" (2.5 cm) minimum diameter hole should have been drilled in the left rear corner of the support surface to pass the appliance cable through to the junction box.
- Oven support surface must be solid, level and flush with bottom of cabinet cutout. Floor must be able to support a total weight (microwave and built-in oven) of 208 lbs (95 kg) for 27" (68.6 cm) models or 249 lbs (113 kg) for 30" (76.2 cm) models.

**IMPORTANT:** To avoid damage to your cabinets, check with your builder or cabinet supplier to make sure that the materials used will not discolor, delaminate or sustain other damage. This oven has been designed in accordance with the requirements of UL and CSA International and complies with the maximum allowable wood cabinet temperatures of 194°F (90°C).

## Product Dimensions

### 27" and 30" (68.6 cm and 76.2 cm) Ovens

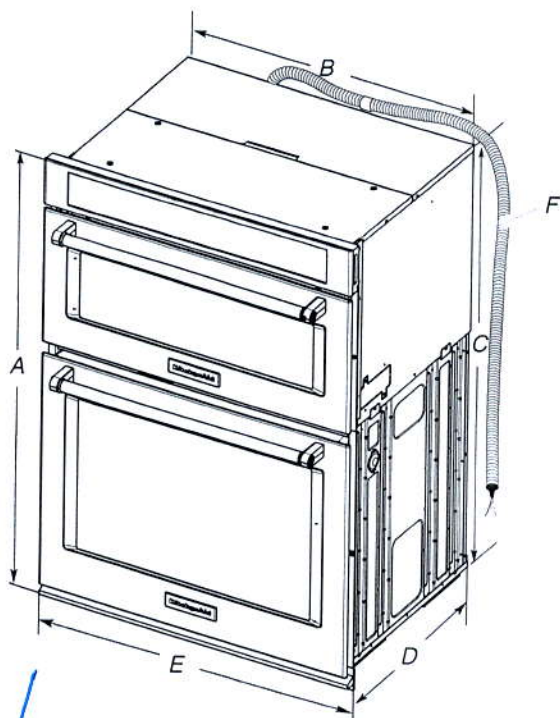

#### 27" (68.6 cm) models

- A. 42 5/16" (108.0 cm) overall height
- B. 25 7/16" (64.6 cm) recessed width
- C. 41" (104.1 cm) recessed height
- D. 23 1/4" (59.1 cm) max. recessed depth
- E. 27" (68.6 cm) overall width
- F. 48" (121.9 cm) flexible conduit length measured from the conduit clamp located at the rear of the oven. Do not remove the conduit clamp.

#### 30" (76.2 cm) models

- A. 42 5/16" (108.0 cm) overall height
- B. 28 7/16" (72.2 cm) recessed width
- C. 41" (104.1 cm) recessed height
- D. 23 1/4" (59.1 cm) max. recessed depth
- E. 30" (76.2 cm) overall width
- F. 48" (121.9 cm) flexible conduit length measured from the conduit clamp located at the rear of the oven. Do not remove the conduit clamp.

## Cabinet Dimensions

### 27" and 30" (68.6 cm and 76.2 cm) Ovens

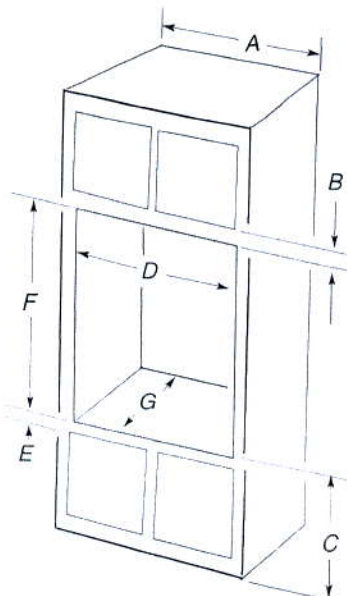

#### 27" (68.6 cm) models

- A. 27" (68.6 cm) min. cabinet width
- B. 1" (2.5 cm) top of cutout to bottom of upper cabinet door
- C. 19 1/4" (48.9 cm) bottom of cutout to floor is recommended. 4"-19 1/4" (10.2-48.9 cm) bottom of cutout to floor is acceptable.
- D. 25 1/8" (64.8 cm) cutout width
- E. 1 1/2" (3.8 cm) min. bottom of cutout to top of cabinet door
- F. 41 5/16" (105 cm)\* recommended cutout height
- G. 24" (60.7 cm) cutout depth

#### 30" (76.2 cm) models

- A. 30" (76.2 cm) min. cabinet width
- B. 1" (2.5 cm) top of cutout to bottom of upper cabinet door
- C. 19 1/4" (48.9 cm) bottom of cutout to floor is recommended. 4"-19 1/4" (10.2-48.9 cm) bottom of cutout to floor is acceptable.
- D. 28 1/2" (72.4 cm) cutout width
- E. 1 1/2" (3.8 cm) min. bottom of cutout to top of cabinet door
- F. 41 5/16" (105 cm)\* recommended cutout height
- G. 24" (60.7 cm) cutout depth

\*NOTE: The cutout height can be between 41" and 41 1/2" (104.1 cm and 105.6 cm) for microwave/oven combination.

## Electrical Requirements

If codes permit and a separate ground wire is used, it is recommended that a qualified electrical installer determine that the ground path and wire gauge are in accordance with local codes.

Check with a qualified electrical installer if you are not sure the oven is properly grounded.

This oven must be connected to a grounded metal, permanent wiring system.

Be sure that the electrical connection and wire size are adequate and in conformance with the National Electrical Code, ANSI/NFPA 70-latest edition or CSA Standards C22.1-94, Canadian Electrical Code, Part 1 and C22.2 No. O-M91-latest edition, and all local codes and ordinances.

A copy of the above code standards can be obtained from:

National Fire Protection Association  
1 Batterymarch Park  
Quincy, MA 02169-7471

CSA International  
8501 East Pleasant Valley Road  
Cleveland, OH 44131-5575



Electrical Connection

To properly install your oven, you must determine the type of electrical connection you will be using and follow the instructions provided for it here.

- Oven must be connected to the proper electrical voltage, amperage, and frequency as specified on the model/serial/rating plate. See the following illustration.

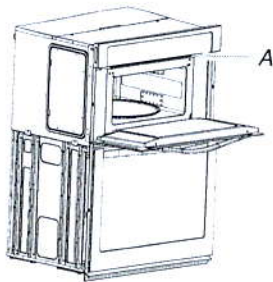

A. Model/serial/rating plate

- Models rated from 7.3 to 9.6 kW at 240 volts (5.4 to 7.4 kW at 208 volts) require a separate 40-amp circuit. Models rated at 4.8 kW and below at 240 volts (3.6 kW and below at 208 volts) require a separate 30-amp circuit.
- A circuit breaker is recommended.
- Connect directly to the fused disconnect (or circuit breaker box) through flexible, armored or nonmetallic sheathed, copper cable (with grounding wire). See "Make Electrical Connection" section.

- Flexible conduit from the oven should be connected directly to the junction box.
- Do not cut the conduit. The length of conduit provided is for serviceability of the oven.
- A UL listed or CSA approved conduit connector must be provided.
- If the house has aluminum wiring, follow the procedure below:
  1. Connect a section of solid copper wire to the ends of the flexible conduit leads.
  2. Connect the aluminum wiring to the added section of copper wire using special connectors and/or tools designed and UL listed for joining copper to aluminum.Follow the electrical connector manufacturer's recommended procedure. Aluminum/copper connection must conform with local codes and industry accepted wiring practices.

For power requirements, refer to the following table.

Model	Voltage	Amperage (L1)*	Amperage (L2)*	Rating (W)
KOCE507E/ KOCE500E	120/240	32	30	8000
KOCE507E/ KOCE500E	120/208	30	28	6600

\*Amperage values noted above are for information purposes only: The units are rated in watts.

INSTALLATION INSTRUCTIONS

Prepare Built-In Microwave/Oven Combination

1. Decide on the final location for the oven. Locate existing wiring to avoid drilling into or severing wiring during installation.

⚠ WARNING

Excessive Weight Hazard

Use two or more people to move and install oven.  
Failure to do so can result in back or other injury.

2. To avoid floor damage, set the oven onto cardboard prior to installation. Do not use handle or any portion of the front frame for lifting.
3. Remember to remove bottom vent from the foam packing on top of oven.
4. Remove the shipping materials and tape from the oven.
5. Remove the hardware package from inside the bag containing literature.
6. Remove and set aside racks and other parts from inside the oven.
7. Move oven and cardboard close to the oven's final location.

Remove Oven Door(s)

IMPORTANT: Use two hands to remove oven door.

1. Prior to removing the oven door, prepare a surface where you will place it. This surface should be flat and covered with a soft blanket, or use the corner posts from your packaging material.
2. Open the oven door.
3. Locate the oven door hinge locks in both corners of the oven door, and then rotate the hinge locks toward the oven door to the unlocked position. If the door hinge lock is not rotated fully (see illustration B), the door will not remove properly.

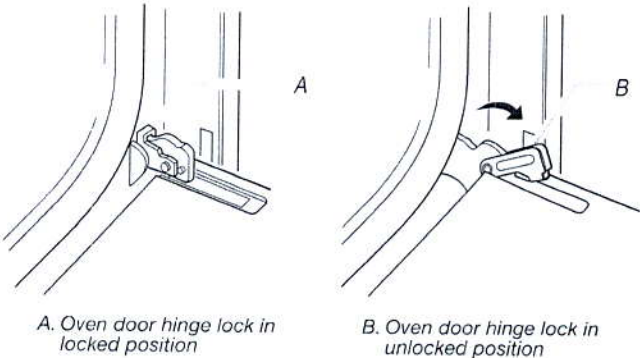



## MODELS

### Side by Side Non-Dispensing Refrigerators

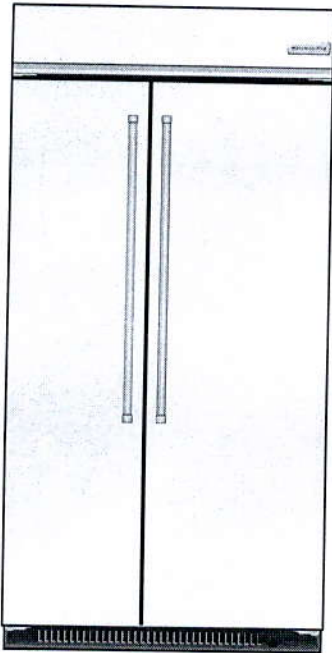

#### Stainless Series

This series provides a warm commercial-looking built-in refrigerator.

KBSN602ESS KBSN608ESS

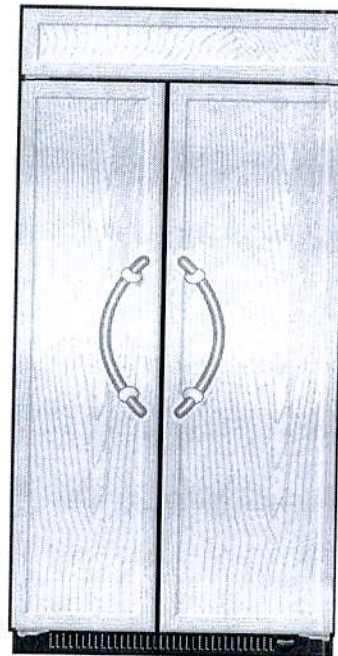

#### Overlay Series

Features factory-installed, overlay style trim to provide a "frameless" look. This series requires the installation of custom panels, handles, and standoffs.

KBSN602EPA KBSN608EPA

### Side by Side Dispensing Refrigerators

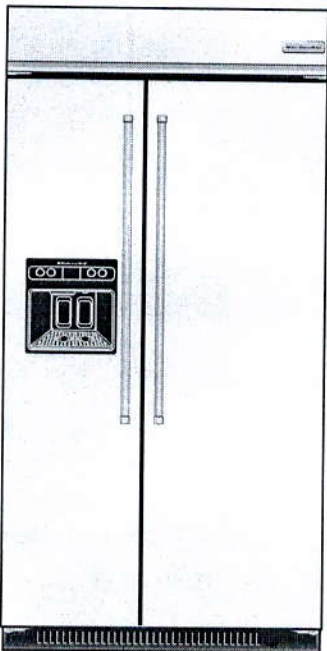

#### Stainless Series

This series provides a warm commercial-looking built-in refrigerator.

KBSD606ESS KBSD602ESS KBSD608ESS KBSD608EBS

Built in  
42"

- The water shutoff should be located in the base cabinet on either side of the refrigerator or some other easily accessible area. If the water shutoff valve is not in the cabinets, the plumbing for the water line can come through the floor or the back wall. See "Water Supply Requirements" for more information.

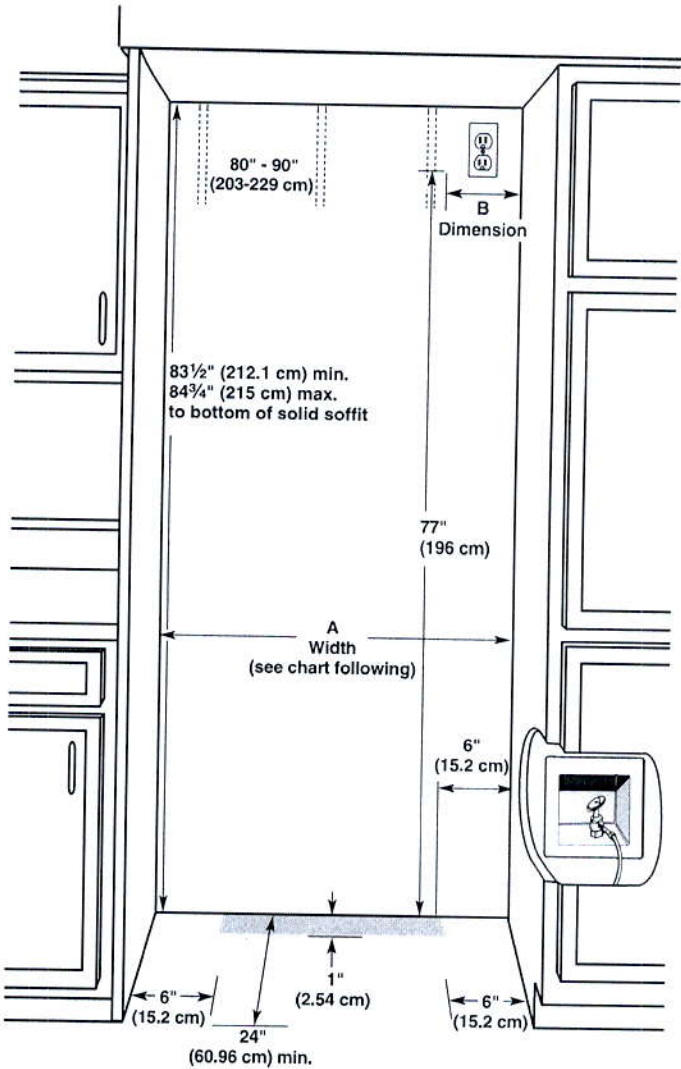

Model	Width A (as shown above)	Dimension B (as shown above)
36	35½" to 35¾" (90.2 cm to 90.8 cm)	4" (10.2 cm)
42	41½" to 41¾" (105.4 cm to 106.1 cm)	7½" (19.1 cm)
48	47½" to 47¾" (120.7 cm to 121.3 cm)	13½" (34.3 cm)

**NOTE:** Flooring under refrigerator must be at same level as the room. Face of cabinetry must be plumb.

## Electrical Requirements

### ⚠WARNING



#### Electrical Shock Hazard

- Plug into a grounded 3 prong outlet.
- Do not remove ground prong.
- Do not use an adapter.
- Do not use an extension cord.
- Failure to follow these instructions can result in death, fire, or electrical shock.

Before you move your refrigerator into its final location, it is important to make sure you have the proper electrical connection.

#### Recommended Grounding Method

A 115 volt, 60 Hz., AC only, 15- or 20-amp fused, grounded electrical supply is required. It is recommended that a separate circuit serving only your refrigerator be provided. Use an outlet that cannot be turned off by a switch. Do not use an extension cord.

**IMPORTANT:** If this product is connected to a GFCI (Ground Fault Circuit Interrupter) protected outlet, nuisance tripping of the power supply may occur, resulting in loss of cooling. Food quality and flavor may be affected. If nuisance tripping has occurred, and if the condition of the food appears poor, dispose of it.

**NOTE:** Before performing any type of installation or cleaning, remove the top grille and turn the master power switch to OFF or disconnect power at the circuit breaker box.

When you are finished, turn ON the master power switch or reconnect power at the circuit breaker box. Then reset the control to the desired setting.



## Product Dimensions

### Side View

- The depth from the front of the top grille to the back of the refrigerator cabinet is 25 $\frac{3}{8}$ " (64.5 cm).
- The power cord is 84" (213 cm) long.
- Height dimensions are shown with leveling legs extended  $\frac{1}{8}$ " (3 mm) below the rollers.

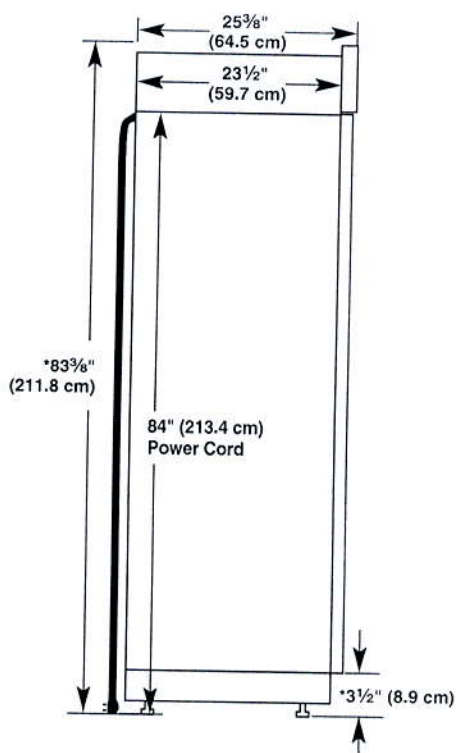

\*When leveling legs are fully extended to 1 $\frac{1}{4}$ " (3.2 cm) below rollers, add 1 $\frac{1}{8}$ " (2.9 cm) to the height dimensions.

### Top View

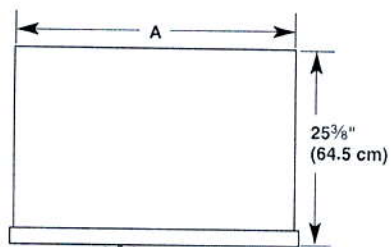

Model	Width A
36	35" (88.9 cm)
42	41" (104.1 cm)
48	47" (119.4 cm)

### Front View

- Width dimensions were measured from trim edge to trim edge.
- Height dimensions are shown with leveling legs extended  $\frac{1}{8}$ " (3 mm) below the rollers.

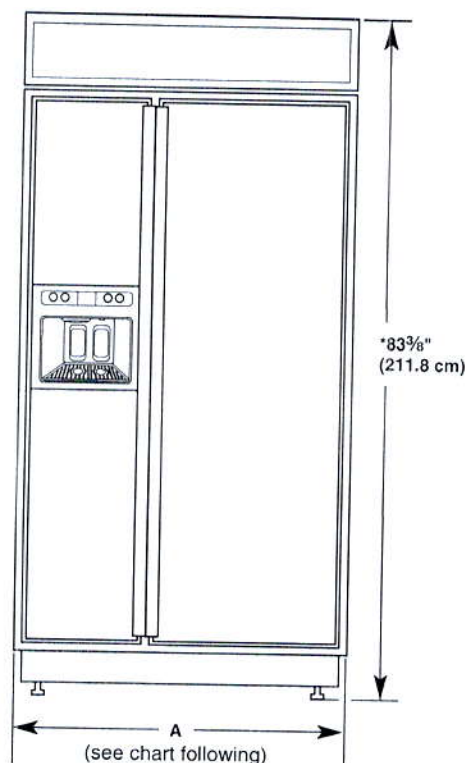

Model	Width A (Trim edge to trim edge)
36	36 $\frac{11}{32}$ " (92.3 cm)
42	42 $\frac{11}{32}$ " (107.5 cm)
48	48 $\frac{11}{32}$ " (122.8 cm)

\*When leveling legs are fully extended to 1 $\frac{1}{4}$ " (3.2 cm) below rollers, add 1 $\frac{1}{8}$ " (2.9 cm) to the height dimensions.

## Door Swing Dimensions

The location must permit both doors to open to a minimum of 90°. Allow 5" (12.7 cm) minimum space between the side of the refrigerator and a corner wall.

**NOTE:** More clearance may be required if you are using overlay panels, custom handles, or extended handles on a Classic model.

To adjust the door swing, see "Adjust Doors."

### 36" (91.4 cm) Models

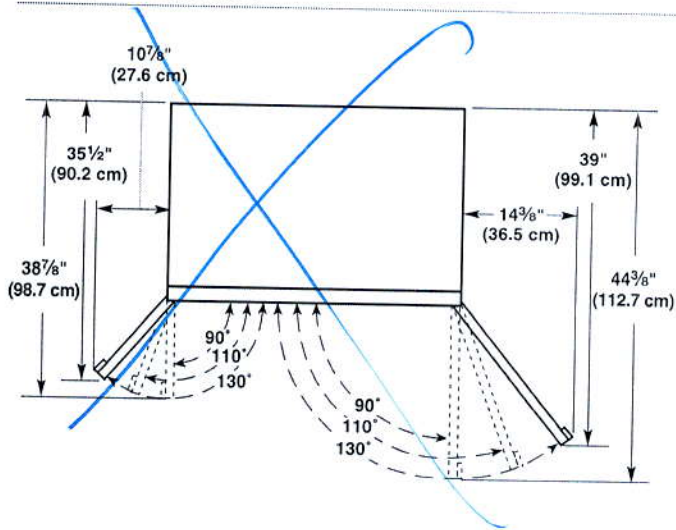

### 42" (106.7 cm) Models

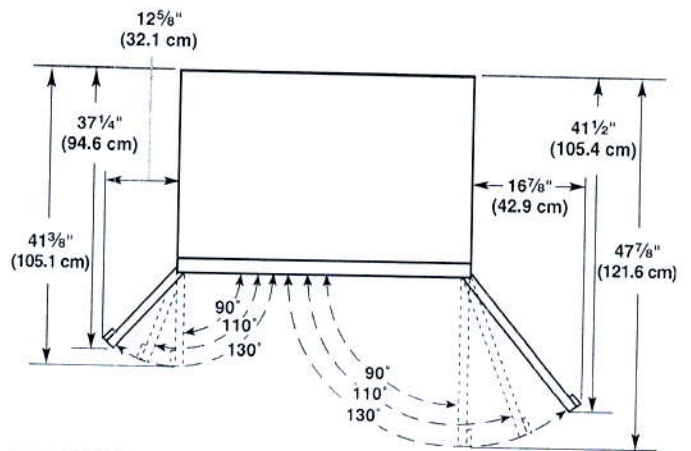

### 48" (121.9 cm) Models

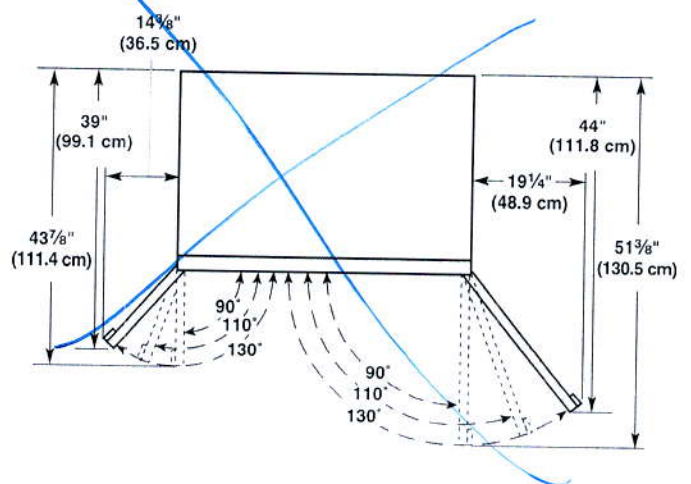





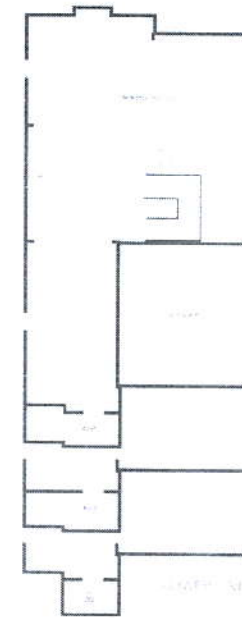
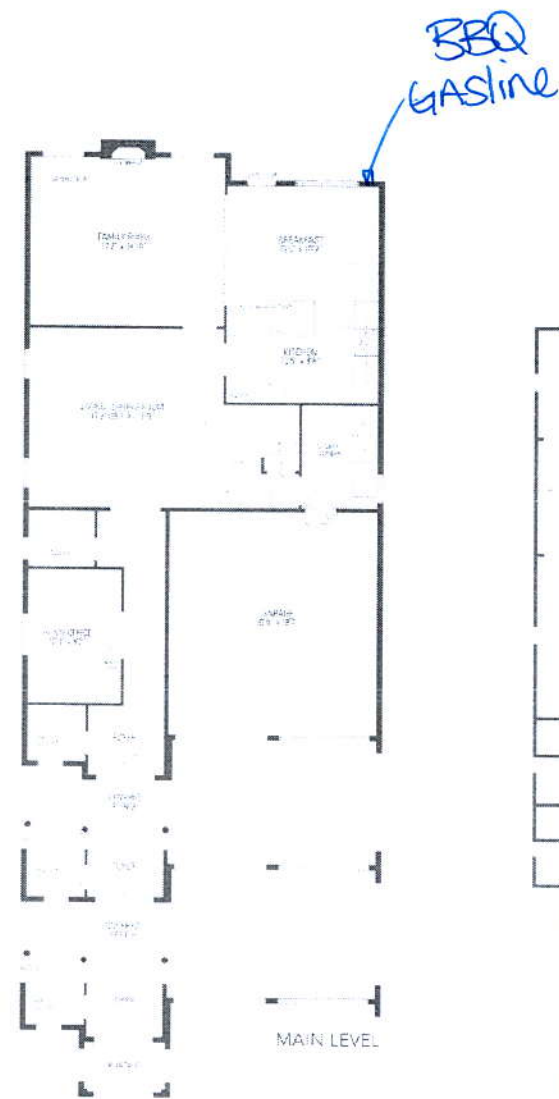

### ROSEWOOD 6

UPPER SUITE INCLUDES 12 SQ. FT. OPEN AREA

