

|  |                         |  |  |                             |  |
|--|-------------------------|--|--|-----------------------------|--|
|  |                         | <b>CONSTRUCTION SUMMARY</b>                      |  | <b>RECEIVED AUG 16 2018</b> |  |
| PURCHASER: SYED ADEEL ALI  |                         | Saddle Ridge (G) - Lecco Ridge Developments Inc. |  | TEL:                        |  |
| LOT / PHASE<br>Block 325 TH 2 / 1  | REG. PLAN #<br>20M-1184 | HOUSE TYPE<br>Ivy 5 Elev 2                       |  |                             |  |

**CABINETRY ACCESSORIES**

|   |  |
|---|--|
| 1 - KITCHEN CABINETRY UPPER - FULL DEPTH ABOVE FRIDGE - WITH GABLES - 600MM - PRICE IS EACH - STANDARD<br>14May18 Note: |  |
|---|--|

**CERAMIC TILE**

|  |  |
|--|--|
| 1 - DELETE ALL CERAMIC BATHROOM ACCESSORIES - DELETE TOWEL BAR, PAPER HOLDER & SOAP DISH THROUGHOUT<br>14May18 Note: |  |
|--|--|

**DOORS AND TRIM**

|  |  |
|--|--|
| 1 - INTERIOR DOORS - WINSTON LEVERS THROUGHOUT - IN LIEU OF STANDARD AS PER OFFER<br>14May18 Note: |  |
|--|--|

**ELECTRICAL**

|  |  |
|--|--|
| 1 - LIGHT AND SWITCH - NO FIXTURE INCLUDED - LIVING ROOM<br>14May18 Note:              |  |
| 1 - ABOVE KITCHEN ISLAND - ADD LIGHT AND SWITCH - NO FIXTURE INCLUDED<br>14May18 Note: |  |

**FIREPLACE AND ACCESSORIES**

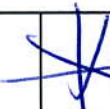
|   |            |   |
|---|------------|---|
| 1 - GAS LINE ROUGH-IN FOR STOVE (INCLUDES ELECTRICAL OUTLET) - FIRST FLOOR<br>15Aug18 Note: | <b>NEW</b> |  |
|---|------------|---|

**RECEIVED AUG 16 2018**

**HARDWOOD FLOORING**

|  |  |
|--|--|
| 1 - LAMINATE -UPGRADE TO CLASSIC PLUS SERIES IN LIEU OF STANDARD LAMINATE<br>14May18 Note: |  |
|--|--|

**PLUMBING**

|  |  |
|--|--|
| 1 - SINK - DROP-IN SINK - CONTRAC LOLAND #4480BST<br>14May18 Note: MASTER ENSUITE BATHROOM                   |  |
| 1 - TOE TESTER - ADD TOE TESTER TO SHOWER<br>14May18 Note: MASTER ENSUITE                                    |  |
| 3 - MOEN BATHROOM ACCESSORIES - MASON CHROME - TOWEL BAR 24" #YB8094/YB8000 - PRICE IS EACH<br>14May18 Note: |  |
| 3 - MOEN BATHROOM ACCESSORIES - MASON CHROME - PAPER HOLDER #YB8099/YB8000 - PRICE IS EACH<br>14May18 Note:  |  |
| 1 - WASHROOM - 3 PIECE ROUGH-IN IN BASEMENT<br>13Mar17 Note:   |  |

**PROMOTIONAL**

|   |  |
|---|--|
| 1 - LESS BALANCE OF CREDIT FROM PURCHASER EXTRA SHEET IN OFFER<br>14May18 Note:   |  |
| 1 - PARTIAL REDEMPTION OF PROMOTIONAL PACKAGE \$\$\$\$\$\$ BALANCE FORWARD TO BE USED AT A LATER DATE.<br>ORIGINAL PROMOTIONAL PACKAGE OF \$\$\$\$\$\$ AS PER SCHEDULE PE DATED MMMDDYYYY.<br>13Mar17 Note: ORIGINAL PROMO PACKAGE - \$5000.00<br>BALANCE FORWARD - \$4360.00 |  |

**STAIRS AND RAILINGS**

|  |  |
|--|--|
| 1 - STAINED HANDRAIL, TREADS, RISERS AND STRINGER EXCLUDING PICKETS (FOR IRON PICKETS) - STANDARD STAIRCASE<br>- PRICE IS PER SET<br>14May18 Note: |  |
|--|--|

|   |             |              |  |      |
|---|-------------|--------------|--|------|
| <div>CONSTRUCTION SUMMARY</div> <div>Saddle Ridge (G) - Lecco Ridge Developments Inc.</div> |             |              |  |      |
| PURCHASER: SYED ADEEL ALI   |             |              |  | TEL: |
| LOT / PHASE   | REG. PLAN # | HOUSE TYPE   |  |      |
| Block 325 TH 2 / 1  | 20M-1184    | Ivy 5 Elev 2 |  |      |
| 1 - EUROLINE 1  |             |              |  |      |
| 14May18 Note: STAIRCASE - IRON PICKETS - BLACK  |             |              |  |      |

EXTRAS AS PER OFFER

|  |  |
|--|--|
| Five (5) White Appliances as per PE Appliances   |  |
| Worksheet Note:  |  |
| The Purchaser acknowledges that the Purchase Price is inclusive of all credits and promotional packages available at the time of purchase.   |  |
| Worksheet Note:  |  |
| The Vendor agrees that notwithstanding any other term or provision in this Agreement included in the Purchase Price and in addition to those items detailed in Schedule GP to the Agreement of Purchase and Sale, the Purchaser is entitled to a credit of Fiv |  |
| Worksheet Note:  |  |

This Document is Extremely Time Sensitive - Printed 15 Aug 18 at 13:57

Purchaser:

SYED ADEEL ALI

Telephone Res. / Bus:

/

Decor Advisor:

Candace Forza

Lock Date:

14-May-18

Layout Changes:

Yes

No

Property:

Block 325 TH 2

Project:

Lecco Ridge Developments Inc.

Model and Elevation:

Ivy 5 Elev 2

14-May-18

Plan #:

20M-1184

Sketch Attached:

Yes

No

Exterior Colour Scheme:

1. Cabinetry

|                         | Style and Colour    | Hardware |
|-------------------------|---------------------|----------|
| Kitchen / Breakfast     | HASTING CHOCOLATE ✓ | 2002     |
| Laundry Room            | ELISSE ✓            | Standard |
| Powder Room             | HASTING CHOCOLATE ✓ | 1001     |
| Master Ensuite Bathroom | HASTING CHOCOLATE ✓ | 1001     |
| Main Bathroom           | HASTING CHOCOLATE ✓ | 1001     |
|                         | N/A                 | N/A      |
|                         | N/A                 | N/A      |
|                         | N/A                 | N/A      |
|                         | N/A                 | N/A      |

Appliances:

Built In Appliances

Yes

No

Slide In Stove

Yes

No

Dishwasher Cabinet

Closed

Open

41" Upper Cabinets

Yes

No

Please NOTE: Standard Cabinet Height is 30"

Stove Opening

NOTE: If not specified, opening will be set to builder's standard opening of approximately 30" width

Fridge Opening

NOTE: If not specified, opening will be set to builder's standard opening of approximately 37" width x 74" height

\*\* Refer to Construction Summary

2. Counters

|                         | Counter                            | Edge |
|-------------------------|------------------------------------|------|
| Kitchen / Breakfast     | LAMINATE-INUK SHUK GREY P-344 LM ✓ |      |
| Laundry Room            | N/A ✓                              |      |
| Powder Room             | LAMINATE-CARRARA BIANCO 6696-46 ✓  |      |
| Master Ensuite Bathroom | LAMINATE-CARRARA BIANCO 6696-46 ✓  |      |
| Main Bathroom           | LAMINATE-CARRARA BIANCO 6696-46 ✓  |      |
|                         | N/A                                |      |
|                         | N/A                                |      |
|                         | N/A                                |      |
|                         | N/A                                |      |

\*\* Refer to Construction Summary

Printed 5/14/2018 15:41:43

Initial:



Page 1 of 4



|                              |                |
|------------------------------|----------------|
| <b>Purchaser:</b>            | SYED ADEEL ALI |
| <b>Telephone Res. / Bus:</b> | /              |
| <b>Decor Advisor:</b>        | Candace Forza  |
| <b>Lock Date:</b>            | 14-May-18      |

**Property:** Block 325 TH 2

**Project:** Lecco Ridge Developments Inc.

**Model and Elevation:** Ivy 5 Elev 2

**Plan #:** 20M-1184

### 3. Ceramic Flooring

At a 45 Threshold-If App.

|                         |                             |   |             |
|-------------------------|-----------------------------|---|-------------|
| Entrance Vestibule      | TILE-BEACH LIGHT GREY-13X13 | ✓ |             |
| Main Hall               | LAMINATE                    | ✓ |             |
| Kitchen / Breakfast     | TILE-BEACH LIGHT GREY-13X13 | ✓ | METAL STRIP |
| Laundry Room            | TILE-BEACH BLACK-13X13      | ✓ | METAL STRIP |
| Powder Room             | TILE-BEACH LIGHT GREY-13X13 | ✓ | METAL STRIP |
| Master Ensuite Bathroom | TILE-BEACH BLACK-13X13      | ✓ | METAL STRIP |
| Main Bathroom           | TILE-BEACH BLACK-13X13      | ✓ | METAL STRIP |
| GARAGE ENTRY            | TILE-BEACH LIGHT GREY-13X13 | ✓ |             |
|                         | N/A                         |   |             |
|                         | N/A                         |   |             |
|                         | N/A                         |   |             |

\*\* Refer to Construction Summary

#### 4. Ceramic Wall Tile

| Master Ensuite Bathroom | Selection             | Description |
|-------------------------|-----------------------|-------------|
| Tub Deck Wall           | TILE-GOLF GRIGIO-8X10 | ✓           |
| Tub Deck                | N/A                   |             |
| Tub Deck Skirt          | N/A                   |             |
| Shower Stall            | TILE-GOLF GRIGIO-8X10 | ✓           |
| Bathtub Enclosure Walls | N/A                   |             |
|                         | N/A                   |             |
| Main Bathroom           | TILE-GOLF GRIGIO-8X10 | ✓           |
|                         | N/A                   |             |
|                         | N/A                   |             |
|                         | N/A                   |             |
| Kitchen Backsplash      | N/A                   |             |

**\*\* Refer to Construction Summary - STANDARD GROUT THROUGHOUT UNLESS SPECIFIED**

## 5. Plumbing Fixtures

| C. Plumbing Fixtures |       | Whirlpool            |  |  |
|----------------------|-------|----------------------|--|--|
| All Bathrooms        | White |                      | N/A  | Yes <input checked="" type="radio"/> No <input checked="" type="radio"/> |
|                      | N/A   |                      |  |  |
|                      | N/A   |                      |  |  |
|                      | N/A   | Dishwasher Rough-In  | <input checked="" type="radio"/> Yes <input checked="" type="radio"/> No |  |
|                      | N/A   | Waterline for Fridge | Yes <input checked="" type="radio"/> No <input checked="" type="radio"/> |  |
|                      | N/A   |                      |  |  |

**\*\* Refer to Construction Summary**

## 6. Trim Carpentry

|                            |  |
|----------------------------|--|
| Interior Doors             | CLERMONT                                       |
| Interior Trim              | 2 3/4" CASING WITH 4 1/4" BASEBOARD - COLONIAL |
| Door Handles               | WEISER WINSTON LEVER IN LIEU OF STANDARD KNOB  |
| Exterior Front Door Handle | As Per Construction Specifications             |

**\*\* Refer to Construction Summary**

Initial:

AA

Purchaser:SYED ADEEL ALI

Telephone Res. / Bus: /

Decor Advisor:Candace Forza

Lock Date:14-May-18

Property: Block 325 TH 2

Project: Lecco Ridge Developments Inc.

Model and Elevation: Ivy 5 Elev 2

Plan #: 20M-1184

7. Other Flooring

|                              |  |          |
|------------------------------|--|----------|
| Main Hall                    | LAMINATE-CLASSIC PLUS - OLD OAK GREY QS-UM1382             | ✓        |
| Living Room                  | LAMINATE-CLASSIC PLUS - OLD OAK GREY QS-UM1382             | ✓        |
| Dining Room                  | LAMINATE-CLASSIC PLUS - OLD OAK GREY QS-UM1382             | ✓        |
| Family Room                  | LAMINATE-CLASSIC PLUS - OLD OAK GREY QS-UM1382             | ✓        |
| Den / Library / Study        | N/A  |          |
| Basement Landing(If Applies) | N/A  |          |
| Lower Landing (If Applies)   | LAMINATE-CLASSIC PLUS - OLD OAK GREY QS-UM1382             | ✓        |
| Upper Landing                | LAMINATE-CLASSIC PLUS - OLD OAK GREY QS-UM1382             | ✓        |
| Upper Hall                   | CARPET-SHAW - E0949 NEWBERN CLASSIC - ANTIQUE SILK 00131   | ✓        |
| Master Bedroom               | CARPET-SHAW - E0949 NEWBERN CLASSIC - ANTIQUE SILK 00131   | ✓        |
| Bedroom #2                   | CARPET-SHAW - E0949 NEWBERN CLASSIC - ANTIQUE SILK 00131   | ✓        |
| Bedroom #3                   | Carpet Shaw - E0949 Newbern Classic - Antique Silk 00131 ✓ |          |
| Bedroom #4                   | N/A  |          |
| Bedroom #5                   | N/A  |          |
| COMPUTER NICHE               | CARPET-SHAW - E0949 NEWBERN CLASSIC - ANTIQUE SILK 00131   | ✓        |
|                              | N/A  |          |
|                              | N/A  |          |
| Underpad                     | Type   | Area     |
|                              | STANDARD   | STANDARD |

\*\* Refer to Construction Summary

8. Railings and Pickets

|                                       |                                    |        |                     |      |
|---------------------------------------|------------------------------------|--------|---------------------|------|
| Railing Type                          | As Per Construction Specifications | Colour | TORLYS OLD OAK GREY | ✓    |
| Picket Type                           | EUROLINE 1 ✓                       | Colour | BLACK               | ✓    |
| Stringer / Riser                      | As Per Construction Specifications | Colour | TORLYS OLD OAK GREY |      |
| Treads                                | As Per Construction Specifications | Colour | TORLYS OLD OAK GREY |      |
| Red Oak Stairs with Semi Gloss Finish |                                    |        | ● Yes               | ✓ No |

\*\* Refer to Construction Summary

9. Wall Paint Flat Finish

|                             |              |   |                |              |   |
|-----------------------------|--------------|---|----------------|--------------|---|
| Main & Upper Hall           | 22 WARM GREY | ✓ | Master Bedroom | 22 WARM GREY | ✓ |
| Living Room                 | 22 WARM GREY | ✓ | Bedroom #2     | 22 WARM GREY | ✓ |
| Dining Room                 | 22 WARM GREY | ✓ | Bedroom #3     | 22 WARM GREY | ✓ |
| Kitchen / Breakfast         | 22 WARM GREY | ✓ | Bedroom #4     | N/A          |   |
| Family Room                 | 22 WARM GREY | ✓ | Bedroom #5     | N/A          |   |
| Powder Room                 | 22 WARM GREY | ✓ | Master Ensuite | 22 WARM GREY | ✓ |
| Laundry Room                | 22 WARM GREY | ✓ | Main Bathroom  | 22 WARM GREY | ✓ |
| Den/Library                 | N/A          |   | GARAGE ENTRY   | 22 WARM GREY | ✓ |
| Trim Paint-Semi Gloss       | BIRCH WHITE  | ✓ | COMPUTER NICHE | 22 WARM GREY | ✓ |
|                             | N/A          |   |                | N/A          |   |
|                             | N/A          |   |                | N/A          |   |
| Smooth Ceilings First Floor | Yes          |   |                | ● No         | ✓ |

\*\* Refer to Construction Summary

Initial: 



Purchaser:SYED ADEEL ALI

Telephone Res. / Bus: /

Decor Advisor:Candace Forza

Lock Date:14-May-18

Property:Block 325 TH 2

Project:Lecco Ridge Developments Inc.

Model and Elevation:Ivy 5 Elev 2

Plan #:20M-1184

10. Plaster Mouldings and Medallions

|                    |     |     |                   |     |     |
|--------------------|-----|-----|-------------------|-----|-----|
| Entrance Vestibule | N/A | N/A | Kitchen/Breakfast | N/A | N/A |
| Main Hall          | N/A | N/A | Den/Library       | N/A | N/A |
| Living Room        | N/A | N/A | Lower Landing     | N/A | N/A |
| Dining Room        | N/A | N/A |                   | N/A | N/A |
| Family Room        | N/A | N/A |                   |     |     |

\*\* Refer to Construction Summary

11. Fireplace

|                | Living Room           |                       |                                  | Family Room           |                       |                                  | Other Room - Specify  |                       |                                  |
|----------------|-----------------------|-----------------------|----------------------------------|-----------------------|-----------------------|----------------------------------|-----------------------|-----------------------|----------------------------------|
|                | Purchased             | As Per Plan           | N/A                              | Purchased             | As Per Plan           | N/A                              | Purchased             | As Per Plan           | N/A                              |
|                | <input type="radio"/> | <input type="radio"/> | <input checked="" type="radio"/> | <input type="radio"/> | <input type="radio"/> | <input checked="" type="radio"/> | <input type="radio"/> | <input type="radio"/> | <input checked="" type="radio"/> |
| Fireplace Type | N/A                   |                       |                                  | N/A                   |                       |                                  | N/A                   |                       |                                  |
| Mantle Type    | N/A                   |                       |                                  | N/A                   |                       |                                  | N/A                   |                       |                                  |
| Colour / Stain | N/A                   |                       |                                  | N/A                   |                       |                                  | N/A                   |                       |                                  |
| Surround       | N/A                   |                       |                                  | N/A                   |                       |                                  | N/A                   |                       |                                  |
| Hearth         | N/A                   |                       |                                  | N/A                   |                       |                                  | N/A                   |                       |                                  |

\*\* Refer to Construction Summary

12. Heating and Air Conditioning

|                      |    |                         |     |
|----------------------|----|-------------------------|-----|
| Air Conditioning     | NO | Gas Provisions Stove    | yes |
| Gas Provisions Dryer | NO | Gas Provisions Barbecue | NO  |
| Comment              |    |                         |     |

\*\* Refer to Construction Summary

13. Electrical

|                     |   |   |                                      |   |                                     |
|---------------------|---|---|--------------------------------------|---|-------------------------------------|
| Plugs and Switches  | <input checked="" type="radio"/> White                        | DECOR   | Above Kitchen Cabinet Light          | <input type="radio"/> Yes                                     | <input checked="" type="radio"/> No |
| Hood Fan            | STANDARD WHITE  |   | Below Kitchen Cabinet Light          | <input type="radio"/> Yes                                     | <input checked="" type="radio"/> No |
| Appliances          | Built in Cooktop  | Built in Oven   | Gas Stove                            | Microwave   |                                     |
|                     | <input type="radio"/> Yes <input checked="" type="radio"/> No | <input type="radio"/> Yes <input checked="" type="radio"/> No | <input checked="" type="radio"/> Yes | <input type="radio"/> Yes <input checked="" type="radio"/> No |                                     |
| Dishwasher Rough-in | Yes   |   |                                      |   |                                     |

\*\* Refer to Construction Summary

14. General Comments

\*\* Refer to Construction Summary

Disclaimers and Notes

- 1) Colours of all materials are as close as possible to builder's selection, but not necessarily identical due to variances in manufacturing.
- 2) Any extras listed above are null and void unless accompanied by a separate invoice/amendment. Said invoice must be paid in full.
- 3) The Purchaser agrees that this colour selection is final and that no changes will be permitted, unless required by the Vendor.
- 4) The Purchaser acknowledges reading and accepting document which contains other miscellaneous disclaimers.

Signature:\_\_\_\_\_Date:\_\_\_\_\_

Page 4 of 4

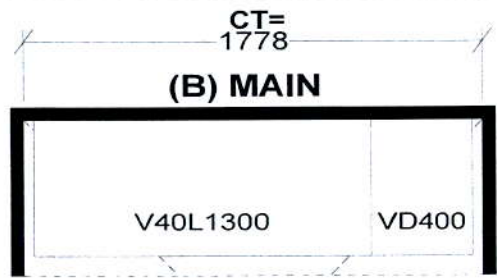
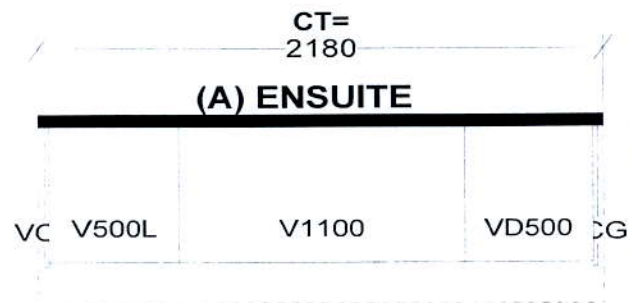
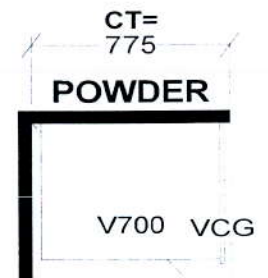
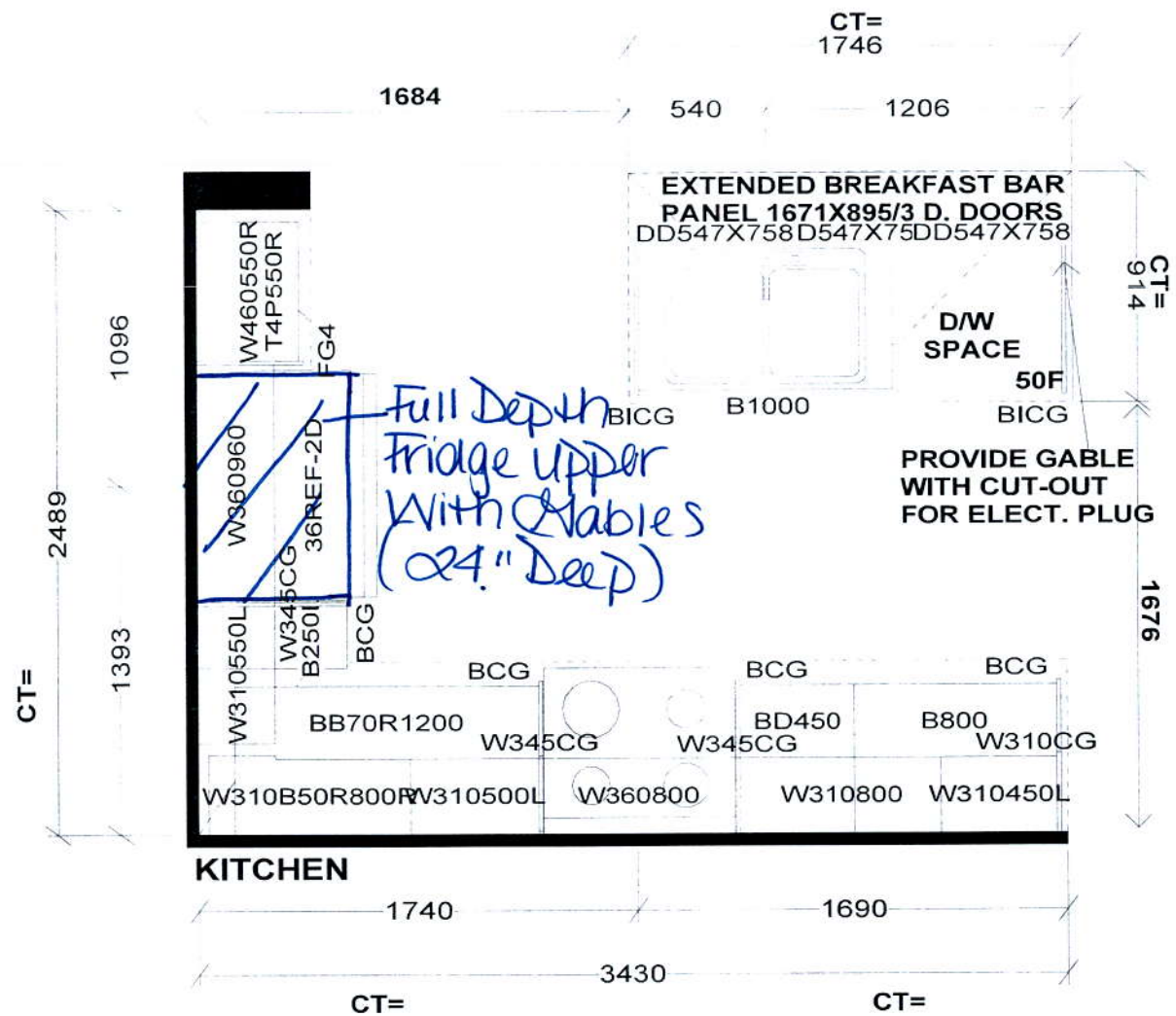

Selba Industries

STANDARD FEATURES:  
 9' CEILINGS WITH D/C BOX  
 1040MM HIGH UPPER CABINETS  
 DISHWASHER SPACE  
 DUMMY DOORS ON EXPOSED BACKS  
 LAMINATE KITCHEN & VANITY COUNTERTOPS

This drawing is the intellectual property of SELBA INDUSTRIES INC. and is an original design which must not be released or copied unless applicable fee has been paid or job order placed.



JOB NUMBER:  
 BUILDER: GREENPARK HOMES  
 SITE NAME: LECCO RIDGE, Milton  
 MODEL: IVY 5X ELEV 1,2,3  
 LOT #:  
 DESIGNER: KS  
 DATE: FEB 13 17

Handwritten initials 'AT' inside a circle.



# IVY 5

2,028 SQ.FT. includes 10 sq ft. of open area

AVAILABLE IN BLOCK: 325, 326, 327, 328, 329, 330

331, 336, 337, 338, 342, 343, 345, 346 & 349

