



CONSTRUCTION SUMMARY

Mountainview Heights (G) - Russell Gardens Building Ltd.

PURCHASERS: RACHELLE E DIPALMA and MATTHEW W WRIGHT

TEL:

LOT / PHASE Block 214 TH 4 / 2	REG. PLAN # 62M-1238	HOUSE TYPE Dewberry 2E Elev 2		
-----------------------------------	-------------------------	----------------------------------	--	--

CABINETRY

1 - KITCHEN - DELETE CABINETS ABOVE STOVE - VENDOR WILL SUPPLY 6 INCH VENT AS PER CONSTRUCTION SPECIFICATIONS AND VENT MAY NOT BE IN THE APPROPRIATE LOCATION FOR INSTALLATION OF PURCHASER SUPPLIED VENT - PURCHASER TO SUPPLY OWN FAN AFTER CLOSING (TEMP. FAN MA 14Aug18 Note:	
1 - CABINETRY - KITCHEN - LIGHT VALENCE 14Aug18 Note:	
1 - CABINETRY - KITCHEN - UPGRADE 2 14Aug18 Note:	

CABINETRY ACCESSORIES

1 - KITCHEN CABINETRY BASE - PIE CUT CORNER CABINET - BASE CABINETRY - UPGRADE 2 14Aug18 Note:	
1 - KITCHEN CABINETRY BASE - POT/PAN DRAWERS (CABINET) - UPGRADE 2 14Aug18 Note:	
1 - KITCHEN CABINETRY UPPER - GLASS DOOR - BEVELED - FINISHED INTERIOR - FITS TALL UPPER CABINETS - PRICE IS PER DOOR - UPGRADE 2 14Aug18 Note:	
1 - KITCHEN CABINETRY UPPER - ANGLED CORNER CABINET - FITS TALL UPPER CABINETS - PER UNIT - UPGRADE 2 14Aug18 Note:	
1 - KITCHEN CABINETRY UPPER - FULL DEPTH ABOVE FRIDGE - WITH GABLES - 600MM - PRICE IS EACH - UPGRADE 2 14Aug18 Note:	

CERAMIC TILE

1 - TILE - UPGRADE 2 FLOOR TILE - - KITCHEN 14Aug18 Note:	
--	--

COUNTER TOP

1 - HARD SURFACE COUNTERTOP - ENSUITE 14Aug18 Note:	
1 - HARD SURFACE COUNTERTOP - KITCHEN 14Aug18 Note:	

ELECTRICAL

1 - PLUG - ELECTRICAL PLUG- ADD PLUG 5FT FROM FLOOR IN GREAT ROOM- SEE SKETCH 14Aug18 Note:	
1 - STANDARD KITCHEN LIGHT TO BE ABOVE ISLAND- SEE SKETCH 14Aug18 Note:	
1 - ABOVE KITCHEN ISLAND - ADD LIGHT AND SWITCH - NO FIXTURE INCLUDED 14Aug18 Note:	
6 - POT LIGHT - LED - SECOND FLOOR INSTALLATION- KITCHEN 14Aug18 Note:	
6 - POT LIGHT - LED - FIRST FLOOR INSTALLATION- GREAT ROOM - WITH DIMMER SWITCH 14Aug18 Note:	
1 - LIGHT AND SWITCH - NO FIXTURE INCLUDED - LIVING ROOM 14Aug18 Note:	
1 - KITCHEN - VALANCE LIGHTING - FLORESCENT LIGHTING 14Aug18 Note:	

CONSTRUCTION SUMMARY

Mountainview Heights (G) - Russell Gardens Building Ltd.

PURCHASERS: RACHELLE E DIPALMA and MATTHEW W WRIGHT

TEL:

LOT / PHASE Block 214 TH 4 / 2	REG. PLAN # 62M-1238	HOUSE TYPE Dewberry 2E Elev 2		
-----------------------------------	-------------------------	----------------------------------	--	--

HARDWOOD FLOORING

1 - LAMINATE -UPGRADE TO CLASSIC PLUS SERIES IN LIEU OF STANDARD LAMINATE 14Aug18 Note:	
--	--

PLUMBING

1 - MASTER ENSUITE SHOWER - ADD CHATEAU TL183/3372/T4171/3669EP/A725 HAND SHOWER WITH SLIDE BAR BESIDE STANDARD SHOWER HEAD 14Aug18 Note:	
1 - SINK - UNDERMOUNT SINK - CONTRAC EMERY #4220CGY- MASTER ENSUITE 14Aug18 Note:	
3 - SINK - DROP-IN SINK - CONTRAC LOLAND #4480BST- BOTH POWDER ROOMS AND MAIN BATH 14Aug18 Note:	
1 - SINK - UNDERMOUNT SINK - BLANCO ESSENTIAL U2 #400008- KITCHEN 14Aug18 Note:	

PROMOTIONAL

1 - LESS CREDIT FROM PURCHASER EXTRA SHEET IN OFFER 14Aug18 Note:	
--	--

STAIRS AND RAILINGS

1 - 1-¾" PICKETS 14Aug18 Note:	
1 - STAINED STAIRS, RAILING AND PICKETS – STANDARD STAIRCASE - PRICE IS PER SET 14Aug18 Note:	

EXTRAS AS PER OFFER

Five (5) White Appliances as per PE Appliances Worksheet Note:	
The Vendor agrees that notwithstanding any other term or provision in this Agreement included in the Purchase Price and in addition to those items detailed in Schedule GP to the Agreement of Purchase and Sale, the Purchaser is entitled to a credit of Fif Worksheet Note:	
The Purchaser acknowledges that the Purchase Price is inclusive of all credits and promotional packages available at the time of purchase. Worksheet Note:	

This Document is Extremely Time Sensitive - Printed 14 Aug 18 at 10:59

Purchasers:

Telephone Res. / Bus:

Decor Advisor:

Lock Date:

RACHELLE E DIPALMA & MATTHEW W WRIGH

/

Natalie Mancuso

14-Aug-18

Property:

Project:

Model and Elevation:

Plan #:

Block 214 TH 4

Russell Gardens Building Ltd.

Dewberry 2E Elev 2

62M-1238

Layout Changes:

Sketch Attached:

Exterior Colour Scheme:

☐ Yes

☒ No

☒ Yes

☐ No

1. Cabinetry

	Style and Colour	Hardware
Kitchen / Breakfast	AMALFI WHITE	2002
Laundry Room	ELISSE	Standard
Powder Room	EVEREST WHITE	2002
Master Ensuite Bathroom	MONACO W350XZ4	2002
Main Bathroom	HASTING CHOCOLATE	2002
GROUND LVL POWDER	MODENA CHOCOLATE	2002

Appliances:

Built In Appliances

Slide In Stove

☐ Yes

☒ No

☐ Yes

☐ No

Dishwasher Cabinet

Stove Opening

Fridge Opening

☐ Closed

☒ Open

41" Upper Cabinets

Please NOTE: Standard Cabinet Height is 30"

NOTE: If not specified, opening will be set to builder's standard opening of approximately 30" width

NOTE: If not specified, opening will be set to builder's standard opening of approximately 37" width x 74" height

** Refer to Construction Summary

2. Counters

	Counter	Edge
Kitchen / Breakfast	QUARTZ- VICTORIA	#360 EDGE
Laundry Room	N/A	
Powder Room	LAMINATE-ARGENTO ROMANO 6697-46	
Master Ensuite Bathroom	QUARTZ- VICTORIA	#360 EDGE
Main Bathroom	LAMINATE-BAHIA GRANITE 4595K-52	
GROUND LVL POWDER	LAMINATE-MYSTIC MOUNT 4761-60	

** Refer to Construction Summary

Purchasers:	RACHELLE E DIPALMA & MATTHEW W WRIGH		Property:	Block 214 TH 4
Telephone Res. / Bus:	/		Project:	Russell Gardens Building Ltd.
Decor Advisor:	Natalie Mancuso		Model and Elevation:	Dewberry 2E Elev 2
Lock Date:	14-Aug-18	14-Aug-18	Plan #:	62M-1238

3. Ceramic Flooring

Entrance Vestibule	TILE- BEACH LIGHT GREY 13X13
Main Hall	LAMINATE
Kitchen / Breakfast	TILE- IND OXIDIZED METAL 12X24
Laundry Room	TILE- ESSENZE NERO 13X13
Powder Room	TILE- RAINBOW WHITE 13X13
Master Ensuite Bathroom	TILE- RAINBOW LIGHT GREY 13X13
Main Bathroom	TILE- BEACH SAND 13X13
GROUND LVL POWDER	TILE- BEACH LIGHT GREY 13X13

At a 45 Threshold-If App.
METAL STRIP THROUGHOUT

** Refer to Construction Summary

4. Ceramic Wall Tile

Master Ensuite Bathroom	Selection	Describe
Tub Deck Wall	TILE- NATURALE GRIGIO 8X10	
Tub Deck		
Tub Deck Skirt		
Shower Stall	TILE- NATURALE GRIGIO 8X10	
Bathtub Enclosure Walls		
Main Bathroom	TILE- CARRARA MATTE MH125 8X10	
GROUND LVL POWDER		

Kitchen Backsplash

**** Refer to Construction Summary - STANDARD GROUT THROUGHOUT UNLESS SPECIFIED**

5. Plumbing Fixtures

All Bathrooms	White
---------------	-------

Whirlpool

☐ Yes ☒ No

Dishwasher Rough-In ☒ Yes ☐ No

Waterline for Fridge ☐ Yes ☒ No

**** Refer to Construction Summary**

6. Trim Carpentry

Interior Doors	CLERMONT
Interior Trim	2 3/4" CASING WITH 4 1/4" BASEBOARD - COLONIAL
Door Handles	As Per Construction Specifications
Exterior Front Door Handle	As Per Construction Specifications

**** Refer to Construction Summary**

Initials:

Page 2 of 4

Purchasers: RACHELLE E DIPALMA & MATTHEW W WRIGH

Telephone Res. / Bus: /

Decor Advisor: Natalie Mancuso

Lock Date: 14-Aug-18

Property: Block 214 TH 4

Project: Russell Gardens Building Ltd.

Model and Elevation: Dewberry 2E Elev 2

Plan #: 62M-1238

7. Other Flooring

Main Hall	LAMINATE-CLASSIC PLUS - HAVANA OAK NATURAL QS-UM1655
Living Room	LAMINATE-CLASSIC PLUS - HAVANA OAK NATURAL QS-UM1655
Dining Room	LAMINATE-CLASSIC PLUS - HAVANA OAK NATURAL QS-UM1655
Family Room	N/A
Den / Library / Study	N/A
Basement Landing(If Applies)	N/A
Lower Landing (If Applies)	TILE- BEACH LIGHT GREY 13X13
Upper Landing	LAMINATE-CLASSIC PLUS - HAVANA OAK NATURAL QS-UM1655
Upper Hall	CARPET-BEAULIEU - A4447 WEBSTER SDN - PEARL GREY 84195
Master Bedroom	CARPET-BEAULIEU - A4447 WEBSTER SDN - PEARL GREY 84195
Bedroom #2	CARPET-BEAULIEU - A4447 WEBSTER SDN - PEARL GREY 84195
Bedroom #3	CARPET-BEAULIEU - A4447 WEBSTER SDN - PEARL GREY 84195
Bedroom #4	CARPET-BEAULIEU - A4447 WEBSTER SDN - PEARL GREY 84195
Bedroom #5	
GREAT ROOM	LAMINATE-CLASSIC PLUS - HAVANA OAK NATURAL QS-UM1655

Underpad	Type	Area
	STANDARD UNDERPAD	SECOND FLOOR

** Refer to Construction Summary

8. Railings and Pickets

Railing Type	AS PER CONSTRUCTION SPECIFICATIONS	Colour	TORLYS- HAVANNA OAK NATURAL
Picket Type	1 3/4 PICKETS COLONIAL	Colour	TORLYS- HAVANNA OAK NATURAL
Stringer / Riser	AS PER CONSTRUCTION SPECIFICATIO	Colour	TORLYS- HAVANNA OAK NATURAL
Treads	AS PER CONSTRUCTION SPECIFICATIO	Colour	TORLYS- HAVANNA OAK NATURAL
Red Oak Stairs with Semi Gloss Finish			<input checked="" type="radio"/> Yes <input type="radio"/> No

** Refer to Construction Summary

9. Wall Paint Flat Finish

Main & Upper Hall	25 OYSTER	Master Bedroom	25 OYSTER
Living Room	25 OYSTER	Bedroom #2	25 OYSTER
Dining Room	25 OYSTER	Bedroom #3	25 OYSTER
Kitchen / Breakfast	25 OYSTER	Bedroom #4	25 OYSTER
Family Room		Bedroom #5	
Powder Room	25 OYSTER	Master Ensuite	25 OYSTER
Laundry Room	25 OYSTER	Main Bathroom	25 OYSTER
Den/Library		GROUND LVL POWDER	25 OYSTER
Trim Paint-Semi Gloss	BIRCH WHITE	GREAT ROOM	25 OYSTER

Smooth Ceilings First Floor ☐ Yes ☒ No

** Refer to Construction Summary

Initials:





Purchasers: RACHELLE E DIPALMA & MATTHEW W WRIGH
Telephone Res. / Bus: / Project: Russell Gardens Building Ltd.
Decor Advisor: Natalie Mancuso Model and Elevation: Dewberry 2E Elev 2
Lock Date: 14-Aug-18 14-Aug-18 Plan #: 62M-1238

10. Plaster Mouldings and Medallions

Entrance Vestibule			Kitchen/Breakfast
Main Hall			Den/Library
Living Room			Lower Landing
Dining Room			
Family Room			

**** Refer to Construction Summary****11. Fireplace**

Living Room			Family Room			Other Room - Specify		
Purchased	As Per Plan	N/A	Purchased	As Per Plan	N/A	Purchased	As Per Plan	N/A
<input type="radio"/>	<input type="radio"/>	<input checked="" type="radio"/>	<input type="radio"/>	<input type="radio"/>	<input checked="" type="radio"/>	<input type="radio"/>	<input type="radio"/>	<input checked="" type="radio"/>

Fireplace Type
Mantle Type
Colour / Stain
Surround
Hearth

**** Refer to Construction Summary****12. Heating and Air Conditioning**

Air Conditioning	NO	Gas Provisions Stove	NO
Gas Provisions Dryer	NO	Gas Provisions Barbecue	NO
Comment			

**** Refer to Construction Summary****13. Electrical**

Plugs and Switches	<input checked="" type="radio"/> White	DECOR	Above Kitchen Cabinet Light	<input type="radio"/> Yes <input checked="" type="radio"/> No
Hood Fan	STANDARD WHITE		Below Kitchen Cabinet Light	<input checked="" type="radio"/> Yes <input type="radio"/> No
Appliances	Built in Cooktop	Built in Oven	Gas Stove	Microwave
	<input type="radio"/> Yes <input checked="" type="radio"/> No	<input type="radio"/> Yes <input checked="" type="radio"/> No	Yes <input checked="" type="radio"/> No	Yes <input checked="" type="radio"/> No
Dishwasher Rough-in	Yes			

**** Refer to Construction Summary****14. General Comments****** Refer to Construction Summary****Disclaimers and Notes**

- Colours of all materials are as close as possible to builder's selection, but not necessarily identical due to variances in manufacturing.
- Any extras listed above are null and void unless accompanied by a separate invoice/amendment. Said invoice must be paid in full.
- The Purchaser agrees that this colour selection is final and that no changes will be permitted, unless required by the Vendor.
- The Purchaser acknowledges reading and accepting document which contains other miscellaneous disclaimers.

Signature: R. DipalmaDate: Aug. 14/18Signature: M. WrightDate: Aug. 14/18

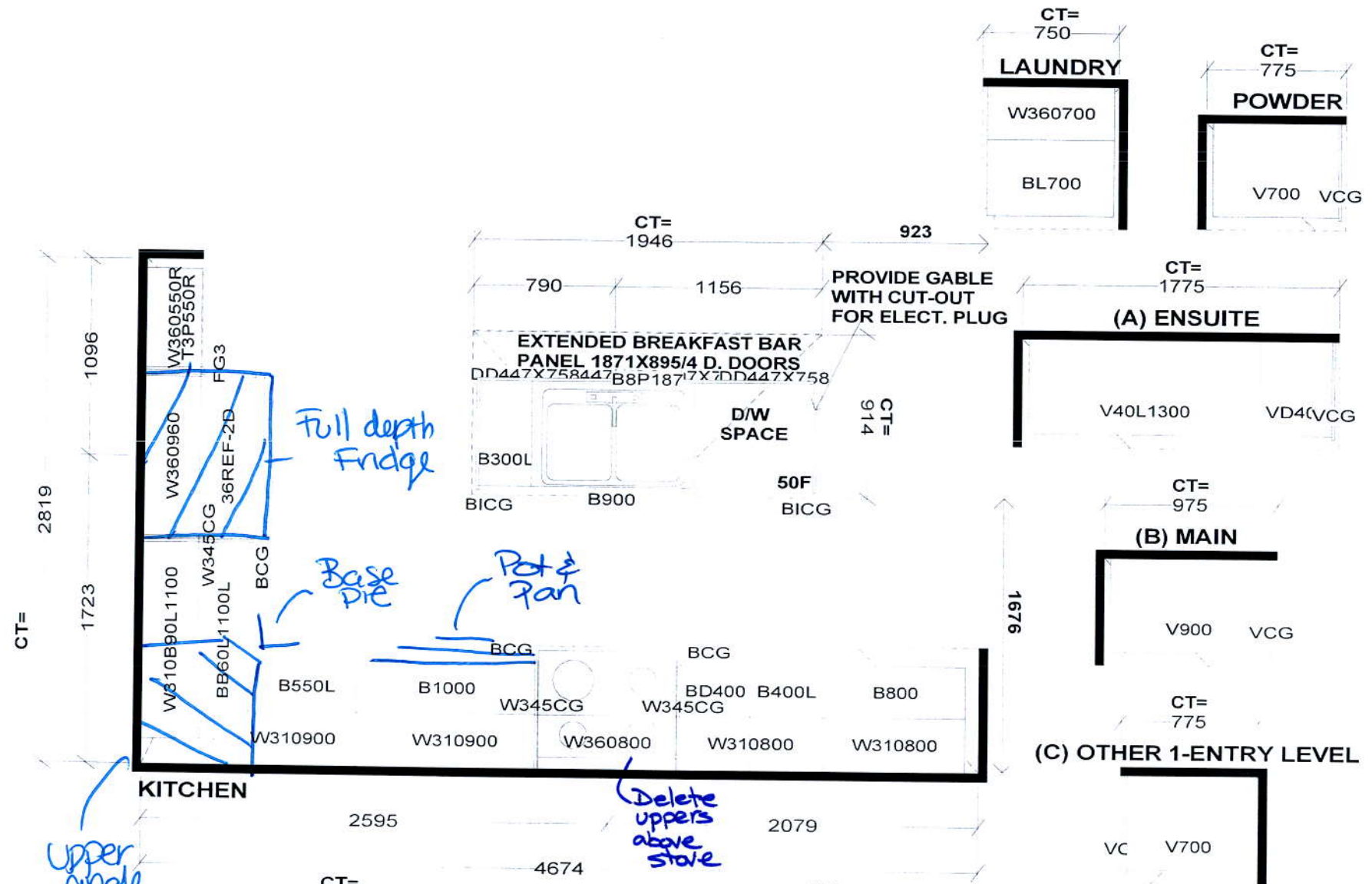

Selba Industries

W WIDTH _____ W HGHT _____ W CNT _____ FL HGHT _____ DWY H _____ ST CENT _____ 2X4 _____ VENT BOX COVER _____

STANDARD FEATURES:
1040MM HIGH UPPERS (9' Ceiling-No D/C Box)
DUMMY DOORS
D/W SPACE
LAMINATE KITCHEN & VANITY COUNTERTOPS

This drawing is the intellectual property of SELBA INDUSTRIES INC. and is an original design which must not be released or copied unless applicable fee has been paid or job order placed.



JOB NUMBER:
BUILDER: GREENPARK
SITE NAME: RUSSEL GARDENS
MODEL: DEWBERRY 2EX ELEV 1,2
LOT #:
DESIGNER: KS
DATE: SEPT 13 17

AVAILABLE IN BLOCK 213, 214 & 215



Submitted: November 20, 2014; Accepted: July 10, 2015; Published: August 10, 2015

