

<div><div></div><div><div>CONSTRUCTION SUMMARY</div><div>Saddle Ridge (G) - Lecco Ridge Developments Inc.</div></div></div>				
PURCHASERS: SRINIVAS KRISHN KASTURI and MAMATHA GRAMA RAMAKRISHA			TEL: RES.: 647-774-8542	
LOT / PHASE Block 324 TH 2 / 1	REG. PLAN # 20M-1184	HOUSE TYPE Ivy 1 Elev 3		

CABINETRY ACCESSORIES

1 - KITCHEN CABINETRY BASE - PIE CUT CORNER CABINET - BASE CABINETRY - STANDARD 31May18 Note:	
2 - PANTRY UNIT UPGRADE - TO GO FROM 300MM TO 600MM DEEP - PRICE IS PER FOOT - STANDARD 31May18 Note:	
1 - KITCHEN CABINETRY UPPER - FULL DEPTH ABOVE FRIDGE - WITH GABLES - 600MM - PRICE IS EACH - STANDARD 31May18 Note:	
1 - KITCHEN CABINETRY UPPER - MICROWAVE SHELF STANDARD - 700MM WIDE - STANDARD 15May18 Note:	

CARPET

1 - UNDERPAD UPGRADE 3 - - BEDROOM 3 31May18 Note:	
1 - UNDERPAD UPGRADE 3 - - BEDROOM 2 31May18 Note:	
1 - UNDERPAD UPGRADE 3 - - MASTER BEDROOM 31May18 Note:	

ELECTRICAL

1 - PLUG - ELECTRICAL PLUG - FOR MICROWAVE SHELF 15May18 Note:	
---	--

HARDWOOD FLOORING

1 - LAMINATE - PARK LANE SERIES - - UPPER HALL 31May18 Note:	
---	--

PLUMBING

1 - WASHROOM - 3 PIECE ROUGH-IN IN BASEMENT 13Apr17 Note:	
--	--

PROMOTIONAL

1 - LESS BALANCE OF CREDIT FROM PURCHASER EXTRA SHEET IN OFFER 31May18 Note:	
1 - PARTIAL REDEMPTION OF PROMOTIONAL PACKAGE \$645.00 BALANCE (\$3,715.00) FORWARD TO BE USED AT A LATER DATE. ORIGINAL PROMOTIONAL PACKAGE OF \$5,000.00 AS PER SCHEDULE PE 15May18 Note:	
1 - PARTIAL REDEMPTION OF PROMOTIONAL PACKAGE \$\$\$\$\$\$ BALANCE FORWARD TO BE USED AT A LATER DATE. ORIGINAL PROMOTIONAL PACKAGE OF \$\$\$\$\$\$ AS PER SCHEDULE PE DATED MMMDDYYYY. 13Apr17 Note: ORIGINAL PROMO PACKAGE - \$5000.00 BALANCE FORWARD - \$4360.00	

STAIRS AND RAILINGS

1 - STAINED STAIRS, RAILING AND PICKETS – STANDARD STAIRCASE - PRICE IS PER SET 31May18 Note:	
--	--

RECEIVED JUN 01 2018



CONSTRUCTION SUMMARY				
Saddle Ridge (G) - Lecco Ridge Developments Inc.				
PURCHASERS: SRINIVAS KRISHN KASTURI and MAMATHA GRAMA RAMAKRISHA			TEL: RES.: 647-774-8542	
LOT / PHASE Block 324 TH 2 / 1	REG. PLAN # 20M-1184	HOUSE TYPE Ivy 1 Elev 3		

EXTRAS AS PER OFFER

Five (5) White Appliances as per PE Appliances <i>Worksheet</i> Note:	
The Vendor agrees that notwithstanding any other term or provision in this Agreement included in the Purchase Price and in addition to those items detailed in Schedule GP to the Agreement of Purchase and Sale, the Purchaser is entitled to a credit of Fi <i>Worksheet</i> Note:	
The Purchaser acknowledges that the Purchase Price is inclusive of all credits and promotional packages available at the time of purchase. <i>Worksheet</i> Note:	

This Document is Extremely Time Sensitive - Printed 31 May 18 at 14:37

Purchasers:

SRINIVAS KRISHN KASTURI & MAMATHA GRAP

Telephone Res. / Bus:

(647) 774-8542 /

Decor Advisor:

Candace Forza

Lock Date:

31-May-18

Property:

Block 324 TH 2

Project:

Lecco Ridge Developments Inc.

Model and Elevation:

Ivy 1 Elev 3

Plan #:

20M-1184

Layout Changes:

☐ Yes ☒ No

Sketch Attached:

☒ Yes ☐ No

Exterior Colour Scheme:

1. Cabinetry

	Style and Colour	Hardware
Kitchen / Breakfast	MODENA WHITE	2004
Laundry Room	BASEMENT	N/A
Powder Room	MODENA WHITE	2004
Master Ensuite Bathroom	MONACO W350XZ4	2004
Main Bathroom	MONACO W350XZ4	2004
	N/A	N/A
	N/A	N/A
	N/A	N/A
	N/A	N/A

Appliances:

Built In Appliances

☐ Yes ☒ No

Slide In Stove

☐ Yes ☒ No

Dishwasher Cabinet

☐ Closed ☒ Open

41" Upper Cabinets

☒ Yes ☐ No

Please NOTE:

Standard Cabinet Height is 30"

Stove Opening

NOTE: If not specified, opening will be set to builder's standard opening of approximately 30" width

Fridge Opening

NOTE: If not specified, opening will be set to builder's standard opening of approximately 37" width x 74" height

** Refer to Construction Summary

2. Counters

	Counter	Edge
Kitchen / Breakfast	LAMINATE-BLACK ALICANTE 4926K-07	
Laundry Room	N/A	
Powder Room	LAMINATE-BLACK ALICANTE 4926K-07	
Master Ensuite Bathroom	LAMINATE-INUK SHUK CARBON P-346 LM	
Main Bathroom	LAMINATE-INUK SHUK CARBON P-346 LM	
	N/A	
	N/A	
	N/A	
	N/A	

** Refer to Construction Summary

Purchasers:

SRINIVAS KRISHN KASTURI & MAMATHA GRAP

Telephone Res. / Bus:

(647) 774-8542 /

Decor Advisor:

Candace Forza

Lock Date:

31-May-18

Property:

Block 324 TH 2

Project:

Lecco Ridge Developments Inc.

Model and Elevation:

Ivy 1 Elev 3

Plan #:

20M-1184

3. Ceramic Flooring

		At a 45 Threshold-If App.	
Entrance Vestibule	TILE-RAINBOW DARK GREY-13X13	<input type="checkbox"/>	METAL STRIP
Main Hall	LAMINATE	<input type="checkbox"/>	
Kitchen / Breakfast	TILE-RAINBOW DARK GREY-13X13	<input type="checkbox"/>	METAL STRIP
Laundry Room	N/A	<input type="checkbox"/>	
Powder Room	TILE-RAINBOW DARK GREY-13X13	<input type="checkbox"/>	
Master Ensuite Bathroom	TILE-ESSENSE GRIGIO-13X13	<input type="checkbox"/>	METAL STRIP
Main Bathroom	TILE-ESSENSE GRIGIO-13X13	<input type="checkbox"/>	METAL STRIP
	N/A	<input type="checkbox"/>	
	N/A	<input type="checkbox"/>	
	N/A	<input type="checkbox"/>	
	N/A	<input type="checkbox"/>	

** Refer to Construction Summary

4. Ceramic Wall Tile

Master Ensuite Bathroom	Selection	Describe
Tub Deck Wall	TILE-GOLF GRIGIO-8X10	
Tub Deck	N/A	
Tub Deck Skirt	N/A	
Shower Stall	TILE-GOLF GRIGIO-8X10	
Bathtub Enclosure Walls	N/A	
	N/A	
Main Bathroom	TILE-GOLF GRIGIO-8X10	
	N/A	
	N/A	
	N/A	
Kitchen Backsplash	N/A	

** Refer to Construction Summary - STANDARD GROUT THROUGHOUT UNLESS SPECIFIED

5. Plumbing Fixtures

All Bathrooms

White

N/A

N/A

N/A

N/A

N/A

Whirlpool

N/A

☐ Yes ☒ No

Dishwasher Rough-In

☒ Yes ☐ No

Waterline for Fridge

☐ Yes ☒ No

** Refer to Construction Summary

6. Trim Carpentry

Interior Doors	CLASSIQUE
Interior Trim	2 3/4" CASING WITH 4 1/4" BASEBOARD - COLONIAL
Door Handles	As Per Construction Specifications
Exterior Front Door Handle	As Per Construction Specifications

** Refer to Construction Summary

Purchasers:

SRINIVAS KRISHN KASTURI & MAMATHA GRAP

Telephone Res. / Bus:

(647) 774-8542 /

Decor Advisor:

Candace Forza

Lock Date:

31-May-18

Property:

Block 324 TH 2

Project:

Lecco Ridge Developments Inc.

Model and Elevation:

Ivy 1 Elev 3

Plan #:

20M-1184

7. Other Flooring

Main Hall	LAMINATE-MANHATTAN - LAVA ROCK OAK TL-15021	
Living Room	LAMINATE-MANHATTAN - LAVA ROCK OAK TL-15021	
Dining Room	LAMINATE-MANHATTAN - LAVA ROCK OAK TL-15021	
Family Room	N/A	
Den / Library / Study	N/A	
Basement Landing(If Applies)	N/A	
Lower Landing (If Applies)	N/A	
Upper Landing	LAMINATE-MANHATTAN - LAVA ROCK OAK TL-15021	
Upper Hall	LAMINATE-MANHATTAN - LAVA ROCK OAK TL-15021	
Master Bedroom	CARPET-SHAW - E0949 NEWBERN CLASSIC - CASTLE GREY 55501	
Bedroom #2	CARPET-SHAW - E0949 NEWBERN CLASSIC - CASTLE GREY 55501	
Bedroom #3	CARPET-SHAW - E0949 NEWBERN CLASSIC - CASTLE GREY 55501	
Bedroom #4	N/A	
Bedroom #5	N/A	
	N/A	
	N/A	
	N/A	
Underpad	Type	Area
	STAINMASTER WITH ODOR GAURD	BEDROOMS ONLY

** Refer to Construction Summary

8. Railings and Pickets

Railing Type	As Per Construction Specifications	Colour	TORLYS LAVA RED OAK
Picket Type	As Per Construction Specifications	Colour	TORLYS LAVA RED OAK
Stringer / Riser	As Per Construction Specifications	Colour	TORLYS LAVA RED OAK
Treads	As Per Construction Specifications	Colour	TORLYS LAVA RED OAK
Red Oak Stairs with Semi Gloss Finish		<input checked="" type="radio"/> Yes <input type="radio"/> No	

** Refer to Construction Summary

9. Wall Paint Flat Finish

Main & Upper Hall	43 BIRCH WHITE	Master Bedroom	43 BIRCH WHITE
Living Room	43 BIRCH WHITE	Bedroom #2	43 BIRCH WHITE
Dining Room	43 BIRCH WHITE	Bedroom #3	43 BIRCH WHITE
Kitchen / Breakfast	43 BIRCH WHITE	Bedroom #4	N/A
Family Room	N/A	Bedroom #5	N/A
Powder Room	43 BIRCH WHITE	Master Ensuite	43 BIRCH WHITE
Laundry Room	N/A	Main Bathroom	43 BIRCH WHITE
Den/Library	N/A		N/A
Trim Paint-Semi Gloss	BIRCH WHITE		N/A
	N/A		N/A
	N/A		N/A
Smooth Ceilings First Floor	<input type="radio"/> Yes <input checked="" type="radio"/> No		

** Refer to Construction Summary

Purchasers:

SRINIVAS KRISHN KASTURI & MAMATHA GRAP

Telephone Res. / Bus:

(647) 774-8542 /

Decor Advisor:

Candace Forza

Lock Date:

31-May-18

Property:

Block 324 TH 2

Project:

Lecco Ridge Developments Inc.

Model and Elevation:

Ivy 1 Elev 3

31-May-18

Plan #:

20M-1184

10. Plaster Mouldings and Medallions

Entrance Vestibule	N/A	N/A	Kitchen/Breakfast	N/A	N/A
Main Hall	N/A	N/A	Den/Library	N/A	N/A
Living Room	N/A	N/A	Lower Landing	N/A	N/A
Dining Room	N/A	N/A		N/A	N/A
Family Room	N/A	N/A			

** Refer to Construction Summary

11. Fireplace

	Living Room			Family Room			Other Room - Specify		
	Purchased	As Per Plan	N/A	Purchased	As Per Plan	N/A	Purchased	As Per Plan	N/A
	<input type="radio"/>	<input type="radio"/>	<input checked="" type="radio"/>	<input type="radio"/>	<input type="radio"/>	<input checked="" type="radio"/>	<input type="radio"/>	<input type="radio"/>	<input checked="" type="radio"/>
Fireplace Type	N/A			N/A			N/A		
Mantle Type	N/A			N/A			N/A		
Colour / Stain	N/A			N/A			N/A		
Surround	N/A			N/A			N/A		
Hearth	N/A			N/A			N/A		

** Refer to Construction Summary

12. Heating and Air Conditioning

Air Conditioning	NO	Gas Provisions Stove	NO
Gas Provisions Dryer	NO	Gas Provisions Barbecue	NO
Comment			

** Refer to Construction Summary

13. Electrical

Plugs and Switches	<input checked="" type="radio"/> White	DECOR	Above Kitchen Cabinet Light	<input type="radio"/> Yes	<input checked="" type="radio"/> No
Hood Fan	STANDARD WHITE		Below Kitchen Cabinet Light	<input type="radio"/> Yes	<input checked="" type="radio"/> No
Appliances	Built in Cooktop	Built in Oven	Gas Stove	Microwave	
	<input type="radio"/> Yes <input checked="" type="radio"/> No	<input type="radio"/> Yes <input checked="" type="radio"/> No	<input type="radio"/> Yes <input checked="" type="radio"/> No	<input checked="" type="radio"/> Yes	<input type="radio"/> No
Dishwasher Rough-in	Yes				

** Refer to Construction Summary

14. General Comments

** Refer to Construction Summary

Disclaimers and Notes

- 1) Colours of all materials are as close as possible to builder's selection, but not necessarily identical due to variances in manufacturing.

2) Any extras listed above are null and void unless accompanied by a separate invoice/amendment. Said invoice must be paid in full.

3) The Purchaser agrees that this colour selection is final and that no changes will be permitted, unless required by the Vendor.

4) The Purchaser acknowledges reading and accepting document which contains other miscellaneous disclaimers.

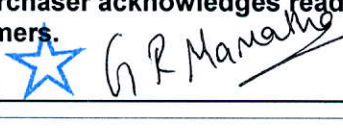
Signature: 

Date: May 31/18

Signature: _____

Date: _____

IVY 1

1,578 SQ.FT.

AVAILABLE IN BLOCK: 324, 327, 328, 329, 330, 332, 334, 335, 337, 338, 341, 342, 343, 344 & 345

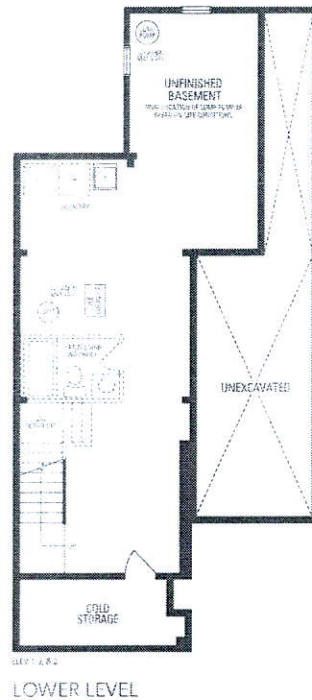

micro
wave
shelf
+ plug

May 15.

