



CONSTRUCTION SUMMARY

Saddle Ridge (G) - Lecco Ridge Developments Inc.

PURCHASERS: SAUD AHMAD and AYESHA NAZNEEN

TEL:

LOT / PHASE Block 330 TH 2 / 1	REG. PLAN # 20M-1184	HOUSE TYPE Ivy 4 Elev 2		
-----------------------------------	-------------------------	----------------------------	--	--

CABINETRY ACCESSORIES

1 - KITCHEN CABINETRY UPPER - FULL DEPTH ABOVE FRIDGE - WITH GABLES - 600MM - PRICE IS EACH - STANDARD 23May18 Note:	
---	--

CERAMIC TILE

1 - TILE - UPGRADE 1 FLOOR TILE - - SIDE HALL 23May18 Note:	
1 - TILE - UPGRADE 1 FLOOR TILE - - SIDE ENTRANCE 23May18 Note:	
1 - TILE - UPGRADE 1 FLOOR TILE - - POWDER ROOM 23May18 Note:	
1 - TILE - UPGRADE 1 FLOOR TILE - - KITCHEN 23May18 Note:	
1 - TILE - UPGRADE 1 FLOOR TILE - - FOYER 23May18 Note:	

HARDWOOD FLOORING

1 - LAMINATE - PARK LANE SERIES - - UPPER HALL 23May18 Note:	
---	--

PLUMBING

1 - WASHROOM - 3 PIECE ROUGH-IN IN BASEMENT 13Feb17 Note:	
--	--

PROMOTIONAL

1 - LESS BALANCE OF CREDIT FROM PURCHASER EXTRA SHEET IN OFFER 23May18 Note:	
1 - PARTIAL REDEMPTION OF PROMOTIONAL PACKAGE \$\$\$\$\$\$ BALANCE FORWARD TO BE USED AT A LATER DATE. ORIGINAL PROMOTIONAL PACKAGE OF \$\$\$\$ AS PER SCHEDULE PE DATED MMMDDYYYY. 13Feb17 Note: ORIGINAL PROMOTIONAL PACKAGE \$5,000.00 BALANCE FORWARD \$4,360.00	

STAIRS AND RAILINGS

1 - STAINED STAIRS, RAILING AND PICKETS – STANDARD STAIRCASE - PRICE IS PER SET 23May18 Note:	
--	--

EXTRAS AS PER OFFER

Five (5) White Appliances as per PE Appliances Worksheet Note:	
COMPLETE CENTRAL AIR CONDITIONER. Worksheet Note:	
The Purchaser acknowledges that the Purchase Price is inclusive of all credits and promotional packages available at the time of purchase. Worksheet Note:	
The Vendor agrees that notwithstanding any other term or provision in this Agreement included in the Purchase Price and in addition to those items detailed in Schedule GP to the Agreement of Purchase and Sale, the Purchaser is entitled to a credit of Fiv Worksheet Note:	

RECEIVED MAY 24 2018

This Document is Extremely Time Sensitive - Printed 23 May 18 at 15:36

Purchasers:SAUD AHMAD & AYESHA NAZNEEN

Property:Block 330 TH 2

Telephone Res. / Bus: /

Project:Lecco Ridge Developments Inc.

Decor Advisor:Natalie Mancuso

Model and Elevation:Ivy 4 Elev 2

Lock Date:23-May-18

23-May-18

Plan #:20M-1184

Layout Changes:☐ Yes ☐ No

Sketch Attached:☐ Yes ☐ No

Exterior Colour Scheme:

1. Cabinetry

	Style and Colour	Hardware
Kitchen / Breakfast	HASTING CHOCOLATE	2004
Laundry Room	ELISSE	
Powder Room	HASTING CHOCOLATE	2004
Master Ensuite Bathroom	EVEREST WHITE	2004
Main Bathroom	EVEREST WHITE	2004

Appliances:

Built In Appliances☐ Yes ☒ No

Slide In Stove☐ Yes ☒ No

Dishwasher Cabinet

☐ Closed ☒ Open

41" Upper Cabinets☒ Yes ☐ No

Please NOTE: Standard Cabinet Height is 30"

Stove Opening

NOTE: If not specified, opening will be set to builder's standard opening of approximately 30" width

Fridge Opening

NOTE: If not specified, opening will be set to builder's standard opening of approximately 37" width x 74" height

** Refer to Construction Summary

2. Counters

	Counter	Edge
Kitchen / Breakfast	LAMINATE-WHITE TIGRIS 4783-60	
Laundry Room		
Powder Room	LAMINATE-WHITE CARRARA 4924-38	
Master Ensuite Bathroom	LAMINATE-INUK SHUK GREY P-344 LM	
Main Bathroom	LAMINATE-ELEMENTAL CONCRETE 8830-58	

** Refer to Construction Summary

Purchasers:SAUD AHMAD & AYESHA NAZNEEN

Property: Block 330 TH 2

Telephone Res. / Bus: /

Project: Lecco Ridge Developments Inc.

Decor Advisor: Natalie Mancuso

Model and Elevation: Ivy 4 Elev 2

Lock Date: 23-May-18

23-May-18

Plan #: 20M-1184

3. Ceramic Flooring

		At a 45	Threshold-If App.
Entrance Vestibule	TILE-FM45GL0015 GLOSSY WHITE 18X18	<input type="checkbox"/>	METAL WHERE APPL
Main Hall	LAMINATE	<input type="checkbox"/>	
Kitchen / Breakfast	TILE-FM45GL0015 GLOSSY WHITE 18X18	<input type="checkbox"/>	
Laundry Room	TILE-ESSENZE GRIGIO 13X13	<input type="checkbox"/>	
Powder Room	TILE-FM45GL0015 GLOSSY WHITE 18X18	<input type="checkbox"/>	
Master Ensuite Bathroom	TILE-ESSENZE GRIGIO 13X13	<input type="checkbox"/>	
SIDE HALL AND ENTRAN	TILE-FM45GL0015 GLOSSY WHITE 18X18	<input type="checkbox"/>	
		<input type="checkbox"/>	
		<input type="checkbox"/>	
		<input type="checkbox"/>	
		<input type="checkbox"/>	

** Refer to Construction Summary

4. Ceramic Wall Tile

Master Ensuite Bathroom	Selection	Describe
Tub Deck Wall	TILE- NATURALE GRIGIO 8X10	
Tub Deck		
Tub Deck Skirt		
Shower Stall	TILE-NATURALE GRIGIO 8X10	
Bathtub Enclosure Walls		
Main Bathroom	TILE-NATURALE GRIGIO 8X10	
Kitchen Backsplash		

** Refer to Construction Summary - STANDARD GROUT THROUGHOUT UNLESS SPECIFIED

5. Plumbing Fixtures

All Bathrooms

White

Whirlpool

☐ Yes☒ No

Dishwasher Rough-In

☒ Yes☐ No

Waterline for Fridge

☐ Yes☒ No

** Refer to Construction Summary

6. Trim Carpentry

Interior Doors	CLERMONT
Interior Trim	STANDARD
Door Handles	As Per Construction Specifications
Exterior Front Door Handle	As Per Construction Specifications

** Refer to Construction Summary

Property: Block 330 TH 2

Project: Lecco Ridge Developments Inc.

Model and Elevation: Ivy 4 Elev 2

23-May-18

Plan #: 20M-1184

7. Other Flooring

Underpad	Type	Area

**** Refer to Construction Summary**

8. Railings and Pickets

Railing Type	AS PER CONSTRUCTION SPECIFICATIONS	Colour	TORLYS HERITAGE OAK
Picket Type	AS PER CONSTRUCTION SPECIFICATIONS	Colour	TORLYS HERITAGE OAK
Stringer / Riser	As Per Construction Specifications	Colour	TORLYS HERITAGE OAK
Treads	Standard	Colour	TORLYS HERITAGE OAK
Red Oak Stairs with Semi Gloss Finish		<input checked="checked" type="radio"/> Yes <input type="radio"/> No	

**** Refer to Construction Summary**

9. Wall Paint Flat Finish

Smooth Ceilings First Floor ☐ Yes ☒ No

**** Refer to Construction Summary**

☒ No

**** Refer to Construction Summary**

Initials: 

Purchasers:SAUD AHMAD & AYESHA NAZNEEN

Property:Block 330 TH 2

Telephone Res. / Bus: /

Project:Lecco Ridge Developments Inc.

Decor Advisor:Natalie Mancuso

Model and Elevation:Ivy 4 Elev 2

Lock Date:23-May-18

23-May-18

Plan #:20M-1184

10. Plaster Mouldings and Medallions

Entrance Vestibule			Kitchen/Breakfast		
Main Hall			Den/Library		
Living Room			Lower Landing		
Dining Room					
Family Room					

** Refer to Construction Summary

11. Fireplace

Living Room	Family Room	Other Room - Specify
Purchased <input type="radio"/>	Purchased <input type="radio"/>	Purchased <input type="radio"/>
As Per Plan <input type="radio"/>	As Per Plan <input type="radio"/>	As Per Plan <input type="radio"/>
N/A <input type="radio"/>	N/A <input checked="" type="radio"/>	N/A <input type="radio"/>

Fireplace Type			
Mantle Type			
Colour / Stain			
Surround			
Hearth			

** Refer to Construction Summary

12. Heating and Air Conditioning

Air Conditioning	<input type="text" value="yes."/>	Gas Provisions Stove	<input type="text" value="NO"/>
Gas Provisions Dryer	<input type="text" value="NO"/>	Gas Provisions Barbecue	<input type="text" value="NO"/>
Comment			

** Refer to Construction Summary

13. Electrical

Plugs and Switches	<input checked="" type="radio"/> White	<input type="text" value="DECOR"/>	Above Kitchen Cabinet Light	<input type="radio"/> Yes <input checked="" type="radio"/> No
Hood Fan	<input type="text" value="STANDARD WHITE"/>		Below Kitchen Cabinet Light	<input type="radio"/> Yes <input checked="" type="radio"/> No
Appliances	Built in Cooktop <input type="radio"/> Yes <input checked="" type="radio"/> No	Built in Oven <input type="radio"/> Yes <input checked="" type="radio"/> No	Gas Stove <input type="radio"/> Yes <input checked="" type="radio"/> No	Microwave <input type="radio"/> Yes <input checked="" type="radio"/> No
Dishwasher Rough-in	<input type="text" value="Yes"/>			

** Refer to Construction Summary

14. General Comments

** Refer to Construction Summary

Disclaimers and Notes

1) Colours of all materials are as close as possible to builder's selection, but not necessarily identical due to variances in manufacturing.

2) Any extras listed above are null and void unless accompanied by a separate invoice/amendment. Said invoice must be paid in full.

3) The Purchaser agrees that this colour selection is final and that no changes will be permitted, unless required by the Vendor.

4) The Purchaser acknowledges reading and accepting document which contains other miscellaneous disclaimers.

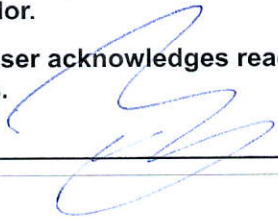
Signature:

Date:05/23/2018

Signature:

Date:05/23/2018

Page 4 of 4

Printed 5/23/2018 15:43:24

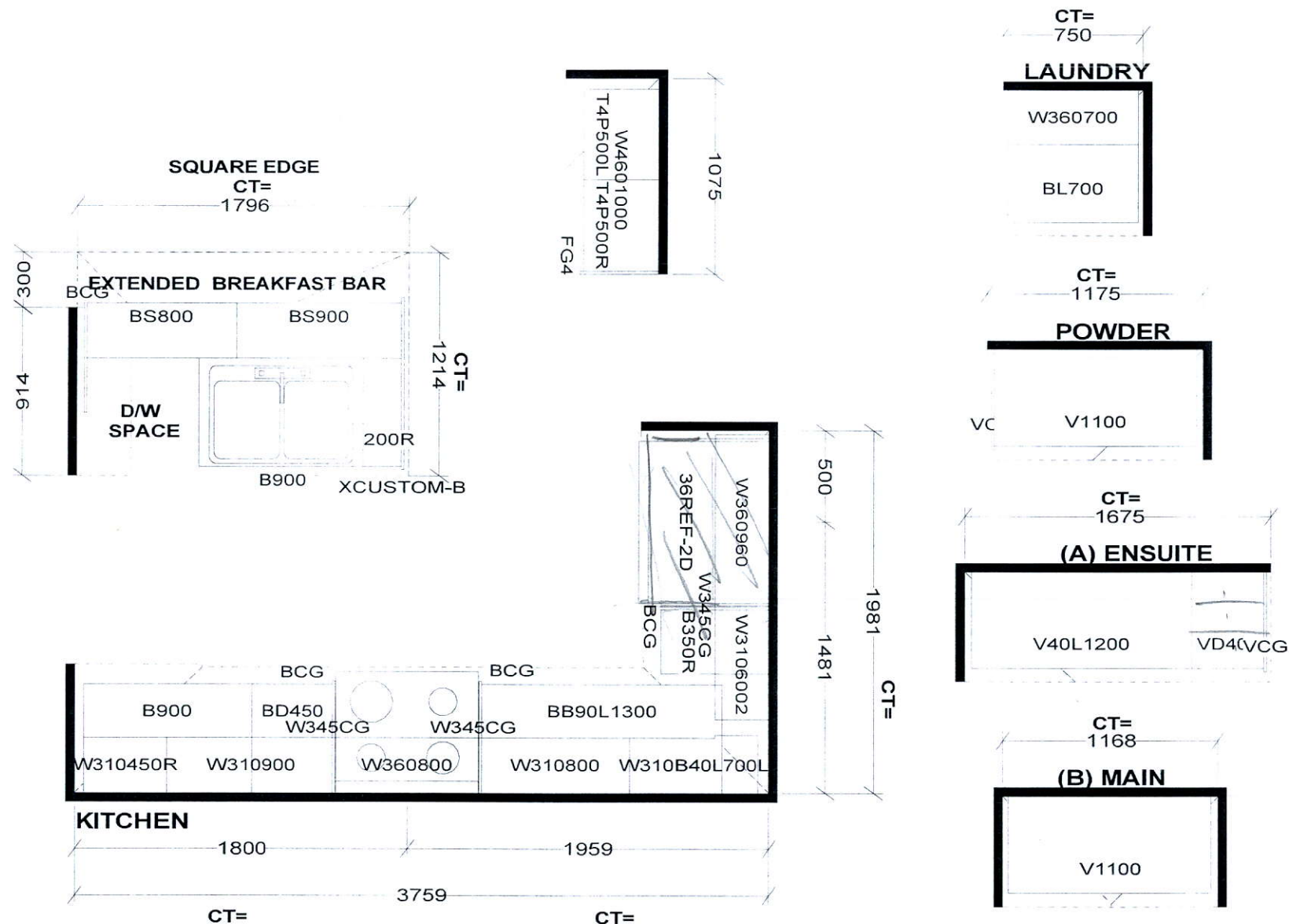

S e l b a I n d u s t r i e s

STANDARD FEATURES:
9' CEILINGS WITH D/C BOX
1040MM HIGH UPPER CABINETS
DISHWASHER SPACE
DUMMY DOORS ON EXPOSED BACKS
LAMINATE KITCHEN & VANITY COUNTERTOPS

This drawing is the intellectual property of SELBA INDUSTRIES INC. and is an original design which must not be released or copied unless applicable fee has been paid or job order placed.



JOB NUMBER:
BUILDER: GREENPARK HOMES
SITE NAME: LECCO RIDGE, Milton
MODEL: IVY 4X ELEV 1, 1A, 2, 3
LOT #:
DESIGNER: KS
DATE: FEB 13 17

IVY 4 1,846 SQ.FT.

AVAILABLE IN BLOCK: 323, 326, 327, 328, 330, 331, 333, 336, 337, 343, 344, 345, 346, 348 & 349

