



CONSTRUCTION SUMMARY

Saddle Ridge (G) - Lecco Ridge Developments Inc.

PURCHASERS: MOHAMMED HIDAYA GHORI and SHABNAM ARA

TEL: RES.: 416-908-4464

LOT / PHASE Block 331 TH 6 / 1	REG. PLAN # 20M-1184	HOUSE TYPE Ivy 12 Elev 2		
-----------------------------------	-------------------------	-----------------------------	--	--

CABINETRY

1 - KITCHEN - DELETE CABINETS ABOVE STOVE - VENDOR WILL SUPPLY 6 INCH VENT AS PER STANDARD CONSTRUCTION SPECIFICATIONS AND VENT MAY NOT BE IN THE APPROPRIATE LOCATION FOR INSTALLATION OF PURCHASER SUPPLIED VENT 17May18 Note: TEMPORARY HOOD FAN TO BE INSTALLED FOR OCCUPANCY PURPOSES ONLY - PURCHASER TO SUPPLY OWN CHIMNEY FAN AFTER CLOSING	
--	--

CABINETRY ACCESSORIES

1 - KITCHEN CABINETRY UPPER - ANGLED CORNER CABINET - FITS TALL UPPER CABINETS - PER UNIT - STANDARD 17May18 Note:	
1 - KITCHEN CABINETRY BASE - PIE CUT CORNER CABINET - BASE CABINETRY - STANDARD 17May18 Note:	
1 - KITCHEN CABINETRY BASE - POT/PAN DRAWERS (CABINET) - STANDARD 17May18 Note:	
1 - KITCHEN CABINETRY UPPER - FULL DEPTH ABOVE FRIDGE - WITH GABLES - 600MM - PRICE IS EACH - STANDARD 17May18 Note:	

DOORS AND TRIM

1 - DOOR KNOBS - PRIVACY LOCK IN LIEU OF PASSAGE- MASTER BEDROOM ONLY 17May18 Note:	
--	--

ELECTRICAL

3 - POT LIGHT - LOW VOLTAGE LED - SECOND FLOOR INSTALLATION 22Mar18 Note:	
4 - POT LIGHT - LOW VOLTAGE LED - FIRST FLOOR INSTALLATION 22Mar18 Note:	

PLUMBING

3 - VIEIRA 2 PC TOILET #4792BOV/4791BOVU (UNLINED TANK) WITH SMOOTH CLOSE TOILET SEAT- ALL BATHROOMS 17May18 Note:	
1 - WATER LINE FOR FRIDGE - ROUGH-IN ONLY 17May18 Note:	
1 - WASHROOM - 3 PIECE ROUGH-IN IN BASEMENT 27Mar17 Note:	

PROMOTIONAL

1 - LESS CREDIT FROM PURCHASER EXTRA SHEET IN OFFER 17May18 Note:	
1 - PARTIAL REDEMPTION OF PROMOTIONAL PACKAGE \$\$\$\$\$\$ BALANCE FORWARD TO BE USED AT A LATER DATE. ORIGINAL PROMOTIONAL PACKAGE OF \$\$\$\$ AS PER SCHEDULE PE DATED MMMDDYYYY. 22Mar18 Note: new promo balance \$2660.00	
1 - LESS CREDIT FROM PURCHASER EXTRA SHEET IN OFFER 27Mar17 Note: balance to be used at time of color chart \$4360.00	

STAIRS AND RAILINGS

1 - STAINED STAIRS, RAILING AND PICKETS – STANDARD STAIRCASE - PRICE IS PER SET 17May18 Note:	
--	--

RECEIVED MAY 18 2018

CONSTRUCTION SUMMARY

Saddle Ridge (G) - Lecco Ridge Developments Inc.

PURCHASERS: MOHAMMED HIDAYA GHORI and SHABNAM ARA TEL: RES.: 416-908-4464

LOT / PHASE Block 331 TH 6 / 1	REG. PLAN # 20M-1184	HOUSE TYPE Ivy 12 Elev 2		
-----------------------------------	-------------------------	-----------------------------	--	--

EXTRAS AS PER OFFER

Five (5) White Appliances as per PE Appliances <i>Worksheet</i> Note:	
The Vendor agrees that notwithstanding any other term or provision in this Agreement included in the Purchase Price and in addition to those items detailed in Schedule GP to the Agreement of Purchase and Sale, the Purchaser is entitled to a credit of Fiv <i>Worksheet</i> Note:	
The Purchaser acknowledges that the Purchase Price is inclusive of all credits and promotional packages available at the time of purchase. <i>Worksheet</i> Note:	

This Document is Extremely Time Sensitive - Printed 17 May 18 at 11:40

Purchasers:MOHAMMED HIDAYA GHORI & SHABNAM ARAP

Property: Block 331 TH 6

Telephone Res. / Bus: (416) 908-4464 /

Project: Lecco Ridge Developments Inc.

Decor Advisor: Natalie Mancuso

Model and Elevation: Ivy 12 Elev 2

Lock Date: 17-May-18

17-May-18

Plan #: 20M-1184

Layout Changes: ☐ Yes ☒ No

Sketch Attached: ☒ Yes ☐ No

Exterior Colour Scheme:

1. Cabinetry

	Style and Colour	Hardware
Kitchen / Breakfast	HASTING CHOCOLATE	2002
Laundry Room	ELISSE	Standard
Powder Room	MONACO W350XZ4	1001
Master Ensuite Bathroom	EVEREST WHITE	1001
Main Bathroom	EVEREST WHITE	1001

Appliances:

Built In Appliances ☐ Yes ☒ No

Slide In Stove ☐ Yes ☒ No

Dishwasher Cabinet ☐ Closed ☒ Open

41" Upper Cabinets ☒ Yes ☐ No

Please NOTE: Standard Cabinet Height is 30"

Stove Opening

NOTE: If not specified, opening will be set to builder's standard opening of approximately 30" width

Fridge Opening

NOTE: If not specified, opening will be set to builder's standard opening of approximately 37" width x 74" height

** Refer to Construction Summary

2. Counters

	Counter	Edge
Kitchen / Breakfast	LAMINATE-ARGENTO ROMANO 6697-46	
Laundry Room	N/A	
Powder Room	LAMINATE-CALCUTTA MARBLE 4925K-07	
Master Ensuite Bathroom	LAMINATE-EBONY FUSION 1799K-07	
Main Bathroom	LAMINATE-EBONY FUSION 1799K-07	

** Refer to Construction Summary

MG

Purchasers:

MOHAMMED HIDAYA GHORI & SHABNAM ARAP

Telephone Res. / Bus:

(416) 908-4464 /

Decor Advisor:

Natalie Mancuso

Lock Date:

17-May-18

Property:

Block 331 TH 6

Project:

Lecco Ridge Developments Inc.

Model and Elevation:

Ivy 12 Elev 2

17-May-18

Plan #:

20M-1184

3. Ceramic Flooring

		At a 45	Threshold-If App.
Entrance Vestibule	TILE- RAINBOW DARK GREY 13X13	<input type="checkbox"/>	METAL STRIP THROUGHOUT
Main Hall	N/A	<input type="checkbox"/>	
Kitchen / Breakfast	TILE- RAINBOW DARK GREY 13X13	<input type="checkbox"/>	
Laundry Room	TILE- RAINBOW DARK GREY 13X13	<input type="checkbox"/>	
Powder Room	TILE- RAINBOW DARK GREY 13X13	<input type="checkbox"/>	
Master Ensuite Bathroom	TILE- RETRO DARK GREY 12X12	<input type="checkbox"/>	
Main Bathroom	TILE- RETRO DARK GREY 12X12	<input type="checkbox"/>	
		<input type="checkbox"/>	
		<input type="checkbox"/>	
		<input type="checkbox"/>	
		<input type="checkbox"/>	

** Refer to Construction Summary

4. Ceramic Wall Tile

	Selection	Describe
Master Ensuite Bathroom		
Tub Deck Wall	TILE- NATURALE GRIGIO 8X10	
Tub Deck		
Tub Deck Skirt		
Shower Stall	TILE- NATURALE GRIGIO 8X10	
Bathtub Enclosure Walls		
Main Bathroom	TILE- NATURALE GRIGIO 8X10	
Kitchen Backsplash		

** Refer to Construction Summary - STANDARD GROUT THROUGHOUT UNLESS SPECIFIED

5. Plumbing Fixtures

All Bathrooms

White

Whirlpool

☐ Yes ☒ No

Dishwasher Rough-In

☒ Yes ☐ No

Waterline for Fridge

☒ Yes ☐ No

** Refer to Construction Summary

6. Trim Carpentry

Interior Doors	800 SERIES
Interior Trim	2 3/4" CASING WITH 4 1/4" BASEBOARD - COLONIAL
Door Handles	As Per Construction Specifications
Exterior Front Door Handle	As Per Construction Specifications

** Refer to Construction Summary

Purchasers:MOHAMMED HIDAYA GHORI & SHABNAM ARAP

Property:Block 331 TH 6

Telephone Res. / Bus: (416) 908-4464 /

Project:Lecco Ridge Developments Inc.

Decor Advisor: Natalie Mancuso

Model and Elevation:Ivy 12 Elev 2

Lock Date:17-May-18

17-May-18

Plan #:20M-1184

7. Other Flooring

Main Hall	N/A	
Living Room	N/A	
Dining Room	LAMINATE-MANHATTAN - LAVA ROCK OAK TL-15021	
Family Room	LAMINATE-MANHATTAN - LAVA ROCK OAK TL-15021	
Den / Library / Study	LAMINATE-MANHATTAN - LAVA ROCK OAK TL-15021	
Basement Landing(If Applies)		
Lower Landing (If Applies)	TILE- RAINBOW DARK GREY 13X13	
Upper Landing	LAMINATE-MANHATTAN - LAVA ROCK OAK TL-15021	
Upper Hall	CARPET-SHAW - E0949 NEWBERN CLASSIC - ANTIQUE SILK 00131	
Master Bedroom	CARPET-SHAW - E0949 NEWBERN CLASSIC - ANTIQUE SILK 00131	
Bedroom #2	CARPET-SHAW - E0949 NEWBERN CLASSIC - ANTIQUE SILK 00131	
Bedroom #3	CARPET-SHAW - E0949 NEWBERN CLASSIC - ANTIQUE SILK 00131	
Bedroom #4	CARPET-SHAW - E0949 NEWBERN CLASSIC - ANTIQUE SILK 00131	
Bedroom #5		
Underpad	Type	Area
	STANDARD	SECOND FLOOR

** Refer to Construction Summary

8. Railings and Pickets

Railing Type	AS PER CONSTRUCTION SPECIFICATIONS	Colour	TORLYS- LAVA ROCK OAK
Picket Type	1 5/16 PICKETS SQUARE CHAMFERED	Colour	TORLYS- LAVA ROCK OAK
Stringer / Riser	As Per Construction Specifications	Colour	TORLYS- LAVA ROCK OAK
Treads	Standard	Colour	TORLYS- LAVA ROCK OAK

Red Oak Stairs with Semi Gloss Finish

☒ Yes☐ No

** Refer to Construction Summary

9. Wall Paint Flat Finish

Main & Upper Hall	22 WARM GREY	Master Bedroom	22 WARM GREY
Living Room	N/A	Bedroom #2	22 WARM GREY
Dining Room	22 WARM GREY	Bedroom #3	22 WARM GREY
Kitchen / Breakfast	22 WARM GREY	Bedroom #4	22 WARM GREY
Family Room	22 WARM GREY	Bedroom #5	
Powder Room	22 WARM GREY	Master Ensuite	22 WARM GREY
Laundry Room	22 WARM GREY	Main Bathroom	22 WARM GREY
Den/Library	22 WARM GREY		
Trim Paint-Semi Gloss	BIRCH WHITE		

Smooth Ceilings First Floor☐ Yes☒ No

** Refer to Construction Summary

Purchasers:

MOHAMMED HIDAYA GHORI & SHABNAM ARAP

Telephone Res. / Bus:

(416) 908-4464 /

Decor Advisor:

Natalie Mancuso

Lock Date:

17-May-18

Property:

Block 331 TH 6

Project:

Lecco Ridge Developments Inc.

Model and Elevation:

Ivy 12 Elev 2

17-May-18

Plan #:

20M-1184

10. Plaster Mouldings and Medallions

Entrance Vestibule			Kitchen/Breakfast		
Main Hall			Den/Library		
Living Room			Lower Landing		
Dining Room					
Family Room					

** Refer to Construction Summary

11. Fireplace

	Living Room			Family Room			Other Room - Specify		
	Purchased	As Per Plan	N/A	Purchased	As Per Plan	N/A	Purchased	As Per Plan	N/A
	<input type="radio"/>	<input type="radio"/>	<input checked="" type="radio"/>	<input type="radio"/>	<input type="radio"/>	<input checked="" type="radio"/>	<input type="radio"/>	<input type="radio"/>	<input checked="" type="radio"/>
Fireplace Type									
Mantle Type									
Colour / Stain									
Surround									
Hearth									

** Refer to Construction Summary

12. Heating and Air Conditioning

Air Conditioning	NO	Gas Provisions Stove	NO
Gas Provisions Dryer	NO	Gas Provisions Barbecue	NO
Comment			

** Refer to Construction Summary

13. Electrical

Plugs and Switches	<input checked="" type="radio"/> White	DECOR	Above Kitchen Cabinet Light	<input type="radio"/> Yes	<input type="radio"/> No
Hood Fan	STANDARD WHITE		Below Kitchen Cabinet Light	<input type="radio"/> Yes	<input checked="" type="radio"/> No
Appliances	Built in Cooktop	Built in Oven	Gas Stove	Microwave	
	<input type="radio"/> Yes <input checked="" type="radio"/> No	<input type="radio"/> Yes <input checked="" type="radio"/> No	<input type="radio"/> Yes <input checked="" type="radio"/> No	<input type="radio"/> Yes <input checked="" type="radio"/> No	
Dishwasher Rough-in	Yes				

** Refer to Construction Summary

14. General Comments

** Refer to Construction Summary

Disclaimers and Notes

1) Colours of all materials are as close as possible to builder's selection, but not necessarily identical due to variances in manufacturing.

2) Any extras listed above are null and void unless accompanied by a separate invoice/amendment. Said invoice must be paid in full.

3) The Purchaser agrees that this colour selection is final and that no changes will be permitted, unless required by the Vendor.

4) The Purchaser acknowledges reading and accepting document which contains other miscellaneous disclaimers.

Signature: MD. Hidayat

Date: May 17th, 2018

Signature: _____

Date: _____

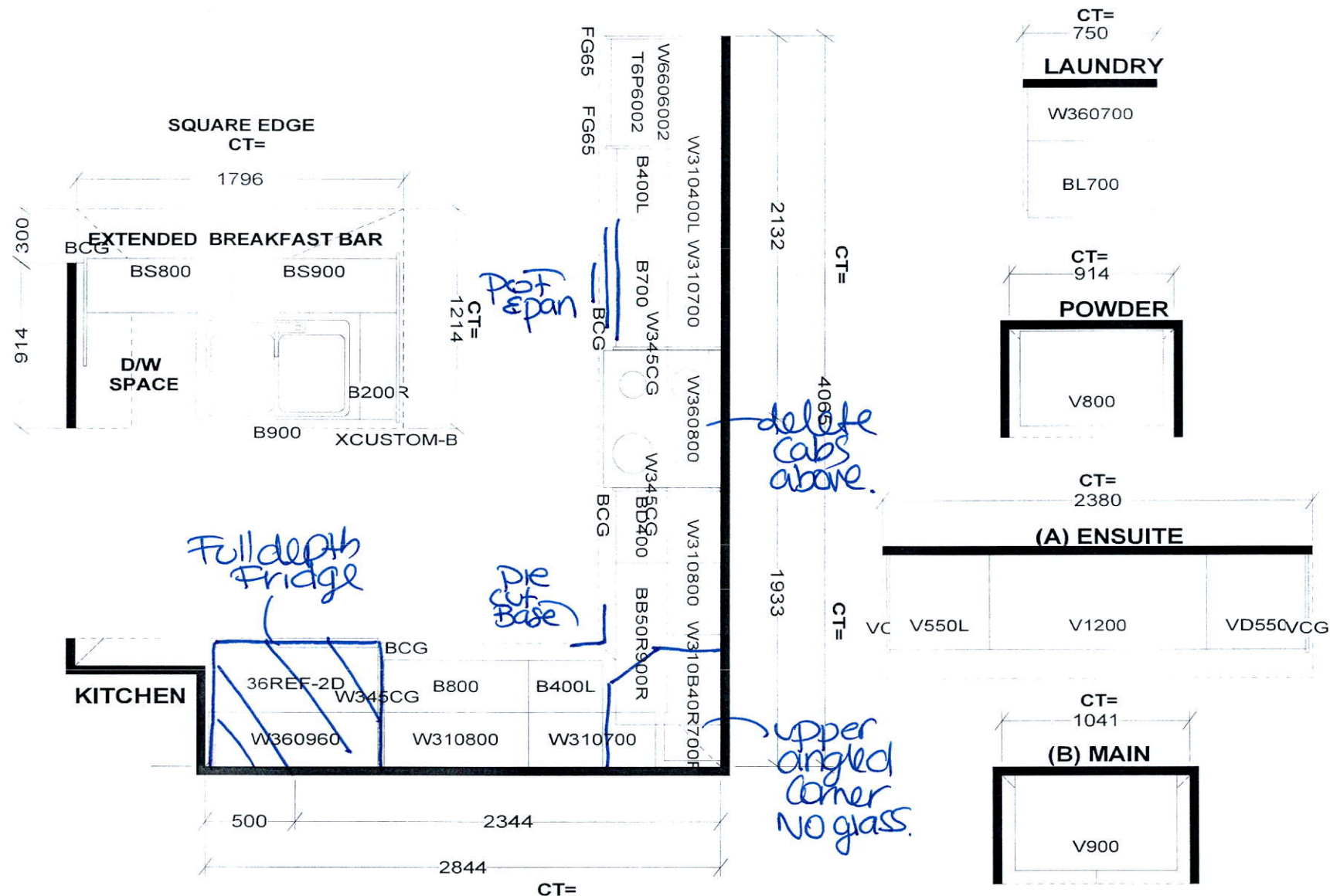

Selba Industries

STANDARD FEATURES:
9' CEILINGS WITH D/C BOX
1040MM HIGH UPPER CABINETS
DISHWASHER SPACE
DUMMY DOORS ON EXPOSED BACKS
LAMINATE KITCHEN & VANITY COUNTERTOPS

This drawing is the intellectual property of SELBA INDUSTRIES INC. and is an original design which must not be released or copied unless applicable fee has been paid or job order placed.



JOB NUMBER:
BUILDER: GREENPARK HOMES
SITE NAME: LECCO RIDGE, Milton
MODEL: IVY 12X ELEV 1,2,3
LOT #:
DESIGNER: KS
DATE: FEB 13 17

IVY 12 2,363 SQ.FT.

AVAILABLE IN BLOCK: 324, 325, 326, 330, 331, 337,
340, 342, 345, 346, 347 & 349

