

CONSTRUCTION SUMMARY
Saddle Ridge (G) - Lecco Ridge Developments Inc.

PURCHASER: Thomas SLEWA

TEL:

LOT / PHASE Block 324 TH 1 / 1	REG. PLAN # 20M-1184	HOUSE TYPE Ivy 11 Elev 3		
-----------------------------------	-------------------------	-----------------------------	--	--

CABINETY ACCESSORIES

1 - ACCESSORY - TOP DRAWER - PRICE IS PER DRAWER - STANDARD 10May18 Note:	
1 - KITCHEN CABINETY UPPER - ANGLED CORNER CABINET - FITS TALL UPPER CABINETS - PER UNIT - STANDARD 10May18 Note:	
2 - PANTRY UNIT UPGRADE - TO GO FROM 300MM TO 600MM DEEP - PRICE IS PER FOOT - STANDARD 10May18 Note:	
1 - KITCHEN CABINETY UPPER - FULL DEPTH ABOVE FRIDGE - WITH GABLES - 600MM - PRICE IS EACH - STANDARD 10May18 Note:	

HARDWOOD FLOORING

1 - LAMINATE - PARK LANE SERIES - - UPPER HALL 10May18 Note:	
---	--

MISCELLANEOUS

1 - FURTHER VENDOR DISCOUNT 10May18 Note:	
--	--

PLUMBING

1 - WATER LINE FOR FRIDGE - ROUGH-IN ONLY 10May18 Note:	
--	--

PROMOTIONAL

1 - LESS CREDIT FROM PURCHASER EXTRA SHEET IN OFFER 10May18 Note:	
--	--

STAIRS AND RAILINGS

1 - STAINED STAIRS, RAILING AND PICKETS – STANDARD STAIRCASE - PRICE IS PER SET 10May18 Note:	
--	--

EXTRAS AS PER OFFER

The Purchaser acknowledges that the Purchase Price is inclusive of all credits and promotional packages available at the time of purchase. Worksheet Note:	
Five (5) White Appliances as per PE Appliances Worksheet Note:	
The Vendor agrees that notwithstanding any other term or provision in this Agreement included in the Purchase Price and in addition to those items detailed in Schedule GP to the Agreement of Purchase and Sale, the Purchaser is entitled to a credit of Fiv Worksheet Note:	

This Document is Extremely Time Sensitive - Printed 10 May 18 at 15:40

RECEIVED MAY 12 2018

Greenpark

INTERIOR COLOUR SCHEME

Purchaser: Thomas SLEWA

Telephone Res. / Bus: /

Decor Advisor: Natalie Mancuso

Lock Date: 10-May-18

Property: Block 324 TH 1

Project: Lecco Ridge Developments Inc.

Model and Elevation: Ivy 11 Elev 3

10-May-18

Plan #: 20M-1184

Layout Changes: ☐ Yes ☒ No

Sketch Attached: ☒ Yes ☐ No

Exterior Colour Scheme:

1. Cabinetry

	Style and Colour	Hardware
Kitchen / Breakfast	MONACO W350XZ4	2004
Laundry Room	ELISSE	N/A
Powder Room	MODENA WHITE	1001
Master Ensuite Bathroom	MONACO W350XZ4	2004
Main Bathroom	MODENA WHITE	2004

Appliances:

Built In Appliances ☐ Yes ☒ No

Slide In Stove ☐ Yes ☒ No

Dishwasher Cabinet ☐ Closed ☒ Open

41" Upper Cabinets ☒ Yes ☐ No

Please NOTE: Standard Cabinet Height is 30"

Stove Opening

NOTE: If not specified, opening will be set to builder's standard opening of approximately 30" width

Fridge Opening

NOTE: If not specified, opening will be set to builder's standard opening of approximately 37" width x 74" height

** Refer to Construction Summary

2. Counters

	Counter	Edge
Kitchen / Breakfast	LAMINATE-CARRARA BIANCO 6696-46	
Laundry Room	N/A	
Powder Room	LAMINATE-CALCUTTA MARBLE 4925K-07	
Master Ensuite Bathroom	LAMINATE-WHITE CARRARA 4924-38	
Main Bathroom	LAMINATE-WHITE CARRARA 4924-38	

** Refer to Construction Summary

Purchaser:

Thomas SLEWA

Telephone Res. / Bus:

/

Decor Advisor:

Natalie Mancuso

Lock Date:

10-May-18

Property:

Block 324 TH 1

Project:

Lecco Ridge Developments Inc.

Model and Elevation:

Ivy 11 Elev 3

Plan #:

20M-1184

3. Ceramic Flooring

At a 45 Threshold-If App.

Entrance Vestibule	TILE- ESSENZE GRIGIO 13X13	<input type="checkbox"/>	METAL STRIP THROUGHOUT
Main Hall	LAMINATE	<input type="checkbox"/>	
Kitchen / Breakfast	TILE- ESSENZE GRIGIO 13X13	<input type="checkbox"/>	
Laundry Room	TILE- ESSENZE GRIGIO 13X13	<input type="checkbox"/>	
Powder Room	TILE- ESSENZE GRIGIO 13X13	<input type="checkbox"/>	
Master Ensuite Bathroom	TILE- RAINBOW WHITE 13X13	<input type="checkbox"/>	
Main Bathroom	TILE- RAINBOW LIGHT GREY 13X13	<input type="checkbox"/>	
SIDE HALL	TILE- ESSENZE GRIGIO 13X13	<input type="checkbox"/>	
		<input type="checkbox"/>	
		<input type="checkbox"/>	
		<input type="checkbox"/>	

** Refer to Construction Summary

4. Ceramic Wall Tile

Master Ensuite Bathroom	Selection	Describe
Tub Deck Wall		
Tub Deck		
Tub Deck Skirt		
Shower Stall	TILE- NATURALE GRIGIO 8X10	
Bathtub Enclosure Walls		
Main Bathroom	TILE- GOLF GRIGIO 8X10	
Kitchen Backsplash		

** Refer to Construction Summary - STANDARD GROUT THROUGHOUT UNLESS SPECIFIED

5. Plumbing Fixtures

All Bathrooms

White

Whirlpool

☐ Yes ☒ No

Dishwasher Rough-In

☒ Yes ☐ No

Waterline for Fridge

☒ Yes ☐ No

** Refer to Construction Summary

6. Trim Carpentry

Interior Doors	CLERMONT
Interior Trim	2 3/4" CASING WITH 4 1/4" BASEBOARD - COLONIAL
Door Handles	As Per Construction Specifications
Exterior Front Door Handle	As Per Construction Specifications

** Refer to Construction Summary

Purchaser: Thomas SLEWA

Telephone Res. / Bus: /

Decor Advisor: Natalie Mancuso

Lock Date: 10-May-18

Property: Block 324 TH 1

Project: Lecco Ridge Developments Inc.

Model and Elevation: Ivy 11 Elev 3

10-May-18

Plan #: 20M-1184

7. Other Flooring

Main Hall	LAMINATE-PARK LANE - HERITAGE OAK TL-U1386	
Living Room	N/A	
Dining Room	LAMINATE-PARK LANE - HERITAGE OAK TL-U1386	
Family Room	LAMINATE-PARK LANE - HERITAGE OAK TL-U1386	
Den / Library / Study	LAMINATE-PARK LANE - HERITAGE OAK TL-U1386	
Basement Landing(If Applies)	N/A	
Lower Landing (If Applies)	LAMINATE-PARK LANE - HERITAGE OAK TL-U1386	
Upper Landing	LAMINATE-PARK LANE - HERITAGE OAK TL-U1386	
Upper Hall	LAMINATE-PARK LANE - HERITAGE OAK TL-U1386	
Master Bedroom	CARPET-SHAW - E0949 NEWBERN CLASSIC - MORNING FOG 00530	
Bedroom #2	CARPET-SHAW - E0949 NEWBERN CLASSIC - MORNING FOG 00530	
Bedroom #3	CARPET-SHAW - E0949 NEWBERN CLASSIC - MORNING FOG 00530	
Bedroom #4	CARPET-SHAW - E0949 NEWBERN CLASSIC - MORNING FOG 00530	
Bedroom #5		
Underpad	Type	Area
	STANDARD	BEDROOMS

** Refer to Construction Summary

8. Railings and Pickets

Railing Type	AS PER CONSTRUCTION SPECIFICATIONS	Colour	TORLYS- HERITAGE OAK
Picket Type	1 5/16 PICKETS SQUARE CHAMFERED	Colour	TORLYS- HERITAGE OAK
Stringer / Riser	As Per Construction Specifications	Colour	TORLYS- HERITAGE OAK
Treads	Standard	Colour	TORLYS- HERITAGE OAK
Red Oak Stairs with Semi Gloss Finish		<input checked="" type="radio"/> Yes <input type="radio"/> No	

** Refer to Construction Summary

9. Wall Paint Flat Finish

Main & Upper Hall	22 WARM GREY	Master Bedroom	22 WARM GREY
Living Room	N/A	Bedroom #2	22 WARM GREY
Dining Room	22 WARM GREY	Bedroom #3	22 WARM GREY
Kitchen / Breakfast	22 WARM GREY	Bedroom #4	22 WARM GREY
Family Room	22 WARM GREY	Bedroom #5	
Powder Room	22 WARM GREY	Master Ensuite	22 WARM GREY
Laundry Room	22 WARM GREY	Main Bathroom	22 WARM GREY
Den/Library	22 WARM GREY		
Trim Paint-Semi Gloss	BIRCH WHITE		

Smooth Ceilings First Floor ☐ Yes ☒ No

** Refer to Construction Summary

Purchaser: Thomas SLEWA

Telephone Res. / Bus: /

Decor Advisor: Natalie Mancuso

Lock Date: 10-May-18

Property: Block 324 TH 1

Project: Lecco Ridge Developments Inc.

Model and Elevation: Ivy 11 Elev 3

10-May-18

Plan #: 20M-1184

10. Plaster Mouldings and Medallions

Entrance Vestibule			Kitchen/Breakfast		
Main Hall			Den/Library		
Living Room			Lower Landing		
Dining Room					
Family Room					

** Refer to Construction Summary

11. Fireplace

Living Room			Family Room			Other Room - Specify		
Purchased	As Per Plan	N/A	Purchased	As Per Plan	N/A	Purchased	As Per Plan	N/A
<input type="radio"/>	<input type="radio"/>	<input checked="" type="radio"/>	<input type="radio"/>	<input type="radio"/>	<input checked="" type="radio"/>	<input type="radio"/>	<input type="radio"/>	<input checked="" type="radio"/>
Fireplace Type								
Mantle Type								
Colour / Stain								
Surround								
Hearth								

** Refer to Construction Summary

12. Heating and Air Conditioning

Air Conditioning	NO	Gas Provisions Stove	NO
Gas Provisions Dryer	NO	Gas Provisions Barbecue	NO
Comment			

** Refer to Construction Summary

13. Electrical

Plugs and Switches	<input checked="" type="radio"/> White	DECOR	Above Kitchen Cabinet Light	<input type="radio"/> Yes <input checked="" type="radio"/> No
Hood Fan	STANDARD WHITE		Below Kitchen Cabinet Light	<input type="radio"/> Yes <input checked="" type="radio"/> No
Appliances	Built in Cooktop	Built in Oven	Gas Stove	Microwave
	<input type="radio"/> Yes <input checked="" type="radio"/> No	<input type="radio"/> Yes <input checked="" type="radio"/> No	<input type="radio"/> Yes <input checked="" type="radio"/> No	<input type="radio"/> Yes <input checked="" type="radio"/> No
Dishwasher Rough-in	Yes			

** Refer to Construction Summary

14. General Comments

** Refer to Construction Summary

Disclaimers and Notes

1) Colours of all materials are as close as possible to builder's selection, but not necessarily identical due to variances in manufacturing.

2) Any extras listed above are null and void unless accompanied by a separate invoice/amendment. Said invoice must be paid in full.

3) The Purchaser agrees that this colour selection is final and that no changes will be permitted, unless required by the Vendor.

4) The Purchaser acknowledges reading and accepting document which contains other miscellaneous disclaimers.

Signature:  Date: MAY 10 2018

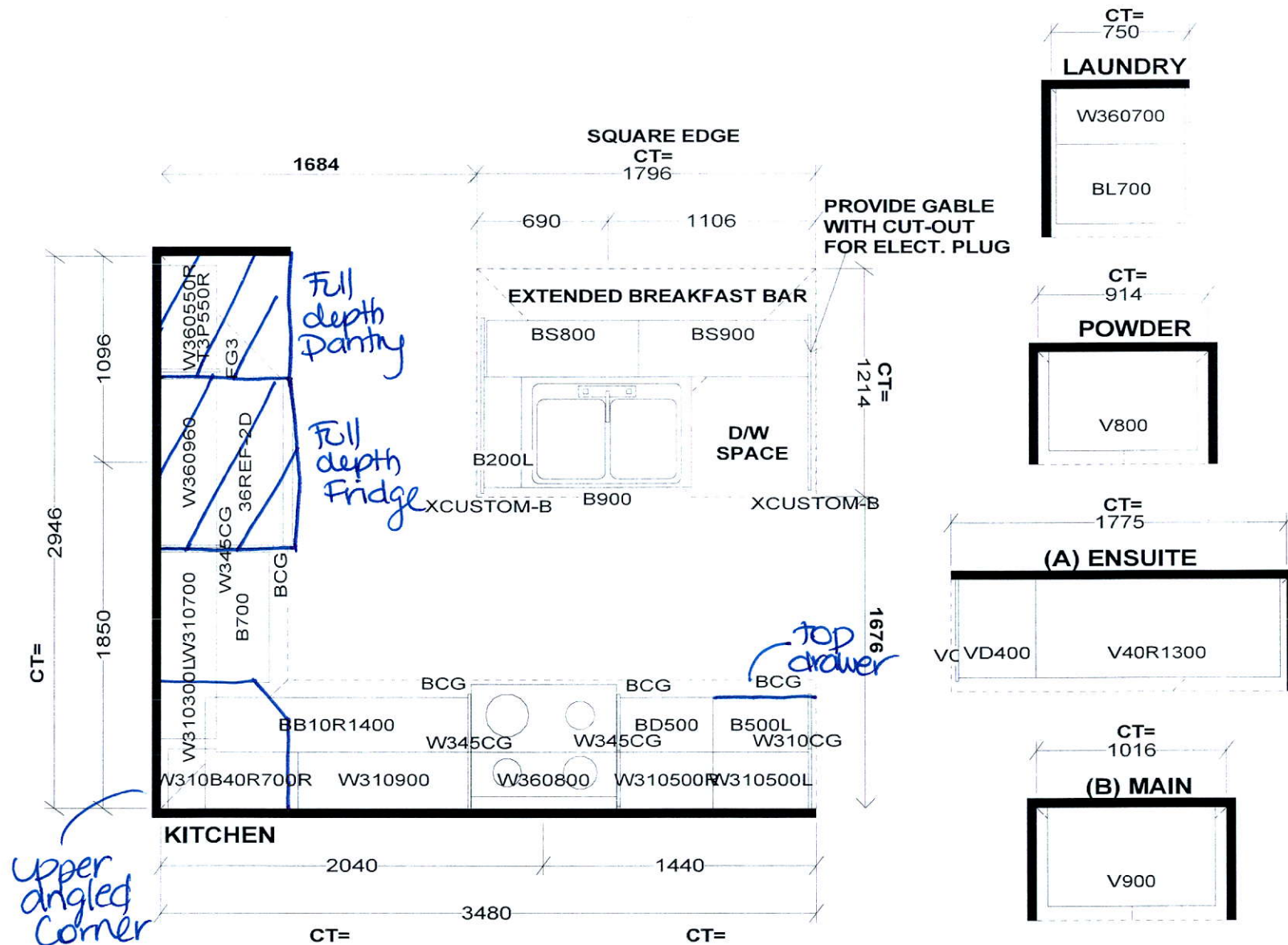

Selba Industries

STANDARD FEATURES:
 9' CEILINGS WITH D/C BOX
 1040MM HIGH UPPER CABINETS
 DISHWASHER SPACE
 DUMMY DOORS ON EXPOSED BACKS
 LAMINATE KITCHEN & VANITY COUNTERTOPS

This drawing is the intellectual property of
 SELBA INDUSTRIES INC. and is an
 original design which must not be released
 or copied unless applicable fee has been
 paid or job order placed.



JOB NUMBER:
 BUILDER: GREENPARK HOMES
 SITE NAME: LECCO RIDGE, Milton
 MODEL: IVY 11X ELEV 1,2,3
 LOT #:
 DESIGNER: KS
 DATE: FEB 13 17

IVY 11 2,259 SQ.FT.

IVY 11 2,259 SQ.FT.

AVAILABLE IN BLOCK: 324, 327, 328, 329, 331,
334, 335, 338, 341, 343 & 344



Orientation of name may be reversed and purchaser agrees to accept the same. Steps and porches may vary at any exterior entrance ways due to grading variance. Actual usable floor space may vary from the stated floor area. All renderings are artist's concept. Dimensions, specifications and architectural detailing subject to minor modifications. Final location of sump pump is based on site conditions. Roofline and adjoining model types may vary due to siting. E & O.E.E. Nov. 11 - Copyright Nov. 2016