

<div></div> <div>CONSTRUCTION SUMMARY</div> <div>Saddle Ridge (G) - Lecco Ridge Developments Inc.</div>				
PURCHASER: LEITH HOSSEIN				TEL:
LOT / PHASE	REG. PLAN #	HOUSE TYPE		
Block 330 TH 6 / 1	20M-1184	Ivy 4 Elev 2		

CABINETRY

1 - LIGHT VALENCE - KITCHEN 08May18 Note:	
1 - KITCHEN - DELETE CABINETS ABOVE STOVE - VENDOR WILL SUPPLY 6 INCH VENT AS PER STANDARD CONSTRUCTION SPECIFICATIONS AND VENT MAY NOT BE IN THE APPROPRIATE LOCATION FOR INSTALLATION OF PURCHASER SUPPLIED VENT 08May18 Note: TEMPORARY HOOD FAN TO BE INSTALLED FOR OCCUPANCY PURPOSES ONLY - PURCHASER TO SUPPLY OWN CHIMNEY FAN AFTER CLOSING	

CABINETRY ACCESSORIES

1 - KITCHEN CABINETY BASE - PIE CUT CORNER CABINET - BASE CABINETY - STANDARD 08May18 Note:	
1 - KITCHEN CABINETY UPPER - ANGLED CORNER CABINET - FITS TALL UPPER CABINETS - PER UNIT - STANDARD 08May18 Note:	
1 - KITCHEN CABINETY UPPER - FULL DEPTH ABOVE FRIDGE - WITH GABLES - 600MM - PRICE IS EACH - STANDARD 08May18 Note:	

CONSTRUCTION

1 - SMOOTH CEILINGS ON FIRST FLOOR ONLY 08May18 Note:	
--	--

HARDWOOD FLOORING

1 - LAMINATE - MANHATTAN SERIES - - UPPER HALL 08May18 Note:	
---	--

PLUMBING

1 - WATER LINE FOR FRIDGE - ROUGH-IN ONLY 08May18 Note:	
1 - WASHROOM - 3 PIECE ROUGH-IN IN BASEMENT 13Feb17 Note:	

PROMOTIONAL

1 - LESS CREDIT FROM PURCHASER EXTRA SHEET IN OFFER 08May18 Note:	
1 - PARTIAL REDEMPTION OF PROMOTIONAL PACKAGE \$\$\$\$\$\$ BALANCE FORWARD TO BE USED AT A LATER DATE. ORIGINAL PROMOTIONAL PACKAGE OF \$\$\$\$\$\$ AS PER SCHEDULE PE DATED MMMDDYYYY. 13Feb17 Note: ORIGINAL PROMOTIONAL PACKAGE \$5,000.00 BALANCE FORWARD \$4,360.00	

STAIRS AND RAILINGS

1 - EUROLINE 1- BLACK IRON PICKETS 08May18 Note:	
1 - STAINED HANDRAIL, TREADS, RISERS AND STRINGER EXCLUDING PICKETS (FOR IRON PICKETS) - STANDARD STAIRCASE - PRICE IS PER SET 08May18 Note:	

RECEIVED MAY 09 2018

CONSTRUCTION SUMMARY

Saddle Ridge (G) - Lecco Ridge Developments Inc.

PURCHASER: LEITH HOSSEIN

TEL:

LOT / PHASE Block 330 TH 6 / 1	REG. PLAN # 20M-1184	HOUSE TYPE Ivy 4 Elev 2		
-----------------------------------	-------------------------	----------------------------	--	--

EXTRAS AS PER OFFER

Five (5) White Appliances as per PE Appliances <i>Worksheet</i> Note:	
The Vendor agrees that notwithstanding any other term or provision in this Agreement included in the Purchase Price and in addition to those items detailed in Schedule GP to the Agreement of Purchase and Sale, the Purchaser is entitled to a credit of Fiv <i>Worksheet</i> Note:	
COMPLETE CENTRAL AIR CONDITIONER. <i>Worksheet</i> Note:	
The Purchaser acknowledges that the Purchase Price is inclusive of all credits and promotional packages available at the time of purchase. <i>Worksheet</i> Note:	

This Document is Extremely Time Sensitive - Printed 8 May 18 at 15:46



Purchaser:

LEITH HOSSEIN

Telephone Res. / Bus:

/

Decor Advisor:

Natalie Mancuso

Lock Date:

8-May-18

Property:

Block 330 TH 6

Project:

Lecco Ridge Developments Inc.

Model and Elevation:

Ivy 4 Elev 2

Plan #:

20M-1184

Layout Changes:

☐ Yes ☒ No

Sketch Attached:

☒ Yes ☐ No

Exterior Colour Scheme:

1. Cabinetry

	Style and Colour	Hardware
Kitchen / Breakfast	MONACO W350XZ4	1001
Laundry Room	ELISSE	Standard
Powder Room	EVEREST WHITE	1001
Master Ensuite Bathroom	EVEREST WHITE	1001
Main Bathroom	MONACO W350XZ4	1001

Appliances:

Built In Appliances

☐ Yes ☒ No

Slide In Stove

☐ Yes ☒ No

Dishwasher Cabinet

☐ Closed ☒ Open

41" Upper Cabinets

☒ Yes ☐ No

Please NOTE: Standard Cabinet Height is 30"

Stove Opening

NOTE: If not specified, opening will be set to builder's standard opening of approximately 30" width

Fridge Opening

NOTE: If not specified, opening will be set to builder's standard opening of approximately 37" width x 74" height

\*\* Refer to Construction Summary

2. Counters

	Counter	Edge
Kitchen / Breakfast	LAMINATE-CARRARA BIANCO 6696-46	
Laundry Room	N/A	
Powder Room	LAMINATE-CARRARA BIANCO 6696-46	
Master Ensuite Bathroom	LAMINATE-CARRARA BIANCO 6696-46	
Main Bathroom	LAMINATE-CARRARA BIANCO 6696-46	

\*\* Refer to Construction Summary

Initial: 

LH

Purchaser:LEITH HOSSEIN

Property:Block 330 TH 6

Telephone Res. / Bus: /

Project:Lecco Ridge Developments Inc.

Decor Advisor:Natalie Mancuso

Model and Elevation:Ivy 4 Elev 2

Lock Date:8-May-18

8-May-18

Plan #:20M-1184

3. Ceramic Flooring

At a 45 Threshold-If App.

Entrance Vestibule	TILE- HABITAT SILVER GREY 12X12	<input type="checkbox"/>	METAL STRIP THROUGHOUT
Main Hall	LAMINATE	<input type="checkbox"/>	
Kitchen / Breakfast	TILE- HABITAT SILVER GREY 12X12	<input type="checkbox"/>	
Laundry Room	TILE- HABITAT SILVER GREY 12X12	<input type="checkbox"/>	
Powder Room	TILE- HABITAT SILVER GREY 12X12	<input type="checkbox"/>	
Master Ensuite Bathroom	TILE- BEACH LIGHT GREY 13X13	<input type="checkbox"/>	
Main Bathroom	TILE- HABITAT SILVER GREY 12X12	<input type="checkbox"/>	
SIDE ENTRANCE/HALL	TILE- HABITAT SILVER GREY 12X12	<input type="checkbox"/>	
		<input type="checkbox"/>	
		<input type="checkbox"/>	
		<input type="checkbox"/>	

\*\* Refer to Construction Summary

4. Ceramic Wall Tile

Master Ensuite Bathroom	Selection	Describe
Tub Deck Wall	TILE- GOLF GRIGIO 8X10	
Tub Deck		
Tub Deck Skirt		
Shower Stall	TILE- GOLF GRIGIO 8X10	
Bathtub Enclosure Walls		
Main Bathroom	TILE- GOLF GRIGIO SCURO 8X10	
Kitchen Backsplash		

\*\* Refer to Construction Summary - STANDARD GROUT THROUGHOUT UNLESS SPECIFIED

5. Plumbing Fixtures

All Bathrooms

White

Whirlpool

☐ Yes ☒ No

Dishwasher Rough-In

☒ Yes ☐ No

Waterline for Fridge

☒ Yes ☐ No

\*\* Refer to Construction Summary

6. Trim Carpentry

Interior Doors	CLERMONT
Interior Trim	2 3/4" CASING WITH 4 1/4" BASEBOARD - COLONIAL
Door Handles	As Per Construction Specifications
Exterior Front Door Handle	As Per Construction Specifications

\*\* Refer to Construction Summary







<b>Purchaser:</b>	LEITH HOSSEIN	<b>Property:</b>	Block 330 TH 6
<b>Telephone Res. / Bus:</b>	/	<b>Project:</b>	Lecco Ridge Developments Inc.
<b>Decor Advisor:</b>	Natalie Mancuso	<b>Model and Elevation:</b>	Ivy 4 Elev 2
<b>Lock Date:</b>	8-May-18	8-May-18	<b>Plan #:</b> 20M-1184

### 10. Plaster Mouldings and Medallions

Entrance Vestibule	<input type="text"/>	<input type="text"/>	Kitchen/Breakfast	<input type="text"/>	<input type="text"/>
Main Hall	<input type="text"/>	<input type="text"/>	Den/Library	<input type="text"/>	<input type="text"/>
Living Room	<input type="text"/>	<input type="text"/>	Lower Landing	<input type="text"/>	<input type="text"/>
Dining Room	<input type="text"/>	<input type="text"/>		<input type="text"/>	<input type="text"/>
Family Room	<input type="text"/>	<input type="text"/>		<input type="text"/>	<input type="text"/>

**\*\* Refer to Construction Summary**

### 11. Fireplace

	Living Room			Family Room			Other Room - Specify		
	Purchased	As Per Plan	N/A	Purchased	As Per Plan	N/A	Purchased	As Per Plan	N/A
	<input type="radio"/>	<input type="radio"/>	<input checked="" type="radio"/>	<input type="radio"/>	<input type="radio"/>	<input checked="" type="radio"/>	<input type="radio"/>	<input type="radio"/>	<input checked="" type="radio"/>
Fireplace Type	<input type="text"/>			<input type="text"/>			<input type="text"/>		
Mantle Type	<input type="text"/>			<input type="text"/>			<input type="text"/>		
Colour / Stain	<input type="text"/>			<input type="text"/>			<input type="text"/>		
Surround	<input type="text"/>			<input type="text"/>			<input type="text"/>		
Hearth	<input type="text"/>			<input type="text"/>			<input type="text"/>		

**\*\* Refer to Construction Summary**

### 12. Heating and Air Conditioning

<b>Air Conditioning</b>	<input type="text" value="YES"/>	<b>Gas Provisions Stove</b>	<input type="text" value="NO"/>
<b>Gas Provisions Dryer</b>	<input type="text" value="NO"/>	<b>Gas Provisions Barbecue</b>	<input type="text" value="NO"/>
<b>Comment</b>	<input type="text"/>		

**\*\* Refer to Construction Summary**

### 13. Electrical

<b>Plugs and Switches</b>	<input checked="" type="radio"/> White	<input type="text" value="DECOR"/>	<b>Above Kitchen Cabinet Light</b>	<input type="radio"/> Yes	<input checked="" type="radio"/> No
<b>Hood Fan</b>	<input type="text" value="STANDARD WHITE"/>		<b>Below Kitchen Cabinet Light</b>	<input type="radio"/> Yes	<input checked="" type="radio"/> No
<b>Appliances</b>	<b>Built in Cooktop</b>	<b>Built in Oven</b>	<b>Gas Stove</b>	<b>Microwave</b>	
	<input type="radio"/> Yes <input checked="" type="radio"/> No	<input type="radio"/> Yes <input checked="" type="radio"/> No	<input type="radio"/> Yes <input checked="" type="radio"/> No	<input type="radio"/> Yes <input checked="" type="radio"/> No	
<b>Dishwasher Rough-in</b>	<input type="text" value="Yes"/>				

**\*\* Refer to Construction Summary**

### 14. General Comments

**\*\* Refer to Construction Summary**

### Disclaimers and Notes

- Colours of all materials are as close as possible to builder's selection, but not necessarily identical due to variances in manufacturing.
- Any extras listed above are null and void unless accompanied by a separate invoice/amendment. Said invoice must be paid in full.
- The Purchaser agrees that this colour selection is final and that no changes will be permitted, unless required by the Vendor.
- The Purchaser acknowledges reading and accepting document which contains other miscellaneous disclaimers.

Signature:  Date: May 8, 2018

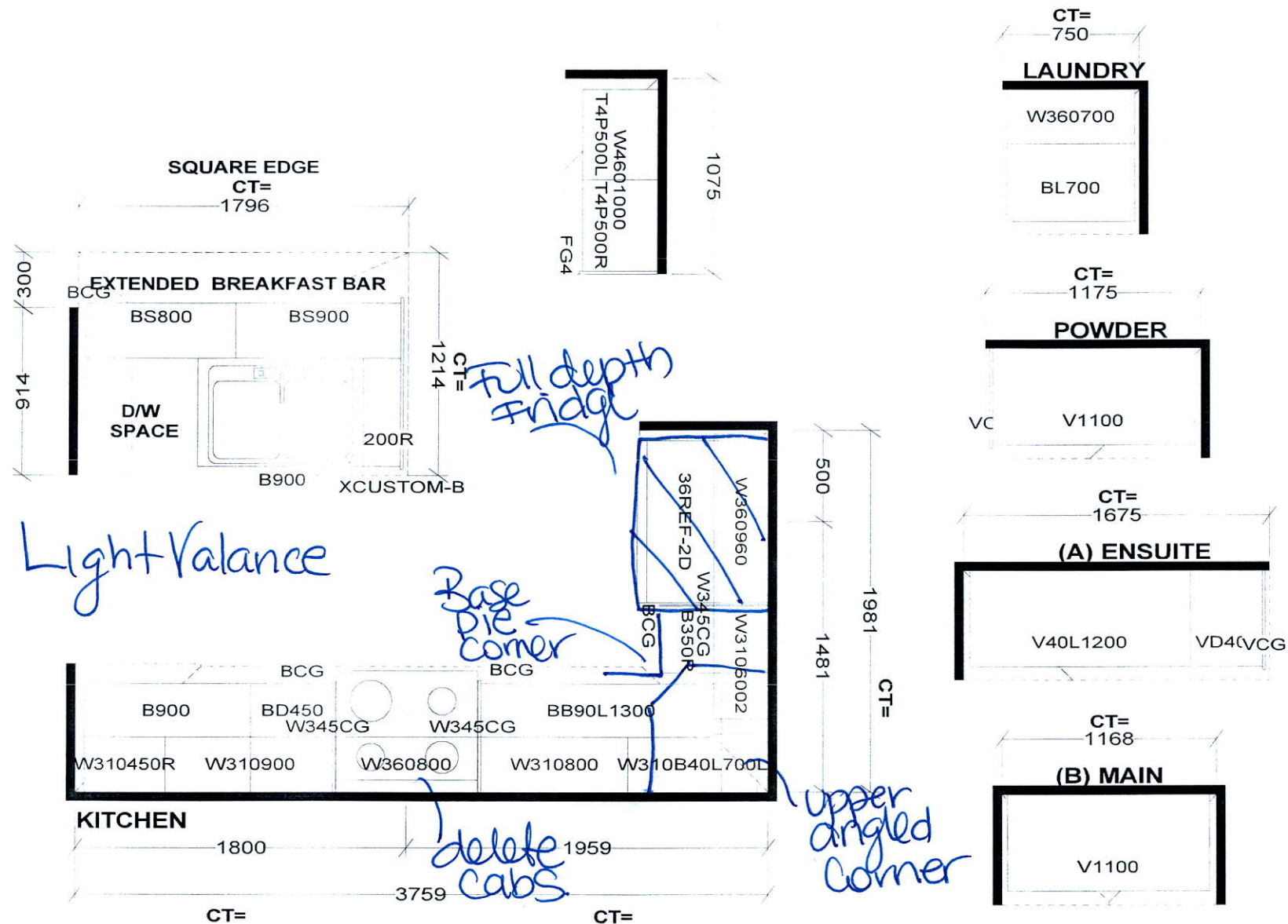

*S e l b a I n d u s t r i e s*

**STANDARD FEATURES:**  
9' CEILINGS WITH D/C BOX  
1040MM HIGH UPPER CABINETS  
DISHWASHER SPACE  
DUMMY DOORS ON EXPOSED BACKS  
LAMINATE KITCHEN & VANITY COUNTERTOPS

This drawing is the intellectual property of SELBA INDUSTRIES INC. and is an original design which must not be released or copied unless applicable fee has been paid or job order placed.



**JOB NUMBER:**  
**BUILDER:** GREENPARK HOMES  
**SITE NAME:** LECCO RIDGE, Milton  
**MODEL:** IVY 4X ELEV 1, 1A, 2, 3  
**LOT #:**  
**DESIGNER:** KS  
**DATE:** FEB 13 17



# IVY 4 1,846 SQ.FT.

AVAILABLE IN BLOCK: 323, 326, 327, 328, 330, 331, 333, 336, 337, 343, 344, 345, 346, 348 & 349

330Th6

