



CONSTRUCTION SUMMARY

Saddle Ridge (G) - Lecco Ridge Developments Inc.

PURCHASERS: Syed I. HUSSAIN and Syeda, Qamar IMTIAZ

TEL:

LOT / PHASE 240 / 1	REG. PLAN # 20M-1184	HOUSE TYPE Juniper 11 Elev 2		
------------------------	-------------------------	---------------------------------	--	--

CONSTRUCTION

1 - PLEASE NOTE THAT NO FURTHER STRUCTURAL CHANGES WILL BE PERMITTED. 20Dec16 Note:	
1 - FIRST FLOOR INCREASE CEILING HEIGHT FROM 9 FEET TO 10 FEET 20Dec16 Note: The ceiling height is measured from the top of the unfinished subfloor to underside of the unfinished ceiling above before finishes and excluding bulkheads and drop ceilings as per plan.	
1 - BASEMENT 8 FOOT 6 INCH CONCRETE POUR - MEASURED FROM TOP OF FOOTING TO TOP OF FOUNDATION WALL 20Dec16 Note:	
1 - ADD BASEMENT WALK-UP 20Dec16 Note:	

ELECTRICAL

1 - STANDARD POWDER ROOM LIGHT TO BE CENTERED ABOVE MIRROR - NOT IN CEILING. 15Feb18 Note:	
1 - RELOCATE STANDARD KITCHEN LIGHT TO BE CENTERED OVER ISLAND 15Feb18 Note:	

MIRRORS AND GLASS

1 - FRAMELESS GLASS SHOWER ENCLOSURE- WITH CHROME KNOB - MASTER ENSUITE 15Feb18 Note:	
--	--

PROMOTIONAL

1 - LESS CREDIT FROM PURCHASER EXTRA SHEET IN OFFER 20Dec16 Note:	
--	--

EXTRAS AS PER OFFER

The Purchaser acknowledges that the Purchase Price is inclusive of all credits and promotional packages available at the time of purchase. Worksheet Note:	
The Vendor agrees that notwithstanding any other term or provision in this Agreement included in the Purchase Price and in addition to those items detailed in Schedule GP to the Agreement of Purchase and Sale, the Purchaser is entitled to a credit of Ten Worksheet Note:	

This Document is Extremely Time Sensitive - Printed 24 Apr 18 at 15:31

RECEIVED APR 25 2018

Purchasers: Syed I. HUSSAIN & Syeda, Qamar IMTIAZ

Property: 240

Telephone Res. / Bus: /

Project: Lecco Ridge Developments Inc.

Decor Advisor: Natalie Mancuso

Model and Elevation: Juniper 11 Elev 2

Lock Date: 24-Apr-18

24-Apr-18

Plan #: 20M-1184

Layout Changes: ☒ Yes ☐ No

Sketch Attached: ☒ Yes ☐ No

Exterior Colour Scheme:

1. Cabinetry

	Style and Colour	Hardware
Kitchen / Breakfast	EVEREST WHITE	1001
Laundry Room	ELISSE	Standard
Powder Room	EVEREST WHITE	2002
Master Ensuite Bathroom	EVEREST WHITE	1001
Ensuite Bath - Bedroom 2/3	MONACO W324XZ4	1001
Ensuite Bath - Bedroom 4	MONACO W350XZ4	1001

Appliances:

Built In Appliances ☐ Yes ☒ No

Slide In Stove ☐ Yes ☒ No

Dishwasher Cabinet ☐ Closed ☒ Open

41" Upper Cabinets ☒ Yes ☐ No

Please NOTE: Standard Cabinet Height is 30"

Stove Opening

NOTE: If not specified, opening will be set to builder's standard opening of approximately 30" width

Fridge Opening

NOTE: If not specified, opening will be set to builder's standard opening of approximately 37" width x 74" height

** Refer to Construction Summary

2. Counters

	Counter	Edge
Kitchen / Breakfast	LAMINATE-ARGENTO ROMANO 6697-46	
Laundry Room	N/A	
Powder Room	LAMINATE-ARGENTO ROMANO 6697-46	
Master Ensuite Bathroom	LAMINATE-PEWTER P-999CA	
Ensuite Bath - Bedroom 2/3	LAMINATE-BORDEAUX JUPARANA 4929-52	
Ensuite Bath - Bedroom 4	LAMINATE-SMOKEY TOPAZ 4589K-07	

** Refer to Construction Summary

Initials:

Purchasers:

Syed I. HUSSAIN & Syeda, Qamar IMTIAZ

Telephone Res. / Bus:

/

Decor Advisor:

Natalie Mancuso

Lock Date:

24-Apr-18

Property:

240

Project:

Lecco Ridge Developments Inc.

Model and Elevation:

Juniper 11 Elev 2

Plan #:

20M-1184

3. Ceramic Flooring

		At a 45	Threshold-If App.
Entrance Vestibule	TILE- ESSENZE GRIGIO 13X13	<input type="checkbox"/>	METAL STRIP THROUGHOUT
Main Hall	HARDWOOD	<input type="checkbox"/>	
Kitchen / Breakfast	TILE- ESSENZE GRIGIO 13X13	<input type="checkbox"/>	
Laundry Room	TILE- ESSENZE GRIGIO 13X13	<input type="checkbox"/>	
Powder Room	TILE- ESSENZE GRIGIO 13X13	<input type="checkbox"/>	
Master Ensuite Bathroom	TILE- RAINBOW LIGHT GREY 13X13	<input type="checkbox"/>	
Ensuite Bath - Bedroom 2/3	TILE- BEACH IVORY 13X13	<input type="checkbox"/>	
Ensuite Bath - Bedroom 4	TILE- RAINBOW WHITE 13X13	<input type="checkbox"/>	
SIDE HALL	TILE- ESSENZE GRIGIO 13X13	<input type="checkbox"/>	
		<input type="checkbox"/>	
		<input type="checkbox"/>	

** Refer to Construction Summary

4. Ceramic Wall Tile

Master Ensuite Bathroom	Selection	Describe
Tub Deck Wall		
Tub Deck		
Tub Deck Skirt		
Shower Stall	TILE- LUC CONCEPT FERRO 8X16	
Bathtub Enclosure Walls		
Ensuite Bath - Bedroom 2/3	TILE- LUC BEIGE AMERICA 8X16	
Ensuite Bath - Bedroom 4	TILE- LUC CONCEPT NEVE 8X16	
Kitchen Backsplash		

** Refer to Construction Summary - STANDARD GROUT THROUGHOUT UNLESS SPECIFIED

5. Plumbing Fixtures

All Bathrooms

White

Whirlpool

☐ Yes ☒ No

Dishwasher Rough-In

☒ Yes ☐ No

Waterline for Fridge

☐ Yes ☒ No

** Refer to Construction Summary

6. Trim Carpentry

Interior Doors	800 SERIES
Interior Trim	3" BB CASING WITH 5 1/4" BASEBOARD - COLONIAL
Door Handles	As Per Construction Specifications
Exterior Front Door Handle	As Per Construction Specifications

** Refer to Construction Summary

Initials: 

Purchasers: Syed I. HUSSAIN & Syeda, Qamar IMTIAZ

Telephone Res. / Bus: /

Decor Advisor: Natalie Mancuso

Lock Date: 24-Apr-18

Property: 240

Project: Lecco Ridge Developments Inc.

Model and Elevation: Juniper 11 Elev 2

24-Apr-18

Plan #: 20M-1184

7. Other Flooring

Main Hall	HARDWOOD- 2 1/4 X 3/4 RED OAK- NATURAL- SEMI GLOSS
Living Room	HARDWOOD- 2 1/4 X 3/4 RED OAK- NATURAL- SEMI GLOSS
Dining Room	HARDWOOD- 2 1/4 X 3/4 RED OAK- NATURAL- SEMI GLOSS
Family Room	HARDWOOD- 2 1/4 X 3/4 RED OAK- NATURAL- SEMI GLOSS
Den / Library / Study	
Basement Landing(If Applies)	
Lower Landing (If Applies)	HARDWOOD- 2 1/4 X 3/4 RED OAK- NATURAL- SEMI GLOSS
Upper Landing	HARDWOOD- 2 1/4 X 3/4 RED OAK- NATURAL- SEMI GLOSS
Upper Hall	LAMINATE-MANHATTAN - RED OAK NATURAL TL-1504
Master Bedroom	LAMINATE-MANHATTAN - RED OAK NATURAL TL-1504
Bedroom #2	LAMINATE-MANHATTAN - RED OAK NATURAL TL-1504
Bedroom #3	LAMINATE-MANHATTAN - RED OAK NATURAL TL-1504
Bedroom #4	LAMINATE-MANHATTAN - RED OAK NATURAL TL-1504
Bedroom #5	
Underpad	Type Area

** Refer to Construction Summary

8. Railings and Pickets

Railing Type	AS PER CONSTRUCTION SPECIFICATIONS	Colour	NATURAL
Picket Type	1 3/4 PICKETS COLONIAL	Colour	NATURAL
Stringer / Riser	As Per Construction Specifications	Colour	NATURAL
Treads	Standard	Colour	NATURAL
Red Oak Stairs with Semi Gloss Finish		<input checked="" type="radio"/> Yes <input type="radio"/> No	

** Refer to Construction Summary

9. Wall Paint Flat Finish

Main & Upper Hall	22 WARM GREY	Master Bedroom	22 WARM GREY
Living Room	22 WARM GREY	Bedroom #2	22 WARM GREY
Dining Room	22 WARM GREY	Bedroom #3	22 WARM GREY
Kitchen / Breakfast	22 WARM GREY	Bedroom #4	22 WARM GREY
Family Room	22 WARM GREY	Bedroom #5	
Powder Room	22 WARM GREY	Master Ensuite	22 WARM GREY
Laundry Room	22 WARM GREY	Ensuite Bath - Bedroom 2/3	22 WARM GREY
Den/Library		Ensuite Bath - Bedroom 4	22 WARM GREY
Trim Paint-Semi Gloss	BIRCH WHITE		

Smooth Ceilings First Floor ☐ Yes ☒ No

** Refer to Construction Summary

Initials: 

Purchasers: Syed I. HUSSAIN & Syeda, Qamar IMTIAZ

Property: 240

Telephone Res. / Bus: /

Project: Lecco Ridge Developments Inc.

Decor Advisor: Natalie Mancuso

Model and Elevation: Juniper 11 Elev 2

Lock Date: 24-Apr-18

24-Apr-18

Plan #: 20M-1184

10. Plaster Mouldings and Medallions

Entrance Vestibule	<input type="text"/>	<input type="text"/>	Kitchen/Breakfast	<input type="text"/>	<input type="text"/>
Main Hall	<input type="text"/>	<input type="text"/>	Den/Library	<input type="text"/>	<input type="text"/>
Living Room	<input type="text"/>	<input type="text"/>	Lower Landing	<input type="text"/>	<input type="text"/>
Dining Room	<input type="text"/>	<input type="text"/>		<input type="text"/>	<input type="text"/>
Family Room	<input type="text"/>	<input type="text"/>		<input type="text"/>	<input type="text"/>

** Refer to Construction Summary

11. Fireplace

	Living Room			Family Room			Other Room - Specify		
	Purchased	As Per Plan	N/A	Purchased	As Per Plan	N/A	Purchased	As Per Plan	N/A
Fireplace Type	<input type="radio"/>	<input type="radio"/>	<input checked="" type="radio"/>	<input type="radio"/>	<input checked="" type="radio"/>	<input type="radio"/>	<input type="radio"/>	<input type="radio"/>	<input checked="" type="radio"/>
Mantle Type	<input type="text"/>			FLAT ON WALL			<input type="text"/>		
Colour / Stain	<input type="text"/>			MANTLE M2-STANDARD			<input type="text"/>		
Surround	<input type="text"/>			AS PER CONSTRUCTION SPECIFICATIONS			<input type="text"/>		
Hearth	<input type="text"/>			NERO			<input type="text"/>		
	<input type="text"/>			NO			<input type="text"/>		

** Refer to Construction Summary

12. Heating and Air Conditioning

Air Conditioning	<input type="text" value="NO"/>	Gas Provisions Stove	<input type="text" value="NO"/>
Gas Provisions Dryer	<input type="text" value="NO"/>	Gas Provisions Barbecue	<input type="text" value="NO"/>
Comment	<input type="text"/>		

** Refer to Construction Summary

13. Electrical

Plugs and Switches	<input checked="" type="radio"/> White	<input type="text" value="DECOR"/>	Above Kitchen Cabinet Light	<input type="radio"/> Yes	<input checked="" type="radio"/> No
Hood Fan	<input type="text" value="STANDARD WHITE"/>		Below Kitchen Cabinet Light	<input type="radio"/> Yes	<input checked="" type="radio"/> No
Appliances	Built in Cooktop	Built in Oven	Gas Stove	Microwave	
	<input type="radio"/> Yes <input checked="" type="radio"/> No	<input type="radio"/> Yes <input checked="" type="radio"/> No	<input type="radio"/> Yes <input checked="" type="radio"/> No	<input type="radio"/> Yes <input checked="" type="radio"/> No	
Dishwasher Rough-in	<input type="text" value="Yes"/>				

** Refer to Construction Summary

14. General Comments

** Refer to Construction Summary

Disclaimers and Notes

- Colours of all materials are as close as possible to builder's selection, but not necessarily identical due to variances in manufacturing.
- Any extras listed above are null and void unless accompanied by a separate invoice/amendment. Said invoice must be paid in full.
- The Purchaser agrees that this colour selection is final and that no changes will be permitted, unless required by the Vendor.
- The Purchaser acknowledges reading and accepting document which contains other miscellaneous disclaimers.

Signature:  Date: Apr 24/18 Signature: _____ Date: _____

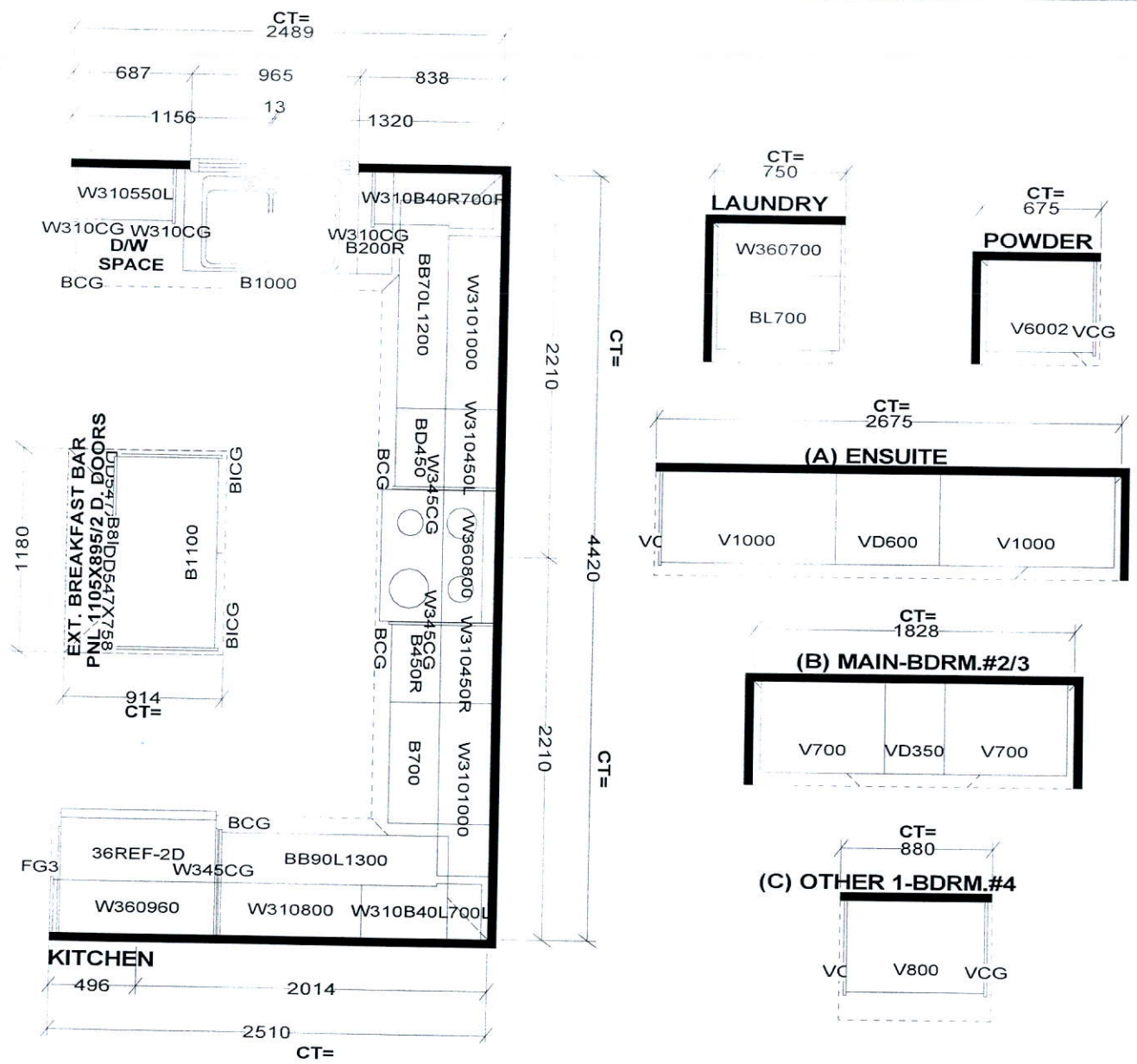

Selba Industries

<p>STANDARD FEATURES:</p> <p>9' CEILINGS WITH D/C BOX</p> <p>1040MM HIGH UPPER CABINETS</p> <p>DISHWASHER SPACE</p> <p>DUMMY DOORS ON EXPOSED BACKS</p> <p>LAMINATE KITCHEN & VANITY COUNTERTOPS</p>	<p>This drawing is the intellectual property of SELBA INDUSTRIES INC. and is an original design which must not be released or copied unless applicable fee has been paid or job order placed.</p>	<p>JOB NUMBER:</p> <p>BUILDER: GREENPARK HOMES</p> <p>SITE NAME: LECCO RIDGE, Milton</p> <p>MODEL: JUNIPER 11X ELEV 1,2</p> <p>LOT #:</p> <p>DESIGNER: KS</p> <p>DATE: FEB 13 17</p>
--	---	--

[illegible]

Floor plan for ELEV. 2 (Second Floor):

- FAMILY ROOM**: 18'6" x 14'6", COFFERED CEILING, FIREPLACE.
- LIVING/DINING ROOM**: 15'4" x 14'0", COFFERED CEILING, FIREPLACE.
- FOYER**: Central area with stairs labeled "UP" and "DN".
- PORTICO**: Located between the family room and living/dining room.
- COVERED PORCH**: Located at the bottom right.
- OPEN TO ARENE**: Located below the foyer.

Floor Plan Details:

- BEDROOM 2**: 12'0" x 10'6"
- BEDROOM 3**: 11'10" x 11'8"
- BEDROOM 4**: 15'4" (11'11") x 14'0"
- MASTER BEDROOM**: 17'10" x 14'6"
- MASTERS BATH**
- SHARED BATH #1**
- LAUNDRY**
- CLOSETS**: WALK-IN CLOSET, WALK-IN CLOSET, WALK-IN CLOSET, WALK-IN CLOSET, CLOSET 2
- HALLWAY**
- ENTRY**
- OPEN TO BELOW**
- RAMPING DOWN**
- RAMPING UP**
- W**, **T**, **D**, **S** (closet labels)

UPPER LEVEL

MASTER BEDROOM 17'10" x 14'6"

BEDROOM 4

BATH

BATH

JACK & JILL BATH

CL. LINEN

CL. BROOM

OPEN TO BELOW

ELEV. 2

Orientation of home may be reversed and purchaser agrees to accept the same. Steps and porches may vary in any external entrance ways due to grading variance. Actual inside floor space may vary from the stated floor area. All renderings are artist's concept. Dimensions, specifications and architectural detailing subject to minor modifications. Final location of sump pump is based on site conditions. Roofline and adjoining model types may vary due to being C, E, LEI, Juniper II • Copyright Nov. 2016