



CONSTRUCTION SUMMARY

Saddle Ridge (G) - Lecco Ridge Developments Inc.

PURCHASERS: KANNATHASAN KANDIAH and CHITRA KANNATHASAN

TEL: RES.: 647-522-0225

LOT / PHASE Block 338 TH 6 / 1	REG. PLAN # 20M-1184	HOUSE TYPE Ivy 11 Elev 3		
-----------------------------------	-------------------------	-----------------------------	--	--

CABINETRY ACCESSORIES

1 - KITCHEN CABINETY BASE - PIE CUT CORNER CABINET - BASE CABINETY - STANDARD 17Apr18 Note:	
1 - PANTRY UNIT UPGRADE - TO GO FROM 300MM TO 600MM DEEP - PRICE IS PER FOOT - STANDARD 17Apr18 Note:	
1 - KITCHEN CABINETY UPPER - FULL DEPTH ABOVE FRIDGE - WITH GABLES - 600MM - PRICE IS EACH - STANDARD 17Apr18 Note:	

HARDWOOD FLOORING

1 - LAMINATE - LEXINGTON SERIES - - UPPER HALL 17Apr18 Note:	
1 - LAMINATE -UPGRADE TO LEXINGTON SERIES IN LIEU OF STANDARD LAMINATE 17Apr18 Note:	

PROMOTIONAL

1 - LESS CREDIT FROM PURCHASER EXTRA SHEET IN OFFER 17Apr18 Note:	
--	--

STAIRS AND RAILINGS

1 - STAINED HANDRAIL, TREADS, RISERS AND STRINGER EXCLUDING PICKETS (FOR IRON PICKETS) - STANDARD STAIRCASE - PRICE IS PER SET 17Apr18 Note:	
1 - EUROLINE 1 17Apr18 Note: STAIRCASE - IRON PICKETS - BLACK	

EXTRAS AS PER OFFER

Lot Premium Worksheet Note:	
The Vendor agrees that notwithstanding any other term or provision in this Agreement included in the Purchase Price and in addition to those items detailed in Schedule GP to the Agreement of Purchase and Sale, the Purchaser is entitled to a credit of Fiv Worksheet Note:	
Five (5) White Appliances as per PE Appliances Worksheet Note:	
The Purchaser acknowledges that the Purchase Price is inclusive of all credits and promotional packages available at the time of purchase. Worksheet Note:	

This Document is Extremely Time Sensitive - Printed 17 Apr 18 at 15:20

RECEIVED APR 18 2018

Purchasers: KANNATHASAN KANDIAH & CHITRA KANNATH

Property: Block 338 TH 6

Telephone Res. / Bus: (647) 522-0225 /

Project: Lecco Ridge Developments Inc.

Decor Advisor: Candace Forza

Model and Elevation: Ivy 11 Elev 3

Lock Date: 17-Apr-18

17-Apr-18

Plan #: 20M-1184

Layout Changes: ☐ Yes ☒ No

Sketch Attached: ☒ Yes ☐ No

Exterior Colour Scheme:

1. Cabinetry

	Style and Colour	Hardware
Kitchen / Breakfast	EVEREST WHITE	2002
Laundry Room	ELISSE	Standard
Powder Room	EVEREST WHITE	1001
Master Ensuite Bathroom	EVEREST WHITE	1001
Main Bathroom	EVEREST WHITE	1001
	N/A	N/A
	N/A	N/A
	N/A	N/A
	N/A	N/A
	N/A	N/A

Appliances:

Built In Appliances ☐ Yes ☒ No

Slide In Stove ☐ Yes ☒ No

Dishwasher Cabinet

☐ Closed ☒ Open

41" Upper Cabinets ☒ Yes ☐ No

Please NOTE: Standard Cabinet Height is 30"

Stove Opening

NOTE: If not specified, opening will be set to builder's standard opening of approximately 30" width

Fridge Opening

NOTE: If not specified, opening will be set to builder's standard opening of approximately 37" width x 74" height

\*\* Refer to Construction Summary

2. Counters

	Counter	Edge
Kitchen / Breakfast	LAMINATE-CARRARA BIANCO 6696-46	
Laundry Room	N/A	
Powder Room	LAMINATE-INUK SHUK GREY P-344 LM	
Master Ensuite Bathroom	LAMINATE-PALOMA DARK GREY 6366-46	
Main Bathroom	LAMINATE-PALOMA DARK GREY 6366-46	
	N/A	
	N/A	
	N/A	
	N/A	

\*\* Refer to Construction Summary

Purchasers: KANNATHASAN KANDIAH & CHITRA KANNATH

Telephone Res. / Bus: (647) 522-0225 /

Decor Advisor: Candace Forza

Lock Date: 17-Apr-18

Property: Block 338 TH 6

Project: Lecco Ridge Developments Inc.

Model and Elevation: Ivy 11 Elev 3

17-Apr-18

Plan #: 20M-1184

3. Ceramic Flooring

		At a 45	Threshold-If App.
Entrance Vestibule	TILE-ESSENZE GRIGIO-13X13	<input type="checkbox"/>	METAL STRIP
Main Hall	LAMINATE	<input type="checkbox"/>	
Kitchen / Breakfast	TILE-ESSENZE GRIGIO-13X13	<input type="checkbox"/>	METAL STRIP
Laundry Room	TILE-RAINBOW WHITE-13X13	<input type="checkbox"/>	
Powder Room	TILE-ESSENZE GRIGIO-13X13	<input type="checkbox"/>	
Master Ensuite Bathroom	TILE-RAINBOW WHITE-13X13	<input type="checkbox"/>	METAL STRIP
Main Bathroom	TILE-RAINBOW WHITE-13X13	<input type="checkbox"/>	METAL STRIP
GARAGE ENTRY	TILE-ESSENZE GRIGIO-13X13	<input type="checkbox"/>	
	N/A	<input type="checkbox"/>	
	N/A	<input type="checkbox"/>	
	N/A	<input type="checkbox"/>	

\*\* Refer to Construction Summary

4. Ceramic Wall Tile

Master Ensuite Bathroom	Selection	Describe
Tub Deck Wall	TILE-NATURALE GRIGIO-8X10	***LAID HORIZONTALLY***
Tub Deck	N/A	
Tub Deck Skirt	N/A	
Shower Stall	TILE-NATURALE GRIGIO-8X10	***LAID HORIZONTALLY***
Bathtub Enclosure Walls	N/A	
	N/A	
Main Bathroom	TILE-NATURALE GRIGIO-8X10	***LAID HORIZONTALLY***
	N/A	
	N/A	
	N/A	
Kitchen Backsplash	N/A	

\*\* Refer to Construction Summary - STANDARD GROUT THROUGHOUT UNLESS SPECIFIED

5. Plumbing Fixtures

All Bathrooms

White

N/A

N/A

N/A

N/A

N/A

Whirlpool

N/A

Yes

No

Dishwasher Rough-In

Yes

No

Waterline for Fridge

Yes

No

\*\* Refer to Construction Summary

6. Trim Carpentry

Interior Doors	CLERMONT
Interior Trim	2 3/4" CASING WITH 4 1/4" BASEBOARD - COLONIAL
Door Handles	As Per Construction Specifications
Exterior Front Door Handle	As Per Construction Specifications

\*\* Refer to Construction Summary

Initials: K.K K.C

Purchasers:

KANNATHASAN KANDIAH & CHITRA KANNATHAN

Telephone Res. / Bus:

(647) 522-0225 /

Decor Advisor:

Candace Forza

Lock Date:

17-Apr-18

Property:

Block 338 TH 6

Project:

Lecco Ridge Developments Inc.

Model and Elevation:

Ivy 11 Elev 3

Plan #:

20M-1184

7. Other Flooring

Main Hall	LAMINATE-LEXINGTON - HAZELWOOD OAK TL21016 - M	
Living Room	N/A	
Dining Room	LAMINATE-LEXINGTON - HAZELWOOD OAK TL21016 - M	
Family Room	LAMINATE-LEXINGTON - HAZELWOOD OAK TL21016 - M	
Den / Library / Study	LAMINATE-LEXINGTON - HAZELWOOD OAK TL21016 - M	
Basement Landing(If Applies)	N/A	
Lower Landing (If Applies)	LAMINATE-LEXINGTON - HAZELWOOD OAK TL21016 - M	
Upper Landing	LAMINATE-LEXINGTON - HAZELWOOD OAK TL21016 - M	
Upper Hall	LAMINATE-LEXINGTON - HAZELWOOD OAK TL21016 - M	
Master Bedroom	CARPET-SHAW - E0949 NEWBERN CLASSIC - MORNING FOG 00530	
Bedroom #2	CARPET-SHAW - E0949 NEWBERN CLASSIC - MORNING FOG 00530	
Bedroom #3	CARPET-SHAW - E0949 NEWBERN CLASSIC - MORNING FOG 00530	
Bedroom #4	CARPET-SHAW - E0949 NEWBERN CLASSIC - MORNING FOG 00530	
Bedroom #5	N/A	
	N/A	
	N/A	
	N/A	
Underpad	Type	Area
	STANDARD	BEDROOMS ONLY

\*\* Refer to Construction Summary

8. Railings and Pickets

Railing Type	As Per Construction Specifications	Colour	TORLYS HAZELWOOD OAK
Picket Type	EUROLINE 1	Colour	BLACK
Stringer / Riser	As Per Construction Specifications	Colour	TORLYS HAZELWOOD OAK
Treads	As Per Construction Specifications	Colour	TORLYS HAZELWOOD OAK
Red Oak Stairs with Semi Gloss Finish		<input checked="" type="radio"/> Yes <input type="radio"/> No	

\*\* Refer to Construction Summary

9. Wall Paint Flat Finish

Main & Upper Hall	43 BIRCH WHITE	Master Bedroom	43 BIRCH WHITE
Living Room	N/A	Bedroom #2	43 BIRCH WHITE
Dining Room	43 BIRCH WHITE	Bedroom #3	43 BIRCH WHITE
Kitchen / Breakfast	43 BIRCH WHITE	Bedroom #4	43 BIRCH WHITE
Family Room	43 BIRCH WHITE	Bedroom #5	N/A
Powder Room	43 BIRCH WHITE	Master Ensuite	43 BIRCH WHITE
Laundry Room	43 BIRCH WHITE	Main Bathroom	43 BIRCH WHITE
Den/Library	43 BIRCH WHITE	GARAGE ENTRY	43 BIRCH WHITE
Trim Paint-Semi Gloss	BIRCH WHITE		N/A
	N/A		N/A
	N/A		N/A

Smooth Ceilings First Floor ☐ Yes ☒ No

\*\* Refer to Construction Summary

Initials: K.K CE

Purchasers: KANNATHASAN KANDIAH & CHITRA KANNATHAN

Telephone Res. / Bus: (647) 522-0225 /

Decor Advisor: Candace Forza

Lock Date: 17-Apr-18

Property: Block 338 TH 6

Project: Lecco Ridge Developments Inc.

Model and Elevation: Ivy 11 Elev 3

Plan #: 20M-1184

10. Plaster Mouldings and Medallions

Entrance Vestibule	N/A	N/A	Kitchen/Breakfast	N/A	N/A
Main Hall	N/A	N/A	Den/Library	N/A	N/A
Living Room	N/A	N/A	Lower Landing	N/A	N/A
Dining Room	N/A	N/A		N/A	N/A
Family Room	N/A	N/A			

\*\* Refer to Construction Summary

11. Fireplace

	Living Room			Family Room			Other Room - Specify		
	Purchased	As Per Plan	N/A	Purchased	As Per Plan	N/A	Purchased	As Per Plan	N/A
Fireplace Type	<input type="radio"/>	<input type="radio"/>	<input checked="" type="radio"/>	<input type="radio"/>	<input type="radio"/>	<input checked="" type="radio"/>	<input type="radio"/>	<input type="radio"/>	<input checked="" type="radio"/>
Mantle Type	N/A			N/A			N/A		
Colour / Stain	N/A			N/A			N/A		
Surround	N/A			N/A			N/A		
Hearth	N/A			N/A			N/A		

\*\* Refer to Construction Summary

12. Heating and Air Conditioning

Air Conditioning	NO	Gas Provisions Stove	NO
Gas Provisions Dryer	NO	Gas Provisions Barbecue	NO
Comment			

\*\* Refer to Construction Summary

13. Electrical

Plugs and Switches	<input checked="" type="radio"/> White	DECOR	Above Kitchen Cabinet Light	<input type="radio"/> Yes <input checked="" type="radio"/> No
Hood Fan	STANDARD WHITE		Below Kitchen Cabinet Light	<input type="radio"/> Yes <input checked="" type="radio"/> No
Appliances	Built in Cooktop	Built in Oven	Gas Stove	Microwave
	<input type="radio"/> Yes <input checked="" type="radio"/> No	<input type="radio"/> Yes <input checked="" type="radio"/> No	<input type="radio"/> Yes <input checked="" type="radio"/> No	<input type="radio"/> Yes <input checked="" type="radio"/> No
Dishwasher Rough-in	Yes			

\*\* Refer to Construction Summary

14. General Comments

\*\* Refer to Construction Summary

Disclaimers and Notes

- Colours of all materials are as close as possible to builder's selection, but not necessarily identical due to variances in manufacturing.
- Any extras listed above are null and void unless accompanied by a separate invoice/amendment. Said invoice must be paid in full.
- The Purchaser agrees that this colour selection is final and that no changes will be permitted, unless required by the Vendor.
- The Purchaser acknowledges reading and accepting document which contains other miscellaneous disclaimers.

Signature:  Date: 04/17/18

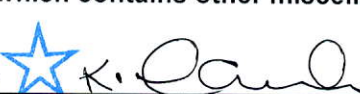
Signature:  Date: 04/17/2018

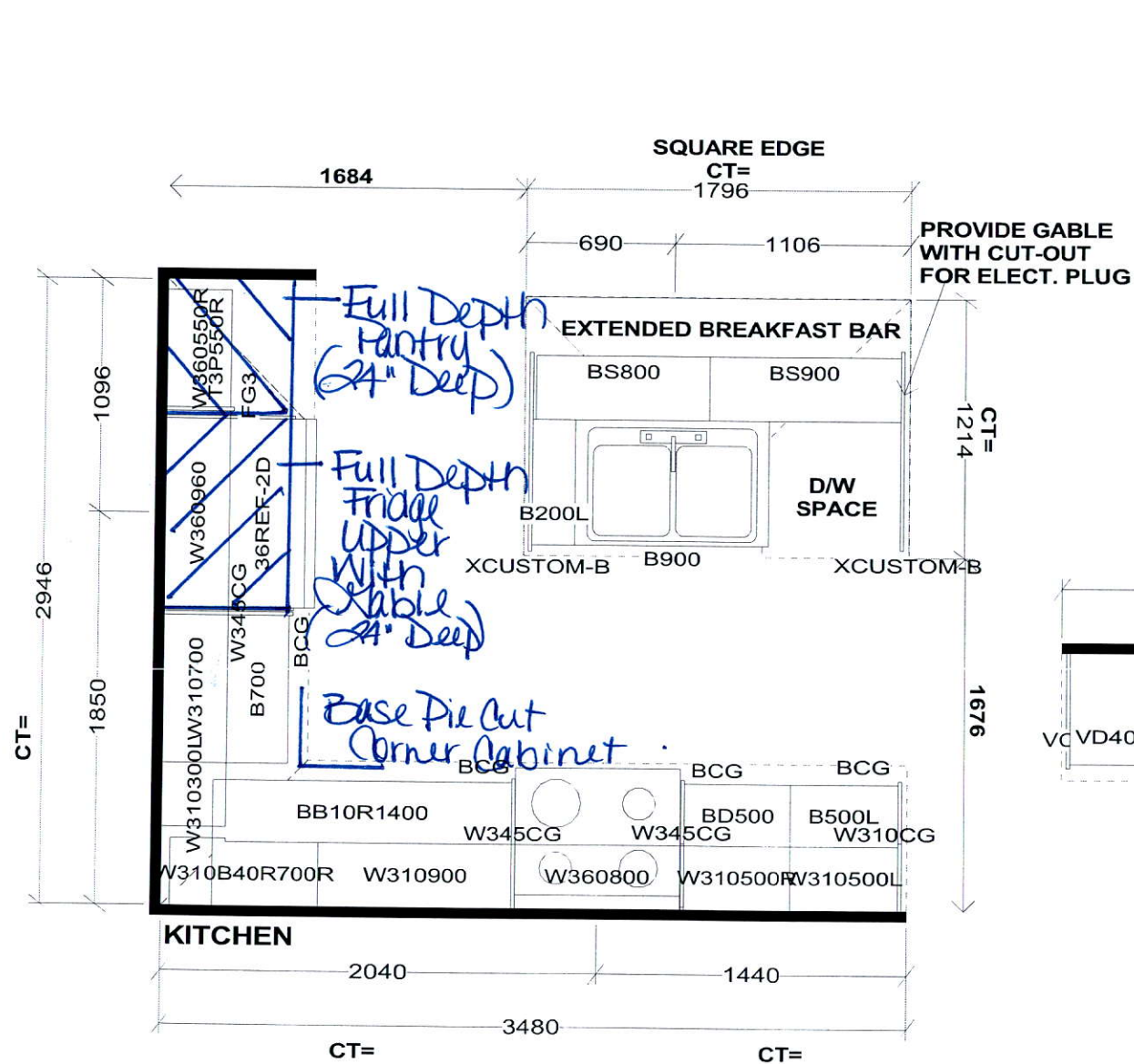

Selba Industries

kk kr

STANDARD FEATURES:  
 9' CEILINGS WITH D/C BOX  
 1040MM HIGH UPPER CABINETS  
 DISHWASHER SPACE  
 DUMMY DOORS ON EXPOSED BACKS  
 LAMINATE KITCHEN & VANITY COUNTERTOPS

This drawing is the intellectual property of SELBA INDUSTRIES INC. and is an original design which must not be released or copied unless applicable fee has been paid or job order placed.



JOB NUMBER:  
 BUILDER: GREENPARK HOMES  
 SITE NAME: LECCO RIDGE, Milton  
 MODEL: IVY 11X ELEV 1,2,3  
 LOT #:  
 DESIGNER: KS  
 DATE: FEB 13 17

# IVY 11 2,259 SQ.FT.

AVAILABLE IN BLOCK: 324, 327, 328, 329, 331, 334, 335, 338, 341, 343 & 344



K.K. KQ

Orientation of home may be reversed and purchaser agrees to accept the same. Steps and porches may vary in any exterior entrance ways due to grading variance. Actual usable floor space may vary from the stated floor area. All renderings are artist's concept. Dimensions, specifications and architectural detailing subject to minor modifications. Final location of sump pump is based on site conditions. Roofline and adjoining model types may vary due to lotting. F. & O. E. I.C. Ivy 11 • Copyright Nov. 2016