



CONSTRUCTION SUMMARY

Saddle Ridge (G) - Lecco Ridge Developments Inc.

PURCHASERS: ZAIDOUN MOAYAD AL-BADRI and ABEER WALEED HUSSAIN ALEZZI

TEL: RES.: 647-923-6644

LOT / PHASE Block 323 TH 2 / 1	REG. PLAN # 20M-1184	HOUSE TYPE Ivy 4 Elev 1A		
-----------------------------------	-------------------------	-----------------------------	--	--

CABINETY ACCESSORIES

1 - KITCHEN CABINETY BASE - PIE CUT CORNER CABINET - BASE CABINETY - STANDARD 02Apr18 Note:	
1 - KITCHEN CABINETY UPPER - FULL DEPTH ABOVE FRIDGE - WITH GABLES - 600MM - PRICE IS EACH - STANDARD 02Apr18 Note:	

HARDWOOD FLOORING

1 - LAMINATE - LEXINGTON SERIES - - UPPER HALL 02Apr18 Note:	
1 - LAMINATE -UPGRADE TO LEXINGTON SERIES IN LIEU OF STANDARD LAMINATE 02Apr18 Note:	

PROMOTIONAL

1 - LESS CREDIT FROM PURCHASER EXTRA SHEET IN OFFER 02Apr18 Note:	
--	--

STAIRS AND RAILINGS

1 - STAINED HANDRAIL, TREADS, RISERS AND STRINGER EXCLUDING PICKETS (FOR IRON PICKETS) - STANDARD STAIRCASE - PRICE IS PER SET 02Apr18 Note:	
1 - EUROLINE 1- BLACK IRON PICKETS 02Apr18 Note:	

EXTRAS AS PER OFFER

The Vendor agrees that notwithstanding any other term or provision in this Agreement included in the Purchase Price and in addition to those items detailed in Schedule GP to the Agreement of Purchase and Sale, the Purchaser is entitled to a credit of Fiv Worksheet Note:	
Five (5) White Appliances as per PE Appliances Worksheet Note:	
The Purchaser acknowledges that the Purchase Price is inclusive of all credits and promotional packages available at the time of purchase. Worksheet Note:	

This Document is Extremely Time Sensitive - Printed 2 Apr 18 at 11:11

RECEIVED APR 03 2018

Purchasers:ZAIDOUN MOAYAD AL-BADRI & ABEER WALEE

Property: Block 323 TH 2

Telephone Res. / Bus: (647) 923-6644 /

Project: Lecco Ridge Developments Inc.

Decor Advisor: Natalie Mancuso

Model and Elevation: Ivy 4 Elev 1A

Lock Date: 2-Apr-18

2-Apr-18

Plan #: 20M-1184

Layout Changes: ☐ Yes ☒ No

Sketch Attached: ☒ Yes ☐ No

Exterior Colour Scheme:

1. Cabinetry

	Style and Colour	Hardware
Kitchen / Breakfast	EVEREST WHITE	2002
Laundry Room	ELISSE	Standard
Powder Room	MONACO W350XZ4	1001
Master Ensuite Bathroom	MONACO W350XZ4	1001
Main Bathroom	MONACO W350XZ4	1001

Appliances:

Built In Appliances ☐ Yes ☒ No

Slide In Stove ☐ Yes ☒ No

Dishwasher Cabinet ☐ Closed ☒ Open

41" Upper Cabinets ☒ Yes ☐ No

Please NOTE: Standard Cabinet Height is 30"

Stove Opening

NOTE: If not specified, opening will be set to builder's standard opening of approximately 30" width

Fridge Opening

NOTE: If not specified, opening will be set to builder's standard opening of approximately 37" width x 74" height

** Refer to Construction Summary

2. Counters

	Counter	Edge
Kitchen / Breakfast	LAMINATE-CALCUTTA MARBLE 4925K-07	
Laundry Room	N/A	
Powder Room	LAMINATE-CARRARA BIANCO 6696-46	
Master Ensuite Bathroom	LAMINATE-CARRARA BIANCO 6696-46	
Main Bathroom	LAMINATE-CARRARA BIANCO 6696-46	

** Refer to Construction Summary

Initials:

Z.A

AA

Purchasers:ZAIDOUN MOAYAD AL-BADRI & ABEER WALEE

Property: Block 323 TH 2

Telephone Res. / Bus: (647) 923-6644 /

Project: Lecco Ridge Developments Inc.

Decor Advisor: Natalie Mancuso

Model and Elevation: Ivy 4 Elev 1A

Lock Date: 2-Apr-18

2-Apr-18

Plan #: 20M-1184

3. Ceramic Flooring

Entrance Vestibule	TILE- RAINBOW WHITE 13X13	<input type="checkbox"/>	At a 45 Threshold-If App.
Main Hall	LAMINATE	<input type="checkbox"/>	METAL STRIP THROUGHOUT
Kitchen / Breakfast	TILE- RAINBOW WHITE 13X13	<input type="checkbox"/>	
Laundry Room	TILE- RAINBOW WHITE 13X13	<input type="checkbox"/>	
Powder Room	TILE- RAINBOW WHITE 13X13	<input type="checkbox"/>	
Master Ensuite Bathroom	TILE- SN PASTELLO WHITE 13X13	<input type="checkbox"/>	
Main Bathroom	TILE- SN PASTELLO WHITE 13X13	<input type="checkbox"/>	
SIDE ENTRANCE	TILE- RAINBOW WHITE 13X13	<input type="checkbox"/>	
		<input type="checkbox"/>	
		<input type="checkbox"/>	
		<input type="checkbox"/>	

** Refer to Construction Summary

4. Ceramic Wall Tile

Master Ensuite Bathroom	Selection	Describe
Tub Deck Wall	TILE- GLOSSY WHITE 8X10	
Tub Deck		
Tub Deck Skirt		
Shower Stall	TILE- GLOSSY WHITE 8X10	
Bathtub Enclosure Walls		
Main Bathroom	TILE- GLOSSY WHITE 8X10	
Kitchen Backsplash		

** Refer to Construction Summary - STANDARD GROUT THROUGHOUT UNLESS SPECIFIED

5. Plumbing Fixtures

All Bathrooms

White

Whirlpool

☐ Yes ☒ No

Dishwasher Rough-In

☒ Yes ☐ No

Waterline for Fridge

☐ Yes ☒ No

** Refer to Construction Summary

6. Trim Carpentry

Interior Doors	CLERMONT
Interior Trim	2 3/4" CASING WITH 4 1/4" BASEBOARD - COLONIAL
Door Handles	As Per Construction Specifications
Exterior Front Door Handle	As Per Construction Specifications

** Refer to Construction Summary

Initials: ZA AA

Purchasers:

Telephone Res. / Bus:

Decor Advisor:

Lock Date:

ZAIDOUN MOAYAD AL-BADRI & ABEER WALEE

(647) 923-6644 /

Natalie Mancuso

2-Apr-18

Property:

Project:

Model and Elevation:

Plan #:

Block 323 TH 2

Lecco Ridge Developments Inc.

Ivy 4 Elev 1A

20M-1184

7. Other Flooring

Main Hall	LAMINATE-LEXINGTON - HAZELWOOD OAK TL21016 - M
Living Room	LAMINATE-LEXINGTON - HAZELWOOD OAK TL21016 - M
Dining Room	LAMINATE-LEXINGTON - HAZELWOOD OAK TL21016 - M
Family Room	LAMINATE-LEXINGTON - HAZELWOOD OAK TL21016 - M
Den / Library / Study	
Basement Landing(If Applies)	
Lower Landing (If Applies)	
Upper Landing	LAMINATE-LEXINGTON - HAZELWOOD OAK TL21016 - M
Upper Hall	LAMINATE-LEXINGTON - HAZELWOOD OAK TL21016 - M
Master Bedroom	CARPET-SHAW - E0949 NEWBERN CLASSIC - MORNING FOG 00530
Bedroom #2	CARPET-SHAW - E0949 NEWBERN CLASSIC - MORNING FOG 00530
Bedroom #3	CARPET-SHAW - E0949 NEWBERN CLASSIC - MORNING FOG 00530
Bedroom #4	
Bedroom #5	
Underpad	TypeArea
	STANDARD

** Refer to Construction Summary

8. Railings and Pickets

Railing Type	AS PER CONSTRUCTION SPECIFICATIONS	Colour	TORLYS- HAZELWOOD OAK
Picket Type	EUROLINE 1 BLACK	Colour	BLACK
Stringer / Riser	As Per Construction Specifications	Colour	TORLYS- HAZELWOOD OAK
Treads	Standard	Colour	TORLYS- HAZELWOOD OAK
Red Oak Stairs with Semi Gloss Finish		<input checked="" type="radio"/> Yes <input type="radio"/> No	

** Refer to Construction Summary

9. Wall Paint Flat Finish

Main & Upper Hall	22 WARM GREY	Master Bedroom	22 WARM GREY
Living Room	22 WARM GREY	Bedroom #2	22 WARM GREY
Dining Room	22 WARM GREY	Bedroom #3	22 WARM GREY
Kitchen / Breakfast	22 WARM GREY	Bedroom #4	
Family Room	22 WARM GREY	Bedroom #5	
Powder Room	22 WARM GREY	Master Ensuite	22 WARM GREY
Laundry Room	22 WARM GREY	Main Bathroom	22 WARM GREY
Den/Library			
Trim Paint-Semi Gloss	BIRCH WHITE		

Smooth Ceilings First Floor ☐ Yes ☒ No

** Refer to Construction Summary

Initials: ZA AA

Purchasers: ZAIDOUN MOAYAD AL-BADRI & ABEER WALEED
Telephone Res. / Bus: (647) 923-6644 /
Decor Advisor: Natalie Mancuso
Lock Date: 2-Apr-18 2-Apr-18
Property: Block 323 TH 2
Project: Lecco Ridge Developments Inc.
Model and Elevation: Ivy 4 Elev 1A
Plan #: 20M-1184

10. Plaster Mouldings and Medallions

Entrance Vestibule			Kitchen/Breakfast		
Main Hall			Den/Library		
Living Room			Lower Landing		
Dining Room					
Family Room					

**** Refer to Construction Summary****11. Fireplace**

	Living Room			Family Room			Other Room - Specify		
	Purchased	As Per Plan	N/A	Purchased	As Per Plan	N/A	Purchased	As Per Plan	N/A
Fireplace Type	<input type="radio"/>	<input type="radio"/>	<input checked="" type="radio"/>	<input type="radio"/>	<input type="radio"/>	<input checked="" type="radio"/>	<input type="radio"/>	<input type="radio"/>	<input checked="" type="radio"/>
Mantle Type									
Colour / Stain									
Surround									
Hearth									

**** Refer to Construction Summary****12. Heating and Air Conditioning**

Air Conditioning	NO	Gas Provisions Stove	NO
Gas Provisions Dryer	NO	Gas Provisions Barbecue	NO
Comment			

**** Refer to Construction Summary****13. Electrical**

Plugs and Switches	<input checked="" type="radio"/> White	DECOR	Above Kitchen Cabinet Light	<input type="radio"/> Yes	<input checked="" type="radio"/> No
Hood Fan	STANDARD WHITE		Below Kitchen Cabinet Light	<input type="radio"/> Yes	<input checked="" type="radio"/> No
Appliances	Built in Cooktop	Built in Oven	Gas Stove	Microwave	
	<input type="radio"/> Yes <input checked="" type="radio"/> No	<input type="radio"/> Yes <input checked="" type="radio"/> No	<input type="radio"/> Yes <input checked="" type="radio"/> No	<input type="radio"/> Yes <input checked="" type="radio"/> No	
Dishwasher Rough-in	Yes				

**** Refer to Construction Summary****14. General Comments****** Refer to Construction Summary****Disclaimers and Notes**

- Colours of all materials are as close as possible to builder's selection, but not necessarily identical due to variances in manufacturing.
- Any extras listed above are null and void unless accompanied by a separate invoice/amendment. Said invoice must be paid in full.
- The Purchaser agrees that this colour selection is final and that no changes will be permitted, unless required by the Vendor.
- The Purchaser acknowledges reading and accepting document which contains other miscellaneous disclaimers.

Signature: Zaidoun Date: Apr. 2nd 2018 Signature: Abeer Date: Apr. 2nd 2018

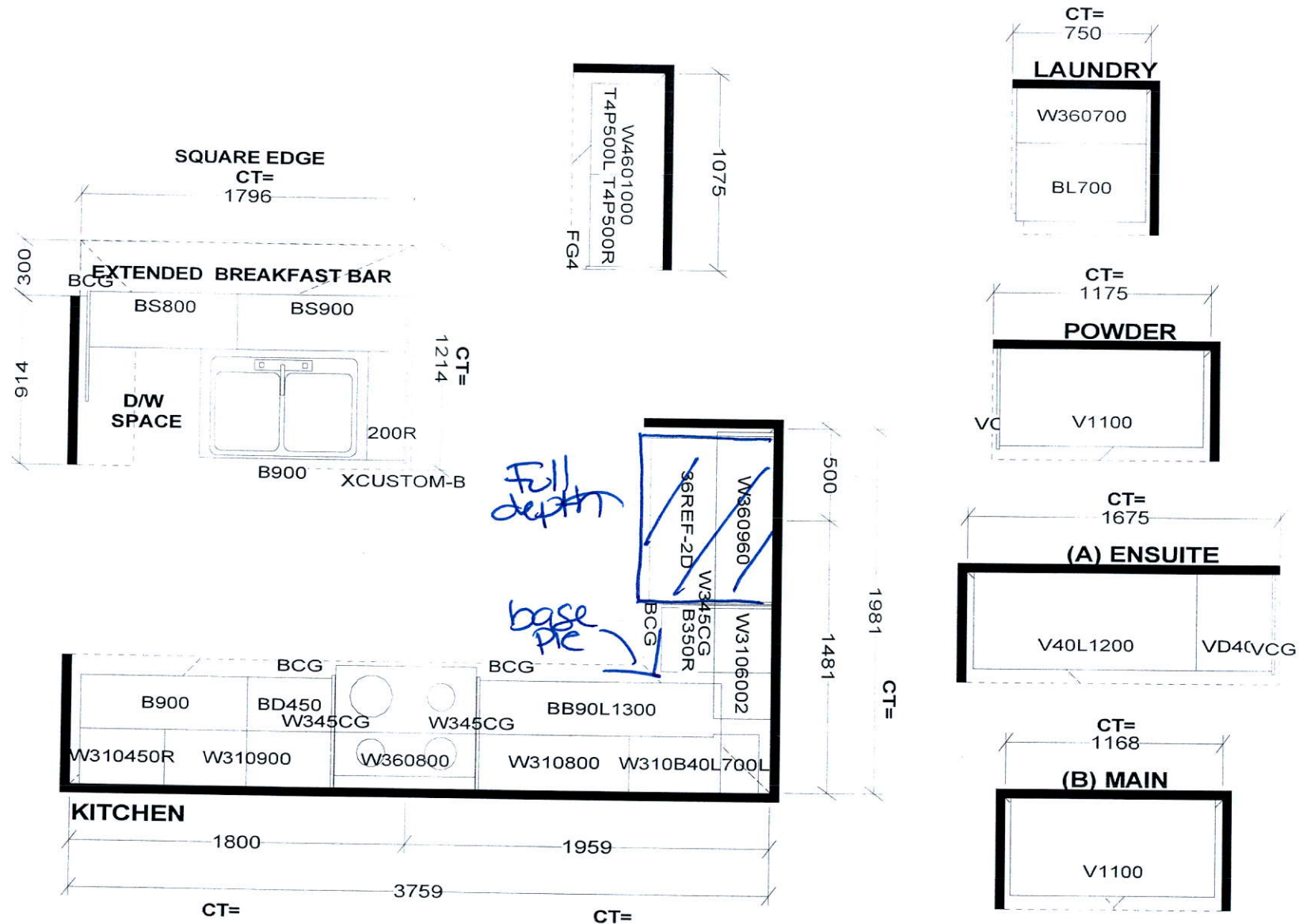

Selba Industries

STANDARD FEATURES:
9' CEILINGS WITH D/C BOX
1040MM HIGH UPPER CABINETS
DISHWASHER SPACE
DUMMY DOORS ON EXPOSED BACKS
LAMINATE KITCHEN & VANITY COUNTERTOPS

This drawing is the intellectual property of SELBA INDUSTRIES INC. and is an original design which must not be released or copied unless applicable fee has been paid or job order placed.



JOB NUMBER:
BUILDER: GREENPARK HOMES
SITE NAME: LECCO RIDGE, Milton
MODEL: IVY 4X ELEV 1, 1A, 2, 3
LOT #:
DESIGNER: KS
DATE: FEB 13 17

IVY 4

1,846 SQ.FT.

AVAILABLE IN BLOCK 323, 326, 327, 328, 330, 331,
333, 336, 337, 343, 344, 345, 346, 348 & 349

