



CONSTRUCTION SUMMARY

Saddle Ridge (G) - Lecco Ridge Developments Inc.

TEL: RES.: 416-400-9006

PURCHASER: 2153944 ONTARIO LIMITED

LOT / PHASE Block 346 TH 1 / 1	REG. PLAN # 20M-1184	HOUSE TYPE Ivy 12 Elev 2		
-----------------------------------	-------------------------	-----------------------------	--	--

CABINETRY

1 - VANITIES - MONACO WITH UPGRADE STAIN - PRICE IS FOR ONE OR ALL BATHS - TOWNS 01Aug17 Note:	
1 - KITCHEN - MONACO CABINETRY WITH UPGRADE STAIN 01Aug17 Note:	

CABINETRY ACCESSORIES

1 - KITCHEN CABINETRY UPPER - FULL DEPTH ABOVE FRIDGE - WITH GABLES - 600MM - PRICE IS EACH - STANDARD 01Aug17 Note:	
---	--

CONSTRUCTION

1 - SMOOTH CEILINGS ON FIRST FLOOR ONLY 01Aug17 Note:	
--	--

COUNTER TOP

1 - ENSUITE BATHROOM VANITY COUNTER TOP 01Aug17 Note:	
1 - MAIN BATHROOM VANITY COUNTER TOP 01Aug17 Note:	
1 - POWDER ROOM VANITY COUNTER TOP 01Aug17 Note:	
1 - KITCHEN COUNTER TOP 01Aug17 Note:	

HARDWOOD FLOORING

1 - LAMINATE - LEXINGTON SERIES - - SECOND FLOOR COMPLETE 01Aug17 Note:	
1 - LAMINATE -UPGRADE TO LEXINGTON SERIES IN LIEU STANDARD LAMINATE 01Aug17 Note:	

PLUMBING

3 - SINK - UNDERMOUNT - CONTRAC CALVIN UNDERMOUNT SINK - #4220CFY 01Aug17 Note: ALL BATHROOMS	
1 - KITCHEN - BLANCO HORIZON U2 UNDERMOUNT SINK - #401234 01Aug17 Note:	
1 - WASHROOM - 3 PIECE ROUGH-IN IN BASEMENT 15Dec16 Note:	

PROMOTIONAL

1 - LESS BALANCE OF CREDIT FROM PURCHASER EXTRA SHEET IN OFFER 01Aug17 Note:	
1 - PARTIAL REDEMPTION OF PROMOTIONAL PACKAGE \$\$\$\$\$\$ BALANCE FORWARD TO BE USED AT A LATER DATE. ORIGINAL PROMOTIONAL PACKAGE OF \$\$\$\$\$\$ AS PER SCHEDULE PE DATED MMMDDYYYY. 15Dec16 Note: ORIGINAL PROMOTIONAL PACKAGE \$5,000.00 BALANCE FORWARD \$4,360.00	

STAIRS AND RAILINGS

1 - STAINED STAIRS, RAILING AND PICKETS - FIRST TO SECOND FLOOR - STANDARD STAIRCASE 01Aug17 Note:	
---	--

RECEIVED AUG 21 2017

CONSTRUCTION SUMMARY				
Saddle Ridge (G) - Lecco Ridge Developments Inc.				
PURCHASER: 2153944 ONTARIO LIMITED			TEL: RES.: 416-400-9006	
LOT / PHASE	REG. PLAN #	HOUSE TYPE		
Block 346 TH 1 / 1	20M-1184	Ivy 12 Elev 2		
1 - 1-3/4" PICKETS				
01Aug17 Note: STAIRCASE				
1 - V GROOVE HANDRAIL				
01Aug17 Note: STAIRCASE				

EXTRAS AS PER OFFER

The Purchaser acknowledges that the Purchase Price is inclusive of all credits and promotional packages available at the time of purchase.	
Worksheet Note:	
The Vendor agrees that notwithstanding any other term or provision in this Agreement included in the Purchase Price and in addition to those items detailed in Schedule GP to the Agreement of Purchase and Sale, the Purchaser is entitled to a credit of Fiv	
Worksheet Note:	
Five (5) White Appliances as per PE Appliances	
Worksheet Note:	

This Document is Extremely Time Sensitive - Printed 1 Aug 17 at 11:48

Purchaser:

2153944 ONTARIO LIMITED

Telephone Res. / Bus:

(416) 400-9006 /

Decor Advisor:

Candace Forza

Lock Date:

1-Aug-17

Property:

Block 346 TH 1

Project:

Lecco Ridge Developments Inc.

Model and Elevation:

Ivy 12 Elev 2

Plan #:

20M-1184

Layout Changes:

☐ Yes ☒ No

Sketch Attached:

☒ Yes ☐ No

Exterior Colour Scheme:

1. Cabinetry

	Style and Colour	Hardware
Kitchen / Breakfast	MONACO W823XZ4	2002
Laundry Room	ELISSE	Standard
Powder Room	MONACO W823XZ4	2002
Master Ensuite Bathroom	MONACO W823XZ4	2002
Main Bathroom	MONACO W823XZ4	2002
	N/A	N/A
	N/A	N/A
	N/A	N/A
	N/A	N/A

Appliances:

Built In Appliances

☐ Yes ☒ No

Slide In Stove

☐ Yes ☒ No

Dishwasher Cabinet

☐ Closed ☒ Open

41" Upper Cabinets

☒ Yes ☐ No

Please NOTE: Standard Cabinet Height is 30"

Stove Opening

NOTE: If not specified, opening will be set to builder's standard opening of approximately 30" width

Fridge Opening

NOTE: If not specified, opening will be set to builder's standard opening of approximately 37" width x 74" height

** Refer to Construction Summary

2. Counters

	Counter	Edge
Kitchen / Breakfast	QUARTZ-CALACATTA MICHAELANGELO	#320 PENCIL ROUND EDGE
Laundry Room	N/A	
Powder Room	QUARTZ-PAPIRO	#320 PENCIL ROUND EDGE
Master Ensuite Bathroom	QUARTZ-PAPIRO	#320 PENCIL ROUND EDGE
Main Bathroom	QUARTZ-PAPIRO	#320 PENCIL ROUND EDGE
	N/A	
	N/A	
	N/A	
	N/A	

** Refer to Construction Summary

Initial: 

Purchaser:2153944 ONTARIO LIMITED

Telephone Res. / Bus: (416) 400-9006 /

Decor Advisor: Candace Forza

Lock Date: 1-Aug-17

Property: Block 346 TH 1

Project: Lecco Ridge Developments Inc.

Model and Elevation: Ivy 12 Elev 2

Plan #: 20M-1184

3. Ceramic Flooring

		At a 45 Threshold-If App.
Entrance Vestibule	TILE-RAINBOW WHITE-13X13	<input type="checkbox"/> METAL STRIP
Main Hall	LAMINATE	<input type="checkbox"/>
Kitchen / Breakfast	TILE-RAINBOW WHITE-13X13	<input type="checkbox"/> METAL STRIP
Laundry Room	TILE-RAINBOW WHITE-13X13	<input type="checkbox"/> METAL STRIP
Powder Room	TILE-RAINBOW WHITE-13X13	<input type="checkbox"/>
Master Ensuite Bathroom	TILE-RAINBOW WHITE-13X13	<input type="checkbox"/> METAL STRIP
Main Bathroom	TILE-RAINBOW WHITE-13X13	<input type="checkbox"/> METAL STRIP
SIDE ENTRANCE	TILE-RAINBOW WHITE-13X13	<input type="checkbox"/>
	N/A	<input type="checkbox"/>
	N/A	<input type="checkbox"/>
	N/A	<input type="checkbox"/>

** Refer to Construction Summary

4. Ceramic Wall Tile

Master Ensuite Bathroom	Selection	Describe
Tub Deck Wall	TILE-MATTE WHITE-8X8	
Tub Deck	N/A	
Tub Deck Skirt	N/A	
Shower Stall	TILE-MATTE WHITE-8X8	
Bathtub Enclosure Walls	N/A	
	N/A	
Main Bathroom	TILE-MATTE WHITE-8X8	
	N/A	
	N/A	
	N/A	
Kitchen Backsplash	N/A	

** Refer to Construction Summary - STANDARD GROUT THROUGHOUT UNLESS SPECIFIED

5. Plumbing Fixtures

All Bathrooms

White

N/A

N/A

N/A

N/A

N/A

Whirlpool

N/A

☐ Yes

☒ No

Dishwasher Rough-In

☒ Yes

☐ No

Waterline for Fridge

☐ Yes

☒ No

** Refer to Construction Summary

6. Trim Carpentry

Interior Doors	CLERMONT
Interior Trim	As Per Construction Specifications
Door Handles	SATIN CHROME KNOB
Exterior Front Door Handle	SATIN CHROME CHELSEA

** Refer to Construction Summary

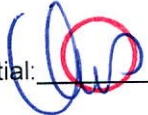
Initial: 

Purchaser:

2153944 ONTARIO LIMITED

Telephone Res. / Bus:

(416) 400-9006 /

Decor Advisor:

Candace Forza

Lock Date:

1-Aug-17

Property:

Block 346 TH 1

Project:

Lecco Ridge Developments Inc.

Model and Elevation:

Ivy 12 Elev 2

Plan #:

20M-1184

7. Other Flooring

Main Hall	LAMINATE-TORLYS-LEXINGTON-HAZELWOOD OAK-TL-21016	
Living Room	N/A	
Dining Room	LAMINATE-TORLYS-LEXINGTON-HAZELWOOD OAK-TL-21016	
Family Room	LAMINATE-TORLYS-LEXINGTON-HAZELWOOD OAK-TL-21016	
Den / Library / Study	LAMINATE-TORLYS-LEXINGTON-HAZELWOOD OAK-TL-21016	
Basement Landing(If Applies)	N/A	
Lower Landing (If Applies)	LAMINATE-TORLYS-LEXINGTON-HAZELWOOD OAK-TL-21016	
Upper Landing	LAMINATE-TORLYS-LEXINGTON-HAZELWOOD OAK-TL-21016	
Upper Hall	LAMINATE-TORLYS-LEXINGTON-HAZELWOOD OAK-TL-21016	
Master Bedroom	LAMINATE-TORLYS-LEXINGTON-HAZELWOOD OAK-TL-21016	
Bedroom #2	LAMINATE-TORLYS-LEXINGTON-HAZELWOOD OAK-TL-21016	
Bedroom #3	LAMINATE-TORLYS-LEXINGTON-HAZELWOOD OAK-TL-21016	
Bedroom #4	LAMINATE-TORLYS-LEXINGTON-HAZELWOOD OAK-TL-21016	
Bedroom #5	N/A	
	N/A	
	N/A	
	N/A	
Underpad	Type	Area
	N/A	N/A

** Refer to Construction Summary

8. Railings and Pickets

Railing Type	3 1/4 V-GROOVE	Colour	TORLYS HAZELWOOD OAK
Picket Type	1 3/4" COLONIAL - UPGRADE	Colour	TORLYS HAZELWOOD OAK
Stringer / Riser	AS PER CONSTRUCTION SPECS	Colour	TORLYS HAZELWOOD OAK
Treads	AS PER CONSTRUCTION SPECS	Colour	TORLYS HAZELWOOD OAK
Red Oak Stairs with Semi Gloss Finish		<input checked="" type="radio"/> Yes	<input type="radio"/> No

** Refer to Construction Summary

9. Wall Paint Flat Finish

Main & Upper Hall	22 WARM GREY	Master Bedroom	22 WARM GREY
Living Room	N/A	Bedroom #2	22 WARM GREY
Dining Room	22 WARM GREY	Bedroom #3	22 WARM GREY
Kitchen / Breakfast	22 WARM GREY	Bedroom #4	22 WARM GREY
Family Room	22 WARM GREY	Bedroom #5	N/A
Powder Room	22 WARM GREY	Master Ensuite	22 WARM GREY
Laundry Room	22 WARM GREY	Main Bathroom	22 WARM GREY
Den/Library	22 WARM GREY	SIDE ENTRANCE	22 WARM GREY
Trim Paint-Semi Gloss	BIRCH WHITE		N/A
	N/A		N/A
	N/A		N/A

Smooth Ceilings First Floor

☒ Yes

☐ No

** Refer to Construction Summary

Initial: 

Purchaser:

2153944 ONTARIO LIMITED

Telephone Res. / Bus:

(416) 400-9006 /

Decor Advisor:

Candace Forza

Lock Date:

1-Aug-17

Property:

Block 346 TH 1

Project:

Lecco Ridge Developments Inc.

Model and Elevation:

Ivy 12 Elev 2

Plan #:

20M-1184

10. Plaster Mouldings and Medallions

Entrance Vestibule	N/A	N/A	Kitchen/Breakfast	N/A	N/A
Main Hall	N/A	N/A	Den/Library	N/A	N/A
Living Room	N/A	N/A	Lower Landing	N/A	N/A
Dining Room	N/A	N/A		N/A	N/A
Family Room	N/A	N/A			

** Refer to Construction Summary

11. Fireplace

	Living Room			Family Room			Other Room - Specify		
	Purchased	As Per Plan	N/A	Purchased	As Per Plan	N/A	Purchased	As Per Plan	N/A
	<input type="radio"/>	<input type="radio"/>	<input checked="" type="radio"/>	<input type="radio"/>	<input type="radio"/>	<input checked="" type="radio"/>	<input type="radio"/>	<input type="radio"/>	<input checked="" type="radio"/>
Fireplace Type	N/A			N/A			N/A		
Mantle Type	N/A			N/A			N/A		
Colour / Stain	N/A			N/A			N/A		
Surround	N/A			N/A			N/A		
Hearth	N/A			N/A			N/A		

** Refer to Construction Summary

12. Heating and Air Conditioning

Air Conditioning	NO	Gas Provisions Stove	NO
Gas Provisions Dryer	NO	Gas Provisions Barbecue	NO
Comment			

** Refer to Construction Summary

13. Electrical

Plugs and Switches	<input checked="" type="radio"/> White	DECOR	Above Kitchen Cabinet Light	<input type="radio"/> Yes	<input checked="" type="radio"/> No
Hood Fan	STANDARD		Below Kitchen Cabinet Light	<input type="radio"/> Yes	<input checked="" type="radio"/> No
Appliances	Built in Cooktop	Built in Oven	Gas Stove	Microwave	
	<input type="radio"/> Yes <input checked="" type="radio"/> No	<input type="radio"/> Yes <input checked="" type="radio"/> No	<input type="radio"/> Yes <input checked="" type="radio"/> No	<input type="radio"/> Yes <input checked="" type="radio"/> No	
Dishwasher Rough-in	Yes				

** Refer to Construction Summary

14. General Comments

** Refer to Construction Summary

Disclaimers and Notes

1) Colours of all materials are as close as possible to builder's selection, but not necessarily identical due to variances in manufacturing.

2) Any extras listed above are null and void unless accompanied by a separate invoice/amendment. Said invoice must be paid in full.

3) The Purchaser agrees that this colour selection is final and that no changes will be permitted, unless required by the Vendor.

4) The Purchaser acknowledges reading and accepting document which contains other miscellaneous disclaimers.

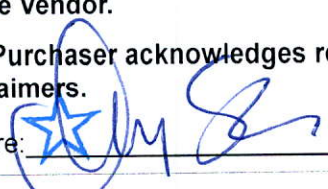
Signature:  Date: _____

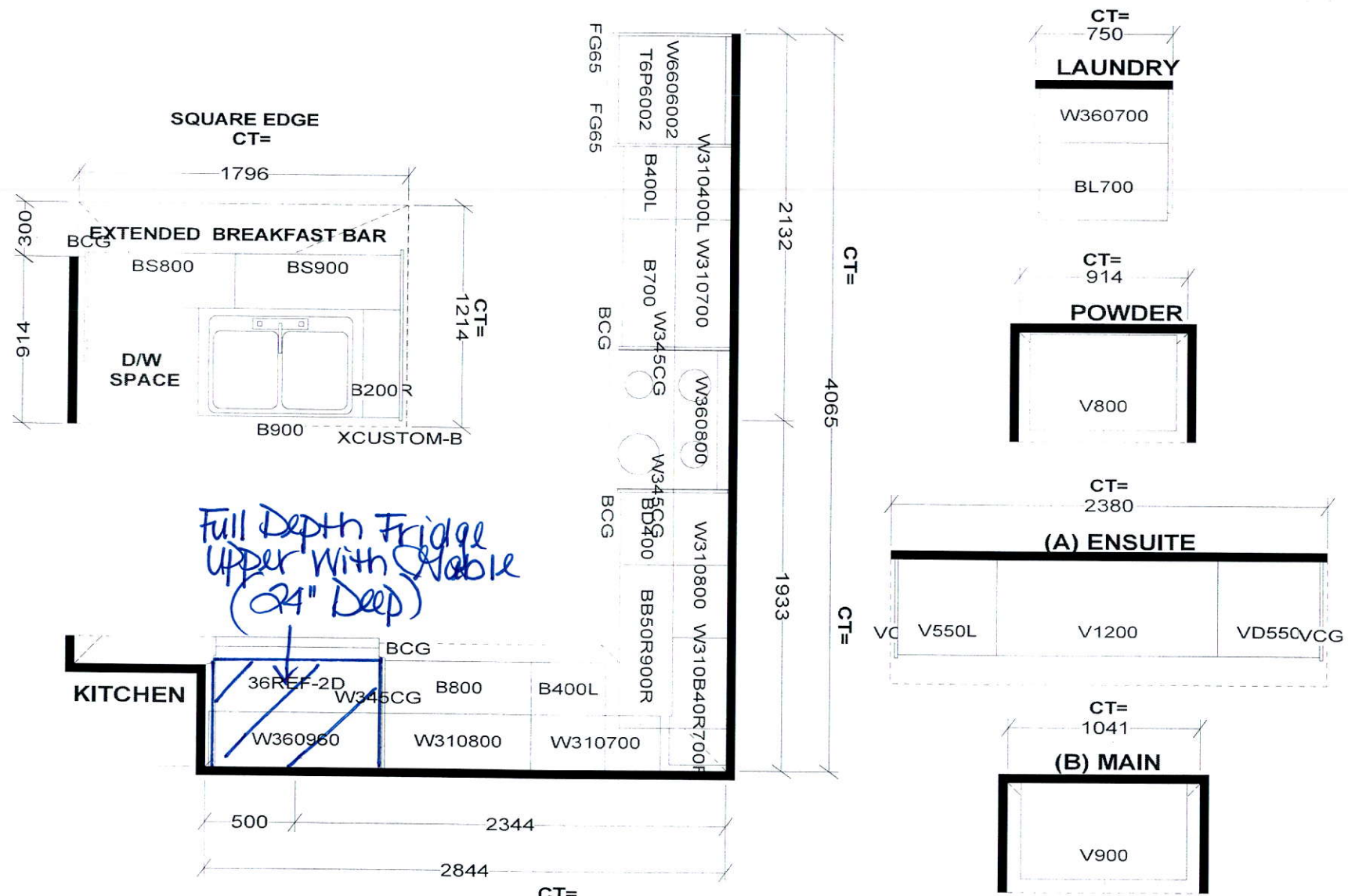

Selba Industries

STANDARD FEATURES:

9' CEILINGS WITH D/C BOX
1040MM HIGH UPPER CABINETS
DISHWASHER SPACE
DUMMY DOORS ON EXPOSED BACKS
LAMINATE KITCHEN & VANITY COUNTERTOPS

This drawing is the intellectual property of SELBA INDUSTRIES INC. and is an original design which must not be released or copied unless applicable fee has been paid or job order placed.



JOB NUMBER:
BUILDER: GREENPARK HOMES
SITE NAME: LECCO RIDGE, Milton
MODEL: IVY 12X ELEV 1,2,3
LOT #:
DESIGNER: KS
DATE: FEB 13 17

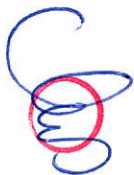

IVY 12 2,363 SQ.FT.

AVAILABLE IN BLOCK: 324, 325, 326, 330, 331, 337,
340, 342, 345, 346, 347 & 349



“As-received” items may be recycled and purchaser agrees to design the new strips and patches may vary at any exterior or interior edge due to grading variance. Actual usable floor space may vary from the stated floor area. All renderings are artist's concept. Dimensions, specifications and a schedule of materials subject to minor modifications. Final location of sump pump is based on city connection. Roofline and adjoining model types may vary due to zoning. © 2016 LED by T2 • Copyright Nov, 2016