



CONSTRUCTION SUMMARY  
Saddle Ridge (G) - Lecco Ridge Developments Inc.

PURCHASER: JOE DI SIMONE

TEL:

LOT / PHASE Block 325 TH 3 / 1	REG. PLAN # 20M-1184	HOUSE TYPE Ivy 12 Elev 2		
-----------------------------------	-------------------------	-----------------------------	--	--

CABINETY ACCESSORIES

1 - KITCHEN CABINETY UPPER - ANGLED CORNER CABINET - FITS TALL UPPER CABINETS - PER UNIT - STANDARD 09Mar18 Note:	
1 - ACCESSORY - GLASS DOOR - BEVELED - FINISHED INTERIOR - FITS TALL UPPER CABINETS - PRICE IS PER DOOR - STANDARD 09Mar18 Note:	
1 - KITCHEN CABINETY UPPER - FULL DEPTH ABOVE FRIDGE - WITH GABLES - 600MM - PRICE IS EACH - STANDARD 09Mar18 Note:	

CERAMIC TILE

1 - DELETE ALL CERAMIC BATHROOM ACCESSORIES - DELETE TOWEL BAR, PAPER HOLDER & SOAP DISH THROUGHOUT 09Mar18 Note:	
--	--

HARDWOOD FLOORING

1 - LAMINATE - PARK LANE SERIES - - UPPER HALL 09Mar18 Note:	
---	--

MISCELLANEOUS

1 - FURTHER DISCOUNT AS PER VENDOR 09Mar18 Note:	
---	--

PLUMBING

3 - MOEN BATHROOM ACCESSORIES - MASON CHROME - TOWEL BAR 24" #YB8094/YB8000 - PRICE IS EACH 09Mar18 Note: ALL BATHROOMS	
3 - MOEN BATHROOM ACCESSORIES - MASON CHROME - PAPER HOLDER #YB8099/YB8000 - PRICE IS EACH 09Mar18 Note: ALL BATHROOMS	
1 - WASHROOM - 3 PIECE ROUGH-IN IN BASEMENT 17Feb17 Note:	

PROMOTIONAL

1 - LESS BALANCE OF CREDIT FROM PURCHASER EXTRA SHEET IN OFFER 09Mar18 Note:	
1 - PARTIAL REDEMPTION OF PROMOTIONAL PACKAGE \$\$\$\$\$\$ BALANCE FORWARD TO BE USED AT A LATER DATE. ORIGINAL PROMOTIONAL PACKAGE OF \$\$\$\$\$\$ AS PER SCHEDULE PE DATED MMMDDYYYY. 17Feb17 Note: ORIGINAL PROMOTIONAL PACKAGE \$5,000.00 BALANCE FORWARD \$4,360.00	

STAIRS AND RAILINGS

1 - STAINED STAIRS, RAILING AND PICKETS – STANDARD STAIRCASE - PRICE IS PER SET 09Mar18 Note:	
--	--

EXTRAS AS PER OFFER

Five (5) White Appliances as per PE Appliances Worksheet Note:	
The Vendor agrees that notwithstanding any other term or provision in this Agreement included in the Purchase Price and in addition to those items detailed in Schedule GP to the Agreement of Purchase and Sale, the Purchaser is entitled to a credit of Fiv Worksheet Note:	
The Purchaser acknowledges that the Purchase Price is inclusive of all credits and promotional packages available at the time of purchase. Worksheet Note:	RECEIVED MAR 22 2018

CONSTRUCTION SUMMARY

Saddle Ridge (G) - Lecco Ridge Developments Inc.

PURCHASER: JOE DI SIMONE

TEL:

LOT / PHASE Block 325 TH 3 / 1	REG. PLAN # 20M-1184	HOUSE TYPE Ivy 12 Elev 2		
-----------------------------------	-------------------------	-----------------------------	--	--

This Document is Extremely Time Sensitive - Printed 20 Mar 18 at 16:17

Purchaser: JOE DI SIMONE  
Telephone Res. / Bus: /  
Decor Advisor: Candace Forza  
Lock Date: 9-Mar-18

Property: Block 325 TH 3  
Project: Lecco Ridge Developments Inc.  
Model and Elevation: Ivy 12 Elev 2  
Plan #: 20M-1184

Layout Changes: ☐ Yes ☒ No      Sketch Attached: ☒ Yes ☐ No      Exterior Colour Scheme:

1. Cabinetry

	Style and Colour	Hardware
Kitchen / Breakfast	EVEREST WHITE	1001
Laundry Room	ELISSE	Standard
Powder Room	MONACO W350XZ4	2004
Master Ensuite Bathroom	MODENA ULTRA WHITE	2004
Main Bathroom	MODENA ULTRA WHITE	2004
	N/A	N/A
	N/A	N/A
	N/A	N/A
	N/A	N/A

Appliances:      Built In Appliances ☐ Yes ☒ No      Slide In Stove ☐ Yes ☒ No

Dishwasher Cabinet ☐ Closed ☒ Open      41" Upper Cabinets ☒ Yes ☐ No      Please NOTE: Standard Cabinet Height is 30"

Stove Opening      NOTE: If not specified, opening will be set to builder's standard opening of approximately 30" width

Fridge Opening      NOTE: If not specified, opening will be set to builder's standard opening of approximately 37" width x 74" height

\*\* Refer to Construction Summary

2. Counters

	Counter	Edge
Kitchen / Breakfast	LAMINATE-CARRARA BIANCO 6696-46	
Laundry Room	N/A	
Powder Room	LAMINATE-CALCUTTA MARBLE 4925K-07	
Master Ensuite Bathroom	LAMINATE-WHITE CARRARA 4924-38	
Main Bathroom	LAMINATE-WHITE CARRARA 4924-38	
	N/A	
	N/A	
	N/A	
	N/A	

\*\* Refer to Construction Summary



Purchaser: JOE DI SIMONE  
Telephone Res. / Bus: /  
Decor Advisor: Candace Forza  
Lock Date: 9-Mar-18

Property: Block 325 TH 3  
Project: Lecco Ridge Developments Inc.  
Model and Elevation: Ivy 12 Elev 2  
Plan #: 20M-1184

3. Ceramic Flooring

Entrance Vestibule	TILE-RAINBOW WHITE-13X13	At a 45 Threshold-If App.
Main Hall	N/A	METAL STRIP
Kitchen / Breakfast	TILE-RAINBOW WHITE-13X13	
Laundry Room	TILE-RAINBOW LIGHT GREY-13X13	METAL STRIP
Powder Room	TILE-RAINBOW WHITE-13X13	METAL STRIP
Master Ensuite Bathroom	TILE-RAINBOW LIGHT GREY-13X13	
Main Bathroom	TILE-RAINBOW LIGHT GREY-13X13	METAL STRIP
GARAGE ENTRY	TILE-RAINBOW WHITE-13X13	METAL STRIP
	N/A	
	N/A	
	N/A	

\*\* Refer to Construction Summary

4. Ceramic Wall Tile

Master Ensuite Bathroom	Selection	Describe
Tub Deck Wall	TILE-NATURALE GRIGIO-8X10	
Tub Deck	N/A	
Tub Deck Skirt	N/A	
Shower Stall	TILE-NATURALE GRIGIO-8X10	
Bathtub Enclosure Walls	N/A	
	N/A	
Main Bathroom	TILE-GOLF GRIGIO-8X10	
	N/A	
	N/A	
	N/A	
Kitchen Backsplash	N/A	

\*\* Refer to Construction Summary - STANDARD GROUT THROUGHOUT UNLESS SPECIFIED

5. Plumbing Fixtures

All Bathrooms	White	Whirlpool
	N/A	N/A <input type="radio"/> Yes <input checked="" type="radio"/> No
	N/A	
	N/A	
	N/A	Dishwasher Rough-In <input checked="" type="radio"/> Yes <input type="radio"/> No
	N/A	Waterline for Fridge <input type="radio"/> Yes <input checked="" type="radio"/> No

\*\* Refer to Construction Summary

6. Trim Carpentry

Interior Doors	CLERMONT
Interior Trim	As Per Construction Specifications
Door Handles	As Per Construction Specifications
Exterior Front Door Handle	As Per Construction Specifications

\*\* Refer to Construction Summary

Initial: 

Purchaser: JOE DI SIMONE

Property: Block 325 TH 3

Telephone Res. / Bus: /

Project: Lecco Ridge Developments Inc.

Decor Advisor: Candace Forza

Model and Elevation: Ivy 12 Elev 2

Lock Date: 9-Mar-18

9-Mar-18

Plan #: 20M-1184

7. Other Flooring

Main Hall	N/A	
Living Room	N/A	
Dining Room	LAMINATE-MANHATTAN - LAVA ROCK OAK TL-15021	
Family Room	LAMINATE-MANHATTAN - LAVA ROCK OAK TL-15021	
Den / Library / Study	LAMINATE-MANHATTAN - LAVA ROCK OAK TL-15021	
Basement Landing(If Applies)	N/A	
Lower Landing (If Applies)	LAMINATE-MANHATTAN - LAVA ROCK OAK TL-15021	
Upper Landing	LAMINATE-MANHATTAN - LAVA ROCK OAK TL-15021	
Upper Hall	LAMINATE-MANHATTAN - LAVA ROCK OAK TL-15021	
Master Bedroom	CARPET-SHAW - E0949 NEWBERN CLASSIC - MORNING FOG 00530	
Bedroom #2	CARPET-SHAW - E0949 NEWBERN CLASSIC - MORNING FOG 00530	
Bedroom #3	CARPET-SHAW - E0949 NEWBERN CLASSIC - MORNING FOG 00530	
Bedroom #4	CARPET-SHAW - E0949 NEWBERN CLASSIC - MORNING FOG 00530	
Bedroom #5	N/A	
	N/A	
	N/A	
	N/A	
Underpad	Type	Area
	STANDARD	BEDROOMS ONLY

\*\* Refer to Construction Summary

8. Railings and Pickets

Railing Type	As Per Construction Specifications	Colour	TORLYS LAVA ROCK OAK
Picket Type	As Per Construction Specifications	Colour	TORLYS LAVA ROCK OAK
Stringer / Riser	As Per Construction Specifications	Colour	TORLYS LAVA ROCK OAK
Treads	As Per Construction Specifications	Colour	TORLYS LAVA ROCK OAK
Red Oak Stairs with Semi Gloss Finish			<input checked="" type="radio"/> Yes <input type="radio"/> No

\*\* Refer to Construction Summary

9. Wall Paint Flat Finish

Main & Upper Hall	22 WARM GREY	Master Bedroom	22 WARM GREY
Living Room	N/A	Bedroom #2	22 WARM GREY
Dining Room	22 WARM GREY	Bedroom #3	22 WARM GREY
Kitchen / Breakfast	22 WARM GREY	Bedroom #4	22 WARM GREY
Family Room	22 WARM GREY	Bedroom #5	N/A
Powder Room	22 WARM GREY	Master Ensuite	22 WARM GREY
Laundry Room	22 WARM GREY	Main Bathroom	22 WARM GREY
Den/Library	22 WARM GREY		N/A
Trim Paint-Semi Gloss	BIRCH WHITE		N/A
	N/A		N/A
	N/A		N/A

Smooth Ceilings First Floor ☐ Yes ☒ No

\*\* Refer to Construction Summary

Initial: 



Purchaser: JOE DI SIMONE  
Telephone Res. / Bus: /  
Decor Advisor: Candace Forza  
Lock Date: 9-Mar-18

Property: Block 325 TH 3  
Project: Lecco Ridge Developments Inc.  
Model and Elevation: Ivy 12 Elev 2  
Plan #: 20M-1184

10. Plaster Mouldings and Medallions

Entrance Vestibule	N/A	N/A	Kitchen/Breakfast	N/A	N/A
Main Hall	N/A	N/A	Den/Library	N/A	N/A
Living Room	N/A	N/A	Lower Landing	N/A	N/A
Dining Room	N/A	N/A		N/A	N/A
Family Room	N/A	N/A			

\*\* Refer to Construction Summary

11. Fireplace

Living Room			Family Room			Other Room - Specify		
Purchased	As Per Plan	N/A	Purchased	As Per Plan	N/A	Purchased	As Per Plan	N/A
<input type="radio"/>	<input type="radio"/>	<input checked="" type="radio"/>	<input type="radio"/>	<input type="radio"/>	<input checked="" type="radio"/>	<input type="radio"/>	<input type="radio"/>	<input checked="" type="radio"/>
Fireplace Type	N/A		N/A			N/A		
Mantle Type	N/A		N/A			N/A		
Colour / Stain	N/A		N/A			N/A		
Surround	N/A		N/A			N/A		
Hearth	N/A		N/A			N/A		

\*\* Refer to Construction Summary

12. Heating and Air Conditioning

Air Conditioning	NO	Gas Provisions Stove	NO
Gas Provisions Dryer	NO	Gas Provisions Barbecue	NO
Comment			

\*\* Refer to Construction Summary

13. Electrical

Plugs and Switches	<input checked="" type="radio"/> White	DECOR	Above Kitchen Cabinet Light	<input type="radio"/> Yes <input checked="" type="radio"/> No
Hood Fan	STANDARD WHITE		Below Kitchen Cabinet Light	<input type="radio"/> Yes <input checked="" type="radio"/> No
Appliances	Built in Cooktop	Built in Oven	Gas Stove	Microwave
	<input type="radio"/> Yes <input checked="" type="radio"/> No	<input type="radio"/> Yes <input checked="" type="radio"/> No	<input type="radio"/> Yes <input checked="" type="radio"/> No	<input type="radio"/> Yes <input checked="" type="radio"/> No
Dishwasher Rough-in	Yes			

\*\* Refer to Construction Summary

14. General Comments

\*\* Refer to Construction Summary

Disclaimers and Notes

- 1) Colours of all materials are as close as possible to builder's selection, but not necessarily identical due to variances in manufacturing.
- 2) Any extras listed above are null and void unless accompanied by a separate invoice/amendment. Said invoice must be paid in full.
- 3) The Purchaser agrees that this colour selection is final and that no changes will be permitted, unless required by the Vendor.
- 4) The Purchaser acknowledges reading and accepting document which contains other miscellaneous disclaimers.

Signature:  Date: \_\_\_\_\_

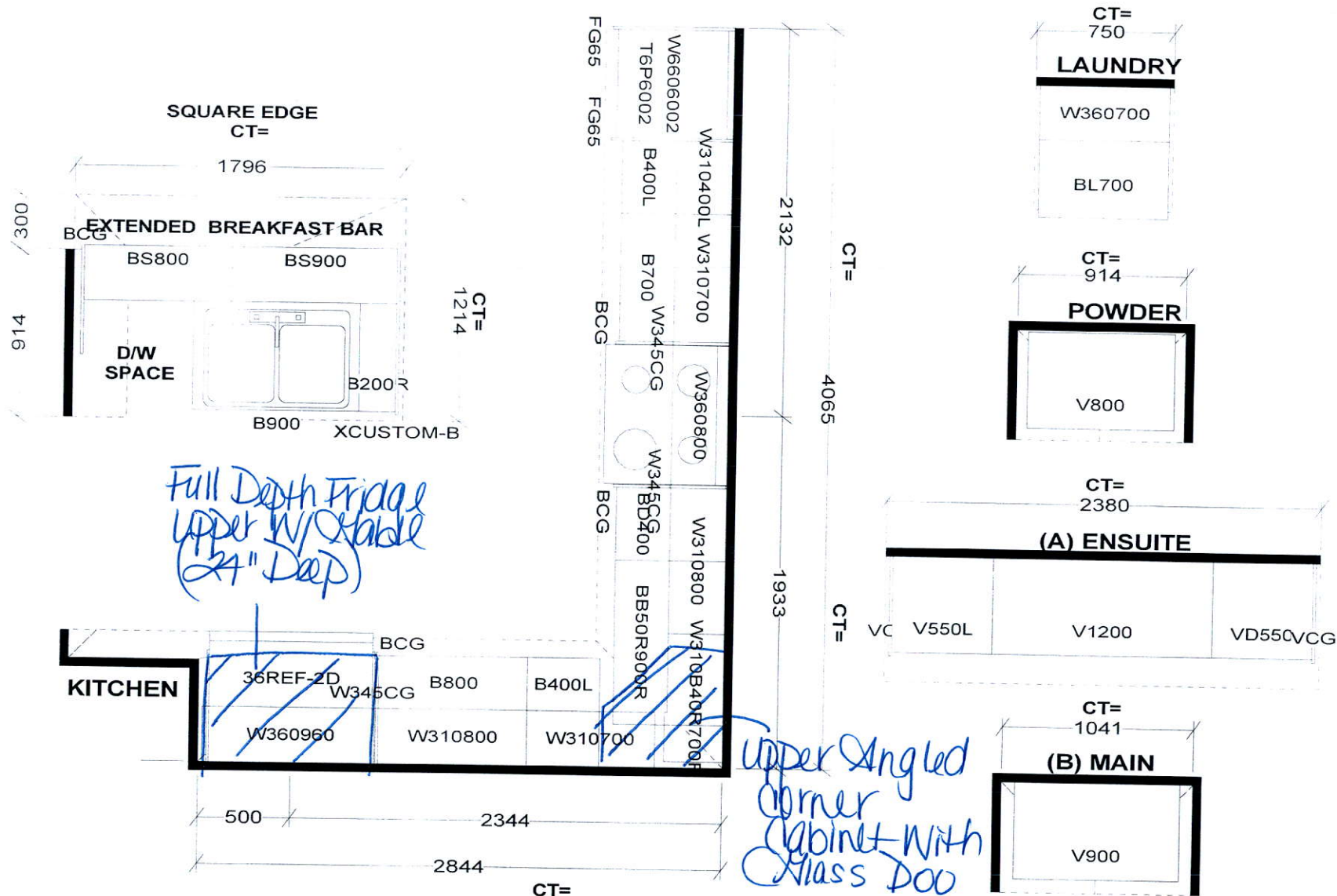

**Selba Industries**

**STANDARD FEATURES:**  
9' CEILINGS WITH D/C BOX  
1040MM HIGH UPPER CABINETS  
DISHWASHER SPACE  
DUMMY DOORS ON EXPOSED BACKS  
LAMINATE KITCHEN & VANITY COUNTERTOPS

This drawing is the intellectual property of SELBA INDUSTRIES INC. and is an original design which must not be released or copied unless applicable fee has been paid or job order placed.



**JOB NUMBER:**  
**BUILDER:** GREENPARK HOMES  
**SITE NAME:** LECCO RIDGE, Milton  
**MODEL:** IVY 12X ELEV 1,2,3  
**LOT #:**  
**DESIGNER:** KS  
**DATE:** FEB 13 17



# IVY 12 2,363 SQ. FT.

AVAILABLE IN BLOCK: 324, 325, 326, 330, 331, 337,  
340, 342, 345, 346, 347 & 349

