



CONSTRUCTION SUMMARY

Saddle Ridge (G) - Lecco Ridge Developments Inc.

PURCHASER: Rabeya Absar HASHMI

TEL:

LOT / PHASE 156 / 1	REG. PLAN # 20M-1184	HOUSE TYPE Juniper 9 Elev 2		
------------------------	-------------------------	--------------------------------	--	--

CABINETRY

1 - CABINETRY - UPGRADE 3 - POWDER ROOM 15Mar18 Note:	
1 - VANITY - UPGRADE 3 - ENSUITE BATHROOM 15Mar18 Note:	

CABINETRY ACCESSORIES

1 - ALL BATHROOMS - RAISE VAINTY HEIGHT TO 36" 15Mar18 Note:	
---	--

CERAMIC TILE

1 - TILE - UPGRADE 4 WALL TILE - - BATHROOM 5 - SHOWER 15Mar18 Note:	
1 - TILE - UPGRADE 4 FLOOR TILE - - BATHROOM 5 - FLOOR 15Mar18 Note:	
1 - DELETE ALL CERAMIC BATHROOM ACCESSORIES - DELETE TOWEL BAR, PAPER HOLDER & SOAP DISH THROUGHOUT 15Mar18 Note:	
1 - TILE - UPGRADE 2 WALL TILE - - BATHROOM 4 - SHOWER 15Mar18 Note:	
1 - TILE - UPGRADE 2 FLOOR TILE - - BATHROOM 4 - FLOOR 15Mar18 Note:	
1 - TILE - UPGRADE 2 WALL TILE - - BATHROOM 2/3 - SHOWER 15Mar18 Note:	
1 - TILE - UPGRADE 2 FLOOR TILE - - BATHROOM 2/3 - FLOOR 15Mar18 Note:	
1 - TILE - UPGRADE 5 WALL TILE - - ENSUITE WALL TILE - SHOWER 15Mar18 Note:	
1 - TILE - UPGRADE 5 FLOOR TILE - - ENSUITE BATHROOM - FLOOR 15Mar18 Note:	
1 - TILE - UPGRADE 5 FLOOR TILE - - POWDER ROOM 15Mar18 Note:	
1 - TILE - UPGRADE 5 FLOOR TILE - - KITCHEN 15Mar18 Note:	
1 - TILE - UPGRADE 5 FLOOR TILE - - FOYER 15Mar18 Note:	

CONSTRUCTION

1 - SMOOTH CEILINGS ON FIRST FLOOR ONLY 08Feb18 Note:	
--	--

DOORS AND TRIM

1 - DOORS INTERIOR - FOR 8 OR 9 FOOT CEILING - CARRARA SMOOTH HALLOW IN LIEU OF STANDARD SERIES - PRICE IS PER DOOR 15Mar18 Note:	
1 - DOORS INTERIOR - FOR 10 FOOT CEILING - CARRARA SMOOTH HALLOW IN LIEU OF STANDARD SERIES - PRICE IS PER DOOR 15Mar18 Note:	

RECEIVED MAR 20 2018

CONSTRUCTION SUMMARY

Saddle Ridge (G) - Lecco Ridge Developments Inc.

PURCHASER: Rabeya Absar HASHMI TEL:

LOT / PHASE	REG. PLAN #	HOUSE TYPE		
156 / 1	20M-1184	Juniper 9 Elev 2		

I - TRIM - UPGRADE 2- 7-¼" BASEBOARD AND 8050 CASING 15Mar18 Note:	
---	--

ELECTRICAL

I - LIGHT AND SWITCH - NO FIXTURE INCLUDED 08Feb18 Note: MASTER ENSUITE BATHROOM - INSTALLED ABOVE TUB - SEE SKETCH	
I - PLUG - ELECTRICAL PLUG - TO BE INSTALLED OVER FIREPLACE 08Feb18 Note:	
I - PLUG - ELECTRICAL PLUG - ADD TO ISLAND 08Feb18 Note:	
I - BUILT IN OVEN AND COOKTOP PROVISION - PROVISION ONLY - ELECTRICAL ONLY 08Feb18 Note:	
I - LIGHT AND SWITCH - NO FIXTURE INCLUDED - LIVING ROOM 08Feb18 Note:	
I - ABOVE KITCHEN ISLAND - ADD LIGHT AND SWITCH - NO FIXTURE INCLUDED 08Feb18 Note:	
I - 200 AMP ELECTRICAL SERVICE 08Feb18 Note:	

FIREPLACE AND ACCESSORIES

I - MANTEL - PAINTED - M6 - IN LIEU OF STANDARD MANTEL 15Mar18 Note:	
I - GAS LINE ROUGH-IN FOR STOVE (INCLUDES ELECTRICAL OUTLET) - FIRST FLOOR 08Feb18 Note:	

HARDWOOD FLOORING

I - LAMINATE -UPGRADE TO LEXINGTON SERIES IN LIEU OF STANDARD LAMINATE 15Mar18 Note:	
I - HARDWOOD – GROUP B SERIES 5 INCH - - UPPER HALL 15Mar18 Note:	
I - HARDWOOD – GROUP B SERIES 5 INCH - IN LIEU OF 2 1/4 INCH NATURAL RED OAK - - FIRST FLOOR COMPLETE 15Mar18 Note:	

MIRRORS AND GLASS

I - FRAMELESS GLASS SHOWER ENCLOSURE 08Feb18 Note: MASTER ENSUITE BATHROOM - CHROME KNOB AND HINGES	
--	--

MISCELLANEOUS

I - PURCHASER TO SUPPLY BUILT-IN APPLIANCE SPECS NO LATER THAN MARCH 22, 2018 15Mar18 Note:	
I - FURTHER DISCOUNT AS PER VENDOR 15Mar18 Note:	

PLUMBING

5 - MOEN BATHROOM ACCESSORIES - MASON CHROME - TOWEL BAR 24" #YB8094/YB8000 - PRICE IS EACH 15Mar18 Note: ALL BATHROOMS	
5 - MOEN BATHROOM ACCESSORIES - MASON CHROME - PAPER HOLDER #YB8099/YB8000 - PRICE IS EACH 15Mar18 Note: ALL BATHROOMS	

CONSTRUCTION SUMMARY

Saddle Ridge (G) - Lecco Ridge Developments Inc.

PURCHASER: Rabeya Absar HASHMI

TEL:

LOT / PHASE	REG. PLAN #	HOUSE TYPE		
156 / 1	20M-1184	Juniper 9 Elev 2		
1 - MASTER ENSUITE BATHROOM - SHOWER STALL - DELTA ZURA SHOWER KIT - CHROME - DFKIT19 08Feb18 Note:				
1 - ENSUITE 2/3 BATHROOM - INSTALL STANDARD TOE TESTER 08Feb18 Note:				
3 - TOE TESTER - ADD TOE TESTER TO SHOWER 08Feb18 Note: MASTER ENSUITE BATHROOM, ENSUITE 4 & ENSUITE 5 BATHROOMS				
1 - WATER LINE FOR FRIDGE - ROUGH-IN ONLY 08Feb18 Note:				
1 - 5 FOOT SHOWER WITH SLIDING GLASS CHROME DOORS IN LIEU OF TUB 08Feb18 Note: ENSUITE 2/3 BATHROOM				

PROMOTIONAL

1 - LESS CREDIT FROM PURCHASER EXTRA SHEET IN OFFER 08Feb18 Note:	
--	--

STAIRS AND RAILINGS

1 - STAINED HANDRAIL, TREADS, RISERS AND STRINGER EXCLUDING PICKETS (FOR IRON PICKETS) - STANDARD STAIRCASE - PRICE IS PER SET 15Mar18 Note:	
1 - V GROOVE HANDRAIL 15Mar18 Note: STAIRCASE -LARGER POST AND HANDRAIL	
1 - EUROLINE 1 15Mar18 Note: STAIRCASE - IRON PICKETS - BLACK	

EXTRAS AS PER OFFER

10 FOOT CEILING ON MAIN LEVEL Worksheet Note:	
The Purchaser acknowledges that the Purchase Price is inclusive of all credits and promotional packages available at the time of purchase. Worksheet Note:	
The Vendor agrees that notwithstanding any other term or provision in this Agreement included in the Purchase Price and in addition to those items detailed in Schedule GP to the Agreement of Purchase and Sale, the Purchaser is entitled to a credit of Ten Worksheet Note:	

This Document is Extremely Time Sensitive - Printed 15 Mar 18 at 17:12

Purchaser: Rabeya Absar HASHMI

Telephone Res. / Bus: /

Decor Advisor: Candace Forza

Lock Date: 15-Mar-18

Layout Changes: ☒ Yes ☐ No

Property: 156

Project: Lecco Ridge Developments Inc.

Model and Elevation: Juniper 9 Elev 2

15-Mar-18

Plan #: 20M-1184

Sketch Attached: ☒ Yes ☐ No

Exterior Colour Scheme:

1. Cabinetry

	Style and Colour	Hardware
Kitchen / Breakfast	Hasting Chocolate . 	2002
Laundry Room	ELISSE	Standard
Powder Room	LEGACY L614XZ4	2002
Master Ensuite Bathroom	LEGACY L614XZ4	2002
Ensuite Bath - Bedroom 2/3	EVEREST WHITE	2002
Ensuite Bath - Bedroom 4	EVEREST WHITE	2002
Ensuite Bath - Bedroom 5	EVEREST WHITE	2002
	N/A	N/A
	N/A	N/A

Appliances:

Built In Appliances ☐ Yes ☒ No

Slide In Stove ☐ Yes ☒ No

Dishwasher Cabinet ☐ Closed ☒ Open

41" Upper Cabinets ☒ Yes ☐ No

Please NOTE: Standard Cabinet Height is 30"

Stove Opening

NOTE: If not specified, opening will be set to builder's standard opening of approximately 30" width

Fridge Opening

NOTE: If not specified, opening will be set to builder's standard opening of approximately 37" width x 74" height

** Refer to Construction Summary

2. Counters

	Counter	Edge
Kitchen / Breakfast	LAMINATE Autumn Carnival 1877K-52 	
Laundry Room	N/A	
Powder Room	LAMINATE-CARRARA BIANCO 6696-46	
Master Ensuite Bathroom	LAMINATE-CALCUTTA MARBLE 4925K-07	
Ensuite Bath - Bedroom 2/3	LAMINATE-CARRARA BIANCO 6696-46	
Ensuite Bath - Bedroom 4	LAMINATE-WHITE CARRARA 4924-38	
Ensuite Bath - Bedroom 5	LAMINATE-WHITE CARRARA 4924-38	
	N/A	
	N/A	

** Refer to Construction Summary

Initial: 

Purchaser:	Rabeya Absar HASHMI	Property:	156
Telephone Res. / Bus:	/	Project:	Lecco Ridge Developments Inc.
Decor Advisor:	Candace Forza	Model and Elevation:	Juniper 9 Elev 2
Lock Date:	15-Mar-18	15-Mar-18	Plan #: 20M-1184

3. Ceramic Flooring

		At a 45 Threshold-If App.
Entrance Vestibule	TILE-CALCATTa (CA60829) POL-24X24	
Main Hall	STRIP	
Kitchen / Breakfast	TILE-CALCATTa (CA60829) POL-24X24	METAL STRIP
Laundry Room	TILE-ESSENZE GRIGIO-13X13	
Powder Room	TILE-CALCATTa (CA60829) POL-24X24	METAL STRIP
Master Ensuite Bathroom	TILE-GOTHA DIAMOND LUX-24X24	METAL STRIP
Ensuite Bath - Bedroom 2/3	TILE-BSC 36009P LIGHT GREY POL-12X24	METAL STRIP
Ensuite Bath - Bedroom 4	TILE-BSC 36009P LIGHT GREY POL-12X24	METAL STRIP
Ensuite Bath - Bedroom 5	TILE-SBH-80001 ONICE-16X16	METAL STRIP
	N/A	
	N/A	

** Refer to Construction Summary

4. Ceramic Wall Tile

Master Ensuite Bathroom	Selection	Describe
Tub Deck Wall	N/A	
Tub Deck	N/A	
Tub Deck Skirt	N/A	
Shower Stall	TILE-GOTHA DIAMOND LUX-12X24	
Bathtub Enclosure Walls	N/A	
	N/A	
Ensuite Bath - Bedroom 2/3	TILE-BSC 36009P LIGHT GREY POL-12X24	
Ensuite Bath - Bedroom 4	TILE-BSC 36009P LIGHT GREY POL-12X24	
Ensuite Bath - Bedroom 5	TILE-SBH-60001 ONICE-12X24	
	N/A	
Kitchen Backsplash	N/A	

** Refer to Construction Summary - STANDARD GROUT THROUGHOUT UNLESS SPECIFIED

5. Plumbing Fixtures

		Whirlpool
All Bathrooms	White	
	N/A	N/A <input type="radio"/> Yes <input checked="" type="radio"/> No
	N/A	
	N/A	Dishwasher Rough-In <input checked="" type="radio"/> Yes <input type="radio"/> No
	N/A	Waterline for Fridge <input checked="" type="radio"/> Yes <input type="radio"/> No
	N/A	

** Refer to Construction Summary

6. Trim Carpentry

Interior Doors	CARRARA SMOOTH
Interior Trim	8050 BB CASING WITH 7 1/4" BASEBOARD - COLONIAL
Door Handles	As Per Construction Specifications
Exterior Front Door Handle	As Per Construction Specifications

** Refer to Construction Summary

7. Other Flooring

Purchaser: Rabeya Absar HASHMI

Telephone Res. / Bus: /

Decor Advisor: Candace Forza

Lock Date: 15-Mar-18

Property: 156

Project: Lecco Ridge Developments Inc.

Model and Elevation: Juniper 9 Elev 2

Plan #: 20M-1184

7. Other Flooring		
Main Hall	STRIP-MIRAGE-RED OAK-CHARACTER-CASHMERE-TREASURE-5"	
Living Room	STRIP-MIRAGE-RED OAK-CHARACTER-CASHMERE-TREASURE-5"	
Dining Room	STRIP-MIRAGE-RED OAK-CHARACTER-CASHMERE-TREASURE-5"	
Family Room	STRIP-MIRAGE-RED OAK-CHARACTER-CASHMERE-TREASURE-5"	
Den / Library / Study	STRIP-MIRAGE-RED OAK-CHARACTER-CASHMERE-TREASURE-5"	
Basement Landing(If Applies)	N/A	
Lower Landing (If Applies)	STRIP-MIRAGE-RED OAK-CHARACTER-CASHMERE-TREASURE-5"	
Upper Landing	STRIP-MIRAGE-RED OAK-CHARACTER-CASHMERE-TREASURE-5"	
Upper Hall	STRIP-MIRAGE-RED OAK-CHARACTER-CASHMERE-TREASURE-5"	
Master Bedroom	LAMINATE-LEXINGTON - HAZELWOOD OAK TL21016 - M	
Bedroom #2	LAMINATE-LEXINGTON - HAZELWOOD OAK TL21016 - M	
Bedroom #3	LAMINATE-LEXINGTON - HAZELWOOD OAK TL21016 - M	
Bedroom #4	LAMINATE-LEXINGTON - HAZELWOOD OAK TL21016 - M	
Bedroom #5	LAMINATE-LEXINGTON - HAZELWOOD OAK TL21016 - M	
	N/A	
	N/A	
	N/A	
Underpad	Type	Area
	N/A	N/A

** Refer to Construction Summary

8. Railings and Pickets

Railing Type	V-GROOVE	Colour	MIRAGE TREASURE
Picket Type	EUROLINE 1	Colour	BLACK
Stringer / Riser	As Per Construction Specifications	Colour	MIRAGE TREASURE
Treads	As Per Construction Specifications	Colour	MIRAGE TREASURE
Red Oak Stairs with Semi Gloss Finish		<input checked="" type="radio"/> Yes	<input type="radio"/> No

** Refer to Construction Summary

9. Wall Paint Flat Finish

Main & Upper Hall	22 WARM GREY	Master Bedroom	22 WARM GREY
Living Room	22 WARM GREY	Bedroom #2	22 WARM GREY
Dining Room	22 WARM GREY	Bedroom #3	22 WARM GREY
Kitchen / Breakfast	22 WARM GREY	Bedroom #4	22 WARM GREY
Family Room	22 WARM GREY	Bedroom #5	22 WARM GREY
Powder Room	22 WARM GREY	Master Ensuite	22 WARM GREY
Laundry Room	22 WARM GREY	Ensuite Bath - Bedroom 2/3	22 WARM GREY
Den/Library	22 WARM GREY	Ensuite Bath - Bedroom 4	22 WARM GREY
Trim Paint-Semi Gloss	BIRCH WHITE	Ensuite Bath - Bedroom 5	22 WARM GREY
	N/A		N/A
	N/A		N/A
Smooth Ceilings First Floor	<input checked="" type="radio"/> Yes		<input type="radio"/> No

** Refer to Construction Summary

Purchaser: Rabeya Absar HASHMI

Property: 156

Telephone Res. / Bus: /

Project: Lecco Ridge Developments Inc.

Decor Advisor: Candace Forza

Model and Elevation: Juniper 9 Elev 2

Lock Date: 15-Mar-18

15-Mar-18

Plan #: 20M-1184

10. Plaster Mouldings and Medallions

Entrance Vestibule	N/A	N/A	Kitchen/Breakfast	N/A	N/A
Main Hall	N/A	N/A	Den/Library	N/A	N/A
Living Room	N/A	N/A	Lower Landing	N/A	N/A
Dining Room	N/A	N/A		N/A	N/A
Family Room	N/A	N/A			

** Refer to Construction Summary

11. Fireplace

	Living Room			Family Room			Other Room - Specify		
	Purchased	As Per Plan	N/A	Purchased	As Per Plan	N/A	Purchased	As Per Plan	N/A
	<input type="radio"/>	<input type="radio"/>	<input checked="" type="radio"/>	<input type="radio"/>	<input checked="" type="radio"/>	<input type="radio"/>	<input type="radio"/>	<input type="radio"/>	<input checked="" type="radio"/>
Fireplace Type	N/A			FLAT ON WALL			N/A		
Mantle Type	N/A			MANTLE M6			N/A		
Colour / Stain	N/A			AS PER CONSTRUCTION SPECIFICATIONS			N/A		
Surround	N/A			GRIGIO CARNICO			N/A		
Hearth	N/A			NO			N/A		

** Refer to Construction Summary

12. Heating and Air Conditioning

Air Conditioning	NO	Gas Provisions Stove	YES
Gas Provisions Dryer	NO	Gas Provisions Barbecue	NO
Comment			

** Refer to Construction Summary

13. Electrical

Plugs and Switches	<input checked="" type="radio"/> White	DECOR	Above Kitchen Cabinet Light	<input type="radio"/> Yes	<input checked="" type="radio"/> No
Hood Fan	STANDARD WHITE		Below Kitchen Cabinet Light	<input type="radio"/> Yes	<input checked="" type="radio"/> No
Appliances	Built in Cooktop	Built in Oven	Gas Stove	Microwave	
	<input type="radio"/> Yes <input checked="" type="radio"/> No	<input type="radio"/> Yes <input checked="" type="radio"/> No	<input checked="" type="radio"/> Yes <input type="radio"/> No	<input type="radio"/> Yes <input checked="" type="radio"/> No	<input checked="" type="radio"/> No
Dishwasher Rough-in	Yes				

** Refer to Construction Summary

14. General Comments

** Refer to Construction Summary

Disclaimers and Notes

- 1) Colours of all materials are as close as possible to builder's selection, but not necessarily identical due to variances in manufacturing.
- 2) Any extras listed above are null and void unless accompanied by a separate invoice/amendment. Said invoice must be paid in full.
- 3) The Purchaser agrees that this colour selection is final and that no changes will be permitted, unless required by the Vendor.
- 4) The Purchaser acknowledges reading and accepting document which contains other miscellaneous disclaimers.

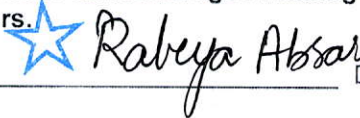
Signature: 

Date: March 15 '2018

3-1/2" MDF Casing #80871:

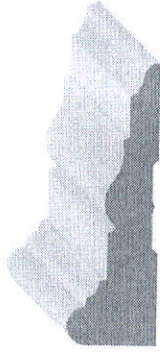

7-1/4" MDF Colonial
Baseboard :



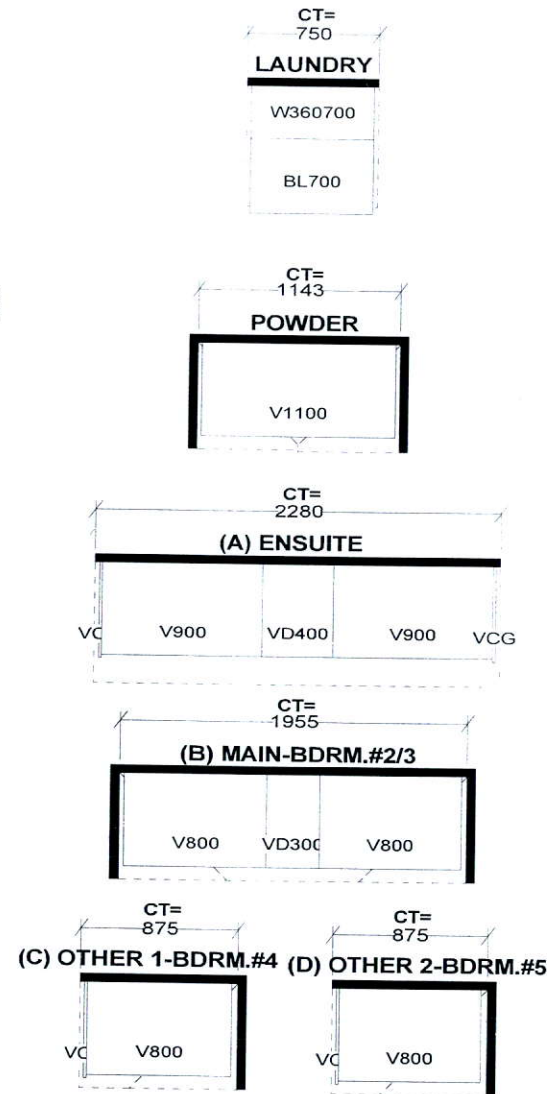

- Raise Vanity Heights to 36"

Plug Provision

JOB NUMBER:
BUILDER: GREENPARK HOMES
SITE NAME: LECCO RIDGE, Milton
MODEL: JUNIPER 9X ELEV 1,2,3
LOT #:
DESIGNER: KS
DATE: FEB 13 17

