

CONSTRUCTION SUMMARY
Saddle Ridge (G) - Lecco Ridge Developments Inc.



PURCHASER: NABEEL KHAN

TEL:

LOT / PHASE	REG. PLAN #	HOUSE TYPE		
Block 345 TH 4 / 1	20M-1184	Ivy 4 Elev 3		

CABINETRY ACCESSORIES

1 - KITCHEN CABINETY BASE - POT/PAN DRAWERS (CABINET) - STANDARD 05Mar18 Note:	
1 - ACCESSORY - GLASS DOOR - BEVELED - FINISHED INTERIOR - FITS TALL UPPER CABINETS - PRICE IS PER DOOR - STANDARD 05Mar18 Note:	
1 - KITCHEN CABINETY UPPER - ANGLED CORNER CABINET - FITS TALL UPPER CABINETS - PER UNIT - STANDARD 05Mar18 Note:	
1 - KITCHEN CABINETY UPPER - FULL DEPTH ABOVE FRIDGE - WITH GABLES - 600MM - PRICE IS EACH - STANDARD 05Mar18 Note:	
1 - KITCHEN CABINETY BASE - PIE CUT CORNER CABINET - BASE CABINETY - STANDARD 05Mar18 Note:	

PLUMBING

1 - WASHROOM - 3 PIECE ROUGH-IN IN BASEMENT 13Feb17 Note:	
--	--

PROMOTIONAL

1 - PURCHASER FOREFITS REMIANDER OF UPGRADE BONUS 05Mar18 Note:	
1 - LESS CREDIT FROM PURCHASER EXTRA SHEET IN OFFER 05Mar18 Note:	
1 - PARTIAL REDEMPTION OF PROMOTIONAL PACKAGE \$\$\$\$\$\$ BALANCE FORWARD TO BE USED AT A LATER DATE. ORIGINAL PROMOTIONAL PACKAGE OF \$\$\$\$ AS PER SCHEDULE PE DATED MMMDDYYYY. 13Feb17 Note: ORIGINAL PROMOTIONAL PACKAGE \$5,000.00 BALANCE FORWARD \$4,360.00	

STAIRS AND RAILINGS

1 - STAINED STAIRS, RAILING AND PICKETS – STANDARD STAIRCASE - PRICE IS PER SET 05Mar18 Note:	
--	--

EXTRAS AS PER OFFER

The Vendor agrees that notwithstanding any other term or provision in this Agreement included in the Purchase Price and in addition to those items detailed in Schedule GP to the Agreement of Purchase and Sale, the Purchaser is entitled to a credit of Fiv Worksheet Note:	
Five (5) White Appliances as per PE Appliances Worksheet Note:	
The Purchaser acknowledges that the Purchase Price is inclusive of all credits and promotional packages available at the time of purchase. Worksheet Note:	

This Document is Extremely Time Sensitive - Printed 5 Mar 18 at 15:04

RECEIVED MAR 07 2018

Purchaser: NABEEL KHAN

Property: Block 345 TH 4

Telephone Res. / Bus: /

Project: Lecco Ridge Developments Inc.

Decor Advisor: Natalie Mancuso

Model and Elevation: Ivy 4 Elev 3

Lock Date: 5-Mar-18

5-Mar-18

Plan #: 20M-1184

Layout Changes: ☐ Yes ☒ No

Sketch Attached: ☒ Yes ☐ No

Exterior Colour Scheme:

1. Cabinetry

	Style and Colour	Hardware
Kitchen / Breakfast	EVEREST WHITE	2002
Laundry Room	ELISSE	Standard
Powder Room	MODENA WHITE	1001
Master Ensuite Bathroom	MODENA WHITE	1001
Main Bathroom	MODENA WHITE	1001

Appliances:

Built In Appliances ☐ Yes ☒ No

Slide In Stove ☐ Yes ☒ No

Dishwasher Cabinet

☐ Closed ☒ Open

41" Upper Cabinets ☒ Yes ☐ No

Please NOTE: Standard Cabinet Height is 30"

Stove Opening

NOTE: If not specified, opening will be set to builder's standard opening of approximately 30" width

Fridge Opening

NOTE: If not specified, opening will be set to builder's standard opening of approximately 37" width x 74" height

** Refer to Construction Summary

2. Counters

	Counter	Edge
Kitchen / Breakfast	LAMINATE-CARRARA BIANCO 6696-46	
Laundry Room	N/A	
Powder Room	LAMINATE-WHITE CARRARA 4924-38	
Master Ensuite Bathroom	LAMINATE-CALCUTTA MARBLE 4925K-07	
Main Bathroom	LAMINATE-CALCUTTA MARBLE 4925K-07	

** Refer to Construction Summary

Purchaser: NABEEL KHAN
Telephone Res. / Bus: /
Decor Advisor: Natalie Mancuso
Lock Date: 5-Mar-18

Property: Block 345 TH 4
Project: Lecco Ridge Developments Inc.
Model and Elevation: Ivy 4 Elev 3
Plan #: 20M-1184

3. Ceramic Flooring

Entrance Vestibule	TILE- RAINBOW WHITE 13X13	At a 45 Threshold-If App.	
Main Hall	LAMINATE	<input type="checkbox"/>	METAL STRIP THROUGHOUT
Kitchen / Breakfast	TILE- RAINBOW WHITE 13X13	<input type="checkbox"/>	
Laundry Room	TILE- RAINBOW WHITE 13X13	<input type="checkbox"/>	
Powder Room	TILE- RAINBOW WHITE 13X13	<input type="checkbox"/>	
Master Ensuite Bathroom	TILE- BEACH LIGHT GREY 13X13	<input type="checkbox"/>	
Main Bathroom	TILE- RAINBOW WHITE 13X13	<input type="checkbox"/>	
		<input type="checkbox"/>	
		<input type="checkbox"/>	
		<input type="checkbox"/>	
		<input type="checkbox"/>	

** Refer to Construction Summary

4. Ceramic Wall Tile

Master Ensuite Bathroom	Selection	Describe
Tub Deck Wall	TILE- NATURALE GRIGIO 8X10	
Tub Deck		
Tub Deck Skirt		
Shower Stall	TILE- NATURALE GRIGIO 8X10	
Bathtub Enclosure Walls		
Main Bathroom	TILE- GOLF GRIGIO 8X10	
Kitchen Backsplash		

** Refer to Construction Summary - STANDARD GROUT THROUGHOUT UNLESS SPECIFIED

5. Plumbing Fixtures

All Bathrooms

White

Whirlpool

☐ Yes ☒ No

Dishwasher Rough-In

☒ Yes ☐ No

Waterline for Fridge

☐ Yes ☒ No

** Refer to Construction Summary

6. Trim Carpentry

Interior Doors	CLERMONT
Interior Trim	2 3/4" CASING WITH 4 1/4" BASEBOARD - COLONIAL
Door Handles	As Per Construction Specifications
Exterior Front Door Handle	As Per Construction Specifications

** Refer to Construction Summary

Initial: 

Purchaser: NABEEL KHAN

Property: Block 345 TH 4

Telephone Res. / Bus: /

Project: Lecco Ridge Developments Inc.

Decor Advisor: Natalie Mancuso

Model and Elevation: Ivy 4 Elev 3

Lock Date: 5-Mar-18

5-Mar-18

Plan #: 20M-1184

7. Other Flooring

Main Hall	LAMINATE-PARK LANE - HERITAGE OAK TL-U1386	
Living Room	LAMINATE-PARK LANE - HERITAGE OAK TL-U1386	
Dining Room	LAMINATE-PARK LANE - HERITAGE OAK TL-U1386	
Family Room	LAMINATE-PARK LANE - HERITAGE OAK TL-U1386	
Den / Library / Study		
Basement Landing(If Applies)		
Lower Landing (If Applies)	TILE- RAINBOW WHITE 13X13	
Upper Landing	LAMINATE-PARK LANE - HERITAGE OAK TL-U1386	
Upper Hall	CARPET-SHAW - E0949 NEWBERN CLASSIC - MORNING FOG 00530	
Master Bedroom	CARPET-SHAW - E0949 NEWBERN CLASSIC - MORNING FOG 00530	
Bedroom #2	CARPET-SHAW - E0949 NEWBERN CLASSIC - MORNING FOG 00530	
Bedroom #3	CARPET-SHAW - E0949 NEWBERN CLASSIC - MORNING FOG 00530	
Bedroom #4		
Bedroom #5		
Underpad	Type STANDARD	Area

** Refer to Construction Summary

8. Railings and Pickets

Railing Type	AS PER CONSTRUCTION SPECIFICATIONS	Colour	TORLYS- HERITAGE OAK
Picket Type	1 5/16 PICKETS SQUARE CHAMFERED	Colour	TORLYS- HERITAGE OAK
Stringer / Riser	As Per Construction Specifications	Colour	TORLYS- HERITAGE OAK
Treads	Standard	Colour	TORLYS- HERITAGE OAK
Red Oak Stairs with Semi Gloss Finish		<input checked="" type="radio"/> Yes <input type="radio"/> No	

** Refer to Construction Summary

9. Wall Paint Flat Finish

Main & Upper Hall	22 WARM GREY	Master Bedroom	22 WARM GREY
Living Room	22 WARM GREY	Bedroom #2	22 WARM GREY
Dining Room	22 WARM GREY	Bedroom #3	22 WARM GREY
Kitchen / Breakfast	22 WARM GREY	Bedroom #4	
Family Room	22 WARM GREY	Bedroom #5	
Powder Room	22 WARM GREY	Master Ensuite	22 WARM GREY
Laundry Room	22 WARM GREY	Main Bathroom	22 WARM GREY
Den/Library			
Trim Paint-Semi Gloss	BIRCH WHITE		

Smooth Ceilings First Floor ☐ Yes ☒ No

** Refer to Construction Summary



Initial: _____

Purchaser: NABEEL KHAN

Property: Block 345 TH 4

Telephone Res. / Bus: /

Project: Lecco Ridge Developments Inc.

Decor Advisor: Natalie Mancuso

Model and Elevation: Ivy 4 Elev 3

Lock Date: 5-Mar-18

5-Mar-18

Plan #: 20M-1184

10. Plaster Mouldings and Medallions

Entrance Vestibule

Main Hall

Living Room

Dining Room

Family Room

Kitchen/Breakfast

Den/Library

Lower Landing

** Refer to Construction Summary

11. Fireplace

Living Room

Purchased

As Per Plan

N/A

Family Room

Purchased

As Per Plan

N/A

Other Room - Specify

Purchased

As Per Plan

N/A

Fireplace Type

Mantle Type

Colour / Stain

Surround

Hearth

** Refer to Construction Summary

12. Heating and Air Conditioning

Air Conditioning

NO

Gas Provisions Stove

NO

Gas Provisions Dryer

NO

Gas Provisions Barbecue

NO

Comment

** Refer to Construction Summary

13. Electrical

Plugs and Switches

● White

DECOR

Hood Fan

STANDARD WHITE

Appliances

Built in Cooktop

○ Yes

● No

Built in Oven

○ Yes

● No

Gas Stove

○ Yes

● No

Microwave

○ Yes

● No

Dishwasher Rough-in Yes

** Refer to Construction Summary

14. General Comments

** Refer to Construction Summary

Disclaimers and Notes

- Colours of all materials are as close as possible to builder's selection, but not necessarily identical due to variances in manufacturing.
- Any extras listed above are null and void unless accompanied by a separate invoice/amendment. Said invoice must be paid in full.
- The Purchaser agrees that this colour selection is final and that no changes will be permitted, unless required by the Vendor.
- The Purchaser acknowledges reading and accepting document which contains other miscellaneous disclaimers.

Signature: Date: March 5, 2018

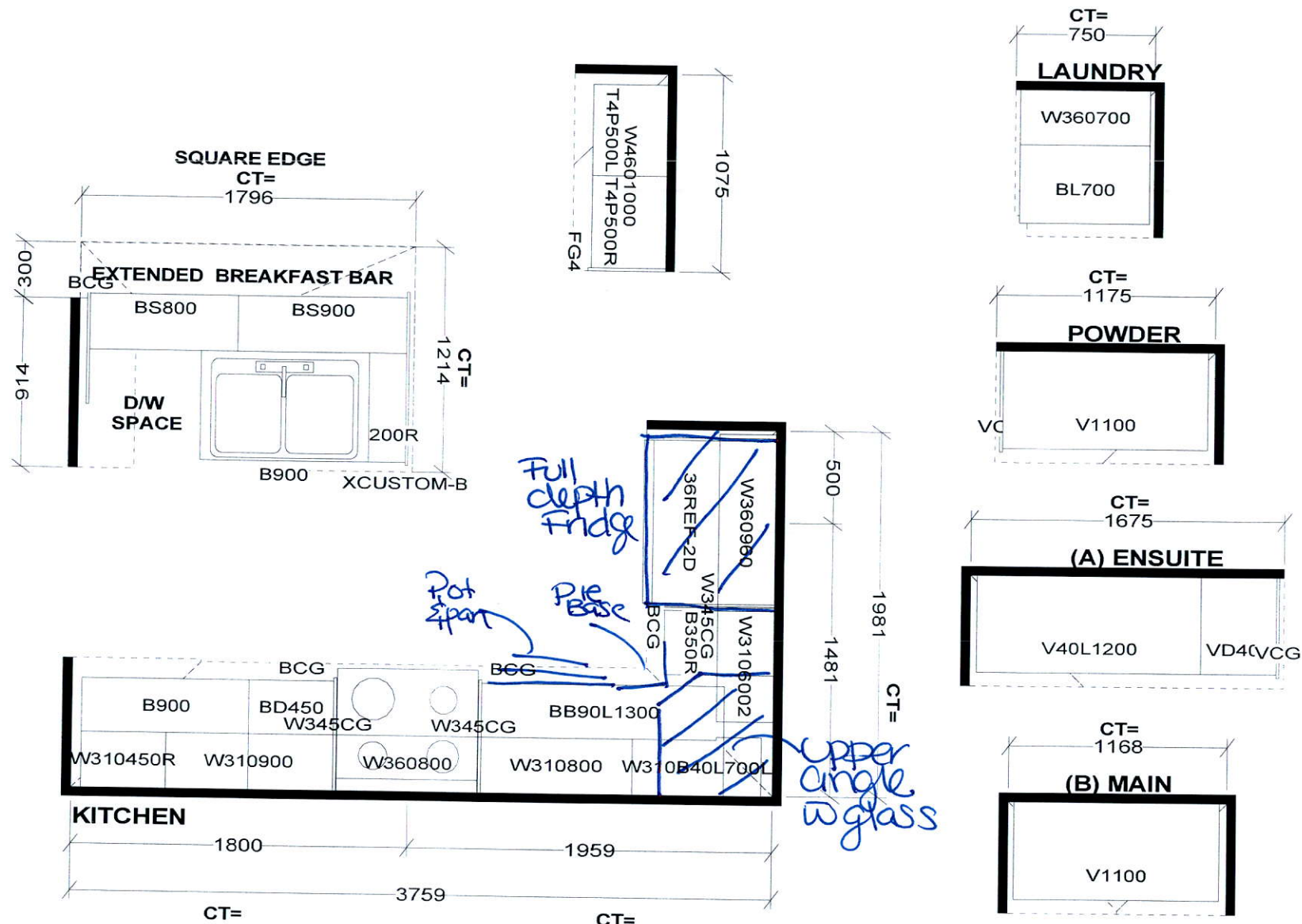

Selba Industries

STANDARD FEATURES:
9' CEILINGS WITH D/C BOX
1040MM HIGH UPPER CABINETS
DISHWASHER SPACE
DUMMY DOORS ON EXPOSED BACKS
LAMINATE KITCHEN & VANITY COUNTERTOPS

This drawing is the intellectual property of SELBA INDUSTRIES INC. and is an original design which must not be released or copied unless applicable fee has been paid or job order placed.



JOB NUMBER:
BUILDER: GREENPARK HOMES
SITE NAME: LECCO RIDGE, Milton
MODEL: IVY 4X ELEV 1, 1A, 2, 3
LOT #:
DESIGNER: KS
DATE: FEB 13 17

IVY 4

1,846 SQ.FT.

AVAILABLE IN BLOCK: 323, 326, 327, 328, 330, 331,
333, 336, 337, 343, 344, 345, 346, 348 & 349

345 TH4

