



CONSTRUCTION SUMMARY

Saddle Ridge (G) - Lecco Ridge Developments Inc.

PURCHASERS: Remon S HANNA and Lilianne HANNA

TEL:

LOT / PHASE 243 / 1	REG. PLAN # 20M-1184	HOUSE TYPE Juniper 7 Elev 2		
------------------------	-------------------------	--------------------------------	--	--

CABINETRY

1 - KITCHEN - UPGRADE 1 HARDWARE 06Oct17 Note:	
1 - VANITIES - MONACO CABINETRY STAIN WITH UPGRADE STAIN - PRICE IS FOR ONE OR ALL BATHS - DETACHED 06Oct17 Note:	
1 - KITCHEN - LIGHT VALANCE 06Oct17 Note: LS2	
1 - KITCHEN - CROWN MOULDING WITH HEADER 06Oct17 Note: cm3	
1 - KITCHEN - MINI STACKED UPPER CABINETRY - INCLUDES ABOVE CHIMNEY HOOD 06Oct17 Note:	
1 - KITCHEN - UPGRADE 3 CABINETRY 06Oct17 Note:	

CABINETRY ACCESSORIES

1 - FOR CONFIRMATION PURPOSES - KITCHEN - INSTALL 2 HANDLES ON EACH POT DRAWER 06Oct17 Note:	
1 - CABINETRY FEE FOR FLUSH CUTOUT ON WALL OVEN/MICROWAVE COMBO CABINET ONLY 06Oct17 Note:	
1 - KITCHEN - ADD 3' OF CUSTOM UPPERS ABOVE DESK 06Oct17 Note:	
1 - KITCHEN - ADD 3' DESK WITH 2 TOP DRAWERS 06Oct17 Note:	
1 - KITCHEN - FULL DEPTH PANTRY - 24" DEEP 06Oct17 Note:	
1 - KITCHEN - FULL DEPTH FRIDGE UPPER WITH GABLE - 24" DEEP 06Oct17 Note:	
1 - KITCHEN - BUILT-IN MICRO/OVEN CABINETRY PROVISIONS 06Oct17 Note:	
1 - KITCHEN - COOKTOP CABINETRY PROVISIONS 06Oct17 Note:	
2 - KITCHEN - PULL-OUT SPICE RACK 06Oct17 Note:	
4 - KITCHEN - POT AND PAN DRAWERS 06Oct17 Note:	
1 - KITCHEN - 4-BIN PULL-OUT RECYCLE CENTRE 06Oct17 Note:	
1 - KITCHEN- PIE CUT BASE CORNER CABINET 06Oct17 Note:	
1 - KITCHEN - ADD 2 FEET OF UPPER AND BASE CABINETRY ON SINK CABINETRY RUN 06Oct17 Note:	
1 - KITCHEN - HORIZONTAL WINE RACK 06Oct17 Note:	

CONSTRUCTION SUMMARY

Saddle Ridge (G) - Lecco Ridge Developments Inc.

PURCHASERS: Remon S HANNA and Lilianne HANNA

TEL:

LOT / PHASE 243 / 1	REG. PLAN # 20M-1184	HOUSE TYPE Juniper 7 Elev 2		
------------------------	-------------------------	--------------------------------	--	--

1 - KITCHEN - LARGE WINDOW VALANCE DECOR #4
06Oct17 Note:

1 - KITCHEN - ANGLED UPPER CORNER CABINET
06Oct17 Note:

CERAMIC TILE

1 - THROUGHOUT - LAY TILES WITH TIGHT JOINTS
06Oct17 Note:

1 - TILE - UPGRADE 2 WALL TILE - - ENSUITE WALL TILE - SHOWER
06Oct17 Note:

1 - TILE - UPGRADE 2 FLOOR TILE - - ENSUITE BATHROOM - FLOOR
06Oct17 Note:

1 - TILE - UPGRADE 1 FLOOR TILE - - BATHROOM 3/4 - FLOOR
06Oct17 Note:

1 - TILE - UPGRADE 1 FLOOR TILE - - BATHROOM 2 - FLOOR
06Oct17 Note:

1 - DELETE ALL CERAMIC BATHROOM ACCESSORIES
06Oct17 Note:

1 - TILE - UPGRADE 5 FLOOR TILE - - SIDE HALL
06Oct17 Note: MUD ROOM

1 - TILE - UPGRADE 5 FLOOR TILE - - POWDER ROOM
06Oct17 Note:

1 - TILE - UPGRADE 5 FLOOR TILE - - KITCHEN
06Oct17 Note:

1 - TILE - UPGRADE 5 FLOOR TILE - - FOYER AND MAIN HALL
06Oct17 Note:

CONSTRUCTION

1 - SMOOTH CEILINGS ON FIRST FLOOR ONLY
23Jun17 Note:

1 - KITCHEN - DELETE BULKHEAD - IF CONSTRUCTION PERMITS
23Jun17 Note:

1 - FAMILY ROOM - WAFFLE CEILING - 9 BOXES - SMOOTH FINISH
23Jun17 Note: waffle by Update Precast Moulding

1 - PLEASE NOTE THAT NO FURTHER STRUCTURAL CHANGES WILL BE PERMITTED.
09Dec16 Note:

1 - FIRST FLOOR INCREASE CEILING HEIGHT FROM 9 FEET TO 10 FEET
09Dec16 Note: The ceiling height is measured from the top of the unfinished subfloor to underside of the unfinished ceiling above before finishes and excluding bulkheads and drop ceilings as per plan.

DOORS AND TRIM

1 - THROUGHOUT - CARRARA SMOOTH INTERIOR DOORS
06Oct17 Note:

ELECTRICAL

1 - PLUG - 240V ELECTRICAL PLUG IN GARAGE FOR FUTURE ELECTRIC CAR - 50 AMP
02Mar18 Note:

RECEIVED MAR 07 2018

NEW



CONSTRUCTION SUMMARY

Saddle Ridge (G) - Lecco Ridge Developments Inc.

PURCHASERS: Remon S HANNA and Lilianne HANNA

TEL:

LOT / PHASE 243 / 1	REG. PLAN # 20M-1184	HOUSE TYPE Juniper 7 Elev 2		
------------------------	-------------------------	--------------------------------	--	--

1 - ***DELETE PAYMENT FOR DECOR SWITCHES - STANDARD AS PER OFFER
18Oct17 Note:

2 - ***DELETE - 2 PUCK LIGHTS FOR DESK***
16Oct17 Note:

1 - KITCHEN - COMPLETE FLORESCENT LIGHTING FOR LIGHT VALANCE
06Oct17 Note:

1 - PLUG - ELECTRICAL PLUG
23Jun17 Note: KITCHEN - INSTALL PLUG UNDER SINK

2 - POT LIGHT - HOCKEY PUCK
23Jun17 Note: KITCHEN - BELOW OPEN SHELVES ABOVE DESK

1 - BUILT IN OVEN AND COOKTOP PROVISION - PROVISION ONLY - ELECTRICAL ONLY
23Jun17 Note:

1 - PLUG - ELECTRICAL PLUG - TO BE INSTALLED OVER FIREPLACE
23Jun17 Note:

2 - KITCHEN - DIMMER SWITCHES FOR POTLIGHTS ONLY
23Jun17 Note:

9 - POT LIGHT - LOW VOLTAGE LED - FIRST FLOOR INSTALLATION
23Jun17 Note: KITCHEN - WIRED TO 2 SEPERATE SWITCHES

1 - RELOCATE STANDARD KITCHEN LIGHT TO BE CENTERED OVER ISLAND
23Jun17 Note:

2 - LIVING/DINING ROOM - DIMMER SWITCH
23Jun17 Note:

6 - POT LIGHT - LOW VOLTAGE LED - FIRST FLOOR INSTALLATION
23Jun17 Note: LIVING/DINING ROOM - WIRED TO A SEPERATE SWITCH FROM STANDARD LIGHT

1 - STANDARD DINING ROOM LIGHT TO BE CENTERED BETWEEN LIVING AND DINING ROOM
23Jun17 Note:

1 - FAMILY ROOM - DIMMER SWITCH FOR POTLIGHTS
23Jun17 Note:

8 - POT LIGHT - LOW VOLTAGE LED - FIRST FLOOR INSTALLATION
23Jun17 Note: FAMILY ROOM - LED - WIRED TO SEPERATE SWITCH FROM STANDARD LIGHT

1 - PLUG - ELECTRICAL PLUG WITH GFI AND SWITCH - FOR FESTIVE LIGHTING
23Jun17 Note:

1 - DÉCOR SWITCHES AND PLUGS (THROUGHOUT HOUSE)
23Jun17 Note:

1 - 200 AMP ELECTRICAL SERVICE
23Jun17 Note:

FIREPLACE AND ACCESSORIES

1 - GAS LINE ROUGH-IN FOR BARBECUE
23Jun17 Note:

HARDWOOD FLOORING

1 - FIRST FLOOR - STANDARD NON-TILED AREAS - 5" STAINED ETCHED ENGINEERED HARDWOOD FLOORING IN LIEU OF STANDARD AS PER OFFER
06Oct17 Note:

CONSTRUCTION SUMMARY

Saddle Ridge (G) - Lecco Ridge Developments Inc.

PURCHASERS: Remon S HANNA and Lilianne HANNA TEL:

LOT / PHASE	REG. PLAN #	HOUSE TYPE		
243 / 1	20M-1184	Juniper 7 Elev 2		

MIRRORS AND GLASS

1 - ***DELETE - MASTER ENSUITE BATHROOM - FRAMELESS GLASS SHOWER ENCLOSURE WITH D-RING AND TOWEL BAR*** 08Aug17 Note:	
1 - FRAMELESS GLASS SHOWER ENCLOSURE 23Jun17 Note: MASTER ENSUITE BATHROOM - CHROME D-RING AND TOWEL BAR Deleted	

MISCELLANEOUS

1 - FURTHER DISCOUNT AS PER VENDOR 06Oct17 Note:	
1 - FURTHER DISCOUNT AS PER VENDOR 06Oct17 Note:	

PLUMBING

1 - ALL BATHROOMS - MOEN MASON CHROME ACCESSORIES POWDER ROOM - TOWEL RING & TOILET PAPER HOLDER ENSUITE 3/4 & MASTER BATHROOMS - 24 " TOWEL BAR, TOWEL RING (X2) & TOILET PAPER HOLDER ENSUITE 2 BATHROOM - 24 " TOWEL BAR, TOWEL RING & TOILET PAPER HOLDER 06Oct17 Note:	
1 - POWDER ROOM - CONTRAC VIEIRA PEDESTAL SINK - #4390DHX / 4389DHX - STANDARD FAUCET 06Oct17 Note:	
1 - WATER LINE FOR FRIDGE - ROUGH-IN ONLY 23Jun17 Note:	

PROMOTIONAL

1 - LESS CREDIT FROM PURCHASER EXTRA SHEET IN OFFER 23Jun17 Note:	
--	--

STAIRS AND RAILINGS

1 - UPPER HALL - ADD 3 POSTS TO STAIRCASE 06Oct17 Note:	
1 - V GROOVE HANDRAIL 06Oct17 Note: STAIRCASE	
1 - STAINED HANDRAIL - TREADS, RISERS AND STRINGER EXCLUDING PICKETS FIRST TO SECOND FLOOR - STANDARD STAIRCASE 06Oct17 Note:	
1 - EUROLINE 1 06Oct17 Note: STAIRCASE - IRON PICKETS - BLACK	

EXTRAS AS PER OFFER

The Vendor agrees that notwithstanding any other term or provision in this Agreement included in the Purchase Price and in addition to those items detailed in Schedule GP to the Agreement of Purchase and Sale, the Purchaser is entitled to a credit of Ten Worksheet Note:	
The Purchaser acknowledges that the Purchase Price is inclusive of all credits and promotional packages available at the time of purchase. Worksheet Note:	

Purchasers: Remon S HANNA & Lilianne HANNA

Property: 243

Telephone Res. / Bus: /

Project: Lecco Ridge Developments Inc.

Decor Advisor: Candace Forza

Model and Elevation: Juniper 7 Elev 2

Lock Date: 6-Oct-17

6-Oct-17

Plan #: 20M-1184

Layout Changes: ☒ Yes ☐ No

Sketch Attached: ☒ Yes ☐ No

Exterior Colour Scheme:

1. Cabinetry

	Style and Colour	Hardware
Kitchen / Breakfast	BANCROFT W823XZ3	428SB
Laundry Room	ELISSE	Standard
Powder Room	PEDESTAL	N/A
Master Ensuite Bathroom	MONACO W823XZ4	2002
Ensuite Bath - Bedroom 2	MONACO W821XZ4	2002
Ensuite Bath - Bedroom 3/4	MONACO W821XZ4	2002
	N/A	N/A
	N/A	N/A
	N/A	N/A

Appliances:

Built In Appliances ☒ Yes ☐ No

Slide In Stove ☐ Yes ☒ No

Dishwasher Cabinet

☐ Closed ☒ Open

41" Upper Cabinets ☒ Yes ☐ No

Please NOTE: Standard Cabinet Height is 30"

Stove Opening

NOTE: If not specified, opening will be set to builder's standard opening of approximately 30" width

Fridge Opening

NOTE: If not specified, opening will be set to builder's standard opening of approximately 37" width x 74" height

** Refer to Construction Summary

2. Counters

	Counter	Edge
Kitchen / Breakfast	LAMINATE-WHITE CARRARA-4924-38	
Laundry Room	N/A	
Powder Room	N/A	
Master Ensuite Bathroom	LAMINATE-WHITE TIGRIS-4783-60	
Ensuite Bath - Bedroom 2	LAMINATE-INUKSHUK GREY-P344-LM	
Ensuite Bath - Bedroom 3/4	LAMINATE-INUKSHUK GREY-P344-LM	
	N/A	
	N/A	
	N/A	

** Refer to Construction Summary

Purchasers: Remon S HANNA & Lilianne HANNA

Property: 243

Telephone Res. / Bus: /

Project: Lecco Ridge Developments Inc.

Decor Advisor: Candace Forza

Model and Elevation: Juniper 7 Elev 2

Lock Date: 6-Oct-17

6-Oct-17

Plan #: 20M-1184

3. Ceramic Flooring

		At a 45	Threshold-If App.
Entrance Vestibule	TILE-GOTHA DIAMOND LUX-24X24	<input type="checkbox"/>	METAL STRIP
Main Hall	STRIP	<input type="checkbox"/>	
Kitchen / Breakfast	TILE-GOTHA DIAMOND LUX-24X24	<input type="checkbox"/>	METAL STRIP
Laundry Room	TILE-RAINBOW LIGHT GREY-13X13	<input type="checkbox"/>	METAL STRIP
Powder Room	TILE-GOTHA DIAMOND LUX-24X24	<input type="checkbox"/>	
Master Ensuite Bathroom	TILE-MARMANI BIANCO-12X24	<input type="checkbox"/>	METAL STRIP
Ensuite Bath - Bedroom 2	TILE-FM45GL001S GLOSSY WHITE-18X18	<input type="checkbox"/>	METAL STRIP
Ensuite Bath - Bedroom 3/4	TILE-FM45GL001S GLOSSY WHITE-18X18	<input type="checkbox"/>	METAL STRIP
	N/A	<input type="checkbox"/>	
	N/A	<input type="checkbox"/>	
	N/A	<input type="checkbox"/>	

** Refer to Construction Summary

4. Ceramic Wall Tile

Master Ensuite Bathroom	Selection	Describe
Tub Deck Wall	N/A	
Tub Deck	N/A	
Tub Deck Skirt	N/A	
Shower Stall	TILE-MARMANI BIANCO-12X24	***LAID HORIZONTALLY***
Bathtub Enclosure Walls	N/A	
	N/A	
Ensuite Bath - Bedroom 2	TILE-STARDUST BIANCO-8X16	***LAID HORIZONTALLY***
Ensuite Bath - Bedroom 3/4	TILE-STARDUST BIANCO-8X16	***LAID HORIZONTALLY***
	N/A	
	N/A	
Kitchen Backsplash	N/A	

** Refer to Construction Summary - STANDARD GROUT THROUGHOUT UNLESS SPECIFIED

5. Plumbing Fixtures

All Bathrooms

White

N/A

N/A

N/A

N/A

N/A

Whirlpool

N/A

☐ Yes ☒ No

Dishwasher Rough-In

☒ Yes ☐ No

Waterline for Fridge

☒ Yes ☐ No

** Refer to Construction Summary

6. Trim Carpentry

Interior Doors	CARRARA 2 PANEL - SMOOTH
Interior Trim	As Per Construction Specifications
Door Handles	SATIN CHROME LEVER
Exterior Front Door Handle	SATIN CHROME CHELSEA

** Refer to Construction Summary

Initials: 

Purchasers: Remon S HANNA & Lilianne HANNA

Property: 243

Telephone Res. / Bus: /

Project: Lecco Ridge Developments Inc.

Decor Advisor: Candace Forza

Model and Elevation: Juniper 7 Elev 2

Lock Date: 6-Oct-17

6-Oct-17

Plan #: 20M-1184

7. Other Flooring

Main Hall	STRIP-VINTAGE-NSS-MAPLE-ETCHED ESTATE-UV OIL-TAHITI05"
Living Room	STRIP-VINTAGE-NSS-MAPLE-ETCHED ESTATE-UV OIL-TAHITI05"
Dining Room	STRIP-VINTAGE-NSS-MAPLE-ETCHED ESTATE-UV OIL-TAHITI05"
Family Room	STRIP-VINTAGE-NSS-MAPLE-ETCHED ESTATE-UV OIL-TAHITI05"
Den / Library / Study	STRIP-VINTAGE-NSS-MAPLE-ETCHED ESTATE-UV OIL-TAHITI05"
Basement Landing(If Applies)	N/A
Lower Landing (If Applies)	N/A
Upper Landing	STRIP-VINTAGE-NSS-MAPLE-ETCHED ESTATE-UV OIL-TAHITI05"
Upper Hall	LAMINATE-TORLYS-PARK LANE-GREY VARNISHED OAK-TL-U1305
Master Bedroom	LAMINATE-TORLYS-PARK LANE-GREY VARNISHED OAK-TL-U1305
Bedroom #2	LAMINATE-TORLYS-PARK LANE-GREY VARNISHED OAK-TL-U1305
Bedroom #3	LAMINATE-TORLYS-PARK LANE-GREY VARNISHED OAK-TL-U1305
Bedroom #4	LAMINATE-TORLYS-PARK LANE-GREY VARNISHED OAK-TL-U1305
Bedroom #5	N/A
	N/A
	N/A
	N/A
Underpad	Type Area
	N/A N/A

** Refer to Construction Summary

8. Railings and Pickets

Railing Type	3 1/4 V-GROOVE	Colour	VINTAGE TAHITI
Picket Type	EURO LINE 1 BLACK	Colour	BLACK
Stringer / Riser	AS PER CONSTRUCTION SPECS	Colour	VINTAGE TAHITI
Treads	AS PER CONSTRUCTION SPECS	Colour	VINTAGE TAHITI
Red Oak Stairs with Semi Gloss Finish		<input checked="" type="radio"/> Yes <input type="radio"/> No	

** Refer to Construction Summary



9. Wall Paint Flat Finish

Main & Upper Hall	22 WARM GREY	Master Bedroom	22 WARM GREY
Living Room	22 WARM GREY	Bedroom #2	22 WARM GREY
Dining Room	22 WARM GREY	Bedroom #3	22 WARM GREY
Kitchen / Breakfast	22 WARM GREY	Bedroom #4	22 WARM GREY
Family Room	22 WARM GREY	Bedroom #5	N/A
Powder Room	22 WARM GREY	Master Ensuite	22 WARM GREY
Laundry Room	22 WARM GREY	Ensuite Bath - Bedroom 2	22 WARM GREY
Den/Library	22 WARM GREY	Ensuite Bath - Bedroom 3/4	22 WARM GREY
Trim Paint-Semi Gloss	BIRCH WHITE	MUD ROOM	22 WARM GREY
	N/A		N/A
	N/A		N/A

Smooth Ceilings First Floor ☒ Yes ☐ No

** Refer to Construction Summary

Initials:

Purchasers: Remon S HANNA & Lilianne HANNA

Telephone Res. / Bus: /

Decor Advisor: Candace Forza

Lock Date: 6-Oct-17

Property: 243

Project: Lecco Ridge Developments Inc.

Model and Elevation: Juniper 7 Elev 2

6-Oct-17

Plan #: 20M-1184

10. Plaster Mouldings and Medallions

Entrance Vestibule	N/A	N/A	Kitchen/Breakfast	N/A	N/A
Main Hall	N/A	N/A	Den/Library	N/A	N/A
Living Room	N/A	N/A	Lower Landing	N/A	N/A
Dining Room	N/A	N/A		N/A	N/A
Family Room	N/A	N/A			

** Refer to Construction Summary

11. Fireplace

	Living Room			Family Room			Other Room - Specify		
	Purchased	As Per Plan	N/A	Purchased	As Per Plan	N/A	Purchased	As Per Plan	N/A
Fireplace Type	<input type="radio"/>	<input type="radio"/>	<input checked="" type="radio"/>	<input type="radio"/>	<input checked="" type="radio"/>	<input type="radio"/>	<input type="radio"/>	<input type="radio"/>	<input checked="" type="radio"/>
Mantle Type	N/A			FLAT ON WALL			N/A		
Colour / Stain	N/A			MANTLE M2-STANDARD			N/A		
Surround	N/A			AS PER CONSTRUCTION SPECIFICATIONS			N/A		
Hearth	N/A			GRIGIO CARNICO			N/A		
	N/A			NO			N/A		

** Refer to Construction Summary

12. Heating and Air Conditioning

Air Conditioning	NO	Gas Provisions Stove	NO
Gas Provisions Dryer	NO	Gas Provisions Barbecue	YES
Comment			

** Refer to Construction Summary

13. Electrical

Plugs and Switches	<input checked="" type="radio"/> White	DECOR	Above Kitchen Cabinet Light	<input type="radio"/> Yes	<input checked="" type="radio"/> No
Hood Fan	STANDARD		Below Kitchen Cabinet Light	<input checked="" type="radio"/> Yes	<input type="radio"/> No
Appliances	Built in Cooktop	Built in Oven	Gas Stove	Microwave	
	<input checked="" type="radio"/> Yes <input type="radio"/> No	<input checked="" type="radio"/> Yes <input type="radio"/> No	<input type="radio"/> Yes <input checked="" type="radio"/> No	<input checked="" type="radio"/> Yes <input type="radio"/> No	
Dishwasher Rough-in	Yes				

** Refer to Construction Summary

14. General Comments

** Refer to Construction Summary

Disclaimers and Notes

- Colours of all materials are as close as possible to builder's selection, but not necessarily identical due to variances in manufacturing.
- Any extras listed above are null and void unless accompanied by a separate invoice/amendment. Said invoice must be paid in full.
- The Purchaser agrees that this colour selection is final and that no changes will be permitted, unless required by the Vendor.
- The Purchaser acknowledges reading and accepting document which contains other miscellaneous disclaimers.

Signature:  Date: 00+ 6/17 Signature:  Date: 00+ 6/17

SEP 15 17 FB
SEP 20 17 FB

LECCO 243
PROTOTYPE FOR EXTRAS

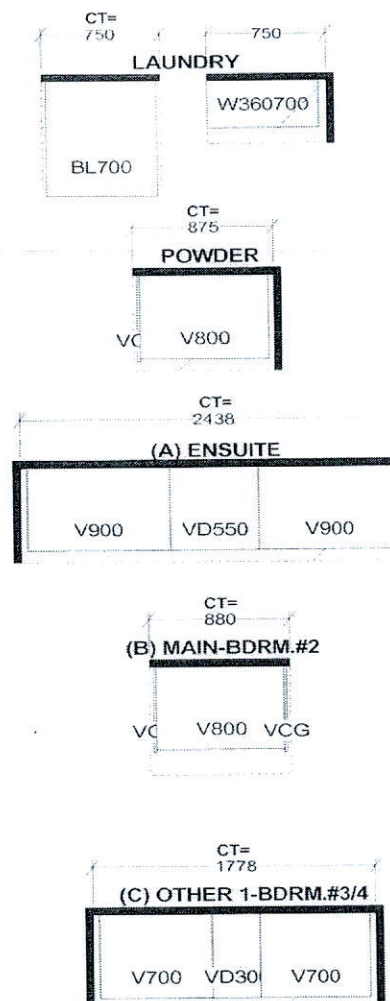

Add
mini Stacked
uppers
above Hood-

- CM-3 moulding.
- LS2-Valance.

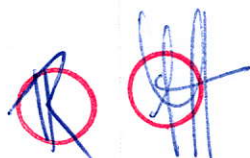

THIS IS NOT
A FINAL LAYOUT

* Fridge Is Not Built-In *

Selba Industries							
W WDT	W HGHT	W CNT	FL HGHT	DWY H	ST CENT	2X4	PARK BOX COVER
STANDARD FEATURES:				This drawing is the intellectual property of SELBA INDUSTRIES INC. and is an original design which must not be released or copied unless applicable fee has been paid to job order placed.	G H A B F E D	JOB NUMBER:	
9' CEILINGS WITH D/C BOX 1040MM HIGH UPPER CABINETS DISHWASHER SPACE DUMMY DOORS ON EXPOSED BACKS LAMINATE KITCHEN & VANITY COUNTERTOPS						BUILDER: GREENPARK HOMES SITE NAME: LECCO RIDGE, Milton MODEL: JUNIPER 7X ELEV 1.2 LOT #: 243 DESIGNER: KS DATE: FEB 13 17	

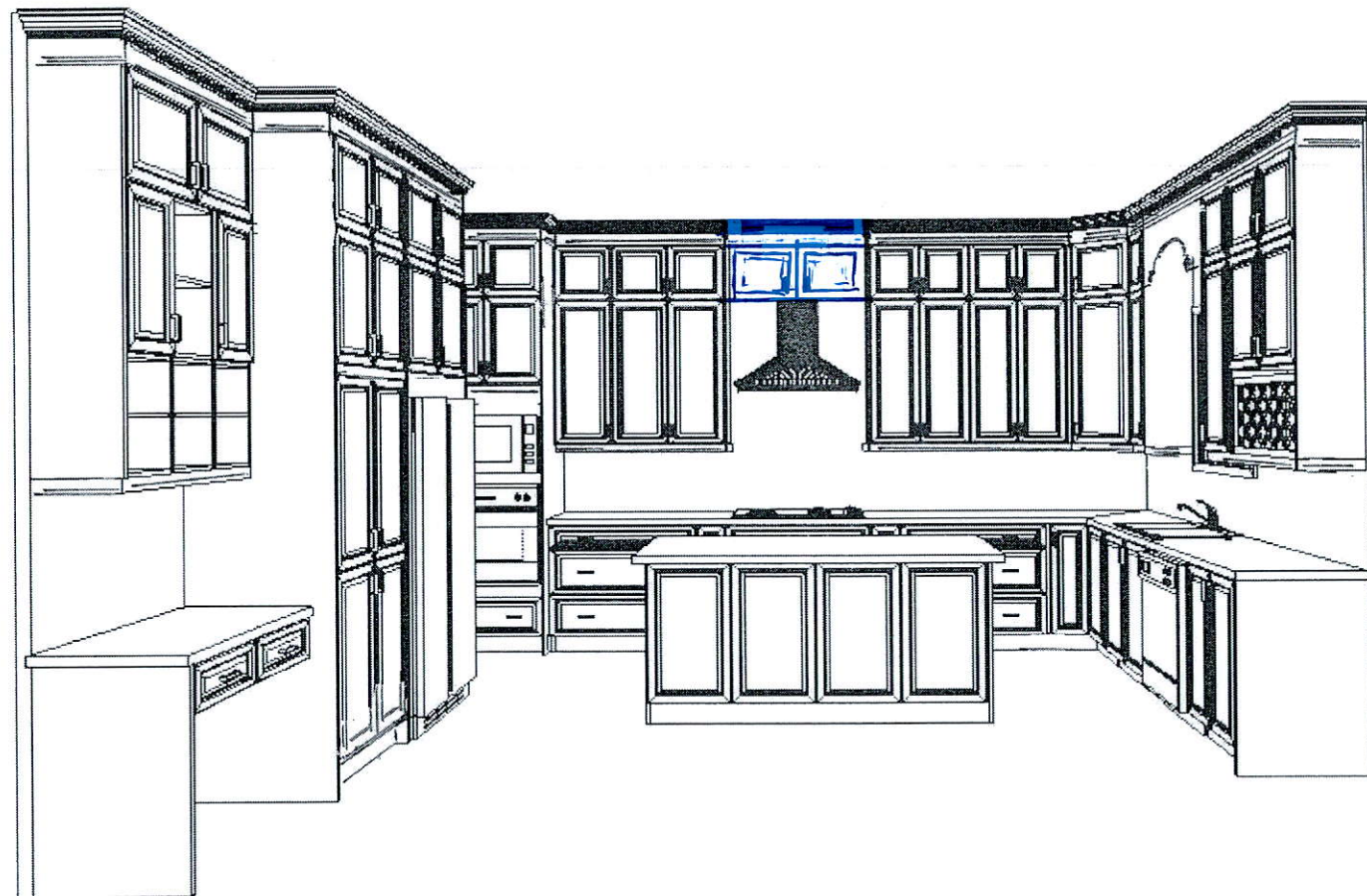

This drawing is the intellectual property of SELBA INDUSTRIES INC. and is an artistic interpretation of the general appearance of the design. It is not meant to be an exact rendition.



Designed: 9/15/2017
Printed: 9/20/2017

THIS IS NOT
A FINAL LAYOUT

LECCO 243.kit

LECCO 243.kit Drawing #: 1

CM3)

MINI STACKED
UPPERS

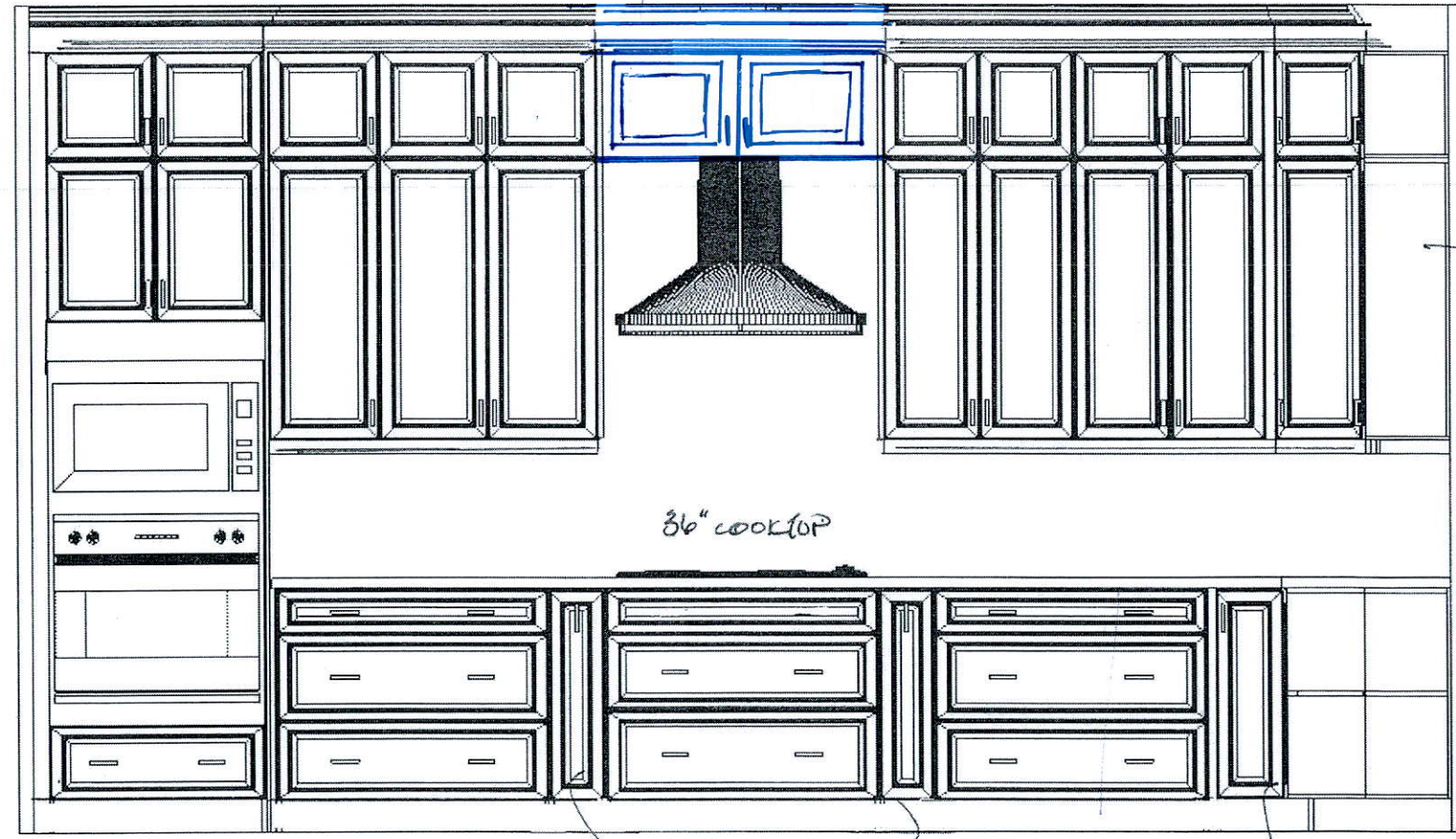

ANGLE
CORNER

36" COOKTOP

BUILT IN
OVEN/MICRO

SPICE PULL OUTS
x 2

DIE CUT
BASE

THIS IS NOT
A FINAL LAYOUT

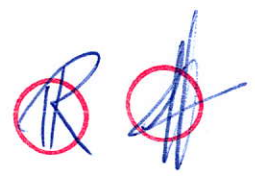

This drawing is the intellectual property of
SELBA INDUSTRIES INC. and is an
artistic interpretation of the general
appearance of the design. It is not meant to
be an exact rendition.



Designed: 9/15/2017
Printed: 9/20/2017

LECCO 243.kit

LECCO 243.kit Drawing #: 1

DECOR WINDOW
JALANEE X 4

ANGLE
CORNER
UPPER

MINI STACKED
UPPERS

WINE RACK

PIC CUT
BASE

THIS IS NOT
A FINAL LAYOUT

This drawing is the intellectual property of
SELBA INDUSTRIES INC. and is an
artistic interpretation of the general
appearance of the design. It is not meant to
be an exact rendition.

Selba

Kitchen + Bath Designs

Designed: 9/15/2017
Printed: 9/20/2017

LECCO 243.kit

LECCO 243.kit Drawing #: 1

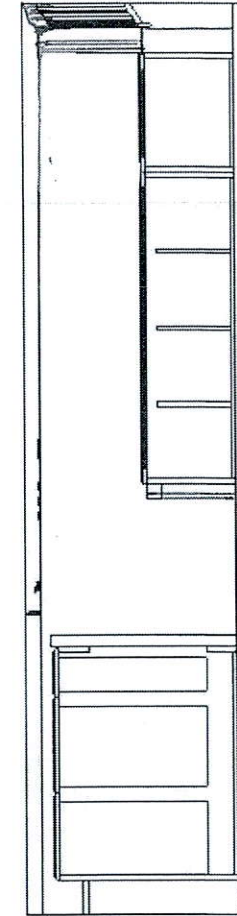
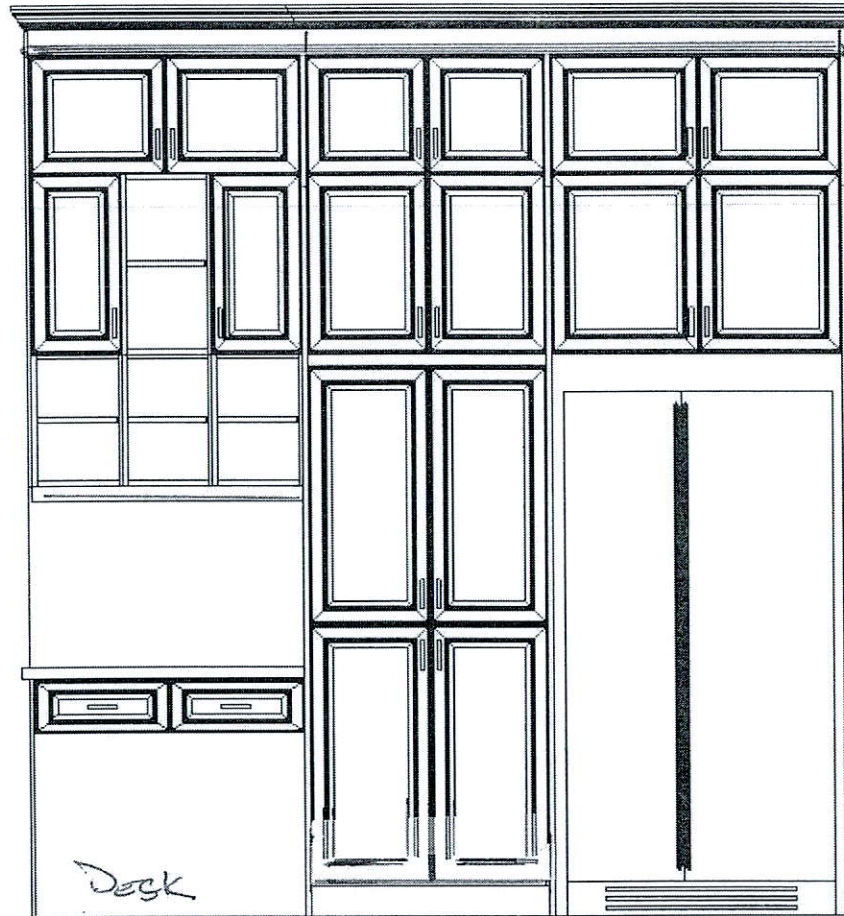

PANTRY STD. 36" REF

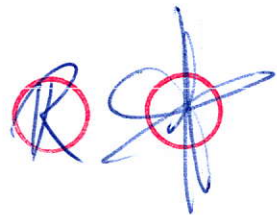

THIS IS NOT
A FINAL LAYOUT

This drawing is the intellectual property of SELBA INDUSTRIES INC. and is an artistic interpretation of the general appearance of the design. It is not meant to be an exact rendition.

Selba
Kitchen + Bath Designs

Designed: 9/15/2017
Printed: 9/20/2017

LECCO 243.kit

LECCO 243.kit Drawing #: 1

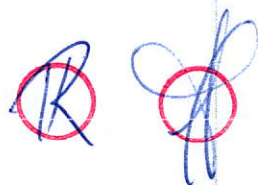
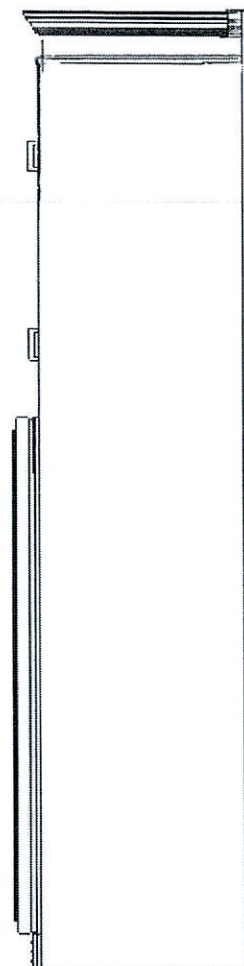
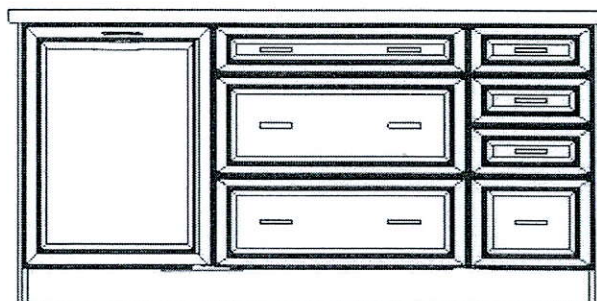
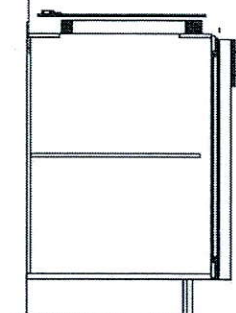
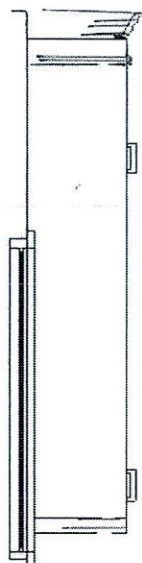

THIS IS NOT
A FINAL LAYOUT

4 BIN
WASTE
RECYCLE

POTS + PAN

BANK
DOORS

This drawing is the intellectual property of SELBA INDUSTRIES INC. and is an artistic interpretation of the general appearance of the design. It is not meant to be an exact rendition.

Selba
Kitchen + Bath Designs

Designed: 9/15/2017
Printed: 9/20/2017

LECCO 243.kit

LECCO 243.kit Drawing #: 1

KitchenAid® 27" (68.6 cm) and 30" (76.2 cm) Electric Built-In Microwave/Oven Combination

PRODUCT MODEL NUMBERS

KEMS309E

KOCE500E

KOCE507E

ELECTRICAL CONNECTION

If codes permit and a separate ground wire is used, it is recommended that a qualified electrical installer determine that the ground path and the wire gauge are in accordance with local codes. Check with a qualified electrical installer if you are not sure the oven is properly grounded.

This oven must be connected to a grounded metal, permanent wiring system.

Be sure that the electrical connection and wire size are adequate and in conformance with the National Electrical Code, ANSI/NFPA 70-latest edition or CSA Standards C22.1-94, Canadian Electrical Code, Part 1 and C22.2 No. O-M91-latest edition, and all local codes and ordinances.

To properly install your oven, you must determine the type of electrical connection you will be using and follow the instructions provided for it here.

- Oven must be connected to the proper electrical voltage and frequency as specified on the model/serial/rating plate. See the following illustration.

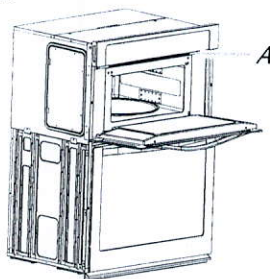

A. Model/serial/rating plate

- Models rated from 7.3 to 9.6 kW at 240 volts (5.4 to 7.4 kW at 208 volts) require a separate 40-amp circuit. Models rated at 4.8 kW and below at 240 volts (3.6 kW and below at 208 volts) require a separate 30-amp circuit.
- A circuit breaker is recommended.
- Connect directly to the fused disconnect (or circuit breaker box) through flexible, armored or nonmetallic sheathed, copper cable (with grounding wire). See "Make Electrical Connection" section.
- Flexible conduit from the oven should be connected directly to the junction box.
- Do not cut the conduit. The length of conduit provided is for serviceability of the oven.
- A UL listed or CSA approved conduit connector must be provided.
- If the house has aluminum wiring, follow the procedure below:
 - Connect a section of solid copper wire to the pigtail leads.
 - Connect the aluminum wiring to the added section of copper wire using special connectors and/or tools designed and UL listed for joining copper to aluminum.

Follow the electrical connector manufacturer's recommended procedure. Aluminum/copper connection must conform with local codes and industry accepted wiring practices.

For power requirements, refer to the following table.

Model	Voltage	Amperage (L1)*	Amperage (L2)*	Rating (W)
KOCE507E/KOCE500E	120/240	32	30	8000
KOCE507E/KOCE500E	120/208	30	28	6600

*Amperage values noted above are for information purposes only: the units are rated in watts.

PRODUCT DIMENSIONS

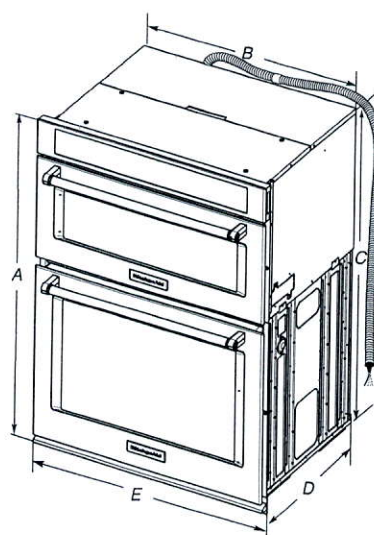

27" (68.6 cm) models

- A. 42³/₁₆" (108.0 cm) overall height
- B. 25⁷/₁₆" (64.6 cm) recessed width
- C. 41" (104.1 cm) recessed height
- D. 23¹/₄" (59.1 cm) max. recessed depth
- E. 27" (68.6 cm) overall width
- F. 48" (121.9 cm) flexible conduit length measured from the conduit clamp located at the rear of the oven. Do not remove the conduit clamp.

30" (76.2 cm) models

- A. 42³/₁₆" (108.0 cm) overall height
- B. 28⁷/₁₆" (72.3 cm) recessed width
- C. 41" (104.1 cm) recessed height
- D. 23¹/₄" (59.1 cm) max. recessed depth
- E. 30" (76.2 cm) overall width
- F. 48" (121.9 cm) flexible conduit length measured from the conduit clamp located at the rear of the oven. Do not remove the conduit clamp.

Cabinet Dimensions

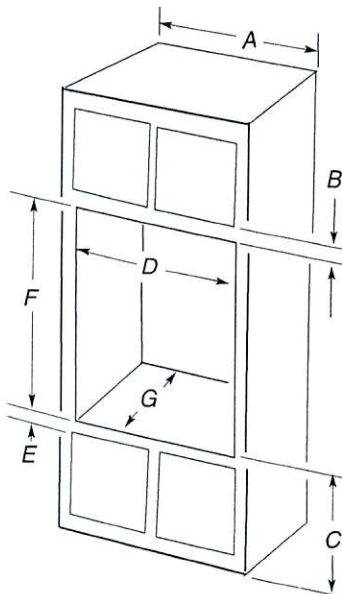

27" (68.6 cm) models

- A. 27" (68.6 cm) min. cabinet width
- B. 1" (2.5 cm) top of cutout to bottom of upper cabinet door
- C. 19¹/₄" (48.9 cm) bottom of cutout to floor is recommended. 4"-19¹/₄" (10.2-48.9 cm) bottom of cutout to floor is acceptable.
- D. 25¹/₂" (64.8 cm) cutout width
- E. 1¹/₂" (3.8 cm) min. bottom of cutout to top of cabinet door
- F. 41³/₁₆" (105 cm)* recommended cutout height
- G. 24" (60.7 cm) cutout depth

30" (76.2 cm) models

- A. 30" (76.2 cm) min. cabinet width
- B. 1" (2.5 cm) top of cutout to bottom
- C. 19¹/₄" (48.9 cm) bottom of cutout to floor is recommended. 4"-19¹/₄" (10.2-48.9 cm) bottom of cutout to floor is acceptable.
- D. 28¹/₂" (72.4 cm) cutout width
- E. 1¹/₂" (3.8 cm) min. bottom of cutout
- F. 41³/₁₆" (105 cm)* recommended cutout
- G. 24" (60.7 cm) cutout depth

* NOTE: The cabinet height can be between 41" (104.1 cm) and 41¹/₂" (105.6 cm) for microwave/oven combination.

KitchenAid® 30" (76.2 CM) AND 36" (91.4 CM) ELECTRIC INDUCTION COOKTOP

PRODUCT MODEL NUMBERS

KICU509X KICU569X

ELECTRICAL REQUIREMENTS:

Before You Make the Electrical Connection:

To properly install your cooktop, you must determine the type of electrical connection you will be using and follow the instructions provided for it here.

- A 4-wire or 3-wire, single phase, 240 volt, 60 Hz., AC only electrical supply is required on a separate, 50-amp circuit (36" [91.4 cm] models) or 40-amp circuit (30" [76.2 cm] models), fused on both sides of the line.
- The cooktop should be connected directly to the junction box through flexible, armored or nonmetallic sheathed, copper cable. The flexible, armored cable extending from the fuse box or circuit breaker box should be connected directly to the junction box.
- Locate the junction box to allow as much slack as possible between the junction box and the cooktop so that the cooktop can be moved if servicing becomes necessary in the future.
- Do not cut the conduit. The length of conduit provided is for serviceability of the cooktop.
- A UL listed or CSA approved conduit connector must be provided at each end of the power supply cable (at the cooktop and at the junction box). A listed conduit connector is already provided at the cooktop.
- If the house has aluminum wiring, follow the procedure below:
 1. Connect a section of solid copper wire to the pigtail leads.
 2. Connect the aluminum wiring to the added section of copper wire using special connectors and/or tools designed and UL listed for joining copper to aluminum.

Follow the electrical connector manufacturer's recommended procedure. Aluminum/copper connection must conform with local codes and industry accepted wiring practices.

PRODUCT DIMENSIONS

30" (76.2 cm) Cooktop

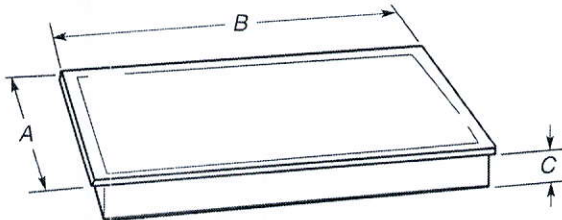

Model JIC4430	Model KICU509
A. 21 ⁵ / ₁₆ " (54.1 cm)	A. 21 ⁵ / ₁₆ " (54.1 cm)
B. 30 ⁵ / ₁₆ " (77.0 cm)	B. 30 ³ / ₄ " (78.2 cm)
C. 3 ¹ / ₈ " (8.0 cm)	C. 3 ¹ / ₈ " (8.0 cm)

36" (91.4 cm) Cooktop

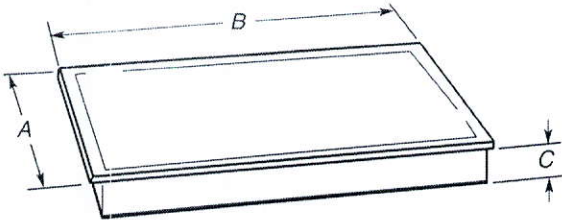

Models JIC4536 and KICU569
A. 21 ⁵ / ₁₆ " (54.1 cm)
B. 36 ⁵ / ₁₆ " (92.0 cm)
C. 3 ¹ / ₈ " (8.0 cm)

CABINET DIMENSIONS

IMPORTANT: If installing a range hood or microwave hood combination above the range, follow the range hood or microwave hood combination installation instructions for dimensional clearances above the cooktop surface.

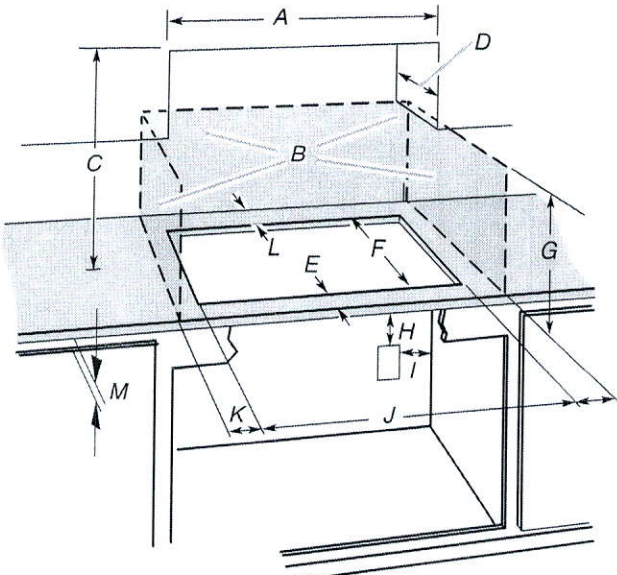

- A. 29¹/₂" (75.0 cm) on 30" (76.2 cm) models
33¹/₁₆" (84.0 cm) on 36" (91.4 cm) models
- B. Combustible area above countertop (shown by dashed box above)
- C. 30" (76.2 cm) minimum clearance between top of cooktop platform and bottom of uncovered wood or metal cabinet (24" [61 cm] minimum clearance if bottom of wood or metal cabinet is covered by not less than 1/4" [0.6 cm] flame retardant millboard covered with not less than No. 28 MSG sheet steel, 0.015" [0.04 cm] stainless steel, or 0.024" [0.06 cm] aluminum or 0.020" [0.05 cm] copper)
- D. 13" (33.0 cm) recommended upper cabinet depth
- E. 2" (5.1 cm)
- F. 19⁵/₁₆" (49.0 cm)
- G. 18" (45.7 cm) minimum clearance from upper cabinet to countertop within minimum horizontal clearances to cooktop
- H. Junction box or outlet; 12" (30.5 cm) minimum from bottom of countertop
- I. Junction box or outlet; 10" (25.4 cm) from right-hand side of cabinet
- J. 29¹/₂" (75.0 cm) on 30" (76.2 cm) models
33¹/₁₆" (84.0 cm) on 36" (91.4 cm) models
- K. 1" (2.5 cm) minimum distance to nearest left and right side combustible surface above cooktop
- L. 1" (2.5 cm) minimum clearance between back wall and countertop
- M. **IMPORTANT:** For proper ventilation, provide a vent of 3/16" (5 mm) under the countertop, in the front of the cabinet. The ventilation opening is to extend the full length of the cooktop cutout. See the following illustration.

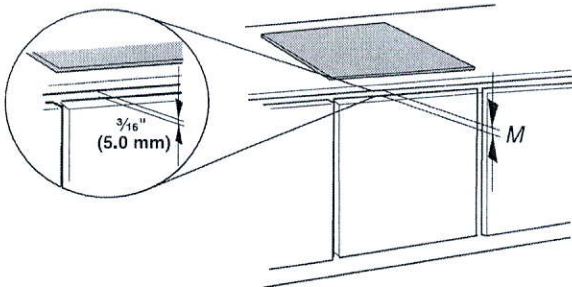

NOTES: After you make the countertop cutout, some installations may require notching down the base cabinet side walls to clear the cooktop base. To avoid this modification, use a base cabinet with sidewalls wider than the cutout.
If cabinet has a drawer, a 5¹/₈" (13 cm) depth clearance from the countertop to the top of the drawer (or other obstruction) in base cabinet is required.



PRODUCT MODEL NUMBERS

KRMF606E KRMF706E

Electrical: A 115 volt, 60 Hz, AC only, 15- or 20-amp fused, grounded electrical supply is required. It is recommended that a separate circuit serving only your refrigerator be provided. Use an outlet that cannot be turned off by a switch. Do not use an extension cord.

Water: A cold water supply with water pressure between 35 and 120 psi (241 and 827 kPa) is required to operate the water dispenser and ice maker. If you have questions about your water pressure, call a licensed, qualified plumber.

NOTE: If the water pressure is less than what is required, the flow of water from the water dispenser could decrease or ice cubes could be hollow or irregular shaped.

Reverse Osmosis Water Supply:

IMPORTANT: The pressure of the water supply coming out of a reverse osmosis system going to the water inlet valve of the refrigerator needs to be between 35 and 120 psi (241 and 827 kPa).

If a reverse osmosis water filtration system is connected to your cold water supply, the water pressure to the reverse osmosis system needs to be a minimum of 40 to 60 psi (276 to 414 kPa).

Bottom Mount Refrigerator

PRODUCT DIMENSIONS

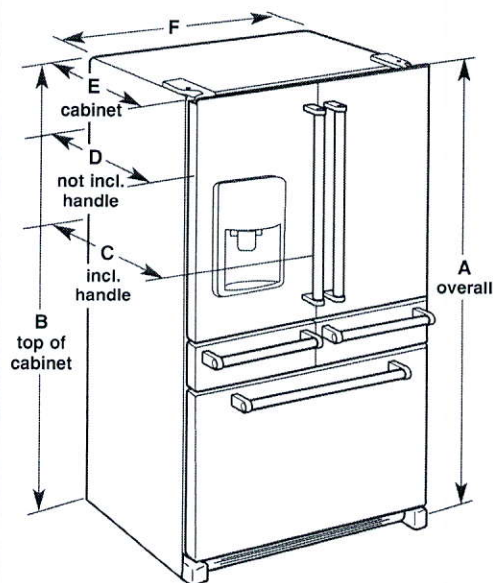

Model Size	Height - Overall "A"	Height - Top of Cabinet "B"	Depth - With Handles "C"	Depth - Without Handles "D"	Depth - Cabinet Only "E"	Width - Cabinet "F"
25.8	70 1/8" (178.1 cm)	68 3/8" (173.7 cm)	36 1/4" (92.1 cm)	34 1/2" (87.7 cm)	29" (73.7 cm)	36" (91.4 cm)

LOCATION REQUIREMENTS

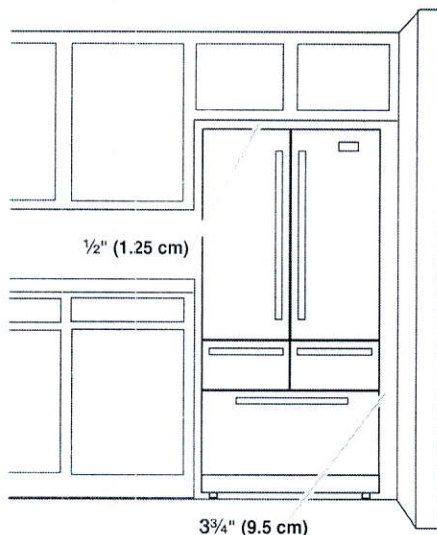

IMPORTANT: This refrigerator is designed for indoor, household use only.

To ensure proper ventilation for your refrigerator, allow for a ½" (1.25 cm) of space on each side and at the top. Allow for a 1" (2.54 cm) space behind the refrigerator. If your refrigerator has an ice maker, allow extra space at the back for the water line connections. When installing your refrigerator next to a fixed wall, leave a 3¾" (9.5 cm) minimum space between the refrigerator and wall to allow the door to swing open.

NOTE: This refrigerator is intended for use in a location where the temperature ranges from a minimum of 55°F (13°C) to a maximum of 110°F (43°C). The preferred room temperature range for optimum performance, which reduces electricity usage and provides superior cooling, is between 60°F (15°C) and 90°F (32°C). It is recommended that you do not install the refrigerator near a heat source, such as an oven or radiator.

PRODUCT MODEL NUMBERS

KVWB600D KVWB606D

Electrical: A 120 volt, 60 Hz., AC only, 15-amp, fused electrical circuit is required.

VENTING METHODS

This canopy range hood is factory set for venting through the roof or through the wall.

A 6" (15.2 cm) round vent system is needed for installation (not included). The hood exhaust opening is 6" (15.2 cm) round.

NOTE: Flexible vent is not recommended. Flexible vent creates back pressure and air turbulence that greatly reduce performance.

Vent system can terminate either through the roof or wall. To vent through a wall, a 90° elbow is needed.

Rear Discharge

A 90° elbow may be installed immediately above the hood.

For Non-Vented (Recirculating) Installations

If it is not possible to vent cooking fumes and vapors to the outside, the hood can be used in the non-vented (recirculating) version, using a Recirculation Kit (which includes charcoal filters and a deflector). To order, see the "Assistance or Service" section.

Roof Venting

Wall Venting

Non-Vented (Recirculating)

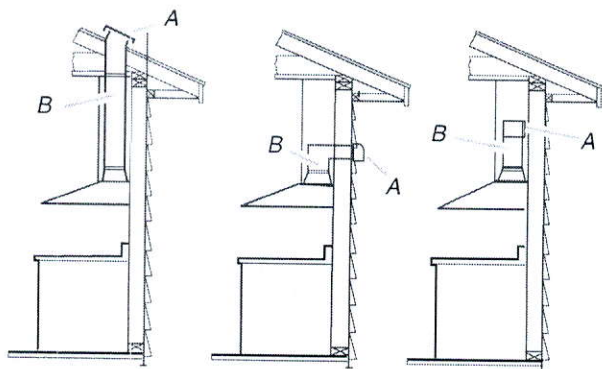

A. Roof cap
B. 6" (15.2 cm) round vent



A. Wall cap
B. 6" (15.2 cm) round vent

A. Diverter
B. 6" (15.2 cm) round vent

Calculating Vent System Length

To calculate the length of the system you need, add the equivalent feet (meters) for each vent piece used in the system.

Vent System

Vent Piece	6" (15.2 cm) Round	
45° elbow	2.5 ft (0.8 m)	
90° elbow	5.0 ft (1.5 m)	

Maximum equivalent vent length is 35 ft (10.7 m).

30" (72.6 cm) and 36" (91.4 cm) Wall-Mount Canopy Range Hood

Example Vent System

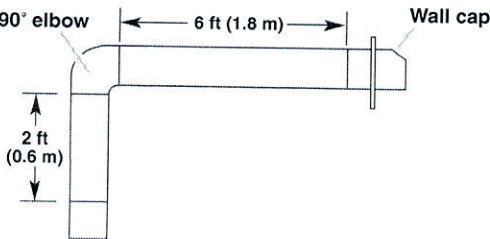

The following example falls within the maximum recommended vent length of 35 ft (10.7 m).

1 - 90° elbow	= 5.0 ft (1.5 m)
1 - wall cap	= 0.0 ft (0.0 m)
8 ft (2.4 m) straight	= 8.0 ft (2.4 m)
Length of system	= 13.0 ft (3.9 m)

PRODUCT DIMENSIONS

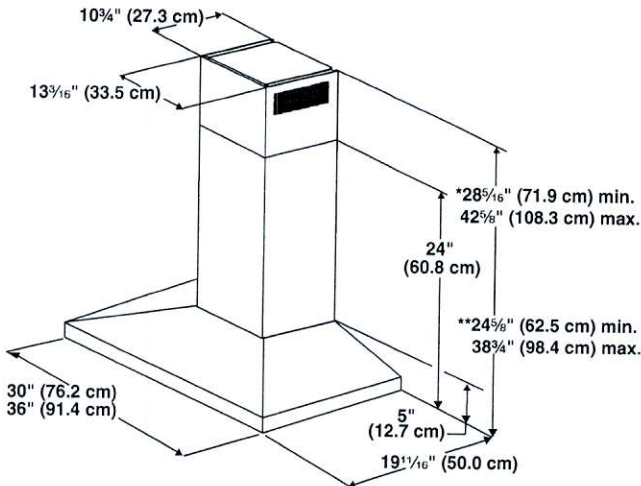

*For non-vented (recirculating) installations
**For vented installations

CABINET DIMENSIONS

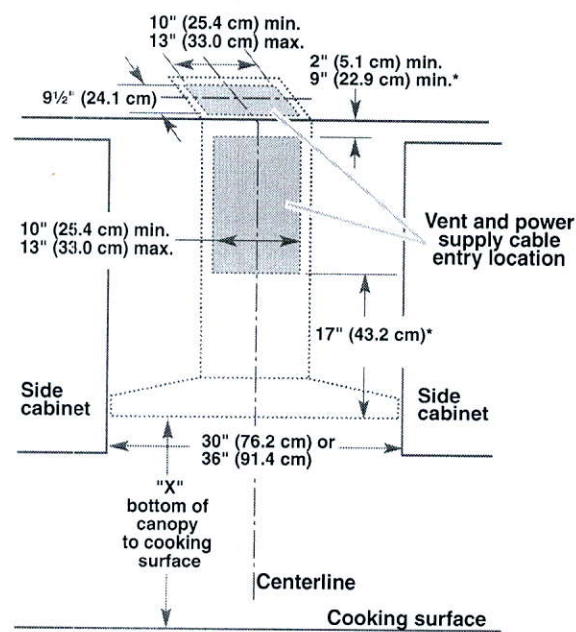

*For non-vented (recirculating) installations

IMPORTANT:

- Minimum distance "X": 24" (61.0 cm) from electric cooking surface.
- Minimum distance "X": 27" (68.6 cm) from gas cooking surfaces.
- Suggested maximum distance "X": 36" (91.4 cm)

The chimneys can be adjusted for different ceiling heights. See the following chart.

Vented Installations		
	Min. ceiling height	Max. ceiling height
Electric cooking surface	7' 1" (2.16 m)	9' 2" (2.79 m)
Gas cooking surface	7' 4" (2.23 m)	9' 2" (2.79 m)

Non-vented (recirculating) Installations		
	Min. ceiling height	Max. ceiling height
Electric cooking surface	7' 1" (2.16 m)	9' 6" (2.9 m)
Gas cooking surface	7' 4" (2.23 m)	9' 6" (2.9 m)

***NOTE:** The range hood chimneys are adjustable and designed to meet varying ceiling or soffit heights depending on the distance "X" between the bottom of the range hood and the cooking surface. For higher ceilings, a Chimney Extension Kit is available from your dealer or an authorized parts distributor. The chimney extension replaces the chimney shipped with the range hood. To order, see the "Assistance or Service" section.

Undercounter Dishwasher

PRODUCT MODEL NUMBERS

KDFE204E, KDTE104E, KDTE204E, KDTE254E, KDTM354E, KDTM384E, KDTM404E, KDTM504E, KDTM704E, KDTM804E

Electrical Requirements: 120-volt, 60 Hz, AC-only, 15- or 20-amp. fused electrical supply. Copper wire only. A time delay fuse or circuit breaker and separate circuit is recommended.

If direct wiring dishwasher: Use flexible, armored or nonmetallic, sheathed copper wire with grounding wire that meets the wiring requirements for your home and local codes and ordinances. Use a UL Listed or CSA Approved conduit connector.

If connecting dishwasher with a power supply cord: Use power supply cord kit (Part Number 4317824) marked for use with dishwashers. Follow the kit instructions for installing the power supply cord. Power supply cord must plug into a grounded three-prong outlet located in the cabinet next to the dishwasher opening. Outlet must meet all local codes and ordinances.

Water Supply Requirements: A hot water line with 20 to 120 psi (138 to 862 kPa) water pressure. Water temperature must be 120°F (49°C) water at dishwasher. Use 3/8" O.D. copper tubing with compression fitting or flexible braided water supply line

Note: 1/2" minimum plastic tubing is not recommended. Use a 90° elbow with 3/4" hose connection with rubber washer (part number W10273460). Do not solder within 6" (15.2 cm) from water inlet valve.

Drain Requirements: A new drain hose is supplied with your dishwasher. If this is not long enough, use a new drain hose with a maximum length of 12' (3.7 m) (Part No. 3385556) that meets all current AHAM/IAPMO test standards, is resistant to heat and detergent, and fits the 1" (2.5 cm) drain connector of the dishwasher.

Make sure to connect the drain hose to waste tee or disposer inlet above drain trap in house plumbing and 20" (50.8 cm) minimum above the floor. It is recommended that the drain hose either be looped up and securely fastened to the underside of the counter, or be connected to an air gap. Make sure to use an air gap if the drain hose is connected to house plumbing lower than 20" (50.8 cm) above subfloor or floor.

Use 1/2" (1.3 cm) minimum I.D. drain line fittings. If required, the air gap should be installed in accordance with the air gap installation instructions. When connecting the air gap a rubber hose (not provided) will be needed to connect to the waste tee or disposer inlet.

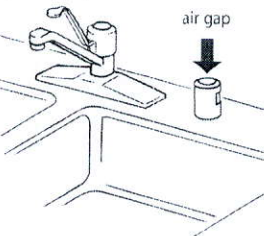

PRODUCT DIMENSIONS

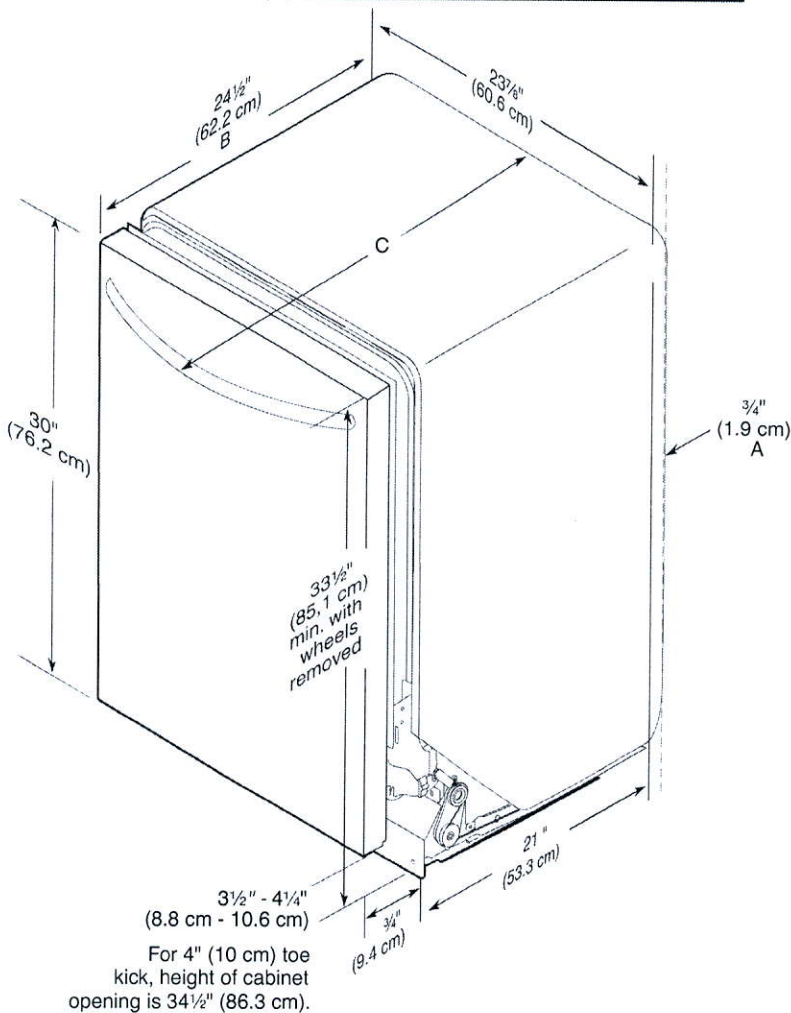

- A. Insulation may be compressed (not used on all models).
- B. For panel-ready models, dishwasher depth is 24" (60 cm) not including the 3/4" (1.9 cm) custom door panel.
- C. Door handles may protrude forward of the face of the dishwasher; varies by model.

CABINET CUTOUT DIMENSIONS

NOTE: Shaded areas of cabinet walls show where utility connections may be installed.

*Measure from the lowest point on the underside of the countertop. May be reduced to 33½" (85.1 cm) be removing the rear leveling legs from dishwasher.

**Minimum, measured from narrowest point of opening.

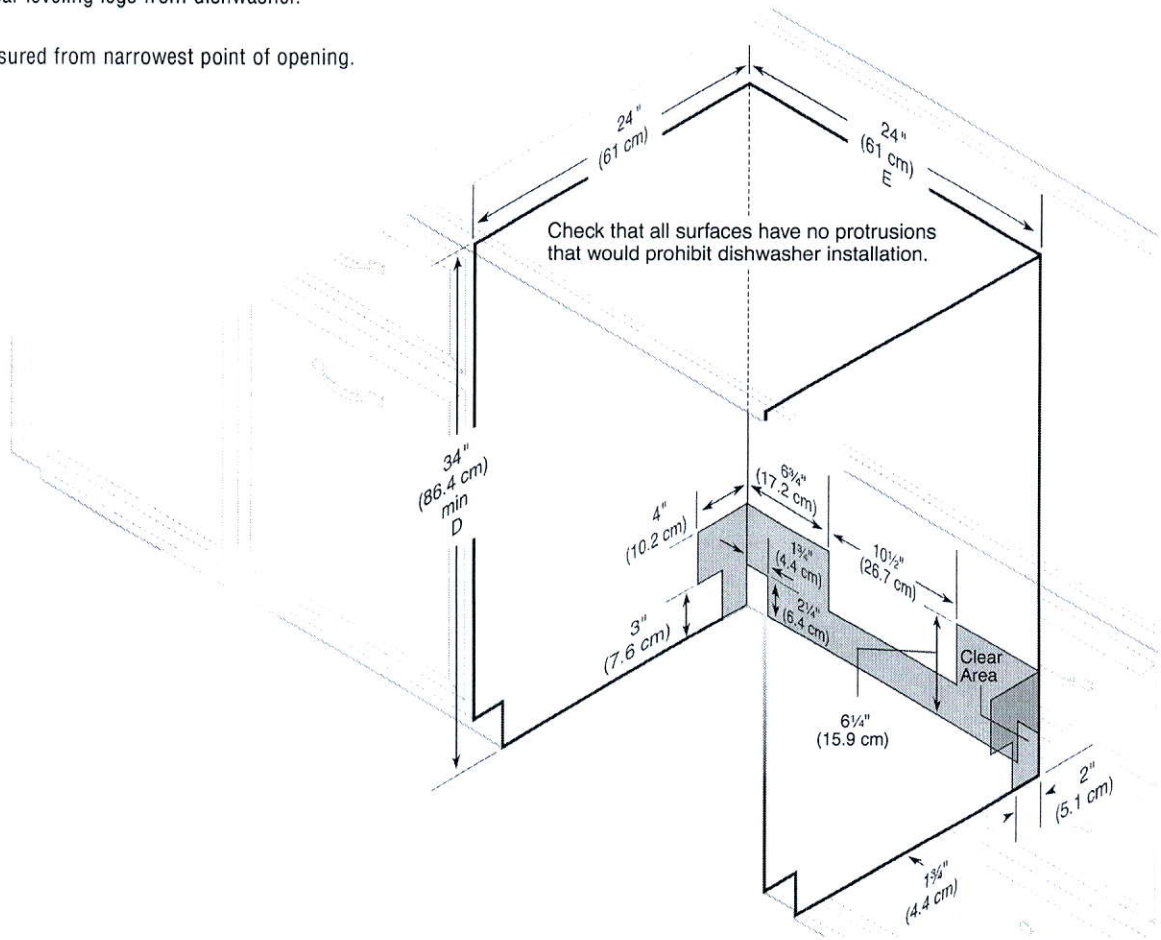

Moen Bathroom Accessories



Moen Mason Towel Ring

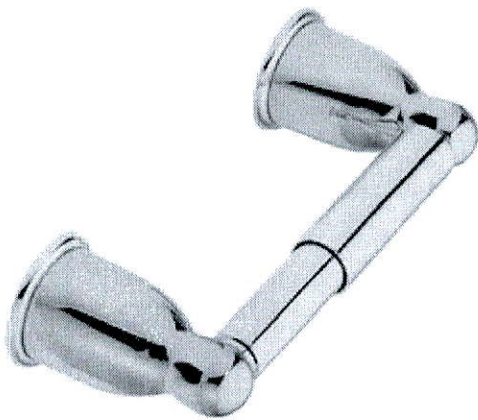

Moen Mason Toilet Paper Holder

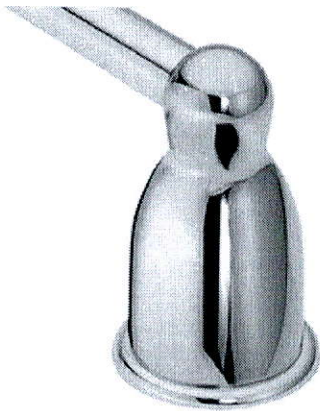

Moen Mason 18" Towel Bar

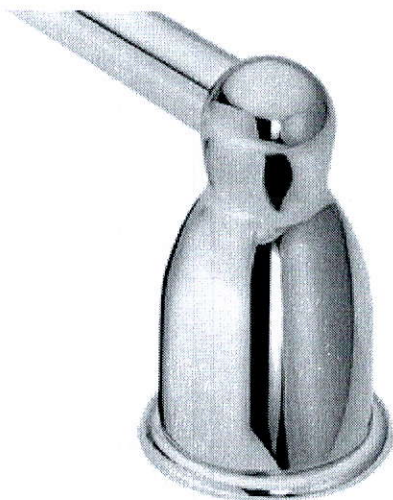

Moen Mason 24" Towel Bar

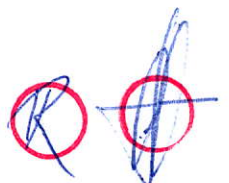



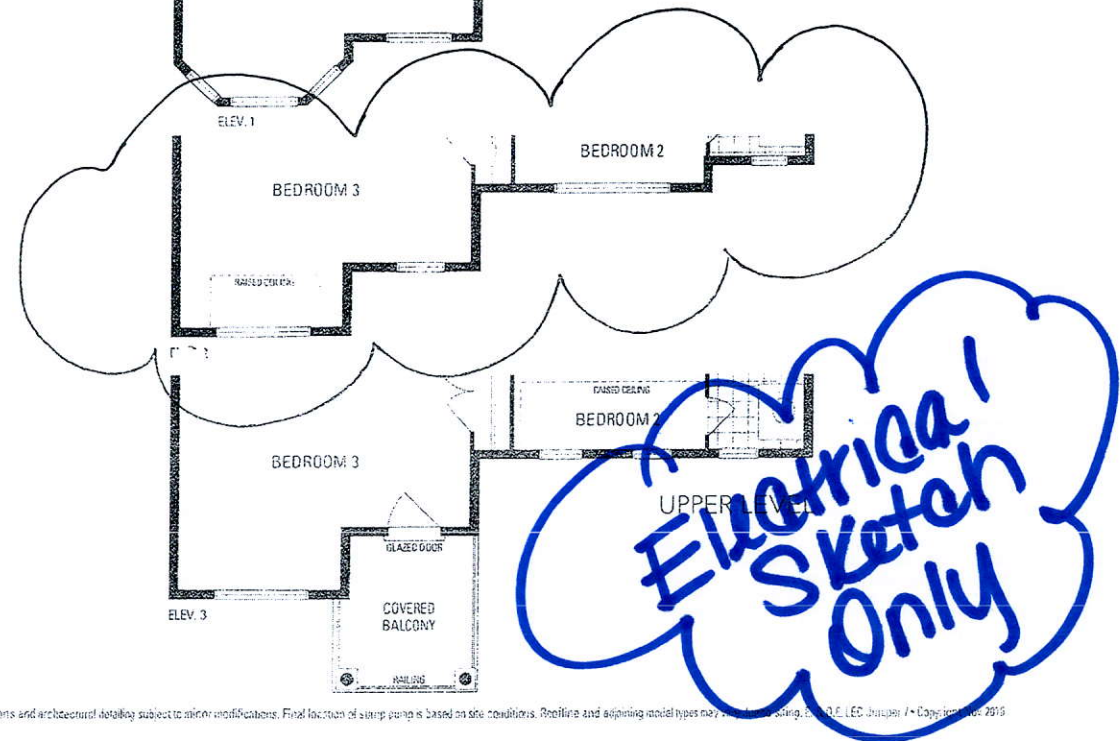

Diagram showing a room layout with electrical symbols (switch, outlet, light fixture) and a large handwritten note in blue ink: "Electrical Sketch Only".

On denaturation of the DNA, the reverse primer and purchased oligonucleotides to accept the same. Steps and primers may vary at any external difference caused due to grading variance. Actual usable floor space may vary from the stated floor area. All renderings are artist's concept. Dimensions, specifications and architectural details subject to minor modifications. Final location of single pump is based on site conditions. Profile and signage model types may vary. © 2019, The City of Dallas, Texas. All rights reserved. LED Jasper 1 - Copyright 2019

LOT 243

LECCO RIDGE

JUNIPER 7

REVISION:

1. ADD WAFFLE CEILING TO FAMILY ROOM.

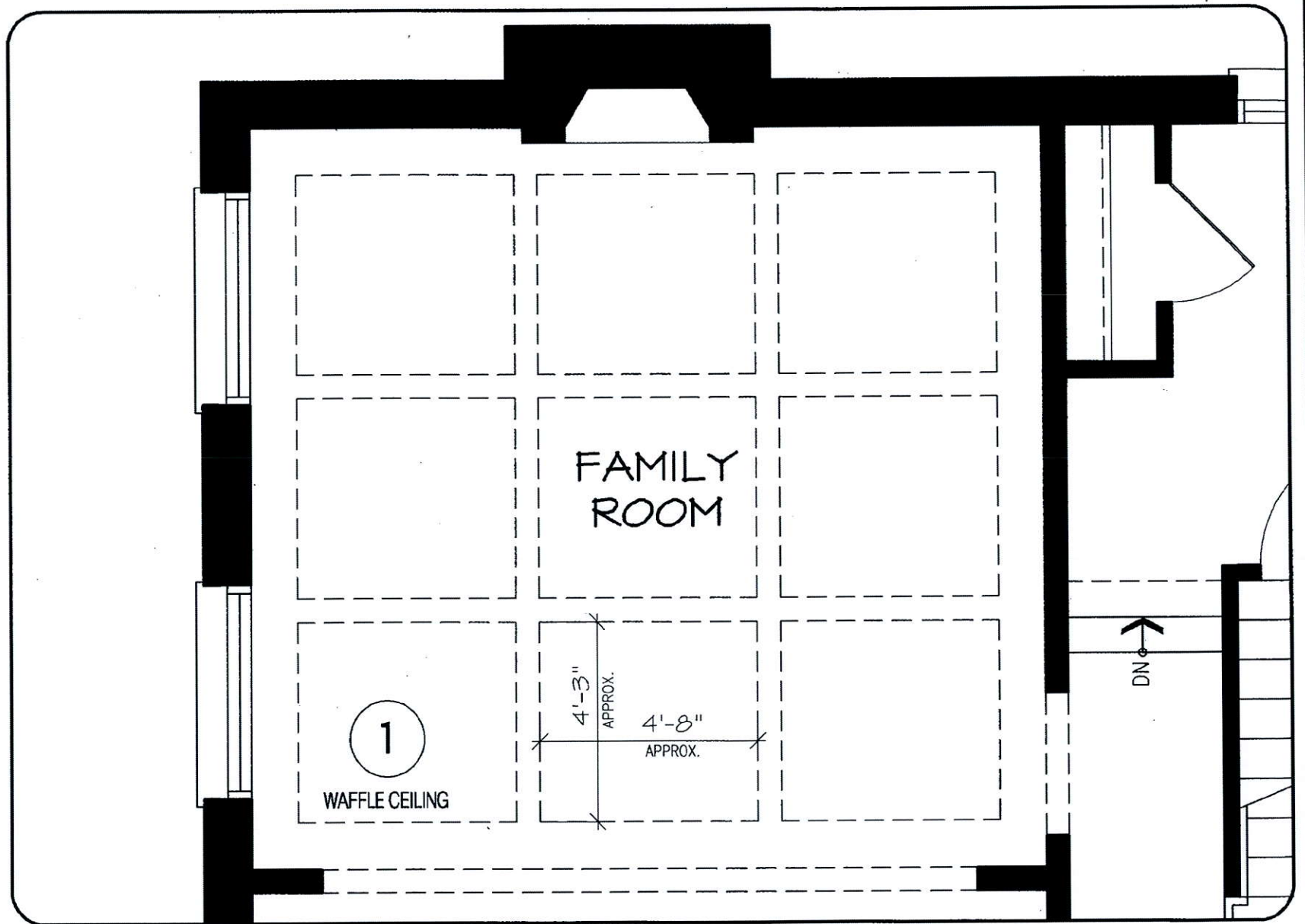

OCT 11 2017

MAIN LEVEL

DISCLAIMERS: SKETCH NOT TO SCALE. DIMENSIONS, SPECIFICATIONS AND ARCHITECTURAL DETAILS SUBJECT TO MODIFICATION BY THE VENDOR. SKETCH IS ONLY FOR THE PURPOSE OF ILLUSTRATING REVISIONS REQUESTED BY THE PURCHASER AND ALL REVISIONS ARE SUBJECT TO VENDOR'S FINAL APPROVAL. ONLY REVISIONS ACCEPTED IN WRITING BY THE PURCHASER AND VENDOR ON A PURCHASER'S EXTRA SHEET WILL BE INCORPORATED INTO THE PLANS FILED WITH THE MUNICIPALITY. E. & O.E.

REGION
DESIGN
INC.

SCALE

N.T.S.

BY
MB

PAGE No.
1 OF 2

 **Greenpark**

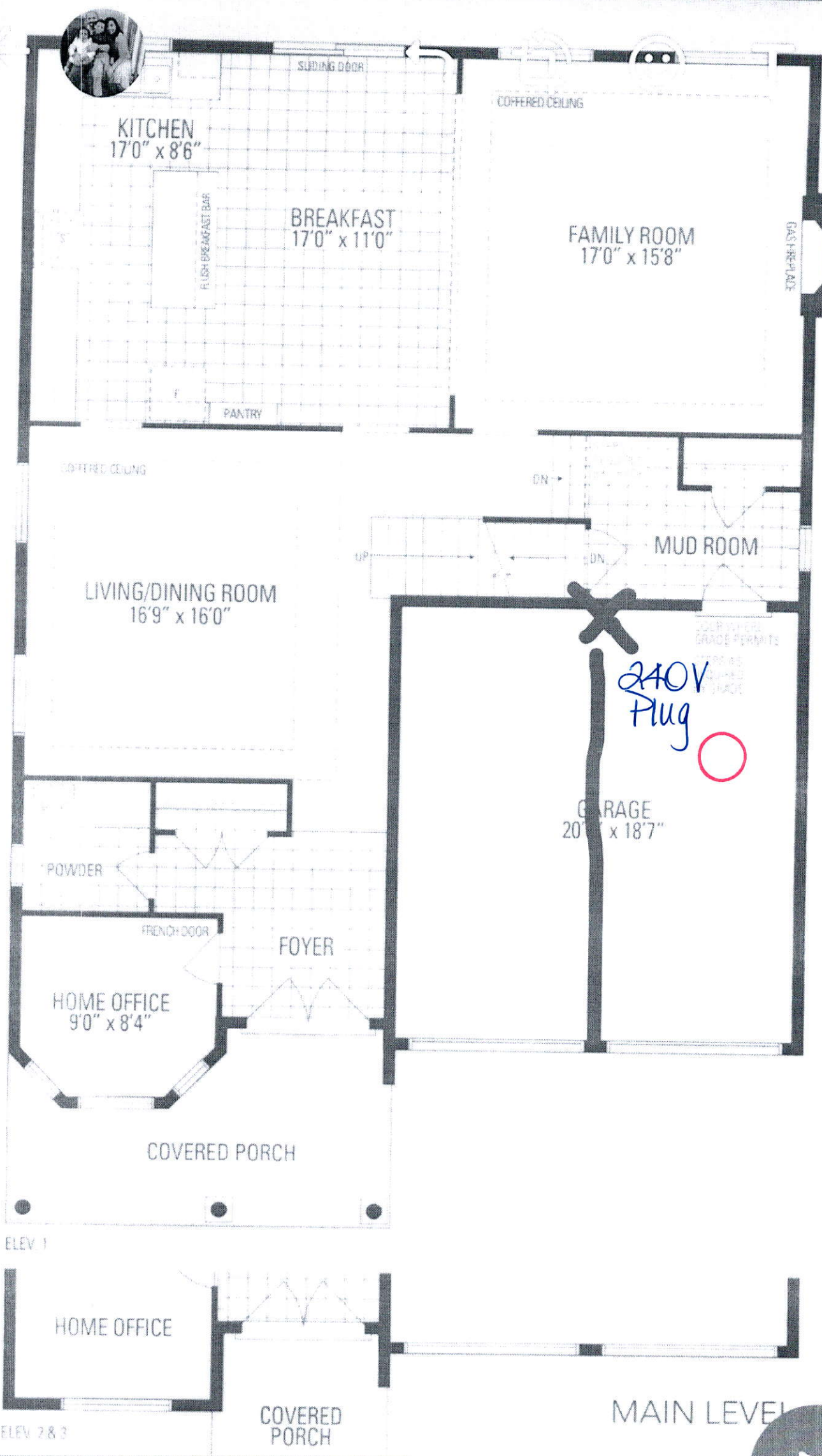

Add a caption...

