		CONSTRUCTION SUMMARY	
PURCHASER: KAMALJEET SIDHU		Saddle Ridge (G) - Lecco Ridge Developments Inc.	
		TEL: RES.: 905-515-6410	

LOT / PHASE Block 333 TH 2 / 1	REG. PLAN # 20M-1184	HOUSE TYPE Ivy 5 Elev 1		
--	--------------------------------	-----------------------------------	--	--

CABINETRY ACCESSORIES

1 - KITCHEN CABINETRY UPPER - FULL DEPTH ABOVE FRIDGE - WITH GABLES - 600MM - PRICE IS EACH - STANDARD 21Feb18 Note:	
1 - KITCHEN CABINETRY BASE - RECYCLE PULLOUT 2 BIN - PRICE IS EACH 21Feb18 Note:	
1 - KITCHEN CABINETRY BASE - POT/PAN DRAWERS (CABINET) - STANDARD 21Feb18 Note:	

COUNTER TOP

1 - HARD SURFACE COUNTERTOP - MAIN BATHROOM 21Feb18 Note: with standard topmount sink STANDARD TOPMOUNT SINK	
1 - HARD SURFACE COUNTERTOP - POWDER ROOM 21Feb18 Note: STANDARD TOP MOUNT SINK	
1 - HARD SURFACE COUNTERTOP - ENSUITE 21Feb18 Note: STANDARD TOPMOUNT SINK	
1 - HARD SURFACE COUNTERTOP - KITCHEN 21Feb18 Note: UNDERMOUNT SINK SOLD SEPERATELY	

FIREPLACE AND ACCESSORIES

1 - GAS LINE ROUGH-IN FOR STOVE (INCLUDES ELECTRICAL OUTLET) - FIRST FLOOR 21Feb18 Note:	
---	--

PLUMBING

1 - SINK - UNDERMOUNT SINK - BLANCO ESSENTIAL U2 #400008 21Feb18 Note: FOR KITCHEN-----	
1 - WATER LINE FOR FRIDGE - ROUGH-IN ONLY 21Feb18 Note:	

PROMOTIONAL

1 - LESS BALANCE OF CREDIT FROM PURCHASER EXTRA SHEET IN OFFER 21Feb18 Note:	
---	--

STAIRS AND RAILINGS

1 - 1-¾" PICKETS 21Feb18 Note: STAIRCASE	
---	--

EXTRAS AS PER OFFER

Five (5) White Appliances as per PE Appliances Worksheet Note:	
The Vendor agrees that notwithstanding any other term or provision in this Agreement included in the Purchase Price and in addition to those items detailed in Schedule GP to the Agreement of Purchase and Sale, the Purchaser is entitled to a credit of Fiv Worksheet Note:	
The Purchaser acknowledges that the Purchase Price is inclusive of all credits and promotional packages available at the time of purchase. Worksheet Note:	
Lot Premium Worksheet Note:	

RECEIVED FEB 26 2018



CONSTRUCTION SUMMARY

Saddle Ridge (G) - Lecco Ridge Developments Inc.

PURCHASER: KAMALJEET SIDHU

TEL: RES.: 905-515-6410

LOT / PHASE Block 333 TH 2 / 1	REG. PLAN # 20M-1184	HOUSE TYPE Ivy 5 Elev 1		
-----------------------------------	-------------------------	----------------------------	--	--

This Document is Extremely Time Sensitive - Printed 21 Feb 18 at 11:50

Purchaser: KAMALJEET SIDHU
Telephone Res. / Bus: (905) 515-6410 /
Decor Advisor: Candace Forza
Lock Date: 21-Feb-18

Property: Block 333 TH 2
Project: Lecco Ridge Developments Inc.
Model and Elevation: Ivy 5 Elev 1
Plan #: 20M-1184

Layout Changes: ☐ Yes ☒ No Sketch Attached: ☒ Yes ☐ No Exterior Colour Scheme:

1. Cabinetry

	Style and Colour	Hardware
Kitchen / Breakfast	HASTING MAJESTIC	1004
Laundry Room	ELISSE	Standard
Powder Room	HASTING MAJESTIC	1004
Master Ensuite Bathroom	HASTING MAJESTIC	1004
Main Bathroom	HASTING CHOCOLATE	1001
	N/A	N/A
	N/A	N/A
	N/A	N/A
	N/A	N/A

Appliances: Built In Appliances ☐ Yes ☒ No Slide In Stove ☐ Yes ☒ No

Dishwasher Cabinet ☐ Closed ☒ Open 41" Upper Cabinets ☒ Yes ☐ No Please NOTE: Standard Cabinet Height is 30"

Stove Opening NOTE: If not specified, opening will be set to builder's standard opening of approximately 30" width

Fridge Opening NOTE: If not specified, opening will be set to builder's standard opening of approximately 37" width x 74" height

** Refer to Construction Summary

2. Counters

	Counter	Edge
Kitchen / Breakfast	QUARTZ-SABBIA BEIGE	#320 PENCIL ROUND EDGE
Laundry Room	N/A	
Powder Room	QUARTZ-SABBIA BEIGE	#320 PENCIL ROUND EDGE
Master Ensuite Bathroom	QUARTZ-VIRGINA	#320 PENCIL ROUND EDGE
Main Bathroom	QUARTZ-VICTORIA	#320 PENCIL ROUND EDGE
	N/A	
	N/A	
	N/A	
	N/A	

** Refer to Construction Summary

Purchaser: KAMALJEET SIDHU

Property: Block 333 TH 2

Telephone Res. / Bus: (905) 515-6410 /

Project: Lecco Ridge Developments Inc.

Decor Advisor: Candace Forza

Model and Elevation: Ivy 5 Elev 1

Lock Date: 21-Feb-18

21-Feb-18

Plan #: 20M-1184

3. Ceramic Flooring

Entrance Vestibule

TILE-PLAYA BEIGE-12X12

☐

At a 45 Threshold-If App.

Main Hall

LAMIANTE

☐

Kitchen / Breakfast

TILE-PLAYA BEIGE-12X12

☐

METAL STRIP

Laundry Room

TILE-PASTELLO WHITE-13X13

☐

METAL STRIP

Powder Room

TILE-PLAYA BEIGE-12X12

☐

METAL STRIP

Master Ensuite Bathroom

TILE-PASTELLO WHITE-13X13

☐

METAL STRIP

Main Bathroom

TILE-PASTELLO WHITE-13X13

☐

METAL STRIP

GARAGE ENTRY

TILE-PLAYA BEIGE-12X12

☐

N/A

☐

N/A

☐

N/A

☐

** Refer to Construction Summary

4. Ceramic Wall Tile

Master Ensuite Bathroom	Selection	Describe
Tub Deck Wall	TILE-GLOSSY WHITE-8X10	
Tub Deck	N/A	
Tub Deck Skirt	N/A	
Shower Stall	TILE-GLOSSY WHITE-8X10	
Bathtub Enclosure Walls	N/A	
	N/A	
Main Bathroom	TILE-GLOSSY WHITE-8X10	
	N/A	
	N/A	
	N/A	
Kitchen Backsplash	N/A	

** Refer to Construction Summary - STANDARD GROUT THROUGHOUT UNLESS SPECIFIED

5. Plumbing Fixtures

All Bathrooms

White

N/A

N/A

N/A

N/A

N/A

Whirlpool

☐ N/A ☐ Yes ☒ No

Dishwasher Rough-In

☒ Yes ☐ No

Waterline for Fridge

☒ Yes ☐ No

** Refer to Construction Summary

6. Trim Carpentry

Interior Doors

CLASSIQUE

Interior Trim

2 3/4" CASING WITH 4 1/4" BASEBOARD - COLONIAL

Door Handles

As Per Construction Specifications

Exterior Front Door Handle

As Per Construction Specifications

** Refer to Construction Summary

7. Other Flooring

Purchaser: KAMALJEET SIDHU

Telephone Res. / Bus: (905) 515-6410 /

Decor Advisor: Candace Forza

Lock Date: 21-Feb-18

Property: Block 333 TH 2

Project: Lecco Ridge Developments Inc.

Model and Elevation: Ivy 5 Elev 1

Plan #: 20M-1184

7. Other Flooring

Main Hall	LAMINATE-MANHATTAN - RED OAK NATURAL TL-1504	
Living Room	LAMINATE-MANHATTAN - RED OAK NATURAL TL-1504	
Dining Room	LAMINATE-MANHATTAN - RED OAK NATURAL TL-1504	
Family Room	LAMINATE-MANHATTAN - RED OAK NATURAL TL-1504	
Den / Library / Study	N/A	
Basement Landing(If Applies)	N/A	
Lower Landing (If Applies)	LAMINATE-MANHATTAN - RED OAK NATURAL TL-1504	
Upper Landing	LAMINATE-MANHATTAN - RED OAK NATURAL TL-1504	
Upper Hall	CARPET-SHAW - E0949 NEWBERN CLASSIC - IVORY TINT 55101	
Master Bedroom	CARPET-SHAW - E0949 NEWBERN CLASSIC - IVORY TINT 55101	
Bedroom #2	CARPET-SHAW - E0949 NEWBERN CLASSIC - IVORY TINT 55101	
Bedroom #3	CARPET-SHAW - E0949 NEWBERN CLASSIC - IVORY TINT 55101	
Bedroom #4	N/A	
Bedroom #5	N/A	
COMPUTER NICHE	CARPET-SHAW - E0949 NEWBERN CLASSIC - IVORY TINT 55101	
	N/A	
	N/A	
Underpad	Type	Area
	STANDARD	SECOND FLOOR

** Refer to Construction Summary

8. Railings and Pickets

Railing Type	As Per Construction Specifications	Colour	NATURAL
Picket Type	1 3/4 PICKETS COLONIAL	Colour	NATURAL
Stringer / Riser	As Per Construction Specifications	Colour	NATURAL
Treads	As Per Construction Specifications	Colour	NATURAL
Red Oak Stairs with Semi Gloss Finish		<input checked="" type="radio"/> Yes <input type="radio"/> No	

** Refer to Construction Summary

9. Wall Paint Flat Finish

Main & Upper Hall	43 BIRCH WHITE	Master Bedroom	43 BIRCH WHITE
Living Room	43 BIRCH WHITE	Bedroom #2	43 BIRCH WHITE
Dining Room	43 BIRCH WHITE	Bedroom #3	43 BIRCH WHITE
Kitchen / Breakfast	43 BIRCH WHITE	Bedroom #4	N/A
Family Room	43 BIRCH WHITE	Bedroom #5	N/A
Powder Room	43 BIRCH WHITE	Master Ensuite	43 BIRCH WHITE
Laundry Room	43 BIRCH WHITE	Main Bathroom	43 BIRCH WHITE
Den/Library	N/A	COMPUTER NICHE	43 BIRCH WHITE
Trim Paint-Semi Gloss	BIRCH WHITE		N/A
	N/A		N/A
	N/A		N/A
Smooth Ceilings First Floor	<input type="radio"/> Yes <input checked="" type="radio"/> No		

** Refer to Construction Summary

Initial: 

Purchaser: KAMALJEET SIDHU

Telephone Res. / Bus: (905) 515-6410 /

Decor Advisor: Candace Forza

Lock Date: 21-Feb-18

Property: Block 333 TH 2

Project: Lecco Ridge Developments Inc.

Model and Elevation: Ivy 5 Elev 1

21-Feb-18

Plan #: 20M-1184

10. Plaster Mouldings and Medallions

Entrance Vestibule	N/A	N/A	Kitchen/Breakfast	N/A	N/A
Main Hall	N/A	N/A	Den/Library	N/A	N/A
Living Room	N/A	N/A	Lower Landing	N/A	N/A
Dining Room	N/A	N/A		N/A	N/A
Family Room	N/A	N/A			

** Refer to Construction Summary

11. Fireplace

Living Room			Family Room			Other Room - Specify		
Purchased	As Per Plan	N/A	Purchased	As Per Plan	N/A	Purchased	As Per Plan	N/A
		<input checked="" type="radio"/>			<input checked="" type="radio"/>			<input checked="" type="radio"/>
Fireplace Type	N/A		N/A			N/A		
Mantle Type	N/A		N/A			N/A		
Colour / Stain	N/A		N/A			N/A		
Surround	N/A		N/A			N/A		
Hearth	N/A		N/A			N/A		

** Refer to Construction Summary

12. Heating and Air Conditioning

Air Conditioning	NO	Gas Provisions Stove	YES
Gas Provisions Dryer	NO	Gas Provisions Barbecue	NO
Comment			

** Refer to Construction Summary

13. Electrical

Plugs and Switches	<input checked="" type="radio"/> White	DECOR	Above Kitchen Cabinet Light	<input type="radio"/> Yes <input checked="" type="radio"/> No
Hood Fan	STANDARD WHITE		Below Kitchen Cabinet Light	<input type="radio"/> Yes <input checked="" type="radio"/> No
Appliances	Built in Cooktop	Built in Oven	Gas Stove	Microwave
	<input type="radio"/> Yes <input checked="" type="radio"/> No	<input type="radio"/> Yes <input checked="" type="radio"/> No	<input checked="" type="radio"/> Yes <input type="radio"/> No	<input type="radio"/> Yes <input checked="" type="radio"/> No
Dishwasher Rough-in	Yes			

** Refer to Construction Summary

14. General Comments

** Refer to Construction Summary

Disclaimers and Notes

- 1) Colours of all materials are as close as possible to builder's selection, but not necessarily identical due to variances in manufacturing.

2) Any extras listed above are null and void unless accompanied by a separate invoice/amendment. Said invoice must be paid in full.

3) The Purchaser agrees that this colour selection is final and that no changes will be permitted, unless required by the Vendor.

4) The Purchaser acknowledges reading and accepting document which contains other miscellaneous disclaimers.

Signature:  Date: _____

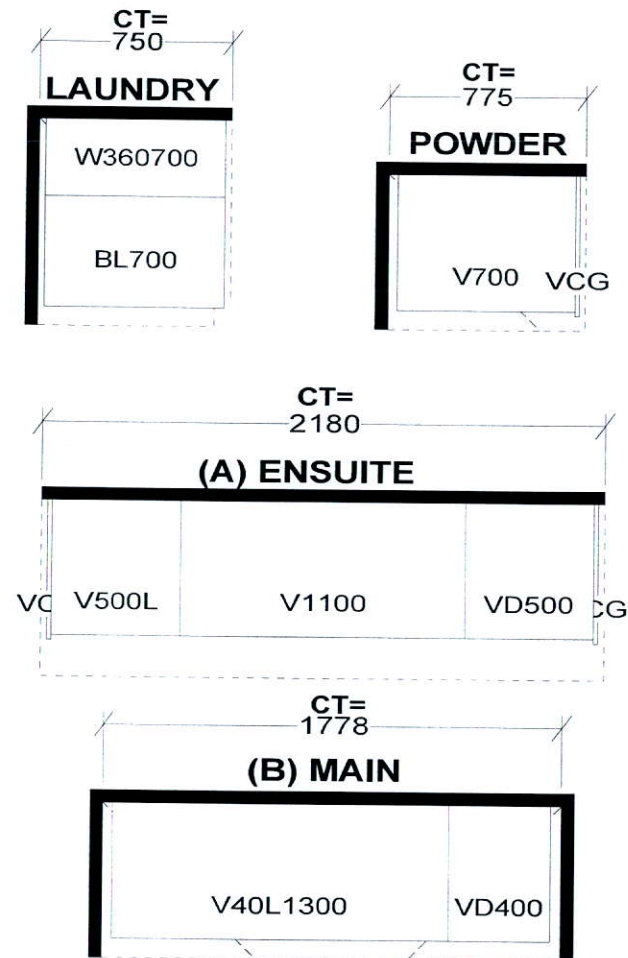

JOB NUMBER:
BUILDER: GREENPARK HOMES
SITE NAME: LECCO RIDGE, Milton
MODEL: IVY 5X ELEV 1,2,3
LOT #:
DESIGNER: KS
DATE: FEB 13 17

IVY 5

2,028 SQ.FT. includes 10 sq.ft. of open area

AVAILABLE IN BLOCK: 325, 326, 327, 328, 329, 330
331, 336, 337, 338, 342, 343, 345, 346 & 349

