

CONSTRUCTION SUMMARY

Saddle Ridge (G) - Lecco Ridge Developments Inc.

PURCHASERS: Abdul MOEED and Imrozia SHAFaq

TEL:

LOT / PHASE	REG. PLAN #	HOUSE TYPE		
253 / 1	20M-1184	Juniper 6 Elev 3		

CABINETRY

1 - UPGRADED HARDWARE - KITCHEN 17Jan18 Note:	
1 - KITCHEN - DELETE CABINETS ABOVE STOVE - VENDOR WILL SUPPLY 6 INCH VENT AS PER CONSTRUCTION SPECIFICATIONS AND VENT MAY NOT BE IN THE APPROPRIATE LOCATION FOR INSTALLATION OF PURCHASER SUPPLIED VENT - PURCHASER TO SUPPLY OWN FAN AFTER CLOSING 17Jan18 Note:	
1 - LIGHT VALENCE - KITCHEN 17Jan18 Note: NO ELECTRICAL	

CABINETRY ACCESSORIES

1 - KITCHEN CABINETRY BASE - RECYCLE PULLOUT 4 BIN - PRICE IS EACH 17Jan18 Note:	
2 - KITCHEN - UPPER CABINETRY - FROSTED GLASS DOORS - FITS TALL UPPER CABINETRY 17Jan18 Note:	
1 - PANTRY UNIT UPGRADE - TO GO FROM 300MM TO 600MM DEEP - PRICE IS PER FOOT - STANDARD 17Jan18 Note:	
1 - KITCHEN CABINETRY UPPER - FULL DEPTH ABOVE FRIDGE - WITH GABLES - 600MM - PRICE IS EACH - STANDARD 17Jan18 Note:	
2 - KITCHEN CABINETRY BASE - PIE CUT CORNER CABINET - BASE CABINETRY - STANDARD 17Jan18 Note:	
1 - KITCHEN CABINETRY BASE - POT/PAN DRAWERS (CABINET) - STANDARD 17Jan18 Note:	
1 - OVEN CABINET - BUILT-IN - MICROWAVE COMBO - PRICE IS EACH - STANDARD 17Jan18 Note:	
1 - KITCHEN CABINETRY BASE - COOKTOP CABINET FULL HEIGHT DOORS - STANDARD 17Jan18 Note:	
1 - KITCHEN CABINETRY BASE - BANK OF DRAWERS - STANDARD 17Jan18 Note:	
4 - KITCHEN CABINETRY UPPER - UPPER CABINETS - FITS TALL UPPER CABINETS - PRICE IS PER FOOT - STANDARD 10Oct17 Note:	
4 - KITCHEN CABINETRY BASE - BASE AND STANDARD. COUNTER - PRICE IS PER FOOT - STANDARD 10Oct17 Note:	

CERAMIC TILE

1 - PRICE IS FOR LABOUR ONLY - INSTALL TILE AT A 45 DEGREE ANGLE INSTALL TILE IN A STAGGERED PATTERN - - SIDE ENTRANCE 17Jan18 Note:	
1 - PRICE IS FOR LABOUR ONLY - INSTALL TILE AT A 45 DEGREE ANGLE INSTALL TILE IN A STAGGERED PATTERN - - POWDER ROOM 17Jan18 Note:	
1 - PRICE IS FOR LABOUR ONLY - INSTALL TILE AT A 45 DEGREE ANGLE INSTALL TILE IN A STAGGERED PATTERN - - KITCHEN 17Jan18 Note:	
1 - PRICE IS FOR LABOUR ONLY - INSTALL TILE AT A 45 DEGREE ANGLE INSTALL TILE IN A STAGGERED PATTERN - - FOYER AND MAIN HALL 17Jan18 Note:	

RECEIVED JAN 24 2018

CONSTRUCTION SUMMARY				
Saddle Ridge (G) - Lecco Ridge Developments Inc.				
PURCHASERS: Abdul MOEED and Imrozia SHAFaq				TEL:
LOT / PHASE	REG. PLAN #	HOUSE TYPE		
253 / 1	20M-1184	Juniper 6 Elev 3		
1 - TILE - UPGRADE 2 FLOOR TILE - - KITCHEN 17Jan18 Note:				
1 - TILE - UPGRADE 2 FLOOR TILE - - SIDE ENTRANCE 17Jan18 Note:				
1 - TILE - UPGRADE 2 FLOOR TILE - - POWDER ROOM 17Jan18 Note:				
1 - TILE - UPGRADE 2 FLOOR TILE - - FOYER AND MAIN HALL 17Jan18 Note:				
1 - DELETE ALL CERAMIC BATHROOM ACCESSORIES - DELETE TOWEL BAR, PAPER HOLDER & SOAP DISH THROUGHOUT 17Jan18 Note:				

CONSTRUCTION

1 - DELETE BULK HEADS IN KITCHEN IF CONSTRUCTION PERMITS 17Jan18 Note:	
1 - FAMILY ROOM - ANGLED CORNERS ON COFFERED CEILING 04Dec17 Note:	
1 - LIVING AND DINING ROOM- ADJUST COFFERED CEILING TO BE ONE BOX AROUND -SEE SKETCH WITH ANGLED CORNERS- 10Oct17 Note:	
1 - CLOSE OPENING BETWEEN KITCHEN AND DINING ROOM- SEE SKETCH 10Oct17 Note:	
1 - PLEASE NOTE THAT NO FURTHER STRUCTURAL CHANGES WILL BE PERMITTED. 15Dec16 Note:	
1 - ADD NEW ENLARGE BASEMENT WINDOW (MAY REQUIRE WINDOW WELL) - WINDOW IS 30 INCHES X 24 INCHES 15Dec16 Note:	
1 - FRONT EXTERIOR ELEVATION - MAKE ALL STONE AND STUCCO TO FRONT ELEVATION - NO BRICK ON FRONT 15Dec16 Note:	
1 - BASEMENT 8 FOOT 6 INCH CONCRETE POUR - MEASURED FROM TOP OF FOOTING TO TOP OF FOUNDATION WALL 15Dec16 Note:	
1 - FIRST FLOOR INCREASE CEILING HEIGHT FROM 9 FEET TO 10 FEET 15Dec16 Note: The ceiling height is measured from the top of the unfinished subfloor to underside of the unfinished ceiling above before finishes and excluding bulkheads and drop ceilings as per plan.	

COUNTER TOP

1 - HARD SURFACE COUNTERTOP - ENSUITE 17Jan18 Note:	
--	--

DOORS AND TRIM

1 - THROUGHOUT - INTERIOR DOORS ONLY - WEISER WINSTON SATIN CHROME LEVERS 17Jan18 Note:	
2 - DOOR HANDLES - PRIVACY LOCK IN LIEU OF PASSAGE 17Jan18 Note: MASTER BEDROOM & HOME OFFICE	

ELECTRICAL

1 - BUILT IN OVEN AND COOKTOP PROVISION - PROVISION ONLY - ELECTRICAL ONLY 17Jan18 Note:	
1 - RELOCATE STANDARD KITCHEN LIGHT TO BE CENTERED OVER ISLAND 04Dec17 Note:	



CONSTRUCTION SUMMARY				
Saddle Ridge (G) - Lecco Ridge Developments Inc.				
PURCHASERS: Abdul MOEED and Imrozia SHAFaq				TEL:
LOT / PHASE	REG. PLAN #	HOUSE TYPE		
253 / 1	20M-1184	Juniper 6 Elev 3		
1 - STANDARD DINING ROOM LIGHT TO BE CENTERED BETWEEN LIVING AND DINING ROOM 04Dec17 Note:				
3 - PLUG - ELECTRICAL PLUG 10Oct17 Note: extra plug in family room-master bedroom and bedroom 4 for future tv.- see sketch REVISED HEIGHTS TO 5' FOR ALL 3 TV PLUGS - SEE SKETCH JAN 17/18				
1 - PLUG - ELECTRICAL PLUG WITH GFI AND SWITCH - FOR FESTIVE LIGHTING 10Oct17 Note: REVISED LOCATION TO UPPER LEVEL SOFFIT - SEE SKETCH JAN 17/18				
1 - PLUG - ELECTRICAL PLUG - TO BE INSTALLED OVER FIREPLACE 10Oct17 Note:				
1 - 200 AMP ELECTRICAL SERVICE 10Oct17 Note:				
FIREPLACE AND ACCESSORIES				
1 - MANTEL - CAST STONE - AEQUALITAS 1 STYLE MANTEL 17Jan18 Note:				
1 - GAS LINE ROUGH-IN FOR BARBECUE - FIRST FLOOR 17Jan18 Note:				
1 - GAS LINE ROUGH-IN FOR STOVE (INCLUDES ELECTRICAL OUTLET) - FIRST FLOOR 17Jan18 Note:				
HARDWOOD FLOORING				
1 - LAMINATE -UPGRADE TO CLASSIC PLUS SERIES IN LIEU OF STANDARD LAMINATE 17Jan18 Note:				
1 - HARDWOOD – PROMO SERIES 4 7/16 INCH - IN LIEU OF 2 1/4 INCH NATURAL RED OAK - - FIRST FLOOR COMPLETE 17Jan18 Note:				
MISCELLANEOUS				
1 - FURTHER DISCOUNT AS PER VENDOR 17Jan18 Note:				
PLUMBING				
1 - WATER LINE FOR FRIDGE - ROUGH-IN ONLY 17Jan18 Note:				
4 - MOEN BATHROOM ACCESSORIES - MASON CHROME - TOWEL BAR 24" #YB8094/YB8000 - PRICE IS EACH 17Jan18 Note: ALL BATHROOMS				
4 - MOEN BATHROOM ACCESSORIES - MASON CHROME - PAPER HOLDER #YB8099/YB8000 - PRICE IS EACH 17Jan18 Note: ALL BATHROOMS				
2 - SINK - UNDERMOUNT SINK - CONTRAC COLLETTE #4220CIY 17Jan18 Note: MASTER ENSUITE BATHROOM				
2 - TOE TESTER - ADD TOE TESTER TO SHOWER 10Oct17 Note:				
PROMOTIONAL				
1 - LESS CREDIT FROM PURCHASER EXTRA SHEET IN OFFER 15Dec16 Note:				
STAIRS AND RAILINGS				

CONSTRUCTION SUMMARY				
Saddle Ridge (G) - Lecco Ridge Developments Inc.				
PURCHASERS: Abdul MOEED and Imrozia SHAFaq				TEL:
LOT / PHASE	REG. PLAN #	HOUSE TYPE		
253 / 1	20M-1184	Juniper 6 Elev 3		
1 - STAINED HANDRAIL, TREADS, RISERS AND STRINGER EXCLUDING PICKETS (FOR IRON PICKETS) - STANDARD STAIRCASE - PRICE IS PER SET 17Jan18 Note:				
1 - V GROOVE HANDRAIL 17Jan18 Note: STAIRCASE - LARGER POST AND HANDRAIL				
1 - EUROLINE 2 17Jan18 Note: STAIRCASE - IRON PICKETS - BLACK				

EXTRAS AS PER OFFER

The Vendor agrees that notwithstanding any other term or provision in this Agreement included in the Purchase Price and in addition to those items detailed in Schedule GP to the Agreement of Purchase and Sale, the Purchaser is entitled to a credit of Ten Worksheet Note:	
The Purchaser acknowledges that the Purchase Price is inclusive of all credits and promotional packages available at the time of purchase. Worksheet Note:	

This Document is Extremely Time Sensitive - Printed 17 Jan 18 at 12:35

Greenpark™

INTERIOR COLOUR SCHEME

Purchasers:

Abdul MOEED & Imrozia SHAFQAQ

Property: 253

Telephone Res. / Bus:

/

Project: Lecco Ridge Developments Inc.

Decor Advisor:

Candace Forza

Model and Elevation: Juniper 6 Elev 3

Lock Date:

17-Jan-18

17-Jan-18

Plan #: 20M-1184

Layout Changes:

☒ Yes ☐ No

Sketch Attached:

☒ Yes ☐ No

Exterior Colour Scheme:

1. Cabinetry

	Style and Colour	Hardware
Kitchen / Breakfast	HASTING SILKEN	428SB
Laundry Room	ELISSE	Standard
Powder Room	MODENA MAJESTIC	2002
Master Ensuite Bathroom	EVEREST WHITE	1001
Ensuite Bath - Bedroom 2/3	MODENA CHOCOLATE	2002
Ensuite Bath - Bedroom 4	MODENA SILKEN	2002
	N/A	N/A
	N/A	N/A
	N/A	N/A

Appliances:

Built In Appliances ☒ Yes ☐ No

Slide In Stove ☐ Yes ☒ No

Dishwasher Cabinet ☐ Closed ☒ Open

41" Upper Cabinets ☒ Yes ☐ No

Please NOTE: Standard Cabinet Height is 30"

Stove Opening

NOTE: If not specified, opening will be set to builder's standard opening of approximately 30" width

Fridge Opening

NOTE: If not specified, opening will be set to builder's standard opening of approximately 37" width x 74" height

** Refer to Construction Summary

2. Counters

	Counter	Edge
Kitchen / Breakfast	LAMINATE-AUTUMN CARNIVAL 1877K-52	
Laundry Room	N/A	
Powder Room	LAMINATE-KALAHARI TOPAZ 4588K-07	
Master Ensuite Bathroom	QUARTZITE-TERRA BIANCO	#320 PENCIL ROUND
Ensuite Bath - Bedroom 2/3	LAMINATE-WHITE TIGRIS 4783-60	
Ensuite Bath - Bedroom 4	LAMINATE-INUK SHUK TAUPE P-345 LM	
	N/A	
	N/A	
	N/A	

** Refer to Construction Summary

Initials:

AM

YS

Page 1 of 4

Printed 1/17/2018 12:26:43

Purchasers:Abdul MOEED & Imrozia SHAFQA

Property: 253

Telephone Res. / Bus: /

Project: Lecco Ridge Developments Inc.

Decor Advisor: Candace Forza

Model and Elevation: Juniper 6 Elev 3

Lock Date: 17-Jan-18

17-Jan-18

Plan #: 20M-1184

3. Ceramic Flooring

At a 45 Threshold-If App.

Entrance Vestibule	TILE-CHALLENGE(D057404) BIANCO-12X24***STAGG	<input type="checkbox"/>	METAL STRIP
Main Hall	STRIP	<input type="checkbox"/>	
Kitchen / Breakfast	TILE-CHALLENGE(D057404) BIANCO-12X24***STAGG	<input type="checkbox"/>	METAL STRIP
Laundry Room	TILE-BEACH IVORY-13X13	<input type="checkbox"/>	
Powder Room	TILE-CHALLENGE(D057404) BIANCO-12X24***STAGG	<input type="checkbox"/>	
Master Ensuite Bathroom	TILE-BEACH LIGHT GREY-13X13	<input type="checkbox"/>	METAL STRIP
Ensuite Bath - Bedroom 2/3	TILE-ESSENZE GRIGIO-13X13	<input type="checkbox"/>	METAL STRIP
Ensuite Bath - Bedroom 4	TILE-ESSENZE TAUPE-13X13	<input type="checkbox"/>	METAL STRIP
SIDE ENTRY	TILE-CHALLENGE(D057404) BIANCO-12X24***STAGG	<input type="checkbox"/>	
	N/A	<input type="checkbox"/>	
	N/A	<input type="checkbox"/>	

** Refer to Construction Summary

4. Ceramic Wall Tile

Master Ensuite Bathroom	Selection	Describe
Tub Deck Wall	N/A	
Tub Deck	N/A	
Tub Deck Skirt	N/A	
Shower Stall	TILE-PIXEL BIANCO-8X16	
Bathtub Enclosure Walls	N/A	
	N/A	
Ensuite 2/3	TILE-PIXEL BIANCO-8X16	
Ensuite 4	TILE-PIXEL BEIGE-8X16	
	N/A	
	N/A	
Kitchen Backsplash	N/A	

** Refer to Construction Summary - STANDARD GROUT THROUGHOUT UNLESS SPECIFIED

5. Plumbing Fixtures

All Bathrooms

White

N/A

N/A

N/A

N/A

N/A

Whirlpool

N/A

Yes

No

Dishwasher Rough-In

Yes

No

Waterline for Fridge

Yes

No

** Refer to Construction Summary

6. Trim Carpentry

Interior Doors	CLASSIQUE
Interior Trim	3" BB CASING WITH 5 1/4" BASEBOARD - COLONIAL
Door Handles	SATIN NICKEL LEVER
Exterior Front Door Handle	As Per Construction Specifications

** Refer to Construction Summary

Purchasers:

Abdul MOEED & Imrozia SHAFQA

Telephone Res. / Bus:

/

Decor Advisor:

Candace Forza

Lock Date:

17-Jan-18

Property: 253

Project: Lecco Ridge Developments Inc.

Model and Elevation: Juniper 6 Elev 3

Plan #: 20M-1184

7. Other Flooring

Main Hall	STRIP-MIRAGE-ADMIRATION-MAPLE-CASHMERE-RIO-4 7/16"	
Living Room	STRIP-MIRAGE-ADMIRATION-MAPLE-CASHMERE-RIO-4 7/16"	
Dining Room	STRIP-MIRAGE-ADMIRATION-MAPLE-CASHMERE-RIO-4 7/16"	
Family Room	STRIP-MIRAGE-ADMIRATION-MAPLE-CASHMERE-RIO-4 7/16"	
Den / Library / Study	STRIP-MIRAGE-ADMIRATION-MAPLE-CASHMERE-RIO-4 7/16"	
Basement Landing(If Applies)	N/A	
Lower Landing (If Applies)	STRIP-MIRAGE-ADMIRATION-MAPLE-CASHMERE-RIO-4 7/16"	
Upper Landing	STRIP-MIRAGE-ADMIRATION-MAPLE-CASHMERE-RIO-4 7/16"	
Upper Hall	LAMINATE-CLASSIC PLUS - HAVANA OAK NAT SAW CUT QS-UM1656	
Master Bedroom	LAMINATE-CLASSIC PLUS - HAVANA OAK NAT SAW CUT QS-UM1656	
Bedroom #2	LAMINATE-CLASSIC PLUS - HAVANA OAK NAT SAW CUT QS-UM1656	
Bedroom #3	LAMINATE-CLASSIC PLUS - HAVANA OAK NAT SAW CUT QS-UM1656	
Bedroom #4	LAMINATE-CLASSIC PLUS - HAVANA OAK NAT SAW CUT QS-UM1656	
Bedroom #5	N/A	
	N/A	
	N/A	
	N/A	
Underpad	Type	Area
	N/A	N/A

** Refer to Construction Summary

8. Railings and Pickets

Railing Type	V-GROOVE	Colour	MIRAGE RIO
Picket Type	EUROLINE 2	Colour	BLACK
Stringer / Riser	As Per Construction Specifications	Colour	MIRAGE RIO
Treads	As Per Construction Specifications	Colour	MIRAGE RIO
Red Oak Stairs with Semi Gloss Finish		<input checked="" type="radio"/> Yes <input type="radio"/> No	

** Refer to Construction Summary

9. Wall Paint Flat Finish

Main & Upper Hall	25 OYSTER	Master Bedroom	25 OYSTER
Living Room	25 OYSTER	Bedroom #2	25 OYSTER
Dining Room	25 OYSTER	Bedroom #3	25 OYSTER
Kitchen / Breakfast	25 OYSTER	Bedroom #4	25 OYSTER
Family Room	25 OYSTER	Bedroom #5	N/A
Powder Room	25 OYSTER	Master Ensuite	22 WARM GREY
Laundry Room	25 OYSTER	Ensuite Bath - Bedroom 2/3	22 WARM GREY
Den/Library	25 OYSTER	Ensuite Bath - Bedroom 4	25 OYSTER
Trim Paint-Semi Gloss	BIRCH WHITE		N/A
	N/A		N/A
	N/A		N/A
Smooth Ceilings First Floor	<input type="radio"/> Yes <input checked="" type="radio"/> No		

** Refer to Construction Summary

Purchasers:Abdul MOEED & Imrozia SHAFQA

Property: 253

Telephone Res. / Bus: /

Project: Lecco Ridge Developments Inc.

Decor Advisor: Candace Forza

Model and Elevation: Juniper 6 Elev 3

Lock Date: 17-Jan-18

17-Jan-18

Plan #: 20M-1184

10. Plaster Mouldings and Medallions

Entrance Vestibule	N/A	N/A	Kitchen/Breakfast	N/A	N/A
Main Hall	N/A	N/A	Den/Library	N/A	N/A
Living Room	N/A	N/A	Lower Landing	N/A	N/A
Dining Room	N/A	N/A		N/A	N/A
Family Room	N/A	N/A			

** Refer to Construction Summary

11. Fireplace

	Living Room			Family Room			Other Room - Specify		
	Purchased	As Per Plan	N/A	Purchased	As Per Plan	N/A	Purchased	As Per Plan	N/A
	<input type="radio"/>	<input type="radio"/>	<input checked="" type="radio"/>	<input type="radio"/>	<input checked="" type="radio"/>	<input type="radio"/>	<input type="radio"/>	<input type="radio"/>	<input checked="" type="radio"/>
Fireplace Type	N/A			FLAT ON WALL			N/A		
Mantle Type	N/A			CASTONE-AEQUALITIES			N/A		
Colour / Stain	N/A			TUSCANY SAND			N/A		
Surround	N/A			N/A			N/A		
Hearth	N/A			N/A			N/A		

** Refer to Construction Summary

12. Heating and Air Conditioning

Air Conditioning	NO	Gas Provisions Stove	YES
Gas Provisions Dryer	NO	Gas Provisions Barbecue	YES
Comment			

** Refer to Construction Summary

13. Electrical

Plugs and Switches	<input checked="" type="radio"/> White	DECOR	Above Kitchen Cabinet Light	<input type="radio"/> Yes	<input checked="" type="radio"/> No
Hood Fan	STANDARD WHITE		Below Kitchen Cabinet Light	<input type="radio"/> Yes	<input checked="" type="radio"/> No
Appliances	Built in Cooktop	Built in Oven	Gas Stove	Microwave	
	<input checked="" type="radio"/> Yes <input type="radio"/> No	<input checked="" type="radio"/> Yes <input type="radio"/> No	<input checked="" type="radio"/> Yes <input type="radio"/> No	<input checked="" type="radio"/> Yes <input type="radio"/> No	
Dishwasher Rough-in	Yes				

** Refer to Construction Summary

14. General Comments

** Refer to Construction Summary

Disclaimers and Notes

1) Colours of all materials are as close as possible to builder's selection, but not necessarily identical due to variances in manufacturing.

2) Any extras listed above are null and void unless accompanied by a separate invoice/amendment. Said invoice must be paid in full.

3) The Purchaser agrees that this colour selection is final and that no changes will be permitted, unless required by the Vendor.

4) The Purchaser acknowledges reading and accepting document which contains other miscellaneous disclaimers.

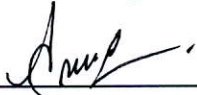
Signature:  Date: Jan 17/18

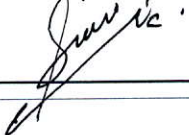
Signature:  Date: Jan. 17/18

Page 4 of 4

KitchenAid® 27" (68.6 cm) and 30" (76.2 cm) Electric Built-In Microwave/Oven Combination

PRODUCT MODEL NUMBERS

KEMS309E

KOCE500E

KOCE507E

ELECTRICAL CONNECTION

If codes permit and a separate ground wire is used, it is recommended that a qualified electrical installer determine that the ground path and the wire gauge are in accordance with local codes. Check with a qualified electrical installer if you are not sure the oven is properly grounded.

This oven must be connected to a grounded metal, permanent wiring system.

Be sure that the electrical connection and wire size are adequate and in conformance with the National Electrical Code, ANSI/NFPA 70-latest edition or CSA Standards C22.1-94, Canadian Electrical Code, Part 1 and C22.2 No. 0-M91-latest edition, and all local codes and ordinances.

To properly install your oven, you must determine the type of electrical connection you will be using and follow the instructions provided for it here.

- Oven must be connected to the proper electrical voltage and frequency as specified on the model/serial/rating plate. See the following illustration.

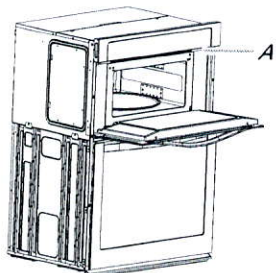

A. Model/serial/rating plate

- Models rated from 7.3 to 9.6 kW at 240 volts (5.4 to 7.4 kW at 208 volts) require a separate 40-amp circuit. Models rated at 4.8 kW and below at 240 volts (3.6 kW and below at 208 volts) require a separate 30-amp circuit.
- A circuit breaker is recommended.
- Connect directly to the fused disconnect (or circuit breaker box) through flexible, armored or nonmetallic sheathed, copper cable (with grounding wire). See "Make Electrical Connection" section.
- Flexible conduit from the oven should be connected directly to the junction box.
- Do not cut the conduit. The length of conduit provided is for serviceability of the oven.
- A UL listed or CSA approved conduit connector must be provided.
- If the house has aluminum wiring, follow the procedure below:
 1. Connect a section of solid copper wire to the pigtail leads.
 2. Connect the aluminum wiring to the added section of copper wire using special connectors and/or tools designed and UL listed for joining copper to aluminum.

Follow the electrical connector manufacturer's recommended procedure. Aluminum/copper connection must conform with local codes and industry accepted wiring practices.

For power requirements, refer to the following table.

Model	Voltage	Amperage (L1)*	Amperage (L2)*	Rating (W)
KOCE507E/KOCE500E	120/240	32	30	8000
KOCE507E/KOCE500E	120/208	30	28	6600

*Amperage values noted above are for information purposes only; the units are rated in watts.

PRODUCT DIMENSIONS

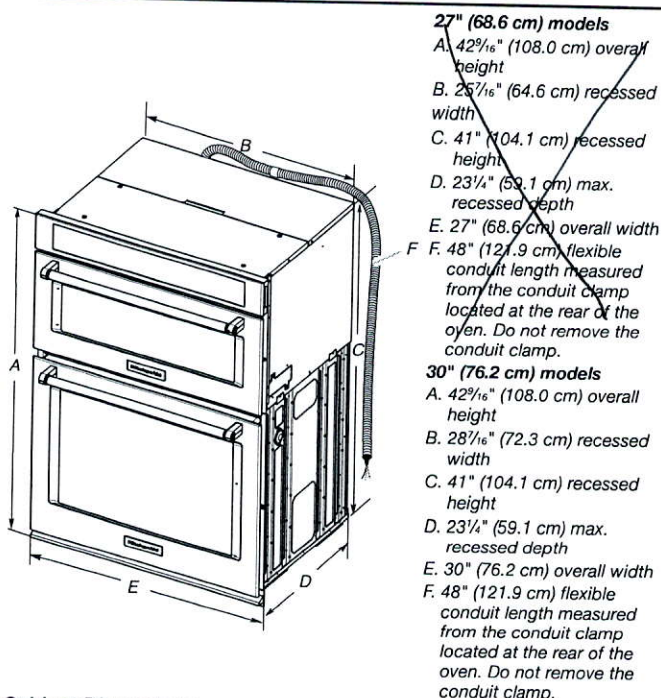

Cabinet Dimensions

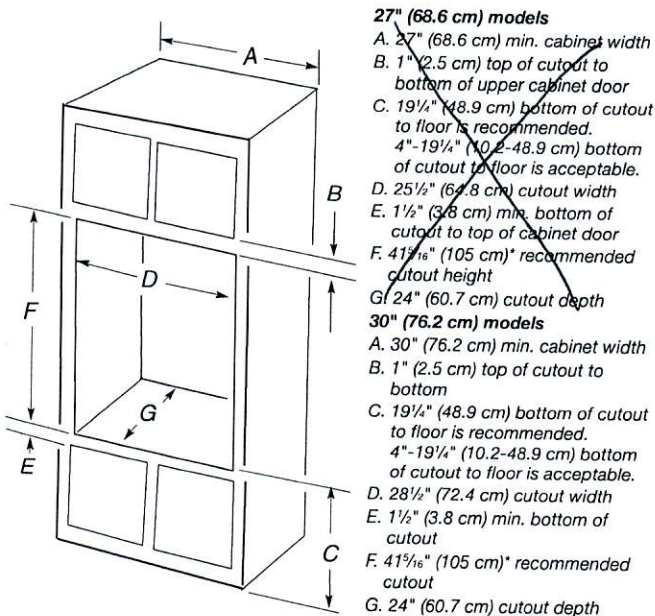

* NOTE: The cabinet height can be between 41" (104.1 cm) and 41¹/₂" (105.6 cm) for microwave/oven combination.

30" (76.2 CM) AND 36" (91.4 CM) GAS BUILT-IN COOKTOP

PRODUCT MODEL NUMBERS

KCGS350E	KCGS950E	MGC9530D	WCG75US0D
KCGS356E	KCGS956E	MGC9536D	WCG97US0D
KCGS550E	MGC7430D	WCG51US0D	WCG97US6D
KCGS556E	MGC7536D	WCG51US6D	

GAS SUPPLY REQUIREMENTS

Type of Gas

Natural Gas:

- This cooktop is factory set for use with Natural gas. If converting to LP gas, see the "LP Gas Conversion" instructions provided in the package containing literature. The model/serial rating plate located on the underside of the cooktop base has information on the types of gas that can be used. If the types of gas listed do not include the type of gas available, check with the local gas supplier.

LP Gas Conversion:

Conversion must be done by a qualified service technician.

No attempt shall be made to convert the cooktop from the gas specified on the model/serial rating plate for use with a different gas without consulting the serving gas supplier. See the Gas Conversion instructions provided in the package containing literature.

Gas Supply Line

- Provide a gas supply line of 3/4" (1.9 cm) rigid pipe to the cooktop location. A smaller size pipe on longer runs may result in insufficient gas supply. Pipe-joint compounds that resist the action of LP gas must be used. Do not use TEFLON[®] tape. With LP gas, piping or tubing size should be 1/2" minimum. Usually, LP gas suppliers determine the size and materials used in the system.

Flexible metal appliance connector:

- If local codes permit, use a 1/2" or 3/4" I.D. flexible stainless steel tubing gas connector, designed by CSA to connect the cooktop to the rigid gas supply line.



- A 1/2" male pipe thread is needed for connection to the female pipe threads of the inlet to the cooktop pressure regulator.
- Do not kink or damage the flexible metal tubing when moving the cooktop.

- Must include a shutoff valve:

The supply line must be equipped with a manual shutoff valve. This valve should be located in the same room but external to the cooktop opening, such as an adjacent cabinet. It must be accessible without removing the cooktop, and it should be in a location that allows ease of opening and closing. Do not block access to shutoff valve. The valve is for turning on or shutting off gas to the cooktop.

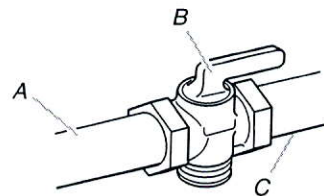

A. Gas supply line
B. Shutoff valve "open" position
C. To cooktop

[®]TEFLON is a registered trademark of E.I. Du Pont De Nemours and Company.

ELECTRICAL REQUIREMENTS

- A 120 volt, 60 Hz, AC only, 15-amp, fused electrical circuit is required. A time-delay fuse or circuit breaker is also recommended. It is recommended that a separate circuit serving only this cooktop be provided.
- Electronic ignition systems operate within wide voltage limits, but proper grounding and polarity are necessary. Check that the outlet provides 120-volt power and is correctly grounded.

PRODUCT DIMENSIONS

KCGS550ESS and KCGS950ESS Models

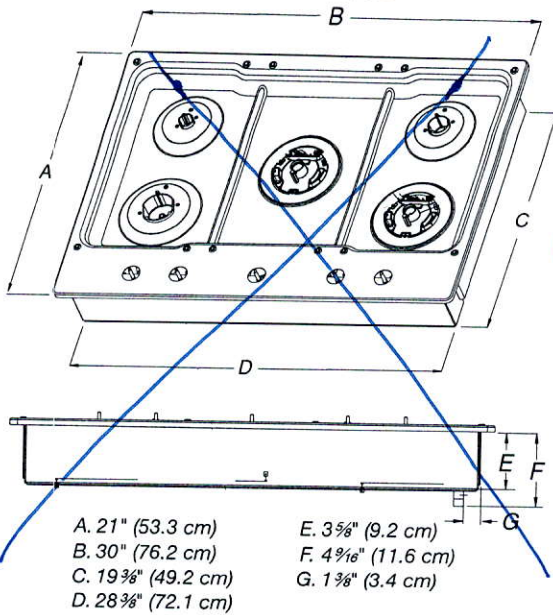

KCGS556ESS and KCGS956ESS Models

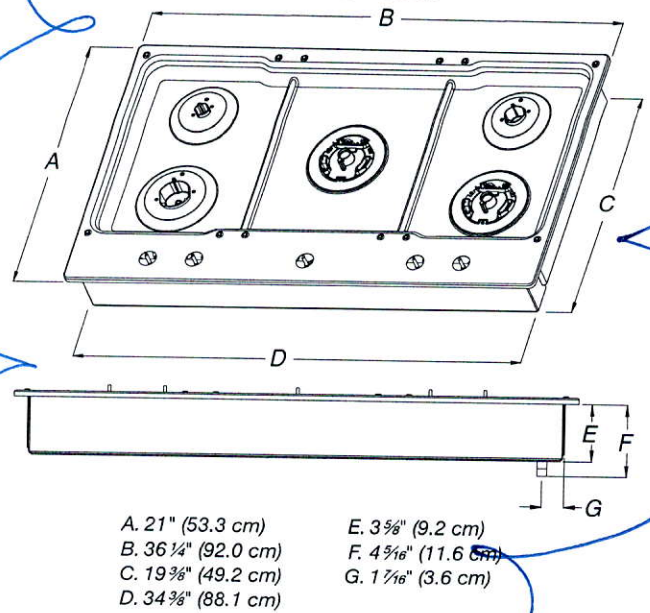

All Other 30" (76.2 cm) Models

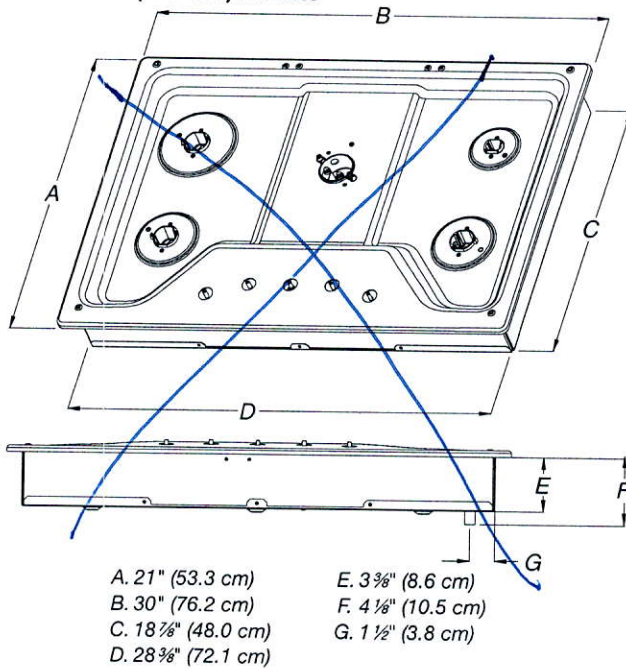

All Other 36" (91.4 cm) Models

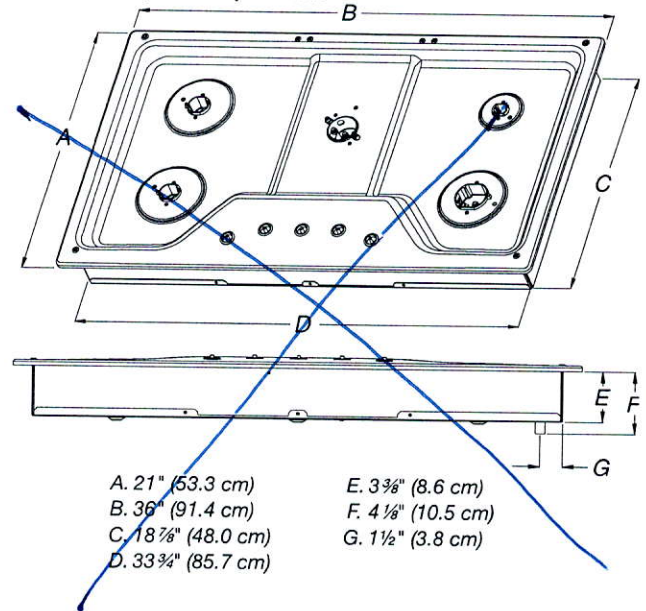

CABINET DIMENSIONS

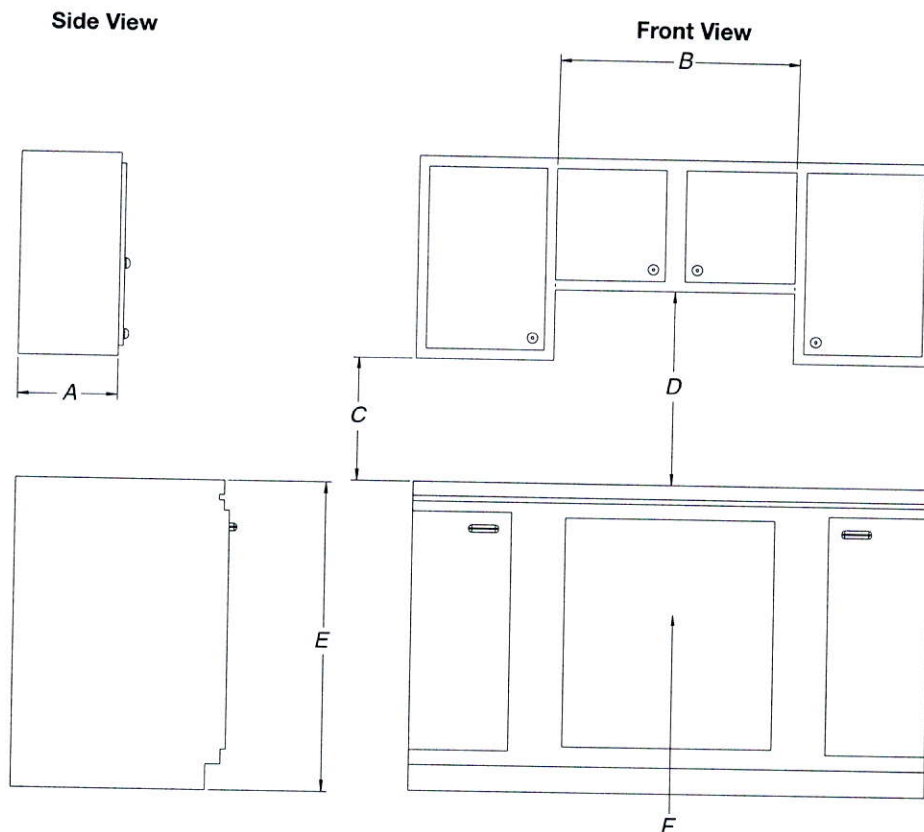

- A. 13" (33.0 cm) recommended upper cabinet depth.
- B. 30" (76.2 cm) for 30" models; 36" (91.4 cm) for 36" models.
- C. 18" (45.7 cm) minimum clearance from upper cabinet to countertop within minimum horizontal clearances to cooktop.
- D. 30" (76.2 cm) minimum clearance between top of cooktop platform and bottom of uncovered wood or metal cabinet. 24" [61 cm] minimum clearance if bottom of wood or metal cabinet is covered by not less than 1/4" [0.6 cm] flame retardant millboard covered with not less than No. 28 MSG sheet steel, 0.015" [0.04 cm] stainless steel, or 0.024" [0.06 cm] aluminum or 0.020" [0.05 cm] copper.
- E. 36" (91.4 cm) top of countertop to floor.
- F. Gas line opening - Wall: anywhere 5" (12.7 cm) below underside of countertop. Cabinet floor: anywhere within 6" (15.2 cm) of rear wall is recommended.

CABINET DIMENSIONS (cont.)

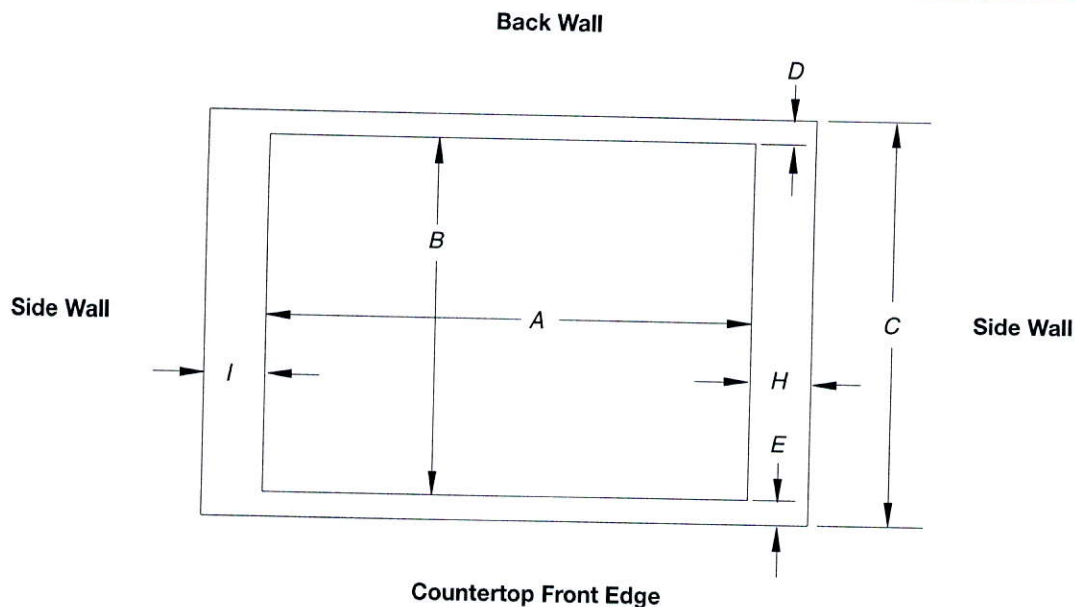

Cutout (Product Opening) Dimensions						
30" (76.2 cm) Models						
Models	A			B		
	Min	Recommended	Max	Min	Recommended	Max
KCGS550 and KCGS950	28 1/2" (72.4 cm)	28 7/8" (73.4 cm)	29 5/8" (74.3 cm)	19 1/2" (49.5 cm)	19 13/16" (50.2 cm)	20" (50.8 cm)
All Other 30" (76.2 cm) Models	28 1/2" (72.4 cm)	28 7/8" (73.4 cm)	29 5/8" (74.3 cm)	19" (48.3 cm)	19 1/2" (49.5 cm)	20" (50.8 cm)
36" (91.4 cm) Models						
KCGS556 and KCGS956	34 7/8" (88.4 cm)	35 3/8" (89.4 cm)	35 5/8" (90.3 cm)	19 1/2" (49.5 cm)	19 13/16" (50.2 cm)	20" (50.8 cm)
All Other 36" (91.4 cm) Models	33 7/8" (86.0 cm)	34 5/8" (87.0 cm)	35 1/4" (89.5 cm)	19" (48.3 cm)	19 1/2" (49.5 cm)	20" (50.8 cm)

Side Walls (Combustible Surfaces)	
Models	H and I
KCGS5 and KCGS9	H and I added together must be at least 48" (122.0 cm), with each side individually being at least 8" (20.3 cm).
KCGS350, KCGS356, MGC9536, WCG97US0, WCG97US6	H and I added together must be at least 48" (122.0 cm), with each side individually being at least 12" (30.5 cm).
All Other Models	Both have to be 8" (20.3 cm) or more.

Back Wall and Countertop Front Dimensions			
Models	C	D	E
KCGS550 and KCGS950	25" (63.5 cm)	2 7/8" (7.3 cm)	2 3/4" (6.9 cm)
All Other Models			3 1/8" (7.9 cm)

NOTES: After making the countertop cutout, some installations may require notching down the base cabinet side walls to clear the cooktop base. To avoid this modification, use a base cabinet with sidewalls wider than the cutout.

If cabinet has a drawer, a 4" (10.2 cm) depth clearance from the countertop to the top of the drawer (or other obstruction) in base cabinet is required. The drawer depth may need to be shortened to avoid interfering with the regulator.

IMPORTANT: If a built-in wall oven is to be installed below this cooktop, the grounded outlet and gas supply piping must be located in an adjacent cabinet.

This cooktop and its gas and electrical supply sources must be installed before the undercounter built-in wall oven is installed.

Product and Cabinet Opening Dimensions

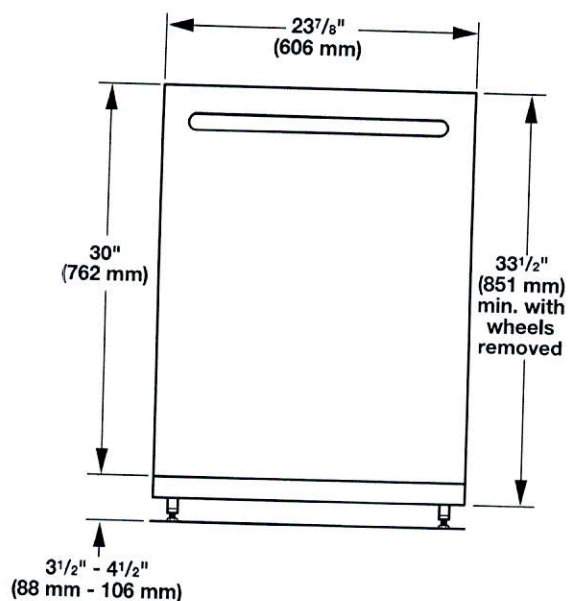

For 4" (100 mm) toe kick, height of cabinet opening is 34 ¹/₂" (863 mm).

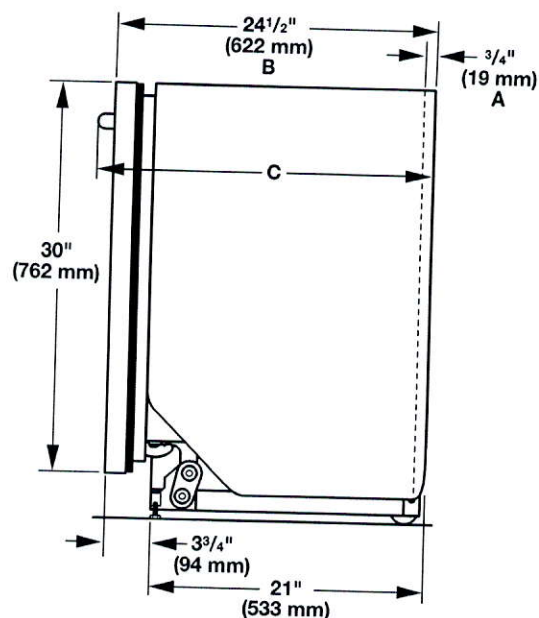

A. Insulation may be compressed (not used on all models).

B. For panel-ready models, dishwasher depth is 24" (610 mm), not including the 3/4" (19 mm) custom door panel.

C. Door handles may protrude forward of the face of the dishwasher, varies by model.

Check that all surfaces have no protrusions that would prohibit dishwasher installation.

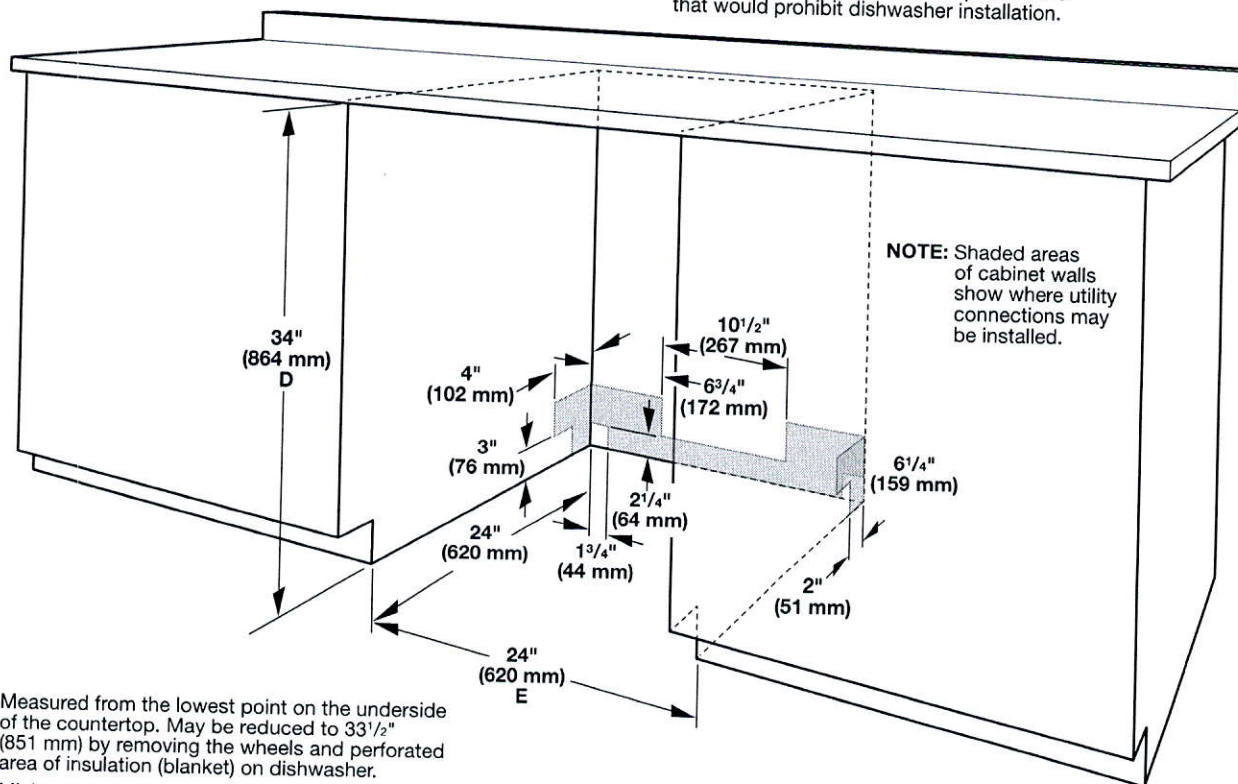

D. Measured from the lowest point on the underside of the countertop. May be reduced to 33 ¹/₂" (851 mm) by removing the wheels and perforated area of insulation (blanket) on dishwasher.

E. Minimum, measured from narrowest point of opening

DRAIN REQUIREMENTS

- A new drain hose is supplied with your dishwasher. If drain hose is not long enough, use a new drain hose with a maximum length of 12 ft (3.7 m) that meets all current AHAM/IAPMO test standards, is resistant to heat and detergent, and fits the 1" (25 mm) drain connector of the dishwasher. See the "Tools and Parts" section at the front of the guide for part details and orders.

NOTE: Do not connect multiple drain hoses together.

- Make sure to connect drain hose to waste tee or disposer inlet above drain trap in house plumbing and 20" (508 mm) minimum above the floor. It is recommended that the drain hose either be looped up and securely fastened to the underside of the counter or be connected to an air gap.
- Make sure to use an air gap if the drain hose is connected to house plumbing lower than 20" (508 mm) above subfloor or floor.

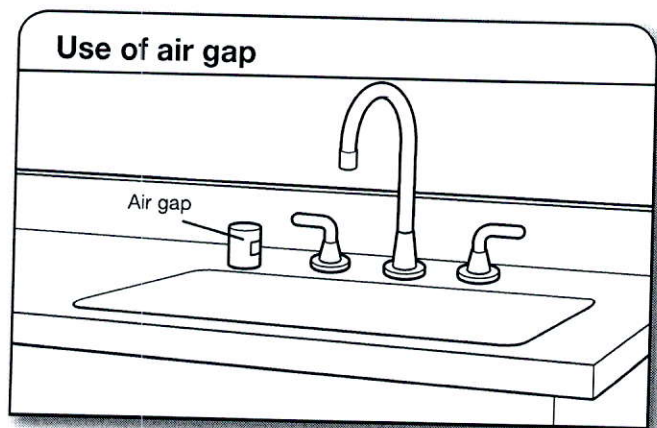

- If required, the air gap should be installed in accordance with the air gap installation instructions. When you are connecting the air gap, a rubber hose (not provided) will be needed to connect to the waste tee or disposer inlet.
- Use 1/2" minimum I.D. drain line fittings.

WATER SUPPLY REQUIREMENTS

- This dishwasher has a water heating feature and also requires a connection to a hot water supply line.
- A hot water line with 20 to 120 psi (138 to 862 kPa) water pressure can be verified by a licensed plumber.
- 120°F (49°C) water at dishwasher
- 3/8" O.D. copper tubing with compression fitting or flexible braided water supply line. See the "Tools and Parts" section at the front of the guide for part details and orders.

NOTE: 1/2" minimum plastic tubing is not recommended.

- A 90° elbow with 3/4" hose connection with rubber washer. See the "Tools and Parts" section at the front of the guide for part details and orders.
- Do not solder within 6" (152 mm) of the water inlet valve.
- If installed in new construction, make sure the house water supply lines have been flushed prior to connecting the dishwasher to remove any debris that may exist in the supply line.

NOTE: If replacing an existing dishwasher, it is recommended to install a new water line (see the "Tools and Parts" section at the front of the guide for part details) and drain hose (supplied) with the new dishwasher.

ELECTRICAL REQUIREMENTS

Be sure that the electrical connection and wire size are adequate and in conformance with the National Electrical Code, ANSI/NFPA 70 - latest edition, and all local codes and ordinances.

A copy of the above code standards can be obtained from:

National Fire Protection Association
1 Batterymarch Park
Quincy, MA 02169-7471

You Must Have:

- 120-volt, 60 Hz, AC-only, 15- or 20-amp, fused electrical supply
- Copper wire only
- A maximum of 2 field wiring supply conductors (12 AWG largest size) plus 1 grounding conductor are permitted in the terminal box.

We Recommend:

- A time-delay fuse or circuit breaker
- A separate circuit

If Connecting Dishwasher with a Power Cord:

- Use UL Listed power cord kit marked for use with dishwasher. See the "Tools and Parts" section at the front of the guide for part details and orders.
- Plug into a grounded 3 prong outlet. Outlet must meet all local codes and ordinances.



If Connecting Dishwasher with Direct Wiring:

- Use flexible, armored, or nonmetallic sheathed copper wire with grounding wire that meets the wiring requirements for your home and local codes and ordinances.
- Use a UL Listed/CSA Approved metallic strain relief. See the "Tools and Parts" section at the front of the guide for part details and orders.

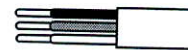

253 Lecco Ridge

Gas Line for BBQ.

Ada Plug

Ada Plug 5' from floor

Relocate standard Light

Close Opening

Center standard Light

Add enlarged Basement Window 30'x24'

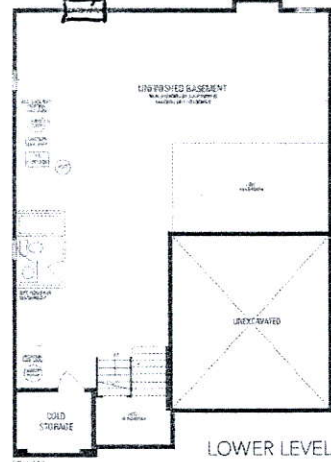

*Family Room + Living/Dining Angled Corners on Coffered Ceiling

★ *Amey* Dec. 15/16
★ *Jim* 12/16

JUNIPER 6

3,107 sq.ft. includes 102 sq.ft. of open area



Festive Plug

Jan. 17/2018

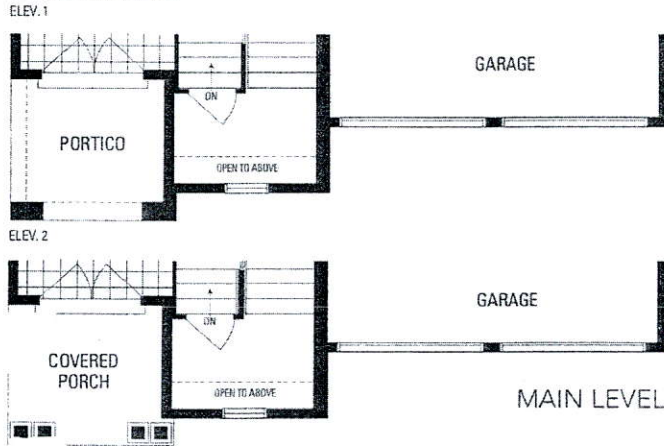

LOT 253

LECCO RIDGE

JUNIPER 6

ELEV. 3

REVISION:

1. MAKE ALL STONE AND STUCCO FRONT ELEVATION. NO BRICK ON FRONT.

Amor
Dec 15/16

SUBJECT TO FINAL ARCHITECTURAL CONTROL APPROVALS AT PERMIT APPLICATION

REVISE BRICK TO STUCCO

REVISE BRICK TO STONE

REVISE BRICK TO STONE

REVISE BRICK TO STONE



Festive Plug

Jan. 17/18
updated
Festive Plug
location

DEC 08 2016

FRONT ELEVATION 3

DISCLAIMERS: SKETCH NOT TO SCALE. DIMENSIONS, SPECIFICATIONS AND ARCHITECTURAL DETAILS SUBJECT TO MODIFICATION BY THE VENDOR. SKETCH IS ONLY FOR THE PURPOSE OF ILLUSTRATING REVISIONS REQUESTED BY THE PURCHASER AND ALL REVISIONS ARE SUBJECT TO VENDOR'S FINAL APPROVAL. ONLY REVISIONS ACCEPTED IN WRITING BY THE PURCHASER AND VENDOR ON A PURCHASER'S EXTRA SHEET WILL BE INCORPORATED INTO THE PLANS FILED WITH THE MUNICIPALITY. E. & O.E.

REGION
DESIGN
INC.

SCALE
N.T.S.
BY
PAGE NO.
1 OF 1

Greenpark.