



CONSTRUCTION SUMMARY

Saddle Ridge (G) - Lecco Ridge Developments Inc.

PURCHASER: NAMBY PROPERTIES operated by 7756593 CAN

TEL:

LOT / PHASE	REG. PLAN #	HOUSE TYPE		
Block 346 TH 3 / 1	20M-1184	Ivy 4 Elev 2		

CABINETY ACCESSORIES

1 - KITCHEN CABINETY UPPER - FULL DEPTH ABOVE FRIDGE - WITH GABLES - 600MM - PRICE IS EACH - STANDARD 08Jan18 Note:	
--	--

HARDWOOD FLOORING

1 - LAMINATE - PARK LANE SERIES - - UPPER HALL 08Jan18 Note:	
---	--

PLUMBING

1 - WATER LINE FOR FRIDGE - ROUGH-IN ONLY 08Jan18 Note:	
1 - WASHROOM - 3 PIECE ROUGH-IN IN BASEMENT 15Mar17 Note:	

PROMOTIONAL

1 - LESS CREDIT FROM PURCHASER EXTRA SHEET IN OFFER 08Jan18 Note:	
1 - PARTIAL REDEMPTION OF PROMOTIONAL PACKAGE \$640.00 BALANCE (\$4,360.00) FORWARD TO BE USED AT A LATER DATE. ORIGINAL PROMOTIONAL PACKAGE OF \$5,000.00 AS PER SCHEDULE PE. 15Mar17 Note:	

STAIRS AND RAILINGS

1 - EUROLINE 1 08Jan18 Note: BLACK IRON PICKETS	
1 - STAINED STAIRS, RAILING AND PICKETS - STANDARD STAIRCASE - PRICE IS PER SET 08Jan18 Note:	

EXTRAS AS PER OFFER

Five (5) White Appliances as per PE Appliances Worksheet Note:	
The Vendor agrees that notwithstanding any other term or provision in this Agreement included in the Purchase Price and in addition to those items detailed in Schedule GP to the Agreement of Purchase and Sale, the Purchaser is entitled to a credit of Fiv Worksheet Note:	
The Purchaser acknowledges that the Purchase Price is inclusive of all credits and promotional packages available at the time of purchase. Worksheet Note:	

This Document is Extremely Time Sensitive - Printed 8 Jan 18 at 11:19

RECEIVED JAN 09 2018

**Purchaser:** NAMBY PROPERTIES operated by 7756593 CAI **Property:** Block 346 TH 3  
**Telephone Res. / Bus:** / **Project:** Lecco Ridge Developments Inc.  
**Decor Advisor:** Natalie Mancuso **Model and Elevation:** Ivy 4 Elev 2  
**Lock Date:** 8-Jan-18 8-Jan-18 **Plan #:** 20M-1184

**Layout Changes:** ☐ Yes ☒ No **Sketch Attached:** ☒ Yes ☐ No **Exterior Colour Scheme:**

### 1. Cabinetry

	Style and Colour	Hardware
Kitchen / Breakfast	EVEREST WHITE	2004
Laundry Room	ELISSE	Standard
Powder Room	MODENA WHITE	2004
Master Ensuite Bathroom	MODENA WHITE	2004
Main Bathroom	MODENA WHITE	2004

**Appliances:** **Built In Appliances** ☐ Yes ☒ No **Slide In Stove** ☐ Yes ☒ No  
**Dishwasher Cabinet** ☐ Closed ☒ Open **41" Upper Cabinets** ☒ Yes ☐ No Please NOTE: Standard Cabinet Height is 30"  
**Stove Opening**  NOTE: If not specified, opening will be set to builder's standard opening of approximately 30" width  
**Fridge Opening**  NOTE: If not specified, opening will be set to builder's standard opening of approximately 37" width x 74" height

**\*\* Refer to Construction Summary**

### 2. Counters

	Counter	Edge
Kitchen / Breakfast	LAMINATE-CALCUTTA MARBLE 4925K-07	
Laundry Room		
Powder Room	LAMINATE-CARRARA BIANCO 6696-46	
Master Ensuite Bathroom	LAMINATE-BRONZITE 4971-52	
Main Bathroom	LAMINATE-PEARL SOAPSTONE 4886-38	

**\*\* Refer to Construction Summary**

Initial: 



Purchaser:

NAMBY PROPERTIES operated by 7756593 CAI

Property:

Block 346 TH 3

Telephone Res. / Bus:

/

Project:

Lecco Ridge Developments Inc.

Decor Advisor:

Natalie Mancuso

Model and Elevation:

Ivy 4 Elev 2

Lock Date:

8-Jan-18

8-Jan-18

Plan #:

20M-1184

3. Ceramic Flooring

		At a 45	Threshold-If App.
Entrance Vestibule	TILE- HABITAT SILVER GREY 12X12	<input type="checkbox"/>	
Main Hall	LAMINATE	<input type="checkbox"/>	
Kitchen / Breakfast	TILE- HABITAT SILVER GREY 12X12	<input type="checkbox"/>	METAL STRIP
Laundry Room	TILE- RAINBOW WHITE 13X13	<input type="checkbox"/>	METAL STRIP
Powder Room	TILE- SIENA IVORY 13X13	<input type="checkbox"/>	METAL STRIP
Master Ensuite Bathroom	TILE- RAINBOW WHITE 13X13	<input type="checkbox"/>	METAL STRIP
Main Bathroom	TILE- SIENA GREY 13X13	<input type="checkbox"/>	METAL STRIP
		<input type="checkbox"/>	
		<input type="checkbox"/>	
		<input type="checkbox"/>	
		<input type="checkbox"/>	

\*\* Refer to Construction Summary

4. Ceramic Wall Tile

Master Ensuite Bathroom	Selection	Describe
Tub Deck Wall	TILE- NATURALE GRIGIO 8X10	
Tub Deck		
Tub Deck Skirt		
Shower Stall	TILE- NATURALE GRIGIO 8X10	
Bathtub Enclosure Walls		
Main Bathroom	TILE- GOLF GRIGIO 8X10	
Kitchen Backsplash		

\*\* Refer to Construction Summary - STANDARD GROUT THROUGHOUT UNLESS SPECIFIED

5. Plumbing Fixtures

All Bathrooms

White

Whirlpool

☐ Yes ☒ No

Dishwasher Rough-In

☒ Yes ☐ No

Waterline for Fridge

☒ Yes ☐ No

\*\* Refer to Construction Summary

6. Trim Carpentry

Interior Doors	CLERMONT
Interior Trim	2 3/4" CASING WITH 4 1/4" BASEBOARD - COLONIAL
Door Handles	As Per Construction Specifications
Exterior Front Door Handle	As Per Construction Specifications

\*\* Refer to Construction Summary

Initial:



Purchaser:

NAMBY PROPERTIES operated by 7756593 CAI

Property:

Block 346 TH 3

Telephone Res. / Bus:

/

Project:

Lecco Ridge Developments Inc.

Decor Advisor:

Natalie Mancuso

Model and Elevation:

Ivy 4 Elev 2

Lock Date:

8-Jan-18

8-Jan-18

Plan #:

20M-1184

7. Other Flooring

Main Hall	LAMINATE-PARK LANE - CHOCOLATE WALNUT TL- U1222	
Living Room	LAMINATE-PARK LANE - CHOCOLATE WALNUT TL- U1222	
Dining Room	LAMINATE-PARK LANE - CHOCOLATE WALNUT TL- U1222	
Family Room	LAMINATE-PARK LANE - CHOCOLATE WALNUT TL- U1222	
Den / Library / Study		
Basement Landing(If Applies)		
Lower Landing (If Applies)	TILE- HABITAT SILVER GREY 12X12	
Upper Landing	LAMINATE-PARK LANE - CHOCOLATE WALNUT TL- U1222	
Upper Hall	LAMINATE-PARK LANE - CHOCOLATE WALNUT TL- U1222	
Master Bedroom	CARPET-SHAW - E0949 NEWBERN CLASSIC - DOVE 55700	
Bedroom #2	CARPET-SHAW - E0949 NEWBERN CLASSIC - DOVE 55700	
Bedroom #3	CARPET-SHAW - E0949 NEWBERN CLASSIC - DOVE 55700	
Bedroom #4		
Bedroom #5		
Underpad	Type	Area
	STANDARD	

\*\* Refer to Construction Summary

8. Railings and Pickets

Railing Type	AS PER CONSTRUCTION SPECIFICATIONS	Colour	TORLYS- CHOCOLATE WALNUT
Picket Type	EUROLINE 1	Colour	BLACK
Stringer / Riser	As Per Construction Specifications	Colour	TORLYS- CHOCOLATE WALNUT
Treads	Standard	Colour	TORLYS- CHOCOLATE WALNUT
Red Oak Stairs with Semi Gloss Finish			
		<input checked="" type="radio"/> Yes	<input type="radio"/> No

\*\* Refer to Construction Summary

9. Wall Paint Flat Finish

Main & Upper Hall	22 WARM GREY	Master Bedroom	BIRCH WHITE
Living Room	22 WARM GREY	Bedroom #2	BIRCH WHITE
Dining Room	22 WARM GREY	Bedroom #3	BIRCH WHITE
Kitchen / Breakfast	22 WARM GREY	Bedroom #4	
Family Room	22 WARM GREY	Bedroom #5	
Powder Room	22 WARM GREY	Master Ensuite	BIRCH WHITE
Laundry Room	BIRCH WHITE	Main Bathroom	BIRCH WHITE
Den/Library			
Trim Paint-Semi Gloss	BIRCH WHITE		

Smooth Ceilings First Floor

☐ Yes

☒ No

\*\* Refer to Construction Summary

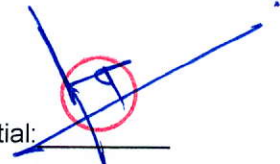
Initial: 



Purchaser: NAMBY PROPERTIES operated by 7756593 CAI Property: Block 346 TH 3  
Telephone Res. / Bus: / Project: Lecco Ridge Developments Inc.  
Decor Advisor: Natalie Mancuso Model and Elevation: Ivy 4 Elev 2  
Lock Date: 8-Jan-18 8-Jan-18 Plan #: 20M-1184

**10. Plaster Mouldings and Medallions**

Entrance Vestibule			Kitchen/Breakfast		
Main Hall			Den/Library		
Living Room			Lower Landing		
Dining Room					
Family Room					

**\*\* Refer to Construction Summary****11. Fireplace**

	Living Room			Family Room			Other Room - Specify		
	Purchased	As Per Plan	N/A	Purchased	As Per Plan	N/A	Purchased	As Per Plan	N/A
Fireplace Type	<input type="radio"/>	<input type="radio"/>	<input checked="" type="radio"/>	<input type="radio"/>	<input type="radio"/>	<input checked="" type="radio"/>	<input type="radio"/>	<input type="radio"/>	<input checked="" type="radio"/>
Mantle Type									
Colour / Stain									
Surround									
Hearth									

**\*\* Refer to Construction Summary****12. Heating and Air Conditioning**

Air Conditioning	NO	Gas Provisions Stove	NO
Gas Provisions Dryer	NO	Gas Provisions Barbecue	NO
Comment			

**\*\* Refer to Construction Summary****13. Electrical**

Plugs and Switches	<input checked="" type="radio"/> White	DECOR	Above Kitchen Cabinet Light	<input type="radio"/> Yes	<input checked="" type="radio"/> No
Hood Fan	STANDARD WHITE		Below Kitchen Cabinet Light	<input type="radio"/> Yes	<input checked="" type="radio"/> No
Appliances	Built in Cooktop	Built in Oven	Gas Stove	Microwave	
	<input type="radio"/> Yes <input checked="" type="radio"/> No	<input type="radio"/> Yes <input checked="" type="radio"/> No	<input type="radio"/> Yes <input checked="" type="radio"/> No	<input type="radio"/> Yes	<input checked="" type="radio"/> No
Dishwasher Rough-in	Yes				

**\*\* Refer to Construction Summary****14. General Comments****\*\* Refer to Construction Summary****Disclaimers and Notes**

- Colours of all materials are as close as possible to builder's selection, but not necessarily identical due to variances in manufacturing.
- Any extras listed above are null and void unless accompanied by a separate invoice/amendment. Said invoice must be paid in full.
- The Purchaser agrees that this colour selection is final and that no changes will be permitted, unless required by the Vendor.
- The Purchaser acknowledges reading and accepting document which contains other miscellaneous disclaimers.

Signature: 

Date: 8/Jan/2018

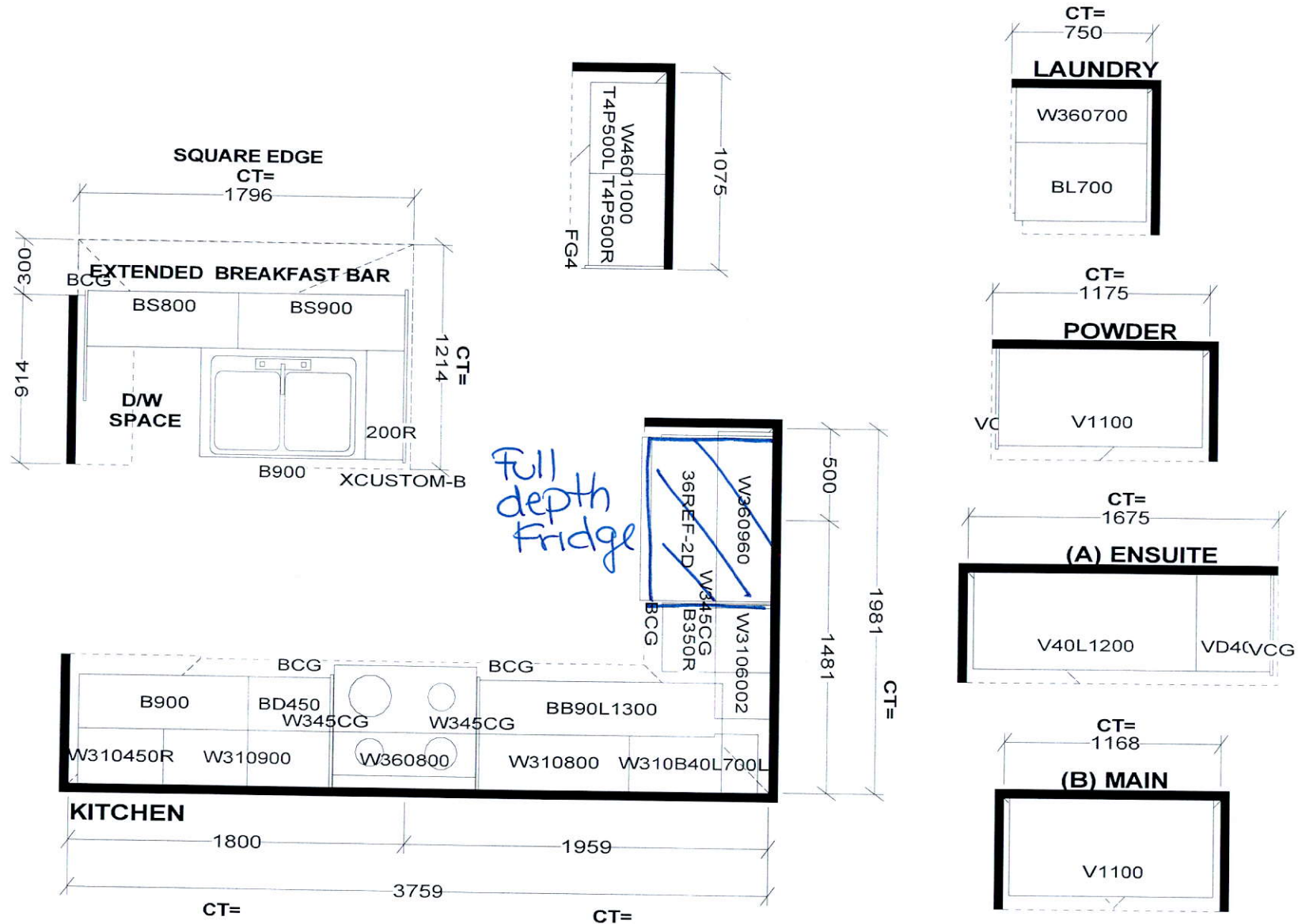

*Selba Industries*

**STANDARD FEATURES:**  
9' CEILINGS WITH D/C BOX  
1040MM HIGH UPPER CABINETS  
DISHWASHER SPACE  
DUMMY DOORS ON EXPOSED BACKS  
LAMINATE KITCHEN & VANITY COUNTERTOPS

This drawing is the intellectual property of SELBA INDUSTRIES INC. and is an original design which must not be released or copied unless applicable fee has been paid or job order placed.



**JOB NUMBER:**  
**BUILDER:** GREENPARK HOMES  
**SITE NAME:** LECCO RIDGE, Milton  
**MODEL:** IVY 4X ELEV 1, 1A, 2, 3  
**LOT #:**  
**DESIGNER:** KS  
**DATE:** FEB 13 17



**IVY 4** 1,846 SQ.FT.

AVAILABLE IN BLOCK: 323, 326, 327, 328, 330, 331,  
333, 336, 337, 343, 344, 345, 346, 348 & 349

