



CONSTRUCTION SUMMARY

Saddle Ridge (G) - Lecco Ridge Developments Inc.

PURCHASERS: ELIAS RMEILI and RACHEL CLAIRE MACCARONE

TEL: RES.: 905-220-6850

LOT / PHASE Block 348 TH 3 / 1	REG. PLAN # 20M-1184	HOUSE TYPE Ivy 4 Elev 1		
-----------------------------------	-------------------------	----------------------------	--	--

CABINETRY

1 - VANITIES - MONACO WITH UPGRADE STAIN - PRICE IS FOR ONE OR ALL BATHS - TOWNS 05Jan18 Note:	
1 - KITCHEN - DELETE CABINETS ABOVE STOVE - VENDOR WILL SUPPLY 6 INCH VENT AS PER CONSTRUCTION SPECIFICATIONS AND VENT MAY NOT BE IN THE APPROPRIATE LOCATION FOR INSTALLATION OF PURCHASER SUPPLIED VENT - PURCHASER TO SUPPLY OWN FAN AFTER CLOSING 05Jan18 Note:	
1 - CABINETRY - UPGRADE 2 - KITCHEN 05Jan18 Note:	

CABINETRY ACCESSORIES

1 - KITCHEN CABINETRY UPPER - FULL DEPTH ABOVE FRIDGE - WITH GABLES - 600MM - PRICE IS EACH - UPGRADE 2 05Jan18 Note:	
1 - KITCHEN CABINETRY BASE - PIE CUT CORNER CABINET - BASE CABINETRY - UPGRADE 2 05Jan18 Note:	
1 - KITCHEN CABINETRY BASE - POT/PAN DRAWERS (CABINET) - UPGRADE 2 05Jan18 Note:	

CERAMIC TILE

1 - DELETE ALL CERAMIC BATHROOM ACCESSORIES - DELETE TOWEL BAR, PAPER HOLDER & SOAP DISH THROUGHOUT 05Jan18 Note:	
--	--

ELECTRICAL

1 - RELOCATE STANDARD KITCHEN LIGHT TO BE CENTERED OVER ISLAND 05Jan18 Note:	
1 - STANDARD DINING ROOM LIGHT TO BE CENTERED BETWEEN LIVING AND DINING ROOM 05Jan18 Note:	
1 - PLUG - ELECTRICAL PLUG 05Jan18 Note: FAMILY ROOM - 5' FROM FLOOR FOR FUTURE TV - SEE SKETCH	

HARDWOOD FLOORING

1 - LAMINATE -UPGRADE TO CLASSIC PLUS SERIES IN LIEU OF STANDARD LAMINATE 05Jan18 Note:	
--	--

PLUMBING

1 - WATER LINE FOR FRIDGE - ROUGH-IN ONLY 05Jan18 Note:	
2 - MOEN BATHROOM ACCESSORIES - MASON CHROME - TOWEL BAR 24" #YB8094/YB8000 - PRICE IS EACH 05Jan18 Note: MAIN & MASTER ENSUITE BATHROOMS	
1 - MOEN BATHROOM ACCESSORIES - MASON CHROME - TOWEL RING #YB8086 - PRICE IS EACH 05Jan18 Note: POWDER ROOM	
3 - MOEN BATHROOM ACCESSORIES - MASON CHROME - PAPER HOLDER #YB8099/YB8000 - PRICE IS EACH 05Jan18 Note: ALL BATHROOMS	
1 - WASHROOM - 3 PIECE ROUGH-IN IN BASEMENT 09Mar17 Note:	

PROMOTIONAL

RECEIVED JAN 05 2018

CONSTRUCTION SUMMARY

Saddle Ridge (G) - Lecco Ridge Developments Inc.

PURCHASERS: ELIAS RMEILI and RACHEL CLAIRE MACCARONE

TEL: RES.: 905-220-6850

LOT / PHASE	REG. PLAN #	HOUSE TYPE		
Block 348 TH 3 / 1	20M-1184	Ivy 4 Elev 1		
1 - LESS BALANCE OF CREDIT FROM PURCHASER EXTRA SHEET IN OFFER 05Jan18 Note:				
1 - PARTIAL REDEMPTION OF PROMOTIONAL PACKAGE \$\$\$\$\$\$ BALANCE FORWARD TO BE USED AT A LATER DATE. ORIGINAL PROMOTIONAL PACKAGE OF \$\$\$\$ AS PER SCHEDULE PE DATED MMMDDYYYY. 09Mar17 Note: ORIGINAL PROMOTIONAL PACKAGE \$5,000.00 BALANCE FORWARD \$4,360.00				

STAIRS AND RAILINGS

1 - STAINED STAIRS, RAILING AND PICKETS – STANDARD STAIRCASE - PRICE IS PER SET 05Jan18 Note:	
--	--

EXTRAS AS PER OFFER

Five (5) White Appliances as per PE Appliances Worksheet Note:	
The Vendor agrees that notwithstanding any other term or provision in this Agreement included in the Purchase Price and in addition to those items detailed in Schedule GP to the Agreement of Purchase and Sale, the Purchaser is entitled to a credit of Fiv Worksheet Note:	
The Purchaser acknowledges that the Purchase Price is inclusive of all credits and promotional packages available at the time of purchase. Worksheet Note:	

This Document is Extremely Time Sensitive - Printed 5 Jan 18 at 12:20

Purchasers:ELIAS RMEILI & RACHEL CLAIRE MACCARONI

Property:Block 348 TH 3

Telephone Res. / Bus: (905) 220-6850 /

Project:Lecco Ridge Developments Inc.

Decor Advisor:Candace Forza

Model and Elevation:Ivy 4 Elev 1

Lock Date:5-Jan-185-Jan-18

Plan #:20M-1184

Layout Changes:☐ Yes ☒ No

Sketch Attached:☒ Yes ☐ No

Exterior Colour Scheme:

1. Cabinetry

	Style and Colour	Hardware
Kitchen / Breakfast	HAMPTON W823XZ4	2002
Laundry Room	ELISSE	Standard
Powder Room	MONACO W821XZ4	2004
Master Ensuite Bathroom	MONACO W823XZ4	2004
Main Bathroom	MONACO W823XZ4	2004
	N/A	N/A
	N/A	N/A
	N/A	N/A
	N/A	N/A

Appliances:

Built In Appliances☐ Yes ☒ No

Slide In Stove☐ Yes ☒ No

Dishwasher Cabinet☐ Closed ☒ Open

41" Upper Cabinets☒ Yes ☐ No

Please NOTE: Standard Cabinet Height is 30"

Stove Opening

NOTE: If not specified, opening will be set to builder's standard opening of approximately 30" width

Fridge Opening

NOTE: If not specified, opening will be set to builder's standard opening of approximately 37" width x 74" height

** Refer to Construction Summary

2. Counters

	Counter	Edge
Kitchen / Breakfast	LAMINATE-CARRARA BIANCO 6696-46	
Laundry Room	N/A	
Powder Room	LAMINATE-PEARL SOAPSTONE 4886-38	
Master Ensuite Bathroom	LAMINATE-CALCUTTA MARBLE 4925K-07	
Main Bathroom	LAMINATE-CALCUTTA MARBLE 4925K-07	
	N/A	
	N/A	
	N/A	
	N/A	

** Refer to Construction Summary

Purchasers: ELIAS RMEILI & RACHEL CLAIRE MACCARONI

Property: Block 348 TH 3

Telephone Res. / Bus: (905) 220-6850 /

Project: Lecco Ridge Developments Inc.

Decor Advisor: Candace Forza

Model and Elevation: Ivy 4 Elev 1

Lock Date: 5-Jan-18

5-Jan-18

Plan #: 20M-1184

3. Ceramic Flooring

		At a 45	Threshold-If App.
Entrance Vestibule	TILE-RAINBOW WHITE-13X13	<input type="checkbox"/>	
Main Hall	LAMINATE	<input type="checkbox"/>	
Kitchen / Breakfast	TILE-RAINBOW WHITE-13X13	<input type="checkbox"/>	METAL STRIP
Laundry Room	TILE-RAINBOW LIGHT GREY-13X13	<input type="checkbox"/>	METAL STRIP
Powder Room	TILE-RAINBOW WHITE-13X13	<input type="checkbox"/>	METAL STRIP
Master Ensuite Bathroom	TILE-RAINBOW LIGHT GREY-13X13	<input type="checkbox"/>	METAL STRIP
Main Bathroom	TILE-RAINBOW LIGHT GREY-13X13	<input type="checkbox"/>	METAL STRIP
SIDE ENTRY	TILE-RAINBOW WHITE-13X13	<input type="checkbox"/>	
	N/A	<input type="checkbox"/>	
	N/A	<input type="checkbox"/>	
	N/A	<input type="checkbox"/>	

** Refer to Construction Summary

4. Ceramic Wall Tile

Master Ensuite Bathroom	Selection	Describe
Tub Deck Wall	TILE-NATURALE GRIGIO-8X10	***LAID HORIZONTALLY***
Tub Deck	N/A	
Tub Deck Skirt	N/A	
Shower Stall	TILE-NATURALE GRIGIO-8X10	***LAID HORIZONTALLY***
Bathtub Enclosure Walls	N/A	
	N/A	
Main Bathroom	TILE-NATURALE GRIGIO-8X10	***LAID HORIZONTALLY***
	N/A	
	N/A	
	N/A	
Kitchen Backsplash	N/A	

** Refer to Construction Summary - STANDARD GROUT THROUGHOUT UNLESS SPECIFIED

5. Plumbing Fixtures

All Bathrooms	White	Whirlpool	
	N/A		N/A <input type="radio"/> Yes <input checked="" type="radio"/> No
	N/A		
	N/A		
	N/A		Dishwasher Rough-In <input checked="" type="radio"/> Yes <input type="radio"/> No
	N/A		Waterline for Fridge <input checked="" type="radio"/> Yes <input type="radio"/> No
	N/A		

** Refer to Construction Summary

6. Trim Carpentry

Interior Doors	CLERMONT
Interior Trim	2 3/4" CASING WITH 4 1/4" BASEBOARD - COLONIAL
Door Handles	As Per Construction Specifications
Exterior Front Door Handle	As Per Construction Specifications

** Refer to Construction Summary

Purchasers:

Telephone Res. / Bus:

Decor Advisor:

Lock Date:

ELIAS RMEILI & RACHEL CLAIRE MACCARONI

(905) 220-6850 /

Candace Forza

5-Jan-18

Property: Block 348 TH 3

Project: Lecco Ridge Developments Inc.

Model and Elevation: Ivy 4 Elev 1

Plan #: 20M-1184

7. Other Flooring

Main Hall	LAMINATE-CLASSIC PLUS - OLD OAK GREY QS-UM1382	
Living Room	LAMINATE-CLASSIC PLUS - OLD OAK GREY QS-UM1382	
Dining Room	LAMINATE-CLASSIC PLUS - OLD OAK GREY QS-UM1382	
Family Room	LAMINATE-CLASSIC PLUS - OLD OAK GREY QS-UM1382	
Den / Library / Study	N/A	
Basement Landing(If Applies)	N/A	
Lower Landing (If Applies)	N/A	
Upper Landing	LAMINATE-CLASSIC PLUS - OLD OAK GREY QS-UM1382	
Upper Hall	CARPET-SHAW - E0949 NEWBERN CLASSIC - TAUPE 55105	
Master Bedroom	CARPET-SHAW - E0949 NEWBERN CLASSIC - TAUPE 55105	
Bedroom #2	CARPET-SHAW - E0949 NEWBERN CLASSIC - TAUPE 55105	
Bedroom #3	CARPET-SHAW - E0949 NEWBERN CLASSIC - TAUPE 55105	
Bedroom #4	N/A	
Bedroom #5	N/A	
	N/A	
	N/A	
	N/A	
Underpad	Type	Area
	STANDARD	SECOND FLOOR ONLY

** Refer to Construction Summary

8. Railings and Pickets

Railing Type	As Per Construction Specifications	Colour	TORLYS OLD OAK GREY
Picket Type	As Per Construction Specifications	Colour	TORLYS OLD OAK GREY
Stringer / Riser	As Per Construction Specifications	Colour	TORLYS OLD OAK GREY
Treads	As Per Construction Specifications	Colour	TORLYS OLD OAK GREY
Red Oak Stairs with Semi Gloss Finish			<input checked="" type="radio"/> Yes <input type="radio"/> No

** Refer to Construction Summary

9. Wall Paint Flat Finish

Main & Upper Hall	43 BIRCH WHITE	Master Bedroom	43 BIRCH WHITE
Living Room	43 BIRCH WHITE	Bedroom #2	43 BIRCH WHITE
Dining Room	43 BIRCH WHITE	Bedroom #3	43 BIRCH WHITE
Kitchen / Breakfast	43 BIRCH WHITE	Bedroom #4	N/A
Family Room	43 BIRCH WHITE	Bedroom #5	N/A
Powder Room	43 BIRCH WHITE	Master Ensuite	43 BIRCH WHITE
Laundry Room	43 BIRCH WHITE	Main Bathroom	43 BIRCH WHITE
Den/Library	N/A	SIDE ENTRY	43 BIRCH WHITE
Trim Paint-Semi Gloss	BIRCH WHITE		N/A
	N/A		N/A
	N/A		N/A

Smooth Ceilings First Floor

☐ Yes

☒ No

** Refer to Construction Summary

Initials:





Purchasers:ELIAS RMEILI & RACHEL CLAIRE MACCARONI

Telephone Res. / Bus: (905) 220-6850 /

Decor Advisor: Candace Forza

Lock Date: 5-Jan-18

Property: Block 348 TH 3

Project: Lecco Ridge Developments Inc.

Model and Elevation: Ivy 4 Elev 1

5-Jan-18

Plan #: 20M-1184

10. Plaster Mouldings and Medallions

Entrance Vestibule	N/A	N/A	Kitchen/Breakfast	N/A	N/A
Main Hall	N/A	N/A	Den/Library	N/A	N/A
Living Room	N/A	N/A	Lower Landing	N/A	N/A
Dining Room	N/A	N/A		N/A	N/A
Family Room	N/A	N/A			

** Refer to Construction Summary

11. Fireplace

Living Room			Family Room			Other Room - Specify		
Purchased	As Per Plan	N/A	Purchased	As Per Plan	N/A	Purchased	As Per Plan	N/A
<input type="radio"/>	<input type="radio"/>	<input checked="" type="radio"/>	<input type="radio"/>	<input type="radio"/>	<input checked="" type="radio"/>	<input type="radio"/>	<input type="radio"/>	<input checked="" type="radio"/>
Fireplace Type	N/A		Fireplace Type	N/A		Fireplace Type	N/A	
Mantle Type	N/A		Mantle Type	N/A		Mantle Type	N/A	
Colour / Stain	N/A		Colour / Stain	N/A		Colour / Stain	N/A	
Surround	N/A		Surround	N/A		Surround	N/A	
Hearth	N/A		Hearth	N/A		Hearth	N/A	

** Refer to Construction Summary

12. Heating and Air Conditioning

Air Conditioning	NO	Gas Provisions Stove	NO
Gas Provisions Dryer	NO	Gas Provisions Barbecue	NO
Comment			

** Refer to Construction Summary

13. Electrical

Plugs and Switches	<input checked="" type="radio"/> White	DECOR	Above Kitchen Cabinet Light	<input type="radio"/> Yes <input checked="" type="radio"/> No
Hood Fan	STANDARD WHITE		Below Kitchen Cabinet Light	<input type="radio"/> Yes <input checked="" type="radio"/> No
Appliances	Built in Cooktop	Built in Oven	Gas Stove	Microwave
	<input type="radio"/> Yes <input checked="" type="radio"/> No	<input type="radio"/> Yes <input checked="" type="radio"/> No	<input type="radio"/> Yes <input checked="" type="radio"/> No	<input type="radio"/> Yes <input checked="" type="radio"/> No
Dishwasher Rough-in	Yes			

** Refer to Construction Summary

14. General Comments

** Refer to Construction Summary

Disclaimers and Notes

- 1) Colours of all materials are as close as possible to builder's selection, but not necessarily identical due to variances in manufacturing.
- 2) Any extras listed above are null and void unless accompanied by a separate invoice/amendment. Said invoice must be paid in full.
- 3) The Purchaser agrees that this colour selection is final and that no changes will be permitted, unless required by the Vendor.
- 4) The Purchaser acknowledges reading and accepting document which contains other miscellaneous disclaimers.

Signature:  Date: Jan 5/18

Signature:  Date: Jan 5/18

Page 4 of 4

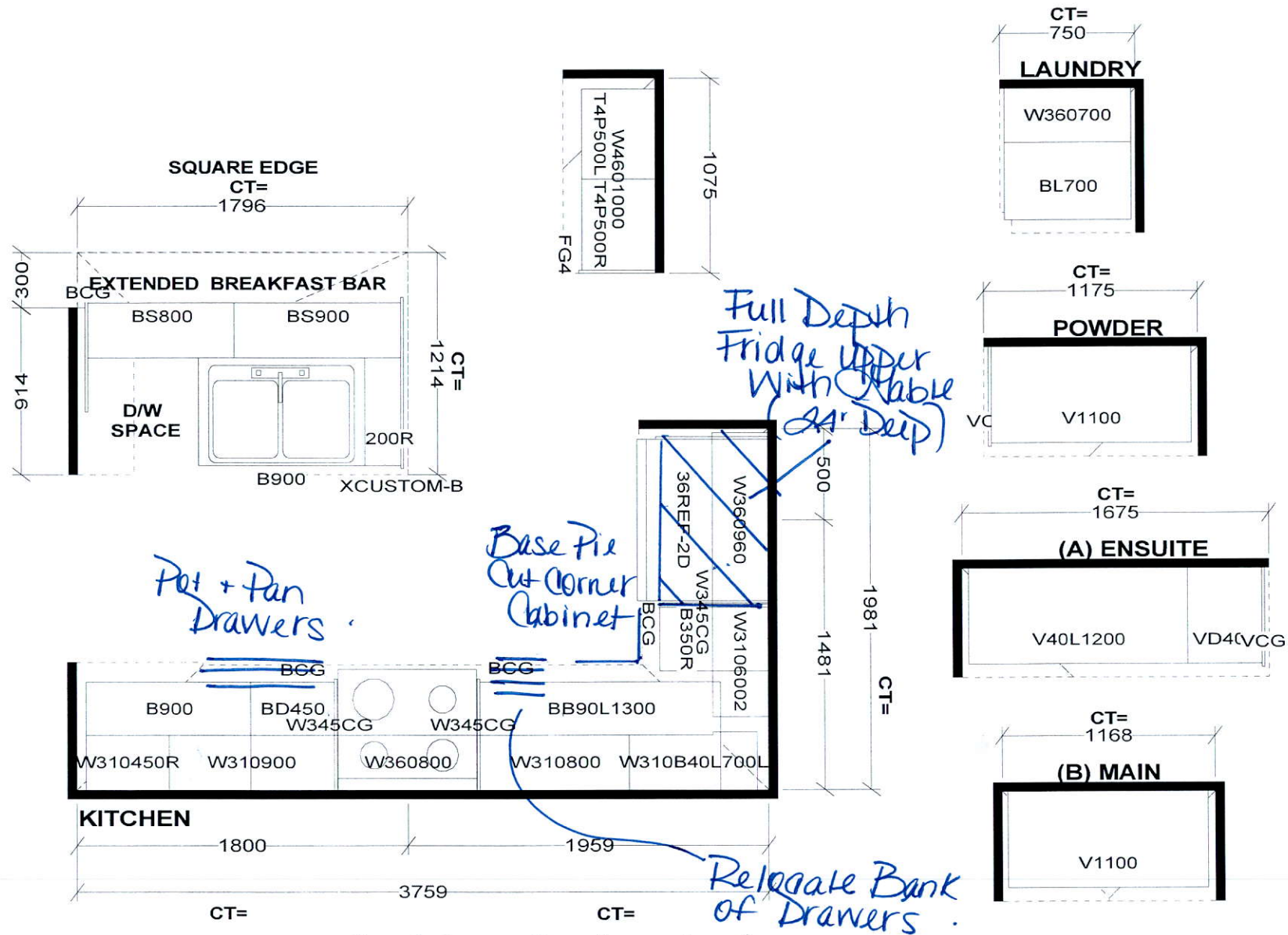

Selba Industries

STANDARD FEATURES:

9' CEILINGS WITH D/C BOX
1040MM HIGH UPPER CABINETS
DISHWASHER SPACE
DUMMY DOORS ON EXPOSED BACKS
LAMINATE KITCHEN & VANITY COUNTERTOPS

This drawing is the intellectual property of SELBA INDUSTRIES INC. and is an original design which must not be released or copied unless applicable fee has been paid or job order placed.



JOB NUMBER:
BUILDER: GREENPARK HOMES
SITE NAME: LECCO RIDGE, Milton
MODEL: IVY 4X ELEV 1, 1A, 2, 3
LOT #:
DESIGNER: KS
DATE: FEB 13 17

ER

IVY 4 1,846 SQ.FT.

AVAILABLE IN BLOCK: 323, 326, 327, 328, 330, 331, 333, 336, 337, 343, 344, 345, 346, 348 & 349

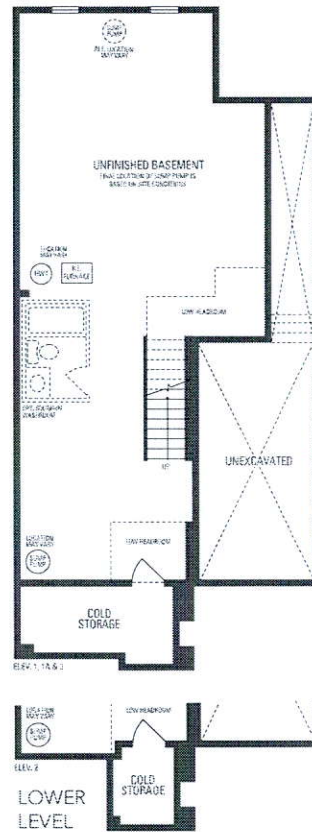

Rebate
Std.
Light

Center
Std.
Light

