



CONSTRUCTION SUMMARY

Saddle Ridge (G) - Lecco Ridge Developments Inc.

PURCHASER: 1800922 ONTARIO INC.

TEL:

LOT / PHASE Block 341 TH 1 / 1	REG. PLAN # 20M-1184	HOUSE TYPE Ivy 6E Elev 2		
-----------------------------------	-------------------------	-----------------------------	--	--

CABINETRY

1 - KITCHEN - MONACO CABINETRY WITH UPGRADE STAIN 04Dec17 Note:	
--	--

CABINETRY ACCESSORIES

1 - KITCHEN CABINETRY UPPER - FULL DEPTH ABOVE FRIDGE - WITH GABLES - 600MM - PRICE IS EACH - STANDARD 04Dec17 Note:	
---	--

COUNTER TOP

1 - HARD SURFACE COUNTERTOP - KITCHEN 04Dec17 Note:	
--	--

HARDWOOD FLOORING

1 - LAMINATE - UPGRADE TO LEXINGTON SERIES IN LIEU OF STANDARD LAMINATE 05Dec17 Note:	
--	--

PLUMBING

1 - SINK - UNDERMOUNT SINK - BLANCO HORIZON U2 8" #401234 04Dec17 Note:	
--	--

KITCHEN

PROMOTIONAL

1 - LESS CREDIT FROM PURCHASER EXTRA SHEET IN OFFER 04Dec17 Note:	
--	--

STAIRS AND RAILINGS

1 - STAINED STAIRS, RAILING AND PICKETS - STANDARD STAIRCASE - PRICE IS PER SET 04Dec17 Note:	
--	--

EXTRAS AS PER OFFER

The Purchaser acknowledges that the Purchase Price is inclusive of all credits and promotional packages available at the time of purchase. Worksheet Note:	
Five (5) White Appliances as per PE Appliances Worksheet Note:	
The Vendor agrees that notwithstanding any other term or provision in this Agreement included in the Purchase Price and in addition to those items detailed in Schedule GP to the Agreement of Purchase and Sale, the Purchaser is entitled to a credit of Fiv Worksheet Note:	

This Document is Extremely Time Sensitive - Printed 5 Dec 17 at 15:48

RECEIVED DEC 04 2017

Purchaser:1800922 ONTARIO INC.

Property:Block 341 TH 1

Telephone Res. / Bus: /

Project:Lecco Ridge Developments Inc.

Decor Advisor:Candace Forza

Model and Elevation:Ivy 6E Elev 2

Lock Date:4-Dec-17

4-Dec-17

Plan #:20M-1184

Layout Changes:☐ Yes☒ No

Sketch Attached:☒ Yes☐ No

Exterior Colour Scheme:

1. Cabinetry

	Style and Colour	Hardware
Kitchen / Breakfast	MONACO W823XZ4	2004
Laundry Room	ELISSE	Standard
Powder Room	EVEREST WHITE	1001
Master Ensuite Bathroom	MONACO W350XZ4	2004
Main Bathroom	MONACO W350XZ4	1001

Appliances:

Built In Appliances☐ Yes☒ No

Slide In Stove☐ Yes☒ No

Dishwasher Cabinet

☐ Closed☒ Open

41" Upper Cabinets☒ Yes☐ No

Please NOTE: Standard Cabinet Height is 30"

Stove Opening

NOTE: If not specified, opening will be set to builder's standard opening of approximately 30" width

Fridge Opening

NOTE: If not specified, opening will be set to builder's standard opening of approximately 37" width x 74" height

** Refer to Construction Summary

2. Counters

	Counter	Edge
Kitchen / Breakfast	QUARTZ-VICTORIA	PENCIL ROUND #320
Laundry Room	N/A	
Powder Room	LAMINATE-CALCUTTA MARBLE 4925K-07	
Master Ensuite Bathroom	LAMINATE-CARRARA BIANCO 6696-46	
Main Bathroom	LAMINATE-ARGENTO ROMANO 6697-46	

** Refer to Construction Summary

Purchaser:1800922 ONTARIO INC.

Property:Block 341 TH 1

Telephone Res. / Bus: /

Project:Lecco Ridge Developments Inc.

Decor Advisor:Candace Forza

Model and Elevation:Ivy 6E Elev 2

Lock Date:4-Dec-17

4-Dec-17

Plan #:20M-1184

3. Ceramic Flooring

		At a 45	Threshold-If App.
Entrance Vestibule	TILE-RAINBOW LIGHT GREY 13X13	<input type="checkbox"/>	
Main Hall	LAMINATE-LEXINGTON - HAZELWOOD OAK TL21016 - M	<input type="checkbox"/>	
Kitchen / Breakfast	TILE-RAINBOW LIGHT GREY 13X13	<input type="checkbox"/>	METAL STRIP
Laundry Room	TILE-RAINBOW LIGHT GREY 13X13	<input type="checkbox"/>	METAL STRIP
Powder Room	TILE-RAINBOW LIGHT GREY 13X13	<input type="checkbox"/>	METAL STRIP
Master Ensuite Bathroom	TILE-SIENA GREY 13X13	<input type="checkbox"/>	METAL STRIP
Main Bathroom	TILE-RAINBOW WHITE 13X13	<input type="checkbox"/>	METAL STRIP
		<input type="checkbox"/>	
		<input type="checkbox"/>	
		<input type="checkbox"/>	
		<input type="checkbox"/>	

** Refer to Construction Summary

4. Ceramic Wall Tile

Master Ensuite Bathroom	Selection	Describe
Tub Deck Wall	TILE-NATURALE GRIGIO 8X10	
Tub Deck		
Tub Deck Skirt		
Shower Stall	TILE-NATURALE GRIGIO 8X10	
Bathtub Enclosure Walls		
Main Bathroom	TILE-NATURALE GRIGIO 8X10	
Kitchen Backsplash	N/A	

** Refer to Construction Summary - STANDARD GROUT THROUGHOUT UNLESS SPECIFIED

5. Plumbing Fixtures

All Bathrooms

White

Whirlpool

☐ Yes☒ No

Dishwasher Rough-In

☒ Yes☐ No

Waterline for Fridge

☐ Yes☒ No

** Refer to Construction Summary

6. Trim Carpentry

Interior Doors	800 SERIES
Interior Trim	As Per Construction Specifications
Door Handles	As Per Construction Specifications
Exterior Front Door Handle	As Per Construction Specifications

** Refer to Construction Summary

Purchaser:1800922 ONTARIO INC.

Property:Block 341 TH 1

Telephone Res. / Bus: /

Project:Lecco Ridge Developments Inc.

Decor Advisor:Candace Forza

Model and Elevation:Ivy 6E Elev 2

Lock Date:4-Dec-17

4-Dec-17

Plan #:20M-1184

7. Other Flooring

Main Hall	
Living Room	LAMINATE-LEXINGTON - HAZELWOOD OAK TL21016 - M
Dining Room	LAMINATE-LEXINGTON - HAZELWOOD OAK TL21016 - M
Family Room	LAMINATE-LEXINGTON - HAZELWOOD OAK TL21016 - M
Den / Library / Study	N/A
Basement Landing(If Applies)	N/A
Lower Landing (If Applies)	LAMINATE-LEXINGTON - HAZELWOOD OAK TL21016 - M
Upper Landing	LAMINATE-LEXINGTON - HAZELWOOD OAK TL21016 - M
Upper Hall	CARPET-SHAW - E0949 NEWBERN CLASSIC - MORNING FOG 00530
Master Bedroom	CARPET-SHAW - E0949 NEWBERN CLASSIC - MORNING FOG 00530
Bedroom #2	CARPET-SHAW - E0949 NEWBERN CLASSIC - MORNING FOG 00530
Bedroom #3	CARPET-SHAW - E0949 NEWBERN CLASSIC - MORNING FOG 00530
Bedroom #4	CARPET-SHAW - E0949 NEWBERN CLASSIC - MORNING FOG 00530
Bedroom #5	N/A
Underpad	TypeArea

** Refer to Construction Summary

8. Railings and Pickets

Railing Type	AS PER CONSTRUCTION SPECIFICATIONS	Colour	TORLYS-HAZELWOOD OAK TL-21016-M
Picket Type	AS PER CONSTRUCTION SPECIFICATIONS	Colour	TORLYS-HAZELWOOD OAK TL-21016-M
Stringer / Riser	As Per Construction Specifications	Colour	TORLYS-HAZELWOOD OAK TL-21016-M
Treads	As Per Construction Specifications	Colour	TORLYS-HAZELWOOD OAK TL-21016-M
Red Oak Stairs with Semi Gloss Finish		<input checked="" type="radio"/> Yes <input type="radio"/> No	

** Refer to Construction Summary

9. Wall Paint Flat Finish

Main & Upper Hall	22 WARM GREY	Master Bedroom	22 WARM GREY
Living Room	22 WARM GREY	Bedroom #2	22 WARM GREY
Dining Room	22 WARM GREY	Bedroom #3	22 WARM GREY
Kitchen / Breakfast	22 WARM GREY	Bedroom #4	22 WARM GREY
Family Room	22 WARM GREY	Bedroom #5	N/A
Powder Room	22 WARM GREY	Master Ensuite	22 WARM GREY
Laundry Room	22 WARM GREY	Main Bathroom	22 WARM GREY
Den/Library			
Trim Paint-Semi Gloss	BIRCH WHITE		

Smooth Ceilings First Floor ☐ Yes ☒ No

** Refer to Construction Summary

Purchaser: 1800922 ONTARIO INC.
Telephone Res. / Bus: /
Decor Advisor: Candace Forza
Lock Date: 4-Dec-17

Property: Block 341 TH 1
Project: Lecco Ridge Developments Inc.
Model and Elevation: Ivy 6E Elev 2
Plan #: 20M-1184

10. Plaster Mouldings and Medallions

Entrance Vestibule	N/A		Kitchen/Breakfast	N/A	
Main Hall	N/A		Den/Library	N/A	
Living Room	N/A		Lower Landing	N/A	
Dining Room	N/A				
Family Room	N/A				

** Refer to Construction Summary

11. Fireplace

	Living Room			Family Room			Other Room - Specify		
	Purchased	As Per Plan	N/A	Purchased	As Per Plan	N/A	Purchased	As Per Plan	N/A
Fireplace Type	<input type="radio"/>	<input type="radio"/>	<input checked="" type="radio"/>	<input type="radio"/>	<input type="radio"/>	<input checked="" type="radio"/>	<input type="radio"/>	<input type="radio"/>	<input checked="" type="radio"/>
Mantle Type									
Colour / Stain									
Surround									
Hearth									

** Refer to Construction Summary

12. Heating and Air Conditioning

Air Conditioning	NO	Gas Provisions Stove	NO
Gas Provisions Dryer	NO	Gas Provisions Barbecue	NO
Comment			

** Refer to Construction Summary

13. Electrical

Plugs and Switches	<input checked="" type="radio"/> White	DECOR	Above Kitchen Cabinet Light	<input type="radio"/> Yes	<input checked="" type="radio"/> No
Hood Fan	STANDARD WHITE		Below Kitchen Cabinet Light	<input type="radio"/> Yes	<input checked="" type="radio"/> No
Appliances	Built in Cooktop	Built in Oven	Gas Stove	Microwave	
	<input type="radio"/> Yes <input checked="" type="radio"/> No	<input type="radio"/> Yes <input checked="" type="radio"/> No	<input type="radio"/> Yes <input checked="" type="radio"/> No	<input type="radio"/> Yes <input checked="" type="radio"/> No	
Dishwasher Rough-in	Yes				

** Refer to Construction Summary

14. General Comments

** Refer to Construction Summary

Disclaimers and Notes

- Colours of all materials are as close as possible to builder's selection, but not necessarily identical due to variances in manufacturing.
- Any extras listed above are null and void unless accompanied by a separate invoice/amendment. Said invoice must be paid in full.
- The Purchaser agrees that this colour selection is final and that no changes will be permitted, unless required by the Vendor.
- The Purchaser acknowledges reading and accepting document which contains other miscellaneous disclaimers.

Signature: _____ Date: _____

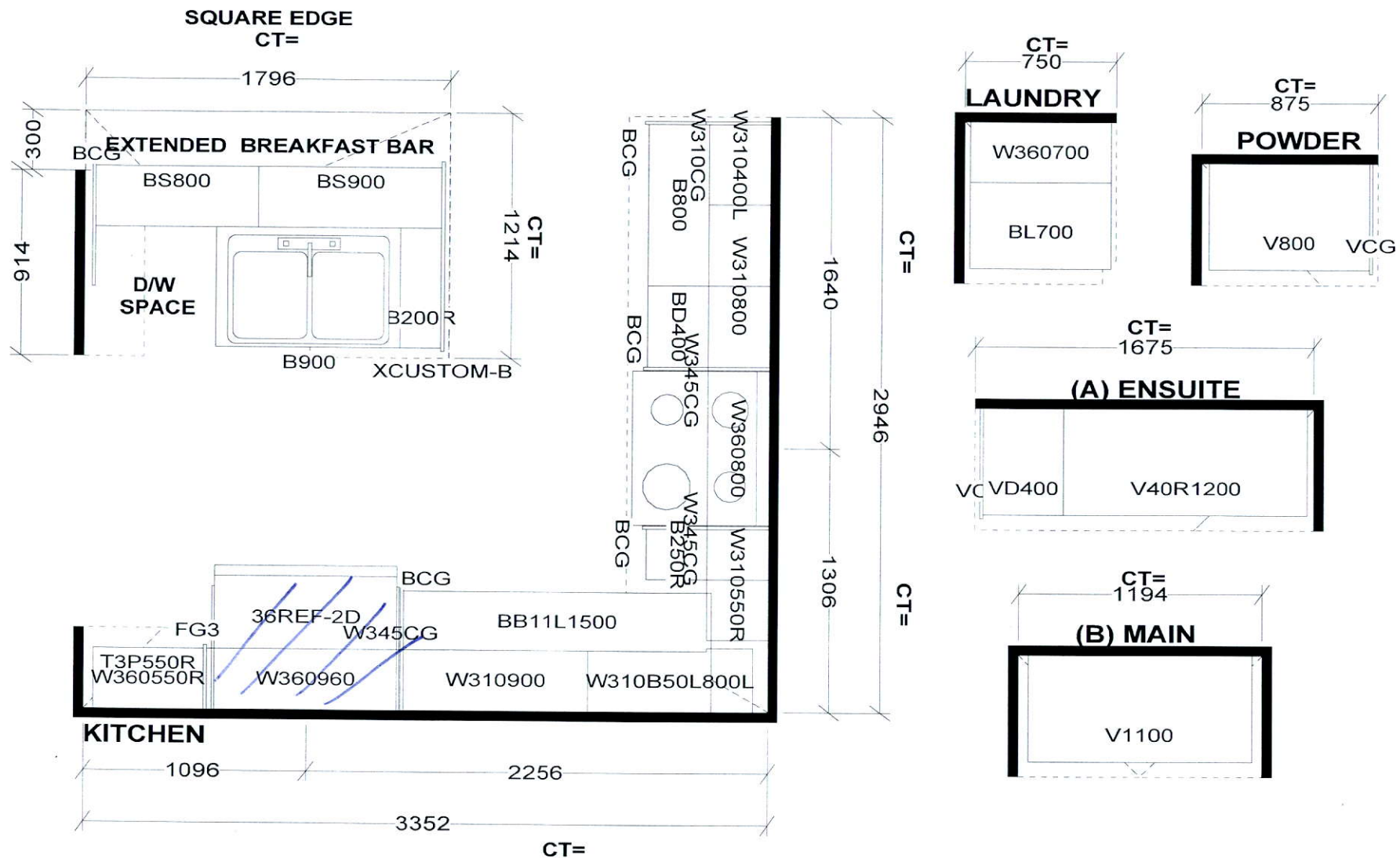

S e l b a I n d u s t r i e s

STANDARD FEATURES:

- 9' CEILINGS WITH D/C BOX
- 1040MM HIGH UPPER CABINETS
- DISHWASHER SPACE
- DUMMY DOORS ON EXPOSED BACKS
- LAMINATE KITCHEN & VANITY COUNTERTOPS

This drawing is the intellectual property of SELBA INDUSTRIES INC. and is an original design which must not be released or copied unless applicable fee has been paid or job order placed.



JOB NUMBER:
BUILDER: GREENPARK HOMES
SITE NAME: LECCO RIDGE, Milton
MODEL: IVY 6EX ELEV 1,2,3
LOT #:
DESIGNER: KS
DATE: FEB 13 17

IVY 6E 2,133 SQ.FT.

AVAILABLE IN BLOCK: 323, 332, 333, 334, 335, 336, 337
341, 342, 343 & 344

