

CONSTRUCTION SUMMARY

Saddle Ridge (G) - Lecco Ridge Developments Inc.



PURCHASERS: Muhammad Owais ALAM and Zarmeen QAZI

TEL:

LOT / PHASE 67 / 1	REG. PLAN # 20M-1184	HOUSE TYPE Juniper 12 Elev 1		
-----------------------	-------------------------	---------------------------------	--	--

CABINETRY

1 - KITCHEN - DELETE CABINETS ABOVE STOVE - VENDOR WILL SUPPLY 6 INCH VENT AS PER CONSTRUCTION SPECIFICATIONS AND VENT MAY NOT BE IN THE APPROPRIATE LOCATION FOR INSTALLATION OF PURCHASER SUPPLIED VENT - PURCHASER TO SUPPLY OWN FAN AFTER CLOSING 06Dec17 Note:	
1 - VANITIES - MONACO CABINETRY STAIN WITH UPGRADE STAIN - PRICE IS FOR ONE OR ALL BATHS - DETACHED 06Dec17 Note:	
1 - KITCHEN -MONACO CABINETRY WITH UPGRADE STAIN 06Dec17 Note:	

CONSTRUCTION

1 - PLEASE NOTE THAT NO FURTHER STRUCTURAL CHANGES WILL BE PERMITTED. 07Dec16 Note:	
1 - FIRST FLOOR INCREASE CEILING HEIGHT FROM 9 FEET TO 10 FEET 07Dec16 Note: The ceiling height is measured from the top of the unfinished subfloor to underside of the unfinished ceiling above before finishes and excluding bulkheads and drop ceilings as per plan.	

DOORS AND TRIM

1 - UPGRADE INTERIOR LEVERS TO WINSTON SATIN NICKEL THROUGHOUT HOUSE 06Dec17 Note:	
---	--

HARDWOOD FLOORING

1 - LAMINATE -UPGRADE TO LEXINGTON SERIES IN LIEU OF STANDARD LAMINATE 06Dec17 Note:	
1 - HARDWOOD – GROUP B SERIES 5 INCH - IN LIEU OF 2 1/4 INCH NATURAL RED OAK - - FIRST FLOOR COMPLETE 06Dec17 Note:	

PLUMBING

2 - TOE TESTER - ADD TOE TESTER TO SHOWER 06Nov17 Note: ADD TOE TESTER TO MASTER ENSUITE SHOWER AND BED 4 SHOWER	
---	--

PROMOTIONAL

1 - LESS CREDIT FROM PURCHASER EXTRA SHEET IN OFFER 07Dec16 Note:	
--	--

STAIRS AND RAILINGS

1 - STAINED STAIRS, RAILING AND PICKETS – STANDARD STAIRCASE - PRICE IS PER SET 06Dec17 Note:	
--	--

EXTRAS AS PER OFFER

The Vendor agrees that notwithstanding any other term or provision in this Agreement included in the Purchase Price and in addition to those items detailed in Schedule GP to the Agreement of Purchase and Sale, the Purchaser is entitled to a credit of Ten Worksheet Note:	
The Purchaser acknowledges that the Purchase Price is inclusive of all credits and promotional packages available at the time of purchase. Worksheet Note:	

This Document is Extremely Time Sensitive - Printed 6 Dec 17 at 15:43

RECEIVED DEC 12 2017

Greenpark™

INTERIOR COLOUR SCHEME

Purchasers:

Muhammad Owais ALAM & Zarmeen QAZI

Property: 67

Telephone Res. / Bus:

/

Project: Lecco Ridge Developments Inc.

Decor Advisor:

Natalie Mancuso

Model and Elevation: Juniper 12 Elev 1

Lock Date:

6-Dec-17

6-Dec-17

Plan #: 20M-1184

Layout Changes:

☐ Yes ☒ No

Sketch Attached:

☒ Yes ☐ No

Exterior Colour Scheme:

1. Cabinetry

	Style and Colour	Hardware
Kitchen / Breakfast	MONACO W823XZ4	2002
Laundry Room	ELISSE	Standard
Powder Room	MONACO W821XZ4	2002
Master Ensuite Bathroom	MONACO W821XZ4	2002
Ensuite Bath - Bedroom 2/3	MONACO W350XZ4	2002
Ensuite Bath - Bedroom 4	MONACO W821XZ4	2004

Appliances:

Built In Appliances

☐ Yes ☒ No

Slide In Stove

☐ Yes ☒ No

Dishwasher Cabinet

☐ Closed ☒ Open

41" Upper Cabinets

☒ Yes ☐ No

Please NOTE: Standard Cabinet Height is 30"

Stove Opening

NOTE: If not specified, opening will be set to builder's standard opening of approximately 30" width

Fridge Opening

NOTE: If not specified, opening will be set to builder's standard opening of approximately 37" width x 74" height

** Refer to Construction Summary

2. Counters

	Counter	Edge
Kitchen / Breakfast	LAMINATE-PALOMA POLAR 6698-46	
Laundry Room		
Powder Room	LAMINATE-WHITE TIGRIS 4783-60	
Master Ensuite Bathroom	LAMINATE-CARRARA BIANCO 6696-46	
Ensuite Bath - Bedroom 2/3	LAMINATE-CALCUTTA MARBLE 4925K-07	
Ensuite Bath - Bedroom 4	LAMINATE-ARGENTO ROMANO 6697-46	

** Refer to Construction Summary

Initials:

Page 1 of 4

Printed 12/6/2017 15:43:35

Purchasers:Muhammad Owais ALAM & Zarmeen QAZI

Property: 67

Telephone Res. / Bus: /

Project: Lecco Ridge Developments Inc.

Decor Advisor: Natalie Mancuso

Model and Elevation: Juniper 12 Elev 1

Lock Date: 6-Dec-17

6-Dec-17

Plan #: 20M-1184

3. Ceramic Flooring

At a 45 Threshold-If App.

Entrance Vestibule	TILE- ESSENZE GRIGIO 13X13	<input type="checkbox"/>	METAL STRIP
Main Hall	HARDWOOD	<input type="checkbox"/>	
Kitchen / Breakfast	TILE- ESSENZE GRIGIO 13X13	<input type="checkbox"/>	METAL STRIP
Laundry Room	TILE- SN PASTELLO WHITE 13X13	<input type="checkbox"/>	METAL STRIP
Powder Room	TILE- ESSENZE GRIGIO 13X13	<input type="checkbox"/>	METAL STRIP
Master Ensuite Bathroom	TILE- BEACH LIGHT GREY 13X13	<input type="checkbox"/>	METAL STRIP
Ensuite Bath - Bedroom 2/3	TILE- SN PASTELLO WHITE 13X13	<input type="checkbox"/>	BIANCO CARRARA
Ensuite Bath - Bedroom 4	TILE- RAINBOW WHITE 13X13	<input type="checkbox"/>	METAL STRIP
		<input type="checkbox"/>	
		<input type="checkbox"/>	
		<input type="checkbox"/>	

** Refer to Construction Summary

4. Ceramic Wall Tile

Master Ensuite Bathroom	Selection	Describe
Tub Deck Wall		
Tub Deck		
Tub Deck Skirt		
Shower Stall	TILE- PIXEL BIANCO 8X16	
Bathtub Enclosure Walls		
Ensuite Bath - Bedroom 2/3	TILE- PIXEL BIANCO 8X16	
Ensuite Bath - Bedroom 4	TILE- PIXEL GRIGIO 8X16	
Kitchen Backsplash		

** Refer to Construction Summary - STANDARD GROUT THROUGHOUT UNLESS SPECIFIED

5. Plumbing Fixtures

All Bathrooms

White

Whirlpool

☐ Yes ☒ No

Dishwasher Rough-In

☒ Yes ☐ No

Waterline for Fridge

☐ Yes ☒ No

** Refer to Construction Summary

6. Trim Carpentry

Interior Doors	800 SERIES
Interior Trim	3" BB CASING WITH 5 1/4" BASEBOARD - COLONIAL
Door Handles	SATIN NICKEL LEVER
Exterior Front Door Handle	As Per Construction Specifications

** Refer to Construction Summary

Initials:

M.A

Purchasers:

Muhammad Owais ALAM & Zarmeen QAZI

Property: 67

Telephone Res. / Bus:

/

Project: Lecco Ridge Developments Inc.

Decor Advisor:

Natalie Mancuso

Model and Elevation: Juniper 12 Elev 1

Lock Date:

6-Dec-17

6-Dec-17

Plan #: 20M-1184

7. Other Flooring

Main Hall	HARDWOOD- MIRAGE 5" ENGINEERED- RED OAK CHARACTER- DRIFTWOOD- DURAMATT	
Living Room	HARDWOOD- MIRAGE 5" ENGINEERED- RED OAK CHARACTER- DRIFTWOOD- DURAMATT	
Dining Room	HARDWOOD- MIRAGE 5" ENGINEERED- RED OAK CHARACTER- DRIFTWOOD- DURAMATT	
Family Room	HARDWOOD- MIRAGE 5" ENGINEERED- RED OAK CHARACTER- DRIFTWOOD- DURAMATT	
Den / Library / Study	HARDWOOD- MIRAGE 5" ENGINEERED- RED OAK CHARACTER- DRIFTWOOD- DURAMATT	
Basement Landing(If Applies)		
Lower Landing (If Applies)	TILE- ESSENZE GRIGIO 13X13	
Upper Landing	HARDWOOD- MIRAGE 5" ENGINEERED- RED OAK CHARACTER- DRIFTWOOD- DURAMATT	
Upper Hall	LAMINATE- LEXNGTON- HAZELWOOD OAK- TL2116-M	
Master Bedroom	LAMINATE- LEXNGTON- HAZELWOOD OAK- TL2116-M	
Bedroom #2	LAMINATE- LEXNGTON- HAZELWOOD OAK- TL2116-M	
Bedroom #3	LAMINATE- LEXNGTON- HAZELWOOD OAK- TL2116-M	
Bedroom #4	LAMINATE- LEXNGTON- HAZELWOOD OAK- TL2116-M	
Bedroom #5		
Underpad	Type	Area

** Refer to Construction Summary

8. Railings and Pickets

Railing Type	AS PER CONSTRUCTION SPECIFICATIONS	Colour	MIRAGE- DRIFTWOOD
Picket Type	1 3/4 PICKETS COLONIAL	Colour	MIRAGE- DRIFTWOOD
Stringer / Riser	As Per Construction Specifications	Colour	MIRAGE- DRIFTWOOD
Treads	Standard	Colour	MIRAGE- DRIFTWOOD
Red Oak Stairs with Semi Gloss Finish		<input checked="" type="radio"/> Yes <input type="radio"/> No	

** Refer to Construction Summary

9. Wall Paint Flat Finish

Main & Upper Hall	22 WARM GREY	Master Bedroom	22 WARM GREY
Living Room	22 WARM GREY	Bedroom #2	43 BIRCH WHITE
Dining Room	22 WARM GREY	Bedroom #3	43 BIRCH WHITE
Kitchen / Breakfast	22 WARM GREY	Bedroom #4	22 WARM GREY
Family Room	22 WARM GREY	Bedroom #5	
Powder Room	22 WARM GREY	Master Ensuite	22 WARM GREY
Laundry Room	43 BIRCH WHITE	Ensuite Bath - Bedroom 2/3	22 WARM GREY
Den/Library	22 WARM GREY	Ensuite Bath - Bedroom 4	22 WARM GREY
Trim Paint-Semi Gloss	BIRCH WHITE		

Smooth Ceilings First Floor

☐ Yes

☒ No

** Refer to Construction Summary

Initials: 

Purchasers:

Muhammad Owais ALAM & Zarmeen QAZI

Property: 67

Telephone Res. / Bus:

/

Project: Lecco Ridge Developments Inc.

Decor Advisor:

Natalie Mancuso

Model and Elevation: Juniper 12 Elev 1

Lock Date:

6-Dec-17

6-Dec-17

Plan #: 20M-1184

10. Plaster Mouldings and Medallions

Entrance Vestibule			Kitchen/Breakfast		
Main Hall			Den/Library		
Living Room			Lower Landing		
Dining Room					
Family Room					

** Refer to Construction Summary

11. Fireplace

Living Room			Family Room			Other Room - Specify		
Purchased	As Per Plan	N/A	Purchased	As Per Plan	N/A	Purchased	As Per Plan	N/A
<input type="radio"/>	<input type="radio"/>	<input checked="" type="radio"/>	<input type="radio"/>	<input checked="" type="radio"/>	<input type="radio"/>	<input type="radio"/>	<input type="radio"/>	<input checked="" type="radio"/>

Fireplace Type		FLAT ON WALL	
Mantle Type		MANTLE M2-STANDARD	
Colour / Stain		AS PER CONSTRUCTION SPECIFICATIONS	
Surround		GRIGIO CARNICO	
Hearth		NO	

** Refer to Construction Summary

12. Heating and Air Conditioning

Air Conditioning	NO	Gas Provisions Stove	NO
Gas Provisions Dryer	NO	Gas Provisions Barbecue	NO
Comment			

** Refer to Construction Summary

13. Electrical

Plugs and Switches	<input checked="" type="radio"/> White	DECOR	Above Kitchen Cabinet Light	<input type="radio"/> Yes	<input checked="" type="radio"/> No
Hood Fan	STANDARD WHITE		Below Kitchen Cabinet Light	<input type="radio"/> Yes	<input checked="" type="radio"/> No
Appliances	Built in Cooktop	Built in Oven	Gas Stove	Microwave	
	<input type="radio"/> Yes <input checked="" type="radio"/> No	<input type="radio"/> Yes <input checked="" type="radio"/> No	<input type="radio"/> Yes <input checked="" type="radio"/> No	<input type="radio"/> Yes	<input checked="" type="radio"/> No
Dishwasher Rough-in	Yes				

** Refer to Construction Summary

14. General Comments

** Refer to Construction Summary

Disclaimers and Notes

1) Colours of all materials are as close as possible to builder's selection, but not necessarily identical due to variances in manufacturing.

2) Any extras listed above are null and void unless accompanied by a separate invoice/amendment. Said invoice must be paid in full.

3) The Purchaser agrees that this colour selection is final and that no changes will be permitted, unless required by the Vendor.

4) The Purchaser acknowledges reading and accepting document which contains other miscellaneous disclaimers.

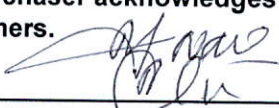
Signature: 

Date: 12/06/17

Signature:

Date:

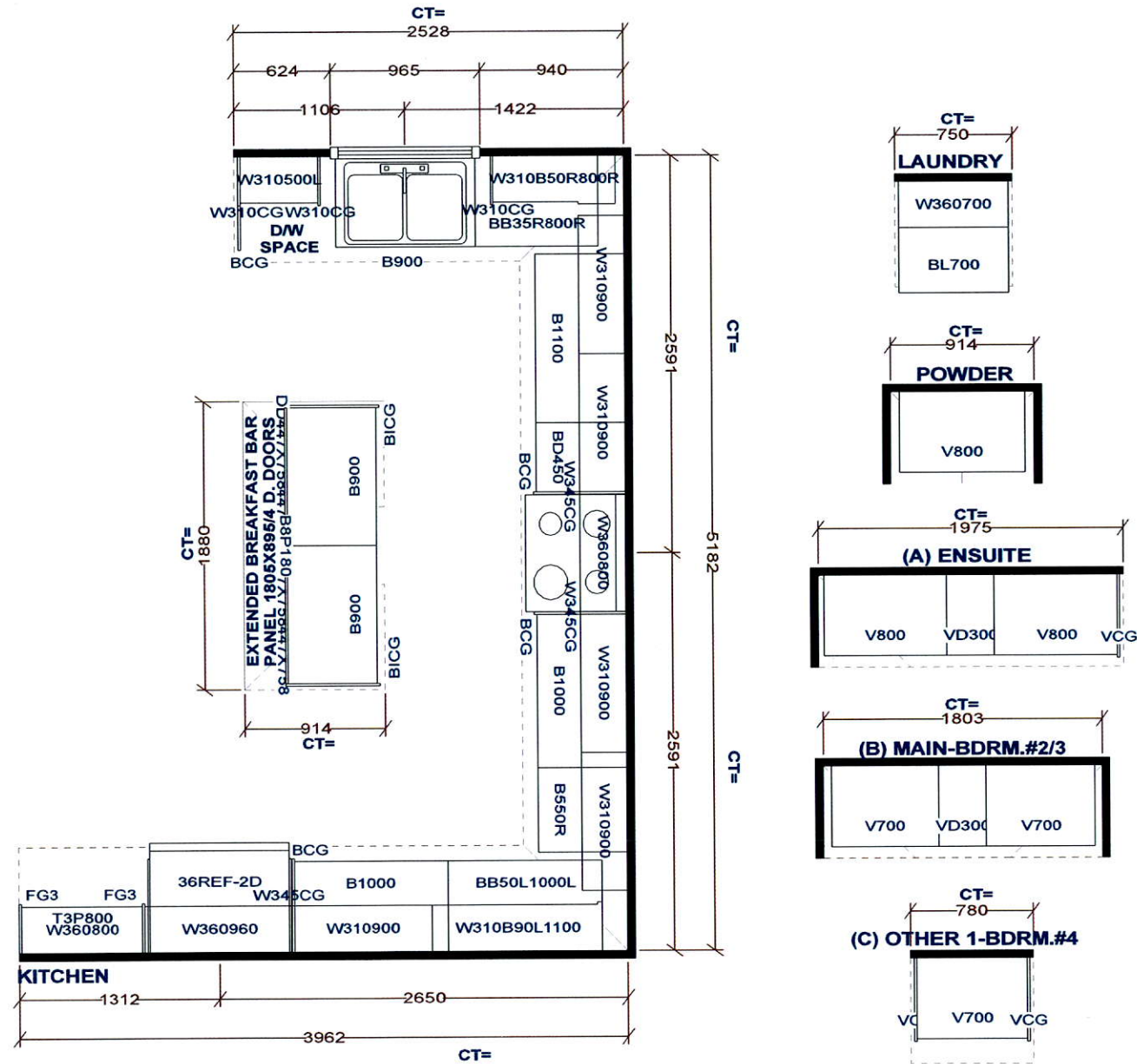

Selba Industries

<p>STANDARD FEATURES:</p> <p>9' CEILINGS WITH D/C BOX</p> <p>1040MM HIGH UPPER CABINETS</p> <p>DISHWASHER SPACE</p> <p>DUMMY DOORS ON EXPOSED BACKS</p> <p>LAMINATE KITCHEN & VANITY COUNTERTOPS</p>	<p>This drawing is the intellectual property of SELBA INDUSTRIES INC. and is an original design which must not be released or copied unless applicable fee has been paid or job order placed.</p>		<p>JOB NUMBER:</p> <p>BUILDER: GREENPARK HOMES</p> <p>SITE NAME: LECCO RIDGE, Milton</p> <p>MODEL: JUNIPER 12X ELEV 1,2</p> <p>LOT #:</p> <p>DESIGNER: KS</p> <p>DATE: FEB 13 17</p>
--	---	---	--

