

CONSTRUCTION SUMMARY

Saddle Ridge (G) - Lecco Ridge Developments Inc.

PURCHASERS: LUIS GERARDO AYALA CEREZO and MARIA GABRIELA ZODDA ORTUNA

TEL:

LOT / PHASE Block 349 TH 2 / 1	REG. PLAN # 20M-1184	HOUSE TYPE Ivy 4 Elev 3		
-----------------------------------	-------------------------	----------------------------	--	--

CABINETRY

1 - LIGHT VALENCE - KITCHEN 16Nov17 Note:	
--	--

CABINETRY ACCESSORIES

1 - KITCHEN CABINETRY BASE - SLIDE IN RANGE PROVISION 20Nov17 Note: Specs to follow Attached Nov. 23, 2017	
1 - KITCHEN CABINETRY UPPER - MICROWAVE SHELF STANDARD - 700MM WIDE - STANDARD 16Nov17 Note:	
1 - KITCHEN CABINETRY BASE - POT/PAN DRAWERS (CABINET) - STANDARD 16Nov17 Note:	
1 - KITCHEN CABINETRY UPPER - FULL DEPTH ABOVE FRIDGE - WITH GABLES - 600MM - PRICE IS EACH - STANDARD 16Nov17 Note:	

COUNTER TOP

1 - HARD SURFACE COUNTERTOP - KITCHEN 16Nov17 Note:	
--	--

ELECTRICAL

1 - PLUG - ELECTRICAL PLUG - FOR MICROWAVE SHELF 16Nov17 Note:	
---	--

PLUMBING

1 - SINK - UNDERMOUNT SINK - BLANCO HORIZON U2 8" #401234 16Nov17 Note: KITCHEN SINK	
1 - WASHROOM - 3 PIECE ROUGH-IN IN BASEMENT 21Dec16 Note:	

PROMOTIONAL

1 - LESS CREDIT FROM PURCHASER EXTRA SHEET IN OFFER 16Nov17 Note:	
1 - PARTIAL REDEMPTION OF PROMOTIONAL PACKAGE \$\$\$\$\$\$ BALANCE FORWARD TO BE USED AT A LATER DATE. ORIGINAL PROMOTIONAL PACKAGE OF \$\$\$\$ AS PER SCHEDULE PE DATED MMMDDYYYY. 21Dec16 Note: ORIGINAL PROMOTIONAL PACKAGE \$5,000.00 BALANCE FORWARD \$4,360.00	

STAIRS AND RAILINGS

1 - STAINED STAIRS, RAILING AND PICKETS – STANDARD STAIRCASE - PRICE IS PER SET 16Nov17 Note:	
--	--

EXTRAS AS PER OFFER

The Vendor agrees that notwithstanding any other term or provision in this Agreement included in the Purchase Price and in addition to those items detailed in Schedule GP to the Agreement of Purchase and Sale, the Purchaser is entitled to a credit of Fiv Worksheet Note:	
The Purchaser acknowledges that the Purchase Price is inclusive of all credits and promotional packages available at the time of purchase. Worksheet Note:	
Five (5) White Appliances as per PE Appliances Worksheet Note:	

RECEIVED NOV 21 2017

Greenpark

INTERIOR COLOUR SCHEME

Purchasers:

LUIS GERARDO AYALA CEREZO & MARIA GAB

Property:

Block 349 TH 2

Telephone Res. / Bus:

/

Project:

Lecco Ridge Developments Inc.

Decor Advisor:

Natalie Mancuso

Model and Elevation:

Ivy 4 Elev 3

Lock Date:

16-Nov-17

16-Nov-17

Plan #:

20M-1184

Layout Changes:

☐ Yes ☒ No

Sketch Attached:

☒ Yes ☐ No

Exterior Colour Scheme:

1. Cabinetry

	Style and Colour	Hardware
Kitchen / Breakfast	MODENA WHITE	2002
Laundry Room	ELISSE	Standard
Powder Room	MODENA WHITE	1001
Master Ensuite Bathroom	MONACO W350XZ4	1001
Main Bathroom	MODENA WHITE	1001

Appliances:

Built In Appliances

☐ Yes ☒ No

Slide In Stove

☒ Yes ☐ No

Dishwasher Cabinet

☐ Closed ☒ Open

41" Upper Cabinets

☒ Yes ☐ No

Please NOTE: Standard Cabinet Height is 30"

Stove Opening

NOTE: If not specified, opening will be set to builder's standard opening of approximately 30" width

Fridge Opening

NOTE: If not specified, opening will be set to builder's standard opening of approximately 37" width x 74" height

** Refer to Construction Summary

2. Counters

	Counter	Edge
Kitchen / Breakfast	QUARTZ- MOUNTAIN GREY	#320 PENCIL EDGE
Laundry Room		
Powder Room	LAMINATE-ARGENTO ROMANO 6697-46	
Master Ensuite Bathroom	LAMINATE-ARGENTO ROMANO 6697-46	
Main Bathroom	LAMINATE-CALCUTTA MARBLE 4925K-07	

** Refer to Construction Summary

Initials:

HS

MZ

Purchasers:

LUIS GERARDO AYALA CEREZO & MARIA GAB

Telephone Res. / Bus:

/

Decor Advisor:

Natalie Mancuso

Lock Date:

16-Nov-17

Property:

Block 349 TH 2

Project:

Lecco Ridge Developments Inc.

Model and Elevation:

Ivy 4 Elev 3

Plan #:

20M-1184

16-Nov-17

3. Ceramic Flooring

		At a 45	Threshold-If App.
Entrance Vestibule	TILE- RAINBOW WHITE 13X13	<input type="checkbox"/>	METAL STRIP
Main Hall	LAMINATE	<input type="checkbox"/>	
Kitchen / Breakfast	TILE- RAINBOW WHITE 13X13	<input type="checkbox"/>	METAL STRIP
Laundry Room	TILE- RAINBOW WHITE 13X13	<input type="checkbox"/>	METAL STRIP
Powder Room	TILE- RAINBOW WHITE 13X13	<input type="checkbox"/>	METAL STRIP
Master Ensuite Bathroom	TILE- RAINBOW LIGHT GREY 13X13	<input type="checkbox"/>	METAL STRIP
Main Bathroom	TILE- ESSENZE GRIGIO 13X13	<input type="checkbox"/>	METAL STRIP
		<input type="checkbox"/>	
		<input type="checkbox"/>	
		<input type="checkbox"/>	
		<input type="checkbox"/>	

** Refer to Construction Summary

4. Ceramic Wall Tile

Master Ensuite Bathroom	Selection	Describe
Tub Deck Wall	TILE- GOLF GRIGIO 8X10	
Tub Deck		
Tub Deck Skirt		
Shower Stall	TILE- GOLF GRIGIO 8X10	
Bathtub Enclosure Walls		
Main Bathroom	TILE- GOLF SCURO GRIGIO 8X10	
Kitchen Backsplash		

** Refer to Construction Summary - STANDARD GROUT THROUGHOUT UNLESS SPECIFIED

5. Plumbing Fixtures

All Bathrooms

White

Whirlpool

☐ Yes ☒ No

Dishwasher Rough-In

☒ Yes ☐ No

Waterline for Fridge

☐ Yes ☒ No

** Refer to Construction Summary

6. Trim Carpentry

Interior Doors	CLERMONT
Interior Trim	2 3/4" CASING WITH 4 1/4" BASEBOARD - COLONIAL
Door Handles	As Per Construction Specifications
Exterior Front Door Handle	As Per Construction Specifications

** Refer to Construction Summary

Initials:

NA

MT

Purchasers:

LUIS GERARDO AYALA CEREZO & MARIA GAB

Property:

Block 349 TH 2

Telephone Res. / Bus:

/

Project:

Lecco Ridge Developments Inc.

Decor Advisor:

Natalie Mancuso

Model and Elevation:

Ivy 4 Elev 3

Lock Date:

16-Nov-17

16-Nov-17

Plan #:

20M-1184

7. Other Flooring

Main Hall	LAMINATE-PARK LANE - HERITAGE OAK TL-U1386	
Living Room	LAMINATE-PARK LANE - HERITAGE OAK TL-U1386	
Dining Room	LAMINATE-PARK LANE - HERITAGE OAK TL-U1386	
Family Room	LAMINATE-PARK LANE - HERITAGE OAK TL-U1386	
Den / Library / Study	N/A	
Basement Landing(If Applies)	N/A	
Lower Landing (If Applies)	TILE- RAINBOW WHITE 13X13	
Upper Landing	LAMINATE-PARK LANE - HERITAGE OAK TL-U1386	
Upper Hall	CARPET-SHAW - E0949 NEWBERN CLASSIC - TAUPE 55105	
Master Bedroom	CARPET-SHAW - E0949 NEWBERN CLASSIC - TAUPE 55105	
Bedroom #2	CARPET-SHAW - E0949 NEWBERN CLASSIC - TAUPE 55105	
Bedroom #3	CARPET-SHAW - E0949 NEWBERN CLASSIC - TAUPE 55105	
Bedroom #4		
Bedroom #5		
Underpad	Type	Area
	STANDARD	SECOND FLOOR

** Refer to Construction Summary

8. Railings and Pickets

Railing Type	AS PER CONSTRUCTION SPECIFICATIONS	Colour	TORLYS- HERITAGE OAK
Picket Type	1 5/16 PICKETS SQUARE CHAMFERED	Colour	TORLYS- HERITAGE OAK
Stringer / Riser	As Per Construction Specifications	Colour	TORLYS- HERITAGE OAK
Treads	As Per Construction Specifications	Colour	TORLYS- HERITAGE OAK
Red Oak Stairs with Semi Gloss Finish		<input checked="" type="radio"/> Yes <input type="radio"/> No	

** Refer to Construction Summary

9. Wall Paint Flat Finish

Main & Upper Hall	22 WARM GREY	Master Bedroom	22 WARM GREY
Living Room	22 WARM GREY	Bedroom #2	22 WARM GREY
Dining Room	22 WARM GREY	Bedroom #3	22 WARM GREY
Kitchen / Breakfast	22 WARM GREY	Bedroom #4	
Family Room	22 WARM GREY	Bedroom #5	
Powder Room	22 WARM GREY	Master Ensuite	22 WARM GREY
Laundry Room	22 WARM GREY	Main Bathroom	22 WARM GREY
Den/Library			
Trim Paint-Semi Gloss	BIRCH WHITE		

Smooth Ceilings First Floor

☐ Yes

☒ No

** Refer to Construction Summary

Initials:

LGA

MZ

Purchasers:

LUIS GERARDO AYALA CEREZO & MARIA GAB

Property:

Block 349 TH 2

Telephone Res. / Bus:

/

Project:

Lecco Ridge Developments Inc.

Decor Advisor:

Natalie Mancuso

Model and Elevation:

Ivy 4 Elev 3

Lock Date:

16-Nov-17

16-Nov-17

Plan #:

20M-1184

10. Plaster Mouldings and Medallions

Entrance Vestibule

Main Hall

Living Room

Dining Room

Family Room

Kitchen/Breakfast

Den/Library

Lower Landing

** Refer to Construction Summary

11. Fireplace

Living Room

Purchased

As Per Plan

N/A

Family Room

Purchased

As Per Plan

N/A

Other Room - Specify

Purchased

As Per Plan

N/A

Fireplace Type

Mantle Type

Colour / Stain

Surround

Hearth

** Refer to Construction Summary

12. Heating and Air Conditioning

Air Conditioning

NO

Gas Provisions Stove

NO

Gas Provisions Dryer

NO

Gas Provisions Barbecue

NO

Comment

** Refer to Construction Summary

13. Electrical

Plugs and Switches

White

DECOR

Hood Fan

STANDARD WHITE

Appliances

Built in Cooktop

Built in Oven

Gas Stove

Microwave

Dishwasher Rough-in

Yes

Above Kitchen Cabinet Light

Yes

No

Below Kitchen Cabinet Light

Yes

No

Built in Cooktop

Yes

No

Built in Oven

Yes

No

Gas Stove

Yes

No

Microwave

Yes

No

** Refer to Construction Summary

14. General Comments

** Refer to Construction Summary

Disclaimers and Notes

1) Colours of all materials are as close as possible to builder's selection, but not necessarily identical due to variances in manufacturing.

2) Any extras listed above are null and void unless accompanied by a separate invoice/amendment. Said invoice must be paid in full.

3) The Purchaser agrees that this colour selection is final and that no changes will be permitted, unless required by the Vendor.

4) The Purchaser acknowledges reading and accepting document which contains other miscellaneous disclaimers.

Signature:

Date:

NOV 16/17

Signature:

Hang Guld Zada

Date:

Page 4 of 4

Printed 11/16/2017 15:25:15

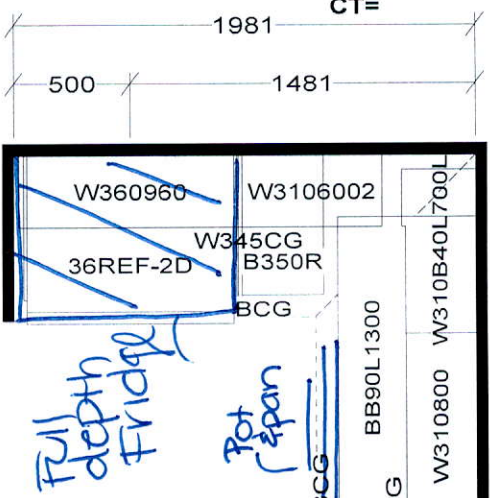
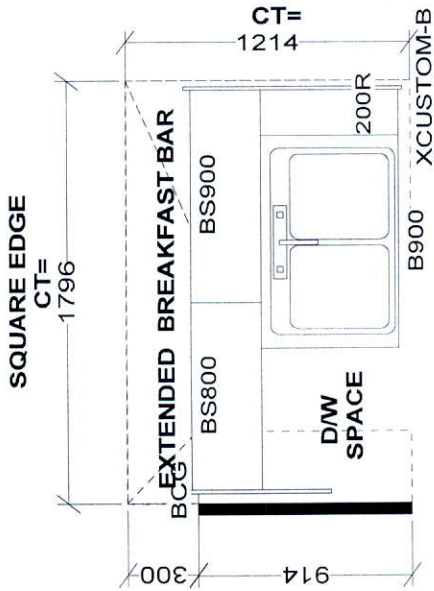
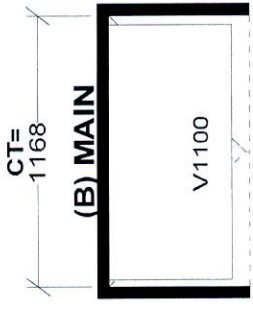
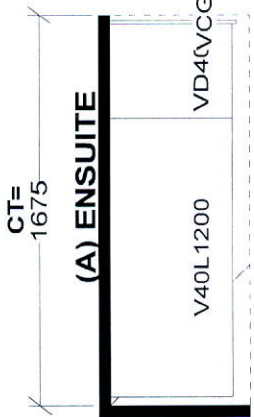
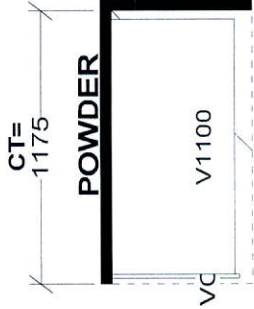
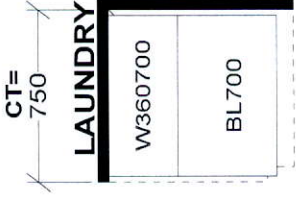
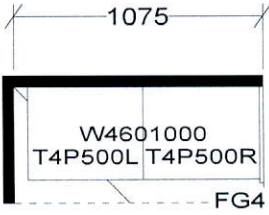

CT=

S e l b a I n d u s t r i e s

STANDARD FEATURES:

9' CEILINGS WITH D/C BOX
1040MM HIGH UPPER CABINETS
DISHWASHER SPACE
DUMMY DOORS ON EXPOSED BACKS
LAMINATE KITCHEN & VANITY COUNTERTOPS

This drawing is the intellectual property of SELBA INDUSTRIES INC. and is an original design which must not be released or copied unless applicable fee has been paid or job order placed.



JOB NUMBER:
BUILDER: GREENPARK HOMES
SITE NAME: LECCO RIDGE, Milton
MODEL: IVY 4X ELEV 1, 1A, 2, 3
LOT #:
DESIGNER: KS
DATE: FEB 13 17

IVY 4

1,846 SQ.FT.

AVAILABLE IN BLOCK: 323, 326, 327, 328, 330, 331, 333, 336, 337, 343, 344, 345, 346, 348 & 349

349 Th2

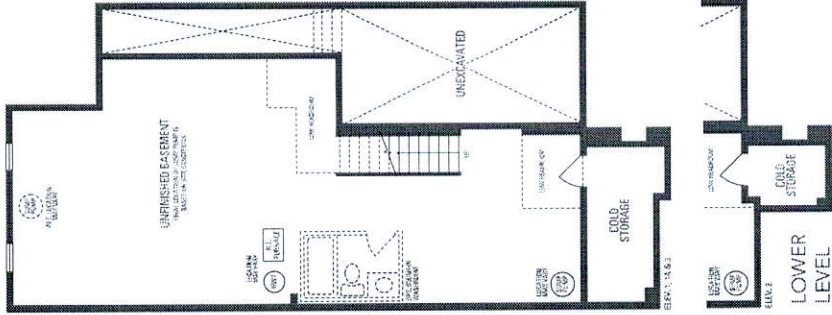

349 Th 2
Leclo

NE58F9500SS

5.8 cu. ft. Slide-in Electric Range

Installing Your Range

*30" minimum clearance between the top of the cooking surface and the bottom of an unprotected wood or metal cabinet; or 24" minimum when the bottom of the wood or metal cabinet is protected by not less than 1/4" flame-retardant millboard covered with not less than no. 28 MSG sheet steel, 0.015" stainless steel, 0.024" aluminum or 0.020" copper.

** 18" minimum between the countertop and the adjacent cabinet bottom.

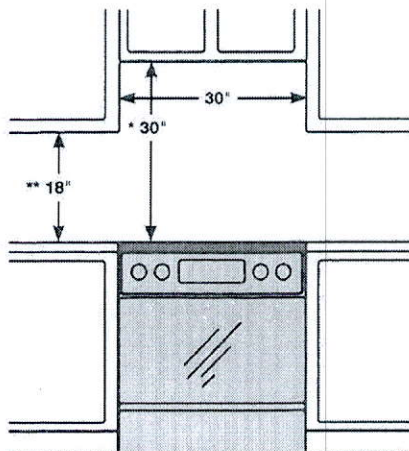

IMPORTANT: To eliminate the risk of burns or fire caused by reaching over heated surface units, cabinet storage space located above the surface units should be avoided. If cabinet storage is to be provided, the risk can be reduced by installing a range hood that projects horizontally a minimum of 5" beyond the bottom of the cabinets.

Dimensions

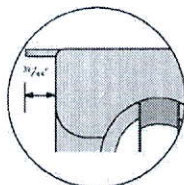
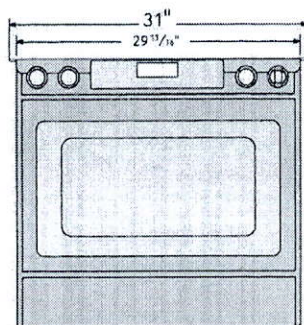

Glass cooktop overlaps and sits on top of your kitchen countertop to give a built-in look. Cutout space for the range is 29 13/16".

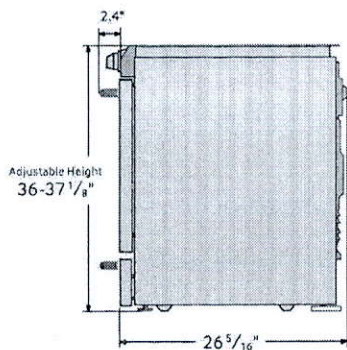

Electric Ceramic Cooktop

- Right Front: 9 1/2", 3.0 kW
- Left Front: 6 7/8", 3.0 kW
- Right Rear: 6", 1.2 kW
- Left Rear: 6", 1.2 kW
- Center: 100 W

Oven

- Hidden Bake Element: 3000 W
- Bake: 175°F-550°F
- Convection Bake: 175°F-550°F
- Convection Roast: 175°F-550°F
- Variable Broil (Low - High)
- Convection Element/Heater: 1250 W
- Proofing
- Sabbath Mode
- Storage Drawer Capacity - 0.7 cu. ft.

Warranty

One (1) Year All Parts and Labor
Five (5) Years Electric Cooktop

Product Dimensions & Weight (WxHxD)

Outside Dimensions:
31" x 36-37 1/8" (Adjustable) x 26 5/16"

Weight: 191.8 lbs.

Shipping Dimensions & Weight (WxHxD)

Dimensions:
33 1/16" x 41 5/4" x 30 5/16"

Weight: 216 lbs.

Color	Model #	UPC Code
Stainless Steel	NE58F9500SS	887276988191
Black Stainless Steel	NE58K9500SG	887276142876

SAMSUNG

Actual color may vary. Design, specifications, and color availability are subject to change without notice.
Non-metric weights and measurements are approximate.
©2016 Samsung Electronics America, Inc. 85 Challenger Road, Ridgefield Park, NJ 07660. Tel: 800-SAMSUNG, samsung.com
Samsung is a registered trademark of Samsung Electronics Co., Ltd.