

CONSTRUCTION SUMMARY

Saddle Ridge (G) - Lecco Ridge Developments Inc.



PURCHASERS: SYED MAQSOOD AHMED and NABILA MAQSOOD

TEL:

LOT / PHASE Block 346 TH 4 / 1	REG. PLAN # 20M-1184	HOUSE TYPE Ivy 4 Elev 2		
-----------------------------------	-------------------------	----------------------------	--	--

CABINETRY ACCESSORIES

1 - KITCHEN CABINETRY UPPER - FULL DEPTH ABOVE FRIDGE - WITH GABLES - 600MM - PRICE IS EACH - STANDARD 20Nov17 Note:	
---	--

CONSTRUCTION

1 - SMOOTH CEILINGS ON FIRST FLOOR ONLY 20Nov17 Note:	
--	--

ELECTRICAL

1 - STANDARD DINING ROOM LIGHT TO BE CENTERED BETWEEN LIVING AND DINING ROOM 20Nov17 Note:	
1 - ABOVE KITCHEN ISLAND - ADD LIGHT AND SWITCH - NO FIXTURE INCLUDED 20Nov17 Note:	
4 - POT LIGHT - LOW VOLTAGE LED - FIRST FLOOR INSTALLATION 20Nov17 Note: FAMILY ROOM - INSTALLED ON SEPERATE SWITCH FROM STANDARD LIGHT - SEE SKETCH	
4 - POT LIGHT - LOW VOLTAGE LED - FIRST FLOOR INSTALLATION 20Nov17 Note: LIVING/DINING ROOM - INSTALLED ON SEPERATE SWITCH FROM STANDARD LIGHT - SEE SKETCH	

HEATING AND AIR CONDITIONING

1 - AIR CONDITIONING - 13 SEER - 2 TON 20Nov17 Note:	
---	--

PLUMBING

1 - WASHROOM - 3 PIECE ROUGH-IN IN BASEMENT 22Feb17 Note:	
--	--

PROMOTIONAL

1 - LESS BALANCE OF CREDIT FROM PURCHASER EXTRA SHEET IN OFFER 20Nov17 Note:	
1 - PARTIAL REDEMPTION OF PROMOTIONAL PACKAGE \$\$\$\$\$\$ BALANCE FORWARD TO BE USED AT A LATER DATE. ORIGINAL PROMOTIONAL PACKAGE OF \$\$\$\$\$ AS PER SCHEDULE PE DATED MMMDDYYYY. 22Feb17 Note: ORIGINAL PROMOTIONAL PACKAGE \$5,000.00 BALANCE FORWARD \$4,360.00	

STAIRS AND RAILINGS

1 - STAINED STAIRS, RAILING AND PICKETS – STANDARD STAIRCASE - PRICE IS PER SET 20Nov17 Note:	
--	--

EXTRAS AS PER OFFER

Five (5) White Appliances as per PE Appliances Worksheet Note:	
The Vendor agrees that notwithstanding any other term or provision in this Agreement included in the Purchase Price and in addition to those items detailed in Schedule GP to the Agreement of Purchase and Sale, the Purchaser is entitled to a credit of Fiv Worksheet Note:	
The Purchaser acknowledges that the Purchase Price is inclusive of all credits and promotional packages available at the time of purchase. Worksheet Note:	

Purchasers:SYED MAQSOOD AHMED & NABILA MAQSOOD

Telephone Res. / Bus: /

Decor Advisor:Candace Forza

Lock Date:20-Nov-17

Property: Block 346 TH 4

Project: Lecco Ridge Developments Inc.

Model and Elevation: Ivy 4 Elev 2

20-Nov-17

Plan #: 20M-1184

Layout Changes: ☐ Yes ☒ No

Sketch Attached: ☒ Yes ☐ No

Exterior Colour Scheme:

1. Cabinetry

	Style and Colour	Hardware
Kitchen / Breakfast	MONACO W350XZ4	2002
Laundry Room	ELISSE	Standard
Powder Room	MONACO W350XZ4	2004
Master Ensuite Bathroom	MONACO W350XZ4	2004
Main Bathroom	MONACO W350XZ4	2004
	N/A	N/A
	N/A	N/A
	N/A	N/A
	N/A	N/A

Appliances:

Built In Appliances ☐ Yes ☒ No

Slide In Stove ☐ Yes ☒ No

Dishwasher Cabinet ☐ Closed ☒ Open

41" Upper Cabinets ☒ Yes ☐ No

Please NOTE: Standard Cabinet Height is 30"

Stove Opening

NOTE: If not specified, opening will be set to builder's standard opening of approximately 30" width

Fridge Opening

NOTE: If not specified, opening will be set to builder's standard opening of approximately 37" width x 74" height

** Refer to Construction Summary

2. Counters

	Counter	Edge
Kitchen / Breakfast	LAMINATE-CARRARA BIANCO 6696-46	
Laundry Room	N/A	
Powder Room	LAMINATE-WHITE CARRARA 4924-38	
Master Ensuite Bathroom	LAMINATE-WHITE CARRARA 4924-38	
Main Bathroom	LAMINATE-WHITE CARRARA 4924-38	
	N/A	
	N/A	
	N/A	
	N/A	

** Refer to Construction Summary

Initials: 

Purchasers:SYED MAQSOOD AHMED & NABILA MAQSOOD

Property: Block 346 TH 4

Telephone Res. / Bus: /

Project: Lecco Ridge Developments Inc.

Decor Advisor: Candace Forza

Model and Elevation: Ivy 4 Elev 2

Lock Date: 20-Nov-17

20-Nov-17

Plan #: 20M-1184

3. Ceramic Flooring

At a 45 Threshold-If App.

Entrance Vestibule	TILE-RAINBOW WHITE-13X13		
Main Hall	LAMINATE		
Kitchen / Breakfast	TILE-RAINBOW WHITE-13X13		METAL STRIP
Laundry Room	TILE-RAINBOW WHITE-13X13		
Powder Room	TILE-RAINBOW WHITE-13X13		METAL STRIP
Master Ensuite Bathroom	TILE-RAINBOW WHITE-13X13		METAL STRIP
Main Bathroom	TILE-RAINBOW WHITE-13X13		METAL STRIP
GARAGE ENTRY	TILE-RAINBOW WHITE-13X13		
	N/A		
	N/A		
	N/A		

** Refer to Construction Summary

4. Ceramic Wall Tile

Master Ensuite Bathroom	Selection	Describe
Tub Deck Wall	TILE-GOLF GRIGIO-8X10	***LAID HORIZONTALLY***
Tub Deck	N/A	
Tub Deck Skirt	N/A	
Shower Stall	TILE-GOLF GRIGIO-8X10	***LAID HORIZONTALLY***
Bathtub Enclosure Walls	N/A	
	N/A	
Main Bathroom	TILE-GOLF GRIGIO-8X10	***LAID HORIZONTALLY***
	N/A	
	N/A	
	N/A	
Kitchen Backsplash	N/A	

** Refer to Construction Summary - STANDARD GROUT THROUGHOUT UNLESS SPECIFIED

5. Plumbing Fixtures

All Bathrooms

White

N/A

N/A

N/A

N/A

N/A

Whirlpool

N/A Yes No

Dishwasher Rough-In

Yes No

Waterline for Fridge

Yes No

** Refer to Construction Summary

6. Trim Carpentry

Interior Doors	CLERMONT
Interior Trim	2 3/4" CASING WITH 4 1/4" BASEBOARD - COLONIAL
Door Handles	KNOB - SATIN NICKEL
Exterior Front Door Handle	SATIN NICKEL CHELSEA

** Refer to Construction Summary

7. Other Flooring

Purchasers:SYED MAQSOOD AHMED & NABILA MAQSOOD

Telephone Res. / Bus: /

Decor Advisor:Candace Forza

Lock Date:20-Nov-17

Property: Block 346 TH 4

Project: Lecco Ridge Developments Inc.

Model and Elevation: Ivy 4 Elev 2

Plan #: 20M-1184

7. Other Flooring

Main Hall	LAMINATE-PARK LANE - GREY VARNISHED OAK TL-U1305	
Living Room	LAMINATE-PARK LANE - GREY VARNISHED OAK TL-U1305	
Dining Room	LAMINATE-PARK LANE - GREY VARNISHED OAK TL-U1305	
Family Room	LAMINATE-PARK LANE - GREY VARNISHED OAK TL-U1305	
Den / Library / Study	N/A	
Basement Landing(If Applies)	N/A	
Lower Landing (If Applies)	N/A	
Upper Landing	LAMINATE-PARK LANE - GREY VARNISHED OAK TL-U1305	
Upper Hall	CARPET-SHAW - E0949 NEWBERN CLASSIC - MORNING FOG 00530	
Master Bedroom	CARPET-SHAW - E0949 NEWBERN CLASSIC - MORNING FOG 00530	
Bedroom #2	CARPET-SHAW - E0949 NEWBERN CLASSIC - MORNING FOG 00530	
Bedroom #3	CARPET-SHAW - E0949 NEWBERN CLASSIC - MORNING FOG 00530	
Bedroom #4	N/A	
Bedroom #5	N/A	
	N/A	
	N/A	
	N/A	
Underpad	Type	Area
	STANDARD	STANDARD

** Refer to Construction Summary

8. Railings and Pickets

Railing Type	As Per Construction Specifications	Colour	TORLYS GREY VARNISHED OAK
Picket Type	As Per Construction Specifications	Colour	TORLYS GREY VARNISHED OAK
Stringer / Riser	As Per Construction Specifications	Colour	TORLYS GREY VARNISHED OAK
Treads	As Per Construction Specifications	Colour	TORLYS GREY VARNISHED OAK
Red Oak Stairs with Semi Gloss Finish		<input checked="" type="radio"/> Yes <input type="radio"/> No	

** Refer to Construction Summary

9. Wall Paint Flat Finish

Main & Upper Hall	22 WARM GREY	Master Bedroom	22 WARM GREY
Living Room	22 WARM GREY	Bedroom #2	22 WARM GREY
Dining Room	22 WARM GREY	Bedroom #3	22 WARM GREY
Kitchen / Breakfast	22 WARM GREY	Bedroom #4	N/A
Family Room	22 WARM GREY	Bedroom #5	N/A
Powder Room	22 WARM GREY	Master Ensuite	22 WARM GREY
Laundry Room	22 WARM GREY	Main Bathroom	22 WARM GREY
Den/Library	N/A		N/A
Trim Paint-Semi Gloss	BIRCH WHITE		N/A
	N/A		N/A
	N/A		N/A

Smooth Ceilings First Floor ☒ Yes ☐ No

** Refer to Construction Summary

Initials: 

Purchasers:SYED MAQSOOD AHMED & NABILA MAQSOOD

Telephone Res. / Bus: /

Decor Advisor:Candace Forza

Lock Date:20-Nov-17

Property: Block 346 TH 4

Project: Lecco Ridge Developments Inc.

Model and Elevation: Ivy 4 Elev 2

20-Nov-17

Plan #: 20M-1184

10. Plaster Mouldings and Medallions

Entrance Vestibule	N/A	N/A	Kitchen/Breakfast	N/A	N/A
Main Hall	N/A	N/A	Den/Library	N/A	N/A
Living Room	N/A	N/A	Lower Landing	N/A	N/A
Dining Room	N/A	N/A		N/A	N/A
Family Room	N/A	N/A			

** Refer to Construction Summary

11. Fireplace

	Living Room			Family Room			Other Room - Specify		
	Purchased	As Per Plan	N/A	Purchased	As Per Plan	N/A	Purchased	As Per Plan	N/A
Fireplace Type	<input type="radio"/>	<input type="radio"/>	<input checked="" type="radio"/>	<input type="radio"/>	<input type="radio"/>	<input checked="" type="radio"/>	<input type="radio"/>	<input type="radio"/>	<input checked="" type="radio"/>
Mantle Type	N/A			N/A			N/A		
Colour / Stain	N/A			N/A			N/A		
Surround	N/A			N/A			N/A		
Hearth	N/A			N/A			N/A		

** Refer to Construction Summary

12. Heating and Air Conditioning

Air Conditioning	YES	Gas Provisions Stove	NO
Gas Provisions Dryer	NO	Gas Provisions Barbecue	NO
Comment			

** Refer to Construction Summary

13. Electrical

Plugs and Switches	<input checked="" type="radio"/> White	DECOR	Above Kitchen Cabinet Light	<input type="radio"/> Yes	<input checked="" type="radio"/> No
Hood Fan	STANDARD WHITE		Below Kitchen Cabinet Light	<input type="radio"/> Yes	<input checked="" type="radio"/> No
Appliances	Built in Cooktop	Built in Oven	Gas Stove	Microwave	
	<input type="radio"/> Yes <input checked="" type="radio"/> No	<input type="radio"/> Yes <input checked="" type="radio"/> No	<input type="radio"/> Yes <input checked="" type="radio"/> No	<input type="radio"/> Yes <input checked="" type="radio"/> No	
Dishwasher Rough-in	Yes				

** Refer to Construction Summary

14. General Comments

** Refer to Construction Summary

Disclaimers and Notes

- Colours of all materials are as close as possible to builder's selection, but not necessarily identical due to variances in manufacturing.
- Any extras listed above are null and void unless accompanied by a separate invoice/amendment. Said invoice must be paid in full.
- The Purchaser agrees that this colour selection is final and that no changes will be permitted, unless required by the Vendor.
- The Purchaser acknowledges reading and accepting document which contains other miscellaneous disclaimers.

Signature:  Date: Nov 20/17 Signature: _____ Date: _____

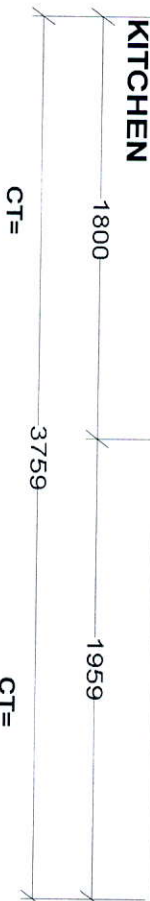
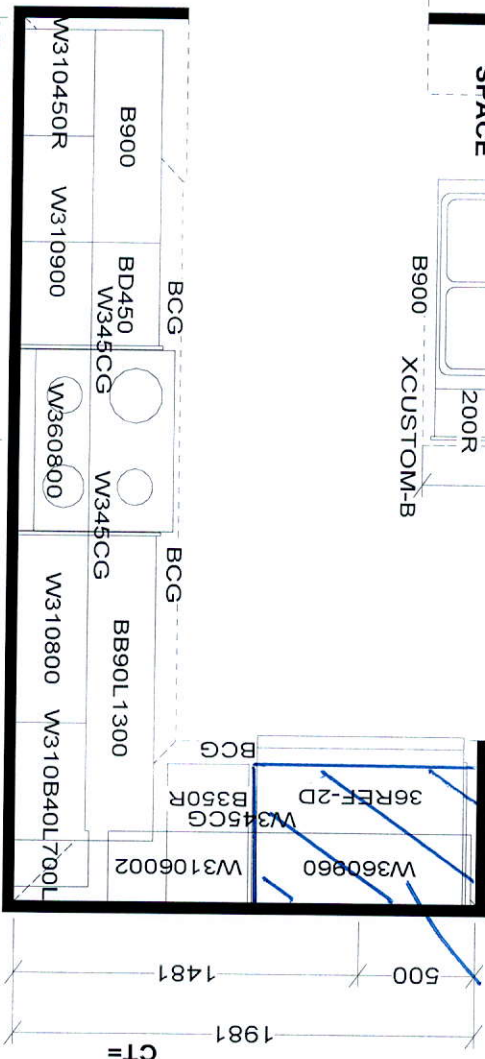
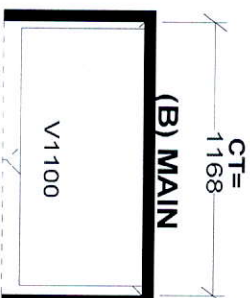
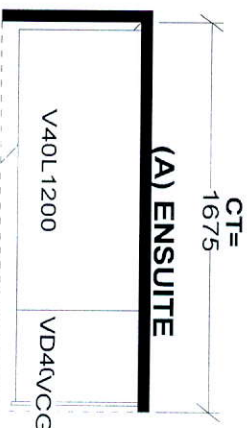
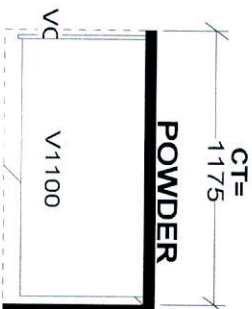
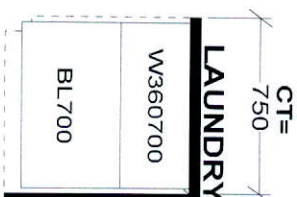
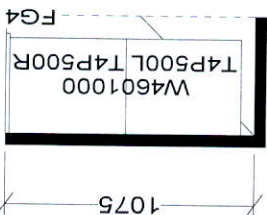
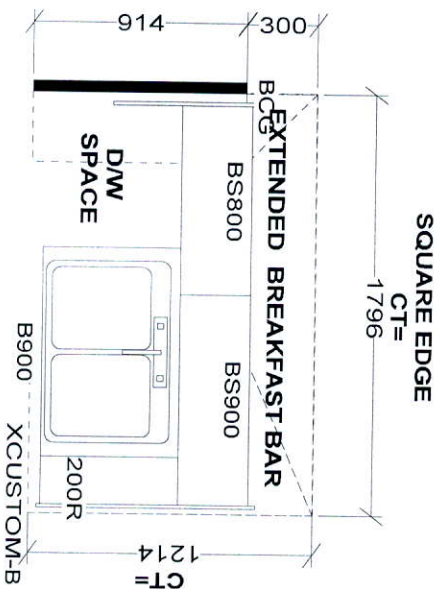

S e l b a I n d u s t r i e s

STANDARD FEATURES:

9" CEILINGS WITH D/C BOX
1040MM HIGH UPPER CABINETS
DISHWASHER SPACE
DUMMY DOORS ON EXPOSED BACKS
LAMINATE KITCHEN & VANITY COUNTERTOPS

This drawing is the intellectual property of
SELBA INDUSTRIES INC. and is an
original design which must not be released
or copied unless applicable fee has been
paid or job order placed.



JOB NUMBER:
BUILDER: GREENPARK HOMES
SITE NAME: LECCO RIDGE, Milton
MODEL: IVY 4X ELEV 1, 1A, 2, 3
LOT #:
DESIGNER: KS
DATE: FEB 13 17

18

1,846 SQ.FT.

AVAILABLE IN BLOCK: 323, 326, 327, 328, 330, 331, 333, 336, 337, 343, 344, 345, 346, 348 & 349

