

<div><div></div><div><div>CONSTRUCTION SUMMARY</div><div>Saddle Ridge (G) - Lecco Ridge Developments Inc.</div></div></div> <div><div>PURCHASERS: Uzair A THANVI and Sheemah THANVI</div><div>TEL:</div></div>				
LOT / PHASE	REG. PLAN #	HOUSE TYPE		
Block 341 TH 3 / 1	20M-1184	Ivy 1 Elev 2		

CABINTRY ACCESSORIES

I - PANTRY UNIT UPGRADE - TO GO FROM 300MM TO 600MM DEEP - PRICE IS PER FOOT - STANDARD 16Nov17 Note:	
I - KITCHEN CABINTRY UPPER - FULL DEPTH ABOVE FRIDGE - WITH GABLES - 600MM - PRICE IS EACH - STANDARD 16Nov17 Note:	

ELECTRICAL

I - STANDARD DINING ROOM LIGHT TO BE CENTERED BETWEEN LIVING AND DINING ROOM 16Nov17 Note:	
---	--

HARDWOOD FLOORING

I - LAMINATE - LEXINGTON SERIES - - SECOND FLOOR COMPLETE 16Nov17 Note:	
I - LAMINATE -UPGRADE TO LEXINGTON SERIES IN LIEU OF STANDARD LAMINATE 16Nov17 Note:	

PLUMBING

I - WASHROOM - 3 PIECE ROUGH-IN IN BASEMENT 27Mar17 Note:	
--	--

PROMOTIONAL

I - LESS BALANCE OF CREDIT FROM PURCHASER EXTRA SHEET IN OFFER 16Nov17 Note:	
I - LESS CREDIT FROM PURCHASER EXTRA SHEET IN OFFER 27Mar17 Note: balance of promo \$4360 to be used at time of colour chart.	

STAIRS AND RAILINGS

I - STAINED STAIRS, RAILING AND PICKETS – STANDARD STAIRCASE - PRICE IS PER SET 16Nov17 Note:	
--	--

EXTRAS AS PER OFFER

Five (5) White Appliances as per PE Appliances Worksheet Note:	
The Vendor agrees that notwithstanding any other term or provision in this Agreement included in the Purchase Price and in addition to those items detailed in Schedule GP to the Agreement of Purchase and Sale, the Purchaser is entitled to a credit of Fiv Worksheet Note:	
The Purchaser acknowledges that the Purchase Price is inclusive of all credits and promotional packages available at the time of purchase. Worksheet Note:	

This Document is Extremely Time Sensitive - Printed 16 Nov 17 at 11:40

RECEIVED NOV 20 2017

Purchasers: Uzair A THANVI & Sheemah THANVI

Property: Block 341 TH 3

Telephone Res. / Bus: /

Project: Lecco Ridge Developments Inc.

Decor Advisor: Candace Forza

Model and Elevation: Ivy 1 Elev 2

Lock Date: 16-Nov-17

16-Nov-17

Plan #: 20M-1184

Layout Changes: ☐ Yes ☒ No

Sketch Attached: ☒ Yes ☐ No

Exterior Colour Scheme:

1. Cabinetry

	Style and Colour	Hardware
Kitchen / Breakfast	MODENA WHITE	2002
Laundry Room	BASEMENT	N/A
Powder Room	MODENA WHITE	1001
Master Ensuite Bathroom	MODENA WHITE	1001
Main Bathroom	MODENA WHITE	1001
	N/A	N/A
	N/A	N/A
	N/A	N/A
	N/A	N/A

Appliances:

Built In Appliances ☐ Yes ☒ No

Slide In Stove ☐ Yes ☒ No

Dishwasher Cabinet

☐ Closed ☒ Open

41" Upper Cabinets ☒ Yes ☐ No

Please NOTE: Standard Cabinet Height is 30"

Stove Opening

NOTE: If not specified, opening will be set to builder's standard opening of approximately 30" width

Fridge Opening

NOTE: If not specified, opening will be set to builder's standard opening of approximately 37" width x 74" height

\*\* Refer to Construction Summary

2. Counters

	Counter	Edge
Kitchen / Breakfast	LAMINATE-ARGENTO ROMANO 6697-46	
Laundry Room	N/A	
Powder Room	LAMINATE-CARRARA BIANCO 6696-46	
Master Ensuite Bathroom	LAMINATE-CALCUTTA MARBLE 4925K-07	
Main Bathroom	LAMINATE-CALCUTTA MARBLE 4925K-07	
	N/A	
	N/A	
	N/A	
	N/A	

\*\* Refer to Construction Summary

Initials: SI JS



Purchasers: Uzair A THANVI & Sheemah THANVI

Property: Block 341 TH 3

Telephone Res. / Bus: /

Project: Lecco Ridge Developments Inc.

Decor Advisor: Candace Forza

Model and Elevation: Ivy 1 Elev 2

Lock Date: 16-Nov-17

16-Nov-17

Plan #: 20M-1184

3. Ceramic Flooring

Entrance Vestibule	TILE-RAINBOW WHITE-13X13	<input type="checkbox"/>	At a 45 Threshold-If App.
Main Hall	LAMINATE	<input type="checkbox"/>	METAL STRIP
Kitchen / Breakfast	TILE-RAINBOW WHITE-13X13	<input type="checkbox"/>	
Laundry Room	N/A	<input type="checkbox"/>	METAL STRIP
Powder Room	TILE-RAINBOW WHITE-13X13	<input type="checkbox"/>	
Master Ensuite Bathroom	TILE-RAINBOW LIGHT GREY-13X13	<input type="checkbox"/>	METAL STRIP
Main Bathroom	TILE-RAINBOW LIGHT GREY-13X13	<input type="checkbox"/>	METAL STRIP
	N/A	<input type="checkbox"/>	
	N/A	<input type="checkbox"/>	
	N/A	<input type="checkbox"/>	
	N/A	<input type="checkbox"/>	

\*\* Refer to Construction Summary

4. Ceramic Wall Tile

Master Ensuite Bathroom	Selection	Describe
Tub Deck Wall	TILE-NATURALE GRIGIO-8X10	***LAID HORIZONTALLY***
Tub Deck	N/A	
Tub Deck Skirt	N/A	
Shower Stall	TILE-NATURALE GRIGIO-8X10	***LAID HORIZONTALLY***
Bathtub Enclosure Walls	N/A	
	N/A	
Main Bathroom	TILE-NATURALE GRIGIO-8X10	***LAID HORIZONTALLY***
	N/A	
	N/A	
	N/A	
Kitchen Backsplash	N/A	

\*\* Refer to Construction Summary - STANDARD GROUT THROUGHOUT UNLESS SPECIFIED

5. Plumbing Fixtures

All Bathrooms	White	Whirlpool
	N/A	<input type="checkbox"/> N/A <input type="radio"/> Yes <input checked="" type="radio"/> No
	N/A	
	N/A	Dishwasher Rough-In <input checked="" type="radio"/> Yes <input type="radio"/> No
	N/A	Waterline for Fridge <input type="radio"/> Yes <input checked="" type="radio"/> No
	N/A	

\*\* Refer to Construction Summary

6. Trim Carpentry

Interior Doors	CLERMONT
Interior Trim	2 3/4" CASING WITH 4 1/4" BASEBOARD - COLONIAL
Door Handles	KNOB - SATIN NICKEL
Exterior Front Door Handle	SATIN NICKEL CHELSEA

\*\* Refer to Construction Summary



Purchasers: Uzair A THANVI & Sheemah THANVI

Telephone Res. / Bus: /

Decor Advisor: Candace Forza

Lock Date: 16-Nov-17

Property: Block 341 TH 3

Project: Lecco Ridge Developments Inc.

Model and Elevation: Ivy 1 Elev 2

Plan #: 20M-1184

7. Other Flooring

Main Hall	LAMINATE-LEXINGTON - HAZELWOOD OAK TL21016 - M	
Living Room	LAMINATE-LEXINGTON - HAZELWOOD OAK TL21016 - M	
Dining Room	LAMINATE-LEXINGTON - HAZELWOOD OAK TL21016 - M	
Family Room	N/A	
Den / Library / Study	N/A	
Basement Landing(If Applies)	N/A	
Lower Landing (If Applies)	N/A	
Upper Landing	LAMINATE-LEXINGTON - HAZELWOOD OAK TL21016 - M	
Upper Hall	LAMINATE-LEXINGTON - HAZELWOOD OAK TL21016 - M	
Master Bedroom	LAMINATE-LEXINGTON - HAZELWOOD OAK TL21016 - M	
Bedroom #2	LAMINATE-LEXINGTON - HAZELWOOD OAK TL21016 - M	
Bedroom #3	LAMINATE-LEXINGTON - HAZELWOOD OAK TL21016 - M	
Bedroom #4	N/A	
Bedroom #5	N/A	
	N/A	
	N/A	
	N/A	
Underpad	Type	Area
	N/A	N/A

\*\* Refer to Construction Summary

8. Railings and Pickets

Railing Type	AS PER CONSTRUCTION SPECIFICATIONS	Colour	TORLYS HAZELWOOD OAK
Picket Type	AS PER CONSTRUCTION SPECIFICATIONS	Colour	TORLYS HAZELWOOD OAK
Stringer / Riser	As Per Construction Specifications	Colour	TORLYS HAZELWOOD OAK
Treads	As Per Construction Specifications	Colour	TORLYS HAZELWOOD OAK
Red Oak Stairs with Semi Gloss Finish		<input checked="" type="radio"/> Yes <input type="radio"/> No	

\*\* Refer to Construction Summary

9. Wall Paint Flat Finish

Main & Upper Hall	22 WARM GREY	Master Bedroom	22 WARM GREY
Living Room	22 WARM GREY	Bedroom #2	22 WARM GREY
Dining Room	22 WARM GREY	Bedroom #3	22 WARM GREY
Kitchen / Breakfast	22 WARM GREY	Bedroom #4	N/A
Family Room	N/A	Bedroom #5	N/A
Powder Room	22 WARM GREY	Master Ensuite	22 WARM GREY
Laundry Room	N/A	Main Bathroom	22 WARM GREY
Den/Library	N/A		N/A
Trim Paint-Semi Gloss	BIRCH WHITE		N/A
	N/A		N/A
	N/A		N/A

Smooth Ceilings First Floor ☐ Yes ☒ No

\*\* Refer to Construction Summary

Initials: 

ST



Purchasers: Uzair A THANVI &amp; Sheemah THANVI

Property: Block 341 TH 3

Telephone Res. / Bus: /

Project: Lecco Ridge Developments Inc.

Decor Advisor: Candace Forza

Model and Elevation: Ivy 1 Elev 2

Lock Date: 16-Nov-17

16-Nov-17

Plan #: 20M-1184

**10. Plaster Mouldings and Medallions**

Entrance Vestibule	N/A	N/A	Kitchen/Breakfast	N/A	N/A
Main Hall	N/A	N/A	Den/Library	N/A	N/A
Living Room	N/A	N/A	Lower Landing	N/A	N/A
Dining Room	N/A	N/A		N/A	N/A
Family Room	N/A	N/A		N/A	N/A

\*\* Refer to Construction Summary

**11. Fireplace**

	Living Room			Family Room			Other Room - Specify		
	Purchased	As Per Plan	N/A	Purchased	As Per Plan	N/A	Purchased	As Per Plan	N/A
Fireplace Type	<input type="radio"/>	<input type="radio"/>	<input checked="" type="radio"/>	<input type="radio"/>	<input type="radio"/>	<input checked="" type="radio"/>	<input type="radio"/>	<input type="radio"/>	<input checked="" type="radio"/>
Mantle Type	N/A			N/A			N/A		
Colour / Stain	N/A			N/A			N/A		
Surround	N/A			N/A			N/A		
Hearth	N/A			N/A			N/A		

\*\* Refer to Construction Summary

**12. Heating and Air Conditioning**

Air Conditioning NO

Gas Provisions Stove NO

Gas Provisions Dryer NO

Gas Provisions Barbecue NO

Comment

\*\* Refer to Construction Summary

**13. Electrical**

Plugs and Switches	<input checked="" type="radio"/> White	DECOR	Above Kitchen Cabinet Light	<input type="radio"/> Yes	<input checked="" type="radio"/> No
Hood Fan	STANDARD WHITE		Below Kitchen Cabinet Light	<input type="radio"/> Yes	<input checked="" type="radio"/> No
Appliances	Built in Cooktop	Built in Oven	Gas Stove	Microwave	
	<input type="radio"/> Yes <input checked="" type="radio"/> No	<input type="radio"/> Yes <input checked="" type="radio"/> No	<input type="radio"/> Yes <input checked="" type="radio"/> No	<input type="radio"/> Yes <input checked="" type="radio"/> No	
Dishwasher Rough-in	Yes				

\*\* Refer to Construction Summary

**14. General Comments**

\*\* Refer to Construction Summary

**Disclaimers and Notes**

- Colours of all materials are as close as possible to builder's selection, but not necessarily identical due to variances in manufacturing.
- Any extras listed above are null and void unless accompanied by a separate invoice/amendment. Said invoice must be paid in full.
- The Purchaser agrees that this colour selection is final and that no changes will be permitted, unless required by the Vendor.
- The Purchaser acknowledges reading and accepting document which contains other miscellaneous disclaimers.

Signature: 

Date: 16 Nov 2017

Signature: 

Date: Nov. 16 2017

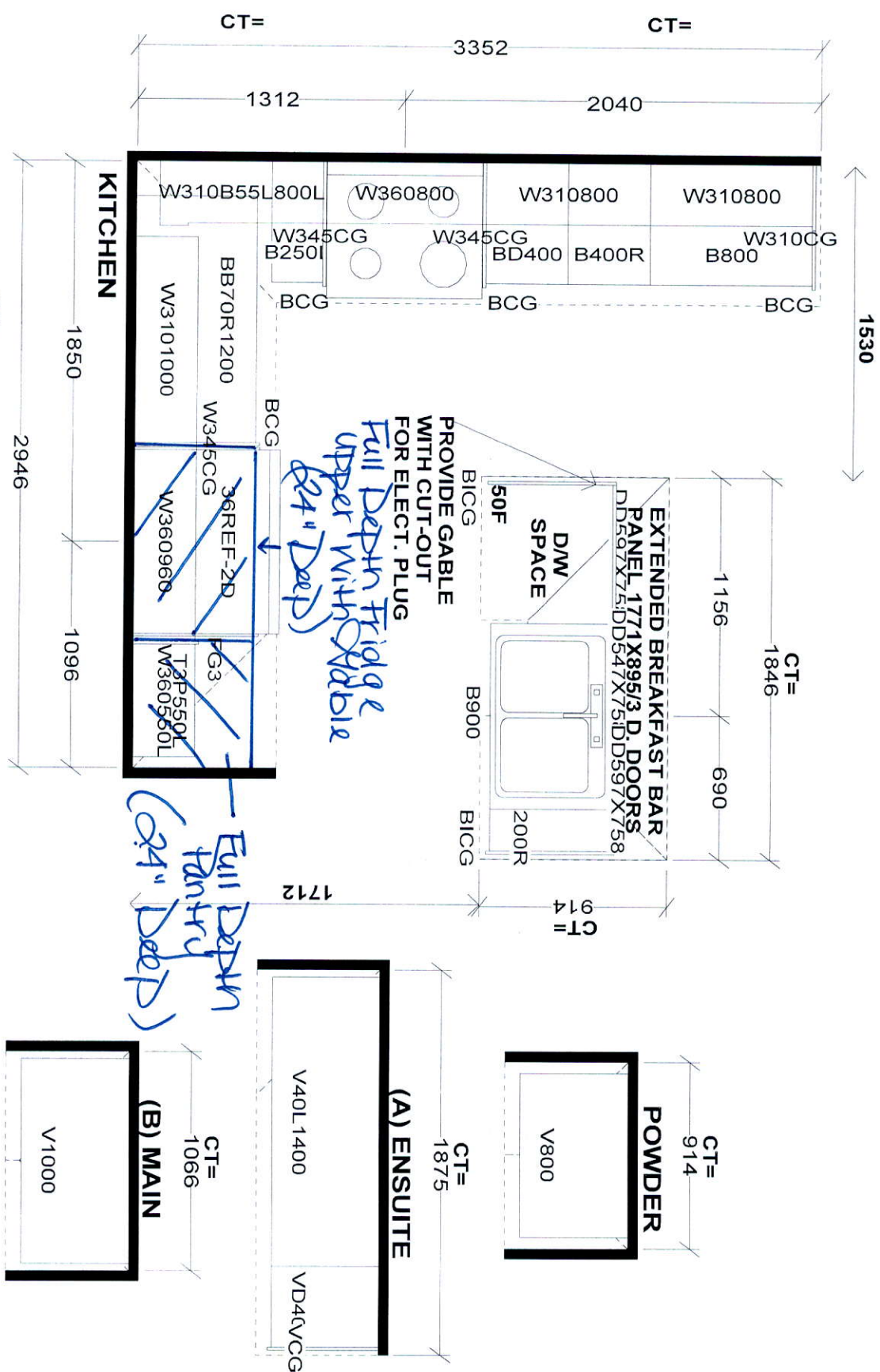

S e l b a I n d u s t r i e s

STANDARD FEATURES:

- 9' CEILINGS WITH D/C BOX
- 1040MM HIGH UPPER CABINETS
- DISHWASHER SPACE
- DUMMY DOORS ON EXPOSED BACKS
- LAMINATE KITCHEN & VANITY COUNTERTOPS

This drawing is the intellectual property of SELBA INDUSTRIES INC. and is an original design which must not be released or copied unless applicable fee has been paid or job order placed.



**JOB NUMBER:**  
**BUILDER:** GREENPARK HOMES  
**SITE NAME:** LECCO RIDGE, Milton  
**MODEL:** IVY 1X ELEV 1,2,3  
**LOT #:**  
**DESIGNER:** KS  
**DATE:** FEB 13 17



# IVY 1

1,578 SQ.FT.

AVAILABLE IN BLOCK: 324, 327, 328, 329, 330, 332, 334, 335, 337, 338, 341, 342, 343, 344 & 345

Center Standard  
Light

