

CONSTRUCTION SUMMARY

Saddle Ridge (G) - Lecco Ridge Developments Inc.



PURCHASERS: SALMAN AYUB KHAN and RIFFAT QADEER

TEL:

LOT / PHASE Block 347 TH 2 / 1	REG. PLAN # 20M-1184	HOUSE TYPE Ivy 2 Elev 2		
-----------------------------------	-------------------------	----------------------------	--	--

CABINETRY ACCESSORIES

2 - PANTRY UNIT UPGRADE - TO GO FROM 300MM TO 600MM DEEP - PRICE IS PER FOOT - STANDARD 13Nov17 Note:	
1 - KITCHEN CABINETRY UPPER - FULL DEPTH ABOVE FRIDGE - WITH GABLES - 600MM - PRICE IS EACH - STANDARD 13Nov17 Note:	

ELECTRICAL

1 - STANDARD DINING ROOM LIGHT TO BE CENTERED BETWEEN LIVING AND DINING ROOM 13Nov17 Note:	
---	--

HARDWOOD FLOORING

1 - LAMINATE - PARK LANE SERIES - - SECOND FLOOR COMPLETE 13Nov17 Note:	
--	--

PLUMBING

1 - WASHROOM - 3 PIECE ROUGH-IN IN BASEMENT 13Feb17 Note:	
--	--

PROMOTIONAL

1 - LESS CREDIT FROM PURCHASER EXTRA SHEET IN OFFER 13Nov17 Note:	
1 - PARTIAL REDEMPTION OF PROMOTIONAL PACKAGE \$\$\$\$\$\$ BALANCE FORWARD TO BE USED AT A LATER DATE. ORIGINAL PROMOTIONAL PACKAGE OF \$\$\$\$ AS PER SCHEDULE PE DATED MMMDDYYYY. 13Feb17 Note: ORIGINAL PROMOTIONAL PACKAGE \$5,000.00 BALANCE FORWARD \$4,360.00	

STAIRS AND RAILINGS

1 - STAINED STAIRS, RAILING AND PICKETS – STANDARD STAIRCASE - PRICE IS PER SET 13Nov17 Note:	
--	--

EXTRAS AS PER OFFER

The Vendor agrees that notwithstanding any other term or provision in this Agreement included in the Purchase Price and in addition to those items detailed in Schedule GP to the Agreement of Purchase and Sale, the Purchaser is entitled to a credit of Fiv Worksheet Note:	
Five (5) White Appliances as per PE Appliances Worksheet Note:	
The Purchaser acknowledges that the Purchase Price is inclusive of all credits and promotional packages available at the time of purchase. Worksheet Note:	

This Document is Extremely Time Sensitive - Printed 13 Nov 17 at 15:33

RECEIVED NOV 16 2017

Greenpark™

INTERIOR COLOUR SCHEME

Purchasers:

SALMAN AYUB KHAN & RIFFAT QADEER

Property:

Block 347 TH 2

Telephone Res. / Bus:

/

Project:

Lecco Ridge Developments Inc.

Decor Advisor:

Natalie Mancuso

Model and Elevation:

Ivy 2 Elev 2

Lock Date:

13-Nov-17

13-Nov-17

Plan #:

20M-1184

Layout Changes:

☐ Yes ☒ No

Sketch Attached:

☒ Yes ☐ No

Exterior Colour Scheme:

1. Cabinetry

	Style and Colour	Hardware
Kitchen / Breakfast	MONACO W350XZ4	2004
Laundry Room	N/A	N/A
Powder Room	MONACO W350XZ4	2004
Master Ensuite Bathroom	MODENA CHOCOLATE	2004
Main Bathroom	MODENA CHOCOLATE	2004

Appliances:

Built In Appliances

☐ Yes ☒ No

Slide In Stove

☐ Yes ☒ No

Dishwasher Cabinet

☐ Closed ☒ Open

41" Upper Cabinets

☒ Yes ☐ No

Please NOTE: Standard Cabinet Height is 30"

Stove Opening

NOTE: If not specified, opening will be set to builder's standard opening of approximately 30" width

Fridge Opening

NOTE: If not specified, opening will be set to builder's standard opening of approximately 37" width x 74" height

\*\* Refer to Construction Summary

2. Counters

	Counter	Edge
Kitchen / Breakfast	LAMINATE-WHITE TIGRIS 4783-60	
Laundry Room		
Powder Room	LAMINATE-WHITE TIGRIS 4783-60	
Master Ensuite Bathroom	LAMINATE-PEARL SOAPSTONE 4886-38	
Main Bathroom	LAMINATE-PEARL SOAPSTONE 4886-38	

\*\* Refer to Construction Summary

Initials:

Page 1 of 4

Printed 11/13/2017 15:33:02



Purchasers: SALMAN AYUB KHAN & RIFFAT QADEER

Property: Block 347 TH 2

Telephone Res. / Bus: /

Project: Lecco Ridge Developments Inc.

Decor Advisor: Natalie Mancuso

Model and Elevation: Ivy 2 Elev 2

Lock Date: 13-Nov-17

13-Nov-17

Plan #: 20M-1184

3. Ceramic Flooring

At a 45 Threshold-If App.

Entrance Vestibule	TILE- RAINBOW LIGHT GREY 13X13	<input type="checkbox"/>	
Main Hall	LAMINATE	<input type="checkbox"/>	
Kitchen / Breakfast	TILE- RAINBOW LIGHT GREY 13X13	<input type="checkbox"/>	METAL STRIP
Laundry Room	N/A	<input type="checkbox"/>	
Powder Room	TILE- RAINBOW LIGHT GREY 13X13	<input type="checkbox"/>	METAL STRIP
Master Ensuite Bathroom	TILE- BEACH LIGHT GREY 13X13	<input type="checkbox"/>	METAL STRIP
Main Bathroom	TILE- BEACH LIGHT GREY 13X13	<input type="checkbox"/>	METAL STRIP
		<input type="checkbox"/>	
		<input type="checkbox"/>	
		<input type="checkbox"/>	
		<input type="checkbox"/>	

\*\* Refer to Construction Summary

4. Ceramic Wall Tile

Master Ensuite Bathroom	Selection	Describe
Tub Deck Wall	TILE- GOLF GRIGIO 8X10	
Tub Deck		
Tub Deck Skirt		
Shower Stall	TILE- GOLF GRIGIO 8X10	
Bathtub Enclosure Walls		
Main Bathroom	TILE- GOLF GRIGIO 8X10	
Kitchen Backsplash		

\*\* Refer to Construction Summary - STANDARD GROUT THROUGHOUT UNLESS SPECIFIED

5. Plumbing Fixtures

All Bathrooms

White

Whirlpool

☐ Yes ☒ No

Dishwasher Rough-In

☒ Yes ☐ No

Waterline for Fridge

☐ Yes ☒ No

\*\* Refer to Construction Summary

6. Trim Carpentry

Interior Doors	CLERMONT
Interior Trim	2 3/4" CASING WITH 4 1/4" BASEBOARD - COLONIAL
Door Handles	As Per Construction Specifications
Exterior Front Door Handle	As Per Construction Specifications

\*\* Refer to Construction Summary



Purchasers: SALMAN AYUB KHAN & RIFFAT QADEER

Property: Block 347 TH 2

Telephone Res. / Bus: /

Project: Lecco Ridge Developments Inc.

Decor Advisor: Natalie Mancuso

Model and Elevation: Ivy 2 Elev 2

Lock Date: 13-Nov-17

13-Nov-17

Plan #: 20M-1184

7. Other Flooring

Main Hall	LAMINATE-PARK LANE - HERITAGE OAK TL-U1386	
Living Room	LAMINATE-PARK LANE - HERITAGE OAK TL-U1386	
Dining Room	LAMINATE-PARK LANE - HERITAGE OAK TL-U1386	
Family Room	N/A	
Den / Library / Study	LAMINATE-PARK LANE - HERITAGE OAK TL-U1386	
Basement Landing(If Applies)		
Lower Landing (If Applies)	TILE- BEACH LIGHT GREY 13X13	
Upper Landing	LAMINATE-PARK LANE - HERITAGE OAK TL-U1386	
Upper Hall	LAMINATE-PARK LANE - HERITAGE OAK TL-U1386	
Master Bedroom	LAMINATE-PARK LANE - HERITAGE OAK TL-U1386	
Bedroom #2	LAMINATE-PARK LANE - HERITAGE OAK TL-U1386	
Bedroom #3	LAMINATE-PARK LANE - HERITAGE OAK TL-U1386	
Bedroom #4		
Bedroom #5		
Underpad	Type	Area

\*\* Refer to Construction Summary

8. Railings and Pickets

Railing Type	AS PER CONSTRUCTION SPECIFICATIONS	Colour	TORLYS- HERITAGE OAK
Picket Type	1 5/16 PICKETS SQUARE CHAMFERED	Colour	TORLYS- HERITAGE OAK
Stringer / Riser	As Per Construction Specifications	Colour	TORLYS- HERITAGE OAK
Treads	Standard	Colour	TORLYS- HERITAGE OAK
Red Oak Stairs with Semi Gloss Finish		<input checked="" type="radio"/> Yes <input type="radio"/> No	

\*\* Refer to Construction Summary

9. Wall Paint Flat Finish

Main & Upper Hall	22 WARM GREY	Master Bedroom	22 WARM GREY
Living Room	22 WARM GREY	Bedroom #2	22 WARM GREY
Dining Room	22 WARM GREY	Bedroom #3	22 WARM GREY
Kitchen / Breakfast	22 WARM GREY	Bedroom #4	
Family Room	22 WARM GREY	Bedroom #5	
Powder Room	22 WARM GREY	Master Ensuite	22 WARM GREY
Laundry Room		Main Bathroom	22 WARM GREY
Den/Library	22 WARM GREY		
Trim Paint-Semi Gloss	BIRCH WHITE		

Smooth Ceilings First Floor ☐ Yes ☒ No

\*\* Refer to Construction Summary



Purchasers: SALMAN AYUB KHAN & RIFFAT QADEER

Property: Block 347 TH 2

Telephone Res. / Bus: /

Project: Lecco Ridge Developments Inc.

Decor Advisor: Natalie Mancuso

Model and Elevation: Ivy 2 Elev 2

Lock Date: 13-Nov-17

13-Nov-17

Plan #: 20M-1184

10. Plaster Mouldings and Medallions

Entrance Vestibule			Kitchen/Breakfast		
Main Hall			Den/Library		
Living Room			Lower Landing		
Dining Room					
Family Room					

\*\* Refer to Construction Summary

11. Fireplace

	Living Room			Family Room			Other Room - Specify		
	Purchased	As Per Plan	N/A	Purchased	As Per Plan	N/A	Purchased	As Per Plan	N/A
Fireplace Type	<input type="radio"/>	<input type="radio"/>	<input checked="" type="radio"/>	<input type="radio"/>	<input type="radio"/>	<input checked="" type="radio"/>	<input type="radio"/>	<input type="radio"/>	<input checked="" type="radio"/>
Mantle Type									
Colour / Stain									
Surround									
Hearth									

\*\* Refer to Construction Summary

12. Heating and Air Conditioning

Air Conditioning	NO	Gas Provisions Stove	NO
Gas Provisions Dryer	NO	Gas Provisions Barbecue	NO
Comment			

\*\* Refer to Construction Summary

13. Electrical

Plugs and Switches	<input checked="" type="radio"/> White	DECOR	Above Kitchen Cabinet Light	<input type="radio"/> Yes	<input checked="" type="radio"/> No		
Hood Fan	STANDARD WHITE		Below Kitchen Cabinet Light	<input type="radio"/> Yes	<input checked="" type="radio"/> No		
Appliances	Built in Cooktop		Built in Oven		Gas Stove		
	<input type="radio"/> Yes	<input checked="" type="radio"/> No	<input type="radio"/> Yes	<input checked="" type="radio"/> No	<input type="radio"/> Yes	<input checked="" type="radio"/> No	
Dishwasher Rough-in	Yes				Microwave	<input type="radio"/> Yes	<input checked="" type="radio"/> No

\*\* Refer to Construction Summary

14. General Comments

\*\* Refer to Construction Summary

Disclaimers and Notes

- 1) Colours of all materials are as close as possible to builder's selection, but not necessarily identical due to variances in manufacturing.
- 2) Any extras listed above are null and void unless accompanied by a separate invoice/amendment. Said invoice must be paid in full.
- 3) The Purchaser agrees that this colour selection is final and that no changes will be permitted, unless required by the Vendor.
- 4) The Purchaser acknowledges reading and accepting document which contains other miscellaneous disclaimers.

Signature:  Date: 13-Nov-2017

Signature:  Date: 13 Nov 2017

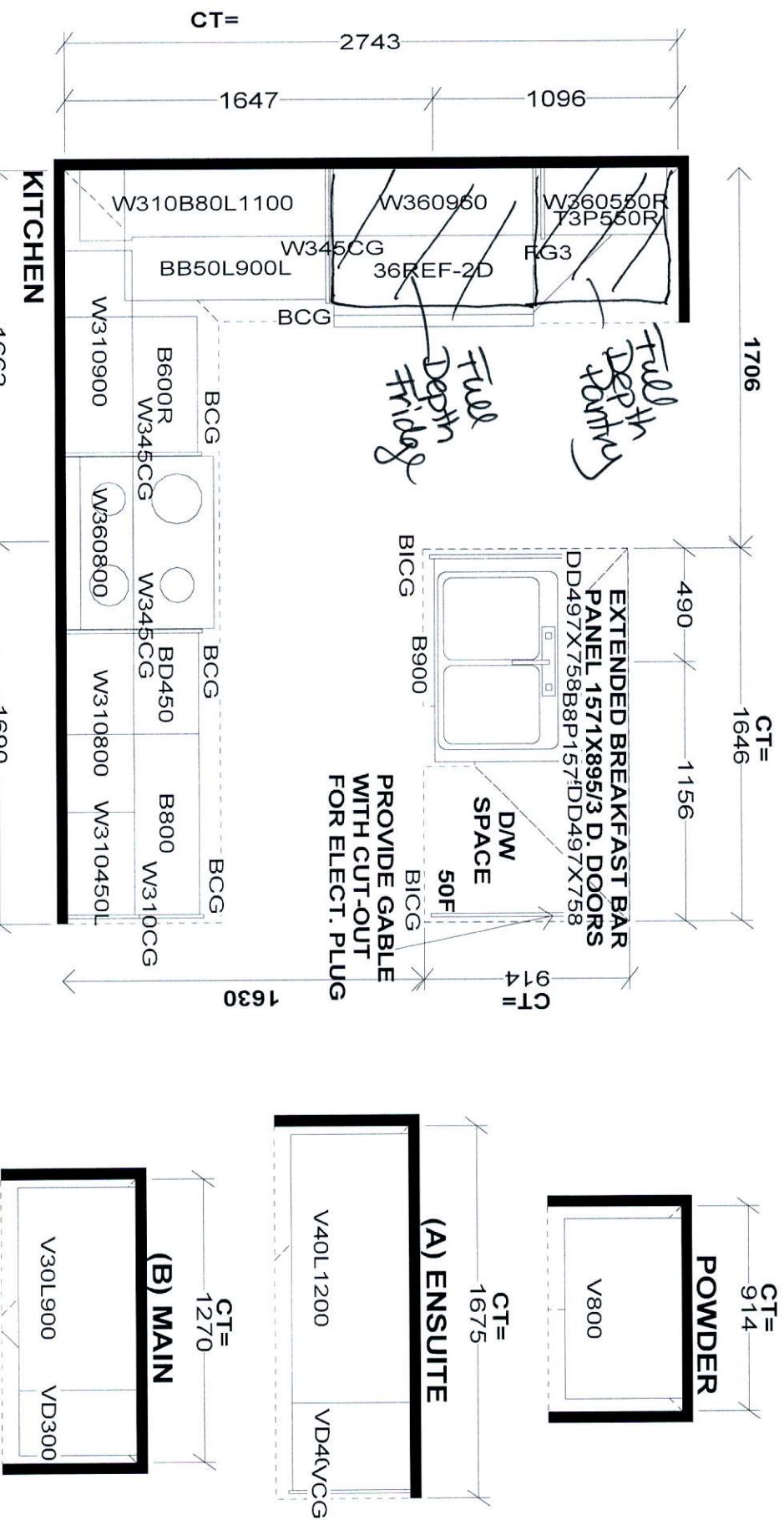

S e l b a I n d u s t r i e s

STANDARD FEATURES:  
9' CEILINGS WITH D/C BOX  
1040MM HIGH UPPER CABINETS  
DISHWASHER SPACE  
DUMMY DOORS ON EXPOSED BACKS  
LAMINATE KITCHEN & VANITY COUNTERTOPS

This drawing is the intellectual property of SELBA INDUSTRIES INC. and is an original design which must not be released or copied unless applicable fee has been paid or job order placed.

HA  
B  
C  
F  
E  
D

JOB NUMBER:  
BUILDER: GREENPARK HOMES  
SITE NAME: LECCO RIDGE, Milton  
MODEL: IVY 2X ELEV 1,2,3  
LOT #:  
DESIGNER: KS  
DATE: FEB 13 17



347 TH2

IVY 2  
1,641 SQ.FT.

AVAILABLE IN BLOCK: 327, 328, 329, 335, 340, 341, 342,  
343, 345 & 347

