



CONSTRUCTION SUMMARY

Saddle Ridge (G) - Lecco Ridge Developments Inc.

PURCHASERS: Danny F. Mauro and Roberto CALTAGIRONE

TEL: RES.: 416-571-1279

LOT / PHASE Block 343 TH 1 / 1	REG. PLAN # 20M-1184	HOUSE TYPE Ivy 6E Elev 3		
-----------------------------------	-------------------------	-----------------------------	--	--

CABINETRY

1 - CABINETRY - UPGRADE 1 - KITCHEN 13Nov17 Note:	
--	--

Ceramic Tile

1 - TILE - UPGRADE 2 FLOOR TILE - - FOYER 13Nov17 Note:	
--	--

HARDWOOD FLOORING

1 - LAMINATE - MANHATTAN SERIES - - UPPER HALL 13Nov17 Note:	
---	--

PROMOTIONAL

1 - LESS CREDIT FROM PURCHASER EXTRA SHEET IN OFFER 13Nov17 Note:	
--	--

STAIRS AND RAILINGS

1 - STAINED STAIRS, RAILING AND PICKETS – STANDARD STAIRCASE - PRICE IS PER SET 13Nov17 Note:	
--	--

EXTRAS AS PER OFFER

Five (5) White Appliances as per PE Appliances Worksheet Note:	
The Vendor agrees that notwithstanding any other term or provision in this Agreement included in the Purchase Price and in addition to those items detailed in Schedule GP to the Agreement of Purchase and Sale, the Purchaser is entitled to a credit of Fiv Worksheet Note:	
The Purchaser acknowledges that the Purchase Price is inclusive of all credits and promotional packages available at the time of purchase. Worksheet Note:	

This Document is Extremely Time Sensitive - Printed 13 Nov 17 at 16:24

RECEIVED NOV 16 2017

Purchasers: Danny F. Mauro & Roberto CALTAGIRONE

Property: Block 343 TH 1

Telephone Res. / Bus: (416) 571-1279 /

Project: Lecco Ridge Developments Inc.

Decor Advisor: Natalie Mancuso

Model and Elevation: Ivy 6E Elev 3

Lock Date: 13-Nov-17

13-Nov-17

Plan #: 20M-1184

Layout Changes: ☐ Yes ☒ No

Sketch Attached: ☒ Yes ☐ No

Exterior Colour Scheme:

1. Cabinetry

	Style and Colour	Hardware
Kitchen / Breakfast	RICHMOND W823XZ4	2004
Laundry Room	ELISSE	Standard
Powder Room	EVEREST WHITE	2004
Master Ensuite Bathroom	EVEREST WHITE	2004
Main Bathroom	EVEREST WHITE	2004

Appliances:

Built In Appliances ☐ Yes ☒ No

Slide In Stove ☐ Yes ☒ No

Dishwasher Cabinet

☐ Closed ☒ Open

41" Upper Cabinets ☒ Yes ☐ No

Please NOTE: Standard Cabinet Height is 30"

Stove Opening

NOTE: If not specified, opening will be set to builder's standard opening of approximately 30" width

Fridge Opening

NOTE: If not specified, opening will be set to builder's standard opening of approximately 37" width x 74" height

** Refer to Construction Summary

2. Counters

	Counter	Edge
Kitchen / Breakfast	LAMINATE-BRONZITE 4971-52	
Laundry Room	N/A	
Powder Room	LAMINATE-PEARL SOAPSTONE 4886-38	
Master Ensuite Bathroom	LAMINATE-BLACK ALICANTE 4926K-07	
Main Bathroom	LAMINATE-PEARL SOAPSTONE 4886-38	

** Refer to Construction Summary

Purchasers:

Danny F. Mauro & Roberto CALTAGIRONE

Telephone Res. / Bus:

(416) 571-1279 /

Decor Advisor:

Natalie Mancuso

Lock Date:

13-Nov-17

Property:

Block 343 TH 1

Project:

Lecco Ridge Developments Inc.

Model and Elevation:

Ivy 6E Elev 3

Plan #:

20M-1184

3. Ceramic Flooring

At a 45 Threshold-If App.

Entrance Vestibule	TILE-VERSAILLES CHATEAUX IVORIE 12X24	<input type="checkbox"/>	METAL STRIP
Main Hall	LAMINATE	<input type="checkbox"/>	
Kitchen / Breakfast	TILE- RAINBOW LIGHT GREY 13X13	<input type="checkbox"/>	METAL STRIP
Laundry Room	TILE- RAINBOW WHITE 13X13	<input type="checkbox"/>	METAL STRIP
Powder Room	TILE- RAINBOW LIGHT GREY 13X13	<input type="checkbox"/>	METAL STRIP
Master Ensuite Bathroom	TILE- RAINBOW WHITE 13X13	<input type="checkbox"/>	METAL STRIP
Main Bathroom	TILE- RAINBOW WHITE 13X13	<input type="checkbox"/>	METAL STRIP
		<input type="checkbox"/>	
		<input type="checkbox"/>	
		<input type="checkbox"/>	
		<input type="checkbox"/>	

** Refer to Construction Summary

4. Ceramic Wall Tile

Master Ensuite Bathroom	Selection	Describe
Tub Deck Wall	TILE- NATURALE NERO 8X10	
Tub Deck		
Tub Deck Skirt		
Shower Stall	TILE- NATURALE NERO 8X10	
Bathtub Enclosure Walls		
Main Bathroom	TILE- NATURALE NERO 8X10	
Kitchen Backsplash		

** Refer to Construction Summary - STANDARD GROUT THROUGHOUT UNLESS SPECIFIED

5. Plumbing Fixtures

All Bathrooms

White

Whirlpool

☐ Yes ☒ No

Dishwasher Rough-In

☒ Yes ☐ No

Waterline for Fridge

☐ Yes ☒ No

** Refer to Construction Summary

6. Trim Carpentry

Interior Doors	CLERMONT
Interior Trim	2 3/4" CASING WITH 4 1/4" BASEBOARD - COLONIAL
Door Handles	As Per Construction Specifications
Exterior Front Door Handle	As Per Construction Specifications

** Refer to Construction Summary

7. Other Flooring

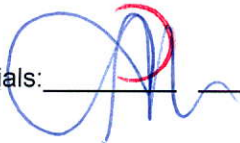
Initials: 

Purchasers: Danny F. Mauro & Roberto CALTAGIRONE

Property: Block 343 TH 1

Telephone Res. / Bus: (416) 571-1279 /

Project: Lecco Ridge Developments Inc.

Decor Advisor: Natalie Mancuso

Model and Elevation: Ivy 6E Elev 3

Lock Date: 13-Nov-17

13-Nov-17

Plan #: 20M-1184

7. Other Flooring

Main Hall	LAMINATE-MANHATTAN - LAVA ROCK OAK TL-15021	
Living Room	LAMINATE-MANHATTAN - LAVA ROCK OAK TL-15021	
Dining Room	LAMINATE-MANHATTAN - LAVA ROCK OAK TL-15021	
Family Room	LAMINATE-MANHATTAN - LAVA ROCK OAK TL-15021	
Den / Library / Study	N/A	
Basement Landing(If Applies)	N/A	
Lower Landing (If Applies)	LAMINATE-MANHATTAN - LAVA ROCK OAK TL-15021	
Upper Landing	LAMINATE-MANHATTAN - LAVA ROCK OAK TL-15021	
Upper Hall	LAMINATE-MANHATTAN - LAVA ROCK OAK TL-15021	
Master Bedroom	CARPET-SHAW - E0949 NEWBERN CLASSIC - MORNING FOG 00530	
Bedroom #2	CARPET-SHAW - E0949 NEWBERN CLASSIC - MORNING FOG 00530	
Bedroom #3	CARPET-SHAW - E0949 NEWBERN CLASSIC - MORNING FOG 00530	
Bedroom #4	CARPET-SHAW - E0949 NEWBERN CLASSIC - MORNING FOG 00530	
Bedroom #5		
Underpad	Type	Area
	STANDARD	BEDROOMS

** Refer to Construction Summary

8. Railings and Pickets

Railing Type	AS PER CONSTRUCTION SPECIFICATIONS	Colour	TORLYS- LAVA ROCK OAK
Picket Type	1 5/16 PICKETS SQUARE CHAMFERED	Colour	TORLYS- LAVA ROCK OAK
Stringer / Riser	As Per Construction Specifications	Colour	TORLYS- LAVA ROCK OAK
Treads	As Per Construction Specifications	Colour	TORLYS- LAVA ROCK OAK
Red Oak Stairs with Semi Gloss Finish		<input checked="" type="radio"/> Yes <input type="radio"/> No	

** Refer to Construction Summary

9. Wall Paint Flat Finish

Main & Upper Hall	22 WARM GREY	Master Bedroom	22 WARM GREY
Living Room	22 WARM GREY	Bedroom #2	22 WARM GREY
Dining Room	22 WARM GREY	Bedroom #3	22 WARM GREY
Kitchen / Breakfast	22 WARM GREY	Bedroom #4	22 WARM GREY
Family Room	22 WARM GREY	Bedroom #5	
Powder Room	22 WARM GREY	Master Ensuite	22 WARM GREY
Laundry Room	22 WARM GREY	Main Bathroom	22 WARM GREY
Den/Library	22 WARM GREY		
Trim Paint-Semi Gloss	BIRCH WHITE		

Smooth Ceilings First Floor ☐ Yes ☒ No

** Refer to Construction Summary

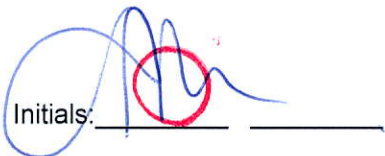
Initials: 

Purchasers: Danny F. Mauro & Roberto CALTAGIRONE

Property: Block 343 TH 1

Telephone Res. / Bus: (416) 571-1279 /

Project: Lecco Ridge Developments Inc.

Decor Advisor: Natalie Mancuso

Model and Elevation: Ivy 6E Elev 3

Lock Date: 13-Nov-17

13-Nov-17

Plan #: 20M-1184

10. Plaster Mouldings and Medallions

Entrance Vestibule	<input type="text"/>	<input type="text"/>	Kitchen/Breakfast	<input type="text"/>	<input type="text"/>
Main Hall	<input type="text"/>	<input type="text"/>	Den/Library	<input type="text"/>	<input type="text"/>
Living Room	<input type="text"/>	<input type="text"/>	Lower Landing	<input type="text"/>	<input type="text"/>
Dining Room	<input type="text"/>	<input type="text"/>		<input type="text"/>	<input type="text"/>
Family Room	<input type="text"/>	<input type="text"/>		<input type="text"/>	<input type="text"/>

** Refer to Construction Summary

11. Fireplace

	Living Room			Family Room			Other Room - Specify		
	Purchased	As Per Plan	N/A	Purchased	As Per Plan	N/A	Purchased	As Per Plan	N/A
Fireplace Type	<input type="radio"/>	<input type="radio"/>	<input checked="" type="radio"/>	<input type="radio"/>	<input type="radio"/>	<input checked="" type="radio"/>	<input type="radio"/>	<input type="radio"/>	<input checked="" type="radio"/>
Mantle Type	<input type="text"/>	<input type="text"/>	<input type="text"/>	<input type="text"/>	<input type="text"/>	<input type="text"/>	<input type="text"/>	<input type="text"/>	<input type="text"/>
Colour / Stain	<input type="text"/>	<input type="text"/>	<input type="text"/>	<input type="text"/>	<input type="text"/>	<input type="text"/>	<input type="text"/>	<input type="text"/>	<input type="text"/>
Surround	<input type="text"/>	<input type="text"/>	<input type="text"/>	<input type="text"/>	<input type="text"/>	<input type="text"/>	<input type="text"/>	<input type="text"/>	<input type="text"/>
Hearth	<input type="text"/>	<input type="text"/>	<input type="text"/>	<input type="text"/>	<input type="text"/>	<input type="text"/>	<input type="text"/>	<input type="text"/>	<input type="text"/>

** Refer to Construction Summary

12. Heating and Air Conditioning

Air Conditioning	<input type="text" value="NO"/>	Gas Provisions Stove	<input type="text" value="NO"/>
Gas Provisions Dryer	<input type="text" value="NO"/>	Gas Provisions Barbecue	<input type="text" value="NO"/>
Comment			

** Refer to Construction Summary

13. Electrical

Plugs and Switches	<input checked="" type="radio"/> White	<input type="text" value="DECOR"/>	Above Kitchen Cabinet Light	<input type="radio"/> Yes <input checked="" type="radio"/> No
Hood Fan	<input type="text" value="STANDARD WHITE"/>		Below Kitchen Cabinet Light	<input type="radio"/> Yes <input checked="" type="radio"/> No
Appliances	Built in Cooktop	Built in Oven	Gas Stove	Microwave
	<input type="radio"/> Yes <input checked="" type="radio"/> No	<input type="radio"/> Yes <input checked="" type="radio"/> No	<input type="radio"/> Yes <input checked="" type="radio"/> No	<input type="radio"/> Yes <input checked="" type="radio"/> No
Dishwasher Rough-in	<input type="text" value="Yes"/>			

** Refer to Construction Summary

14. General Comments

** Refer to Construction Summary

Disclaimers and Notes

- Colours of all materials are as close as possible to builder's selection, but not necessarily identical due to variances in manufacturing.
- Any extras listed above are null and void unless accompanied by a separate invoice/amendment. Said invoice must be paid in full.
- The Purchaser agrees that this colour selection is final and that no changes will be permitted, unless required by the Vendor.
- The Purchaser acknowledges reading and accepting document which contains other miscellaneous disclaimers.

Signature:  Date: Nov 13/17 Signature: _____ Date: _____

SQUARE EDGE
CT=

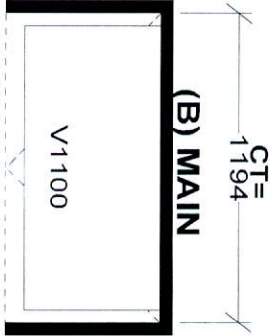
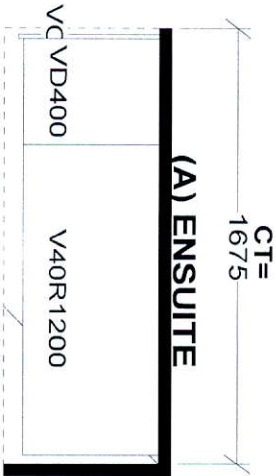
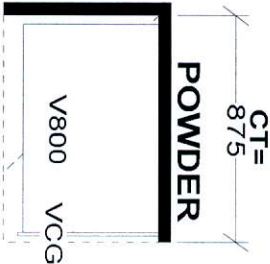
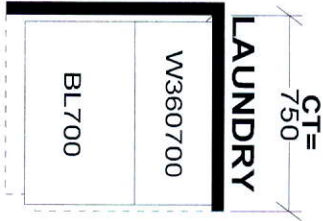
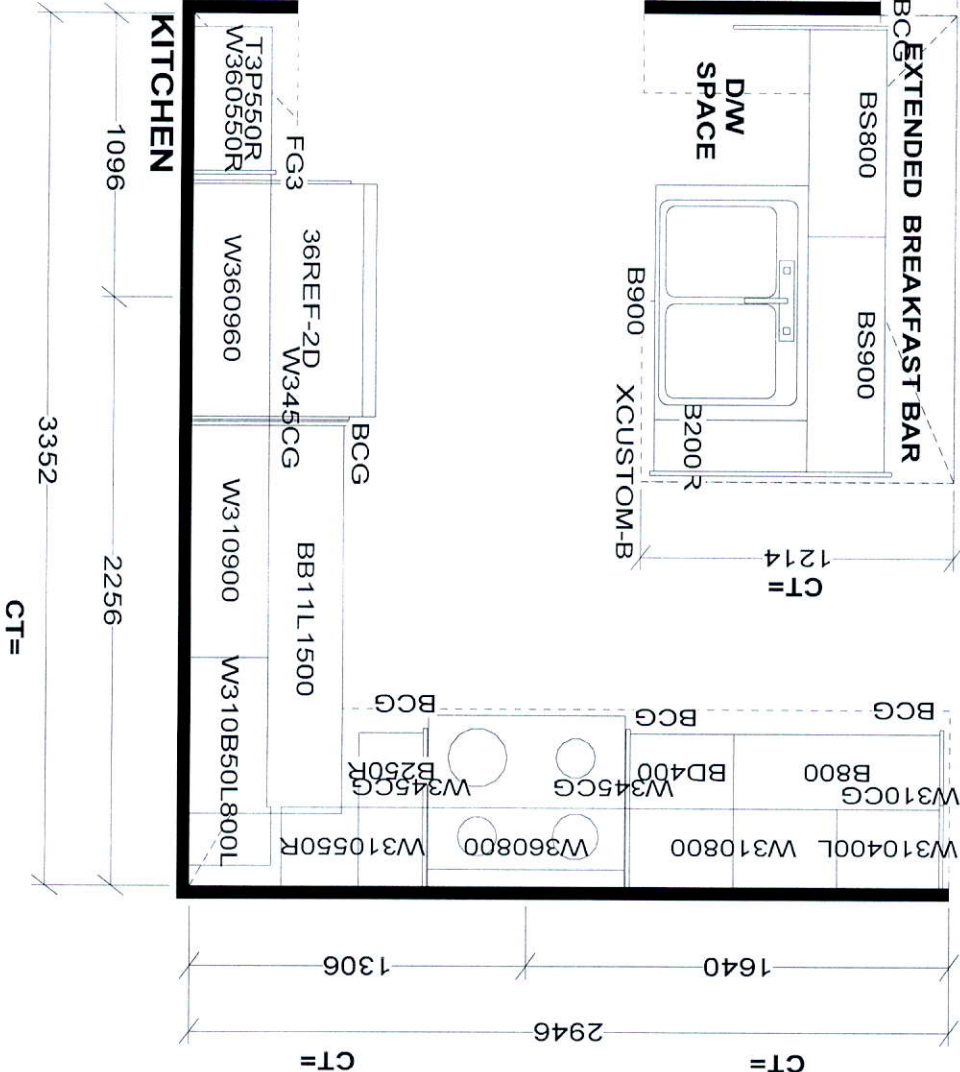
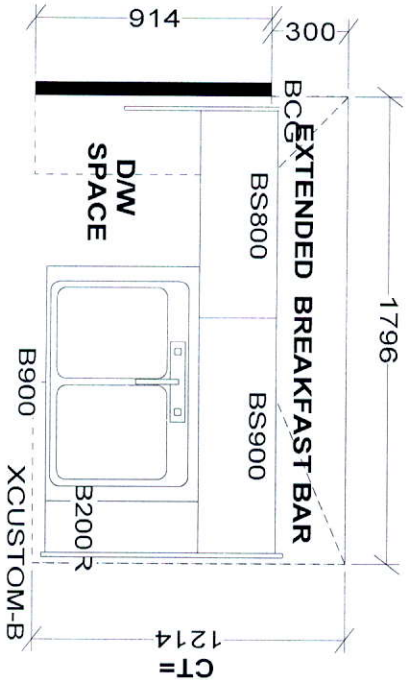

S e l b a I n d u s t r i e s

STANDARD FEATURES:

- 9' CEILINGS WITH D/C BOX
- 1040MM HIGH UPPER CABINETS
- DISHWASHER SPACE
- DUMMY DOORS ON EXPOSED BACKS
- LAMINATE KITCHEN & VANITY COUNTERTOPS

This drawing is the intellectual property of SELBA INDUSTRIES INC. and is an original design which must not be released or copied unless applicable fee has been paid or job order placed.



JOB NUMBER:

BUILDER: GREENPARK HOMES
SITE NAME: LECCO RIDGE, Milton
MODEL: IVY 6EX ELEV 1,2,3
LOT #:
DESIGNER: KS
DATE: FEB 13 17

