



CONSTRUCTION SUMMARY
Saddle Ridge (G) - Lecco Ridge Developments Inc.

PURCHASER: Karamjit Singh DHILLON TEL:

LOT / PHASE 34 / 1	REG. PLAN # 20M-1184	HOUSE TYPE Juniper 7 Elev 2		
-----------------------	-------------------------	--------------------------------	--	--

CABINETRY

1 - VANITIES - MONACO CABINETRY STAIN WITH UPGRADE STAIN - PRICE IS FOR ONE OR ALL BATHS - DETACHED 11Nov17 Note:	
1 - KITCHEN -MONACO CABINETRY WITH UPGRADE STAIN 11Nov17 Note:	

CABINETRY ACCESSORIES

1 - KITCHEN CABINETRY UPPER - FULL DEPTH ABOVE FRIDGE - WITH GABLES - 600MM - PRICE IS EACH - STANDARD 11Nov17 Note:	
1 - KITCHEN CABINETRY BASE - PIE CUT CORNER CABINET - BASE CABINETRY - STANDARD 11Nov17 Note:	
1 - KITCHEN CABINETRY BASE - POT/PAN DRAWERS (CABINET) - STANDARD 11Nov17 Note:	
1 - OVEN CABINET - BUILT-IN - MICROWAVE COMBO - PRICE IS EACH - STANDARD 11Nov17 Note: install in fridge location shift fridge over and pantry-	
1 - KITCHEN CABINETRY BASE - COOKTOP CABINET FULL HEIGHT DOORS - STANDARD 11Nov17 Note:	

Ceramic Tile

1 - TILE - UPGRADE 2 FLOOR TILE - - BATHROOM 3/4 - FLOOR 11Nov17 Note:	
1 - TILE - UPGRADE 2 FLOOR TILE - - BATHROOM 2 - FLOOR 11Nov17 Note:	
1 - TILE - UPGRADE 2 FLOOR TILE - - ENSUITE BATHROOM - FLOOR 11Nov17 Note:	
1 - TILE - UPGRADE 2 FLOOR TILE - - SIDE HALL 11Nov17 Note:	
1 - TILE - UPGRADE 2 FLOOR TILE - - POWDER ROOM 11Nov17 Note:	
1 - TILE - UPGRADE 2 FLOOR TILE - - KITCHEN 11Nov17 Note:	
1 - TILE - UPGRADE 2 FLOOR TILE - - FOYER AND MAIN HALL 11Nov17 Note:	

CONSTRUCTION

1 - PLEASE NOTE THAT NO FURTHER STRUCTURAL CHANGES WILL BE PERMITTED. 23Dec16 Note:	
1 - ADD BASEMENT WALK-UP 23Dec16 Note:	RECEIVED NOV 16 2017

ELECTRICAL

1 - BUILT IN OVEN AND COOKTOP PROVISION - PROVISION ONLY - ELECTRICAL ONLY 11Nov17 Note:	
---	--

HARDWOOD FLOORING

1 - HARDWOOD – GROUP A SERIES 5 INCH - IN LIEU OF 2 1/4 INCH NATURAL RED OAK - - FIRST FLOOR COMPLETE 11Nov17 Note:	
--	--



CONSTRUCTION SUMMARY				
Saddle Ridge (G) - Lecco Ridge Developments Inc.				
PURCHASER: Karamjit Singh DHILLON				TEL:
LOT / PHASE	REG. PLAN #	HOUSE TYPE		
34 / 1	20M-1184	Juniper 7 Elev 2		

STAIRS AND RAILINGS

1 - STAINED HANDRAIL, TREADS, RISERS AND STRINGER EXCLUDING PICKETS (FOR IRON PICKETS) - STANDARD STAIRCASE - PRICE IS PER SET 11Nov17 Note:	
1 - EUROLINE 1 11Nov17 Note:	
1 - V GROOVE HANDRAIL 11Nov17 Note:	

EXTRAS AS PER OFFER

The Purchaser acknowledges that the Purchase Price is inclusive of all credits and promotional packages available at the time of purchase. Worksheet Note:	
The Vendor agrees that notwithstanding any other term or provision in this Agreement included in the Purchase Price and in addition to those items detailed in Schedule GP to the Agreement of Purchase and Sale, the Purchaser is entitled to a credit of Ten Worksheet Note:	

This Document is Extremely Time Sensitive - Printed 11 Nov 17 at 14:39

Layout Changes: ☐ Yes ☒ No

Sketch Attached: ☒ Yes ☐ No

Exterior Colour Scheme:

1. Cabinetry

	Style and Colour	Hardware
Kitchen / Breakfast	MONACO W823XZ4	2004
Laundry Room	ELISSE	
Powder Room	MONACO W823XZ4	2004
Master Ensuite Bathroom	MONACO W823XZ4	2004
Ensuite Bath - Bedroom 2	MONACO W823XZ4	2004
Ensuite Bath - Bedroom 3/4	MONACO W823XZ4	2004

Appliances:

Built In Appliances ☒ Yes ☐ No

Slide In Stove ☐ Yes ☒ No

Dishwasher Cabinet ☐ Closed ☒ Open

41" Upper Cabinets ☒ Yes ☐ No

Please NOTE: Standard Cabinet Height is 30"

Stove Opening

NOTE: If not specified, opening will be set to builder's standard opening of approximately 30" width

Fridge Opening

NOTE: If not specified, opening will be set to builder's standard opening of approximately 37" width x 74" height

** Refer to Construction Summary

2. Counters

	Counter	Edge
Kitchen / Breakfast	LAMINATE-WHITE CARRARA-4924-38	
Laundry Room		
Powder Room	LAMINATE-WHITE CARRARA-4924-38	
Master Ensuite Bathroom	LAMINATE- GREY GLACE 4142-60	
Ensuite Bath - Bedroom 2	LAMINATE-GREY GLACE 4142-60	
Ensuite Bath - Bedroom 3/4	LAMINATE-GREY GLACE 4142-60	

** Refer to Construction Summary

Purchaser:

Karamjit Singh DHILLON

Telephone Res. / Bus:

/

Decor Advisor:

Anne Federico

Lock Date:

13-Nov-17

Property: 34

Project: Lecco Ridge Developments Inc.

Model and Elevation: Juniper 7 Elev 2

Plan #: 20M-1184

11-Nov-17

3. Ceramic Flooring

		At a 45	Threshold-If App.
Entrance Vestibule	TILE-ARREDO ARGENTO 12X24	<input type="checkbox"/>	BIANCO CARRARA
Main Hall	HARWOOD	<input type="checkbox"/>	
Kitchen / Breakfast	TILE-ARREDO ARGENTO 12X24	<input type="checkbox"/>	BIANCO CARRARA
Laundry Room	TILE-RAINBOW LIGHT GREY	<input type="checkbox"/>	
Powder Room	TILE-ARREDO ARGENTO 12X24	<input type="checkbox"/>	BIANCO CARRARA
Master Ensuite Bathroom	TILE-ARREDO ARGENTO 12X24	<input type="checkbox"/>	
Ensuite Bath - Bedroom 2	TILE-ARREDO ARGENTO 12X24	<input type="checkbox"/>	
Ensuite Bath - Bedroom 3/4	TILE- ARREDO ARGENTO 12X24	<input type="checkbox"/>	
MUD ROOM-	TILE-ARREDO ARGENTO 12X24	<input type="checkbox"/>	
		<input type="checkbox"/>	
		<input type="checkbox"/>	

** Refer to Construction Summary

4. Ceramic Wall Tile

Master Ensuite Bathroom	Selection	Describe
Tub Deck Wall		
Tub Deck		
Tub Deck Skirt		
Shower Stall	TILE-GOLF GRIGIO 8X10	
Bathtub Enclosure Walls		
Ensuite Bath - Bedroom 2	TILE- GOLF GRIGIO 8X10	
Ensuite Bath - Bedroom 3/4	TILE- GOLF GRIGIO 8X10	
Kitchen Backsplash		

** Refer to Construction Summary - STANDARD GROUT THROUGHOUT UNLESS SPECIFIED

5. Plumbing Fixtures

All Bathrooms

White

Whirlpool

☐ Yes ☒ No

Dishwasher Rough-In

☒ Yes ☐ No

Waterline for Fridge

☐ Yes ☒ No

** Refer to Construction Summary

6. Trim Carpentry

Interior Doors	CLASSIQUE
Interior Trim	As Per Construction Specifications
Door Handles	As Per Construction Specifications
Exterior Front Door Handle	As Per Construction Specifications

** Refer to Construction Summary

Purchaser:

Karamjit Singh DHILLON

Telephone Res. / Bus:

/

Decor Advisor:

Anne Federico

Lock Date:

13-Nov-17

Property: 34

Project: Lecco Ridge Developments Inc.

Model and Elevation: Juniper 7 Elev 2

11-Nov-17

Plan #: 20M-1184

7. Other Flooring

Main Hall	STRIP-MIRAGE 5" RED OAK CHARCOAL CASHMERE	
Living Room	STRIP-MIRAGE 5" RED OAK CHARCOAL CASHMERE	
Dining Room	STRIP-MIRAGE 5" RED OAK CHARCOAL CASHMERE	
Family Room	STRIP-MIRAGE 5" RED OAK CHARCOAL CASHMERE	
Den / Library / Study	STRIP-MIRAGE 5" RED OAK CHARCOAL CASHMERE	
Basement Landing(If Applies)		
Lower Landing (If Applies)		
Upper Landing	STRIP-MIRAGE 5" RED OAK CHARCOAL CASHMERE	
Upper Hall	TORLYS MANHATTAN-EARL GREY OAK TL15012	
Master Bedroom	TORLYS MANHATTAN-EARL GREY OAK TL15012	
Bedroom #2	TORLYS MANHATTAN-EARL GREY OAK TL15012	
Bedroom #3	TORLYS MANHATTAN-EARL GREY OAK TL15012	
Bedroom #4	TORLYS MANHATTAN-EARL GREY OAK TL15012	
Bedroom #5		
Underpad	Type	Area

** Refer to Construction Summary

8. Railings and Pickets

Railing Type	3 1/4 V-GROOVE	Colour	MIRAGE CHARCOAL
Picket Type	EURO LINE 1 BLACK	Colour	BLACK
Stringer / Riser	STANDARD	Colour	MIRAGE CHARCOAL
Treads	STANDARD	Colour	MIRAGE CHARCOAL
Red Oak Stairs with Semi Gloss Finish		<input checked="" type="radio"/> Yes <input type="radio"/> No	

** Refer to Construction Summary

9. Wall Paint Flat Finish

Main & Upper Hall	22 WARM GREY	Master Bedroom	22 WARM GREY
Living Room	22 WARM GREY	Bedroom #2	22 WARM GREY
Dining Room	22 WARM GREY	Bedroom #3	22 WARM GREY
Kitchen / Breakfast	22 WARM GREY	Bedroom #4	22 WARM GREY
Family Room	22 WARM GREY	Bedroom #5	
Powder Room	22 WARM GREY	Master Ensuite	22 WARM GREY
Laundry Room	22 WARM GREY	Ensuite Bath - Bedroom 2	22 WARM GREY
Den/Library	22 WARM GREY	Ensuite Bath - Bedroom 3/4	22 WARM GREY
Trim Paint-Semi Gloss	BIRCH WHITE		

Smooth Ceilings First Floor ☐ Yes ☒ No

** Refer to Construction Summary

Purchaser:Karamjit Singh DHILLON

Telephone Res. / Bus: /

Decor Advisor:Anne Federico

Lock Date:13-Nov-17

Property: 34

Project: Lecco Ridge Developments Inc.

Model and Elevation: Juniper 7 Elev 2

11-Nov-17

Plan #: 20M-1184

10. Plaster Mouldings and Medallions

Entrance Vestibule			Kitchen/Breakfast		
Main Hall			Den/Library		
Living Room			Lower Landing		
Dining Room					
Family Room					

** Refer to Construction Summary

11. Fireplace

Living Room			Family Room			Other Room - Specify		
Purchased	As Per Plan	N/A	Purchased	As Per Plan	N/A	Purchased	As Per Plan	N/A
<input type="radio"/>	<input type="radio"/>	<input type="radio"/>	<input type="radio"/>	<input checked="" type="radio"/>	<input type="radio"/>	<input type="radio"/>	<input type="radio"/>	<input type="radio"/>

Fireplace Type		FLAT ON WALL	
Mantle Type		M2	
Colour / Stain		AS PER CONSTRUCTION SPECIFICATIONS	
Surround		BIANCO	
Hearth		N/A	

** Refer to Construction Summary

12. Heating and Air Conditioning

Air Conditioning	NO	Gas Provisions Stove	NO
Gas Provisions Dryer	NO	Gas Provisions Barbecue	NO
Comment			

** Refer to Construction Summary

13. Electrical

Plugs and Switches	<input checked="" type="radio"/> White	DECOR	Above Kitchen Cabinet Light	<input type="radio"/> Yes	<input checked="" type="radio"/> No
Hood Fan	STANDARD WHITE		Below Kitchen Cabinet Light	<input type="radio"/> Yes	<input checked="" type="radio"/> No
Appliances	Built in Cooktop	Built in Oven	Gas Stove	Microwave	
	<input checked="" type="radio"/> Yes <input type="radio"/> No	<input checked="" type="radio"/> Yes <input type="radio"/> No	<input type="radio"/> Yes <input checked="" type="radio"/> No	<input type="radio"/> Yes	<input checked="" type="radio"/> No
Dishwasher Rough-in	Yes				

** Refer to Construction Summary

14. General Comments

** Refer to Construction Summary

Disclaimers and Notes

- 1) Colours of all materials are as close as possible to builder's selection, but not necessarily identical due to variances in manufacturing.

2) Any extras listed above are null and void unless accompanied by a separate invoice/amendment. Said invoice must be paid in full.

3) The Purchaser agrees that this colour selection is final and that no changes will be permitted, unless required by the Vendor.

4) The Purchaser acknowledges reading and accepting document which contains other miscellaneous disclaimers.

Signature:_____ Date: _____

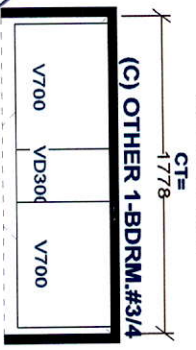
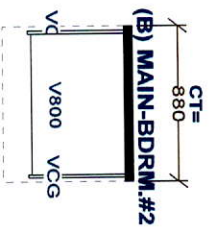
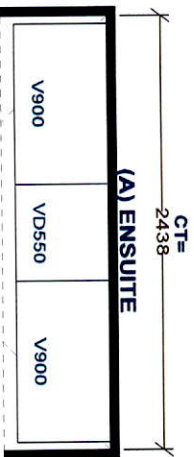
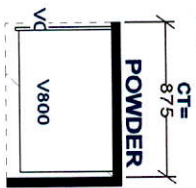
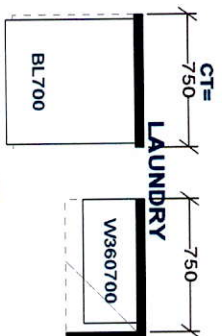
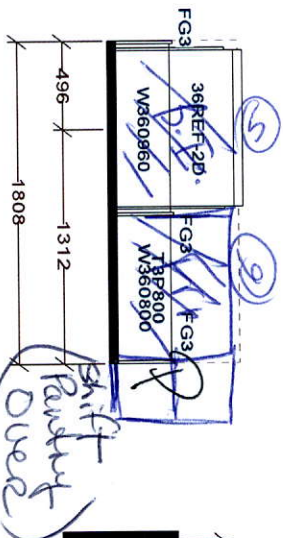
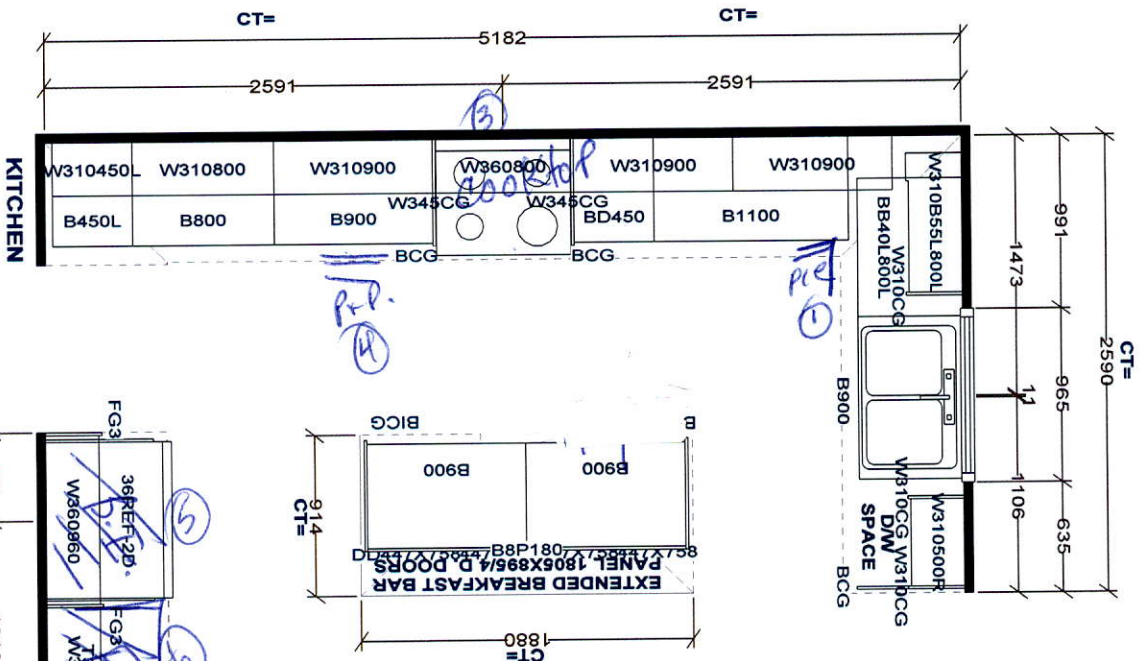

Selba Industries

<p>STANDARD FEATURES:</p> <p>9" CEILINGS WITH D/C BOX</p> <p>1040MM HIGH UPPER CABINETS</p> <p>DISHWASHER SPACE</p> <p>DUMMY DOORS ON EXPOSED BACKS</p> <p>LAMINATE KITCHEN & VANITY COUNTERTOPS</p>	<p>This drawing is the intellectual property of SELBA INDUSTRIES INC. and is an original design which must not be released or copied unless applicable fee has been paid or per order placed.</p>	<p>JOB NUMBER:</p> <p>BUILDER: GREENPARK HOMES</p> <p>SITE NAME: LECO RIDGE, MILLION</p> <p>MODEL: JUNIPER TX ELEV 1,2</p> <p>LOT #:</p> <p>DESIGNER: KS</p> <p>DATE: FEB-13-17</p>
--	---	---

