



CONSTRUCTION SUMMARY

Saddle Ridge (G) - Lecco Ridge Developments Inc.

PURCHASER: DEENA GH SAEED

TEL:

LOT / PHASE Block 346 TH 5 / 1	REG. PLAN # 20M-1184	HOUSE TYPE Ivy 5 Elev 2		
-----------------------------------	-------------------------	----------------------------	--	--

CABINETRY

1 - LIGHT VALENCE - KITCHEN 07Nov17 Note: NO ELECTRICAL	
---	--

CABINETRY ACCESSORIES

1 - KITCHEN CABINETRY UPPER - FULL DEPTH ABOVE FRIDGE - WITH GABLES - 600MM - PRICE IS EACH - STANDARD 07Nov17 Note:	
---	--

COUNTER TOP

1 - COUNTERTOP - HARD SURFACE COUNTERTOP - POWDER ROOM VANITY COUNTERTOP 07Nov17 Note: STANDARD DROP-IN SINK	
--	--

HARDWOOD FLOORING

1 - LAMINATE - LEXINGTON SERIES - - UPPER HALL 07Nov17 Note:	
---	--

MISCELLANEOUS

1 - credit balance waived 07Nov17 Note:	
--	--

PROMOTIONAL

1 - LESS CREDIT FROM PURCHASER EXTRA SHEET IN OFFER 07Nov17 Note:	
--	--

STAIRS AND RAILINGS

1 - STAINED STAIRS, RAILING AND PICKETS – STANDARD STAIRCASE - PRICE IS PER SET 07Nov17 Note:	
--	--

EXTRAS AS PER OFFER

Five (5) White Appliances as per PE Appliances Worksheet Note:	
The Vendor agrees that notwithstanding any other term or provision in this Agreement included in the Purchase Price and in addition to those items detailed in Schedule GP to the Agreement of Purchase and Sale, the Purchaser is entitled to a credit of Fiv Worksheet Note:	
The Purchaser acknowledges that the Purchase Price is inclusive of all credits and promotional packages available at the time of purchase. Worksheet Note:	

This Document is Extremely Time Sensitive - Printed 9 Nov 17 at 14:02

RECEIVED NOV 09 2017

Purchaser:DEENA GH SAEED

Property:Block 346 TH 5

Telephone Res. / Bus: /

Project:Lecco Ridge Developments Inc.

Decor Advisor:Candace Forza

Model and Elevation:Ivy 5 Elev 2

Lock Date:7-Nov-17

7-Nov-17

Plan #:20M-1184

Layout Changes:☐ Yes ☐ No

Sketch Attached:☐ Yes ☐ No

Exterior Colour Scheme:

1. Cabinetry

	Style and Colour	Hardware
Kitchen / Breakfast	MODENA WHITE	1001
Laundry Room	ELISSE	
Powder Room	MODENA WHITE	1001
Master Ensuite Bathroom	MODENA WHITE	1001
Main Bathroom	MODENA WHITE	1001

Appliances:

Built In Appliances☐ Yes ☒ No

Slide In Stove☐ Yes ☒ No

Dishwasher Cabinet

☐ Closed ☒ Open

41" Upper Cabinets☒ Yes ☐ No

Please NOTE: Standard Cabinet Height is 30"

Stove Opening

NOTE: If not specified, opening will be set to builder's standard opening of approximately 30" width

Fridge Opening

NOTE: If not specified, opening will be set to builder's standard opening of approximately 37" width x 74" height

** Refer to Construction Summary

2. Counters

	Counter	Edge
Kitchen / Breakfast	LAMINATE-PEARL SOAPSTONE 4886-38	
Laundry Room		
Powder Room	GRANITE-NERO IMPALA	320 EDGE
Master Ensuite Bathroom	LAMINATE-INUKSHUK CARBON P346-LM	
Main Bathroom	LAMINATE-INUKSHUK CARBON P346-LM	

** Refer to Construction Summary

Purchaser: DEENA GH SAEED

Property: Block 346 TH 5

Telephone Res. / Bus: /

Project: Lecco Ridge Developments Inc.

Decor Advisor: Candace Forza

Model and Elevation: Ivy 5 Elev 2

Lock Date: 7-Nov-17

7-Nov-17

Plan #: 20M-1184

3. Ceramic Flooring

		At a 45	Threshold-If App.
Entrance Vestibule	TILE-RAINBOW WHITE 13X13	<input type="checkbox"/>	Metal Strip- App-
Main Hall	LAMINATE	<input type="checkbox"/>	
Kitchen / Breakfast	TILE- RAINBOW LIGHT GREY 13X13	<input type="checkbox"/>	
Laundry Room	TILE-RAINBOW WHITE 13X13	<input type="checkbox"/>	
Powder Room	TILE-RAINBOW WHITE 13X13	<input type="checkbox"/>	
Master Ensuite Bathroom	TILE-RAINBOW LIGHT GREY 13X13	<input type="checkbox"/>	
Main Bathroom	TILE-SIENA IVORY 13X13	<input type="checkbox"/>	
Garage Entrance	Tile- Rainbow white 13x13	<input type="checkbox"/>	
		<input type="checkbox"/>	
		<input type="checkbox"/>	
		<input type="checkbox"/>	

** Refer to Construction Summary

4. Ceramic Wall Tile

Master Ensuite Bathroom	Selection	Describe
Tub Deck Wall	TILE- NATURALE GRIGIO 8X10	
Tub Deck		
Tub Deck Skirt		
Shower Stall	TILE-NATURALE GRIGIO 8X10	
Bathtub Enclosure Walls		
Main Bathroom	TILE-WHITE GLOSSY 8X8	
Kitchen Backsplash		

** Refer to Construction Summary - STANDARD GROUT THROUGHOUT UNLESS SPECIFIED

5. Plumbing Fixtures

All Bathrooms

White

Whirlpool

☐ Yes ☒ No

Dishwasher Rough-In

☒ Yes ☐ No

Waterline for Fridge

☐ Yes ☒ No

** Refer to Construction Summary

6. Trim Carpentry

Interior Doors	CLASSIQUE
Interior Trim	As Per Construction Specifications
Door Handles	As Per Construction Specifications
Exterior Front Door Handle	As Per Construction Specifications

** Refer to Construction Summary

Purchaser:DEENA GH SAEED

Telephone Res. / Bus: /

Decor Advisor:Candace Forza

Lock Date:7-Nov-17

Property: Block 346 TH 5

Project: Lecco Ridge Developments Inc.

Model and Elevation: Ivy 5 Elev 2

7-Nov-17

Plan #: 20M-1184

7. Other Flooring

Main Hall

Living Room

Dining Room

Family Room

Den / Library / Study

Basement Landing(If Applies)

Lower Landing (If Applies)

Upper Landing

Upper Hall

Master Bedroom

Bedroom #2

Bedroom #3

Bedroom #4

Bedroom #5

LAMINATE-LEXINGTON- HAZELWOOD OAK TL 21016-M

LAMINATE-LEXINGTON- HAZELWOOD OAK TL 21016-M

LAMINATE-LEXINGTON- HAZELWOOD OAK TL 21016-M

LAMINATE-LEXINGTON- HAZELWOOD OAK TL 21016-M

LAMINATE-LEXINGTON- HAZELWOOD OAK TL 21016-M

LAMINATE-LEXINGTON- HAZELWOOD OAK TL 21016-M

LAMINATE-LEXINGTON- HAZELWOOD OAK TL 21016-M

CARPET- NEWBERN 30949-MORNING FOG 00530

CARPET- NEWBERN 30949-MORNING FOG 00530

CARPET- NEWBERN 30949-MORNING FOG 00530

Underpad

Type

Area

** Refer to Construction Summary

8. Railings and Pickets

Railing Type

Picket Type

Stringer / Riser

Treads

STANDARD

STANDARD

STANDARD

STANDARD

Colour

Colour

Colour

Colour

TORLYS HAZELWOOD OAK

TORLYS HAZELWOOD OAK

TORLYS HAZELWOOD OAK

TORLYS HAZELWOOD OAK

Red Oak Stairs with Semi Gloss Finish

YesNo

** Refer to Construction Summary

9. Wall Paint Flat Finish

Main & Upper Hall

Living Room

Dining Room

Kitchen / Breakfast

Family Room

Powder Room

Laundry Room

Den/Library

Trim Paint-Semi Gloss

43 BIRCH WHITE

43 BIRCH WHITE

43 BIRCH WHITE

43 BIRCH WHITE

43 BIRCH WHITE

43 BIRCH WHITE

43 BIRCH WHITE

BIRCH WHITE

Master Bedroom

Bedroom #2

Bedroom #3

Bedroom #4

Bedroom #5

Master Ensuite

Main Bathroom

43 BIRCH WHITE

43 BIRCH WHITE

43 BIRCH WHITE

43 BIRCH WHITE

43 BIRCH WHITE

Smooth Ceilings First Floor

YesNo

** Refer to Construction Summary

Initial: DS

Page 3 of 4

Printed 11/7/2017 11:48:47

Purchaser:DEENA GH SAEED

Telephone Res. / Bus: /

Decor Advisor:Candace Forza

Lock Date:7-Nov-17

Property: Block 346 TH 5

Project: Lecco Ridge Developments Inc.

Model and Elevation: Ivy 5 Elev 2

7-Nov-17

Plan #: 20M-1184

10. Plaster Mouldings and Medallions

Entrance Vestibule			Kitchen/Breakfast		
Main Hall			Den/Library		
Living Room			Lower Landing		
Dining Room					
Family Room					

** Refer to Construction Summary

11. Fireplace

Living Room			Family Room			Other Room - Specify		
Purchased	As Per Plan	N/A	Purchased	As Per Plan	N/A	Purchased	As Per Plan	N/A
<input type="radio"/>	<input type="radio"/>	<input type="radio"/>	<input type="radio"/>	<input type="radio"/>	<input checked="" type="radio"/>	<input type="radio"/>	<input type="radio"/>	<input type="radio"/>

Fireplace Type			
Mantle Type			
Colour / Stain			
Surround			
Hearth			

** Refer to Construction Summary

12. Heating and Air Conditioning

Air Conditioning		Gas Provisions Stove	
Gas Provisions Dryer		Gas Provisions Barbecue	
Comment			

** Refer to Construction Summary

13. Electrical

Plugs and Switches	<input checked="" type="radio"/> White	DECOR	Above Kitchen Cabinet Light	<input type="radio"/> Yes	<input checked="" type="radio"/> No
Hood Fan	STANDARD WHITE		Below Kitchen Cabinet Light	<input type="radio"/> Yes	<input checked="" type="radio"/> No
Appliances	Built in Cooktop	Built in Oven	Gas Stove	Microwave	
	<input type="radio"/> Yes <input checked="" type="radio"/> No	<input type="radio"/> Yes <input checked="" type="radio"/> No	<input type="radio"/> Yes <input checked="" type="radio"/> No	<input type="radio"/> Yes	<input checked="" type="radio"/> No
Dishwasher Rough-in	Yes				

** Refer to Construction Summary

14. General Comments

** Refer to Construction Summary

Disclaimers and Notes

1) Colours of all materials are as close as possible to builder's selection, but not necessarily identical due to variances in manufacturing.

2) Any extras listed above are null and void unless accompanied by a separate invoice/amendment. Said invoice must be paid in full.

3) The Purchaser agrees that this colour selection is final and that no changes will be permitted, unless required by the Vendor.

4) The Purchaser acknowledges reading and accepting document which contains other miscellaneous disclaimers.

Signature: Deena Date: 7th Nov 2017

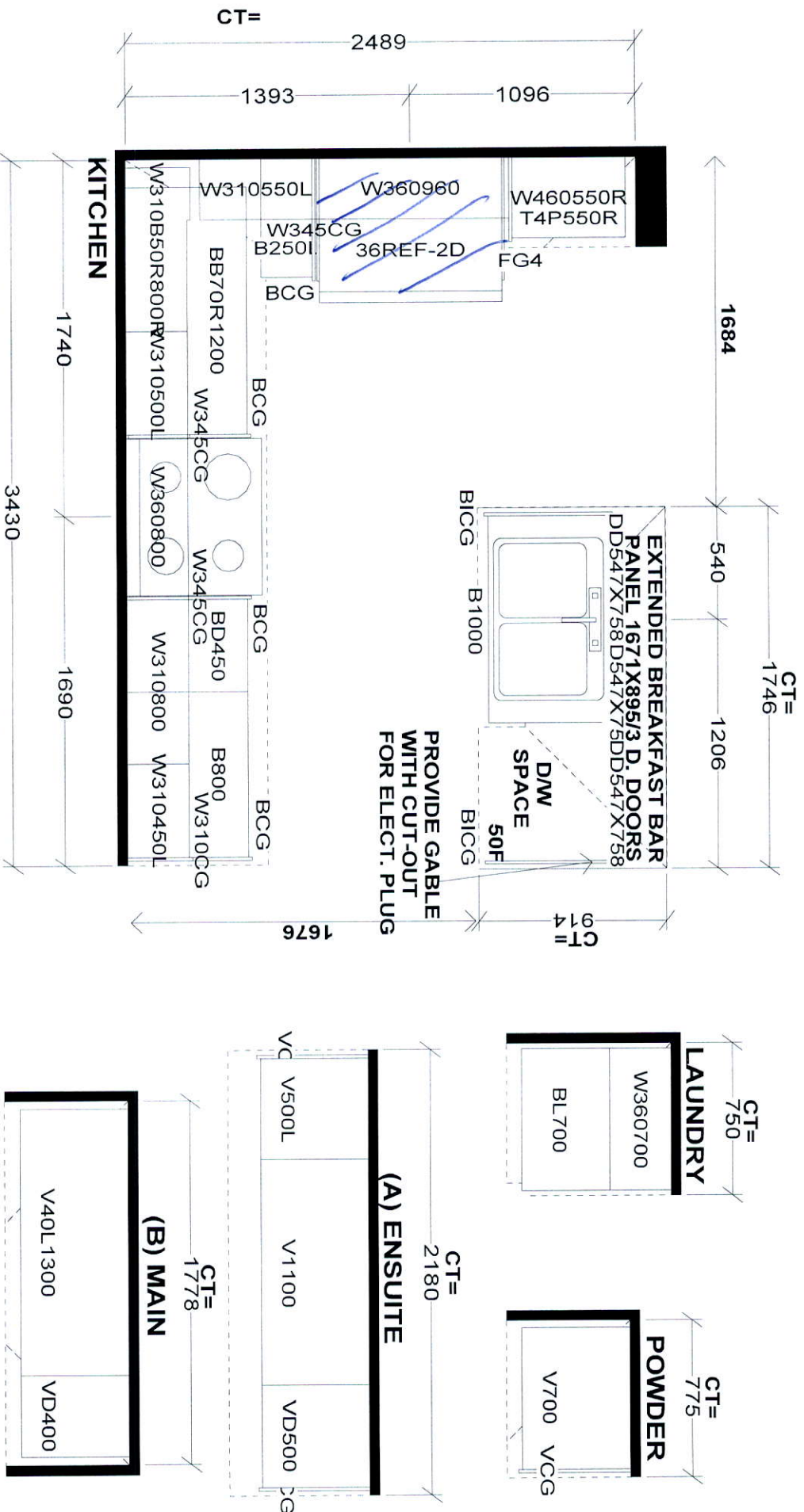

S e l b a I n d u s t r i e s

STANDARD FEATURES:

9' CEILINGS WITH D/C BOX
1040MM HIGH UPPER CABINETS
DISHWASHER SPACE
DUMMY DOORS ON EXPOSED BACKS
LAMINATE KITCHEN & VANITY COUNTERTOPS

This drawing is the intellectual property of SELBA INDUSTRIES INC. and is an original design which must not be released or copied unless applicable fee has been paid or job order placed.



JOB NUMBER:

BUILDER: GREENPARK HOMES
SITE NAME: LECGO RIDGE, Milton
MODEL: IVY 5X ELEV 1,2,3
LOT #:
DESIGNER: KS
DATE: FEB 13 17

IVY 5 2,028 SQ.FT. includes 10 sq. ft. of open area

AVAILABLE IN BLOCK: 325, 326, 327, 328, 329, 330
331, 336, 337, 338, 342, 343, 345, 346 & 349

