

CONSTRUCTION SUMMARY

Saddle Ridge (G) - Lecco Ridge Developments Inc.



PURCHASER: M. CAPITAL INC.

TEL:

LOT / PHASE Block 330 TH 8 / 1	REG. PLAN # 20M-1184	HOUSE TYPE Ivy 12 Elev 2		
-----------------------------------	-------------------------	-----------------------------	--	--

Ceramic Tile

1 - TILE - UPGRADE 1 FLOOR TILE - - SIDE ENTRANCE 06Sep17 Note:	
1 - TILE - UPGRADE 1 FLOOR TILE - - POWDER ROOM 06Sep17 Note:	
1 - TILE - UPGRADE 1 FLOOR TILE - - KITCHEN 06Sep17 Note:	
1 - TILE - UPGRADE 1 FLOOR TILE - - FOYER 06Sep17 Note:	

MISCELLANEOUS

1 - VENDOR DISCOUNT 06Sep17 Note:	
--------------------------------------	--

PLUMBING

1 - WASHROOM - 3 PIECE ROUGH-IN IN BASEMENT 25May17 Note:	
--	--

PROMOTIONAL

1 - LESS BALANCE OF CREDIT FROM PURCHASER EXTRA SHEET IN OFFER 06Sep17 Note:	
1 - PARTIAL REDEMPTION OF PROMOTIONAL PACKAGE \$\$\$\$\$\$ BALANCE FORWARD TO BE USED AT A LATER DATE. ORIGINAL PROMOTIONAL PACKAGE OF \$\$\$\$ AS PER SCHEDULE PE DATED MMMDDYYYY. 25May17 Note: ORIGINAL PROMO PACKAGE - \$5000.00 BALANCE FORWARD - \$4360.00	

STAIRS AND RAILINGS

1 - STAINED STAIRS, RAILING AND PICKETS - FIRST TO SECOND FLOOR - STANDARD STAIRCASE 06Sep17 Note:	
---	--

EXTRAS AS PER OFFER

Five (5) White Appliances as per PE Appliances Worksheet Note:	
The Vendor agrees that notwithstanding any other term or provision in this Agreement included in the Purchase Price and in addition to those items detailed in Schedule GP to the Agreement of Purchase and Sale, the Purchaser is entitled to a credit of Fiv Worksheet Note:	
The Purchaser acknowledges that the Purchase Price is inclusive of all credits and promotional packages available at the time of purchase. Worksheet Note:	
COMPLETE CENTRAL AIR CONDITIONING Worksheet Note:	

This Document is Extremely Time Sensitive - Printed 6 Sep 17 at 15:08

RECEIVED SEP 08 2017

Purchaser: M. CAPITAL INC.

Property: Block 330 TH 8

Telephone Res. / Bus: /

Project: Lecco Ridge Developments Inc.

Decor Advisor: Candace Forza

Model and Elevation: Ivy 12 Elev 2

Lock Date: 6-Sep-17

6-Sep-17

Plan #: 20M-1184

Layout Changes: ☐ Yes ☐ No

Sketch Attached: ☐ Yes ☐ No

Exterior Colour Scheme:

1. Cabinetry

	Style and Colour	Hardware
Kitchen / Breakfast	Everest P790XZ9	2002
Laundry Room	ELISSE	Standard
Powder Room	Everest P790XZ9	2004
Master Ensuite Bathroom	Everest P790XZ9	2004
Main Bathroom	MONACO W350XZ4	2004
	N/A	N/A
	N/A	N/A
	N/A	N/A
	N/A	N/A
	N/A	N/A

Appliances:

Built In Appliances ☐ Yes ☒ No

Slide In Stove ☐ Yes ☒ No

Dishwasher Cabinet ☐ Closed ☒ Open

41" Upper Cabinets ☒ Yes ☐ No

Please NOTE: Standard Cabinet Height is 30"

Stove Opening

NOTE: If not specified, opening will be set to builder's standard opening of approximately 30" width

Fridge Opening

NOTE: If not specified, opening will be set to builder's standard opening of approximately 37" width x 74" height

\*\* Refer to Construction Summary

2. Counters

	Counter	Edge
Kitchen / Breakfast	LAMINATE-INUKSHUK GREY-P-344 LM	
Laundry Room	N/A	
Powder Room	LAMINATE-CARRARA BIANCO-6696-46	
Master Ensuite Bathroom	LAMINATE-CALCUTTA MARBLE-4925K-07	
Main Bathroom	LAMINATE-WHITE CARRARA-4924-38	
	N/A	
	N/A	
	N/A	
	N/A	

\*\* Refer to Construction Summary

Printed 9/6/2017 15:08:10

Initial: 

Page 1 of 4



**Purchaser:** M. CAPITAL INC.

Property: Block 330 TH 8

Telephone Res. / Bus: /

**Project:** Lecco Ridge Developments Inc.

Decor Advisor: Candace Forza

**Model and Elevation:** Ivy 12 Elev 2

Lock Date: 6-Sep-17

6-Sep-17

Plan #: 20M-1184

### –3. Ceramic Flooring

		At a 45°	Threshold-If App.
Entrance Vestibule	TILE-EE0028 LUXOR GRIGIO-18x18	<input type="checkbox"/>	METAL STRIP
Main Hall	N/A	<input type="checkbox"/>	
Kitchen / Breakfast	TILE-EE0028 LUXOR GRIGIO-18x18	<input type="checkbox"/>	METAL STRIP
Laundry Room	TILE-RAINBOW WHITE-13X13	<input type="checkbox"/>	METAL STRIP
Powder Room	TILE-EE0028 LUXOR GRIGIO-18x18	<input type="checkbox"/>	
Master Ensuite Bathroom	TILE-BEACHES LIGHT GREY-13X13	<input type="checkbox"/>	METAL STRIP
Main Bathroom	TILE-HABITAT SILVER GREY-12X12	<input type="checkbox"/>	METAL STRIP
SIDE ENTRANCE	TILE-EE0028 LUXOR GRIGIO-18x18	<input type="checkbox"/>	
	N/A	<input type="checkbox"/>	
	N/A	<input type="checkbox"/>	
	N/A	<input type="checkbox"/>	

\*\* Refer to Construction Summary

#### 4. Ceramic Wall Tile

Master Ensuite Bathroom	Selection	Describe
Tub Deck Wall	TILE-MATTE WHITE-8X8	
Tub Deck	N/A	
Tub Deck Skirt	N/A	
Shower Stall	TILE-MATTE WHITE-8X8	
Bathtub Enclosure Walls	N/A	
	N/A	
Main Bathroom	TILE-MATTE WHITE-8X8	
	N/A	
	N/A	
	N/A	
Kitchen Backsplash	N/A	

**\*\* Refer to Construction Summary - STANDARD GROUT THROUGHOUT UNLESS SPECIFIED**

## 5. Plumbing Fixtures

All Bathrooms	White	Whirlpool	Dishwasher Rough-In	Waterline for Fridge
N/A		N/A	<input checked="" type="radio"/> Yes <input type="radio"/> No	<input type="radio"/> Yes <input checked="" type="radio"/> No
N/A			<input type="radio"/> Yes <input type="radio"/> No	<input type="radio"/> Yes <input checked="" type="radio"/> No
N/A			<input type="radio"/> Yes <input type="radio"/> No	<input type="radio"/> Yes <input checked="" type="radio"/> No
N/A			<input type="radio"/> Yes <input type="radio"/> No	<input type="radio"/> Yes <input checked="" type="radio"/> No
N/A			<input type="radio"/> Yes <input type="radio"/> No	<input type="radio"/> Yes <input checked="" type="radio"/> No

**\*\* Refer to Construction Summary**

## 6. Trim Carpentry

Interior Doors	CLERMONT
Interior Trim	As Per Construction Specifications
Door Handles	As Per Construction Specifications
Exterior Front Door Handle	As Per Construction Specifications

\*\* Refer to Construction Summary

Initial:





Purchaser:

M. CAPITAL INC.

Telephone Res. / Bus: /

Decor Advisor:

Candace Forza

Lock Date:

6-Sep-17

Property: Block 330 TH 8

Project: Lecco Ridge Developments Inc.

Model and Elevation: Ivy 12 Elev 2

6-Sep-17

Plan #: 20M-1184

7. Other Flooring

Main Hall	N/A
Living Room	N/A
Dining Room	Laminate - Park Lane - Heritage Oak QS-U1386
Family Room	Laminate - Park Lane - Heritage Oak QS-U1386
Den / Library / Study	Laminate - Park Lane - Heritage Oak QS-U1386
Basement Landing(If Applies)	N/A
Lower Landing (If Applies)	Laminate - Park Lane - Heritage Oak QS-U1386
Upper Landing	Laminate - Park Lane - Heritage Oak QS-U1386
Upper Hall	CARPET-SHAW-NEWBERN CLASSIC-MORNING FOG-00530
Master Bedroom	CARPET-SHAW-NEWBERN CLASSIC-MORNING FOG-00530
Bedroom #2	CARPET-SHAW-NEWBERN CLASSIC-MORNING FOG-00530
Bedroom #3	CARPET-SHAW-NEWBERN CLASSIC-MORNING FOG-00530
Bedroom #4	CARPET-SHAW-NEWBERN CLASSIC-MORNING FOG-00530
Bedroom #5	N/A
	N/A
	N/A
	N/A
Underpad	TypeArea
	STANDARDSECOND FLOOR

\*\* Refer to Construction Summary

8. Railings and Pickets

Railing Type	AS PER CONSTRUCTION SPECIFICATIONS	Colour	TORLYS HERITAGE OAK
Picket Type	AS PER CONSTRUCTION SPECS	Colour	TORLYS HERITAGE OAK
Stringer / Riser	AS PER CONSTRUCTION SPECS	Colour	TORLYS HERITAGE OAK
Treads	AS PER CONSTRUCTION SPECS	Colour	TORLYS HERITAGE OAK
Red Oak Stairs with Semi Gloss Finish		<input checked="" type="radio"/> Yes <input type="radio"/> No	

\*\* Refer to Construction Summary

9. Wall Paint Flat Finish

Main & Upper Hall	22 WARM GREY	Master Bedroom	22 WARM GREY
Living Room	N/A	Bedroom #2	22 WARM GREY
Dining Room	22 WARM GREY	Bedroom #3	22 WARM GREY
Kitchen / Breakfast	22 WARM GREY	Bedroom #4	22 WARM GREY
Family Room	22 WARM GREY	Bedroom #5	N/A
Powder Room	22 WARM GREY	Master Ensuite	22 WARM GREY
Laundry Room	22 WARM GREY	Main Bathroom	22 WARM GREY
Den/Library	22 WARM GREY		N/A
Trim Paint-Semi Gloss	BIRCH WHITE		N/A
	N/A		N/A
	N/A		N/A
Smooth Ceilings First Floor	<input type="radio"/> Yes		<input checked="" type="radio"/> No

\*\* Refer to Construction Summary

Initial:



Purchaser: M. CAPITAL INC.

Telephone Res. / Bus: /

Decor Advisor: Candace Forza

Lock Date: 6-Sep-17

Property: Block 330 TH 8

Project: Lecco Ridge Developments Inc.

Model and Elevation: Ivy 12 Elev 2

Plan #: 20M-1184

10. Plaster Mouldings and Medallions

Entrance Vestibule	N/A	N/A	Kitchen/Breakfast	N/A	N/A
Main Hall	N/A	N/A	Den/Library	N/A	N/A
Living Room	N/A	N/A	Lower Landing	N/A	N/A
Dining Room	N/A	N/A		N/A	N/A
Family Room	N/A	N/A			

\*\* Refer to Construction Summary

11. Fireplace

	Living Room			Family Room			Other Room - Specify		
	Purchased	As Per Plan	N/A	Purchased	As Per Plan	N/A	Purchased	As Per Plan	N/A
	<input type="radio"/>	<input type="radio"/>	<input checked="" type="radio"/>	<input type="radio"/>	<input type="radio"/>	<input checked="" type="radio"/>	<input type="radio"/>	<input type="radio"/>	<input checked="" type="radio"/>
Fireplace Type	N/A			N/A			N/A		
Mantle Type	N/A			N/A			N/A		
Colour / Stain	N/A			N/A			N/A		
Surround	N/A			N/A			N/A		
Hearth	N/A			N/A			N/A		

\*\* Refer to Construction Summary

12. Heating and Air Conditioning

Air Conditioning	YES	Gas Provisions Stove	NO
Gas Provisions Dryer	NO	Gas Provisions Barbecue	NO
Comment			

\*\* Refer to Construction Summary

13. Electrical

Plugs and Switches	<input checked="" type="radio"/> White	DECOR	Above Kitchen Cabinet Light	<input type="radio"/> Yes	<input checked="" type="radio"/> No
Hood Fan	STANDARD		Below Kitchen Cabinet Light	<input type="radio"/> Yes	<input checked="" type="radio"/> No
Appliances	Built in Cooktop	Built in Oven	Gas Stove	Microwave	
	<input type="radio"/> Yes <input checked="" type="radio"/> No	<input type="radio"/> Yes <input checked="" type="radio"/> No	<input type="radio"/> Yes <input checked="" type="radio"/> No	<input type="radio"/> Yes <input checked="" type="radio"/> No	<input type="radio"/> Yes <input checked="" type="radio"/> No
Dishwasher Rough-in	Yes				

\*\* Refer to Construction Summary

14. General Comments

\*\* Refer to Construction Summary

Disclaimers and Notes

1) Colours of all materials are as close as possible to builder's selection, but not necessarily identical due to variances in manufacturing.

2) Any extras listed above are null and void unless accompanied by a separate invoice/amendment. Said invoice must be paid in full.

3) The Purchaser agrees that this colour selection is final and that no changes will be permitted, unless required by the Vendor.

4) The Purchaser acknowledges reading and accepting document which contains other miscellaneous disclaimers.

Signature:  Date: \_\_\_\_\_

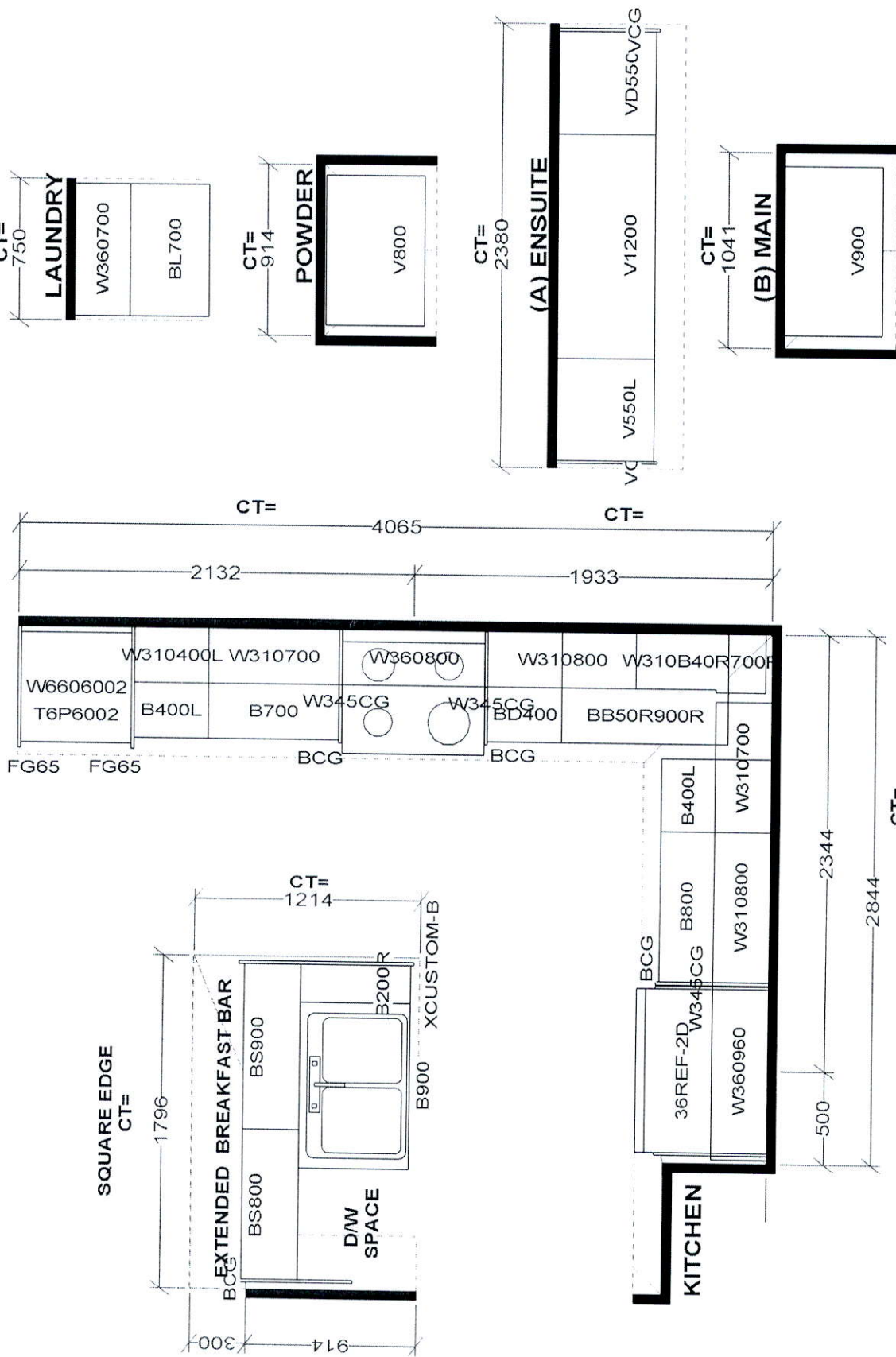

S e l b a I n d u s t r i e s

<p>STANDARD FEATURES:</p> <p>9' CEILINGS WITH D/C BOX</p> <p>1040MM HIGH UPPER CABINETS</p> <p>DISHWASHER SPACE</p> <p>DUMMY DOORS ON EXPOSED BACKS</p> <p>LAMINATE KITCHEN &amp; VANITY COUNTERTOPS</p>	<p>This drawing is the intellectual property of SELBA INDUSTRIES INC. and is an original design which must not be released or copied unless applicable fee has been paid or job order placed.</p>	<p>JOB NUMBER:</p> <p>BUILDER: GREENPARK HOMES</p> <p>SITE NAME: LECCO RIDGE, Milton</p> <p>MODEL: IVY 12X ELEV 1,2,3</p> <p>LOT #:</p> <p>DESIGNER: KS</p> <p>DATE: FEB 13 17</p>
--	---	--



**IVY12** 2,363 SQ.FT.

AVAILABLE IN BLOCK: 324, 325, 326, 330, 331, 337,  
340, 342, 345, 346, 347 & 349

