



CONSTRUCTION SUMMARY

Saddle Ridge (G) - Lecco Ridge Developments Inc.

TEL:

PURCHASER: Nadine MIZZONI

LOT / PHASE 47 / 1	REG. PLAN # 20M-1184	HOUSE TYPE Juniper 9 Elev 3		
-----------------------	-------------------------	--------------------------------	--	--

CABINETRY

1 - VANITY - UPGRADE 2 - POWDER ROOM 11Oct17 Note:	
1 - KITCHEN - MONACO CABINETRY WITH UPGRADE STAIN 11Oct17 Note:	

CABINETRY ACCESSORIES

1 - KITCHEN CABINETRY UPPER - FULL DEPTH ABOVE FRIDGE - WITH GABLES - 600MM - PRICE IS EACH - STANDARD 11Oct17 Note:	
---	--

Ceramic Tile

1 - TILE - UPGRADE 1 FLOOR TILE - - KITCHEN 11Oct17 Note:	
1 - TILE - UPGRADE 1 FLOOR TILE - - POWDER ROOM 11Oct17 Note:	
1 - TILE - UPGRADE 1 FLOOR TILE - - FOYER 11Oct17 Note:	

CONSTRUCTION

1 - RAISE NOSING ON UPPER HALL FOR FUTURE HARDWOOD FLOORING 11Oct17 Note:	
1 - ADD BASEMENT WALK-UP 19Dec16 Note:	

COUNTER TOP

1 - POWDER ROOM VANITY COUNTER TOP 11Oct17 Note: QUARTZ WITH STANDARD DROP IN SINK	
1 - KITCHEN COUNTER TOP 11Oct17 Note: QUARTZ	

HARDWOOD FLOORING

1 - HARDWOOD - GROUP A SERIES 5" - FIRST FLOOR - IN LIEU OF 2 1/4" NATURAL RED OAK 11Oct17 Note:	
---	--

PLUMBING

1 - UNDERMOUNT - SINK UNDERMOUNT - BLANCO HORIZON U2 8" #401234 11Oct17 Note: Kitchen	
--	--

PROMOTIONAL

1 - LESS CREDIT FROM PURCHASER EXTRA SHEET IN OFFER 11Oct17 Note:	
--	--

STAIRS AND RAILINGS

1 - EUROLINE 1 11Oct17 Note: BACK IRON STAIR PICKETS	
1 - STAINED HANDRAIL, TREADS, RISERS AND STRINGER EXCLUDING PICKETS (FOR IRON PICKETS) - STANDARD STAIRCASE - PRICE IS PER SET 11Oct17 Note:	

RECEIVED OCT 19 2017



CONSTRUCTION SUMMARY	
Saddle Ridge (G) - Lecco Ridge Developments Inc.	
PURCHASER: Nadine MIZZONI	TEL:

LOT / PHASE 47 / 1	REG. PLAN # 20M-1184	HOUSE TYPE Juniper 9 Elev 3		
------------------------------	--------------------------------	---------------------------------------	--	--

EXTRAS AS PER OFFER

The Purchaser acknowledges that the Purchase Price is inclusive of all credits and promotional packages available at the time of purchase. <i>Worksheet Note:</i>	
The Vendor agrees that notwithstanding any other term or provision in this Agreement included in the Purchase Price and in addition to those items detailed in Schedule GP to the Agreement of Purchase and Sale, the Purchaser is entitled to a credit of Ten <i>Worksheet Note:</i>	

This Document is Extremely Time Sensitive - Printed 11 Oct 17 at 17:52

Purchaser:

Nadine MIZZONI

Telephone Res. / Bus:

/

Decor Advisor:

Candace Forza

Lock Date:

11-Oct-17

Property: 47

Project: Lecco Ridge Developments Inc.

Model and Elevation: Juniper 9 Elev 3

Plan #: 20M-1184

Layout Changes:

☐ Yes ☒ No

Sketch Attached:

☒ Yes ☐ No

Exterior Colour Scheme:

1. Cabinetry

	Style and Colour	Hardware
Kitchen / Breakfast	MONACO W 823XZ4	1001
Laundry Room	ELISSE	
Powder Room	HAMPTON W823XZ4	1001
Master Ensuite Bathroom	MONACO W350XZ4	1001
Ensuite Bath - Bedroom 2/3	Monaco W350XZ4	1001
Ensuite Bath - Bedroom 4	Monaco W350XZ4	1001
Ensuite Bath - Bedroom 5	Monaco W350XZ4	1001

Appliances:

Built In Appliances

☐ Yes ☒ No

Slide In Stove

☐ Yes ☒ No

Dishwasher Cabinet

☐ Closed ☒ Open

41" Upper Cabinets

☒ Yes ☐ No

Please NOTE: Standard Cabinet Height is 30"

Stove Opening

NOTE: If not specified, opening will be set to builder's standard opening of approximately 30" width

Fridge Opening

NOTE: If not specified, opening will be set to builder's standard opening of approximately 37" width x 74" height

** Refer to Construction Summary

2. Counters

	Counter	Edge
Kitchen / Breakfast	QUARTZ-VICTORIA	320 EDGE
Laundry Room		
Powder Room	QUARTZ-METROPOLIS BEIGE	320 EDGE
Master Ensuite Bathroom	LAMINATE-WHITE CARRARA 4924-38	
Ensuite Bath - Bedroom 2/3	LAMINATE-INUK SHUR GREY P344 LM	
Ensuite Bath - Bedroom 4	LAMINATE- PEARLSOAP STONE 4886-38	
Ensuite Bath - Bedroom 5	LAMINATE- PEARL SOAP STONE 4886-38	

** Refer to Construction Summary

Purchaser:

Nadine MIZZONI

Telephone Res. / Bus:

/

Decor Advisor:

Candace Forza

Lock Date:

11-Oct-17

Property: 47

Project: Lecco Ridge Developments Inc.

Model and Elevation: Juniper 9 Elev 3

Plan #: 20M-1184

3. Ceramic Flooring

At a 45 Threshold-If App.

Entrance Vestibule	TILE- FM45GL001S GLOSSY WHITE 18X18	<input type="checkbox"/>	METAL STRIP
Main Hall	HARDWOOD	<input type="checkbox"/>	
Kitchen / Breakfast	TILE-FM45GL001S GLOSSY WHITE 18X18	<input type="checkbox"/>	
Laundry Room	TILE-RAINBOW LIGHT GREY 13X13	<input type="checkbox"/>	
Powder Room	TILE-FM45GL001S GLOSSY WHITE 18X18	<input type="checkbox"/>	
Master Ensuite Bathroom	TILE-RAINBOW LIGHT GREY 13X13	<input type="checkbox"/>	
Ensuite Bath - Bedroom 2/3	TILE-RAINBOW LIGHT GREY 13X13	<input type="checkbox"/>	
Ensuite Bath - Bedroom 4	TILE-RAINBOW WHITE 13X13	<input type="checkbox"/>	
Ensuite Bath - Bedroom 5	TILE-RAINBOW WHITE 13X13	<input type="checkbox"/>	
		<input type="checkbox"/>	
		<input type="checkbox"/>	

** Refer to Construction Summary

4. Ceramic Wall Tile

Master Ensuite Bathroom	Selection	Describe
Tub Deck Wall		
Tub Deck		
Tub Deck Skirt		
Shower Stall	TILE-STARDUST GRIGIO 8X16	
Bathtub Enclosure Walls		
Ensuite Bath - Bedroom 2/3	TILE-BIANCO MATT 8X16	
Ensuite Bath - Bedroom 4	TILE-BIANCO MATT 8X16	
Ensuite Bath - Bedroom 5	TILE-BIANCO MATT 8X16	
Kitchen Backsplash		

** Refer to Construction Summary - STANDARD GROUT THROUGHOUT UNLESS SPECIFIED

5. Plumbing Fixtures

All Bathrooms

White

Whirlpool

☐ Yes ☒ No

Dishwasher Rough-In

☒ Yes ☐ No

Waterline for Fridge

☐ Yes ☒ No

** Refer to Construction Summary

6. Trim Carpentry

Interior Doors	CLERMONT
Interior Trim	As Per Construction Specifications
Door Handles	As Per Construction Specifications
Exterior Front Door Handle	As Per Construction Specifications

** Refer to Construction Summary

Purchaser:

Telephone Res. / Bus:

Decor Advisor:

Lock Date:

Nadine MIZZONI

/

Candace Forza

11-Oct-17

Property: 47

Project: Lecco Ridge Developments Inc.

Model and Elevation: Juniper 9 Elev 3

Plan #: 20M-1184

7. Other Flooring

Main Hall

Living Room

Dining Room

Family Room

Den / Library / Study

Basement Landing(If Applies)

Lower Landing (If Applies)

Upper Landing

Upper Hall

Master Bedroom

Bedroom #2

Bedroom #3

Bedroom #4

Bedroom #5

MIRAGE RED OAK CHARCOAL 5" SEMI GLOSS

MIRAGE RED OAK CHARCOAL 5" SEMI GLOSS

MIRAGE RED OAK CHARCOAL 5" SEMI GLOSS

MIRAGE RED OAK CHARCOAL 5" SEMI GLOSS

MIRAGE RED OAK CHARCOAL 5" SEMI GLOSS

MIRAGE RED OAK CHARCOAL 5" SEMI GLOSS

MIRAGE RED OAK CHARCOAL 5" SEMI GLOSS

LAMINATE GREY VARNISHED OAK TLU1305

LAMINATE GREY VARNISHED OAK TLU1305

LAMINATE GREY VARNISHED OAK TLU1305

LAMINATE GREY VARNISHED OAK TLU1305

LAMINATE GREY VARNISHED OAK TLU1305

LAMINATE GREY VARNISHED OAK TLU1305

Underpad

Type

Area

** Refer to Construction Summary

8. Railings and Pickets

Railing Type

Picket Type

Stringer / Riser

Treads

AS PER CONSTRUCTION SPECIFICATIONS

EURO LINE 1 BLACK

STANDARD

STANDARD

Colour

Colour

Colour

Colour

MIRAGE CHARCOAL

BLACK

MIRAGE CHARCOAL

MIRAGE CHARCOAL

Red Oak Stairs with Semi Gloss Finish

☒ Yes

☐ No

** Refer to Construction Summary

9. Wall Paint Flat Finish

Main & Upper Hall

Living Room

Dining Room

Kitchen / Breakfast

Family Room

Powder Room

Laundry Room

Den/Library

Trim Paint-Semi Gloss

25 OYSTER

25 OYSTER

25 OYSTER

25 OYSTER

25 OYSTER

25 OYSTER

25 OYSTER

25 OYSTER

BIRCH WHITE

Master Bedroom

Bedroom #2

Bedroom #3

Bedroom #4

Bedroom #5

Master Ensuite

Ensuite Bath - Bedroom 2/3

Ensuite Bath - Bedroom 4

ENSUITE 5

25 OYSTER

25 OYSTER

25 OYSTER

25 OYSTER

25 OYSTER

22 WARM GREY

22 WARM GREY

22 WARM GREY

22 WARM GREY

Smooth Ceilings First Floor

☐ Yes

☒ No

** Refer to Construction Summary

Initial: _____

Page 3 of 4

Printed 10/11/2017 17:50:26

Purchaser: Nadine MIZZONI

Property: 47

Telephone Res. / Bus: /

Project: Lecco Ridge Developments Inc.

Decor Advisor: Candace Forza

Model and Elevation: Juniper 9 Elev 3

Lock Date: 11-Oct-17

11-Oct-17

Plan #: 20M-1184

10. Plaster Mouldings and Medallions

Entrance Vestibule			Kitchen/Breakfast		
Main Hall			Den/Library		
Living Room			Lower Landing		
Dining Room					
Family Room					

** Refer to Construction Summary

11. Fireplace

Living Room	Family Room	Other Room - Specify
Purchased As Per Plan N/A	Purchased As Per Plan N/A	Purchased As Per Plan N/A
<input type="radio"/> <input type="radio"/> <input checked="" type="radio"/>	<input type="radio"/> <input checked="" type="radio"/> <input type="radio"/>	<input type="radio"/> <input type="radio"/> <input checked="" type="radio"/>

Fireplace Type	FLAT ON WALL	
Mantle Type	M2	
Colour / Stain	AS PER CONSTRUCTION SPECIFICATIONS	
Surround	NERO MARQUINA	
Hearth		

** Refer to Construction Summary

12. Heating and Air Conditioning

Air Conditioning	NO	Gas Provisions Stove	NO
Gas Provisions Dryer	NO	Gas Provisions Barbecue	NO

Comment

** Refer to Construction Summary

13. Electrical

Plugs and Switches	<input checked="" type="radio"/> White DECOR	Above Kitchen Cabinet Light	<input type="radio"/> Yes <input checked="" type="radio"/> No	
Hood Fan	STANDARD WHITE	Below Kitchen Cabinet Light	<input type="radio"/> Yes <input checked="" type="radio"/> No	
Appliances	Built in Cooktop	Built in Oven	Gas Stove	Microwave
	<input type="radio"/> Yes <input checked="" type="radio"/> No	<input type="radio"/> Yes <input checked="" type="radio"/> No	<input type="radio"/> Yes <input checked="" type="radio"/> No	<input type="radio"/> Yes <input checked="" type="radio"/> No
Dishwasher Rough-in	Yes			

** Refer to Construction Summary

14. General Comments

** Refer to Construction Summary

Disclaimers and Notes

1) Colours of all materials are as close as possible to builder's selection, but not necessarily identical due to variances in manufacturing.

2) Any extras listed above are null and void unless accompanied by a separate invoice/amendment. Said invoice must be paid in full.

3) The Purchaser agrees that this colour selection is final and that no changes will be permitted, unless required by the Vendor.

4) The Purchaser acknowledges reading and accepting document which contains other miscellaneous disclaimers.

Signature: Date:

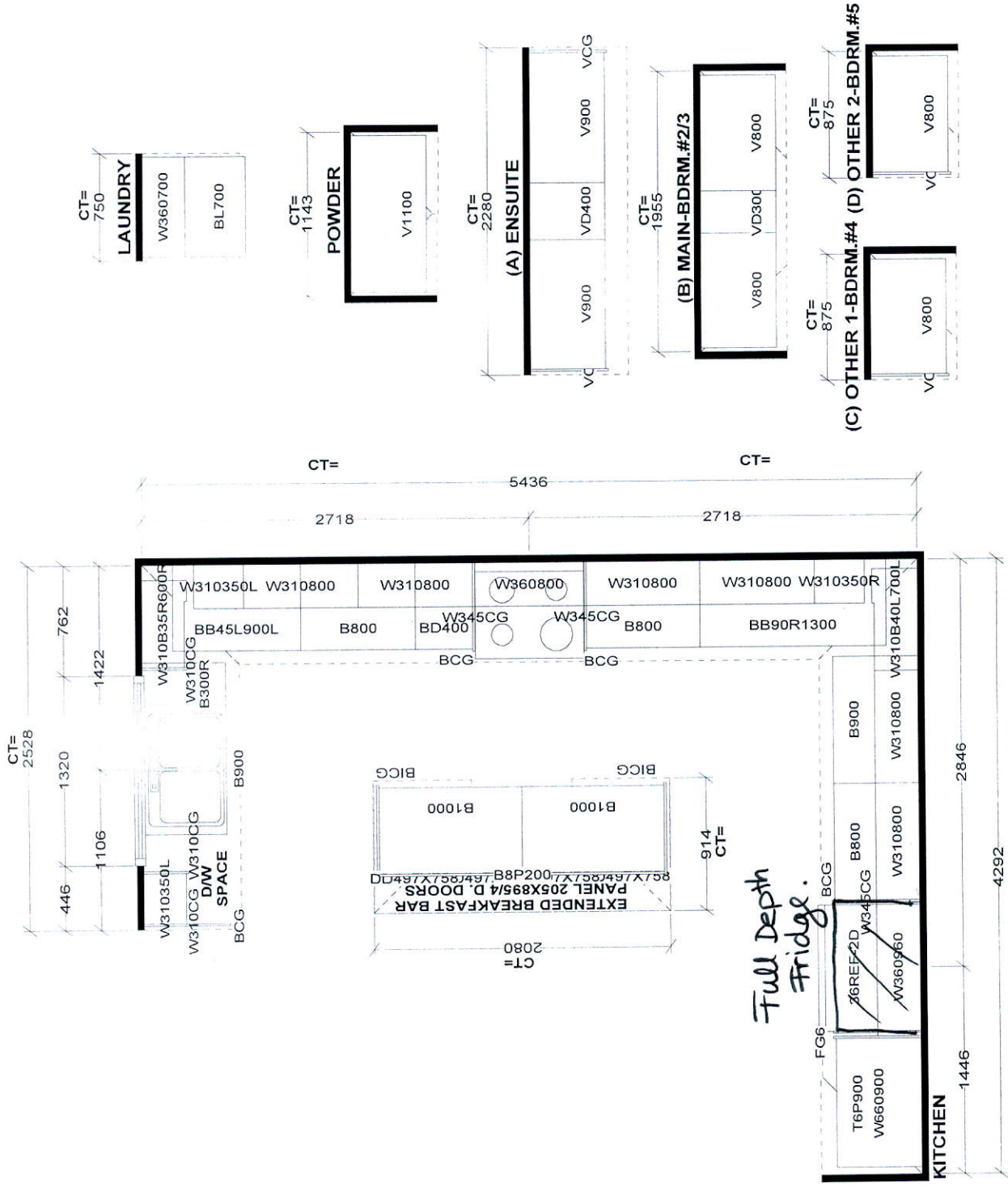

Full Depth
Fridge.

S e l b a I n d u s t r i e s

STANDARD FEATURES: 9' CEILINGS WITH D/C BOX 1040MM HIGH UPPER CABINETS DISHWASHER SPACE DUMMY DOORS ON EXPOSED BACKS LAMINATE KITCHEN & VANITY COUNTERTOPS	<p>This drawing is the intellectual property of SELBA INDUSTRIES INC. and is an unauthorised document. It is not to be released or copied unless applicable fee has been paid or job order placed.</p> <p>HA B G S E L B A I N D U S T R I E S P R I V A T E</p>	JOB NUMBER: BUILDER: GREENPARK HOMES SITE NAME: LECCO RIDGE, Milton MODEL: JUNIPER 9X ELEV 1,2,3 LOT #: DESIGNER: KS DATE: FEB 13 17
---	--	--

Hand-drawn floor plan of the lower level of a building. The plan shows a large open area on the left, a central staircase labeled 'STAIRS', and a large rectangular area on the right labeled 'UNOCCUPIED'. A 'WALK-UP' label is written vertically on the left side of the plan. A 'LOWER LEVEL' label is written vertically on the right side of the plan. The plan also includes various symbols for doors, windows, and furniture.



JUNIPER 9

3,466 sq.ft. includes 10 sq.ft. of open area

