

CONSTRUCTION SUMMARY

Saddle Ridge (G) - Lecco Ridge Developments Inc.

TEL: RES.: 647-892-4614



PURCHASERS: Varun GOEL and Amandeep KAUR

LOT / PHASE 42 / 1	REG. PLAN # 20M-1184	HOUSE TYPE Juniper 7 Elev 1		
-----------------------	-------------------------	--------------------------------	--	--

CABINETRY

1 - KITCHEN - MONACO CABINETRY WITH UPGRADE STAIN 24Oct17 Note:	
--	--

CABINETRY ACCESSORIES

1 - KITCHEN CABINETRY BASE - POT/PAN DRAWERS (CABINET) - STANDARD 24Oct17 Note:	
1 - KITCHEN - CUT OUT FOR PLUG ON ISLAND 30Aug17 Note:	

Ceramic Tile

1 - TILE - UPGRADE 2 FLOOR TILE - - ENSUITE BATHROOM - FLOOR 24Oct17 Note:	
1 - DELETE ALL CERAMIC BATHROOM ACCESSORIES 24Oct17 Note:	
1 - TILE - UPGRADE 5 FLOOR TILE - - POWDER ROOM 24Oct17 Note:	
1 - TILE - UPGRADE 5 FLOOR TILE - - KITCHEN 24Oct17 Note:	
1 - TILE - UPGRADE 5 FLOOR TILE - - FOYER AND MAIN HALL 24Oct17 Note:	

CONSTRUCTION

1 - SMOOTH CEILINGS ON FIRST FLOOR ONLY 30Aug17 Note:	
1 - PLEASE NOTE THAT NO FURTHER STRUCTURAL CHANGES WILL BE PERMITTED. 12Dec16 Note:	
1 - FIRST FLOOR INCREASE CEILING HEIGHT FROM 9 FEET TO 10 FEET 12Dec16 Note: The ceiling height is measured from the top of the unfinished subfloor to underside of the unfinished ceiling above before finishes and excluding bulkheads and drop ceilings as per plan.	

ELECTRICAL

1 - PLUG - ELECTRICAL PLUG 30Aug17 Note: KITCHEN - INSTALLED ON ISLAND	
1 - BUILT IN OVEN AND COOKTOP PROVISION - PROVISION ONLY - ELECTRICAL ONLY 30Aug17 Note:	
1 - LIGHT AND SWITCH - NO FIXTURE INCLUDED 30Aug17 Note: MASTER ENSUITE BATHROOM - INSTALLED ABOVE TUB	
1 - PLUG - ELECTRICAL PLUG - TO BE INSTALLED OVER FIREPLACE 30Aug17 Note:	
1 - PLUG - ELECTRICAL PLUG WITH GFI AND SWITCH - FOR FESTIVE LIGHTING 30Aug17 Note:	
1 - 200 AMP ELECTRICAL SERVICE 12Dec16 Note:	

FIREPLACE AND ACCESSORIES

1 - GAS LINE ROUGH-IN FOR BARBECUE 30Aug17 Note:	
---	--

RECEIVED NCV 01 2017

CONSTRUCTION SUMMARY				
Saddle Ridge (G) - Lecco Ridge Developments Inc.				
PURCHASERS: Varun GOEL and Amandeep KAUR			TEL: RES.: 647-892-4614	
LOT / PHASE	REG. PLAN #	HOUSE TYPE		
42 / 1	20M-1184	Juniper 7 Elev 1		
1 - GAS LINE ROUGH-IN FOR STOVE (INCLUDES ELECTRICAL OUTLET)				
30Aug17 Note:				

HARDWOOD FLOORING	
1 - HARDWOOD - 5" ENGINEERED - ADMIRATION COLLECTION - STAINED - MAPLE OR RED OAK - IN LIEU OF VENDOR ST - - FIRST FLOOR COMPLETE	
24Oct17 Note:	

MIRRORS AND GLASS	
1 - FRAMELESS GLASS SHOWER ENCLOSURE	
30Aug17 Note: MASTER ENSUITE BATHROOM - CHROME KNOB AND HINGES	

MISCELLANEOUS	
1 - NO FURTHER CHANGES PERMITTED	
27Oct17 Note:	

PLUMBING	
6 - MOEN BATHROOM ACCESSORIES - MASON CHROME - TOWEL RING #YB8086 - PRICE IS EACH	
24Oct17 Note: ALL BATHROOMS - 1 IN POWDER ROOM AND ENSUITE 2 AND 2 IN MASTER AND SHARED ENSUITE	
4 - MOEN BATHROOM ACCESSORIES - MASON CHROME - TOWEL BAR 24" #YB8094/YB8000 - PRICE IS EACH	
24Oct17 Note: ALL BATHROOMS	
4 - MOEN BATHROOM ACCESSORIES - MASON CHROME - PAPER HOLDER #YB8099/YB8000 - PRICE IS EACH	
24Oct17 Note: ALL BATHROOMS	
1 - WATER LINE FOR FRIDGE - ROUGH-IN ONLY	
30Aug17 Note:	
2 - TOE TESTER - ADD TOE TESTER TO SHOWER	
30Aug17 Note: MASTER & ENSUITE 2 BATHROOMS	

PROMOTIONAL	
1 - LESS CREDIT FROM PURCHASER EXTRA SHEET IN OFFER	
12Dec16 Note:	

STAIRS AND RAILINGS	
1 - STAINED HANDRAIL - TREADS, RISERS AND STRINGER EXCLUDING PICKETS FIRST TO SECOND FLOOR - STANDARD STAIRCASE	
24Oct17 Note:	
1 - EUROLINE 1	
24Oct17 Note: STAIRCASE - IRON PICKETS - BLACK	

CONSTRUCTION SUMMARY				
Saddle Ridge (G) - Lecco Ridge Developments Inc.				
PURCHASERS: Varun GOEL and Amandeep KAUR			TEL: RES.: 647-892-4614	
LOT / PHASE	REG. PLAN #	HOUSE TYPE		
42 / 1	20M-1184	Juniper 7 Elev 1		

EXTRAS AS PER OFFER

The Vendor agrees that notwithstanding any other term or provision in this Agreement included in the Purchase Price and in addition to those items detailed in Schedule GP to the Agreement of Purchase and Sale, the Purchaser is entitled to a credit of Ten Worksheet Note:	
The Purchaser acknowledges that the Purchase Price is inclusive of all credits and promotional packages available at the time of purchase. Worksheet Note:	

This Document is Extremely Time Sensitive - Printed 1 Nov 17 at 10:40

Purchasers: Varun GOEL & Amandeep KAUR

Property: 42

Telephone Res. / Bus: (647) 892-4614 /

Project: Lecco Ridge Developments Inc.

Decor Advisor: Candace Forza

Model and Elevation: Juniper 7 Elev 1

Lock Date: 24-Oct-17

24-Oct-17

Plan #: 20M-1184

Layout Changes: ☒ Yes ☐ No

Sketch Attached: ☒ Yes ☐ No

Exterior Colour Scheme:

1. Cabinetry

	Style and Colour	Hardware
Kitchen / Breakfast	MONACO W814XZ4	1001
Laundry Room	ELISSE	Standard
Powder Room	Everest P790XZ9	2002
Master Ensuite Bathroom	Everest P790XZ9	2004
Ensuite Bath - Bedroom 2	Everest P790XZ9	2002
Ensuite Bath - Bedroom 3/4	MONACO W350XZ4	2002
	N/A	N/A
	N/A	N/A
	N/A	N/A

Appliances:

Built In Appliances ☐ Yes ☒ No

Slide In Stove ☐ Yes ☒ No

Dishwasher Cabinet ☐ Closed ☒ Open

41" Upper Cabinets ☒ Yes ☐ No

Please NOTE: Standard Cabinet Height is 30"

Stove Opening

NOTE: If not specified, opening will be set to builder's standard opening of approximately 30" width

Fridge Opening

NOTE: If not specified, opening will be set to builder's standard opening of approximately 37" width x 74" height

ELECTRICAL ONLY FOR BUILT-IN APPLIANCES

** Refer to Construction Summary

2. Counters

	Counter	Edge
Kitchen / Breakfast	LAMINATE-WHITE CARRARA-4924-38	
Laundry Room	N/A	
Powder Room	LAMINATE-ARGENTO ROMANO-6697-46	
Master Ensuite Bathroom	LAMINATE-WHITE CARRARA-4924-38	
Ensuite Bath - Bedroom 2	LAMINATE-CALCUTTA MARBLE-4925K-07	
Ensuite Bath - Bedroom 3/4	LAMINATE-WHITE JUPERANA-4931K-52	
	N/A	
	N/A	
	N/A	

** Refer to Construction Summary

Initials:

VG

CA

Purchasers:	Varun GOEL & Amandeep KAUR
Telephone Res. / Bus:	(647) 892-4614 /
Decor Advisor:	Candace Forza
Lock Date:	24-Oct-17 24-O

Property: 42

Project: Lecco Ridge Developments Inc.

Model and Elevation: Juniper 7 Elev 1

Plan #: 20M-1184

3. Ceramic Flooring

At a 45 Threshold-If App.

Entrance Vestibule	TILE-CALCATT (CA6082P) POL-24X24	<input type="checkbox"/>	METAL STRIP
Main Hall	STRIP	<input type="checkbox"/>	
Kitchen / Breakfast	TILE-CALCATT (CA6082P) POL-24X24	<input type="checkbox"/>	METAL STRIP
Laundry Room	TILE-RAINBOW WHITE-13X13	<input type="checkbox"/>	METAL STRIP
Powder Room	TILE-CALCATT (CA6082P) POL-24X24	<input type="checkbox"/>	
Master Ensuite Bathroom	TILE-MARMANI BIANCO-12X24	<input type="checkbox"/>	METAL STRIP
Ensuite Bath - Bedroom 2	TILE-BEACH LIGHT GREY-13X13	<input type="checkbox"/>	METAL STRIP
Ensuite Bath - Bedroom 3/4	TILE-RAINBOW WHITE-13X13	<input type="checkbox"/>	METAL STRIP
SIDE HALL @Foyer	TILE-CALCATT (CA6082P) POL-24X24	<input type="checkbox"/>	
Mudroom	Tile-Rainbow White-13x13	<input checked="" type="checkbox"/>	
	N/A	<input type="checkbox"/>	

** Refer to Construction Summary

4. Ceramic Wall Tile

4. Ceramic Wall Tile	Selection	Describe
Master Ensuite Bathroom		
Tub Deck Wall	N/A	
Tub Deck	N/A	
Tub Deck Skirt	N/A	
Shower Stall	TILE-STAR DUST GRIGIO-8X16	
Bathtub Enclosure Walls	N/A	
	N/A	
Ensuite Bath - Bedroom 2	TILE-BIANCO MATTE-8X16	
Ensuite Bath - Bedroom 3/4	TILE-BIANCO LUCIDO-8X16	
	N/A	
	N/A	
Kitchen Backsplash	N/A	

**** Refer to Construction Summary - STANDARD GROUT THROUGHOUT UNLESS SPECIFIED**

5. Plumbing Fixtures

All Bathrooms	White
	N/A
	N/A
	N/A
	N/A
	N/A

-Whirlpool

N/A ☐ Yes ☒ No

Dishwasher Rough-In ☒ Yes ☐ No

Waterline for Fridge ☒ Yes ☐ No

**** Refer to Construction Summary**

6. Trim Carpentry

Interior Doors	CLASSIQUE
Interior Trim	As Per Construction Specifications
Door Handles	SATIN CHROME LEVER
Exterior Front Door Handle	SATIN CHROME CHELSEA

**** Refer to Construction Summary**

Initials:

Purchasers:Varun GOEL & Amandeep KAUR

Property: 42

Telephone Res. / Bus: (647) 892-4614 /

Project: Lecco Ridge Developments Inc.

Decor Advisor: Candace Forza

Model and Elevation: Juniper 7 Elev 1

Lock Date: 24-Oct-17

24-Oct-17

Plan #: 20M-1184

7. Other Flooring		
Main Hall	STRIP-MIRAGE-ADMIRATION-ENGINEERED-RED OAK-SEMI-GLOSS-CHARCOAL-5"	
Living Room	STRIP-MIRAGE-ADMIRATION-ENGINEERED-RED OAK-SEMI-GLOSS-CHARCOAL-5"	
Dining Room	STRIP-MIRAGE-ADMIRATION-ENGINEERED-RED OAK-SEMI-GLOSS-CHARCOAL-5"	
Family Room	STRIP-MIRAGE-ADMIRATION-ENGINEERED-RED OAK-SEMI-GLOSS-CHARCOAL-5"	
Den / Library / Study	STRIP-MIRAGE-ADMIRATION-ENGINEERED-RED OAK-SEMI-GLOSS-CHARCOAL-5"	
Basement Landing(If Applies)	N/A	
Lower Landing (If Applies)	N/A	
Upper Landing	STRIP-MIRAGE-ADMIRATION-ENGINEERED-RED OAK-SEMI-GLOSS-CHARCOAL-5"	
Upper Hall	LAMINATE-TORLYS-PARK LANE-GREY VARNISHED OAK-TL-U1305	
Master Bedroom	LAMINATE-TORLYS-PARK LANE-GREY VARNISHED OAK-TL-U1305	
Bedroom #2	LAMINATE-TORLYS-PARK LANE-GREY VARNISHED OAK-TL-U1305	
Bedroom #3	LAMINATE-TORLYS-PARK LANE-GREY VARNISHED OAK-TL-U1305	
Bedroom #4	LAMINATE-TORLYS-PARK LANE-GREY VARNISHED OAK-TL-U1305	
Bedroom #5	N/A	
	N/A	
	N/A	
	N/A	
Underpad	Type	Area
	N/A	N/A

** Refer to Construction Summary

8. Railings and Pickets			
Railing Type	AS PER CONSTRUCTION SPECIFICATIONS	Colour	MIRAGE CHARCOAL
Picket Type	EURO LINE 1 BLACK	Colour	BLACK
Stringer / Riser	AS PER CONSTRUCTION SPECS	Colour	MIRAGE CHARCOAL
Treads	AS PER CONSTRUCTION SPECS	Colour	MIRAGE CHARCOAL
Red Oak Stairs with Semi Gloss Finish		<input checked="" type="radio"/> Yes <input type="radio"/> No	

** Refer to Construction Summary

9. Wall Paint Flat Finish			
Main & Upper Hall	43 BIRCH WHITE	Master Bedroom	22 WARM GREY
Living Room	43 BIRCH WHITE	Bedroom #2	22 WARM GREY
Dining Room	43 BIRCH WHITE	Bedroom #3	22 WARM GREY
Kitchen / Breakfast	43 BIRCH WHITE	Bedroom #4	22 WARM GREY
Family Room	43 BIRCH WHITE	Bedroom #5	N/A
Powder Room	22 WARM GREY	Master Ensuite	43 BIRCH WHITE
Laundry Room	22 WARM GREY	Ensuite Bath - Bedroom 2	43 BIRCH WHITE
Den/Library	43 BIRCH WHITE	Ensuite Bath - Bedroom 3/4	22 WARM GREY
Trim Paint-Semi Gloss	BIRCH WHITE	Mud Room	43 BIRCH WHITE
	N/A		N/A
	N/A		N/A
Smooth Ceilings First Floor	<input checked="" type="radio"/> Yes <input type="radio"/> No		

** Refer to Construction Summary

V.G.

A.K.

Initials:

Purchasers: Varun GOEL & Amandeep KAUR
Telephone Res. / Bus: (647) 892-4614 /
Decor Advisor: Candace Forza
Lock Date: 24-Oct-17

Property: 42

Project: Lecco Ridge Developments Inc.

Model and Elevation: Juniper 7 Elev 1

Plan #: 20M-1184

10. Plaster Mouldings and Medallions

Entrance Vestibule	N/A	N/A	Kitchen/Breakfast	N/A	N/A
Main Hall	N/A	N/A	Den/Library	N/A	N/A
Living Room	N/A	N/A	Lower Landing	N/A	N/A
Dining Room	N/A	N/A		N/A	N/A
Family Room	N/A	N/A			

** Refer to Construction Summary

11. Fireplace

	Living Room			Family Room			Other Room - Specify		
	Purchased	As Per Plan	N/A	Purchased	As Per Plan	N/A	Purchased	As Per Plan	N/A
	<input type="radio"/>	<input type="radio"/>	<input checked="" type="radio"/>	<input type="radio"/>	<input checked="" type="radio"/>	<input type="radio"/>	<input type="radio"/>	<input type="radio"/>	<input checked="" type="radio"/>
Fireplace Type	N/A			FLAT ON WALL			N/A		
Mantle Type	N/A			MANTLE M2-STANDARD			N/A		
Colour / Stain	N/A			AS PER CONSTRUCTION SPECIFICATIONS			N/A		
Surround	N/A			BIANCO			N/A		
Hearth	N/A			NO			N/A		

** Refer to Construction Summary

12. Heating and Air Conditioning

Air Conditioning

Gas Provisions Dryer

Comment

Gas Provisions Stove

Gas Provisions Barbecue

** Refer to Construction Summary

13. Electrical

Plugs and Switches	<input checked="" type="radio"/> White	<input type="text" value="DECOR"/>	Above Kitchen Cabinet Light	<input type="radio"/> Yes	<input checked="" type="radio"/> No
Hood Fan	<input type="text" value="STANDARD WHITE"/>		Below Kitchen Cabinet Light	<input type="radio"/> Yes	<input checked="" type="radio"/> No
Appliances	Built in Cooktop	Built in Oven	Gas Stove	Microwave	
	<input checked="" type="radio"/> Yes <input type="radio"/> No	<input checked="" type="radio"/> Yes <input type="radio"/> No	<input checked="" type="radio"/> Yes <input type="radio"/> No	<input checked="" type="radio"/> Yes	<input type="radio"/> No
Dishwasher Rough-in	<input type="text" value="Yes"/>				

ELECTRICAL ONLY FOR BUILT-IN APPLIANCES

** Refer to Construction Summary

14. General Comments

** Refer to Construction Summary

Disclaimers and Notes

- Colours of all materials are as close as possible to builder's selection, but not necessarily identical due to variances in manufacturing.
- Any extras listed above are null and void unless accompanied by a separate invoice/amendment. Said invoice must be paid in full.
- The Purchaser agrees that this colour selection is final and that no changes will be permitted, unless required by the Vendor.
- The Purchaser acknowledges reading and accepting document which contains other miscellaneous disclaimers.

Signature: 

Date: Oct 24, 2017

Signature: 

Date: Oct 24, 2017

Monaco Cabinetry
With Stain

*Puranaser Dealines
Full Depth Fridge

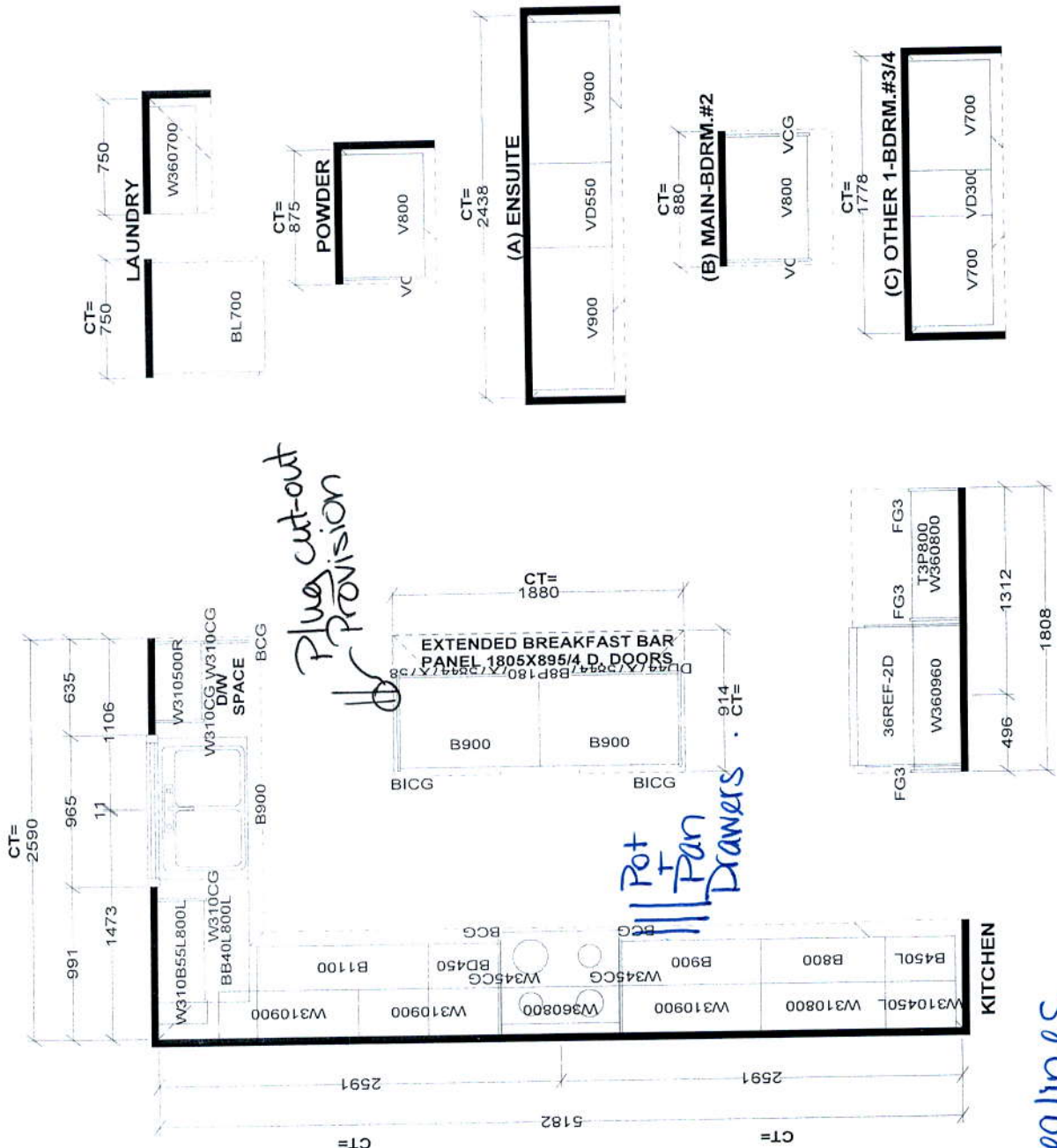

Selba Industries

<p>STANDARD FEATURES:</p> <p>9" CEILINGS WITH D/C BOX</p> <p>1040MM HIGH UPPER CABINETS</p> <p>DISHWASHER SPACE</p> <p>DUMMY DOORS ON EXPOSED BACKS</p> <p>LAMINATE KITCHEN & VANITY COUNTERTOPS</p>	<p><i>This drawing is the intellectual property of SELBA INDUSTRIES INC. and is an original design which must not be released without the written approval of Selba Inc. or paid for job order placed.</i></p>	<p></p> <p>JOB NUMBER:</p> <p>BUILDER: GREENPARK HOMES</p> <p>SITE NAME: LECCO RIDGE, MILTON</p> <p>MODEL: JUNIPER 7X ELEV 1,2</p> <p>NOT #:</p> <p>DESIGNER: KS</p> <p>DATE: FEB 13 17</p>
---	--	---



OK

