



Specifications for Project

132 SOUTHSEA CRES

ANTHONY PRESTA

Salesperson

Mike Albanese

mike.albanese@caplans.ca



REMINDER:

To ensure a smooth project it is the responsibility of the homeowner / purchaser of appliances for this project to share all the attached specifications to ensure the cabinet provider, contractor, or any other tradesperson have all the information required to complete their work accurately.

Specifications are subject to change. If any tradesperson has questions regarding the attached specifications please contact our sales associate.

132 SOUTHSEA CRES

ANTHONY PRESTA

BLOCK 7 LOT 1

WOODBIDGE, ON L4H 5K9

Cell: 416 409-7803

ANTHONYPRESTA93@GMAIL.COM



<i>Contents</i>	<i>Page no.</i>
WM6500HBA LG Washer 5.8 cu. ft. Mega Capacity Smart Front Load Energy Star Washer with TurboWash® 360° and AI DD® Built-In Intelligence	4-7
DLEX6500B LG Dryer 7.4 cu. ft. Capacity Energy Star Smart Front Load Dryer with AI Sensor Dry & TurboSteam®	8-12
JF36NXXFXDE JennAir Refrigeration 36" Panel-Ready Built-In French Door Refrigerator	13-23
W10663562 JennAir Accessory 36" Refrigerator Armoire Style Door Panel Kit, Obsidian	24-30
JOECC530RL	31-36

Caplan's Appliances

caplans.ca

Mike Albanese

Account Manager

4165780719

Sales Order **271436**

Version 1.1

Mon, Aug 11, 2025

10:27 AM EDT



enterprise.steelcod.com/sp/cpln/PY4R1JUN

Note about page numbers:

Because the original manufacturer's documents are not altered in any way, the page numbers displayed on the page may not correspond to the page number within this package.

All specifications are intended for initial planning purposes only.

Manufacturers reserve the right to change specifications at any time without notice. Always consult the installation instructions found on the manufacturer's website or included with the appliances before installation.

JennAir Wall Oven

RISE™ Microwave Combination Wall Oven
with MultiMode® Convection

JDAF3924RX	37-41
JennAir Dishwasher	
24" Panel-Ready Fully Integrated Dishwasher with Precise Fit 3rd Rack for Cutlery	

JIC4736HS	42-45
JennAir Cooktop	
Lustre Stainless 36" Induction Flex Cooktop	

EPR634S16	46-47
Elica Insert Hood	

Note about page numbers:
Because the original manufacturer's documents are not altered in any way, the page numbers displayed on the page may not correspond to the page number within this package.

All specifications are intended for initial planning purposes only.
Manufacturers reserve the right to change specifications at any time without notice. Always consult the installation instructions found on the manufacturer's website or included with the appliances before installation.

WM6500H

5.8 cu. ft. Mega Capacity Smart Front Load
Energy Star Washer with TurboWash®
360° and AI DD® Built-In Intelligence

- 5.8 cu. ft. Mega Capacity
- Digital Dial Control with LCD Display & Touch Button Control Panel
- TurboWash® 360° Technology
- AI DD®: AI Fabric and Weight Sensors with Smart Pairing
- LG ThinQ® Technology
- Allergiene® Cycle
- Cold Wash Technology
- NeveRust® Stainless Steel Drum
- ENERGY STAR® Certified & ENERGY STAR Most Efficient
- Direct Drive Motor 10-Year Limited Warranty

AVAILABLE COLOURS



BLACK STEEL



Proactive Smart Alerts to Keep
Your Appliances Running Smoothly

ThinQ Care

- Preventative Alerts help you stay a step ahead of potential issues to find proactive solutions before problems arise.
- Avoid preventable repairs and service calls with real-time diagnostics for a hassle-free experience.
- Integrated within LG's ThinQ app—a smart home hub for managing your smart devices and appliances.

SUMMARY

Type	Front Load Dryer
Capacity (cu. ft.)	5.8 cu. ft.
Matching Electric Dryer	DLEX6500B
Color	Black Steel (B)

APPEARANCE

LCD Display	Yes
Touch Buttons	Yes
Dial-A-Cycle®	Yes

ENERGY

ENERGY STAR® Most Efficient	Yes
ENERGY STAR® Certified	Yes
CEE Tier	Tier2
IMEF	2.92
IWF	3.0

WASH PROGRAMS

No. of Programs	25
Wash Programs	Normal, AI Wash, Bedding, Delicates, Towels, Quick Wash, Heavy Duty, Allergiene®, Perm. Press, Tub Clean, Bright Whites™, Sanitary, Rinse+Spin, Spin Only, Hand/Wool, Active Wear, Swimwear, Kids Wear, Jeans, Dresses, Color Care, Sweat Stains, Small Load, Large Load, X Large Load

WASH OPTIONS

No. of Options	15
Options	TurboWash®, Steam, Fresh Care, Pre-wash, Remote Start, Delay Wash, Wi-Fi, Add Item, Extra Rinse, Control Lock, Drum Light, ColdWash, Signal, Cycle List Edit, Cycle Optimization

WASH DETAILS

No. of Wash/Rinse Temps	5
Wash/Rinse Temps	Ex. Hot, Hot, Warm, Cold, Tap Cold
No. of Spin Speeds	5

Spin Speeds	Ex. High, High, Medium, Low, No Spin
Max RPM	1300
Water Levels	Load Sensing
No. of Soil Levels	5

FABRIC CARE FEATURES

AI DD®	Yes
TurboWash® 360° Technology	Yes
Steam Technology	Yes
Allergiene® Cycle	Yes
Sanitary Cycle	Yes
Cold Wash Option	Yes

CONVENIENCE FEATURES

Vibration Sensing (Cabinet Vibration Sensor)	Yes
TrueBalance® Anti-Vibration System	Yes

4 Tray Dispenser	Prewash, Main Wash (with liquid detergent cup), Bleach, Fabric Softener
End of Cycle Signal	Yes
LoadSense	Yes
Control Lock	Yes
Auto Suds Removal	Yes
Leveling Legs	4 Adjustable Legs
Drum Light	Yes

ThinQ® TECHNOLOGY

Smart Diagnosis	Yes
Wi-Fi	Yes
Energy Monitoring	Yes
Tub Clean Coach	Yes

MOTOR AND AGITATOR

Motor Type	Inverter Direct Drive Motor
Axis	Horizontal

MATERIALS AND FINISHES

NeveRust® Stainless Steel Drum	Yes
--------------------------------	-----

Cabinet	Painted Steel (One unit)
Control Panel	Painted Steel
Top Plate	Painted Steel
Door / Rim	Glass / Shiny Rose Gold
Door Cover	Tempered Glass Door
All Available Colors	Black Steel (B)

CERTIFICATION

Asthma Canada	Yes
---------------	-----

POWER SOURCE

Ratings	UL Listed
Electrical Requirements	120V, 10 Amps
Type	Electric

OPTIONS/ACCESSORIES

Pedestal	WDP6B
Pedestal (WxHxD)	27" x 13 5/8" x 25 3/8" (43 7/8" D with door open)
LG Sidekick™ Pedestal Washer	WD300CB
LG Sidekick™ Pedestal Washer (WxHxD)	27" x 14 1/8" x 30 3/4" (50 1/2" with drawer open)
Stacking Kit	KSTK4

DIMENSIONS

Product (WxHxD)	27" x 39" x 33 1/8"
Depth with Door Open	57 3/4"
Carton (WxHxD)	29 1/2" x 42 1/8" x 34 1/4"
Weight (Product/Carton)	202.6 / 216.5 lbs.

LIMITED WARRANTY

Parts & Labor	1 Year
Drum	3 Years
Direct Drive Motor	10 Years

UPC CODES

WM6500HBA (Black)	195174052921
-------------------	--------------

⚠ WARNING

- Certain internal parts are intentionally not grounded and may present a risk of electric shock only during servicing. Service personnel- Do not contact the following parts while the appliance is energized: pump, valve, motor, control board.

Tools Needed

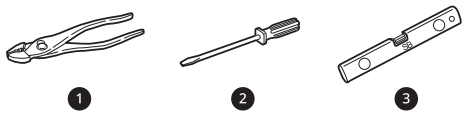

- ❶ Pliers
- ❷ Flat-Blade Screwdriver
- ❸ Level

Choosing the Proper Location

Check the following requirements for the install location before installing the washer.

- Allow for sufficient space between the walls and the washer for installation.
- Make sure that the floor is clean, dry and free of dust, dirt, water and oil so the leveling feet cannot slide easily. Leveling feet that can move or slide on the floor can contribute to excess vibration and noise.
- If the floor has too much flex, reinforce it to make it more rigid. If the floor is not solid, it may cause severe vibration and noise.
- If a drain pan must be used, take extra care to follow the instructions provided with the drain pan and make sure the leveling feet are adjusted for firm and even contact with the pan. Use of drain pans and failure to properly level the washer may result in increased vibration and noise during operation.

Power Outlet

- The power outlet must be within **60 inches (1.5 m)** of either side of the washer.
- Position the washer so that the outlet and plug are easily accessible.
- Do not overload the outlet with more than one appliance.
- The outlet must be grounded in accordance with current electrical wiring codes and regulations.
- Use a time-delay fuse or circuit breaker.

- It is the personal responsibility and obligation of the washer owner to have a proper outlet installed by a qualified electrician.

Flooring

- To minimize noise and vibration, install the washer on a level, solidly constructed floor capable of supporting the washer without flexing or bouncing.
- The washer must be installed on firm flooring to minimize vibration during the spin cycle. Concrete flooring is best, but a wood floor is sufficient, provided it is built to FHA standards.
- The floor under the washer must not slope more than 1 inch (2.5 cm) from front to back or side to side.
- Installing on carpeting and soft tile surfaces is not recommended.
- Never install the washer on a platform or weakly supported structure.

Floor Installation

To ensure sufficient clearance for water inlet hoses, drain hose and airflow, allow minimum clearances of at least **1 inch (2.5 cm)** at the sides and **4 inches (10 cm)** behind the washer. Be sure to allow for wall, door, or floor moldings that may increase the required clearances.

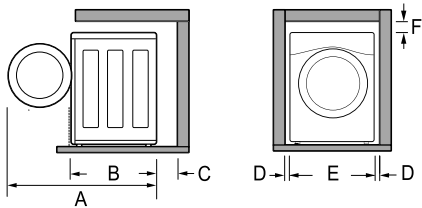

Dimensions and Clearances		
Model	WM5500H*A	WM6500H*A
A	55" (139.6 cm)	57 3/4" (146.6 cm)
B	30 1/4" (77 cm)	33 1/8" (84 cm)
C	4" (10 cm)	

Dimensions and Clearances		
Model	WM5500H*A	WM6500H*A
D	1" (2.5 cm)	
E	27" (70 cm)	
F	1/4" (0.5 cm)	

Stacking or Pedestal Installation

The washer can be stacked under a dryer or on top of a pedestal or pedestal washer.

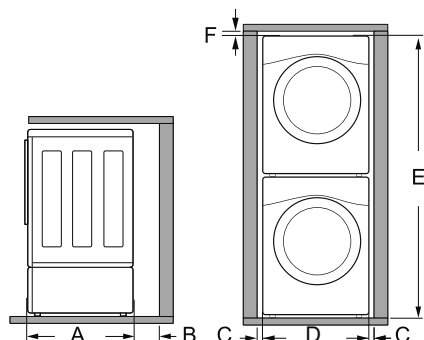

Dimensions and Clearances		
Model	WM5500H*A	WM6500H*A
A	30 1/4" (77 cm)	33 1/8" (84 cm)
B	4" (10 cm)	
C	1" (2.5 cm)	
D	27" (70 cm)	
E	77 1/2" (196.8 cm)	
F	1/4" (0.5 cm)	

NOTE

- Refer to the instructions packaged with the optional pedestal kit before stacking appliance on pedestal.
- Do not use a drain pan with a pedestal or pedestal washer installation as it can block the drawer. Using a drain pan may result in increased vibration and noise during operation.

Unpacking and Removing Shipping Material

Remove all shipping materials from the washer for proper operation and inspect it for shipping damage.

CAUTION

- Failure to remove shipping materials can cause excessive noise and vibration.

Unpacking Shipping Material

*Some models do not ship with drum support.

Lift the washer off the foam base.

- After removing the carton and shipping material, lift the washer off the foam base.
- Make sure the plastic drum support **1*** comes off with the base and is not stuck to the bottom of the washer.
- If you must lay the washer down to remove the carton base **2**, always protect the side of the washer and lay it carefully on its side. Do not lay the washer on its front or back.

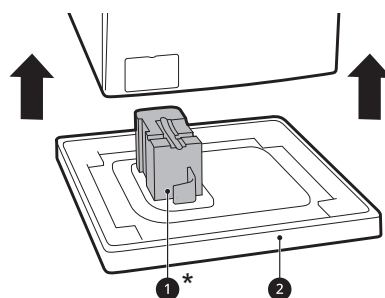

Removing Shipping Material

- Remove the bolt assemblies.
 - Starting with the bottom two shipping bolts **3**, use the included wrench to fully loosen all 4 shipping bolts by turning them counterclockwise.
 - Remove the bolt assemblies (bolts and retainers) by wiggling them slightly while pulling them out.

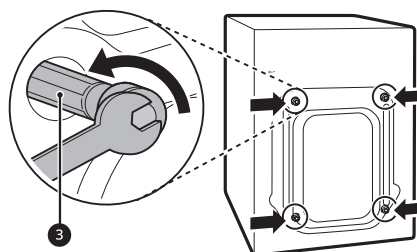

- Install the hole caps.
 - Locate the hole caps **4** included in the accessory pack or attached to the back of

14 INSTALLATION

hoses with the provided tie strap ③ (ribbed side on inside).

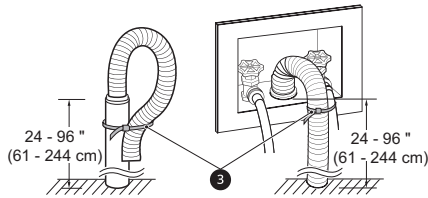

Using the Laundry Tub to Drain

- 1 Clip the end of the hose into the elbow bracket.
 - Connect the elbow bracket ① within **4 inches (10 cm)** of the end of the drain hose. If the drain hose is extended more than **4 inches (10 cm)** beyond the end of the elbow bracket, mold or microorganisms could spread to the inside of the washer.

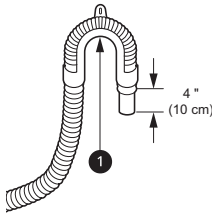

- 2 Hang the end of the drain hose over the side of the laundry tub.

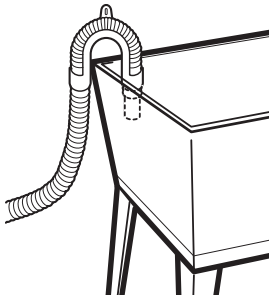

- 3 Use the provided tie strap to secure the drain hose in place.

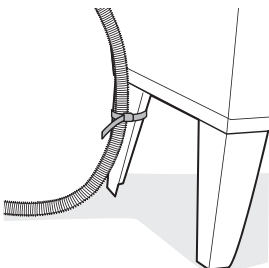

Leveling the Washer

The drum of the washer spins at very high speeds. To minimize vibration, noise, and unwanted movement, the floor must be a solid, level surface.

CAUTION

- Using the washer without leveling it may cause excess vibration and noise, leading to a washer malfunction.
- Adjust the leveling feet only as far as necessary to level the washer. Extending the leveling feet more than necessary can cause the washer to vibrate.

NOTE

- Before installing the washer, make sure that the floor is clean, dry and free of dust, dirt, water and oil so the washer feet cannot slide easily. Feet that move or slide on the floor can contribute to excessive vibration and noise.

How to Level the Washer

- 1 Position the washer in its final location.
 - Take special care not to pinch, strain, or crush the water and drain hoses. If you have a carpenter's level ①, you can use it to check that the washer is level. The slope beneath the washer should not exceed **1 inch**, and all 4 leveling feet must rest firmly on the floor.

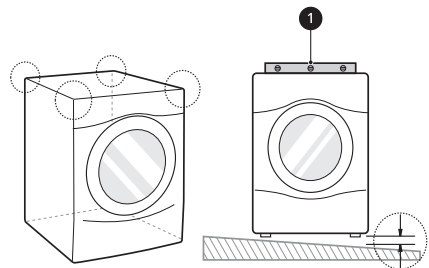

DLEX6500B

7.4 cu. ft. Capacity Energy Star Smart Front Load Dryer with AI Sensor Dry & TurboSteam®

- KEY FEATURES
- 7.4 cu. ft. Ultra Large Capacity
 - Digital Dial Control with LCD Display & Touch Button Control Panel
 - AI Sensor Dry with Smart Pairing
 - TurboSteam®, SteamFresh®, and SteamSanitary® Technology
 - Wrinkle Care Option
 - LG ThinQ® Technology with ThinQ Care
 - FlowSense® Duct Clogging Indicator
 - Tempered Glass Door (Reversible)
 - NeveRust® Stainless Steel Drum
 - ENERGY STAR® Certified

AVAILABLE COLOURS



BLACK STEEL



Proactive Smart Alerts to Keep Your Appliances Running Smoothly

ThinQ Care

- Preventative Alerts help you stay a step ahead of potential issues to find proactive solutions before problems arise.
- Avoid preventable repairs and service calls with real-time diagnostics for a hassle-free experience.
- Integrated within LG's ThinQ app—a smart home hub for managing your smart devices and appliances.

SUMMARY	
Type	Front Load Dryer
Vent Type	Vented
Dryer Type	DLEX6500B
Capacity	7.4 cu. ft.
Matching Washer	WM6500HBA / WM6500HWA
Sensor Dry	Yes
Steam	Yes
Color	Black Steel (B)
APPEARANCE	
LCD Display	Yes
Touch Buttons	Yes
Dial-A-Cycle®	Yes
DRYER PROGRAMS	
No. of Programs	23
Programs (Sensor Dry)	Normal, AI Dry, Bedding, Delicates, Towels, Quick Dry, Timed Dry, Power Dry, Perm. Press, SteamFresh™, Heavy Duty, Air Dry, Steam Sanitary™, Super Dry, Active Wear, Denim -> Jeans, Blanket Refresh, Low Temp Dry, Overnight Dry, Easy Ironing, Small Load, Large Load Dry, X Large Load Dry
No. of Options	11
Options	Cycle Optimization, Damp Dry Signal, Wrinkle Care, Control Lock, Wi-Fi, Energy Saver, TurboSteam®, Reduce Static, Remote Start, Drum Light, Signal
Temperature Settings	High, Med. High, Medium, Low, Ultra Low
Drying Levels	Very Dry, More Dry, Normal Dry, Less Dry, Damp Dry
Manual Dry Times	10 min ~ 100 min (10 min increments)

FABRIC CARE FEATURES	
AI Sensor Dry	Yes
Sensor Dry	Yes
Precise Temperature Control with Variable Heater	Yes
Steam	TurboSteam®
CONVENIENCE FEATURES	
3 Minute Installation Check	Yes
End of Cycle Signal	Yes
Drum Light (Door Open)	Yes
Reversible Door	Yes
FlowSense® Duct Clogging Indicator	Yes
Wrinkle Care Option	Yes
Control Lock	Yes
Venting Option	4 Way Venting
4 Adjustable Legs	Yes
Remaining Time Display / Status Indicator(s)	Yes
ThinQ® TECHNOLOGY	
Smart Diagnosis	Yes
Wi-Fi	Yes
Remote Start and Cycle Monitor	Yes
Energy Monitoring	Yes
ENERGY	
ENERGY STAR® Certified	Yes
CEF	3.94
MATERIALS AND FINISHES	
NeveRust® Stainless Steel Drum	Yes
Cabinet	Painted Steel
Door	Tempered Glass Door
All Available Colors	Black Steel (B)

POWER SOURCE	
Ratings	CSA Listed
Electrical Requirements	120/240V, 60Hz, 26A
Type	Electric
OPTIONS	
Side Venting Kit	3911EZ9131X
Pedestal	WDP6B
Pedestal (WxHxD)	27" x 13 5/8" x 28" (43 7/8" D with door open)
DIMENSIONS	
Product (W x H x D)	27" x 39" x 29 3/4"
Depth with Door Open	51 3/8"
Carton (W x H x D)	28 31/32" x 46 29/64" x 31 27/64"
Product Weight (lbs.)	Electric: 124.3 lbs.
Carton Weight (lbs.)	Electric: 136.5 lbs.
LIMITED WARRANTY	
Parts & Labor	1 Year
Drum	3 Years
UPC CODES	
DLEX6500B (Black)	195174052945

Dimensions and Clearances

The following clearances are recommended for the appliance.

- Additional clearances should be considered for ease of installation and servicing.
- Additional clearances should be considered on all sides of the dryer to reduce noise transfer.

Installation Spacing for Recessed Area or Closet Installation

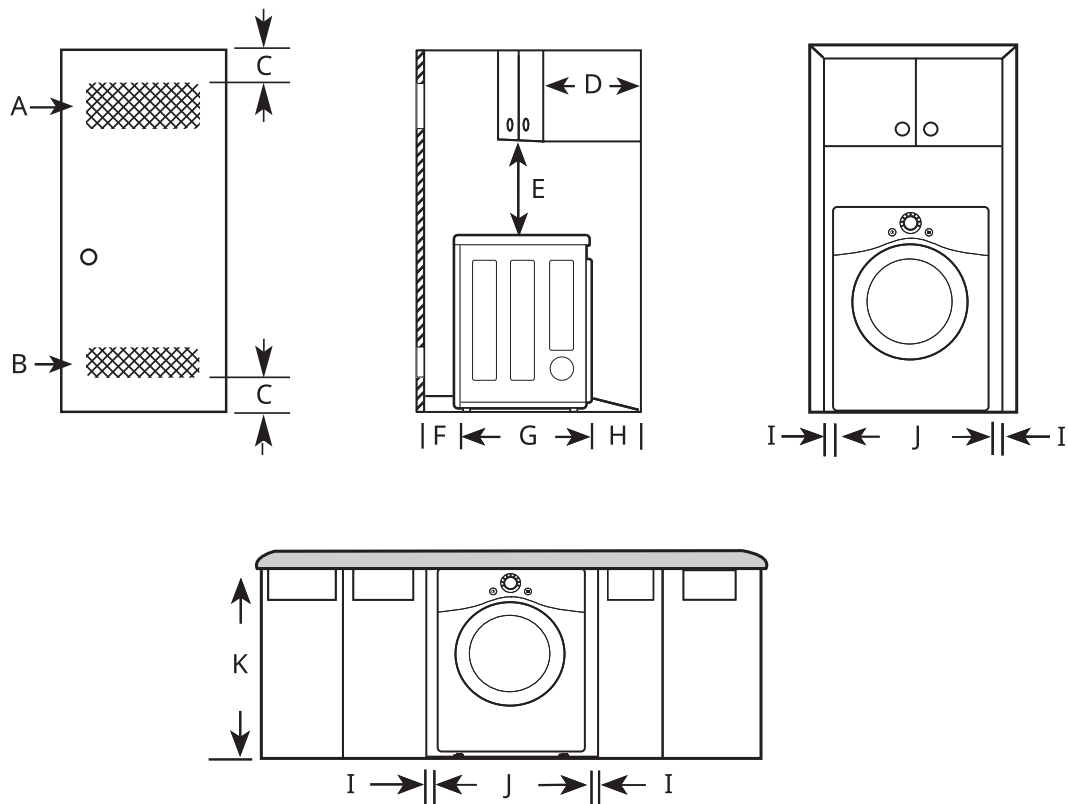

-	Description	Dimension/Clearance
A	Upper Ventilation Opening	≥ 48 sq. in. (310 cm ²)
B	Lower Ventilation Opening	≥ 24 sq. in. (155 cm ²)
C	Distance to Ventilation Opening	≥ 3" (76 mm)
D	Overhead Cabinet Depth	≤ 14" (356 mm)
E	Distance to the Overhead Cabinet/Shelf	≥ 18" (457 mm)
F	Front Clearance	1" (25 mm)
G	Depth	29 3/4" (756 mm)
H	Back Clearance	≥ 5" (127 mm)
I	Side Clearance	≥ 1" (25 mm)
J	Width	27" (686 mm)
K	Height of Cabinet Opening	39" (989 mm)

Closet Ventilation Requirements

Closets with doors must have both an upper and lower vent to prevent heat and moisture buildup in the closet. One upper vent opening with a minimum opening of 48 sq. in. (310 cm²) must be installed no lower than 6 feet above the floor. One lower vent opening with a minimum opening of 24 sq. in. (155 cm²) must be installed no more than one foot above the floor. Install vent grilles in the door or cut down the door at the top and bottom to form openings. Louvered doors with equivalent ventilation openings are also acceptable.

NOTE

- There should be at least a little space around the dryer (or any other appliance) to eliminate the transfer of vibration from one appliance to another. If there is enough vibration, it could cause appliances to make noise or come into contact, causing paint damage and further increasing noise.
- No other fuel-burning appliance can be installed in the same closet as a dryer.

Installation Spacing for Recessed Area or Closet, with Stacked Washer and Dryer

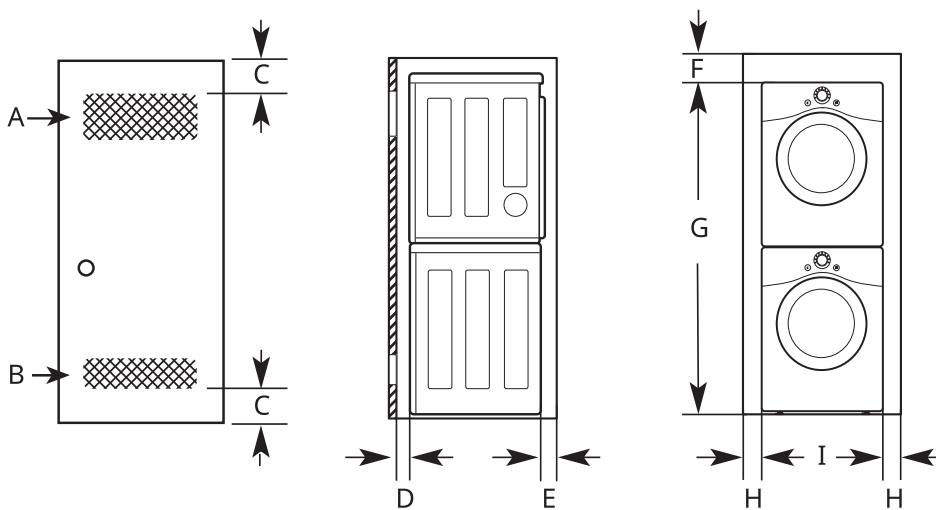

-	Description	Dimension/Clearance
A	Upper Ventilation Opening	≥ 48 sq. in. (310 cm ²)
B	Lower Ventilation Opening	≥ 24 sq. in. (155 cm ²)
C	Distance to Ventilation Opening	≥ 3" (76 mm)
D	Front Clearance	≥ 1" (25 mm)
E	Back Clearance	≥ 5 1/2" (140 mm)
F	Top Clearance to the Ceiling	≥ 6" (152 mm)
G	Height to the Top of Stacked Appliances [†]	78" (1980 mm)
H	Side Clearance	≥ 1" (25 mm)
I	Width [†]	27" (686 mm)

[†] Differs depending on the washer dimensions.

Installation Spacing for Cabinet

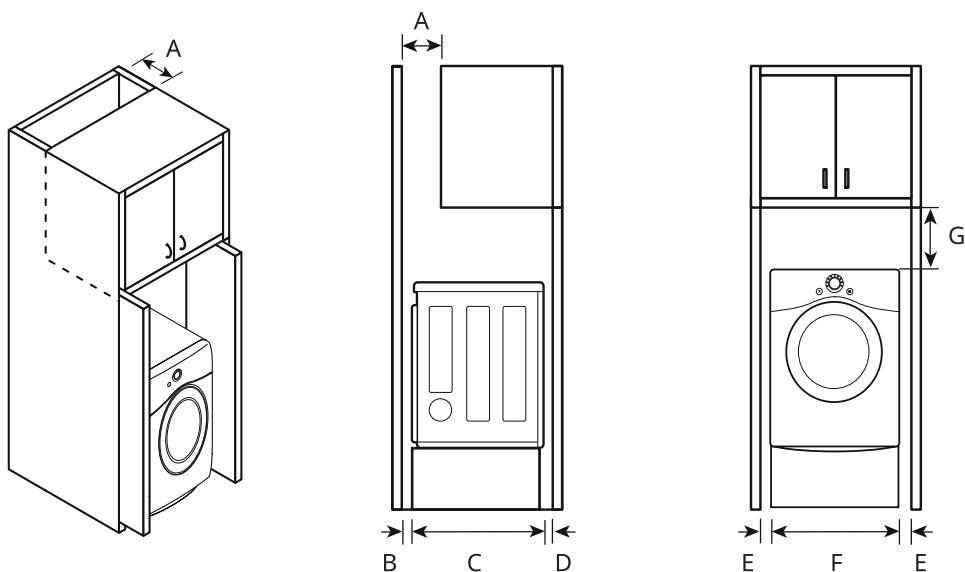

For cabinet installation with a door, minimum ventilation openings in the top of the cabinet are required.

-	Description	Dimension/Clearance
A	Depth of Ventilation Opening	≥ 7" (178 mm)
B	Back Clearance	≥ 5" (127 mm)
C	Depth	29 3/4" (756 mm)
D	Front Clearance	≥ 1" (25mm)
E	Side Clearance	≥ 1" (25 mm)
F	Width	27" (686 mm)
G	Clearance to Top of Cabinet	≥ 9" (229 mm)

Ductwork

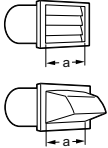
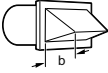
Wall Cap Type	No. of 90° Elbows	Maximum length of 4-inch diameter rigid metal duct
 a: 4" (10.2 cm)	0	65 ft. (19.8 m)
	1	55 ft. (16.8 m)
	2	47 ft. (14.3 m)
	3	36 ft. (11.0 m)
	4	28 ft. (8.5 m)
Use for only short run installations  b: 2.5" (6.35 cm)	0	55 ft. (16.8 m)
	1	47 ft. (14.3 m)
	2	41 ft. (12.5 m)
	3	30 ft. (9.1 m)
	4	22 ft. (6.7 m)

NOTE

- Deduct 6 ft. (1.8 m) for each additional elbow. Do not use more than four 90° elbows.
- In Canada, only those foil-type flexible ducts, if any, specifically identified for use with the appliance by the manufacturer should be used. In the United States, only those foil-type flexible ducts, if any, specifically identified for use with the appliance by the manufacturer and that comply with the Outline for Clothes Dryer Transition Duct, Subject 2158A, should be used.

Routing and Connecting Ductwork

Follow the guidelines below to maximize drying performance and reduce lint buildup and condensation in the ductwork. Ductwork and fittings are NOT included and must be purchased separately.

- Use 4-inch (10.2 cm) diameter rigid, semi-rigid or flexible metal ductwork.
- The exhaust duct run should be as short as possible.
- Use as few elbow joints as possible.
- The male end of each section of exhaust duct must point away from the dryer.
- Use duct tape on all duct joints.
- Insulate ductwork that runs through unheated areas in order to reduce condensation and lint buildup on duct surfaces.

- Incorrect or inadequate exhaust systems are not covered by the dryer warranty. Dryer failures or service required because of such exhaust systems will not be covered by the dryer warranty.

Correct Venting

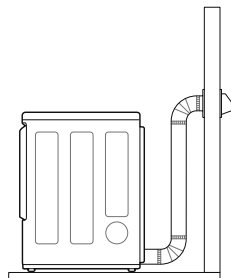

Incorrect Venting

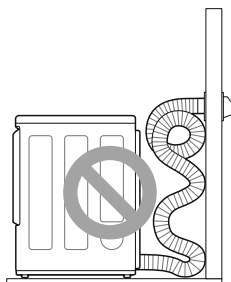

Connecting Gas Dryers

⚠ WARNING

- To reduce the risk of fire or explosion, electric shock, property damage, injury to persons, or death when using this appliance, follow requirements including the following.

Electrical Requirements for Gas Models

⚠ WARNING

- This dryer is equipped with a three-prong grounding plug for protection against shock hazard which should be plugged directly into a properly grounded three-prong receptacle. Do not cut or remove the grounding prong from this plug.
- Do not, under any circumstances, cut or remove the third (ground) prong from the power cord.
- For personal safety, this dryer must be properly grounded.

JF36NXFXDE

36" Panel-Ready Built-In French Door Refrigerator



<http://www.jennair.com>



Key Features:

- Daring Obsidian Interior
- Multi-Point Cinematic Lighting
- Fully Flush, Fully Integrated Design
- Precision Temperature Management™ System
- Glass Shelving
- Light-Guided Capacitive Touch Controls
- Soft-Close Crisper Drawers
- Elegance Shelving
- Produce Preserver
- FreshFlow™ Air Filter
- Variable Capacity Compressor
- Automatic Ice Maker with Storage Drawer

Product Dimensions:

Height: 84

Width: 35 3/4

Depth: 24

Electrical Requirements:

20. 115 V.

Additional Information:

[Owners Manual](#)

[Dimension Guide](#)

[Installation Guide](#)

[Energy Guide](#)

[Warranty Certificate](#)

Available in:



Panel Ready

®Registered trademark/TM Trademark of Whirlpool, U.S.A. © 2023 Whirlpool Corporation. All Rights Reserved.
All other trademarks are owned by their respective companies.

Because Whirlpool Corporation policy includes a continuous commitment to improve our products, we reserve the right to change materials and specifications without notice. We also reserve the right to discontinue or transition products without notice.

Manufacturer's Suggested Retail Price (MSRP) and Minimum Advertised Price (MAP) provided for reference purposes only. Dealer alone determines advertised and retail prices.

Created On: Wednesday, April 05, 2023 10:20:07

FRENCH DOOR BOTTOM MOUNT MODELS

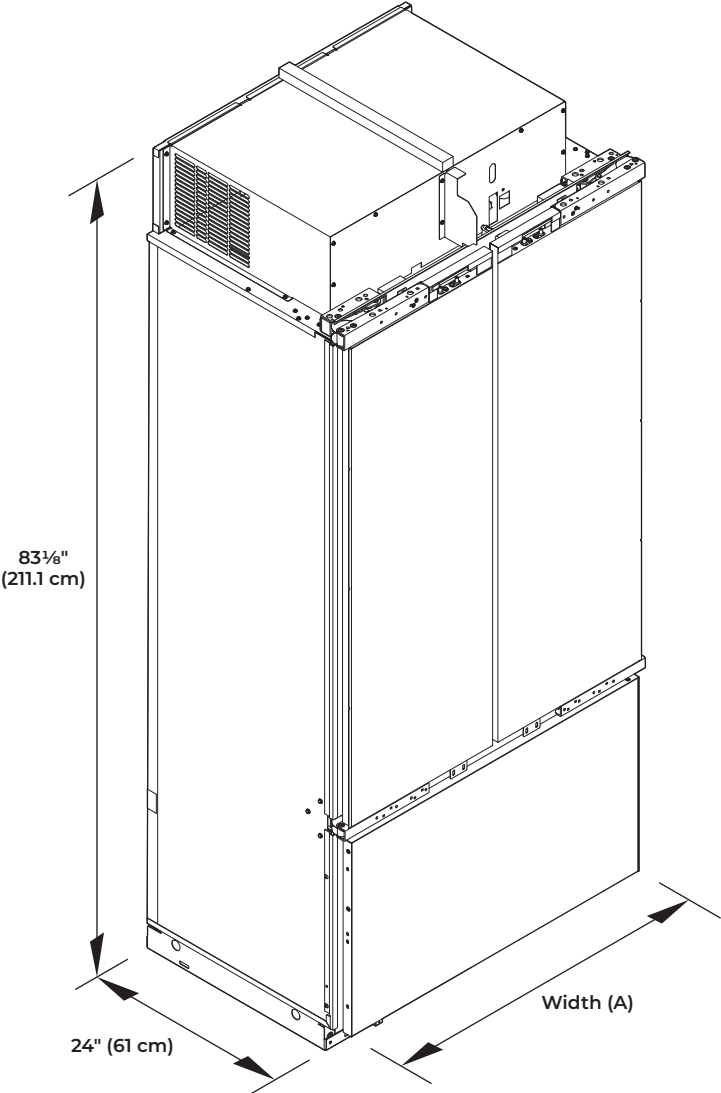

MODEL	WIDTH A (HINGE EDGE TO HINGE EDGE)
36	35 3/4" (90.8 cm)

DOOR SWING DIMENSIONS

The location must permit both doors to open to a minimum of 90°. Allow 4 1/2" (11.4 cm) minimum space between the side of the refrigerator and a corner wall.

NOTE : More clearance may be required if you are using wood overlay panels, custom handles, or extended handles.

36" (91.4 CM) FRENCH DOOR MODELS

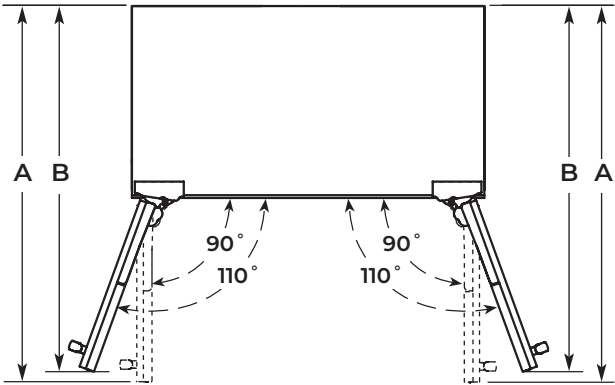

MODEL	A	B
36	41" (104 cm)	39 3/4" (101 cm)

SITE PREPARATION

OPEN TO CEILING OR SOFFIT CABINET

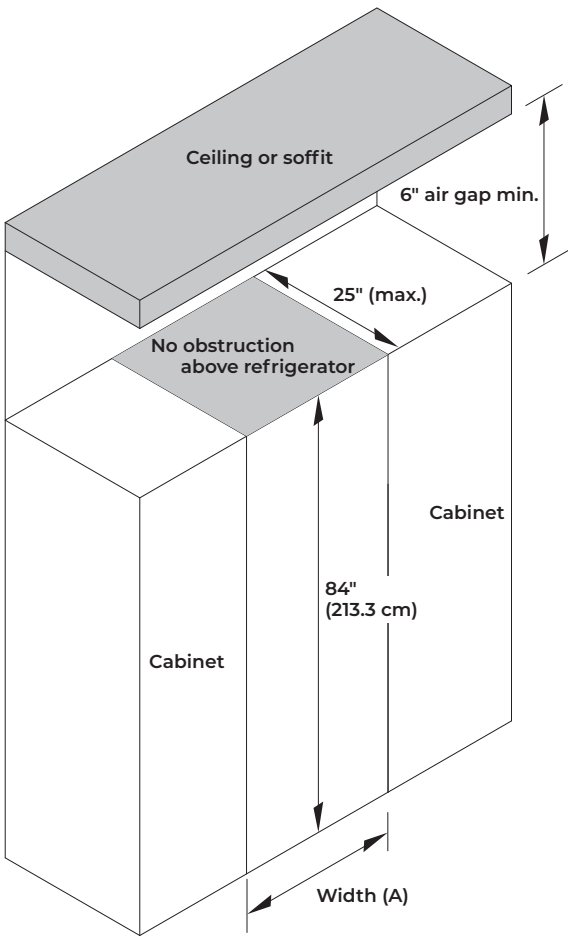

MODEL	WIDTH A
36	36" (91.4 cm)

- These type of installations require a minimum of 6" (15.24 cm) of open space above the refrigerator. This space must not be blocked in any way, including soffits.
- Depth of cabinet must be less than 25" (63.5 cm).
- If your opening does not meet these requirements, you will need to make modifications.

CLOSED SOFFIT CABINET

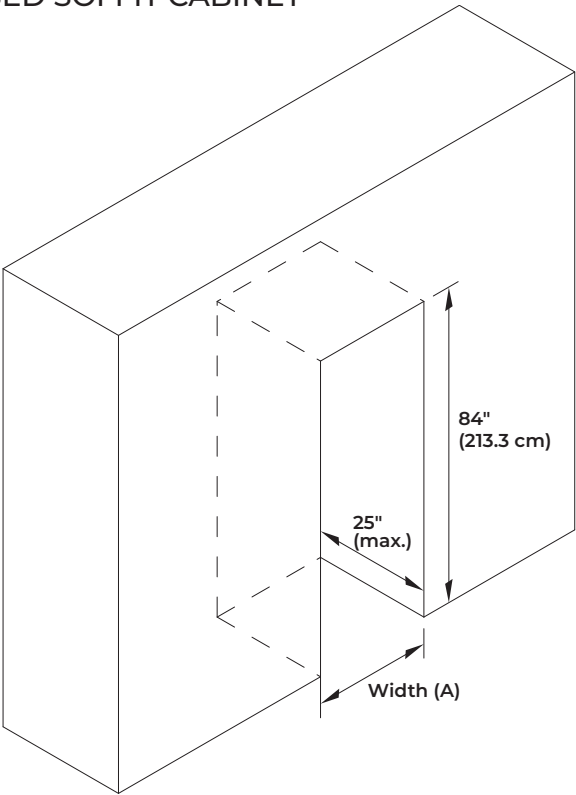

MODEL	WIDTH A
36	36" (91.4 cm)

- Depth of cabinet must be less than 25" (63.5 cm).
- Height of soffit must not exceed 84" (213.3 cm).
- Following illustrations explain the cabinet construction (soffit and rear wall positions) required for optimum ventilation and airflow.

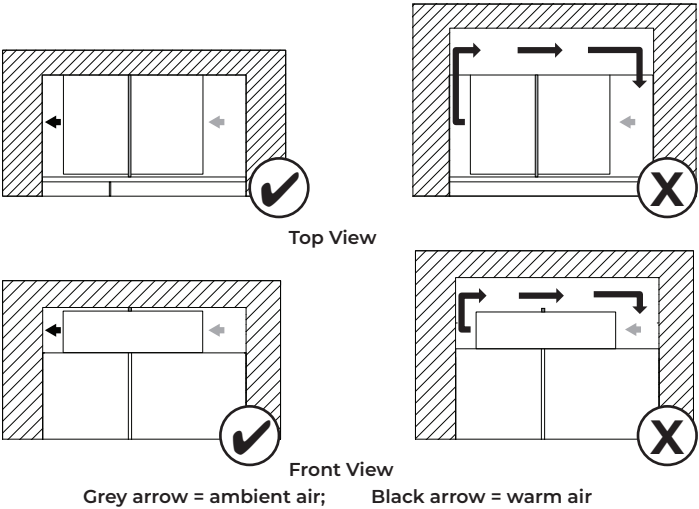

Cabinet depth 25" and soffit located at 84", provides proper airflow/ventilation to the refrigerator. Efficient cooling is achieved.

Cabinet depth more than 25" and/or soffit located at more than 84", causes air gap at back and/or top of the refrigerator. Air gap allows warm air recirculation causing loss in cooling efficiency.

- If your opening does not meet these requirements, you will need to make modifications.

ANTI-TIP BOARDS

For open to ceiling or soffit cabinet constructions the refrigerator must be braced with the help of primary and secondary anti-tip boards.

PRIMARY ANTI-TIP BOARDS

IMPORTANT:

- It is recommended that primary anti-tip boards be installed before the refrigerator is installed.
- Boards must be long enough to fully cover the width of the compressor cover.
- Place the boards so that the bottom surfaces of the boards are 84" (213 cm) from the floor.
- During installation, raise the refrigerator up until the top of the refrigerator is making contact with the bottom of the anti-tip boards. Do not crush the compressor cover when raising the rear leveling legs.

NOTE: The foam gasket, on top of the compressor cover, will compress to fit under the anti-tip board(s). There is no need to trim the gasket.

To install primary anti-tip boards-

1. Mark the stud locations on rear wall.
2. Securely attach two 2" x 4" x 32" (5 cm x 10 cm x 81 cm) boards to wall studs behind refrigerator. Use six #8 x 3" (7.6 cm) (or longer) wood screws. The wood screws must be screwed into the studs at least 1½" (3.8 cm). The boards must overlap the compressor cover.

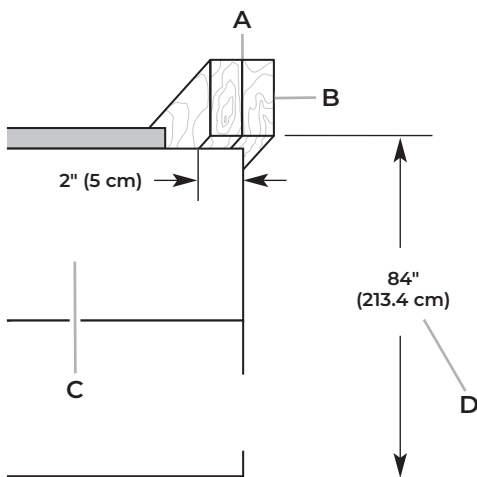

A. Two 2" x 4" x 32" (5 cm x 10 cm x 81 cm) boards
B. Attach to studs with six #8 x 3" (7.6 cm) screws.
C. Compressor cover
D. Distance from bottom of anti-tip boards to floor

SECONDARY ANTI-TIP BOARDS

⚠ WARNING



Tip Over Hazard

Refrigerator is top heavy and tips easily when not completely installed.

Install secondary anti-tip board to ensure product stability.

Use two or more people to move and install refrigerator.

Failure to do so can result in death or serious injury.

- For all full height door or armoire panel installations, the secondary anti-tip board is required to be installed prior to door panel installation.
- This anti-tip board is to be secured on the right side of the cabinet enclosure as per the dimensions shown in illustration.
- Secure the secondary anti-tip board so that the bottom surface of the secondary anti-tip board is 75½" (191.77 cm) from the floor (right hand side).

To install secondary anti-tip board-

1. Mark the stud locations on right hand side cabinet wall.
2. Securely attach one 2" x 4" x 12" (5 cm x 10 cm x 30.4 cm) board to the cabinet on right hand side cabinet using wood screws. Use three #8 x 2" (5.08 cm) (or longer) wood screws.

NOTE:

- It is recommended to drive the wood screws from cabinet wall into the secondary anti-tip board as shown in the illustration.
- The board must have overlap of 1" (2.54) with the refrigerator top.
- Leave 4" (10.16 cm) free space at rear as shown in the illustration.

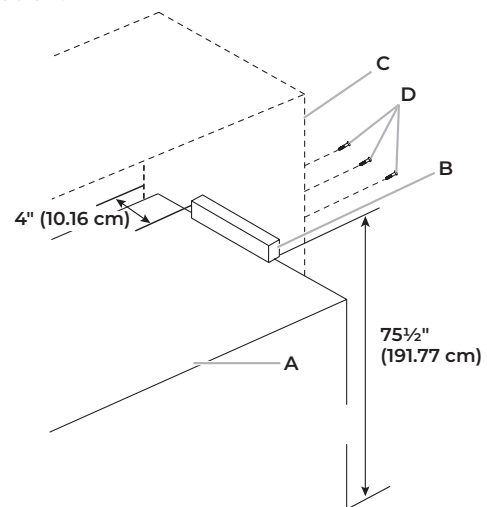

A. Refrigerator
B. Secondary anti-tip board
C. Kitchen cabinet
D. Wood screws

LOCATION REQUIREMENTS

⚠ WARNING



Explosion Hazard

Keep flammable materials and vapors, such as gasoline, away from refrigerator.

Failure to do so can result in death, explosion, or fire.

IMPORTANT: This refrigerator is designed for indoor, household use only.

This appliance is intended to be used in household and similar applications such as:

- Staff kitchen areas in shops, offices and other working environments.
- Farm houses and by clients in hotels, motels and other residential type environments.
- Bed and breakfast type environments.
- Catering and similar non-retail applications.

NOTE: The refrigerator is intended for use in a location where the temperature ranges from a minimum of 55°F (13°C) to a maximum of 43°C (110°F). The preferred room temperature range for optimum performance, which reduces electricity usage and provides superior cooling, is between 15°C (60°F) and 32°C (90°F). It is recommended that you do not install the refrigerator near a heat source, such as an oven or radiator.

IMPORTANT:

- Observe all governing codes and ordinances.
- It is recommended that you do not install the refrigerator near an oven, radiator, or other heat source.
- Do not install in a location where the temperature will fall below 13°C (55°F).
- Floor must support the refrigerator weight, more than 600 lbs (272 kg), door panels and contents of the refrigerator. Flooring under refrigerator must be at same level as the room. Face of cabinetry must be plumb.
- Location should permit door to open fully. See "Door Swing Dimensions."
- Location must permit top grille removal. See "Site Preparation."

WATER SUPPLY REQUIREMENTS

IMPORTANT :

- All installations must meet local plumbing code requirements.
- Connect to potable water supply only.

Do not use with water that is microbiologically unsafe or of unknown quality without adequate disinfection before or after the system. Systems certified for cyst reduction may be used on disinfected waters that may contain filterable cysts.

- There is not enough clearance to achieve a flush installation if a water shutoff valve is located in the wall behind the refrigerator.
- The water shutoff should be located in the base cabinet on either side of the refrigerator or some other easily accessible area. The water supply line, however, must come up through the floor in the gray shaded area shown.

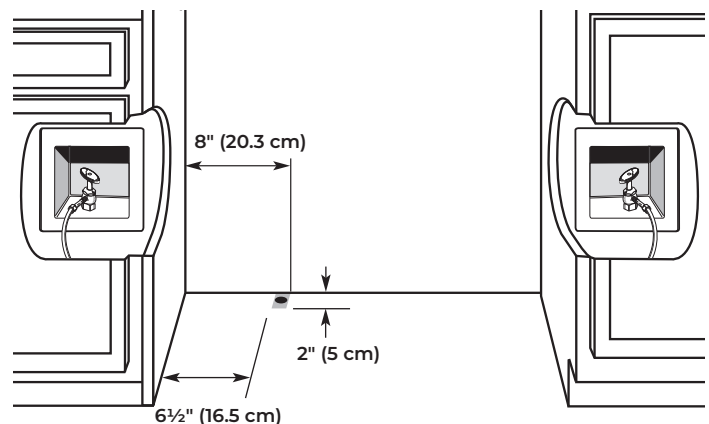

- A 1/2" (12.7 mm) hole for plumbing should be drilled on the floor at least 6½" (16.5 cm) from the left-hand side cabinet and should be no more than 2" (5 cm) away from the back wall. Refer above illustration for more details.
- The water supply connection is made at the front of the refrigerator.
- If additional tubing is needed, use copper tubing and check for leaks. Install the copper tubing only in areas where the household temperatures will remain above freezing.
- Do not use a piercing-type or 3/16" (4.76 mm) saddle valve which reduces water flow and also clogs more easily.

NOTE : Your refrigerator dealer has a kit available with a 1/4" (6.35 mm) saddle-type shutoff valve, a union, and copper tubing. Before purchasing, make sure a saddle-type valve complies with your local plumbing codes.

WATER PRESSURE

A cold water supply with water pressure between 30 psi and 120 psi (207 kPa and 827 kPa) is required to operate the water dispenser and ice maker. If you have questions about your water pressure, call a licensed, qualified plumber.

REVERSE OSMOSIS WATER SUPPLY

IMPORTANT : The pressure of the water supply coming out of a reverse osmosis system going to the water inlet valve of the refrigerator needs to be between 30 psi and 120 psi (207 kPa and 827 kPa).

If a reverse osmosis water filtration system is connected to your cold water supply, the water pressure to the reverse osmosis system needs to be a minimum of 40 psi to 60 psi (276 kPa to 414 kPa).

If the water pressure to the reverse osmosis system is less than 40 psi to 60 psi (276 kPa to 414 kPa):

- Check to see whether the sediment filter in the reverse osmosis system is blocked. Replace the filter if necessary.
- Allow the storage tank on the reverse osmosis system to refill after heavy usage.
- If your refrigerator has a water filter, it may further reduce the water pressure when used in conjunction with a reverse osmosis system. Remove the water filter cartridge.

If you have questions about your water pressure, call a licensed, qualified plumber.

ELECTRICAL REQUIREMENTS

⚠ WARNING



Electrical Shock Hazard

Plug into a grounded 3 prong outlet.

Do not remove ground prong.

Do not use an adapter.

Do not use an extension cord.

Failure to follow these instructions can result in death, fire, or electrical shock.

Before you move your refrigerator into its final location, it is important to make sure you have the proper electrical connection.

A grounded 3 prong electrical outlet should be located within a specified number of inches from the right-hand side cabinets or end panel. See the chart following the illustration for the number of inches required for your model.

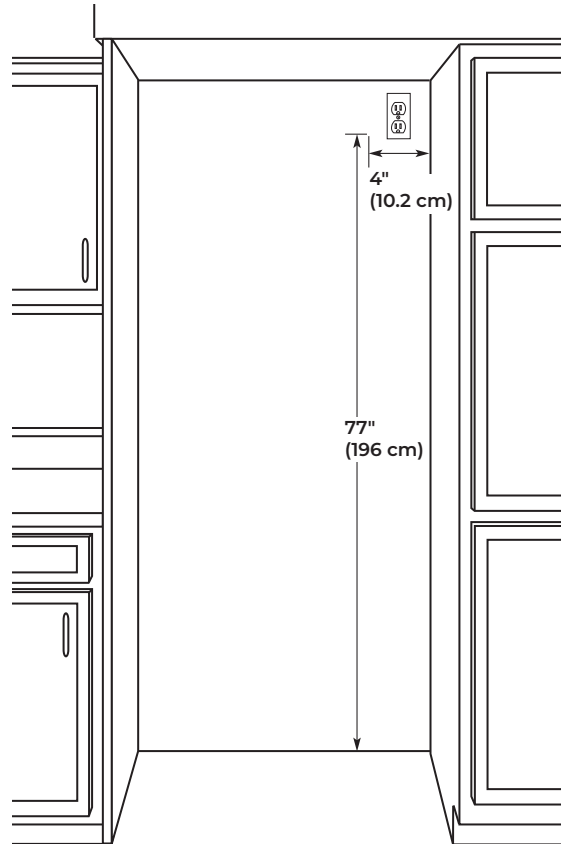

If the supply cord is damaged, it must be replaced by the manufacturer or its service agent or a similar qualified person. Do not use a cord that shows cracks or abrasion damage along its length or at either the plug or connection end.

RECOMMENDED GROUNDING METHOD

A 115 V, 60 Hz, AC only, 15 A or 20 A fused, grounded electrical supply is required. It is recommended that a separate circuit serving only your refrigerator be provided. Use an outlet that cannot be turned off by a switch. Do not use an extension cord.

IMPORTANT : If this product is connected to a GFCI (Ground Fault Circuit Interrupter) protected outlet, nuisance tripping of the power supply may occur, resulting in loss of cooling. Food quality and flavor may be affected. If nuisance tripping has occurred, and if the condition of the food appears poor, dispose of it.

NOTE : Before performing any type of installation or cleaning, remove the top grille and turn the master power switch to OFF or disconnect power at the circuit breaker box.

When you are finished, turn ON the master power switch or reconnect power at the circuit breaker box. Then reset the control to the desired setting.

SITE PREPARATION

CABINET CUTOUT OPTIONS

AIRFLOW VENTING RECOMMENDATIONS

IMPORTANT:

- Armoire-style installations recommends a minimum of 1/8" (3.2 mm) of open space above the refrigerator. It is recommended that this space not be blocked in any way, including soffits.
- Models may be installed using either Option 1, Option 2 or option 3.

Option 1 - Open to Ceiling

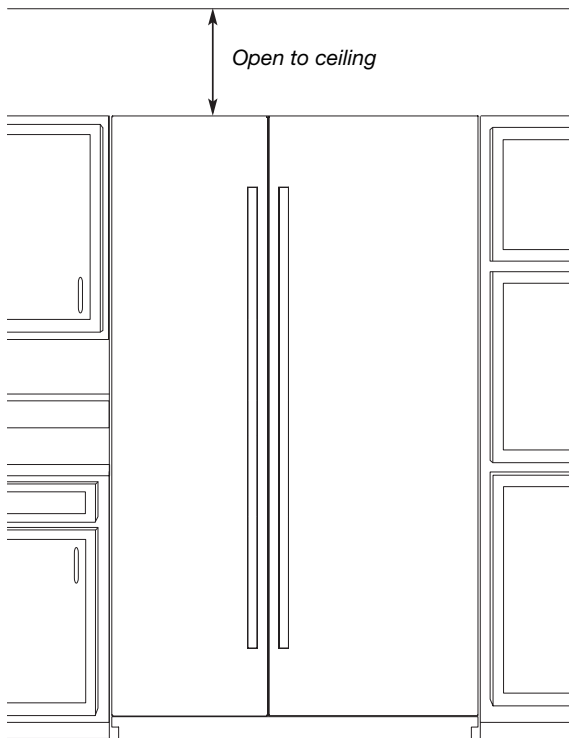

Option 2 - False Front (cabinet face only)

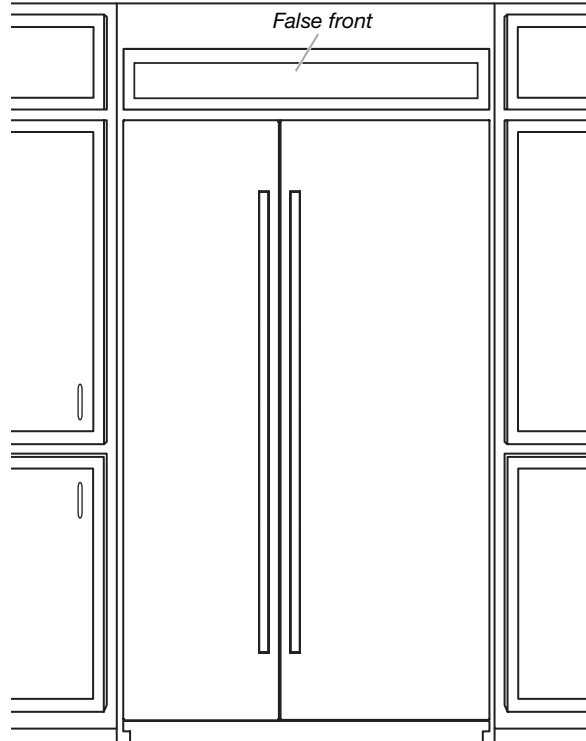

Option 3 - Closed Soffit

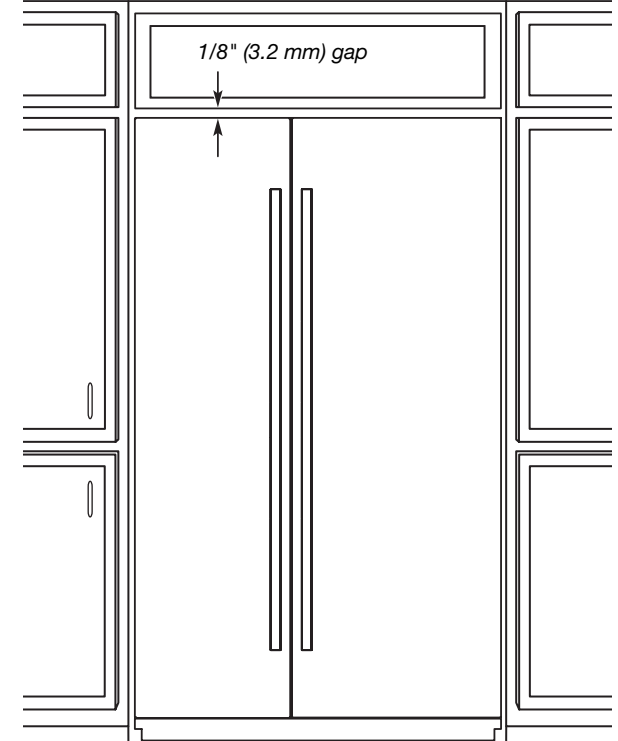

SITE PREPARATION

PANEL DIMENSIONS

FRENCH DOOR BOTTOM MOUNT MODELS

!

Maximum allowable weights:

- Door panel - 38 lbs (17.2 kg)
- Drawer panel (36" model) - 25 lbs (11.3 kg)
- Drawer panel (42" model) - 30 lbs (13.6 kg)

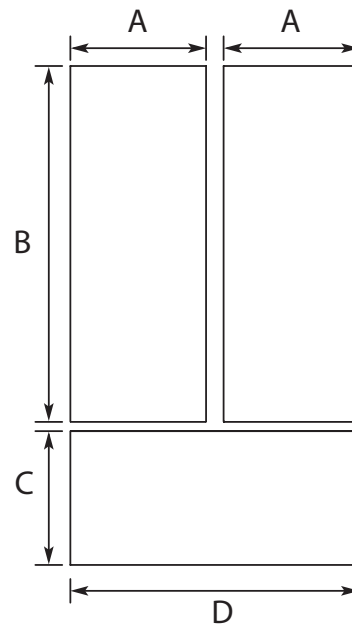

Legend	Model	Dimension
A	36"	17 ³ / ₄ " (45.24 cm)
B		59 ¹ / ₈ " (150.2 cm)
C		20 ¹ / ₂ " (52.07 cm)
D		35 ³ / ₄ " (90.81 cm)

SITE PREPARATION

INSTALLATION REQUIREMENTS

PLAN THE INSTALLATION

IMPORTANT:

- Install the handles on the panels prior to panel installation. Follow the instructions received with handle kit to install the handles.
- Plan your installation using these instructions in conjunction with the Installation Instructions provided with the refrigerator. Modifications must be made to the refrigerator to accommodate the Armoire-style door panels.

Required parts

- One of the following built-in refrigerator models:
 - 42" Side-by-Side: JS42NXFXDE
 - 48" Side-by-Side: JS48NXFXDE
 - 36" Bottom Mount: JB36NXFXLE, JB36NXFXRE
 - 36" French Door Bottom Mount: JF36NXFXDE
 - 42" French Door Bottom Mount: JF42NXFXDE
- Accessory Armoire-Style Door Panel Kit which includes (Grille Assembly and Grille Bracket Assembly)
- Custom Panels

NOTE: The required thickness for all panels is 3/4" (1.91 cm).

OPENING REQUIREMENTS

IMPORTANT:

- The width of the opening, from side to side, must be as specified for your model, for at least 3" (7.62 cm) back from the face of the cabinet. If your opening does not meet this requirement, you will need to make modifications.
- The depth of the opening from the front of the cabinet to the back wall must be 25" (63.5 cm) minimum to achieve a flush installation.

CABINET AND PANEL INSTALLATION OPTIONS

Cabinet Depth - 25" (63.5 cm)

Grille Bracket - Top View

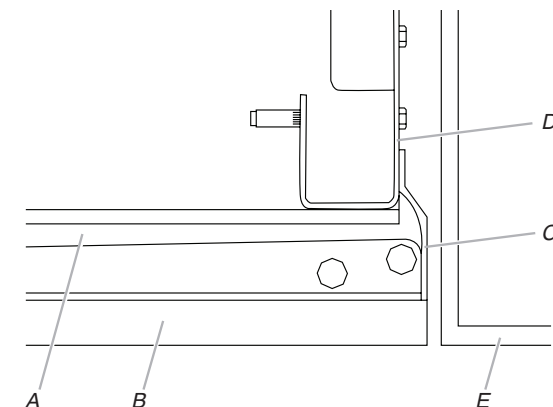

- A. Refrigerator door
- B. Armoire-style door panel
- C. Side trim
- D. Grille bracket
- E. Adjacent cabinet

Grille Bracket - Side View

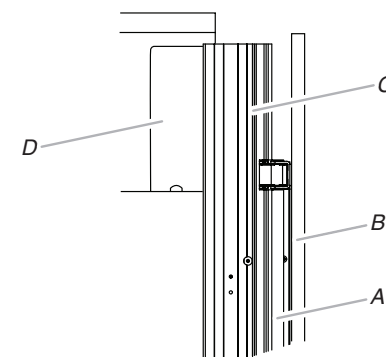

- A. Refrigerator door
- B. Armoire-style door panel
- C. Side trim
- D. Grille bracket

SITE PREPARATION

CABINET CUTOUT OPTIONS

AIRFLOW VENTING RECOMMENDATIONS

IMPORTANT:

- Armoire-style installations recommends a minimum of 1/8" (3.2 mm) of open space above the refrigerator. It is recommended that this space not be blocked in any way, including soffits.
- Models may be installed using either Option 1, Option 2 or option 3.

Option 1 - Open to Ceiling

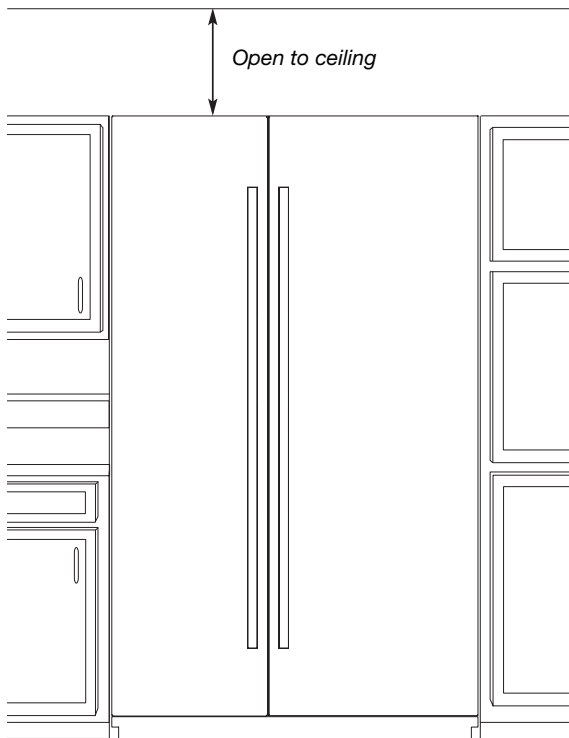

Option 2 - False Front (cabinet face only)

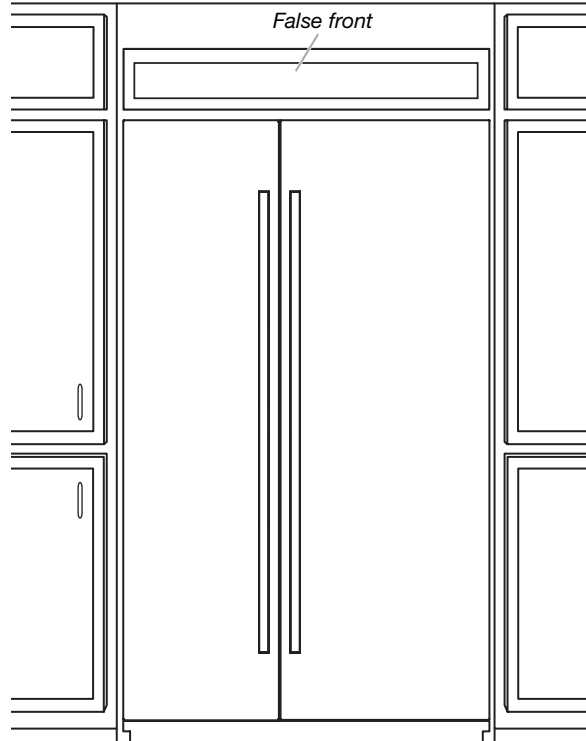

Option 3 - Closed Soffit

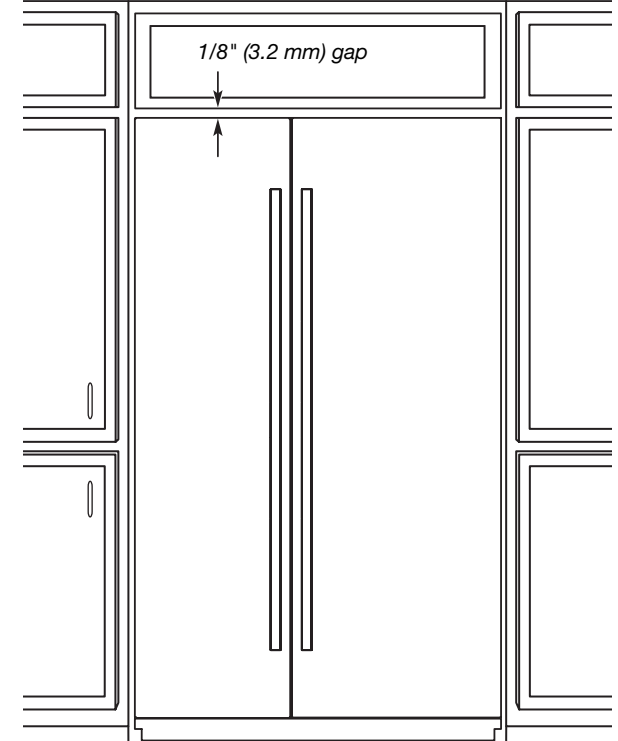

SITE PREPARATION

PANEL DIMENSIONS

BOTTOM MOUNT MODEL

- ! Maximum allowable weights:
- Door panel - 60 lbs (27.2 kg)
 - Drawer panel - 25 lbs (11.3 kg)

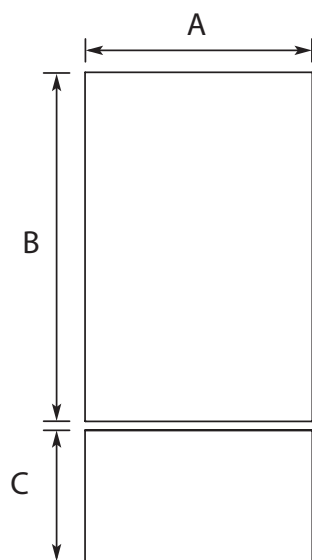

Legend	Model	Dimension
A	36"	35 ³ / ₄ " (90.81 cm)
B	36"	59 ¹ / ₈ " (150.2 cm)
C	36"	20 ¹ / ₂ " (52.07 cm)

FRENCH DOOR BOTTOM MOUNT MODELS

- ! Maximum allowable weights:
- Door panel - 38 lbs (17.2 kg)
 - Drawer panel (36" model) - 25 lbs (11.3 kg)
 - Drawer panel (42" model) - 30 lbs (13.6 kg)

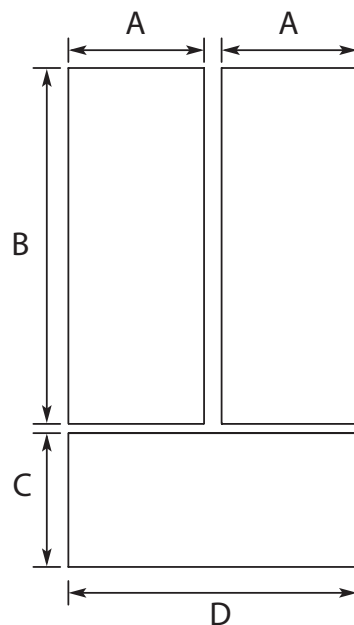

Legend	Model	Dimension
A	36"	17 ³ / ₄ " (45.24 cm)
B		59 ¹ / ₈ " (150.2 cm)
C		20 ¹ / ₂ " (52.07 cm)
D		35 ³ / ₄ " (90.81 cm)
A	42"	20 ³ / ₄ " (52.86 cm)
B		59 ¹ / ₈ " (150.2 cm)
C		20 ¹ / ₂ " (52.07 cm)
D		41 ³ / ₄ " (106.05 cm)

SIDE BY SIDE MODELS

- ! Maximum allowable weights (42" models):
- Refrigerator Door panel - 65 lbs (29.5 kg)
 - Freezer Door panel - 49 lbs (22.2 kg)
- Maximum allowable weights (48" models):
- Refrigerator Door panel - 66 lbs (29.9 kg)
 - Freezer Door panel - 50 lbs (23 kg)

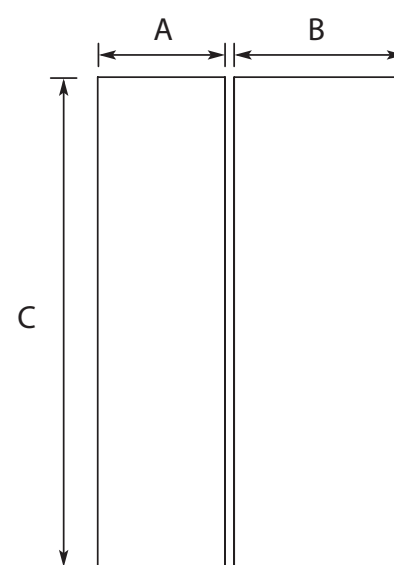

Legend	Model	Dimension
A	42"	17 ³ / ₄ " (45.24 cm)
B		23 ³ / ₄ " (60.48 cm)
C		81" (205.7 cm)
A	48"	20 ¹ / ₄ " (51.59 cm)
B		27 ¹ / ₄ " (69.37 cm)
C		81" (205.7 cm)



36" REFRIGERATOR ARMOIRE STYLE DOOR PANEL KIT, OBSIDIAN

Signature Features

THIS PRODUCT IS A FACTORY CERTIFIED ACCESSORY. THESE THREE WORDS REPRESENT QUALITY PARTS AND ACCESSORIES DESIGNED SPECIFICALLY FOR YOUR APPLIANCE. TIME TESTED ENGINEERING THAT MEETS OUR STRICT QUALITY SPECIFICATIONS

30-DAY RETURN POLICY

PACKAGE CONTAINS (1) 36" REFRIGERATOR ARMOIRE STYLE DOOR PANEL KIT, OBSIDIAN. INCLUDES (1) LEFT AND (1) RIGHT GRILLE BRACKETS AND MACHINE COMPARTMENT COVER

TOOLS NEEDED: MULTI SCREWDRIVER

W10663562



Technical Specifications

Certifications

Prop 65: Standard

®/™ © 2023 JennAir. All rights reserved. Specifications subject to change without notice.

Plan the Installation

Plan your installation using these instructions in conjunction with the Installation Instructions provided with the refrigerator. Modifications must be made to the refrigerator to accommodate the armoire cabinet.

Required parts

- One of the following built-in refrigerator models:
Side-by-Side: JS42NFXDW, JS42NFXDE, JS48NFXDW, JS48NFXDE
36" Bottom Mount: JB36NFXLW, JB36NFXRW, JB36NFXLE, JB36NFXRE
36" French Door Bottom Mount: JF36NFXDE
42" French Door Bottom Mount: JF42NFXDW, JF42NFXDE
- Accessory Armoire-Style Door Panel Kit which includes (Grille Assembly and Grille Bracket Assembly)
- Custom Panels

Opening Requirements

IMPORTANT:

- An Armoire installation requires an open soffit. For a fully integrated installation, a minimum of 6" (15.24 cm) of open space above the refrigerator is required. The open space must also extend the width and depth of the unit. See "Fully Integrated Installation." Anti-tip boards are required. See "Install Anti-Tip Boards" in the Installation Instructions provided with the refrigerator for more information.
- The width of the opening, from side to side, must be as specified for your model, for at least 3" (7.62 cm) back from the face of the cabinet. If your opening does not meet this requirement, you will need to make modifications.
- The depth of the opening from the front of the cabinet to the back wall must be 25" (63.5 cm) minimum to achieve a flush installation.
- A grounded 3 prong electrical outlet should be placed within 4" (10.2 cm) of the right side cabinets or end panel. See "Electrical Requirements" in the Installation Instructions provided with the refrigerator.
- The water shutoff should be located in the base cabinets on either side of the refrigerator or some other easily accessible area. If the water shutoff valve is not in the cabinets, the plumbing for the water line can come through the floor. See "Water Supply Requirements" in the Installation Instructions provided with the refrigerator.

Cabinet and Panel Installation Options

Cabinet Depth - 25" (63.5 cm)

Framed Cabinetry

Top View - Overlay

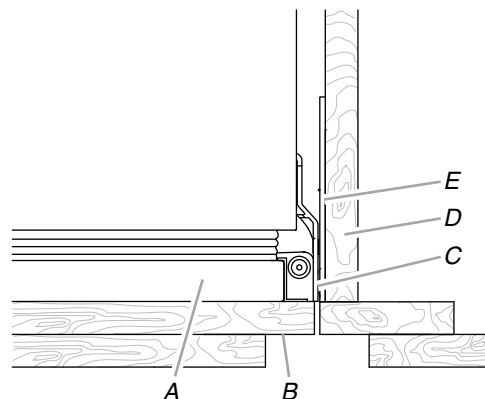

A. Refrigerator door
B. Overlay panel
C. Side trim

D. Adjacent cabinet
E. Grille bracket

Top View - Inset

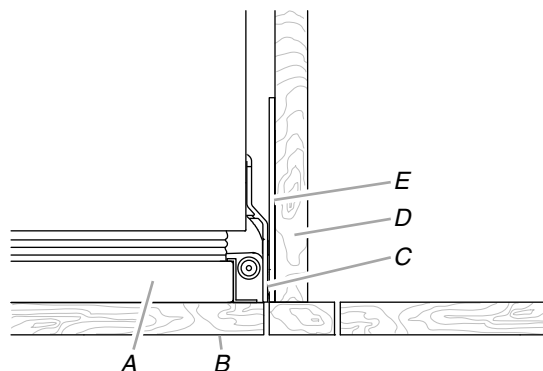

A. Refrigerator door
B. Overlay panel
C. Side trim

D. Adjacent cabinet
E. Grille bracket

Frameless Cabinetry

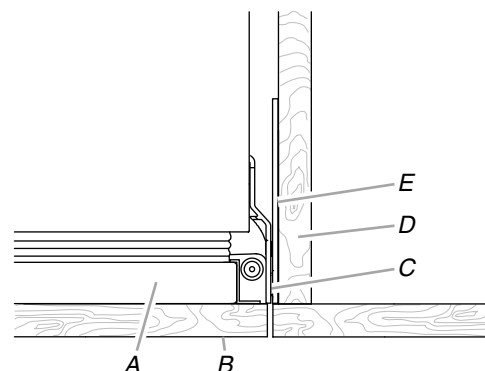

A. Refrigerator door
B. Overlay panel
C. Side trim

D. Adjacent cabinet
E. Grille bracket

Armoire Style Installation Requirements

Top Grille - Side View

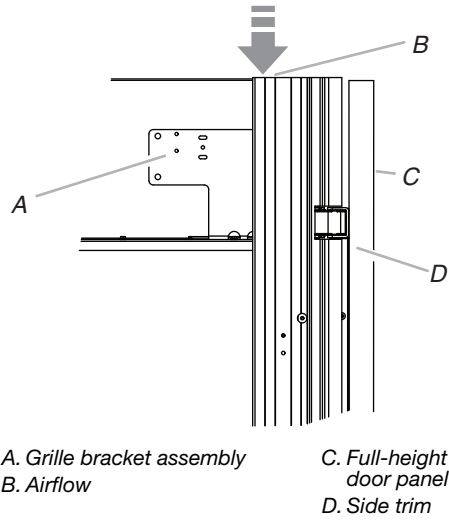

Option 1 - Open to Ceiling (all models)

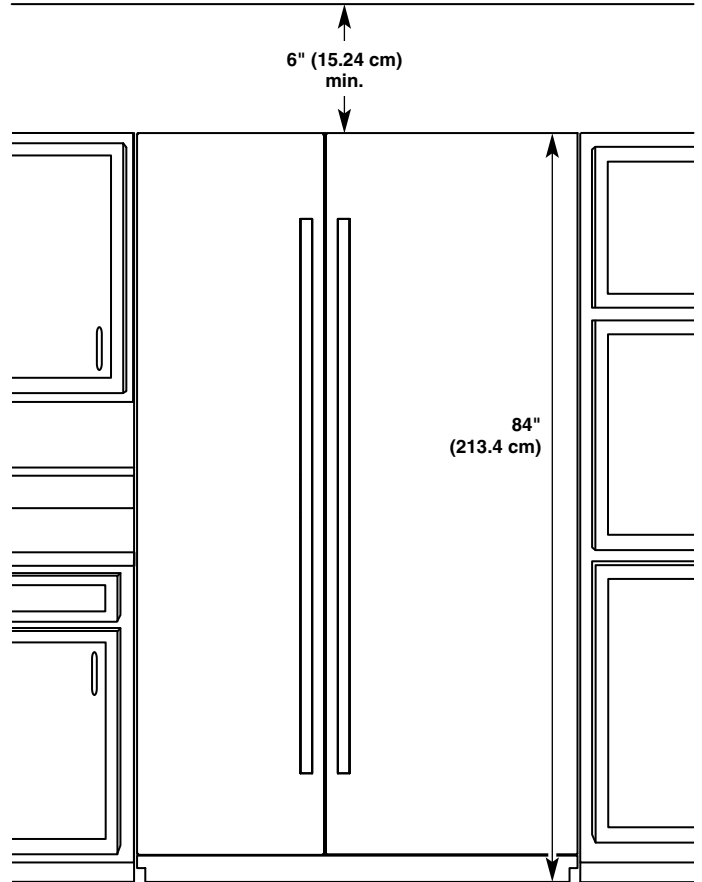

Option 2 - False Front (cabinet face only) (all models)

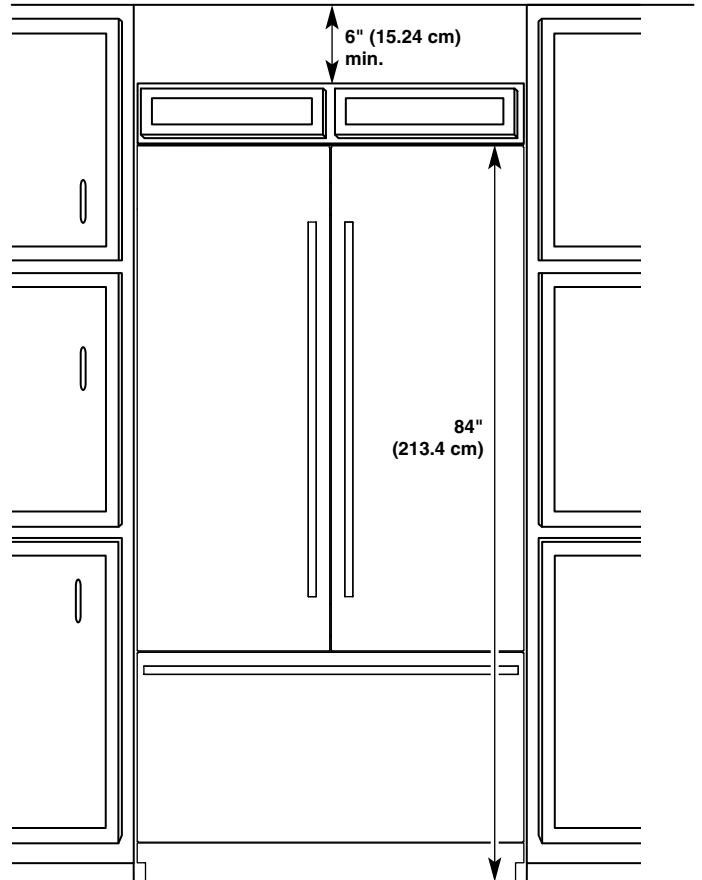

Airflow Venting Requirements

IMPORTANT:

- Armoire style installations require a minimum of 6" (15.24 cm) of open space above the refrigerator. This space must not be blocked in any way, including soffits.
- Models may be installed using either Option 1 or Option 2.

Custom Overlay Panels

Custom overlay panels allow you to blend the exterior of your refrigerator into the overall kitchen décor and to use custom handles for additional design flexibility.

In some cases, your cabinet manufacturer may choose to work with one panel routed for the different dimensions. Follow these panel dimension and placement instructions to be sure that the custom overlay panels will fit properly.

IMPORTANT:

- This installation does not require filler or backer panels.
- The required thickness for all panels is $\frac{3}{4}$ " (1.91 cm).

Bottom Mount

- For 36" (91.4 cm) Single-door Bottom Mount models, the weight of the refrigerator door overlay panel cannot exceed 60 lbs (27.2 kg) and the freezer drawer overlay panel cannot exceed 25 lbs (11.3 kg).
- For 36" (91.4 cm) or 42" (106.7 cm) French Door models, the weight of each refrigerator door cannot exceed 38 lbs (17.2 kg) and the freezer drawer overlay panel cannot exceed 30 lbs (13.6 kg).
- For all models, the weight at the top grille overlay panel cannot exceed 7 lbs (3.2 kg).

Side-by-Side

- The weight of the refrigerator door overlay panel cannot exceed 66 lbs (29.9 kg) for 48" models or 65 lbs (29.5 kg) for 42" models.
- The weight of the freezer door overlay panel cannot exceed 50 lbs (23 kg) for 48" models or 49 lbs (22.2 kg) for 42" models.
- The weight of the top grille overlay panel cannot exceed 8 lbs (3.6 kg) for 48" models or 7 lbs (3.2 kg) for 42" models.

⚠ CAUTION

Pinch Hazard

Installation of door panels with less than a $\frac{3}{8}$ " (0.95 cm) gap between the door panel and the adjacent cabinet increases the risk of potential pinching.

Overlay Panel Dimensions

36" (91.4 cm) Single-Door Model - Door and Drawer Panels

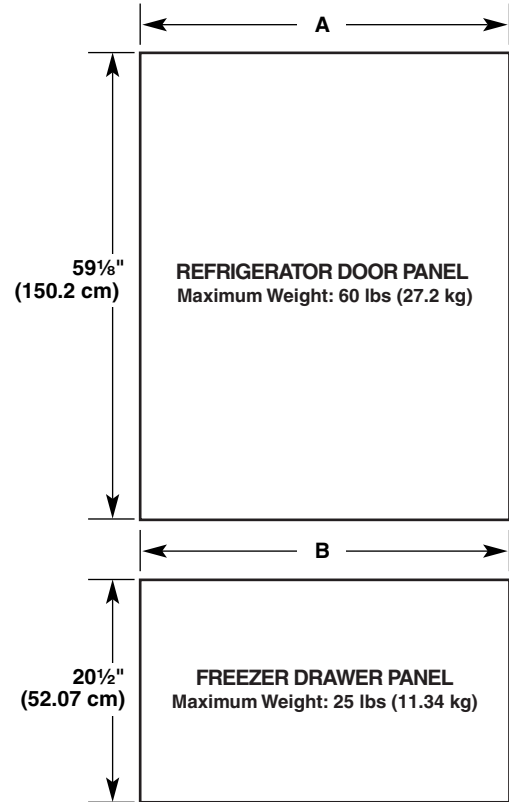

Model	36" Bottom Mount	
Reveal	$\frac{3}{8}$ "	$\frac{1}{8}$ "
A	35 1/4" (89.54 cm)	35 3/4" (90.81 cm)
B	35 1/4" (89.54 cm)	35 3/4" (90.81 cm)

36" (91.4 cm) French Door and 42" (106.7 cm) French Door Model - Door and Drawer Panels

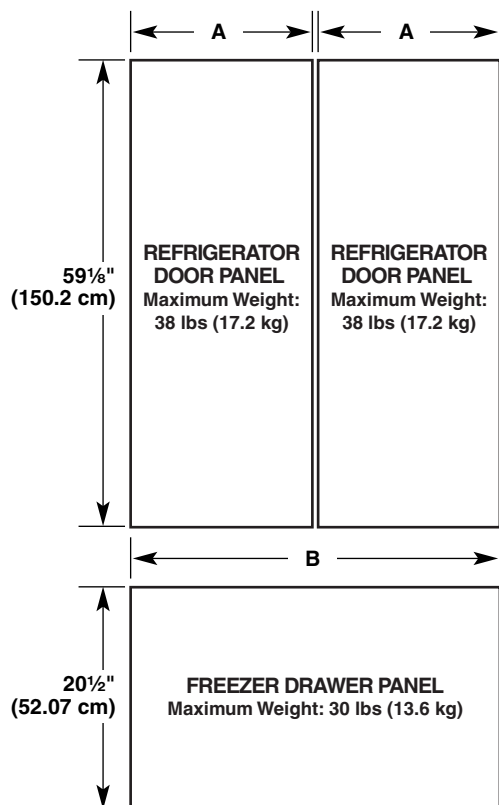

Model	36" French Door Bottom Mount	
Reveal	3/8"	1/8"
A	17 9/16" (44.61 cm)	17 13/16" (45.24 cm)
B	35 1/4" (89.54cm)	35 3/4" (90.81cm)

Model	42" French Door Bottom Mount	
Reveal	3/8"	1/8"
A	20 9/16" (52.23 cm)	20 13/16" (52.86 cm)
B	41 1/4" (104.76 cm)	41 3/4" (106.05 cm)

Side-by-Side - Door Panels

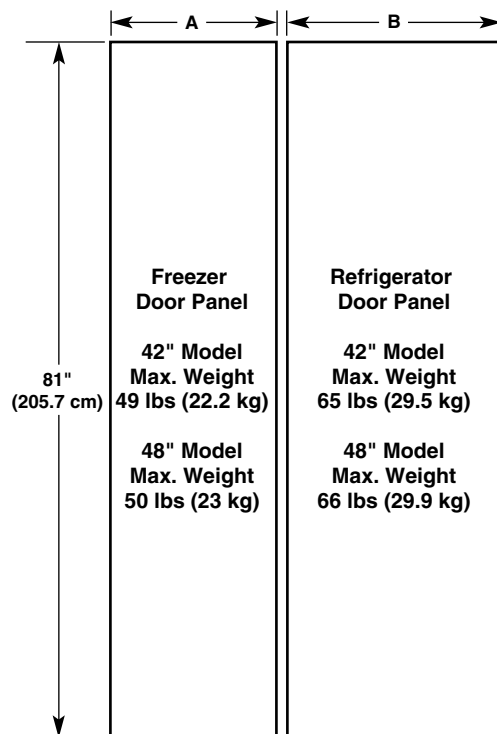

Model	42		48	
Reveal	3/8"	1/8"	3/8"	1/8"
A	17 9/16" (44.61 cm)	17 13/16" (45.24 cm)	20 1/16" (50.96 cm)	20 5/16" (50.17 cm)
B	23 9/16" (59.85 cm)	23 13/16" (60.48 cm)	27 1/16" (68.74 cm)	27 5/16" (69.37 cm)

MODIFICATIONS FOR AN ARMOIRE KIT INSTALLATION

Top Grille

1. Remove the three screws fastening each mounting plate to the top of the refrigerator on each side. Discard the mounting plates but keep the screws for attaching the two grille bracket assemblies provided in this kit.
2. Remove the two screws fastening the air divider to the unit housing. Discard the air divider, but replace the screws into the holes from where they were removed.

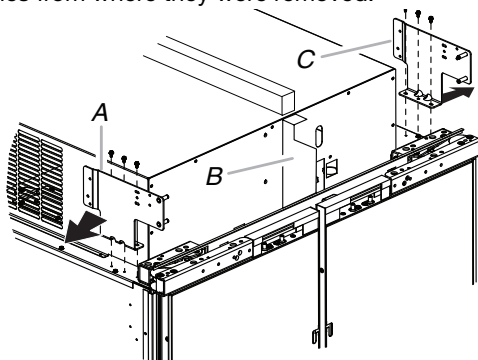

A. Grille bracket mounting plate
B. Air divider
C. Grille bracket mounting plate

3. Align the three holes in a grille bracket assembly with the three holes in a cabinet side, as shown. Using the screws removed in Step 1, attach the grille bracket assembly.

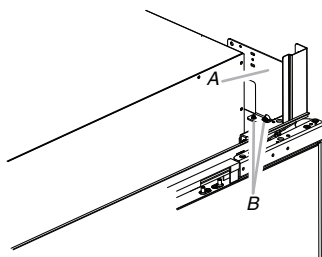

A. Grille bracket assembly
B. Screws

4. Repeat steps 2 and 3 to install the other grille bracket assembly to the opposite side of the refrigerator.

Install Refrigerator

IMPORTANT: Follow the "Installation Instructions" in the "Installation Guide" provided with your refrigerator.

1. Plug refrigerator into grounded 3 prong outlet.

! WARNING



Tip Over Hazard

Refrigerator is top heavy and tips easily when not completely installed.

Keep doors taped closed until refrigerator is completely installed.

Use two or more people to move and install refrigerator.

Failure to do so can result in death or serious injury.

2. Move the refrigerator to its final location.

Install Grille Panel

1. Position the armoire grille panel between the grille brackets on each side of the cabinet.
2. Slide the grille panel down until the top of the grille panel hangs on top of the offsets of the grille brackets.

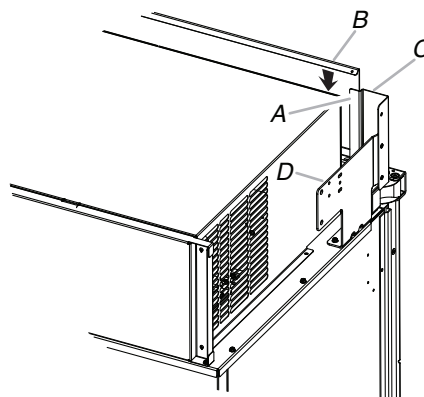

A. Offset in bracket
B. Grille
C. Grille bracket
D. Grille bracket assembly

Prepare Custom Wood Door Panels

IMPORTANT: For an armoire installation, instead of drilling holes along the top edge(s) of the custom door panel(s), you must adjust the placement of the drilling template (provided with the refrigerator).

NOTES:

- No template adjustment is needed for the bottom edge of the door panel(s).
 - No template adjustment is needed for the custom freezer drawer panel.
1. Align the drilling template on the back of the custom refrigerator door panel so that the top of the template is offset $6\frac{3}{4}"$ (17.2 cm) from the top of the refrigerator door panel.

NOTE: The only offset dimension is the $6\frac{3}{4}"$ (17.2 cm) offset from the top of the door panel.

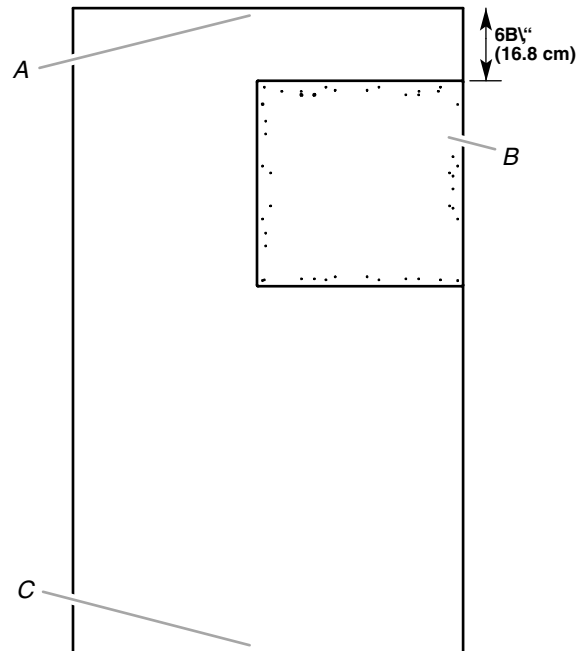

A. Top of custom refrigerator door panel
B. Drilling template
C. Bottom of custom refrigerator door panel

2. Continue to use the template as you normally would along the bottom, handle side of the door panel.

Complete Installation

IMPORTANT: Return to the instructions provided with your refrigerator to complete the installation. See "Prepare Custom Overlay Panels" in the Installation Guide.



JennAir Model: JOECC530RL

RISE™ Microwave Combination Wall Oven with MultiMode® Convection

Color Stainless Steel

Product Description

An upper convection microwave with Speed Cook helps you create chef-inspired meals quickly. Below, the lower cavity's MultiMode® True Convection system with Air Fry transforms prepped food into delicious dinners.

Specifications

Oven Cavity Details

Convection Element Power	3,200
Cooking Power	900
Convection Power	900

Microwave Details

Microwave Capacity	1.4
--------------------	-----

Details

Turntable Diameter Size	14.125
-------------------------	--------

Dimensions

Cutout Depth	24
Cutout Height	41.5
Cutout Width	28.5
Depth	23.25
Depth Closed Excluding	24.313
Depth Excluding Doors	23
Depth With Door Open 90	45.438
Gross Weight	293.88
Height	43.75
Net Weight	288.88
Oven Capacity	5
Oven Interior Height	18
Oven Interior Depth	19
Oven Interior Width	25
Width	30
Capacity	6.4
Common Size	30

Dimensions

Gross Weight	0.000
--------------	-------

Key Features

MultiMode® True Convection System
MultiMode® True Convection System
7.8 Full Color Ultra Wide LCD Display With Culinary
Smart Wall Oven
Smart Wall Oven
Air Fry
Speed Cook
Temperature Probe
Versatile Cooking Modes
Speed Cook
Versatile Cooking Modes
Favorites
Favorites
Jet Black Oven Interior
Jet Black Oven Interior
5.0 Cu. Ft. Capacity
5.0 Cu. Ft. Capacity
Cinematic Lighting
Cinematic Lighting
Closed Door Infrared Broiling
Closed Door Infrared Broiling
3,200-Watt Convection Element
2,800-Watt Hidden Bake Element
4,000-Watt Broil Element
8-Pass Reflective Broil Element
8-Pass Reflective Broil Element
Control Lock
Control Lock
Sabbath Mode
Sabbath Mode
Serviced By a Select Few
Serviced By a Select Few
RISE™ Design Expression
RISE™ Design Expression
Convection & Microwave Combination Cooking
Convection & Microwave Combination Cooking
Stainless Steel Microwave Interior
Stainless Steel Microwave Interior
1.4 Cu. Ft. Microwave Capacity
1.4 Cu. Ft. Microwave Capacity
1,200-Watt Convection Element

900-Watt Microwave Element
Sensor Cooking
Sensor Cooking
Microwave Soften/Melt Cycle
Microwave Soften/Melt Cycle
1,600-Watt Grill Element
Crisp Pan
Crisp Pan
Smooth Glide Flat-Tine Racks
Smooth Close Door
Smooth Glide Flat-Tine Racks
Flush Install Kit Included
On-Demand Experts
Smooth Close Door
Flush Install Kit Included
On-Demand Experts

UPC Listing	
Model : JOECC530RL	UPC : 883049703145

DIMENSION GUIDE

1 of 4

JENNAIR® ELECTRIC COMBO MICROWAVE/WALL OVEN

PRODUCT: JOECC530RL; JOECC530RM; JOECC730RL; JOECC730RM

APPLIANCE:		30" ELECTRIC COMBO MICROWAVE/WALL OVEN			
		JOECC530RL00; JOECC730RL00		JOECC530RM00; JOECC730RM00	
	Units	in	cm	in	cm
A	Depth Closed Excluding Handle (Flush Install)	24 ⁷ / ₁₆	62	24 ⁷ / ₁₆	62
B	Depth Closed Including Handle	27 ⁵ / ₁₆	69.3	26 ¹ / ₂	67.3
C	Depth to Back of Console (Standard Install)	23 ¹ / ₁₆	58.6	23 ¹ / ₁₆	58.6
D	Depth with Door Open 90°	46 ³ / ₁₆	117.3	46 ³ / ₁₆	117.1
E	Maximum Height (Including Console)	44 ³ / ₄	113.6	44 ³ / ₄	113.5
E	Minimum Height (Including Console)	42 ¹⁵ / ₁₆	109.1	42 ⁷ / ₈	109
F	Face Width	29 ³ / ₄	75.6	29 ³ / ₄	75.8
G	Maximum Height (Not Including Console)	43	109.2	43	109.2
G	Minimum Height (Not Including Console)	41 ¹ / ₈	104.4	41 ¹ / ₈	104.4
H	Recessed Width	28 ⁵ / ₁₆	71.9	28 ⁵ / ₁₆	71.9

Feet are available through Service to increase product height for installations where taller cutouts were used.

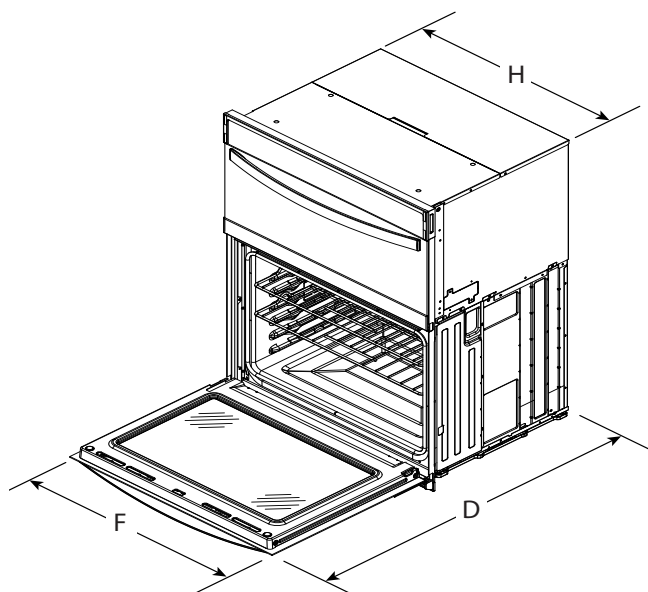

ANGLED VIEW

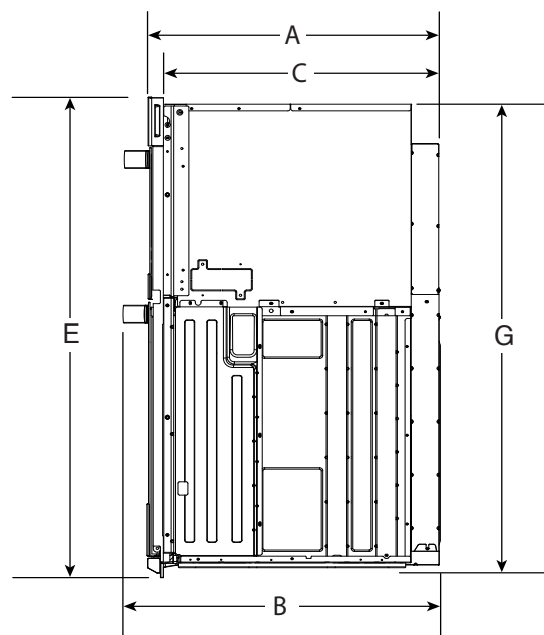

SIDE VIEW

IMPORTANT: Dimensional specifications are provided for planning purposes only.
Do not make any cutouts based on this information. Refer to the Owner's Manual before selecting cabinetry, verifying electrical/gas connections, making cutouts or beginning installation.

Location Requirements

IMPORTANT: Observe all governing codes and ordinances.

- Cabinet opening dimensions that are shown must be used. Given dimensions provide minimum clearance with oven.
- Recessed installation area must provide complete enclosure around the recessed portion of the oven.
- Grounded electrical supply is required. See "Electrical Requirements" section.
- Electrical supply junction box should be located 3" (7.6 cm) maximum above the support surface when the oven is installed in a wall cabinet. A 1" (2.5 cm) minimum diameter hole should have been drilled in the right rear or left rear corner of the support surface to pass the appliance cable through to the junction box.
- Oven support surface must be solid, level, and flush with bottom of cabinet cutout. Floor must be able to support a total weight (microwave and built-in oven) of 350 lbs (158.7 kg) for 30" (76.2 cm) models.

IMPORTANT: To avoid damage to your cabinets, check with your builder or cabinet supplier to make sure that the materials used will not discolor, delaminate or sustain other damage. This oven has been designed in accordance with the requirements of UL and CSA International and complies with the maximum allowable wood cabinet temperatures of 194°F (90°C).

- For ovens installed using flush installation cabinetry, a deflector assembly must be installed. See "Install Deflector Assembly" section of the owner's manual for further instruction.

Cabinet Dimensions - Built-in Microwave/Oven Combination Standard Installation

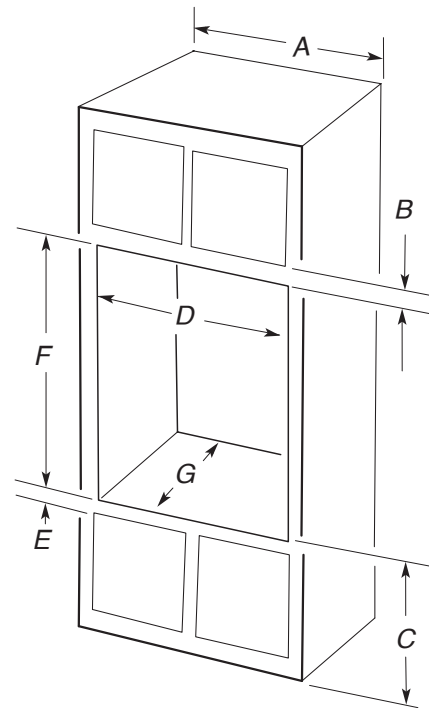

30" (76.2 cm) models

- A. 30" (76.2 cm) minimum cabinet width
- B. 2¹/₄" (5.7 cm) top of cutout to bottom of upper cabinet door
- C. 19¹/₄" (48.9 cm) bottom of cutout to floor is recommended
7¹/₂"-19¹/₄" (19.1 cm-48.9 cm) bottom of cutout to floor is acceptable.
- D. 28¹/₂" (72.4 cm) minimum cutout width
- E. 1¹/₂" (3.8 cm) minimum bottom of cutout to top of cabinet door
- F. 41⁵/₁₆" (105 cm)* recommended cutout height
- G. 24" (60.7 cm) cutout depth

***NOTE:** The cutout height can be between 41¹/₈" (104.5 cm) and 41⁷/₈" (106.3 cm) for microwave/oven combination.

Flush Installation

A 25" (63.5 cm) minimum cutout depth is required.

These dimensions will result in a 1/4" (6 mm) reveal on the top, a 1/4" (6 mm) reveal on the sides, and a 1/8" (3 mm) reveal on the bottom of the wall oven.

The front face of the cleats and platform will be visible and should be treated as a finished surface.

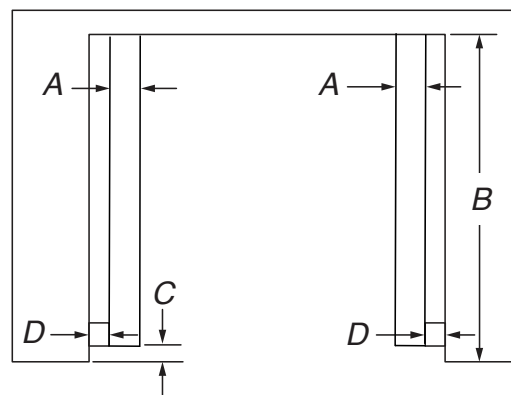
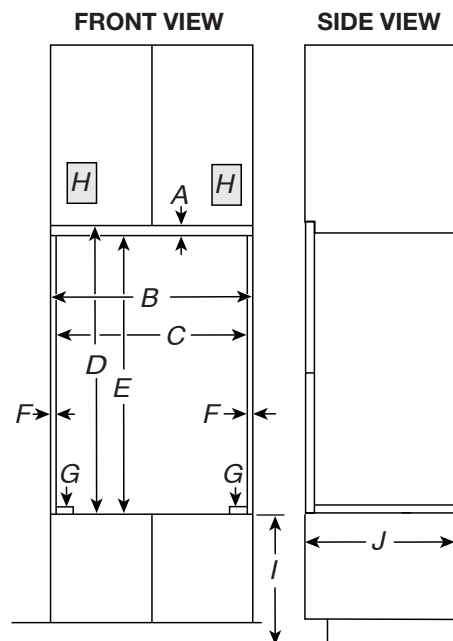

TOP VIEW

30" (76.2 cm) models

- A. 2" (5.1 cm) spacer the entire depth of the cutout*
- B. 25" (63.5 cm) depth of cutout
- C. 1 1/2" (3.8 cm) recess from front of cabinet
- D. 7/8" (2.2 cm) side cleat*

*Cleats and spacers must be recessed 1 3/8" (3.5 cm) from the front of the cabinet.

Electrical Requirements

⚠ WARNING



Electrical Shock Hazard

Disconnect power before servicing.

Electrically ground appliance.

Failure to do so can result in death, fire, or electrical shock.

If codes permit and a separate ground wire is used, it is recommended that a qualified electrical installer determine that the ground path and the wire gauge are in accordance with local codes.

Check with a qualified electrical installer if you are not sure the oven is properly grounded.

This oven must be connected to a grounded metal, permanent wiring system.

Be sure that the electrical connection and wire size are adequate and in conformance with the National Electrical Code, ANSI/NFPA 70-latest edition or CSA Standards C22.1-94, Canadian Electrical Code, Part 1 and C22.2 No. O-M91-latest edition, and all local codes and ordinances.

30" (76.2 cm) models

- A. 3/4" (1.9 cm) top cleat*
- B. 30 1/4" (76.8 cm) minimum width of flush inset cutout**
- C. 28 7/8" (73.3 cm) minimum width of opening
- D. 44 5/16" (112.5 cm) minimum height of flush inset cutout
- E. 43 9/16" (110.6 cm) recommended cutout height
- F. 1 1/16" (1.7 cm) side cleat*
- G. 15/16" to 1 5/16" (2.3 cm to 3.5 cm) recommended, 1/4" (0.6 cm) allowable with optional foot.***
- H. Recommended junction box location.
- I. 7 1/2"-19 1/4" (19 cm-48.9 cm) bottom of cutout to floor
- J. 25" (63.5 cm) minimum depth of cutout

*Cleats and spacers must be recessed 1 3/8" (3.5 cm) from the front of the cabinet.

**These dimensions will lead to side gaps of 1/4" (0.6 cm).

***Top and bottom gaps will be 3/8" (0.9 cm) gap above the 1/8" (0.3 cm) gap below the product. Top and bottom gaps not required for installation. Expose areas of the cabinet should be finished to match.

Feet are available through Service to increase product height for installations where taller cutouts were used.

NOTE: This is an alternate option to install your product in the cabinet and obtain a flush look. For standard installation, refer section "Product Dimensions - Built-in Microwave/Oven Combination, Standard Installation."

NOTE: For flush installations add the deflector assembly. See "Install Deflector Assembly" section of the owner's manual for further instruction.

A copy of the above code standards can be obtained from:
National Fire Protection Association
1 Batterymarch Park
Quincy, MA 02169-7471
CSA International
8501 East Pleasant Valley Road
Cleveland, OH 44131-5575.

Electrical Connection

To properly install your oven, you must determine the type of electrical connection you will be using and follow the instructions provided for it here.

- Oven must be connected to the proper electrical voltage and frequency as specified on the model/serial/rating plate. The model/serial/rating plate is located under the control panel on single ovens and under the control panel on the upper oven cavity on double ovens. See the following illustration.

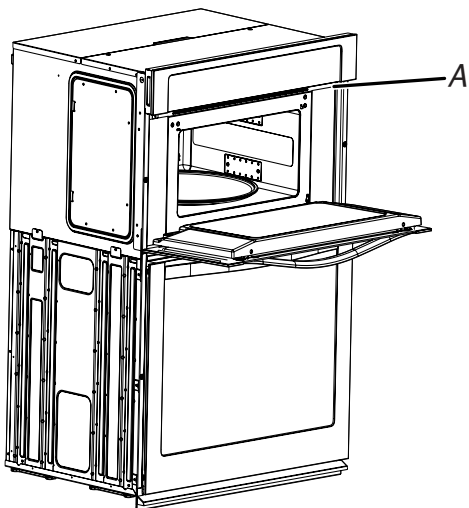

A. Model/serial/rating plate

- Models rated from 7.3 to 9.6 kW at 240 V (5.4 to 7.4 kW at 208 V) require a separate 40 A circuit. Models rated at 4.8 kW and below at 240 V (3.6 kW and below at 208 V) require a separate 20 A circuit.
- A circuit breaker is recommended.
- Connect directly to the fused disconnect (or circuit breaker box) through flexible, armored or nonmetallic sheathed, copper cable (with grounding wire). See the "Make Electrical Connection" section in the Owner's Manual.
- Flexible conduit from the oven should be connected directly to the junction box.
- Fuse both sides of the line.
- Do not cut the conduit. The length of conduit provided is for serviceability of the oven.
- A UL listed or CSA-approved conduit connector must be provided.

- If the house has aluminum wiring, follow the procedure below:

Connect the aluminum wiring using special connectors and/or tools designed and UL listed for joining copper to aluminum.

Follow the electrical connector manufacturer's recommended procedure. Aluminum/copper connection must conform with local codes and industry-accepted wiring practices.

Be sure that the electrical connection and wire size are adequate and in conformance with the National Electrical Code, ANSI/ NFPA 70-latest edition or CSA Standards C22.1-94, Canadian Electrical Code, Part 1 and C22.2 No. 0-M91-latest edition, and all local codes and ordinances.

A copy of the above code standards can be obtained from:

National Fire Protection Association
1 Batterymarch Park
Quincy, MA 02169-7471

CSA International
8501 East Pleasant Valley Road
Cleveland, OH 44131-5575.



JennAir Model: JDAF3924RX

24" Panel-Ready Fully Integrated Dishwasher with Precise Fit
3rd Rack for Cutlery

Color  Panel Ready

Product Description

Inside, a storm rages as relentless power brings every dish and glass to a state of refined cleanliness. Outside, tranquility, with sleek lines wrapped in high design. With a 3rd rack designed for cutlery and a seamless flush to cabinet design, the quietest luxury dishwasher brand* never sacrifices performance.

*Based on Normal Cycle.

Specifications

Certifications

CUL	Yes
ADA Compliant	Yes (US Only)
Energy Star Qualified	ENERGY STAR® Qualified
Prop 65	 CALIFORNIA RESIDENTS ONLY - WARNING: Cancer and Reproductive Harm - www.P65Warnings.ca.gov
NSF Certified	Yes

Details

Built-In Water Softener	Yes
Design Expression	Panel-Ready
Dishwasher Cycle Selection	Cookware Crystal Normal Refresh Sensor
Dishwasher Option	Bottom Rack Wash Delay Door Open Dry Extended Dry Hi Temp Wash Sani Rinse Top 2 Racks Wash
Dishwasher Type	Built-In
Dispensers	Detergent and Rinse Aid
Drying System Type	Open Door System
Number of Racks	3
Number of Place Settings	14
Number of Wash Levels	3
Number of Washarms	3
Rack Material	Nylon
Rinse Aid Dispenser Level	Yes
Sensor	Yes
Sound Package	Yes
Tub Material	Stainless Steel
True Hold Door	Yes
Water Filtration	Yes
Wash System	Filter

Silverware Basket Details

Silverware Basket Location	Bottom Rack
Silverware Basket Covers	Yes

Controls

Automatic Temperature	Yes
Control Location	Top Hidden
Control Type	Electronic Touch
End of Cycle Signal	Yes
Status Light	Display on Floor

Installation Considerations

Hoses Included	Yes, Drain
----------------	------------

Dimensions

Cutout Height	32-313/1000
Cutout Width	23-5/8
Depth Closed Excluding	22-5/8
Depth With Door Open 90	47-1/4
Depth Closed Including	24-5/8
Cutout Depth	22-7/8
Depth	21-7/8
Height	32-5/16
Gross Weight	86-1/5
Net Weight	81-49/50
Width	23-9/16

Exterior Details

Door Style	Flat
Magnetic Door	Yes

Smart Compatibility

Connectivity	No
Works With	No

Rack Details

Lower Rack Cushion-Tip	No
Lower Rack Extras	Culinary Caddy®
Second Level Rack Extras	6 Stemware Holders Stainless Steel Wash Arm
Second Level Rack	Yes
Second Level Rack Cushion-	Yes
Second Level Rack Fold-	1 Row 6 Position
Third Level Rack Adjustable	No
Third Level Rack Removable	Yes
Third Level Rack Type	Toss and Go

Cycles

Number of Wash Cycles	6
-----------------------	---

Dimensions

Gross Weight	86-1/5
--------------	--------

Interior Details

Interior Light	No
----------------	----

Key Features

38 dBA Tranquility System*
39 dBA Tranquility System*
Fully Flush & Integrated Design
Precise Fit Flexible 3rd Rack for Cutlery
Time on Floor
Door Open Dry
ADA Compliant
Water Softener
ClearScan™ Sensor Cycle
Cookware Cycle
Normal Cycle
Crystal Cycle
Rapid Wash Cycle
Refresh Cycle
1 to 24-Hour Delay Start Option
Bottom Rack Wash Option
Hi-Temp Wash Option
Sanitize Rinse Option
Extended Dry
14 Place Setting Capacity
2 Position Fold-Away™ Tines
Daring Obsidian Racks
Superior Glide Middle Rack
3-Stage Filtration
Emotive Feedback
Concealed Controls
Adjustable Silverware Basket
Panel Ready
ENERGY STAR® Certified
Premium Rack Adjusters
Cup Shelf with Stemware Holders
Stainless Steel Spray Arms
Stainless Steel Tub
TriFecta™ Wash System
True Hold Door
Waterlock Leak Detection System
Experts at the Ready
Serviced by a Select Few

Electrical Requirements

Power Cord Included	No
---------------------	----

UPC Listing

Model : JDAF3924RX	UPC : 883049663050
--------------------	--------------------



PRODUCT MODEL NUMBERS

JDAF3924RX

JDAF5924RL

JDAF5924RM

JDAF5924RX

DRAIN REQUIREMENTS

- A new drain hose is supplied with your dishwasher. If drain hose is not long enough, use a drain hose extension with a maximum length of 12 ft (3.7 m).
- Make sure to connect drain hose to waste tee or disposer inlet above drain trap in house plumbing and 20" (508 mm) minimum above the floor. It is recommended that the drain hose either be looped up and securely fastened to the underside of the counter or be connected to an air gap.

IMPORTANT: This product is not equipped with a high loop on the side of the dishwasher. The installer is responsible for adding a high loop in the adjacent cabinet. A high loop is required if the dishwasher will drain into a floor drain. This prevents water draw off from the dishwasher during operation. When the drain is connected to a sink drain, counter-top air-gap or disposer, the high loop is generally not required. An check valve internal to the drain prevents back-flow into the dishwasher.

- Make sure to use an air gap if the drain hose is connected to house plumbing lower than 20" (508 mm) above subfloor or floor.

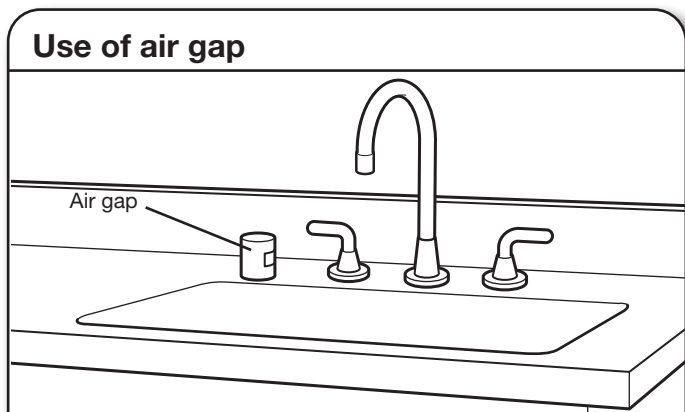

- If required, the air gap should be installed in accordance with the air gap installation instructions. When you are connecting the air gap, a rubber hose (not provided) will be needed to connect to the waste tee or disposer inlet.
- Use 1/2" (13 mm) minimum I.D. drain line fittings.

WATER SUPPLY REQUIREMENTS

- This dishwasher maybe fitted with a smart inlet hose with a water cut off valve. Do not cut the water inlet hose for any reason, to install, adapt or shorten.
- This dishwasher has a water heating feature and also requires a connection to a hot water supply line.
- A hot water line with 20 psi to 120 psi (138 kPa to 862 kPa) water pressure can be verified by a licensed plumber.
- 120°F (49°C) water at dishwasher.
- 3/8" (95 mm) O.D. copper tubing with compression fitting or flexible braided water supply line.

Undercounter Dishwasher

- Included water inlet hose with Leak Detection System for some models.
- Included 3/8" (9.5 mm) Compression x 3/4" (19 mm) Water inlet adapter (only for models with Leak Detection System).
- If installed in new construction, make sure the house water supply lines have been flushed prior to connecting the dishwasher to remove any debris that may exist in the supply line.

ELECTRICAL REQUIREMENTS

Be sure that the electrical connection and wire size are adequate and in conformance with the National Electrical Code, ANSI/NFPA 70 - latest edition, and all local codes and ordinances.

For a fee, a copy of the above code standards can be obtained from:

National Fire Protection Association
1 Batterymarch Park
Quincy, MA 02169-7471

You Must Have:

- 120 V, 60 Hz, AC only, 15 A or 20 A, fused electrical supply.
- Copper wire only.
- A maximum of 2 field wiring supply conductors (12 AWG largest size) plus 1 grounding conductor are permitted in the terminal box.

We Recommend:

- Install the dishwasher on a circuit with appropriate interrupter per your local code. The dishwasher is compatible with time delay fuses, standard circuit breakers, and GFCI and AFCI circuit breakers.

Circuit Requirement:

- The dishwasher may be installed on the same circuit as a garbage disposal providing that the branch circuit cannot exceed rated circuit load and must comply with all governing codes and regulations such as but not limited to National Electrical Code, ANSI/NFPA 70 - latest edition.
- No electrical connections other than the dishwasher power and ground connections can be made inside of the dishwasher junction box.

If Connecting Dishwasher with a Power Cord:

- Use UL Listed power cord kit marked for use with dishwasher. See the "Tools and Parts" section at the front of the Owner's manual for part details and orders.
- Plug into a grounded 3 prong outlet. Outlet must meet all local codes and ordinances.

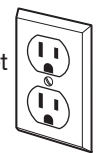

If Connecting Dishwasher with Direct Wiring:

- Use flexible, armored, or nonmetallic sheathed copper wire with grounding wire that meets the wiring requirements for your home and local codes and ordinances.
- Use only the supplied plastic cable fittings for flexible and non-metallic sheathed wiring (Romex, etc.). Do not use metallic strain reliefs for these wire constructions.
- Use a UL-listed/CSA-approved metallic strain relief for armored cable installations (21 mm diameter). Using the strain relief's manufacturer installations instructions.



Because Whirlpool Corporation policy includes a continuous commitment to improve our products, we reserve the right to change materials and specifications without notice.

Dimensions are for planning purposes only. For complete details, see Installation Instructions packed with product. Specifications subject to change without notice.

PRODUCT DIMENSIONS (FOR PANEL READY MODELS)

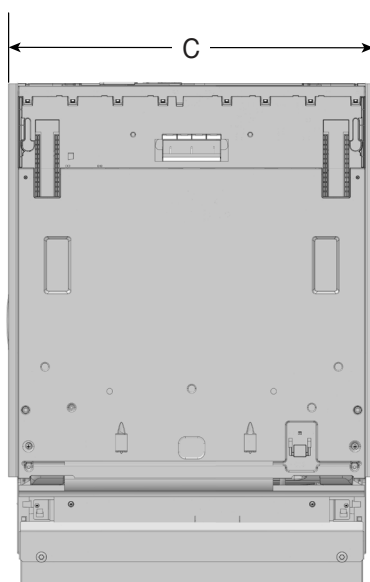

C. $23\frac{9}{16}$ " (599 mm)

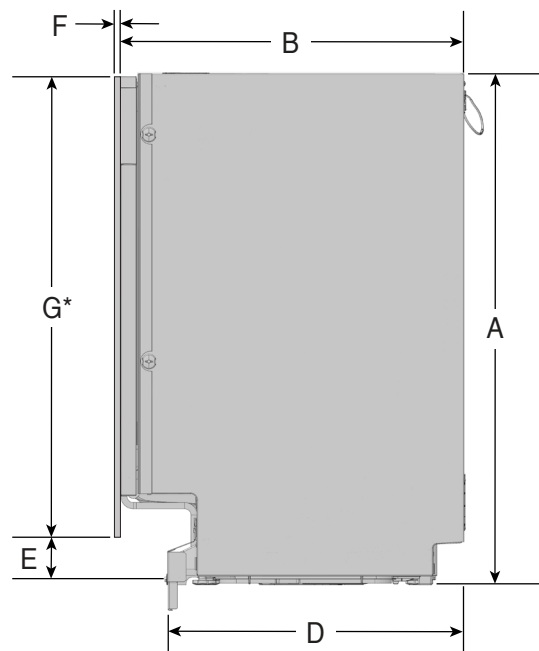

A. $32\frac{1}{4}$ "- $35\frac{7}{16}$ " (820-900 mm) E. $E = A - G$
 B. $21\frac{7}{8}$ " (555 mm) F. $11\frac{1}{16}$ "- $1\frac{3}{4}$ " (18-45 mm)
 D. $18\frac{3}{4}$ " (477 mm) G. $28\frac{3}{8}$ "- $29\frac{15}{16}$ " (720-760 mm)

***NOTE:** If a custom toe kick is desired to be installed, adjust the thickness of the custom panel to make it flush with the cabinet toe kick. Product's original metal toe kick must remain even if custom toe kick is installed.

Because Whirlpool Corporation policy includes a continuous commitment to improve our products, we reserve the right to change materials and specifications without notice.

Dimensions are for planning purposes only. For complete details, see Installation Instructions packed with product. Specifications subject to change without notice.

CABINET OPENING DIMENSIONS

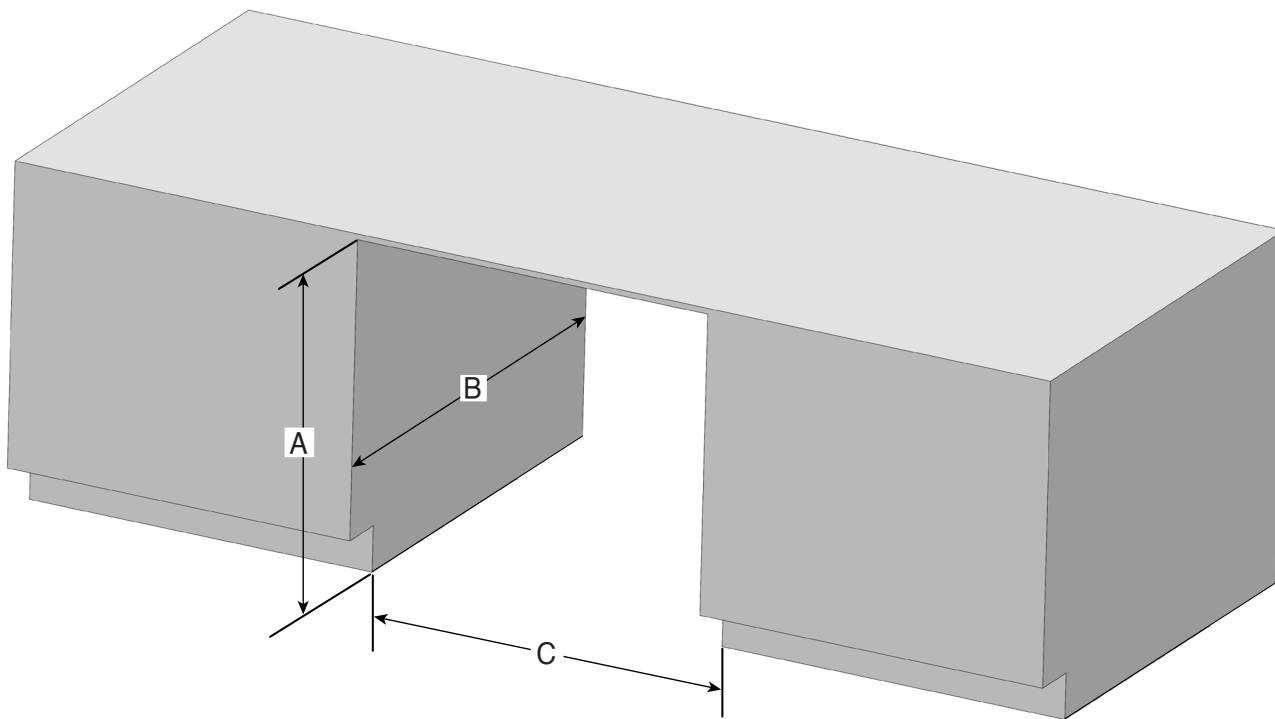

- A. $32\frac{1}{4}"$ - $35\frac{7}{16}"$ (820-900 mm) measured from the lowest point on the underside of the countertop.
- B. 24" (609.6 mm) Minimum
- C. $23\frac{5}{8}"$ - $24\frac{1}{4}"$ (600-616 mm) Minimum, measured from narrowest point of opening.

JIC4736HS

Lustre 36" Induction Flex Cooktop



<http://www.jennair.com>

Key Features:

- Emotive Controls
- Lustre Brushed Metal Design
- Versatile Installation
- Magnetic Induction
- Bridge Function

Product Dimensions:

Height: 3/16

Width: 36

Depth: 21

Electrical Requirements:

50. 240V.

Additional Information:

[Owners Manual](#)

[Dimension Guide](#)

[Installation Guide](#)

[Warranty Certificate](#)

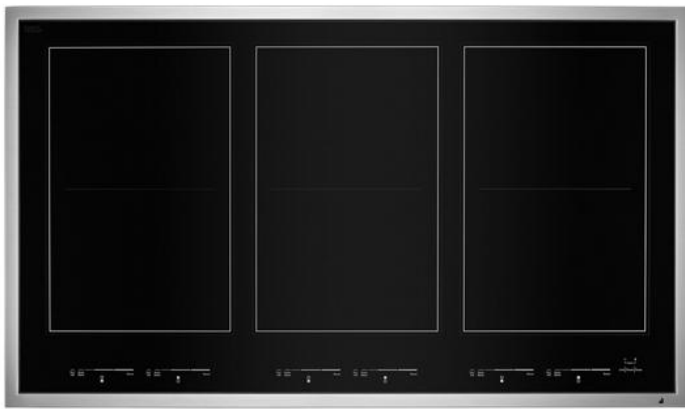

Available in:

- Floating Glass Black
- Stainless Steel

©Registered trademark/TM Trademark of Whirlpool, U.S.A. © 2024 Whirlpool Corporation. All Rights Reserved.
All other trademarks are owned by their respective companies.

Because Whirlpool Corporation policy includes a continuous commitment to improve our products, we reserve the right to change materials and specifications without notice. We also reserve the right to discontinue or transition products without notice.

Manufacturer's Suggested Retail Price (MSRP) and Minimum Advertised Price (MAP) provided for reference purposes only. Dealer alone determines advertised and retail prices.

Created On: Monday, June 10, 2024 11:58:28

Product Dimensions

Cabinet Dimensions

IMPORTANT: If installing a range hood or microwave hood combination above the cooktop, follow the range hood or microwave hood combination installation instructions for dimensional clearances above the cooktop surface.

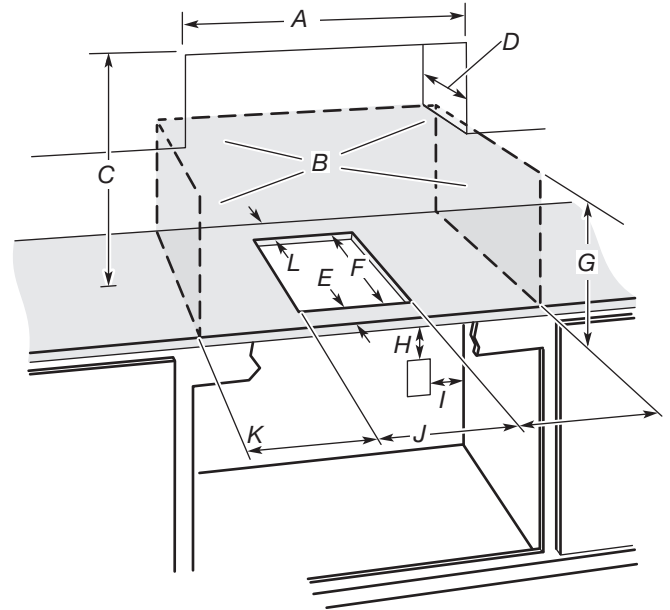

36" (91.4 cm) Cooktop (Model JIC4736HS, JIC4736HB)

Top View

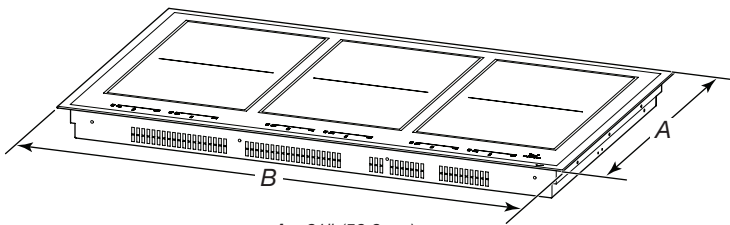

- A. 21" (53.3 cm)
- B. 36" (91.4 cm)

- A. Minimum upper cabinet width. See the "Standard Install Dimensions" table.
- B. Combustible area above countertop (shown by dashed box above)
- C. 30" (76.2 cm) minimum clearance between top of cooktop platform and bottom of uncovered wood or metal cabinet (24" [61.0 cm] minimum clearance if bottom of wood or metal cabinet is covered by not less than 1/4" [0.06 mm] flame retardant millboard covered with not less than No. 28 MSG sheet steel, 0.015" [0.04 cm] stainless steel, or 0.024" [0.06 cm] aluminum or 0.020" [0.05 cm] copper)
- D. 13" (33 cm) recommended upper cabinet depth
- E. 2⁵/₁₆" (5.9 cm) minimum distance to front countertop edge
- F. 20³/₁₆" (51.8 cm)
- G. 18" (45.7 cm) minimum clearance from upper cabinet to countertop within minimum horizontal clearances to cooktop
- H. Junction box or outlet: 7" (17.8 cm) minimum from top of countertop
- I. Junction box or outlet: 9" (23.0 cm) maximum from right side of cabinet
- J. See the "Standard Install Dimensions" Table
- K. 6" (15.2 cm) minimum side wall clearance
- L. 2⁵/₁₆" (5.9 cm) minimum distance to rear combustable surface

Standard Install Dimensions Table

NOTE: When pairing cooktops, this option is recommended only with stainless steel or framed cooktops.

Units	Upper Cabinet Width (A)	Cutout Width (J)
-------	-------------------------	------------------

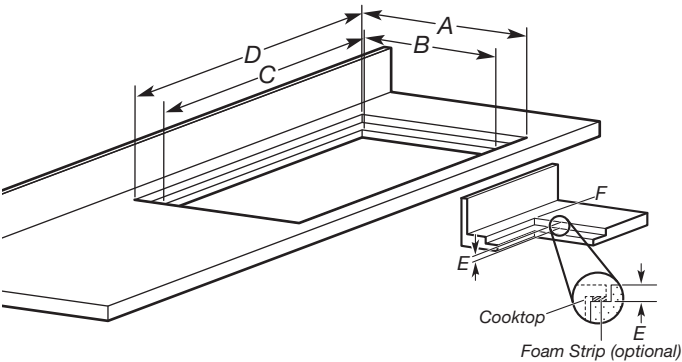

- A. Recessed area length 21³/₁₆" (53.8 cm)
- B. Cutout length 20³/₈" (51.8 cm)
- C. See the "Flush Install Dimension" table.
- D. See the "Flush Install Dimension" table.
- E. Recessed area depth 11/64" (4.3 mm)
- F. Recessed area radius 5/64" (2.0 mm) maximum

Flush Install Dimension Table

Units	Recessed Area Width (D)	Cutout Width (C)
-------	-------------------------	------------------

36" (91.4 cm) cooktop	36" (91.4 cm)	34 ³¹ / ₃₂ " (88.8 cm)
36" (91.4 cm) cooktop and one 15" (38.1 cm) unit	51" (129.5 cm)	50 ³ / ₁₆ " (127.5 cm)

NOTE: After making the countertop cutout, some installations may require notching down the base cabinet side walls to clear the cooktop base. To avoid this modification, use a base cabinet with sidewalls wider than the cutout.

If cabinet has a drawer, a 5¹/₂" (14.0 cm) depth clearance from the countertop to the top of the drawer (or other obstruction) in base cabinet is required.

Flush Installation Dimensions

All cooktops can be mounted with a frameless standard installation sitting on top of the countertop surface or flush with the top of the countertop.

If the cooktop is to be mounted flush with the countertop, a recessed area surrounding the cooktop cutout must be provided with the following dimensions:

- 1. 11/64" (4.3 mm) recessed depth is needed for the SS Frame Model (see dimension E).

NOTE: This option is not recommended for countertops with a molded backsplash. Do not silicone seal in place.

36" (91.4 cm) cooktop	36 ¹ / ₈ " (91.8 cm)	35 ³ / ₈ " (89.9 cm)
36" (91.4 cm) cooktop and one 15" (38.1 cm) unit	51 ¹ / ₈ " (129.9 cm)	50 ³ / ₁₆ " (127.5 cm)

IMPORTANT: If multiple units are installed side by side, the mounting bridge kit W11031680 is needed for proper installation.

Electrical Requirements

⚠ WARNING



Electrical Shock Hazard

Disconnect power before servicing.

Use 8 gauge copper wire.

Electrically ground cooktop.

Failure to follow these instructions can result in death, fire, or electrical shock.

If codes permit and a separate ground wire is used, it is recommended that a qualified electrical installer determine that the ground path and wire gauge are in accordance with local codes.

Check with a qualified electrical installer if you are not sure the cooktop is properly grounded.

Make sure that the electrical connection and wire size are adequate and in conformance with the National Electrical Code, ANSI/NFPA 70—latest edition or CSA Standards C22.1—94, Canadian Electrical Code, Part 1 and C22.2 No. O-M91—latest edition, and all local codes and ordinances.

A copy of the above code standards can be obtained from:

National Fire Protection Association
1 Batterymarch Park
Quincy, MA 02169-7471

CSA International
8501 East Pleasant Valley Road
Cleveland, OH 44131-5575

Before You Make the Electrical Connection:

To properly install your cooktop, you must determine the type of electrical connection you will be using and follow the instructions provided for it here.

- A 3-wire or 4-wire, single phase, 240 V, 60 Hz, AC only electrical supply is required on a separate, 40 A for 24" (61.0 cm) and 30" (76.2 cm) models; 50 A for 36" (91.4 cm) model, 2-pole breaker, 240/208 V, 50/60 Hz AC supply circuit fused on both sides of the line. The model/serial/rating plate is located on the metal cabinet underneath the cooktop. See the following illustration.

NOTE: A separate 40 A [24" (61.0 cm) and 30" (76.2 cm) models] or 50 A [36" (91.4 cm) model] circuit fused on both sides of the line can be used for 40 A or 50 A, 2-pole breaker, 240/208 V, 50/60 Hz AC-supply.

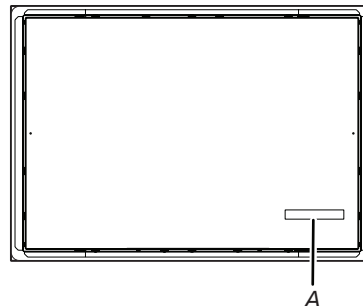

A. Model/serial/rating plate

- The cooktop is rated 240/208 V.
- The cooktop should be connected directly to the junction box through flexible, conduit shielded wire. No alternative is permissible. The flexible, armored cable extending from the fuse box or circuit breaker box should be connected directly to the junction box.
- Locate the junction box to allow as much slack as possible between the junction box and the cooktop so that the cooktop can be moved if servicing becomes necessary in the future.
- Do not cut the conduit. Use the length of conduit provided.
- A UL Listed or CSA Approved conduit connector must be provided at each end of the power supply cable (at the cooktop and at the junction box). A listed conduit connector is already provided at the cooktop.
- If the house has aluminum wiring, follow the procedure below:
Connect the aluminum wiring using special connectors and/or tools designed and UL listed for joining copper to aluminum.

INSTALLATION INSTRUCTIONS

Prepare Cooktop for Installation

Write down the model and serial numbers before installing the cooktop. Both numbers are located on the center underside of the burner box.

Unpack the parts supplied with your cooktop. The parts shipped with the cooktop depend on the model ordered. See the "Tools and Parts" section for a complete list of parts supplied with the cooktop.

Decide on the final location for the cooktop. Locate existing wiring to avoid drilling into or severing wiring during installation.

1. Remove the foam strip from the hardware package. Remove the backing from the foam strip.

For countertop installations: Apply the foam strip with the adhesive side to the countertop within 1/16" (1.6 mm) of the edge of the cutout, front, back, and sides.

For flush installations: Apply the foam strip with the adhesive side to the bottom of the cutout recessed area. Save the excess foam strip for use with the mounting bridge kit.

NOTE: The foam strip helps keep the underside of the cooktop frame free from debris and helps the cooktop sit flat on uneven countertops. Do not silicone seal in place.

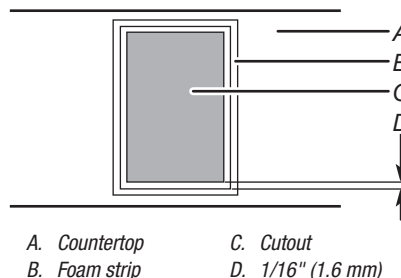

A. Countertop

B. Foam strip

C. Cutout

D. 1/16" (1.6 mm)

Palermo

Insert hood

Specification sheet



Learn
more

MEASUREMENTS

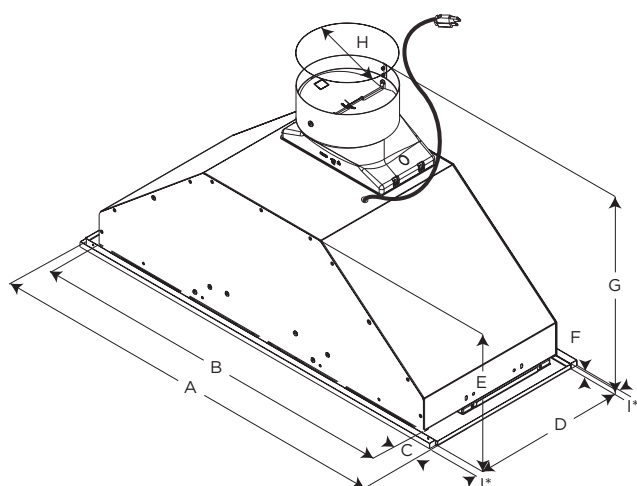

	EPR628S2	EPR634S1
A	28 1/4" (71.8 cm)	34 1/4" (86.7 cm)
B	26" (66 cm)	
C	1 15/16" (3 cm)	4 1/16" (10.3 cm)
D	10 3/4" (27.3 cm)	
E	9 1/2" (24.2 cm)	
F	7/8" (.85 cm)	
G	14 9/16" (37 cm)	
H	6" (15.2 cm)	
I*	1/2" (1.27 cm)	

I* - Metallic spacers: spacers have to be installed and used when cabinet depth is greater than 12".

DESCRIPTION

Palermo provides professional-grade performance, while its 28" and 34" width models with a 10 3/4" depth enable it to be discreetly installed within standard 12" deep cabinetry, making it ideal for smaller kitchens or where the range hood needs to be out of sight. Palermo features a powerful 600 CFM blower to support most cooking needs. Stylish stainless steel push button controls operate a 3-speed blower and LED lighting. Easy maintenance, higher efficiency, and a cleaner kitchen are ensured by Elica's Baffle Slot Filters, which capture a higher percentage of grease and hold larger volumes of grease than traditional baffle filters. Palermo is designed for both ducted and recirculating installations and top & rear ducting capability, now with a snap system that make it safer and easier to install.

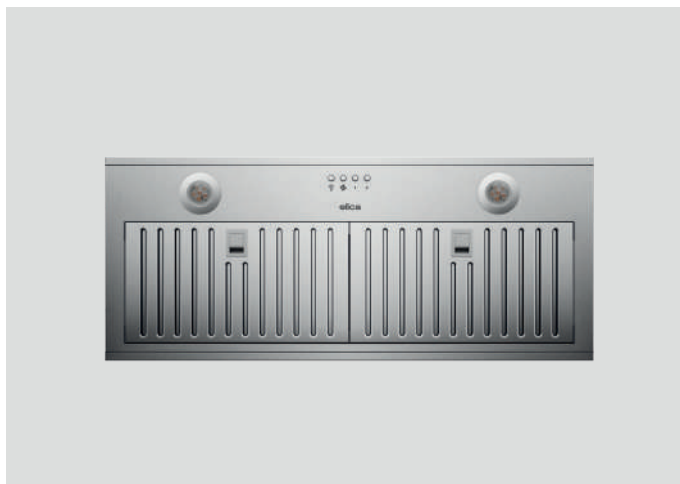

FEATURES

- Semi baffle filter
- Hush system
- Led light
- Top performance
- Super easy installation
- Top or rear outlet



GENERAL PROPERTIES

Width	28"	34"
Model	EPR628S2	EPR634S1
Dimensions	28 1/4"W x 10 3/4"D x 9 1/2"H	34 1/4"W x 10 3/4"D x 9 1/2"H
Blower Type (Internal) ¹	600 CFM (3-speed)	
Noise (Min-max sones) ¹	1.7-6.8 Sones	
Electrical	120V-60Hz, 455W	
Illumination	2 premium dimmable LED, 2.1W, 4000K	
Finish	Stainless Steel	
Controls	Stainless steel push buttons	
Grease filters	Dishwasher-Safe, stainless steel baffle slot	
Installation type	Ducted or recirculating with kit (sold separately)	
Duct transition	Round 6" with backdraft damper (top & rear)	

KITS

Recirculating Kit	KIT02770 (Contains 2 round carbon filters and cabinet grate)	
Electronic CFM Reduction Bypass	KIT0175561 (Achieves <300 CFM)	
Optional 30" hood liner	KIT02773 (29"W x 17 1/2"-20 1/2"D x 4"H)	Not applicable
Optional 36" hood liner	KIT02774 (35"W x 17 1/2"-20 1/2"D x 4"H)	Not applicable

WARRANTY:² Two (2) Years Parts & In-Home Labor. Earn an additional One (1) Year of Parts & In-Home Labor by registering on elica.com



The product images shown are for illustration purposes only and may not be an exact representation of the product.
¹ CFM and Noise data indicate the performance of the hood blower tested according to international standards. For AHAM Certified Ratings, established in accordance with California Title 24 Standardized test procedure, please refer to AHAM Certified Product Directory. Electric Ratings are declared according to UL.

² For valid warranty extension, register within 3 months from purchase. For USA & Canada Users Only.