

Spec Lot Addendum(s)

Project: Pine Valley Forevergreen - Ph 2, Model: 4202(A) - ROSEDALE, Lot: 04-001
229, Purple Creek Road, Vaughan, ONTARIO

Addendum 01/[01] | STRUCTURAL ORDER

STRUCTURAL EXTRA'S

Principal Bedroom		
Category	Attribute	Opt. Quantity
Custom Changes		1.00
Opt. Description		
Custom Option		
Notes		
CUSTOM LAYOUT ADD OPTIONAL 10' TRAY CEILING, AS PER PLAN		
Custom Changes		1.00
Opt. Description		
Custom Option		
Notes		
CUSTOM LAYOUT RELOCATE DOUBLE DOORS APPROX 30" TOWARDS FRONT OF HOUSE. SEE PLAN FOR LOCATION		
Breakfast Room		
Category	Attribute	Opt. Quantity
ELECTRICAL SWITCHES		1.00
Opt. Description		
S/I ADDITIONAL INTERIOR SWITCH. SINGLE POLE		
Notes		
FOR POTLIGHTS		
EXT, WINDOWS AND DOORS		1.00
Opt. Description		
INCREASE EXSITING REAR GARDEN DOOR OR FRENCH GARDEN DOOR HEIGHT TO APPROX. 96" - TRANSOM MAY BE REQUIRED		
Notes		
Basement (Unfinished) Area		
Category	Attribute	Opt. Quantity
BASEMENT WINDOWS		3.00
Opt. Description		
S/I BASEMENT WINDOW SIZE 30" X 24" IN LIEU OF STANDARD 10" - WHITE. WINDOW WELLS MAY BE REQUIRED.		
Notes		
CONCRETE AND DRAIN		1.00
Opt. Description		
S/I BACK -FLOW PREVENTER VALVE (BASEMENT)		
Notes		
Custom Changes		1.00
Opt. Description		
Custom Option		
Notes		
*****9' POURED BASEMENT*****		

Spec Lot Addendum(s)

Project: Pine Valley Forevergreen - Ph 2, Model: 4202(A) - ROSEDALE, Lot: 04-001
229, Purple Creek Road, Vaughan, ONTARIO

Principal Ensuite		
Category	Attribute	Opt. Quantity
FRAMING		1.00
Opt. Description		
S/I RECESSED SHOWER NICHE [SHAMPOO SHELF]. COMPLETE WITH QUARTZ ON 4 SIDES, APPROX. 12 X 18 INSTALLED VERTICALLY. BASED ON STANDARD FINISHES.		
Notes		
FIXTURES		2.00
Opt. Description		
Align 2-Handle Widespread Lav - BG		
Notes		
FIXTURES		1.00
Opt. Description		
Align 3-Function Rain Shwr/Hand Shwr/S.Bar - BG		
Notes		
FIXTURES		1.00
Opt. Description		
Align Free Standing Tub Filler - BG		
Notes		
SEE PLAN FOR LOCATION		
Exterior		
Category	Attribute	Opt. Quantity
ELECTRICAL		8.00
Opt. Description		
S/I EXTERIOR LED SOFFIT POT LIGHT - EACH		
Notes		
2 @ FRONT 2 @ LEFT SIDE 2 @ RIGHT SIDE 2 @ REAR		
ELECTRICAL		2.00
Opt. Description		
S/I EXTERIOR LED SOFFIT POT LIGHT - EACH		
Notes		
LOCATE APPROX CENTERED ABOVE GARAGE DOORS, IN LIEU OF STANDARD COACH LIGHTS. USE STANDARD SWITCH		
ELECTRICAL		1.00
Opt. Description		
Exterior Hanging Pendant Light		
Notes		
IN LIEU OF STANDARD COACH LIGHT, USE STANDARD SWITCH. SEE PLAN FOR LOCATION		
Foyer		
Category	Attribute	Opt. Quantity
ELECTRICAL SWITCHES		1.00
Opt. Description		
S/I ADDITIONAL INTERIOR SWITCH. SINGLE POLE		
Notes		
FOR SOFFIT LIGHTS		

Spec Lot Addendum(s)

Project: Pine Valley Forevergreen - Ph 2, Model: 4202(A) - ROSEDALE, Lot: 04-001
229, Purple Creek Road, Vaughan, ONTARIO

Great Room		
Category	Attribute	Opt. Quantity
ELECTRICAL OUTLETS		1,00
Opt. Description		
S/I 110V WALL RECEPTACLE ON SEPARATE CIRCUIT		
Notes		
LOCATE APPROX 66" A.F.F. ABOVE FIREPLACE, FOR FUTURE TV		
ELECTRICAL		1,00
Opt. Description		
BASE STND - 8 INCLUDED 4" WHITE E/S LED POT LIGHTS with (1) SWITCH. TO BE LOCATED ON MAIN FLOOR IN (1) ROOM ONLY.		
Notes		
IN ADDITION TO STANDARD CEILING LIGHT, SEE PLAN FOR LOCATION.		
WAFFLE CEILING		1,00
Opt. Description		
WAFFLE CEILING , BEAM DETAIL AS PER PLAN (9 BOXES) OPTION # 1 CTRB07		
Notes		
FRAMING		1,00
Opt. Description		
S/I COFFERED CEILING (OPTIONAL PER ROOM)		
Notes		
Hall Main Floor		
Category	Attribute	Opt. Quantity
ELECTRICAL		7,00
Opt. Description		
S/I 4" E/S LED INTERIOR POT LIGHT - EACH. WHITE		
Notes		
IN LIEU OF STANDARD CEILING LIGHTS, USE STANDARD SWITCHES. SEE PLAN FOR LOCATION		
Hall 2nd Level		
Category	Attribute	Opt. Quantity
ELECTRICAL		6,00
Opt. Description		
S/I 4" E/S LED INTERIOR POT LIGHT - EACH. WHITE		
Notes		
IN LIEU OF STANDARD CEILING LIGHTS, USE STANDARD SWITCHES. SEE PLAN FOR LOCATION		
Kitchen		
Category	Attribute	Opt. Quantity
ELECTRICAL OUTLETS		1,00
Opt. Description		
S/I 220V (40 AMP) RECEPTACLE ON A SEPARATE CIRCUIT		
Notes		
FOR FUTURE WALL OVENS, SEE PLAN FOR LOCATION		
ELECTRICAL OUTLETS		1,00
Opt. Description		
Capped Ceiling Outlet		
Notes		

Spec Lot Addendum(s)

Project: Pine Valley Forevergreen - Ph 2, Model: 4202(A) - ROSEDALE, Lot: 04-001
229, Purple Creek Road, Vaughan, ONTARIO

Category	Attribute	Opt. Quantity
LOCATE APPROX CENTERED ABOVE CEILING, USE SAME SWITCH AS STANDARD CEILING LIGHT. SEE PLAN FOR LOCATION		
ELECTRICAL		6,00
Opt. Description		
S/I 4" E/S LED INTERIOR POT LIGHT - EACH. WHITE		
Notes		
IN ADDITION TO STANDARD CEILING LIGHT. SEE PLAN FOR LOCATION		
ELECTRICAL		1,00
Opt. Description		
Kit/Serv Led Valance Fixture - 42" Series only		
Notes		
ELECTRICAL SWITCHES		1,00
Opt. Description		
S/I ADDITIONAL INTERIOR SWITCH. SINGLE POLE		
Notes		
FOR POTLIGHTS		
GASLINE		1,00
Opt. Description		
GAS LINE ROUGH-IN - MAIN FLOOR FOR APPLIANCE		
Notes		
FOR FUTURE COOK TOP		
ELECTRICAL OUTLETS		1,00
Opt. Description		
S/I 110V WALL RECEPTACLE (NOT ON SEPARATE CIRCUIT)		
Notes		
FOR FUTURE COOKTOP		
ELECTRICAL		1,00
Opt. Description		
RELOCATE KITCHEN APPLIANCE FROM STANDARD LOCATION - APPROX. "NEW" LOCATION AS PER ATTACHED DRAWINGS		
Notes		
SEE PLAN FOR LOCATION OF FRIDGE		
Whole House		
Category	Attribute	Opt. Quantity
INTERIOR DOORS AND TRIM		21,00
Opt. Description		
S/I 8FT HIGH DOOR THROUGHOUT SECOND FLOOR IN LIEU OF STANDARD HEIGHT DOOR. PRICE IS PER DOOR		
Notes		

Spec Lot Addendum(s)

Project: Pine Valley Forevergreen - Ph 2, Model: 4202(A) - ROSEDALE, Lot: 04-001
229, Purple Creek Road, Vaughan, ONTARIO

This is your direction to install the above extras in accordance with the following terms and conditions:

1. In the event the work on the house has progressed beyond the point where the items covered by this extra agreement cannot be installed without entailing any unusual expense, this order is to be cancelled and any deposit paid in connection with same is to be refunded to the purchaser.
2. The Vendor will undertake to incorporate the work covered by the sales extra in the construction of the house but will not be liable to the purchaser in anyway, if for any reason the work covered by the extra is not carried out. In that event, any monies paid in connection with same shall be returned to the purchaser.
3. It is understood and agreed that if for any reason whatsoever the transaction of the Purchase and Sale is not completed by the purchaser, the total cost of the extras ordered are not refundable to the Purchaser(s).
4. Extras or changes will not be processed unless signed by the Vendor.
5. These extras may not be amended without the written consent of Gold Park Homes.
6. The purchaser(s) and the builder acknowledge and agree that this "Purchaser Extra" form shall not be part of the Agreement of Purchase and Sale entered into between them, nor an addendum thereto.
7. Prices are estimates only and guaranteed for a period of 5 business days.
8. Post-dated cheques with NOT be accepted.
9. Estimates or orders will NOT be accepted once construction has commenced.
10. All extras/selections are final, checked and approved by purchaser. Purchaser has reviewed and confirmed there are no missing or outstanding items.
11. Any inquiry to re-open a file and/or request a change to any extra or selection is subject to a minimum fee of \$1500.00 (fifteen hundred dollars).
12. No estimates will be considered an official order until submitted as a signed Purchaser Extra order, accompanied by payment in full.
13. Purchaser has reviewed this addendum for accuracy. There are no outstanding items.
14. Once extras/selections are signed, they are considered final. Absolutely no changes or deletions will be accepted regardless of when selections are finalized or the stage of construction.

SCHEDULE 'F'



PV-1
SEPT 26 2022

The Rosedale 42' SERIES

→ Elevation A • 3,655 sq.ft.
Elevation B • 3,605 sq.ft.
Elevation C • 3,590 sq.ft.

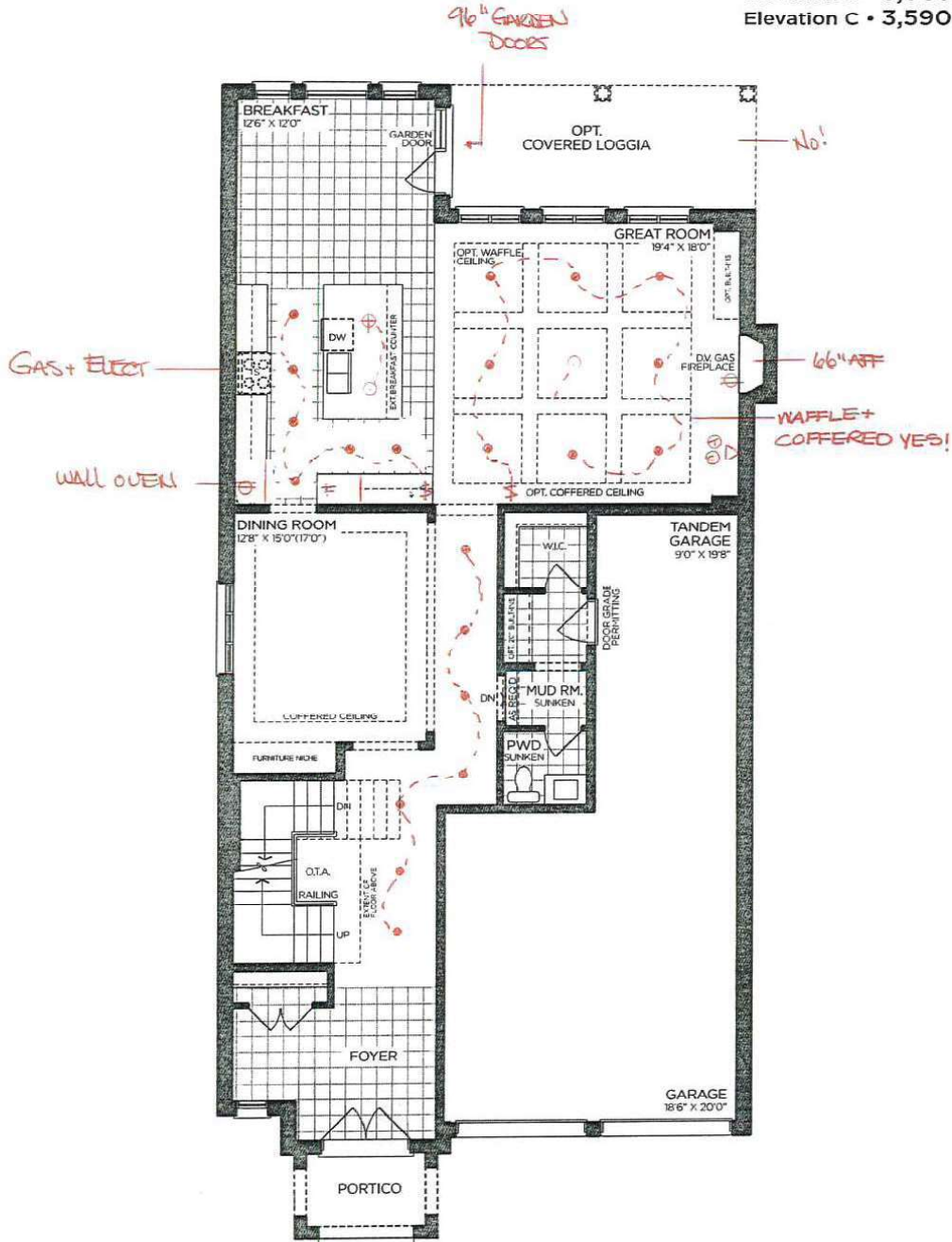

GROUND FLOOR | ELEV. A

VENDOR

PURCHASER

PURCHASER

GOLDPARK
WORTH MORE™

Prices, figures, illustrations, sizes, features and finishes are subject to change without notice. Areas and dimensions are approximate and actual usable floor space may vary from the stated area. Layout may be reverse of the unit purchased. E. & O.E. 4202

SCHEDULE 'F'



PV4-1
SEPT 26 2022

The Rosedale 42' SERIES

→ Elevation A • 3,655 sq.ft.
Elevation B • 3,605 sq.ft.
Elevation C • 3,590 sq.ft.

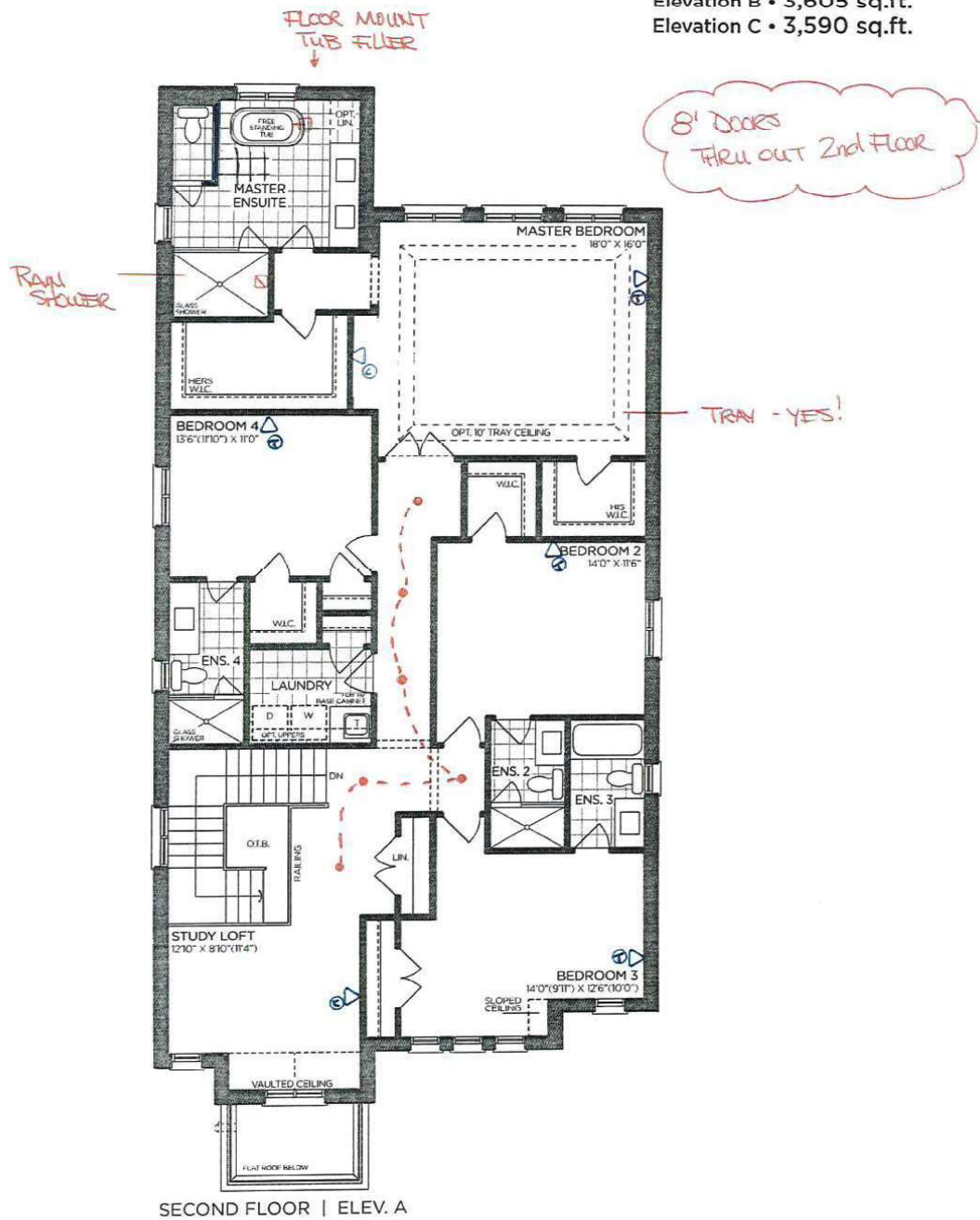

VENDOR
PURCHASER
PURCHASER

GOLDPARK
WORTH MORE™

Prices, figures, illustrations, sizes, features and finishes are subject to change without notice. Areas and dimensions are approximate and actual usable floor space may vary from the stated area. Layout may be reverse of the unit purchased. E. & O.E. 4202

SCHEDULE 'F'



PV4-1
SEPT 26 2022

The Rosedale 42' SERIES

→ Elevation A • 3,655 sq.ft.
Elevation B • 3,605 sq.ft.
Elevation C • 3,590 sq.ft.

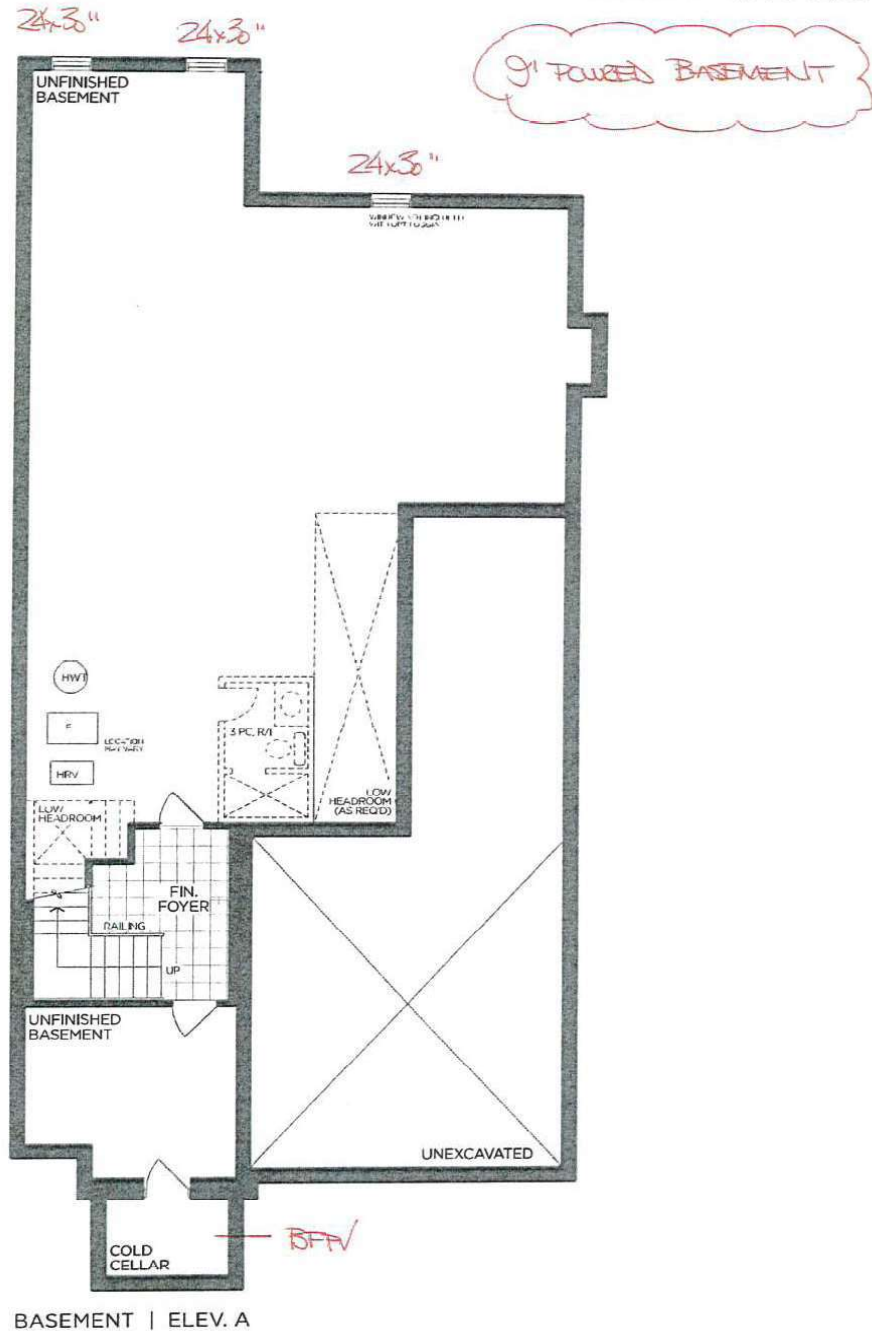

VENDOR
PURCHASER
PURCHASER

GOLDPARK
WORTH MORE™

Prices, figures, illustrations, sizes, features and finishes are subject to change without notice. Areas and dimensions are approximate and actual usable floor space may vary from the stated area. Layout may be reverse of the unit purchased, E. & O.E. 4202



PINE VALLEY

FOREVERGREEN

PLUMBING UPGRADES

ALIGN



Brushed Gold



Brushed Nickel



Chrome



Matte Black



Date: <i>October 4, 2023</i>	Lot: <i>PV4-01</i>
Location: <i>Principal Ensuite</i>	
Signature:	Signature:

Freestanding Floor-Mounted Tub Filler
Model 395/TS50100

GOLDPARK
WORTH MORE™





PINE VALLEY
FOREVERGREEN

PLUMBING UPGRADES

ALIGN

Ceiling Mount: 226651 (12" Arm)



Brushed Gold

Brushed Nickel

Chrome

Matte Black



Date: October 4, 2023	Lot: PV4-01
Location: Principal Ensuite	
Signature:	Signature:

**Shower with 3-Function Transfer Valve/Trim
and Slide Bar with Hand Shower + 7" Rain
Showerhead From Ceiling on 12" Arm**
(includes plumbing provision for ceiling mount showerhead)
Model T2192EP/UT4191/3887EP/226651/S176/U361CI/
62320/A725

GOLD PARK
WORTH MORE™



PINE VALLEY
FOREVERGREEN

PLUMBING UPGRADES

ALIGN



Brushed Gold



Brushed Nickel



Chrome



Matte Black



Date: October 4, 2023	Lot: PV4-01
Location: Principal Ensuite	
Signature:	Signature:

Two Handle 8" Widespread Lav
Model T6193/69000

GOLDPARK
WORTH MORE™



PROJECT PARTNER:

SHIP TO:

Oleg Varaavva

229 Purple Creek Road
Vaughan, ON L4L1A6
H: (416) 566-5401

REMINDER:

To ensure a smooth project it is the responsibility of the homeowner / purchaser of appliances to share all the attached specifications with their cabinet provider, contractor, or any other tradesperson so they have the information required to complete their work accurately. Product specifications are for planning purposes only and are subject to change without notice. Refer to installation instructions shipped with the product before cutting cabinets, counters, panels, etc.

Tasco Appliances assumes no liability for product specifications.

PV4-1 Nov 21, 2023

Qv.

PE

Full Spec Package

Oleg Varaavva

229 Purple Creek Road
Vaughan, ON L4L1A6
H: (416) 566-5401

Contents	Page no.
SPO30TE/S/TH Wolf Wall Oven 30" E Series Transitional Speed Oven	4-7
DW2450 Cove Dishwasher	8-11
CL4850SID/O Sub-Zero Refrigeration 48" Classic Side-by-Side Refrigerator/Freezer with Internal Dispenser - Panel Ready	12-24
DEU2450BG/L Sub-Zero Refrigeration 24" Designer Undercounter Beverage Center - Panel Ready	25-28
SRT364G Wolf Rangetop 36" Sealed Burner Rangetop - 4 Burners and Infrared Griddle	29-30
SO3050TE/S/T	31-34

Note about page numbers:

Because the original manufacturer's documents are not altered in any way, the page numbers displayed on the page may not correspond to the page number within this package.

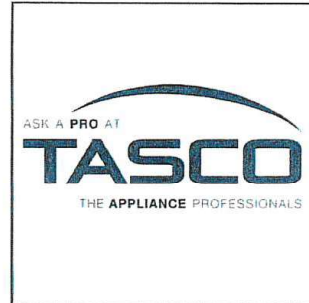

Tasco Appliances
tascoappliance.ca

Nasir Khan
Appliance professional
4167819145

Sub-Zero Doc **000044787**
Version 5.5

Sat, Jul 29, 2023
3:38 PM EDT



enterprise.steelcod.com/sp/tasc/00EAIT13

PV4-1
Nov 21, 2023

OV.

RE

All specifications are intended for initial planning purposes only. Manufacturers reserve the right to change specifications at any time without notice. Always consult the installation instructions found on the manufacturer's website or included with the appliances before installation.

Full Spec Package

Wolf Wall Oven

30" E Series Transitional Built-In Single Oven

Nov 21, 2023
PV4-1

OU. RE

Note about page numbers:

Because the original manufacturer's documents are not altered in any way, the page numbers displayed on the page may not correspond to the page number within this package.

All specifications are intended for initial planning purposes only.

Manufacturers reserve the right to change specifications at any time without notice. Always consult the installation instructions found on the manufacturer's website or included with the appliances before installation.

30" E SERIES TRANSITIONAL SPEED OVEN



SPO30TE/S/TH

FEATURES

Combines microwave, convection, and broil technologies to provide all-in-one oven versatility

Provides more cooking power than a traditional microwave with the help of convection and broil

Assures predictably delicious results with 10 microwave power levels, convenient quick-start modes, and an intuitive Gourmet mode

Fits a 9-by-13 pan in the 1.6 cubic feet, stainless-steel interior

Micro Bake and Micro Roast modes reduce or completely eliminate preheat times

Frees up counter space with efficient drop-down door design

Coordinates with other Wolf built-in ovens and appliances with various handle and trim options

Master your technique with tips and recipes from the Mastering the Speed Oven guide



PV4-1 NOV21,23
O.V. RE

DIMENSIONS

Technical drawings of the oven showing front and side views with dimensions:

- Front View Dimensions:**
 - Overall Width: 29 7/8" (759)
 - Overall Height: 177 1/8" (454)
 - Top Panel Height: 7/8" (22)
 - Bottom Panel Height: 2 1/8" (64)
 - Interior Width: 21 1/2" (546)
 - Interior Height: 17 1/2" (446)
 - Label: "BEHIND FRAME"
- Side View Dimensions:**
 - Overall Width: 21 3/16" (536)
 - Overall Height: 147 1/16" (360)
 - Label: "OPEN OVEN DOOR"

FLUSH INSTALLATION

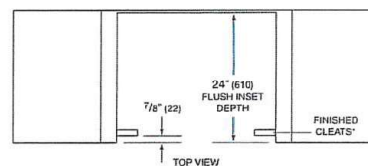

TO
18 1/8"
(460)
FLUSH INSET
HEIGHT"

SIDE VIEW

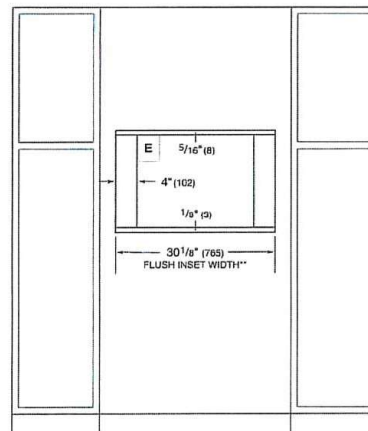

FRONT VIEW

*Will be visible and should be finished to match cabinetry.
**Dimension provides minimum reveals.

NOV 21, 2023
PV4-1
QV. RE

24" DISHWASHER - PANEL READY

COVE

DW2450

FEATURES

Adapts easily to differently shaped dishes and glasses with a height-adjustable middle rack and fold-down tines

Removes food and grease with three powerful spray arms and custom wash and dry options for different soil levels

Filters food efficiently through fine mesh for cleaner water throughout every cycle

Dries every type of dish, utensil, and pan thoroughly with a hot rinse and fan-assist

Operates in near silence that never interrupts

Matches classic Wolf and Sub-Zero stainless steel or accepts custom panels to integrate into any kitchen design

Opt for a stainless steel exterior panel for equal durability and a timeless, sophisticated look

Provides better visibility with interior LED lights

Maintains clean lines with sleek control panel and floor status light

Marvel at the durability of the stainless steel interior, built for decades of use

Monitor cycle progress, even start a new cycle, remotely. Receive alerts when rinse aid is low

Cove's leak protection system offers peace of mind in the rare event of a leak. A conductivity sensor in the base of the unit will automatically stop a cycle in progress if it detects a leak.

ACCESSORIES

Pro Handle

Tubular Handle

24" Stainless Steel Door Panels

60cm Stainless Steel Door Panels

24" Stainless Steel Kickplates

60cm Stainless Steel Kickplates

Accessories are available through an authorized dealer.
For local dealer information, visit subzero-wolf.com/locator.



HANDLE ACCESSORIES

PRO



TUBULAR



PRODUCT DETAILS

DISHWASHER

- 4 LED lights (2 sides; 2 top)
- 43 spray jets across three spray arms
- Four-stage, fine mesh filter
- Adjustable stemware rail
- Adjustable cup shelf
- Height-adjustable middle rack
- Easy-glide bottom rack
- Upper silverware rack
- One large utensil basket

PV4-1
NOV 21, 2023
DV. RE

24" DISHWASHER - PANEL READY

COVE

PRODUCT SPECIFICATIONS

Model	DW2450
Dimensions	23 5/8" W x 34 1/2" H x 23 1/4" D
Door Clearance	26 3/4"
Sound Level	41 dBA (Model and cycle/option dependent)
Electrical Supply	115 VAC, 60 Hz
Electrical Service	15 amp dedicated circuit
Receptacle	3-prong grounding-type
Cord Length	6'
Water Connection	5' braided tubing with 3/8" female compression fitting
Drain Connection	5' (1.5 m) corrugated tubing
Plumbing Pressure	30-140 psi

ELECTRICAL

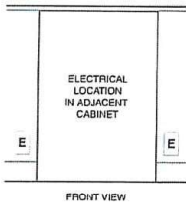

PLUMBING

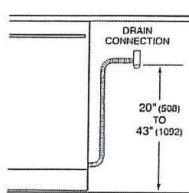

COVE OPENING WIDTH Cove dishwashers accommodate varying opening widths. A 23 5/8" (60 cm) width provides minimum reveals and is ideal for new construction. A 24" width is also common; however, reveals for a 24" opening will be larger than the reveals for a 23 5/8" opening unless the panel width is adjusted accordingly. 24" and 60 cm stainless steel panels are available and must be specified accordingly.

PANEL SPECIFICATIONS For complete panel specifications including width/height, weight requirements and thickness requirements visit subzero-wolf.com/reveal.

INTERIOR VIEW

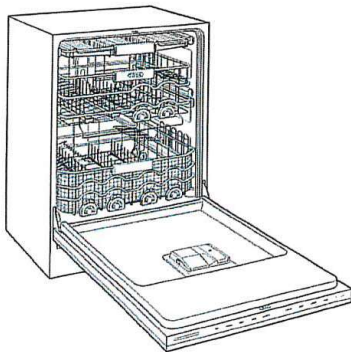

This illustration is intended for interior reference only and may not represent the exterior of the model being specified.

DIMENSIONS

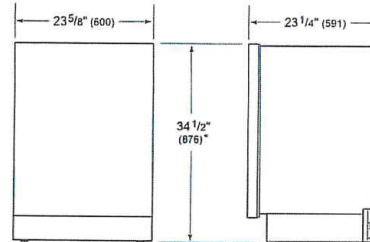

*34" (864) MIN TO 34 5/8" (880) MAX

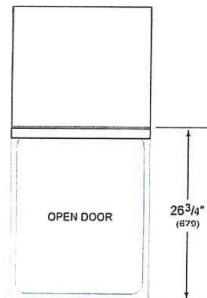

24" INSTALLATION

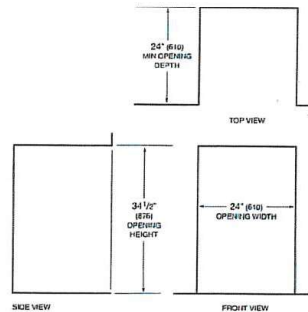

NOTE: 3/4" (19) finished returns will be visible and should be finished to match cabinetry.

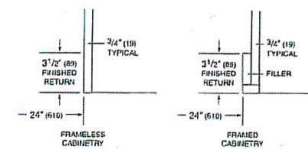

NOV 21, 2023
PV4-1
D.V. RE

Specifications are subject to change without notice. This information was generated on July 2, 2023. Verify specifications prior to finalizing your cabinetry/enclosures.

COVE DISHWASHERS

Door Panel

CUSTOM PANEL

IMPORTANT NOTE: The dishwasher opening width determines the custom panel width. The panel width should be $\frac{1}{4}$ " (6) less than the opening width to achieve minimum reveals.

The panel dimensions in the chart below are based on a $34\frac{1}{2}$ " (876) opening, with a 4" (102) toe kick and $\frac{1}{8}$ " (3) top reveal. For all other opening and toe kick heights, adjust the panel accordingly. The minimum panel height is 28" (711). The minimum toe kick height is 4" (102).

Finish all sides of the custom panel. They may be visible when the door is open.

Locate the handle near the top of the door. Handle mounting hardware must be flush with the back of the door panel.

PANEL DIMENSIONS	W	H
23 $\frac{5}{8}$ " (60 cm) Opening	23 $\frac{3}{8}$ " (594)	30 $\frac{3}{8}$ " (772)
24" (610) Opening	23 $\frac{3}{4}$ " (603)	30 $\frac{3}{8}$ " (772)

PANEL REQUIREMENTS

Max Weight (including handle)	20 lb (9 kg)*
Min Thickness	$\frac{1}{2}$ " (13)

*Less than 16 lb (7 kg) is optimal.

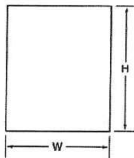

Panel dimensions

STAINLESS STEEL PANEL

Stainless steel accessory door panels are available in two widths to accommodate a 23 $\frac{5}{8}$ " (60 cm) or a 24" (610) opening. The panels are also available in two heights to accommodate a 4" (102) or 6" (152) toe kick. Refer to the chart below for panel dimensions. The panels are available through an authorized Cove dealer. For local dealer information, use the showroom, sales, and service search tool on coveappliance.com.

PANEL DIMENSIONS

4" (102) TOE KICK	W	H	D
23 $\frac{5}{8}$ " (60 cm) Opening	23 $\frac{3}{8}$ " (594)	30 $\frac{3}{8}$ " (772)	$\frac{3}{4}$ " (19)
24" (610) Opening	23 $\frac{3}{4}$ " (603)	30 $\frac{3}{8}$ " (772)	$\frac{3}{4}$ " (19)
6" (152) TOE KICK	W	H	D
23 $\frac{5}{8}$ " (60 cm) Opening	23 $\frac{3}{8}$ " (594)	28 $\frac{3}{8}$ " (721)	$\frac{3}{4}$ " (19)
24" (610) Opening	23 $\frac{3}{4}$ " (603)	28 $\frac{3}{8}$ " (721)	$\frac{3}{4}$ " (19)

STANDARD HANDLES

Optional stainless steel tubular and pro handles are available through an authorized Cove dealer. For local dealer information, use the showroom, sales, and service search tool on coveappliance.com. Refer to the chart below for standard handle lengths for the dishwasher.

HANDLE LENGTH

Tubular	21 $\frac{1}{4}$ " (540)
Pro	19 $\frac{1}{2}$ " (495)

PV4-1
NOV 21, 2023
O.V. RE

COVE DISHWASHERS

Door Panel

KICKPLATE CLEARANCE

It is possible to adhere a custom kickplate to the factory kickplate. The height and thickness can vary, provided it does not impede the door panel rotation. Refer to the illustration below.

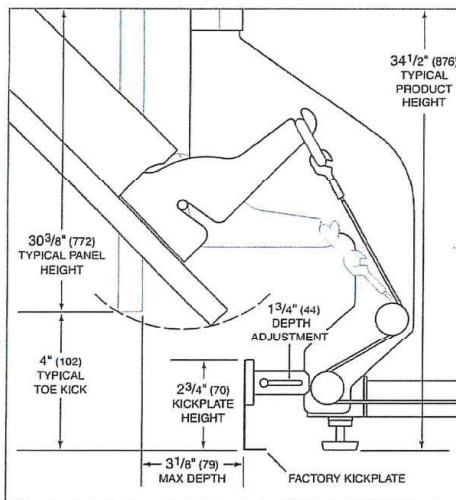

Toe kick area (side view)

KICKPLATE

The upper right corner of any kickplate exceeding 3 3/8" (80) in height must be notched to allow for airflow. Refer to the illustration below.

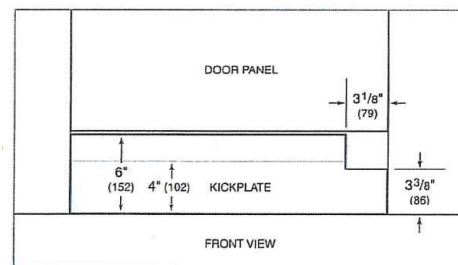

Kickplate notch

Sub-Zero, Sub-Zero & Design, Sub-Zero & Snowflake Design, Dual Refrigeration, The Living Kitchen, Great American Kitchens The Fine Art of Kitchen Design, Wolf, Wolf & Design, Wolf Gourmet, W & Design, red colored knobs, Cove, and Cove & Design are registered trademarks and service marks of Sub-Zero Group, Inc. and its subsidiaries. All other trademarks are property of their respective owners in the United States and other countries.

PV4-1 NOV 21, 2023

O.V. RE

48" CLASSIC SIDE-BY-SIDE REFRIGERATOR/FREEZER WITH INTERNAL DISPENSER - PANEL READY

SUB-ZERO

CL4850SID/O



FEATURES

Legacy product image shown; actual product varies slightly.

Split Climate™ intelligent cooling system revolutionizes Sub-Zero's already-superior preservation capabilities, keeping food even fresher for longer

ClearSight™ LED lighting system fully illuminates the interior and reduces shadows

Sleek stainless accents trim the interior, matching the sophistication of the exterior

Touch control panel is conveniently located for easy access at the tap of a finger

Night Mode optimizes the interior lighting based on the detected ambient light, reducing the brightness by 90% in dim environments

Lift the base of the flip-up dairy compartment to store taller items on the shelf below

Delivers fresh, filtered water and ice through an internal dispenser located discreetly within the refrigerator

Activate Max Ice Mode to temporarily increase ice production

Wi-Fi enabled features provide remote access from your mobile device

Sub-Zero offers an industry-leading full two-year warranty on appliances, along with a full five-year sealed system warranty and a limited twelve-year sealed system warranty

ACCESSORIES

90° Door Stop

Air Purification Cartridge

Custom Front Panel Mounting Kit

Custom Side Panel Mounting Kit

Egg Container

Grille Frame - 84"

Stainless Steel Flush Inset Grille Panel

Stainless Steel Side Panel

Water Filter

Water Filter

Stainless Steel Flush Inset Door and Drawer Panels with Pro Handle

Stainless Steel Flush Inset Door and Drawer Panels with Tubular Handle

Classic Stainless Steel Pro Louvered Grilles

Stainless Steel Pro Handles

Stainless Steel Tubular Handles

Stainless Steel Kickplate

Accessories are available through an authorized dealer.
For local dealer information, visit subzero-wolf.com/locator



HANDLE ACCESSORIES

PRO



TUBULAR



PRODUCT DETAILS

REFRIGERATOR

- 5 glass refrigerator shelves (4 adjustable; 1 stationary)
- 4 crisper drawers with removable dividers
- 5 refrigerator door bins (3 adjustable; 2 stationary)
- 1 flip-up dairy compartment
- Air purification system
- Internal ice and water dispenser
- LED refrigerator and freezer lights

FREEZER

- 3 freezer shelves (2 adjustable, 1 stationary)
- 5 adjustable door bins
- 3 storage drawers
- Fold-up shelf
- Water filtration system

PV4-1
NOV 21, 2023
D.V. RE

Specifications are subject to change without notice. This information was generated on July 2, 2023. Verify specifications prior to finalizing your cabinetry/enclosures.

48" CLASSIC SIDE-BY-SIDE REFRIGERATOR/FREEZER WITH INTERNAL DISPENSER - PANEL READY

SUB-ZERO

PRODUCT SPECIFICATIONS

Model	CL4850SID/O
Dimensions	48"W x 84"H x 24"D
Refrigerator Capacity	18.3 cu. ft.
Freezer Capacity	10.5 cu. ft.
Weight	705 lbs
Electrical Supply	115 VAC, 60 Hz
Electrical Service	15 amp dedicated circuit
Plumbing Supply	1/4" OD copper, braided stainless steel or PEX tubing
Plumbing Pressure	35-120 psi
Receptacle	3-prong grounding-type

ELECTRICAL

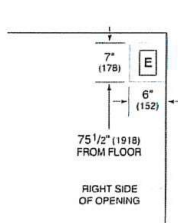

PLUMBING

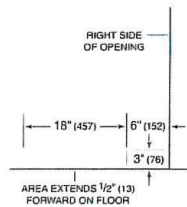

PANEL SPECIFICATIONS For complete panels specifications including width/height, weight requirements, thickness requirements and offset details visit subzero-wolf.com/builtinconfigurator.

NOTE: Dimensions in parenthesis are in millimeters unless otherwise specified

INTERIOR VIEW

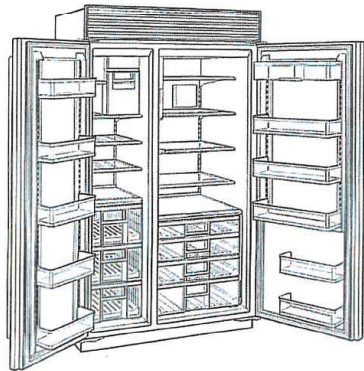

This illustration is intended for interior reference only and may not represent the exterior of the model being specified.

DIMENSIONS

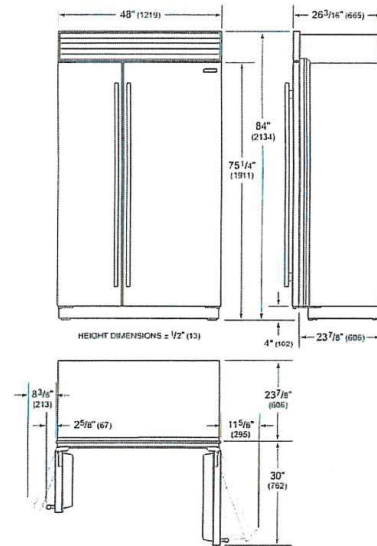

FLUSH INSET INSTALLATION

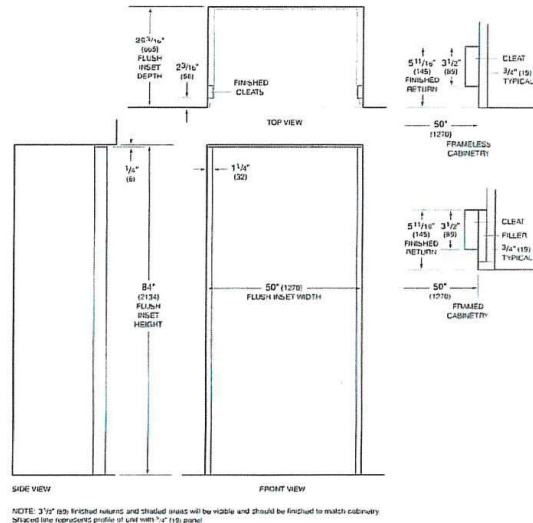

NOTE: 3/16" gap finished returns and shaded areas will be visible and should be finished to match cabinetry. Shaded line represents profile of Unit with 3/4" (19) panel.

** KICK PLATE **









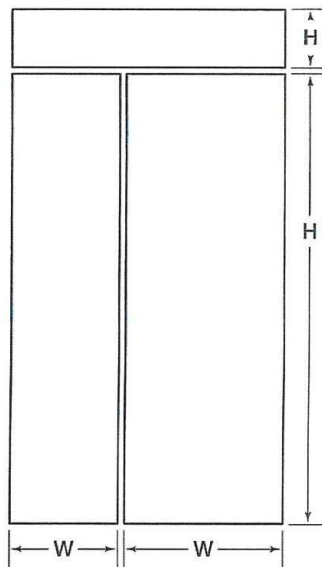



PV4-1
NOV 21, 2023

D.V. RE

Specifications are subject to change without notice. This information was generated on July 2, 2023. Verify specifications prior to finalizing your cabinetry/enclosures

Single Model: CL4850SID/O



PANEL	FRONT	SPACER	BACKER	MAX WEIGHT
Refrigerator	29 $\frac{7}{8}$ "  71 $\frac{1}{4}$ " 	27 $\frac{7}{8}$ "  70 $\frac{1}{16}$ " 	28 $\frac{1}{2}$ "  71 $\frac{1}{16}$ " 	50 lbs
Freezer	19 $\frac{1}{2}$ "  71 $\frac{1}{4}$ " 	18 $\frac{1}{8}$ "  70 $\frac{1}{16}$ " 	18 $\frac{3}{4}$ "  71 $\frac{1}{16}$ " 	50 lbs
Grille	49"  7 $\frac{3}{4}$ " 	47 $\frac{1}{8}$ "  6 $\frac{13}{16}$ " 	47 $\frac{3}{4}$ "  7 $\frac{7}{16}$ " 	13 lbs

PV4-1
NOV 21, 2023
D.V. RE

Panel Planning Notes

Single Model: CL4850SID/O

The flush inset application is an overlay model with flush inset panels. It is not a separate model.

The flush inset design allows custom panels to be installed flush with adjacent cabinets. Similar to overlay, flush inset panels are typically created by combining a 3/4" (19) custom panel, a .10" (3) spacer panel and a 1/4" (6) backer panel.

For flush inset panels thicker than 3/4" (19), a 90° door stop may be required to prevent interference with adjacent cabinets.

Minimum Panel Thickness

3/4"

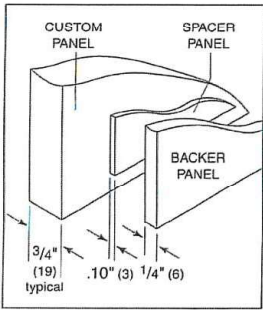

Panel assembly (rear view).

Standard Handle Lengths (Optional)

HANDLE

TUBULAR

PRO

CL4850SID/O Door

60 3/4"

59 11/16"

PV4-1
NOV 21, 2023
D.V. RE

Panel Offsets

Single Model: CL4850SID/O

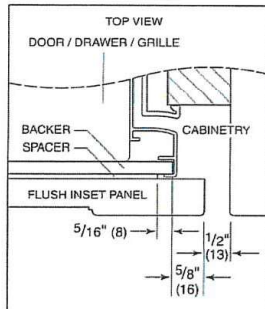

Door (hinge) / Drawer / Grille Sides

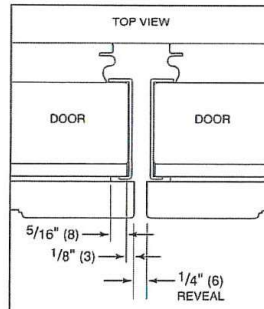

Doors (handle) Sides

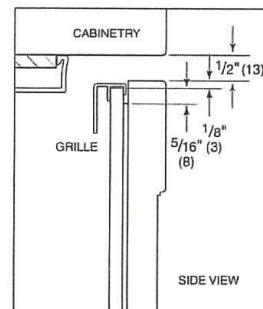

Grille Top

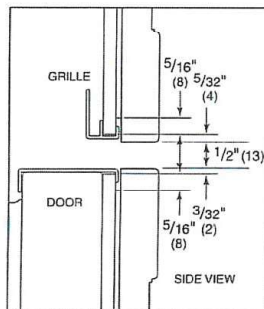

Grille Bottom / Door Top

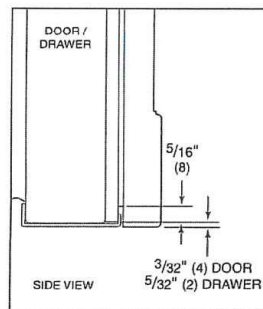

Door/Drawer Bottom

PV4-1
NOV 21, 20 23
O.V. RE

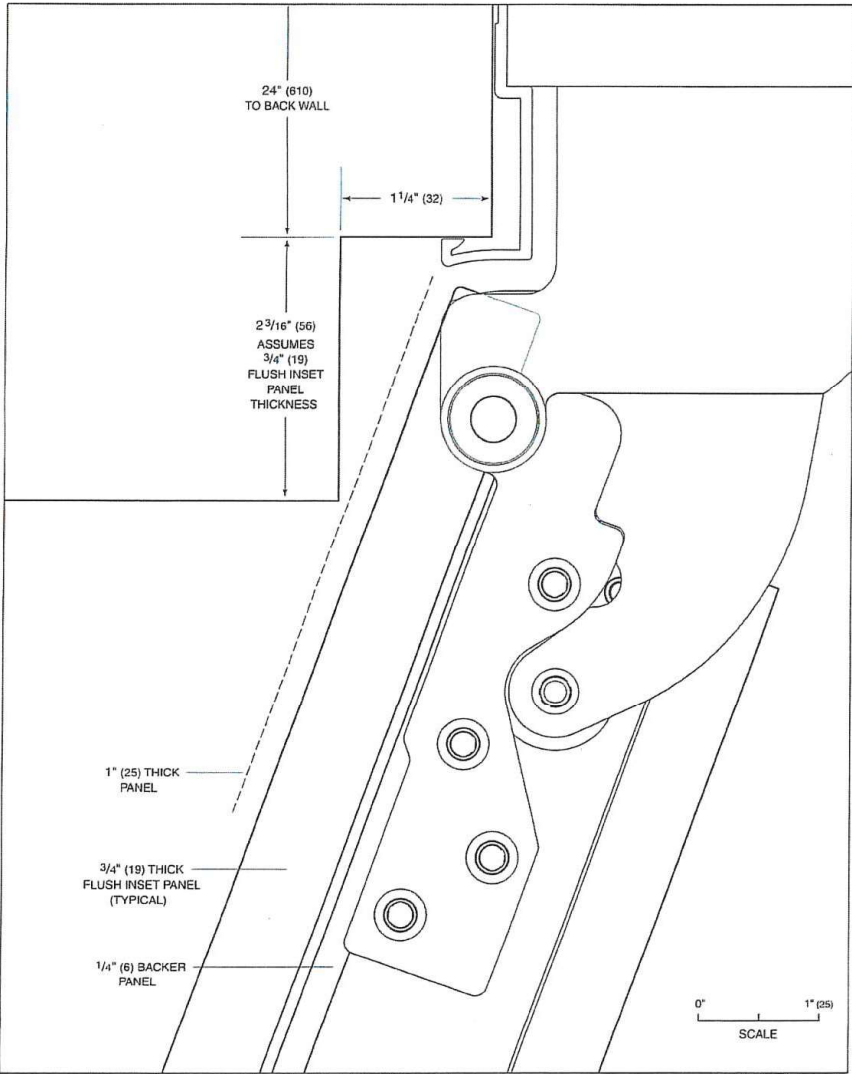

Flush inset application—110° door opening (top view).

PV4-1
 NOV 21, 2023 O.V. RE

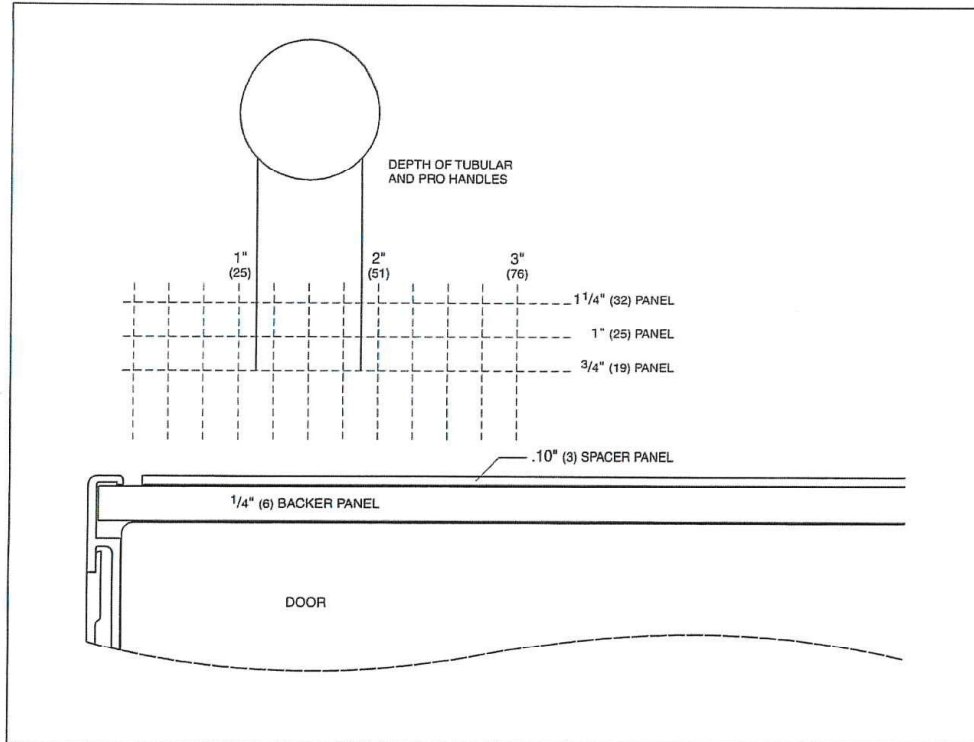

Overlay and flush inset panel thickness.

PV4-1
NOV 21, 2023
O.V. PE

24" DESIGNER UNDERCOUNTER BEVERAGE CENTER - PANEL READY

SUB-ZERO

DEU2450BG



FEATURES

Fully customizable exterior, accepting custom panels for an integrated look within cabinetry or stainless steel accessory panels and handles to coordinate with other Sub-Zero, Wolf, and Cove appliances

Seamlessly integrating anywhere, an undercounter beverage center adds comfort to your master suite, creates a corner for libations in the study—the options are endless

Patented, full-extension upright beverage shelf features adjustable gates that anchor contents upright and in place and fold down flat to make room for bulky items

Full-extension, multipurpose shelf offers ample storage space for bottles, soft drinks, and food

Intuitive, on-door touch control panel offers ergonomic, convenient access to settings

Cleanup is simple with nano-coated, spill-proof shelves

UV-resistant glass door protects food and beverages from harmful light that hastens spoilage

Magnetic door seals lock in cold air to ensure freshness and provide superior energy efficiency

Offers precise temperature control within one degree of setpoint, preserving wine, craft beer, dairy, produce, and other perishables at their optimal temperature

Soft-on LED lighting fully illuminates the interior when the door is open and can be adjusted to four unique stand-by accent lighting settings

Wi-Fi enabled features allow for remote temperature control, provide important door-ajar notifications, and assist with remote service diagnostics—all from your mobile device

ACCESSORIES

Custom Panel Lock Kit

Dual Install Kit - Handle-to-Drawer

Dual Install Kit - Handle-to-Handle

Pro Handle

Tubular Handle

Stainless Steel Glass Door Panels

Undercounter Solid Overlay Door

Stainless Steel Dual Kickplates

Accessories are available through an authorized dealer.
For local dealer information, visit subzero-wolf.com/locator

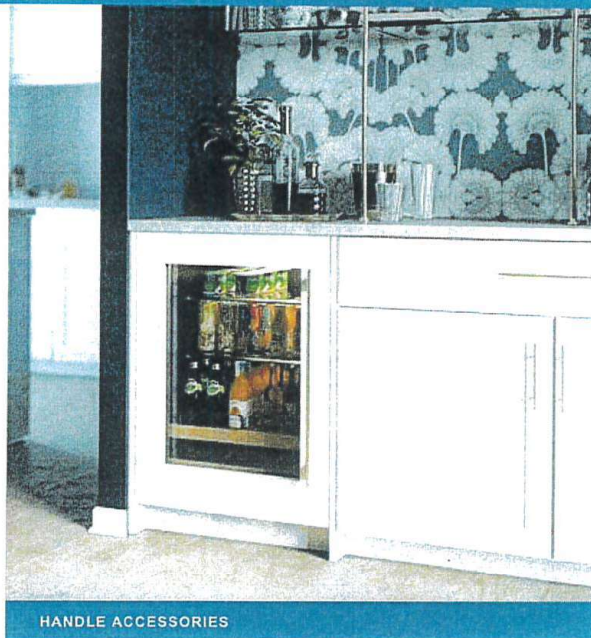

HANDLE ACCESSORIES

PRO



TUBULAR



PRODUCT DETAILS

REFRIGERATOR

- 1 full-extension upright beverage shelf
- 1 full-extension multipurpose shelf
- 2 adjustable glass shelves

Flush Installation.

PV4-1
NOV 21, 2023

OV. RE

24" DESIGNER UNDERCOUNTER BEVERAGE CENTER - PANEL READY

SUB-ZERO

PRODUCT SPECIFICATIONS

Model	DEU2450BG
Dimensions	24"W x 34 1/2"H x 23 1/8"D
Refrigerator Capacity	5.5 cu. ft.
Weight	146 lbs
Electrical Supply	115 VAC, 60 Hz
Electrical Service	15 amp dedicated circuit
Wine Storage Capacity	8 Bottles
Receptacle	3-prong grounding-type

ELECTRICAL

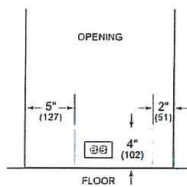

NOTE: The electrical outlet must be positioned with the grounding prong to the right of the thinner blades.

PANEL SPECIFICATIONS For complete panels specifications including width/height, weight requirements and thickness requirements visit subzero-wolf.com/reveal.

NOTE: Dimensions in parenthesis are in millimeters unless otherwise specified

INTERIOR VIEW

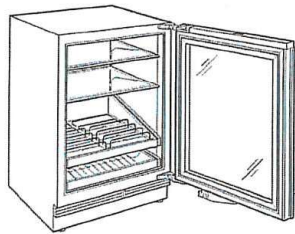

This illustration is intended for interior reference only and may not represent the exterior of the model being specified.

DIMENSIONS

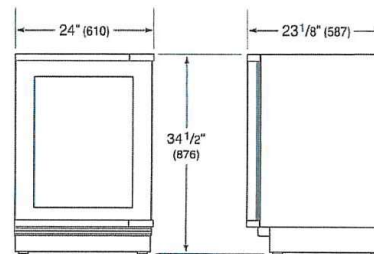

HEIGHT DIMENSIONS $\pm 1/2"$ (13)

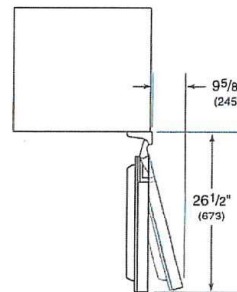

STANDARD INSTALLATION

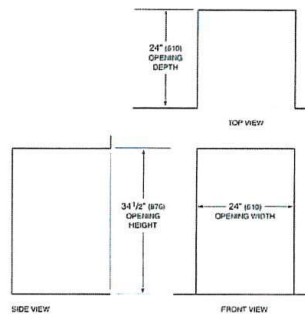

NOTE: 3/16" gap finished returns will be visible and should be finished to match cabinetry.

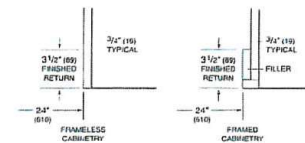

* KICK PLATE *

PV4-1
Nov 21, 2023
C.V. RE

Panel Specifications

Single Model: DEU2450BG

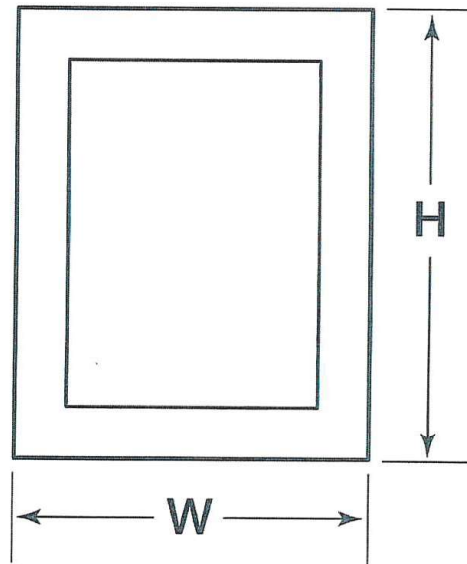

PANEL	WIDTH	HEIGHT	MIN THICKNESS	MAX WEIGHT
Door	23 3/4"	30 3/8"	5/8"	22 lbs
Top Rail	--	3 1/2"	3/8"	--
Bottom Rail	--	4 1/2"	3/8"	--
Stiles	3 1/4"	--	3/8"	--

PLEASE NOTE: Panel specs change slightly when units are combined. Visit

<http://www.subzero-wolf.com/traderesources/reveal> for exact dimensions.

Nov 21, 2023

PV4-1

CV.

RE



Panel Planning Notes

Single Model: DEU2450BG

The thickness of the custom panel can vary. A 5/8" (16) minimum to 3/4" (19) maximum thick panel is required.

The depth of each designer model is 23 1/8" (587). Allow for panel thickness when planning the finished opening depth.

Finish all sides of custom panels. They will be visible when the door is open.

Stainless steel tubular and pro handles are available through an authorized Sub-Zero dealer.

Finish all sides of the custom panels. They may be visible when the door is open or through the glass.

Do not install a solid panel on a glass door unit. A solid door is available as a sales accessory and must be installed if a solid panel is being specified. Service may be required to install the door.

Minimum Panel Thickness

5/8"

Standard Handle Lengths (Optional)

HANDLE

TUBULAR

PRO

DEU2450BG Door

24 3/16"

22 1/2"

Toe Kick Clearance

The height of the toe kick area can extend beyond the typical toe kick height, provided it does not exceed the dimensions in the illustration below.

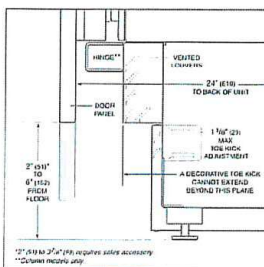

Toe Kick (side view).

PV4-1
NOV 21, 2023

O.V.

RE



36" SEALED BURNER RANGETOP - 4 BURNERS AND INFRARED GRIDDLE

WOLF

SRT364G



FEATURES

- Maintain control with four dual-stacked burners that go from 20,000 Btu down to a mere breath of flame
- Simmer and melt sauces, soups, and marinades easily with the lower tier of the dual-stacked burner
- Match other Sub-Zero, Wolf, and Cove products with heavy-gauge stainless steel and signature red infinite control knobs
- Sear in seconds with the additional 15,000 Btu infrared griddle
- Cleanup is a snap as sealed, seamless burner pans contain splashes and spills
- Move pots and pans effortlessly across the continuous cast-iron grates
- Reignites flame automatically with spark ignition system

ACCESSORIES

- 11" Cutting Board
- 2-Burner Wok Grate
- 36" Brass Bezels
- 36" Chrome Bezels
- 36" Stainless Bezels
- Filler Trim
- Griddle Cleaning Kit
- Griddle Cleaning Pads
- Griddle Cleaning Solution
- Sealed Burner Rangetop with Wok Black Knobs
- Sealed Burner Rangetop with Wok Red Knobs
- Sealed Burner Rangetop with Wok Stainless Knobs
- High altitude conversion kits available
- 5" and 10" stainless steel risers, and 20" riser with shelf

Accessories available through an authorized dealer.
For local dealer information, visit subzero-wolf.com/locator.



KNOB OPTIONS



TOP CONFIGURATION

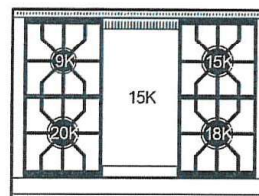

RANGETOP SPECIFICATIONS

- Stainless-steel island trim (included)
- Stainless-steel bezels
- 1 - 9,200 Btu burner
- 1 - 15,000 Btu burner
- 1 - 18,000 Btu burner
- 1 - 20,000 Btu burner
- 1 - Infrared 15,000 Btu griddle

PV4-1
NOV 21, 2023
OJ. RE

36" SEALED BURNER RANGETOP - 4 BURNERS AND INFRARED GRIDDLE



PRODUCT SPECIFICATIONS

Model	SRT364G
Dimensions	35 7/8"W x 8 1/2"H x 28 1/2"D
Electrical Supply	120 VAC, 60 Hz
Electrical Service	15 amp dedicated circuit
Gas Supply	3/4" ID line
Gas Inlet	1/2" NPT female
Receptacle	3-prong grounding-type

ELECTRICAL

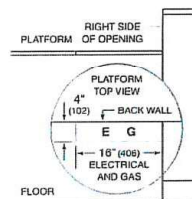

GAS

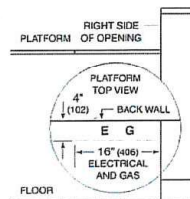

NOTE: Dimensions in parenthesis are in millimeters unless otherwise specified

DIMENSIONS

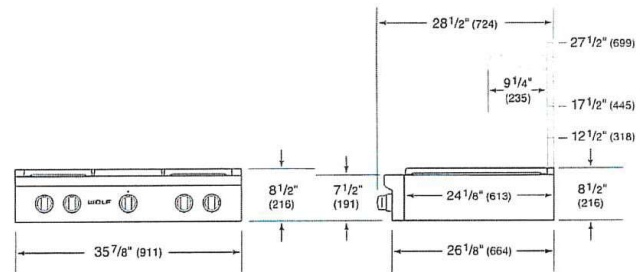

STANDARD INSTALLATION

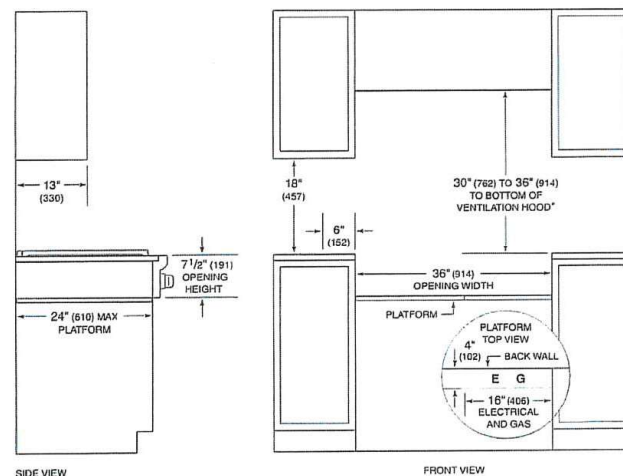

SIDE VIEW

FRONT VIEW

*Without ventilation hood, 36" (914) minimum clearance countertop to combustible materials, 44" (1118) for charbroiler.

NOTE: Shaded area above countertop indicates minimum clearance to combustible surfaces, combustible materials cannot be located within this area.

Electrical and gas supply located through bottom of platform.

For island installation, 12" (305) minimum clearance back of range to combustible rear wall above countertop.

PV4-1
NOV 21, 2023
D.V. RE

30" E SERIES TRANSITIONAL BUILT-IN SINGLE OVEN



SO3050TE/S/T



FEATURES

Wolf's dual convection system provides reliably even heat, reduces hot and cold spots, and enables consistent multi-rack cooking

Take the guesswork out of cooking with 10 chef-created cooking modes, including Bake, Broil, Convection, Convection Roast, Dehydrate, Gourmet, Proof, Roast, Stone, and Warm

Gourmet Mode offers nearly 50 presets to automatically cook a delicious set of impressive dishes

The large full-color touch screen and stainless touch controls are intuitive and easy-to-read

The temperature probe alerts you when your dish has reached the desired temperature

The oven offers self-clean, delayed start, timed cook, and Sabbath features

The Wi-Fi enabled feature lets you remotely preheat, select modes, and adjust oven temperature from your mobile device

Coordinates with other Sub-Zero, Wolf, and Cove appliances to create a cohesive look in your kitchen

Get the most out of your oven with tips and recipes from the Mastering the E Series Oven guide



ACCESSORIES

30" Broiler Pan

30" Premier Baking Sheet

30" Standard Oven Rack

Bake Stone Kit

Dehydration Kit

Dual Installation Kit

Full-Extension Ball-Bearing Rack

Standard Oven Rack

Temperature Probe

Accessories available through an authorized dealer.
For local dealer information, visit subzero-wolf.com/locator.

Nov 21, 2023
PV4-1
DN RE

Specifications are subject to change without notice. This information was generated on July 2, 2023. Verify specifications prior to finalizing your cabinetry/enclosures.

30" E SERIES TRANSITIONAL BUILT-IN SINGLE OVEN



PRODUCT SPECIFICATIONS

Model	SO3050TE/S/T
Dimensions	29 7/8"W x 28 1/2"H x 23"D
Oven 1 Interior Dimensions	25 1/4"W x 17 1/2"H x 18 1/2"D
Overall Capacity	4.7 cu. ft.
Usable Capacity	3.1 cu. ft.
Door Clearance	21 3/8"
Weight	257 lbs
Electrical Supply	240/208 VAC, 60 Hz
Electrical Service	30 amp dedicated circuit
Conduit Length	4 Feet

DIMENSIONS

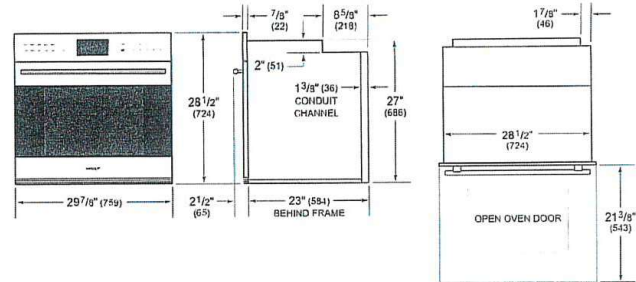

ELECTRICAL

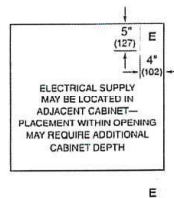

NOTE: Dimensions in parenthesis are in millimeters unless otherwise specified

FLUSH INSTALLATION

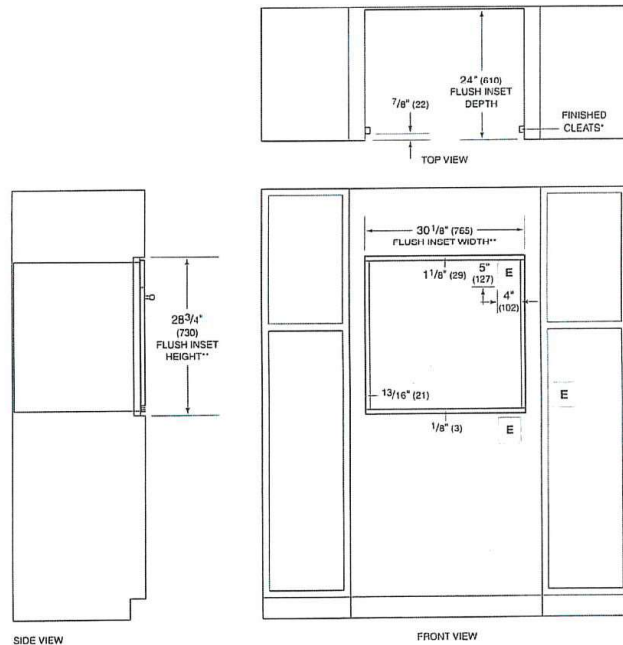

SIDE VIEW

FRONT VIEW

*Shaded areas will be visible and should be finished to match cabinetry.

**Dimension provides minimum reveals.

NOTE: Location of electrical supply within opening may require additional cabinet depth.

PV4-1
Nov 21, 2023
D.U. RE

NA-1
NOV 21, 2023

52" PRO HOOD LINER - 22" DEPTH



PL522212

FEATURES

Rigorously tested for decades of use
Exceptional support from our Customer Care team in Madison
Heavy-duty stainless steel construction
Blower required (internal, in-line or remote blowers available)
Bright LED Lighting
Heat sentry for safety
Recessed controls for sleeker look
Transition with backdraft minimizes backward flow of cold air
Infinite speed blower control

ACCESSORIES

1100 CFM Inline Blower
1200 CFM Internal Blower
1500 CFM Remote Blower
300 CFM Internal Blower
400 CFM Internal Blower
600 CFM Inline Blower
600 CFM Internal Blower
600 CFM Remote Blower
800 CFM Internal Blower
820071-Make-Up Air Damper
900 CFM Remote Blower

Accessories available through an authorized dealer.
For local dealer information, visit subzero-wolf.com/locator.

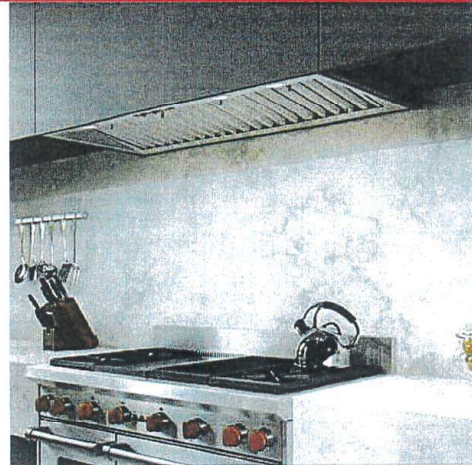

BLOWER OPTIONS

- 300 CFM Internal
- 400 CFM Internal
- 600 CFM Internal
- 800 CFM Internal
- 1200 CFM Internal
- 600 CFM Inline
- 1100 CFM Inline
- 600 CFM Remote
- 900 CFM Remote
- 1200 CFM Remote
- 1500 CFM Remote

Specifications are subject to change without notice. This information was generated on October 26, 2023. Verify specifications prior to finalizing your cabinetry/enclosures.

Q.V. RE

PV4-1
NOV 21, 2023

52" PRO HOOD LINER - 22" DEPTH



PRODUCT SPECIFICATIONS

Model

PL522212

Dimensions

52 3/8"W x 12"H x 22 5/8"D

Weight

60 lbs

Electrical Supply

110/120 VAC, 60 Hz

Electrical Service

15 amp dedicated circuit

Discharge Location

Vertical

Discharge Dimensions

10" Round

Bottom of Hood to Countertop

30" to 36"

ELECTRICAL

DECORATIVE HOOD

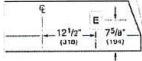

48g to 8" duct.

DIMENSIONS

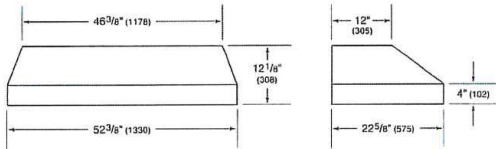

NOTE: Dimensions in parenthesis are in millimeters unless otherwise specified

Specifications are subject to change without notice. This information was generated on October 26, 2023. Verify specifications prior to finalizing your cabinetry enclosures.

PV.

RE