



CONSTRUCTION SUMMARY

Lot: 88
Model: 40.06 A LILAC
Project/Phase: Pine Valley Forevergreen / 1

CENTRAL VAC AND WIRING

Invoice	Qty.	Description
1974 72,189 04Nov19	1	CONDUIT PIPE TO BE RUN IN A STRAIGHT LINE FROM ATTIC TO ELECTRICAL PANEL AS CLOSE TO CENTER OF ATTIC AS POSSIBLE

CERAMIC

Invoice	Qty.	Description
2178 37 08Jun22	1	FOYER: TILE, FLOOR , LEVEL 5 - 12X24" LAID IN STRAIGHT, STACKED PATTERN. SEE PLAN FOR TILE DIRECTION.
2178 19 08Jun22	1	FRONT FOYER: TILE GROUT UPGRADE, FLOOR
2178 37 08Jun22	1	MUD ROOM: TILE, FLOOR , LEVEL 5 - 12X24" LAID IN STRAIGHT, STACKED PATTERN. SEE PLAN FOR TILE DIRECTION
2178 19 08Jun22	1	MUD ROOM: TILE GROUT UPGRADE, FLOOR
2178 37 08Jun22	1	BASEMENT FOYER: TILE, FLOOR , LEVEL 3 - 12X24" LAID IN STRAIGHT, STACKED PATTERN. SEE PLAN FOR TILE DIRECTION
2178 19 08Jun22	1	BASEMENT FOYER: TILE GROUT UPGRADE, FLOOR
2178 37 08Jun22	1	POWDER ROOM: TILE, FLOOR , LEVEL 5 - 12X24" LAID IN STRAIGHT, STACKED PATTERN. SEE PLAN FOR TILE DIRECTION
2178 19 08Jun22	1	POWDER ROOM: TILE GROUT UPGRADE, FLOOR
2178 35 08Jun22	1	LAUNDRY FLOOR: TILE, FLOOR , LEVEL 5 - 12X24" LAID IN STRAIGHT, STACKED PATTERN. SEE PLAN FOR TILE DIRECTION
2178 37 08Jun22	1	MASTER ENSUITE: TILE, FLOOR , LEVEL 5 - 12X24" LAID IN STRAIGHT, STACKED PATTERN. SEE PLAN FOR TILE DIRECTION
2178 51 08Jun22	1	MASTER ENSUITE: TILE, WALL, LEVEL 5 - 12X24" LAID IN HORIZONTAL, STACKED PATTERN.



CONSTRUCTION SUMMARY

Lot: 88
Model: 40.06 A LILAC
Project/Phase: Pine Valley Forevergreen / 1

CERAMIC

Invoice	Qty.	Description
2178 44 08Jun22	1	SHARED ENSUITE 3/4: TILE, SHOWER FLOOR, LEVEL 3 - PENNY ROUND
2178 34 08Jun22	1	ENSUITE 2: TILE, FLOOR , LEVEL 3 - 12X24" LAID IN STRAIGHT, STACKED PATTERN. SEE PLAN FOR TILE DIRECTION
2178 46 08Jun22	1	SHARED ENSUITE 3/4: TILE, WALL, LEVEL 2 - 2X16" CDC LAID IN VERTICAL STACKED PATTERN
2178 21 08Jun22	1	ENSUITE 2: TILE GROUT UPGRADE, WALL, UPG GROUT
2178 19 08Jun22	1	ENSUITE 2: TILE GROUT UPGRADE, FLOOR , UPG GROUT
2178 20 08Jun22	1	SHARED ENSUITE 3/4: TILE GROUT UPGRADE, SHOWER FLOOR, UPG GROUT
2178 35 08Jun22	1	ENSUITE 2: TILE, WALL, LEVEL 1 - 3X6" LAID IN HORIZONTAL, STACKED PATTERN.
2178 46 08Jun22	1	SHARED ENSUITE 3/4: TILE, FLOOR LEVEL 3 - 12X24" LAID STRAIGHT, STACKED, SEE PLAN FOR DIRECTION
2178 19 08Jun22	1	SHARED ENSUITE 3/4: TILE GROUT UPGRADE, FLOOR , UPG GROUT
2178 20 08Jun22	1	SHARED ENSUITE 3/4: TILE GROUT UPGRADE, SHOWER FLOOR, UPG GROUT
2178 21 08Jun22	1	SHARED ENSUITE 3/4: TILE GROUT UPGRADE, WALL, UPG GROUT
2178 08Jun22 NoCat	1	KITCHEN/BREAKFAST: VINTAGE SERIES, 5" WHITE OAK, NSS ENGINEERED HARDWOOD, 3/4" THK, WIREBRUSH TEXTURE, UV OIL FINISH - CORNER - LEVEL 3 CREDIT - DO NOT SUPPLY / INSTALL CERAMIC IN KITCHEN/BREAKFAST



CONSTRUCTION SUMMARY

Lot: 88
Model: 40.06 A LILAC
Project/Phase: Pine Valley Forevergreen / 1

CROWN MOULDING

Invoice	Qty.	Description
1974 72,182 04Nov19	1	GREAT ROOM: UPGRADE TO COFERRED CEILING - GREAT ROOM
1974 04Nov19 NoCat	1	GREAT ROOM: UPGRADE TO 9 BOX WAFFLE CEILING CTR-B07
1974 72,181 04Nov19	1	LIBRARY: UPGRADE TO COFERRED CEILING
1974 04Nov19 NoCat	1	LIBRARY: UPGRADE TO WAFFLE CEILING - 4 SQUARES
2178 08Jun22 NoCat	1	GREAT ROOM: UPGRADE MANTLE TO 'CAPRI'

DRYWALL

Invoice	Qty.	Description
1974 72,149 04Nov19	1	UPGRADE TO SMOOTH CEILINGS - THROUGHOUT SECOND FLOOR



CONSTRUCTION SUMMARY

Lot: 88
Model: 40.06 A LILAC
Project/Phase: Pine Valley Forevergreen / 1

ELECTRICAL

Invoice	Qty.	Description
1974 72,158 04Nov19	8	GREAT ROOM: ADD INTERIOR POT LIGHT - GROUND FLOOR
1974 72,151 04Nov19	1	GREAT ROOM: ADD A SEPARATE SWITCH - FOR LIGHTING PURPOSES FOR POTLIGHTS
1974 72,158 04Nov19	4	LIBRARY: ADD INTERIOR POT LIGHT - GROUND FLOOR
1974 72,151 04Nov19	1	LIBRARY: ADD A SEPARATE SWITCH - FOR LIGHTING PURPOSES FOR POTLIGHTS
1974 72,161 04Nov19	1	KITCHEN: RELOCATE ONLY - STANDARD CEILING LIGHT - RELOCATE TO ABOVE ISLAND, SEE PLAN FOR LOCATION
1974 04Nov19 NoCat	1	KITCHEN: ADD CAPPED CEILING ROUGH-IN FOR FUTURE INTERIOR LIGHT, FIXTURE NOT INCLUDED. LOCATE ABOVE ISLAND, USE SAME SWITCH AS STANDARD CEILING LIGHT
1974 72,157 04Nov19	1	KITCHEN: ADD FULL ELECTRICAL VALANCE LIGHTING UNDER UPPER CABINETS IN KITCHEN ON A SEPARATE SWITCH - REQUIRES PURCHASE OF VALANCE CABINETRY
1974 72,184 04Nov19	1	KITCHEN: ADD A 240V RECEPTICE ON A SEPARATE SWITCH - FOR FUTURE 'COMBO' WALL OVEN/MICROWAVE - WALL OVEN NOT INCLUDED - DOES NOT INCLUDE BREAKER THAT IS TO BE INSTALLED BY LICENSED ELECTRICIAN AND ARRANGED BY HOMEOWNER AFTER CLOSING SEE PLAN FOR LOCATION
1974 72,158 04Nov19	7	KITCHEN: ADD INTERIOR POT LIGHT - GROUND FLOOR
1974 72,151 04Nov19	1	KITCHEN: ADD A SEPARATE SWITCH - FOR LIGHTING PURPOSES FOR POTLIGHTS
1974 72,159 04Nov19	4	DRESSING ROOM: ADD INTERIOR POT LIGHT - SECOND FLOOR
1974 72,151 04Nov19	1	DRESSING ROOM: ADD A SEPARATE SWITCH - FOR LIGHTING PURPOSES FOR POTLIGHTS
1974 72,153 04Nov19	1	MASTER ENSUITE: ADD CAPPED CEILING ROUGH-IN (ON SEPARATE SWITCH) FOR FUTURE INTERIOR LIGHT FIXTURE - FIXTURE NOT INCLUDED LOCATE ABOVE TUB



CONSTRUCTION SUMMARY

Lot: 88
Model: 40.06 A LILAC
Project/Phase: Pine Valley Forevergreen / 1

ELECTRICAL

Invoice	Qty.	Description
1974 72,159 04Nov19	4	MASTER BEDROOM: ADD INTERIOR POT LIGHT - SECOND FLOOR
1974 72,151 04Nov19	1	MASTER BEDROOM: ADD A SEPARATE SWITCH - FOR LIGHTING PURPOSES FOR POTLIGHTS
1974 72,156 04Nov19	1	FRONT ELEVATION & GARAGE ELEVATION: ADD EXTERIOR POT LIGHTS 4 AT FRONT ELEVATION 4 AT GARAGE SIDE ELEVATION
1974 72,151 04Nov19	1	FOYER: ADD A SEPARATE SWITCH - FOR LIGHTING PURPOSES FOR EXTERIOR SOFFIT LIGHTS
1974 04Nov19 NoCat	1	FRONT ELEVATION: IN ADDITION TO STANDARD HOLIDAY LIGHT, ADD ANOTHER FOR A TOTAL OF 2: **1 AT GARAGE SOFFIT + 1 AT PORCH SOFFIT** both on same switch, switch located in foyer closet
2178 08Jun22 NoCat	2	DECORA TIMER SWITCH FOR EXTERIOR SOFFIT LIGHTS
2178 08Jun22 NoCat	1	Info only - KITCHEN: FULL HEIGHT SLAB BACKSPLASH - LEVEL 6 QUARTZ
2178 08Jun22 NoCat	1	Information only - GREAT ROOM: UPGRADE MANTLE TO 'CAPRI'

EXTERIOR COLOURS

Invoice	Qty.	Description
1955 27,676 09Jan19	1	EXTERIOR COLOUR PACKAGE BR.1

FIREPLACE

Invoice	Qty.	Description
2178 08Jun22 NoCat	1	GREAT ROOM: UPGRADE MANTLE TO 'CAPRI'

FORMING

Invoice	Qty.	Description
1955 72,168 09Jan19 **	1	ADD OPTIONAL TRAY CEILING IN MASTER BEDROOM



CONSTRUCTION SUMMARY

Lot: 88
Model: 40.06 A LILAC
Project/Phase: Pine Valley Forevergreen / 1

FRAMING

Invoice	Qty.	Description
1974 04Nov19 NoCat	1	GREAT ROOM / KITCHEN: REDUCE WIDTH OF ARCH, LEAVE APPROX. 30" NIB WALLS AT EACH SIDE OF ARCH. SEE PLAN FOR LOCATION
1974 04Nov19 NoCat	18	2ND FLOOR: UPGRADE TO 96" DOORS THRU OUT 2ND FLOOR
1974 04Nov19 NoCat	1	2ND FLOOR: UPGRADE TO 96" ARCHWAY
1974 04Nov19 NoCat	1	**NOTE** COFFERED CEILING IN GREAT ROOM & LIBRARY

GLASS AND MIRROR

Invoice	Qty.	Description
1974 72,169 04Nov19	1	MASTER ENSUITE: UPGRADE FROM FRAMED GLASS SHOWER TO FRAMELESS
1974 72,169 04Nov19	1	ENSUITE 2: UPGRADE FROM FRAMED GLASS SHOWER TO FRAMELESS
1974 72,169 04Nov19	1	SEMI ENSUITE: 3/4: UPGRADE FROM FRAMED GLASS SHOWER TO FRAMELESS
2178 08Jun22 NoCat	2	MASTER ENSUITE + SHARED ENSUITE: UPGRADE SHOWER DOOR HANDLE AND HINGE - MATTE BLACK



CONSTRUCTION SUMMARY

Lot: 88
Model: 40.06 A LILAC
Project/Phase: Pine Valley Forevergreen / 1

GRANITE MARBLE QUARTZ

Invoice	Qty.	Description
2178 08Jun22 NoCat	1	POWDER ROOM: UPGRADE COUNTER LEVEL 5 QUARTZ
2178 08Jun22 NoCat	1	KITCHEN: UPGRADE 6 QUARTZ COUNTER
2178 08Jun22 NoCat	1	KITCHEN: FULL HEIGHT SLAB BACKSPLASH - LEVEL 6 QUARTZ
2178 08Jun22 NoCat	1	LAUNDRY ROOM: ADD QUARTZ COUNTER LEVEL 1 + OVER MACHINES
2178 08Jun22 NoCat	1	MASTER ENSUITE: UPGRADE 3 QUARTZ COUNTER
2178 08Jun22 NoCat	1	ENSUITE 2: UPGRADE COUNTER TOP LEVEL 1
2178 08Jun22 NoCat	1	SHARED ENSUITE: UPGRADE COUNTER TOP - LEVEL 4
2178 08Jun22 NoCat	1	KITCHEN: COOKTOP CUT OUT

HARDWOOD

Invoice	Qty.	Description
2178 3 08Jun22	1	THRU OUT STANDARD AREAS - MAIN HALL/ GREAT ROOM/ LIBRARY/ DINING ROOM/ UPPER HALL/ MASTER BEDROOM/ BEDROOM 2/ BEDROOM 3/ BEDROOM 4: VINTAGE SERIES, 5" WHITE OAK, NSS ENGINEERED HARDWOOD, 3/4" THK, WIREBRUSH TEXTURE, UV OIL FINISH - CORNER - LEVEL 3
2178 5 08Jun22	1	KITCHEN/BREAKFAST: VINTAGE SERIES, 5" WHITE OAK, NSS ENGINEERED HARDWOOD, 3/4" THK, WIREBRUSH TEXTURE, UV OIL FINISH - CORNER - LEVEL 3



CONSTRUCTION SUMMARY

Lot: 88
Model: 40.06 A LILAC
Project/Phase: Pine Valley Forevergreen / 1

HVAC

Invoice	Qty.	Description
1974 72,186 04Nov19	1	KITCHEN: ADD GASLINE FOR FUTURE COOKTOP - COOKTOP NOT INCLUDED - NEW 110V RECEPTICLE REQUIRED & INCLUDED WITH THIS PURCHASE
1974 04Nov19 NoCat	1	AIR CONDITIONER - LENNOX 13 SEER MODEL #13ACX060 - 5.0 TON
1974 04Nov19 NoCat	1	HUMIDIFIER: LENNOX #WB3-17

INTERIOR TRIM AND DOORS

Invoice	Qty.	Description
2178 08Jun22 NoCat	1	THRU OUT: UPGRADE INTERIOR DOOR HARDWARE TO HALIFAX MATTE BLACK + SQUARE HINGES

KITCHEN AND BATH CABINETRY

Invoice	Qty.	Description
2178 08Jun22 NoCat	1	THRU OUT: SEE ATTACHED CABINETRY SCHEDULE

PAINT

Invoice	Qty.	Description
2178 08Jun22 NoCat	2	MAIN STAIRS: STAIN STAIRS AND LANDINGS STAIRS AND LANDINGS WILL NOT MATCH HARDWOOD FLOORS IN COLOUR/TEXTURE/SPECIES
2178 08Jun22 NoCat	1	FYI - MAIN STAIRS: ADD FOR GLASS PANEL IN LIEU OF PICKETS - UPG - GLASS PANEL Information only - MAIN STAIRS: ADD FOR GLASS PANEL IN LIEU OF PICKETS - UPG - GLASS PANEL



CONSTRUCTION SUMMARY

Lot: 88
Model: 40.06 A LILAC
Project/Phase: Pine Valley Forevergreen / 1

PLUMBING

Invoice	Qty.	Description
1974 72,174 04Nov19	1	KITCHEN: ADD WATERLINE FOR FRIDGE
2178 08Jun22 NoCat	1	POWDER ROOM: UPGRADE SINK + FAUCET + TOILET
2178 08Jun22 NoCat	1	KITCHEN: UPGRADE SINK AND FAUCET
2178 08Jun22 NoCat	1	LAUNDRY ROOM: UPGRADE SINK AND FAUCET
2178 08Jun22 NoCat	1	MASTER ENSUITE: MOEN 'RIZON' - UPGRADE TO MATTE BLACK FINISH + 7" RAIN SHOWER HEAD + TUB FILLER + 8" LAV FAUCETx2
2178 08Jun22 NoCat	1	SHARED ENSUITE 3/4: UPGRADE SHOWER TRIM + LAV (x2) TO MOEN 'RIZON' MATTE BLACK
2178 08Jun22 NoCat	1	ENSUITE 2: UPGRADE SHOWER TRIM + LAV TO MOEN 'RIZON' MATTE BLACK

STAIR AND RAILINGS

Invoice	Qty.	Description
2178 100,227 08Jun22	1	MAIN STAIRS: ADD FOR GLASS PANEL IN LIEU OF PICKETS - UPG - GLASS PANEL

WINDOWS - BASEMENT

Invoice	Qty.	Description
1955 72,177 09Jan19	2	UPGRADE EXISTING WINDOW TO 30X24 INCHES Upgrade both the existing standard windows from 30x16 to 30x24, may require window wells.

Scheduled Closing Date:

Purchaser: PRE-OPENING INVENTORY HOME PH1 LOT 8 Property: 88 of Plan -

Telephone Res. / Bus: (905) 760-9595

Project: Pine Valley Forevergreen - Phase 1

Decor Advisor: Yolande Somerville

Model and Elevation: 40.06 A LILAC

Layout Changes: ☐ Yes ☒ No Sketch Attached: ☒ Yes ☐ No Exterior Colour Scheme:

1. Cabinetry

	Style and Colour	Counter	Hardware
Kitchen / Breakfast	*2-tone	*Calacatta Gold	attached
Laundry Room	Bowery Avenza	*Jet Black	attached
Powder Room	*Manhattan Glazed Clay	*Eternal Noire	attached
Master Ensuite Bathroom	*Manhattan Glazed Clay	*Calacatta Gold	attached
Second Ensuite Bathroom (If Applicable)	Tribeca Ariss	*Jet Black	attached
Shared Ensuite	*Manhattan Pitch Black	*Granite: Titanium	attached

Comment

Kitchen perimeter: *Base: Manhattan oak Cashew // Upper + Tall + Island: *Kensington Pitch Black

white oak natural

2. Floor Tile

	Selection
Entrance Vestibule	*12x24" Marmorea 'Port Laurent' matte + charcoal grout
Main Hall	
Kitchen / Breakfast	hardwood
Laundry Room	*12x24" Marmorea 'Port Laurent' matte + charcoal grout
Powder Room	*12x24" Marmorea 'Port Laurent' matte + charcoal grout
Mud Room	*12x24" Marmorea 'Port Laurent' matte + charcoal grout
Master Ensuite Bathroom	*12x24" Marmorea 'Port Laurent' matte + charcoal grout
Second Ensuite Bathroom (If Applicable)	*12x24" Regal matte 'Shell White' + Bone grout
Lower Landing (If Applicable)	*12x24" Regal matte 'Shell White' + Bone grout
Shared Ensuite	*12x24" Chambray 'Taupe' + Bone grout

Comment

Shower Floor Tile: Master Ensuite - Penny Round black + charcoal grout // Shared Ensuite: Penny Round Taupe + Bone Grout

2nd Ensuite: 2x2 Quebec Arctic white + Bone Grout.

matte

Revised: Sept. 14, 2022

3. Wall Tile

	Selection	Listello/Inserts	Describe
		<input type="radio"/> Yes <input checked="" type="radio"/> No	
Master Ensuite Bathroom			
Tub Deck		<input type="radio"/> Yes <input checked="" type="radio"/> No	
Shower Stall	*12x24" Marm B. Calcta pol + bone gr	<input type="radio"/> Yes <input checked="" type="radio"/> No	
Bathroom Walls		<input type="radio"/> Yes <input checked="" type="radio"/> No	
Second Ensuite Bathroom (If Applicable)	*3x6" CDC matte blk + charcoal gr	<input type="radio"/> Yes <input checked="" type="radio"/> No	
Shared Ensuite	*2x16" CDC matte Taupe + bone gr	<input type="radio"/> Yes <input checked="" type="radio"/> No	
Kitchen Backsplash	<input checked="" type="radio"/> Yes <input type="radio"/> No	Backsplash Behind Fridge	
Comment	*FHBS same as perimeter counter		

see attached

Revised: Sept. 14, 2022

Scheduled Closing Date:

Purchaser: PRE-OPENING INVENTORY HOME PH1 LOT 8 Property: 88 of Plan -

Telephone Res. / Bus: (905) 760-9595

Project: Pine Valley Forevergreen - Phase 1

Decor Advisor: Yolande Somerville

Model and Elevation: 40.06 A LILAC

4. Plumbing Fixtures

<input type="checkbox"/>	Second Ensuite	<input type="checkbox"/>	Powder Room	<input type="checkbox"/>	
Master Ensuite Bathroom	<input type="checkbox"/>	Other Room - Specify	<input type="checkbox"/>	Other Washroom	<input type="checkbox"/>

Comment

see extras

5. Hardwood Flooring

	Type and Stain		Type and Stain
Main Hall	<input type="text"/>	Upper Landing	<input type="text"/>
Kitchen / Breakfast	*3/4x5" wht oak wirebrush 'Orion'	Upper Hall	<input type="text"/>
Living Room	<input type="text"/>	Master Bedroom	<input type="text"/>
Dining Room	<input type="text"/>	Bedroom #2	<input type="text"/>
Family Room	<input type="text"/>	Bedroom #3	<input type="text"/>
Den/Library	<input type="text"/>	Bedroom #4	<input type="text"/>
Entrance Vestibule	<input type="text"/>	Bedroom #5	<input type="text"/>
Lower Landing (If Applicable)	<input type="text"/>	Other Room - Specify	<input type="text"/>
		Thru out standard areas	*3/4x5" wht oak wirebrush 'Orion'

Comment

6. Carpeting

	Upgrade	Description
Ground Floor	<input type="checkbox"/>	<input type="text"/>
Second Floor	<input type="checkbox"/>	<input type="text"/>
<input type="text"/>	<input type="checkbox"/>	<input type="text"/>

Upgrade Underpad	Type	Area
	<input type="text"/>	<input type="text"/>
Carpet on Stairs	Capped	Runner - *Upgrade
	<input type="text"/>	<input type="text"/>

Comment

7. Fireplace

	Living Room			Family Room			Other Room - Specify		
	Purchased	As Per Plan	N/A	Purchased	As Per Plan	N/A	Purchased	As Per Plan	N/A
Fireplace Type	<input type="radio"/>	<input type="radio"/>	<input checked="" type="radio"/>	<input type="radio"/>	<input checked="" type="radio"/>	<input type="radio"/>	<input type="radio"/>	<input type="radio"/>	<input checked="" type="radio"/>
Mantle Type	<input type="text"/>			standard gas			<input type="text"/>		
Colour / Stain	<input type="text"/>			*capri			<input type="text"/>		
Surround	<input type="text"/>			arctic white			<input type="text"/>		
Hearth	<input type="text"/>			n/a			<input type="text"/>		
	<input type="text"/>			none			<input type="text"/>		

Comment

see station revised: sept. 14, 2000

Scheduled Closing Date:

Purchaser:	PRE-OPENING INVENTORY HOME PH1 LOT 8	Property:	88 of Plan -
Telephone Res. / Bus:	(905) 760-9595	Project:	Pine Valley Forevergreen - Phase 1
Decor Advisor:	Yolande Somerville	Model and Elevation:	40.06 A LILAC

8. Trim Carpentry

Interior Doors	Carrara	Front Door Glass Inserts	std	Door Handles	*Halifax blk + hng
Interior Trim	Standard Trim Package				
Comment					

9. Plaster Mouldings and Medallions

Standard Throughout ☐ Yes ☐ No ☒ N/A

Entrance Vestibule			Kitchen/Breakfast		
Main Hall			Den/Library	*CTR-B07	
Living Room			Lower Landing		
Dining Room			Other Room - Specify		
Family Room	*CTR-B07				
Comment					

10. Railings and Spindles

Railing Package	*Glass Railing		
Railing Colour	*Pharoah	Spindle Colour	*Glass
Stringer / Riser	*Pharoah	Treads	*Pharoah
Comment	Oak Stairs	<input checked="" type="radio"/> Yes <input type="radio"/> No <input type="radio"/> N/A	

11. Wall Paint / Ceilings

Throughout Finished Areas	Cool White
Trim Paint	White
Smooth Ceilings	
Ground Floor	<input checked="" type="checkbox"/>
Second Floor	<input checked="" type="checkbox"/>
Note	
Comment	

see attached raised: Sept. 14, 2022

Scheduled Closing Date:

Purchaser: PRE-OPENING INVENTORY HOME PH1 LOT 8 Property: 88 of Plan -

Telephone Res. / Bus: (905) 760-9595

Project: Pine Valley Forevergreen - Phase 1

Decor Advisor: Yolande Somerville

Model and Elevation: 40.06 A LILAC

12. Electrical

Hood Fan ☐ White ☐ Stainless ☐ N/A

Above Kitchen Cabinet Light ☐ Yes ☒ No

Below Kitchen Cabinet Light ☒ Yes ☐ No

Standard Appliances ☐

Over The Range Microwave ☐

Chimney Style Fan ☐

Comment

13. Heating and Air Conditioning

Air Conditioning

Gas Provisions Stove

Gas Provisions Dryer

Gas Provisions Barbecue

Comment

14. Additional Comments

15. Disclaimers and Notes

- 1) Colours of all materials are as close as possible to builder's selection, but not necessarily identical due to variances in manufacturing.
- 2) Any extras listed above are null and void unless accompanied by a separate invoice/amendment. Said invoice must be paid in full.
- 3) The Purchaser acknowledges that after Interior Colour Selection form is signed and dated, no further changes will be permitted other than re-selection due to unavailability. _____ Purchaser's Initials
- 4) The Purchaser acknowledges reading and accepting the "Gold Park Homes Decor Centre Disclaimers" form. This document contains other miscellaneous disclaimers.

This Interior Colour Selection is final and approved by:

see attached. Revised: Sept. 14, 2022

Signature: _____ Date: _____

PURCHASER'S EXTRAS QUOTATION
Pine Valley Forevergreen - Phase 1

PURCHASER: PRE-OPENING INVENTORY HOME PHI LOT 88 TEL: RES.: 905-760-9595

Table with 3 columns: LOT NUMBER (88), PHASE (1), HOUSE TYPE (40.06 A LILAC)

Table with 5 columns: ITEM, EXTRA / CHANGE, QTY, UNIT PRICE, EXTENDED. Row 1: 1, ENSUITE 2: UPGRADE 2 SHOWER FLOOR TILE + UPGRADED GROUT, 1, \$720.00, \$720.00

\$720.00 Sub Total
\$93.60 HST
\$813.60 Total

This is your direction to install the above extras in accordance with the following terms and conditions:

- 1. In the event the work on the house has progressed beyond the point where the items covered by this extra cannot be installed without entailing any unusual expense, then this order is to be cancelled and any deposit paid in connection with the same is to be refunded to the purchaser.
2. The Vendor will undertake to incorporate the work covered by the sales extra in the construction of the house but will not be liable to the purchaser in any way, if for any reason the work covered by the extra is not carried out. In that event, any monies paid in connection with the same shall be returned to the purchaser.
3. It is understood and agreed that if for any reason whatsoever the transaction of Purchase and Sale is not completed, the total cost of extras ordered are not refundable to the Purchaser(s).
4. Extras or changes will not be processed unless signed by the Vendor.
5. These extras may not be amended without the written consent of GOLDPARK (PINE VALLEY) INC.
6. The purchaser(s) and the builder acknowledge and agree that this "Purchaser's Extra" form shall not be deemed to be part of the agreement of purchase and sale entered into between them, nor an addendum thereto.
7. Prices are estimates only and guaranteed for a period of 5 days only.
8. No post dated cheques will be accepted.
9. No Estimates or orders will be accepted once construction has commenced.
10. All extras/selections are final with signature. All enquiries to re-open a file and/or request changes to any extras/selections is subject to a fee of \$500.00 (five hundred dollars).
11. No estimates will be considered official orders until resubmitted on a signed Purchaser Extras Form, accompanied by payment in full.

Payment Summary
Paid By Amount
Total Payment:

Bonus Summary
Bonus Package offering (includes taxes) from Gold Park Homes Décor Centre is being applied to this order.
Any remaining balance(s) will be applied accordingly to extras purchased.
Bonus Package Offering
Invoice Number Date Amount
Total Bonus Used:
Remaining Balance:

Initials: [Signature]

CONSTRUCTION SCHEDULING APPROVAL
PER:
DATE:

PURCHASER'S EXTRAS QUOTATION

Pine Valley Forevergreen - Phase 1

PURCHASER: PRE-OPENING INVENTORY HOME PH1 LOT 88

TEL: RES.: 905-760-9595

LOT NUMBER	PHASE	HOUSE TYPE
88	1	40.06 A LILAC

ITEM	EXTRA / CHANGE	QTY	UNIT PRICE	EXTENDED
------	----------------	-----	------------	----------

PURCHASER:

see attached

PRE-OPENING INVENTORY HOME
PH1 LOT 88

14-Sep-22

DATE

VENDOR:

PER: GOLDPARK (PINE VALLEY) INC.

CONSTRUCTION SCHEDULING APPROVAL

PER: _____

DATE: _____

Yolande Somerville

From: Mellina Plener <Mellina@mosconetile.com>
Sent: September 14, 2022 9:02 AM
To: Yolande Somerville
Cc: Michael Pilato; Ben Moscone
Subject: GOL101-0088

Importance: High

Hi Chanel,

Can you confirm the **Ensuite 2 Bathroom**. We believe it is a shower instead of a tub and if so we will require the **shower floor selection**. We do not have that information.

Thank you.

SCHEDULE 'F'



PV-88
MAY 25 2022

The Lilac

40' SERIES

→ Elevation A • 3,425 sq.ft.
Elevation B • 3,385 sq.ft.

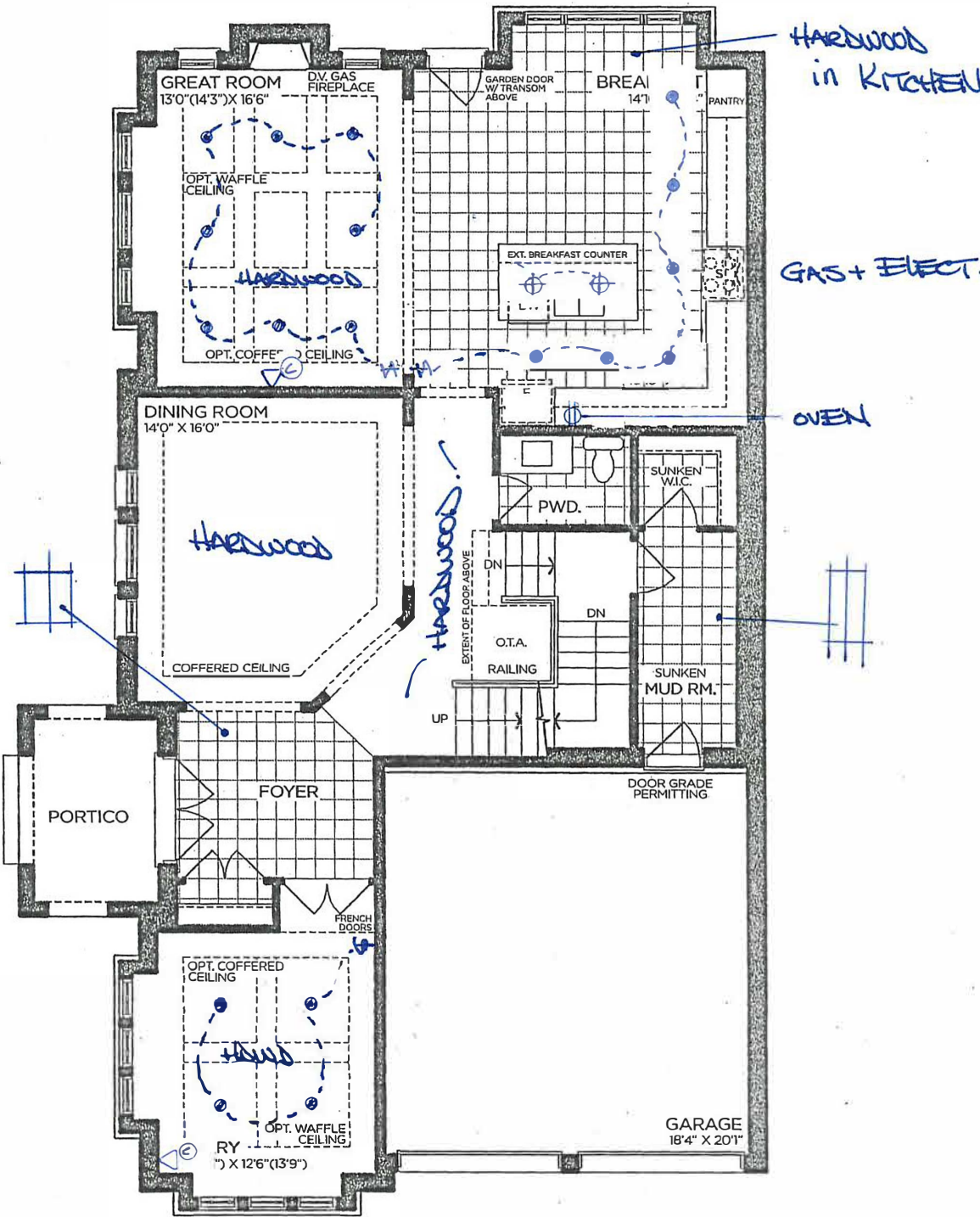

GROUND FLOOR | ELEV. A

VENDOR

PURCHASER

PURCHASER

GOLDPARK
WORTH MORE™

Prices, figures, illustrations, sizes, features and finishes are subject to change without notice. Areas and dimensions are approximate and actual usable floor space may vary from the stated area. Layout may be reverse of the unit purchased. E. & O.E. 4006

SCHEDULE 'F'



TV-88
MAY 25 2022

The Lilac

40' SERIES

Elevation A • 3,425 sq.ft.
Elevation B • 3,385 sq.ft.

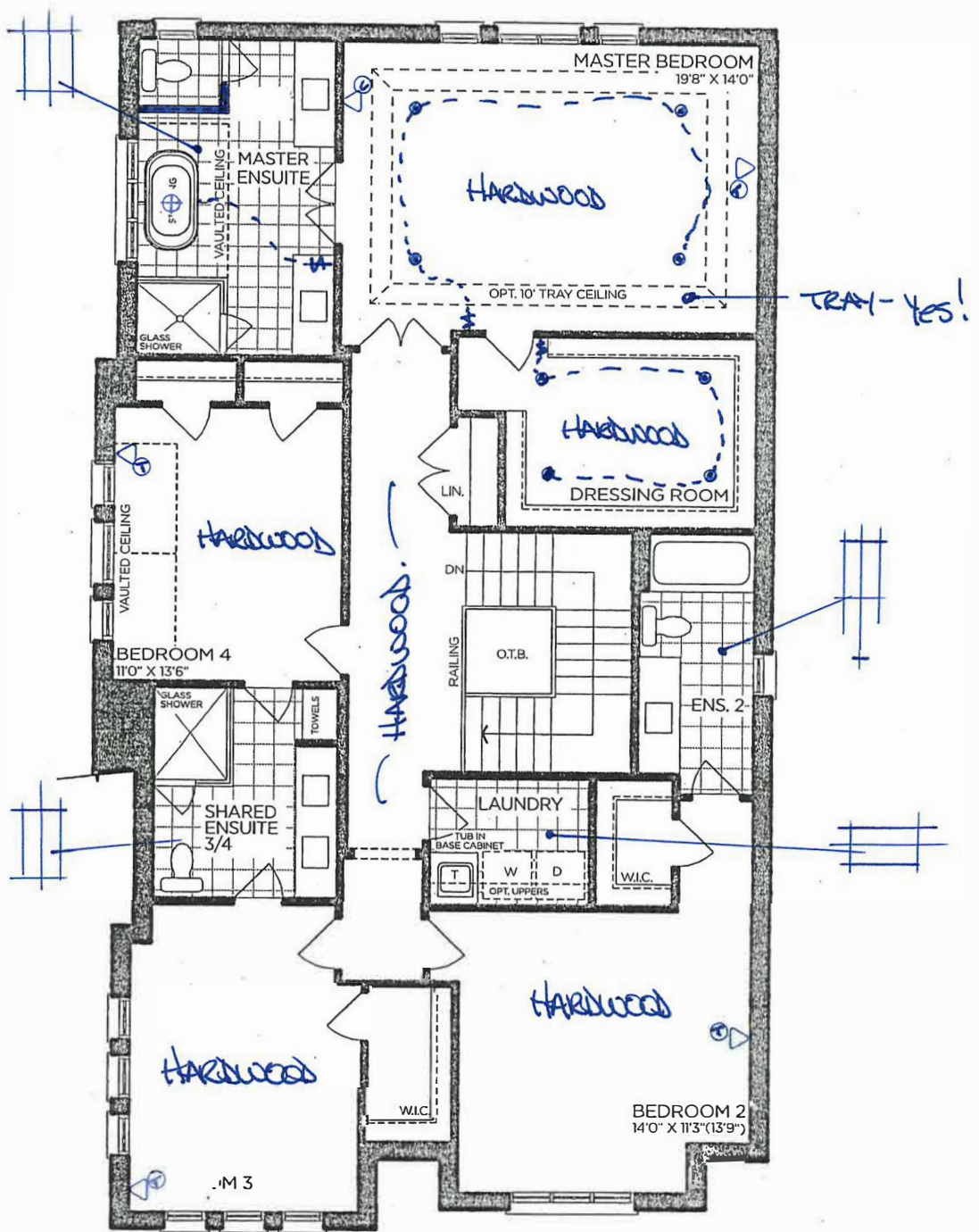

SECOND FLOOR | ELEV. A

VENDOR

PURCHASER

PURCHASER

GOLDPARK
WORTH MORE™

Prices, figures, illustrations, sizes, features and finishes are subject to change without notice. Areas and dimensions are approximate and actual usable floor space may vary from the stated area. Layout may be reverse of the unit purchased. E. & O.E. 4006

SCHEDULE 'F'

PV-88
MAY 25 2022



The Lilac

40' SERIES

→ Elevation A • 3,425 sq.ft.
Elevation B • 3,385 sq.ft.

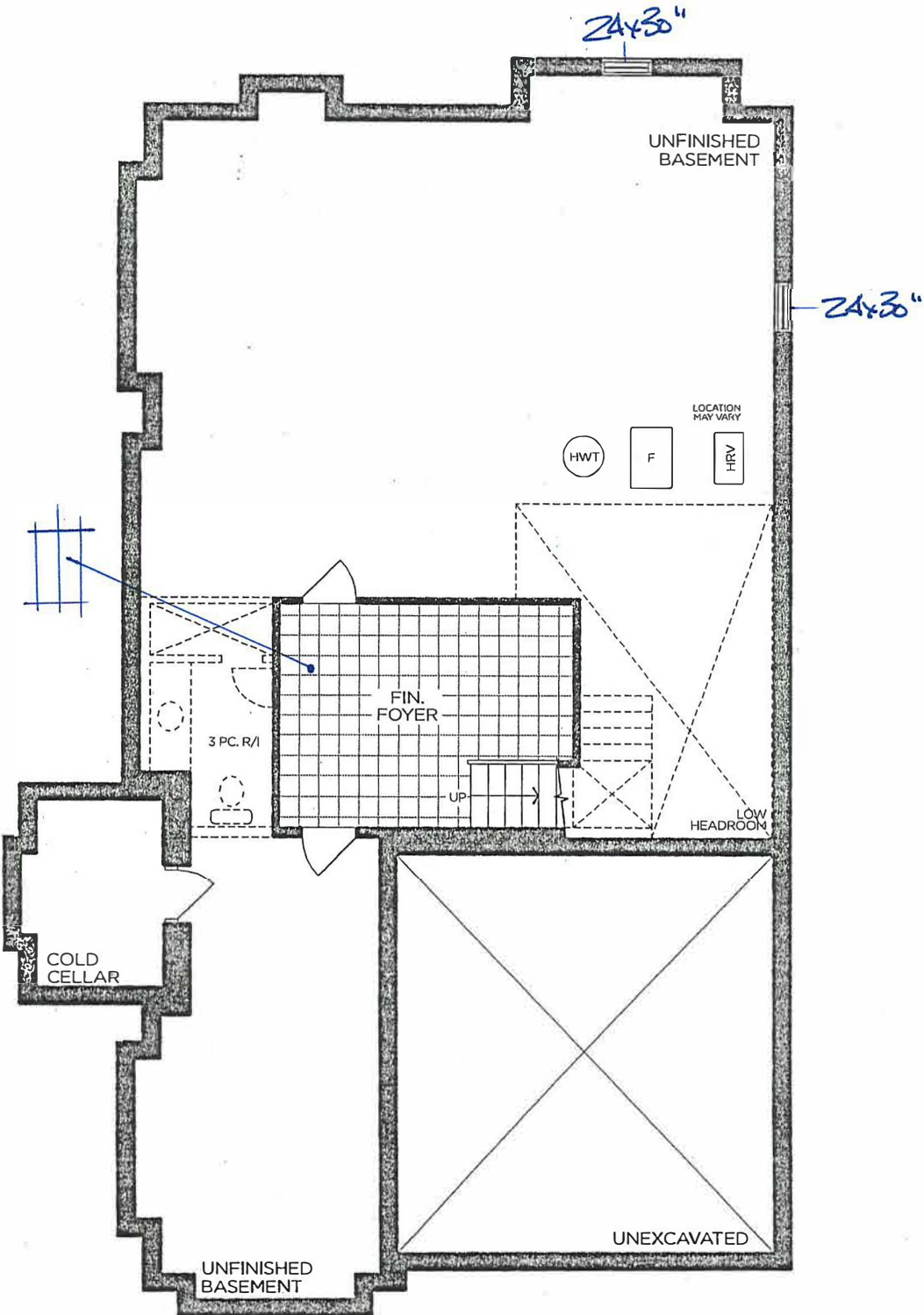

BASEMENT | ELEV. A

VENDOR	
PURCHASER	
PURCHASER	

GOLDPARK
WORTH MORE™

Prices, figures, illustrations, sizes, features and finishes are subject to change without notice. Areas and dimensions are approximate and actual usable floor space may vary from the stated area. Layout may be reverse of the unit purchased. E. & O.E. 4006

PV-88
MAY 26 2022

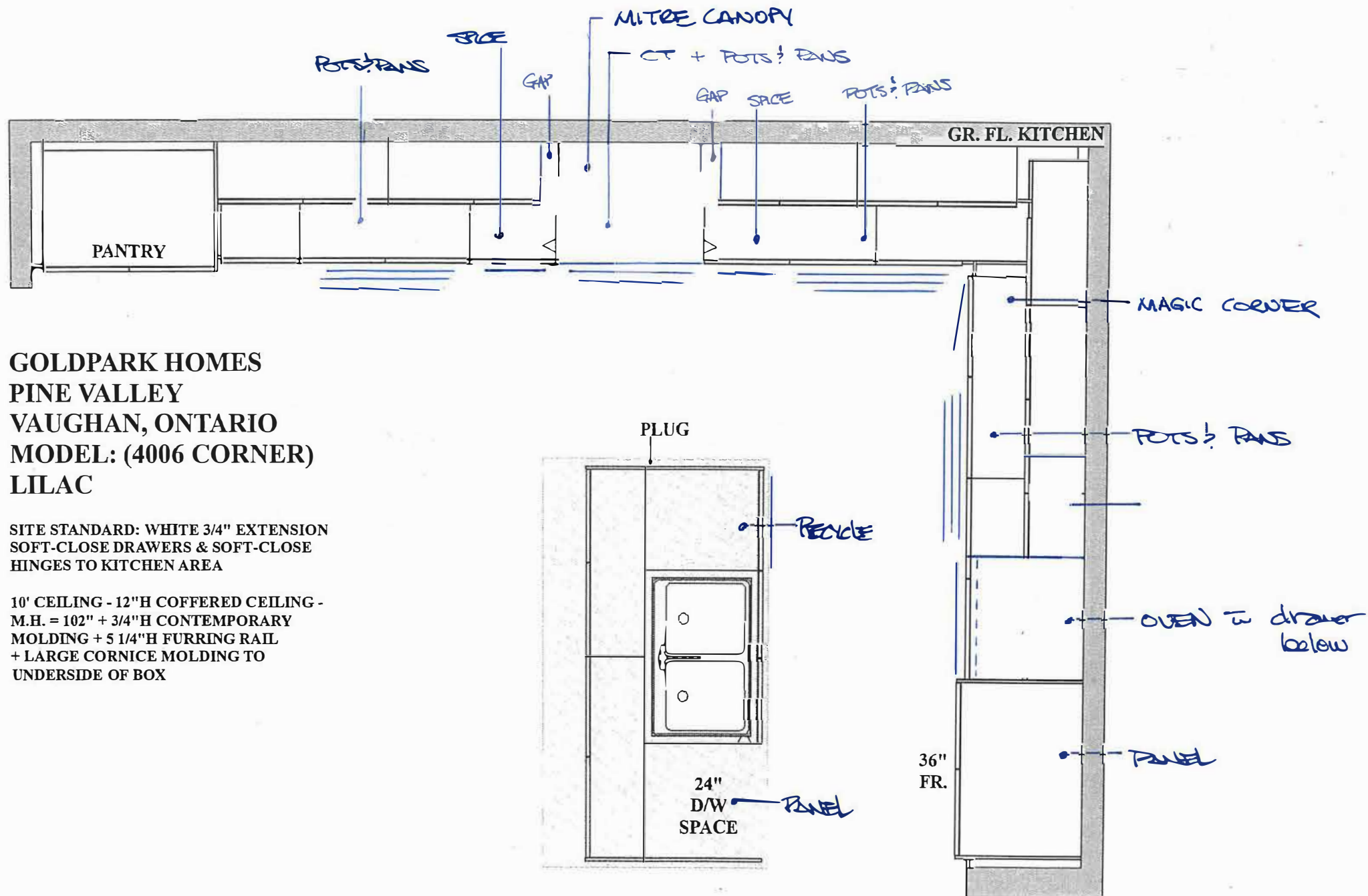

**GOLDPARK HOMES
PINE VALLEY
VAUGHAN, ONTARIO
MODEL: (4006 CORNER)
LILAC**

SITE STANDARD: WHITE 3/4" EXTENSION
SOFT-CLOSE DRAWERS & SOFT-CLOSE
HINGES TO KITCHEN AREA

10' CEILING - 12"H COFFERED CEILING -
M.H. = 102" + 3/4"H CONTEMPORARY
MOLDING + 5 1/4"H FURRING RAIL
+ LARGE CORNICE MOLDING TO
UNDERSIDE OF BOX



PLAN VIEW

#: AKOWALTCHUK-0058-20

Page# 17/22

PV-88
MAY 26 2022

**GOLDPARK HOMES
PINE VALLEY
VAUGHAN, ONTARIO
MODEL: (4006 CORNER) LILAC**

SITE STANDARD: WHITE 3/4" EXTENSION
SOFT-CLOSE DRAWERS & STANDARD SLAM DOOR HINGES
TO VANITIES

ONE TOP DRAWER WHERE POSSIBLE THROUGHOUT EACH
VANITY, ONE BANK OF DRAWERS WHERE POSSIBLE
THROUGHOUT EACH MASTER ENSUITE VANITY

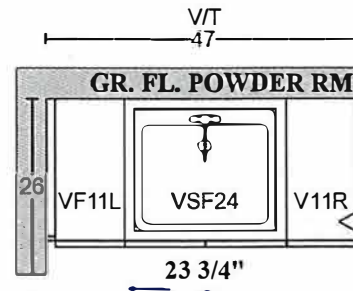

BLACK METAL LEGS

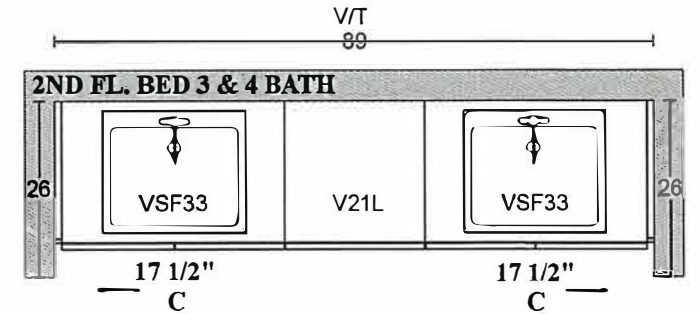
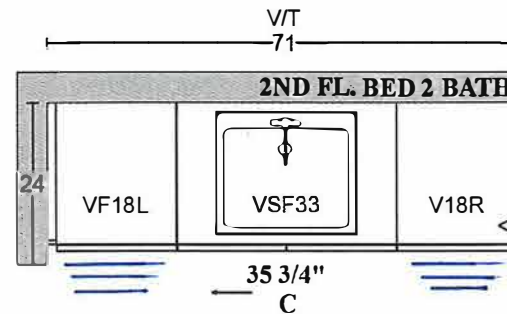
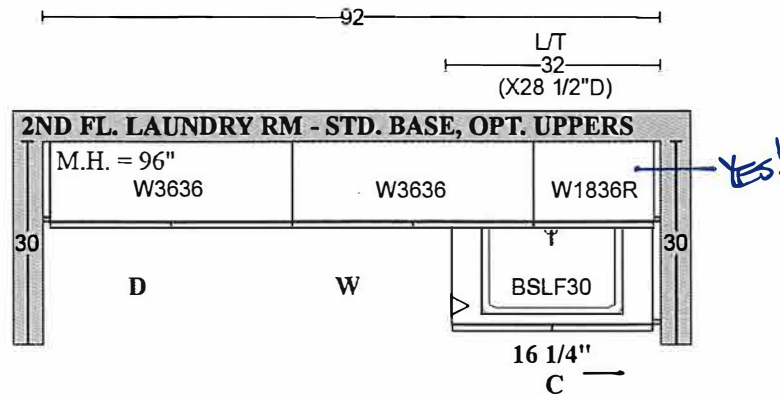
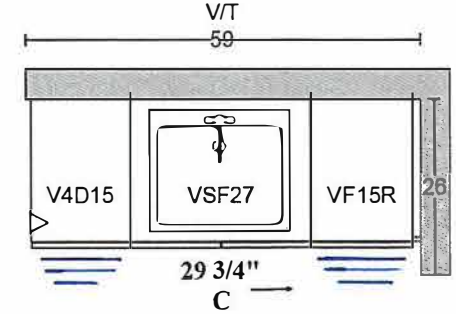
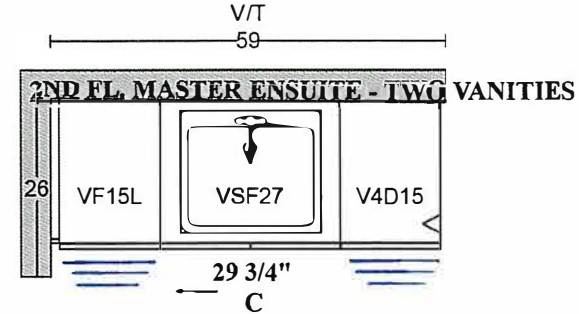

PLAN VIEW

#: AKOWALTCHUK-0032-20 (V1.02)

Page# 18/22

UPGRADE HARDWARE



BAH-083-03

Appliance Pull

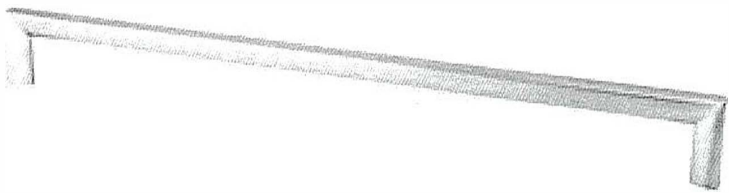

- ☐ BRUSHED NICKEL
- ☒ MATTE BLACK
- ☐ MODERN BRONZE

LOCATION:

KITCHEN FRIDGE/FREEZER

LOT # 88	DATE: MAY 27 2022
-------------	----------------------

SIGNATURE:

SIGNATURE:



UPGRADE HARDWARE

BH-081-03

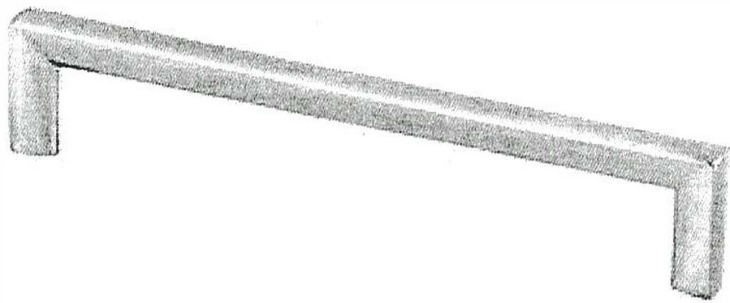

- ☐ BRUSHED NICKEL
☒ MATTE BLACK
☐ MODERN BRONZE

LOCATION:

KITCHEN
POWDER
MASTER
ENSUITE 2
SHARED ENSUITE

LOT # 88	DATE: MAY 27 2022
-------------	----------------------

SIGNATURE:

SIGNATURE:

CONTEMPORARY 9696

Aluminum Edge Pull - 'Brushed Black'
Length: 6"

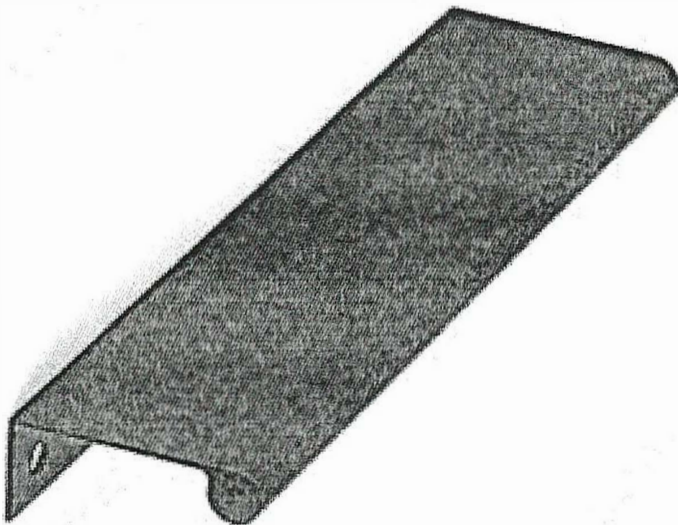

LOCATION:

LAUNDRY

LOT #

88

DATE:

MAY 26 2022

SIGNATURE:

SIGNATURE:



PINE VALLEY

FOREVERGREEN

Range Hood - Mitred Square

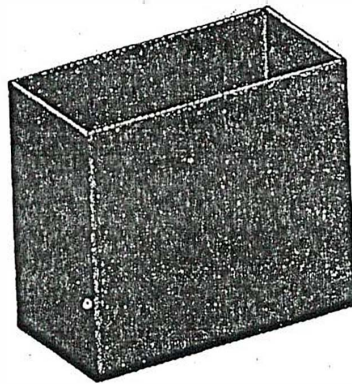

Lot#
88

Room:
KITCHEN

Signature:

Date:
MAY 27 2022

Signature:

UPGRADE KITCHEN SINK

BLANCO - PRECIS U SUPER SINGLE

Silgranit - Undermount Sink
32" x 19" x 9-1/2"

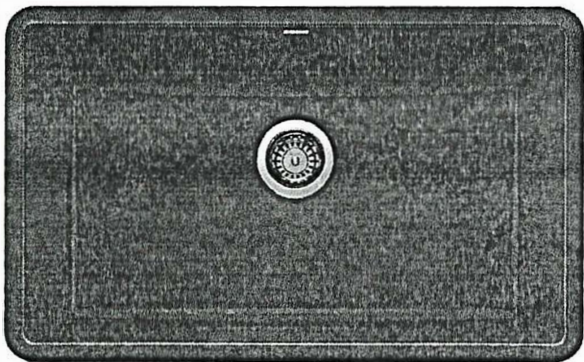

Anthracite

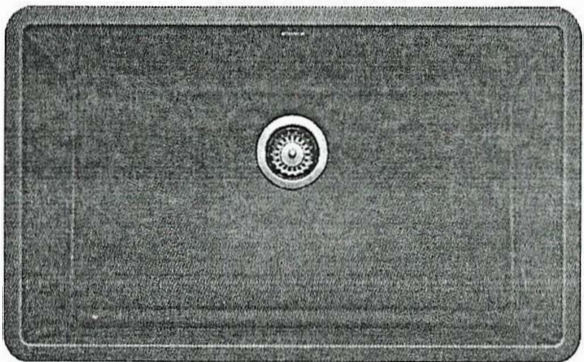

Concrete Grey

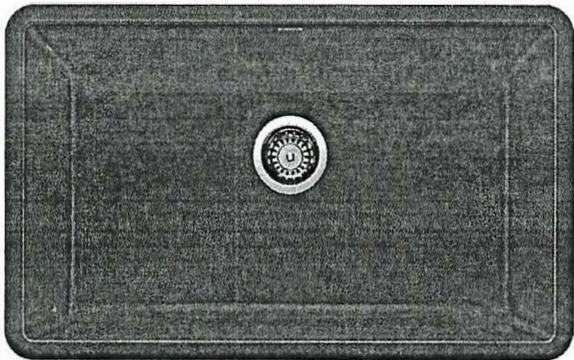

Metallic Grey

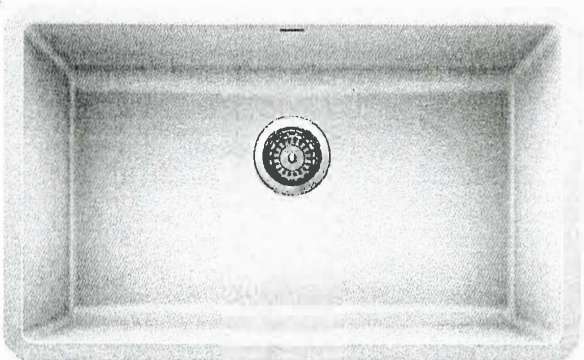

White

- ☐ ANTHRACITE
- ☐ CONCRETE GREY
- ☐ METALLIC GREY
- ☒ WHITE
- ☐ CINDER

MODEL 400890 Anthracite / 402266 Concrete Grey / 401683 Metallic Grey / 401820 White / 401397 Cinder

Lot# 88	Date: MAY 26 2022	Room: KITCHEN
Signature:		
Signature:		



PINE VALLEY
FOREVERGREEN

UPGRADE KITCHEN FAUCET

MOEN - NIO

One-Handle Pulldown Kitchen Faucet

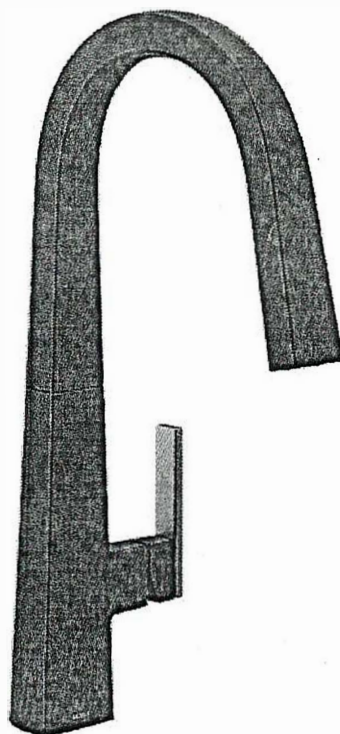

- ☐ CHROME
- ☒ MATTE BLACK / BRUSHED GOLD (BL)
- ☐ SPOT RESIST STAINLESS (SRS)

MODEL: S75005 Chrome / S75005BL Matte Black / S75005SRS Spot Resist Stainless

Lot# 88	Date: MAY 26 2022	Room: KITCHEN
Signature:		
Signature:		

VANITY SINK UPGRADES

21" Wetstyle Undermount Sink
OVAL

21" x 15" x 4"

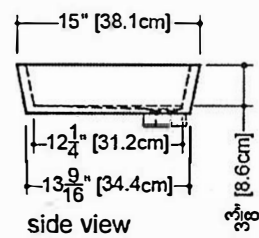
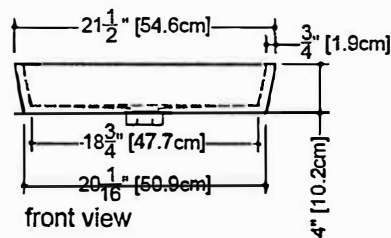
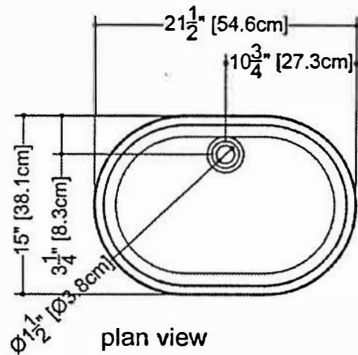
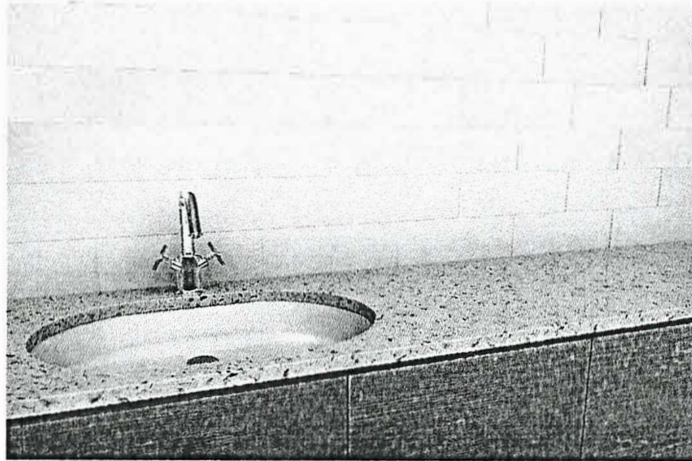

VOV 821U

MODEL: VOV 821U-MA

Lot# 98	Date: MAY 26 2022	Room: POWDER
Signature:		
Signature:		

FAUCET NOT INCLUDED



PLUMBING UPGRADES

MOEN - RIZON

Single-Handle Lav Faucet with Lift Rod Drain

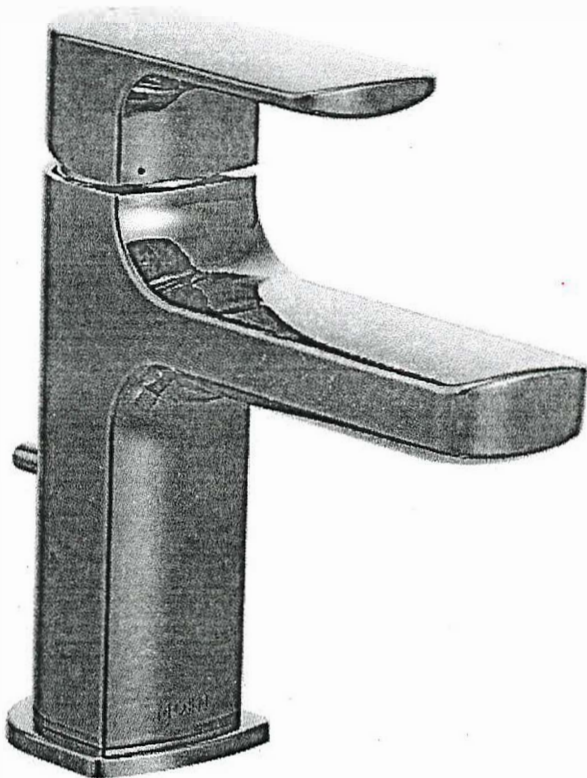

CHROME - STANDARD

- ☐ BRUSHED NICKEL (BN)
☒ MATTE BLACK (BL)

MODEL: 6900

Lot# 88	Date: MAY 26 2022.	Room: MASTER ENSUITE / ENS 2 / SHABEN ENS
Signature:		
Signature:		



PINE VALLEY

FOREVERGREEN

PLUMBING UPGRADES

MOEN - RIZON

Eco-Performance Posi-Temp Tub/Shower Faucet



- ☐ CHROME
- ☐ BRUSHED NICKEL (BN)
- ☒ MATTE BLACK (BL)

MODEL: T2813EP / 62320

Lot# 88	Date: MAY 26 2022	Room: MASTER ENS / ENS 2 / SHARED ENS.
Signature:		
Signature:		



PINE VALLEY
FOREVERGREEN

PLUMBING UPGRADES

MOEN - ALIGN

Two-Handle Adjustable Widespread Lav Faucet with Lift Rod Drain

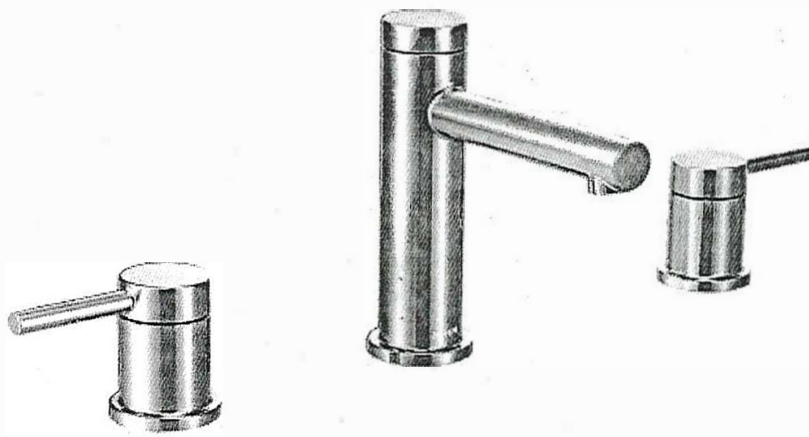

- ☐ CHROME
- ☐ BRUSHED NICKEL (BN)
- ☐ BRUSHED GOLD (BG)
- ☒ MATTE BLACK (BL)

MODEL: T6193 / 69000

Lot# 88	Date: MAY 26 2022	Room: POWDER
Signature:		
Signature:		

UPGRADE TOILET

CILA

Contrac
Soft White

1 Piece Elongated Bowl w/ Concealed Skirted Trap-Way

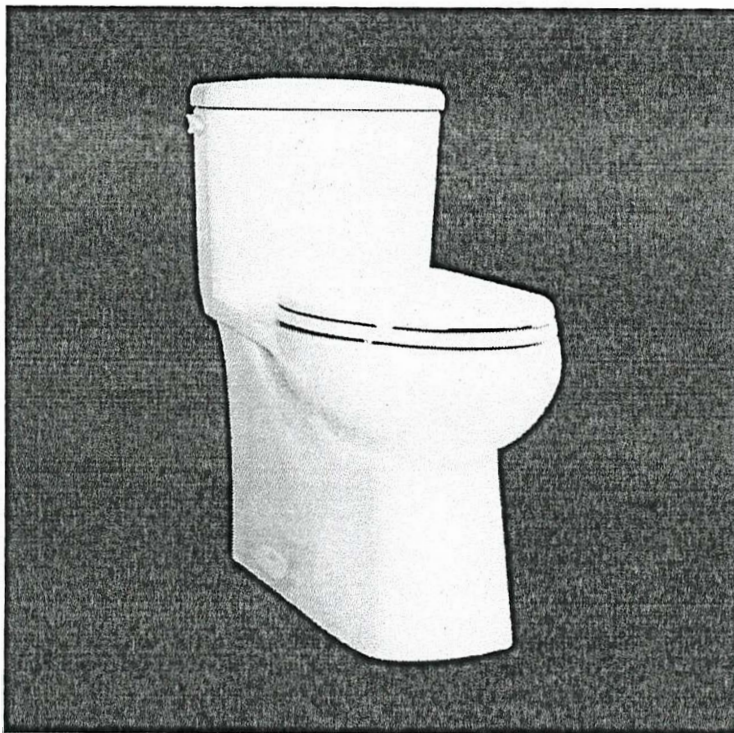

DESCRIPTION: Soft White, 17" plus height for greater comfort, Soft white tank lever

DIMENSIONS: 15 3/8" W x 28 1/2" D x 30 1/8" H

MODEL: 4710BOXU

Lot#

88

Date:

MAY 26 2022

Room:

BW202

Signature:

Signature:



UPGRADE SINK + FAUCET

BLANCO - QUATRUS R15 LAUNDRY SINK
+
MOEN - SLEEK SINGLE HANDLE PULLOUT FAUCET

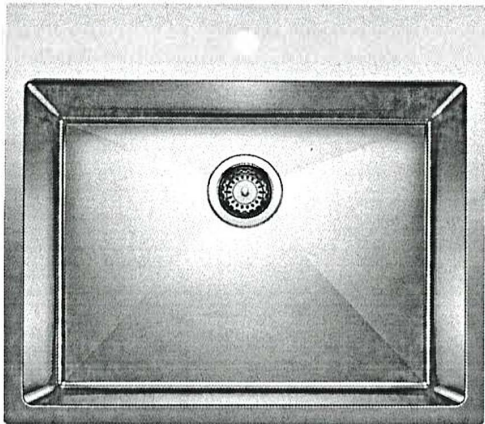
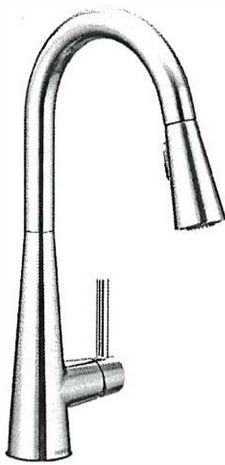

*CHROME ONLY + STAINLESS STEEL

MODEL: 7864 Faucet / 401802 Stainless Steel Sink

Lot# 88	Date: MAY 26 2022	Room: LAUNDRY
Signature:		
Signature:		



STONE COUNTERTOP EDGE PROFILES

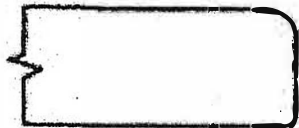

STANDARD 2CM EASED EDGE

LOCATION: THRU OUT



UPGRADE 3CM EASED EDGE

LOCATION: _____



UPGRADE 4CM MITRED EDGE

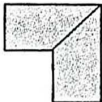

LOCATION: _____

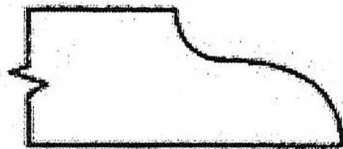

UPGRADE 2CM OGEE EDGE

LOCATION: _____

LOT #: <u>88</u>	DATE: <u>MAY 26 2022</u>
SIGNATURE: _____	
SIGNATURE: _____	



PINE VALLEY
FOREVERGREEN

UPGRADE SHOWER HARDWARE

SQ6X6

Shower Door Handle

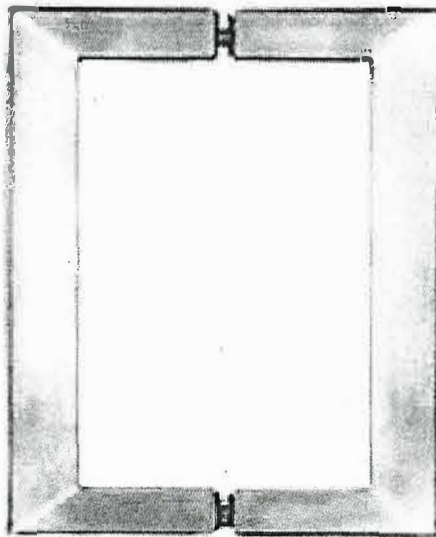

SQ6X6
Shower Door Handle

6" x 6" back-to-back
3/4" square tube

☐ CHROME

☒ MATTE BLACK

Lot# 88	Date: MAY 26 2022	Room: MASTER + JAVED ENSUITE
Signature:		
Signature:		



FIREPLACE MANTLE UPGRADE

CAPRI

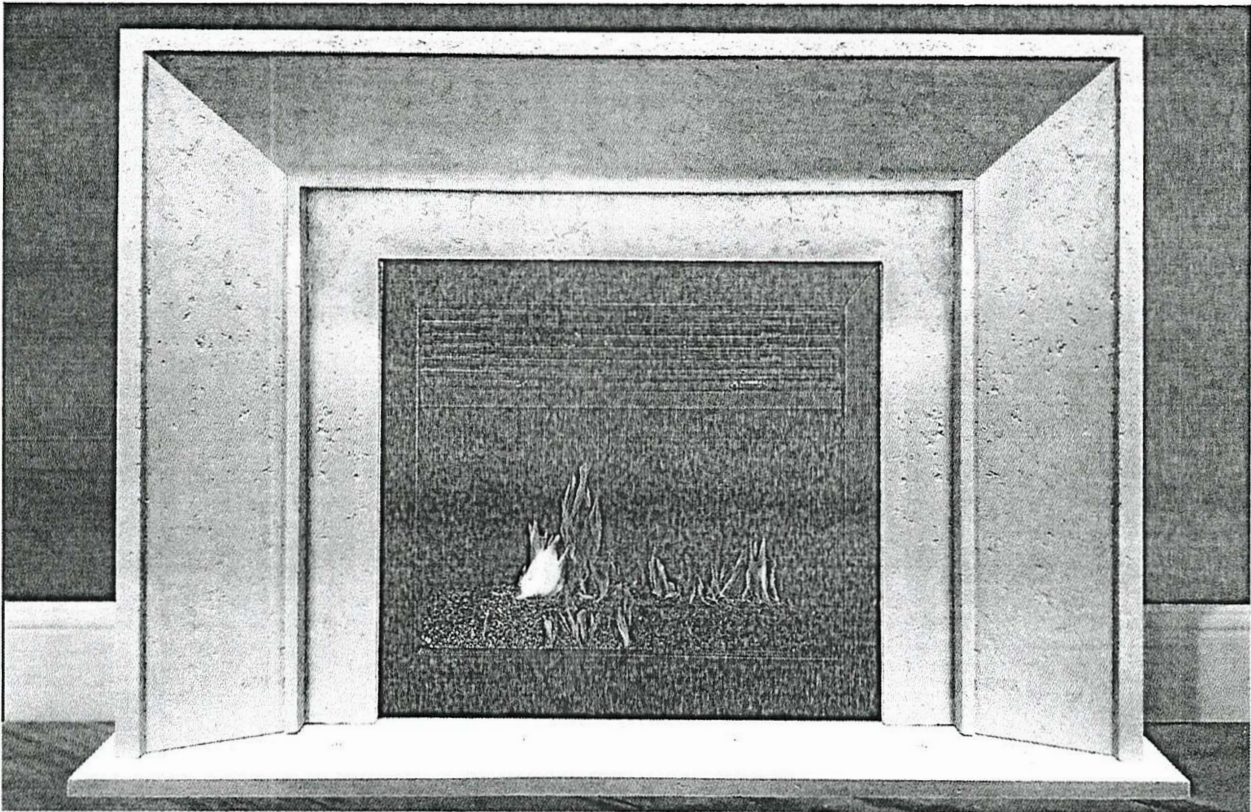

TOP VIEW

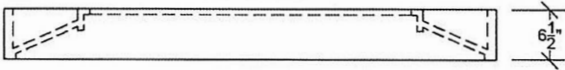

SIDE VIEW

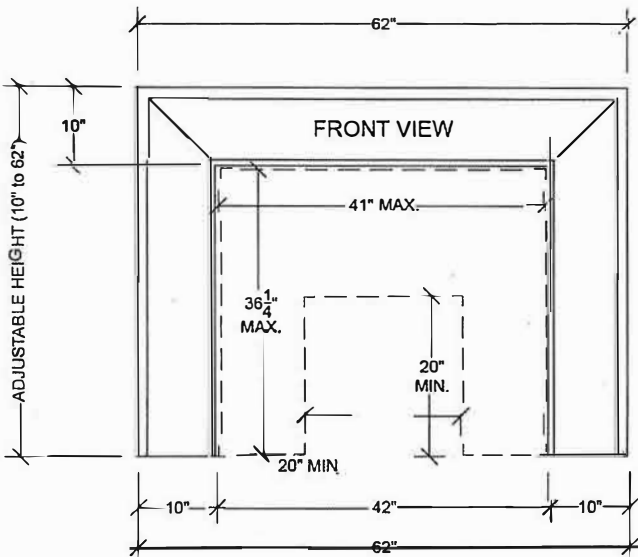

OR MEASUREMENT OR DESCRIPTION

LOT #: 88	DATE: MAY 26 2022	LOCATION: GREAT ROOM
SIGNATURE:		
SIGNATURE:		



PINE VALLEY
FOREVERGREEN

BATHROOM ACCESSORIES

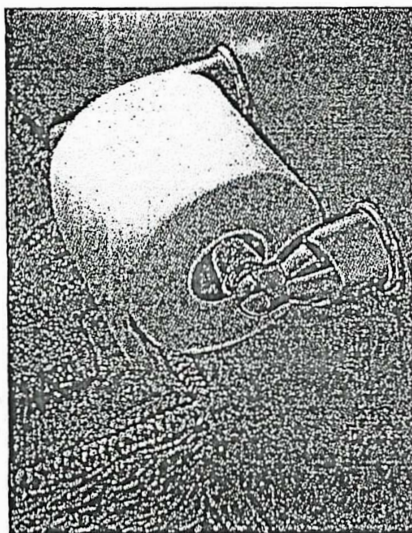

Tissue Holder
Mason - Chrome

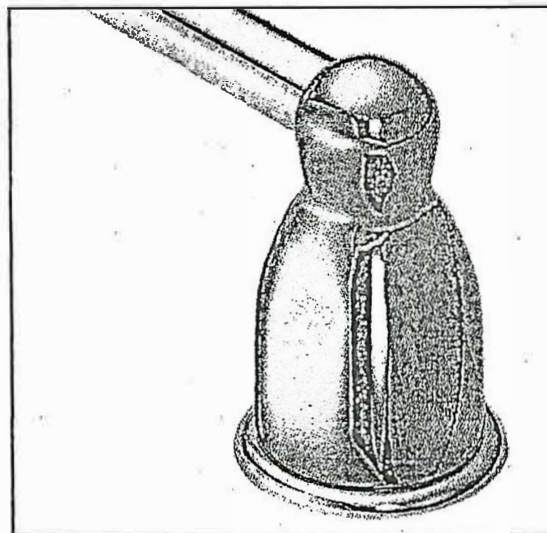

Towel Bar
Mason - Chrome

Please select one of the following:

☐ INSTALL STANDARD BATHROOM ACCESSORIES THRU OUT
(tissue holder + towel bar) **location as per vendors discretion**

☒ ***DO NOT*** INSTALL STANDARD BATHROOM ACCESSORIES
THRU OUT **tissue holder + towel bar will not be provided**

LOT #

88

DATE:

MAY 27 2022

SIGNATURE:

SIGNATURE:



Project: PINE VALLEY

Lot: 88

Purchaser(s): INVENTORY

Standard Hood Fan Deletion

We acknowledge that the builder's standard hood fan will not be installed.
Do not supply, install and/or credit. We will install our own hood fan after closing.

Signature:  _____

Signature: _____

Date: MAY 26 2022



KITCHEN



POWDER ROOM



MASTER ENSUITE



SECOND ENSUITE



SHARED ENSUITE



LAUNDRY





PV-88

APRIL 1 2019

The Lilac

*REVISED - JUNE 10 2019.



→ Elevation A - 3,440 sq.ft.

↗ SOFFIT LIGHT LOCATION