



CONSTRUCTION SUMMARY

Lot: 7
Model: 40.03 A BROOKSIDE
Project/Phase: Pine Valley Forevergreen / 1

APPLIANCES

Invoice	Qty.	Description
2748 06May21 NoCat	1	APPLIANCES SPECIFICATIONS ATTACHED - SIGNED COPIES

CERAMIC

Invoice	Qty.	Description
2532 05May21 NoCat	1	MASTER ENSUITE: SHOWER NICHE [SHAMPOO SHELF] - COMPLETE WITH MATCHING MARBLE JAMBS ON 4 SIDES, STANDARD TILE, APPROX. 12 X 18 INSTALLED VERTICALLY - SEE PLAN FOR LOCATION
2746 05May21 NoCat	1	KITCHEN/BREAKFAST: VINTAGE SERIES, 5" WHITE OAK, NSS ENGINEERED HARDWOOD, 3/4" THK, SCULPTED TEXTURE, UVF FINISH - LEVEL 4 KITCHEN/BREAKFAST: DO NOT SUPPLY / INSTALL CERAMIC (CREDIT)

CONCRETE AND DRAIN

Invoice	Qty.	Description
2483 21Oct20 NoCat	1	BACK-FLOW PREVENTER VALVE

CROWN MOULDING

Invoice	Qty.	Description
2532 05May21 NoCat	1	GREAT ROOM: MODEL OPTIONS 40.03 - GREAT ROOM - OPT. WAFFLE CEILING , BEAM DETAIL AS PER PLAN (6 BOXES) OPTION # 1 CTR-B07
2532 05May21 NoCat	1	STUDY: MODEL OPTIONS 40.03 - STUDY- OPT. WAFFLE CEILING , BEAM DETAIL AS PER PLAN (4 BOXES) OPTION # 1 CTR-B07



CONSTRUCTION SUMMARY

Lot: 7
Model: 40.03 A BROOKSIDE
Project/Phase: Pine Valley Forevergreen / 1

DRYWALL

Invoice	Qty.	Description
2483 72,351 21Oct20 **	3	BASEMENT WINDOWS - UPGRADE BASEMENT WINDOW SIZE TO 30 " X 24" - 8" FRAME
2532 72,398 05May21	1	GREAT ROOM: MODEL OPTIONS 40.03 - GREAT ROOM - OPT. COFFERED CEILING AS PER PLAN
2532 72,397 05May21	1	GREAT ROOM: MODEL OPTIONS 40.03 - GREAT ROOM - OPT. WAFFLE CEILING , BEAM DETAIL AS PER PLAN (6 BOXES) OPTION # 1 CTR-B07
2532 72,401 05May21	1	STUDY: MODEL OPTIONS 40.03 - STUDY - OPT. COFFERED CEILING AS PER PLAN
2532 72,400 05May21	1	STUDY: MODEL OPTIONS 40.03 - STUDY- OPT. WAFFLE CEILING , BEAM DETAIL AS PER PLAN (4 BOXES) OPTION # 1 CTR-B07
2532 72,401 05May21	1	MAIN HALL: MODEL OPTIONS 40.03 - OPT. COFFERED CEILING AS PER PLAN
2532 05May21 NoCat	1	STUDY: MODEL OPTIONS 40.03 - STUDY - OPT. 8 FOOT HIGH DOUBLE FRENCH DOORS WITH FLAT CLEAR GLASS COMPLETE WITH BUILDERS STANDARD OFFERINGS
2532 05May21 NoCat	1	MASTER ENSUITE: SHOWER NICHE [SHAMPOO SHELF] - COMPLETE WITH MATCHING MARBLE JAMBS ON 4 SIDES, STANDARD TILE, APPROX. 12 X 18 INSTALLED VERTICALLY - SEE PLAN FOR LOCATION
2532 05May21 NoCat	1	THRU OUT 2ND FLOOR: INCREASE HEIGHT OF DOOR TO 8FT SECOND FLOOR - PER DOOR
2532 05May21 NoCat	1	BREAKFAST: UPGRADE TO 96" FRENCH DOOR ASSEMBLY



CONSTRUCTION SUMMARY

Lot: 7
Model: 40.03 A BROOKSIDE
Project/Phase: Pine Valley Forevergreen / 1

ELECTRICAL

Invoice	Qty.	Description
2483 72,351 21Oct20 **	3	BASEMENT WINDOWS - UPGRADE BASEMENT WINDOW SIZE TO 30 " X 24" - 8" FRAME
2532 72,281 05May21	1	GREAT ROOM: INTERIOR WALL OUTLET: ADDITIONAL 110V WALL INTERIOR RECEPTACLE ON EXISTING CIRCUIT FOR WALL MOUNTED TV - LOCATE APPROX 66" A.F.F. ABOVE FIREPLACE
2532 72,289 05May21	6	GREAT ROOM: 4" E/S LED INTERIOR POT LIGHT - GROUND FLOOR - EACH INCLUDED IN APS USE STANDARD SWITCH
2532 72,307 05May21	1	KITCHEN: FIXTURE: RELOCATE STANDARD CEILING MOUNT FIXTURE -LOCATE APPROX CENTERED ABOVE ISLAND - SEE PLAN
2532 72,280 05May21	1	KITCHEN: CEILING OUTLET: ADDITIONAL REINFORCED CEILING OUTLET - LOCATE APPROX CENTERED ABOVE ISLAND - SEE PLAN USE SAME SWITCH AS STANDARD
2532 72,303 05May21	1	KITCHEN: FIXTURE: UNDER CABINET FLUORESCENT LIGHT FIXTURES - DOES NOT INCLUDE (AND REQUIRES) LIGHT VALANCE
2532 72,289 05May21	7	KITCHEN: 4" E/S LED INTERIOR POT LIGHT - GROUND FLOOR - EACH SEE PLAN FOR LOCATION
2532 72,278 05May21	1	KITCHEN: ADDITIONAL INTERIOR SWITCH FOR POTLIGHTS
2532 72,282 05May21	1	KITCHEN: ADDITIONAL 220V RECEPTACLE ON A SEPARATE CIRCUIT - FOR BUILT-IN WALL OVEN - APPLIANCE NOT INCLUDED - DOES NOT INCLUDE BREAKER THAT IS TO BE INSTALLED BY LICENSED ELECTRICIAN AND ARRANGED BY HOMEOWNER AFTER CLOSING
2532 72,273 05May21	1	KITCHEN: 110V WALL RECEPTACLE ON SEPARATE CIRCUIT - GAS FIRED COOKTOP- FOR AUX. EQUIPMENT - NOT A STOVE PLUG
2532 72,289 05May21	4	BREAKFAST: 4" E/S LED INTERIOR POT LIGHT - GROUND FLOOR - EACH SEE PLAN FOR LOCATION
2532 72,278 05May21	1	BREAKFAST: ADDITIONAL INTERIOR SWITCH FOR POTLIGHTS
2532 72,289 05May21	4	DINING: 4" E/S LED INTERIOR POT LIGHT - GROUND FLOOR - EACH



CONSTRUCTION SUMMARY

Lot: 7
Model: 40.03 A BROOKSIDE
Project/Phase: Pine Valley Forevergreen / 1

ELECTRICAL

Invoice	Qty.	Description
2532 72,278 05May21	1	DINING: ADDITIONAL INTERIOR SWITCH FOR POTLIGHTS
2532 72,289 05May21	4	STUDY: 4" E/S LED INTERIOR POT LIGHT - GROUND FLOOR - EACH USE STANDARD SWITCH SEE PLAN FOR LOCATION
2532 72,290 05May21	6	UPPER HALL: 4" E/S LED INTERIOR POT LIGHT (INSULATED CEILING) - SECOND FLOOR - EACH USE STANDARD SWITCHES
2532 72,289 05May21	6	MAIN HALL: 4" E/S LED INTERIOR POT LIGHT - GROUND FLOOR - EACH IN LIEU OF STANDARD CEILING LIGHTS USE STANDARD SWITCHES



CONSTRUCTION SUMMARY

Lot: 7
Model: 40.03 A BROOKSIDE
Project/Phase: Pine Valley Forevergreen / 1

FRAMING

Invoice	Qty.	Description
2532 72,631 05May21	1	MASTER ENSUITE: SHOWER NICHE [SHAMPOO SHELF] - COMPLETE WITH MATCHING MARBLE JAMBS ON 4 SIDES, STANDARD TILE, APPROX. 12 X 18 INSTALLED VERTICALLY - SEE PLAN FOR LOCATION
2532 05May21 NoCat	1	GREAT ROOM: MODEL OPTIONS 40.03 - GREAT ROOM - OPT. COFFERED CEILING AS PER PLAN
2532 05May21 NoCat	1	GREAT ROOM: MODEL OPTIONS 40.03 - GREAT ROOM - OPT. WAFFLE CEILING , BEAM DETAIL AS PER PLAN (6 BOXES) OPTION # 1 CTR-B07
2532 05May21 NoCat	1	STUDY: MODEL OPTIONS 40.03 - STUDY - OPT. COFFERED CEILING AS PER PLAN
2532 05May21 NoCat	1	STUDY: MODEL OPTIONS 40.03 - STUDY- OPT. WAFFLE CEILING , BEAM DETAIL AS PER PLAN (4 BOXES) OPTION # 1 CTR-B07
2532 05May21 NoCat	1	MAIN HALL: MODEL OPTIONS 40.03 - OPT. COFFERED CEILING AS PER PLAN
2532 05May21 NoCat	1	STUDY: MODEL OPTIONS 40.03 - STUDY - OPT. 8 FOOT HIGH DOUBLE FRENCH DOORS WITH FLAT CLEAR GLASS COMPLETE WITH BUILDERS STANDARD OFFERINGS
2532 05May21 NoCat	1	THRU OUT 2ND FLOOR: INCREASE HEIGHT OF DOOR TO 8FT SECOND FLOOR - PER DOOR
2532 05May21 NoCat	1	BREAKFAST: UPGRADE TO 96" FRENCH DOOR ASSEMBLY

GLASS AND MIRROR

Invoice	Qty.	Description
2746 05May21 NoCat	2	MASTER ENSUITE + SHARED ENSUITE: UPGRADE SHOWER DOOR HARDWARE TO MT6X6 - CHROME



CONSTRUCTION SUMMARY

Lot: 7
Model: 40.03 A BROOKSIDE
Project/Phase: Pine Valley Forevergreen / 1

GRANITE MARBLE QUARTZ

Invoice	Qty.	Description
2746 05May21 NoCat	1	KITCHEN: UPGRADE QUARTZ COUNTERTOP - LEVEL 6
2746 74,433 05May21	2	KITCHEN: QUARTZ, 48" WATERFALL LEG (PRICE PER LEG) - LEVEL 6

HARDWOOD

Invoice	Qty.	Description
2746 7 05May21	1	KITCHEN/BREAKFAST: VINTAGE SERIES, 5" WHITE OAK, NSS ENGINEERED HARDWOOD, 3/4" THK, SCULPTED TEXTURE, UVF FINISH - LEVEL 4
2746 7 05May21	1	THRU OUT STANDARD AREAS: MAIN HALL, GREAT ROOM, DINING ROOM, STUDY, UPPER HALL, MASTER BEDROOM, BEDROOM 2, BEDROOM 3, BEDROOM 4, LOWER MEDIA ROOM - VINTAGE SERIES, 5" WHITE OAK, NSS ENGINEERED HARDWOOD, 3/4" THK, SCULPTED TEXTURE, UVF FINISH - LEVEL 4

HVAC

Invoice	Qty.	Description
2532 72,224 05May21	1	KITCHEN: GAS LINE ROUGH-IN - MAIN FLOOR FOR GAS COOKTOP

INTERIOR DOORS AND TRIM

Invoice	Qty.	Description
2532 72,402 05May21	1	STUDY: MODEL OPTIONS 40.03 - STUDY - OPT. 8 FOOT HIGH DOUBLE FRENCH DOORS WITH FLAT CLEAR GLASS COMPLETE WITH BUILDERS STANDARD OFFERINGS
2532 72,644 05May21	16	THRU OUT 2ND FLOOR: INCREASE HEIGHT OF DOOR TO 8FT SECOND FLOOR - PER DOOR
2532 05May21 NoCat	1	GREAT ROOM: MODEL OPTIONS 40.03 - GREAT ROOM - OPT. COFFERED CEILING AS PER PLAN



CONSTRUCTION SUMMARY

Lot: 7
Model: 40.03 A BROOKSIDE
Project/Phase: Pine Valley Forevergreen / 1

KITCHEN AND BATH CABINETRY

Invoice	Qty.	Description
2532 05May21 NoCat	1	KITCHEN: FIXTURE: UNDER CABINET FLUORESCENT LIGHT FIXTURES - DOES NOT INCLUDE (AND REQUIRES) LIGHT VALANCE
2532 05May21 NoCat	1	KITCHEN: GAS LINE ROUGH-IN - MAIN FLOOR FOR GAS COOKTOP
2746 05May21 NoCat	1	THRU OUT: SEE ATTACHED CABINETRY SCHEDULE
2746 05May21 NoCat	1	FYI - KITCHEN: QUARTZ, 48" WATERFALL LEG (PRICE PER LEG) - LEVEL 6
2748 06May21 NoCat	1	APPLIANCES SPECIFICATIONS ATTACHED - SIGNED COPIES
2980 22Jun22 NoCat	1	KITCHEN: REMAKE KITCHEN CABINETRY DOOR, PER PURCHASER REQUEST AYA CODE: W3045-24 ** Add-on sale - Closed House - Please arrange delivery direct with Home Owner for this item only.

NETWORK AND WIRING

Invoice	Qty.	Description
2532 72,259 05May21	1	GREAT ROOM: CONDUIT PIPE - FOR WALL MOUNT TV - LOCATE ABOVE FIREPLACE, APPROX 66" A.F.F., TERMINATING AT CABLE LOCATION - SEE PLAN
2532 72,258 05May21	1	GREAT ROOM: ADDITIONAL CAT6 ETHERNET OUTLET - EACH -SEE PLAN FOR LOCATION



CONSTRUCTION SUMMARY

Lot: 7
Model: 40.03 A BROOKSIDE
Project/Phase: Pine Valley Forevergreen / 1

PAINT

Invoice	Qty.	Description
2532 05May21 NoCat	1	GREAT ROOM: MODEL OPTIONS 40.03 - GREAT ROOM - OPT. COFFERED CEILING AS PER PLAN
2532 05May21 NoCat	1	GREAT ROOM: MODEL OPTIONS 40.03 - GREAT ROOM - OPT. WAFFLE CEILING , BEAM DETAIL AS PER PLAN (6 BOXES) OPTION # 1 CTR-B07
2532 05May21 NoCat	1	STUDY: MODEL OPTIONS 40.03 - STUDY - OPT. COFFERED CEILING AS PER PLAN
2532 05May21 NoCat	1	STUDY: MODEL OPTIONS 40.03 - STUDY- OPT. WAFFLE CEILING , BEAM DETAIL AS PER PLAN (4 BOXES) OPTION # 1 CTR-B07
2532 05May21 NoCat	1	MAIN HALL: MODEL OPTIONS 40.03 - OPT. COFFERED CEILING AS PER PLAN
2532 05May21 NoCat	1	STUDY: MODEL OPTIONS 40.03 - STUDY - OPT. 8 FOOT HIGH DOUBLE FRENCH DOORS WITH FLAT CLEAR GLASS COMPLETE WITH BUILDERS STANDARD OFFERINGS
2532 05May21 NoCat	1	THRU OUT 2ND FLOOR: INCREASE HEIGHT OF DOOR TO 8FT SECOND FLOOR - PER DOOR
2532 05May21 NoCat	1	BREAKFAST: UPGRADE TO 96" FRENCH DOOR ASSEMBLY



CONSTRUCTION SUMMARY

Lot: 7
Model: 40.03 A BROOKSIDE
Project/Phase: Pine Valley Forevergreen / 1

PLUMBING

Invoice	Qty.	Description
2532 72,332 05May21	1	KITCHEN: ROUGH-IN 1/4" COLD WATER LINE TO FRIDGE
2532 72,346 05May21	1	KITCHEN: ADD POT FILLER - MOEN 'MODERN' CHROME ROUGH-IN INCLUDED
2532 05May21 NoCat	1	MASTER ENSUITE: UPGRADE SHOWER SYSTEM TO MOEN 'ALIGN' RAIN SHOWER (from ceiling) + HAND SHOWER w/ SLIDE BAR - CHROME

STAIRS AND RAILINGS

Invoice	Qty.	Description
2746 05May21 NoCat	2	MAIN STAIRS - 2ND FLOOR TO BASEMENT: STAIN STAIRS AND LANDINGS WILL NOT MATCH HARDWOOD IN COLOUR, SPECIES, OR TEXTURE

WINDOWS AND DOORS

Invoice	Qty.	Description
2532 05May21 NoCat	1	BREAKFAST: UPGRADE TO 96" FRENCH DOOR ASSEMBLY
2483 72,351 21Oct20 **	3	BASEMENT WINDOWS - UPGRADE BASEMENT WINDOW SIZE TO 30 " X 24" - 8" FRAME

PV - 7 Cabinetry Schedule

ROOM	DESCRIPTION	PRICE	Q	TOTAL
KITCHEN	UPGRADE PERIMETER FROM SERIES 2 TO SERIES 6 - MEDIO 6 FOG		1	
	(UPGRADE ISLAND FROM SERIES 2 TO SERIES 6 - MEDIO 6 DUSK		1	
	NOTE: NO HARDWARE / NO HOLES THRU OUT - PURCHASER IS RESPONSIBLE FOR THE INSTALLATION OF THEIR OWN HARDWARE AFTER CLOSING AT THEIR OWN EXPENSE AND WARRANTY			
	*NOTE: RETURN TRIP FOR HARDWOOD IN KITCHEN IN LIEU OF STANDARD TILE		1	
	ADD CABINETRY VALANCE (ELECTRICAL INCLUDED IN APS)		1	
	ADD DECORATIVE HOOD FAN CANOPY - ASPEN		1	
	LEAVE 3" GAP ON EITHER SIDE OF CANOPY (N/C)		1	
	RELOCATE STANDARD BANK OF 4 DRAWERS TO ISLAND (N/C)		1	
	CONVERT STD BASE CABINETS TO BASE POTS AND PANS (ONE AT ISLAND, TWO AT PERIMETER)		3	
	ADD PROUD FURNITURE KICK TO REAR ISLAND		1	
	CONVERT STD UPPER AND BASE CABINETS TO TALL, DEEP BUILT IN OVEN UNIT W/ DRAWER BELOW		1	
	ADJUST CABINETRY FOR 36" RANGETOP (N/C)		1	
	ADD POTS AND PANS BELOW RANGETOP		1	
	ADD SPICE PULL OUT ACCESSORY TO BASE CABINET BESIDE RANGETOP		1	
	ADD BEVELLED GLASS INSERTS TO UPPER CABINETS FLANKING RANGE		1	
	ADD MATCHING INTERIOR TO GLASS CABINETS		1	
			\$	
CABINETRY TOTAL:				

HANDLE PLACEMENT: AT INSTALLERS DISCRETION

LOT #: PV - 7

DATE: May 4, 2021

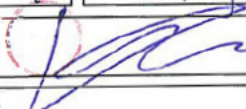
SIGNATURE: 

SIGNATURE:

Scheduled Closing Date: Wednesday, February 3, 2021

Purchaser: VANIA C SILVA FARIA

Property: 7 of Plan -

Telephone Res. / Bus: /

Project: Pine Valley Forevergreen - Phase 1

Decor Advisor: Amanda Ceresino

Model and Elevation: 40.03 A BROOKSIDE

Layout Changes: ☐ Yes ☒ No

Sketch Attached: ☒ Yes ☐ No

Exterior Colour Scheme:

1. Cabinetry

	Style and Colour	Counter	Hardware
Kitchen / Breakfast	*2-tone	*Quartz: Calacatta Gold	attachd
Laundry Room			
Powder Room	Bowery 'Ello'	Quartz: Ice Snow	attachd
MUD ROOM	Bowery 'Ello'	P-Lam - White	attachd
Master Ensuite Bathroom	Monterey maple 'Slate Grey'	Quartz: Ice Snow	attachd
Second Ensuite Bathroom (If Applicable)	Tribecca 'Stello'	Quartz: Ice Snow	attachd
Shared Ensuite	Chesapeake 'Pewter'	Quartz: Ice Snow	attachd

Comment

KITCHEN: Perimeter: Medio 6 'Fog' / Island: Medio 6 'Dusk'

2. Floor Tile

	Selection
Entrance Vestibule	13x13" Costa 'White'
Main Hall	
Kitchen / Breakfast	hardwood
Laundry Room	
Powder Room	13x13" Costa 'White'
Mud Room	13x13" Costa 'White'
Master Ensuite Bathroom	13x13" Costa 'White'
Second Ensuite Bathroom (If Applicable)	13x13" Cambridge 'White'
Lower Landing (If Applicable)	13x13" Costa 'White' (basement foyer)
Shared Bath	13x13" Cambridge 'Grey'

Comment

3. Wall Tile

	Selection	Listello/Inserts	Describe
Master Ensuite Bathroom		<input type="radio"/> Yes <input checked="" type="radio"/> No	
Tub Deck		<input type="radio"/> Yes <input checked="" type="radio"/> No	
Shower Stall	8x10" Weave 'White'	<input type="radio"/> Yes <input checked="" type="radio"/> No	
Bathroom Walls		<input type="radio"/> Yes <input checked="" type="radio"/> No	
Second Ensuite Bathroom (If Applicable)	8x10" Weave 'White'	<input type="radio"/> Yes <input checked="" type="radio"/> No	
Shared Bath	8x10" Weave 'White'	<input type="radio"/> Yes <input checked="" type="radio"/> No	
Kitchen Backsplash	<input type="radio"/> Yes <input checked="" type="radio"/> No	Backsplash Behind Fridge	

Comment

Scheduled Closing Date: Wednesday, February 3, 2021

Purchaser: VANIA C SILVA FARIA

Property: 7 of Plan -

Telephone Res. / Bus: /

Project: Pine Valley Forevergreen - Phase 1

Decor Advisor: Amanda Ceresino

Model and Elevation: 40.03 A BROOKSIDE

4. Plumbing Fixtures

<input type="text"/>	Second Ensuite	<input type="text"/>	Powder Room	<input type="text"/>	
Master Ensuite Bathroom	<input type="text"/>	Other Room - Specify	<input type="text"/>	Other Washroom	<input type="text"/>

Comment

See extras

5. Hardwood Flooring

	Type and Stain		Type and Stain
Main Hall	<input type="text"/>	Upper Landing	<input type="text"/>
Kitchen / Breakfast	*3/4x5" wht oak sculpted 'Apollo'	Upper Hall	<input type="text"/>
Living Room	<input type="text"/>	Master Bedroom	<input type="text"/>
Dining Room	<input type="text"/>	Bedroom #2	<input type="text"/>
Family Room	<input type="text"/>	Bedroom #3	<input type="text"/>
Den/Library	<input type="text"/>	Bedroom #4	<input type="text"/>
Entrance Vestibule	<input type="text"/>	Bedroom #5	<input type="text"/>
Lower Landing (If Applicable)	<input type="text"/>	Other Room - Specify	<input type="text"/>
		Thru out standard areas	*3/4x5" wht oak sculpted 'Apollo'

Comment

6. Carpeting

	Upgrade	Description
Ground Floor	<input type="checkbox"/>	<input type="text"/>
Second Floor	<input type="checkbox"/>	<input type="text"/>
<input type="text"/>	<input type="checkbox"/>	<input type="text"/>

Upgrade Underpad	Type	Area
	<input type="text"/>	<input type="text"/>
Carpet on Stairs	Capped	Runner - *Upgrade
	<input type="text"/>	<input type="text"/>

Comment

7. Fireplace

	Living Room			Family Room			Other Room - Specify		
	Purchased	As Per Plan	N/A	Purchased	As Per Plan	N/A	Purchased	As Per Plan	N/A
Fireplace Type	<input type="radio"/>	<input type="radio"/>	<input checked="" type="radio"/>	<input type="radio"/>	<input checked="" type="radio"/>	<input type="radio"/>	<input type="radio"/>	<input type="radio"/>	<input checked="" type="radio"/>
Mantle Type	<input type="text"/>			Standard Gas			<input type="text"/>		
Colour / Stain	<input type="text"/>			Mediterranean			<input type="text"/>		
Surround	<input type="text"/>			Arctic White			<input type="text"/>		
Hearth	<input type="text"/>			n/a			<input type="text"/>		
	<input type="text"/>			none			<input type="text"/>		

Comment

Scheduled Closing Date: Wednesday, February 3, 2021

Purchaser: VANIA C SILVA FARIA

Property: 7 of Plan -

Telephone Res. / Bus: /

Project: Pine Valley Forevergreen - Phase 1

Decor Advisor: Amanda Ceresino

Model and Elevation: 40.03 A BROOKSIDE

8. Trim Carpentry

Interior Doors Carrara Front Door Glass Inserts Standard Door Handles Standard

Interior Trim Standard package

Comment

9. Plaster Mouldings and Medallions

Standard Throughout ☐ Yes ☐ No ☒ N/A

Entrance Vestibule			Kitchen/Breakfast		
Main Hall			Den/Library		
Living Room			Lower Landing		
Dining Room			Other Room - Specify		
Family Room					

Comment

10. Railings and Spindles

Railing Package	Standard 2	
Railing Colour	*Hopscotch	Spindle Colour *Hopscotch
Stringer / Riser	*Hopscotch	Treads *Hopscotch

Comment

Oak Stairs ☒ Yes ☐ No ☐ N/A

11. Wall Paint / Ceilings

Throughout Finished Areas Warm Grey

Trim Paint White

Smooth Ceilings

Ground Floor ☒Second Floor ☒

Note

Comment

Scheduled Closing Date: Wednesday, February 3, 2021

Purchaser: VANIA C SILVA FARIA

Property: 7 of Plan -

Telephone Res. / Bus: /

Project: Pine Valley Forevergreen - Phase 1

Decor Advisor: Amanda Ceresino

Model and Elevation: 40.03 A BROOKSIDE

12. Electrical

Hood Fan ☐ White ☐ Stainless ☐ N/A

Above Kitchen Cabinet Light ☐ Yes ☒ No

Below Kitchen Cabinet Light ☒ Yes ☐ No

Standard Appliances ☐

Over The Range Microwave ☐

Chimney Style Fan ☐

Comment

13. Heating and Air Conditioning

Air Conditioning

Gas Provisions Stove

Gas Provisions Dryer

Gas Provisions Barbecue

Comment

14. Additional Comments

15. Disclaimers and Notes

- 1) Colours of all materials are as close as possible to builder's selection, but not necessarily identical due to variances in manufacturing.
- 2) Any extras listed above are null and void unless accompanied by a separate invoice/amendment. Said invoice must be paid in full.
- 3) The Purchaser acknowledges that after Interior Colour Selection form is signed and dated, no further changes will be permitted other than re-selection due to unavailability. _____ Purchaser's Initials
- 4) The Purchaser acknowledges reading and accepting the "Gold Park Homes Decor Centre Disclaimers" form. This document contains other miscellaneous disclaimers.

This Interior Colour Selection is final and approved by:

Signature:  Date: _____



(No trace)

 $^{33}\text{R.S.O}$

29
WALL
MIN.

PV-7
May 4, 2021

GOLDPARK HOMES
PINE VALLEY
VAUGHAN, ONTARIO
MODEL: (4003) BROOKSIDE

SITE STANDARD: WHITE 3/4" EXTENSION
SOFT-CLOSE DRAWERS & STANDARD SLAM DOOR HINGES
TO VANITIES

ONE TOP DRAWER WHERE POSSIBLE THROUGHOUT EACH
VANITY, ONE BANK OF DRAWERS WHERE POSSIBLE
THROUGHOUT EACH MASTER ENSUITE VANITY

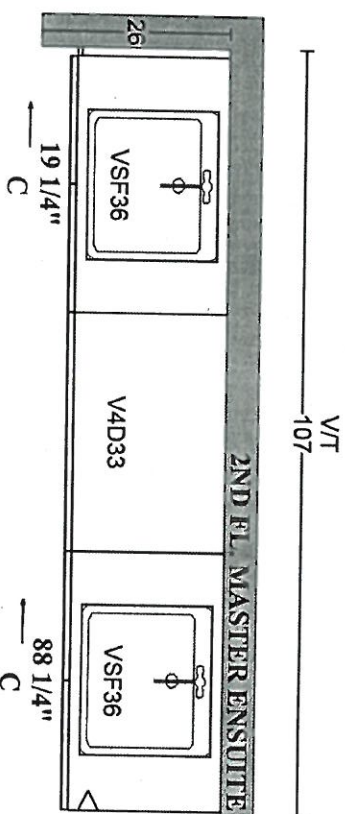
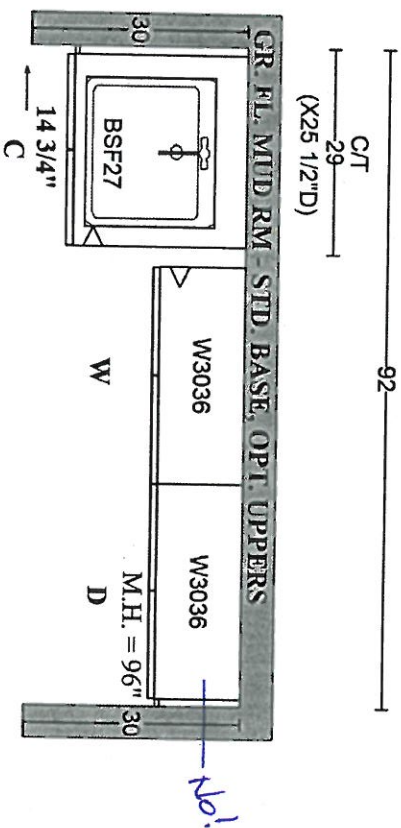
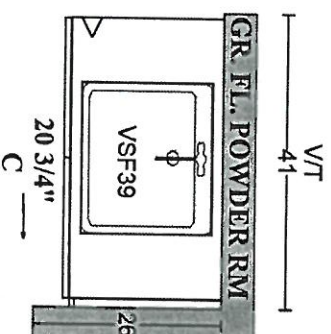
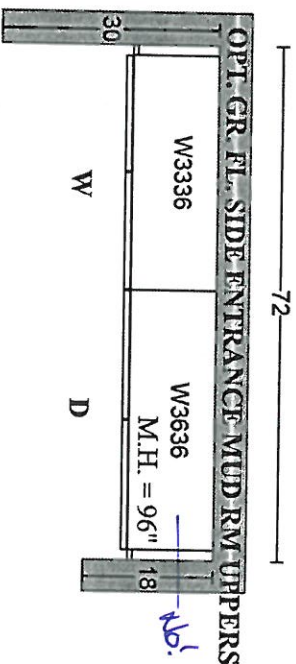
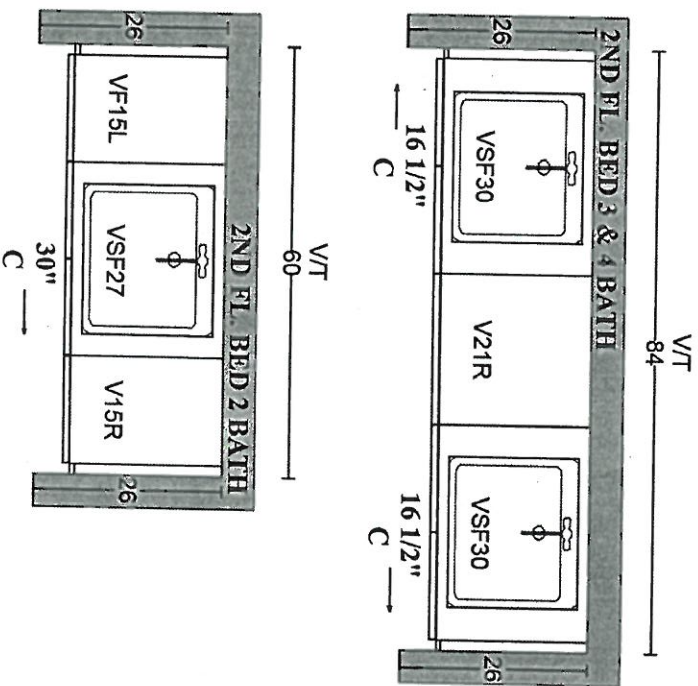

PLAN VIEW

SCHEDULE 'F'



PV-7
May 4, 2021

PV-7
Oct 19 2020
Dec 11 2020

The Brookside 40' SERIES

Elevation A • 3,380 sq.ft.
Elevation B • 3,350 sq.ft.

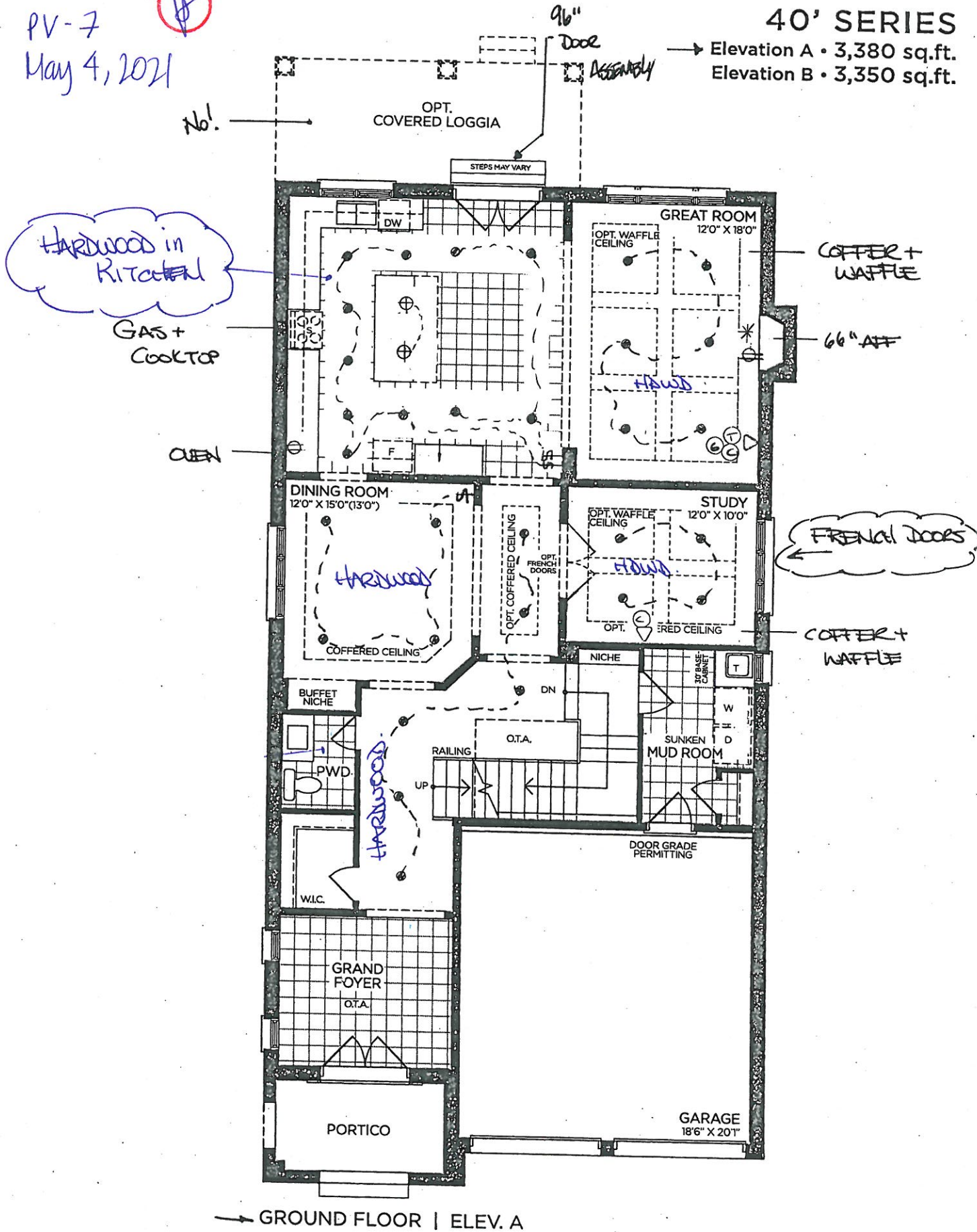

VENDOR

PURCHASER

PURCHASER

GOLDPARK
WORTH MORE™

Prices, figures, illustrations, sizes, features and finishes are subject to change without notice. Areas and dimensions are approximate and actual usable floor space may vary from the stated area. Layout may be reverse of the unit purchased. E. & O.E. 4003

SCHEDULE 'F'



PV-7
 OCT. 19 2020
 DEC 11 2020
 PV-7 ~~11~~
 May 4, 2021

The
Brookside
 40' SERIES
 Elevation A • 3,380 sq.ft
 Elevation B • 3,350 sq.ft

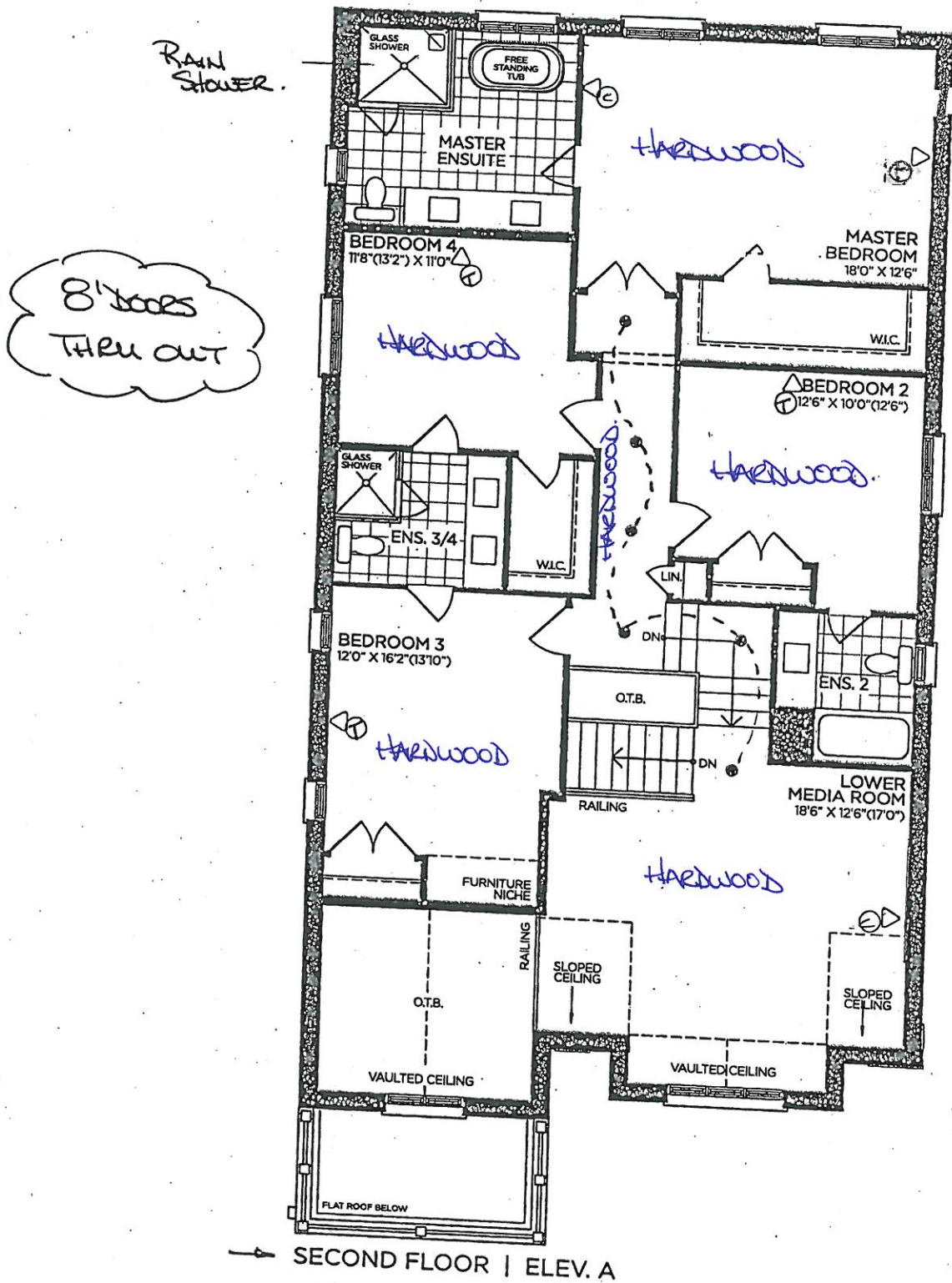

VENDOR

PURCHASER

PURCHASER

GOLDPARK
 WORTH MORE™

Prices, figures, illustrations, sizes, features and finishes are subject to change without notice. Areas and dimensions are approximate and actual usable floor space may vary from the stated area. Layout may be reverse of the unit purchased. E. & O.E. 4003

SCHEDULE 'F'



PV-7
OCT 10 2020
DEC 11 2020
PV-7
May 4, 2021
24x30"

The
Brookside
40' SERIES

→ Elevation A • 3,380 sq.ft.
Elevation B • 3,350 sq.ft.

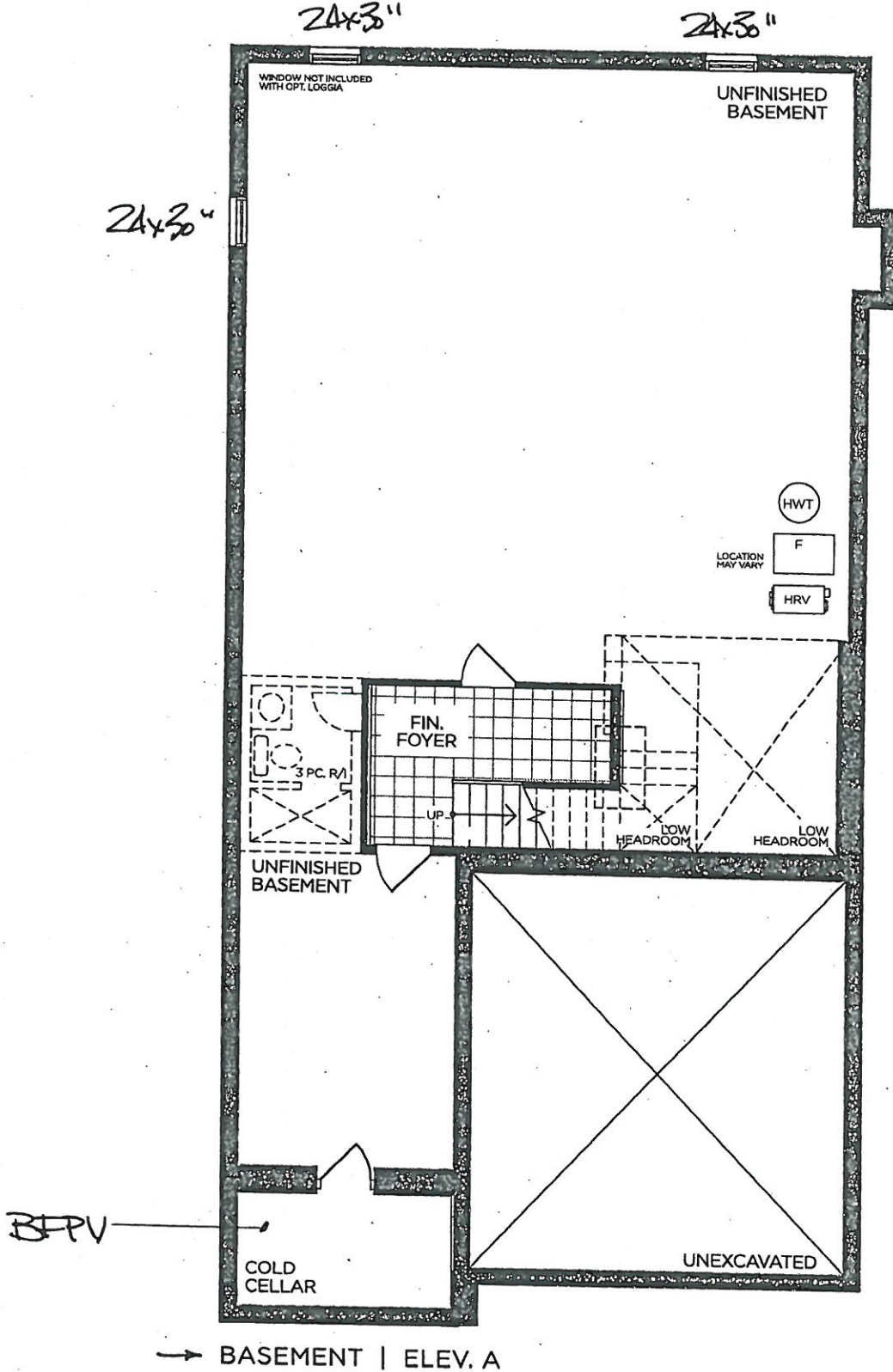

→ BASEMENT | ELEV. A

VENDOR
PURCHASER
PURCHASER

GOLDPARK
WORTH MORE™

Prices, figures, illustrations, sizes, features and finishes are subject to change without notice. Areas and dimensions are approximate and actual usable floor space may vary from the stated area. Layout may be reverse of the unit purchased. E. & O.E. 4003



PINE VALLEY
FOREVERGREEN

STONE COUNTERTOP EDGE PROFILES



STANDARD 2CM EASED EDGE



LOCATION:

THRU OUT

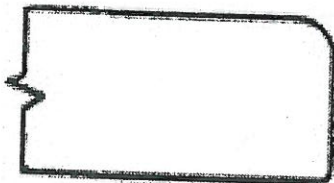

UPGRADE 3CM EASED EDGE

LOCATION:

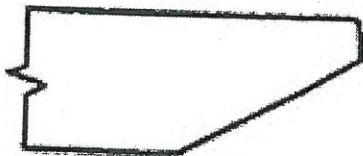

UPGRADE 4CM MITRED EDGE

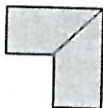

LOCATION:



UPGRADE 2CM OGEE EDGE

LOCATION:

LOT #: PV-7

DATE: May 4, 2021

SIGNATURE:

SIGNATURE:

STANDARD HARDWARE / HANDLES

☐

H001-02

☐

H001-03

☐

H001-04

☐

H009-03

☐

H009-09

☐

H011-03

☐

H011-05

☐

H011-06

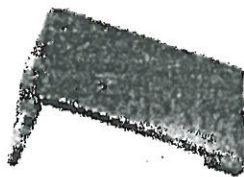
☒

H033-01

POWDER + MUD.

☒

H039-03

MASTER +
ENS 2+
STAGED

☒

*NO HARDWARE

KITCHEN

LOT # PV-7

DATE: May 4, 2021

SIGNATURE:

SIGNATURE:



PINE VALLEY
FOREVERGREEN

UPGRADE SHOWER HARDWARE

MT6X6

Shower Door Handle

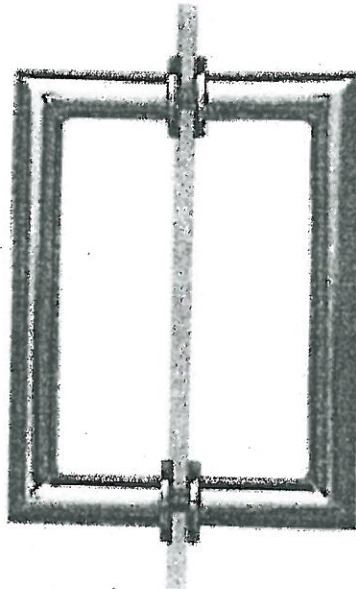

MT6X6
Shower Door Handle

6" x 6" back-to-back
3/4" dia. tube
Cut and mitred corners with
washers
(Also available single sided)

- ☒ CHROME
☐ MATTE BLACK
☐ BRUSHED GOLD

Lot# PV-7

Date: May 4, 2021

Room: Master Ensuite, Ensuite 3/4

Signature:

Signature:

BATHROOM ACCESSORIES



PINE VALLEY

FOREVERGREEN

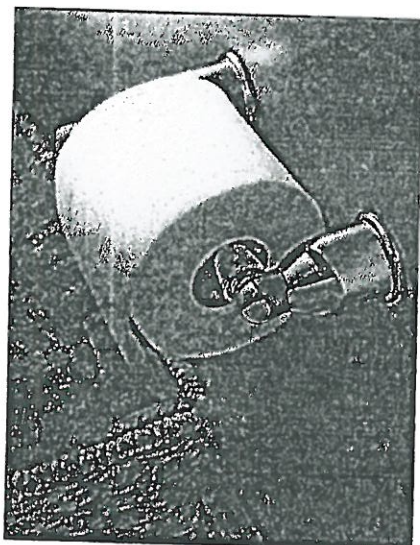

Tissue Holder
Mason - Chrome

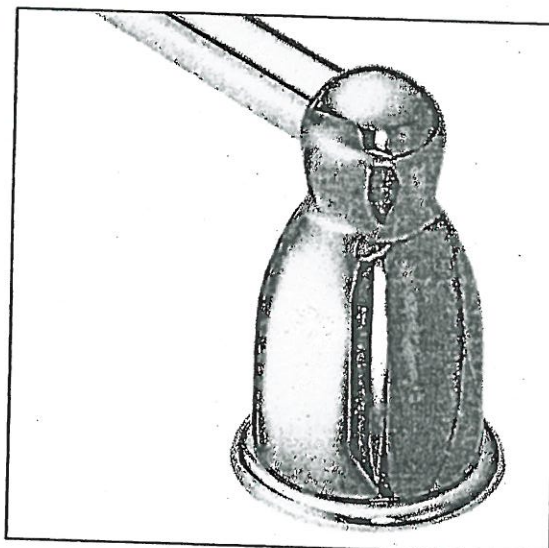

Towel Bar
Mason - Chrome

Please select one of the following:

☒ INSTALL STANDARD BATHROOM ACCESSORIES THRU OUT
(tissue holder + towel bar) **location as per vendors discretion**

☐ ***DO NOT*** INSTALL STANDARD BATHROOM ACCESSORIES
THRU OUT **tissue holder + towel bar will not be provided**

LOT # PV-7

DATE: May 4, 2021

SIGNATURE:

SIGNATURE:



Project: Pine Valley

Lot: 7

Purchaser(s): Vania C. Silva Faria

Standard Hood Fan Deletion

We acknowledge that the builder's standard hood fan will not be installed.
Do not supply, install and/or credit. We will install our own hood fan after closing.

Signature: _____

Signature: _____

Date: May 4, 2021

UPGRADE KITCHEN EXTRA



ASPEN RANGE HOOD

(Insert fan not included)

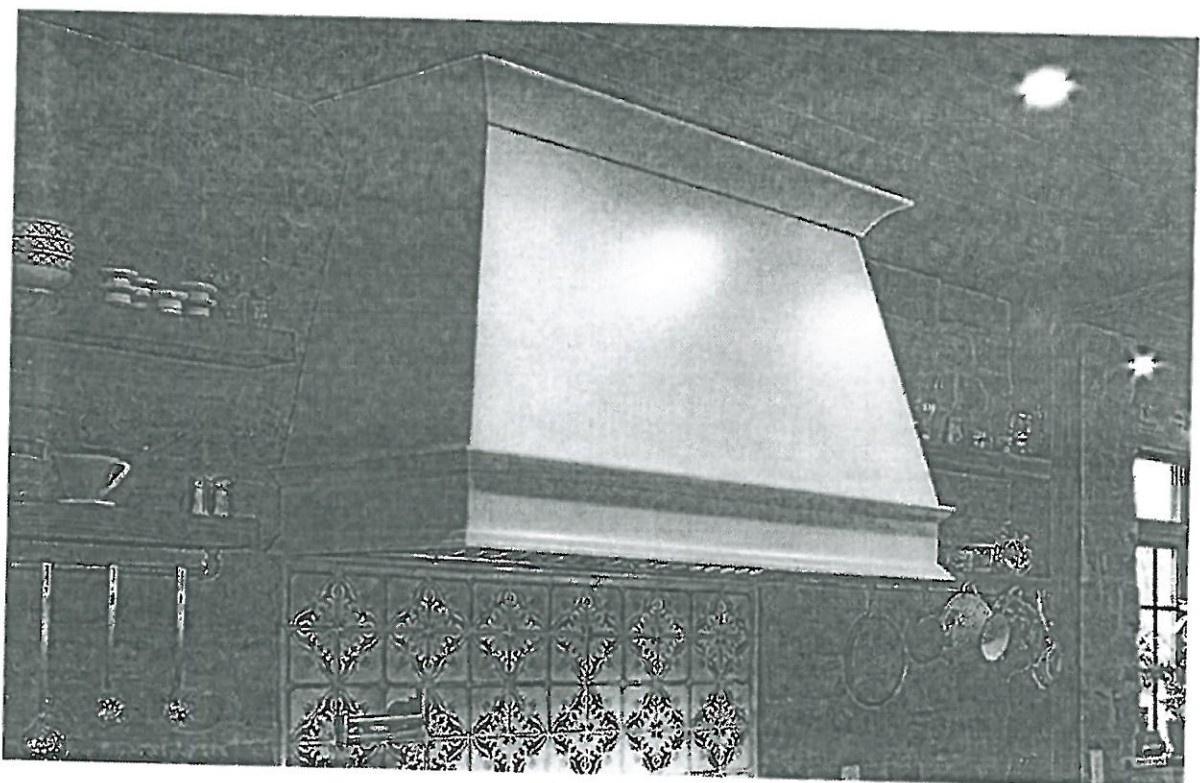

LOT # PV-7

DATE: May 4, 2021

ROOM: Kitchen

SIGNATURE:

A handwritten signature in blue ink, written over a red circular stamp.

SIGNATURE:

UPGRADE KITCHEN EXTRA

MOEN - MODERN

Pot Filler

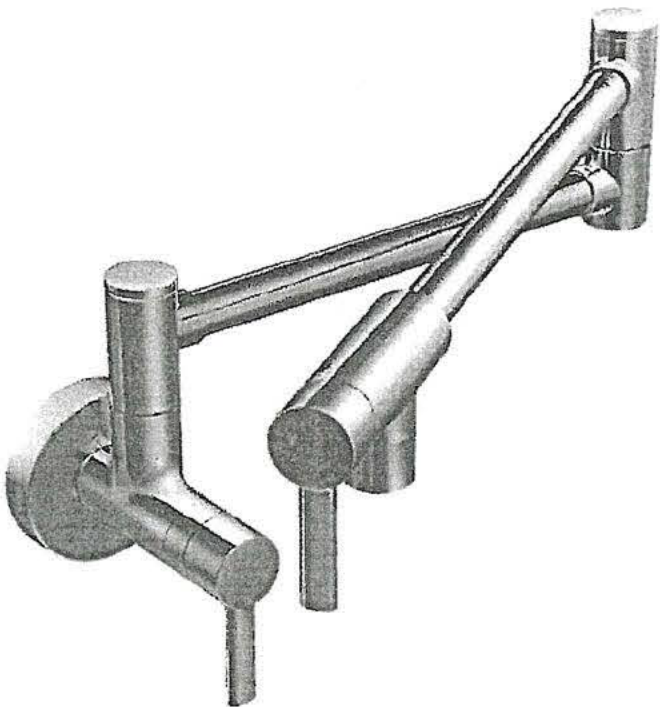

- ☒ CHROME
- ☐ STAINLESS (SRS)
- ☐ BRUSHED GOLD (BG)
- ☐ MATTE BLACK (BL)

MODEL: S665 (SRS, BG, BL) Pot Filler

Lot# PV- 7	Date: Dec. 11, 2020.	Room: Kitchen.
Signature:		
Signature:		

UPGRADE PLUMBING

MOEN - ALIGN
3 Function SHOWER ONLY* Rain Shower and Handshower



MODEL: T2192EP Shower: Trim Only* / T4191 Transfer Trim + 3372 Transfer Valve / 62320 1/2" CC Valve / 3887EP Handshower + A725 Drop El / 2166S1 Shower Arm (from ceiling) / S6360 Showerhead

LOT #: PV-7	DATE: Dec. 11, 2020.	ROOM: Master Ensuite.
SIGNATURE:		
SIGNATURE:		

PV-7 
May 5, 2024

DIMENSIONS

COMMERCIAL-STYLE RANGETOPS

1 of 24

PRODUCT DIMENSIONS

MODEL #	30" (76.2 cm) Rangetop KCGC500J		36" (91.4 cm) Rangetop KCGC506J		48" (121.9 cm) Rangetop KCGC558J	
	in	cm	in	cm	in	cm
Overall Width (A)	29 3/4	75.6	35 3/4	90.8	47 3/4	121.3
Grate Depth (B)	22	55.9	22	55.9	22	55.9
Depth without Control Panel (C)	23 3/4	59.1	23 3/4	59.1	23 3/4	59.1
Depth with Control Panel Overhang (D)	27 3/4	70.8	27 3/4	70.8	27 3/4	70.8
Depth with Knobs (E)	29 3/4	74.6	29 3/4	74.6	29 3/4	74.6

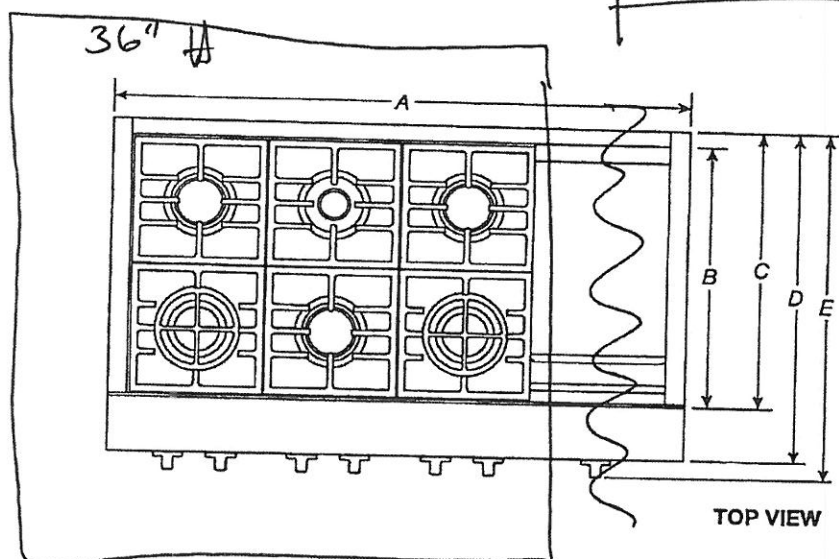

PV-7 (A)
May 5, 2021

DIMENSIONS

COMMERCIAL-STYLE RANGETOPS

2 of 24

PRODUCT DIMENSIONS

MODEL #	30" (76.2 cm) Rangetop KCGC500J		36" (91.4 cm) Rangetop KCGC506J		48" (121.9 cm) Rangetop KCGC558J	
Unit of Measurement	in	cm	in	cm	in	cm
Grate Width (F)*	27 ¹ / ₁₆	69.7	33	83.8	44 ¹ / ₁₆	112.7
Gas Inlet to Surface (G)	10 ¹ / ₄	27.3	10 ¹ / ₄	27.3	10 ¹ / ₄	27.3
Center to Gas Inlet (H)	11	27.9	14 ¹ / ₁₆	35.9	19 ¹ / ₁₆	49.8
Recessed Rangetop Width (I)	29 ¹ / ₁₆	74	35 ¹ / ₁₆	89.2	47 ¹ / ₁₆	119.7

*Includes width of grates and griddle.

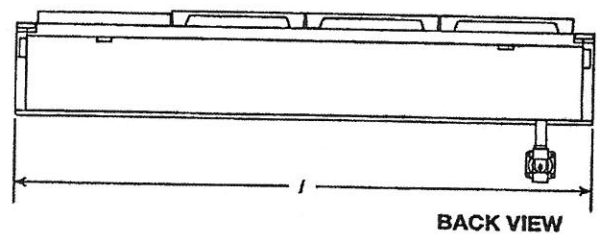
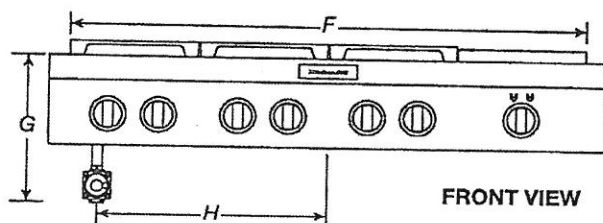

PV-7 ~~4~~
May 5, 2021

DIMENSIONS

COMMERCIAL-STYLE RANGETOPS

3 of 24

PRODUCT DIMENSIONS

MODEL #	30" (76.2 cm) Rangetop KCGC500J		36" (91.4 cm) Rangetop KCGC506J		48" (121.9 cm) Rangetop KCGC558J	
	in	cm	in	cm	in	cm
Height with Grates (J)	9	22.9	9	22.9	9	22.9
Control Panel Height (K)	7 ¹³ / ₁₆	19.8	7 ¹³ / ₁₆	19.8	7 ¹³ / ₁₆	19.8
Recessed Rangetop Height (L)	7	17.8	7	17.8	7	17.8
Cooking Surface Height (M)	7 ⁷ / ₁₆	18.9	7 ⁷ / ₁₆	18.9	7 ⁷ / ₁₆	18.9
Recessed Rangetop Depth (N)	21 ¹ / ₄	55.6	21 ¹ / ₄	55.6	21 ¹ / ₄	55.6
Depth with Control Panel (O)	25 ¹ / ₂	64.8	25 ¹ / ₂	64.8	25 ¹ / ₂	64.8

IMPORTANT: Supplied regulator does not come preattached and is pictured for reference purposes only.

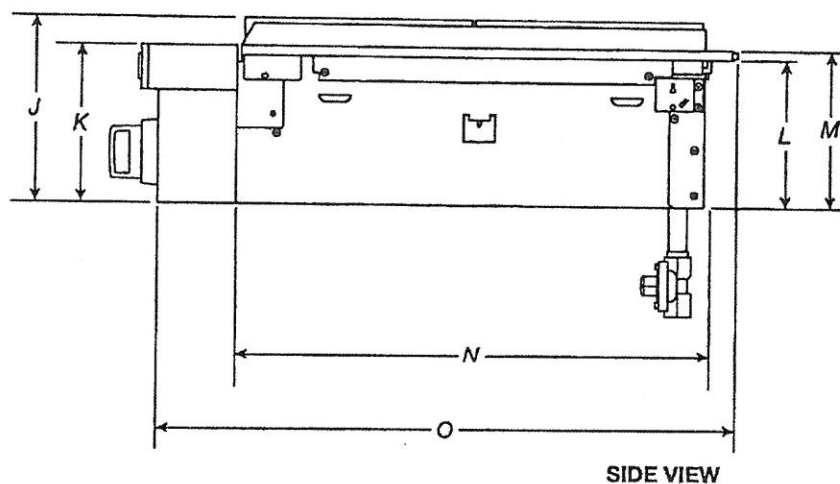

SIDE VIEW

PV-7 
 May 5, 2021

DIMENSIONS

COMMERCIAL-STYLE RANGETOPS
 OPENING/CLEARANCE DIMENSIONS

MODEL #	30" (76.2 cm) Rangetop KCGC500J		36" (91.4 cm) Rangetop KCGC506J		48" (121.9 cm) Rangetop KCGC558J	
Unit of Measurement	in	cm	in	cm	in	cm
Combustible Area above Cooking Surface Width (min.) (A)	30	76.2	36	91.4	48	121.9
Bottom of Cabinet Height above Cooking Surface (min.) (B)*	42	106.7	58	147.3	58	147.3
Bottom of Cabinet Height above Countertop (min.) (C)	18	45.7	18	45.7	18	45.7
Distance to Fixed Wall or Combustible Material (D)	12	30.5	12	30.5	12	30.5

*If installing a hood above the rangetop, follow the hood instructions for dimensional clearances above the cooking surface.

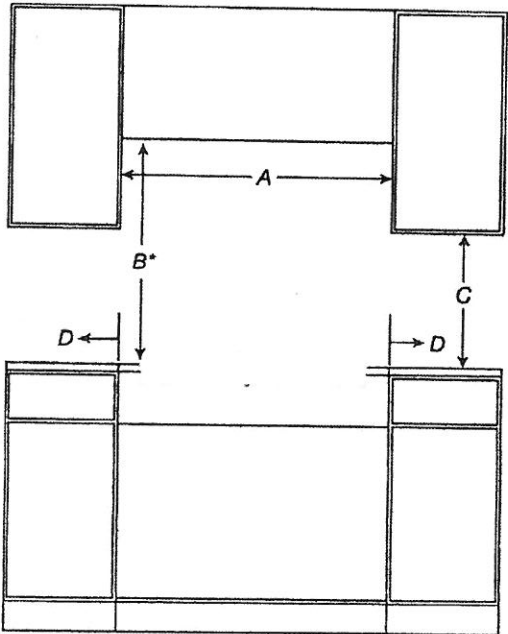

FRONT VIEW

PV-7 
 May 5, 2021

DIMENSIONS

COMMERCIAL-STYLE RANGETOPS 5 of 24
 OPENING/CLEARANCE DIMENSIONS

36" 

MODEL #	30" (76.2 cm) Rangetop KCGC500J		36" (91.4 cm) Rangetop KCGC506J		48" (121.9 cm) Rangetop KCGC558J	
Unit of Measurement	in	cm	in	cm	in	cm
Recommended Upper Cabinet Depth (E)	13	33	13	33	13	33
Cutout to Wall Depth (if backwall is constructed of non-combustible material) (F)*	1 3/4	4.4	1 3/4	4.4	1 3/4	4.4
Cutout to Wall Depth (if backwall is constructed of combustible material) (F)*	7 3/4	19.7	7 3/4	19.7	7 3/4	19.7
Cabinet to Countertop Height (G)**	7 3/4	18.4	7 3/4	18.4	7 3/4	18.4
Cabinet Depth (H)	24	61	24	61	24	61

*If the back wall is constructed of a combustible material and a backsplash is not installed, a 7 3/4" (19.7 cm) minimum clearance is required from the cutout or 6" (15.2 cm) minimum clearance from the back edge of the rangetop.

**The bottom of the cutout supports the product. Unlike many cooktops, these models do not hang from the side flanges, but rather sit on the floor of the cutout.

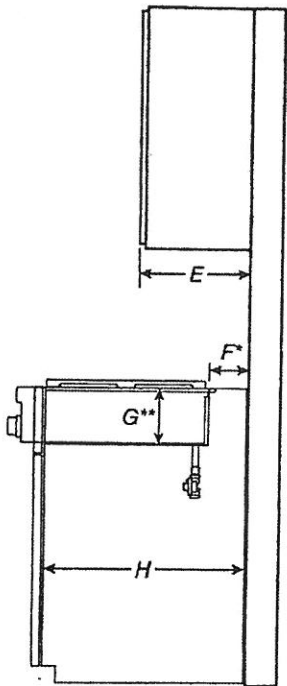

SIDE VIEW

PV-7 (V)

May 5, 2021

DIMENSIONS

COMMERCIAL-STYLE RANGETOPS

ELECTRICAL REQUIREMENTS

ELECTRIC REQUIREMENTS CHECKLIST

- ☐ A 120 V, 60 Hz, AC only, 15 A fused, electrical circuit is required.
- ☐ A dedicated circuit is recommended.

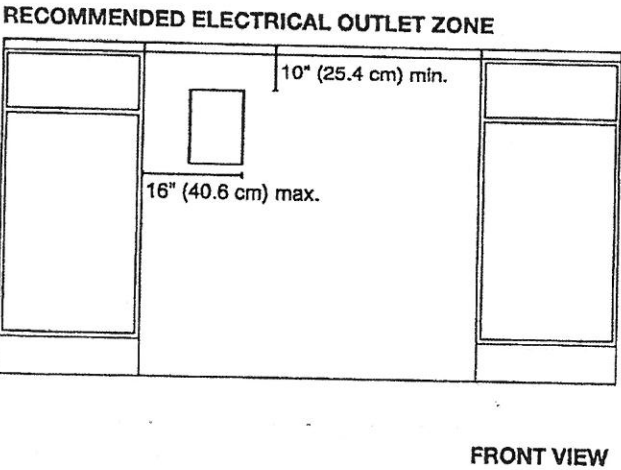

NOTE: If you have questions about your electrical supply, call a licensed, qualified electrician.

PV-7 
 May 5, 2021

DIMENSIONS

COMMERCIAL-STYLE RANGETOPS

8 of 24

GAS REQUIREMENTS

RECOMMENDED GAS SUPPLY LOCATION

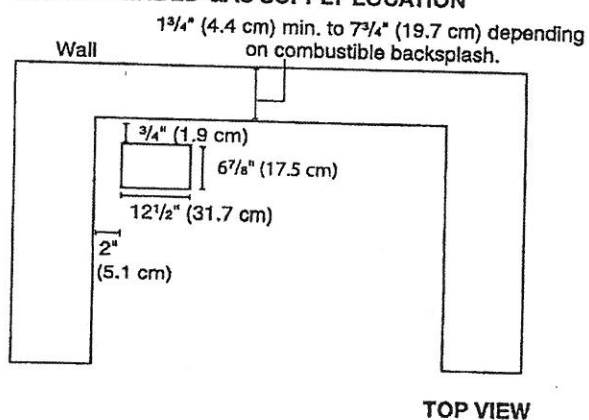

GAS SUPPLY ZONE

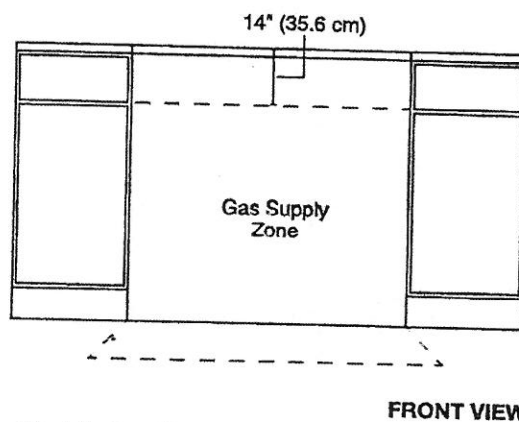

*If the back wall is constructed of a combustible material and a backsplash is not installed, a $7\frac{1}{2}"$ (19.1 cm) minimum clearance is required from the cutout or 6" (15.2 cm) minimum clearance from the back edge of the rangetop.

**Unlike many cooktops, these models do not hang from the side flanges, but rather sit on the floor of the cutout. The grey box pictured in the image above on the left is a hole in the cutout for the gas and electric lines to pass through.

NOTE: If you have questions about your gas supply, call a licensed, qualified service technician.

PV-7

May 5, 2021

KitchenAid® 27" (68.6 cm) and 30" (76.2 cm) Electric Built-In Microwave/Oven Combination

PRODUCT MODEL NUMBERS

KEMS309E KOCE500E KOCE507E

ELECTRICAL CONNECTION

If codes permit and a separate ground wire is used, it is recommended that a qualified electrical installer determine that the ground path and the wire gauge are in accordance with local codes. Check with a qualified electrical installer if you are not sure the oven is properly grounded.

This oven must be connected to a grounded metal, permanent wiring system.

Be sure that the electrical connection and wire size are adequate and in conformance with the National Electrical Code, ANSI/NFPA 70-latest edition or CSA Standards C22.1-94, Canadian Electrical Code, Part 1 and C22.2 No. 0-M91-latest edition, and all local codes and ordinances.

To properly install your oven, you must determine the type of electrical connection you will be using and follow the instructions provided for it here.

- Oven must be connected to the proper electrical voltage and frequency as specified on the model/serial/rating plate. See the following illustration.

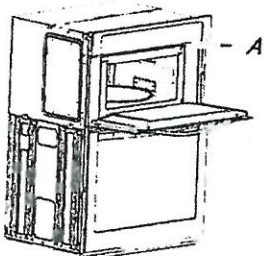

A. Model/serial/rating plate

- Models rated from 7.3 to 9.6 kW at 240 volts (5.4 to 7.4 kW at 208 volts) require a separate 40-amp circuit. Models rated at 4.8 kW and below at 240 volts (3.6 kW and below at 208 volts) require a separate 30-amp circuit.
- A circuit breaker is recommended.
- Connect directly to the fused disconnect (or circuit breaker box) through flexible, armored or nonmetallic sheathed, copper cable (with grounding wire). See "Make Electrical Connection" section.
- Flexible conduit from the oven should be connected directly to the junction box.
- Do not cut the conduit. The length of conduit provided is for serviceability of the oven.
- A UL listed or CSA approved conduit connector must be provided.
- If the house has aluminum wiring, follow the procedure below:
 1. Connect a section of solid copper wire to the pigtail leads.
 2. Connect the aluminum wiring to the added section of copper wire using special connectors and/or tools designed and UL listed for joining copper to aluminum.

Follow the electrical connector manufacturer's recommended procedure. Aluminum/copper connection must conform with local codes and industry accepted wiring practices.

For power requirements, refer to the following table.

Model	Voltage	Amperage (L1)*	Amperage (L2)*	Rating (W)
-------	---------	----------------	----------------	------------

PRODUCT DIMENSIONS

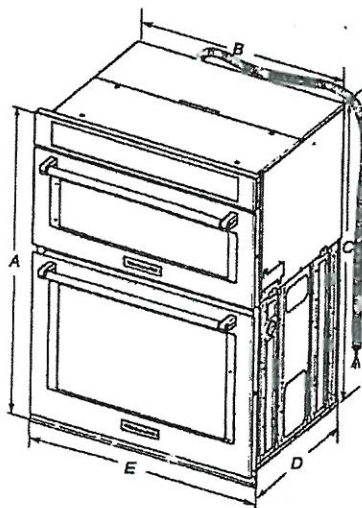

- 27" (68.6 cm) models**
- A. 42 1/8" (108.0 cm) overall height
 - B. 25 1/8" (64.6 cm) recessed width
 - C. 41" (104.1 cm) recessed height
 - D. 23 1/4" (59.1 cm) max. recessed depth
 - E. 27" (68.6 cm) overall width
 - F. 48" (121.9 cm) flexible conduit length measured from the conduit clamp located at the rear of the oven. Do not remove the conduit clamp.
- 30" (76.2 cm) models**
- A. 42 1/8" (108.0 cm) overall height
 - B. 28 1/8" (72.3 cm) recessed width
 - C. 41" (104.1 cm) recessed height
 - D. 23 1/4" (59.1 cm) max. recessed depth
 - E. 30" (76.2 cm) overall width
 - F. 48" (121.9 cm) flexible conduit length measured from the conduit clamp located at the rear of the oven. Do not remove the conduit clamp.

Cabinet Dimensions

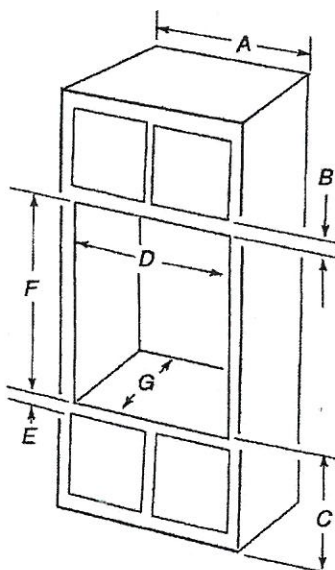

- 27" (68.6 cm) models**
- A. 27" (68.6 cm) min. cabinet width
 - B. 1" (2.5 cm) top of cutout to bottom of upper cabinet door
 - C. 19 1/4" (48.9 cm) bottom of cutout to floor is recommended. 4"-19 1/4" (10.2-48.9 cm) bottom of cutout to floor is acceptable.
 - D. 25 1/2" (64.8 cm) cutout width
 - E. 1 1/2" (3.8 cm) min. bottom of cutout to top of cabinet door
 - F. 41 1/8" (105 cm)* recommended cutout height
 - G. 24" (60.7 cm) cutout depth
- 30" (76.2 cm) models**
- A. 30" (76.2 cm) min. cabinet width
 - B. 1" (2.5 cm) top of cutout to bottom
 - C. 19 1/4" (48.9 cm) bottom of cutout to floor is recommended. 4"-19 1/4" (10.2-48.9 cm) bottom of cutout to floor is acceptable.
 - D. 28 1/2" (72.4 cm) cutout width
 - E. 1 1/2" (3.8 cm) min. bottom of cutout
 - F. 41 1/8" (105 cm)* recommended cutout
 - G. 24" (60.7 cm) cutout depth

* NOTE: The cabinet height can be between 41" (104.1 cm) and 41 1/2" (105.6 cm) for microwave/oven combination.

PV-7 (14)

May 5, 2021

KitchenAid® French Door Bottom Mount Refrigerator with Ice Dispenser
(KRFC704F, KRFC604F)

PRODUCT DIMENSIONS

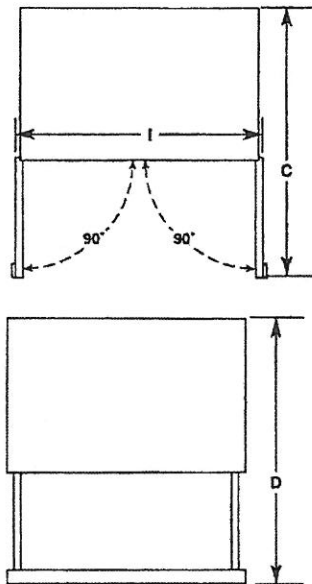
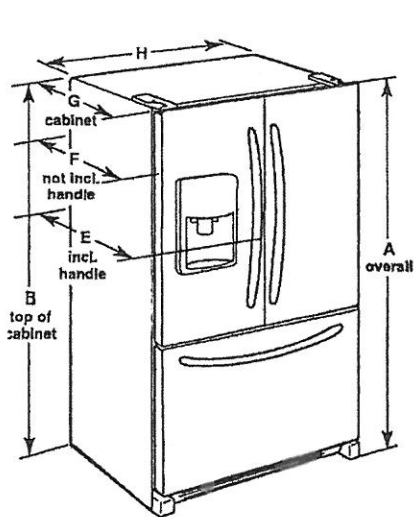

Model Number	KRFC704F, KRFC604F
Model Size	23.8 cu. ft. (673.9 L)
Height - Overall "A"	71 ¹ / ₄ " (182.6 cm)
Height - Top of Cabinet "B"	70 ⁷ / ₈ " (180.0 cm)
Depth - Doors Open 90° "C"	43 ³ / ₄ " (111.1 cm)
Depth - Drawer Open "D"	45 ⁷ / ₈ " (116.5 cm)
Depth - With Handles "E"	31 ¹ / ₂ " (80.0 cm)
Depth - Without Handles "F"	28 ⁷ / ₈ " (73.3 cm)
Depth - Cabinet Only "G"	24 ¹ / ₄ " (61.9 cm)
Width - Cabinet "H"	35 ⁵ / ₈ " (90.5 cm)
Width - Door Open 90° "I"	43 ³ / ₄ " (110.8 cm)

⚠ WARNING



Electrical Shock Hazard

- Plug Into a grounded 3 prong outlet.
- Do not remove ground prong.
- Do not use an adapter.
- Do not use an extension cord.
- Failure to follow these instructions can result in death, fire, or electrical shock.

Electrical: A 115 V, 60 Hz., AC only, 15 or 20 A fused, grounded electrical supply is required. It is recommended that a separate circuit serving only your freezer be provided. Use an outlet that cannot be turned off by a switch. Do not use an extension cord.

Water: A cold water supply with water pressure between 35 and 120 psi (241 and 827 kPa) is required to operate the water dispenser and ice maker. If you have questions about your water pressure, call a licensed, qualified plumber.

NOTE: If the water pressure is less than what is required, the flow of water from the water dispenser could decrease or ice cubes could be hollow or irregular shaped.

Reverse Osmosis Water Supply

IMPORTANT: The pressure of the water supply coming out of a reverse osmosis system going to the water inlet valve of the refrigerator needs to be between 35 and 120 psi (241 and 827 kPa).

If a reverse osmosis water filtration system is connected to your home cold water supply, the water pressure to the reverse osmosis system needs to be a minimum of 40 to 50 psi (276 to 414 kPa).

PV-7 (S)
May 5, 2021

KitchenAid® French Door Bottom Mount Refrigerator with Ice Dispenser

LOCATION REQUIREMENTS

⚠ WARNING



Explosion Hazard
Keep flammable materials and vapors, such as gasoline, away from refrigerator.
Failure to do so can result in death, explosion, or fire.

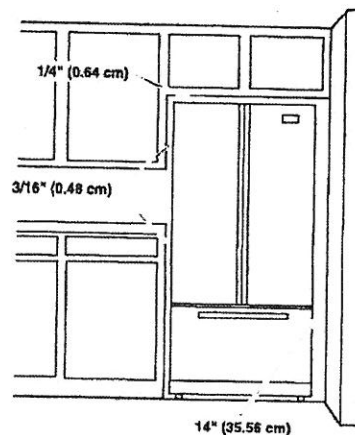

IMPORTANT: This refrigerator is designed for indoor and household use only.

To ensure proper ventilation for your refrigerator, allow for a 3/16" (0.48 cm) of space on each side and 1/4" (0.64 cm) space at the top. Allow for a 1" (2.54 cm) space behind the refrigerator. If your refrigerator has an ice maker, allow extra space at the back for the water line connections. When installing your refrigerator next to a fixed wall, leave a 14" (35.56 cm) minimum space between the refrigerator and wall to allow the door to swing open.

NOTE: This refrigerator is intended for use in a location where the temperature ranges from a minimum of 55°F (13°C) to a maximum of 110°F (43°C). The preferred room temperature range for optimum performance, which reduces electricity usage and provides superior cooling, is between 60°F (15°C) and 90°F (32°C). It is recommended that you do not install the refrigerator near a heat source, such as an oven or radiator.

PV-7 (2)
May 5, 2021

KitchenAid®

24" Dishwasher

DETAILED PLANNING DIMENSIONS GUIDE

Applies to all model numbers starting with;

KDFE104K, KDTE104K, KDFE204K, KDTE204K, KDTE304LPA,
KDFM404K, KDTM404K, KDPM604K, KDTM604K, KDPM704K,
KDTM704K, KDTM704LPA, KDPM804K, KDTM804K

PRODUCT DIMENSIONS

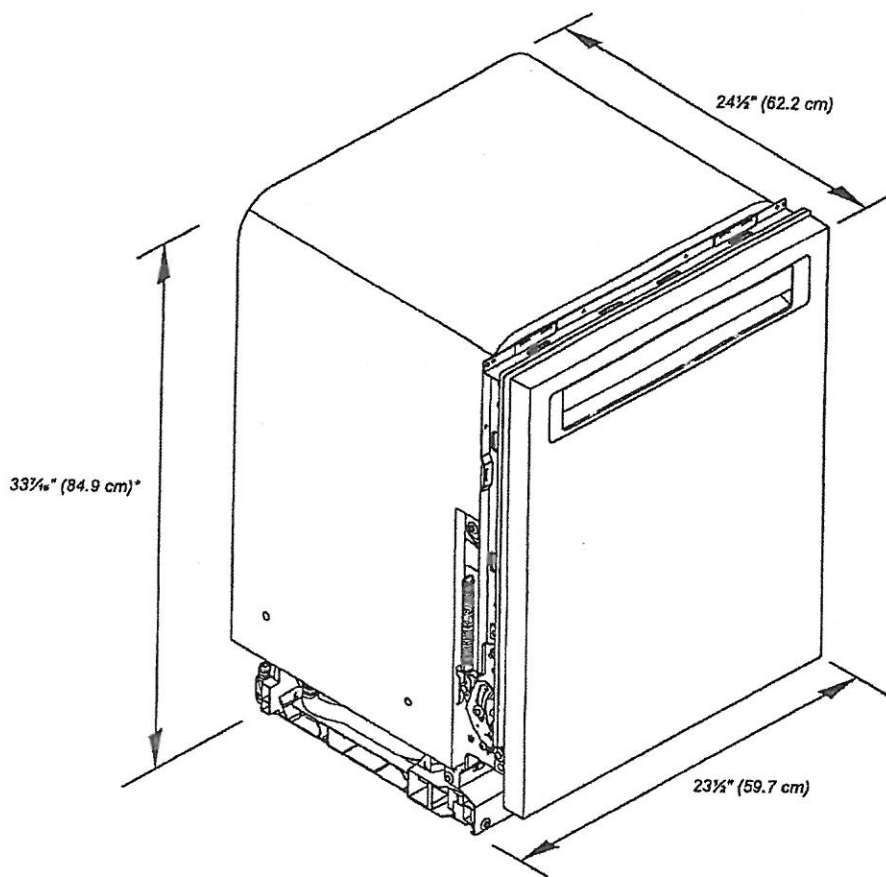

*Dishwasher can be raised 1 1/8" (3.7 cm) with feet fully extended.

PV-7 (H)
May 5, 2021

KitchenAid® 24" Dishwasher

DETAILED PLANNING DIMENSIONS GUIDE

PRODUCT DIMENSIONS (CONTD.)

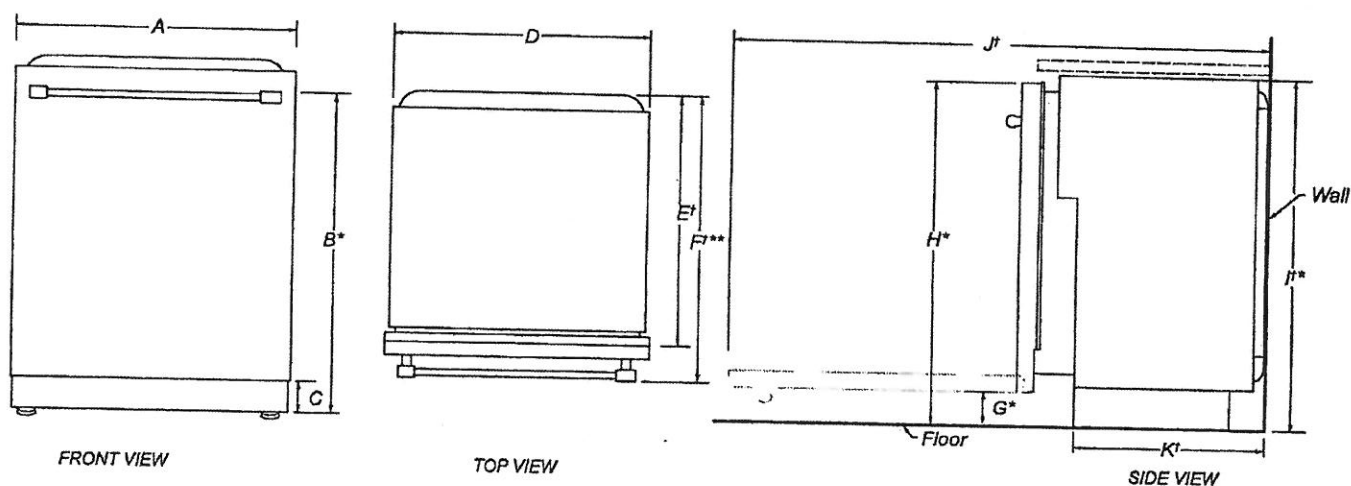

	DESCRIPTION	DIMENSIONS
A	Width of door	23½" (59.7 cm)
B*	Height to top of handle	30⅜" (78.3 cm)
C	Height of adjustable toe kick	3⅝" (8.4 cm) - min. 4⅞" (11.8 cm) - max.
D	Width of recessed dishwasher	22⅝" (57.4 cm)
E†	Depth without door	22⅝" (57.5 cm)
F**	Depth with Towel Bar Handle	26⅝" (68.3 cm)
	Depth with Pocket Handle	24½" (62.6 cm)
	Depth of Panel-Ready Models	24" (61.0 cm)
G*	Height to bottom of door (min.)	3⅝" (8.4 cm)
H*	Height to top of door (min.)	33⅞" (84.9 cm)
I*	Height of recessed dishwasher (min.)	33⅝" (85.4 cm)
J†	Depth with door fully open (min.)	50⅝" (127.4 cm)
K†	Depth with toe kick (min.)	20⅞" (52.9 cm)

†Insulation blanket thickness adds up to 11/16" (1.8 cm) but can crush up to 1/8" (0.3 cm).

*Dishwasher can be raised 1⅞" (3.7 cm) with feet fully extended.

**For panel-ready models, dishwasher depth is 24" (61.0 cm), not including the 3/4" (1.9 cm) custom door panel.

PV-7 
May 5, 2021

KitchenAid® 24" Dishwasher

DETAILED PLANNING DIMENSIONS GUIDE

OPENING/CLEARANCE DIMENSIONS

IMPORTANT: Check that all surfaces have no protrusions that would prohibit dishwasher installation.

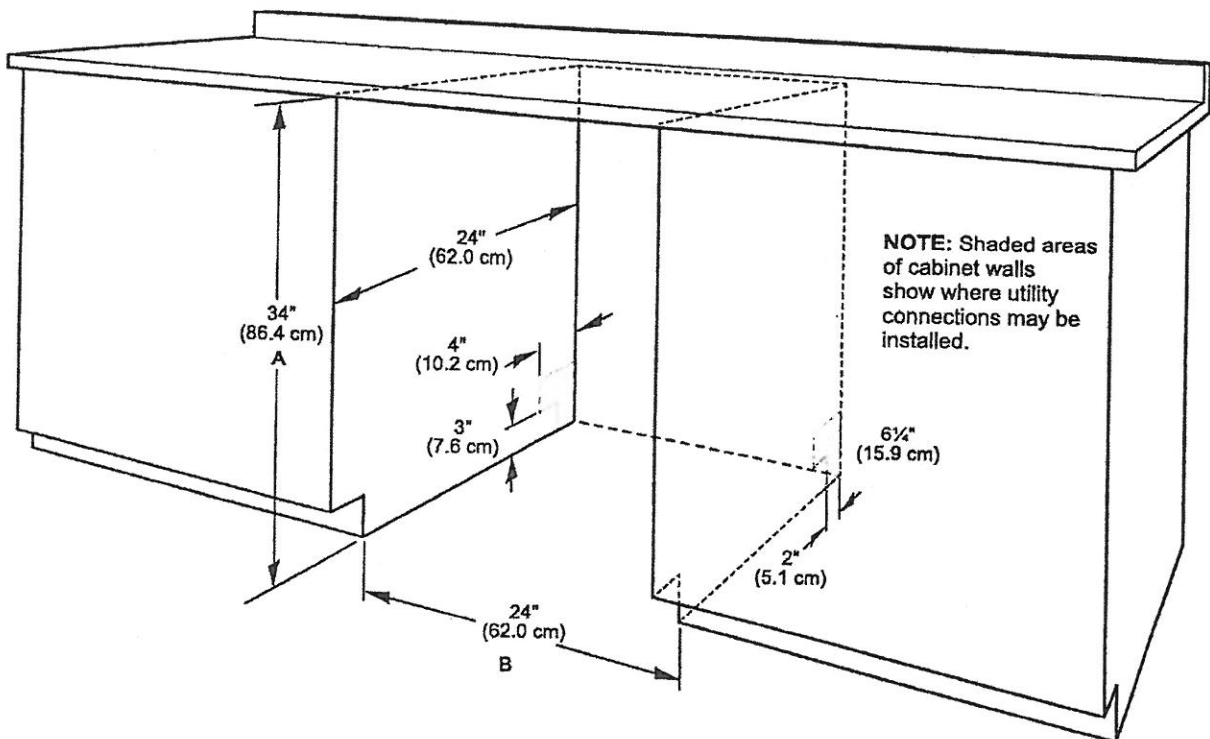

A. Measured from the lowest point on the underside of the countertop. May be reduced to 33 1/2" (85.1 cm) by removing the wheels and perforated area of insulation (blanket) on dishwasher.

B. Minimum, measured from narrowest point of opening.

NOTE: Corner locations require a 2" (5.1 cm) minimum clearance between the side of the dishwasher door and the wall or cabinet.

CLOSED TO IN-PERSON VISITS. REQUEST A VIRTUAL APPOINTMENT

Tasco Appliances

Home COOKING VENTILATION HOOD INSERTS CP551Q369SB

BEST BY BROAN CP551Q369SB



PV-7



May 5, 2021

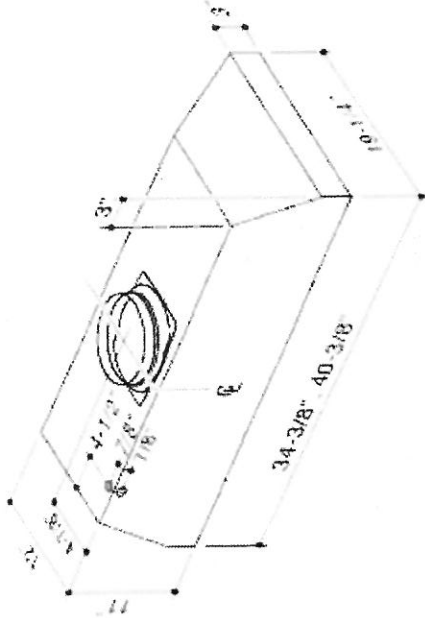

Welcome to Tasco Appliances!

2. PREPARE INSTALLATION

⚠ WARNING

When performing installation, servicing or cleaning the unit, it is recommended to wear safety glasses and gloves.

NOTE: Before proceeding to the installation, check the contents of the box. If items are missing or damaged, contact the manufacturer.

Make sure that the following items are included:

- Power Pack
- Accessories
 - Hybrid baffle filters with handles (3 for 36" width power pack, 4 for 42" width power pack and 5 for 48" to 66" width power packs)
 - 8" round adapter and damper (included with CP551Q power pack series)
 - 10" round in-line vertical damper (included with CP571QT power pack series)
 - 10" round adapter (included with CP571QT power pack series)
 - Bag of parts including: 1 wire clamp, 2 wire connectors, 4 no. 8 x 3/8" screws, 9 no. 8 x 1/2" chrome plated screws, 10 no. 8-32 x 1/4" screws (not used with this product, please discard).

Parts sold separately:

- ACR Series remote control kit
- In-line blower assembly model ILB3, ILB6, ILB9 or ILB11.
- Exterior blower assembly model EB6, EB9, EB12 or EB15.
- Ducts, elbows, wall and roof caps. Refer to page 3 and 4 for a complete list of venting options and model numbers.
- Non-duct kit ANKCP55 Series, mandatory for non-ducted installation.

NOTE: During installation, protect countertop and/or cooktop.

3. CUSTOM HOOD PREPARATION

⚠ WARNING

When building a custom hood, always follow all applicable construction codes and standards.

The custom hood must be constructed to fit the size and shape of the CP551Q, CP571QT or the CP57E power pack. See chart and illustration for details.

POWER PACK		TOTAL WEIGHT	POWER PACK DIMENSIONS		
MODEL	WIDTH		A*	B*	C
CP551Q	36"	52 LB.	19½"6"	347/16"	4¼"
	42"	62 LB.	19½"6"	407/16"	4¾"
CP571Q	36"	62 LB.	19½"6"	347/16"	5¾"
	48"	72 LB.	19½"6"	467/16"	5¾"
	48"	72 LB.	22½"6"	467/16"	5¾"
	54"	82 LB.	22½"6"	527/16"	5¾"
	60"	85 LB.	22½"6"	587/16"	5¾"
	66"	88 LB.	22½"6"	647/16"	5¾"
CP57E	36"	40 LB.	22½"6"	347/16"	6"
	48"	53 LB.	22½"6"	467/16"	6"
	60"	66 LB.	22½"6"	587/16"	6"

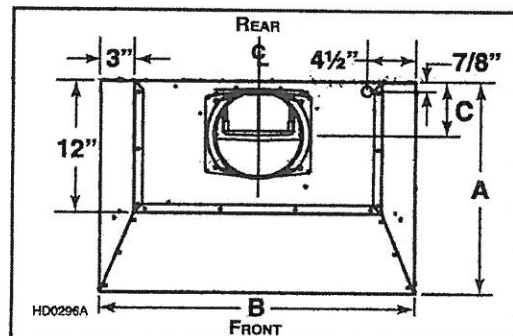

* Dimensions A and B include rivets head.

To minimize the gap around the power pack, take actual width and depth measurements of power pack and add 1/16" to get **D** and **E** measurements. Cut the hole in the bottom of the cabinet according to dimensions. See chart and illustration for details.

POWER PACK		CUTOUT DIMENSIONS	
MODEL	WIDTH	D	E
CP551Q	36"	19 $\frac{3}{8}$ "	34 $\frac{1}{2}$ "
	42"	19 $\frac{3}{8}$ "	40 $\frac{1}{2}$ "
CP571QT	36"	19 $\frac{3}{8}$ "	34 $\frac{1}{2}$ "
	48"	19 $\frac{3}{8}$ "	46 $\frac{1}{2}$ "
	48"	22 $\frac{5}{8}$ "	46 $\frac{1}{2}$ "
	54"	22 $\frac{5}{8}$ "	52 $\frac{1}{2}$ "
	60"	22 $\frac{5}{8}$ "	58 $\frac{1}{2}$ "
	66"	22 $\frac{5}{8}$ "	64 $\frac{1}{2}$ "
CP57E	36"	22 $\frac{5}{8}$ "	34 $\frac{1}{2}$ "
	48"	22 $\frac{5}{8}$ "	46 $\frac{1}{2}$ "
	60"	22 $\frac{5}{8}$ "	58 $\frac{1}{2}$ "

