



CONSTRUCTION SUMMARY

Lot: 48

Model: 50.03 A OAKGROVE OPT. 5 BEDROOM

Project/Phase: Pine Valley Forevergreen / 1

APPLIANCES

Invoice	Qty.	Description
2936 72,217 10Dec21 **	1	KITCHEN - UPGRADE TO 8" DUCT ( EXTERIOR WALL) IN LIEU OF STANDARD OFFERING

CERAMIC

Invoice	Qty.	Description
2947  11Mar22 NoCat	1	FRONT FOYER: UPGRADE 7 FLOOR TILE - 30X30" LAID IN STRAIGHT, STACKED PATTERN.
2947  11Mar22 NoCat	1	FRONT FOYER: UPGRADE GROUT
2947  11Mar22 NoCat	1	POWDER ROOM: UPGRADE 5 HEX FLOOR TILE
2947  11Mar22 NoCat	1	POWDER ROOM: UPGRADE FLOOR GROUT
2947  11Mar22 NoCat	1	MUDROOM + OUTSIDE POWDER ROOM: UPGRADE 5 HEX FLOOR TILE
2947  11Mar22 NoCat	1	MUD ROOM: UPGRADE FLOOR GROUT
2947  11Mar22 NoCat	1	MASTER ENSUITE: UPGRADE 9 FLOOR TILE: 30X60" LAID IN STRAIGHT, STACKED PATTERN. SEE PLAN FOR TILE DIRECTION
2947  11Mar22 NoCat	1	MASTER ENSUITE: UPGRADE 9 WALL TILE - 30X60" LAID IN HORIZONTAL STACKED PATTERN.
2947  11Mar22 NoCat	1	MASTER ENSUITE SHOWER FLOOR: UPGRADE 7 MARBLE MOSAIC
2947  11Mar22 NoCat	1	MASTER ENSUITE - FLOOR + SHOWER WALL + SHOWER FLOOR: UPGRADE GROUT
2947  11Mar22 NoCat	1	SHARED ENSUITE 2/5: UPGRADE 3 FLOOR TILE - 12X24" LAID IN STRAIGHT, STACKED PATTERN. SEE PLAN FOR TILE DIRECTION



CONSTRUCTION SUMMARY

Lot: 48

Model: 50.03 A OAKGROVE OPT. 5 BEDROOM

Project/Phase: Pine Valley Forevergreen / 1

CERAMIC

Invoice	Qty.	Description
2947  11Mar22 NoCat	1	SHARED ENSUITE 2/5: UPGRADE 1 WALL TILE - 3X6"
2947  11Mar22 NoCat	1	SHARED ENSUITE 2/5: LAY WALL TILE IN HERRINGBONE PATTERN
2947  11Mar22 NoCat	1	SHARED ENSUITE 2/5: FLOOR + WALL TILE - UPGRADE GROUT
2947  11Mar22 NoCat	1	SHARED ENSUITE 3/4: UPGRADE 3 BATHROOM FLOOR TILE + SHOWER FLOOR TILE - HEX
2947  11Mar22 NoCat	1	SHARED ENSUITE 3/4: UPGRADE 4 WALL TILE - 2X10"
2947  11Mar22 NoCat	1	SHARED ENSUITE 3/4: LAY WALL TILE IN HORIZONTAL BRICK PATTERN.
2947  11Mar22 NoCat	1	SHARED ENSUITE 3/4: UPGRADE GROUT - FLOOR + SHOWER FLOOR + SHOWER WALL
2947  11Mar22 NoCat	1	LAUNDRY ROOM: UPGRADE 4 FLOOR TILE - 8X8" INSTALLED IN STRAIGHT STACKED 'RANDOM' PATTERN
2947  11Mar22 NoCat	1	LAUNDRY ROOM: UPGRADE GROUT ON FLOOR

CONCRETE AND DRAIN

Invoice	Qty.	Description
2799  08Jun21 NoCat	1	BACK-FLOW PREVENTER VALVE



CONSTRUCTION SUMMARY

Lot: 48

Model: 50.03 A OAKGROVE OPT. 5 BEDROOM

Project/Phase: Pine Valley Forevergreen / 1

CROWN MOULDING

Invoice	Qty.	Description
2947  11Mar22 NoCat	1	KITCHEN: CEILING DETAIL: ADD 3 BOX WAFFLE + BEAM DETAIL - SEE ATTACHED SKETCH
2947  11Mar22 NoCat	1	GREAT ROOM: CEILING DETAIL: ADD 3 BOX WAFFLE + BEAM DETAIL - SEE ATTACHED SKETCH

DRYWALL

Invoice	Qty.	Description
2799  08Jun21 NoCat	1	MASTER BEDROOM: MODEL OPTIONS 50.03. A - MASTER BEDROOM - OPT. SITTING AREA 10 FOOT TRAY CEILING - AS PER PLAN
2936 72,377 10Dec21	1	LIVING ROOM: ADD OPT. COFFERED CEILING AS PER PLAN
2936 72,377 10Dec21	1	GREAT ROOM: MODEL OPTIONS GREAT ROOM - OPT. COFFERED CEILING AS PER PLAN
2936 72,377 10Dec21	1	KITCHEN / BREAKFAST : ADD COFFERED CEILING AS PER PLAN
2936 72,324 10Dec21 **	2	GARAGE DOOR OPENER (CHAMBERLAIN BELT DRIVE) - WITH 1 REMOTE - PRICE IS PER DOOR
2936  10Dec21 NoCat	1	**CUSTOM LAYOUT** LIVING / DINING: DELETE OPENING, CREATE FULL WALL PARTITION BETWEEN LIVING/DINING



CONSTRUCTION SUMMARY

Lot: 48

Model: 50.03 A OAKGROVE OPT. 5 BEDROOM

Project/Phase: Pine Valley Forevergreen / 1

ELECTRICAL

Invoice	Qty.	Description
2936 72,281 10Dec21	1	GREAT ROOM: INTERIOR WALL OUTLET: ADDITIONAL 110V WALL INTERIOR RECEPTACLE ON EXISTING CIRCUIT FOR WALL MOUNTED TV - LOCATE APPROX 66" A.F.F. ABOVE FIREPLACE
2936 72,281 10Dec21	1	MASTER BEDROOM - SITTING ROOM: INTERIOR WALL OUTLET: ADDITIONAL 110V WALL INTERIOR RECEPTACLE ON EXISTING CIRCUIT FOR WALL MOUNTED TV - LOCATE APPROX 42" A.F.F. ABOVE FIREPLACE
2936 72,291 10Dec21	5	*EXTERIOR* EXTERIOR LED SOFFIT POT LIGHT - EACH - (TOTAL 5) 2 @ FRONT ELEVATION - SEE ATTACHED ELEVATION 3 @ REAR ELEVATION - CENTERED ACROSS REAR
2936 72,288 10Dec21	1	LIVING ROOM: ROUGH-IN FOR ADDITIONAL WALL SCONCE (1) CAPPED OUTLET + SINGLE POL SWITCH - FIXTURE NOT INCLUDED  LOCATE APPROX 84" A.F.F. - SEE PLAN FOR LOCATION
2936 72,289 10Dec21	5	MAIN HALL: 4" E/S LED INTERIOR POT LIGHT - GROUND FLOOR - EACH  IN LIEU OF CEILING LIGHTS - USE STANDARD SWITCHES
2936 72,289 10Dec21	6	KITCHEN: 4" E/S LED INTERIOR POT LIGHT - GROUND FLOOR - EACH, INCLUDES 1 SWITCH  INCLUDED IN APS
2936 72,289 10Dec21	1	KITCHEN: 4" E/S LED INTERIOR POT LIGHT - GROUND FLOOR - EACH  SAME SWITCH AS STANDARD POTLIGHTS
2936 72,307 10Dec21	1	KITCHEN: FIXTURE: RELOCATE STANDARD CEILING MOUNT FIXTURE - LOCATE APPROXD CENTER ABOVE ISLAND
2936 72,280 10Dec21	2	KITCHEN: CEILING OUTLET: ADDITIONAL REINFORCED CEILING OUTLET - LOCATE APPROX CENTERED ABOVE ISLAND, USE SAME SWITCH AS STANDARD
2936 72,288 10Dec21	2	BREAKFAST ROOM: ROUGH-IN FOR ADDITIONAL WALL SCONCE (1) CAPPED OUTLET - FIXTURE NOT INCLUDED  LOCATE APPROX 80" A.F.F.
2936 72,278 10Dec21	1	BREAKFAST ROOM: ADDITIONAL INTERIOR SWITCH  FOR WALL SCONCES
2936 72,307 10Dec21	1	GREAT ROOM: FIXTURE: RELOCATE STANDARD CEILING MOUNT FIXTURE - SEE PLAN FOR LOCATION
2936 72,280 10Dec21	1	GREAT ROOM: CEILING OUTLET: ADDITIONAL REINFORCED CEILING OUTLET - SEE PLAN FOR LOCATION  SAME SWITCH AS STANDARD CEILING LIGHT



CONSTRUCTION SUMMARY

Lot: 48

Model: 50.03 A OAKGROVE OPT. 5 BEDROOM

Project/Phase: Pine Valley Forevergreen / 1

ELECTRICAL

Invoice	Qty.	Description
2936 72,289 10Dec21	8	GREAT ROOM: 4" E/S LED INTERIOR POT LIGHT - GROUND FLOOR - EACH  SEE PLAN FOR LOCATION
2936 72,278 10Dec21	1	GREAT ROOM: ADDITIONAL INTERIOR SWITCH  FOR POTLIGHTS
2936 72,303 10Dec21	1	KITCHEN: FIXTURE: UNDER CABINET LED LIGHT FIXTURES - CABINETRY LIGHT VALANCE INCLUDED
2936 72,273 10Dec21	1	KITCHEN: 110V WALL RECEPTACLE ON SEPARATE CIRCUIT - GAS FIRED APPLIANCE - FOR AUX. EQUIPMENT - NOT A STOVE PLUG
2936 72,665 10Dec21	1	KITCHEN: 240V WALL RECEPTACLE ON SEPARATE CIRCUIT FOR BUILT-IN WALL OVEN. - APPROX. LOCATION AS PER ATTACHED DRAWINGS
2936 72,272 10Dec21	1	KITCHEN: 110V WALL RECEPTACLE ON SEPARATE CIRCUIT - FOR FRIDGE - LOCATION TO BE APPROX- APPLIANCE NOT INCLUDED  FINAL LOCATION MAY NEED TO BE ADJUSTED AFTER CLOSING BY LICENCED ELECTRICIAN
2936 72,272 10Dec21	1	SERVERY: 110V WALL RECEPTACLE ON SEPARATE CIRCUIT - FOR WINE FRIDGE, APPLIANCE NOT INCLUDED
2936 72,249 10Dec21 **	1	STEAM HUMIDIFER - APRILAIRE 800 WHOLE HOUSE STEAM HUMIDIFIER (UP TO 6,200 SQ.FT.) - COMPLETE WITH HI VOLTAGE WIRING, 240V DOUBLE BREAKER 20 AMP, SHUT OFF VALVE
2936 72,290 10Dec21	10	MASTER WIC: 4" E/S LED INTERIOR POT LIGHT (INSULATED CEILING) - SECOND FLOOR - EACH  SEE PLAN FOR LOCATION
2936 72,278 10Dec21	1	WIC: ADDITIONAL INTERIOR SWITCH  FOR POTLIGHTS
2936 72,280 10Dec21	1	MASTER ENSUITE: CEILING OUTLET: ADDITIONAL REINFORCED CEILING OUTLET - LOCATE APPROX CENTER ABOVE TUB
2936 72,278 10Dec21	1	MASTER ENSUITE: ADDITIONAL INTERIOR SWITCH  FOR TUB LIGHT
2936 72,288 10Dec21	2	UPPER HALL: ADD ROUGH-IN FOR ADDITIONAL WALL SCONCE (1) CAPPED OUTLET ON EXISTING SWITCH - FIXTURE NOT INCLUDED  LOCATE APPROX 80" A.F.F.



CONSTRUCTION SUMMARY

Lot: 48

Model: 50.03 A OAKGROVE OPT. 5 BEDROOM

Project/Phase: Pine Valley Forevergreen / 1

ELECTRICAL

Invoice	Qty.	Description
2936 72,276 10Dec21	1	UPPER HALL: ADDITIONAL 3 - WAY SWITCH (LIGHT OPERATED BY 2 DIFFERENT SWITCHES)  FOR UPPER HALL SCONCES
2936  10Dec21 NoCat	1	**CUSTOM LAYOUT** BREAKFAST ROOM: DELETE DOOR TO DECK, INSTALL WINDOW INSTEAD
2936  10Dec21 NoCat	1	STEAM HUMIDIFER - APRILAIRE 800 WHOLE HOUSE STEAM HUMIDIFIER (UP TO 6,200 SQ.FT.) - COMPLETE WITH HI VOLTAGE WIRING, 240V DOUBLE BREAKER 20 AMP, SHUT OFF VALVE
2947  11Mar22 NoCat	1	SERVERY: ADD ELECTRICAL AND SWITCH FOR IN CABINET LIGHTING (cabinet lighting supplied + installed by AYA)
2947 72,669 11Mar22	1	ADD-ON EXTERIOR SOFFIT LIGHT TIMER - EACH
2947 72,291  11Mar22	8	**EXTERIOR - REVISED** EXTERIOR LED SOFFIT POT LIGHT - EACH  REVISED LOCATIONS: 2@ FRONT ELEVATION 2@ SIDE ELEVATION 4@ REAR ELEVATION 5@ SIDE ELEVATION ADD 8 SOFFIT LIGHTS, *IN ADDITION TO* 5 PREVIOUSLY PURCHASED - TOTAL OF 13 SOFFIT LIGHTS
2947 72,275 11Mar22	1	KITCHEN: 240V WALL RECEPTACLE ON SEPARATE CIRCUIT FOR SPEED OVEN

EXTERIOR COLOURS

Invoice	Qty.	Description
2799  08Jun21 NoCat	1	EXTERIOR COLOUR PACKAGE BR4

FIREPLACE - MANTEL

Invoice	Qty.	Description
2947  11Mar22 NoCat	1	GREAT ROOM: UPGRADE FIREPLACE MANTLE TO 'CAPRI'



CONSTRUCTION SUMMARY

Lot: 48

Model: 50.03 A OAKGROVE OPT. 5 BEDROOM

Project/Phase: Pine Valley Forevergreen / 1

FRAMING

Invoice	Qty.	Description
2799 72,552 08Jun21	1	MASTER BEDROOM: MODEL OPTIONS 50.03. A - MASTER BEDROOM - OPT. SITTING AREA 10 FOOT TRAY CEILING - AS PER PLAN
2936  10Dec21 NoCat	1	**CUSTOM LAYOUT** LIVING / DINING: DELETE OPENING, CREATE FULL WALL PARTITION BETWEEN LIVING/DINING
2936  10Dec21 NoCat	1	**CUSTOM LAYOUT** BREAKFAST ROOM: DELETE DOOR TO DECK, INSTALL WINDOW INSTEAD
2936  10Dec21 NoCat	1	**CUSTOM LAYOUT** WIC - DELETE WALL/DOOR, CREATING 1 LARGE OPEN SPACE
2936 72,631 10Dec21	1	MASTER ENSUITE: SHOWER NICHE [SHAMPOO SHELF] - COMPLETE WITH MATCHING MARBLE JAMBS ON 4 SIDES, STANDARD TILE, APPROX. 12 X 18 INSTALLED VERTICALLY - SEE PLAN FOR PREFERRED LOCATION
2936 72,631 10Dec21	1	SHARED ENSUITE 3/4: SHOWER NICHE [SHAMPOO SHELF] - COMPLETE WITH MATCHING MARBLE JAMBS ON 4 SIDES, STANDARD TILE, APPROX. 12 X 18 INSTALLED VERTICALLY - SEE PLAN FOR PREFERRED LOCATION
2936 72,631 10Dec21	1	SHARED ENSUITE 2/5: SHOWER NICHE [SHAMPOO SHELF] - COMPLETE WITH MATCHING MARBLE JAMBS ON 4 SIDES, STANDARD TILE, APPROX. 12 X 18 INSTALLED VERTICALLY - LOCATE WALL OPPOSITE VALVE
2936  10Dec21 NoCat	1	LIVING ROOM: ADD OPT. COFFERED CEILING AS PER PLAN
2936  10Dec21 NoCat	1	KITCHEN / BREAKFAST : ADD COFFERED CEILING AS PER PLAN
2936  10Dec21 NoCat	1	GREAT ROOM: MODEL OPTIONS GREAT ROOM - OPT. COFFERED CEILING AS PER PLAN
2962  14Mar22 NoCat	26	THRU OUT: INCREASE HEIGHT OF DOORS AND ARCHES TO 8FT SECOND FLOOR - PER DOOR



CONSTRUCTION SUMMARY

Lot: 48

Model: 50.03 A OAKGROVE OPT. 5 BEDROOM

Project/Phase: Pine Valley Forevergreen / 1

GARAGE DOORS

Invoice	Qty.	Description
2936 72,324 10Dec21	2	GARAGE DOOR OPENER (CHAMBERLAIN BELT DRIVE) - WITH 1 REMOTE - PRICE IS PER DOOR
2936 72,323 10Dec21	1	GARAGE: WIRELESS KEYPAD GARAGE DOOR ENTRY   877LM  SEE PLAN FOR LOCATION

GLASS AND MIRROR

Invoice	Qty.	Description
2936  10Dec21 NoCat	1	MASTER ENSUITE: UPGRADE TO FROSTED GLASS ENCLOSURE AT WATER CLOSET - DOOR + SHARED SHOWER WALL  SHOWER DOOR AND OTHER GLASS WALLS TO BE CLEAR GLASS
2947  11Mar22 NoCat	2	MASTER ENSUITE SHOWER + WATER CLOSET: UPGRADE SHOWER DOOR HANDLE AND HINGES - BRUSHED GOLD
2947  11Mar22 NoCat	1	SHARED ENSUITE 3/4: UPGRADE SHOWER DOOR HANDLE AND HINGES - BRUSHED GOLD
2947  11Mar22 NoCat	1	THRU OUT: DO NOT SUPPLY/INSTALL MIRRORS





CONSTRUCTION SUMMARY

Lot: 48

Model: 50.03 A OAKGROVE OPT. 5 BEDROOM

Project/Phase: Pine Valley Forevergreen / 1

GRANITE MARBLE QUARTZ

Invoice	Qty.	Description
2947  11Mar22 NoCat	1	POWDER ROOM: UPGRADE 2 QUARTZ COUNTER
2947  11Mar22 NoCat	1	MUD ROOM: UPGRADE 2 QUARTZ COUNTER TOP
2947  11Mar22 NoCat	1	KITCHEN: UPGRADE COUNTER TOP - LEVEL 6 QUARTZ  SEE REVISED ISLAND LAYOUT + EXTENDED PERIMETER OF KITCHEN (towards breakfast room)
2947  11Mar22 NoCat	1	KITCHEN: FULL HEIGHT SLAB BACKSPLASH - LEVEL 6 QUARTZ
2947  11Mar22 NoCat	1	SERVERY: UPGRADE 5 QUARTZ COUNTER TOP + FULL HEIGHT BACKSPLASH
2947  11Mar22 NoCat	1	MASTER ENSUITE: UPGRADE 2 QUARTZ COUNTER
2947  11Mar22 NoCat	1	SHARED ENSUITE 2/5: UPGRADE 2 QUARTZ COUNTER TOP
2947  11Mar22 NoCat	1	SHARED ENSUITE 3/4: UPGRADE 2 QUARTZ COUNTER
2947  11Mar22 NoCat	1	LAUNDRY ROOM: UPGRADE 2 QUARTZ COUNTER AT COUNTER + ABOVE MACHINES
2947  11Mar22 NoCat	1	KITCHEN: COOKTOP CUT OUT
2947  11Mar22 NoCat	1	KITCHEN: ADD MOEN SIP FAUCET - HOLE DRILLED AND INSTALLED, BUT NOT PLUMBED - PURCHASER TO FIT TO OWN WATER FILTRATION SYSTEM AFTER CLOSING  LOCATE RIGHT OF KITCHEN FAUCET
2947  11Mar22 NoCat	1	SERVERY: UPGRADE SINK (Blanco Silgranit Anthracite) + FAUCET (Moen Align - Brushed Gold)



CONSTRUCTION SUMMARY

Lot: 48

Model: 50.03 A OAKGROVE OPT. 5 BEDROOM

Project/Phase: Pine Valley Forevergreen / 1

HARDWOOD

Invoice	Qty.	Description
2947 4 11Mar22	1	THRU OUT STD AREAS MAIN HALL/ LIVING/ DINING/ GREAT/ SERVERY/ UPPER HALL/ MASTER BEDRM + SITTING + WIC/ BEDRM 2/ BEDRM 3/ BEDRM 4/ BDRM 5: VINTAGE SERIES, 5" WHITE OAK, NSS ENGINEERED HARDWOOD, 3/4" THK, WIREBRUSH TEXTURE, UV OIL FINISH- LEVEL 3
2947 4 11Mar22	1	KITCHEN: VINTAGE SERIES, 5" WHITE OAK, NSS ENGINEERED HARDWOOD, 3/4" THK, WIREBRUSH TEXTURE, UV OIL FINISH - LEVEL 3

HVAC

Invoice	Qty.	Description
2936 72,217 10Dec21	1	KITCHEN - UPGRADE TO 8" DUCT ( EXTERIOR WALL) IN LIEU OF STANDARD OFFERING
2936 72,224 10Dec21	1	KITCHEN: GAS LINE ROUGH-IN - MAIN FLOOR FOR GAS COOKTOP - LOCATE TO BE APPROXIMATE, FINAL POSITION MAY NEED TO BE ADJUSTED AFTER CLOSING BY LICENCED GAS FITTER.
2936 72,213 10Dec21	1	MASTER ENSUITE / ENSUITE 2/5 / ENSUITE 3/4/ LAUNDRY ROOM: HRV WITH 20 MINUTE LIGHT TIMER , INCLUDES MAIN WALL CONTROLLER UP TO 4 OUTLETS
2936 72,249 10Dec21	1	STEAM HUMIDIFER - APRILAIRE 800 WHOLE HOUSE STEAM HUMIDIFIER (UP TO 6,200 SQ.FT.) - COMPLETE WITH HI VOLTAGE WIRING, 240V DOUBLE BREAKER 20 AMP, SHUT OFF VALVE
2936  10Dec21 ** NoCat	1	STEAM HUMIDIFER - APRILAIRE 800 WHOLE HOUSE STEAM HUMIDIFIER (UP TO 6,200 SQ.FT.) - COMPLETE WITH HI VOLTAGE WIRING, 240V DOUBLE BREAKER 20 AMP, SHUT OFF VALVE

INTERIOR DOORS

Invoice	Qty.	Description
2947  11Mar22 NoCat	1	THRU OUT: UPGRADE INTERIOR DOOR HARDWARE - HALIFAX MATTE BLACK
2947  11Mar22 NoCat	1	THRU OUT: UPGRADE INTERIOR DOOR HINGES TO SQUARE FLAT TIP HINGE - MATTE BLACK



CONSTRUCTION SUMMARY

Lot: 48

Model: 50.03 A OAKGROVE OPT. 5 BEDROOM

Project/Phase: Pine Valley Forevergreen / 1

INTERIOR DOORS AND TRIM

Invoice	Qty.	Description
2936 72,640 10Dec21	2	MASTER BEDROOM + MASTER ENSUITE (AT WIC): ADD SINGLE POCKET DOOR 800 SERIES COMPLETE WITH BUILDERS STANDARD OFFERINGS
2936 72,645 10Dec21	18	THRU OUT: ADDITIONAL FOR SAFE & SOUND (SOLID CORE) INTERIOR DOORS  NOT INCLUDING CLOSET DOORS
2962 72,644 14Mar22	26	THRU OUT: INCREASE HEIGHT OF DOORS AND ARCHES TO 8FT SECOND FLOOR - PER DOOR  INCLUDED IN APS

INTERIOR TRIM AND DOORS

Invoice	Qty.	Description
2947  11Mar22 NoCat	1	THRU OUT: UPGRADE INTERIOR DOOR PROFILE TO 'LIVINGSTON'
2947  11Mar22 NoCat	1	THRU OUT - ALL CLOSETS DO NOT INSTALL CLOSET FITTINGS, LEAVE EMPTY FOR PURCHASER TO INSTALL OWN CUSTOM CLOSET ORGANIZERS AFTER CLOSING

KITCHEN AND BATH CABINETRY

Invoice	Qty.	Description
2936 72,217 10Dec21 **	1	KITCHEN - UPGRADE TO 8" DUCT ( EXTERIOR WALL) IN LIEU OF STANDARD OFFERING
2947  11Mar22 NoCat	1	THRU OUT: SEE ATTACHED CABINETRY SCHEDULE



CONSTRUCTION SUMMARY

Lot: 48

Model: 50.03 A OAKGROVE OPT. 5 BEDROOM

Project/Phase: Pine Valley Forevergreen / 1

NETWORK AND WIRING

Invoice	Qty.	Description
2936 72,260 10Dec21	1	BASEMENT/ATTIC: CONDUIT PIPE - FROM APPROX CENTER OF ATTIC TO BASEMENT NEAR ELECTRICAL PANEL
2936 72,265 10Dec21	3	DINING ROOM / GREAT ROOM / KITCHEN: ROUGH - IN WIRING FOR ONE PAIR OF SPEAKERS - SEE PLAN FOR LOCATION
2936 72,258 10Dec21	1	FRONT FOYER: ADDITIONAL CAT6 ETHERNET OUTLET - EACH FOR FUTURE 'RING-TYPE' DOOR BELL
2936 72,259 10Dec21	1	GREAT ROOM: CONDUIT PIPE - FOR WALL MOUNT TV - LOCATE ABOVE FIREPLACE, APPROX 66" A.F.F., THRU BASEMENT, TERMINATE AT CABLE LOCATION - SEE PLAN FOR LOCATION
2936 72,259 10Dec21	1	MASTER BEDROOM - SITTING ROOM: CONDUIT PIPE - FOR WALL MOUNT TV - LOCATE ABOVE FIREPLACE, APPROX 42" A.F.F., TERMINATE AT CABLE LOCATION - SEE PLAN FOR LOCATION
2936 72,258 10Dec21	1	LIVING ROOM: ADDITIONAL CAT6 ETHERNET OUTLET - EACH - SEE PLAN FOR LOCATION
2936  10Dec21 NoCat	1	NO STANDARD PHONES ON 2ND FLOOR, PLEASE

PAINT

Invoice	Qty.	Description
2799  08Jun21 NoCat	1	MASTER BEDROOM: MODEL OPTIONS 50.03. A - MASTER BEDROOM - OPT. SITTING AREA 10 FOOT TRAY CEILING - AS PER PLAN
2936  10Dec21 NoCat	1	LIVING ROOM: ADD OPT. COFFERED CEILING AS PER PLAN
2936  10Dec21 NoCat	1	KITCHEN / BREAKFAST : ADD COFFERED CEILING AS PER PLAN
2936  10Dec21 NoCat	1	GREAT ROOM: MODEL OPTIONS GREAT ROOM - OPT. COFFERED CEILING AS PER PLAN
2947  11Mar22 NoCat	2	MAIN STAIRS: STAIN STAIRS AND LANDINGS  STAIN WILL NOT MATCH HARDWOOD IN COLOUR/TEXTURE/SPECIES



CONSTRUCTION SUMMARY

Lot: 48

Model: 50.03 A OAKGROVE OPT. 5 BEDROOM

Project/Phase: Pine Valley Forevergreen / 1

PAINTING

Invoice	Qty.	Description
2947  11Mar22 NoCat	1	KITCHEN: CEILING DETAIL: ADD 3 BOX WAFFLE + BEAM DETAIL - SEE ATTACHED SKETCH
2947  11Mar22 NoCat	1	GREAT ROOM: CEILING DETAIL: ADD 3 BOX WAFFLE + BEAM DETAIL - SEE ATTACHED SKETCH
2962  14Mar22 NoCat	26	THRU OUT: INCREASE HEIGHT OF DOORS AND ARCHES TO 8FT SECOND FLOOR - PER DOOR

PANL - FRAMING

Invoice	Qty.	Description
2936 72,324 10Dec21 **	2	GARAGE DOOR OPENER (CHAMBERLAIN BELT DRIVE) - WITH 1 REMOTE - PRICE IS PER DOOR



CONSTRUCTION SUMMARY

Lot: 48

Model: 50.03 A OAKGROVE OPT. 5 BEDROOM

Project/Phase: Pine Valley Forevergreen / 1

PLUMBING

Invoice	Qty.	Description
2936 72,346 10Dec21	1	KITCHEN: ADD POT FILLER - MOEN MODERN 'BRUSHED GOLD'  INCLUDES ROUGH-IN
2936 72,335 10Dec21	1	GARAGE: UPGRADE TO HOT AND COLD WATER SUPPLY LINES IN GARAGE IN LIEU OF STANDARD OFFERING  SEE PLAN FOR *PREFERRED LOCATION* OF HOSE BIB
2936 72,249 10Dec21 **	1	STEAM HUMIDIFER - APRILAIRE 800 WHOLE HOUSE STEAM HUMIDIFIER (UP TO 6,200 SQ.FT.) - COMPLETE WITH HI VOLTAGE WIRING, 240V DOUBLE BREAKER 20 AMP, SHUT OFF VALVE
2936  10Dec21 NoCat	1	MASTER ENSUITE: UPGRADE PLUMBING *SHOWER TO 3-FUNCTION SHOWER COMPLETE WITH RAIN SHOWER FROM CEILING AND HAND SHOWER *TUB FAUCET - FLOOR MOUNT * LAV FAUCET x2 MOEN ALIGN BRUSHED GOLD
2936  10Dec21 NoCat	1	SHARED ENSUITE 3/4: UPGRADE FAUCETS SHOWER FAUCET LAV FAUCET x2 MATTE BLACK
2936  10Dec21 NoCat	1	SHARED ENSUITE 2/5: UPGRADE FAUCETS TUB/SHOWER FAUCET LAV FAUCET MATTE BLACK
2936  10Dec21 ** NoCat	1	STEAM HUMIDIFER - APRILAIRE 800 WHOLE HOUSE STEAM HUMIDIFIER (UP TO 6,200 SQ.FT.) - COMPLETE WITH HI VOLTAGE WIRING, 240V DOUBLE BREAKER 20 AMP, SHUT OFF VALVE
2947  11Mar22 NoCat	1	POWDER ROOM: UPGRADE FAUCET TO MOEN 'ALIGN' WIDESPREAD - BRUSHED GOLD
2947  11Mar22 NoCat	1	MUD ROOM: UPGRADE SINK (Blanco Silgranit - White) + FAUCET (Moen Align - Brushed Gold)
2947  11Mar22 NoCat	1	KITCHEN: UPGRADE SINK (Blanco Silgranit - white) + FAUCET (Moen Align - brushed gold)
2947  11Mar22 NoCat	1	KITCHEN: ADD MOEN SIP FAUCET - HOLE DRILLED AND INSTALLED, BUT NOT PLUMBED - PURCHASER TO FIT TO OWN WATER FILTRATION SYSTEM AFTER CLOSING  LOCATE RIGHT OF KITCHEN FAUCET
2947  11Mar22 NoCat	1	SERVERY: UPGRADE SINK (Blanco Silgranit Anthracite) + FAUCET (Moen Align - Brushed Gold)
2947  11Mar22 NoCat	4	THRU OUT: POWDER ROOM/ MASTER ENSUITE/ SHARED ENSUITE 2/5/ SHARED ENSUITE 3/4: UPGRADE TOILET TO CONTRAC 'CILA' WHITE



CONSTRUCTION SUMMARY

Lot: 48

Model: 50.03 A OAKGROVE OPT. 5 BEDROOM

Project/Phase: Pine Valley Forevergreen / 1

PLUMBING

Invoice	Qty.	Description
2947	1	LAUNDRY ROOM: UPGRADE SINK (Blanco Silgranit - 'Anthracite') + FAUCET (Moen Align 'Matte Black')
11Mar22 NoCat		
2947	1	**REVISED SELECTION - FEB 23 2022** SHARED ENSUITE 2/5 + SHARED ENSUITE 3/4: INSTALL MOEN 'ALIGN' SHOWER SYSTEM and LAV FAUCET ^IN LIEU OF PREVIOUS SELECTION (rizon)^
11Mar22 NoCat		This is difference in price from previous selection

STAIRS AND RAILINGS

Invoice	Qty.	Description
2947	1	MAIN STAIRS: UPGRADE RAILING TO A2 - BLACK METAL PACKAGE
11Mar22 NoCat		

TRIM AND DOORS

Invoice	Qty.	Description
2947	1	THRU OUT: ADD WINDOW STOOLS AND APRONS
11Mar22 NoCat		

WINDOWS AND DOORS

Invoice	Qty.	Description
2799 72,675 08Jun21	4	BASEMENT WINDOWS - UPGRADE BASEMENT WINDOW SIZE TO 30 " X 24" - 10" FRAME ( PINEVALLEY 50 FOOT LOTS ONLY)
2936  10Dec21 NoCat	1	**CUSTOM LAYOUT** BREAKFAST ROOM: DELETE DOOR TO DECK, INSTALL WINDOW INSTEAD

Scheduled Closing Date:

Purchaser: KARAN PAL SINGH

Property: 48 of Plan -

Telephone Res. / Bus: (905) 850-8067

Project: Pine Valley Forevergreen - Phase 1

Decor Advisor: Yolande Somerville

Model and Elevation: 50.03 A OAKGROVE OPT. 5 BEDROOM

Layout Changes: ☒ Yes ☐ No      Sketch Attached: ☒ Yes ☐ No      Exterior Colour Scheme:

1. Cabinetry

	Style and Colour	Counter	Hardware
Kitchen / Breakfast	*2-tone	*2-tone	attached
Laundry Room	Modena 'White'	*Quartz: Organic White	attached
Powder Room	*Willis 'Oyster'	*Quartz: Organic White	attached
Mud Room	Modena 'white'	*Quartz: Organic White	attached
Master Ensuite Bathroom	*Winsette 'Anthracite'	*Quartz: Organic White	attached
Second Ensuite Bathroom (If Applicable)	*Winsette 'Oyster' (ens2/5)	*Quartz: Organic White	attached
Shared 3/4	*Winsette 'Oyster'	*Quartz: Organic White	attached

Comment

Kitchen: 'Willis Oyster + Calacatta Gold + FHBS /    Servery: Willis Pitch Black + Empira Black + FHBS

2. Floor Tile

	Selection
Entrance Vestibule	*30x30" Marmorea matte 'Port Laurent' + Charcoal grout
Main Hall	
Kitchen / Breakfast	hardwood
Laundry Room	*8x8" Maku decor 'Light Mix' + Bone Grout
Powder Room	*Merino Hex 'Ivory' + Bone Grout
Mud Room	*Merino Hex 'Ivory' + Bone Grout
Master Ensuite Bathroom	*30x60" Marmorea polished 'Breccia White' + Bone Grout
Second Ensuite Bathroom (If Applicable)	*12x24" Timeless matte 'white (ens 2/5) + Bone Grout
Lower Landing (If Applicable)	13x13" Capri 'White'
Shared 3/4	*Mosaic Quebec Hex 'Arctic white' + Bone Grout

Comment

Master Shower Floor: Marble mosaic herringbone 'Oriental White' + bone grout /    Shared Ensuite 3/4: Mosaic Quebec hex 'white' + bone grout

3. Wall Tile

	Selection	Listello/Inserts	Describe
	<input type="text"/>	<input type="radio"/> Yes <input checked="" type="radio"/> No	<input type="text"/>
Master Ensuite Bathroom			
Tub Deck	<input type="text"/>	<input type="radio"/> Yes <input checked="" type="radio"/> No	<input type="text"/>
Shower Stall	*30x60" Marmorea pol Breccia wht	<input type="radio"/> Yes <input checked="" type="radio"/> No	<input type="text"/>
Bathroom Walls	<input type="text"/>	<input type="radio"/> Yes <input checked="" type="radio"/> No	<input type="text"/>
Second Ensuite Bathroom (If Applicable)	*3x6" Soho bevel 'White' gloss (2/5)	<input type="radio"/> Yes <input checked="" type="radio"/> No	<input type="text"/>
Ensuite 3/4	*2x10" London 'White' + Bone grout	<input type="radio"/> Yes <input checked="" type="radio"/> No	<input type="text"/>
Kitchen Backsplash	<input checked="" type="radio"/> Yes <input type="radio"/> No	Backsplash Behind Fridge	<input type="text"/>
Comment	see below		

Kitchen: Calacatta Gold FHBS /    Servery: Empira Black FHBS





Scheduled Closing Date:

Purchaser: KARAN PAL SINGH  
Telephone Res. / Bus: (905) 850-8067  
Decor Advisor: Yolande Somerville

Property: 48 of Plan -  
Project: Pine Valley Forevergreen - Phase 1  
Model and Elevation: 50.03 A OAKGROVE OPT. 5 BEDROOM

4. Plumbing Fixtures

<input type="text"/>	Second Ensuite	<input type="text"/>	Powder Room	<input type="text"/>
Master Ensuite Bathroom	<input type="text"/>	Other Room - Specify	<input type="text"/>	Other Washroom
Comment		<input type="text"/>		

See extras

5. Hardwood Flooring

	Type and Stain		Type and Stain
Main Hall	<input type="text"/>	Upper Landing	<input type="text"/>
Kitchen / Breakfast	*3/4x5" wht oak wire brsh 'Atlantis'	Upper Hall	<input type="text"/>
Living Room	<input type="text"/>	Master Bedroom	<input type="text"/>
Dining Room	<input type="text"/>	Bedroom #2	<input type="text"/>
Family Room	<input type="text"/>	Bedroom #3	<input type="text"/>
Den/Library	<input type="text"/>	Bedroom #4	<input type="text"/>
Entrance Vestibule	<input type="text"/>	Bedroom #5	<input type="text"/>
Lower Landing (If Applicable)	<input type="text"/>	Other Room - Specify	<input type="text"/>
		Thru out standard areas	*3/4x5" wht oak wire brsh 'Atlantis'

Comment

6. Carpeting

	Upgrade	Description
Ground Floor	<input type="checkbox"/>	<input type="text"/>
Second Floor	<input type="checkbox"/>	<input type="text"/>
<input type="text"/>	<input type="checkbox"/>	<input type="text"/>

	Type	Area
Upgrade Underpad	<input type="text"/>	<input type="text"/>
	Capped	Runner - *Upgrade
Carpet on Stairs	<input type="text"/>	<input type="text"/>

Comment

7. Fireplace

	Living Room			Family Room			Other Room - Specify		
	Purchased	As Per Plan	N/A	Purchased	As Per Plan	N/A	Purchased	As Per Plan	N/A
	<input type="radio"/>	<input type="radio"/>	<input checked="" type="radio"/>	<input type="radio"/>	<input checked="" type="radio"/>	<input type="radio"/>	<input type="radio"/>	<input type="radio"/>	<input checked="" type="radio"/>
Fireplace Type	<input type="text"/>			Standard Gas			<input type="text"/>		
Mantle Type	<input type="text"/>			*Capri			<input type="text"/>		
Colour / Stain	<input type="text"/>			Arctic White			<input type="text"/>		
Surround	<input type="text"/>			n/a			<input type="text"/>		
Hearth	<input type="text"/>			none			<input type="text"/>		

Comment

KS

Scheduled Closing Date:

Purchaser: KARAN PAL SINGH

Property: 48 of Plan -

Telephone Res. / Bus: (905) 850-8067

Project: Pine Valley Forevergreen - Phase 1

Decor Advisor: Yolande Somerville

Model and Elevation: 50.03 A OAKGROVE OPT. 5 BEDROOM

### 8. Trim Carpentry

Interior Doors  Front Door Glass Inserts  Door Handles   
 Interior Trim   
 Comment

### 9. Plaster Mouldings and Medallions

Standard Throughout ☐ Yes ☐ No ☐ N/A

Entrance Vestibule	<input type="text"/>	<input type="text"/>	Kitchen/Breakfast	<input type="text" value="CTRB05A/615"/>	<input type="text"/>
Main Hall	<input type="text"/>	<input type="text"/>	Den/Library	<input type="text"/>	<input type="text"/>
Living Room	<input type="text"/>	<input type="text"/>	Lower Landing	<input type="text"/>	<input type="text"/>
Dining Room	<input type="text"/>	<input type="text"/>	Other Room - Specify	<input type="text"/>	<input type="text"/>
Family Room	<input type="text" value="CTRB05A/615"/>	<input type="text"/>		<input type="text"/>	<input type="text"/>

Comment

### 10. Railings and Spindles

Railing Package   
 Railing Colour  Spindle Colour   
 Stringer / Riser  Treads   
 Oak Stairs ☒ Yes ☐ No ☐ N/A  
 Comment

### 11. Wall Paint / Ceilings

Throughout Finished Areas   
  
 Trim Paint   
 Smooth Ceilings  
 Ground Floor ☒  
 Second Floor ☒  
 Note

Comment

KS

Scheduled Closing Date:

Purchaser: KARAN PAL SINGH

Property: 48 of Plan -

Telephone Res. / Bus: (905) 850-8067

Project: Pine Valley Forevergreen - Phase 1

Decor Advisor: Yolande Somerville

Model and Elevation: 50.03 A OAKGROVE OPT. 5 BEDROOM

## 12. Electrical

Hood Fan ☐ White ☐ Stainless ☒ N/A

Above Kitchen Cabinet Light ☐ Yes ☒ No

Below Kitchen Cabinet Light ☒ Yes ☐ No

Standard Appliances ☐

Over The Range Microwave ☐

Chimney Style Fan ☐

Comment

## 13. Heating and Air Conditioning

Air Conditioning

Gas Provisions Stove

Gas Provisions Dryer

Gas Provisions Barbecue

Comment

## 14. Additional Comments

## 15. Disclaimers and Notes

- 1) Colours of all materials are as close as possible to builder's selection, but not necessarily identical due to variances in manufacturing.
- 2) Any extras listed above are null and void unless accompanied by a separate invoice/amendment. Said invoice must be paid in full.
- 3) The Purchaser acknowledges that after Interior Colour Selection form is signed and dated, no further changes will be permitted other than re-selection due to unavailability. \_\_\_\_\_ Purchaser's Initials
- 4) The Purchaser acknowledges reading and accepting the "Gold Park Homes Decor Centre Disclaimers" form. This document contains other miscellaneous disclaimers.

This Interior Colour Selection is final and approved by:

Signature:  Date: \_\_\_\_\_

# SCHEDULE 'F'



PV-48  
NOV. 22, 2021

PV-48  
DEC 8 2021 (KS)

Lot 48  
50' SERIES

Elevation A • 4,936 sq.ft.

## LEGEND

(S) = SPEAKER R11

PV-48  
MARCH 1 2022 (KS) CHANGE from door to window

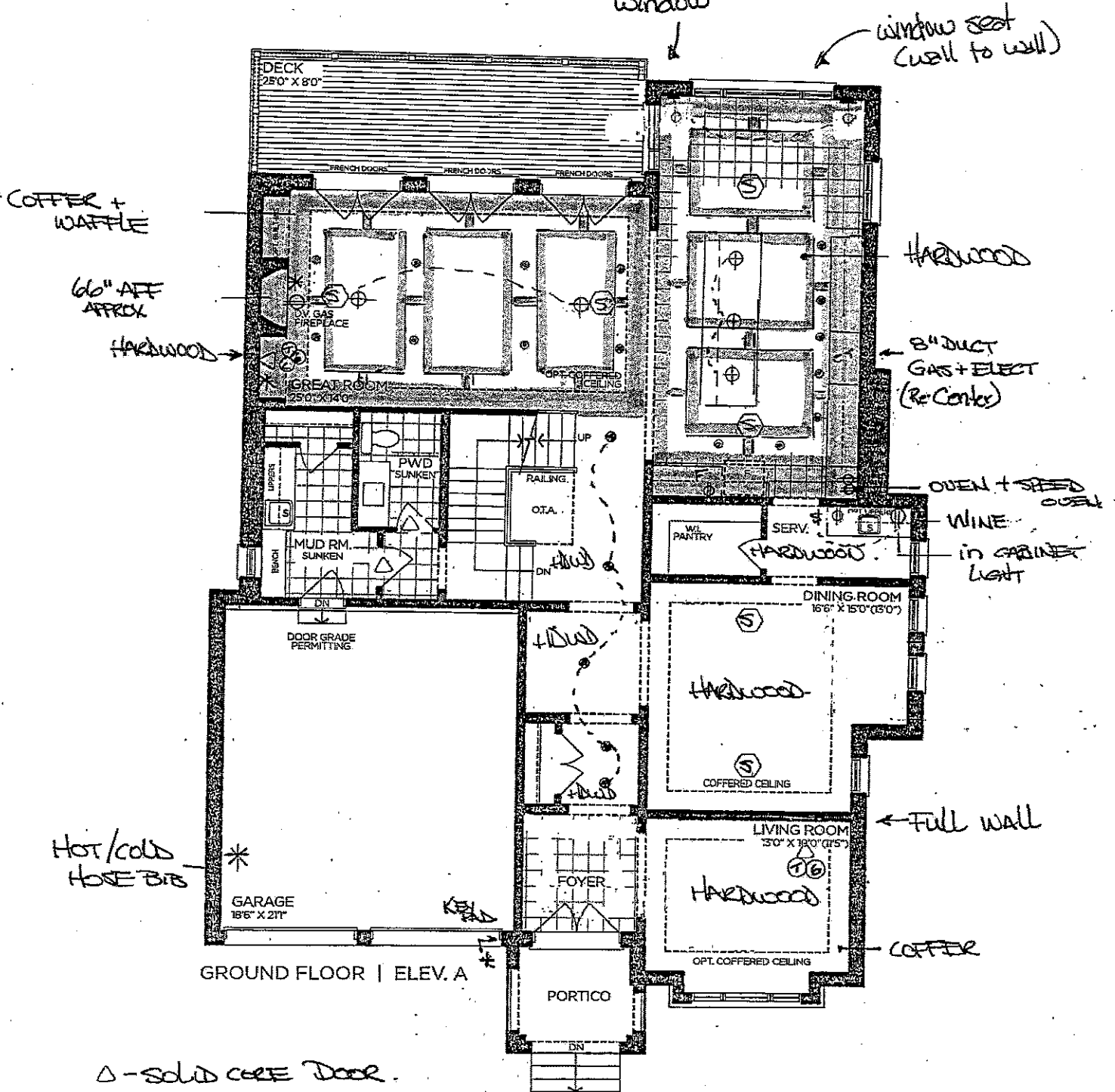

VENDOR

PURCHASER

PURCHASER

GOLDPARK  
WORTH MORE™

Prices, figures, illustrations, sizes, features and finishes are subject to change without notice. Areas and dimensions are approximate and actual usable floor space may vary from the stated area. Layout may be reverse of the unit purchased. E. & O.E. 5003

# SCHEDULE 'F'



PV-48

NOV. 22, 2021

PV-48

DEC 8 2021 (KS)

PV-48

MARCH 1 2022 (KS)

Lot 48

50' SERIES

Elevation A • 4,936 sq.ft.

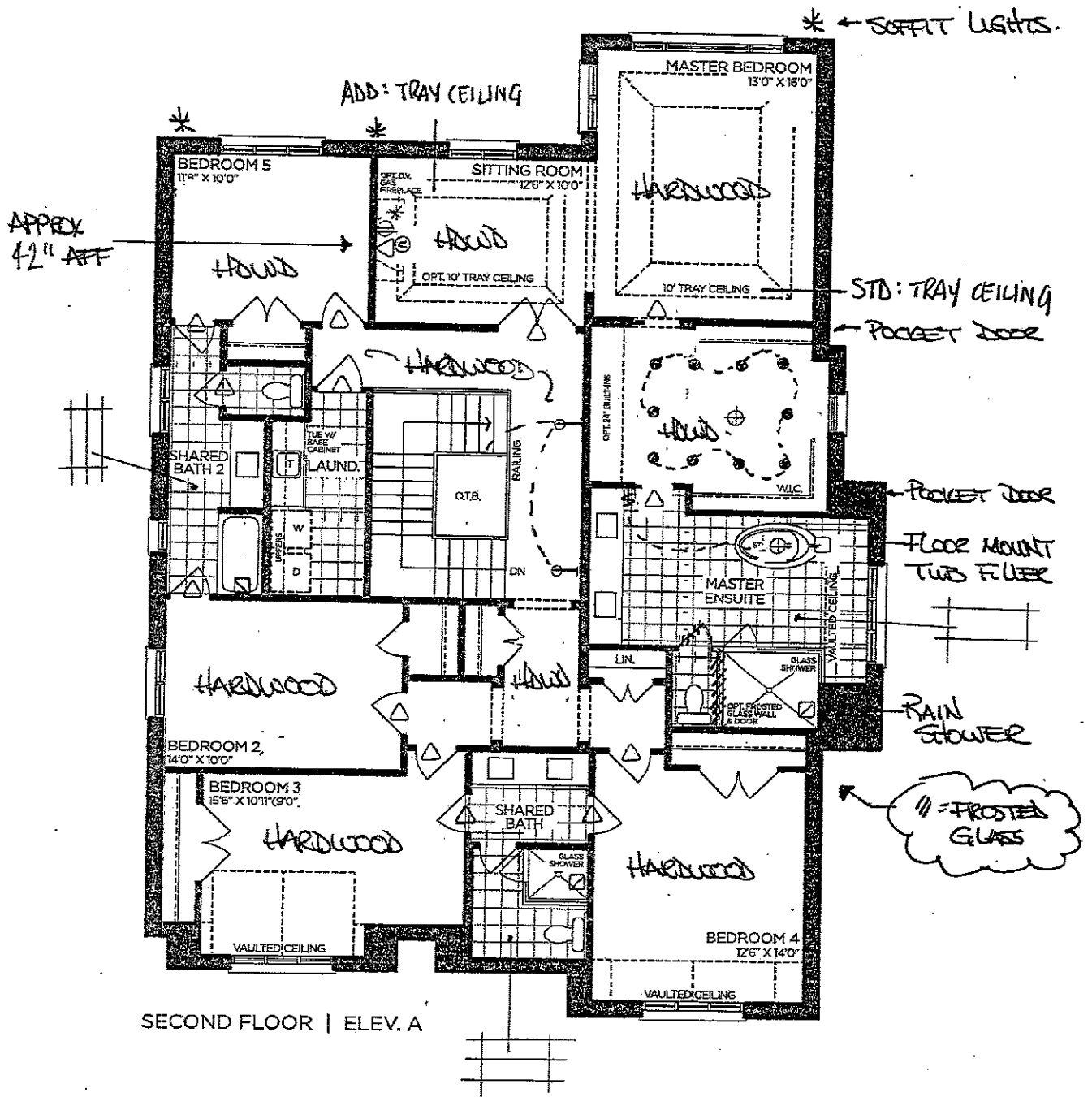

VENDOR

PURCHASER

PURCHASER

**GOLDPARK**  
WORTH MORE™

Prices, figures, illustrations, sizes, features and finishes are subject to change without notice. Areas and dimensions are approximate and actual usable floor space may vary from the stated area. Layout may be reverse of the unit purchased. E. & O.E. 5003

SCHEDULE 'F'



PV-48

NOV 22, 2021

PV-48

DEC 8 2021 (KS)

PV-48

MARCH 1 2022 (KS)

Lot 48

50' SERIES

Elevation A • 4,936 sq.ft.

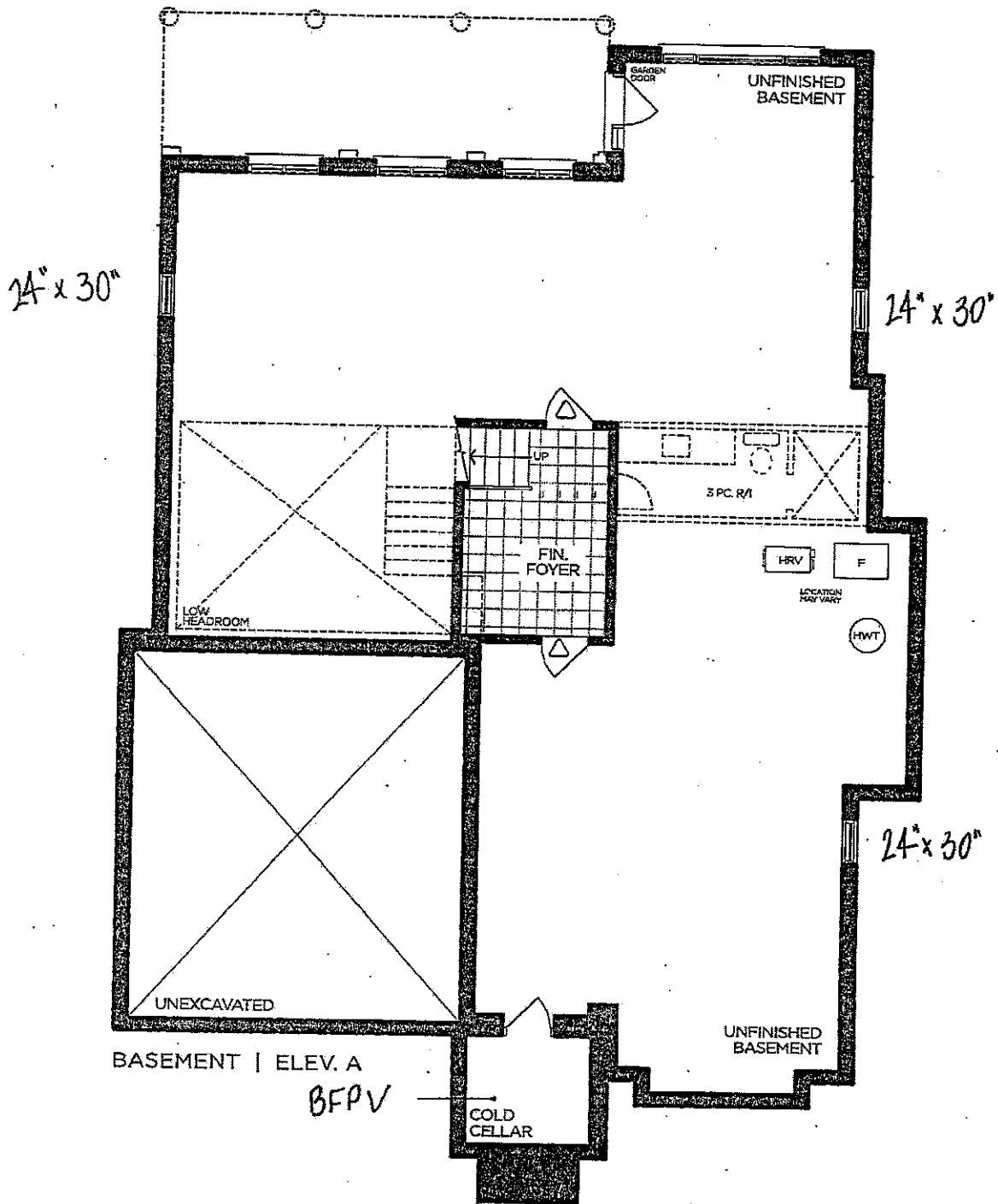

VENDOR

PURCHASER

PURCHASER

GOLDPARK  
WORTH MORE™

Prices, figures, illustrations, sizes, features and finishes are subject to change without notice. Areas and dimensions are approximate and actual usable floor space may vary from the stated area. Layout may be reverse of the unit purchased. E. & O.E. 5003



KITCHEN  
ISLAND

Wanda SEAT!  
Willis oyster  
Gidd hardware

SECRET

~~Base:~~ willis Pencil Block  
upper: Ric Alum Block.

Page 1/2

- Ric Aluminum
- Back/class - car
- fin int
- 1/2 cut
- LED lights inside

**GOLDPARK HOMES  
PINE VALLEY  
VAUGHAN, ONTARIO  
MODEL: (5003) OAKGROVE  
LOT SPECIFIC 48**

**SITE STANDARD: WHITE 3/4" EXTENSION  
SOFT-CLOSE DRAWERS WITH STANDARD  
SLAM DOOR HINGES**

10" CEILING - 12"H COFFERED CELL.  
M.H. = 102" + 3/4"H CONTEMPORARY  
MOLDING + 5 1/4"H FURRING RAIL  
+ LARGE CORNICE MOLDING TO  
UNDERSIDE OF BOX

7419 685

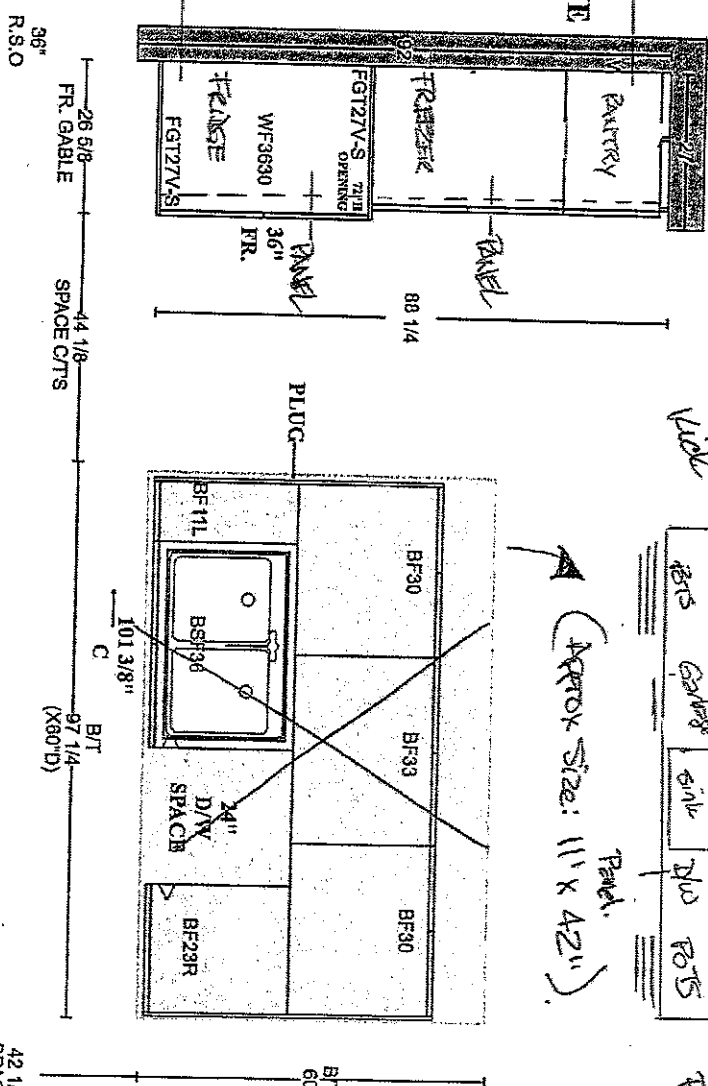

Dr. Patel  
+ Rick  
Kick

(Approx Size: 11' x 42")

Is ~~not~~ shallow? CARBONATES + Tuff  
rests on Gneiss, silt also POTs

Dec  
Panel +  
Packed  
luck

used to  
used

T/LATCH  
DRAUGHTS  
FINISHED TOP  
FURN KICK

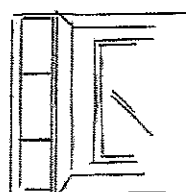

Minibus 8471

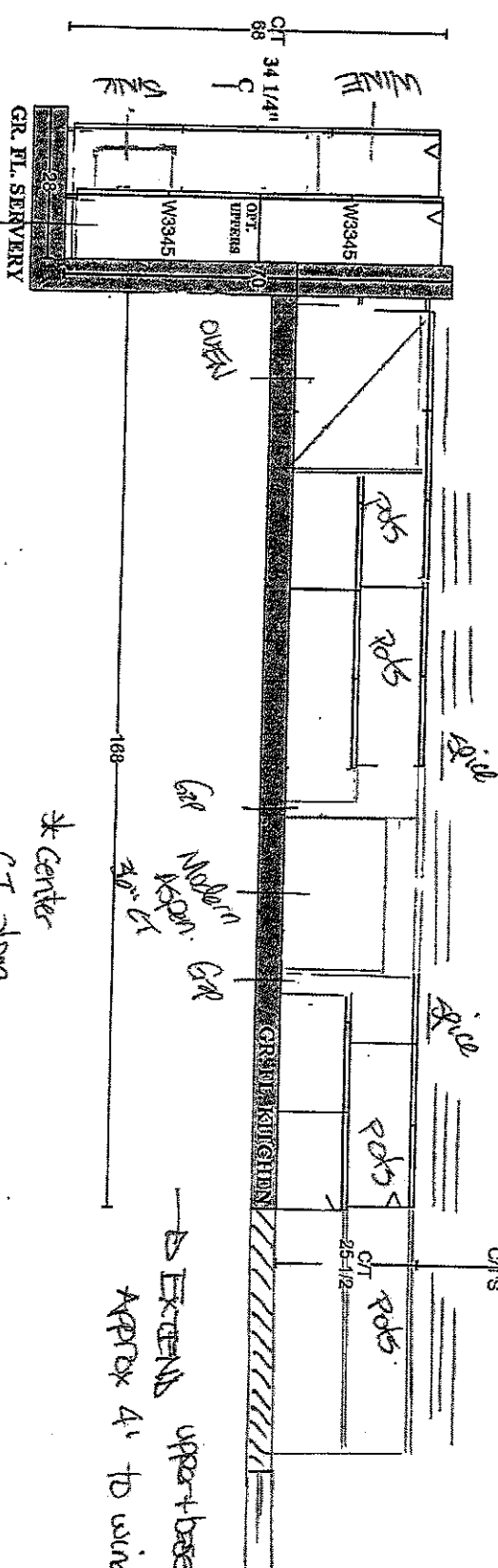

\* Center  
CT along  
New car  
Run

→ EXCISES upper + base.

PU-48  
 Model 1 2022 (S)

GOLDPARK HOMES  
 PINE VALLEY  
 VAUGHAN, ONTARIO  
 MODEL: (5003) OAKGROVE  
 LOT SPECIFIC 48

SITE STANDARD: WHITE 3/4" EXTENSION  
 SOFT-CLOSE DRAWERS WITH STANDARD  
 SLAM DOOR HINGES

Gold handles  
 w/inselle overlay

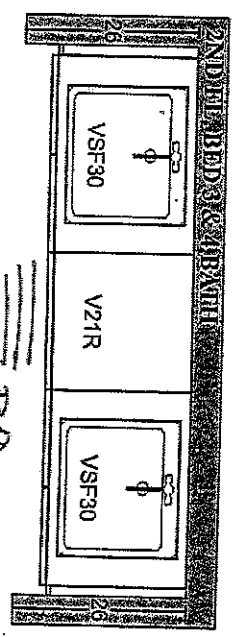
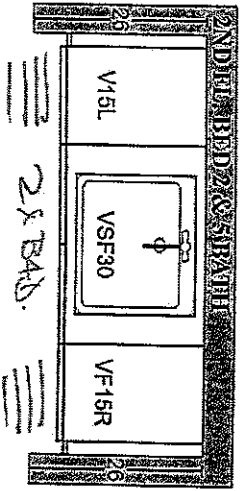

B4D.  
 w/inselle overlay  
 Black handles.

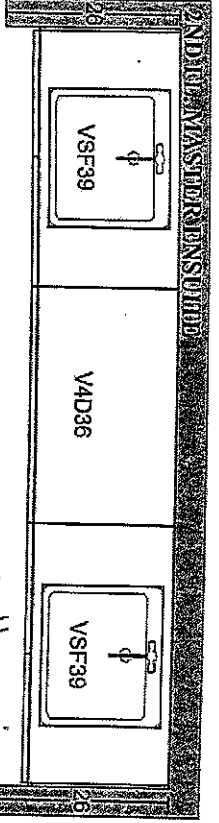

Moderna white + Gold hardware.

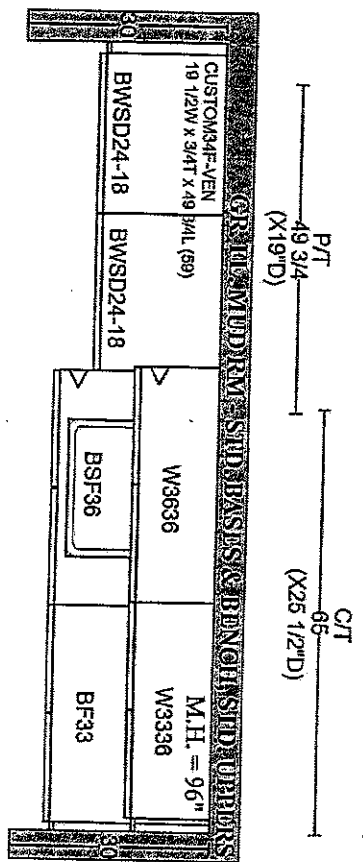

P/T 49 3/4"  
 C/T 65"  
 (X19"D)  
 (X25 1/2"D)

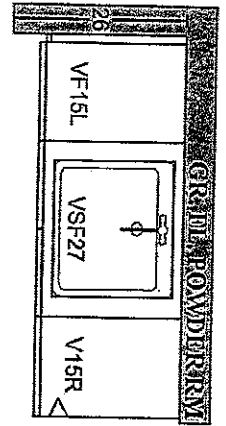

w/inselle overlay  
 Gold hardware.  
 Black metal feet

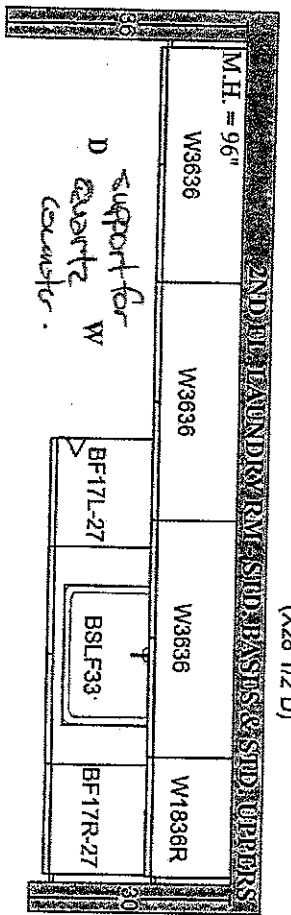

LT 68"  
 (X28 1/2"D)

support for  
 D quartz w  
 counter.

Moderna - white  
 Black handles

PLAN VIEW



UPGRADE HARDWARE



BAH-053-09

Appliance Pull - 'Brushed Gold'



LOCATION:

KITCHEN

LOT # 48	DATE: FEB 25 2022
-------------	----------------------

SIGNATURE: 

SIGNATURE:

UPGRADE HARDWARE



BH-052-09

'Brushed Gold'

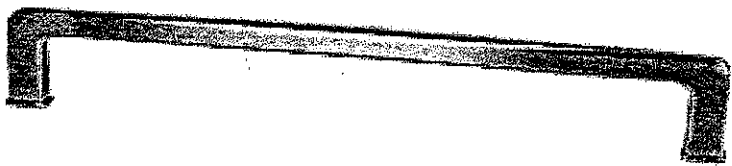

LOCATION:

KITCHEN  
ISLAND  
SERVING

LOT #  
48

DATE:  
FEB 25 2022

SIGNATURE: (KS)

SIGNATURE:

UPGRADE HARDWARE



BH-081-03

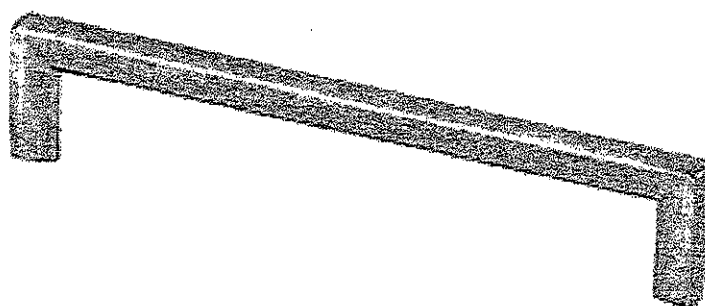

☐ BRUSHED NICKEL

☒ MATTE BLACK - LAUNDRY

☒ MODERN BRONZE - POWDER

- MUD

- MASTER

- SHAVED 2/5 + SHAVED 3/4.

LOCATION:

LOT #

48

DATE:

FEB 25 2022

SIGNATURE:

KS

SIGNATURE:



# UPGRADE DECORATIVE HOOD CABINET

PINE VALLEY  
FOREVERGREEN

## ASPEN MODERN HOOD

(Insert fan not included)

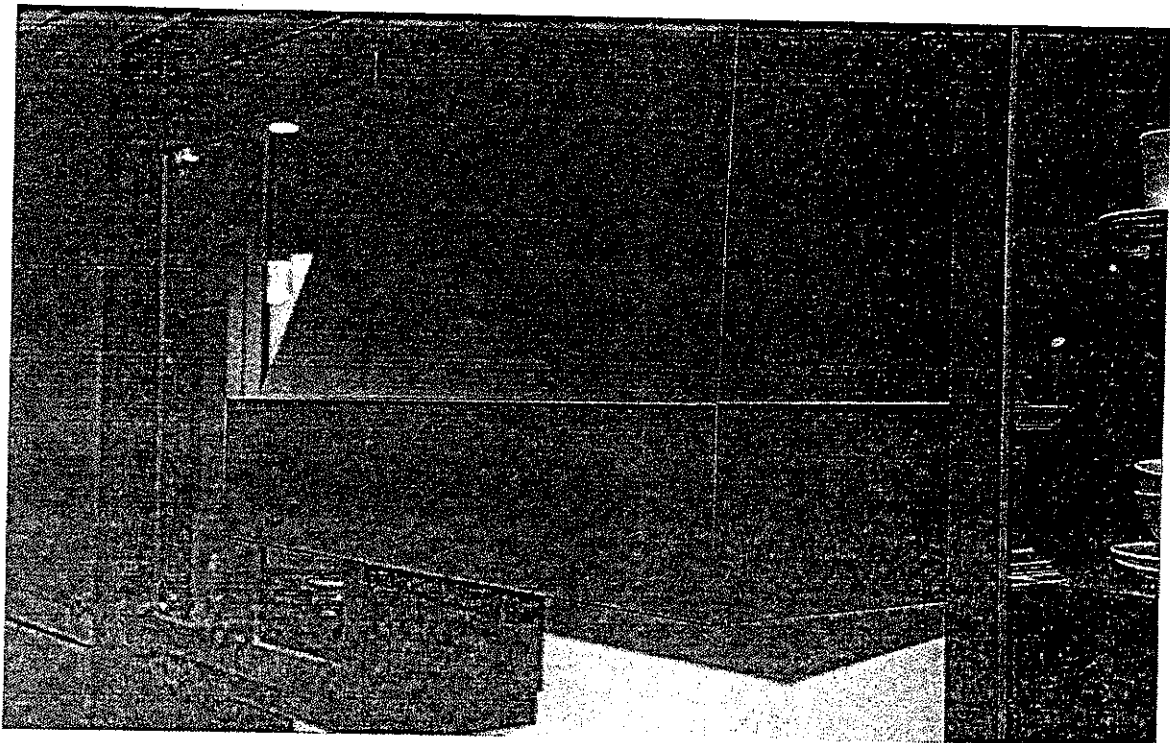

Lot# 48	Date: FEB 25 2022	Room: KITCHEN
Signature: (KS)		
Signature:		



PINE VALLEY

FOREVERGREEN

UPGRADE KITCHEN SINK

BLANCO - PRECIS U SUPER SINGLE

Silgranit - Undermount Sink

32" x 19"

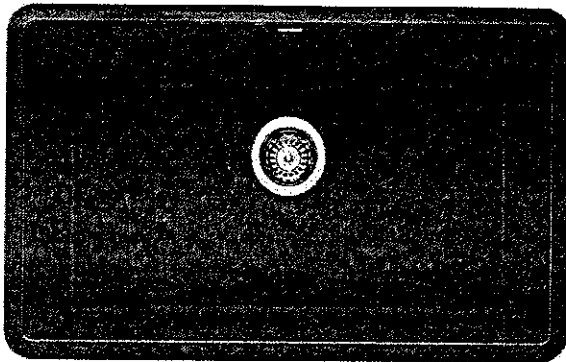

Anthracite

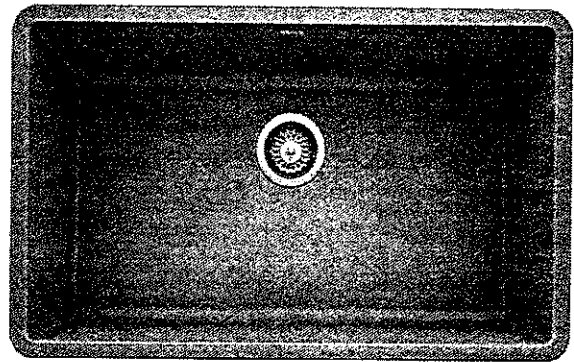

Concrete Grey

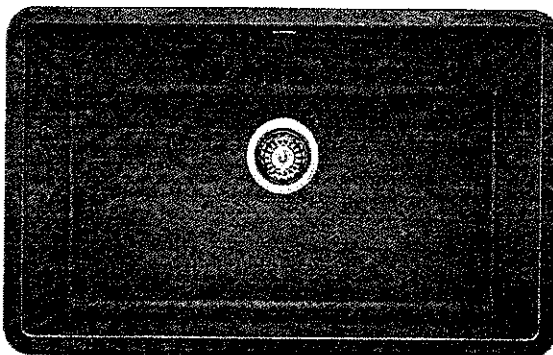

Metallic Grey

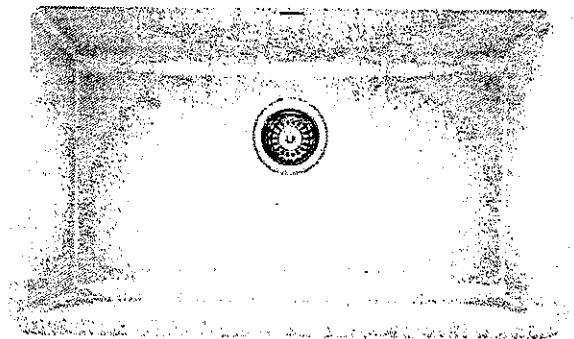

White

☒ ANTHRACITE - ~~SERVERY~~

☐ CONCRETE GREY

☐ METALLIC GREY

☒ WHITE - KITCHEN

MODEL 400890 Anthracite / 402266 Concrete Grey / 401683 Metallic Grey / 401820 White

Lot#  
48

Room:  
KITCHEN + ~~SERVERY~~

Signature:  
(KS)

Date:  
FEB 25 2022

Signature:

GOLDPARK  
WORTH MORE

UPGRADE KITCHEN FAUCET



MOEN - ALIGN

One-Handle Pulldown Kitchen Faucet

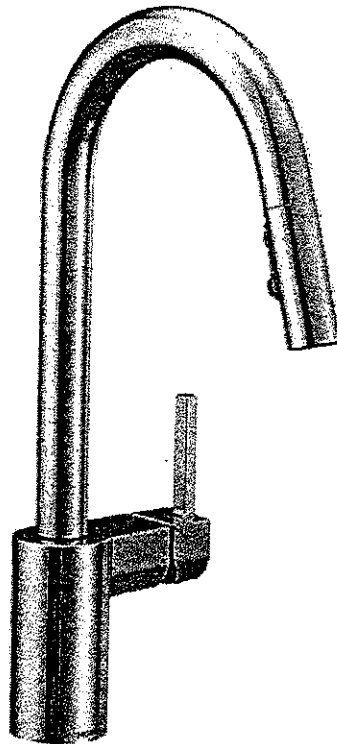

☐ CHROME\* - STANDARD

☐ STAINLESS (SRS)

☒ MATTE BLACK (BL) LAUNDRY ROOM

☒ BRUSHED GOLD (BG) KITCHEN + SERVERY + MUD ROOM

MODEL: 7565 Chrome / 7565SRS Stainless / 7565BL Matte Black / 7565BG Brushed Gold

Lot# 48	Date: FEB 25 2022	Room: KITCHEN + SERVERY + MUD ROOM + LAUNDRY
Signature: (KS)		
Signature:		

UPGRADE FAUCET



MOEN - SIP MODERN

Single Handle Beverage Faucet

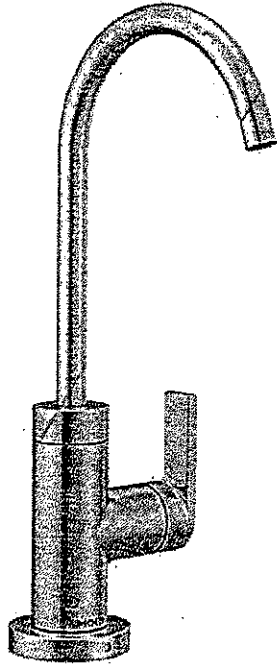

- ☒ GOLD (BG)
- ☐ CHROME (C)
- ☐ STAINLESS (SRS)
- ☐ MATTE BLACK (BL)
- ☐ BLACK STAINLESS (BLS)

MODEL: S5530 / S5500

LOCATE Right of faucet  
DO NOT PLUMB, purchaser to  
finish plumbing to own water  
filtration system after closing

Lot# 48	Date: March 1 2022	Room: Kitchen
------------	-----------------------	------------------

Signature: (KS)
--------------------

Signature: ( )
-------------------

UPGRADE LAUNDRY SINK

BLANCO - LIVEN  
Silgranit - ~~UNDERMOUNT~~  
25" x 22" x 12"

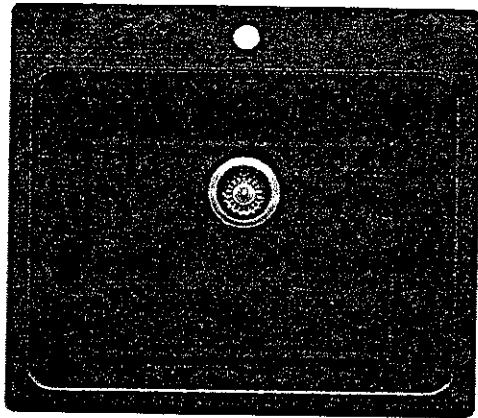

Anthracite

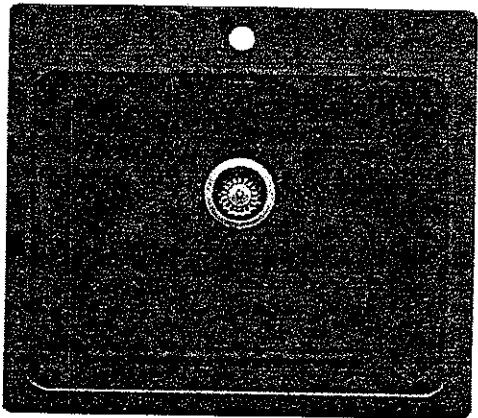

Concrete Grey

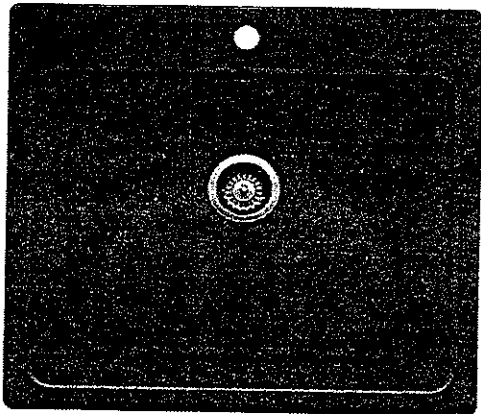

Metallic Grey

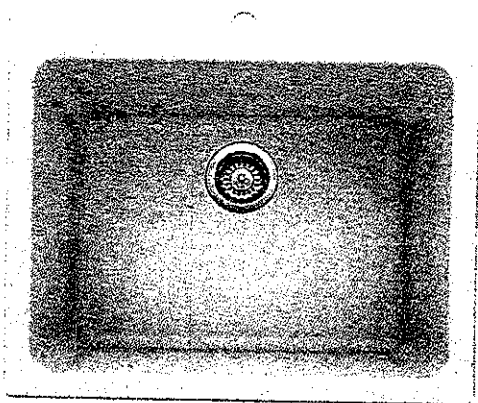

White

- ☒ ANTHRACITE - Laundry Room
- ☐ CONCRETE GREY
- ☐ METALLIC GREY
- ☒ WHITE - Mud Room

MODEL 401902 Anthracite / 402297 Concrete Grey / 401906 Metallic Grey / 401908 White /

Lot# 48	
Room: Mud Room + Laundry	Signature: KS
Date: FEB 25 2022	Signature:





PINE VALLEY  
FOREVERGREEN

STONE COUNTERTOP EDGE PROFILES

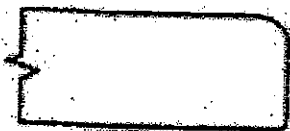

STANDARD 2CM EASED EDGE

LOCATION:

THRU OUT

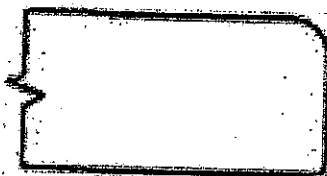

UPGRADE 3CM EASED EDGE

LOCATION:

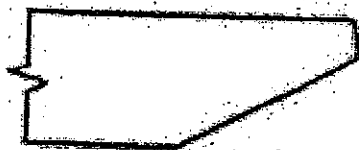

UPGRADE 4CM MITRED EDGE



LOCATION:



UPGRADE 2CM OGEE EDGE

LOCATION:

LOT # 48	DATE: FEB 25 2022
SIGNATURE: KS	
SIGNATURE:	

UPGRADE INTERIOR DOOR

LIVINGSTON DOOR

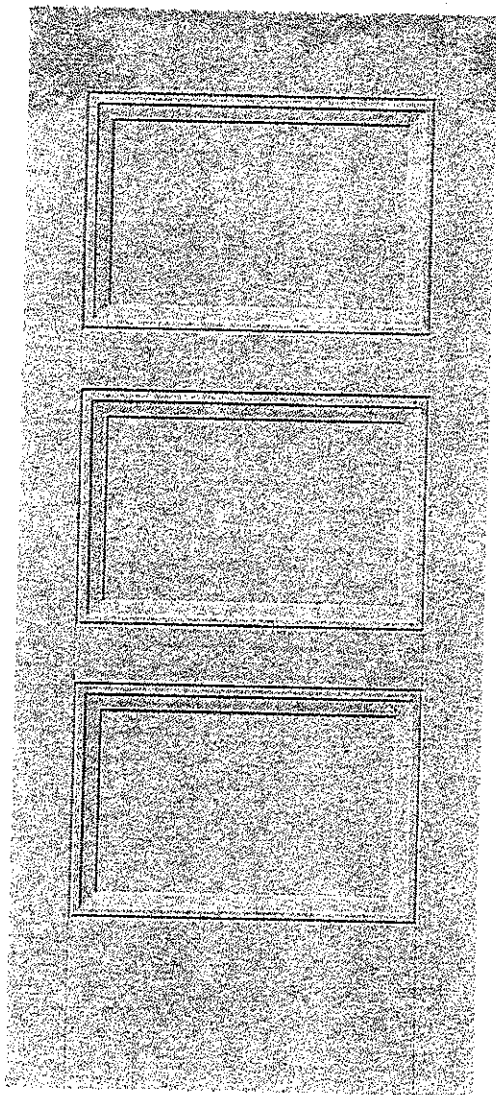

LOCATION:

THRU OUT

LOT # 48	DATE: FEB 25 2022
SIGNATURE: <div>KS</div>	
SIGNATURE:	

UPGRADE TOILET

CILA

Contrac  
Soft White  
1 Piece Elongated Bowl w/ Concealed Skirted Trap-Way

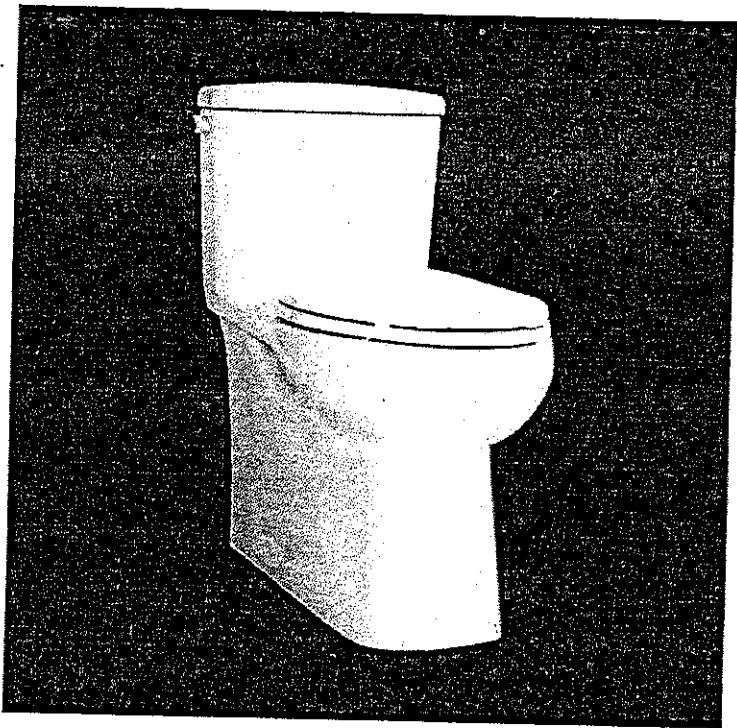

DESCRIPTION: Soft White, 17" plus height for greater comfort, Soft white tank lever

DIMENSIONS: 15 3/8" W x 28 1/2" D x 30 1/8" H

MODEL: 4710BOXU

Lot# 48	Date: <del>FEB</del> 25 2022	Room: THRU OUT
Signature: 		
Signature:		

UPGRADE SHOWER HARDWARE

RM6X6

Shower Door Handle

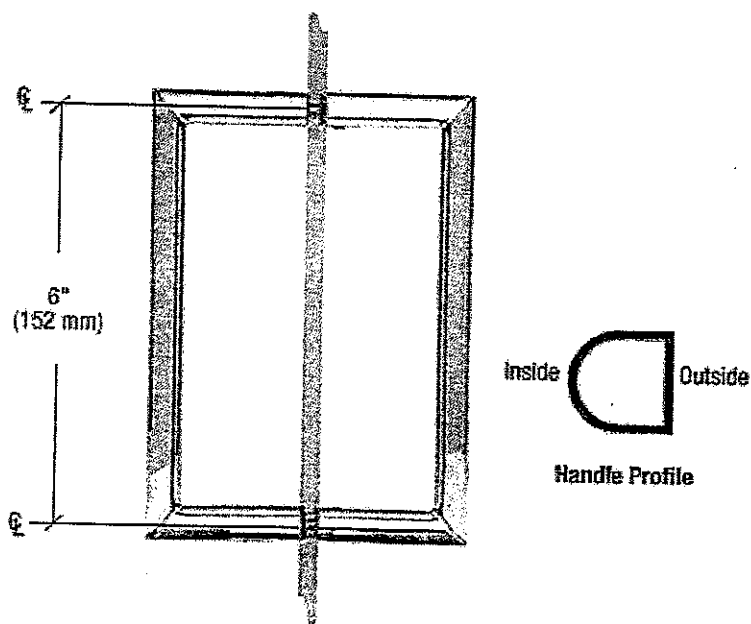

RM6X6  
Shower Door Handle

6" RM Series Flat Outside Surface  
/ Round Tubing Inside Back-to-  
Back Pull Handle

- ☐ CHROME (CH)  
☒ BRASS (BR)  
☐ BRUSHED NICKEL (BN)

Lot# 48	Date: FEB 25 2022	Room: MASTER ENSUITE + ENSUITE 3/4
Signature: 		
Signature:		

WINDOW STOOLS & APRONS

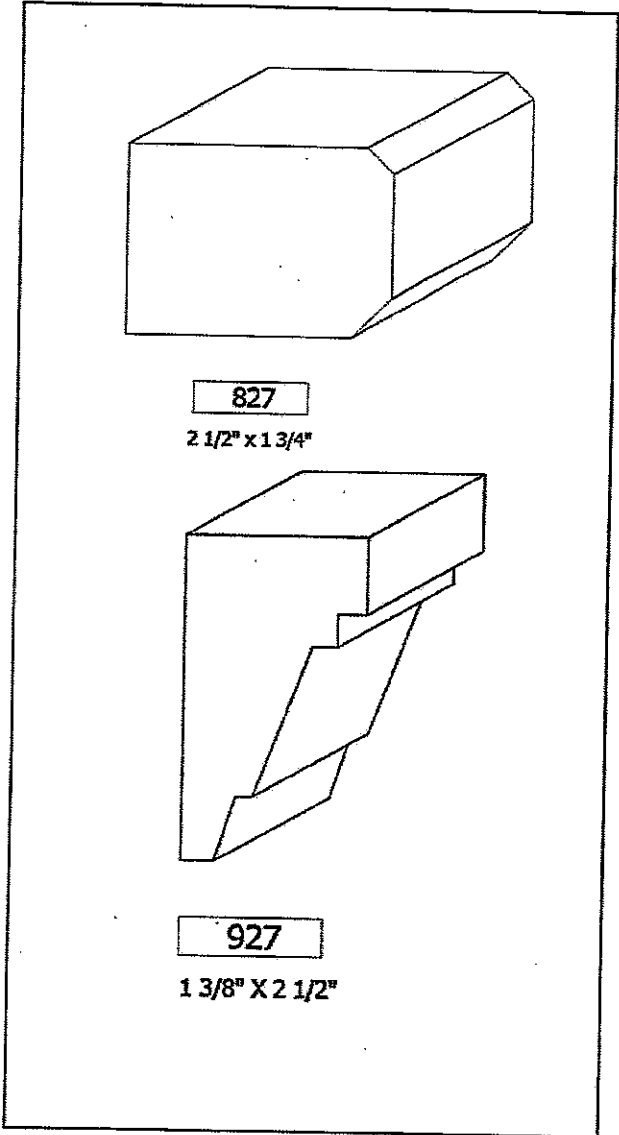
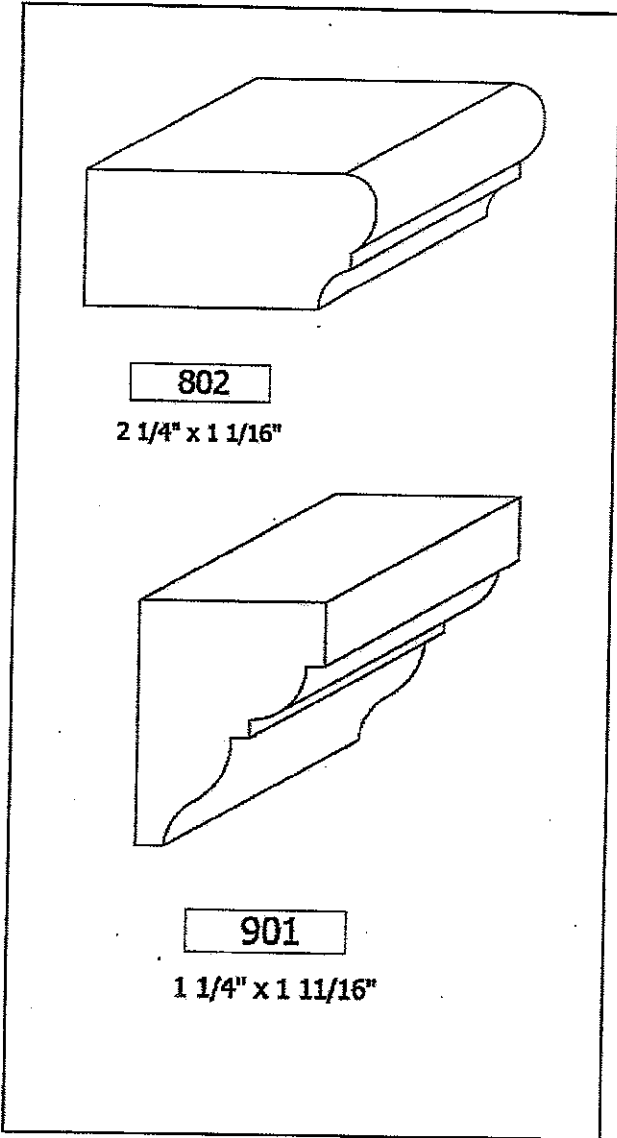

☒ 802 + 901 PACKAGE

☐ 827 + 927 PACKAGE

Lot# 48	Date: FEB 25 2022	Room: THRU OUT
Signature: KS		
Signature:		



CAPRI

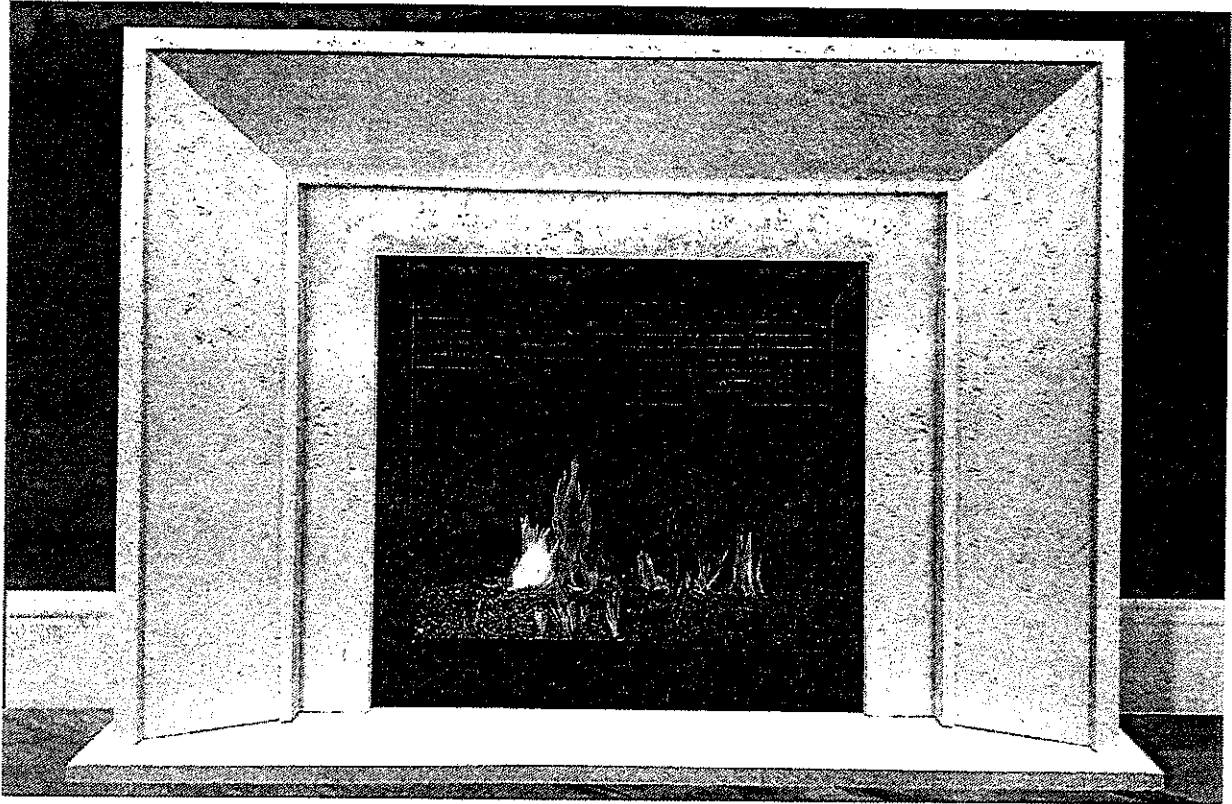

TOP VIEW

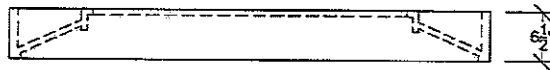

**SIDE VIEW**

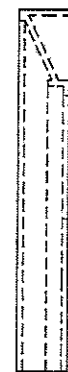

FRONT VIEW

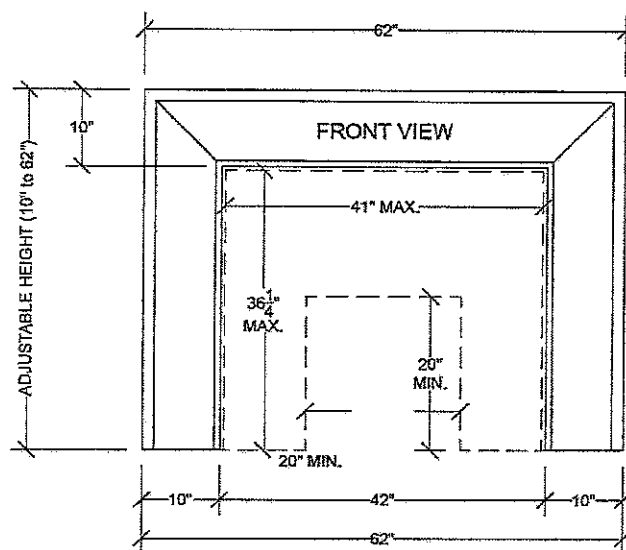

מנהל מחלקת המבחנים

LOT #: 48	DATE: <del>FEB</del> 25 2022	LOCATION: GREAT ROOM
SIGNATURE: KS		
SIGNATURE:		

MOEN - ALIGN

Single-Handle Lav Faucet with Rod Drain

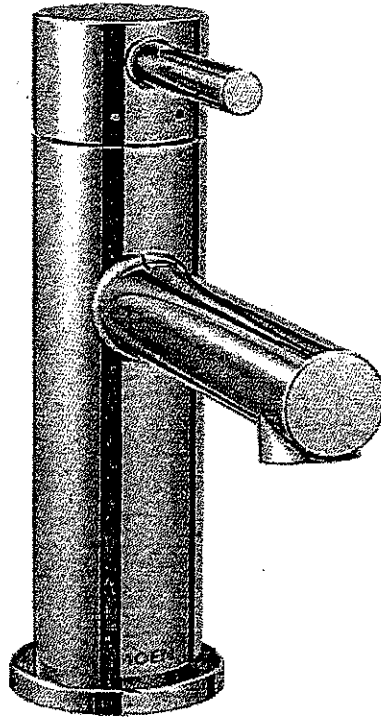

- ☐ CHROME
- ☐ BRUSHED NICKEL (BN)
- ☒ BRUSHED GOLD (BG)
- ☐ MATTE BLACK (BL)

THIS IS A REVERSED SELECTION

MODEL: 6190

Lot# 48	Date: MARCH 1 2022	Room: SHARED 2/5 + 3/4
Signature: 		
Signature:		



PINE VALLEY  
FOREVERGREEN

PLUMBING UPGRADES

MOEN - ALIGN

Eco-Performance Posi-Temp Tub/Shower Faucet

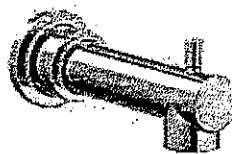
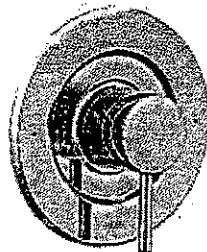
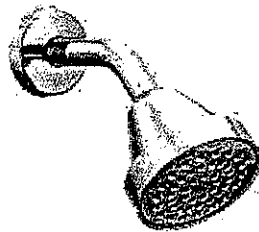

- ☐ CHROME
- ☐ BRUSHED NICKEL (BN)
- ☒ BRUSHED GOLD (BG)
- ☐ MATTE BLACK (BL)

THIS IS A REVISED SELECTION

MODEL: T2193EP / 62320 / 226651

Lot# 48	Date: MARCH 1 2022	Room: SHARED: 2/5.
Signature: KS		
Signature:		

GOLDPARK  
WORTH MORE





PINE VALLEY  
FOREVERGREEN

PLUMBING UPGRADES

MOEN - ALIGN .

Eco-Performance Posi-Temp SHOWER ONLY\* Faucet

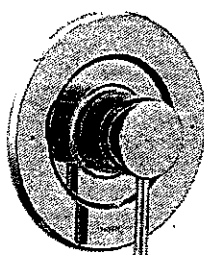
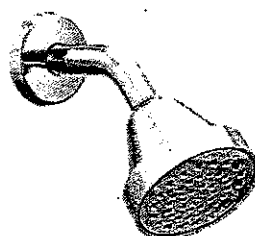

- ☐ CHROME (EP)
- ☒ BRUSHED GOLD (BG)
- ☐ MATTE BLACK (BL)

THIS IS A REVISED SELECTION

MODEL: T2192EP / 62320 / 226651

Lot# 48	Date: March 1 2022	Room: SHARED 3/4
Signature: KS		
Signature:		

GOLDPARK  
WORTH MORE

## BATHROOM ACCESSORIES



Tissue Holder  
Mason - Chrome

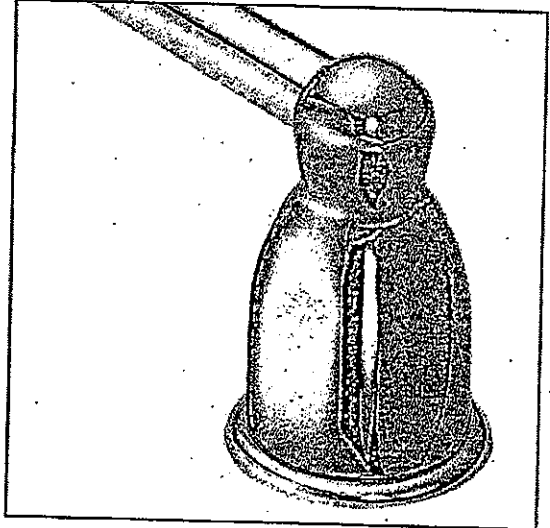

Towel Bar  
Mason - Chrome

Please select one of the following:

☐ INSTALL STANDARD BATHROOM ACCESSORIES THRU OUT  
(tissue holder + towel bar) *\*location as per vendors discretion\**

☒ **\*DO NOT\*** INSTALL STANDARD BATHROOM ACCESSORIES  
THRU OUT *\*tissue holder + towel bar will not be provided\**

LOT #

48

DATE:

~~FEB~~ 25 2022

SIGNATURE:

KS

SIGNATURE:



Project: PINE VALLEY

Lot: 48

Purchaser(s): KARAN PAL SINGH

Standard Hood Fan Deletion

We acknowledge that the builder's standard hood fan will not be installed.  
Do not supply, install and/or credit. We will install our own hood fan after closing.

Signature: \_\_\_\_\_

KS

Signature: \_\_\_\_\_

Date: FEB 25 2022



PINE VALLEY  
FOREVERGREEN

## PLUMBING UPGRADES

### MOEN - RIZON

Eco-Performance Posi-Temp Tub/Shower Faucet

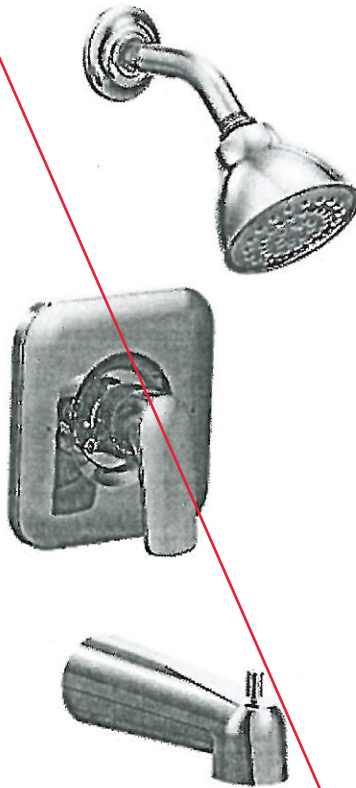

Please see  
revised  
selection  
dated March  
1/22

- ☐ CHROME
- ☐ BRUSHED NICKEL (BN)
- ☒ MATTE BLACK (BL)

MODEL: T2813EP / 62320

Lot#

48

Date:

Dec 8 2021

Room:

SHARED 2/5

Signature:

*[Handwritten signature]*

Signature:

GOLDPARK  
WORTH MORE™

ALIGN MASTER ENSUITE PACKAGE

\*Brushed Gold

MOEN

Lav Faucets, 8" Rainshower, Handshower, Free-Standing Tub Filler

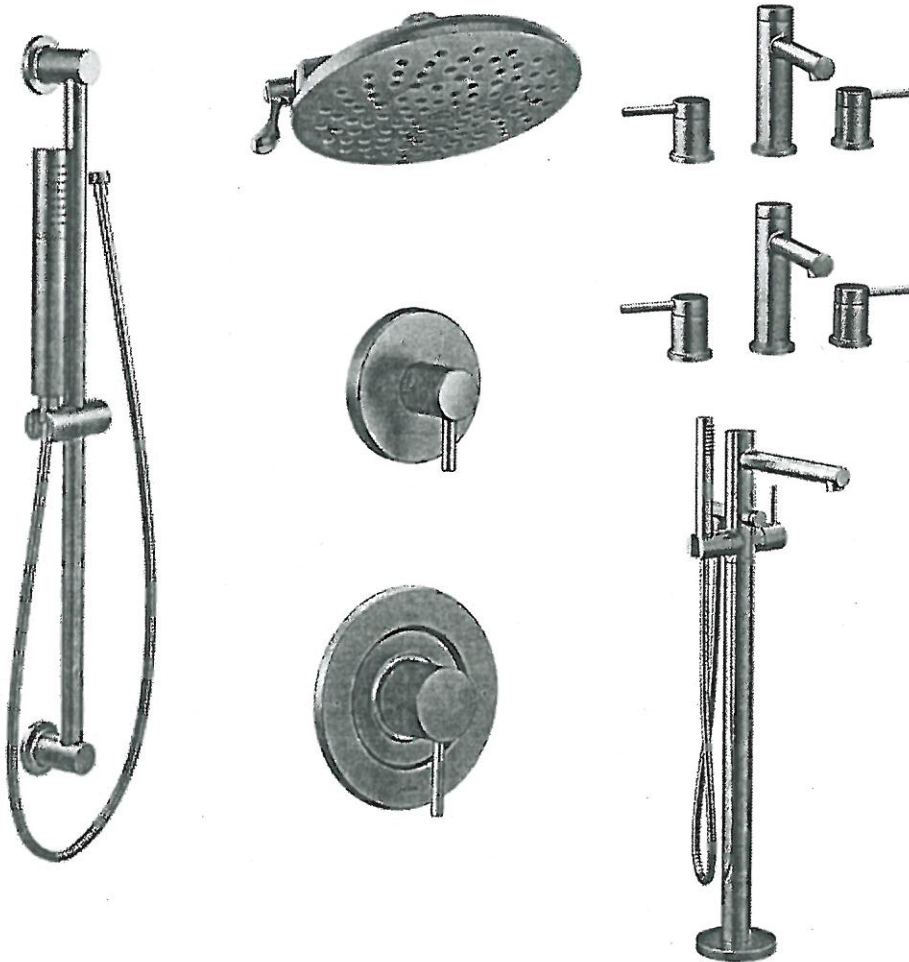

☐ WALL  
☒ CEILING

MODEL: S6320 Shower Head + 226651 Shower Arm + T6193/69000 Lav Facuets(x2) + 395/TS50100 Tub Filler + T2192 Shower + U361CI Transfer Valve + UT4191 Transfer + 62320 Temp Valve + 3887 Handshower + A725 Drop El

Lot# 48	Date: DEC 8 2021	Room: MASTER ENSUITE
Signature: [Signature]		
Signature:		

MOEN - ALIGN

Single Freestanding Tub Filler



- ☐ CHROME (EP)
- ☐ BRUSHED NICKEL (BN)
- ☐ MATTE BLACK (BL)
- ☒ BRUSHED GOLD (BG)

MODEL: 395 / TS50100

Lot# 48	Date: Dec 8 2021	Room: MASTER ENSUITE
Signature: 		
Signature:		

PLUMBING UPGRADES

MOEN - RIZON

Eco-Performance Posi-Temp SHOWER-ONLY\*

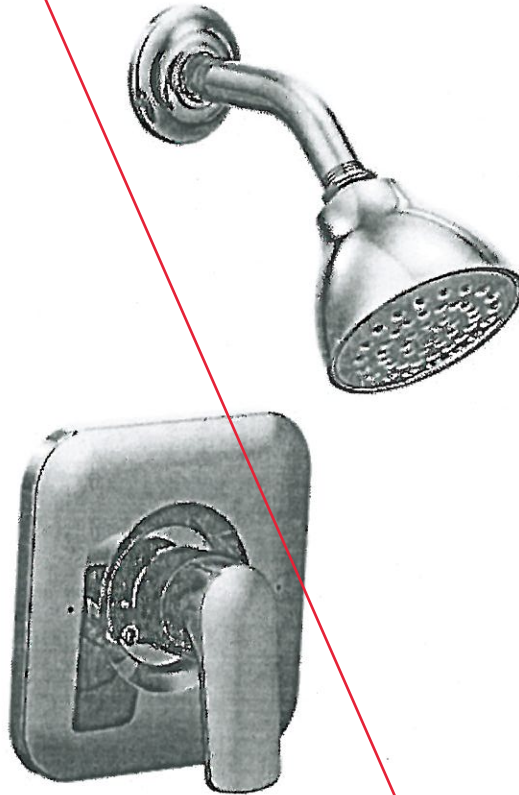

Please see  
revised  
selection  
dated March  
1/22

☐ CHROME - STANDARD

☐ BRUSHED NICKEL (BN)

☒ MATTE BLACK (BL)

MODEL: T2812EP / 62320

Lot# 48	Date: DEC 8 2021	Room: SHADE EN SUITE 3/4.
Signature: 		
Signature:		



PU-48  
MAR 3 2022



## JENN-AIR® 48-INCH BUILT-IN SIDE-BY-SIDE REFRIGERATOR

PANEL-READY

### Signature Features

JS48NFXDE

#### OBSIDIAN INTERIOR

Exclusive Obsidian interior dazzles guests as food item colors "pop", even in matching crisper drawers and the freezer.

#### PRECISION TEMPERATURE MANAGEMENT™ SYSTEM

A sensor-controlled system that uses a variable-speed compressor with an independent sensor in each compartment to monitor and adjust temperatures.

#### MULTI-POINT LED THEATER LIGHTING

Multiple LED lights increases visibility and beautifully showcases food items against the Obsidian interior, on both Elegance Shelving.

#### FULLY FLUSH, FULLY INTEGRATED DESIGN

This integrated built-in refrigerator fits beautifully into any decor, blending into custom cabinetry with a truly seamless appearance, reflecting your appreciation for the fine details of design. Must be installed in a 25" deep cabinet to achieve the fully flush look.

#### ADVANCED CLIMATE CONTROL DRAWER

A dedicated storage drawer with electronic control which provides precise, independent temperature control for sensitive foods.

#### CAPACITIVE TOUCH CONTROLS WITH LED DISPLAY

Allow independent control of refrigerator and freezer temperatures with an integrated design that is easy-to-clean and responds to touch for easy operation.

#### STYLE WITH CUSTOM WOOD PANELS OR SUITE-COORDINATING STAINLESS STEEL PANEL KITS (NOT INCLUDED)

Customize the exterior with wood panels to seamlessly blend with surrounding cabinetry for a fully integrated look, or pair with Euro-Style or Pro-Style® Stainless panel kits to match other Jenn-Air® suite appliances.

#### PRODUCE PRESERVER

Delays over-ripening\* of certain fruits and vegetables by absorbing ethylene gas. \*Based on commonly purchased produce.

#### SOFT-CLOSE CRISPER DRAWERS

Soft-Close technology lets refrigerator drawers close softly, quietly, and securely.



### Dimensions

Freezer Volume: 2971.50 l

Refrigerator Volume: 5292.10 l

Capacity: 29-1/5

Cabinet Width: 11938.00 cm

Depth Closed Excluding Handles: 6286.50 cm

Depth Excluding Doors: 6096.00 cm

Depth With Door Open 90 Degree: 12763.50 cm

Depth: 6286.50 cm

Height: 21113.75 cm

Net Weight: 287123736.00 kg

Width: 12128.50 cm

### Controls

Max Cool/Fast Cool: Yes

Door Ajar/Open Alarm: Yes

Control Location: Interior Up Front

Air Filter Indicator/Reset: No

### Technical Specifications

#### Configuration and Overview

Counter Depth: Yes

Installation Option: Built-In

#### Appearance

Hidden Hinge: Yes

Door Style: Flat

Reversible Door: No

#### Filter Details

Water Filter Indicator/Reset: Yes

Water Filter Location: Exterior

Produce Preserver: Yes

#### Refrigerator Details

Number of Interior Shelves: 3

#### Certifications

Prop 65: Standard

Energy Star® Qualified: No

CEE Tier: Not Rated

#### Details

Cooling Type: Single Evaporator

Freezer Compartment

Door Bins: 5 Adjustable Full-Width

Light: LED

#### Configuration

Installation Configuration: Built-In

Refrigeration Configuration: Refrigerator

EndecaProps



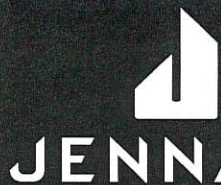

# 48" FULLY INTEGRATED SIDE BY SIDE REFRIGERATOR

## DETAILED PLANNING DIMENSIONS GUIDE

(BASE UNIT REQUIRES SUITE-COORDINATING FULL HEIGHT PANEL KIT OR CUSTOM PANELS AND HANDLES)

JS48NFXDE – 47<sup>3</sup>/<sub>4</sub>" (W) x 83 / " (H) x 24" (depth without door panels/handles)

### PRODUCT DIMENSIONS INCLUDING STAINLESS STEEL DOOR PANEL KIT DIMENSIONS

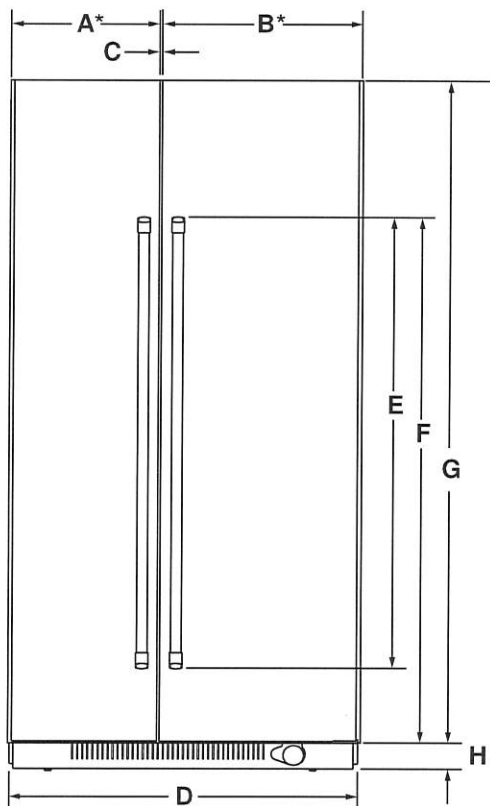

FRONT VIEW

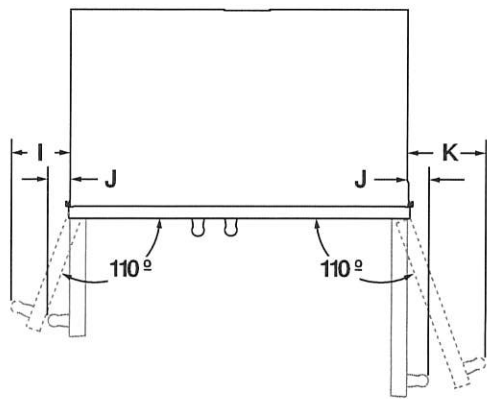

TOP VIEW

DIMENSION	DESCRIPTION	JS48NFXDE
A*	Width of freezer door	20 / " (51.6 cm)
B*	Width of refrigerator door	27 / " (69.4 cm)
C	Space between doors	1/8" (0.3 cm)
D	Overall width (including vinyl side trim)	47 / " (121.3 cm)
E	<b>Height of door handle</b>	
	RISE™ Stainless	58" (147.3 cm)
	NOIR™ Stainless	40 / " (103.2 cm)
F	<b>Height to top of door handle</b>	
	RISE™ Stainless	71 / " (182.1cm)
	NOIR™ Stainless	69 / " (177.3 cm)
G	Height of door	8" (205.7 cm)
H	Height of bottom grille	3" (7.6 cm)
I	<b>Width from side of refrigerator to freezer door handle – door fully open 110°</b>	
	RISE™ Stainless	8 / " (20.7 cm)
	NOIR™ Stainless	7 / " (19.3 cm)
J	<b>Width from side of refrigerator to handle – door open 90°</b>	
	RISE™ Stainless	2 / " (6.1cm)
	NOIR™ Stainless	1 / " (4.1cm)
K	<b>Width from side of refrigerator to refrigerator door handle – door fully open 110°</b>	
	RISE™ Stainless	10 / " (26.8 cm)
	NOIR™ Stainless	10 / " (25.5 cm)

\*Door width dimensions are for stainless steel panel kit only.

PU-48  
MAR 3 2022



# 48" FULLY INTEGRATED SIDE BY SIDE REFRIGERATOR

## DETAILED PLANNING DIMENSIONS GUIDE

(BASE UNIT REQUIRES SUITE-COORDINATING FULL HEIGHT PANEL KIT OR CUSTOM PANELS AND HANDLES)

JS48NFXDE – 47<sup>3</sup>/<sub>4</sub>" (W) x 83 / " (H) x 24" (depth without door panels/handles)

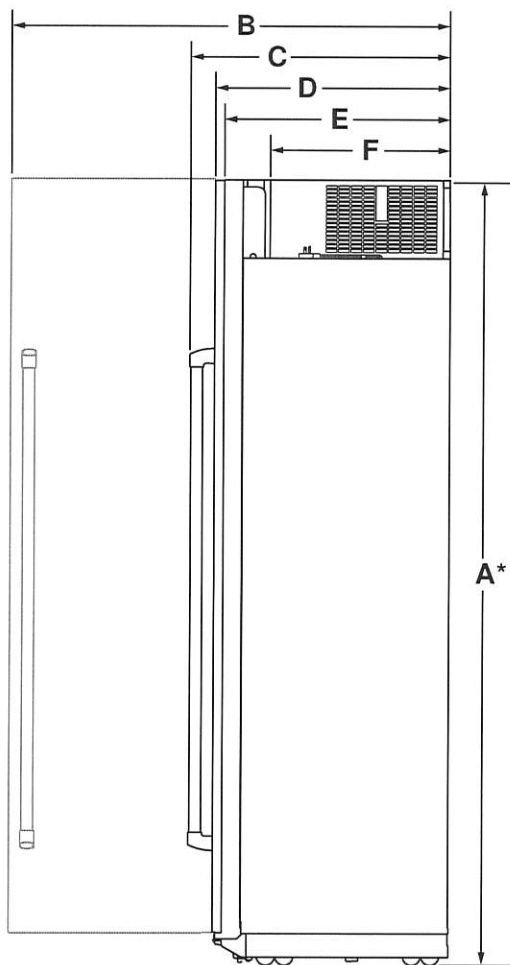

SIDE VIEW

DIMENSION	DESCRIPTION	JS48NFXDE
A*	Height of recessed refrigerator (min.)	83 / " (211.1 cm)
B	Depth with refrigerator door open 90° (min.)	50 / " (128.8 cm)
C	Depth with handles (min.)	
	RISE™ Stainless	27 / " (70.2 cm)
	NOIR™ Stainless	26 / " (68.2 cm)
D	Depth with doors (min.)	
	RISE™ Stainless	24 / " (62.8 cm)
	NOIR™ Stainless	24 / " (62.8 cm)
	Custom panel (3/4"/1.9 cm)	24 / " (62.8 cm)
E	Depth without door panel kit (min.)	24" (61 cm)
F	Depth of compressor cover (min.)	19 / " (50.5 cm)

\*Add 1 / " (3.2 cm) to the height dimension when leveling legs are fully extended.

*attached*  
PV-48  
March 3 2022



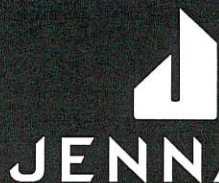

# 48" FULLY INTEGRATED SIDE BY SIDE REFRIGERATOR

## DETAILED PLANNING DIMENSIONS GUIDE

(BASE UNIT REQUIRES SUITE-COORDINATING FULL HEIGHT PANEL KIT OR CUSTOM PANELS AND HANDLES)

JS48NFXDE - 47 3/4" (W) x 83" (H) x 24" (depth without door panels/handles)

### AIRFLOW VENTING RECOMMENDATIONS

### CLOSED SOFFIT CABINET

### OPEN TO CEILING OR SOFFIT CABINET

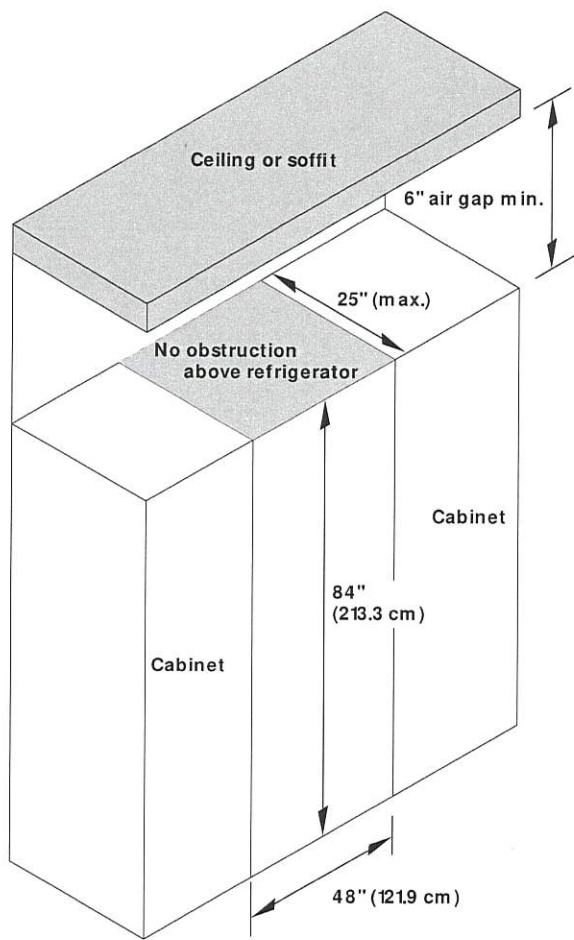

- These type of installations require a minimum of 6" (15.24 cm) of open space above the refrigerator. This space must not be blocked in any way, including soffits.
- Depth of cabinet must be less than 25" (63.5 cm).
- If your opening does not meet these requirements, you will need to make modifications.

PV-48 *stock*  
March 3 2022

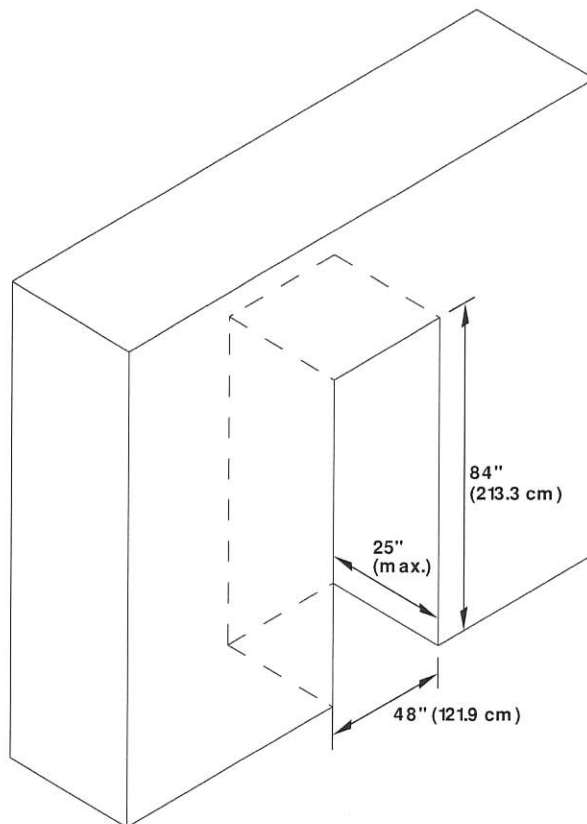

- Depth of cabinet must be less than 25" (63.5 cm).
- Height of soffit must not exceed 84" (213.3 cm).
- Following illustrations explain the cabinet construction (soffit and rear wall positions) required for optimum ventilation and airflow.

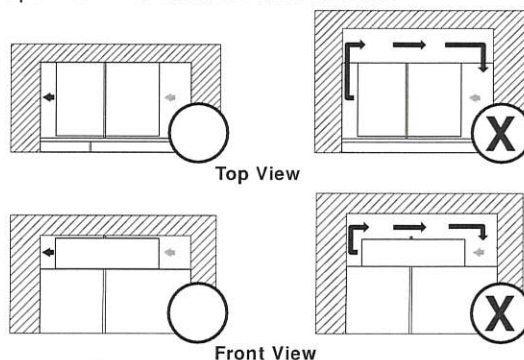

Grey arrow = ambient air; Black arrow = warm air

Cabinet depth 25" and soffit located at 84", provides proper airflow/ventilation to the refrigerator. Efficient cooling is achieved.

Cabinet depth more than 25" and/or soffit located at more than 84", causes air gap at back and/or top of the refrigerator. Air gap allows warm air recirculation causing loss in cooling efficiency.

- If your opening does not meet these requirements, you will need to make modifications.



# 48" FULLY INTEGRATED SIDE BY SIDE REFRIGERATOR

## DETAILED PLANNING DIMENSIONS GUIDE

(BASE UNIT REQUIRES SUITE-COORDINATING FULL HEIGHT PANEL KIT OR CUSTOM PANELS AND HANDLES)

JS48NFXDE – 47<sup>3</sup>/<sub>4</sub>" (W) x 83 / " (H) x 24" (depth without door panels/handles)

### CLEARANCE DIMENSIONS

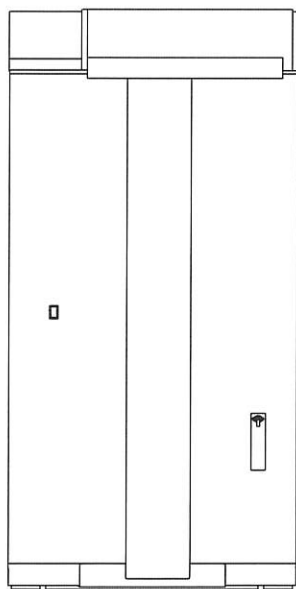
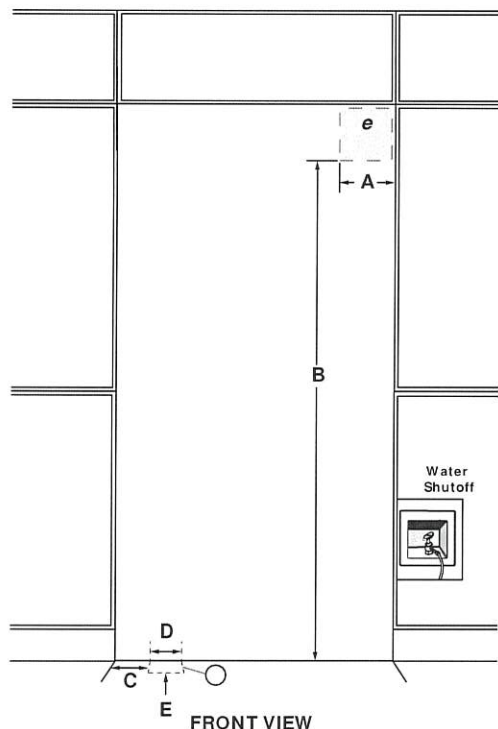

DIMENSION	DESCRIPTION	JF42NFXDE
A	Width of recommended electrical location	7 / " (19.1 cm )
B	Height to recommended electrical location	77" (195.6 cm )
C	Distance from side of cabinet to recommended water connection location	6 / " (16.5 cm )
D	Width of recommended water location	1 / " (3.81 cm )
E	Depth of recommended water connection location (max.)	2" (5 cm )
E	Recommended electrical connection location	
	Recommended water connection location	

\*A minimum 2" (5.1cm) furniture return must extend behind the face of the cabinet on all sides.

PU-48  
March 3 2022



PV-48 ~~Atab~~  
March 3 2022



## EURO-STYLE 36" 5-BURNER GAS COOKTOP

### Signature Features

#### 20,000 BTU DUAL-STACKED POWERBURNER

The most powerful cooktop burner offered by Jenn-Air, the 20,000 BTU dual-stacked PowerBurner can sear, create a rapid boil or achieve high heat for wok cooking, and can reach an ultra-low 700 BTUs that makes it possible to melt chocolate or butter without scorching.

#### LOW-PROFILE DESIGN

With an extremely low profile, you can have a minimal look — nearly flush with the countertop — for an integrated transition to the cooktop.

#### SINGLE POINT ELECTRONIC IGNITION AND FLAME-SENSING™ RE-IGNITION

If the flame is accidentally blown out by a draft, a spark occurs that automatically re-ignites the extinguished burner.

#### BRASS BURNERS WITH REMOVABLE BASE

Elegant brass burners effectively direct heat for desired cooking results and can be removed for easy cleaning.

#### 6,000 BTU SIMMER BURNER WITH MELT CAP

With a power output ranging from 6,000 BTUs to below 1,000 BTUs, this simmer burner gives you maximum control while simmering sauces and melting delicate ingredients like chocolate and butter.

#### WHITE LED BURNER INDICATOR

White indicator light glows indicating when a burner is on, providing a modern look and a convenient reminder for cooks.

JGC3536GS

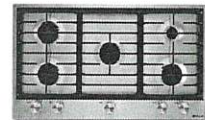

### Dimensions

Depth: 5334.00 cm

Width: 9144.00 cm

### Controls

Knob Color: Stainless Steel

Infinite Heat Controls: Yes

Knob Type: Metal

Control Location: Front

Design Type

Design Expression: Stainless Steel

### Technical Specifications

#### Configuration and Overview

##### Size:

- 9144.00 cm
- 36 cm

Cooktop Type: Traditional

Fuel Type: Gas

LP Convertible: Yes - Kit Included

Installs Over Built-In Oven: Yes

Power Boost: No

#### Cooktop Details

Automatic Pan Detection: No

Downdraft Vent: No

Heating Element On Indicator Light: No

Hot Surface Indicator Light: No

Cooktop Element Style: Sealed Burner

Cooktop Surface Color: Stainless

Number of Cooking Element-Burners: 5

#### Cooktop Details

##### Grate Details:

- Dishwasher Safe
- Matte Finish
- Cast Iron Grates
- Individual

##### Appearance

Digital Display: No

##### Certifications

ADA Compliant: Yes

Prop 65: Standard

##### EndecaProps

ProductOutletCategories: Cooking

##### Features

Power Outage Compatible: Yes

##### Details

Cooktop Surface Material: Stainless Steel

##### Description

Fuel Type: Gas

# INSTALLATION REQUIREMENTS

FU-48  
MARCH 3 2022

## Tools and Parts

Gather the required tools and parts before starting installation.

### Tools needed

- Tape measure
- Flat-blade screwdriver
- $15/16$ " combination wrench
- Pipe wrench
- Channel lock pliers
- Marker or pencil
- Pipe-joint compound resistant to Propane gas
- Noncorrosive leak-detection solution

### Parts supplied

- Gas pressure regulator
- Burner grates (3)
- Burner bases (5)
- Burner caps (5)
- Simmer cap
- Clamp brackets (2)
- $2\frac{1}{2}$ " clamping screws (2)
- Foam tape seal
- Propane conversion kit—W10686634

### Parts needed

Check local codes and consult gas supplier. Check existing gas supply and electrical supply. See the "Electrical Requirements" and "Gas Supply Requirements" sections.

## Location Requirements

**IMPORTANT:** Observe all governing codes and ordinances. Do not obstruct flow of combustion and ventilation air.

- It is the installer's responsibility to comply with installation clearances specified on the model/serial/rating plate. The model/serial rating plate is located on the underside of the cooktop burner box.
- Do not unpack the burner grates and bases until after the cooktop is installed to avoid scratching the cooktop.
- The cooktop should be installed in a location away from strong draft areas, such as windows, doors, and strong heating vents or fans.
- All openings in the wall or floor where cooktop is to be installed must be sealed.
- Cabinet opening dimensions that are shown must be used. Given dimensions are minimum clearances.
- Grounded electrical supply is required. See the "Electrical Requirements" section.
- Proper gas supply connection must be available. See the "Gas Supply Requirements" section.
- The gas and electric supply should be located as shown in "Gas and Electric Connection Locations" in the "Location Requirements" section so that they are accessible without requiring removal of the cooktop.

**IMPORTANT:** To avoid damage to your cabinets, check with your builder or cabinet supplier to make sure that the materials used will not discolor, delaminate, or sustain other damage.

## Mobile Home—Additional Installation Requirements

The installation of this cooktop must conform to the Manufactured Home Construction and Safety Standard, Title 24 CFR, Part 3280 (formerly the Federal Standard for Mobile Home Construction and Safety, Title 24, HUD Part 280). When such standard is not applicable, use the Standard for Manufactured Home Installations, ANSI A225.1/NFPA 501A or local codes.

In Canada, the installation of this cooktop must conform with the current standards CAN/CSA-A240-latest edition, or with local codes.

## Product Dimensions

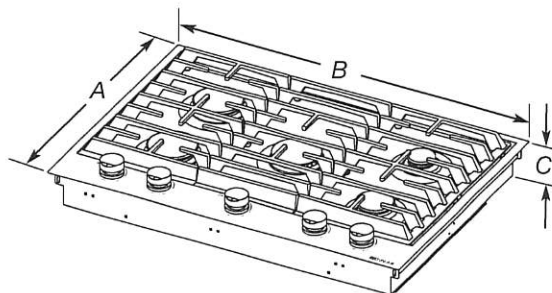

- A. 21" (53.3 cm)
- B. 30" (76.2 cm) on 30" (76.2 cm) models  
36" (91.4 cm) on 36" (91.4 cm) models
- C.  $3\frac{1}{4}$ " (8.3 cm)

## Gas and Electric Connection Locations

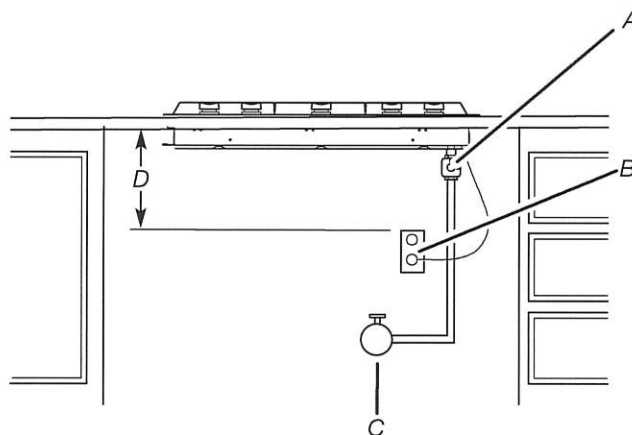

- A. Gas pressure regulator (supplied)—arrow pointed toward cooktop
- B. 3 prong grounding type outlet with correct polarity
- C. Gas shut-off valve
- D. 18" (45.7 cm) minimum



## Installation Clearances

**IMPORTANT:** If installing a range hood or microwave hood combination above the cooking surface, follow the range hood or microwave hood combination installation instructions for dimensional clearances above the cooktop surface.

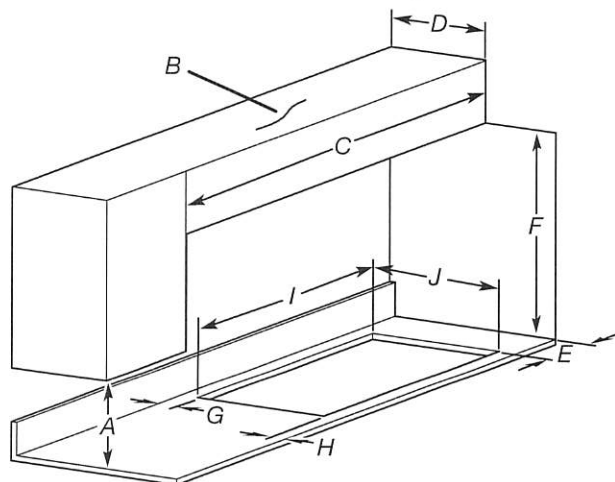

- A. 18" (45.7 cm) minimum clearance upper cabinet to countertop
- B. Cabinet
- C. 36" (91.4 cm) on 30" (76.2 cm) models  
42" (106.7 cm) on 36" (91.4 cm) models
- D. 13" (33 cm) maximum recommended upper cabinet depth
- E. 6" (15.2 cm) minimum side wall clearance
- F. 30" (76.2 cm) minimum clearance between top of cooktop platform and bottom of uncovered wood or metal cabinet (24" [61 cm] minimum clearance if bottom of wood or metal cabinet is covered by not less than 1/4" [0.6 cm] flame retardant millboard covered with not less than No. 28 MSG sheet steel, 0.015" [0.04 cm] stainless steel, or 0.024" [0.06 cm] aluminum or 0.020" [0.05 cm] copper)
- G. 2<sup>5</sup>/<sub>16</sub>" (5.9 cm) minimum distance to rear combustible surface
- H. 2<sup>5</sup>/<sub>16</sub>" (5.9 cm) minimum distance to front countertop edge
- I. Cutout width 29<sup>3</sup>/<sub>8</sub>" (74.6 cm) on 30" (76.2 cm) models  
Cutout width 35<sup>3</sup>/<sub>8</sub>" (89.9 cm) on 36" (91.4 cm) models
- J. Cutout depth 20<sup>3</sup>/<sub>8</sub>" (51.8 cm)

**NOTE:** After making the countertop cutout, some installations may require notching down the base cabinet side walls to clear the burner box. To avoid this modification, use a base cabinet with sidewalls wider than the cutout.

If cabinet has a drawer, a 4" (10.2 cm) depth clearance from the countertop to the top of the drawer (or other obstruction) in base cabinet is required. The drawer depth may need to be shortened to avoid interfering with the regulator and power cord.

## Flush Installation Dimensions

All cooktops can be mounted with a frameless standard installation sitting on top of the countertop surface or flush with the top of the countertop. If the cooktop is to be mounted flush with the countertop, a 11/64"-deep (4.3 mm) recessed area surrounding the cooktop cutout must be provided with the following dimensions.

**NOTE:** This option is not recommended for countertops with a molded backsplash. Do not silicone seal in place.

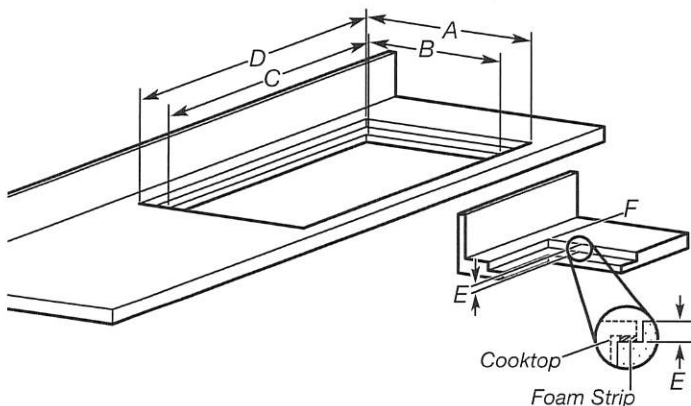

- A. Recessed area length 21<sup>3</sup>/<sub>16</sub>" (53.8 cm)
- B. Cutout length 20<sup>3</sup>/<sub>8</sub>" (51.8 cm)
- C. Cutout width 29<sup>3</sup>/<sub>8</sub>" (74.6 cm) on 30" (76.2 cm) models  
Cutout width 35<sup>3</sup>/<sub>8</sub>" (89.9 cm) on 36" (91.4 cm) models
- D. Recessed area width 30<sup>1</sup>/<sub>8</sub>" (76.5 cm) on 30" (76.2 cm) models  
Recessed area width 36<sup>1</sup>/<sub>8</sub>" (91.7 cm) on 36" (91.4 cm) models
- E. Recessed area depth 11/64" (4.3 mm)
- F. Recessed area radius 5/64" (2.0 mm) maximum

PU-48  
MARCH 3 2022



## RISE™ 30" SINGLE WALL OVEN WITH V2™ VERTICAL DUAL-FAN CONVECTION

### Signature Features

#### IRRESISTIBLE INTERIOR

Captivation cloaked in black. Beyond a dark glass expanse, cinematic lighting illuminates smooth racks, flat tines, and an enticing jet black interior.

#### SEAMLESS TOUCHES

Seamlessly designed. Concealed details melt into their stainless steel surround, as dark interiors and glass expanses pull you in.

#### SMOOTH CLOSE DOOR

Quiet, soft, secure. Your oven gently pulls the door closed.

#### 7-INCH FULL COLOUR LCD DISPLAY

Visually vibrant. This highly-interactive, full-colour display is packed with dynamic features that allow you to navigate effortlessly through settings and the JennAir® Culinary centre.

#### GLIDE RACK

Smooth moves. Glides in and out fluidly and quietly, even when fully loaded.

#### 5.0 CU. FT. CAPACITY

Big on entertaining. Generous capacity to cook multiple dishes at once.

#### CINEMATIC LIGHTING

Lights, camera, cook. Halogen lighting increases to full intensity, minimizing shadows and dramatically showcasing food.

#### CHEF'S LIGHT

Food shown in its best light. This third halogen lamp shines above the door, front and center, further reducing shadows for clear illumination.

#### V2™ VERTICAL DUAL-FAN CONVECTION

Dual counter-rotating vertical fans work in tandem, helping you wield your cooking prowess with everything from mouthwatering fillets to irresistible roasts.

JJW3430IL

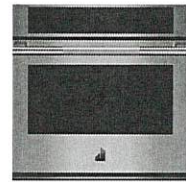

### Dimensions

Capacity: 5.00

Depth Closed Excluding Handles: 6175.38 cm

Depth Closed Including Handles: 6889.75 cm

Depth Excluding Doors: 5842.00 cm

Depth With Door Open 90 Degree: 11541.12 cm

Depth: 5905.50 cm

Height: 7588.25 cm

Net Weight: 71667536.00 kg

Width: 7620.00 cm

### Electrical

Power Cord Included: No

Volts: 240/208

Watts: 4500

### Design Type

Design Expression: RISE™

### Technical Specifications

#### Configuration and Overview

##### Size:

- 7620.00 cm
- 30 cm

Fuel Type: Electric

Installable Under Cooktop: Yes

LP Convertible: No

Oven Type: Single

##### Features

Door Lock: Yes

Power On Indicator Light: Yes

Language Conversion: English/French

Automatic Shut-Off: Yes

Door Broil Position: Closed

Oven Cooking System: Convection

Interior Color: Black

Interior Coating: Porcelain

Light Control: Oven Light Touch Pad

Light Type: Halogen

#### Features

Number of Broil Elements: 1

##### Appearance

Handle Material: Stainless Steel

Flush Installation Approved: Yes

##### Certifications

ADA Compliant: ADA Height and Side and Front Reach Compliant

Kosher Consumer Friendly: Yes

Prop 65: Standard

##### Compatibility

##### Works With:

- WiFi
- App
- Remote Access
- Voice Controlled

##### Configuration

Oven Configuration: Single Oven

##### Details



- Floor must be able to support a double oven weight of 357 lbs (162 kg).

**IMPORTANT:** To avoid damage to your cabinets, check with your builder or cabinet supplier to make sure that the materials used will not discolor, delaminate, or sustain other damage. This oven has been designed in accordance with the requirements of UL and CSA International and complies with the maximum allowable wood cabinet temperatures of 194°F (90°C).

### Undercounter Installation (with Cooktop Installed Above):

Refer to the Cutout Dimensions for Ovens Installed Under Cooktop (separate sheet). See product website for list of cooktop models approved for use above select wall-oven models.

### Product Dimensions - Single Ovens

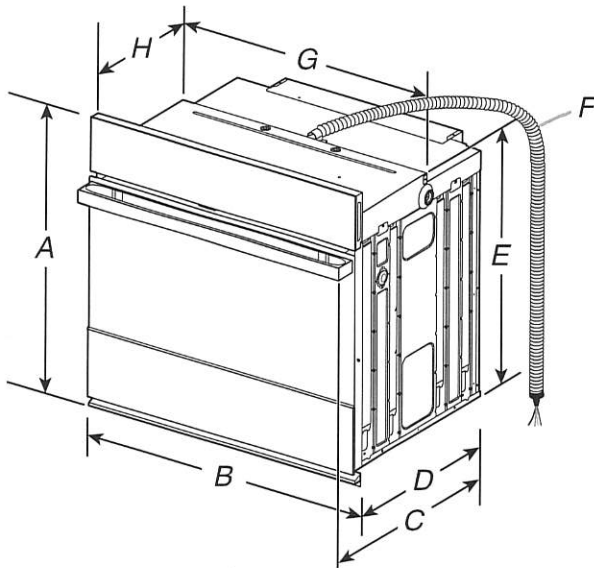

- A. 29<sup>7</sup>/<sub>8</sub>" (75.8 cm) max. overall height
- B. 30" (76.2 cm) overall width
- C. JJW3430IM - 26<sup>3</sup>/<sub>8</sub>" (67 cm)  
JJW3430IL - 27<sup>3</sup>/<sub>16</sub>" (69 cm)
- D. 23<sup>1</sup>/<sub>4</sub>" (59.1 cm) max. recessed depth
- E. 27<sup>3</sup>/<sub>16</sub>" (69 cm) recessed height
- F. 48" (121.9 cm) flexible conduit length
- G. 28<sup>7</sup>/<sub>16</sub>" (72.2 cm) max. recessed width
- H. 12" (30.5 cm) from back of control panel to start of strain relief

at 48"  
PV-48  
MARCH 3 2022

### Cabinet Dimensions - Single Ovens

#### Single Oven Undercounter (Without Cooktop Installed Above)

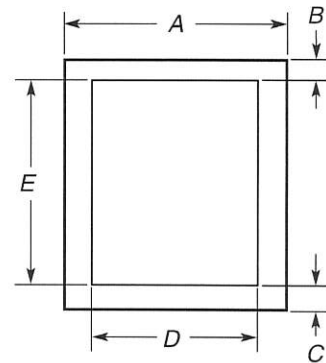

- A. 30" (76.2 cm) min. cabinet width
- B. 1<sup>1</sup>/<sub>2</sub>" (3.8 cm) min. top of cutout to underside of countertop
- C. 5<sup>1</sup>/<sub>4</sub>" (13.3 cm) bottom of cutout to floor
- D. 28<sup>1</sup>/<sub>2</sub>" (72.4 cm) cutout width
- E. 28" (71.2 cm) min. cutout height

#### Single Ovens Installed in Cabinet

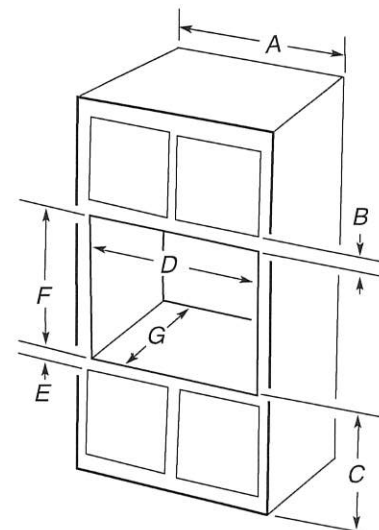

- A. 30" (76.2 cm) min. cabinet width
- B. 2<sup>3</sup>/<sub>16</sub>" (5.5 cm) top of cutout to bottom of upper cabinet door
- C. 32" (81.3 cm) bottom of cutout to floor
- D. 28<sup>1</sup>/<sub>2</sub>" (72.4 cm) cutout width
- E. 1<sup>1</sup>/<sub>2</sub>" (3.8 cm) min. bottom of cutout to top of cabinet door
- F. 28" (71.2 cm)\* recommended cutout height
- G. 24" (60.7 cm) cutout depth

\* **NOTE:** The cutout height can be between 27<sup>1</sup>/<sub>4</sub>" and 29<sup>7</sup>/<sub>16</sub>" (69.2 cm and 74.8 cm) for single ovens.

PU-48  
MAR 13 2022



## RISE™ 30" BUILT-IN MICROWAVE OVEN WITH SPEED-COOK

### Signature Features

#### 4.3-INCH FULL COLOUR LCD DISPLAY

A highly interactive, full-colour LCD touchscreen is packed with dynamic features that allow you to navigate effortlessly through settings and cooking options including temperature and cooking mode.

#### 1.4 CU. FT. MICROWAVE CAPACITY

Explore your options. There's room for whatever you're craving.

#### 900-WATT MICROWAVE ELEMENT

Harness 900 watts of microwave energy to rapidly cook and reheat a variety of foods.

#### SEAMLESS TOUCHES

Seamlessly designed. Concealed details melt into their stainless steel surround, as shiny interiors and glass expanses pull you in.

#### CONVECTION & MICROWAVE COMBINATION COOKING

Let your appetite run wild—broil, bake or warm with convection and microwave energy.

#### SPEED-COOK

Renounce accepted limitations of the microwave. Three potent methods converge to deliver convection's steady heat, microwave speed and broiled caramelization in each oven-caliber bite.

#### STAINLESS STEEL MICROWAVE INTERIOR

Wrapped in luminous steel, intrinsic beauty is reflected in every corner.

#### 1,200-WATT CONVECTION ELEMENT

This 1,200-watt element surrounds your cravings with circulating, consistent heat until baked to your satisfaction.

#### SENSOR COOKING

This intuitive sensor detects humidity released by food as it cooks, determining the precise cooking time and power level for optimal doneness of each dish.

JMC2430IL

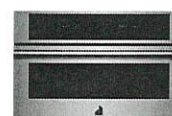

### Dimensions

Capacity: 1-2/5

Depth With Door Open 90 Degree: 9048.75 cm

Depth: 6477.00 cm

Height: 5048.25 cm

Net Weight: 40823280.00 kg

Width: 7556.50 cm

### Controls

Number of Quick Touch/One-Touch Selections: 1

Convenience Cooking Controls: Yes

Display Color: Full Color

Control Location: Top

Design Type

Design Expression: RISE™

### Electrical

Volts: 240/208

Watts: 3300

### Technical Specifications

#### Configuration and Overview

##### Size:

- 7620.00 cm
- 30 cm

Microwave Type: Built-In

#### Microwave Details

Sensor Cooking: Yes

##### Cooking Power:

- 900 W
- 900 W

Cavity Finish: Stainless

Convection: Yes

##### Convection Power:

- 1200 W
- 1200 W

Grill: Yes

##### Grill Power:

- 1600.0 W
- 1600.0 W

Interior Light: No

#### Microwave Details

##### Turntable Diameter Size:

- 3587.75 cm
- 14-1/8 cm

Scrolling Electronic Display: No

#### Details

Number of Power Levels: 10

Clock: Yes

Night Light: No

#### Certifications

ADA Compliant: ADA Height and Side and Front Reach Compliant

Kosher Consumer Friendly: Kosher Consumer Friendly

Prop 65: Standard

#### Configuration

Microwave Configuration: Built-In

Exterior



# INSTALLATION REQUIREMENTS

PJ-48  
MARcel 32022

## Tools and Parts

Gather the required tools and parts before starting installation. Read and follow the instructions provided with any tools listed here.

### Tools Needed

- Phillips screwdriver
- Flat-blade screwdriver
- Measuring tape
- Level
- Drill (for wall cabinet installations)
- 1/8" (3 mm) drill bit (for wall cabinet installations)
- 1" (2.5 cm) drill bit (for wall cabinet installations)

### Parts Needed

- UL listed or CSA approved conduit connector
- UL listed wire connectors

### Parts Needed – Flush Installation

- W10801485 Stainless steel flush installation kit for 27" (68.6 cm) models
- W10801486 Stainless steel flush installation kit for 30" (76.2 cm) models
- W10801487 Black flush installation kit for 30" (76.2 cm) models

To order, see the "Assistance or Service" section of the Use and Care Guide.

### Parts Supplied

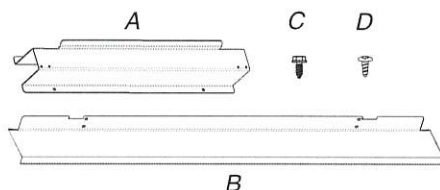

- A. Spacer bars (2)
- B. Bottom vent (1)
- C. 3/8" (9.5 mm) hex-head washer screws (4)
- D. 3/4" (1.9 cm) pan-head screws (4)

Check local codes. Check existing electrical supply. See "Electrical Requirements."

It is recommended that all electrical connections be made by a licensed, qualified electrical installer.

## Location Requirements

**IMPORTANT:** Observe all governing codes and ordinances.

- Cabinet opening dimensions that are shown must be used. Given dimensions provide minimum clearance with microwave oven.
- Recessed installation area must provide complete enclosure around the recessed portion of the microwave oven.
- Grounded electrical supply is required. See "Electrical Requirements" section.
- Electrical supply junction box should be located 3" (7.6 cm) maximum below the support surface when the microwave oven is installed in a wall cabinet. A 1" (2.5 cm) minimum diameter hole should have been drilled in the left rear corner of the support surface to pass the appliance cable through to the junction box.

- For installation above single built-in oven, the junction box must be located inside upper cabinet.
- If you are installing the junction box on rear wall behind the microwave oven, the junction box must be recessed and located in the upper or lower right or left corner of the cabinet; otherwise, the microwave oven will not fit into the cabinet opening.
- Microwave oven support surface must be solid, level, and flush with bottom of cabinet cutout. Floor must be able to support a weight of 108 lbs (49.0 kg).

**IMPORTANT:** To avoid damage to your cabinets, check with your builder or cabinet supplier to make sure that the materials used will not discolor, delaminate, or sustain other damage. This oven has been designed in accordance with the requirements of UL and CSA International and complies with the maximum allowable wood cabinet temperatures of 194°F (90°C).

## Product Dimensions

### 27" (68.6 cm) and 30" (76.2 cm) Microwave Ovens

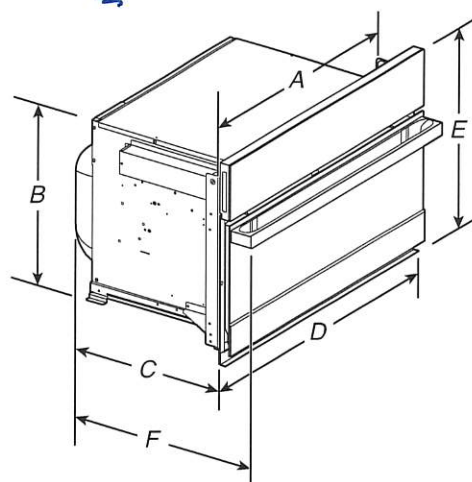

#### 27" (68.6 cm) models

- A. 25<sup>3</sup>/<sub>8</sub>" (64.5 cm)
- B. 17<sup>3</sup>/<sub>8</sub>" (44.1 cm)
- C. 22<sup>11</sup>/<sub>16</sub>" (57.7 cm)
- D. 26<sup>3</sup>/<sub>4</sub>" (68.0 cm) overall width
- E. 19<sup>7</sup>/<sub>8</sub>" (50.3 cm) overall height
- F. JMC2427IM: 25<sup>3</sup>/<sub>16</sub>" (64.9 cm)
- JMC2427IL: 24<sup>3</sup>/<sub>4</sub>" (62.9 cm)

#### 30" (76.2 cm) models

- A. 28<sup>3</sup>/<sub>8</sub>" (72.1 cm)
- B. 17<sup>3</sup>/<sub>8</sub>" (44.1 cm)
- C. 22<sup>11</sup>/<sub>16</sub>" (57.7 cm)
- D. 29<sup>3</sup>/<sub>4</sub>" (75.6 cm) overall width
- E. 19<sup>7</sup>/<sub>8</sub>" (50.3 cm) overall height
- F. JMC2430IM: 25<sup>3</sup>/<sub>16</sub>" (64.9 cm)
- JMC2430IL: 24<sup>3</sup>/<sub>4</sub>" (62.9 cm)

### 27" (68.6 cm) and 30" (76.2 cm) Microwave Oven Spacer Kit

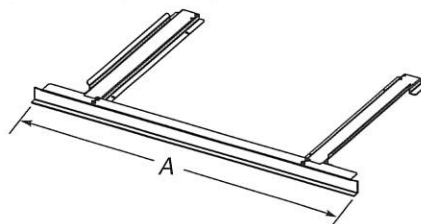

#### 27" (68.6 cm) models

- A. 26<sup>3</sup>/<sub>4</sub>" (67.9 cm) overall width

#### 30" (76.2 cm) models

- A. 29<sup>3</sup>/<sub>4</sub>" (75.6 cm) overall width

**NOTE:** The microwave oven spacer kit will allow the microwave oven to be installed in a 17<sup>3</sup>/<sub>8</sub>" to 17<sup>3</sup>/<sub>4</sub>" (44.1 to 45.1 cm) maximum cutout height.

A microwave oven spacer kit is available from your dealer that will allow the microwave oven to be installed in a 19" to 19<sup>13</sup>/<sub>16</sub>" (48.3 to 50.2 cm) maximum cutout height. Match the oven size to the following kits:

- 27" (68.6 cm) Stainless Steel – Model W10469901
- 30" (76.2 cm) Stainless Steel – Model W10469903

To order, see the "Assistance or Service" section of the Use and Care Guide.

## Cabinet Dimensions

### 27" (68.6 cm) and 30" (76.2 cm) Microwave Ovens

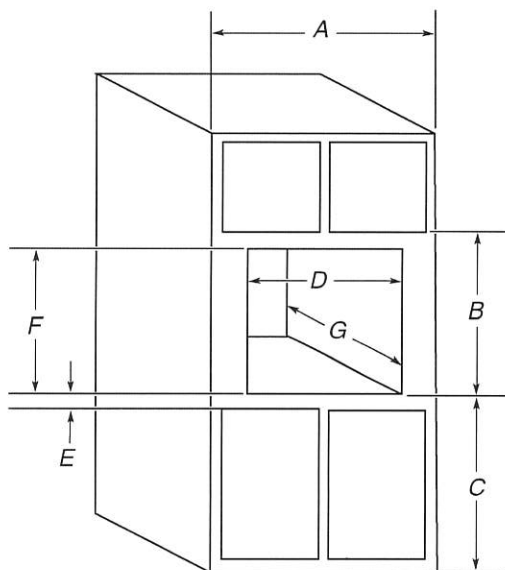

#### 27" (68.6 cm) models

- A. 27" (68.6 cm) minimum cabinet width
- B. 19<sup>7</sup>/<sub>8</sub>" (50.3 cm) from bottom of cutout to bottom of upper cabinet door
- C. 40" (101.6 cm) bottom of cutout to floor (recommended)
- D. 25<sup>1</sup>/<sub>2</sub>" (64.8 cm) cutout width
- E. 1<sup>1</sup>/<sub>2</sub>" (3.8 cm) minimum bottom of cutout to top of cabinet door
- F. 17<sup>5</sup>/<sub>8</sub>" (44.7 cm) recommended cutout height (will fit cutout height from 17<sup>3</sup>/<sub>8</sub>" [44.1 cm] to 17<sup>3</sup>/<sub>4</sub>" [45.1 cm])
- G. 21<sup>7</sup>/<sub>8</sub>" (55.5 cm) minimum cutout depth

#### 30" (76.2 cm) models

- A. 30" (76.2 cm) minimum cabinet width
- B. 19<sup>7</sup>/<sub>8</sub>" (50.3 cm) from bottom of cutout to bottom of upper cabinet door
- C. 40" (101.6 cm) bottom of cutout to floor (recommended)
- D. 28<sup>1</sup>/<sub>2</sub>" (72.4 cm) cutout width
- E. 1<sup>1</sup>/<sub>2</sub>" (3.8 cm) minimum bottom of cutout to top of cabinet door
- F. 17<sup>5</sup>/<sub>8</sub>" (44.7 cm) recommended cutout height (will fit cutout height from 17<sup>3</sup>/<sub>8</sub>" [44.1 cm] to 17<sup>3</sup>/<sub>4</sub>" [45.1 cm])
- G. 21<sup>7</sup>/<sub>8</sub>" (55.5 cm) minimum cutout depth

## Minimum Installation Clearances

For proper installation, the following minimum clearances must exist above and below the cabinet opening.

PU-48 *atash*  
MAR 3 2022

## Installation Above Single Built-In Oven

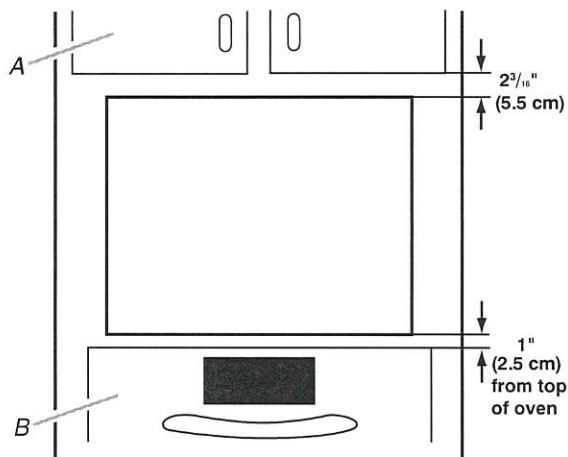

A. Upper cabinet  
B. Lower single oven

## Electrical Requirements

### GROUNDING INSTRUCTIONS

#### For a permanently connected microwave oven:

The microwave oven must be connected to a grounded, metallic, permanent wiring system, or an equipment grounding conductor should be run with the circuit conductors and connected to the equipment grounding terminal or lead on the microwave oven.

### SAVE THESE INSTRUCTIONS

If codes permit and a separate ground wire is used, it is recommended that a qualified electrical installer determine that the ground path and wire gauge are in accordance with local codes.

Check with a qualified electrical installer if you are not sure the oven is properly grounded.

This oven must be connected to a grounded metal, permanent wiring system.

Be sure that the electrical connection and wire size are adequate and in conformance with the National Electrical Code, ANSI/NFPA 70 – latest edition or CSA Standards C22.1-94, Canadian Electrical Code, Part 1 and C22.2 No. O-M91 – latest edition, and all local codes and ordinances.

A copy of the above code standards can be obtained from:

National Fire Protection Association  
1 Batterymarch Park  
Quincy, MA 02169-7471  
CSA International  
8501 East Pleasant Valley Road  
Cleveland, OH 44131-5575

### Electrical Connection

To properly install your microwave oven, you must determine the type of electrical connection you will be using and follow the instructions provided for it here.



# KOBE®

KOBE Range Hoods

*So Quiet... You Won't Believe It's On!*

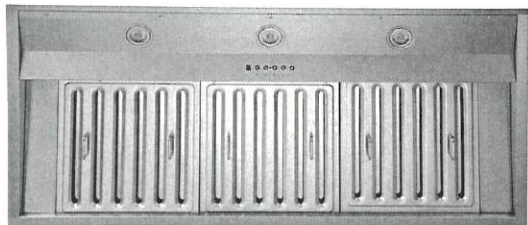

Built-In Hood

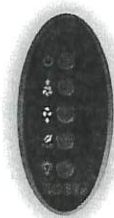

Wireless Remote Control  
(Sold Separately)

- magnet to attach any magnetic surface
- remote control range up to 16 feet

## Premium® IN26 SQB-1200-1 SERIES Built-In

<b>Model / Size</b>		IN2636SQB-1200-1 / 36" IN2648SQB-1200-1 / 48"
<b>Appearance</b>		
Stainless Steel		✓
Seamless		✓
<b>Performance</b>		
CFM / Sone		350 to 1200 / 1.6 to 8.0
QuietMode™		1.6 Sone / 46.5db
ECO Mode		10 Minutes on QuietMode™ Every Hour to Promote a Cleaner Kitchen Air Quality
LED Lights		3 Level Lighting 2 x Lights (3W) - 36" 3 x Lights (3W) - 48"
Speed		6 Speed
Control		Electronic Buttons with LED Display
Blower Type		Single Horizontal Squirrel Cage
Exhaust		Top - 8" Round
Consumption / Ampere		580W / 5.0A
Filter		Baffle Filter

3D View

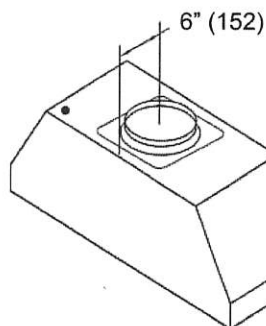
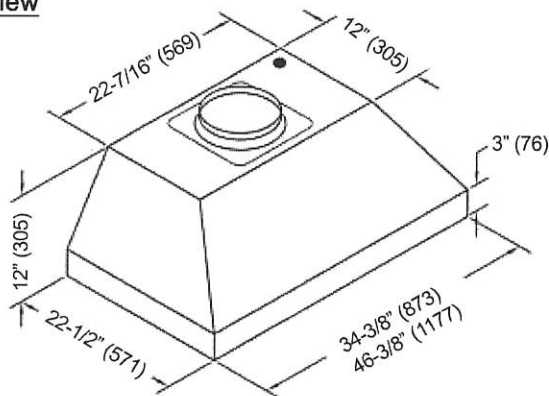

Top View

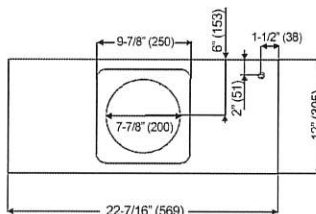

Side View

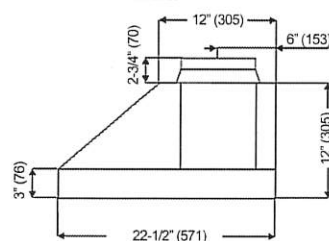

Front View

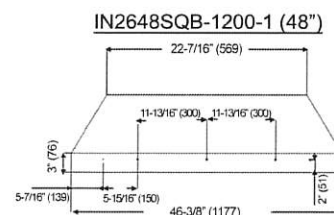
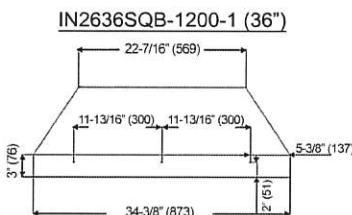



Selected Model	
Model number	BSC46DB2
Avantgarde Collection	
Series	Noire
Dimensions	
Width (in.)	23 3/4"
Depth (in.)	25"
Height (in.)	34 1/2"
Depth (in.) including door	23 1/2"
Depth (in.) without the door and handle	22"
Exterior Appearance	
Cabinet	Black
Color Appearance	Vitrified black glass
Flush with cabinet	Yes
Glass Door	Tinted and UV treated Glass
Handle Type	Tubular
Installation Type	Freestanding or Built-In
Kick Plate	Stainless Steel
Capacity	
Total Capacity	46 Bottles
Features	
Temperature zone(s)	2
Adjustable Temperature	4°-18° C
Built-in	Yes
Configuration	Single Door
Control Type	Soft touch electronic control
Door opening orientation	Reversible
Interior lighting	White LED
Leveling legs	Yes
Shelves extension	Full Extension on Ball Bearings
Shelves type	Metal shelves   Wooden frontage
Electrical Requirements	
Volts; Hertz; Amps	120V / 60 Hz / 15 amp
Accessories (optional)	
Square shape Stainless steel handle kit	DG14-1176
Warranty	
2 Year full Warranty	Entire appliance; parts and labour, in-home service
3-year total warranty	Compressor only

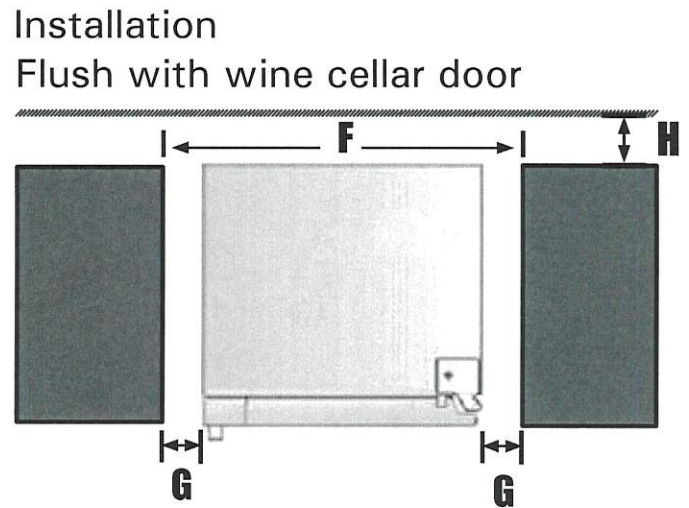
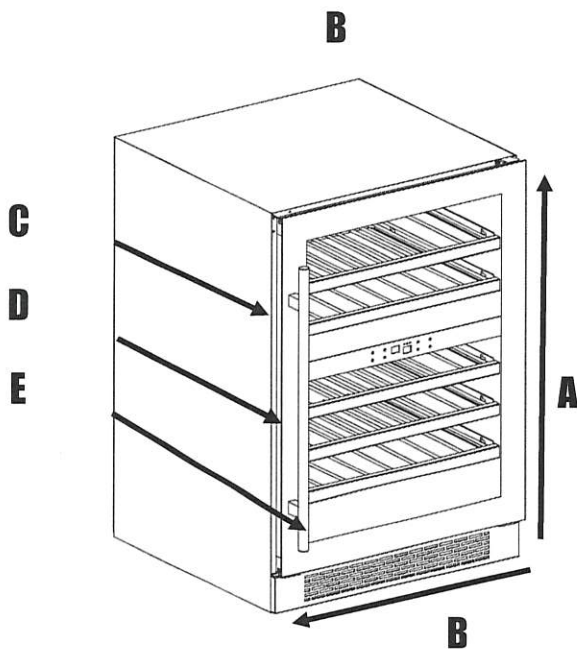

Product dimensions		po
A	Overall height of product	34 1/2
B	Overall width of product	24
C	Depth (excludes door)	21 7/8
D	Depth (including doors without handles)	23 1/4
E	Overall depth (including handles and doors)	25
Cabinetry cutout		
F	Width - Installation flush door	24 1/4
	Minimum Clearances	
G	Side clearance - Flush with door - Full door rotation	1/8
H	Rear clearance	1



## Electrical Planning

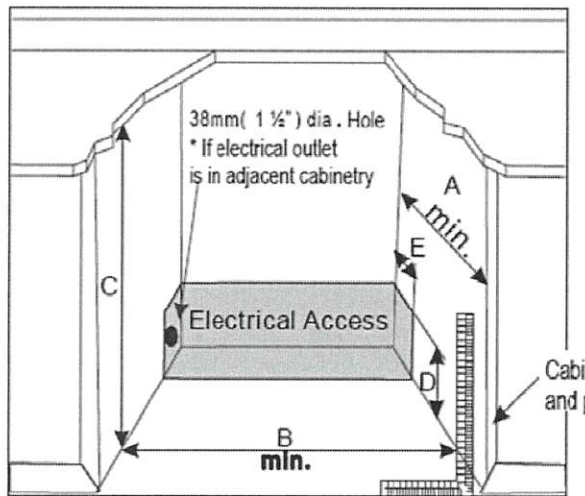

- A 660 mm (min. 26")
- B 610 mm (24")
- C 883 mm (34 3/4")
- D 152 mm (6")
- E 51 mm (2")  
25 mm (1") if electrical outlet is in adjacent cabinetry



PV-48  
March 3 2022



PANEL-READY 24" BUILT-IN DISHWASHER, 38 DBA

Signature Features

QUIETEST LUXURY DISHWASHER  
BRAND<sup>1</sup></sup>\*

\*Based on normal cycle<br><sup>1</sup> \*Based on Normal Cycle.</sup>

ENHANCED CINEMATIC LIGHTING

Shine a spotlight on clean. Packed with 18 LED lights that ramp up to full intensity, JennAir brand's best lighting coverage chases away shadows to illuminate daring Obsidian racks.

1 TO 24-HOUR DELAY START OPTION

Postpone the start of your wash cycle in 1-hour increments for up to 24 hours. Start your wash cycle on your terms.

HIGH-CAPACITY 3RD RACK WITH WASH

The largest 3rd Level Rack in the luxury industry glides with quiet and ease, even when fully loaded with tapas bowls, large rocks glasses and cocktail shakers. (Based on usable volume. Models JDPSS245LX, JDPSS246L and JDPSS245L.)

RAPID WASH CYCLE

This wash cycle cleans dishes in about an hour and is ideal for any get-together, diversion or intimate night in.

38 DBA TRANQUILITY<sup>2</sup></sup>

Listen to the hush. At 38 dBA, JennAir is the quietest luxury dishwasher brand<sup>1</sup></sup>, all without sacrificing performance.<br><sup>1</sup> \*Based on Normal Cycle.</sup><br><sup>2</sup> Based on normal cycle.</sup>

11% MORE LOADING HEIGHT (COMPARED TO JENNAIR® DISHWASHER MODELS: JDTSS246GM, JDTSS246GL, JDTSS245GX.)

DARING OBSIDIAN RACKS

A JennAir® signature, these dramatic black racks are inspired by the beauty of volcanic glass—showcasing clean dishes in striking contrast.

15 PLACE SETTING CAPACITY

Intimate affairs. Lavish after-parties. Enough capacity for a service of 15 means there's always room for one more.

JDPSS245LX



Dimensions

- Depth Closed Excluding Handles: 6223.00 cm
- Depth With Door Open 90 Degree: 12954.00 cm
- Depth: 6794.50 cm
- Height: 8509.00 cm
- Maximum Height: 8763.00 cm
- Minimum Height: 8509.00 cm
- Net Weight: 40369688.00 kg
- Width: 6064.25 cm
- Number of Place Settings: 15
- Gross Weight: 45359200.00 kg
- Controls
  - Control Type: Tap Touch with Display
  - Automatic Temperature Controls: Yes
  - End of Cycle Signal: Yes
  - Status Light: Multi-Color
- Electrical
  - Power Cord Included: No
  - Hz: 60

Technical Specifications

Description	2nd Level Rack
Dishwasher Type: Built-In	Adjustable: 2 Position
Exterior	Cushion-Tip Tines: Yes
Handle Color: Stainless Steel	Glides: Smooth Glide
Control Panel Color: Black	Lower Rack
Handle Type: Towel Bar	Extras: Stainless Steel Wash Arm
Magnetic Door: No	Glides: Ball Bearings
Handle Material: Metal	Utility Basket: No
Toe Panel Color: Black	Silverware Basket
True Hold Door: Yes	Type: Full Length Non Splittable
Details	Location: Bottom Rack
Number of Racks: 3	Culinary Basket: Yes
Built-In Water Softener: No	Covers: Yes
Drying System Type: Fan Dry with Heating Element	Third Level Rack



# 24" DISHWASHER

## DETAILED PLANNING DIMENSIONS GUIDE

JDPSS246LL, JDPSS246LM, JDPSS244LS, JDPSS244LL,  
JDPSS244LM

23<sup>7</sup>/<sub>8</sub>" (W) x 33<sup>5</sup>/<sub>8</sub>" (H) x 24<sup>1</sup>/<sub>2</sub>" (Depth without Handle)

JDPSS245LX

23<sup>7</sup>/<sub>8</sub>" (W) x 33<sup>5</sup>/<sub>8</sub>" (H) x 24<sup>3</sup>/<sub>4</sub>" (Depth without Handle)

PV-48 ~~4804~~  
MAR 3 2022

### PRODUCT DIMENSIONS

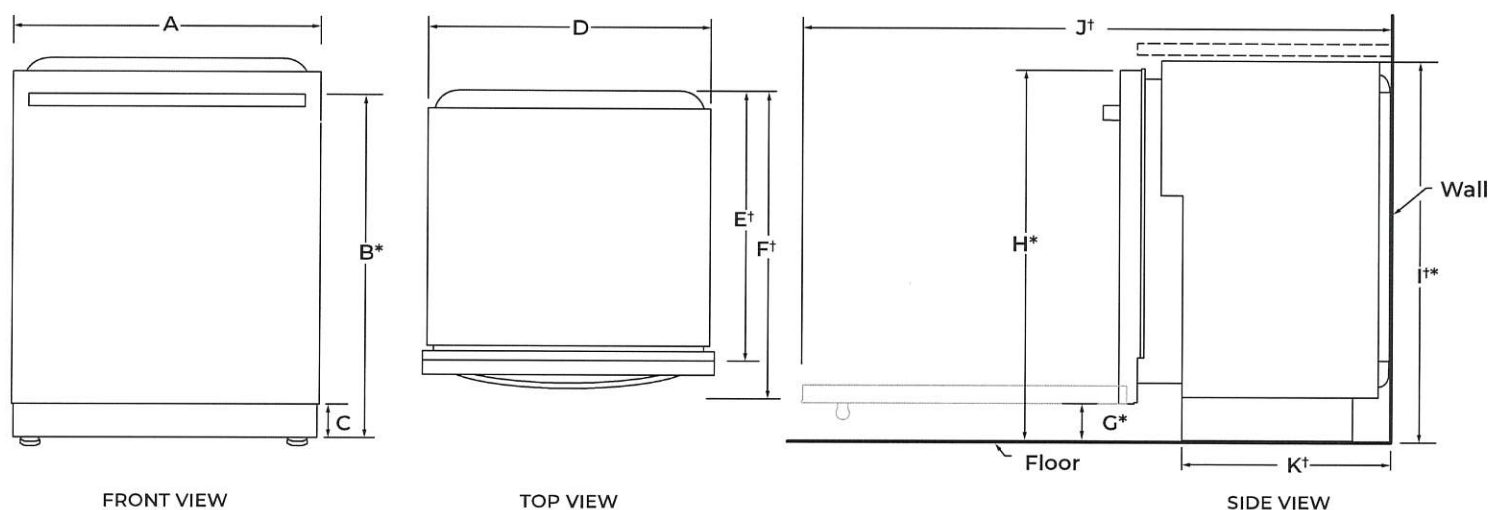

	DESCRIPTION	DIMENSIONS
A	Width of door	23 <sup>7</sup> / <sub>8</sub> " (60.6 cm)
B*	Height to top of handle	31 <sup>9</sup> / <sub>16</sub> " (80.1 cm)
C	Height of adjustable toe kick	3 <sup>1</sup> / <sub>2</sub> " (8.8 cm) - min. 4 <sup>1</sup> / <sub>4</sub> " (10.8 cm) - max.
D	Width of recessed dishwasher	23 <sup>7</sup> / <sub>8</sub> " (60.6 cm)
E†	Depth without door	22 <sup>5</sup> / <sub>8</sub> " (57.5 cm)
F†	Depth with Towel Bar Handle	27 <sup>1</sup> / <sub>4</sub> " (69.2 cm)
	Depth with Pocket Handle	24 <sup>1</sup> / <sub>2</sub> " (62.2 cm)
	Depth with Wood panel	24 <sup>3</sup> / <sub>4</sub> " (62.9 cm)**
G*	Height to bottom of door (min.)	3 <sup>5</sup> / <sub>16</sub> " (8.4 cm)
H*	Height to top of door (min.)	33 <sup>7</sup> / <sub>16</sub> " (84.9 cm)
I†	Height of recessed dishwasher (min.)	33 <sup>5</sup> / <sub>8</sub> " (85.4 cm)
J†	Depth with door fully open (min.)	50 <sup>3</sup> / <sub>16</sub> " (127.4 cm)
K†	Depth with toe kick (min.)	20 <sup>13</sup> / <sub>16</sub> " (52.9 cm)

†Insulation blanket thickness adds up to 11/16" (1.8 cm) but can crush up to 1/8" (0.3 cm).

\*Dishwasher can be raised 1<sup>7</sup>/<sub>16</sub>" (3.7 cm) with feet fully extended.

\*\*Considering 3/4" wood panel thickness.

Because Whirlpool Corporation policy includes a continuous commitment to improve our products, we reserve the right to change materials and specifications without notice.

Dimensions are for planning purposes only. For complete details, see Installation Instructions packed with product. Specifications subject to change without notice.





# 24" DISHWASHER

## DETAILED PLANNING DIMENSIONS GUIDE

JDPSS246LL, JDPSS246LM, JDPSSG244LS, JDPSS244LL,  
JDPSS244LM  
23<sup>7</sup>/<sub>8</sub>" (W) x 33<sup>5</sup>/<sub>8</sub>" (H) x 24<sup>1</sup>/<sub>2</sub>" (Depth without Handle)

JDPSS245LX  
23<sup>7</sup>/<sub>8</sub>" (W) x 33<sup>5</sup>/<sub>8</sub>" (H) x 24<sup>3</sup>/<sub>4</sub>" (Depth without Handle)

PJ-48 *attach*  
MARCH 3 2022

### OPENING/CLEARANCE DIMENSIONS

**IMPORTANT:** Check that all surfaces have no protrusions that would prohibit dishwasher installation.

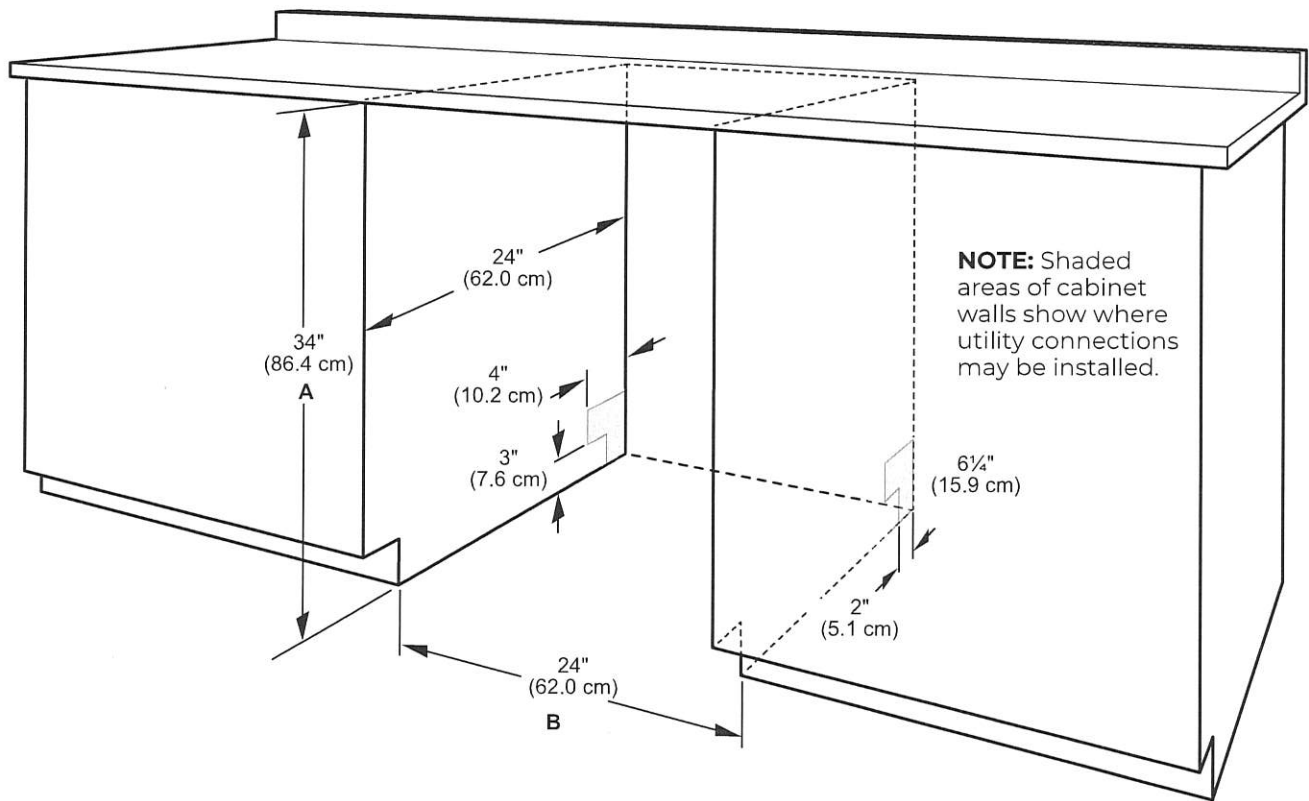

A. Measured from the lowest point on the underside of the countertop. May be reduced to 33<sup>1</sup>/<sub>2</sub>" (85.1 cm) by removing the wheels and perforated area of insulation (blanket) on dishwasher.

B. Minimum, measured from narrowest point of opening.

**NOTE:** Corner locations require a 2" (5.1 cm) minimum clearance between the side of the dishwasher door and the wall or cabinet.