

BASEMENT WINDOWS

Invoice	Qty.	Description
2868 72,675 06Aug21	5	BASEMENT WINDOWS - UPGRADE BASEMENT WINDOW SIZE TO 30 " X 24" - 10" FRAME (PINEVALLEY 50 FOOT LOTS ONLY)

CERAMIC

Invoice	Qty.	Description
2436 37 16Sep21	1	FRONT FOYER: TILE, FLOOR , LEVEL 5 - 12X24" LAID IN STRAIGHT, STACKED PATTERN. SEE PLAN FOR TILE DIRECTION
2436 37 16Sep21	1	POWDER ROOM: TILE, FLOOR , LEVEL 5 - 12X24" LAID IN STRAIGHT, STACKED PATTERN. SEE PLAN FOR TILE DIRECTION
2436 16Sep21 NoCat	1	FOYER / POWDER FLOOR / MUD ROOM: UPGRADE GROUT
2436 36 16Sep21	1	MUD ROOM: TILE, FLOOR , LEVEL 4 - 8X8" LAID IN STRAIGHT, STACKED PATTERN
2436 36 16Sep21	1	LAUNDRY: TILE, FLOOR , LEVEL 4 - 8X8" LAID IN STRAIGHT, STACKED PATTERN.
2436 37 16Sep21	1	MASTER ENSUITE: TILE, FLOOR , LEVEL 5 - 12X24"
2436 25 16Sep21	1	MASTER ENSUITE: TILE INSTALLATION UPGRADE, FLOOR , HERRINGBONE - MASTER ENSUITE - HERRINGBONE
2436 51 16Sep21	1	MASTER ENSUITE: TILE, WALL, LEVEL 5 - 12X24" LAID IN HORIZONTAL STACKED PATTERN.
2436 44 16Sep21	1	MASTER ENSUITE: TILE, SHOWER FLOOR, LEVEL 3 - PENNY ROUND
2436 36 16Sep21	1	ENSUITE 2: TILE, FLOOR , LEVEL 4 - 8X8" LAID IN STRAIGHT, STACKED PATTERN.
2436 51 16Sep21	1	ENSUITE 2: TILE, WALL, LEVEL 1 - 3X6" LAID IN VERTICAL STACKED PATTERN



CONSTRUCTION SUMMARY

Lot: 78
Model: 50.04 A BEAUMONT
Project/Phase: Pine Valley Forevergreen / 1

CERAMIC

Invoice	Qty.	Description
2436 43 16Sep21	1	ENSUITE 2: TILE, SHOWER FLOOR, LEVEL 2 - HEX
2436 19 16Sep21	1	ENSUITE 2: TILE GROUT UPGRADE, FLOOR + WALL , UPG GROUT
2436 34 16Sep21	1	ENSUITE 3: TILE, FLOOR , LEVEL 2 - 8X8" LAID IN STRAIGHT, STACKED PATTERN
2436 46 16Sep21	1	ENSUITE 3: TILE, WALL, LEVEL 1 - 8X8" LAID IN STRAIGHT, STACKED PATTERN.
2436 19 16Sep21	1	ENSUITE 3:TILE GROUT UPGRADE, FLOOR , UPG GROUT -
2436 21 16Sep21	1	ENSUITE 3: TILE GROUT UPGRADE, WALL, UPG GROUT
2436 37 16Sep21	1	ENSUITE 4: TILE, FLOOR , LEVEL 5 - HEX
2436 43 16Sep21	1	ENSUITE 4: TILE, SHOWER FLOOR, LEVEL 2 - HEX
2436 52 16Sep21	1	ENSUITE 4: TILE, WALL, LEVEL 1 - 2X16" LAID IN HORIZONTAL, STACKED PATTERN
2436 19 16Sep21	1	TILE GROUT UPGRADE, FLOOR , UPG GROUT - LAUNDRY - UPG GROUT
2436 19 16Sep21	1	TILE GROUT UPGRADE, FLOOR , UPG GROUT - MASTER ENSUITE - UPG GROUT
2436 20 16Sep21	1	TILE GROUT UPGRADE, SHOWER FLOOR, UPG GROUT - ENSUITE # 2 - UPG GROUT
2436 20 16Sep21	1	TILE GROUT UPGRADE, SHOWER FLOOR, UPG GROUT - ENSUITE #4, ALT. 2ND FLOOR - UPG GROUT



CONSTRUCTION SUMMARY

Lot: 78
Model: 50.04 A BEAUMONT
Project/Phase: Pine Valley Forevergreen / 1

CERAMIC

Invoice	Qty.	Description
2436 21 16Sep21	1	TILE GROUT UPGRADE, WALL, UPG GROUT - ENSUITE # 4 - UPG GROUT
2436 21 16Sep21	1	TILE GROUT UPGRADE, WALL, UPG GROUT - MASTER ENSUITE - UPG GROUT
2436 20 16Sep21	1	TILE GROUT UPGRADE, SHOWER FLOOR, UPG GROUT - MASTER ENSUITE - UPG GROUT
2436 19 16Sep21	1	TILE GROUT UPGRADE, FLOOR , UPG GROUT - ENSUITE # 4 - UPG GROUT

CONCRETE AND DRAIN

Invoice	Qty.	Description
2868 06Aug21 NoCat	1	BACK-FLOW PREVENTER VALVE

CROWN MOULDING

Invoice	Qty.	Description
2868 72,564 06Aug21	1	LIBRARY: MODEL OPTIONS 50.04 - LIBRARY - OPT. WAFFLE CEILING, BEAM DETAIL AS PER PLAN (4 BOXES) OPTION #1 CTR-B07



CONSTRUCTION SUMMARY

Lot: 78
Model: 50.04 A BEAUMONT
Project/Phase: Pine Valley Forevergreen / 1

DRYWALL

Invoice	Qty.	Description
2868 72,567 06Aug21	1	FOYER: MODEL OPTIONS 50.04 - FOYER - OPT. COFFERED CEILING, INCLUDING CIRCULAR COFFERED AS PER PLAN
2868 72,572 06Aug21	1	MAIN HALL: MODEL OPTIONS 50.04 - OPT. COFFERED CEILING, INCLUDING CIRCULAR COFFERED AS PER PLAN
2868 72,572 06Aug21	1	2ND FLOOR HALLWAY: MODEL OPTIONS 50.04 - 2ND FLOOR HALLWAY - OPT. COFFERED CEILING, INCLUDING CIRCULAR COFFERED AS PER PLAN
2868 72,535 06Aug21	1	MASTER BEDROOM: MODEL OPTIONS 50.04.A OR B - MASTER BEDROOM - OPT. 10 FOOT TRAY CEILING - AS PER PLAN
2868 72,546 06Aug21	1	LIBRARY: MODEL OPTIONS 50.04 - OPT. COFFERED CEILING - AS PER PLAN
2868 06Aug21 NoCat	1	MASTER ENSUITE: SHOWER NICHE [SHAMPOO SHELF] - COMPLETE WITH MATCHING MARBLE JAMBS ON 4 SIDES, STANDARD TILE, APPROX. 12 X 18 INSTALLED VERTICALLY - SEE PLAN FOR LOCATION
2868 06Aug21 NoCat	1	THRU OUT 2ND FLOOR: INCREASE HEIGHT OF DOOR TO 8FT SECOND FLOOR - PER DOOR

ELECTRICAL

Invoice	Qty.	Description
2868 72,281 06Aug21	1	GREAT ROOM: INTERIOR WALL OUTLET: ADDITIONAL 110V WALL INTERIOR RECEPTACLE ON EXISTING CIRCUIT FOR WALL MOUNTED TV - LOCATE APPROX 66" A.F.F. ABOVE FIREPLACE
2868 72,282 06Aug21	1	KITCHEN: ADDITIONAL 220V RECEPTACLE ON A SEPARATE CIRCUIT - FOR BUILT-IN WALL OVEN - APPLIANCE NOT INCLUDED - DOES NOT INCLUDE BREAKER THAT IS TO BE INSTALLED BY LICENSED ELECTRICIAN AND ARRANGED BY HOMEOWNER AFTER CLOSING SEE PLAN FOR APPROX LOCATION FINAL LOCATION ORIENTATION AND CONNECTION TO BE ARRANGED AND COMPLETED BY LICENCED ELECTRICIAN AFTER CLOSING AT OWN EXPENSE AND WARRANTY
2868 72,306 06Aug21	1	KITCHEN: RELOCATE FRIDGE FROM STANDARD LOCATION - APPROX. "NEW" LOCATION AS PER ATTACHED DRAWINGS
2868 72,273 06Aug21	1	KTICHEN: 110V WALL RECEPTACLE ON SEPARATE CIRCUIT - GAS FIRED APPLIANCE - FOR AUX. EQUIPMENT - NOT A STOVE PLUG FINAL LOCATION ORIENTATION AND CONNECTION TO BE ARRANGED AND COMPLETED BY LICENCED ELECTRICIAN AFTER CLOSING AT OWN EXPENSE AND WARRANTY
2868 72,303 06Aug21	1	KITCHEN: FIXTURE: UNDER CABINET FLUORESCENT LIGHT FIXTURES - INCLUDES CABINETRY LIGHT VALANCE
2868 72,307 06Aug21	1	KITCHEN: FIXTURE: RELOCATE STANDARD CEILING MOUNT FIXTURE - LOCATE APPROX CENTERED ABOVE ISLAND
2868 72,280 06Aug21	1	KITCHEN: CEILING OUTLET: ADDITIONAL REINFORCED CEILING OUTLET - APPROX CENTERED ABOVE ISLAND - SAME SWITCH AS STANDARD
2868 72,289 06Aug21	6	KITCHEN: 4" E/S LED INTERIOR POT LIGHT - GROUND FLOOR - EACH INCLUDED IN APS, INCLUDES 1 SWITCH
2868 72,289 06Aug21	1	KITCHEN: 4" E/S LED INTERIOR POT LIGHT - GROUND FLOOR - EACH USE SAME SWITCH AS STANDARD
2868 72,289 06Aug21	4	LIBRARY: 4" E/S LED INTERIOR POT LIGHT - GROUND FLOOR - EACH IN LIEU OF STANDARD LIGHT, USE STANDARD SWITCH
2868 72,289 06Aug21	4	MAIN HALL: 4" E/S LED INTERIOR POT LIGHT - GROUND FLOOR - EACH
2868 06Aug21 NoCat	1	THRU OUT 2ND FLOOR: INCREASE HEIGHT OF DOOR TO 8FT SECOND FLOOR - PER DOOR
2436 72,303 16Sep21	-1	**DELETE** ITEM 10 pe.2868- *KITCHEN: FIXTURE: UNDER CABINET FLUORESCENT LIGHT FIXTURES - INCLUDES (AND REQUIRES) LIGHT VALANCE*



CONSTRUCTION SUMMARY

Lot: 78
Model: 50.04 A BEAUMONT
Project/Phase: Pine Valley Forevergreen / 1

ELECTRICAL

Invoice	Qty.	Description
2436 72,288 16Sep21	1	KITCHEN: ROUGH-IN FOR (2) WALL SCONCES + 1 SWITCH - FIXTURE NOT INCLUDED LOCATE APPROX 80" A.F.F. EITHER SIDE OF HOOD FAN - SEE PLAN FOR LOCATION

FORMING

Invoice	Qty.	Description
2868 72,560 06Aug21	1	MODEL OPTIONS 50.04 - KITCHEN REAR - OPT. COVERED LOGGIA AS PER PLAN

FRAMING

Invoice	Qty.	Description
2868 72,631 06Aug21	1	MASTER ENSUITE: SHOWER NICHE [SHAMPOO SHELF] - COMPLETE WITH MATCHING MARBLE JAMBS ON 4 SIDES, STANDARD TILE, APPROX. 12 X 18 INSTALLED VERTICALLY - SEE PLAN FOR LOCATION
2868 06Aug21 NoCat	1	FOYER: MODEL OPTIONS 50.04 - FOYER - OPT. COFFERED CEILING, INCLUDING CIRCULAR COFFERED AS PER PLAN
2868 06Aug21 NoCat	1	MAIN HALL: MODEL OPTIONS 50.04 - OPT. COFFERED CEILING, INCLUDING CIRCULAR COFFERED AS PER PLAN
2868 06Aug21 NoCat	1	2ND FLOOR HALLWAY: MODEL OPTIONS 50.04 - 2ND FLOOR HALLWAY - OPT. COFFERED CEILING, INCLUDING CIRCULAR COFFERED AS PER PLAN
2868 06Aug21 NoCat	1	MASTER BEDROOM: MODEL OPTIONS 50.04.A OR B - MASTER BEDROOM - OPT. 10 FOOT TRAY CEILING - AS PER PLAN
2868 06Aug21 NoCat	1	THRU OUT 2ND FLOOR: INCREASE HEIGHT OF DOOR TO 8FT SECOND FLOOR - PER DOOR
2868 06Aug21 NoCat	1	LIBRARY: MODEL OPTIONS 50.04 - OPT. COFFERED CEILING - AS PER PLAN

GLASS AND MIRROR

Invoice	Qty.	Description
2436 16Sep21 NoCat	1	MASTER ENSUITE: UPGRADE SHOWER DOOR HANDLE - CHROME



CONSTRUCTION SUMMARY

Lot: 78
Model: 50.04 A BEAUMONT
Project/Phase: Pine Valley Forevergreen / 1

GRANITE MARBLE QUARTZ

Invoice	Qty.	Description
2436 16Sep21 NoCat	1	POWDER ROOM: UPGRADE 5 QUARTZ COUNTER
2436 16Sep21 NoCat	1	MASTER ENSUITE: UPGRADE 3 QUARTZ COUNTER
2436 16Sep21 NoCat	1	ENSUITE 2: UPGRADE 2 QUARTZ COUNTER
2436 16Sep21 NoCat	1	ENSUITE 3: UPGRADE 1 QUARTZ COUNTER
2436 16Sep21 NoCat	1	ENSUITE 4: UPGRADE 5 QUARTZ COUNTER
2436 16Sep21 NoCat	1	KITCHEN: UPGRADE 5 QUARTZ
2436 16Sep21 NoCat	1	KITCHEN AND SERVERY: ADD FULL HEIGHT SLAB BACKSPLASH - QUARTZ LEVEL 5 SERVERY: FHBS TO BE APPROX 24" HIGH
2436 16Sep21 NoCat	1	MUD ROOM: UPGRADE COUNTER TOP - LEVEL 1 GRANITE

HARDWOOD

Invoice	Qty.	Description
2436 4 16Sep21	1	THRU OUT STANDARD AREAS -MAIN HALL/ LIBRARY/ GREAT ROOM/ DINING ROOM/ UPPER HALL/ MASTER BEDROOM/ BEDROOM 2/ BEDROOM 3/ BEDROOM 4: VINTAGE SERIES, 5" WHITE OAK, NSS ENGINEERED HARDWOOD, 3/4" THK, WIREBRUSH TEXTURE, UV OIL FINISH - LEVEL 3
2436 4 16Sep21	1	KITCHEN/BREAKFAST/SERVERY: VINTAGE SERIES, 5" WHITE OAK, NSS ENGINEERED HARDWOOD, 3/4" THK, WIREBRUSH TEXTURE, UV OIL FINISH - LEVEL 3

HVAC

Invoice	Qty.	Description
2868 72,224 06Aug21	1	KITCHEN: GAS LINE ROUGH-IN - MAIN FLOOR FOR COOKTOP - FINAL LOCATION ORIENTATION AND CONNECTION TO BE ARRANGED AND COMPLETED BY LICENCED GAS FITTER AFTER CLOSING AT OWN EXPENSE AND WARRANTY



CONSTRUCTION SUMMARY

Lot: 78
Model: 50.04 A BEAUMONT
Project/Phase: Pine Valley Forevergreen / 1

INTERIOR TRIM AND DOORS

Invoice	Qty.	Description
2868 72,644 06Aug21	17	THRU OUT 2ND FLOOR: INCREASE HEIGHT OF DOOR TO 8FT SECOND FLOOR - PER DOOR
2436 155,912 16Sep21	1	THRU OUT: ADD FOR HINGES 3X3 SQUARE FLAT TIP THROUGHOUT UPGRADE
2436 153,834 16Sep21	1	THRU OUT: HALIFAX LEVER, IRON BLACK INTERIOR DOOR HARDWARE UPGRADE

KITCHEN AND BATH CABINETRY

Invoice	Qty.	Description
2436 16Sep21 NoCat	1	THRU OUT: SEE ATTACHED CABINETRY SCHEDULE

NETWORK AND WIRING

Invoice	Qty.	Description
2868 72,259 06Aug21	1	GREAT ROOM: CONDUIT PIPE - FOR WALL MOUNT TV - LOCATE ABOVE FIREPLACE, APPROX 66" A.F.F. THRU BASEMENT, TERMINATE AT CABLE- SEE PLAN FOR LOCATION

PAINT

Invoice	Qty.	Description
2868 06Aug21 NoCat	1	FOYER: MODEL OPTIONS 50.04 - FOYER - OPT. COFFERED CEILING, INCLUDING CIRCULAR COFFERED AS PER PLAN
2868 06Aug21 NoCat	1	MAIN HALL: MODEL OPTIONS 50.04 - OPT. COFFERED CEILING, INCLUDING CIRCULAR COFFERED AS PER PLAN
2868 06Aug21 NoCat	1	LIBRARY: MODEL OPTIONS 50.04 - LIBRARY - OPT. WAFFLE CEILING, BEAM DETAIL AS PER PLAN (4 BOXES) OPTION #1 CTR-B07
2868 06Aug21 NoCat	1	2ND FLOOR HALLWAY: MODEL OPTIONS 50.04 - 2ND FLOOR HALLWAY - OPT. COFFERED CEILING, INCLUDING CIRCULAR COFFERED AS PER PLAN
2868 06Aug21 NoCat	1	MASTER ENSUITE: SHOWER NICHE [SHAMPOO SHELF] - COMPLETE WITH MATCHING MARBLE JAMBS ON 4 SIDES, STANDARD TILE, APPROX. 12 X 18 INSTALLED VERTICALLY - SEE PLAN FOR LOCATION
2868 06Aug21 NoCat	1	MASTER BEDROOM: MODEL OPTIONS 50.04.A OR B - MASTER BEDROOM - OPT. 10 FOOT TRAY CEILING - AS PER PLAN
2868 06Aug21 NoCat	1	THRU OUT 2ND FLOOR: INCREASE HEIGHT OF DOOR TO 8FT SECOND FLOOR - PER DOOR
2868 06Aug21 NoCat	1	LIBRARY: MODEL OPTIONS 50.04 - OPT. COFFERED CEILING - AS PER PLAN
2436 16Sep21 NoCat	2	MAIN STAIRS: STAIN STAIRS AND LANDINGS STAIRS AND LANDINGS WILL NOT MATCH HARDWOOD FLOORS IN COLOUR/TEXTURE/SPECIES



CONSTRUCTION SUMMARY

Lot: 78
Model: 50.04 A BEAUMONT
Project/Phase: Pine Valley Forevergreen / 1

PLUMBING

Invoice	Qty.	Description
2868 06Aug21 NoCat	1	KITCHEN: POT FILLER - MOEN MODERN - BRUSHED GOLD INCLUDES ROUGH-IN
2868 06Aug21 NoCat	1	MASTER ENSUITE: UPGRADE TO MOEN 'ALIGN' SUITE - BRUSHED GOLD -FLOOR MOUNT TUB FILLER -RAIN SHOWER + HAND SHOWER/SLIDE BAR -8" LAV FAUCET x2
2436 16Sep21 NoCat	1	POWDER ROOM: UPGRADE FAUCET TO MOEN 'ALIGN' - BRUSHED GOLD
2436 16Sep21 NoCat	1	KITCHEN: UPGRADE SINK AND FAUCET: BLANCO SILGRANIT SUPER SINGLE SINK + MOEN 'NIO' MATTE BLACK + GOLD HANDLE
2436 16Sep21 NoCat	1	SERVERY: UPGRADE SINK AND FAUCET: BLANCO SILGRANIT BAR SINK + MOEN 'NIO' MATTE BLACK + GOLD HANDLE
2436 16Sep21 NoCat	1	POWDER ROOM: UPGRADE SINK TO CONTRAC 'EMERY' - MATTE BLACK SEE ATTACHED
2436 16Sep21 NoCat	1	LAUNDRY ROOM: UPGRADE SINK (OVERMOUNT) STAINLESS STEEL + UPGRADE FAUCET P-LAM COUNTER TOP
2436 16Sep21 NoCat	1	MUD ROOM: UPGRADE SINK AND FAUCET

PLUMBING FIXTURES

Invoice	Qty.	Description
2436 16Sep21 NoCat	1	POWDER ROOM: UPGRADE TOILET TO CONTRAC 'CILA'

STAIR AND RAILINGS

Invoice	Qty.	Description
2436 93,812 16Sep21	2	MAIN STAIRS: UPGRADE - EURONLINE (ALL PLAIN) PICKET, 3" HALF-ROUND W/V-GROOVE HANDRAIL, 3 1/2" ALL SQUARE POST WITH PYRAMID TOP POST CAP - PACKAGE A-2

PV - 78 Cabinetry Schedule

ROOM	DESCRIPTION	PRICE	QTY	TOTAL
KITCHEN	UPGRADE KITCHEN FROM SERIES 2 TO SERIES 5 - <i>WILLIS 'OYSTER'</i>		1	
	UPGRADE HARDWARE: BH-082-03		1	
	RETURN TRIP FOR HARDWOOD		1	
	CONVERT STD UPPER AND BASE CABINETS TO TALL, DEEP BUILT IN OVEN UNIT W/ DRAWER BELOW		1	
	ADJUST CABINETRY FOR 36" RANGETOP (N/C)		1	
	LEAVE 60" GAP IN UPPER CABINETS ABOVE RANGETOP (N/C)		1	
	ADD DECORATIVE HOOD CANOPY - ASPEN		1	
	ADD POTS AND PANS BELOW RANGETOP		1	
	CONVERT STD CABINETRY TO BASE POTS AND PANS DRAWERS		4	
	ADD DÉCOR PANELS FOR FRIDGE/FREEZER		1	
	ADD FLIP UPS ABOVE FRIDGE/FREEZER/PANTRY WALL		1	
	CONVERT STANDARD BASE AND UPPER CABINETS TO PANTRIES		1	
	CONVERT UPPER CABINETS TO GLASS DOOR HUTCH CABINETS WITH BLACK ALUMINUM RAIL		1	
ISLAND	UPGRADE ISLAND FROM SERIES 2 TO SERIES 5 - <i>WILLIS 'OYSTER'</i>		1	
	NOTE: ISLAND TO BE REDUCED TO APPROX. OVERALL SIZE OF 63x97 1/4"			
	ADD DECOR PANEL FOR DISHWASHER		1	
	ADD TWO-BIN RECYCLE CENTRE TO ISLAND		1	
	ADD OVERSIZED DÉCOR PANELS TO SIDES OF ISLAND		2	
	ADD PROUD FURNITURE KICK TO SIDES + REAR ISLAND		3	
SERVERY	UPGRADE SERVERY FROM SERIES 2 TO SERIES 6 - <i>WILLIS 'PITCH BLACK'</i>		1	
	RELOCATE STANDARD BANK OF 4 DRAWERS TO SERVERY (N/C)		1	
MASTER ENSUITE	UPGRADE PANTRY UNIT TO SERIES 6 - <i>WILLIS 'PITCH BLACK'</i>		1	
	UPGRADE VANITY FROM SERIES 2 TO SERIES 6 - <i>WILLIS 'PITCH BLACK'</i>		1	
	CONVERT STANDARD VANITY TO 9 DRAWER CABINET		1	
	ADD FURNITURE KICK ON THREE SIDES		1	
	UPGRADE HARDWARE: BP8716320CHBRZ		1	
LAUNDRY ROOM	ADD P-LAM COUNTERTOP - WHITE		1	
	ADD SUPPORT FOR COUNTERTOP		1	
POWDER ROOM	UPGRADE FROM SERIES 2 TO SERIES 4 - <i>MANHATTAN 'STORM GREY WALNUT'</i>		1	
	UPGRADE HARDWARE: BH-082-03 (INSTALL HORIZONTAL ON DOORS)		1	
ENSUITE 2	UPGRADE FROM SERIES 2 TO SERIES 4 - <i>WINDERMERE 'OYSTER'</i>		1	
ENSUITE 3	UPGRADE FROM SERIES 2 TO SERIES 4 - <i>WINDERMERE 'OYSTER'</i>		1	
ENSUITE 4	UPGRADE FROM SERIES 2 TO SERIES 4 - <i>MANHATTAN 'STORM GREY WALNUT'</i>		1	
CABINETRY TOTAL:				

HANDLE PLACEMENT: AT INSTALLERS DISCRETION

LOT #:

DATE:

SIGNATURE:

SIGNATURE:

**GOLDPARK HOMES
PINE VALLEY
VAUGHAN, ONTARIO
MODEL: (5004) BEAUMONT**

**SITE STANDARD; WHITE 3/4" EXTENSION
SOFT-CLOSE DRAWERS & SOFT-CLOSE
HINGES TO KITCHEN AREA**

10' CEILING - 12"H COFFERED CEILING -
M.H. = 102" + 3/4"H CONTEMPORARY
MOLDING + 5 1/4"H FURRING RAIL
+ LARGE CORNICE MOLDING TO
UNDERSIDE OF BOX

*Proud' turn kick - all sides

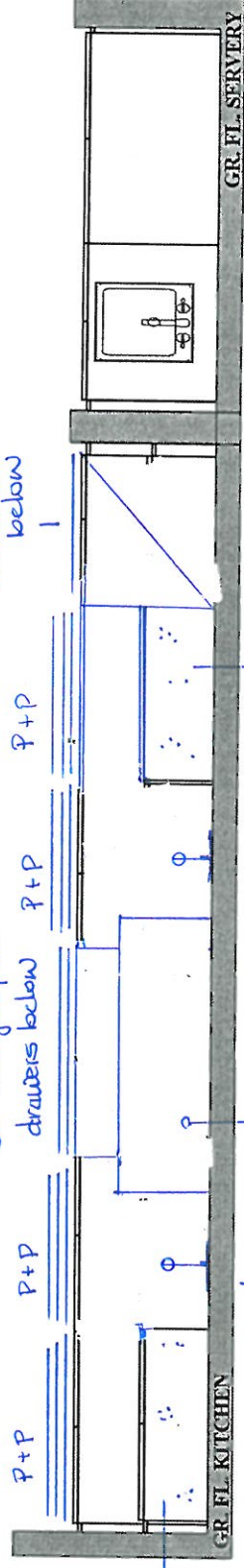
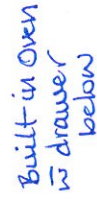
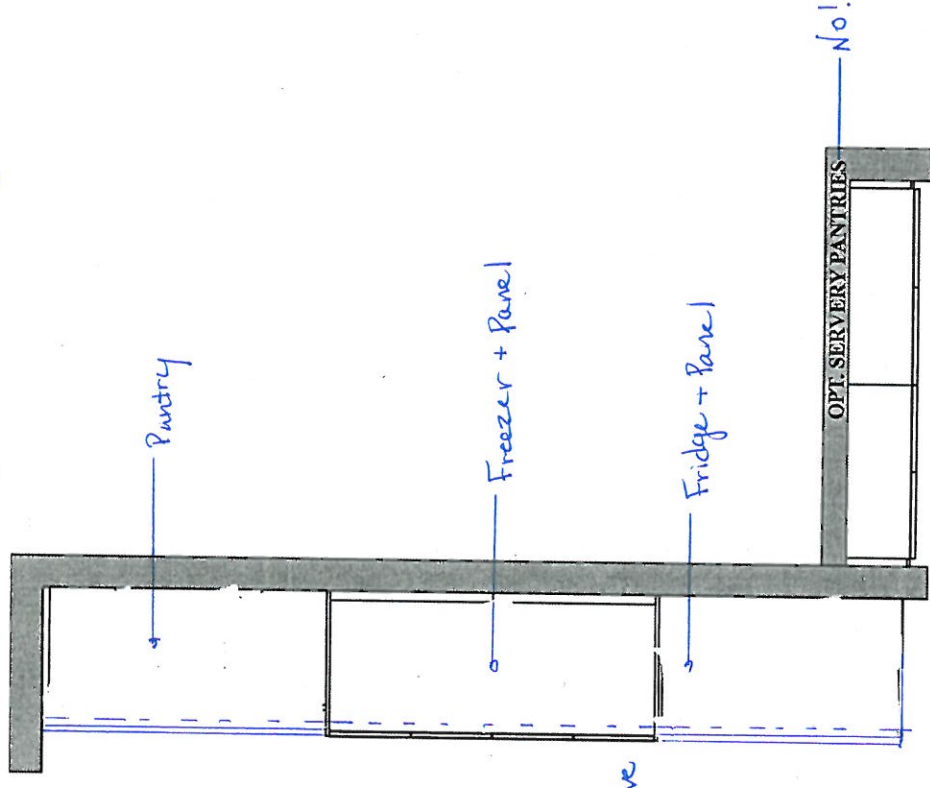
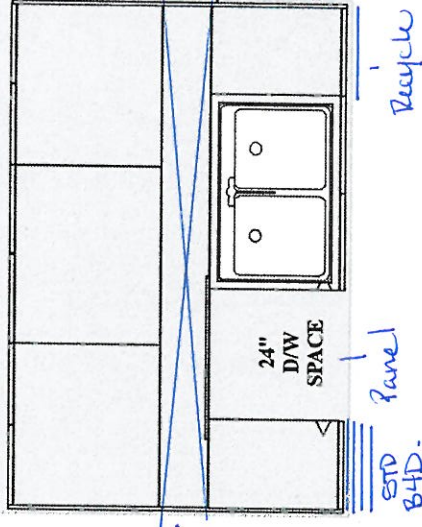
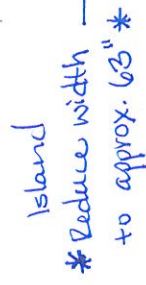

PLAN VIEW

PV-78
Aug 30, 2021

**GOLDPARK HOMES
PINE VALLEY
VAUGHAN, ONTARIO
MODEL: (5004) BEAUMONT**

SITE STANDARD: WHITE 3/4" EXTENSION
SOFT-CLOSE DRAWERS WITH STANDARD SLAM DOOR
HINGES TO VANITIES

ONE TOP DRAWER WHERE POSSIBLE THROUGHOUT EACH
VANITY, ONE BANK OF DRAWERS WHERE POSSIBLE
THROUGHOUT EACH MASTER ENSUITE VANITY

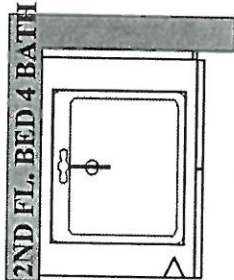
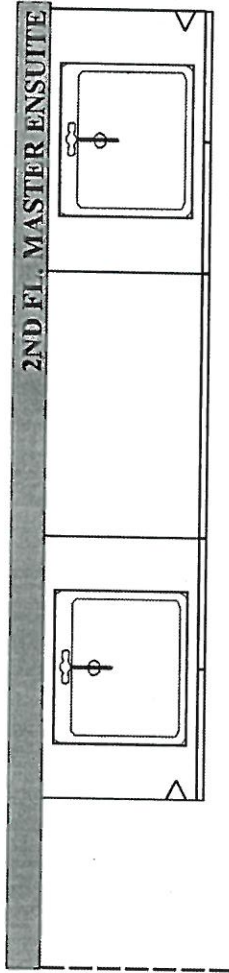
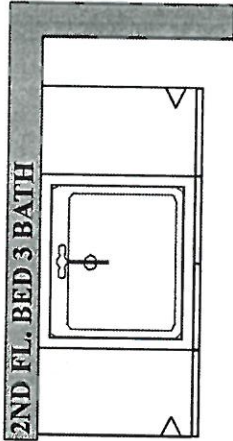
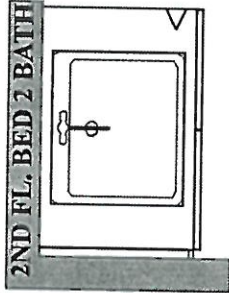
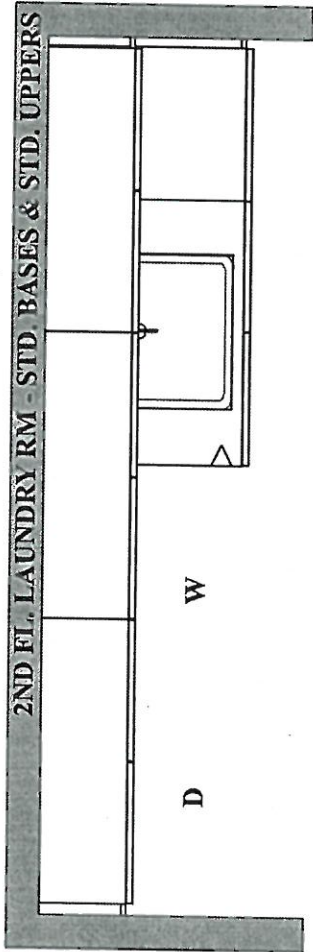
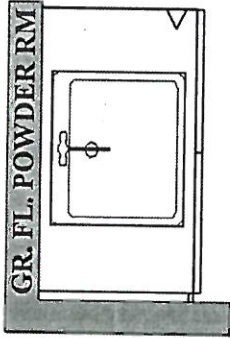
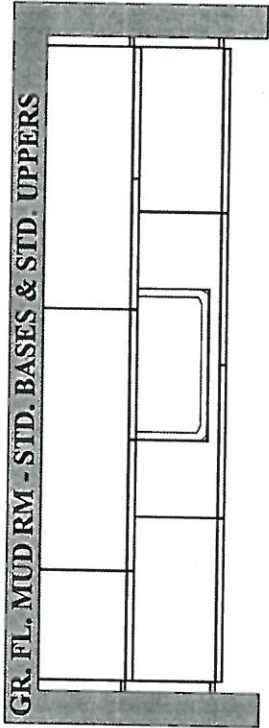

PLAN VIEW

*** NOTE: This is not an approved document. Document must be locked ***

Scheduled Closing Date:

Purchaser: Inventory 78_PH_1

Property: 78 of Plan -

Telephone Res. / Bus: (905) 760-9595

Project: Pine Valley Forevergreen - Phase 1

Decor Advisor: Yolande Somerville

Model and Elevation: 50.04 A BEAUMONT

Layout Changes: ☐ Yes ☒ No Sketch Attached: ☒ Yes ☐ No Exterior Colour Scheme:

1. Cabinetry

	Style and Colour	Counter	Hardware
Kitchen / Breakfast	2-tone	*Quartz: Empira White matte	attached
Laundry Room	Bowery Avenza	*P-Lam: White	attached
Powder Room	*Manhattan Walnut Strm Grey	*Quartz: Empira Black matte	attached
Mud Room	Bowery Avenza	*Granite: Steel Grey LF	attached
Master Ensuite Bathroom	*Willis Pitch Black	*Quartz: Pure White	attached
Second Ensuite Bathroom (If Applicable)	*Windermere Oyster	*Quartz: Misty Carrara	attached
Ensuite 3	*Windermere Oyster	*Quartz: Misty Carrara	attached

Comment

Kitchen: Willis Oyster + Servery: Willis Pitch Black // Ensuite 4: *Manhattan Walnut Strm Grey + Quartz: Empira Black matte

2. Floor Tile

	Selection
Entrance Vestibule	*12x24" Marmorea matte Port Laurent + Grout
Main Hall	n/a
Kitchen / Breakfast	*see hardwood
Laundry Room	*8x8" Maku Dark Matte Decor + Grout
Powder Room	*12x24" Marmorea matte Port Laurent + Grout
Mud Room	*8x8" Maku Dark Matte Decor + Grout
Master Ensuite Bathroom	*12x24" Marmorea polished Breccia White + Grout
Second Ensuite Bathroom (If Applicable)	*8x8" Maku Light Mix Decor + Grout
Lower Landing (If Applicable)	13x13" Capri White
Ensuite 3	*8x8" Marrakesh Decor mix 1 + Grout

Comment

Ensuite 4: Roma Hex Grafite + Grout // Shower Floor: Master - Penny round white matte + Grout // Ensuite 2: Quebec hex black + Grout // Ensuite 4: Quebec Hex arctic white + Grout

3. Wall Tile

	Selection	Listello/Inserts	Describe
Ensuite 3	*8x8" Marakesh 'Ivory matte' + grout	<input type="radio"/> Yes <input checked="" type="radio"/> No	
Master Ensuite Bathroom			
Tub Deck		<input type="radio"/> Yes <input checked="" type="radio"/> No	
Shower Stall	*12x24" Marmorea pol Breccia white	<input type="radio"/> Yes <input checked="" type="radio"/> No	
Bathroom Walls		<input type="radio"/> Yes <input checked="" type="radio"/> No	
Second Ensuite Bathroom (If Applicable)	*3x6" CDC matte Black + grout	<input type="radio"/> Yes <input checked="" type="radio"/> No	
Ensuite 4	*2x16" CDC Arctic White Bright	<input type="radio"/> Yes <input checked="" type="radio"/> No	
Kitchen Backsplash	<input checked="" type="radio"/> Yes <input type="radio"/> No	Backsplash Behind Fridge	

Comment

*FHBS - Slab + Servery

Scheduled Closing Date:

Purchaser: Inventory 78_PH_1

Property: 78 of Plan -

Telephone Res. / Bus: (905) 760-9595

Project: Pine Valley Forevergreen - Phase 1

Decor Advisor: Yolande Somerville

Model and Elevation: 50.04 A BEAUMONT

4. Plumbing Fixtures

Master Ensuite Bathroom Second Ensuite Powder Room
Other Room - Specify Other Washroom

Comment

See extras

5. Hardwood Flooring

	Type and Stain		Type and Stain
Main Hall	<input type="text"/>	Upper Landing	<input type="text"/>
Kitchen / Breakfast	*3/4x5" wht oak wire brush Atlantis	Upper Hall	<input type="text"/>
Living Room	<input type="text"/>	Master Bedroom	<input type="text"/>
Dining Room	<input type="text"/>	Bedroom #2	<input type="text"/>
Family Room	<input type="text"/>	Bedroom #3	<input type="text"/>
Den/Library	<input type="text"/>	Bedroom #4	<input type="text"/>
Entrance Vestibule	<input type="text"/>	Bedroom #5	<input type="text"/>
Lower Landing (If Applicable)	<input type="text"/>	Other Room - Specify	<input type="text"/>
		Thru out standard areas	*3/4x5" wht oak wire brush Atlantis

Comment

6. Carpeting

	Upgrade	Description
Ground Floor	<input type="checkbox"/>	<input type="text"/>
Second Floor	<input type="checkbox"/>	<input type="text"/>
<input type="text"/>	<input type="checkbox"/>	<input type="text"/>

	Type	Area
Upgrade Underpad	<input type="text"/>	<input type="text"/>
	Capped	Runner - *Upgrade
Carpet on Stairs	<input type="text"/>	<input type="text"/>

Comment

7. Fireplace

	Living Room			Family Room			Other Room - Specify			Great Room
	Purchased	As Per Plan	N/A	Purchased	As Per Plan	N/A	Purchased	As Per Plan	N/A	
Fireplace Type	<input type="radio"/>	<input type="radio"/>	<input checked="" type="radio"/>	<input type="radio"/>	<input type="radio"/>	<input checked="" type="radio"/>	<input type="radio"/>	<input checked="" type="radio"/>	<input type="radio"/>	Standard Gas
Mantle Type	<input type="text"/>			<input type="text"/>			<input type="text"/>			n/a
Colour / Stain	<input type="text"/>			<input type="text"/>			<input type="text"/>			n/a
Surround	<input type="text"/>			<input type="text"/>			<input type="text"/>			n/a
Hearth	<input type="text"/>			<input type="text"/>			<input type="text"/>			n/a

Comment

Scheduled Closing Date:

Purchaser: Inventory 78_PH_1

Property: 78 of Plan -

Telephone Res. / Bus: (905) 760-9595

Project: Pine Valley Forevergreen - Phase 1

Decor Advisor: Yolande Somerville

Model and Elevation: 50.04 A BEAUMONT

8. Trim Carpentry

Interior Doors Front Door Glass Inserts Door Handles

Interior Trim

Comment

9. Plaster Mouldings and Medallions

Standard Throughout ☐ Yes ☐ No ☐ N/A

Entrance Vestibule	<input type="text"/>	<input type="text"/>	Kitchen/Breakfast	<input type="text"/>	<input type="text"/>
Main Hall	<input type="text"/>	<input type="text"/>	Den/Library	<input type="text"/>	<input type="text"/>
Living Room	<input type="text"/>	<input type="text"/>	Lower Landing	<input type="text"/>	<input type="text"/>
Dining Room	<input type="text"/>	<input type="text"/>	Other Room - Specify	<input type="text"/>	<input type="text"/>
Family Room	<input type="text"/>	<input type="text"/>			

Comment

10. Railings and Spindles

Railing Package

Railing Colour

Stringer / Riser

Spindle Colour

Treads

Comment

Oak Stairs ☒ Yes ☐ No ☐ N/A

11. Wall Paint / Ceilings

Throughout Finished Areas

Trim Paint

Smooth Ceilings

Ground Floor ☒

Second Floor ☒

Note

Comment

Scheduled Closing Date:

Purchaser: Inventory 78_PH_1

Property: 78 of Plan -

Telephone Res. / Bus: (905) 760-9595

Project: Pine Valley Forevergreen - Phase 1

Decor Advisor: Yolande Somerville

Model and Elevation: 50.04 A BEAUMONT

12. Electrical

Hood Fan ☐ White ☐ Stainless ☒ N/A

Above Kitchen Cabinet Light ☐ Yes ☒ No

Below Kitchen Cabinet Light ☐ Yes ☒ No

Standard Appliances ☐

Over The Range Microwave ☐

Chimney Style Fan ☐

Comment

13. Heating and Air Conditioning

Air Conditioning

Gas Provisions Stove

Gas Provisions Dryer

Gas Provisions Barbecue

Comment

14. Additional Comments

15. Disclaimers and Notes

- 1) Colours of all materials are as close as possible to builder's selection, but not necessarily identical due to variances in manufacturing.
- 2) Any extras listed above are null and void unless accompanied by a separate invoice/amendment. Said invoice must be paid in full.
- 3) The Purchaser acknowledges that after Interior Colour Selection form is signed and dated, no further changes will be permitted other than re-selection due to unavailability. _____ Purchaser's Initials
- 4) The Purchaser acknowledges reading and accepting the "Gold Park Homes Decor Centre Disclaimers" form. This document contains other miscellaneous disclaimers.

This Interior Colour Selection is final and approved by:

Signature: _____ Date: _____

PV-78 Grout Schedule

ROOM	LOCATION	COLOUR
FOYER	FLOOR	CHARCOAL
POWDER ROOM	FLOOR	CHARCOAL
LAUNDRY ROOM	FLOOR	CHARCOAL
MUD ROOM	FLOOR	CHARCOAL
MASTER ENSUITE	FLOOR	BONE
	SHOWER WALL	BONE
	SHOWER FLOOR	BONE
ENSUITE 2	FLOOR	BONE
	SHOWER WALL	CHARCOAL
	SHOWER FLOOR	CHARCOAL
ENSUITE 3	FLOOR	CHARCOAL
	SHOWER WALL	BONE
ENSUITE 4	FLOOR	CHARCOAL
	SHOWER WALL	BONE
	SHOWER FLOOR	BONE

LOT #:

DATE:

SIGNATURE:

SIGNATURE:



SCHEDULE 'F'

PV-78
July 27 2021

AUGUST 31 2021

The Beaumont

50' SERIES

→ Elevation A • 4,170 sq.ft.
4,315 sq.ft. Opt. Elevator
Elevation B • 4,165 sq.ft.
4,315 sq.ft. Opt. Elevator
Elevation C • 4,250 sq.ft.
4,400 sq.ft. Opt. Elevator

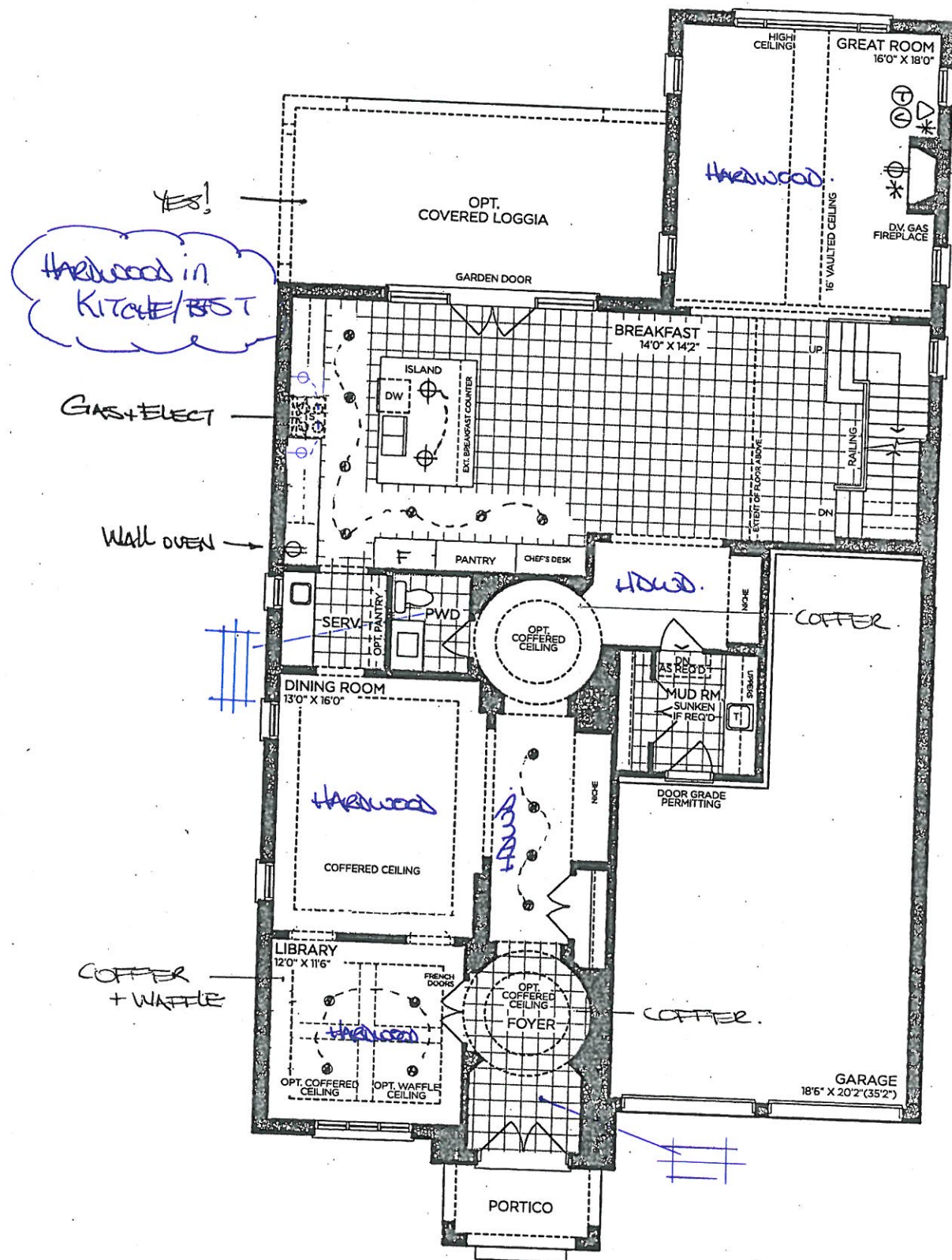

GROUND FLOOR | ELEV. A

VENDOR	
PURCHASER	
PURCHASER	

GOLDPARK
WORTH MORE™

Prices, figures, illustrations, sizes, features and finishes are subject to change without notice. Areas and dimensions are approximate and actual usable floor space may vary from the stated area. Layout may be reverse of the unit purchased. E. & O.E. 5004

SCHEDULE 'F'



PV-78
July 27 2021
August 31 2021

The Beaumont 50' SERIES

Elevation A • 4,170 sq.ft.
4,315 sq.ft. Opt. Elevator
Elevation B • 4,165 sq.ft.
4,315 sq.ft. Opt. Elevator
Elevation C • 4,250 sq.ft.
4,400 sq.ft. Opt. Elevator

8' Doors
on 2nd Floor

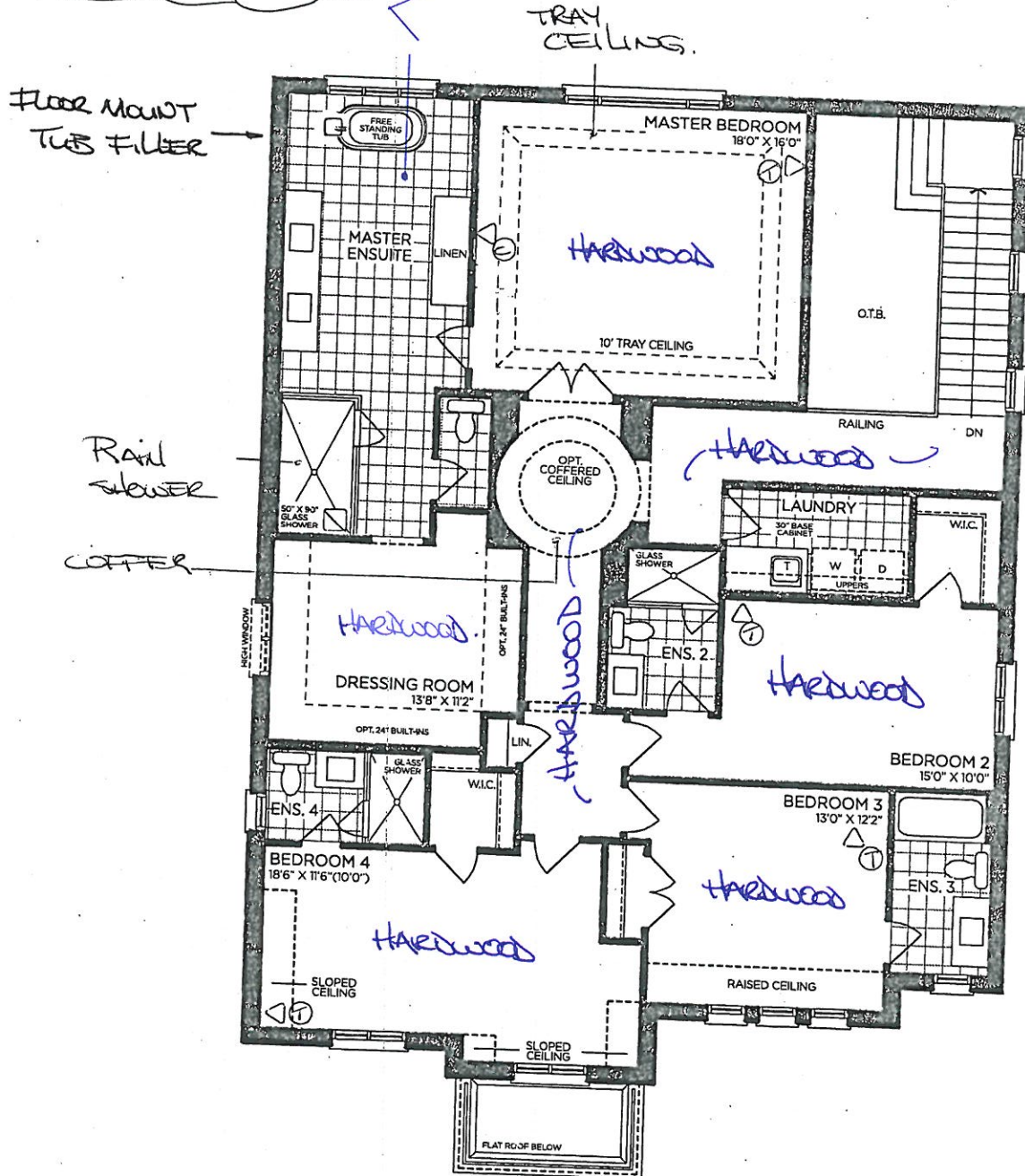

SECOND FLOOR | ELEV. A

VENDOR

PURCHASER

PURCHASER

GOLDPARK
WORTH MORE™

Prices, figures, illustrations, sizes, features and finishes are subject to change without notice. Areas and dimensions are approximate and actual usable floor space may vary from the stated area. Layout may be reverse of the unit purchased. E. & O.E. 5004

SCHEDULE 'F'



PV-78
July 27 2021
August 31 2021

The Beaumont

50' SERIES

- Elevation A • 4,170 sq.ft.
4,315 sq.ft. Opt. Elevator
Elevation B • 4,165 sq.ft.
4,315 sq.ft. Opt. Elevator
Elevation C • 4,250 sq.ft.
4,400 sq.ft. Opt. Elevator

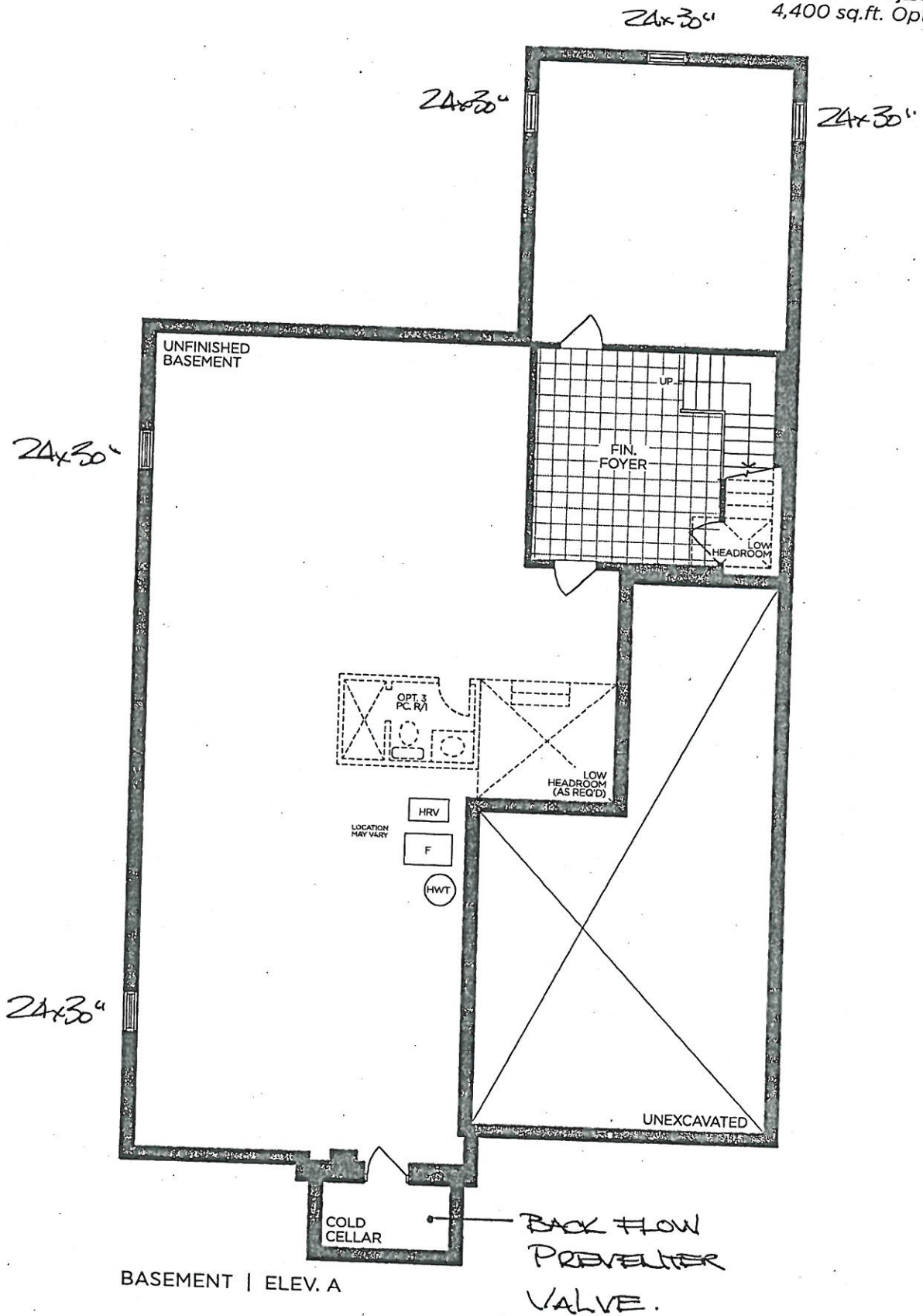

BASEMENT | ELEV. A

VENDOR

PURCHASER

PURCHASER

GOLDPARK
WORTH MORE™

Prices, figures, illustrations, sizes, features and finishes are subject to change without notice. Areas and dimensions are approximate and actual usable floor space may vary from the stated area. Layout may be reverse of the unit purchased. E. & O.E. 5004



PINE VALLEY
FOREVERGREEN

STONE COUNTERTOP EDGE PROFILES



STANDARD 2CM EASED EDGE

LOCATION:

* thru-out *

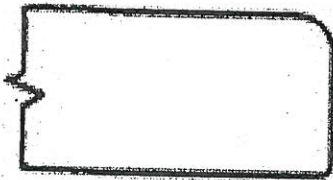

UPGRADE 3CM EASED EDGE

LOCATION:



UPGRADE 4CM MITRED EDGE

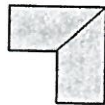

LOCATION:

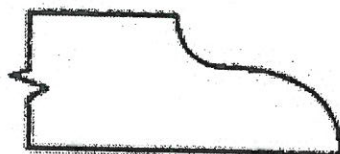

UPGRADE 2CM OGEE EDGE

LOCATION:

LOT #: PV-78

DATE:

SIGNATURE:

SIGNATURE:



PINE VALLEY
FOREVERGREEN

STANDARD HARDWARE / KNOBS

☐

K002-02

☐

K002-03

☐

K002-04

☐

K002-06

☒

K002-05

→ Mud Room
→ Laundry Room
→ Ensuites 2, 3, 4

☐

K008-14

☐

K024-03

☐

*NO HARDWARE

☐

TOUCH-LATCH

*DISCLAIMER: NO HARDWARE OR HOLES THRU-OUT: HOMEOWNER IS RESPONSIBLE FOR THE INSTALLATION OF THEIR OWN HARDWARE AFTER CLOSING AT THEIR OWN EXPENSE AND WARRANTY.

LOT #

PV-78

DATE:

SIGNATURE:

SIGNATURE:



UPGRADE HARDWARE

BH-082-03



- ☐ BRUSHED NICKEL
- ☒ MATTE BLACK

LOCATION:

→ kitchen

LOT # PV-78

DATE:

SIGNATURE:

SIGNATURE:

TRANSITIONAL METAL PULL

338mm - 8716

Product #: BP8716320CHBRZ



LOCATION:

→ Master Ensuite

LOT #
PV-78

DATE:

SIGNATURE:

SIGNATURE:

PLUMBING UPGRADES

MOEN - ALIGN

Two-Handle Adjustable Widespread Lav Faucet with Lift Rod Drain



- ☐ CHROME
- ☐ BRUSHED NICKEL (BN)
- ☐ BRUSHED GOLD (BG)
- ☒ MATTE BLACK (BL)

MODEL: T6193 / 69000

Lot# PV-78	Date:	Room: Powder Room
Signature:		
Signature:		



UPGRADE VANITY SINK

EMERY

RECTANGULAR UNDERMOUNT SINK

- ☐ 4220CGY Undermount Sink, Soft White
☒ 4220CGY-077 Undermount Sink, Matte Black
☐ 4220CGY-088 Undermount Sink, Slate Grey

PRODUCT SPECS:

- Vitreous china
- Front overflow hole
- 8 1/4" Bowl depth
- Template and mounting hardware supplied

DIMENSIONS:

Outer:

545mm W x 355mm D x 210mm H
21 1/2" W x 14" D x 8 1/4" H

Inner:

495mm W x 305mm D x 160mm H
19 1/2" W x 12" D x 6 1/4" H

COMPLIANCE CERTIFICATIONS

Meets or exceeds the following:

- IAPMO cUPC
- ASME A112.19.2 / CSA B45.1

SHIPPING

Cube 1.85
GW 20 lbs



TO BE SPECIFIED

Colour:

- ☐ Soft White
☒ Matte Black
☐ Slate Grey

NOTES: Dimensions of fixtures are nominal and may vary within the range of tolerances established by ASME standard A112.19.2. These measurements are subject to change or cancellation. No responsibility is assumed for use of superseded or voided pages.

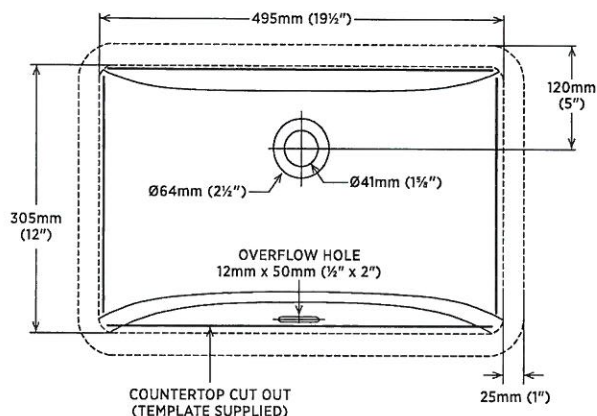

DETAIL OF MOUNTING CLIP

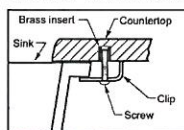

Note:
▲ Dimensions shown for location of supplies and "P" trap are suggested.

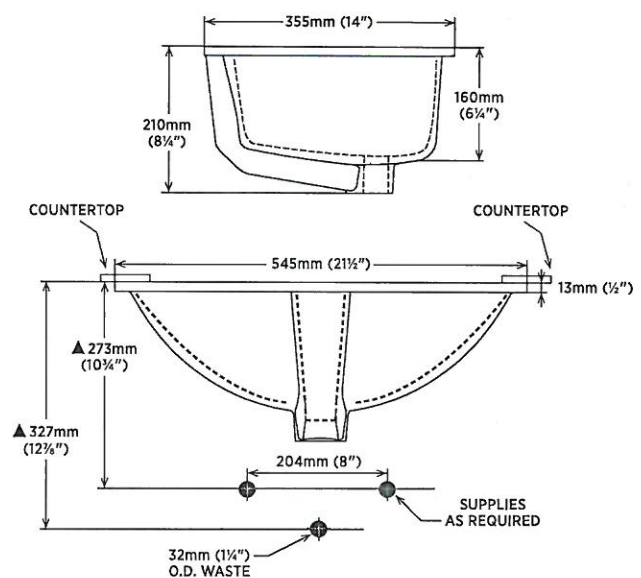

Lot# **PV-78**

Date:

Room: **Powder Room**

Signature:

Signature:



PINE VALLEY
FOREVERGREEN

UPGRADE TOILET

CILA

Contrac
Soft White

1 Piece Elongated Bowl w/ Concealed Skirted Trap-Way



DESCRIPTION: Soft White, 17" plus height for greater comfort, Soft white tank lever

DIMENSIONS: 15 3/8" W x 28 1/2" D x 30 1/8" H

MODEL: 4710BOXU

Lot# PV-78	Date:	Room: Powder Room
Signature:		
Signature:		



PINE VALLEY
FOREVERGREEN

UPGRADE KITCHEN FAUCET

MOEN - NIO

One-Handle Pulldown Kitchen Faucet

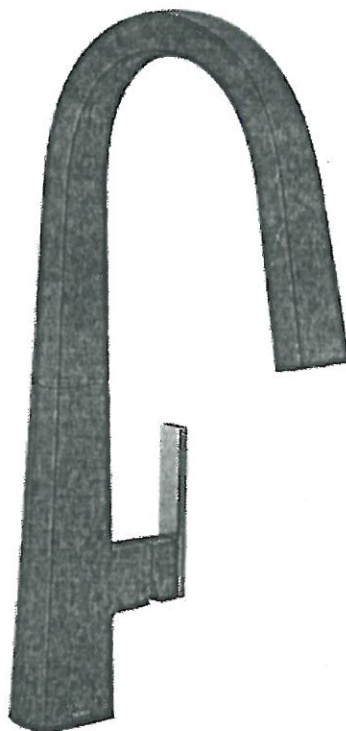

- ☐ CHROME
- ☒ MATTE BLACK / BRUSHED GOLD (BL)
- ☐ SPOT RESIST STAINLESS (SRS)

MODEL: S75005 Chrome / S75005BL Matte Black / S75005SRS Spot Resist Stainless

Lot# PV-78	Date: ✓	Room: Kitchen
Signature:		
Signature:		



PINE VALLEY
FOREVERGREEN

UPGRADE KITCHEN SINK

BLANCO - PRECIS U SUPER SINGLE

Silgranit - Undermount Sink
32" x 19" x 9-1/2"



Anthracite



Concrete Grey



Metallic Grey



White

- ☒ ANTHRACITE
☐ CONCRETE GREY
☐ METALLIC GREY
☐ WHITE
☐ CINDER

MODEL 400890 Anthracite / 402266 Concrete Grey / 401683 Metallic Grey / 401820 White / 401397 Cinder

Lot# 11-78	Date:	Room: Kitchen
Signature:		
Signature:		



PINE VALLEY
FOREVERGREEN

UPGRADE BAR FAUCET

MOEN - NIO

One-Handle Bar Faucet

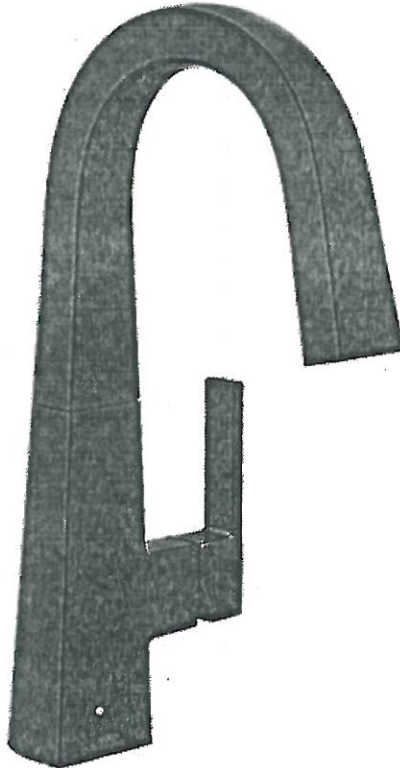

- ☐ CHROME
- ☒ MATTE BLACK / BRUSHED GOLD (BL)
- ☐ STAINLESS (SRS)

MODEL: S55005 Chrome / S55005BL Matte Black / S55005SRS Spot Resist Stainless

Lot# *PV-78*

Date:

Room:

Seveny

Signature:

Signature:

UPGRADE BAR SINK



BLANCO - PRECIS U 3/4
Silgranit - Undermount Sink
13 3/4" x 18 1/8" x 7 1/2"

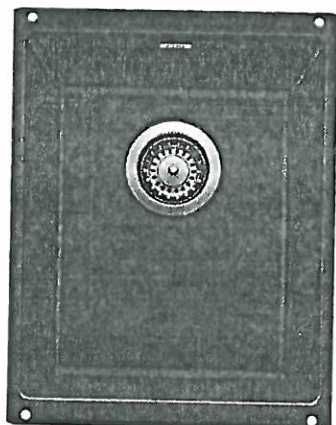

Anthracite

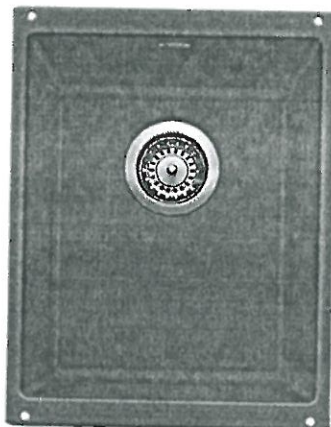

Concrete Grey

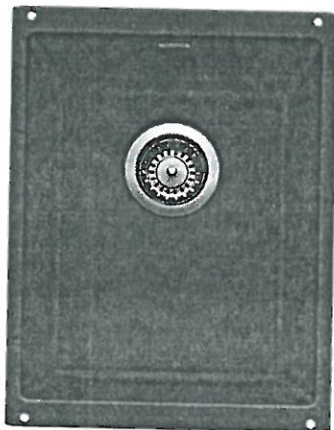

Metallic Grey

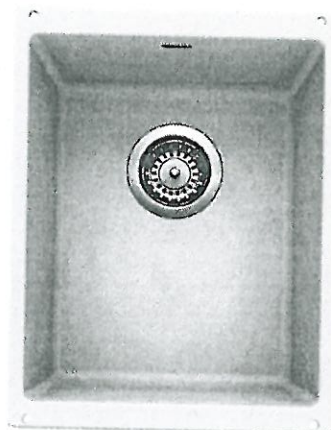

White

- ☒ ANTHRACITE
- ☐ CONCRETE GREY
- ☐ METALLIC GREY
- ☐ WHITE

MODEL 400827 Anthracite / 402270 Concrete Grey / 401679 Metallic Grey / 401703 White /

LOT # *PV-78*

ROOM: *Serveng*

DATE:

SIGNATURE:

SIGNATURE:



PINE VALLEY
FOREVERGREEN

UPGRADE SINK + FAUCET

BLANCO - QUATRUS R15 LAUNDRY SINK
+
MOEN - SLEEK SINGLE HANDLE PULLOUT FAUCET

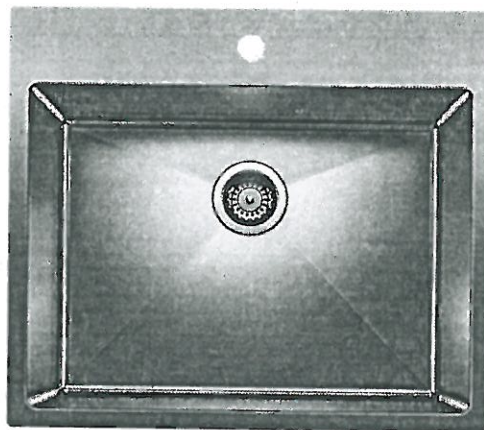
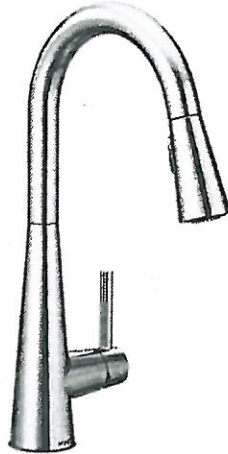

*CHROME ONLY + STAINLESS STEEL

MODEL: 7864 Faucet / 401802 Stainless Steel Sink

Lot# PV-78	Date:	Room: Mud Room + Laundry Room
Signature:		
Signature:		



PINE VALLEY
FOREVERGREEN

UPGRADE SHOWER HARDWARE

SQ6X6

Shower Door Handle

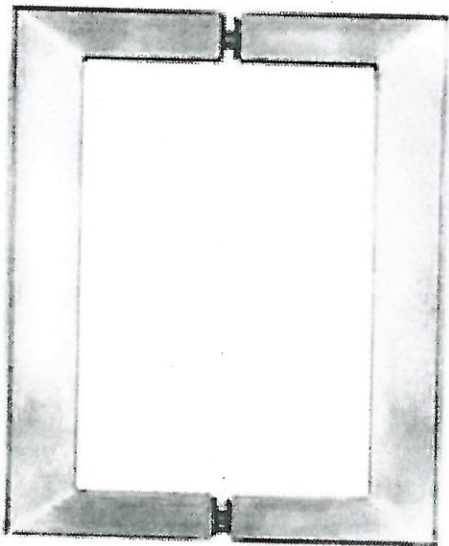

SQ6X6
Shower Door Handle

6" x 6" back-to-back
3/4" square tube

- ☒ CHROME
- ☐ MATTE BLACK

Lot# PV-78	Date: 	Room: Master Ensuite
Signature: 		
Signature: 		



PINE VALLEY

FOREVERGREEN

BATHROOM ACCESSORIES

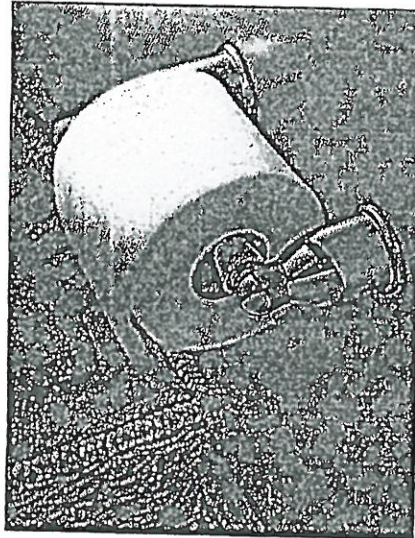

Tissue Holder
Mason - Chrome

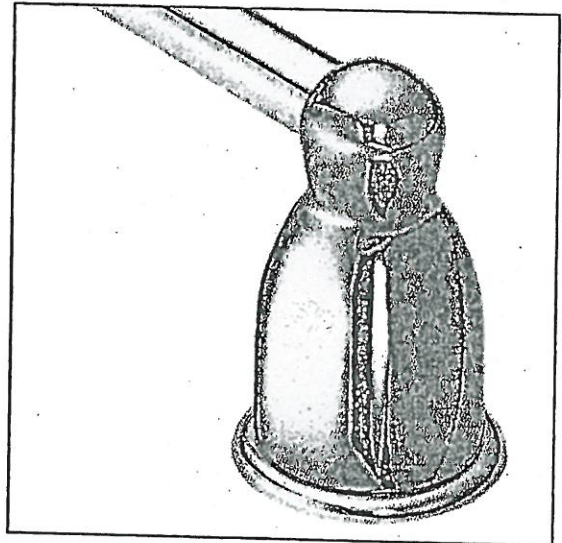

Towel Bar
Mason - Chrome

Please select one of the following:

☐ INSTALL STANDARD BATHROOM ACCESSORIES THRU OUT
(tissue holder + towel bar) **location as per vendors discretion**

☐ ***DO NOT*** INSTALL STANDARD BATHROOM ACCESSORIES
THRU OUT **tissue holder + towel bar will not be provided**

LOT #

PV-78

DATE:

SIGNATURE:

SIGNATURE:

UPGRADE KITCHEN EXTRA



ASPEN RANGE HOOD

(Insert fan not included)

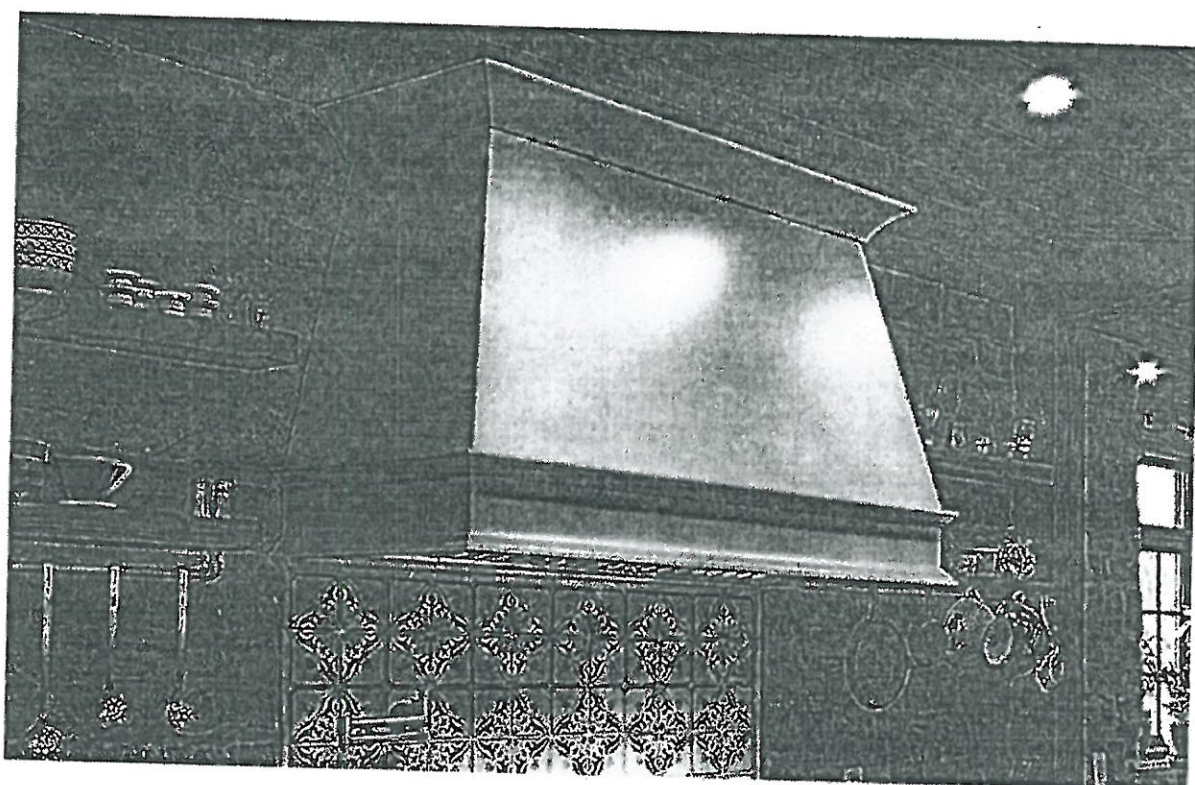

LOT #

PV-78

DATE:

ROOM:

kitchen

SIGNATURE:

SIGNATURE:

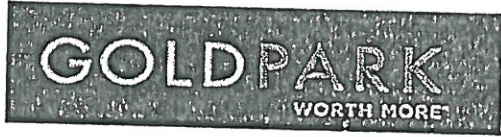

Project: Pine Valley

Lot: 78

Purchaser(s): _____

Standard Hood Fan Deletion

We acknowledge that the builder's standard hood fan will not be installed.
Do not supply, install and/or credit. We will install our own hood fan after closing.

Signature: _____

Signature: _____

Date: _____



PINE VALLEY
FOREVERGREEN

UPGRADE KITCHEN EXTRA

MOEN - MODERN

Pot Filler

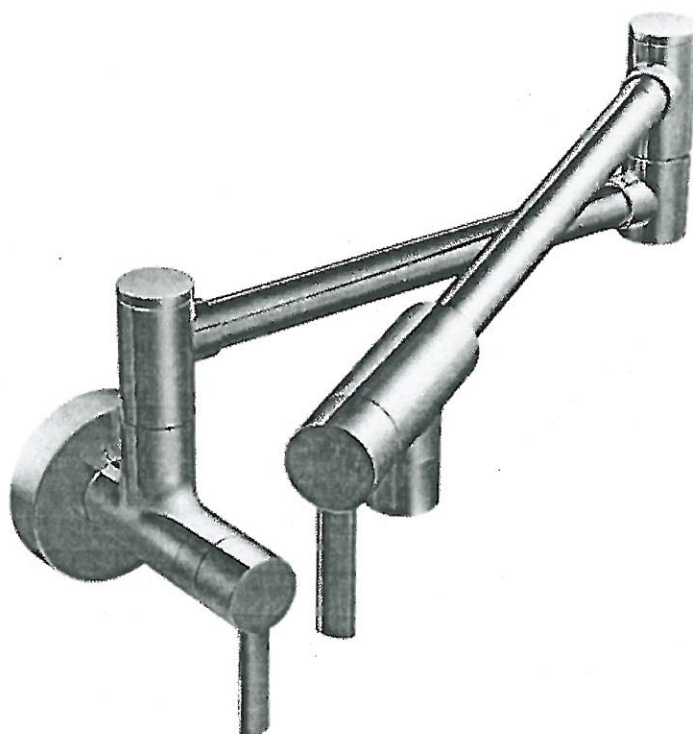

- ☐ CHROME
- ☐ STAINLESS (SRS)
- ☐ POLISHED NICKEL (NL)
- ☐ MATTE BLACK (BL)
- ☒ BRUSHED GOLD (BG)

MODEL: S665 Pot Filler

Lot# 78	Date: July 27 2021	Room: KITCHEN
Signature:		
Signature:		

GOLDPARK
WORTH MORE

ALIGN MASTER ENSUITE PACKAGE

*Brushed Gold

MOEN

Lav Faucets, 8" Rainshower, Handshower, Free-Standing Tub Filler



☐ WALL

☒ CEILING

MODEL: S6320 Shower Head + 226651 Shower Arm + T6193/69000 Lav Facuets(x2) + 395/TS50100 Tub Filler + T2192 Shower + U361CI Transfer Valve + UT4191 Transfer + 62320 Temp Valve + 3887 Handshower + A725 Drop El

Lot# 78	Date: July 27 2021	Room: MASTER ENSUITE
Signature:		
Signature:		



KITCHEN / SERVERY



MASTER ENSUITE



ENSUITE 2

ENSUITE 3



POWDER ROOM



ENSUITE 4



LAUNDRY / MUD ROOM