



CONSTRUCTION SUMMARY

Lot: BLOCK 160  
Model: 38-6 Elev.B SCARLATTI OPT- GFA1  
Project/Phase: Brampton Encore / 2

CERAMIC

Invoice	Qty.	Description
2622 11Mar21 NoCat	1	FOYER / POWDER / GROUND FLOOR FOYER: UPGRADE 4 FLOOR TILE - 12X24" LAID IN STRAIGHT, STACKED PATTERN. SEE PLAN FOR TILE DIRECTION
2622 11Mar21 NoCat	1	MASTER ENSUITE: UPGRADE 4 FLOOR + SHOWER WALL TILE - 12X24" LAID IN STRAIGHT, STACKED PATTERN - HORIZONTAL ON WALLS
2622 11Mar21 NoCat	1	MASTER ENSUITE: UPGRADE TO FREE STANDING TUB - MIROLIN 'BROOKE'  FLOOR TILE REQUIRED WALL TO WALL

CONCRETE AND DRAIN

Invoice	Qty.	Description
2549 28,894 27Jan21 **	1	ROUGH-IN - 3PC BASEMENT ROUGH-IN  INCLUDED IN APS
2549 27Jan21 NoCat	1	.ROUGH-IN - 3PC BASEMENT ROUGH-IN  INCLUDED IN APS

DRYWALL

Invoice	Qty.	Description
2549 27Jan21 NoCat	1	.SIDE DOOR- HOME TO EXTERIOR- AS PER PLAN AND GRADE PERMITTING  Included in APS
2549 27Jan21 NoCat	1	.MANDOOR - GARAGE TO HOUSE- AS PER PLAN AND GRADE PERMITTING  INCLUDED IN APS
2549 27Jan21 NoCat	3	.MAIN FLOOR: EXTENDED HEIGHT ARCHWAY (PRICE PER DOORWAY) - 96"
2549 27Jan21 NoCat	4	.MAIN FLOOR: STANDARD DOOR EXTENDED HEIGHT 96" (PRICE PER DOOR) MAIN FLOOR 3 STOREY MODELS
2622 11Mar21 NoCat	1	FYI - MASTER ENSUITE: UPGRADE TO FREE STANDING TUB - MIROLIN 'BROOKE'

ELECTRICAL

Invoice	Qty.	Description
2549 27Jan21 NoCat	1	KITCHEN: SINGLE POLE SWITCH  FOR PENINSULA LIGHT
2549 28,822 27Jan21	1	KITCHEN: ROUGH - IN CEILING OUTLET ON SAME SWITCH - DOES NOT INCLUDE FIXTURE - LOCATE APPROX CENTERED ABOVE PENINSULA
2549 28,811 27Jan21	1	200 AMP ELECTRICAL SERVICE
2549 28,810 27Jan21	1	KITCHEN: 220V WALL RECEPTICAL ON DEDICATED CIRCUIT- FOR 4 WIRE BUILT-IN WALL OVEN - SEE PLAN FOR LOCATION
2549 28,808 27Jan21	1	KITCHEN: 110V WALL RECEPTACLE ON DEDICATED CIRCUIT - GAS FIRED APPLIANCE - FOR AUX. EQUIPMENT - NOT A STOVE PLUG

EXTERIOR COLOURS

Invoice	Qty.	Description
2549 27Jan21 NoCat	1	COLOUR PACKAGE #4

FORMING

Invoice	Qty.	Description
2549 28,841 27Jan21	1	SIDE DOOR- HOME TO EXTERIOR- AS PER PLAN AND GRADE PERMITTING  INCLUDED IN APS
2549 28,842 27Jan21 **	1	MANDOOR - GARAGE TO HOUSE- AS PER PLAN AND GRADE PERMITTING  INCLUDED IN APS
2549 28,916 27Jan21 **	4	BASEMENT WINDOWS - UPGRADE EXISTING BASEMENT WINDOW TO 30 INCH X 24 INCH - MAY REQUIRE INSTALLATION OF WINDOW WELL
2549 27Jan21 NoCat	1	.MANDOOR - GARAGE TO HOUSE- AS PER PLAN AND GRADE PERMITTING  INCLUDED IN APS
2549 27Jan21 NoCat	4	.BASEMENT WINDOWS - UPGRADE EXISTING BASEMENT WINDOW TO 30 INCH X 24 INCH - MAY REQUIRE INSTALLATION OF WINDOW WELL



CONSTRUCTION SUMMARY

Lot: BLOCK 160  
Model: 38-6 Elev.B SCARLATTI OPT- GFA1  
Project/Phase: Brampton Encore / 2

FRAMING

Invoice	Qty.	Description
2549 28,842 27Jan21	1	MANDOOR - GARAGE TO HOUSE- AS PER PLAN AND GRADE PERMITTING  INCLUDED IN APS
2549  27Jan21 NoCat	1	.SIDE DOOR- HOME TO EXTERIOR- AS PER PLAN AND GRADE PERMITTING  INCLUDED IN APS
2549  27Jan21 NoCat	4	.BASEMENT WINDOWS - UPGRADE EXISTING BASEMENT WINDOW TO 30 INCH X 24 INCH - MAY REQUIRE INSTALLATION OF WINDOW WELL
2549  27Jan21 NoCat	3	.MAIN FLOOR: EXTENDED HEIGHT ARCHWAY (PRICE PER DOORWAY) - 96"
2549  27Jan21 NoCat	4	.MAIN FLOOR: STANDARD DOOR EXTENDED HEIGHT 96" (PRICE PER DOOR) MAIN FLOOR 3 STOREY MODELS
2622  11Mar21 NoCat	1	FYI - MASTER ENSUITE: UPGRADE TO FREE STANDING TUB - MIROLIN 'BROOKE'

GRANITE MARBLE QUARTZ

Invoice	Qty.	Description
2622  11Mar21 NoCat	1	KITCHEN: UPGRADE 3 QUARTZ COUNTER TOP
2622  11Mar21 NoCat	1	KITCHEN: FLUSH BREAKFAST BAR
2622  11Mar21 NoCat	1	KITCHEN: FULL HEIGHT SLAB BACKSPLASH - LEVEL 3 QUARTZ
2622  11Mar21 NoCat	1	KITCHEN: COOKTOP CUT OUT



HARDWOOD

Invoice	Qty.	Description
2622  11Mar21 NoCat	1	FAMILY / LIVING/ DINING/ MAIN HALL / LANDNGS / UPPER HALL / KITCHEN: UPGRADE 3 HARDWOOD - 3/4X5" VINTAGE WHITE OAK WIRE BRUSHED  HARDWOOD FLOORS WILL NOT MATCH STAIRS IN COLOUR/TEXTURE/SPECIES
2622  11Mar21 NoCat	1	FYI - KITCHEN: RAISE CABINETRY 3/4" FOR HARDWOOD FLOOR INSTALL

HVAC

Invoice	Qty.	Description
2549 28,872 27Jan21	1	KITCHEN: GAS LINE ROUGH - 2ND FLOOR- (3-STOREY MODELS) FOR GAS COOKTOP OR RANGE TOP

INTERIOR TRIM AND DOORS

Invoice	Qty.	Description
2549 28,841 27Jan21 **	1	SIDE DOOR- HOME TO EXTERIOR- AS PER PLAN AND GRADE PERMITTING  INCLUDED IN APS
2549 28,885 27Jan21	3	MAIN FLOOR: EXTENDED HEIGHT ARCHWAY (PRICE PER DOORWAY) - 96"
2549 28,884 27Jan21	4	MAIN FLOOR: STANDARD DOOR EXTENDED HEIGHT 96" (PRICE PER DOOR) MAIN FLOOR 3 STOREY MODELS
2549  27Jan21 NoCat	1	.SIDE DOOR- HOME TO EXTERIOR- AS PER PLAN AND GRADE PERMITTING  Included in APS
2549  27Jan21 NoCat	1	.MANDOOR - GARAGE TO HOUSE- AS PER PLAN AND GRADE PERMITTING  INCLUDED IN APS
2549  27Jan21 NoCat	4	.BASEMENT WINDOWS - UPGRADE EXISTING BASEMENT WINDOW TO 30 INCH X 24 INCH - MAY REQUIRE INSTALLATION OF WINDOW WELL
2622  11Mar21 NoCat	1	MASTER ENSUITE: UPGRADE TO FREE STANDING TUB - MIROLIN 'BROOKE'



CONSTRUCTION SUMMARY

Lot: BLOCK 160  
Model: 38-6 Elev.B SCARLATTI OPT- GFA1  
Project/Phase: Brampton Encore / 2

KITCHEN AND BATH CABINETRY

Invoice	Qty.	Description
2622 11Mar21 NoCat	1	KITCHEN: UPGRADE 2 CABINETRY PROFILE + SPRAY STAIN
2622 11Mar21 NoCat	1	KITCHEN: DOUBLE APPLIANCE CABINET WITH POT DRAWER BELOW OVENS
2622 11Mar21 NoCat	3	KITCHEN: POTS AND PANS DRAWERS BELOW COOKTOP - 1 SHALLOW TOP DRAWER (dummy at cooktop) + 2 DEEP DRAWERS BELOW
2622 11Mar21 NoCat	1	KITCHEN: FINISHED GABLE AT OVENS
2622 11Mar21 NoCat	1	KITCHEN: L-SHAPED CANOPY - INCLUDES 600CFM FAN
2622 11Mar21 NoCat	1	KITCHEN: UPGRADE HARDWARE
2622 11Mar21 NoCat	1	KITCHEN: RAISE CABINETRY 3/4" FOR HARDWOOD FLOOR INSTALL
2622 11Mar21 NoCat	1	FYI - KITCHEN: FULL HEIGHT SLAB BACKSPLASH - LEVEL 3 QUARTZ

PAINT

Invoice	Qty.	Description
2549 28,842 27Jan21 **	1	MANDOOR - GARAGE TO HOUSE- AS PER PLAN AND GRADE PERMITTING  INCLUDED IN APS
2549  27Jan21 NoCat	1	.SIDE DOOR- HOME TO EXTERIOR- AS PER PLAN AND GRADE PERMITTING  Included in APS
2549  27Jan21 NoCat	1	.MANDOOR - GARAGE TO HOUSE- AS PER PLAN AND GRADE PERMITTING  INCLUDED IN APS
2549  27Jan21 NoCat	3	.MAIN FLOOR: EXTENDED HEIGHT ARCHWAY (PRICE PER DOORWAY) - 96"
2549  27Jan21 NoCat	4	.MAIN FLOOR: STANDARD DOOR EXTENDED HEIGHT 96" (PRICE PER DOOR) MAIN FLOOR 3 STOREY MODELS
2622  11Mar21 NoCat	1	MAIN STAIRS: STAIN STAIRS
2622  11Mar21 NoCat	1	MASTER ENSUITE: UPGRADE TO FREE STANDING TUB - MIROLIN 'BROOKE'
2622  11Mar21 NoCat	1	FYI - MAIN STAIRS: EUROLINE 0 PICKETS + SQUARE NEWELL POSTS + STANDARD HAND RAIL

PLUMBING

Invoice	Qty.	Description
2549 28,894 27Jan21	1	ROUGH-IN - 3PC BASEMENT ROUGH-IN  INCLUDED IN APS
2622  11Mar21 NoCat	1	KITCHEN: UPGRADE SINK TO BLANCO QATRUS R15 U SUPER SINGLE
2622 28,898 11Mar21	1	MASTER ENSUITE: UPGRADE TO FREE STANDING TUB - MIROLIN 'BROOKE'



CONSTRUCTION SUMMARY

Lot: BLOCK 160  
Model: 38-6 Elev.B SCARLATTI OPT- GFA1  
Project/Phase: Brampton Encore / 2

STAIRS AND RAILINGS

Invoice	Qty.	Description
2622  11Mar21 NoCat	1	MAIN STAIRS: EUROLINE 0 PICKETS + SQUARE NEWELL POSTS + STANDARD HAND RAIL

WINDOWS - BASEMENT

Invoice	Qty.	Description
2549 28,916 27Jan21	4	BASEMENT WINDOWS - UPGRADE EXISTING BASEMENT WINDOW TO 30 INCH X 24 INCH - MAY REQUIRE INSTALLATION OF WINDOW WELL

WINDOWS AND DOORS

Invoice	Qty.	Description
2549 28,841 27Jan21 **	1	SIDE DOOR- HOME TO EXTERIOR- AS PER PLAN AND GRADE PERMITTING  INCLUDED IN APS
2549 28,842 27Jan21 **	1	MANDOOR - GARAGE TO HOUSE- AS PER PLAN AND GRADE PERMITING  INCLUDED IN APS
2549  27Jan21 NoCat	1	.SIDE DOOR- HOME TO EXTERIOR- AS PER PLAN AND GRADE PERMITTING  Included in APS



Scheduled Closing Date:

Purchaser: Inventory Lot\_BLOCK 160

Property: BLOCK 160

Telephone Res. / Bus: (905) 760-9595

Project: Brampton Encore - Phase 2

Decor Advisor: Yolande Somerville

Model and Elevation: 38-6 Elev.B SCARLATTI OPT- GFA1

Layout Changes: ☐ Yes ☒ NoSketch Attached: ☒ Yes ☐ No

Exterior Colour Scheme:

## 1. Cabinetry

	Style and Colour	Counter	Hardware
Kitchen / Breakfast	*Florentine oak 'Slate'	*Quartz: Misty Carrara	*CH-45
Laundry Room	n/a	n/a	n/a
Powder Room	n/a	n/a	n/a
Ground Floor Bath	Varese pvc 'White Crystal'	P-Lam #6698-46	cs1-23
Master Ensuite Bathroom	Siena oak 'Greystone'	P-Lam #4971-52	cs1-24
Second Ensuite Bathroom (If Applicable)	Siena oak 'Slate'	P-Lam #6698-46	cs1-23
Shared Ensuite	Siena oak 'Slate'	P-Lam #6698-46	cs1-23

Comment

## 2. Floor Tile

	Selection
Entrance Vestibule	*12x24" Eterna polished 'Imperial Grey'
Main Hall	
Kitchen / Breakfast	see hardwood
Laundry Room	13x13" New Reeds 'Taupe'
Powder Room	*12x24" Eterna polished 'Imperial Grey'
Ground Floor Bath	13x13" Costa matte 'White'
Master Ensuite Bathroom	*12x24" Eterna polished 'Imperial Grey'
Second Ensuite Bathroom (If Applicable)	13x13" Costa matte 'White'
Lower Landing (If Applicable)	*12x24" Eterna polished 'Imperial Grey'
Shared Bath	13x13" New Reeds 'Taupe'

Comment

## 3. Wall Tile

	Selection	Listello/Inserts	Describe
Ground Floor Bath	8x10" Weave 'White'	<input type="radio"/> Yes <input checked="" type="radio"/> No	
Master Ensuite Bathroom			
Tub Deck		<input type="radio"/> Yes <input checked="" type="radio"/> No	
Shower Stall	*12x24" Eterna pol 'Imperial Grey'	<input type="radio"/> Yes <input checked="" type="radio"/> No	
Bathroom Walls		<input type="radio"/> Yes <input checked="" type="radio"/> No	
Second Ensuite Bathroom (If Applicable)	8x10" Weave 'White'	<input type="radio"/> Yes <input checked="" type="radio"/> No	
Shared Bath	8x10" Weave 'Tender Grey'	<input type="radio"/> Yes <input checked="" type="radio"/> No	
Kitchen Backsplash	<input checked="" type="radio"/> Yes <input type="radio"/> No	Backsplash Behind Fridge	
	*FHBS slab - same as counter		

Comment



Scheduled Closing Date:

Purchaser: Inventory Lot\_BLOCK 160

Property: BLOCK 160

Telephone Res. / Bus: (905) 760-9595

Project: Brampton Encore - Phase 2

Decor Advisor: Yolande Somerville

Model and Elevation: 38-6 Elev.B SCARLATTI OPT- GFA1

### 4. Plumbing Fixtures

Master Ensuite Bathroom  Second Ensuite  Powder Room   
 Other Room - Specify  Other Washroom

Comment

See extras

### 5. Hardwood Flooring

	Type and Stain		Type and Stain
Main Hall	<input type="text"/>	Upper Landing	<input type="text"/>
Kitchen / Breakfast	*3/4x5" wht oak wirebrush 'Atlantis'	Upper Hall	*3/4x5" wht oak wirebrush 'Atlantis'
Living Room	<input type="text"/>	Master Bedroom	<input type="text"/>
Dining Room	<input type="text"/>	Bedroom #2	<input type="text"/>
Family Room	<input type="text"/>	Bedroom #3	<input type="text"/>
Den/Library	<input type="text"/>	Bedroom #4	<input type="text"/>
Entrance Vestibule	<input type="text"/>	Bedroom #5	<input type="text"/>
Lower Landing (If Applicable)	<input type="text"/>	Other Room - Specify	<input type="text"/>
		Thru out standard areas	*3/4x5" wht oak wirebrush 'Atlantis'

Comment

### 6. Carpeting

	Upgrade	Description
Ground Floor	<input type="checkbox"/>	Std: 4002-20 with std u/pad
Second Floor	<input type="checkbox"/>	Std: 4002-20 with std u/pad
<input type="text"/>	<input type="checkbox"/>	<input type="text"/>

	Type	Area
Upgrade Underpad	<input type="text"/>	<input type="text"/>
Carpet on Stairs	Capped <input type="text"/>	Runner - *Upgrade <input type="text"/>

Comment

### 7. Fireplace

	Living Room			Family Room			Other Room - Specify		
	Purchased	As Per Plan	N/A	Purchased	As Per Plan	N/A	Purchased	As Per Plan	N/A
Fireplace Type	<input type="radio"/>	<input type="radio"/>	<input checked="" type="radio"/>	<input type="radio"/>	<input checked="" type="radio"/>	<input type="radio"/>	<input type="radio"/>	<input type="radio"/>	<input checked="" type="radio"/>
Mantle Type	<input type="text"/>			Standard Gas			<input type="text"/>		
Colour / Stain	<input type="text"/>			NF-23			<input type="text"/>		
Surround	<input type="text"/>			White			<input type="text"/>		
Hearth	<input type="text"/>			Nero Marquina			<input type="text"/>		
	<input type="text"/>			none			<input type="text"/>		

Comment

Scheduled Closing Date:

Purchaser: Inventory Lot\_BLOCK 160

Property: BLOCK 160

Telephone Res. / Bus: (905) 760-9595

Project: Brampton Encore - Phase 2

Decor Advisor: Yolande Somerville

Model and Elevation: 38-6 Elev.B SCARLATTI OPT- GFA1

## 8. Trim Carpentry

Interior Doors \*Standard Front Door Glass Inserts Standard Door Handles Standard

Interior Trim Standard Package

Comment

## 9. Plaster Mouldings and Medallions

Standard Throughout ☐ Yes ☐ No ☒ N/A

Entrance Vestibule			Kitchen/Breakfast		
Main Hall			Den/Library		
Living Room			Lower Landing		
Dining Room			Other Room - Specify		
Family Room					

Comment

## 10. Railings and Spindles

Railing Package \*Euroline 0 with standard hand rail + square Newell posts

Railing Colour \*Graphite

Stringer / Riser \*Graphite

Spindle Colour \*Black

Treads \*Graphite

Comment

Oak Stairs ☒ Yes ☐ No ☐ N/A

## 11. Wall Paint / Ceilings

Throughout Finished Areas Warm Grey

Trim Paint White

Smooth Ceilings

Ground Floor ☐Second Floor ☐

Note Standard smooth ceiling on Main Floor

Comment

Scheduled Closing Date:

Purchaser: Inventory Lot\_BLOCK 160

Property: BLOCK 160

Telephone Res. / Bus: (905) 760-9595

Project: Brampton Encore - Phase 2

Decor Advisor: Yolande Somerville

Model and Elevation: 38-6 Elev.B SCARLATTI OPT- GFA1

## 12. Electrical

Hood Fan ☐ White ☐ Stainless ☐ N/A

Above Kitchen Cabinet Light ☐ Yes ☒ No

Below Kitchen Cabinet Light ☐ Yes ☒ No

Standard Appliances ☐

Over The Range Microwave ☐

Chimney Style Fan ☐

Comment

## 13. Heating and Air Conditioning

Air Conditioning

Gas Provisions Stove

Gas Provisions Dryer

Gas Provisions Barbecue

Comment

## 14. Additional Comments

## 15. Disclaimers and Notes

- 1) Colours of all materials are as close as possible to builder's selection, but not necessarily identical due to variances in manufacturing.
- 2) Any extras listed above are null and void unless accompanied by a separate invoice/amendment. Said invoice must be paid in full.
- 3) The Purchaser acknowledges that after Interior Colour Selection form is signed and dated, no further changes will be permitted other than re-selection due to unavailability. \_\_\_\_\_ Purchaser's Initials
- 4) The Purchaser acknowledges reading and accepting the "Gold Park Homes Decor Centre Disclaimers" form. This document contains other miscellaneous disclaimers.

This Interior Colour Selection is final and approved by:

Signature: \_\_\_\_\_ Date: \_\_\_\_\_



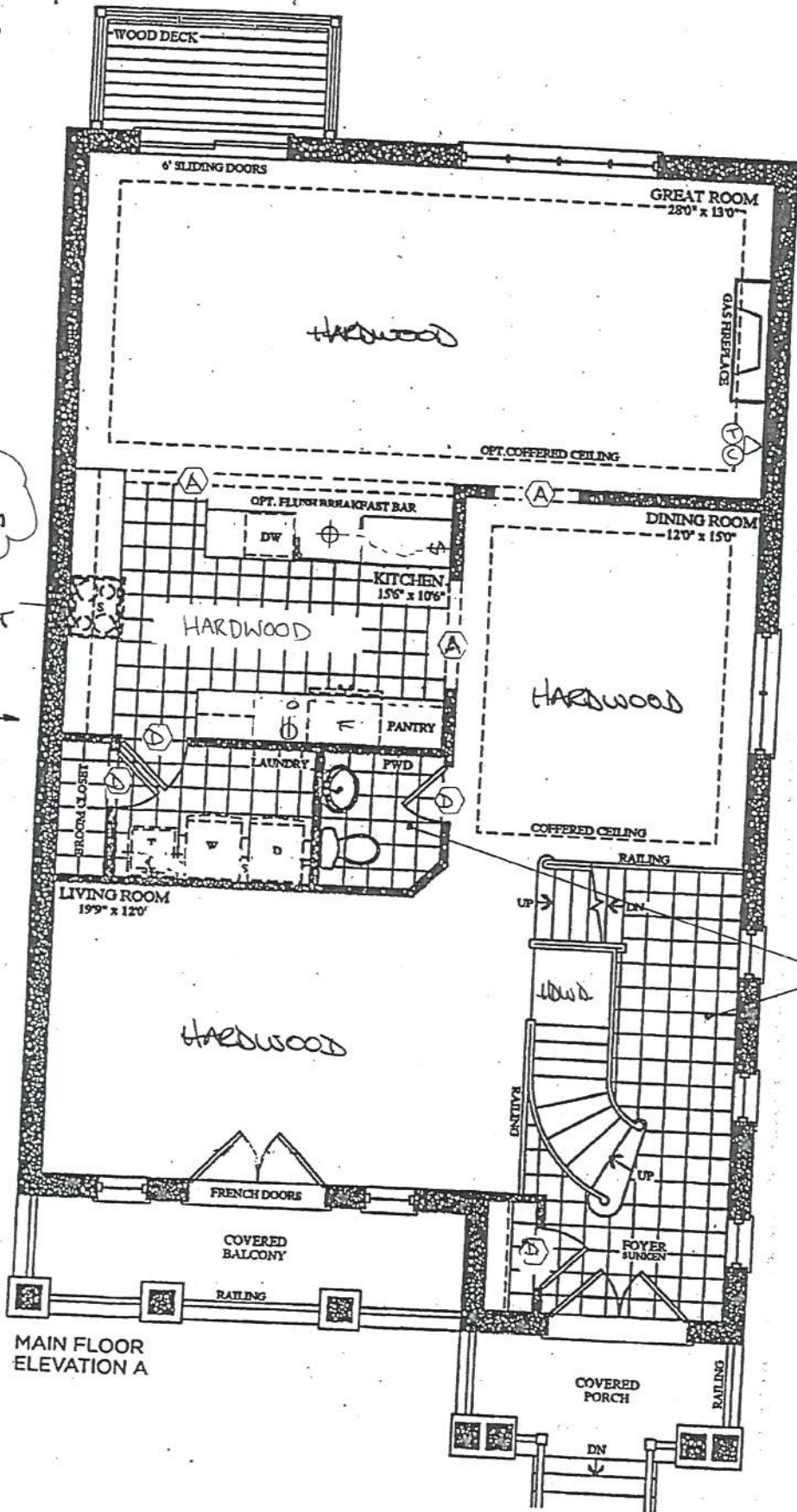

MAIN FLOOR  
ELEVATION A

BF2-160  
JAN. 8 2021

REVISED:  
MARCH 10 2021

# The Scarlatti

Elevation A • 3,591 sq.ft.

Elevation B • 3,578 sq.ft.

Pricing, figures, illustrations, sizes, features and finishes are subject to change without notice. E.A.O.E. Areas and dimensions are approximate and actual usable floor space may vary from the stated area. Layout may be reverse of the unit purchased. E. & O.E.

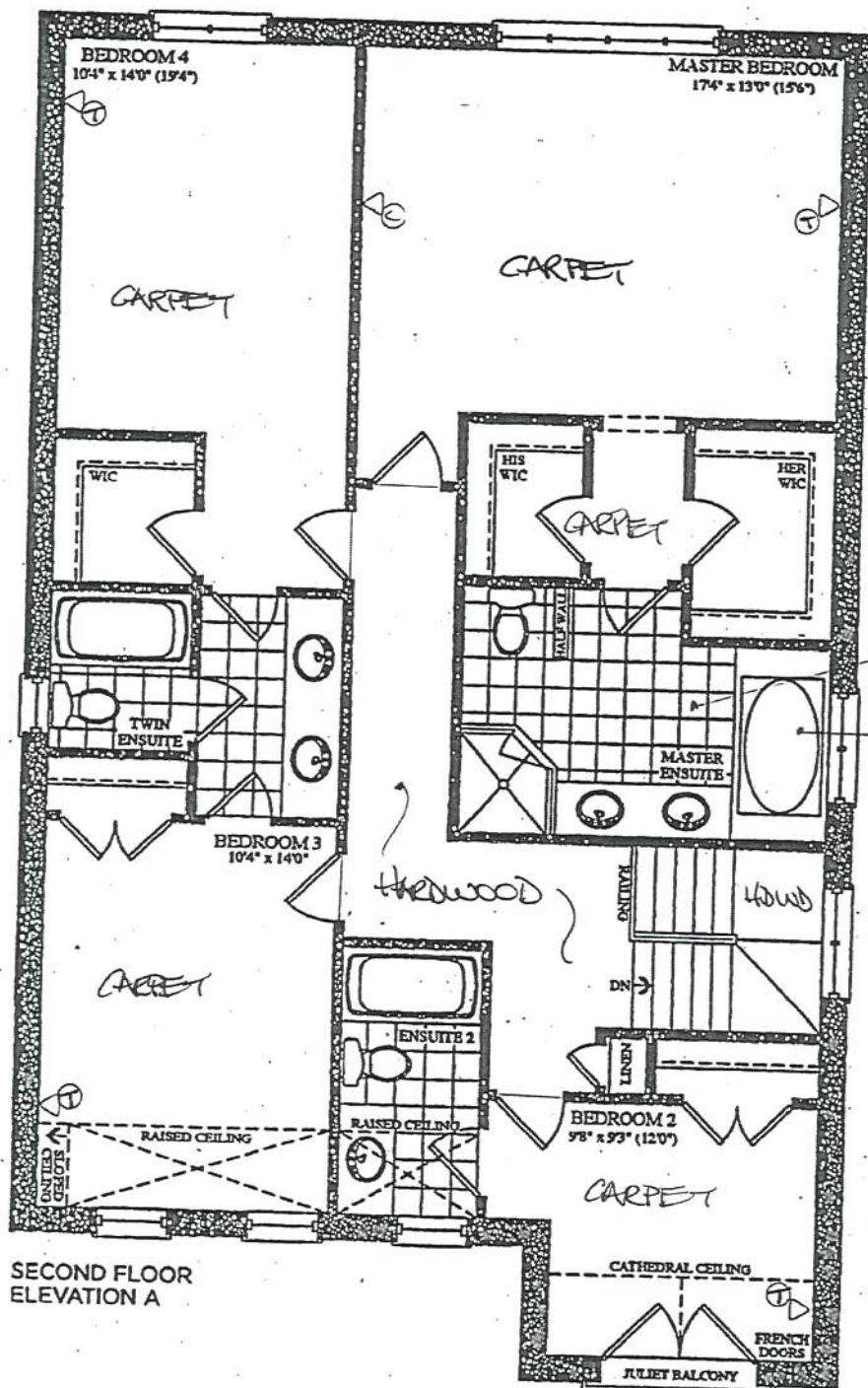

SECOND FLOOR  
ELEVATION A

BEZ-160  
JAN 8 2021

REVISED:  
MAR 10 2021

# The Scarlatti

Elevation A • 3,591 sq.ft. Elevation B • 3,578 sq.ft.

Prices, figures, illustrations, sizes, features and finishes are subject to change without notice. E.A.O.E. Areas and dimensions are approximate and actual usable floor space may vary from the stated area. Layout may be reverse of the unit purchased. E. & O.E.

BE2-160  
JAN 8 2021

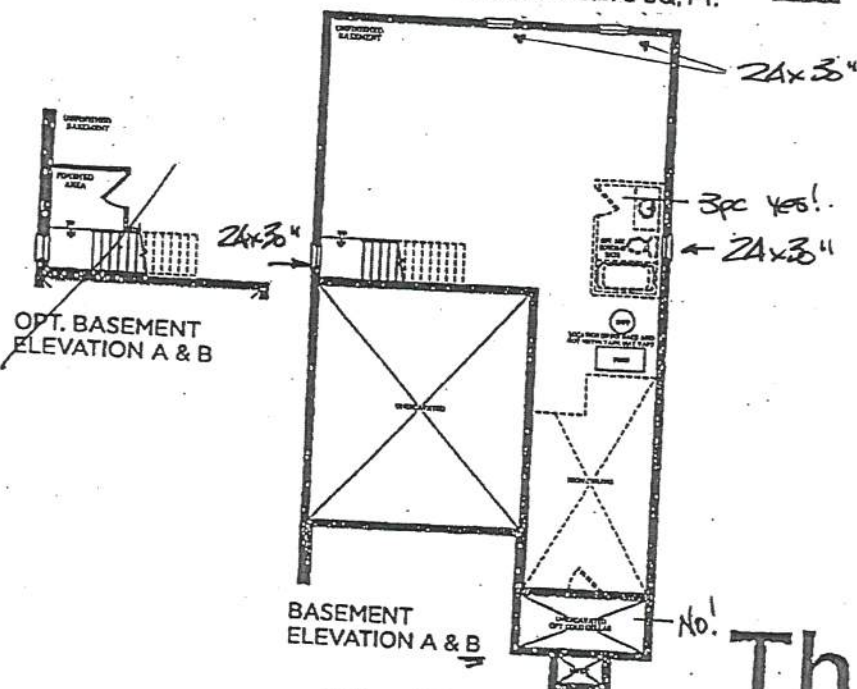
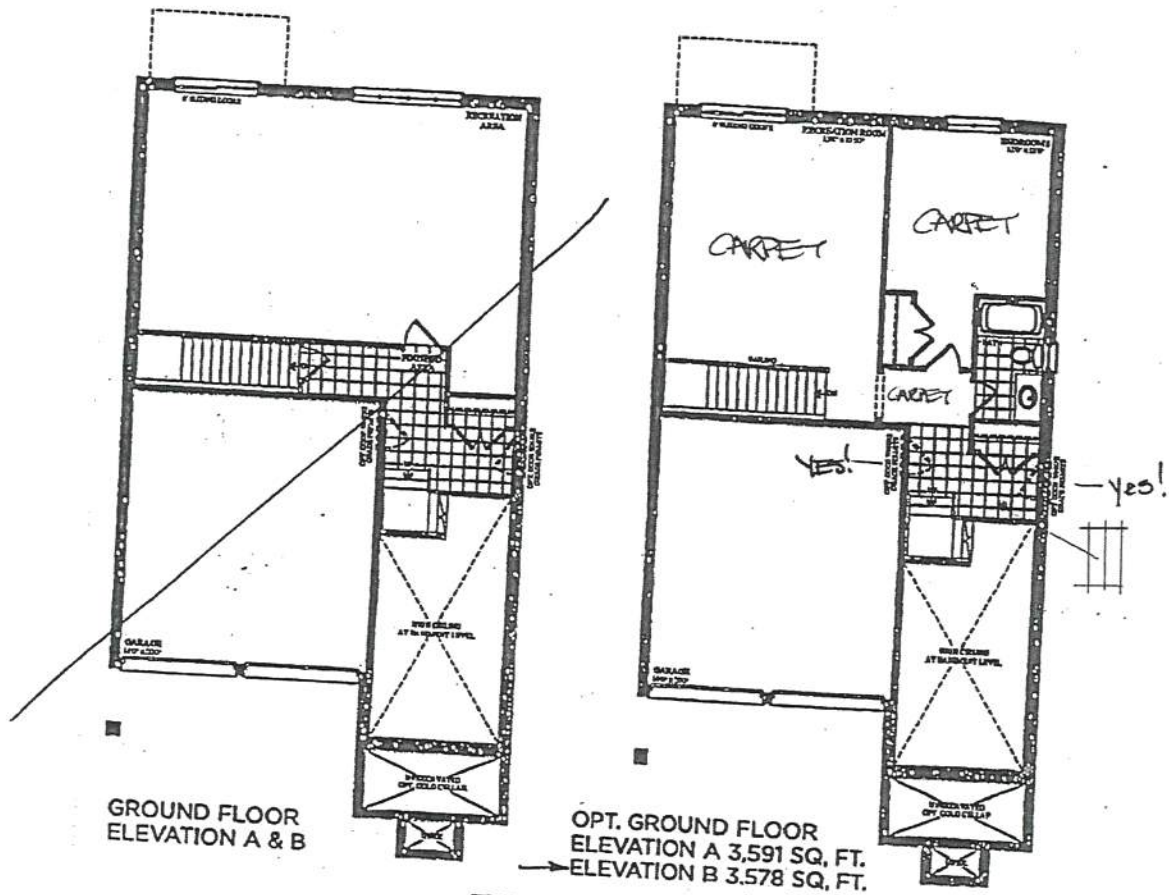

# The Scarlatti

Elevation A • 3,591 sq.ft. Elevation B • 3,578 sq.ft.

Prices, figures, illustrations, sizes, features and finishes are subject to change without notice. E&O.E. Areas and dimensions are approximate and actual usable floor space may vary from the stated area. Layout may be reverse of the unit purchased. E. & O.E.



BE2-160  
MARCH 10 2021

QUOTATION

Date: 06/23/16

Trade Name: Gold Park Homes

Site location: Brampton

Model: 38-6

Address:

Project: Encore

Phase:

This layout has been explained to the purchaser by Cortina Kitchens Inc. and is understood by the purchaser.

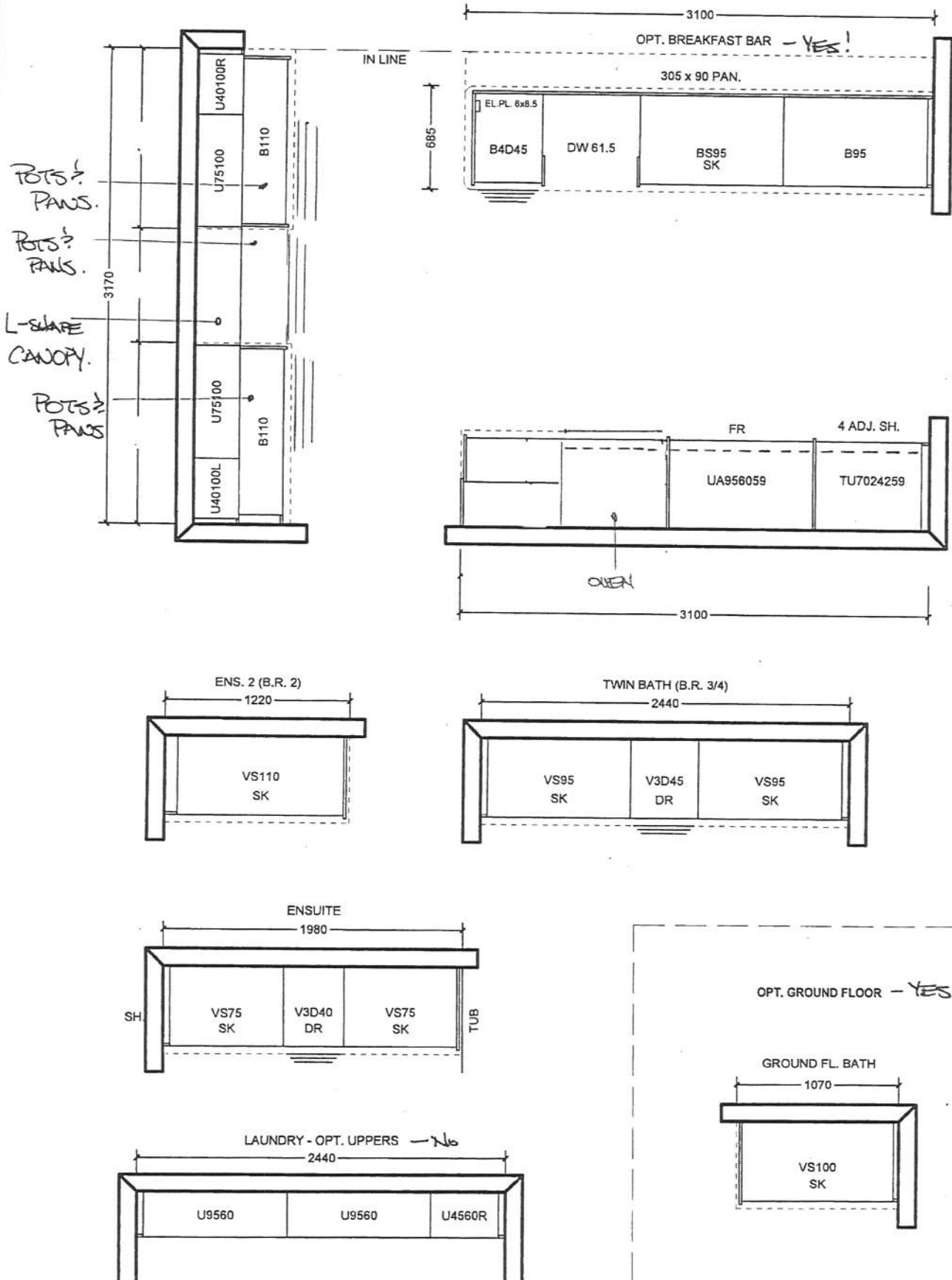

All prices subject to confirmation from head office.  
This quotation is subject to the terms & conditions set out  
in Cortina's Agreement of Purchase and Sale

All agreements are contingent upon strikes, accidents, and delay beyond our control.  
Please provide our installer with template for sinkholes or \$150.00 will be charged for callback.

ACCEPTED DATE: \_\_\_\_\_

\_\_\_\_\_  
CUSTOMER SIGNATURE

\_\_\_\_\_  
SALESPERSON SIGNATURE

\_\_\_\_\_  
CORTINA HEAD OFFICE APPROVAL

ITEM A. Wood grain and colour are characteristics of the product, we cannot guarantee that such grain and colour will always match  
ITEM B. Cortina Kitchens reserves the right to alter dimensions and make technical changes without notice.

BE2-1160

March 10, 2021



20mm 1 3/4" Profiles

Kitchen

30mm 1 3/4" Profiles

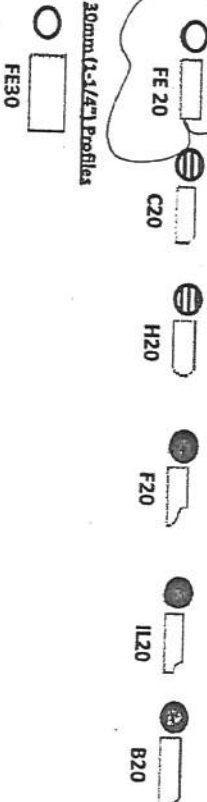

40mm 1 3/4" Profiles

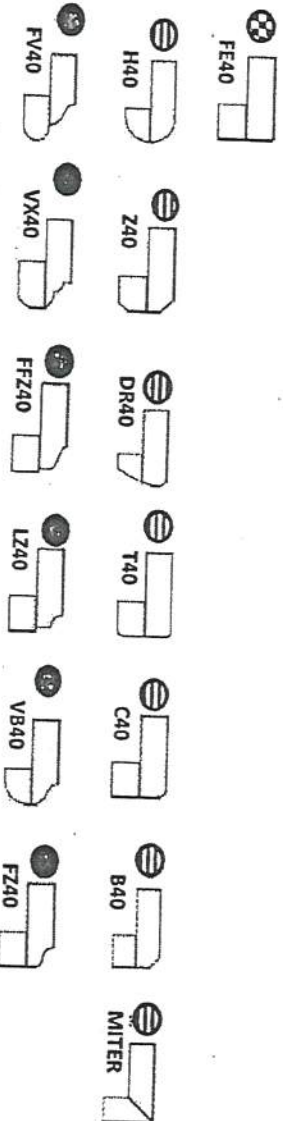

Note: All colours may not be available in 30mm at time ordered. Vendor reserves the right to use 40 mm edges (by lamination process).

\*Mitre edge is available in Upgrade 1 for an overall thickness of 2". All other Mitre edge options will be an Upgrade 2 Edge.



# ARTINA STANDARD HARDWARE

B62-160  
March 10, 2021

MODIFIED: 19/05/18

STANDARD HARDWARE



CSI-6



CSI-10



CSI-14



CSI-16



CSI-18

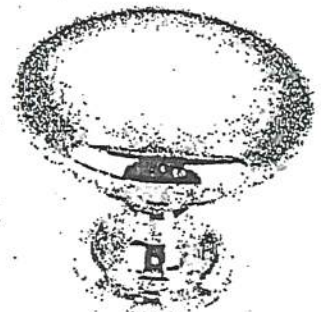

CSI-19



CSI-20

1. Ground Floor Bath
2. Ensuite 2
3. Shared Ensuite



CSI-21



CSI-22



CSI-23

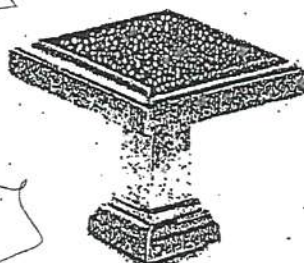

CSI-24

Master Ensuite

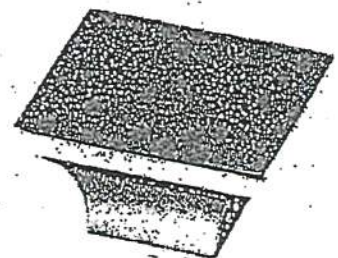

CSI-25

## \*NOTES:

- IMAGES ARE FOR QUICK REFERENCE PURPOSES ONLY
- ACTUAL SIZES AND FINISHES AS PER HARDWARE SAMPLE BOARD PROVIDED TO DECOR CENTRE





CH-32



CH-38

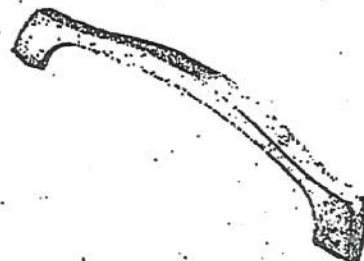

CH-44

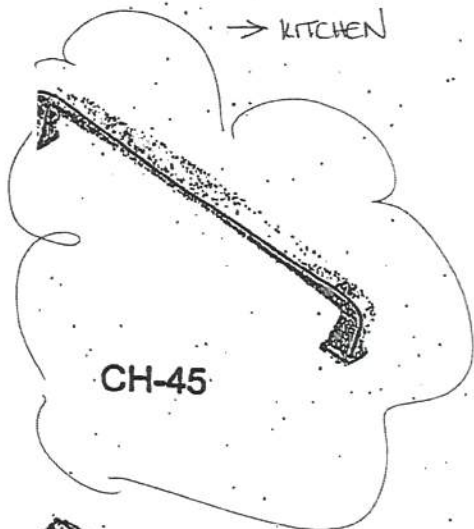

CH-45

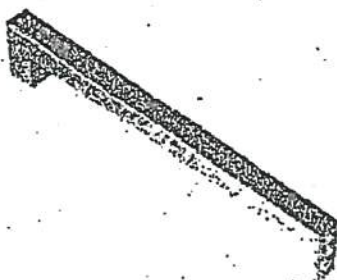

CH-46

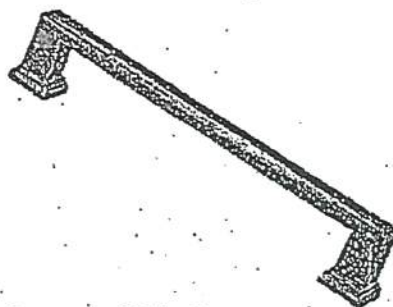

CH-47

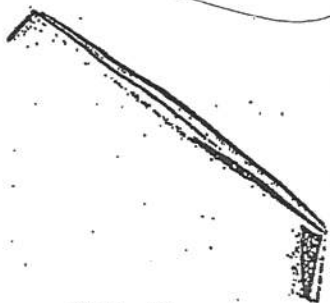

CH-48



CH-49

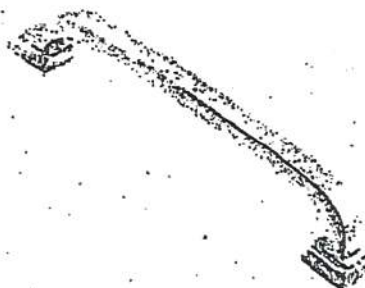

CH-50

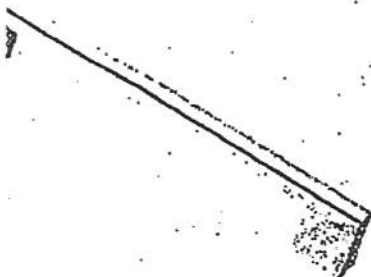

CH-51

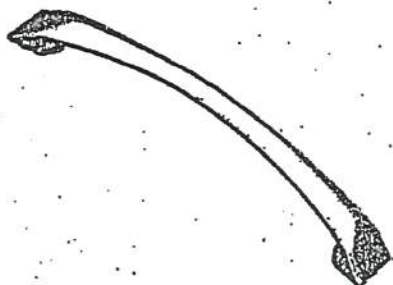

CH-52

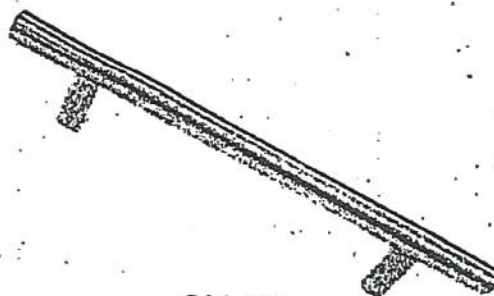

CH-53

### NOTES:

IMAGES ARE FOR QUICK REFERENCE PURPOSES ONLY  
ACTUAL SIZES AND FINISHES AS PER HARDWARE  
SAMPLE BOARD PROVIDED TO DECOR CENTRE

UPGRADE KITCHEN SINK



BLANCO - QUATRUS R15 U SUPER SINGLE

Stainless Steel - Undermount  
32" x 18" x 9"

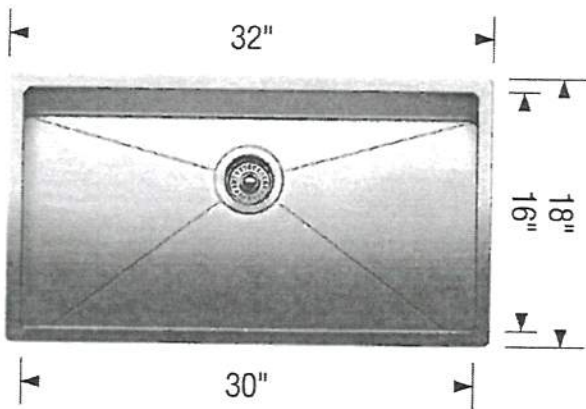
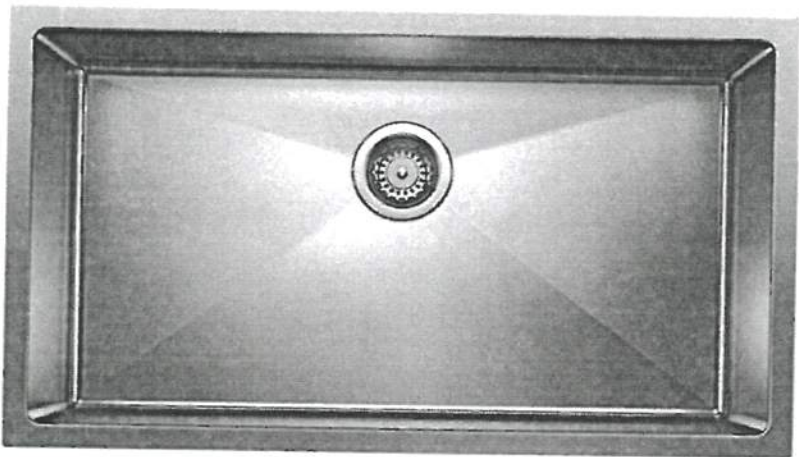

Stainless Steel

MODEL 401518 Stainless Steel

Lot# 160	Date: March 10, 2021	Room: kitchen
Signature:		
Signature:		

UPGRADE TUB



MIROLIN - BROOKE  
Freestanding Tub  
68" x 36"  
CF2002

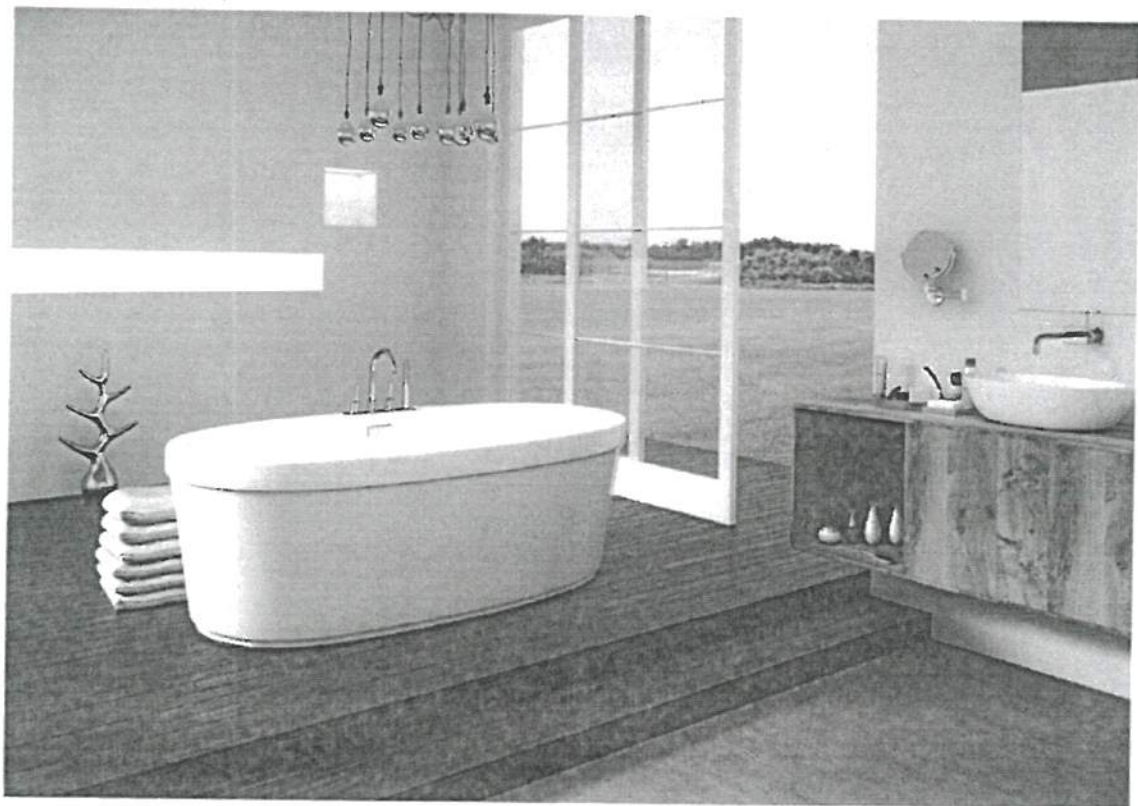

Lot#

160

Date:

March 10, 2021

Room:

Master Ensuite

Signature:

Signature:





**BATHROOM ACCESSORIES**

PROJECT: ENCORE 2

LOT: 160

---

---

INSTALL STANDARD BATHROOM ACCESSORIES  
THRU OUT (TOWEL BAR, SOAP DISH, TISSUE  
HOLDER) \*\*location as per vendors discretion



**DO \*NOT\*** INSTALL STANDARD BATHROOM  
ACCESSORIES THRU OUT (TOWEL BAR, SOAP  
DISH, TISSUE HOLDER)



SIGNATURE: \_\_\_\_\_

SIGNATURE: \_\_\_\_\_

DATE: March 10, 2021

# 800 Series Combination Oven

## 30" Stainless steel

### HBL87M53UC

★★★★☆ 4.0

61 Review

**\$ 5,079.00**

Price shown includes rebates, where applicable. Dealer may sell for less.

☐ Add to product compare

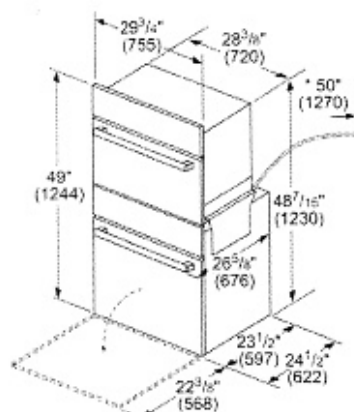

\* Power cable 50" (1270 mm) from the lower oven.

measurements in inches (mm)

## Technical information and characteristics

**Installation Type:** Built-in

**Height of the product (mm):** 1,244 mm

**Width of the product (mm):** 755 mm

**Watts (W):** 7,975 W

Bosch microwave combination ovens create an all-in-one cooking center with an upper microwave and a Genuine European Convection oven below

## Reviews

Reviews

## Specifications

Specifications

## Design

- Bosch wall ovens can be installed flush for a sleek timeless design, or proud for a more traditional look
- Touch control with SteelTouch™ buttons makes operating the oven easier
- Bosch wall ovens are compatible with most existing cutouts

## Performance

- Lower oven's convection multi-rack mode gives uniform baking results even when using all 3 racks simultaneously
- Family or guests late to dinner? Keep food warm in the lower oven without overcooking until ready to serve by using the warm mode
- Lower oven's proof mode maintains a low temperature to proof yeast doughs for an even and faster rise compared to being left on the countertop
- Closed-door broiling prevents intense heat from escaping the lower oven - offering rich, even browning on tender cuts of meat and perfectly toasted casseroles
- Lower oven comes with 2 standard racks and 1 telescopic rack that gives easier accessibility for large or heavy dishes
- Dampened hinges softly guide the lower oven's QuietClose door shut. It's premium engineering that you'll



appreciate each time you close your oven

Efficiency

- Download Bosch Home Connect application and control the lower wall oven with your smart phone or tablet

Convenience

- 1 light in the upper microwave and 2 lights in the lower oven gives visibility in the cavity so you can see the cooking progress
- Large oven window lets you monitor the cooking progress without opening the oven door to maintain a consistent oven temperature
- Keep your home safe by avoiding accidental or unsupervised use of your wall oven with the panel lock feature

Capacity

- With capacities of 1.6 cu. ft upper microwave and 4.6 cu. ft. lower oven allows enough space to cook everyday meals or for a crowd

Technical Specifications

— General

Cooking mode	Microwave
Included accessories	1 x oven racks /lower, 1 x temperature probe /lower

+ Connectivity

Home Connect	✓
Home Connect Features	iService Remote, Remote Monitoring and Control
Connectivity type	Wi-Fi

+ Construction type

Product color  
Stainless steel

Construction type  
Built-in

Type of control setting devices  
- oven 1  
Touch Control

Door Material - cavity 1  
Stainless steel

Energy source  
Electric

Installation Type  
Built-in

— Size and weight

Dimensions  
1244 x 755 x 622 mm

Overall appliance dimensions  
(HxWxD) (in)  
49" x 29 3/4" x 24 1/2"

Required cutout size (HxWxD)  
(in)  
48 5/8" x 28 1/2" x 23 1/2"

Net weight (kg)  
148.768 kg

Net weight (lbs)  
328.000 lbs

+ Oven

Display options - cavity 1  
Digital display

T/b heating temperature max.  
(°F)  
450 °F

— Comfort

Included accessories	1 x oven racks /lower, 1 x temperature probe /lower
----------------------	---

Are some hobs controls integrated?	—
------------------------------------	---

--- Connection

Power cord length (cm)	127.0 cm
------------------------	----------

Power cord length (in)	50"
------------------------	-----

Fuse protection (A)	40 A
---------------------	------

Watts (W)	7,975 W
-----------	---------

Plug type	no plug
-----------	---------

Volts (V)	208-240 V
-----------	-----------

## Accessories

# Accessories

### 1 Accessories





## Accessories cookers/oven

S

**HEZTR301**  
**- 00798846**

**\$ 389.00**

Taxes not included

Price shown includes  
rebates, where applicable.  
Dealer may sell for less.

● Currently out of  
stock (Usually ships  
after 90 days). For  
appliance  
enquiries, please  
call: 1-800-554-  
9043. For parts and  
accessories, please  
call: 1-877-403-  
3185.

HEZTR301

## Manuals and Downloads

### Use & Care Manual

Here you can download the manual for your home appliance or  
view it on the screen.

 [Interactive User Manual](#)

---

 [Supplemental](#)

---

 [Supplemental](#)

---

 [Supplemental](#)

---

### Download Product

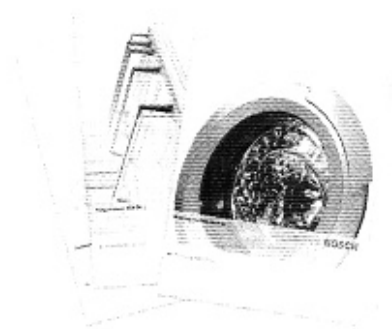

# Information

Technical details and information about all the comfort, efficiency, performance and security features, refer to the product characteristics.

 [Product Spec Sheet](#)

---



# Installation Manual

 [Installation instructions](#)

---

 [Installation instructions](#)

---

# Download CAD Files

[Download CAD Files](#)

---

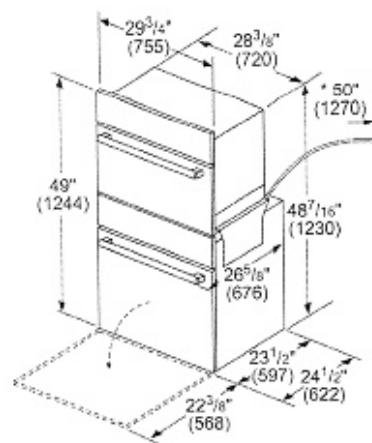

\* Power cable 50" (1270 mm) from the lower oven.

measurements in inches (mm)

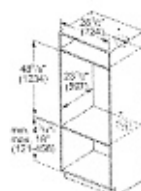

\* Junction box may be installed above, below, or to the left or right of the unit within reach of the power cable.

measurements in inches (mm)

## Free and Open Source Software Info

 Free and Open Source Software Licence



## Our Service

For Customer Service, call:  
1-800-944-2964

For Parts & Accessories, call:  
1-877-403-3185

Buy installation accessories  
online! Click below

[Experience Service >](#)

## Experience Bosch

Discover quality, perfection,  
and reliability.

[This Way >](#)

## Register your product

Register your Bosch  
appliance today to gain  
access to your custom  
dashboard including helpful  
product information, product  
warranty information and  
much more.

[Register Now >](#)

## Where to Buy

Bosch's legendary  
performance and design is  
closer than you think.

Find dealers near you!

[Search Now >](#)

# Benchmark® Gas Cooktop

## 36" Stainless steel

### NGMP656UC

★★★★☆ 4.3

27 Review

**\$ 1,829.00**

Price shown includes rebates, where applicable. Dealer may sell for less.

☐ Add to product compare

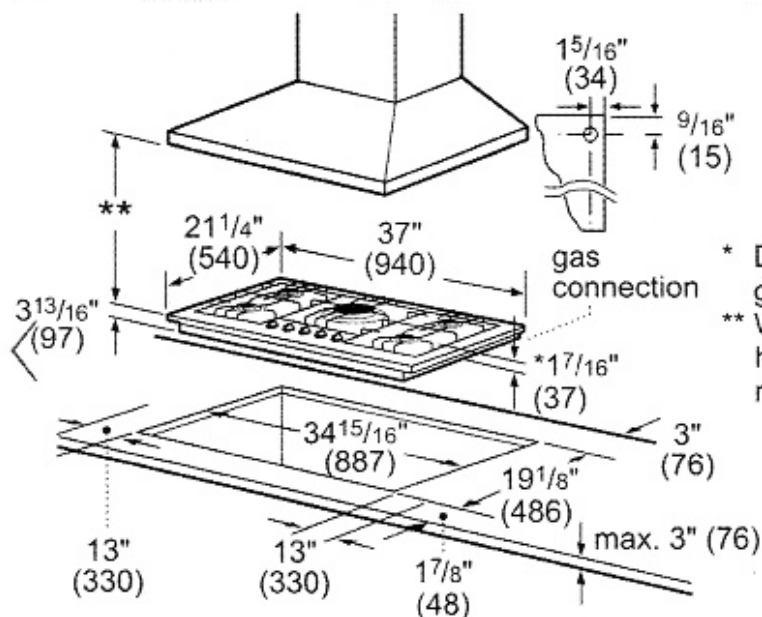

\* Dimension from count  
grates in front of  $17\frac{1}{16}"$   
\*\* When installed in cor  
hood, refer to hood m  
requirements for insta

measuremen

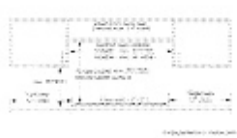
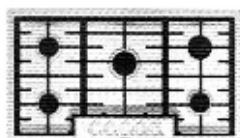

## Technical information and characteristics

**Watts (W):** 360 W

**Type of control:** mechanical

**Width of the product (mm):** 940 mm

**Number of electric cooking zones:** 0

**Energy source:** Gas

The 36" Benchmark® Series gas cooktop features a dual-stacked burner that delivers both a low simmer and high heat flame.

- Continuous Grates Make Moving Heavy Pots Easier
- ⓘ OptiSim® Burner - Simmer Delicate Sauces and Melt Chocolate Without Scorching

## Highlights

### Highlights

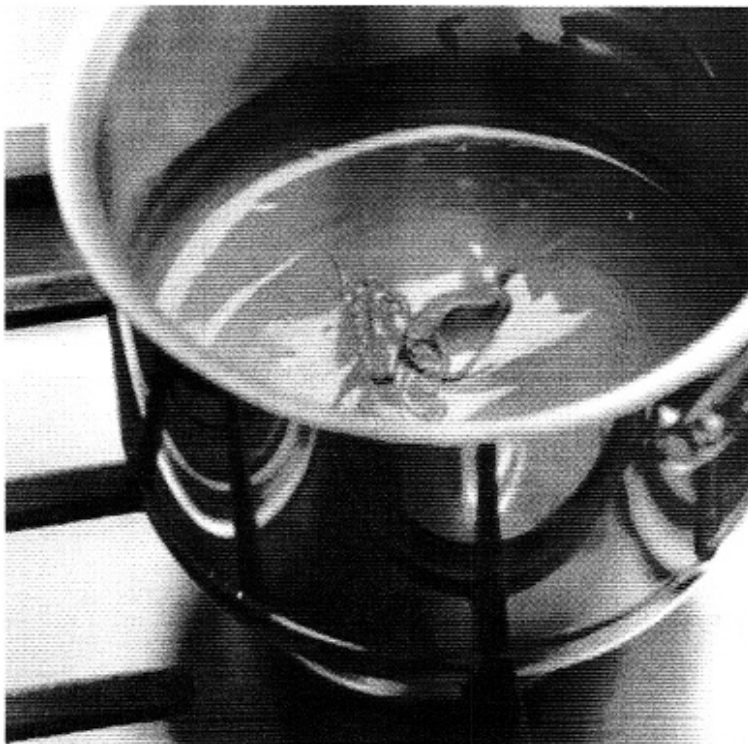

### Better flame control with the OptiSim

The OptiSim® burner cap design is wider and thicker, offering more flame control at the lowest settings so you can simmer delicate sauces and melt chocolate without scorching.

## Reviews

# Reviews

## Specifications

# Specifications

## Technical Specifications

## Performance

- Dual Stacked Burner Delivers Both Low Simmer and Powerful 20,000 BTUs to Speed Boiling Time
- STAR-K Sabbath compliant

## Convenience

- Sealed Burners Prevent Spills from Entering the Burner Box
- Push-to-Turn Knobs
- Automatic Electronic Re-Ignition - In Case Flame Goes Out, the Burner is Automatically Re-Ignited
- Distinctive Red LED Light For Each Knob Indicates Burners Are On
- LP Conversion Kit Included for Conversion from Natural Gas to Liquid Propane

## Design

- Heavy-Duty Metal Knobs for a Premium Look and Feel
- Low-Profile Design for an Integrated Appearance
- Perfect Results are Within Reach With Up-Front Centralized Controls
- Cooktop Design Coordinates with Bosch Ovens and Ventilation

## Technical Specifications

+ General

Energy source

Gas



Type of control	sword knobs
Safety device	Without safety
+ Connectivity	
Home Connect	—
--- Size and weight	
Dimensions	97 x 940 x 540 mm
Overall appliance dimensions (HxWxD) (in)	+ 3 13/16" x 37" x 21 1/4"
Net weight (kg)	20.933 kg
Net weight (lbs)	46.000 lbs
Minimum distance from counter front (in)	1 7/8"
Minimum distance from rear wall (in)	3"
+ Cooking zone 1	
Location of 1st heating element	front left
Type of heating element	Gas
+ Cooking zone 2	
Location of 2nd heating element	center left

+ Cooking zone 3

Location of 3rd heating element	back left
---------------------------------	-----------

Type of 3rd heating element	Gas
-----------------------------	-----

+ Cooking zone 4

Location of 4th heating element	middle back
---------------------------------	-------------

+ Cooking zone 5

Location of 5th heating element	back right
---------------------------------	------------

Type of 5th heating element	Gas
-----------------------------	-----

+ Cooking zone 6

Location of 6th heating element	center right
---------------------------------	--------------

+ Cooking zone 7

Location of 7th heating element	front right
---------------------------------	-------------

Type of 7th heating element	Gas
-----------------------------	-----

+ Cooking zone 8

Location of 8th heating element	front middle / central
---------------------------------	------------------------

+ Cooking zone 9

Location of 9th heating element	front centre/cent
---------------------------------	-------------------

+ Construction type

Color of frame	Stainless steel
----------------	-----------------

Color of surface	Stainless steel
------------------	-----------------

Construction type	Built-in
-------------------	----------

Number of electric elements	0
-----------------------------	---

Number of electric cooking zones	0
----------------------------------	---

Number of gas burners	5
-----------------------	---

Number of halogen elements	0
----------------------------	---

Installation Type	Built-in
-------------------	----------

Type of grate	Cast iron
---------------	-----------

Total number of cooktop burners	5
---------------------------------	---

Number of radiant elements	0
----------------------------	---

Number of electric warming zones	0
----------------------------------	---

+ Safety

Type of safety device for gas	Without
Power on indicator	✓
Residual heat indicator	without
Safety device	Without safety
Main on/off switch	—

+ Connection

Location of gas connection	bottom, rear, right
Gas connection rating (W)	17,440 W
Frequency (Hz)	60 Hz
Energy source	Gas
Power cord length (cm)	152 cm
Power cord length (in)	60"
Watts (W)	360 W

+ Accessories

Included accessories	1 x nozzle set for liquid gas, 1 x cast iron pan support
----------------------	--



## Accessories

# Accessories

### 2 Accessories



Wok ring

**HEZ298102**

**- 00484128**

**\$ 135.00**

Taxes not included

Price shown includes rebates, where applicable.  
Dealer may sell for less.

● In Stock (Usually ships within 90 business days)



Magnetic knob

**HEZ27751**

**- 10008837**

**\$ 189.00**

Taxes not included

Price shown includes rebates, where applicable.  
Dealer may sell for less.

● Currently out of stock (Usually ships after 90 days). For appliance enquiries, please call: 1-800-554-9043. For parts and accessories, please call: 1-877-403-3185.

## Manuals and Downloads

### Use & Care Manual

Here you can download the manual for your home appliance or view it on the screen.

 [Interactive User Manual](#)

---

 [Supplemental](#)

---

### Download Product Information

Technical details and information about all the comfort, efficiency, performance and security features, refer to the product characteristics.

 [Product Spec Sheet](#)

---

### Installation Manual

 [Installation Instructions](#)

---

 [Installation Instructions](#)

---

 [Installation Instructions](#)

---

### Download CAD Files

[Download CAD Files](#)

---

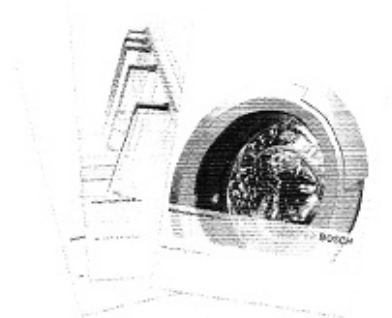

# Dimensional Drawings

Zip all images

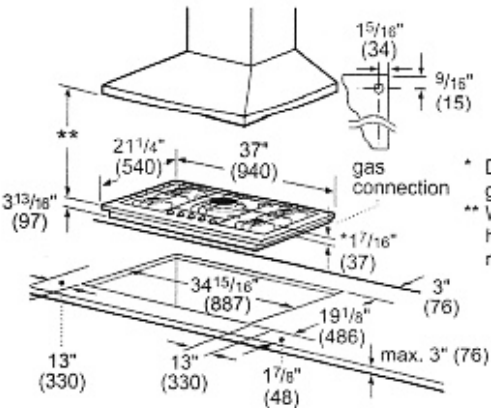

- \* Dimension from countertop to top of grates in front of 1 7/16" (37).
- \*\* When installed in combination with a hood, refer to hood manufacturer's requirements for installation.

measurement in inches (mm)

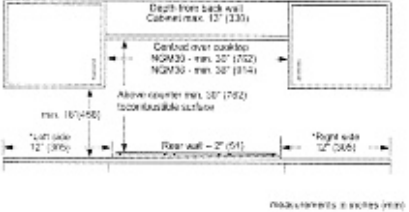
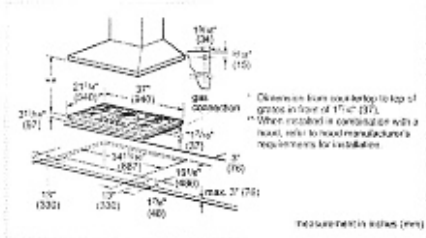

## Our Service

For Customer Service, call:  
1-800-944-2904

For Parts & Accessories, call:  
1-877-403-2185

Buy installation accessories  
online! Click below

[Experience Service >](#)

## Experience Bosch

Discover quality, perfection,  
and reliability.

[This Way >](#)

## Register your product

Register your Bosch  
appliance today to gain  
access to your custom  
dashboard including helpful  
product information, product  
warranty information and  
much more.

[Register Now >](#)

## Where to Buy

Bosch's legendary  
performance and design is  
closer than you think.

Find dealers near you!

[Search Now >](#)