



CONSTRUCTION SUMMARY

Lot: 4
Model: 42.03 B FORESTCREST
Project/Phase: Pine Valley Forevergreen / 1

APPLIANCES

Invoice	Qty.	Description
2787 31May21 NoCat	1	KITCHEN: APPLIANCE SPECIFICATIONS ATTACHED - SIGNED COPY

BASEMENT WINDOWS

Invoice	Qty.	Description
2480 72,351 20Oct20 **	3	BASEMENT WINDOWS - UPGRADE BASEMENT WINDOW SIZE TO 30 " X 24" - 8" FRAME

CERAMIC

Invoice	Qty.	Description
2528 13Jan21 NoCat	1	.MASTER ENSUITE: SHOWER NICHE [SHAMPOO SHELF] - COMPLETE WITH MATCHING MARBLE JAMBS ON 4 SIDES, STANDARD TILE, APPROX. 12 X 18 INSTALLED VERTICALLY - SEE PLAN FOR LOCATION
2727 37 27Apr21	1	FOYER: TILE, FLOOR - LEVEL 5 - 24x24" LAID IN STRAIGHT STACKED PATTERN
2727 35 27Apr21	1	POWDER ROOM: TILE, FLOOR - LEVEL 3 - 12x24" LAID IN STRAIGHT STACKED PATTERN - SEE PLAN FOR DIRECTION
2727 35 27Apr21	1	MUD ROOM: TILE, FLOOR - LEVEL 3 - 12x24" LAID IN STRAIGHT STACKED PATTERN - SEE PLAN FOR DIRECTION
2727 35 27Apr21	1	MASTER ENSUITE: TILE, FLOOR , LEVEL 3 - 12X24" LAID IN STRAIGHT, STACKED PATTERN. SEE PLAN FOR TILE DIRECTION
2727 49 27Apr21	1	MASTER ENSUITE: TILE, SHOWER WALL, LEVEL 3 - 12X24" LAID IN HORIZONTAL, STACKED PATTERN.
2727 37 27Apr21	1	KITCHEN: TILE, FLOOR , LEVEL 5 - LEVEL 5 - 24x24" LAID IN STRAIGHT STACKED PATTERN

CONCRETE AND DRAIN

Invoice	Qty.	Description
2480 20Oct20 NoCat	1	BACK-FLOW PREVENTER VALVE



CONSTRUCTION SUMMARY

Lot: 4
Model: 42.03 B FORESTCREST
Project/Phase: Pine Valley Forevergreen / 1

CROWN MOULDING

Invoice	Qty.	Description
2528 13Jan21 NoCat	1	.GREAT ROOM: MODEL OPTIONS 42.03 - GREAT ROOM - OPT. WAFFLE CEILING, BEAM DETAIL AS PER PLAN (8 BOXES) OPTION #1 CTR-B07
2528 13Jan21 NoCat	1	.STUDY: MODEL OPTIONS 42.03 - STUDY - OPT. WAFFLE CEILING, BEAM DETAIL AS PER PLAN (4 BOXES) OPTION #1 CTR-B07



CONSTRUCTION SUMMARY

Lot: 4
Model: 42.03 B FORESTCREST
Project/Phase: Pine Valley Forevergreen / 1

DRYWALL

Invoice	Qty.	Description
2480 72,351 20Oct20 **	3	BASEMENT WINDOWS - UPGRADE BASEMENT WINDOW SIZE TO 30 " X 24" - 8" FRAME
2528 72,484 13Jan21	1	GREAT ROOM: MODEL OPTIONS 42.03 - GREAT ROOM - OPT. COFFERED CEILING AS PER PLAN
2528 72,486 13Jan21	1	GREAT ROOM: MODEL OPTIONS 42.03 - GREAT ROOM - OPT. WAFFLE CEILING, BEAM DETAIL AS PER PLAN (8 BOXES) OPTION #1 CTR-B07
2528 72,498 13Jan21	1	LIVING ROOM: MODEL OPTIONS 42.03 - LIVING ROOM - OPT. COFFERED CEILING AS PER PLAN
2528 72,490 13Jan21	1	GROUND FLOOR HALLWAY: MODEL OPTIONS 42.03 - GROUND FLOOR HALLWAY - OPT. COFFERED CEILING NEAR POWDER ROOM AS PER PLAN
2528 72,487 13Jan21	1	STUDY: MODEL OPTIONS 42.03 - STUDY - OPT. COFFERED CEILING AS PER PLAN
2528 72,489 13Jan21	1	STUDY: MODEL OPTIONS 42.03 - STUDY - OPT. WAFFLE CEILING, BEAM DETAIL AS PER PLAN (4 BOXES) OPTION # 1 CTR-B07
2528 13Jan21 NoCat	1	.MASTER ENSUITE: SHOWER NICHE [SHAMPOO SHELF] - COMPLETE WITH MATCHING MARBLE JAMBS ON 4 SIDES, STANDARD TILE, APPROX. 12 X 18 INSTALLED VERTICALLY - SEE PLAN FOR LOCATION
2528 13Jan21 NoCat	19	.THRU OUT 2ND FLOOR: INCREASE HEIGHT OF DOOR TO 8FT SECOND FLOOR - PER DOOR
2528 13Jan21 NoCat	1	***CUSTOM LAYOUT*** DELETE 'HIS WIC', MAKE ACCESSIBLE FROM BEDROOM 2 // COMBINE SMALL LINEN CLOSET + BEDROOM 2 REACH IN CLOSET TO MAKE 1 LARGER LINEN CLOSET RELOCATE DOORS TO HALL
2528 13Jan21 NoCat	1	BREAKFAST: UPGRADE TO 96" GARDEN DOOR ASSEMBLY



CONSTRUCTION SUMMARY

Lot: 4
Model: 42.03 B FORESTCREST
Project/Phase: Pine Valley Forevergreen / 1

ELECTRICAL

Invoice	Qty.	Description
2480 72,351 20Oct20 **	3	BASEMENT WINDOWS - UPGRADE BASEMENT WINDOW SIZE TO 30 " X 24" - 8" FRAME
2528 72,281 13Jan21	1	GREAT ROOM: INTERIOR WALL OUTLET: ADDITIONAL 110V WALL INTERIOR RECEPTACLE ON EXISTING CIRCUIT FOR WALL MOUNTED TV - LOCATE ABOVE FIREPLACE, APPROX 66" A.F.F.
2528 72,273 13Jan21	1	KITCHEN: 110V WALL RECEPTACLE ON SEPARATE CIRCUIT - GAS FIRED COOKTOP - FOR AUX. EQUIPMENT - NOT A STOVE PLUG
2528 72,282 13Jan21	1	KITCHEN: ADDITIONAL 220V RECEPTACLE ON A SEPARATE CIRCUIT - FOR BUILT-IN WALL OVEN - APPLIANCE NOT INCLUDED - DOES NOT INCLUDE BREAKER THAT IS TO BE INSTALLED BY LICENSED ELECTRICIAN AND ARRANGED BY HOMEOWNER AFTER CLOSING
2528 72,307 13Jan21	1	KITCHEN: FIXTURE: RELOCATE STANDARD CEILING MOUNT FIXTURE - LOCATE APPROX CENTERED ABOVE ISLAND
2528 72,280 13Jan21	1	KITCHEN: CEILING OUTLET: ADDITIONAL REINFORCED CEILING OUTLET - LOCATE APPROX CENTERED ABOVE ISLAND - USE SAME SWITCH AS STANDARD
2528 72,303 13Jan21	1	KITCHEN: FIXTURE: UNDER CABINET FLUORESCENT LIGHT FIXTURES - DOES NOT INCLUDE (AND REQUIRES) LIGHT VALANCE
2528 72,289 13Jan21	6	KITCHEN: 4" E/S LED INTERIOR POT LIGHT - GROUND FLOOR - EACH - INCLUDES 1 SWITCH INCLUDED IN APS
2528 72,278 13Jan21	1	BREAKFAST: ADDITIONAL INTERIOR SWITCH FOR POTLIGHTS
2528 72,289 13Jan21	4	BREAKFAST: 4" E/S LED INTERIOR POT LIGHT - GROUND FLOOR - EACH - SEE PLAN FOR LOCATION
2528 72,289 13Jan21	4	DINING ROOM: 4" E/S LED INTERIOR POT LIGHT - GROUND FLOOR - EACH - SEE PLAN FOR LOCATION
2528 72,278 13Jan21	1	DINING ROOM: ADDITIONAL INTERIOR SWITCH FOR POTLIGHTS
2528 72,289 13Jan21	8	GREAT ROOM: 4" E/S LED INTERIOR POT LIGHT - GROUND FLOOR - EACH - SEE PLAN FOR LOCATION USE STANDARD SWITCH



CONSTRUCTION SUMMARY

Lot: 4
Model: 42.03 B FORESTCREST
Project/Phase: Pine Valley Forevergreen / 1

ELECTRICAL

Invoice	Qty.	Description
2528 72,289 13Jan21	4	STUDY: 4" E/S LED INTERIOR POT LIGHT - GROUND FLOOR - EACH - SEE PLAN FOR LOCATION USE STANDARD SWITCH
2528 72,290 13Jan21	5	UPPER HALL: 4" E/S LED INTERIOR POT LIGHT (INSULATED CEILING) - SECOND FLOOR - EACH - SEE PLAN FOR LOCATION USE STANDARD SWITCHES
2528 72,290 13Jan21	4	LIVING ROOM: 4" E/S LED INTERIOR POT LIGHT (INSULATED CEILING) - SECOND FLOOR - EACH - SEE PLAN FOR LOCATION
2528 72,278 13Jan21	1	LIVING ROOM: ADDITIONAL INTERIOR SWITCH FOR POTLIGHTS
2528 72,290 13Jan21	4	MASTER BEDROOM: 4" E/S LED INTERIOR POT LIGHT (INSULATED CEILING) - SECOND FLOOR - EACH - SEE PLAN FOR LOCATION
2528 72,278 13Jan21	1	MASTER BEDROOM: ADDITIONAL INTERIOR SWITCH FOR POTLIGHTS
2528 72,288 13Jan21	2	MASTER ENSUITE: ROUGH-IN FOR ADDITIONAL WALL SCONCE (1) CAPPED OUTLET ON EXISTING SWITCH - FIXTURE NOT INCLUDED LOCATE AT VANITY, EITHER SIDE OF SINKS-SAME HEIGHT AND SWITCH AS STANDARD VANITY LIGHT
2528 72,280 13Jan21	1	MASTER ENSUITE: CEILING OUTLET: ADDITIONAL REINFORCED CEILING OUTLET - LOCATE APPROX CENTERED ABOVE TUB - USE SAME SWITCH AS VANITY LIGHTS
2528 72,289 13Jan21	7	MAIN HALL: 4" E/S LED INTERIOR POT LIGHT - GROUND FLOOR - EACH USE STANDARD SWITCHES
2528 13Jan21 NoCat	1	.GREAT ROOM: MODEL OPTIONS 42.03 - GREAT ROOM - OPT. WAFFLE CEILING, BEAM DETAIL AS PER PLAN (8 BOXES) OPTION #1 CTR-B07
2528 13Jan21 NoCat	1	.STUDY: MODEL OPTIONS 42.03 - STUDY - OPT. WAFFLE CEILING, BEAM DETAIL AS PER PLAN (4 BOXES) OPTION # 1 CTR-B07
2787 31May21 NoCat	1	KITCHEN: APPLIANCE SPECIFICATIONS ATTACHED - SIGNED COPY



CONSTRUCTION SUMMARY

Lot: 4
Model: 42.03 B FORESTCREST
Project/Phase: Pine Valley Forevergreen / 1

FRAMING

Invoice	Qty.	Description
2528 72,631 13Jan21	1	MASTER ENSUITE: SHOWER NICHE [SHAMPOO SHELF] - COMPLETE WITH MATCHING MARBLE JAMBS ON 4 SIDES, STANDARD TILE, APPROX. 12 X 18 INSTALLED VERTICALLY - SEE PLAN FOR LOCATION
2528 13Jan21 NoCat	1	***CUSTOM LAYOUT*** DELETE 'HIS WIC', MAKE ACCESSIBLE FROM BEDROOM 2 // COMBINE SMALL LINEN CLOSET + BEDROOM 2 REACH IN CLOSET TO MAKE 1 LARGER LINEN CLOSET RELOCATE DOORS TO HALL
2528 13Jan21 NoCat	1	GREAT ROOM: MODEL OPTIONS 42.03 - GREAT ROOM - OPT. COFFERED CEILING AS PER PLAN
2528 13Jan21 NoCat	1	.GREAT ROOM: MODEL OPTIONS 42.03 - GREAT ROOM - OPT. WAFFLE CEILING, BEAM DETAIL AS PER PLAN (8 BOXES) OPTION #1 CTR-B07
2528 13Jan21 NoCat	1	.LIVING ROOM: MODEL OPTIONS 42.03 - LIVING ROOM - OPT. COFFERED CEILING AS PER PLAN
2528 13Jan21 NoCat	1	.GROUND FLOOR HALLWAY: MODEL OPTIONS 42.03 - GROUND FLOOR HALLWAY - OPT. COFFERED CEILING NEAR POWDER ROOM AS PER PLAN
2528 13Jan21 NoCat	1	.STUDY: MODEL OPTIONS 42.03 - STUDY - OPT. COFFERED CEILING AS PER PLAN
2528 13Jan21 NoCat	1	.STUDY: MODEL OPTIONS 42.03 - STUDY - OPT. WAFFLE CEILING, BEAM DETAIL AS PER PLAN (4 BOXES) OPTION # 1 CTR-B07
2528 13Jan21 NoCat	19	THRU OUT 2ND FLOOR: INCREASE HEIGHT OF DOOR TO 8FT SECOND FLOOR - PER DOOR
2528 13Jan21 NoCat	1	BREAKFAST: UPGRADE TO 96" GARDEN DOOR ASSEMBLY



CONSTRUCTION SUMMARY

Lot: 4
Model: 42.03 B FORESTCREST
Project/Phase: Pine Valley Forevergreen / 1

GRANITE MARBLE QUARTZ

Invoice	Qty.	Description
2727 101,930 27Apr21	1	KITCHEN: UPGRADE QUARTZ COUNTERTOP - LEVEL 3
2727 27Apr21 NoCat	1	KITCHEN: COOKTOP CUT OUT

HVAC

Invoice	Qty.	Description
2528 72,224 13Jan21	1	KITCHEN: GAS LINE ROUGH-IN - MAIN FLOOR FOR APPLIANCE - FOR GAS COOKTOP

INTERIOR TRIM AND DOORS

Invoice	Qty.	Description
2528 72,644 13Jan21	19	THRU OUT 2ND FLOOR: INCREASE HEIGHT OF DOOR TO 8FT SECOND FLOOR - PER DOOR
2528 13Jan21 NoCat	1	***CUSTOM LAYOUT*** DELETE 'HIS WIC', MAKE ACCESSIBLE FROM BEDROOM 2 // COMBINE SMALL LINEN CLOSET + BEDROOM 2 REACH IN CLOSET TO MAKE 1 LARGER LINEN CLOSET RELOCATE DOORS TO HALL
2528 13Jan21 NoCat	1	BREAKFAST: UPGRADE TO 96" GARDEN DOOR ASSEMBLY



CONSTRUCTION SUMMARY

Lot: 4
Model: 42.03 B FORESTCREST
Project/Phase: Pine Valley Forevergreen / 1

KITCHEN AND BATH CABINETRY

Invoice	Qty.	Description
2727 101,930 27Apr21	1	THRU OUT: SEE ATTACHED CABINETRY SCHEDULE
2727 27Apr21 NoCat	1	KITCHEN: APPLIANCE SPECS REQUIRED - PURCHASER MUST SUBMIT SIGNED APPLIANCE SPECS TO DESIGN STUDIO WITHIN 7 BUSINESS DAYS OF APPOINTMENT FAILURE TO SUBMIT SPECS WILL RESULT IN ADDITIONAL FEES AND/OR DELAY TO CLOSING.

NETWORK AND WIRING

Invoice	Qty.	Description
2528 72,258 13Jan21	1	GREAT ROOM: ADDITIONAL CAT6 ETHERNET OUTLET - EACH SEE PLAN FOR LOCATION
2528 72,259 13Jan21	1	GREAT ROOM: CONDUIT PIPE - FOR WALL MOUNT TV - LOCATE ABOVE FIREPLACE, APPROX 66" A.F.F. TERMINATING AT CABLE LOCATION, SEE PLAN



CONSTRUCTION SUMMARY

Lot: 4
Model: 42.03 B FORESTCREST
Project/Phase: Pine Valley Forevergreen / 1

PAINT

Invoice	Qty.	Description
2528 13Jan21 NoCat	1	.GREAT ROOM: MODEL OPTIONS 42.03 - GREAT ROOM - OPT. COFFERED CEILING AS PER PLAN
2528 13Jan21 NoCat	1	.GREAT ROOM: MODEL OPTIONS 42.03 - GREAT ROOM - OPT. WAFFLE CEILING, BEAM DETAIL AS PER PLAN (8 BOXES) OPTION #1 CTR-B07
2528 13Jan21 NoCat	1	.LIVING ROOM: MODEL OPTIONS 42.03 - LIVING ROOM - OPT. COFFERED CEILING AS PER PLAN
2528 13Jan21 NoCat	1	.GROUND FLOOR HALLWAY: MODEL OPTIONS 42.03 - GROUND FLOOR HALLWAY - OPT. COFFERED CEILING NEAR POWDER ROOM AS PER PLAN
2528 13Jan21 NoCat	1	.STUDY: MODEL OPTIONS 42.03 - STUDY - OPT. COFFERED CEILING AS PER PLAN
2528 13Jan21 NoCat	1	.STUDY: MODEL OPTIONS 42.03 - STUDY - OPT. WAFFLE CEILING, BEAM DETAIL AS PER PLAN (4 BOXES) OPTION # 1 CTR-B07
2528 13Jan21 NoCat	19	.THRU OUT 2ND FLOOR: INCREASE HEIGHT OF DOOR TO 8FT SECOND FLOOR - PER DOOR
2528 13Jan21 NoCat	1	***CUSTOM LAYOUT*** DELETE 'HIS WIC', MAKE ACCESSIBLE FROM BEDROOM 2 // COMBINE SMALL LINEN CLOSET + BEDROOM 2 REACH IN CLOSET TO MAKE 1 LARGER LINEN CLOSET RELOCATE DOORS TO HALL
2528 13Jan21 NoCat	1	BREAKFAST: UPGRADE TO 96" GARDEN DOOR ASSEMBLY
2727 27Apr21 NoCat	2	MAIN STAIRS: 2ND FLOOR TO BASEMENT - STAIN STAIRS AND LANDINGS WILL NOT MATCH HARDWOOD IN COLOUR, SPECIES, OR TEXTURE



CONSTRUCTION SUMMARY

Lot: 4
Model: 42.03 B FORESTCREST
Project/Phase: Pine Valley Forevergreen / 1

PLUMBING

Invoice	Qty.	Description
2528 13Jan21 NoCat	1	MASTER ENSUITE: MOEN 'ALIGN' RAIN SHOWER (from ceiling) + HAND SHOWER w/ SLIDE BAR - CHROME
2528 72,346 13Jan21	1	KITCHEN: MOEN 'MODERN' POT FILLER - CHROME ROUGH-IN INCLUDED
2528 13Jan21 NoCat	1	.STUDY: MODEL OPTIONS 42.03 - STUDY - OPT. WAFFLE CEILING, BEAM DETAIL AS PER PLAN (4 BOXES) OPTION # 1 CTR-B07

WINDOWS AND DOORS

Invoice	Qty.	Description
2528 13Jan21 NoCat	1	BREAKFAST: UPGRADE TO 96" GARDEN DOOR ASSEMBLY
2480 72,351 20Oct20 **	3	BASEMENT WINDOWS - UPGRADE BASEMENT WINDOW SIZE TO 30 " X 24" - 8" FRAME

PV - 4 Cabinetry Schedule

ROOM	DESCRIPTION	PRICE	QTY	TOTAL
KITCHEN	ADD POTS AND PANS DRAWER BELOW COOKTOP		1	
	CONVERT STANDARD CABINETRY TO TALL DEEP BUILT IN OVEN UNIT WITH DRAWER BELOW		1	
	ADD CABINETRY VALANCE		1	
	ADJUST CABINETRY FOR 36" COOKTOP (N/C)		1	
	ADD DECORATIVE HOOD CANOPY - CLASSIC		1	
CABINETRY TOTAL:				

HANDLE PLACEMENT: AT INSTALLERS DISCRETION

LOT #: 4 DATE: April 26, 2021

SIGNATURE: 

SIGNATURE: 

*** NOTE: This is not an approved document. Document must be locked ***

Scheduled Closing Date:

Purchaser: KIM TUYEN LIEU

Property: 4 of Plan -

Telephone Res. / Bus: (905) 760-9595

Project: Pine Valley Forevergreen - Phase 1

Decor Advisor: Amanda Ceresino

Model and Elevation: 42.03 B FORESTCREST

Layout Changes: Yes No Sketch Attached: Yes No Exterior Colour Scheme:

1. Cabinetry

Table with 4 columns: Room, Style and Colour, Counter, Hardware. Rows include Kitchen / Breakfast, Laundry Room, Powder Room, Mud Room, Master Ensuite Bathroom, Second Ensuite Bathroom, and Ensuite 4.

Comment

KITCHEN: Perimeter: Chesapeake 'Classic White' / Island: Monterey 'Oak Storm Grey' // Ensuite 3: Bowery 'Ello' + Ice Snow

2. Floor Tile

Table with 2 columns: Room, Selection. Rows include Entrance Vestibule, Main Hall, Kitchen / Breakfast, Laundry Room, Powder Room, Mud Room, Master Ensuite Bathroom, Second Ensuite Bathroom, Lower Landing, and Ensuite 3.

Comment

Ensuite 4: 13x13" Cambridge 'White' // shower floor: std 2x2" white

3. Wall Tile

Table with 4 columns: Room, Selection, Listello/Inserts, Describe. Rows include Ensuite 3, Master Ensuite Bathroom (Tub Deck, Shower Stall, Bathroom Walls), Second Ensuite Bathroom, Ensuite 4, and Kitchen Backsplash.

Comment

Handwritten signature

Scheduled Closing Date:

Purchaser: KIM TUYEN LIEU
Telephone Res. / Bus: (905) 760-9595
Decor Advisor: Amanda Ceresino

Property: 4 of Plan -

Project: Pine Valley Forevergreen - Phase 1

Model and Elevation: 42.03 B FORESTCREST

4. Plumbing Fixtures

Master Ensuite Bathroom Second Ensuite Powder Room
Other Room - Specify Other Washroom

Comment

upgraded in master ensuite shower - see extras

5. Hardwood Flooring

	Type and Stain		Type and Stain
Main Hall	<input type="text"/>	Upper Landing	<input type="text"/>
Kitchen / Breakfast	<input type="text"/>	Upper Hall	<input type="text"/>
Living Room	<input type="text"/>	Master Bedroom	<input type="text"/>
Dining Room	<input type="text"/>	Bedroom #2	<input type="text"/>
Family Room	<input type="text"/>	Bedroom #3	<input type="text"/>
Den/Library	<input type="text"/>	Bedroom #4	<input type="text"/>
Entrance Vestibule	<input type="text"/>	Bedroom #5	<input type="text"/>
Lower Landing (If Applicable)	<input type="text"/>	Other Room - Specify thru out standard areas	3/4x3-5/16" red oak smooth 'Rio'

Comment

6. Carpeting

	Upgrade	Description
Ground Floor	<input type="checkbox"/>	<input type="text"/>
Second Floor	<input type="checkbox"/>	<input type="text"/>
<input type="text"/>	<input type="checkbox"/>	<input type="text"/>

	Type	Area
Upgrade Underpad	<input type="text"/>	<input type="text"/>
	Capped	Runner - *Upgrade
Carpet on Stairs	<input type="text"/>	<input type="text"/>

Comment

7. Fireplace

	Living Room			Family Room			Other Room - Specify		
	Purchased	As Per Plan	N/A	Purchased	As Per Plan	N/A	Purchased	As Per Plan	N/A
Fireplace Type	<input type="radio"/>	<input type="radio"/>	<input type="radio"/>	<input type="radio"/>	<input checked="" type="radio"/>	<input type="radio"/>	<input type="radio"/>	<input type="radio"/>	<input type="radio"/>
Mantle Type	<input type="text"/>			Standard Gas			<input type="text"/>		
Colour / Stain	<input type="text"/>			Mediterranean			<input type="text"/>		
Surround	<input type="text"/>			Arctic White			<input type="text"/>		
Hearth	<input type="text"/>			n/a			<input type="text"/>		
	<input type="text"/>			none			<input type="text"/>		

Comment

Scheduled Closing Date:

Purchaser: KIM TUYEN LIEU

Property: 4 of Plan -

Telephone Res. / Bus: (905) 760-9595

Project: Pine Valley Forevergreen - Phase 1

Decor Advisor: Amanda Ceresino

Model and Elevation: 42.03 B FORESTCREST

8. Trim Carpentry

Interior Doors Carrara Front Door Glass Inserts standard Door Handles standard

Interior Trim Standard package

Comment

9. Plaster Mouldings and Medallions

Standard Throughout ☐ Yes ☐ No ☐ N/A

Entrance Vestibule Kitchen/Breakfast

Main Hall Den/Library

Living Room Lower Landing

Dining Room Other Room - Specify

Family Room

Comment

10. Railings and Spindles

Railing Package Standard 2

Railing Colour *Graphite - mirage Spindle Colour *Graphite - mirage

Stringer / Riser *Graphite - mirage Treads *Graphite - mirage

Comment

Oak Stairs ☒ Yes ☐ No ☐ N/A

11. Wall Paint / Ceilings

Throughout Finished Areas Cool White

Trim Paint White

Smooth Ceilings

Ground Floor ☒Second Floor ☒

Note

Comment

Scheduled Closing Date:

Purchaser: KIM TUYEN LIEU
Telephone Res. / Bus: (905) 760-9595
Decor Advisor: Amanda Ceresino

Property: 4 of Plan -

Project: Pine Valley Forevergreen - Phase 1

Model and Elevation: 42.03 B FORESTCREST

12. Electrical

Hood Fan ☐ White ☐ Stainless ☐ N/A

Above Kitchen Cabinet Light ☐ Yes ☒ No

Below Kitchen Cabinet Light ☒ Yes ☐ No

Standard Appliances ☐

Over The Range Microwave ☐

Chimney Style Fan ☐

Comment

13. Heating and Air Conditioning

Air Conditioning

Gas Provisions Stove

Gas Provisions Dryer

Gas Provisions Barbecue

Comment

14. Additional Comments

15. Disclaimers and Notes

- 1) Colours of all materials are as close as possible to builder's selection, but not necessarily identical due to variances in manufacturing.
- 2) Any extras listed above are null and void unless accompanied by a separate invoice/amendment. Said invoice must be paid in full.
- 3) The Purchaser acknowledges that after Interior Colour Selection form is signed and dated, no further changes will be permitted other than re-selection due to unavailability. _____ Purchaser's Initials
- 4) The Purchaser acknowledges reading and accepting the "Gold Park Homes Decor Centre Disclaimers" form. This document contains other miscellaneous disclaimers.

This Interior Colour Selection is final and approved by:

Signature:  Date: _____

SCHEDULE 'F'



PV-4
OCT 19 2020

DEC 11 2020

PV-4
Apr. 26, 2021

The Forestcrest

42' SERIES

Elevation A • 3,800 sq.ft.
Elevation B • 3,785 sq.ft.
Elevation C • 3,800 sq.ft.

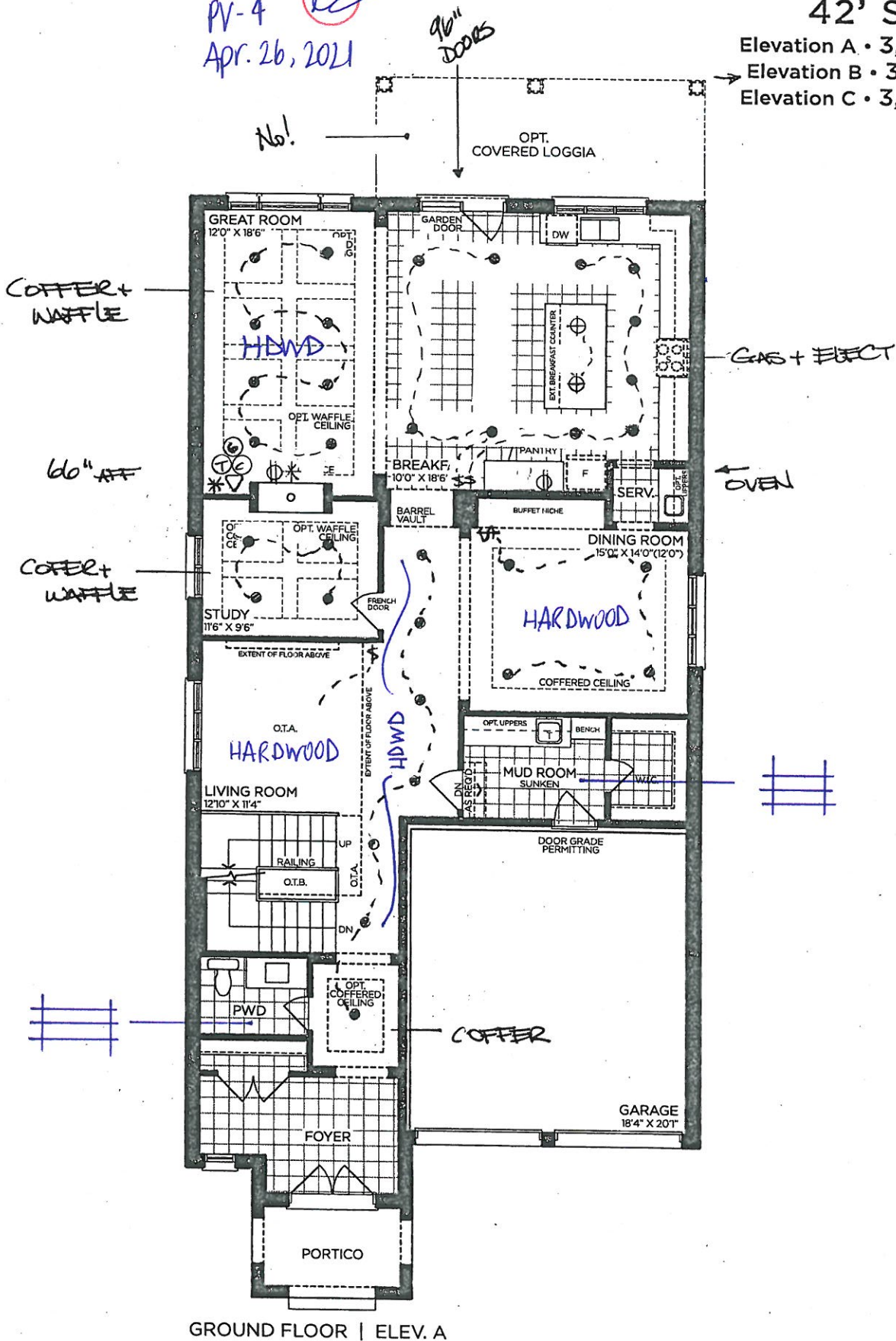

VENDOR

PURCHASER

PURCHASER

GOLDPARK
WORTH MORE™

Prices, figures, illustrations, sizes, features and finishes are subject to change without notice. Areas and dimensions are approximate and actual usable floor space may vary from the stated area. Layout may be reverse of the unit purchased. E. & O.E. 4203

SCHEDULE 'F'



PV-4
OCT 19 2020
DEC 11 2020

PV-4 *12*
Apr. 26, 2021

The Forestcrest

42' SERIES

Elevation A • 3,800 sq.ft.

→ Elevation B • 3,785 sq.ft.

Elevation C • 3,800 sq.ft.

8' DOORS
THRU OUT

RAIN
SHOWER.

COFFER
CEILING

← REVISE WIC

← REVISE LINEN
CLOSET

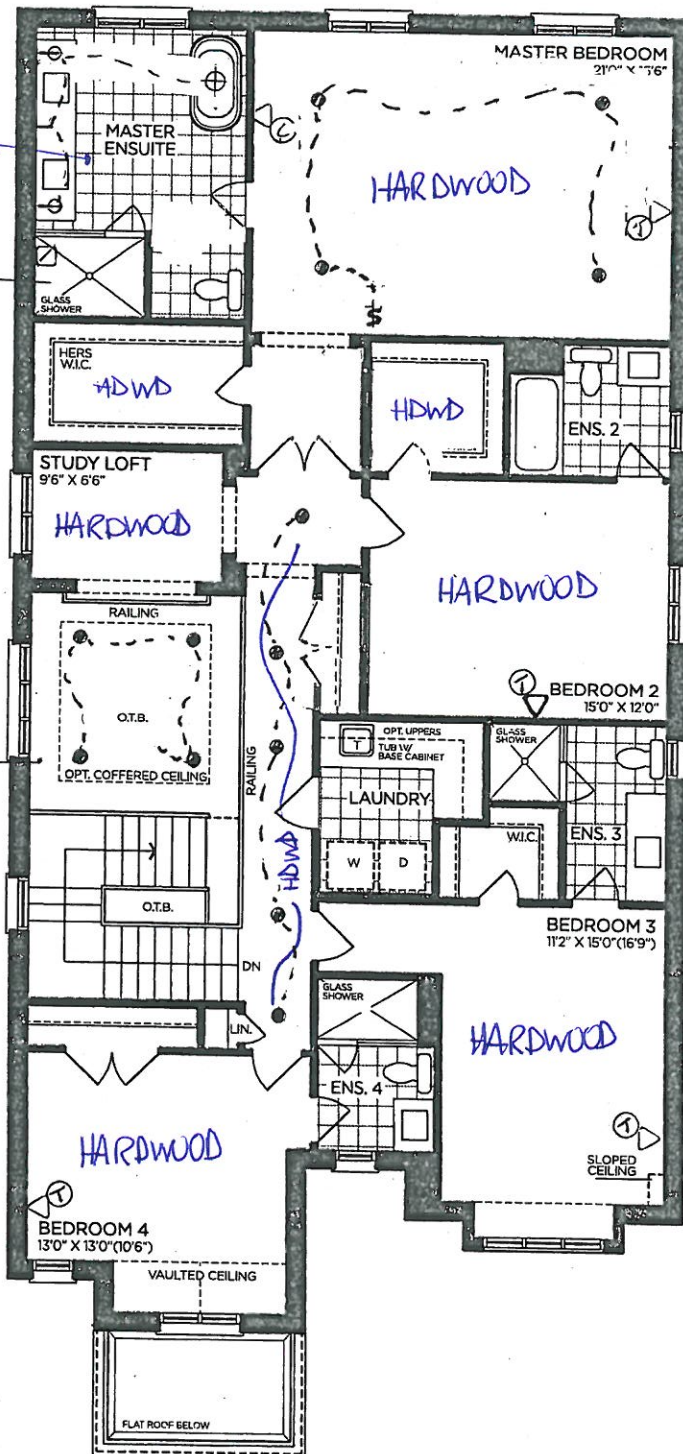

SECOND FLOOR | ELEV. A

VENDOR	<input type="text"/>
PURCHASER	<input type="text"/>
PURCHASER	<input type="text"/>

GOLDPARK

WORTH MORE™

Prices, figures, illustrations, sizes, features and finishes are subject to change without notice. Areas and dimensions are approximate and actual usable floor space may vary from the stated area. Layout may be reverse of the unit purchased. E. & O.E. 4203

SCHEDULE 'F'



PV-4
OCT 19 2020
DEC 11 2020

PV-4
APR. 26, 2021

The Forestcrest

42' SERIES

Elevation A • 3,800 sq.ft.
→ Elevation B • 3,785 sq.ft.
Elevation C • 3,800 sq.ft.

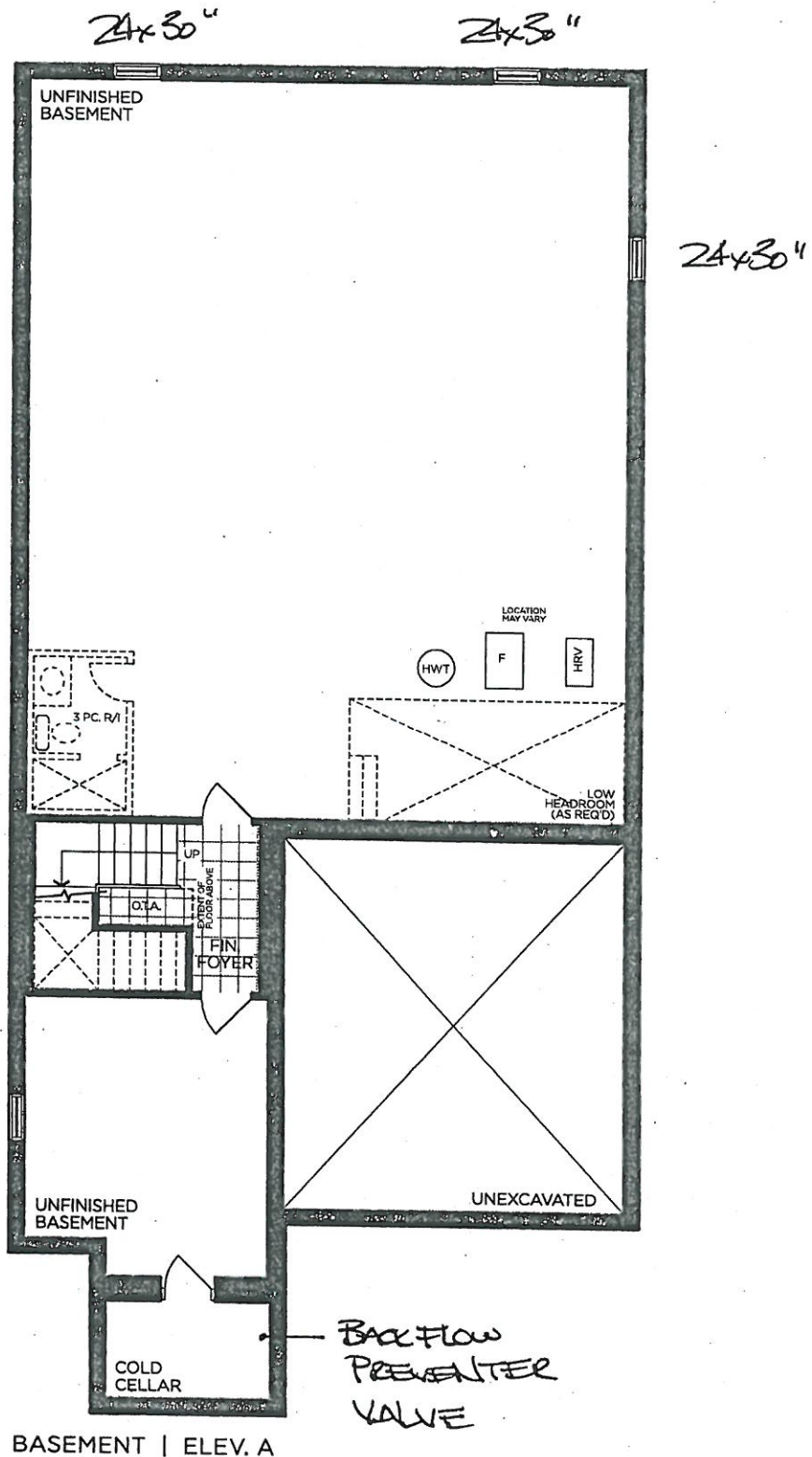

BASEMENT | ELEV. A

VENDOR

PURCHASER

PURCHASER

GOLDPARK
WORTH MORE™

Prices, figures, illustrations, sizes, features and finishes are subject to change without notice. Areas and dimensions are approximate and actual usable floor space may vary from the stated area. Layout may be reverse of the unit purchased. E. & O.E. 4203

PV-4
Apr. 26, 2021

NO!

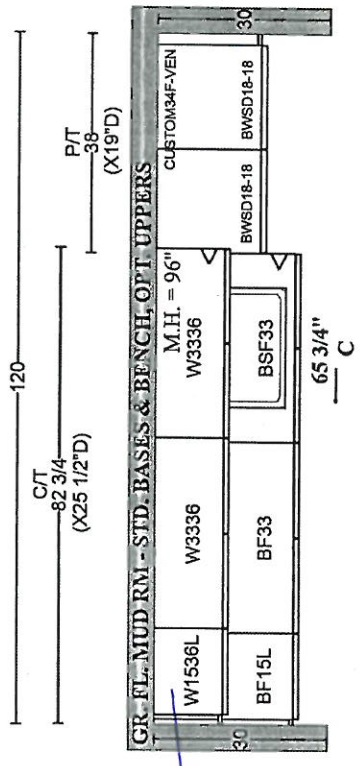

GOLDPARK HOMES
PINE VALLEY
VAUGHAN, ONTARIO
MODEL: (4203) FORESTCREST

SITE STANDARD: WHITE 3/4" EXTENSION
SOFT-CLOSE DRAWERS & STANDARD SLAM DOOR HINGES
TO VANITIES

ONE TOP DRAWER WHERE POSSIBLE THROUGHOUT EACH
VANITY, ONE BANK OF DRAWERS WHERE POSSIBLE
THROUGHOUT EACH MASTER ENSUITE VANITY

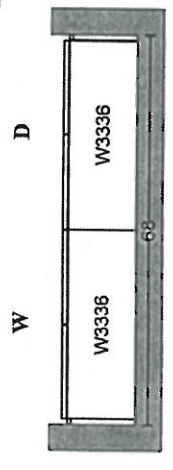
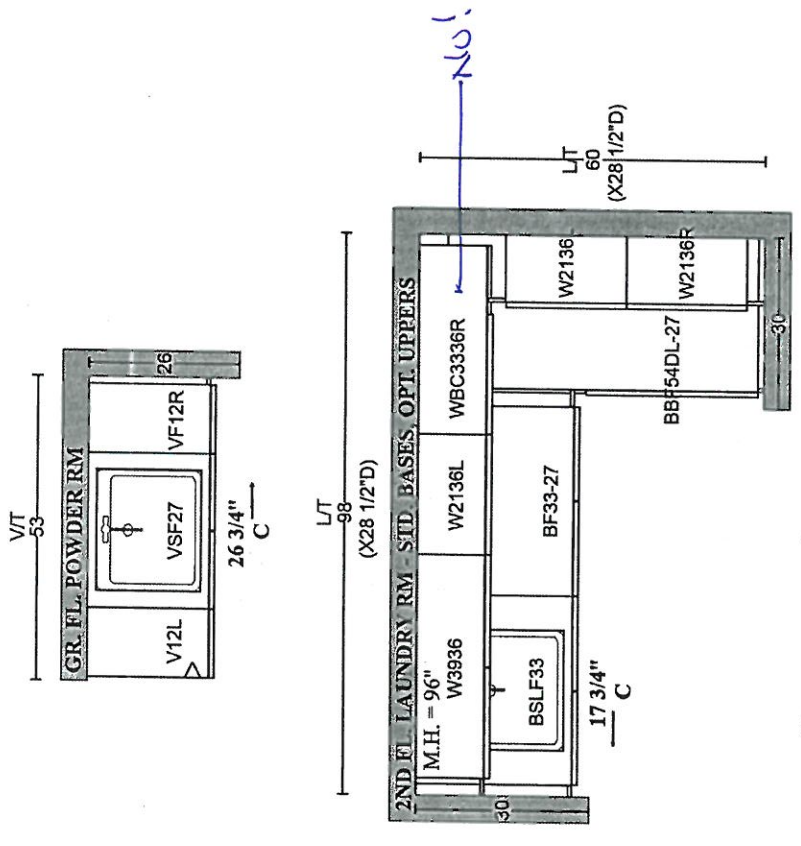
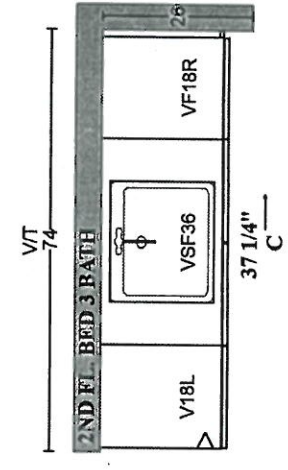
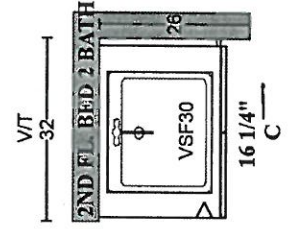
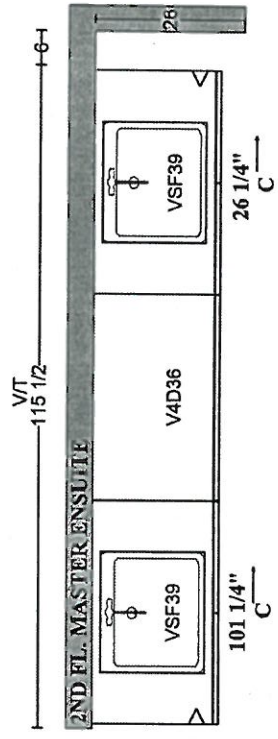



PINE VALLEY

FOREVERGREEN

STONE COUNTERTOP EDGE PROFILES



STANDARD 2CM EASED EDGE



LOCATION:

THRU OUT

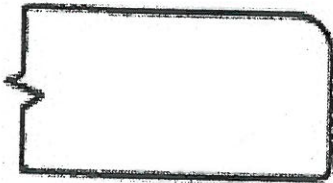

UPGRADE 3CM EASED EDGE

LOCATION:

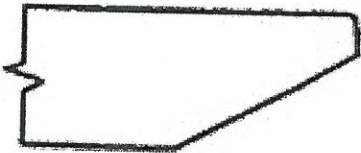

UPGRADE 4CM MITRED EDGE

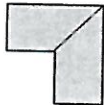

LOCATION:

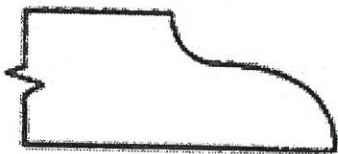

UPGRADE 2CM OGEE EDGE

LOCATION:

LOT #: PV-4

DATE: Apr. 26, 2021

SIGNATURE:

SIGNATURE:



PINE VALLEY
FOREVERGREEN

STANDARD HARDWARE / HANDLES

☐

H001-02

☐

H001-03

☐

H001-04

☐

H009-03

☐

H009-09

☐

H011-03

☐

H011-05

☐

H011-06

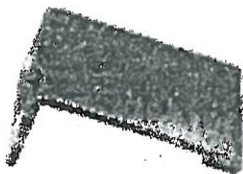
☐

H033-01

☒

H039-03

→ Laundry Room
→ Ensuite 2
→ Ensuite 4

☐

*NO HARDWARE

LOT # PV-4

DATE: Apr. 26, 2021

SIGNATURE:

SIGNATURE:



PINE VALLEY

FOREVERGREEN

STANDARD HARDWARE / KNOBS



K002-02

→ Ensuite 3



K002-03



K002-04



K002-06



K002-05

→ Kitchen
→ Powder Room
→ Mvd Room
→ Master Ensuite



K008-14



K024-03



*NO HARDWARE



*TOUCH-LATCH

LOT # PV-4

DATE: Apr. 26, 2021

SIGNATURE:

SIGNATURE:



PINE VALLEY
FOREVERGREEN

STANDARD SHOWER HARDWARE

SDK106

Shower Door Knob

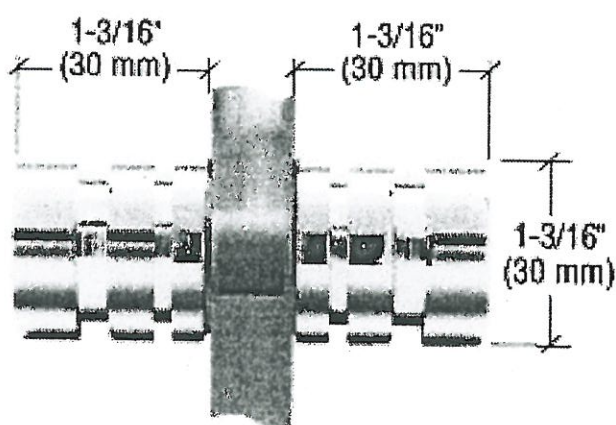

SDK106

Shower Door Knob

1-3/16" dia.

Contemporary Style

(Also available single sided)

CHROME

Lot# PV-4

Date: Apr. 26, 2021

Room: Master Ensuite, Ensuite 3
Ensuite 4

Signature:

Signature:



PINE VALLEY
FOREVERGREEN

UPGRADE DECORATIVE HOOD CABINET

CLASSIC RANGE HOOD

(Insert fan not included)



Lot# 4	Date: April 26, 21	Room: Kitchen
Signature: 		
Signature:		

BATHROOM ACCESSORIES

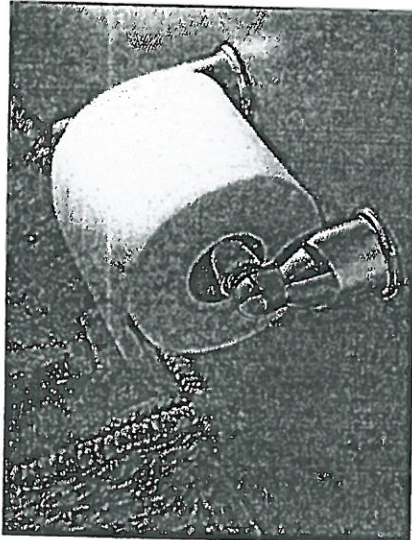

Tissue Holder
Mason - Chrome

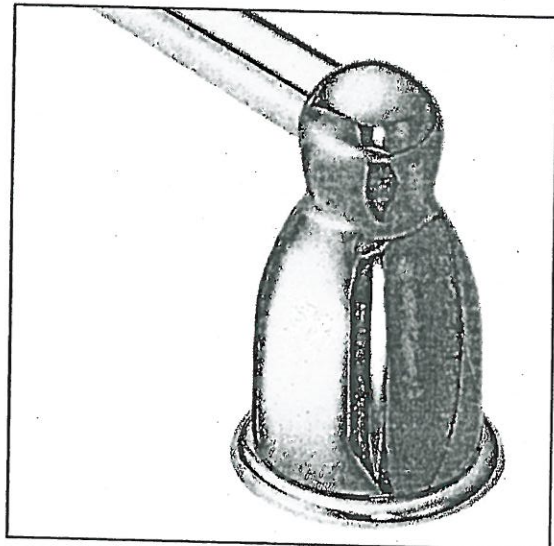

Towel Bar
Mason - Chrome

Please select one of the following:

☒ INSTALL STANDARD BATHROOM ACCESSORIES THRU OUT
(tissue holder + towel bar) **location as per vendors discretion**

☐ ***DO NOT*** INSTALL STANDARD BATHROOM ACCESSORIES
THRU OUT **tissue holder + towel bar will not be provided**

LOT # PV-4

DATE: Apr. 26, 2021

SIGNATURE:

SIGNATURE:



Project: Pine Valley

Lot: 4

Purchaser(s): Kim Tuyen Lieu

Standard Hood Fan Deletion

We acknowledge that the builder's standard hood fan will not be installed.
Do not supply, install and/or credit. We will install our own hood fan after closing.

Signature: 

Signature: _____

Date: Apr. 26, 2021

UPGRADE PLUMBING

MOEN - ALIGN

3 Function SHOWER ONLY* Rain Shower and Handshower

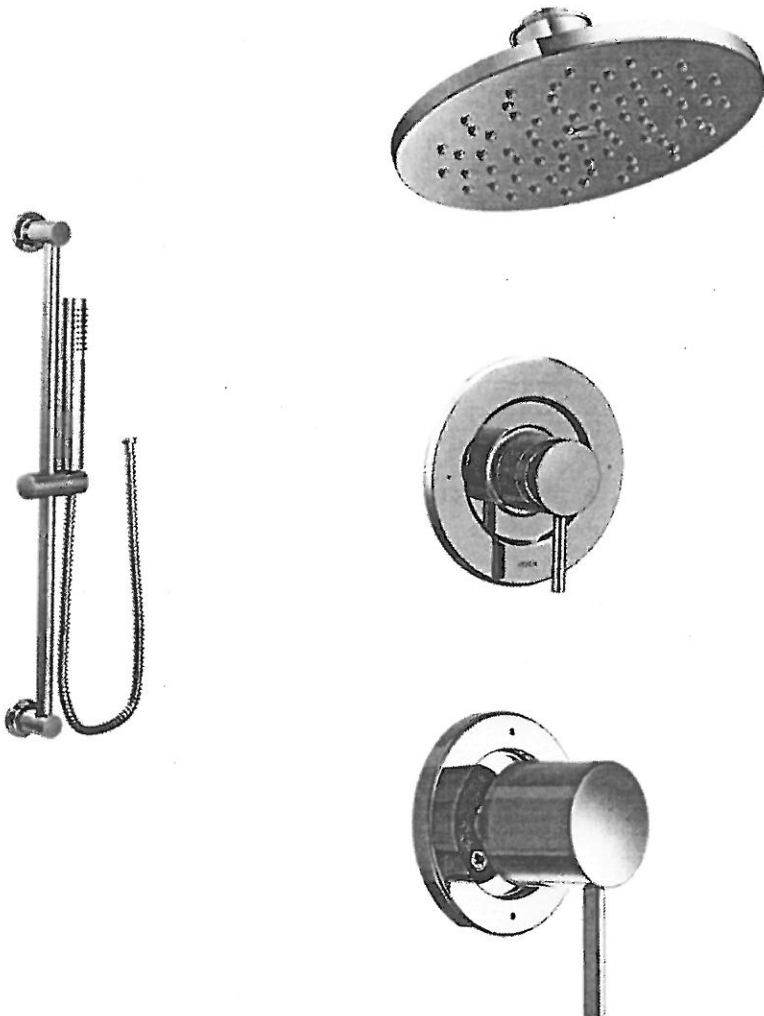

MODEL: T2192EP Shower Trim Only* / T4191 Transfer Trim + 3372 Transfer Valve / 62320 1/2" CC Valve / 3887EP Handshower + A725 Drop El / 226651 Shower Arm (from ceiling) / S6360 Showerhead

LOT #:	PV-4	DATE:	Dec. 11, 2020.	ROOM:	Master Ensuite
SIGNATURE:					
SIGNATURE:					



PINE VALLEY
FOREVERGREEN

UPGRADE KITCHEN EXTRA

MOEN - MODERN

Pot Filler



- ☒ CHROME
☐ STAINLESS (SRS)
☐ BRUSHED GOLD (BG)
☐ MATTE BLACK (BL)

MODEL: S665 (SRS, BG, BL) Pot Filler

Lot# PV-4	Date: Dec. 11, 2020	Room: Kitchen.
Signature:		
Signature:		

GOLDPARK
WORTH MORE

PV-4 attach
May 4, 2021

FRIGIDAIRE GALLERY

FGMC3066U D/F

MICROWAVE
COMBINATION OVENS
30" ELECTRIC

Smudge-Proof
STAINLESS STEEL

Smudge-Proof
BLACK STAINLESS STEEL

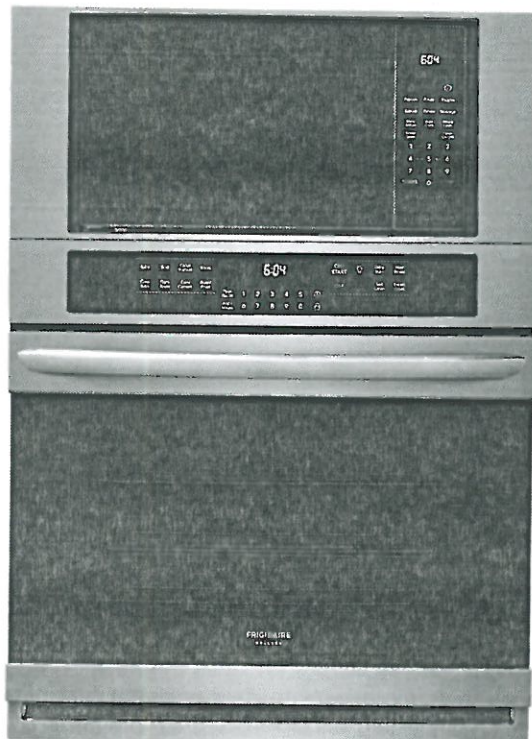

AVAILABLE COLORS



Black
Stainless



Stainless

PRODUCT DIMENSIONS

Height (Max.)	41-1/4"
Width	30"
Depth	24-3/4"

MORE EASY-TO-USE FEATURES

Smudge-Proof® Stainless Steel
Resists fingerprints and cleans easily. Available in Stainless Steel and Black Stainless Steel finishes.

Our Largest Capacity Oven
Cook more at once with 5.1 cubic feet of oven capacity.

Over 30 Setting Options
Offers multiple settings to meet your cooking needs, including chicken nuggets and snacks.

Easy to Clean with Self-Cleaning
Your oven cleans itself - so you don't have to. Self clean options available in 2, 3, and 4-hour cycles.

Effortless™ Reheat
Reheat almost anything at the touch of a button.

One-Touch Keep Warm Setting
Just one touch of a button keeps food warm until everything - and everyone - is ready.

Delay Clean Option
Set the oven to begin cleaning on your schedule.

Steam Cleaning
A 30-minute light oven cleaning that's chemical-free, odor-free, and fast.

CERTIFICATIONS

Star-K® Certified (*Sabbath Mode*)

SIGNATURE FEATURES

Faster, More Even Baking Results with True Convection

Get faster, more even multi-rack baking with a powerful convection fan and third heating element that evenly circulates hot air throughout the oven.

Effortless™ Temperature Probe

The Effortless™ Temperature Probe detects and alerts when the desired finished cooking temperature has been reached and automatically switches to the keep warm setting.

Quick Preheat

Preheat in just a few minutes.¹

Sensor Cooking Options

Microwave automatically adjusts power levels and cooking times to cook a variety of items, effortlessly.

¹ Based on single rack cooking performance, not set temperature, using Quick Preheat.

PV-4 attach
May 4, 2021

FGMC3066U D/F
MICROWAVE COMBINATION OVEN
30" ELECTRIC

FRIGIDAIRE
GALLERY

FEATURES

Control/Timing System	Express-Select® Controls
Exterior Door Finish	Smudge-Proof® Stainless Steel (F), Smudge-Proof® Black Stainless (D)
Handle Design	Stainless Steel (F), Black Stainless (D)

MICROWAVE FEATURES

Microwave Capacity (Cu. Ft.)	1.6
Watts (IEC-705 Test Procedure)	1,100
Window	Large
Interior Light	Yes
Interior Color	White
Turntable Diameter	13.5"
Turntable On / Off	
Control Lock / Clock	Yes/Yes
Touch Pad Buttons / Power Levels	28/11

MICROWAVE CONTROL OPTIONS

Popcorn Button	Yes
Veggies Button (Fresh/Frozen)	2
Potato Button	Yes
Reheat Button	Yes
Auto Melt / Soften Options	4
Auto Reheat Options	3
Auto Cook Options	3
Auto Defrost Options	3
Add-30-Seconds	Yes
Sensor Cooking Options	4
Delay Start / User Preferences	Yes/Yes

OVEN FEATURES

Capacity (Cu. Ft.)	5.1
Oven Window	Large
Oven Lights	2 Halogen
Hidden Bake Element	Yes
Convection System	True Convection
Baking System	Even Baking Technology
Broiling System	Vari-Broil™ (Hi/Low)
Quick Preheat	Yes
Bake / Broil Element (Watts)	2,200 / 4,000
Oven Rack Configuration	1 Extension Glide Rack / 1 Handle Rack
Oven Cleaning System	Self Clean / Steam Clean

OVEN CONTROLS

Control Lock	Yes
Delay Start	Yes
Convection Conversion	Effortless™
Effortless™ Temperature Probe	Yes
Keep Warm / Add-a-Minute	Yes/No

OPTIONAL ACCESSORIES

3"-High Bottom Trim - Stainless Steel (F) / Black Stainless Steel (D)	(F) PN # 5304520627 (D) PN # 5304520624
10'-Long Armored Power Cable	PN # 903056-9010

CERTIFICATIONS

Star-K® Certified (Sabbath Mode)	Yes
----------------------------------	-----

SPECIFICATIONS

Microwave Oven Interior (H x W x D)	10-1/2" x 17-3/8" x 18-5/8"
Oven Interior (H x W x D)	18-5/8" x 24-1/8" x 19-1/2"
Power Supply Connection Location	Left Bottom Rear
Voltage Rating	240V / 208V / 60Hz
Connected Load (kW Rating) @ 240 / 208 Volts¹	7.9 / 5.9
Amps @ 240 / 208 Volts	30.38 / 35.25
Minimum Circuit Required (Amps)	30
Shipping Weight (Approx.)	300 Lbs.

PRODUCT DIMENSIONS

A - Height (Max.)	41-1/4"
B - Width	30"
C - Depth	24-3/4"
D - Height (Wrapper)	40 4/5"
E - Width (Wrapper)	28-1/4"
Depth with Door Open 90°	45-1/8"

CABINET CUTOUT DIMENSIONS

Height (Min.) / (Max.)	41-1/8" / 41-1/4"
Width (Min.) / (Max.)	28-1/2" / 29"
Depth (Min.)	23-3/4"

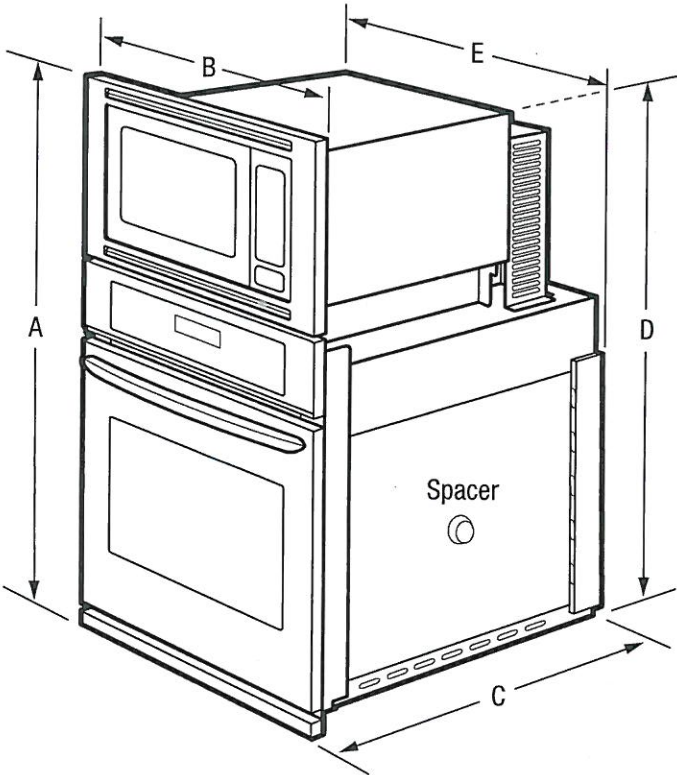

¹Single phase 3- or 4-wire cable, 120 / 240 or 120 / 208 Volt, 60 Hertz AC only electrical supply with ground required on separate circuit fused on both sides of line.
Note: For planning purposes only. Always consult local and national electric, gas and plumbing codes. Refer to Product Installation Guide for detailed installation instructions on the web at frigidaire.com / frigidaire.ca.
Specifications subject to change. Accessories information available on the web at frigidaire.com / frigidaire.ca

FRIGIDAIRE

USA • 10200 David Taylor Drive • Charlotte, NC 28262 • 1-800-FRIGIDAIRE • frigidaire.com
CANADA • 5855 Terry Fox Way • Mississauga, ON L5V 3E4 • 1-800-265-8352 • frigidaire.ca

FGMC3066U 02/19
© 2019 Electrolux Home Products, Inc.

PV-4 ~~attach~~
May 4, 2021

FGMC3066U D/F
MICROWAVE COMBINATION OVEN
30" ELECTRIC

FRIGIDAIRE
GALLERY

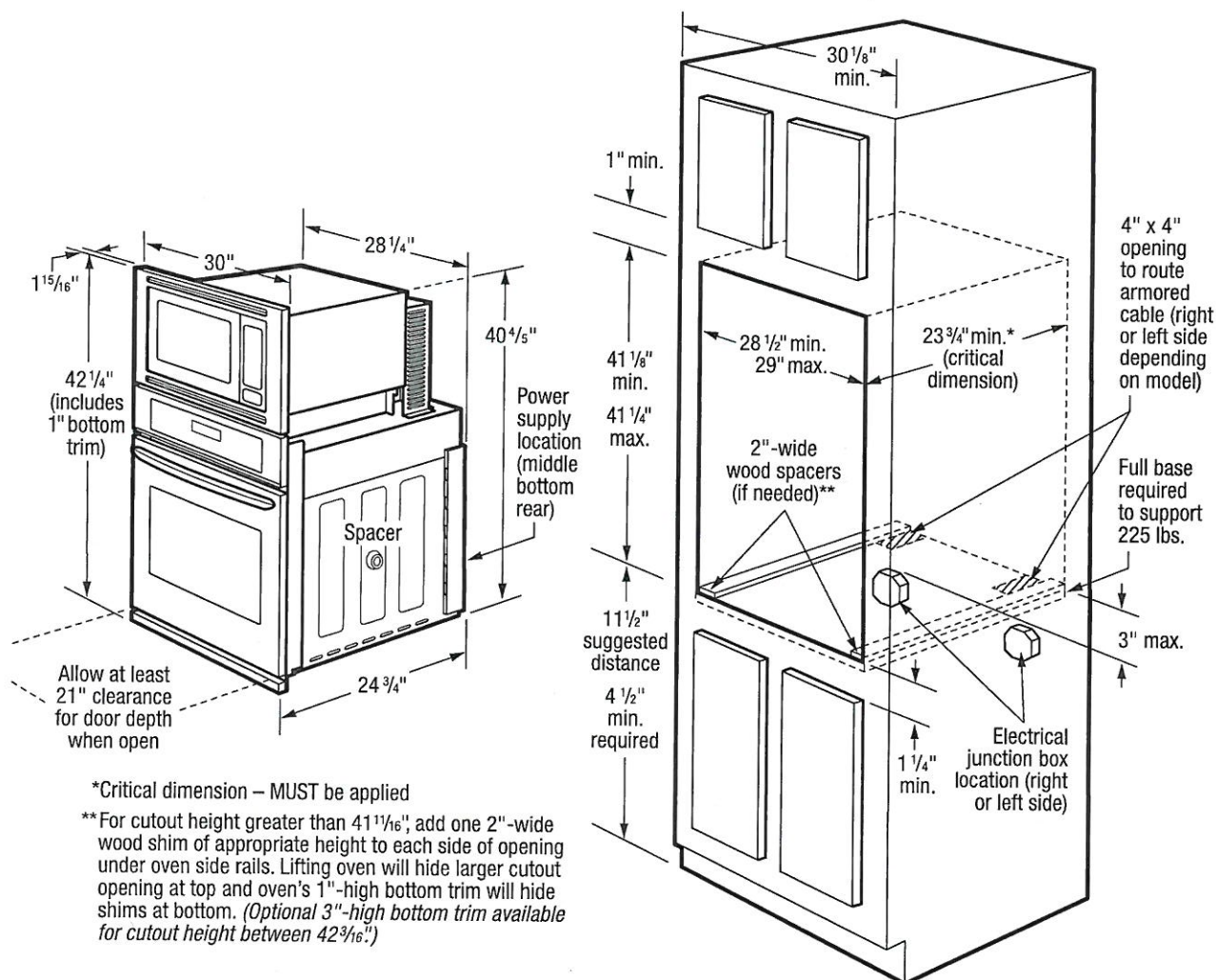

INSTALLATION SPECIFICATIONS

- Product Shipping Weight (approx.) – 300 Lbs.
- Single phase 3- or 4-wire cable, 120 / 240 or 120 / 208 Volt, 60 Hertz AC only electrical supply with ground required on separate circuit fused on both sides of line.
- Connected Load (kW Rating) @ 240 / 208 Volts = 7.9 / 5.9 kW
- Amps @ 240/208 Volts = 30.38 / 35.25
- Recommended Circuit Breaker – 30 Amps
- Always consult local and national electric codes.
- Minimum 2" clearance for oven door depth when open.
- Suggested distance from floor is 11-1/2". Minimum required distance is 4-1/2".
- To adapt Microwave Combination Oven to fit cutout height greater than 41-11/16", add one 2"-wide wood shim of appropriate height to each side of opening under oven side rails. Lifting oven will hide larger cutout opening at top and oven's 1"-high bottom trim will hide shims at bottom. (Standard 1"-High Bottom Trim included.)

- To adapt Microwave Combination Oven to fit cutout height greater than 42-3/16", optional 3"-High Bottom Trim available.
- Minimum 24" deep cutout dimension is critical for proper installation, to ensure that oven's faceplate will fit flush against cabinet front.
- Full oven base of solid plywood or similar material required, capable of supporting 225 Lbs.
- Base must be level and cabinet front must be square.
- Microwave Combination Ovens are NOT approved to be used in stackable or side-by-side installation.

OPTIONAL ACCESSORIES

- 3"-High Stainless Steel Bottom Trim – (PN # 5304520627).
- 3"-High Black Stainless Bottom Trim – (PN # 5304520624).
- 10'-Long Armored Power Cable – (PN # 903056-9010).



FRIGIDAIRE

USA • 10200 David Taylor Drive • Charlotte, NC 28262 • 1-800-FRIGIDAIRE • frigidaire.com
CANADA • 5855 Terry Fox Way • Mississauga, ON L5V 3E4 • 1-800-265-8352 • frigidaire.ca

Note: For planning purposes only. Always consult local and national electric, gas and plumbing codes. Refer to Product Installation Guide for detailed installation instructions on the web at frigidaire.com/frigidaire.ca. Specifications subject to change. Accessories information available on the web at frigidaire.com/frigidaire.ca

FGMC3066U 02/19
© 2019 Electrolux Home Products, Inc.

COMBINATION OVENS 30" ELECTRIC

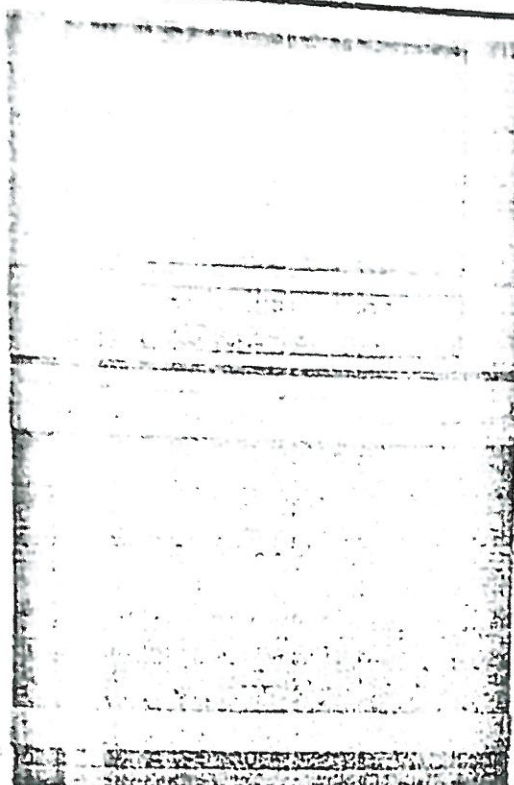
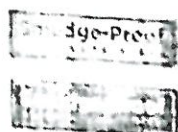

AVAILABLE COLORS



PRODUCT DIMENSIONS

Height	34 1/2"
Width	30"
Depth	24 1/4"

MORE EASY-TO-USE FEATURES

Smudge-Proof® Stainless Steel
Smudge-Proof® Stainless Steel exterior with 30-point stainless steel and glass door for easy cleaning.

Our Largest Capacity Oven
Over 30 cubic feet with 3rd rack for large family meals.

Over 30 Setting Options
Over 30 settings for different cooking needs including bake, broil, roast, and more.

Easy to Clean with Self-Cleaning
Self-cleaning cycle with 3rd rack for easy cleaning. Self-cleaning cycles available in 2, 3, and 4 hours.

Effortless™ Reheat
Reheat almost any food with the touch of a button.

One-Touch Keep Warm Setting
Just one touch of a button and your food stays warm until everything is ready to eat.

Delay Clean Option
Set the oven to begin cleaning at your convenience.

Steam Cleaning
A 30-minute cycle with steam that cleans the oven from the inside out.

CERTIFICATIONS

Star-K® Certified (Kashruth Mark)

SIGNATURE FEATURES

Faster, More Even Baking Results with True Convection
Get faster, more even multi-rack baking with a powerful convection fan and third heating element that evenly circulates hot air throughout the oven.

Effortless™ Temperature Probe
The Effortless™ Temperature Probe detects and alerts when the desired finished cooking temperature has been reached and automatically switches to the keep warm setting.

Quick Preheat
Preheat in just a few minutes.*

Sensor Cooking Options
Microwave automatically adjusts power levels and cooking times to cook a variety of items, effortlessly.

*Based on single rack cooking performance, not set temperature, using Quick Preheat.

PV-4



MA11 04 2021

Finish (Default)	Stainless Steel (F)
	Black Stainless (D)
MICROWAVE FEATURES	
Microwave Power Level	15
Microwave Power Level (Max)	1200
Microwave Power Level (Min)	Large
Microwave Power Level (Max)	Yes
Microwave Power Level (Min)	White
Microwave Power Level (Max)	13.5"
Microwave Power Level (Min)	Yes/Yes
Microwave Power Level (Max)	28-1/2"
MICROWAVE CONTROL OPTIONS	
Control Panel	Yes
Control Panel (Touchscreen)	2
Control Panel (Keypad)	Yes
Control Panel (Touchscreen)	Yes
Control Panel (Keypad)	4
Control Panel (Touchscreen)	3
Control Panel (Keypad)	3
Control Panel (Touchscreen)	3
Control Panel (Keypad)	Yes
Control Panel (Touchscreen)	4
Control Panel (Keypad)	Yes/Yes
OVEN FEATURES	
Oven Power	5"
Oven Power	Large
Oven Power	2 Hydrogen
Oven Power	Yes
Oven Power	True Convection
Oven Power	Even-Broiling Technology
Oven Power	Var-Broil™ (H/L)
Oven Power	Yes
Oven Power	2200 / 4,000
Oven Power	1 Extension Glide Rack / 1 Handle Rack
Oven Power	Self Clean / Steam Clean
OVEN CONTROLS	
Oven Control	Yes
Oven Control	Yes
Oven Control	Effortless™
Oven Control	Yes
Oven Control	Yes/No
OPTIONAL ACCESSORIES	
Optional Accessory (FlexBurn)	(F) PN # 5304520627
Optional Accessory (Black Stainless Steel (D))	(D) PN # 5304520624
Optional Accessory (Power Cord)	PN # 903056-9010
CERTIFICATIONS	
Certification (Safety Mode)	Yes
SPECIFICATIONS	
Product Dimensions (H x W x D)	40-1/2" x 24-1/2" x 18-5/8"
Product Dimensions (H x W x D)	18-5/8" x 24-1/2" x 19-1/2"
Product Dimensions (H x W x D)	Left: Bottom Rear
Product Dimensions (H x W x D)	240V / 208V / 60Hz
Product Dimensions (H x W x D)	79 / 59
Product Dimensions (H x W x D)	30.34 / 35.25
Product Dimensions (H x W x D)	3U
Product Dimensions (H x W x D)	300 Lbs.

Product Dimensions (H x W x D)	40-1/2"
Product Dimensions (H x W x D)	24-1/2"
Product Dimensions (H x W x D)	18-5/8"
CABINET CUTOUT DIMENSIONS	
Product Dimensions (H x W x D)	40-1/8" / 41-1/4"
Product Dimensions (H x W x D)	24-1/2" / 25"
Product Dimensions (H x W x D)	23-3/4"

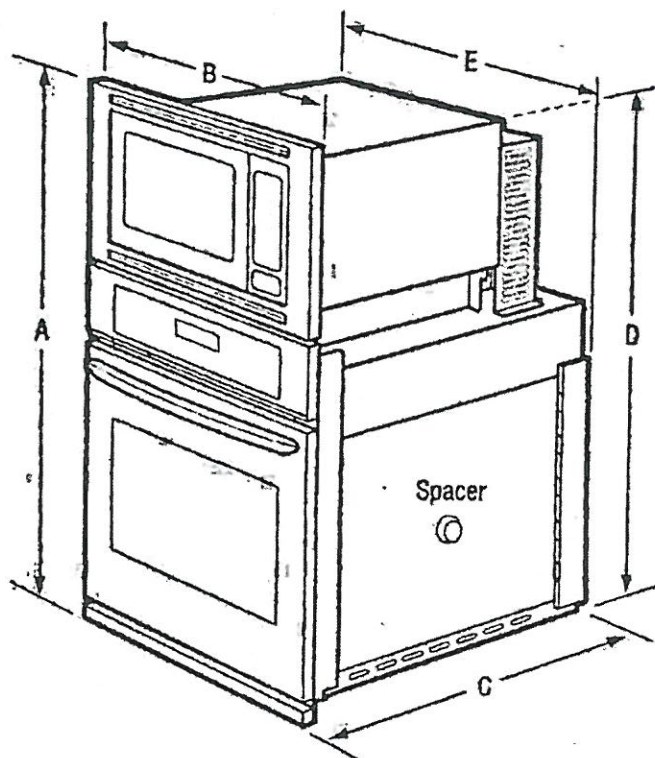

*Single phase 3- or 4-wire cable, 120/240 or 120/208 Volt, 60 Hertz AC only electrical supply with ground required on separate circuit fused on both sides of line.
 Note: For permitting purposes only. Always consult local and national electric, gas and plumbing codes.
 Refer to Product Installation Guide for detailed installation instructions on the web at frigidaire.com/frigidaire.ca
 Specifications subject to change. Accessories information available on the web at frigidaire.com/frigidaire.ca

FRIGIDAIRE
 USA • 100 David Taylor Drive • Channahon, IL 61602 • 1-800-FRIGIDAIRE • frigidaire.com
 CANADA • 8885 Terry Fox Way • Mississauga, ON L5V 3E4 • 1-800-265-8352 • frigidaire.ca

FGMC3066U 02/19
 © 2019 Electrolux Home Products, Inc.

PV-4

May 04 2021

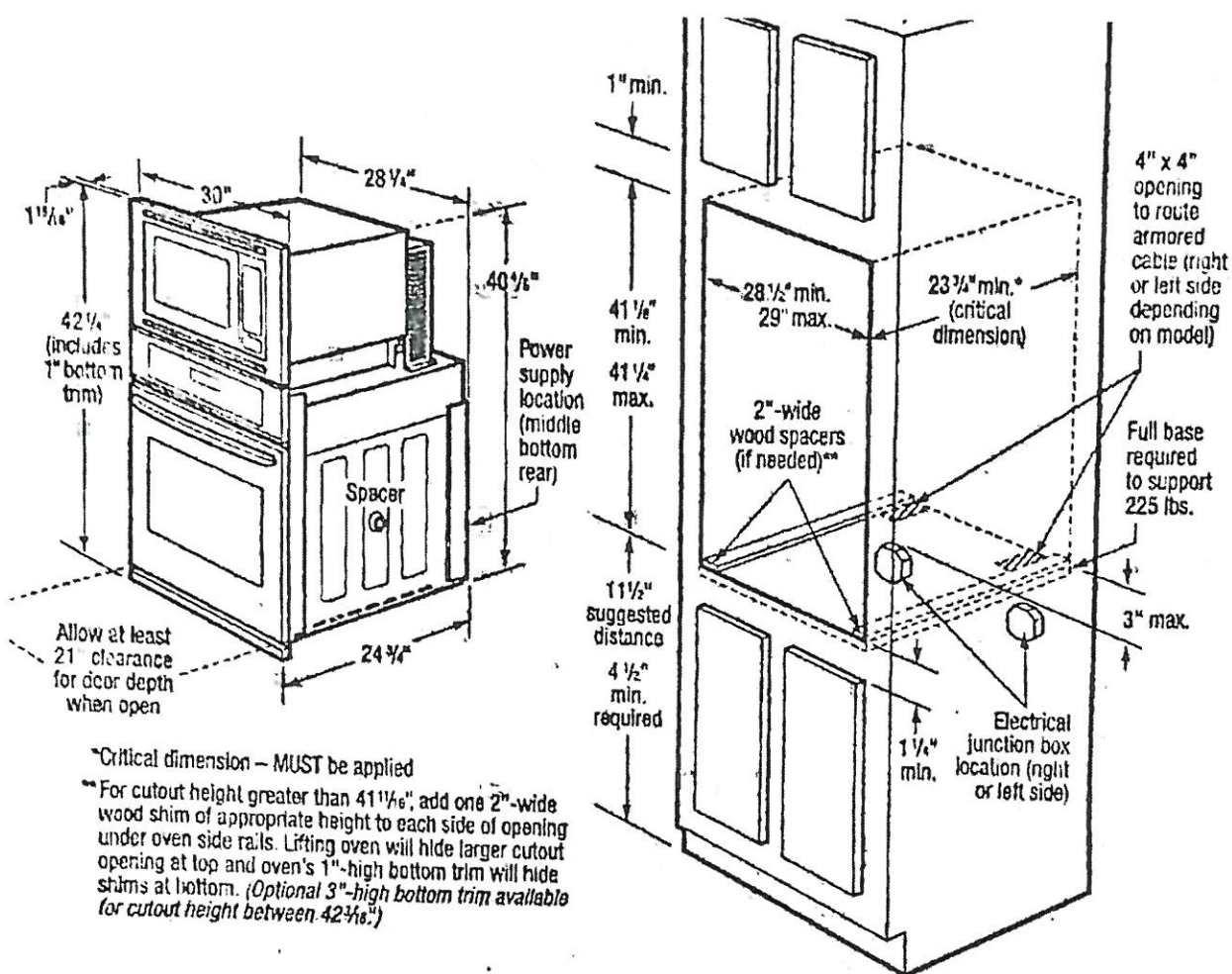

INSTALLATION SPECIFICATIONS

- Product Shipping Weight (approx.) – 300 Lbs.
- Supply phase 3- or 4-wire cable, 120 / 240 or 120 / 208 Volt, 60 Hertz AC only electrical supply with ground required on separate circuit fused on both sides of line
- Connected Load (kW Rating) @ 240 / 208 Volts = 7.9 / 5.9 kW
- Amps @ 240/208 Volts = 30.38 / 35.25
- Recommended Circuit Breaker – 30 Amps
- Always consult local and national electric codes.
- Minimum 21" clearance for oven door depth when open.
- Suggested distance from floor is 11-1/2". Minimum required distance is 4-1/2".
- To adapt Microwave Combination Oven to fit cutout height greater than 42-3/16", add one 2"-wide wood shim of appropriate height to each side of opening under oven side rails. Lifting oven will hide larger cutout opening at top and oven's 1"-high bottom trim will hide shims at bottom. (Standard 3"-high bottom trim included)

- To adapt Microwave Combination Oven to fit cutout height greater than 42-3/16", optional 3"-high Bottom Trim available.
- Minimum 24" deep cutout dimension is critical for proper installation, to ensure that oven's faceplate will fit flush against cabinet front.
- Full oven base of solid plywood or similar material required, capable of supporting 225 Lbs.
- Base must be level and cabinet front must be square.
- Microwave Combination Ovens are NOT approved to be used in stackable or side-by-side installation.

OPTIONAL ACCESSORIES

- 3"-High Stainless Steel Bottom Trim – (PN # 5304520627).
- 3"-High Black Stainless Bottom Trim – (PN # 5304520624).
- 10'-Long Armored Power Cable – (PN # 903056-9010).



FRIGIDAIRE

3650 Northpoint Drive • Charlotte, NC 28262 • 1-800-FRIGIDAIRE • frigidair.com
 5400 Terry Fox Way • Mississauga, ON L5V 3E4 • 1-800-265-8352 • frigidair.ca

Note: For planning purposes only. Always consult local and national electric, gas and plumbing codes. Refer to Product Installation Guide for detailed installation instructions on the web at frigidair.com / frigidair.ca. Specifications subject to change. Accessories information available on the web at frigidair.com / frigidair.ca.

FGMC3066U 02/19
 ©2019 Electrolux Home Products, Inc.

PV-4 
 MAY 04 2021

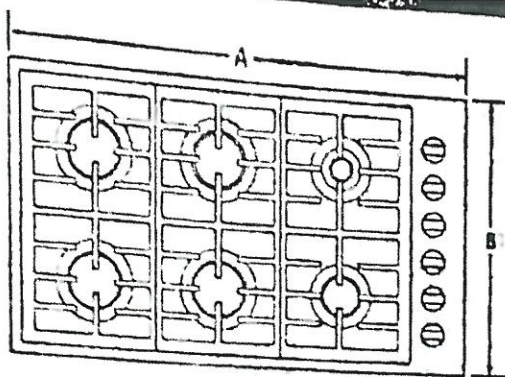

TOP VIEW

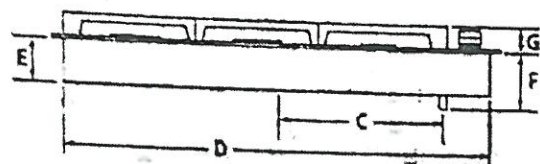

FRONT VIEW

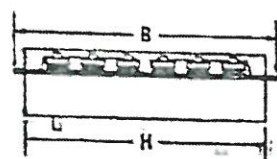

SIDE VIEW

MODEL #		JGC7636B	
		in	mm
A	Overall width	36	91.4
B	Depth of cooktop	21	53.3
C	Center of cooktop to center of gas inlet	13 1/4	34.3
D	Width of recessed cooktop	35 1/4	89.5
E	Height of recessed cooktop	3 1/4	8.3
F	Height from gas inlet to countertop	5 1/4	13.3
G	Height with grates	1 1/4	3.2
H	Depth of recessed cooktop	20 1/4	51.4

IMPORTANT: Dimensional specifications are provided for planning purposes only. Do not make any cutouts based on this information. Refer to the Installation Guide before selecting cabinetry, verifying electrical/gas connections, making cutouts or beginning installation. All Jenn-Air appliances are appropriately UL, CUL or CSA approved.

JENN-AIR

8658AdZw1015

PV-4

MAY 03 2021

(Signature)

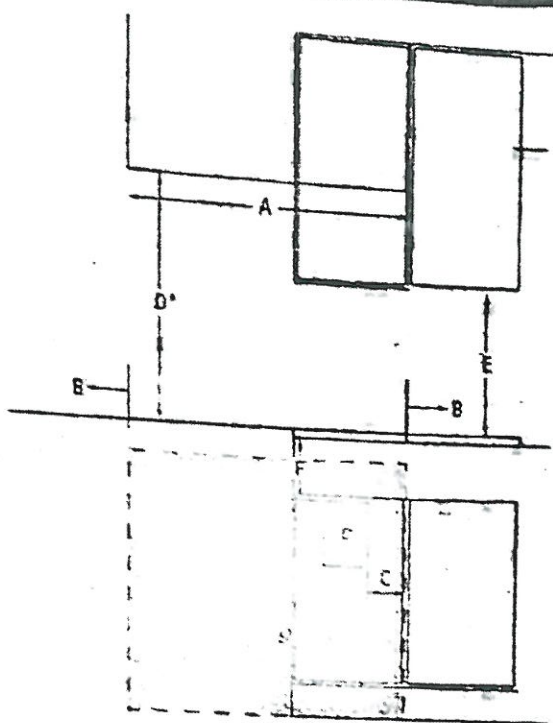

FRONT VIEW

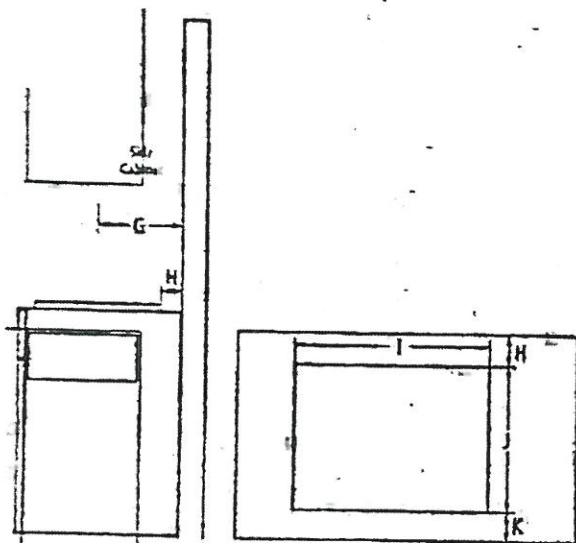

SIDE VIEW

TOP VIEW - CUTOUT

MODEL #		JGC7636B	
		in	cm
A	Width of combustible area above cooking surface (min.)	36	91.4
B	Width from cooktop to fixed wall or other combustible material (min.)	6	15.2
C	Width to outer edge of outlet (max.)	24	61.0
D*	Height to bottom of uncovered wood or metal cabinet above cooking surface (min.)	30	76.2
E	Height to bottom of uncovered wood or metal cabinet (min.)	18	45.7
F	Height to top edge of outlet (min.)	5 1/8	14.0
G	Depth of upper cabinet (recommended)	13	33.0
H	Depth from cutout to wall (min.)	2 1/4	5.9
I	Width of cutout	25 1/4	64.9
J	Depth of cutout	20 1/4	51.8
K	Depth from cutout to front of countertop	2 1/4	5.9
e	Recommended electrical access location		
g	Recommended gas supply line location		

*Dimension can be reduced by 6" (15.2 cm) when bottom of wood or metal cabinet is covered by not less than 1/2" (0.6 cm) flame retardant material covered with not less than No. 28 MSG sheet metal, 0.015" (0.4 mm) stainless steel, 0.024" (0.6 mm) aluminum or 0.020" (0.5 mm) copper. If installing a hood or microwave hood combination above the cooktop, follow the hood or microwave hood combination instructions for dimensional clearances above the cooking surface.

GAS REQUIREMENTS

Natural Gas

This cooktop is factory-set for use with natural gas.

LP Gas Conversion

Conversion must be done by a qualified service technician. To convert to LP gas, use an LP gas conversion kit.

ELECTRICAL REQUIREMENTS

120 volt, 60 Hz, AC only, 15-amp fused, electrical circuit is required. A time-delay fuse or dedicated circuit is recommended.

LOCATION REQUIREMENTS

- To ensure cooktop base clearance, cabinet side walls need to be wider than the cutout.
- If cabinet has a drawer, allow a 4" (10.2 cm) minimum clearance between countertop and top of drawer. Drawer depth may need to be shortened to avoid interfering with the regulator.

IMPORTANT: Dimensional specifications are provided for planning purposes only. Do not make any cutouts based on this information. Refer to the Installation Guide before selecting cabinet, verifying electrical/gas connections, making cutouts or beginning installation. All Jenn-Air appliances are appropriately UL, CUL or CSA approved.

JENN-AIR®

8658Ad2w1015

PV-4

May 03 2021

listed here.

Tools Needed

- Level
- Drill with 1/4" (3 cm), 3/8" (9.5 mm) and 5/16" (7.9 mm) drill bits
- Pencil
- Wire stripper or utility knife
- Tape measure or ruler
- Pliers
- Caulking gun and weatherproof caulking compound
- Vent clamps
- Jigsaw or keyhole saw
- Flat-blade screwdriver
- Metal snips
- Phillips screwdriver

Parts Needed

- Home power supply cable
- 1/2" (12.7 mm) UL listed or CSA approved strain relief
- 3 UL listed wire connectors

For Vented Installations, you will also need:

- 1 wall or roof cap
- Metal vent system

For Non-Vented (Recirculating) Installations, you will also need:

- Recirculation Kit for non-vented (recirculating) installations only. See "Assistance or Service" section to order.
- 6" (15.2 cm) diameter round metal vent duct - length required is determined by ceiling height.

Parts supplied

Remove parts from packages. Check that all parts are included.

- Hood canopy assembly with ventilator and LED lights installed
- Vent transition with back draft dampers
- Metal grease filter - depending on model and size
- Vent cover support bracket
- Mounting template
- 2-piece vent cover
- 4 - 4.2 x 8 mm screws
- 5 - 5 x 45 mm mounting screws
- 2 - D6.4 x 18 mm washers
- 2 - 8 x 40 mm wall anchors
- 4 - 10 x 60 mm wall anchors
- 4 - 5.4 x 75 mm screws (for 10 x 60 mm wall anchors)
- 2 - 3.5 x 9.5 mm sheet metal screws
- T10 TORX® adapter

TORX is a registered trademark of Acument Intellectual Properties, LLC.

4

Have a qualified technician install the range hood. It is the installer's responsibility to comply with installation clearances specified on the model/serial/rating plate. The model/serial/rating plate is located behind the left filter on the rear wall of the vent hood.

Canopy hood location should be away from strong draft areas, such as windows, doors and strong heating vents.

Cabinet opening dimensions that are shown must be used. Given dimensions provide minimum clearance.

This range hood is recommended for use with cooktops with a maximum total rating of 65,000 BTUs or less.

Grounded electrical outlet is required. See "Electrical Requirements" section.

The canopy hood is factory-set for venting through the roof or wall. For non-vented (recirculating) installation see "For Non-Vented (Recirculating) Installation Only" in the "Connect Vent System" section. Recirculation Kit Part Number W10C92903 is available from your dealer or an authorized parts distributor.

All openings in ceiling and wall where canopy hood will be installed must be sealed.

For Mobile Home Installations

The installation of this range hood must conform to the Manufactured Home Construction Safety Standards, Title 24 CFR, Part 328 (formerly the Federal Standard for Mobile Home Construction and Safety, Title 24, HUD, Part 280) or when such standard is not applicable, the standard for Manufactured Home Installation 1982 (Manufactured Home Sites, Communities and Setups) ANSI A225.1/NFPA 501A, or latest edition, or with local codes.

Product Dimensions

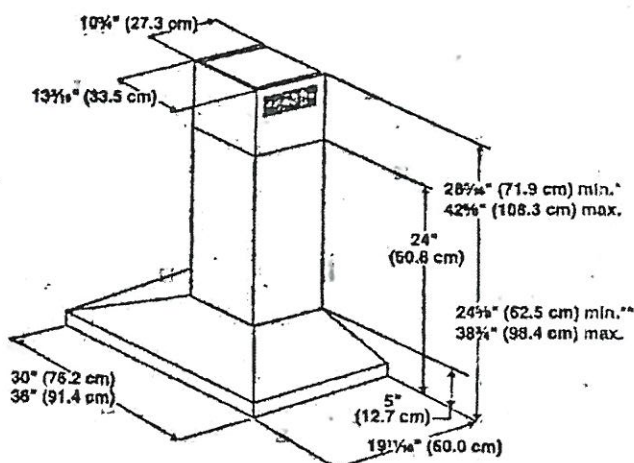

*For non-vented (recirculating) installations

**For vented installations

PV-4

MAY 03 2021



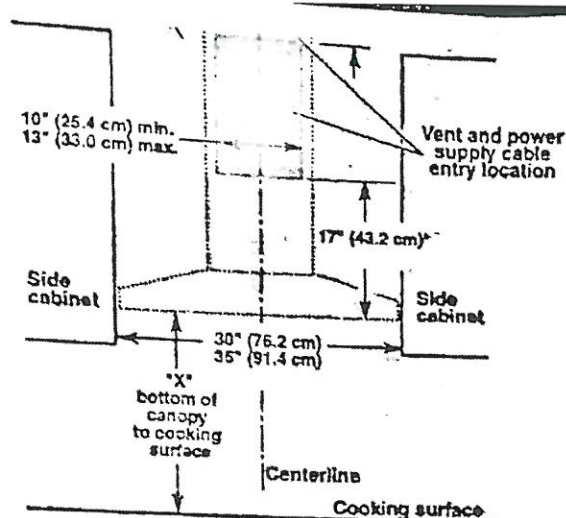

*For non-vented (recirculating) installations

IMPORTANT:

Minimum distance "X": 24" (61.0 cm) from electric cooking surface.

Minimum distance "X": 27" (68.6 cm) from gas cooking surfaces.

Suggested maximum distance "X": 36" (91.4 cm)

The chimneys can be adjusted for different ceiling heights. See the following chart.

Vented Installations		
	Min. ceiling height	Max. ceiling height
Electric cooking surface	7' 1" (2.16 m)	9' 2" (2.79 m)
Gas cooking surface	7' 4" (2.23 m)	9' 2" (2.79 m)
Non-Vented (Recirculating) Installations		
	Min. ceiling height	Max. ceiling height
Electric cooking surface	7' 1" (2.16 m)	9' 6" (2.9 m)
Gas cooking surface	7' 4" (2.23 m)	9' 6" (2.9 m)

*NOTE: The range hood chimneys are adjustable and designed to meet varying ceiling or soffit heights depending on the distance "X" between the bottom of the range hood and the cooking surface. For higher ceilings, a Stainless Steel Chimney Extension Kit Part Number W10272075 is available from your dealer or an authorized parts distributor. The chimney extension replaces the chimney shipped with the range hood.

- Do not terminate the vent system in an attic or other enclosed area.
- Do not use 4" (10.2 cm) laundry-type wall cap.
- Use metal vent only. Rigid metal vent is recommended. Plastic or metal foil vent is not recommended.
- The length of vent system and number of elbows should be kept to a minimum to provide efficient performance.

For the most efficient and quiet operation:

- Use no more than three 90° elbows.
- Make sure there is a minimum of 24" (61 cm) of straight vent between the elbows, if more than 1 elbow is used.
- Do not install 2 elbows together.
- Use clamps to seal all joints in the vent system.
- The vent system must have a damper. If the roof or wall cap has a damper, do not use the damper supplied with the range hood.
- Use caulking to seal exterior wall or roof opening around the cap.
- The size of the vent should be uniform.

Cold Weather Installations

An additional back draft damper should be installed to minimize backward cold airflow and a thermal break should be installed to minimize conduction of outside temperatures as part of the vent system. The damper should be on the cold air side of the thermal break.

The break should be as close as possible to where the vent system enters the heated portion of the house.

Makeup Air

Local building codes may require the use of makeup air systems when using ventilation systems greater than specified CFM of air movement. The specified CFM varies from locale to locale. Consult your HVAC professional for specific requirements in your area.

Venting Methods

This canopy hood is factory-set for venting through the roof or wall.

A 6" (15.2 cm) round vent system is needed for installation (not included). The hood exhaust opening is 6" (15.2 cm) round.

NOTE: Flexible vent is not recommended. Flexible vent creates back pressure and air turbulence that greatly reduce performance.

Vent system can terminate either through the roof or wall. To vent through a wall, a 90° elbow is needed.

Rear discharge

A 90° elbow may be installed immediately above the hood.

PV-4

MAY 03 2021



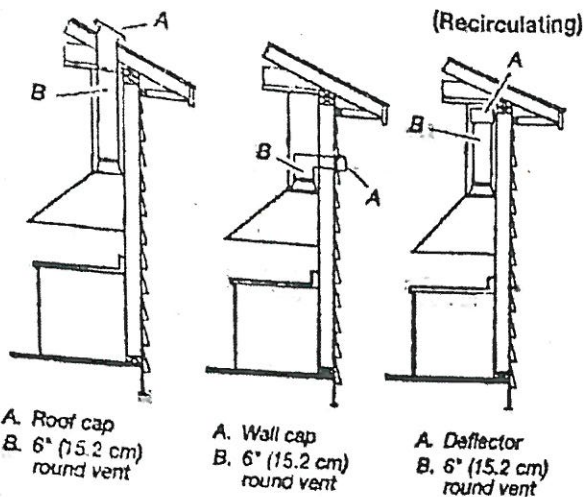

Calculating Vent System Length

To calculate the length of the system you need, add the equivalent feet (meters) for each vent piece used in the system.

Vent Piece 6" (15.2 cm) Round

45° elbow 2.5 ft (0.8 m)



90° elbow 5.0 ft (1.5 m)



Maximum equivalent vent length is 35 ft (10.7 m).

Example vent system

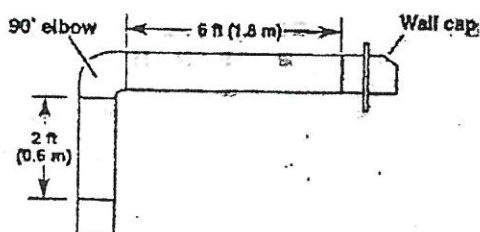

The following example falls within the maximum recommended vent length of 35 ft (10.7 m).

1 - 90° elbow = 5.0 ft (1.5 m)

1 - wall cap = 0.0 ft (0.0 m)

8 ft (2.4 m) straight = 8.0 ft (2.4 m)

Length of system = 13.0 ft (3.9 m)

Code, Part 1 and C22.2 No. 0-M91 (latest edition) and all local codes and ordinances.

If codes permit and a separate ground wire is used, it is recommended that a qualified electrician determine that the ground path is adequate.

A copy of the above code standards can be obtained from:

National Fire Protection Association

1 Batterymarch Park
Quincy, MA 02169-7471

CSA International
8501 East Pleasant Valley Road
Cleveland, OH 44131-5575

■ A 120 V, 60 Hz, AC only, 15 A, fused electrical circuit is required.

■ If the house has aluminum wiring, follow the procedure below:

Connect the aluminum wiring using special connectors and/or tools designed and UL listed for joining copper to aluminum.

Follow the electrical connector manufacturer's recommended procedure. Aluminum/copper connection must conform with local codes and industry accepted wiring practices.

■ Wire sizes and connections must conform with the rating of the appliance as specified on the model/serial/rating plate. The model/serial/rating plate is located behind the left filter on the rear wall of the range hood.

■ Wire sizes must conform to the requirements of the National Electrical Code, ANSI/NFPA 70 (latest edition), or CSA Standards C22. 1-94, Canadian Electrical Code, Part 1 and C22.2 No. 0-M91 (latest edition) and all local codes and ordinances.

PV-4

MAY 03 2021

